Four Valleys Archive

Anthropology

1983

PSB 012 Horikawa Field Notes 1983

Mark Horikawa

Follow this and additional works at: <https://digital.kenyon.edu/honduras>



Part of the Archaeological Anthropology Commons

Recommended Citation

Horikawa, Mark, "PSB 012 Horikawa Field Notes 1983" (1983). *Four Valleys Archive*. Paper 92965.
<https://digital.kenyon.edu/honduras/92965>

This Field Notes is brought to you for free and open access by the Anthropology at Digital Kenyon: Research, Scholarship, and Creative Exchange. It has been accepted for inclusion in Four Valleys Archive by an authorized administrator of Digital Kenyon: Research, Scholarship, and Creative Exchange. For more information, please contact noltj@kenyon.edu.

P.S.B.

31 Mayo 1983

P83-12-1

- Today was our first day in the field, the students first time at the site. We arrived at the site (Gualjoguito) at ~ 2:00 p.m. under a hazy (probably smoky) skies. The sun was bright, but there was also a comfortable breeze reducing the heat.

Pat & Ed immediately checked out the mounds at the Santa Barbara end of the site. Wendy showed the students the map that was prepared by an earlier investigation (Haremann?). We (students) then followed Wendy around to the mounds, looking at test trenches and looter's pits. Jute skulls were seen all over the place, there was also some obsidian, various pot sherds, including a late, pre-classic, bowl sherd identified by its distinctive lines on the lip.

As we all worked our way towards the San Pedro Sula side of the site our attention was drawn to a micro contour in the middle of the soccer field. Excavating the field may be a problem however, due to local opinion. The drain trench at the extreme end of the field was checked for stratigraphy, but no conclusions were made. The flattening of the field is as of yet an unclear event, I think. A linear stone structure bordered the field near the road.

We walked through the mounds on the other side of the road more or less for the sake of orientation. The field between the mounds seemed to have been recently burned for the coming growing season. Cow or horse bones were scattered through the field, no big deal. First day site seeing was basically just a brief show; full of Gualjoguito, the work starts later.

5 workers will be hired @ \$3.00/day (dollar:tempira 1:2) to ~~work~~ work 5 days and to be paid for 7 days.

P.S.B.

1 June 1983

P83-12-2

Hot, bright, sunny morning

Wendy & workers began excavations at STR 29 & 30. Pat & Ed and the students made practice sketch maps of STR 2, 3, 4 & 5, using the iron stakes to indicate the approximate corners. In front of STR 5 (North side) a low platform was inferred. After the sketch maps were finished, Pat & Ed showed us some new interpretations of str 1 and str. 1, 5, 8. STR 1 was divided into 2 attached structures with a "staircase" on the west side of bridging the 2 structures. Split level platforms seem to connect structures 1, 5, 8 following natural contours. The previous map of the site showed none of these characteristics. Drawing the split level platforms seemed to bring everybody a lot of frustration, but under some guidance the structures were eventually drawable.

At 10:00 ish we took a brief break. Ed went back to the house to get the plastic stadium rod and pick up a soda for all of us. During his absence Pat demonstrated the proper use of compasses and the transit. We putzed around with degrees and minutes until Ed got back at ~12:00, which when lunch began. P.b. = jelly sandwiches, eggs, and pineapple and soda pop.

After lunch Pat & Ed plotted points for a site map with the transit located on mound 3. Each structure and feature was identified by a wooden stake & ID number. Rains came around 3:40 so the transit was put away and we began to clean things up. Wendy however was still going strong so we moved campover to STR 29 & 30 and watched the workers screen the dirt for pot, sherds & obsidian & whatever. Bird bone was found at site 30, but whether it was significant or not is not clear.

PSB

P83-12-3

2 June 1983

Muggy, cloudy morning not too hot.
I start collecting at STR 3 (lot 16), 1 meter inside the iron marking stakes. 3 piles of rock rubble lie on the west side of the structure.

Matate like rock found at the middle rock pile at the north-west corner of the mound. Red "X" mark on the ~~two~~ pieces measuring 29 cm x 26 cm x 8 cm.

Possible cut blocks at south pile of rock located on the west: 19 cm x 14 cm x 16 cm (X_1)
28 cm x 16 cm x 10 cm (X_2)
21 x 13 x 11.5 (X_3)
21 x 17 x 12 (X_4) ~~is~~ Dobi

Piece of Dobi 1/2 buried at SW corner of STR 3 26 x 19 cm.
Many large pieces of Dobi all around the mound.
Too large to carry

Possible cut block at the East side of the mound just south of a rock pile. 19 x 17 x 14

2 possible cut blocks at the rock pile at N.E. corner

1 pale orange rectangular piece 26 x 15 x 8 cm

1 grayish triangular piece 32 x 13 x 10 cm

Possible cut block at north face east side; perhaps notched?

29 x 14 x 5.5 cm

"

" West face middle, 1/2 up mound

29 x 18 x 6 cm

"

" N.E. corner on Top 17 x 9 x 9

"

" Mid of mound on Top east 27 x 14 x 13

PSB

2 June 1983

P83-12-4

- 84 rock piles on the west side of mound: no apparent cause for them. Large lithic artifacts e.g. blocks, grinding bases found.
- Some erosional features on the east side. A few rock piles at the base seem to be a result of erosion. Some sherds were taken from the N.E. rftt/slide.
- A small pit was found at the south end on top of the mound some chert was found inside.

Collection was made of small ceramics, chert pieces, and some debi chunks. Not too much was found by either me or John despite the large size of the mound (#3).

After lunch break I helped Pat & Ed plot their map points ~~which~~ was a difficult task in the strong wind. All of the east side of the road was finished.

PSB

P83-12-5

3 June 1983 - Hazy, humid, overcast

- Today I'm ^{surface collecting} excavating STR 13 (Lot 25).

I collected 1/2 way down the saddles connecting STR 13 with STR 1 and STR 2. Most of the stuff ~~was~~ ^{were} small undecorated unpainted pieces. A few were incised. There ~~was~~ ^{were} ~~one~~ thin pieces of ~~an~~ obsidian waste flakes also.

<u>Possible Cat blocks</u>	<u>size</u>	<u>Pieces</u>
- West side, middle 2M from top	23 x 16 x 11 cm	1
- West side, stair case south end, middle	33 x 24 x 8 cm	1
- West side, 1M south of stairs, 1.5M from base	56 x 27 x 13 cm	2

PSB

~~June~~ June 7, 1983

P83-12-6

Clear, cool morning. Only hot under the sun.
A line was run from a point east of STR 29
along the road until the barbed wire fence at
the south end (east) of STR 15. Stakes were marked
every 30M (usually) to designate the Northeast corner
of a test pit 1x1M.

The transit took elevation readings et al from STRs
29, Point OP 10A, STR 21 and STR 15. Kathleen M.L.
excavator #10 has data for all the points.

After the line was finished I continued marking
Test Pts. The 40 stakes I ordered for the job ran out
at 102, so I ordered 80 more to cover the 3 re-
maining STRS.

We shot the Test Pts around STR 6, 23, and 24
from STA. 3 on STR 7. Our numbers didn't quite match
so we reshot the first 5 pits until we found what we
thought to be our error. Kathleen's book has data for all
the points.

On the other side of the road the transit was set
on STA 4 STR 15. The wooden stadia rod was used for all
points, but the transit was shot from under 1 Meter, angle.
Otherwise we would have to use a compensating transit ~~rod~~.
Readings were usually taken off the N.E. corner of the pits
unless marked. Today we reached T.P. 54.

PSB
8 June

P83-12-7

- overcast, cool day.
- I finished staking the test pits today. Point # 164 at STR 20.
 - I started surface collection on the south side of the barbed wire fence behind STR 19. Working from west to east along the fence I found a lot of artifacts but mainly in the post hole dirt. Frequency of stuff dropped as I moved away from STR 19, 18, and 17. The 2nd aisle in from the fence had much less than the first.

The slope on the west side was partially dumped dirt and there ~~was~~ were a greater than normal amount of exposed artifacts found. ~~It~~ I hear that this could be a midden.

A few meters south of the possible midden was a hole that looked much like a looters pit. The hole was approximately 1x1 meter and .5 meter deep. The sherds, chert and obsidian collected there was designated as lot 38.

Following lunch the transit was set back up on STR 15 in order to finish collecting elevation and distance data on STR 15, 16, and part of 17 and 18. Points # 67, 68, 99, and 100 were obscured by a tree, so those points were taken from STR 21 where STRS 20 and 26 were also recorded. All that is left to do is STR 19, I think.

PSS
9 June 1983

P83-12-8

Base line east side of road

			Mid.	Top	Bottom	∠
	From STA A (NE 10L)					
	NE corner	10 K, 2.5 M from wall.	4001	4155	3852	332°20'
	NE corner	10 M	0905	1054	0754	152°20'
	NE corner	10 N 1.92 M from wall	0575	0876	0279	
11	From STA B (10N)	NE corner	2069	2370	1172	332°30'
12	"	10 O 2.5 M from wall	1270	1420	1120	151°50'
13	"	10 P 2.8 "	1112	1412	0812	
(10 as BS)	"	10 Q 2.5 "	1142	1595	0710	
		10 R 2.				
4,5	From STA C (10R)	10 S	0940	1090 ^{29"}	0800	151°50'
6	STA D slope 4 1°50'		0577	0865 ^{58"}	0283	
7,8	From STA D (STR 24)	10 T	2538	2708	2371	
9	"	10 U	1708	2022	1392	
	From STA 5 (STR 11)					
1	10 R x slope 4 1°30'		3909	4132 ^{45"}	3682	203°
2	10 Q x -3°		3967	4103 ^{31"}	3832	243°30'
3	10 P -3°		3517	3693 ^{45"}	3345	299°30'

* distance from 10 S and 10 T is 60 M (not 30 M).
 distance from 10 S to STA D. is 27 M.
 NE corner of 10 Q is in small depression

PSB

9 June '83

P83-12-9

Sunny, breezy afternoon for surface collecting. T. P. Barney and I started surface collecting on the east side of the road (TP 1-26). Most of the artifacts were small fragments of pottery or stone tool stuff. Not too much was left for us to pick up. Some of the pits were filled with debris from surrounding areas, including cow and horse manure. The operation was designated IF and lots were numbered by the pit number.

Some unmarked pits were found behind SPR 6 and 23. I don't know how I missed these but I suppose they'll have to be taken care of sometime.

PSB

10 June 1983

P83-12-10

Photos

- clear morning with some hovering clouds.
Shooting Pentax SP 1000 w/ Fujichrome #100
Early Morning good shadows.

1 - First shot - North side of STRS. 7, 1, 5 from STR 24
SS. $\frac{1}{250}$ f. 11

2 - Trench at STR 24, SS $\frac{1}{125}$ f. 8

3 - North side of acropolis from STR 12 $\frac{1}{125}$ f. 11

4 - depositional delta from STR 12 $\frac{1}{125}$ f. 11

5 - acropolis group from hill on east side
of the site. SS. $\frac{1}{60}$ f. 16

6 } shots of valley from east side of site
7 }
8 } $\frac{1}{125}$ f. 16

9 - STR 12 and soccer field, from hill
 $\frac{1}{125}$ f. 11

* took surface collection here, loose soils

10 - E.L. from STR 3 $\frac{1}{125}$ f. 16

11 - looters pit STR 1 and west side STR 5
from STR 2. $\frac{1}{125}$ f. 11

12 - Wendy at pit 10 G $\frac{1}{125}$ f. 9

13 - Wendy and Kate same

14 - Barney at T.P. 104 $\frac{1}{125}$ f. 8

15 - Waker at T.P. 204

16 }
17 } Emilio and workers at 10c
18 } $\frac{1}{125}$ f. 8.5

ISB
10 June 1983

P83-12-11

delinquent test pits

STA #	point	mid	top	bottom	?
I.H.	NE 165 (STR 6)	3528	3735	3320	175° 00'
.81 M	NE 166	3515	3725	3312	170° 20'
-	NE 167	3640	3847	3430	165° 40'
-	NW 168	3392	3800	3389	162° 30'
-	NE 169	3450	3655	3240	157° 20'
-	NE 170 STR 23	4025	4255	3800	228° 50'
-	171 NE	4155	4415	3902	223° 00'
-	172 NE	4250	4532	4005	225° 00'
-	173 NE	4000	4290	3710	226° 25'
-	174 NW	4025	4330	3720	225° 00'
-	175 NW	4050	4355	3735	222° 05'
-	176 NE	4037	4325	3720	219° 30'
STA 7	NE 177	3306	3520	3048	186° 20'
STR 21					
I.H.	STA 100 STR 18	1965	2560	1402	162° 30'
.73 M					160
	Windy's pit STR 19	24 90	2649	23 32	342 30 ✓
	Middum				271.20'
STA 100	Kathleen's yard	2977	3172	2971	246° 30'
I.H.	lohn's pit NE	2977	3172	2971	246° 30'
L.33	NW	3089	3294	2889	246° 45'
STA 100	SW	3167	3370	2960	245° -
	Concentrations				
	#1 NE	2571	2895	2252	172° 00'
	NW	3035	3335	2738	186° 50'
	SW	3200	3520	2969	182° 40'

PSS

PSS

14 June

PSS-12-13

Site 27

- land owned by Santa Rosa Cooperative

Today Ed, Brad, and I mapped site 27, a hilltop site about 0.5 km SE of Guadalupe. The site is now a cornfield measuring approximately 300 m long x 50 m across. The corn has been planted, probably last week sometime, and it will cover most of the low lying structures. There were two long STRS, roughly opposite each other about 1/2 way down the site. The other STRS were short rectangles ~ 5 m x 2 meters. Very little elevation on any of them. The hilltop upon which the site lies slopes down on all sides except the south side where the road cuts through. The planted area is generally lower than the rim areas, but there are various contours in the landscape.

From STA 1 in the NW corner of the site it is possible to ~~see~~ look down upon Guadalupe and the Urua river valley. Sites across the river can be seen from here. The town of Santa Rosa is about 0.75 km NE of this site.

Ed has sketch map. Brad has data points.

PSB

P83-12-14

14 June, 1983

Site 28

land owned by Santa Rosa Cooperative

Site 28 was located on a low field separating site 27 from Gualajoquito, a quebrada marked off its northern boundary and the hill slope up to site 27 limited its southern extent. Site 28 covered ~~a~~ a triangular area 100 M at its base and 200 m high.

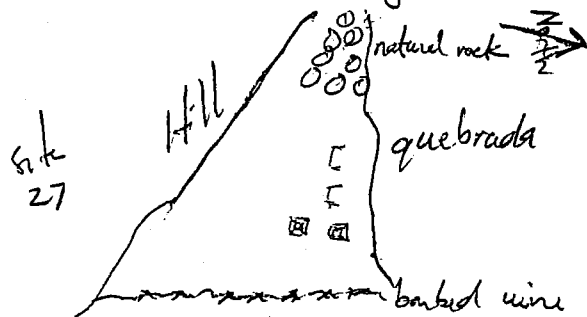

There were 2 distinctive structures with low elevation, and 2 possible structures delineated by lines of rock. All were in a concentrated area of the northeast corner of the site.

The land is basically flat though there is a subtle slope from the hill to the quebrada. As we mapped points using a compass and 30M tape, 2 men were planting corn. During the other seasons it seems to have been used for cattle grazing.

One non-distinctive pot sherd was found in the vicinity of the STRS, but it was discarded.
See Brad's notes for data points.

The next field we surveyed was the adjacent field on the east side. No structures were located but some pot sherds were found at the base of the hill (south side). The field was similar to site 28 except that there were ~~not~~ parallel crests made for crops. The sherds were found on the crests. No planting was apparent yet though in a few days it may be.
The adjacent field to that was also empty, no sherds either.

PSB

14 June 1983

1983-12-15

Site 30

- Site 30 was located on a hill approximately 0.5 km due east of site 27. The field was very rocky, non-cultivated, but used for grazing. Santa Rosa can be seen due north across the quebrada valley. Site ~~28~~ 30 consisted of an arrangement of rocks about 20 M off the road, well away from the hillside, azimuth $78^{\circ}30'$

6.9 - North-south

5 M east-west

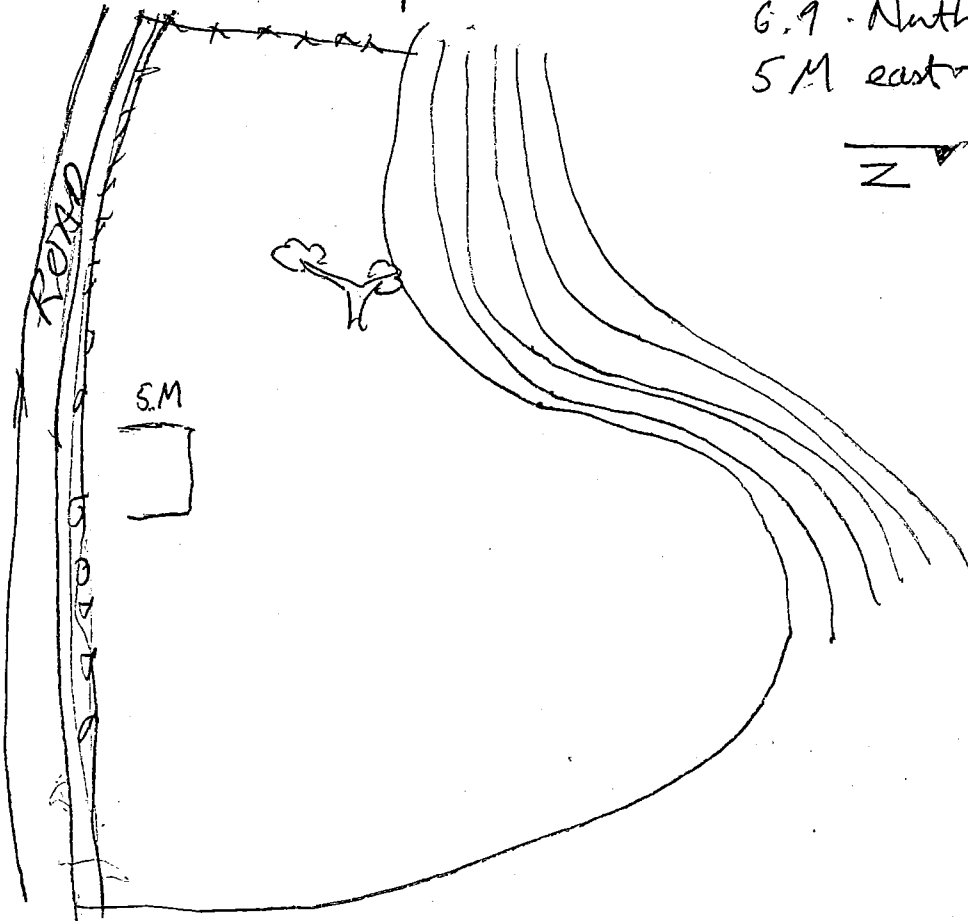

Santa Rosa

PSB

P83-12-16

14 June, 1983

Site 31

Site 31 was a hilltop approximately 0.25 Km from site 27. It appears uncultivated, but grazed low shrub growth and rocks cover the surface. The road marks the south boundary and the hill slope circles around the site.

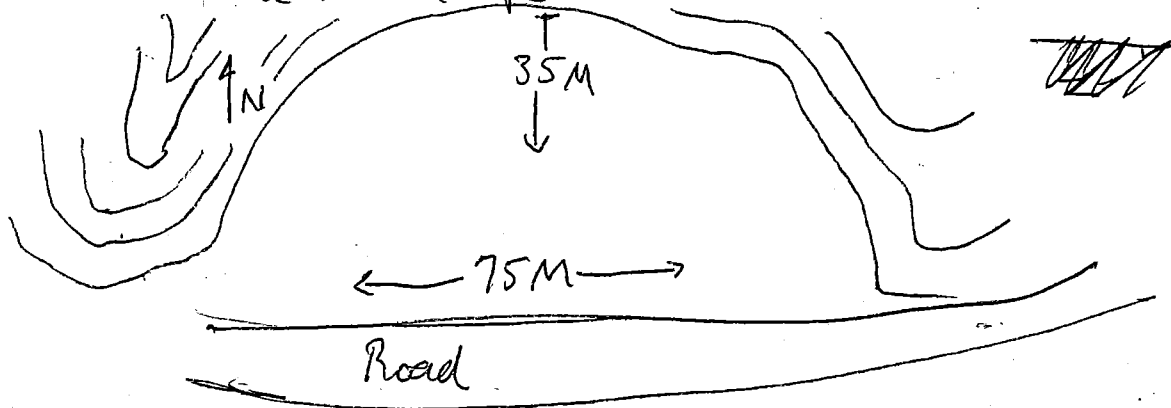

There were 15 STRS located, and 1 Feature. See Brad's book for data, Ed's for sketch maps. The river is not well seen from this site, nor is Cuahloquite visible, but this site follows the pattern of settlements on ridges of the Ulna. Site 30, 27, and other hill top sites seem to be in line with this, the closer to the river the more numerous the STR seem to be.

Pot sherds, obsidian and chert were collected high on the hillside above site 29 where the earlier collection of sherds were found. These sherd probably washed down from here.

PSO

P83-12-17

15 June, 1983

Site 32

-land owned by Santa Rosa Coop 100 x 25 M

Site 32 was found on the south side of the road across from site 27. Brad and Amy found a few possible structures on an overgrown bluff. The vegetation was too high and thick for mapping of the site.

Quebranta is about 500 M NR of site 32 and the Rio Honda is about 500 M south. Quebradas cut through these bluffs fairly regularly but now they are dry.

Shards were found at one of the STRs here and a Metate fragment was found on the path along the quebrada.

Site 33

Site 33 was located south across the quebrada (dry) from site 32. It was an open field under corn cultivation by the Santa Rosa Coop. Measuring ~200 M x 75

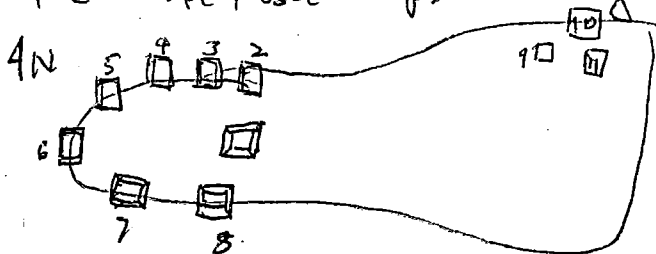

The STRs were fairly low and often covered by brush esp 2-7.

Surface collection for 33A/1 was taken at the south base of STR 8. One shard from STR 9 was discarded.

PSB

15 June, 1983

PSB-12-18

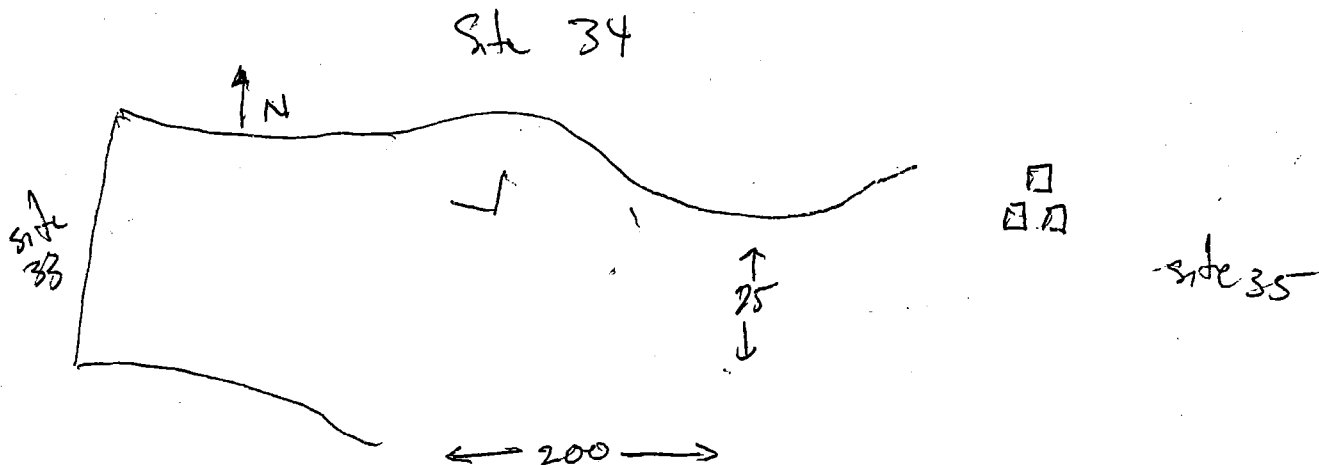

Site 34 was immediately adjacent to site 33. It was only distinguished by the need to change station to continue shooting, an arbitrary line was drawn just west of P1 and P2. This field was also being planted with corn by the Santa Rosa Coop, and they didn't seem to mind our walking through their field. No sherds were found.

Site 35

Site 35 was located about 100 M. north of the Rio Hondo on private property, I think. There were many structures scattered ~~to~~ over the hillside, recently planted with corn. The mapped area was about 25 x 25 M. No artifacts were found.

Site 36

Site 36 was the southwest extension of site 35. It ran along a hill crest about 15 M wide x 65 M long. The structures were low with little or no elevation. Most would overlook the Rio Hondo. The field was also being used as a corn field, much of it seemed to have been burned.

PSB

16 June 1983

P83-12-19

Site 37

Site 37 was located north, across a dry quebrada, from site 35. There were about 8 structures there only 1 with rosette elevation. This field was also privately owned and was being planted with corn. The mapped area was about 70 M². Two artifact collections were made, 37A/1 was collected from the west side of STPS 1 and 37A/2 was the rest of the site.

Site 38

Site 38 was just west of site 37. The STPS. were located mainly on the crest of the hill. The mapped area was about 60 x 10 M. and it was owned by the Santa Rosa Corp.

Site 39

Site 39 was an ~~area~~ overgrown ridge 100 x 50 M, located about 100 M east of site 35 and 30 meters north of the Rio Grande. All STP and/or features were found, including 1 mound measuring about 8 x 5 x 2.5 M. 1 piece of roof tile was found.

PSB June 23, 1983

P83-12-23

Site #	# STR	# F
24	9	3
25	24	0
26	18	7
27	12	3
28	3	2
29	0	0
30	1	0
31	15	1
32	1 (possibly 2)	0
33	11	0
34	14	3
35	17	0
36	6	0
37	11	1
38	8	0
39	12 possible	0
40	10	1
41	3	0
42	13	0
43	5	0
44	1	3
45	2 possible	0
46	0	0
47	3	1
48	2	0
49	11	0
50	8	0
51	10	0
52	42+5	0
53	6	0

27 02
~~27 02~~

GUALJOQUITO

SB2

Centro Monumental

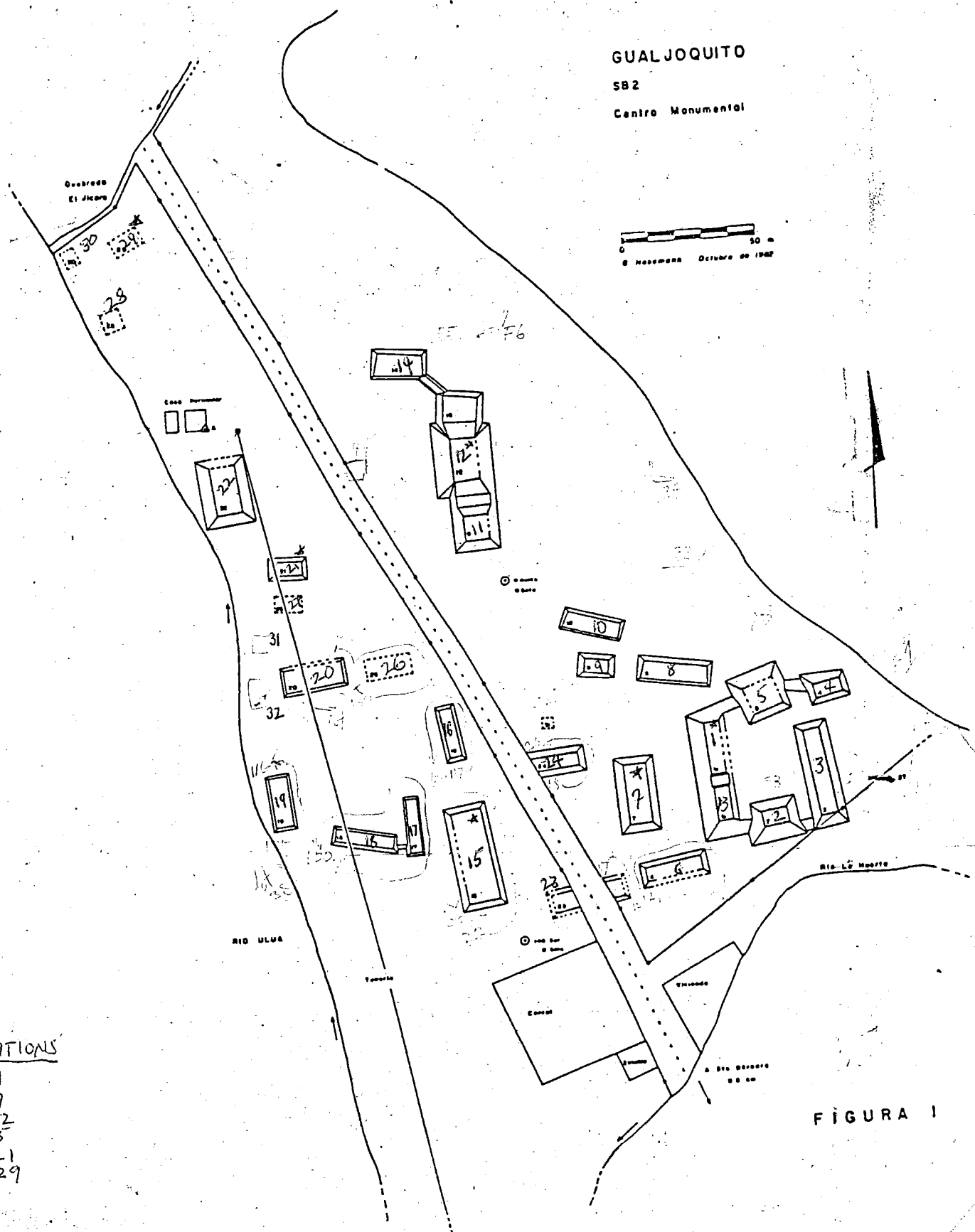
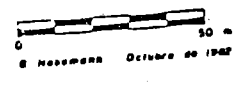

STATIONS

- STR 1
- STR 7
- STR 12
- STR 15
- STR 21
- STR 29

FIGURA 1

PSB June 23, 1983

P83-12-24

<u>Site #</u>	<u># STR</u>	<u># Features</u>
54	6	0
55	7	1
56	1	0
57	2	0
58	1	0
59	3	0
60	4	0
61	4	0
62	2	0
63	3	0
64	1	0
65	6	0
66	6	1
67	4	0
68	4	0
69	5	0
70	4	0
<hr/>		<hr/>
	329	297
	23	3
	<hr/>	<hr/>
	352	300
70	4	0
71	3	2
72	6	1
73	2	0
74	2	0
	<hr/>	<hr/>
	23	3

10J - 10J/1 - 0-10 cm

10J/2 - 10-20 cm

10J/3 - 20-30 cm

10J/4 - 30-40 cm

Base of lot 4 ~ street surface

10J/5 - 40-50 cm

10J/6 - 50-60 cm

10N - 10N/4 - 30-40 cm

10N/5 - 40-50 cm

10N/6 - 50-60 cm

10N/7 - 60-70 cm

10N/8 - 70-80 cm empty

10S - 10S/1 - 0-10 cm

10S/2 - 10-20 cm

10S/3 - 20-30 cm

10S/4 - 30-40 cm

10S/5 - 40-50 cm

10S/6 - 50-60 cm

10M - 10M/1 - 0-10 cm

10M/2 - 10-20 cm

10M/3 - 20-30 cm

10M/4 - 30-40 cm

10M/5 - 40-50 cm

10M/6 - 50-60 cm

1

TR 2 + 2

TR 1

TR 2

TR 3

↑ N

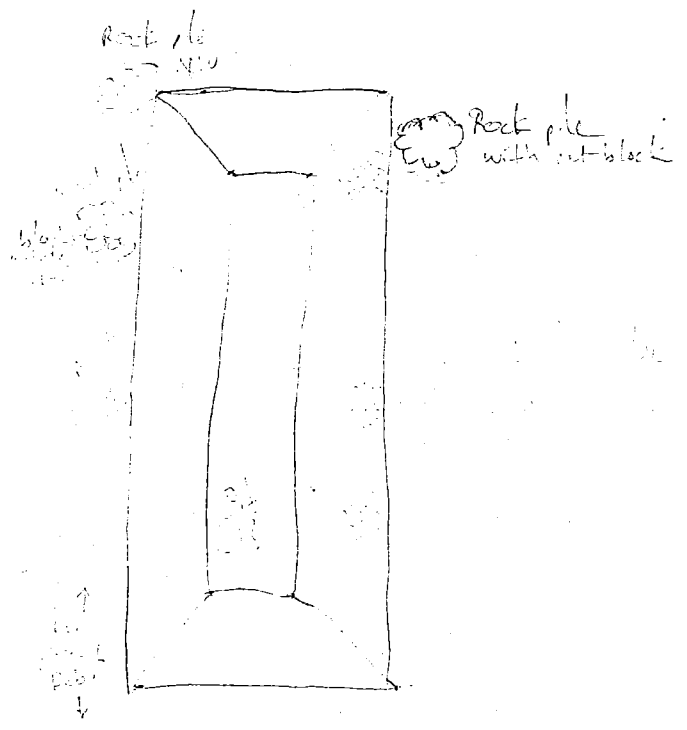

PSB

17 June 1983

183-12-24

Site 43

Site 43 was found on a privately owned hillside overlooking site 24. Large boulders ~~are~~ frequently protrude the surface which otherwise looks like good fertile soil. The site is slightly U-shaped as it slopes down the hill i.e. the east and west sides are higher than the middle. The site measures $\sim 100 \times 60$ M.

Also, the field has been burned for cultivation. One piece of obsidian was found by Ed, and a few ~~other~~ sherds.

The Rio Honda was at the base of the hill, about 250 M from its junction with the Rio Uluca.

From site 43 we walked east to a quebrada where site 44 was located and mapped. It consisted of 1 STR and 3 wall features, using a hand held compass and a 30M tape. The points were roughly plotted. The site was located in a cornfield (privately owned, I think) but only occupied an area of ~ 15 M². No artifacts were found.

Site 45 was about 200 M east of site 44, around a steep hill. This land was also private cornfield, measuring 125 M \times 75 M. No structures were found but some artifacts did come up. The man working the land said that sherds were common. The field was split in two levels with a small quebrada running diagonally through it SE-NW. The Rio Honda and Rio yellow rock joined at the base of the field (north side).

Site 46 was a private field with no structures only sherds, measuring 150 M \times 50 M (the field not the sherds). Yesterday a piece of obsidian was found there and it will be part of the same lot as the sherds. The Rio Honda was located north east of the site by 20 M.

Site 47 was about $3/4$ Km east SE of site 46. There was one group of ~~STRs~~ about 4 STR/features. The land was private and was overgrown. Directly north of site 47 was site 42.

P8B

P83-12-22

17 June 1983

site 47

The east side of the field overlooked a small stream, probably part of the Rio Grande system. This was the southernmost site located by the survey thus far and as hypothesized, the concentration of sites seem to dwindle as distance from Aqualojaito and Rio Uluca increases.

Site 48 was located north of site 42 and south of site 40. It overlooked a field containing 2 portions of the Rio Grande. The river was narrow but ran east. The land was being planted with corn and was privately owned, I think. 2 STRS and 2 pieces of sherds were found in the NE corner of the field on an ~2M high hill. The STRS seemed to have faced south SW, overlooking the field.

Site 49 was about 100M north east of site 48, in a ~~more~~ rocky field. There were about 10 STRS found in one group, some STRS with as much as 0.5M elevation. They occupied an area about 30M x 15M. Across the field to the north was another landscape contour where 2 more groups of STRS were located. These were shot from a new station in between the 2 groups and the site was treated as site 50. The west group of 3 low elevation STRS seemed to be similar in size and shape. The east group consisted of about 5 STRS/features some with low elevations, some with none.

P8B 6 July, 1983

P83-12-25

10J/8 70-80 cm - light brown soil probably indistinguishable from 10J/7 soil. No large stones; sherds & Jute however do appear. North, Northeast corner gets darker in soil color, black streaks

10M/6 50-60 - found nothing. reddish brown soil, no large rocks

10N/9 80-90 cm sherds found in reddish brown soil
cherts too

10 90-100 cm nothing - no change in soil

" 100-110 sherds, obsidian

10M/7 60-70 sherd, no noticeable change in soil color from 10M/6

10S/7 60-70 - trowelling bottom surface. basal? nothing found, end.

10J/9 80-90 cm sherds, lots of Jute soil seemed to get lighter but it may be due to it drying.

10I/1 1-10 cm - humus layer, dark many small tree roots.
some sherd, obsidian

10I/2 10-20 still dark, humus like soil. Roots and small stone cobbles are not infrequent. Some sherds and an obsidian flake were found

10M/8 - not much change in soil appearance. 1 sherd was found.

10M/9 80-90 cm 2 sherds were found.

10T/3 20-30 cm number of sherds increases, stones are also more common, possibly in association with EPR Vt, a stone pebble floor for example? @ 25 cm

PSB
6 July, 1983

P83-12-26

Test Rt 10T/30

After digging down about 30 cm, a pebble layer was hit. Overlying this layer of uneven and irregularly placed pebbles was a higher concentration of pot sherds than that found in lots 10T/1 and 10T/2.

The pebble layer seemed to be about 8 cm below the humus layer, in clay/silt like soil.

The heaviest concentration of these ~~pebbles~~ pebbles starts about 50 cm south of the north wall and continues to the south wall extending probably beyond the east and west walls as well.

Ave. size of the pebble is $\approx 6 \times 4$ cm, and they are all well rounded, non-worked.

After digging through the layer, it appeared to be loosely laid ~~is~~ about 15 cm thick.

PSB

PSB-12-27

6 July, 1953

105/10 90-100 cm - This seems to indicate the basal layer. Juste shells have been collected, but only a few shreds and 1 pc. of worked stone.
End 10T

10N/12 110-120 cm much of the diggers seems very low. 1 sherd was found

10/M 19 80-90 cm The soil seems to be getting progressively lighter in color. 1 large rock lies at the north end of the west wall, but other than that very little can be found. We picked up some shreds and some worked stone.

103T/4 30-40 cm The layer of pebble turned out to be no more than about 6 cm thick. More shreds were found in this layer. Obsidian and chert also appeared.

10T/5 40-50 cm There are still a few rocks under the pebble layer, but nothing suggesting any purposeful construction. Shreds are common, still, and there were a few assorted lithics

10M/10 90-100 cm A few shreds were picked up. The soil seems very hard and brittle

PSB

67 July, 1983

PSB-12-28

10J/10 90-100 cm - end, Jute

10S/7 60-70 cm end empty

10N/12 110-120 cm sherd

10M/10 90-100 cm sherds

10T/5 40-50 cm sherds

This morning pt 10T opened with 2-3 cm left to take out of lot 5. It looks like if it rained last night it didn't rain too hard.

10N will open with lot 13 beginning.

10M still has some dirt to shovel out of 10M/10 but should start PM/11 shortly. 1 sherd, 1 pc of chert

10M/11 100-110 cm - soil seems to become darker from the lower part of 10M/10 continuing into 10M/11. The pick breaks the dirt into large chunks unlike the layers immediately above where the dirt seemed more coarse (sherds, chert)

10N/13 120-130 cm as they start digging this layer the soil seems to become darker. 1 pc of waste stone was found early.
I found three open sherds that the workers said they dug late yesterday from 10N/12, but I wonder.

Not much rock or root lying in either 10M or 10N. The nearest trees are across the road, but I don't know how long this area has

PSB
7 July

P83-12-29

been clear. There seems to be no evidence that a large root system ever existed here.

10T/5 40-50 cm - relatively few sherds were found in comparison to overlying layers. The soil seems to be fairly more fine and lighter in color. This lot was dug yesterday so most of the sherds were taken out!
10T/6 I wouldn't say this stuff is clay, in fact I wonder how fine the soil is. The description above may not be very accurate. The color is lighter however.

10N/13 - Not too much can be found here I'm afraid. The soil profile is pretty nice though. There are about 5 clear layers at 125 cm and under closer inspection it looks like there are some decayed tree roots and holes were either roots once were or where animals have burrowed.

10M/12 110-120 cm 1 sherd was found. The soil looks a bit redder. Few more sherds, but there's not much either here or at 10N. We'll go down to 130.

PSB

1983-12-30

7 July

10T/7

- 60-70 cm The soil continues to lighten in color. There is still cobble pebble litter ~~and~~ sherds aren't maintaining their frequency

10T/8

70-80 cm Still lots of rocks and sherds. Soil is getting redder brown

10N/14

130-140 cm The 5th soil layer seems to continue in 10N/14. The color is dark reddish brown, darker than the soil layer 20 cm above it. Shard found.

The workers started digging this thing in sub levels. So as I see it now there is a level at 10N/14, 10N/15 and ~~10N/16~~. No sherds have been found since early in 10N/14, or so they claim. They seem only interested in getting out of that hole. They'll level the pit at 10N/15 and I'll hold 'em up there. Looks like there will be an early opt. shower.

10T/9

80-90 cm Hit basal level at ~ 90 cm some date in 10T/9 out many sherds. We'll go to 100 cm just for the back pit, then clean it up

PSB
7 July 1983

PSB-12-31

After lunch break I'll get 10N digging down 20cm for a lot. I'm not quite sure where they'll start, at 140 or 150 cm. As soon as 10M gets their ~~130~~ ¹³⁰ cm level cleaned out, I'll get them on 20cm lots as well. Basal rock may be over 2 meters deep in this area, maybe less.

10N/14 150-140 cm - Nothing came out of lot 14 but some large rocks seemed to underlie.

10N/15 140-150 cm - between 145-150 they hit a layer of large stones ~ 7cm². Perhaps the basal rock will be their foundation.

There does seem to be some basal like material already at about 150. The soil looks a little lighter in color, maybe the 6th or 7th layer.

10M/14 - nada - it looks like the soil is becoming lighter again.

10N/16 150-160 cm - This seems to be the end of the line for this pit. At 160 cm they have dug through about 5cm of basal material, possibly more.

10M/15 140-150 cm nothing but dirt, but we may have the first signs of the basal layer just below 150 cm. A few rock tips can be seen at the end of lot 15. Revis's coming but I'll try to get them through 10 more cm.

PSB
8 July

PS3-12-32

10M/16 150-160 con basal material
10M/15 140-150 con

Test pit summary

10J/8 - jute, sherds
10J/9 - jute, sherds
10J/10 - (end) jute, sherd

10M/6 - empty
10M/7 - sherd
10M/8 - sherd
10M/9 - sherds
10M/10 - sherds
10M/11 - sherds, obsidian
10M/12 - sherds
10M/13 -
10M/14 - empty
10M/15 - empty

10T/1 - sherds
10T/2 - sherds
10T/3 - sherds
10T/4 - sherds
10T/5 - sherds
10T/6 - sherds
10T/7 - sherds
10T/8 - sherds
10T/9 - Jute
10T/10 - end

10N/9 - sherd
10N/10 - empty
10N/11 - sherd,
10N/12 - sherd
10N/13 - 1 pc. worked stone
10N/14 - empty
10N/15 - empty
10N/16 - end empty
10N/17 - end

PSB 8 July, 1983

PSB-12-33

10N/17 160-170 cm - Basal material was hit in
lot 15 but the floor was so uneven that
they went down past 160 in order to reater
it up. A piece of obsidian turned up here for
some reason. After the walls and floors are
cleaned up this pit will close.

10M/16 150-160 cm - They're beginning to hit large
rocks at the bottom of this layer. No sherds.
Expect to reach basal layer at 180 cm.

10M/17 160-170 cm. The big rocks have been uncovered.
They measure ~ 30 x 20 cm.
Under these big rocks we'll probably hit the
basal material as in 10N and other pits
north of the main group.

rain at 10:00 work stops

PSB
9 July

PSB-02-34

10N/17

160-170cm We have to take out a bucket or two of water and continue straightening out the walls and corners for photos and drawing.
Found Jute shell.

10M/18

No water has collected in this pit but the floor is very muddy and difficult to shovel. Some of the wall looks a bit washed out but nothing drastic. The big rock at the NE corner measures ~~90~~ 90 x 70 and still has 1/2 unexposed. It is white and rough in a general triangular shape.

PSB

P83-12-35

11 July 1983

Start soil sampling at OP10T.

This pit looks like it was filled 30 cm with rain water according to a ring of wood and plant debris left around the pit wall. The walls look washed out and the floor looks like muck. About 2 cm of dirt was deposited on most of the floor but the corners are almost completely covered over.

sample #1 - 40 cm deep
[all samples from east wall] - 33 cm from SE corner

#2 - 71 cm deep
37 cm from SE corner

#3 - 90 cm deep
50 cm from SE corner

Basal pebbles

#4 - 58 down
92 across

intrusion

Pit 10 ~~10~~ - The floor of this pit is covered by 12 cm of rain water. The wall however looks O.K.

#1 - 42 down
75 across from SE corner

#2 - 72 down
80 across from SE

#3 - 116 down
92 across from SE

P83
11 July 1983

P83-12-3C

Test pit S. $\frac{1}{2}$ back filled. Walls look washed out and
east wall ^{messy} #1 29 down large rock level (floor?)
29 across from North East

#2 50 down below rock level
15 across from North east

RT 3A retaining wall & plaster floor. Samples taken
from East wall below plaster floor.

- #1 21 cm below plaster floor
17 cm south of north wall (NE corner)
- #2 8 cm below plaster floor
20 cm south of north wall (NE corner)
- #3 2 cm below plaster floor
19 cm south of NE corner

10M

- #1 32 from surface
40 cm south of NE corner
- #2 from intrusion of harder, grittier dirt.
52 cm from surface
62 cm south of NE corner
- #3 90 cm from surface
30 cm south of NE corner
- #4 120 from surface
35 from NE corner
- #5 from bottom of pit (basal layer?)
179 cm from surface
110 cm from NE corner

10N Walls in good condition, floor mucky

- #1 80 cm from surface
95 cm from NE corner
- #2 harder inclusion
44 cm from surface
94 cm from NE corner
- #3 67 cm from surface
75 cm from NE corner
- #4 120 cm from surface
70 cm from NE corner
- #5 from basal rock layer
160 cm from surface
80 cm from NE corner
- #6 from another hard inclusion
68 cm from surface
167 cm from NE corner

10J no water in this pit, everything seems to be in good condition

- #1 37 cm down
50 cm south of NE corner
- #2 55 cm down
59 cm south
- #3 69 cm down
21 cm south
- #4 84 cm down
53 cm south
- #5 98 cm down Basal matrix
54 cm across
- #6 60 cm down intrusion
158 cm south

PSB

11 July 1983

soil samples

PK3-12-3D

10F #1 36 cm down

63 cm across from NE corner.

#2 72 down

77 cm south

#3 132 cm down

68 cm south

#4 160 cm down

40 cm south

basal matrix

PSB

P 83-12-39

11, July 1983

Test pit #B

1.00 pm - pit is 80cm deep at the NE corner, and still probably be another meter until they hit sterile soil at the base

4B / lot 7 75-85 cm - light brown, coarse, soft soil. Lots of Jute and some rice polychrome sherds. Took a carbon sample out of the south wall 18 cm down and 30 cm west of the SE corner. Small obsidian blade found

4B / 8 85-95 cm - Sherds, Jute, bone fragment, a few small rocks are scattered through the matrix but nothing to suggest a feature. The soil is still rather coarse and light brown in color.

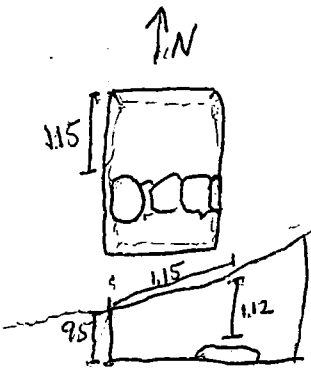

- Uncovered a wall line made of river cobble like material running east-west, ~~1.15~~ cm south of north west corner (at west wall) and 112 cm deep. Cobble size ~ 30 x 20 cm. George's trench just missed the continuation of the wall by a few feet.

4B / 9 95-105 cm The main concern here is to expose the stone wall enough for a photograph. Sherds, jute, and a piece of obsidian have been found.

Ashy layers 90 cm deep from SE corner

light brown fine texture soil turns to light brown tan soil containing 3 different ash lenses

#1 1.080 deep 2 cm thick

#2 1.15 deep

#3 1.27 deep

ashy soil runs over wall. 23-27 cm over "hot" wall.
runs down 29-30 cm north of hot wall
36 cm thick.
"hot" runs 251°30'



PSB

12 July, 1983

PSB-12-41

4B/10

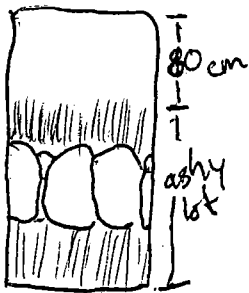

105-115 cm deep - starting from this lot we will separate each lot into an ashy deposit lot and ambient soil lot. The ashy lot starts about 80 cm south of the north wall and continues to the southern wall. Though it has been exposed for about 30 to 40 cm I was not aware of its significance.

- We had gone down to 110 cm until Ed and Wendy came by to map in pit. Unfortunately the pit was not supposed to have been touched until they had mapped it.

- A flotation sample was taken from the soil within 20 cm ~~of~~ north of the hot wall. Large jute, adobe, and sherds were separated into a lot bag and labeled with the flotation sample.

- The rest of 4B 10 (Ashy) was then taken out including the hot wall, and artifacts, etc... were put in a lot bag, marked "Ashy 10".

Sherds, adobe, and jute were found.

4B/10 ashy

- 105-120 cm - due to some mix up this lot was extended 5 extra cm. The pit was leveled at 120. I guess the workers assumed that the intervals fell at the even tens.

- a figurine head 2 cm high was found and some jute and sherds.

4B/11 normal - 115-120 cm - This lot was limited to 5 cm when the diggers leveled the pit at 120. A few jute and sherds were found.

PSB

P83-12-42

12 July, 1983

4B/12 - 120-130 cm - a drilled clamshell came out, right at 120 cm. Shards and jute are still common. The ashy soil continues northwardly but seems to ~~stop~~ disappear at the SE wall where softer coarser medium brown soil appears.

4B/12 normal - 120-130 cm no shards or jute? I wonder what these guys are doing. They seem to understand how the lots are divided, but it seems curious that they're not found anything here. Finally found some shards, jute, and chert but not as much as the ashy lot

4B/13
normal

120-130 cm - bone fragments
From this lot on the pit will be taken down as one lot. The ashy intrusion seemed to end at 120 cm when a lighter brown clay layer was uncovered. The ash did not continue far below the hot wall which was itself only 1 layer of stone. Ed said that hot might have been a foundation of a STR with the ash serving as its fill.

After lunch they start taking the pit down to 150 cm. George's pit, 1 meter to the NW is 140 cm deep, part of that is probably deposited soil. So I expect this pit to go to about 1.5 meters before we hit basal levels.

- Workers hit a burnt earth concentration off the SW corner of the pit. A carbon sample was taken from that area. There was ~~was~~ some light grey ashy material that Mundy assessed as vegetation type material, nothing burned.

PSB

PSB-12-43

OP4B Lot 14

190 cm down in sev corner 16.5 out from South wall
48 out from west wall

seems to be of burnt earth, contains jute, carbon
workmen took out pieces of burnt earth from there
but there were no more sundries.

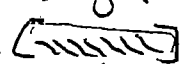
A lot of big pieces of pottery were uncovered in the
southern 1/3 of the pit just past 145 cm deep. 2 had similar
incision  others were red monochrome? another carbon
sample was taken 150 cm deep & 120 cm south of NE corner, 50 cm
west of the east wall

A ton of Jute in this lot. A lot more sherds here
too. Soil color seems to darken and be more
silty.

48 / 15 - Before this lot is started it is possible
to see a floor layer of pebble much like the
basal layer. They'll go 10 cm through these
pebbles to ~~the~~ find out if it really is the base.
150-160 cm below NE corner. Mostly just
jute and broken pebble stuff down here now.

PSB

1983-12-40

14 July, 1983

Bright, clear day, hazy in the distance.

STR Photos Mamiya Asa 32

First shots taken from hill overview east of Guayloquito main plaza.

- #1 - $\frac{1}{125}$ f(8) - main group @ Uha
- #2 - $\frac{1}{125}$ f(11) - same shot, but noting quebrada
- #3 - $\frac{1}{125}$ f(11) - inclusion of horizon line
- #4 - $\frac{1}{125}$ f(11) - STR 11, 12, M.L.'s house from alluvium delta
- #5 - $\frac{1}{250}$ f(8) - "
- #6 - $\frac{1}{250}$ f(11) - #5, 13, 8 from a point east of 11 looking South
- #7 - $\frac{1}{125}$ f(11) - "
- #8 - $\frac{1}{200}$ f(11) - STR 12 water pit, looking due west
- #9 - $\frac{1}{125}$ f(11) - " looking west S.W.

change rolls

- #1 - reshot #8, #9 of last roll because I improperly
- #2 - removed the exposed roll.
- #3 - water pit STR 11, excavation 4A in background
 $\frac{1}{125}$ f(11)
- #4 - STR 48, looking west $\frac{1}{250}$ f(11)
- #5 - " " $\frac{1}{125}$ f(8)
- #6 - reshot #3 for duplicate
- Thick clouds just rolled over the mts. to the east. Possible cloud cover for a long time.
- #7 - STR 9, 10 looking east f(11) $\frac{1}{125}$
- #8 - " " f(6) $\frac{1}{60}$
- #9 - STR 1, 5, 8 looking east $\frac{1}{125}$ f(8)
- #10 - " " looking southeast $\frac{1}{250}$ f(5.6)
- #11 - STR 1, 7 ball court? looking off STR 8. $\frac{1}{250}$ (5.6)
- #12 - STR 1 ball court looking south off 8 $\frac{1}{125}$ (8)

PSB
14 July, 1983

P83-12-41

STR Photos, mamiza, Asa 82

- #13 - STR 5, 1 looking south west $\frac{1}{25}$ f(8)
- #14 - " " " " $\frac{1}{25}$ f(11)

Change rolls

- ~~roll #3~~
- #1 - excavation 3A & STR 2 f(18) $\frac{1}{25}$
 - #2 - " " f(11) $\frac{1}{25}$
 - #3 - STR 4, looking south f(11) $\frac{1}{25}$
 - #4 - " " f(8) $\frac{1}{25}$
 - #5 - STR 5, looking west f(11) $\frac{1}{25}$
 - #6 - " " f(16) $\frac{1}{25}$
 - #7 - STR 13 looking pt, look west (16) "
 - #8 - " " (11) "
 - #9 - Main group, look north off STR 3 (11) "
 - #10 - " " (16) "
 - #11 - E. 1, look north east off STR 3 (16) "
 - #12 - " " (4) "
 - #13 - STR 5 south face and excavation 3A $\frac{1}{25}$ f(11)

Change rolls

- roll #4 -1 - STR 5, 13 south face and 3A from STR 2 $\frac{1}{25}$ f(11)
- 2 - STR 2 south face & saddle STR 13 from quebrada $\frac{1}{25}$ f(11)
- 3 - " " f(5,6)
- [4 - STR 1 & 13 West face from STR 6 $\frac{1}{500}$ f(5,6)
- 5 - " " f(11)

The background hill blended very well with the STR making it difficult to distinguish either, and both.

- 6 - STR 7 south & east face from STR 7 $\frac{1}{250}$ f(8)
- 7 - " " $\frac{1}{500}$ f(11)
- 8 - STR #6 north face from STR 13 (STAIR case) $\frac{1}{25}$ f(8)
- 9 - " " f(11)

PSB

83-12-42

14 July STR Photos, Mamaya, Asa 32

roll
4

- 10. STR 13 Cooper's pit - west wall & south corner. 1/25 f(11)
- 11. " " " " " " " " (8)
- 12. STR 11, 12, 9, from STR 7 1/25 f(11)
- 13. " " " " " " " " f(16)
- 14. STR 23, from STR 7 1/25 f(11)
- 15. " " " " " " " " f(8)

change Roll

Roll 5

- 1. STR 22 & 21 in cornfield 1/25 f(11)
- 2. " " " " " " " " f(11)
- 3. STR 14, 12 north face from soccer field 1/25 f(11)
- 4. STR " " " " " " " " f(8)
- 5. STR 29 looking west east 1/25 f(8)
- 6. " " " " " " " " f(8)
- 7. " " " " " " " " " "
- 8. STR 18, 19, 20, & river from STR 22 1/25 f(8)
- 9. " " " " " " " " " " (11)
- 10. STR 21, 16, 15 from STR 22 1/25 (11)
- 11. ~~STR 21 from cornfield south~~ (8)
- 12. STR 21 from cornfield south (11)
- 13. " " " " " " " " (8)
- 14. STR 19, from 17 looking west 1/25 (11)
- 15. " " " " " " " " (16)
- 16. Cooper's pit STR 15, from STR 17 1/25 (16)