

---

Four Valleys Archive

Anthropology

---

1984

## PSB 005 Urban Field Notes 1984

Patricia Urban

Follow this and additional works at: <https://digital.kenyon.edu/honduras>



Part of the Archaeological Anthropology Commons

---

### Recommended Citation

Urban, Patricia, "PSB 005 Urban Field Notes 1984" (1984). *Four Valleys Archive*. Paper 92968.  
<https://digital.kenyon.edu/honduras/92968>

This Field Notes is brought to you for free and open access by the Anthropology at Digital Kenyon: Research, Scholarship, and Creative Exchange. It has been accepted for inclusion in Four Valleys Archive by an authorized administrator of Digital Kenyon: Research, Scholarship, and Creative Exchange. For more information, please contact [noltj@kenyon.edu](mailto:noltj@kenyon.edu).

5 June 1984

This is the first day of actual field work. I will briefly reconstruct a calendar of activities since our arrival.

- May 24 arr. Tegucigalpa, 2 pieces of luggage missing  
 25 arrange matters at DTHAT, collect luggage  
 26 drive to San Pedro via Comayagua  
 27 drive to Sta. Barbara  
 28 work on house  
 29 work on house  
 30 Copan  
 31 Copan; in afternoon Ed goes to San Pedro
- June 1 house + sheds; students arr. San Pedro  
 2 house + sheds; 5 students arrive Sta. B.  
 3 house + sheds; Ed & Wendy & Earl arr. Sta. B.  
 4 visit sites in Sta. Rosita pocket, + Tenca

The weather has been quite hot, with rain mostly at night. It is like last year.

Wendy, Julie B., and Justine worked hard on finding housing. People seem more inclined to rent to us this year than last. We had some difficulty with the second house; It took several days to get the electricity arranged, water has been off in the upper bathroom, and the kids in the neighborhood were bothering the students a lot until I asked Emilio to yell at them. The cars, especially the van, are having problems. The van was not really fixed in San Pedro, and we often have to give it a rolling start. The students seem to be adjusting well. Brenda & Gene arrived yesterday, getting off the bus too soon, so they were strung out.

✓ June 1984

N84-5-2

Workman List

- Balbino Paz Pineda - mustache
- Pedro Reyes Sabillon - young
- Santos Cecilio Paz Sabillon - mustache
- Mario Antonio Pineda
- Fabian Fernandez Pineda
- Jose Cupertino Sabillon <sup>Fernandez</sup> - oldest
- Jesus Dimas Sabillon (youngest)
- Rene Paz Pineda - mustache

We will begin today by clearing the two sites,  
#27 and #25.

5 June 1984

P84-5-3

## Site 27 Excavations



- 27A surface collection
- 27B Str. 1 front (south) side
- 27C Str. 1 West side

27E Jose Cupertino Sabilon  
Mario Antonio Pineda

27B Rene Paz Pineda, Santos Cecilio Paz

Each pit is 1x3 m, placed well away from the apparent walls. The men are excavating a 1x1 m area in each pit (the south end of 27B, the west end of 27C) in 10 cm levels, so that we can see the earth levels, if there are any. After that we will move in towards the walls.

By 11 AM, the west <sup>27C</sup> pit ~~is~~ beginning to encounter small, somewhat crumbly, yellowish rocks at the base of the 2<sup>nd</sup> level, ca. 20 cm. They have a very few artifacts.

In 27B, only earth so far (ca. 15 cm). No artifacts.

It is extremely hot, and shade is hard to come by.

5 June 1984

P-84-5-4

27c

The initial 1x1 m pit was taken down to 30 cm below G-S. (measured at SW corner of pit). The top 16-20 cm is dark brown earth, somewhat clayey. Few artifacts found.

The bottom material is crumbly, decaying rock, white to yellow in color. A few larger rocks are appearing in the eastern edge of the pit, beginning ca. 15 cm below G-S. The upper margin of the crumbly rock rises to the west.

Measured on the south side, the pit is 32 cm below G-S.

After the 1x1 section was completed, I asked the men to remove the earth level up to the large gray rock which seems to be a major part of the wall. I did not check often enough, and they removed the earth and the stones. About 16 stones were removed from the area, which is 1 m N-S x 1.02 m E-W (measured on the south side).

Judging from the rocks in the south wall, the removed rocks are just tumble. The remaining rocks are at angles, no group oriented with respect to one another. The large gray rock does seem to be part of the wall. This needs to be cleared.

5 June 1987

I will continue this pit to the ~~width~~ north for a 1x1 m extension. Little artifactual material has been found -- only a few shreds and some possibly used stones of local(?) chert-like material.

27B

The original 1x1 m portion was taken down to 40 cm below ground surf. (at SW corner). No shreds or other cultural material found. In actuality, pit goes to 1.10 m N of south edge.

The next segment was removed in a block across the width of the pit, and ~~to~~ to 1.50 m North of pit's south wall. \* No artifacts. Ca. 7 rocks remained, highest ca. 20 cm below ground surface. At the base of this extension there is a change in soil. The color is redder, and it is a sticky clay. Some rocks remain in the wall in the NE corner, about 30 cm below G.S.

\* measured on the west side; 1.43 cm on the east wall

The pit is being extended to the north to the full length, with the base 20 cm below G.S. on the upslope. There has been about a 5 cm rise over the length of the pit.

## LOT LIST

- 27B/1 0-10 cm below <sup>Ground Surf</sup> SW corner in 1x1 m area  
empty lot
- 1/2 10-20, empty lot
- 1/3 20-30, empty lot
- 1/4 30-4, empty lot
- 15 G.S. to 45 cm; ~~at~~ <sup>1.5 m margin</sup> 1.2 m  
N of pit's south edge, to 1.4 m north  
depth measured at west edge

6 June

- 1/6 in earth of northernmost 1 m of original pit  
and in 1x1 m extension; ca. 20 cm below G.S. at SW  
corner, and ca. 45-50 cm below G.S. on north  
edge; sherds are from among the stones, not  
from the earth overburden

- 27C/1 0-10 cm below G.S. (measured at SW corner  
of pit) - small lot
- 1/2 10-20 cm
- 1/3 20-30
- 1/4 in earth (dark, topsoil) above broken  
rock level, from end of 1x1 m initial  
excavation to probable wall cen  
east of pit's west edge
- 1/5 in 1 m N-S x 0.5 m E-W extension of  
pit to North; in earth among rocks &  
possible tumble, & above rocks

6 June 1984

27C

The rocks in the small northern extension have been cleaned, and they definitely look like tumbled. I am having the earth removed over the rocks going up onto the mound, as far as the eastern edge of the original pit.

Schematic

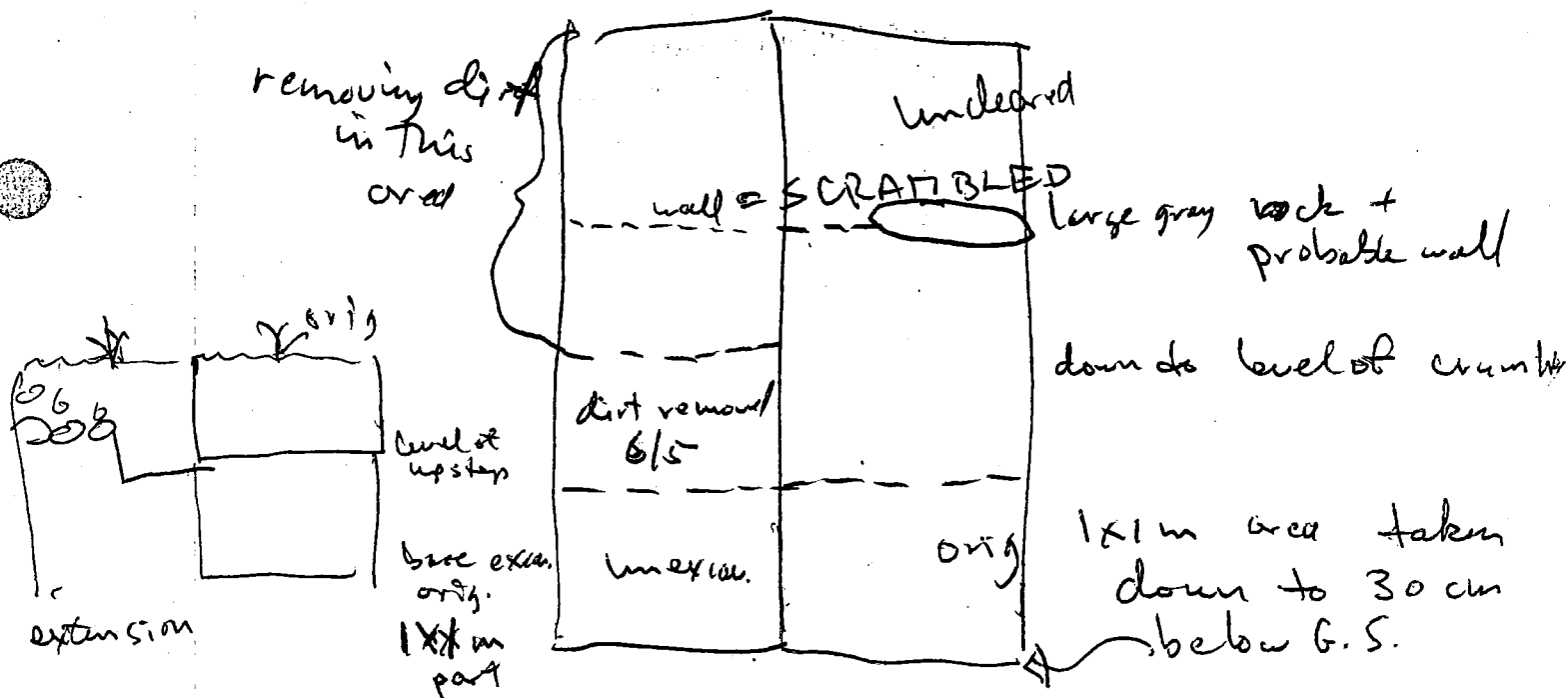

I am trying to clarify the wall, and, perhaps find some buried artifacts

Later There is clearly a wall running north from the big gray rock. The overburden removed, the rocks looked tumbled. The rocks were removed from the southern 50 cm, and the earth removed to the level of the orig-pit?



6 June 1984

27B

Rocks are appearing in the northern part of the pit, but they appear to be tumbled. We may be short of the wall.

I have added a 1 m extension to the north, looking for the wall.

Schematic

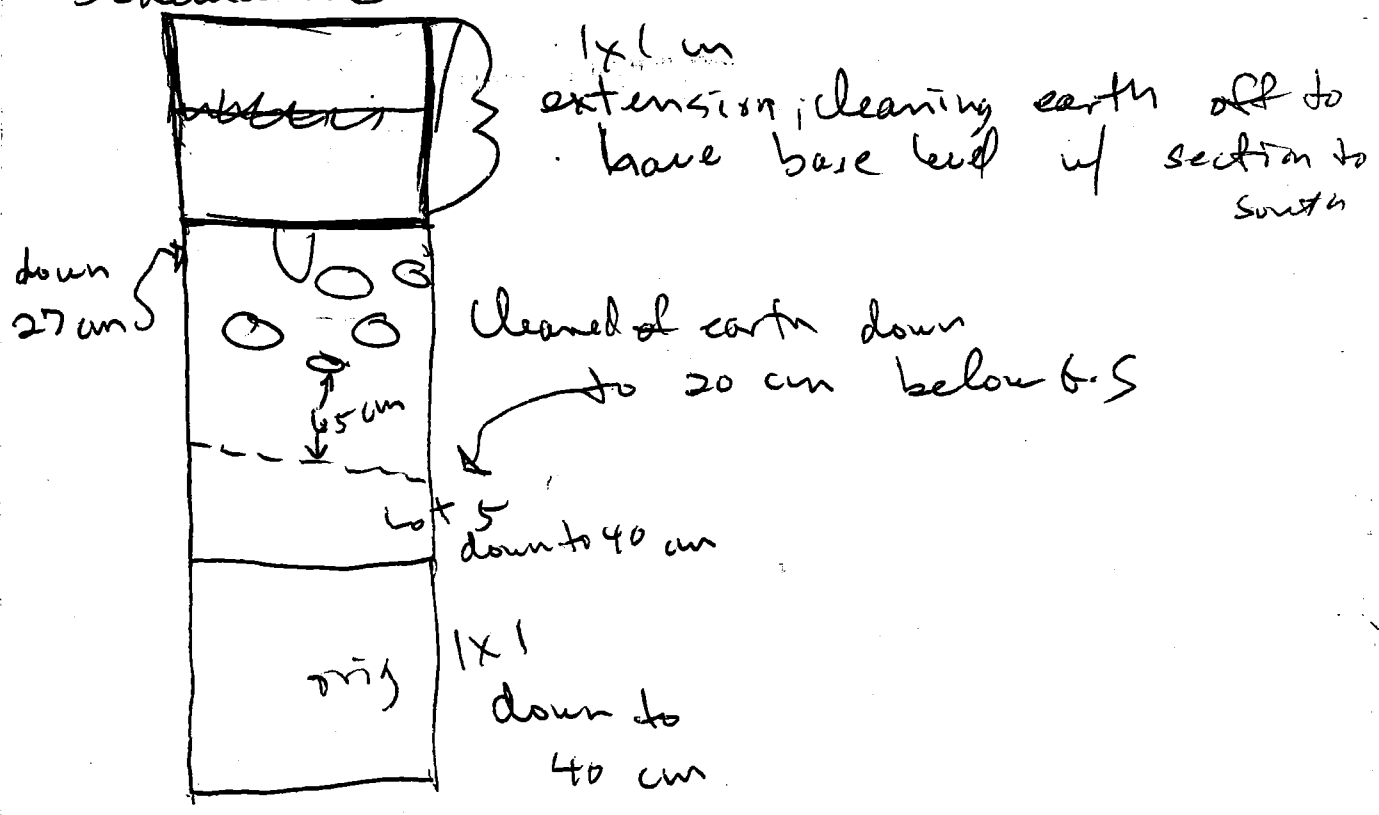

Later

The northern extension has come down on rocks, and I suspect a wall. There are a few shards coming from above and among the stones, but none from the earthen overburden. The next step will be to cut back gradually to find the wall

25B

In the northern extension, as well as in the remains of the orig. pit, we are going deeper.

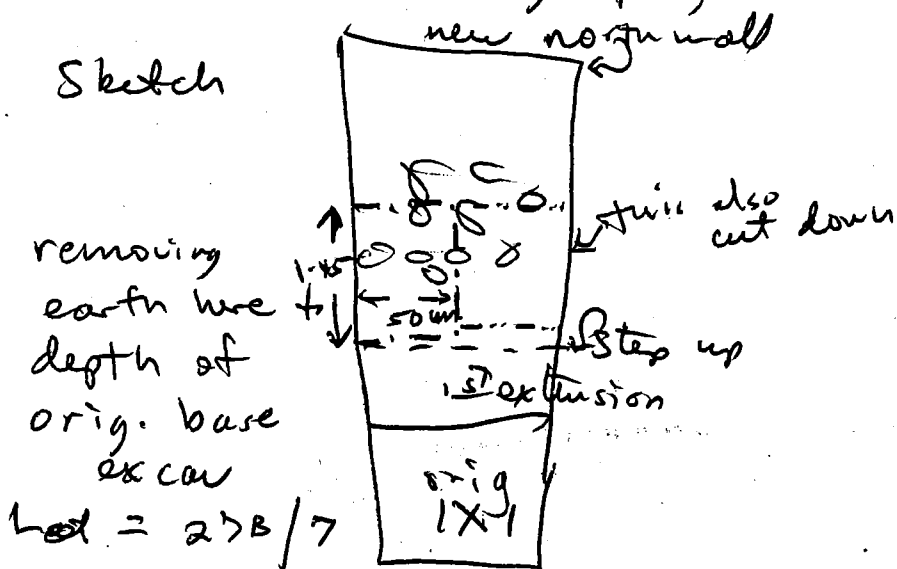

This cut is finding large rocks, rather tumbled a few sherds and a few pits of bajareque. The rocks are ca.  $20 \times 30 \times 5$  to  $10$  cm.

The bajareque is at about 2.5 m from the S edge, and back, at a depth of ca. 50 cm. It is bright orange, but soft + crumbly.

The cut has been extended to the entire width of the pit.

later: We have cut down to the orig. base of excavation over the entire length of the pit. The bajareque mentioned above was suggestive, but nothing really came of it. Either we missed the wall completely, which I doubt, or it was in very poor condition, which I believe is more likely.

6 Jun 1984  
27 B (cont.)

P84-5-10

The wall looks something like this:

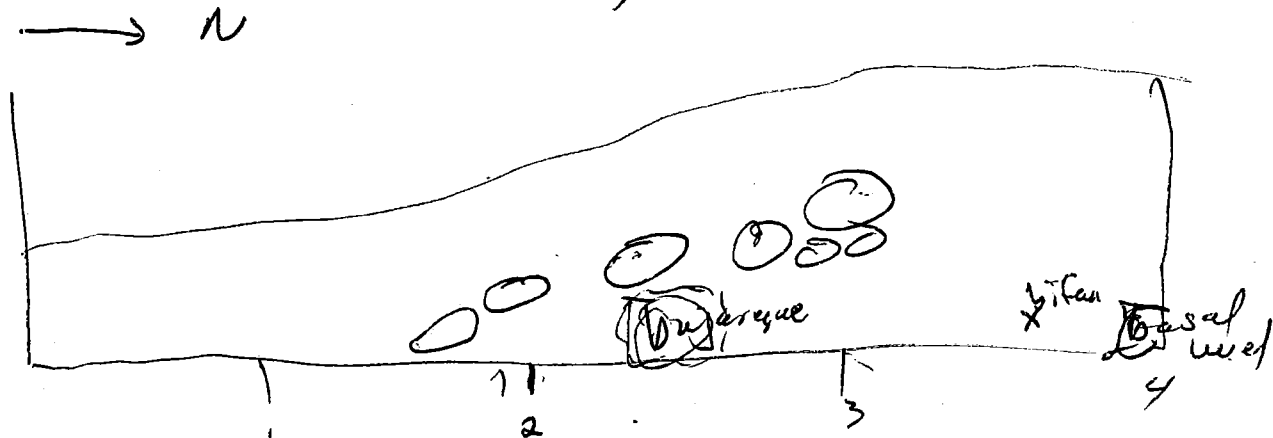

no clear wall, all the rocks at an angle, fine bajareque covered by rocks, but not against the bottom of a ~~wall~~, which is what I'd hoped for.

There is a soil change below the rocks, to a redder possibly coarser earth. In the far end of the pit, at the base, particularly on the east side, the basal rock level seems to be turning up.

Shards were few, even among the rocks. A biface came out of the north end, very deep, almost at the base of excavation, but ~~it~~ from an animal burrow.

### 27D

We have opened a 1x1 m pit about 25 m from the SE corner of Str. 1, near probable Str. 7. We are looking for trash - so far there have been very few shards, but a broken andesite biface was found. level 1 = 0 - 20 cm; level 2 = 20 - 30; level 3 = 30 - 40.

6 June 1984

P84-5-11

LOT LIST

27C/4 from earth below tumble, and ~~west~~ <sup>west</sup> of probable wall

27C/7 from cent. in original pit, into basal rock level; includes a few, variable number of cm. of topsoil; cut is 0.5 m. NS x m E-W, running up to trench wall

~~27D/1~~ 27D located ca. 25 m ESE of SE corner str. 1.  
27D/1 0-20 cm below ground surface - small lot

27D/2 20-30 cm - small lot

27D/3 30-40 cm empty lot

27B/7 from 1.4 - 2.85 m north of pit's southern wall, in western 50 cm of trench, from ca 20 cm below BS to orig. 40 cm base of excavation; expanded to full width, and up to poss. wall, i.e., ca. 1 m south of pit's north wall

27B/8 from the entire block of earth between putative wall and N limit of excavation

2 June 1984

P84-5-12

We are beginning by cleaning 27B + C A photos. We will then do the elevation of SCRAMBLED wall in 27C, and a section of the east wall of 27B.

### 27D

We are extending 27D 1m to the east, to investigate a possible low stone platform which appears on the surface as a line of rocks.

### 27B

Str. 3 A 1 M<sup>2</sup> EW X 5.5 m N-S trench, to investigate the 2 possible terrace levels of Str. 3.

The first meter was excavated to, in theory, 10 cm, in practice, 12-14 cm, below G-S. in NW corner. All rocks have been cleared and left in place. Very few sherds were found.

The second meter was excavated ~~to~~ to the same depth, in the same manner. Again, very few artifacts were found.

The men are now working on the third 1m square

The original pit was set up to start ca. 1m N of a possible wall line, to run up over that possible terrace, as well as the next, and to end ca. 1m south of the upper line

A84-5-13

1 June 1984

27D

In 27D, the men have excavated down to cards cm below G.S., exposing the rocks. The rocks appear to be on end

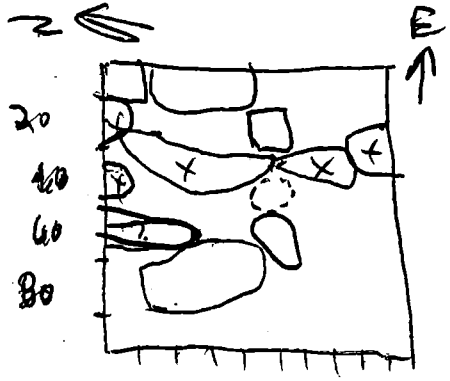

27D sketch

The rocks marked "X" appear to be cut, although they are on edge. All the rocks are on edge

We are following the line to the south, separating material from either side of the rocks, to see if there are an "inside" and an "outside"

sketch 27E

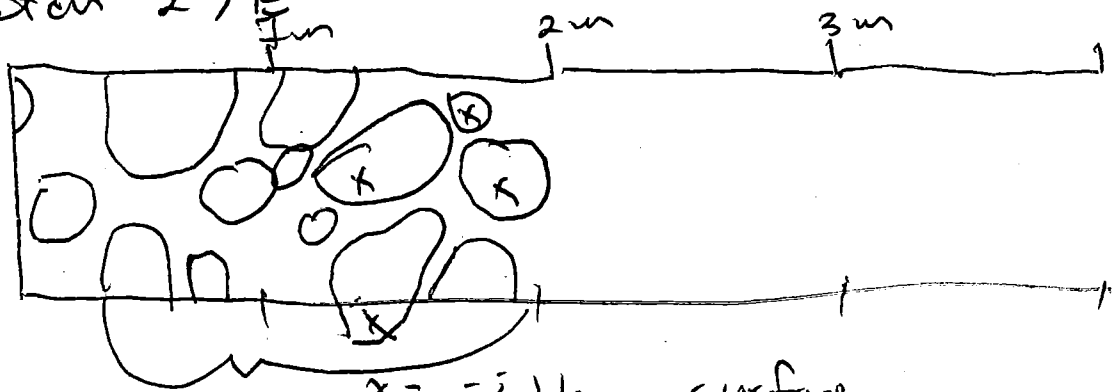

X = visible on surface

heavy rock

ored =  
POACHED  
+ terrace

few rocks past those are  
small, past 2 m

Right now, they are working on the area from 3 to 4 m.

7 June 1984

The drawings are being done by the students.  
 Yesterday Alex did 27C, and today ~~the~~ Alex & Julie  
 are working on 27B. Alec is sick & is home today

Drawing list to date

- 27B Section, East wall trenches D84-16-2
- 27C Section, E-W D84-20-1
- 27C Elevation, SCRAMBLED wall D84-16-1

Lot List

- 27D | 4 among <sup>1m x 6m</sup> and above stones of pass. wall in  
 eastern extension to <sup>10</sup> cm below G-S.
- 15 among stones in 10-20 cm level of east extension
- 16 earth to west of stones of pass. wall in  
 southern 1x1m extension, 0-10 cm, empty
- 17 earth to east of stones of pass. wall in  
 southern extension, 0-10 cm, empty
- 18 10-20 cm below G-S, east of wall (DENT)
- 19 10-20 cm below G-S, west of wall

27E | 1 to 20 cm below G-S. in Northern 1x1m, among stones

- | 2 in next 1x1m to south, earth among stones
- | 3 square 2/2m to 3m south of N wall, in earth
- | 4 square 3/3m-4m south of N wall, in earth
- | 5 4-4.5m south of OMBLET

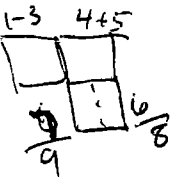

16 south of  
 OMBLET

7 June, 1984

P84-5-<sup>15</sup>~~14~~

27D

The wall in the extension, DEVILED wall, seems to have come to a corner, and a section appears to run EW there, to be called FRIED, if it pans out (so to speak).

I will have the crew (Jose + Mario) follow to the east, looking for another corner.

27E

The square just finished before lunch, from 3-4m, has no rocks, and only 1 piece of obsidian + 1 shard. The next square has the next line.

The northern stone terrace is POACHED terrace.

The southern terrace will be ~~OMLET~~ OMELET.

Notes: ~~the~~ ~~the~~

After OMELET was cleared, I asked the men to follow it for a meter to the east, but the stones stopped just at the east edge of the original pit.

To find the east margin of the structure, I have opened 27F, a very small pit (m x m) on the east side of what appears to be a wall line.



June 1984

P84-5-16

lots

27 E/7 earth of eastern extension, looking for more OMELET; empty lot

27 D/10 in eastern extension of pit, following FRIED wall, 0-20 cm below fs (no shreds in top 10 cm); area is 0.5 m NS x 1.0 m E-W

27 F/1 from earth east of possible wall line, on probable east side of Str-3; trench is 35 cm x 1.2 m NS; very small lot

8 June 1984

P84-5-17

256

This is a 1x1 m pit on the west side of Sh-3, near (slightly south of) the Northwest corner, as it appears on the ground. We will go down 20 cm in an area which should hit the wall

PHOTOS

84-5-B1	OP <sup>27</sup>	<del>G</del>	POACHED WALL
B2	"	"	"
B3	OP	27	<del>G</del> WHOLE PIT
B4	"	"	"
B5	OP	27	E POACHED WALL
B6	"	"	"
B7	OP	27	E OULET
B8	"	"	"
B9	OP	27	E POACHED FROM SOUTH
B10	"	"	"
B11	OP	27	F
B12	"	"	"
<hr/>			
C1	OP	27	I
C2	"	"	"
C3	OP	27	G SUNNYSIDE
C4	"	"	"
C5	OP	27	D DEVILED FROM NORTH
C6	"	"	"
C7	OP	27	D DEVILED FROM WEST
C8	OP	27	D FRIED FROM SOUTH
C9	"	"	"
C10	"	"	"
C11	OP	27	D WHOLE PIT
C12	"	"	"

More down 1 space

D84-5-18

8 June 1984

27G

This pit started as a 1x1 m pit looking for the west side of Str. 3. Only one rock was found, and no artifacts.

The pit was extended 1 m to the south, in a 1x1 m square. More rocks, and the probable North edge of POACHED. The corner, which I had anticipated due to the presence of certain rocks, and the drop in elevation (slight) to the west, but no corner was found. The rocks appear to be an extension of POACHED. The western margin of this structure is still unclear but I don't think I'll dig and find more. The center is the brown soil found elsewhere; we did not penetrate to the basal rock.

27F

Yesterday I put in a small pit to find the east side of Str. 3. The results were inconclusive. The two rocks visible on <sup>out from</sup> the surface were uncovered, but nothing came <sup>in</sup> between them. I am declaring this the east side, nonetheless. ~~Several~~ <sup>Few</sup> artifacts were found.

27E

Alex and Julie drew the ~~sketch~~ profile  
D84-16-3

27H Str. 7

This began as a 1x1 m pit near what we thought (at the suggestion of Alex + Julie) would be the Str. 3 east wall (Str. 7). The wall was exposed and it is very clear. The pit was expanded 1 m to the south (0.5 m E-W) and the corner has been exposed.

The wall is one cobble high. Stone sizes are:

	height	width	depth	
ⓐ	13	28	24	1-4
ⓑ	18	27	17	South to
ⓒ	11	26	22	north
ⓓ	14	12	16	

The corner rock appears broken. The wall is SUNNY-SIDE. The rocks are all white-gray, like the basal rocks, and different from Str. 1's 'big' gray rocks.

[The rocks in 27 D are of the same sort, with 2-3 exceptions]

The earth is the dark brown, somewhat sandy soil found elsewhere. We did not penetrate to the basal rock level. [This was done in 27 D]

27 I on Str. 7.

A 1x1 m pit dug to locate the NW corner.

27 J Str. 3.

A 1 m E-W x 0.5 m NS pit on the west side of the Str., trying to clarify the western extent of the str.

Str. 3 also seems to have a line to the south of ONELET. 27 J is placed to try and pick up that line. ONELET is clear on the surface. <sup>for many meters</sup> The southern line seen on the surface is called HARDBOILED

P89-5-20

8 June 1984

LOT LIST

27 G/1 0-20 cm below G-S. in orig. 1x1 m pit,  
and northern 1x1 m extension

27 H/1 0-20 cm below f.s. in orig. 1x1 m pit,  
and 1 m N x 0.5 m E Southern extension

27 I/1 0-20 cm below f.s.

27 J/1 0-20 cm below f.s.

P84-52

D1	OP	27	B	EAST WALL, w/ BENEDICT "wall"
D2	"	"	"	" "
D3	OP	27	B	WEST WALL
D4	"	"	"	" "
D5	OP	27	B	South wall trench
D6	"	"	"	" "
D7	OP	27	<del>B</del> C	SCRAMBLED WALL
D8	"	"	"	" "
D9	OP	27	C	TUMBLE
D10	"	"	"	" "
D11	OP	27	C	WHOLE WALL
D12	"	"	"	" "

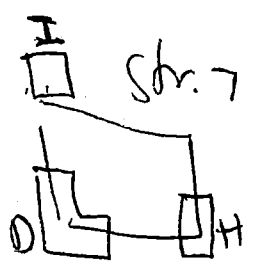
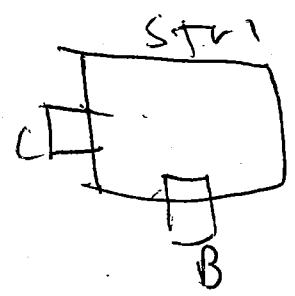

27I -

No stones, virtually no artifacts, no corner; earth typical brown top soil

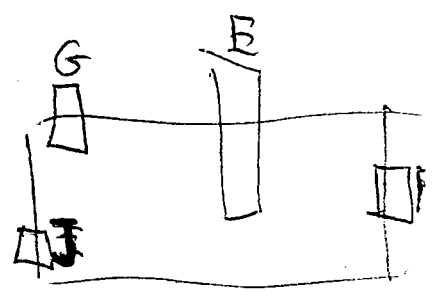

27J Very incohesive: a couple of rocks, not in line w/ anything. Top soil = 12-13 cm; Then basal rock layer as elsewhere. Pit is 20-22 cm deep

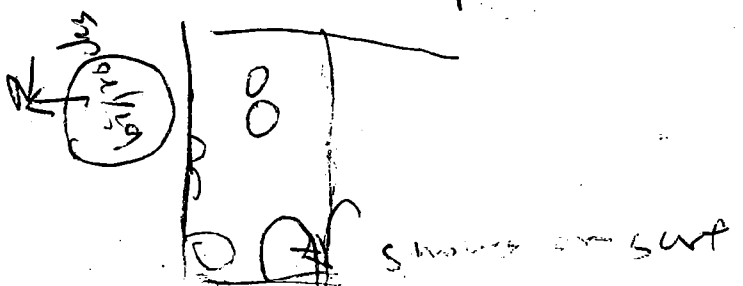

8 June 84

Pg 45-22

27 I

This has failed completely in its objectives. It is now 3 m NS x 1 m E-W, and has merely picked up a few artifacts. The northern m<sup>2</sup> is down to 20 cm, the rest to 10 cm. Most artifacts come from the lower 10 cm of the northern m<sup>2</sup>.

27 D, I, F

I decided to check the walls by trowel pt., and the eastern wall seems to end, or even turn a corner just north of pit 27 H.

DEVILED wall does continue -- it was merely missed by 27 I. The western stones, <sup>of DEVILED</sup> apparently are tumbled, for the buried stones continue in line with the eastern (inner) line of DEVILED. The tops of the stones are under ca. 10 cm of earth (the soil does rise to the north in the vicinity of Str. 7). The top 10 cm of earth were quickly cleared, to demonstrate the existence of these stones, in an area ca. 50 cm NS x 30 E-W, just north of the inner/eastern rocks of DEVILED, as seen in 27 D.

It is still unclear to me how large Str. 7 really is. The earth has accumulated to the point that the northern side, if it exists, is invisible, as are the northern extensions of the west and east walls.

84-5-A1 }  
 84-5-A2 } Probable tumbled wall East face 27B  
 84-5-A3 }  
 84-5-A4 }

84-5-A5 } North face of 27B

84-5-A6 }

84-5-A7 } West face of 27B

84-5-A8 }

84-5-A9 }

84-5-A10 }

A11 Str. 1, OP 27C, SCRAMBLED wall

A12 Str. 1, OP 27C, SCRAMBLED

~~B2~~<sup>13</sup> Str. 1, OP 27C, showing tumble & SCRAMBLED

~~B2~~<sup>14</sup> Str. 1 OP 27C, showing tumble & SCRAMBLED  
 and lower rock level

The roll was 24 shots due to photographer's error. I just took a bunch of miscellaneous photos - burning, wounds, etc.

The formal excavation photos were re-taken later



PLAN PTS. STE #27

EH 1.45 D84-5-24

PT	Angle	Low	HIGH	MID
33 27H NW corner orig. pit	41°	0426	0665	0544
34 NE corner orig. pit	51°30'	0280	0538	0405
35 SE corner orig. pit	52°45'	0259	0521	0391
36 joint orig. t's extension	54°45'	0308	0565	0435
37 SE corner S extension	54°15'	0318	0572	0442
38 SW corner South extension	55°45'	0361	0610	0484
39 FRIED + pit well	54°45'	0375	0619	0496
40 corner FRIED + wells				
41 well & pit edge north	53°45'	0428	0676	0551
42 27E SE corner	52°	0328	0581	0454
43 SW corner	125°45'		0476	0161
44 NW corner	120°42'		0460	0158
45 NE corner	120°		0913	0630
46 POACHED + pit east	122°15'		0918	0630
47 POACHED + pit west	128°45'	0220	0794	0489
48 OTBLET + pit east	124°15'	0141	0720	0430
49 OTBLET + pit west	125°45'		0470	0170
50 27F SE corner	126°15'		0452	0151
51 SW corner	124°		0538	0226
52 NE corner +25'	123°		0604	
53 NW corner	123°		0645	0325
54 poss. wall + pit +18'	124°	0300	0927	0609
55 poss. wall + pit	122°		0656	0347
56 27G NW corner	133°	0513	0999	0756
57 NE corner	131°	0538	1028	0780
58 SW corner	45°	0270	0772	0518
59 SE corner	134°	0259	0770	0515
60 OTBLET possibly	133°	0426	0964	0718
61 OTBLET possibly	133°15'	0317	0812	0559
62 27J NW corner +30'	132°	0500	1027	0763
63 NE corner +30'	139°30'	0400	0928	0662
64 SW corner	138°30'	0430	0962	0694
65 SE corner +20'	140°	040-	0940	0675

+ B  
0500/112  
M0804

# Plan Points

Pt.	Angle	Lower	Upper	17:59
1 NW corner, orig. pit	325° 45'	0.908	1.240	1.0085
2 SW corner, orig. pit	324° 30'	0.977	1.304	1.139
3 Junction orig pit + N extension	326° 45'	0.772	1.104	0.938
4 27C NW corner N extension	327° 45'	0.702	1.042	0.872
5 " NE corner N extension	330° 45'	0.241	0.570	0.404
6 " SE corner N extension	330° -	0.271	0.587	0.428
7 " SCRAMPLED north + pit	329° 45'	0.452	0.788	0.620
8 SCRAMPLED south + pit	328° 15'	0.521	0.895	0.682
9 SCRAMPLED corner, <u>west</u> in pit	326° 30'	0.488	0.694	0.540
10 27B NW corner pit	339° 45'	0.142	0.422	0.281
11 " NE corner pit	341° 45'	0.055	0.332	0.192
12 " SW corner pit	336° 15'	0.763	1.007	0.984
13 " SE corner pit	338° 30'	0.698	0.936	0.816
14 " junct pit + poss. well <sup>west</sup> BENEDICT	338° 15'	0.439	0.702	0.570
15 " junct pit + poss. well BENEDICT <sup>East</sup>	340° 30'	0.479	0.736	0.609
16 27D NW corner orig pit	40° 45'	0.551	0.767	0.659
17 SW corner orig pit	40° 30' (43°)	0.562	0.771	0.668
18 junct orig. + S extension	44° 45'	0.529	0.743	0.634
19 SW corner S extension	46° 45'	0.545	0.755	0.650
20 SE corner S extension	50° 30'	0.494	0.729	0.605
21 NE corner S extension	49° 15'	0.456	0.686	0.571
22 junct orig. + Sect. east	47° 30'	0.479	0.700	0.590
23 NE corner north extension	43° 30'	0.389	0.627	0.507
24 NW corner N extension	42° 30'	0.425	0.659	0.541
25 junct N ext. + orig. pit	44° -	0.457	0.685	0.571
26 West side DEVILED	44° -	<del>0.503</del>	0.727	<del>0.615</del>
27 East side DEVILED	45° -	0.505	0.734	0.619
28 corner, DEVILED-FRIED	47° -	0.522	0.741	0.632
29 S side FRIED + pit wall	49° 45'	0.520	0.949	0.634
30 27I NW corner	35° -	0.664	0.408	0.535
31 NE corner	36° 45'	0.391	0.653	0.520
32 SW corner	39° 15'	0.457	0.690	0.573

11 June 1984

P84-5-26

31B

On str. 7. Set up as 1 m - NS x 3 m EW.  
On the east side of the structure. Designed  
to find the back wall and then cut the  
structure through. Jose + Mario

31C

On str. 1, North side. This str. will be  
excavated for plan data. Trash is secondary.  
It has a terrace & I would like to see the  
connection

31D

Juan Pablo Paz Pineda  
Pedro Reyes Sabillon

SW of str. 5, down from the terrace.  
Looking for trash + natural stratigraphy.

31E

Fabian + Jesus Dimas  
South side of str. 6, looking for trash,  
and eventually the south side of the str.

P84-5-2)

11 June

Site 31 is essentially clear. It is a cattle pasture, but the cows aren't here now. The vegetation is grass and the usual thorny scrub, but little is more than knee high. The plants are higher than last week when we visited.

My aim is to spend 4 days here, possibly 5 if it is interesting and productive. This is the most comfortable of the sites -- a few trees around the mounds, and a well-developed fence of small trees. It is tempting to dig more here!

I am going to take some "human interest" photos with film from last year which is due to expire. It can't hurt, and it may still be good enough for some display shots, if not for record shots.

Film

84-5-F various shots of opening excavations at site 31  
(these may not turn out)

31 D+E

In the second 20 cm levels, sherd counts are increasing.

31B

More sherds from 2nd 20 cm level

31C Lots of rocks of unclear meaning.

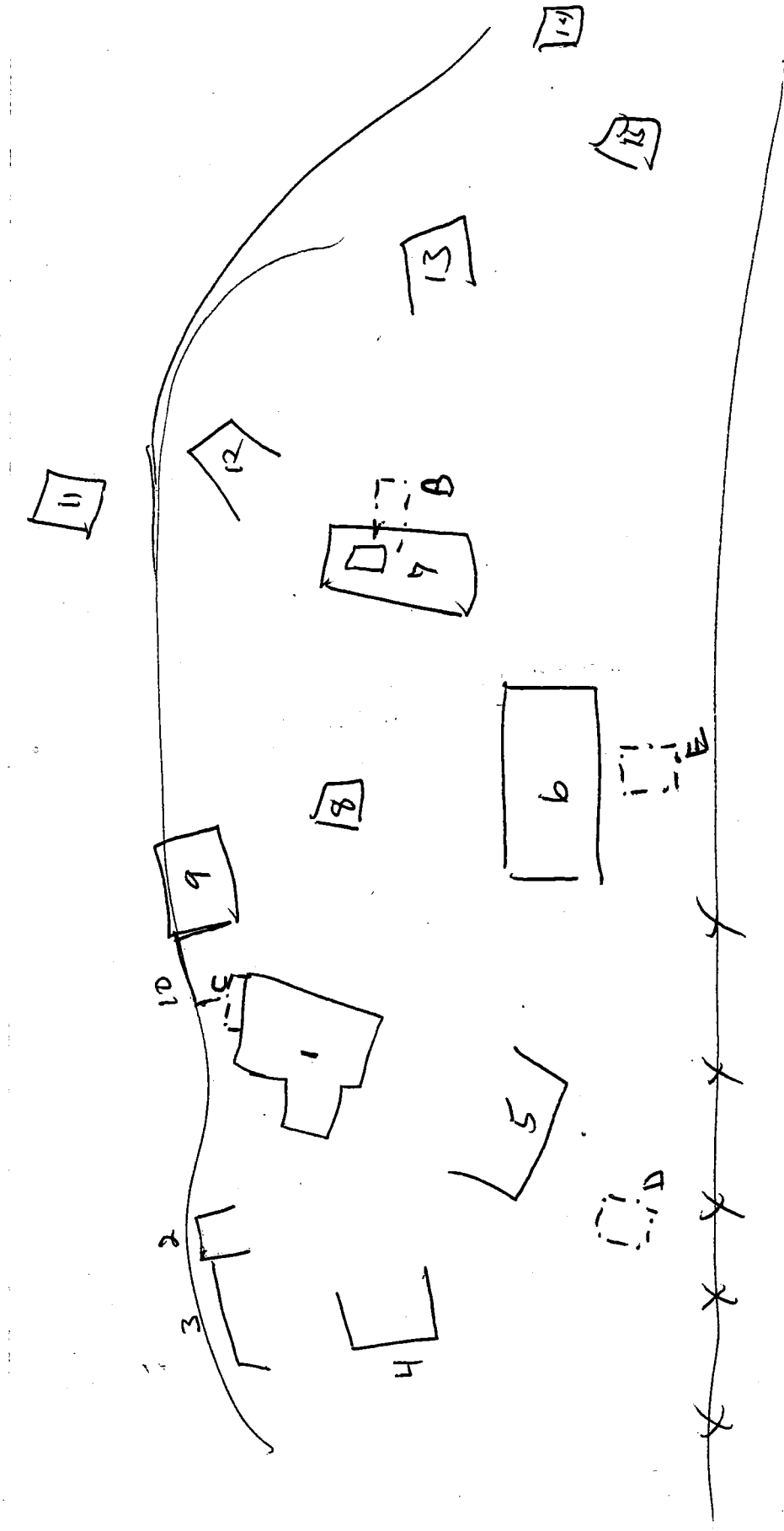

11 June 1984

Rosendo Fernandez has a finca here on his land, and higher, belongs to a nephew

LOT LIST

B/6 20-30 cm in the 1x0.5 m east

- 31 B / 1 1<sup>st</sup> 10 cm below G.S. (measured on east side) of 1<sup>st</sup> 1x1 m segment
- 2 10-20 cm below G.S. in eastern 1x1 m sqm
- 3 20-30 cm
- 4 0-10 cm in 2<sup>nd</sup> 1x1 m square (the center one of the orig. 3), in earth above and among stones
- 5 10-20 cm below G.S. among & below stones in southern 0.50 m of trench 1 m EW

- 31 C / 1 earth above and among stones over entire 2<sup>EW</sup> x 1 m<sup>NS</sup> area of pit
- 2 from below stones of probable tumble in the eastern 1x1 m segment of the pit
- 3 earth above stones in the 1 m N-S x 0.5 m E-W southern extension of orig. pit
- 4 earth among & below possible tumble

- 31 D / 1 0-10 cm below G.S. as measured at SE corner
- 2 10-20 cm below G.S.
- 3 20-30 cm
- 4 30-40 cm - few sherds
- 5 40-50 cm - 3 sherds
- 6 0-20 cm in northern 1x1 m extension of pit

- 31 E / 1 0-10 cm below G.S. as measured at SE corner
- 2 10-20 cm below G.S.
- 3 20-30 cm; lots of vides in this level
- 4 30-40 cm
- 5 special lot - in NW corner pit, in square 35 cm south of N wall, and 31 cm east of West wall; sherds, carbon, flotation (a midden)

E/6 40-50 cm below G.S.

pg 5-30

11 June 1984

11:00 AM

All of the trenches are producing sherds.

31B

In the 20-30 cm level there is a change in the soil. The dark brown topsoil is replaced by a harder, more clayey, and redder soil. The level also has more stones. Interestingly, it continues to produce sherds.

After this level was completed, I asked the men to move into the next 1x1 m square removing the dirt only.

31C

The earth has been cleared to 20 cm, more or less, due to the rocks. Now, in the eastern 1x1 m of the pit, I am having the rocks removed.

Sherds have been found above and among the rocks, and now among and under the rocks.

31E

The 20-30 cm has a lot of rocks, but sherds among them. There really isn't any change in soil color

31D

In the lower 5 cm of the 20-30 level the soil is changing; somewhat redder <sup>or orange</sup> in color, with lots of small stones. It looks like we're approaching the basal level

P84-5-31  
110

11 June 1984

31C

The stones were removed, and the earth, down to 40 cm. The stones are either tumble or a very large retaining wall on the down hill side of the str. If it is a wall, it is very poorly made, and of rather large rocks.

We have gone to the south, in a 1m NS x 0.5m EW trench, trying to locate a wall.

Later - The cut is almost down to the base of the original trench, and the evidence is equivocal at best. The rocks do not appear to be set in any clear way. The men removed a large rock (cm x cm x cm) from the approx. center of the cut. Nothing is very clear in the walls. I may jump them to the other side (S) or the East end, both of which may be a) better preserved or b) better made as they are not downhill sides.

31E

Towards the ~~base~~<sup>top</sup> of the 4th level (30-40cm), in the NW corner of the pit, a group of sherds was found, ~~apparently lying~~ looking like they were close to, if not actually in, primary context. The sherds were removed as a unit (Lot 31E/5). A sample for flotation was also taken, as the material appears to be a midden (lots of sherds, flecks of charcoal, some bajareque, shells (jute). Under the sherds was a carbon sample, perhaps big enough



P84-5-32

11 June

to use for dating. Lot E/5 is from an area of 35 cm S of the N. wall and 31 cm east of the west wall, 40-45 cm below 6-5.

Now that the men are down in the 40-50 level, there seems to be midden material -- more bone, including a tool, bayonet, etc -- across the whole pit.

There is also a flotation sample from lot E/4.

### Flotation

We have taken 4 samples today:

31 B/2 -- 20-30 cm below 6-5.

31 D/2 -- 20-30 cm

31 E/3 -- 30-40

14 -- 40-50

15 -- special corner deposit

### 31B

The ~~was~~ southern 50 cm have been removed down to the base of the orig. excavation. There seems to be a wall on the west side -- 2 stones, apparently set, the bottommost quite square, but probably not cut. The soil below the stones is redder, like the "midden" materials elsewhere.

We will now remove the northern 50 cm up to the probable wall, as a unit

### 31C

The cut was unclear. There may have been a wall, but it was poor. The stones are over the same kind of midden material as in 31B + 31E.

D85-5-33

11 June

Core Lots

31 B/4 50-60 cm below G.S.

31 B/7 10-30 cm below G.S. in northern  
0-5 m NSX 1.0 m EW segment of  
central 1x1 m of orig 1x3 m EW pit

RIC

We will conclude that as a bad job, and  
change to the south side of the str.

P89-5-39

12 June 1984

390

We are moving into the last (westernmost) of the 3 1x1m units in the orig. trench. The first step is cleaning the earth; then will cut.

Tinito Sabillon - owner

Saturno Sabillon - brother  
supervisor Departamental

Baudilio Sabillon

Dpto. Cortes  
east of Yojoa

San Francisco de Yojoa - Municipio

at least 3 mounds around a plaza  
several m. high  
and ca. 40 mounds nearby

has found points, pichingos, ceramic  
"jade"  
claims burials

P84-5-35

12 June

Photo List

85-5-F-1+2 <sup>31B</sup> Probably well, from west  
~~#3+4~~ south wall trench 31B  
 This side 5+6 31C south extension  
 was taken 7+8 31C Tumble, or extensive retaining  
 at the - wall  
wrong ASA - 9+10 31D North face orig 1x1m  
 at 32, instead pit, showing basal rock layer  
 of 125 11+12 31E

Today we began the day with some bad news: the Sta. Rosita co-op land ended at the fence to the west of this site, and we were digging on private land. The owner is Tinito Sabillon, and he lives in San Pedro, coming out Sat + Sun. His brother works in Sta. B. So we quickly drew and photographed the pits, finishing about 10:30.

We left stakes in all the corners, so we could come back and transit in the pits.

Drawings:

- D84-15-1 31C, east face of trench + exten.
- P84-15-2 31B, south face
- { D84-10-1 31D, east face
- { D84-10-1 31E, North + East faces

aided by  
 S. Miller  
 #16

Last few lots are recorded in Miller's notes (#16)

12 June 1984

P84-5-36

Site #25

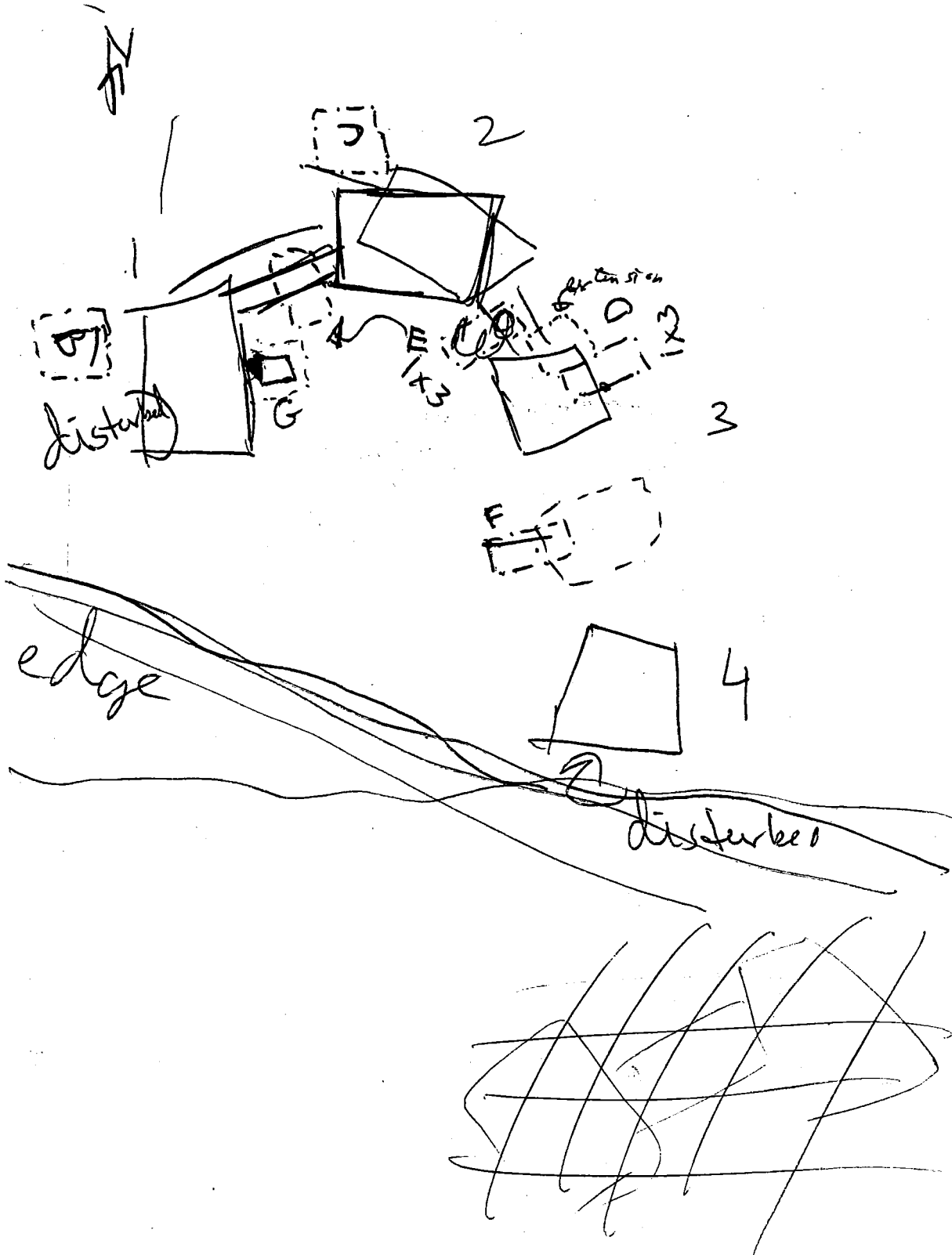

P890-03

12 June

We have changed to site # 25, and are working in the easternmost group.

Now that the group is cleared, it is disturbed, or rather, the disturbances can be seen. It has been hard to decide where to dig due to the disturbances.

25B

Site #3

The first 20 cm of the northern 1x1 m segment produced about 8 sherds.

The soil, from the plants down, is red, clayey sandy soil, with lots of small rocks. There is no topsoil horizon. The level is like some of the lower levels at the other two sites.

We are moving into the middle 1x1 m segment of the original 3 m E-W x 1 m N-S pit.

The purpose of this pit is to a) locate trash by work up to what seems to be a ~~the~~ wall line

25C

Site #2

Some material came from the top 10 cm of this pit. The topsoil is shallow, and is rather red-brown in color. The men are now in the 10-20 cm level, and the earth is becoming redder & more clayey.

12 June 1984

25 B

th. 1

Only this pit is producing much. Some shreds were located in the top 10 cm, and many more are coming from 10-20 cm.

The soil here is black-brown topsoil, with no change as yet.

25 E

Belvedere  
th. 1  
# 1 + 2

No artifacts in 0-10 level, and few in 10-20. A few more in 20-30, where they're digging now.

This trench is 1m EW x 3m (roughly N-S). It is set up to intersect a possible saddle feature between Sh. 5. — and —. Right now the southern 1x1m is being excavated.

The soil so far is black-brown topsoil. At 20-30 cm more rocks are appearing, but there is no change in color.

At the base of the 30 cm level are lots of medium to large rocks. The meaning is unknown.

25 D

In the second square the soil is the same and the artifacts are few.

th. 3

12 June

- 25B / 1 0-10 cm below G.S.  
 / 2 10-20 cm below G.S.  
 / 3 20-30 cm below G.S.  
 / 4 30-40 cm below G.S. -- ~~empty~~ <sup>empty</sup> ~~still~~ <sup>got</sup>
- 
- 25B / 1 0-~~25~~ <sub>25</sub> cm below G.S. in a 1x1 m pit on Br.

- 25C / 1 0-10 cm below G.S.  
 / 2 10-20 cm below G.S.  
 / 3 20-30 cm below G.S.

- 25F / 1 0-10 cm in western 1x1 m square of 1x3 m pit

~~25D~~

- 25D / 1 0-15 cm in northern 1x1 m square of orig. 1x3 m pit

- 25P / 5 from 12 m West of orig. W branch wall to 3-00 m; following wall line
- / 2 0-20 cm in middle segment of orig. 1x3 m pit (a 1x1 m square)
- / 3 0-<sup>ca.</sup> 20 cm in front (N) of wall line, and a few cm. of earth above & south of wall.
- / 4 earth around & N of probable wall line in the pit <sup>pit at 20 m</sup>

- 25E / 1 0-20 cm below G.S. in southern most 1x1 m segment of orig. 1x3 m pit
- / 2 20-30 cm below G.S., & above rocks
- / 3 30-40 cm, south of stones of possible wall or terrace
- / 4 0- level of stones in middle 1x1 segm of pit



12 June

P84-5-80

25 F

On the SW side (or W side) of a mound (probable) which was not mapped as a mound last yr., the pit is 1m N-S x 3m E-W, and is designed to locate the front/plaza wall of the str.

Excavation is in 10 cm levels. Little found  
# in 1<sup>st</sup> level

25 G

On the east side of Str. 1. The pit is started at 1x1m, but may be extended to the west. Excavation is in 10 cm levels.

~~XXXX~~ This pit is designed to find the front/plaza side wall of the structure.

The R + G pits are encountering the dark topsoil.

25 D

The men have cleared the line of stones which does appear to be a wall line. They are now following it to the west.

25 F At 25-30 cm below f.s., and 35-50 cm ~~rest~~ North of ~~SW~~ SE corner were a number of sherds, lying flat

13 June 1984

25 D

The men have been chasing the wall [MISSISSIPPI] to the west, and have reached an area which may have a corner. They are clearing to the south now.

Sketch of Pit

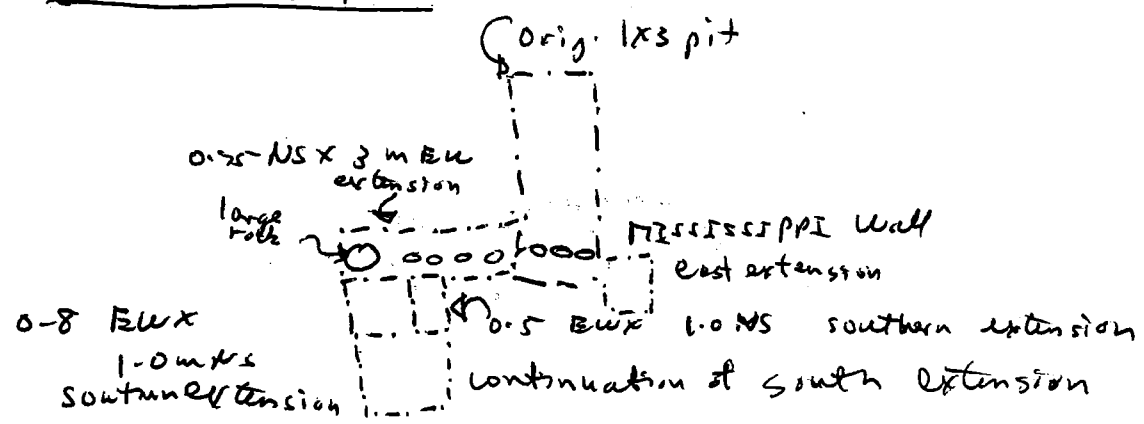

25 E

In the Northern 1.5 m of the pit, the top 10 cm of earth were removed, disclosing rising rocks to the north. The only clear line remains the one on the south at 25-30 cm below G. S.

A few sherds are in the earth around the rocks.

The rocks are higher on the west side -- remains of the neighboring structure? Jambly? I am having the dirt cleaned off the stones to take a picture before deciding what else to do.

12 June 1984

P84-5-42

25 D / 165 1.2 - 30 m west of orig. trench  
W. wall, 0-50 m NS, dirt above  
and around stones of potential  
wall; ~~located in E~~  
16 area above and around POTOMIC well  
(the NS trending well on the west side sh-  
total area 1.1 x 1.5 x 1 m EW; extension is South  
of previous West extension

25 E / 5 0-10 cm of earth above stones in Northern  
1-5 m of trench  
16 10-stones (depth variable) in Northern  
1-5 m of trench  
17 from cut in original 1 x 3 m trench,  
into stones & earth around stones in 0.5 m  
EW x 1.0 m NS area (the central square <sup>to 2 m</sup>  
18 among stones & dirt in northern 1 m x 0.5 m <sup>below</sup>  
of cut into probable tumble; to 30 cm below G.S.

25 F / 2 10-20 cm below G.S.  
13 20-30 cm below G.S.  
14 30-40 cm below G.S.  
15 0-10 cm in central 1 x 1 m section of trench <sup>Small</sup>  
16 10-20 cm in central 1 x 1 m section  
17 20-30 cm in central 1 x 1 m section  
18 0-10 in eastern 1 x 1 m section  
25 G / 2 25-40 cm below G.S. in orig. 1 x 1 m pit  
13 0-10 cm in western 1 x 1 m extension  
14 10 cm to base of excav. (ca. 35-40), among  
rocks and dirt of probable tumble

12 June 1984

25 F

The men have dug down to 20 cm below G-5, and the last 10 were essentially sterile. They are now moving to the East, going down 10 cm in the central 1x1 m square.

25 G

The first level here got out of hand. I had asked them to go to 20 cm, as the 1<sup>st</sup> 10 cm were essentially sterile. They began finding sherds, and got down too low at points, so the base of the first level is roughly 25 cm.

Level 2 is 25-40 cm below G-5.

They are now moving West in a 1x1 m extension, trying to determine where the structure actually begins.

Photos Roll 84-5-G, 84-5-H

- G 1+2 25 F, stones of unknown nature N the ends of pit
- G 3+4 25 E, like of terrace, HUDSON wall
- G 5+6 25 E, HUDSON from above
- G 7+8 25 C, South wall
- G 9+10 25 B, West wall
- G 11+12 25 C, POTOMAC wall (str. — West wall)
- H 1+2 25 E Corner 25 E POTOMAC + ~~MISSISSIPPI~~ MISSISSIPPI
- 3+4 MISSISSIPPI wall from North
- 5+6 MISSISSIPPI, in original trench, S/North

13 June 1954

P89-5-44

25G

The men are cutting through the apparent jumble in the northern half of the trench. (The original 1x1 m square was extended by a second 1x1 m square, to the west.) All of the rock looks like jumble, and sherds are being found among them.

25H

The western extension remains in conclusion. The stones are high on the north side of the 1x1 m square, but low to absent on the south. The rocks look jumbled. In the central part of the original trench, I lifted a rock, to see if the "floor/wall" was real. Under the rock was a large pile of bajareque, & no stone. The stone to the west went down <sup>below</sup> the putative surface. I concluded that we were 25D really looking at jumble. Because of this we did the

On the east side of the str., we attempted to find the well. A distance of 55-60 cm E-W x 1.65 N-S was cleared of earth to a depth of 8 cm (~~not~~ 40 cm) to 15 cm (on south). Only one rock was found. There is no well apparent here.

The men are back on the west wall, POTO MAC, following it to the south. There is topsoil to the west, starting just west of the orig. trench, but none to the east.

25F

The central 1x1 m square is now down to cm. They are now doing the 0-10 cm level in the next (eastern) 1x1 m square

→ 25E -- western extension. Now, the men are cutting to the north, on the east side of the original trench

15 June 1984

P89-5-45

Plan	Points,	Site #	31	14 = 1.5-2			
PT		⋈	Bot	Top	Mid		DIST
1	31 C	NW corner orig	294° 15'	1339	1452	1395	11.11
2		SW corner orig	294° 30'	1247	1360	1302	11.27
3		NW corner S ext.	293° 10'	1320	1220	1270	9.93
4		SW corner S ext.	287°	TOP 1181	1078 <sup>Bot</sup>	1130	10.12
5		SE corner S ext.	285° 10'	1178	1083	1131	9.44
6		NE corner	298° 40'	1424	1321	1378	9.27
7	Str. —	NE corner	293° 45'	1405	1322	1363	8.27
8		SE corner	272°	1359	1223	1315	8.28
9	31 D	NW corner	231° 15'	2312	2079	2195	23.27
10		NE	229° 45'	2233	2068	2121	22.63
11		SE	226° 45'	2462	2218	2339	24.47
12		SW	228° 50'	2487	2235	2360	25.01
13	Str. —	SE corner?	231°	1584	1405	1495	17.74
14		NE corner	234° 15'	1269	1131	1197	12.72
15	31 E	NW corner	198° 30'	1458	1312	1385	14.30
16		SW	197° 15'	1585	1432	1508	15.22
17		SE	193° 45'	1594	1442	1517	15.03
18		NE	194° 30'	1427	1286	1356	14.05
19	Str. —	SW corner	200° 30'	1392	1251	1321	14.0
20	31 B	SW corner	98° 45'	0906	0791	0849	11.44
21		NW	93° 45'	0878	0762	0820	11.47
22		wall S both end	98° 45'	0974	0848	0910	<del>12.81</del>
23		wall N end	95°	1019	0891	0955	12.76
24		NE trench	96°	1088	0941	1014	14.51
25		SE trench	100° 50'	1040	0896	0968	14.34
26	Str. —	NE corner	86° 15'	1107	0963	1035	14.16
27		NW	72° 45'	1224	1120	1152	10.27
28		SW	100°	1153	1071	1112	8.19

15 June 1984

P84-5-46

While Ed & R did the plan points for #31, Alec & Julie supervised #25. The men we know what to do pretty well, so there were no problems with them. Julie, especially, & Alec keep good track of the lots. It's a shame Julie doesn't know any Spanish.

### 25 G

The wall situation here remains as unclear as yesterday. The men are removing a 1x2 m block, parallel to the original trench, on the NE. We are trying to pick up a wall junction.

### 2CE

Three 1 m squares have been excavated, and we're starting a fourth. The low rise seems to be a trash deposit.

15 June 1989

P84-5-~~4~~<sup>47</sup>

25 D

The search for southern and eastern walls has turned up essentially nothing. The trench now looks like this:

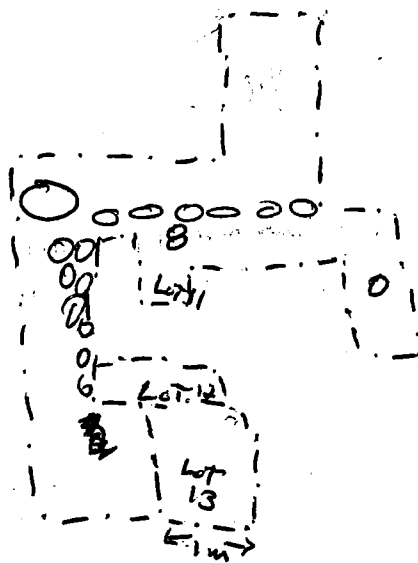

They are digging now in the apparent earth fill of the str. where we thought there was a poss. line, but nothing is there.

After this they dug in on the south, and again found nothing. The southernmost extension is now being expanded to the west.

25 E

The western extension of this pit has finally produced a wall. It isn't great, but it is believable. HUDSON has also been revived, as a surface or small terrace. These are now being cleaned for photos + drawing.



15 June  
25 G

P84-5-48

A probable extension of HUDSON has been uncovered, as well as a probable continuation of NILE. These features run across the pit at an angle

### Sketch

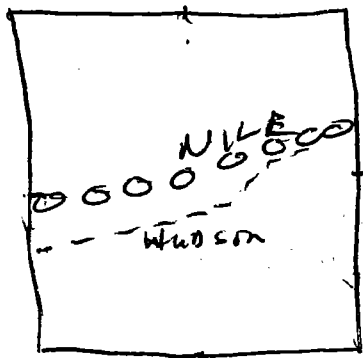

The stones of HUDSON and NILE are on the red clayey, stony level. This level rises to the west, under the structure. A few stones of HUDSON are actually in the

basal red level. I do not claim that these are very clear features, but with their appearance clarified in 25 E, they can be seen here. Plan pts. have been taken on the features, but no drawings were made

Photos 84-5-H11+12 HUDSON x NILE  
in 25 G, from east

Some very large rocks are in side the str, west of NILE; eg. 34 x 26 x 19 high. Most are much smaller, ca. 20 x 12 x 10 high

Str 1 may have more than 4 sides

15 June  
 Plan Points #25  
 Strs 1-4 (Group 1)  
 IH = 1.545

		Mid	Bot	Top	Dist	
1	NE corner original pit	61°0'	1838	1778	1902	12.17
2	NW corner original pit	59°30'	1853	1798	1911	11.28
3	SW corner original pit	74°0'	1400	1347	1453	10.67
4	SE corner original	75°0'	1395	1338	1455	11.50
5	NE corner east extension	73°15'	1459	1394	1525	12.80
6	SE corner east ext.	75°45'	1448	1382	1512	12.84
7	Junction east ext. + SE ext.	75°30'	1413	1353	1477	12.79
8	SE ext. SE corner	79°30'	1351	1292	1410	11.87
9	SE ext. SW corner	79°45'	1303	1246	1361	11.50
10	S ext. NE corner	72°0'	1340	1389	1493	10.31
11	S, ext. SE corner	77°0'	1393	1340	1444	10.18
12	S ext. SW corner	76°0'	1459	1413	1507	9.35
13	S ext. NW corner	70°30'	1527	1478	1574	9.42
14	West. SE corner	72°0'	1506	1452	1560	10.67
15	W. ext. NE corner	67°0'	1629	1565	1675	10.72
16	W. ext. NW corner	60°45'	1735	1694	1777	8.10
17	SW ext. NE corner	70°0'	1578	1533	1624	9.03
18	SW ext. NW corner	79°45'	1557	1505	1565	8.70
19	SW ext. NE inter. corner	81°15'	1310	1340	1440	9.85
20	SW ext. NE inter. corner	84°30'	1385	1335	1435	10.00
21	SW ext. NE corner	85°15'	1412	1356	1468	11.14
22	SW ext. SE corner	89°30'	1446	1390	1502	11.27
23	SW ext. SW corner	96°0'	1577	1538	1617	7.82
24	Potomac Wall South end	82°45'	1358	1516	1600	8.41
25	Potomac wall N. end	68°45'	1680	1635	1726	8.97
26	Potomac wall S end. <sup>W. side</sup>	76°15'	1572	1530	1615	8.41
27	Mississippi West end	66°30'	1615	1571	1662	8.92
28	Mississippi East end	72°0'	1462	1403	1521	11.65
29						
30						

Pts.		$\Delta$	Mid	Bot	Top	Dist
29	25E NW corner	<del>229</del> 229° 0'	<del>1981</del> 1981	<del>1956</del> 1956	2006	4.83
30	NE corner	230° 0'	1972	1951	1994	3.93
31	SE corner	192° 0'	2098	2073	2124	4.82
32	West SW corner	206° 30'	1929	1882	1957	7.35
33	NW corner W. ext.	214° 0'	1893	1857	1930	7.10
34	Junct W. ext. + Main trench	208° 0'	<del>2065</del> 2508	2037	2092	5.14
35	Hudson E end	201° 0'	<del>2000</del>	2475	2525	4.68
36	Hudson W. end	220° 15'	2354	<del>2322</del> 2380	2380	6.11
37	Hudson ?	209° 45'	2309	2282	2328	4.24
38	Nile N End	208° 30'	2425	2397	2453	5.54
39	Nile S. End	203° 30'	2286	2254	2317	6.34
40	25G Nile ?	197° 30'	2366	2330	2409	7.79
41	Nile ?	195° 30'	2280	2239	2323	8.28
42	Hudson ?	194° 30'	2484	2444	2525	7.85
43	NE corner	187° 0'	2114	2080	2150	6.79
44	NW corner	204° 30'	1985	1950	2019	6.87
45	SW corner	201° 0'	1942	1899	1988	8.94
46	SE corner	189° 30'	2100	2055	2145	8.90
47	25B SW corner	257° 15'	2430	2772	2890	11.75
48	NW corner	261° 30'	2921	2657	2982	12.39
49	NE corner	265° 0'	2894	2840	2956	11.76
50	SE corner	261° 15'	2798	2743	2853	10.97
51	25C SW corner	325° 30'	2523	2443	2552	5.67
52	NW corner	327° 30'	2658	2623	2692	6.67
53	NE corner	335° 0'	2590	2556	2626	6.66
54	SE corner	336° 30'	2429	2394	2455	5.66
	25F SW corner	109° 45'	1740	1685	1799	11.17
	SE corner	110° 30'	1695	1634	1755	12.15
	NE corner	92° 15'	1282	1210	1357	14.75
	NW corner	89° 30'	1349	1278	1419	14.02

18 June 1984

P89-5-5-1

Site 33

33 B, on Str. 11

A 1x2m pit on the SE side of the Str. The pit is oriented to the structure, and is placed on the long side (although this is difficult to tell on this str, which is disturbed by 2 trees).



33 B

Objectives - trash for dating, and the wall of the str.

This grouping of 3 may be Early Postcl, and we need to increase our sample of this period.

We were going to do test pits here, but some str. & clusters are planted & can't be excavated. We will therefore do a little more with the ones we can excavate.

33C, Str. 9

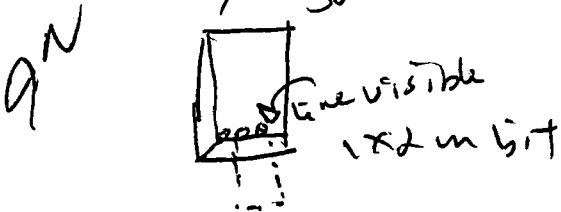

This str - has a clear South wall line, and the excav. is set up to intersect this. It is 1m E x 2m NS.

The objectives are to encounter a midden, and to link it to the structure

18 June 1984

D84-5-52

33 D on str. 1, + 33 E

Str. 1 is the largest structure of the cluster on the point. The group is very overgrown, and we have decided to excavate only one str. The plan of the group is late Classic in appearance, and if this is correct, testing one str. should produce a large enough sample.

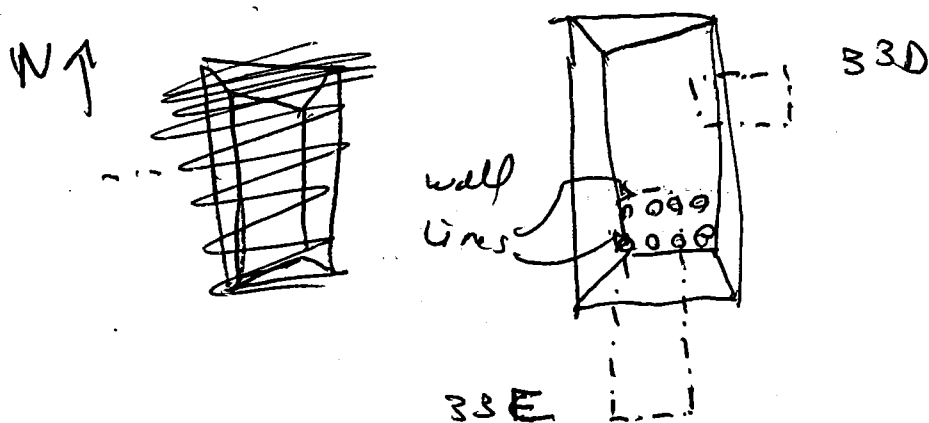

33 D is 1 m NS x 2 m E-W, on the east side of str. 1. It is designed to find trash & the east wall line.

which is just possibly apparent on the surface of the ground.

33 E is on the south side of the str. It is laid out at 1 m E-W x 5 m NS. We do not expect to completely excavate the entire 5 m, but do hope to at least clear away the earth over the last 3 m. The trench runs up and over two times visible on the surface, which seem to be terrace lines. We'd at least like to get a good profile over the terraces.

Photo: 84-5-I 1+2 33 C, OREGANO wall s/s.

18 June 1989

P89-5-53

33 B

lot  
33B/2 A carbon sample has been recovered from the  
W corner, at ca- $25-30$  cm below P.S. It was  
under a rock, and, of course, could be modern  
(e.g. a burned root), but we have saved it.  
The workmen dug it out before we got  
there, and put it on the edge of the trench,  
but I do not think it was much contam-  
inated -- we didn't include leaves, etc, and  
left out the bottom layer of the carbon.

Shards are also coming out at the 20 cm level.  
Before lunch the men began clearing the rocks in the  
2nd 1x1 m portion of the trench. They appear to form a wall,  
although a low one.

33C

Few shards so far, most from the 10-20 cm level.  
Little humus in this pit. They are doing 20-30  
cm now (ca. 10:40).

Level 20-30 cm had only 3 shards, and seems to  
be into the basal rock level - so they are moving  
into the 2nd 1x1 m segment of the pit (the  
northern meter).

Saw an animal larger than a cat but smaller  
than a medium-sized dog. It was red-brown  
and gray. I didn't see the head, but Julie  
says it looked like a fox.

33C - The wall has been disclosed, and is being  
cleaned for photos. After this and a drawing we will  
fill the wall to the next taking for ...

P89-5-54

18 June 1984 LOT LIST

- 33 B | 1 0-10 cm in eastern 1x1 m segment of trench  
| 2 10-20 cm  
| 3 20-30 cm  
| 4 cleaning ~~the~~ BAY wall  
| 5 from earth east of BAY wall  
| 6 from earth and stones east of BAY in  
north-eastern trench extension

- 33 C | 1 0-10 cm in southern 1x1 m segment of trench <sup>Empty</sup>  
| 2 10-20 cm  
| 3 20-30  
| 4 0-20 cm in northern segment of trench  
(0-10 had 1 sherd)  
| 5 from following OREGANO wall to east  
| 6 from following OREGANO wall to the west

- 33 D | 1 0-10 cm in eastern 1x1 m segment of trench  
| 2 10-20  
| 3 20-30 small lot  
| 4 30-40 ; Empty lot  
| 5 from earth above stones <sup>in western 1x1 m</sup> (probably tumbled)  
| 6 from 50x50 cm area, among stones of <sup>probable</sup> platform  
in NE corner of western 1x1 m segment;  
expanded to 1m EW x 0.5m NS; expanded to 1x1m

- 33 E | 1 0-10 cm in southern most 1x1 m segment  
| 2 10-20 cm Empty lot  
| 3 20-30 cm Empty lot  
| 4 40-50 cm (1 sherd)  
| 5 earth above stones in extension of ~~excav.~~ to next  
segment (from cleaning stones) - Empty lot  
| 6 among <sup>below</sup> stones in 1x1 m area <sup>North</sup>
- 17 from removing dirt in remainder of pit to north

18 June 1984

P84-5-55

### 33 C

The wall was drawn & photographed (~~with~~ <sup>OREGANO</sup> wall)  
Drawing = D 84-18-1 (Hendricks)  
They are now trying to follow the wall to the east.

### 33 B

BAY wall has been cleaned, and is very clear.  
It is photographed, and is being drawn by Ed and Julie

### 33 D

The original 1x1m segment is down to 40 cm, with the last lot empty. The men have cleaned the earth from over the stones, and are now removing all rocks from a 50 cm x 50 cm area in the NE corner. A very few sherds are coming out from among the rocks

Sketch

N ←

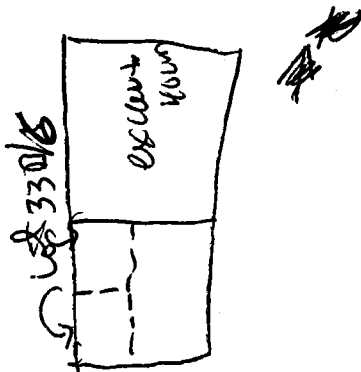

The results were in un-  
sive. There is a basal  
level with a few rocks  
above and slightly in it.  
We will pull out the next  
50 cm going west.

### 33 E

The men dug down to 30-55 cm in the orig. 1x1m area, and found very little. They are now clearing the earth from over the rocks to the north.



18 June 1984

P84-5-56

### 33 C

The probable corner of the structure has been uncovered in an eastern extension of the pit. The corner is fairly clear, and there is a possible eastern terrace or extension called CLOVE

They are now moving west to get the other corner. The corner is about 50 cm west of the original trench. There is another possible surface west of the corner.

### 33 D

The wall seems to have appeared at the western edge of the trench. We are having the southern bunch of rocks removed to clarify this.

The wall is clarified by the removal of the rubble, which has been considerable! The wall is called DILH wall.

### 33 E

An apparent wall has been found at 2 m north of the pit's original south edge. This is called TURMEREC wall. It is above the red bed, which rises a bit over the length of the excavation.

The men are now clearing off the earth going north, up and over the structure.

19 June 1989

P84-5-57

33B is finished & photographed, as is 33C. Jeff and Julie are drawing an elevation of GREGARIO wall.

33D

33D has been finished, drawn (P84-5- ) and photographed.

The wall (DILL) seems to actually be set into the red lower soil level. We did not dig down to the decayed rocks here. The tumble is above and on the red level, with a few small exceptions. Within the red level, at the approximate base of the wall, are several patches of small stones. Although while excavating they weren't very distinctive, they look like a possible surface in the section.

The amount of tumble in this pit is quite high, which leads me to believe that the wall was one higher than it is. Several of the stones in the furthest tumble are large, like the wall stones. The construction technique seems to be large stones as the face, backed by smaller stones.

Large stones in wall:

	width	high
1	24	17
2	23	12
3	20	13
4	11	5
5	14	7
6	9	11

	width	high	deep
1	25	17	14
2	22	8	22
3A	31	14	20
3B	36	7	20
4	14	7	18
5	12	9	12
6	11	6	13

small

19 June

D 84-5-58

33E

TUNEREC is ready for photos, and Ed & I will draw the profile.

33F 1x1 m

This pit is on the (we hope) NE corner of Str. 9. So far the probable corner of the small stone surface (CLOUE) has been found, but the wall line of CINAVAMOI (The N-S wall that corners w/ OREGANO) is not clear.

later ~~the~~ CLOUE's corner is now clear, but the platform walls seem to have disappeared

33G

On the west side of Str. 1, looking for sherds and a wall, perhaps. 1x1 m

later - G has a structure wall, and an unclear feature: a cobble-high possible pavement, or wall, running west, and separated by the wall of the str. by ca. 1 m. They are clearing this western feature

33H Str. G

This is 1 m NS x 1.5 m EW, on the east side of the str. We are trying to get enough sherds to date the group. This pit should intersect the western wall line, which is ~~on~~ the surface at 1-1.10.

later - Dutch rubbish was uncovered, and it is being removed

19 June

D84-5 09

33E

The original pit is well down (50cm) below G-S, but only the red clay level has been found. Although they do not appear clearly in section, the lower part of this 1x1m square has a lot of stones.

The red level comes in just under TUTTEREC wall, which we interpret as some sort of basal wall, even though it is much lower than DILL in 33D.

The upper terraces are less clear. The middle one PARRAGON, is fairly clear, as it was on the surface, ~~then~~ The northern line, as seen on the surface, is not as apparent after cleaning, but we have named it TTYNE.

The line of DILL seems to run along the east side of 33 E. It extends clearly 2 m from the south side of 33D, and less clearly for another 1.20 m, for a total of 3.20m. A few more stones go 0.70 m further, but they seem slumped or tumbled.

SKETCH

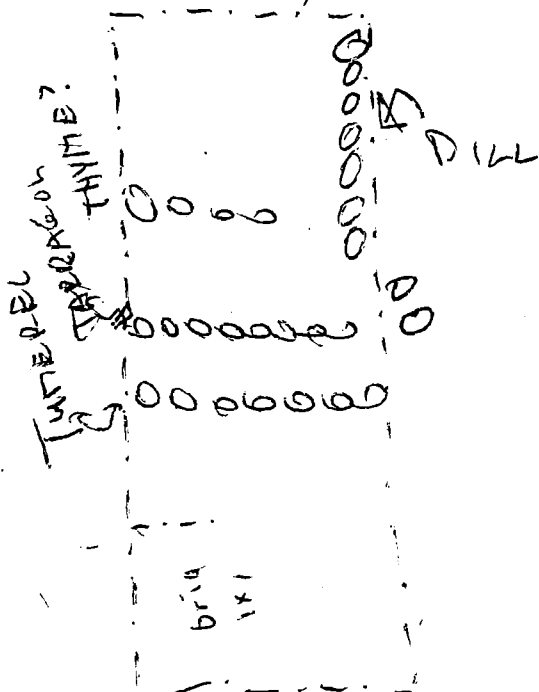

The shape of the str. is odd. DILL may be deeper to the east than it is on the north. TUTTEREC must join something, but we don't know what.

29 June

P84-5-60

SKETCH reconstruction Str 1

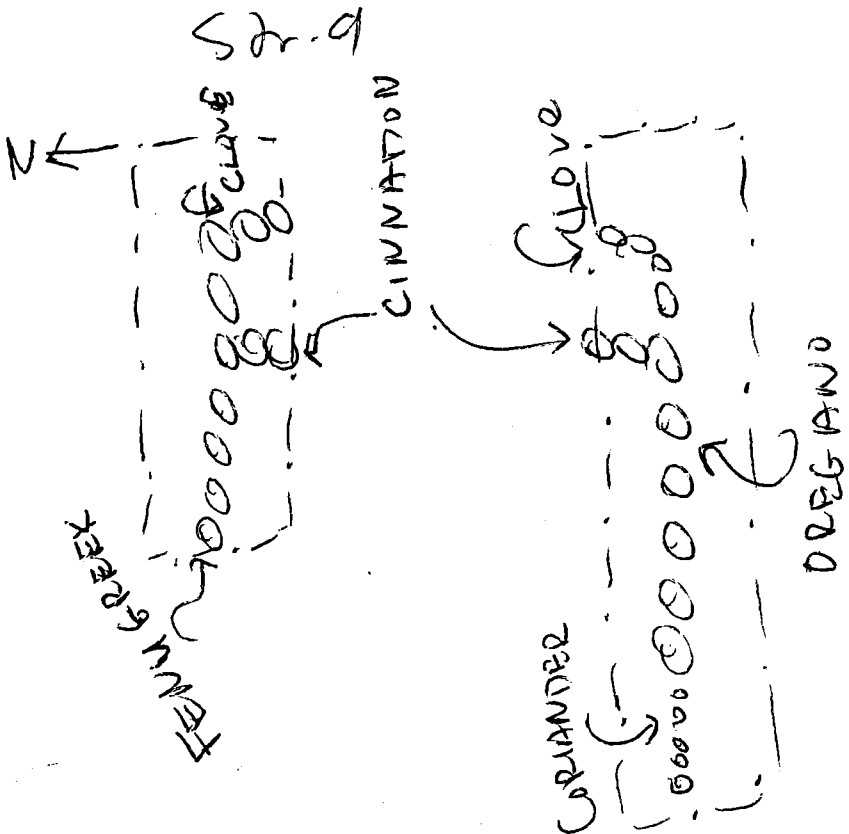

19 June 1989

Site # 35 -- owner Sr. Fernandez  
also # 36 (the one I saw)

# 35 is west along the fence for Sr. Fernandez  
house

34B Str. 5

A clear north wall, BERNAISE, has been uncovered in the orig. 1 m EW x 2 m NS trench. No sherds (or at least negligible quantities) have been found.

The wall is being followed to the east.

34C Str. 14

Nothing is clear here! The rocks on the surface do form a rough rectangle. A 1 m EW x 2 m NS trench was dug on the south side of the Str. (Str. 14). The men are now clearing a third 1 x 1 m square to the north of the original pit.

I was absent during the afternoon. I do not have master lists of lots (see Miller's notes) or photos (see Miller + Schortman).

20 Jan

P84-5-62

Photos

- 84-5-K 374 dead snake at #33  
5+4 33F Stones of western 1x1 m  
segment before removal  
7+8 34B, BERNALISE wall fr/north  
9+10 34B, BECHATEL well fr/east

33F

Sherds were found in the 10-20 cm level in the western segment of the trench. The men are now going down 10 more cm. They have removed the small stones.

Sherds are plentiful in the lower levels here - including a Copador!

Photos

84-5-K 11+12 34C, CHILE wall, fr/south.

Aug-5-63

20 June

PLAN POINTS

PT		ℓ	PI 10	Bot	Top	Dist
1	33B NW corner extension	36°45'	0884	0824	0945	12.00
2	BASIL trench, west	37°15'	0870	0800	0929	11.89
3	NE corner, BASIL + BAY	40°30'	1031	0971	1091	11.96
4	NE corner extension	41°15'	0999	0934	1064	12.75
5	junct. ext. + main pit	47°0	1049	0992	1104	11.16
6	NE corner main pit	51°	1114	1059	1172	11.36
7	SE corner main	54°	1134	1080	1188	10.54
8	BAY south	47°30'	1035	0995	1094	10.06
9	SW trench	43°45'	0888	0840	0937	9.64
10	Str-11 SE corner	56°15'	1247	1206	1287	8.05
11	SW corner	30°30'	1161	1132	1140	5.54
12	NW corner	22°30'	0912	0855	0970	11.26
13	33C NE corner east ext.	325°45'	1278	1259	1297	3.43
14	SE corner east ext	322°15'	1313	1298	1327	2.64
15	CLOVE SE corner	314°30'	1554	1538	1621	3.19
16	OREGANO east, + CIN	303°45'	1389	1371	1408	3.50
17	NW corner E ext.	243°15'	1327	1303	1349	4.28
18	junct main pit + E ext	290°15'	1318	1300	1337	3.41
19	main pit SE corner	244°45'	1543	1529	1558	2.66
20	main pit SW corner	261°	1565	1546	1584	3.52
21	junct. main + West ext	277°45'	1435	1414	1457	4.21
22	West ext SW corner	269°	1477	1443	1712	6.69
23	West ext, NW corner	255°15'	1712	1677	1949	6.85
24	CORIANDE SW	272°15'	1813	1786	1845	6.35
25	CORIANDE + trench	276°	1721	1737	1803	6.55
26	OREGANO west end	278°15'	1499	1473	1524	5.02
27	OREGANO + trench	251°30'	1448 1199	1414 1169	1475	5.46
28	33F SW corner trench	310°	<del>1444</del>	1469	1231	6.09
29	NW corner trench	314°	1263	1228	1299	7.20
30	wall is 46 cm wide FENUGREEK <del>317°15'</del> west	317°15'	1298	1269	1332	6.93
31	CORIANDE SW north	323°30'	1316	1281	1349	6.51



1H = 1.495

20 June

PLAN PTS

P84-5-64

	POINT	26 cm wide	ℓ	MIN	BOT	TOP	Dist
32	33 F CINATION	+ trench South	323°45'	1298	1267	1328	6.0
33	CLOVE	+ trench South	329°	1366	1336	1398	5.88
34	CLOVE	North	328°45'	1321	1288	1355	6.6
35	trench	NW corner	331°30'	1248	1212	1284	6.8
36	trench	SW corner	332°45'	1235	1213	1265	5.8
37	33 C	NE corner	100	1167	1140	1193	5.06
38		SE corner	1090	1195	1167	1225	5.62
39		NW corner	113°	1092	1075	1111	3.41
40		DILL North	1140°30'	1301	1283	1320	3.45
41		DILL + trench	123°45'	1174	1152	1197	4.08
42	33 E	NE corner trench	135°15'	1206	1179	1233	5.23
43		NW corner trench	147°	1092	1048	1117	4.79
44		THYME West	150°15'	1493	1165	1222	5.58
45		THYME East	140°45'	1299	1267	1329	6.05
46		THYME + DILL surface	138°	1316	1283	1348	6.25
47		TARRAGON <del>west</del>	147°45'	1565	1526	1602	7.4
48		TARRAGON West	155°15'	1474	1438	1511	7.18
49		TUNBERG West	156°	1648	1609	1688	7.62
50		TUNBERG East	149°	1755	1715	1895	7.87
51		SE corner trench	152°30'	2048	1999	2098	9.64
52		SW corner	158°45'	2109	2060	2157	9.52
53	33 G	SW corner trench	214°30'	2301	2222	2333	6.05
54		NW corner trench	223°15'	2276	2250	2306	4.40
55		NE	208°15'	1891	1869	1913	4.21
56		<del>NE</del> SE	208°45'	1951	1924	1979	5.09
57		GINGER South	209°	2079	2054	2106	5.21
58		GINGER North	209°45'	2126	2104	2150	4.42
59		ANISE North	219°	2363	2338	2389	4.98
60		ANISE South	271°15'	2343	2364	2422	5.67
61	Sh. 1	NW corner	242°45'	1958	1891	1923	2.85
62		SW corner	188°15'	2350	2305	2395	8.25
63		"DILL" surface NE	105°45'	1054	1038	1071	3.05

1H = 1.45

40 cm wide  
67" tall  
West side

20 June PLAN POINTS

	POINT	ℓ	P.O	BOT	TOP	Dist
	64 Str-1 "DILL" surface corner	172036'	—	—	—	1.33
	65 "DILL" surface SW	1720	1362	1336	1390	5.15
	66 336 NE corner	336°45'	1089			5.70
IH=	67 " SE "	332°15'	1148			4.68
1.52	68 " SW "	314°45'	1339			5.71
	69 " NW " w.	320°15'	1252			6.57
II=	70 336 Pansley wall (e. - w. 2)	324°15'	1535			5.91
near	71 " " " e. (with N. side)	335°45'	1070			5.27
SW	72 Pansley wall, E in trench	6°45'	0939			5.28
corner,	73 PEPPER " + trench wall, N. (NE corner of str.)	333°45'	1032			5.82
TOP	74 MARJORAM, in trench E. (NW corner of str.)	11030'	0940			6.81
of 17,	75 " + PEPPER junction	340°45'	1005			6.51
on	76 SW corner of str.	295°01'	too close.			0.73
S. line.						
	77 34 B main, <sup>tray</sup> NW corner	33°30'	1392			4.68
IH=	78 main NE	45°	1352			5.14
1.495	79 joint main + east ext	56°15'	1310			4.24
	80 east ext., NE corner	66°45'	1261			5.55
	81 jund. east ext. + S ext.	71°45'	1279			5.41
	82 South ext., NE corner	77°15'	1272			5.95
	83 South ext., SE corner	95°45'	1298			5.44
	84 BECHAMEL south	95°15'	1283			4.65
	85 BECHAMEL + BERNAISE	73°45'	1204			5.12
	86 BERNAISE west	52°15'	1233			3.09
	87 Str. corner, NW	290°15'	1395			2.31
	88 " " SW	130°30'	—			1.26
	89 " " SE	101°30'	1343			4.53
	90 Feature (Route) N	88°45'	1056			9.04
	91 Feature South	105°	1091			10.04
	92 Feature East	1030	1132			11.28

20 June 1989

P84-5-66

PLAN POINTS

		ℓ	π <sub>10</sub>	BOT	TOP	DIST
93	34 B SE corner main trench	146°	1331	-	-	7.75
94	SW corner main	157°30'	1324			7.28
1# = 95	Joint main + West ext, south	149°	1315			5.90
1.495 96	West ext. SW corner	159°15'	1222			5.59
97	West ext, NW corner	157°	1331			4.49
98	Joint West ext. + main, north	144°30'	1295			4.88
99	NW main	139°45'	1317			4.38
100	NE main	130°	1317			5.16
101	CHILE wall east	137°	1258			5.97
102	CHILE wall west	149°04.5'	1331			5.26
103	5m Corner, NW	145°45'	1389			3.21
104	1m Corner NE	118°45'	1376			4.12
105-						

Photos

84-5-2 1+2 33 ~~at~~ deep ~~seg~~ segment  
 on west of trench  
 3+4 33 ~~at~~ PARSLEY wall r/wes

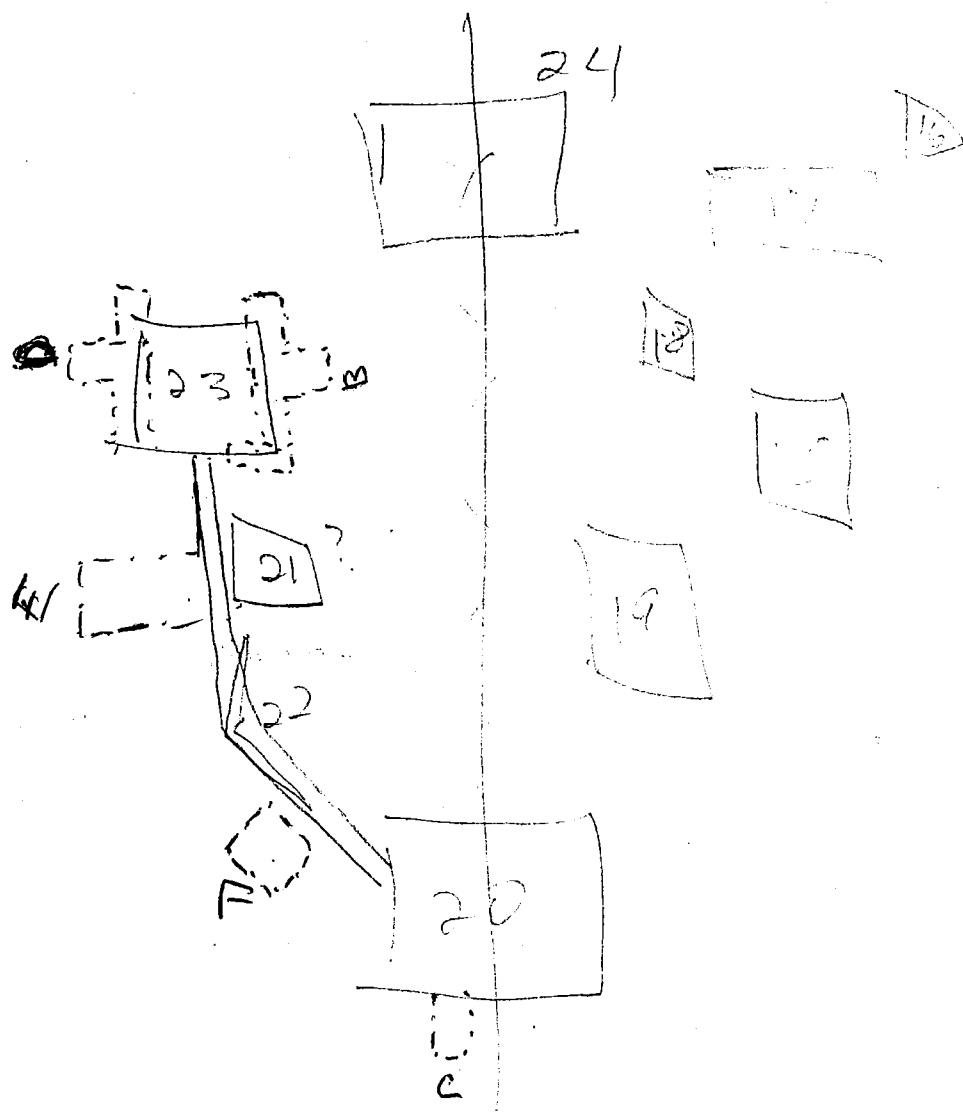

21 June 1984

P84-5-67

Lot LIST

- 52 B-17 Continued f/ 20 June; in earth east of stones of TIOCTHA Wall
- 18 from earth south of stones of probable wall in 1m E x ca. 0.5m NW extension to west of CHOCOLATE wall
  - 19 from earth east of TIOCTHA in northern extension and north of VANILLA

52 C/5 20-30 cm in northern 1x1 m square

-16 30-40

-17 earth above stones in 3rd 1x1 m area ~~Empty~~ <sup>Small</sup>

-18 among stones and earth of probable tumble in western 50cm square, from stone removal activity; extended to SE 50cm square, south of possible wall ~~the~~ <sup>Small lot</sup>

52 F | 10-10 cm in 1x1 m pit

12 10-30 cm

13 0-~~10~~ 5 cm in 50cm northern extension

52-D/8 from earth above and west of stones in (roughly) 1x1 m extension of the pit to the south, looking for more of PEACH wall

-D/9 from earth west of probable wall + above stones in 1m southwestern

-D/10 from earth west of PEACH in northern extension

52E/1 0-10 cm below GS in western 1x1 m square of 1x2 m E-W pit

-E/2 10-20 cm below G.S. in western square; flotation sample

-E/3 30-40 cm; flotation sample

-E/4 40-50 - Very Small lot

-E/5 0-10 in eastern 1x1 m square (small lot)

-E/6 10-20 in eastern square

-E/7 20-30 cm

-E/8 0-30 cm in ca. 20 cm of earth ~~East~~ West of probable wall and following potential PEACH to north <sup>LPEACH</sup>

21 June 1984

yesterday, 20 June, Ed and I spent recording sites #33 and 34. We did 100 plus plan points and 4 drawings.

To keep the work progressing, we set up some excavations at site #52. Most of 52 is on Bualjoquito land, and most of that is private land. One group, on the west of the site, protrudes into Sta. Rosita Co-op land. So we are testing that group.

Yesterday Julie Miller was in charge -- a baptism by fire. We only made it over for 45 minutes at lunch time. The work went well, however. The work men are competent, or better, with one exception (Jesus Dimas). Julie needs some work on organizing her notes, but she does keep track of lots, and has learned a lot about making decisions in excavation.

Kathleen McHaren<sup>#10</sup> is working with me today. I am very tired -- Aeleky was up late last night, and I wake too early this morning. At least there's some shade at this site, and there's very little walking around to do.

52c

Today the men continue to go down in the orig. 1x2m pit. They are excavating down to 60 cm in the northern segment. Some large rocks lie in the eastern part of this square, their tops well below G.S. They do not seem to form a feature, but I am leaving them in the pit. The next step will be to cut into the apparent mound.

P89-5-69

21 June

52D

After the first 1 m extension, we are going another meter to the south, trying to locate the junction with the terrace, which seems to exist on the surface

Next they are cleaning the dirt from the stones a little to the east, to clarify the terrace wall, which is called PECAN

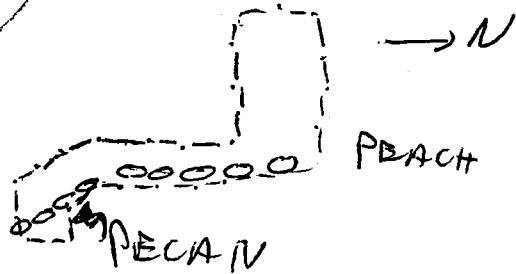

52B

MOCHA wall seems to have reached a corner <sup>ca. 2.20m</sup> south of the original trench. We will chase this new wall, CHOCOLATE, for a while, as I am curious about this possible terrace linking Sr-23 (where B is) and 20 (where C is). The terrace is probably Sr-22 from last yrs. ~~map~~

The extension is 1 m E-W by ca. 50cm N-S.

Later: The corner is confirmed -- CHOCOLATE exists. Next we will photo graph MOCHA, and then go north for the other corner

PHOTOS

- 84-5- L5+6 MOCHA wall, main trench, Sr/east
- 7+8 MOCHA/CHOCOLATE corner
- 9+10 CHOCOLATE wall S/south
- M 11+12 MOCHA, long shot Sr/south
- 1-8 52D PEACH wall (1-6 say '52C')

21 June 1989

52 B + D

The men are now clearing to the north looking for the other 2 corners of the structure. When these are found I think I will have them cut from both sides into the structure.

52 C

In removing the stones in the western 50 cm, a probable line has appeared, as well as some huge rocks that look like down-hill retaining stones. Although it isn't very nice-looking, I do think that this is the south wall.

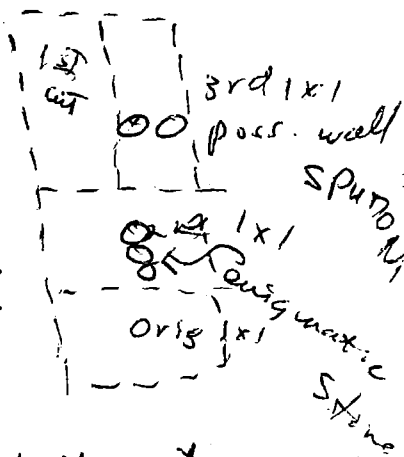

In the middle segment are three rather enigmatic stones in a N-S line, but not really related to anything. I may pick up more when I travel around.

PHOTOS

17 9+10

17 11+12

52C

SPUTONI wall

enigmatic stone feature

LOTS TO

52 D/10

WASH

CAREFULLY

52 B/8

52 E A 1x1 m pit on the south side of Str. 22 (the terrace); looking for trash and for a possible terrace wall, if there's time.

52 F After excavating the 1x2 pit, the men moved east and cleaned a rock that I thought was part of the terrace. Little seems to be beside this very large rock.



21 June

P84-5-71

52 B + D The corners seem to have been found and I christen the wall (with Pol's help) VANILLA.

52 B

There is a peculiar symmetry in the placement of 2 enigmatic groups of stones. At 80-90 cm in towards the S's mid line & both the SE + NE corners there are "lines" of stones which seem to go to the east. We are going to examine the south one.

Sketch

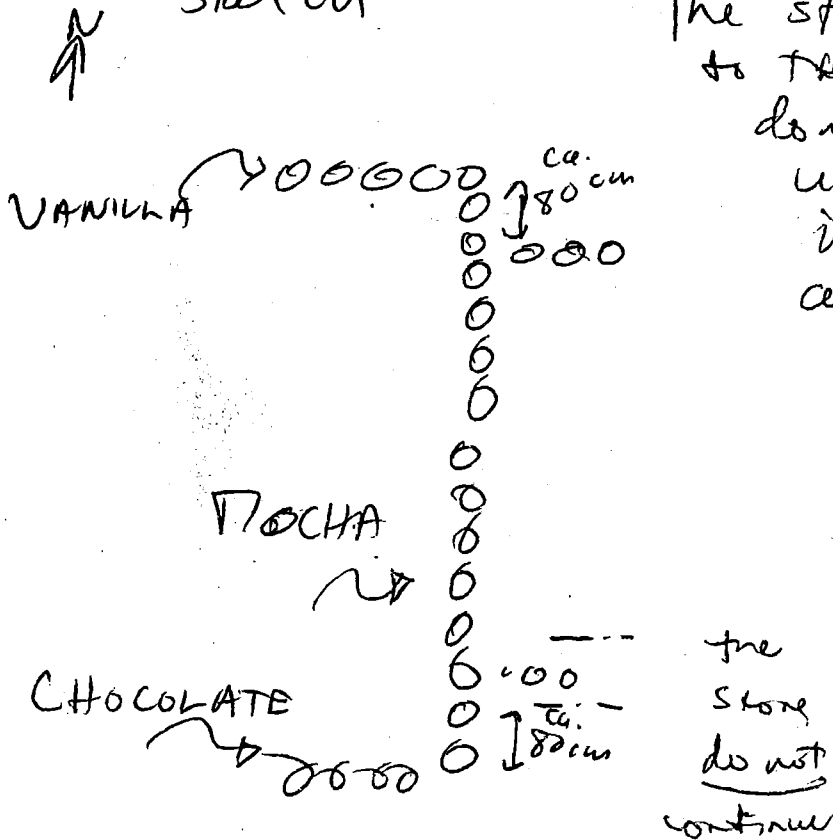

The stones do not continue to the east, so I don't know exactly what we have, it indeed it means anything.

52 F has turned up nothing, not even many shards. We are closing it up, too.

52 E The scratch for the terrace wall has failed to turn

up any stones between the large stone in the trench and the next one to the north

22 June 1984

P84-5-72A

Backdirt lot 52 E quartz? glass?

PHOTOS

- 84-5-N 1+2 52 B NE corner DOCHA
- 3+4 52 B DOCHA fr / North - long sec
- 5+6 52 D PEACH NW corner
- 7+8 52 D PEACH wall, northern sq. m.
- 9+10 52 F north end trench
- 11+12 52 E east end trench

52 F

This pit has produced a lot of tumble, which slopes down from the NE to the SW, and rides over the clay (reddish) level. There are more stones on the east than on the west. I think it's all tumble from above - no walls.

52 E

The large rock (PECAN) which we excavated up to is actually west of the line of the terrace (Str. 22). Trenching around disclosed a line of rocks below G.S. just east of the PECAN rocks. The link to Str. 4 the width is still unclear, although 52 D did clear a lot of the area where the junction should have been.

<sup>of 21 June</sup>  
 PUTONI = 52 C In doing the drawing a third soil level became apparent, one filled w/ small decaying rocks, and dense & hard in texture. FUDGE appears to be set into & on this lowest level. FUDGE has more reality as a feature - some rocks move off to the east from it, and it looks sort of like a terrace. There is little corresponding material in the <sup>left</sup> side - just one rock at 20cm below G.S. at 1m N of trencher South wall. A G. ...

RASBERRY  
 of 22 June

P845-72B

22 June 1984

This one, lower in the section. In the west face there is also a large rock at base corresponding to the upmost rock of PUDDLE.

2 rocks of RASPBERRY / SPURON? are exposed in the trench. ① Weston 42 long 25 high 26 deep  
② in section drawing 22-42 long.

The rocks behind / North of The big rocks, are well packed. Many are laid more flatly. Than appears in the section drawing. I think this is the South wall of the Str.

27 June

PLAN PTS. #52

P84-5-25

	Point	E	N10	DIST
1	52 B SW corner, NW extension	356° 15'	1242	2.60
2	NW corner NW ext	355° 0'	1378	8.55
3	NE corner North extension	8° 0'	1212	8.21
4	junct N ext + main trench	71° 15'	1258	6.33
5	NE corner main	21° 0'	1260	6.36
6	SE corner main	25° 15'	1276	5.50
7	junct South ext. + main	20° 45'	1277	5.23
8	junct S ext. + east ext. <sup>North</sup>	240° 15'	1298	4.46
9	NE corner east ext	32° 15'	1251	4.70
10	SE corner east ext	350° 45'	1318	4.26
11	junct east ext. + S ext, south	300°	1297	3.74
12	SE corner South ext	355° 15'	1361	2.97
13	SW corner SW extension	100°	1269	2.06
14	NW corner <del>SW</del> <sup>SW</sup> ext.	20° 45'	1235	2.52
15	SW ext. junction main	11° 45'	1209	2.97
16	CHOCOLATE + Trench	6° 30'	1269	2.69
17	corner CHOCOLATE + PLOCHA	240° 45'	1345	3.07
18	Enigmatic Rock south	26° 15'	1418	4.03
19	Enigmatic Rock North	16° 0'	1381	3.36
20	corner PLOCHA + VANILLA	60° 15'	1381	8.28
21	VANILLA + trench	359° 15'	1442	8.12
22	<del>junct. <sup>North</sup> Main trench NW CHOCOLATE and <sup>SW</sup> ext.</del>			
23	52 D junct main + NE extension	332° 30'	1514	7.78
24	NE ext, SE corner	347° 15'	1368	7.75
25	NE ext - NE corner	342° 30'	1629	8.70
26	North ext, NW corner	329° 15'	1838	9.41
27	N ext junct. of main	319° 30'	1708	7.57
28	Main trench NW corner	307° 45'	1968	8.78
29	main trench SW corner	303° 30'	1980	8.16
30	main trench junct. of S ext.	312° 15'	1664	6.47
31	S ext, SW corner	285° 30'	1800	4.78
32	S ext, SE	20° 45'		

P84-5-74

	POINT		€	FLID	DIST
33	S2 D SE ext, NE corner	11	306° 45'	1463	3.62
34	junct <del>Sext</del> + SE ext	12	300° 45'	1579	4.18
35	CHOCOLATE, not in trench	1	334° 45'	1884	2.84
36	CHOCOLATE + SE ext J2D	2	300° 45'	1435	3.68
37	CHOCOLATE + PEACH corner	3	298° 15'	1691	4.42
38	PEACH pushed out	4	309° 15'	1598	5.44
39	PEACH / VANILLA corner	5	330° 15'	1736	8.10
40	VANILLA + Trendy	6	342° 15'	1561	8.16
41	S2E Main SE corner	1	249° 15'	1623	2.16
42	main SW corner	2	245°	2021	4.70
43	Main NW corner	3	256° 45'	1982	4.79
44	junct main + Next	4	267° 45'	1778	3.17
45	Next NW corner	5	289°	1663	3.51
46	Next NE corner	6	244° 15'	1555	3.13
47	PECAN rock north	1	291° 45'	1531	3.23
48	PECAN rock south	2	261° 15'	1544	2.38
49	S2F N corner	1	∅		7.90
	E corner	2	167° 30'	1801	8.66
50	S corner	3	174° 15'	—	9.25
51	W corner	4	179° 30'	2031	9.18
52	S2C NW corner trenches	1	148° 30'	1362	11.11
53	NE corner	2	143° 30'	1194	11.72
54	SE corner	3	150° 30'	1764	14.33
55	SW corner	4	154° 15'	1826	14.14
56	FUDGE Feature south	1	149°	1901	13.29
57	FUDGE north	2	147° 30'	1882	12.64
58	RASBERRY East	3	145° 30'	1437	12.25
59	RASBERRY west	4	149° 30'	1524	11.58
60					
61					
62					
63					
64					

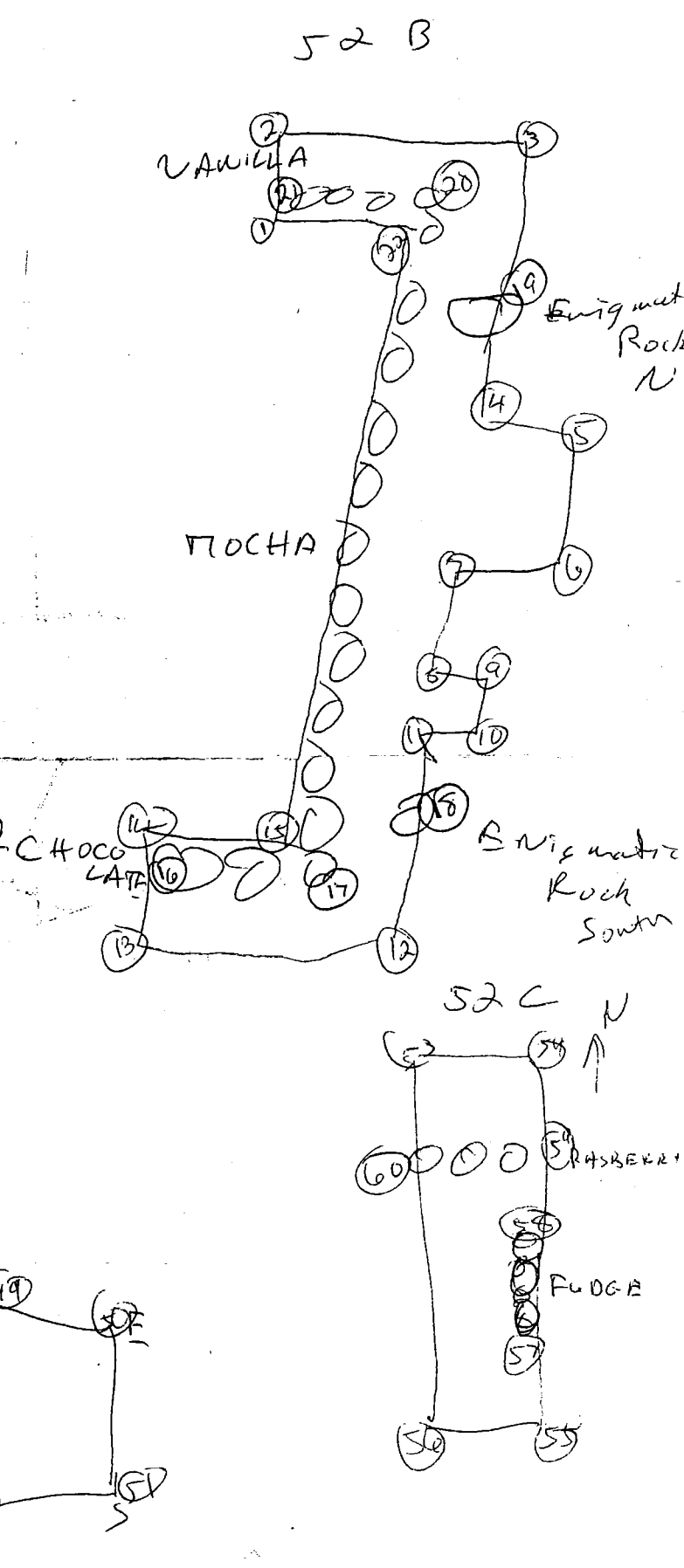
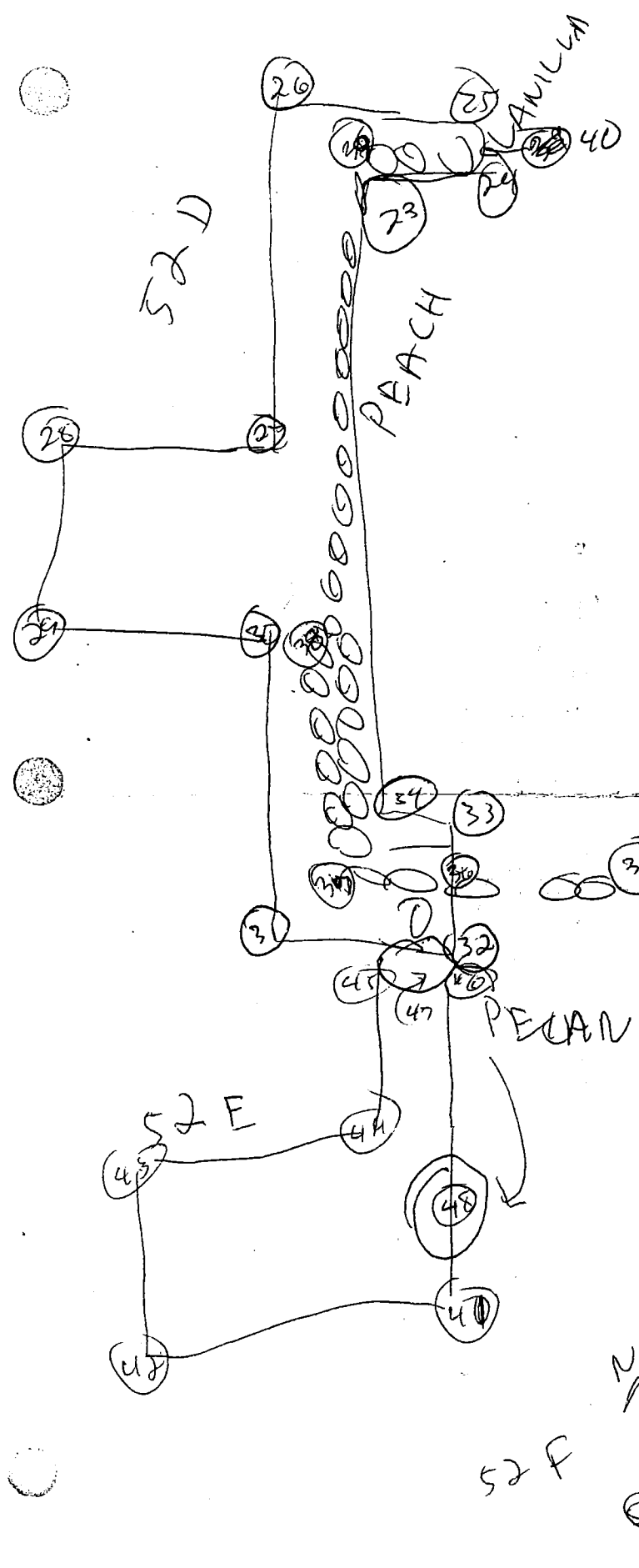

25 June 1984

P84-5-25

I am back out today, after being certain that I was through with excavations! The reasons are widespread illness. Wendy came home Sat. morning, and Ed had to go out and finish the morning. She's still sick with what seems to be the flu -- fever, chills, nausea, diarrhea, general weakness. Maria became ill Sat. night -- probably a continuation of her previous illness, exacerbated by working out in the sun. Fri. & Sat. w/o sufficient fluid or food intake. Sun. she fainted while bringing a soda from across the street, falling in front of the house. Her right hand is cut up, and there's even a stitch in one part. I cleaned her up and took her to the hospital. It should heal well, as most of the cuts are minor. Justine, while in San Pedro w/ Julie B, apparently got food poisoning, and is also ~~home~~ sick. The weekend was  $\therefore$  less than good.

Currently I am fighting off illness. I almost lost my breakfast earlier, and am still queasy. I have been trying to avoid outright diarrhea by taking Lomotil, but ~~they~~ don't think I'm going to succeed in that endeavor. Despite a good night's sleep and a nap yesterday, I am also very tired. So I'll try to make it through today, and maybe tomorrow w/o collapse.

I am "supervising" sites 25 & 26, but in reality Alec is on his own above, and Julie pretty much so here below at #26. I don't think I should walk up the hill -- I feel like the exertion would bring on a vomiting fit. Julie will go up at ca. 11:30 to see what Alec is up to, and to bring down the can. After lunch I may drive up, as the walk across the field is OK.

D84-5-26

23 June

especially w/o a pack - 8 Uamos a vend

We are short one workman today -- Balbino's brother has a bad sore on his hip,

#25 Alec Harris is in charge of [and I said he should go <sup>in to the</sup> hospital

#25 today. One of the small structures in the central group on the ridge, just north of the modern concrete well, was cleared. There are a few possible wall lines, so I have given Alec 3 men (Santos, Pedro, Mario) to do pits on either side of the str., the # of which I don't know. Each is 1m EW x 2m NS, designed to encounter terminal debris, and wall lines, if there are any.

#26

Julie Miller is in charge here, with some consultation from me. We have 2 pits on str. 8, on the east and south. The east pit may have hit a surface already.

The nice Late Cl. looking cluster along the edge has been very disturbed, probably by the bulldozer activity, so it looks as though little may be done there. More clearing is necessary to locate the features and small str. mapped last year. Excavation is going to be dictated by preservation, I'm afraid.

There is a nice path between the two sides. It begins above on the southwest end of the easternmost of the 3 ridge clusters, and goes right down to the southern side of #26's terrace.