Four Valleys Archive

Anthropology

1984

PSB-007-Ashmore-Field Notes-1984

Wendy Ashmore

Follow this and additional works at: <https://digital.kenyon.edu/honduras>



Part of the Archaeological Anthropology Commons

Recommended Citation

Ashmore, Wendy, "PSB-007-Ashmore-Field Notes-1984" (1984). *Four Valleys Archive*. Paper 92994.
<https://digital.kenyon.edu/honduras/92994>

This Field Notes is brought to you for free and open access by the Anthropology at Digital Kenyon: Research, Scholarship, and Creative Exchange. It has been accepted for inclusion in Four Valleys Archive by an authorized administrator of Digital Kenyon: Research, Scholarship, and Creative Exchange. For more information, please contact noltj@kenyon.edu.

June 21, Thursday

Spent all morning, until 11:30, trying to get our tourist cards renewed at Migración.

Went to Gualjocuito today to take over Wendy's excavations in Op. 3 while she goes to San Pedro Sula for today + tomorrow. She + Ed spent about 45 minutes showing me the ropes.

As I understand it, here's a sketch of what's going on in Op 3C (plan).

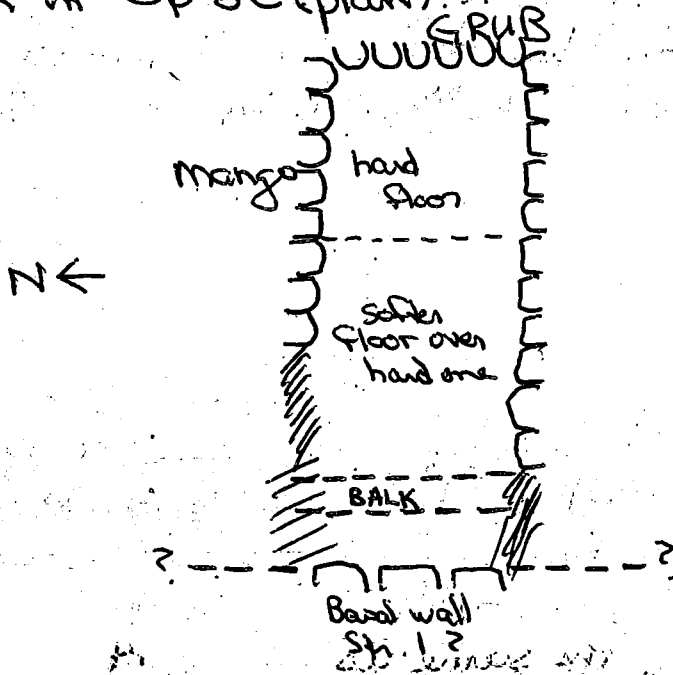

Two workmen worked on clearing + consolidating an area of fill south of mango wall to use as a step-up + out of the pit. The material they got from this is a continuation of lot 3C/9.

After they completed this, these same workmen worked on clearing-up MANGO wall.

The other 2 workmen seem to have exposed the basal retaining wall of Str. 1. They're trying now to locate the SW juncture between this wall + the south retaining wall in op 3C. There is a balk in this area that separates this from the rest of the trench. The material

shell, ceramics, obsidian, + bano quemado. We left the majority of the bano quemado intact.

Op. 3D, lot 5 is from clearing of the eastern end of Op. 3D. It's from approximately 4.40-5.60 m east of the western end of Op 3D. The area was already taken down below the level of MOP floor. I decided to include in lot 3D/5 all material between MOP floor + the next lower floor (the one on which CLEAN feature rests), but we didn't get too far. After going down about 10-15 cm. we temporarily suspended all work on Op 3D to switch all available labor back to Op 3C.

Op 3C had a lot of collapse to clean + all 4 workers spent the rest of the day clearing cobbles + bucket-carrying dirt out of Op 3C.

It appears that the proposed basal wall of Str. 1 rests over (on) the fill retained by MANGO + GRUB walls. So, Str. 1 was built after this fill episode raised the level of the plaza. I'm not even sure that we definitely have the basal wall of Str. 1 yet, but it's suggestive. We're clearing the South retaining wall area at its west end down to the level of the soft + hard plaster floor. It seems as though the plaster floor ends some 6 m to the east, however. It's hard to say for sure now, because there's so much going on in the trench today (so much dirt + so many cobbles all over the place).

Sketch profile of south, west + north faces of trench. ... Possible basal wall of Str. 1

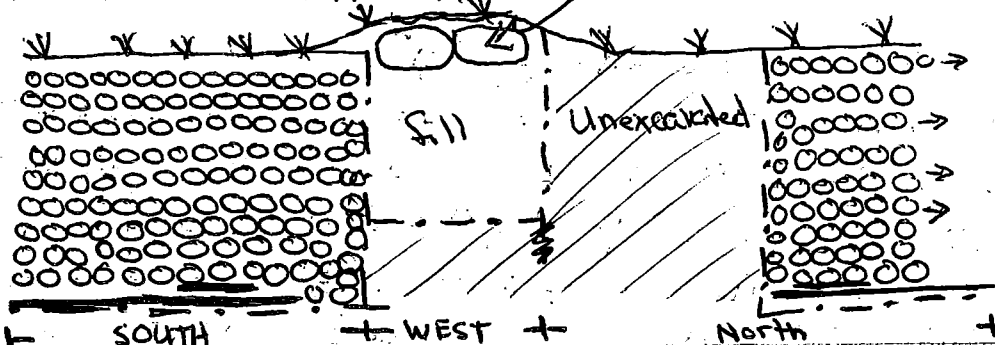

5/20

PSB

May 20 (Sunday)

Arrived with Justine and Julie at midday. One piece of Julie's luggage got bumped (plane was overweight — we had 4 pcs overweight aboard...); promised for tomorrow. All else came through all right.

Rented Bly van — seems "ok", tho' rearview mirror is busted (cracked) and no side mirrors, and no emergency brake.

Tegucigalpa seems quiet/normal. Staying at Marichal - Rms 114 (~~and~~ J&J) & 211 (me). Made reservations for Ed, Pat et al for Thursday. Parked van at IASH with guard's permission.

Meeting with Ricardo tomorrow at 8:30.

May 21 (Monday)

Noisy night (from street); poor (intermittent) sleep. Same for Julie & Justine.

To Instituto — spoke with Ricardo: he was understandably preoccupied with news story that had broken yesterday (2 page spread in La Prensa) accusing George Haseman & Ken Huth of looking at Salomon — terrible scandal. The story, ~~but~~ ^{and} utterly untrue. Will combat immediately.

Re: PSB: welcomed back. Drafted contract (essentially identical to 1983, but Texcon specified at outset & Gap I excavation specifically described) and Ed can sign on Friday. Returned artifacts and got a receipt (shells still awaited — hopefully they will have reached Ed from Feldman & he can bring down; otherwise, Ricardo said we could request an extension) Handed over Negatives PSB 83-1/146 and descriptions for PSB 83-1/208 (Ed & Pat bringing the rest of the negatives, artifact shots). All 6 staff will get credentials, so we got photos for Julie & Justine and typed up vtrac at the Instituto.

P84-7-3

5/22

PSB

May 22 (Tuesday) - called Ed from Honduras
Picked up credentials at HATT (Julie's, Justin's, &
mine) and then got Land Cruiser from Molinari.
Seems in ok shape except (1) hand brake is useless (as
in the van), (2) right hood lock unreliable, (3) some
squeak that occurs intermittently (when car is hot?),
and - as we only discovered by being stopped at
the military checkpoint just north of Teguc -
lacks front license plate. Will check this at Molinari
in SPS.

Ricardo heard back from the bank: our account
was transferred to San Pedro and then cancelled
for having less than L 2! A large deposit (L 500
according to Ricardo) was deposited and withdrawn -
presumably the deposit we were expecting from
John's mother - must pursue further with
Sr. ~~Ricardo~~ Gustavo Lanza (rec. por Sr. Raul Zelaya
in Teguc) of SPS Banco Atlantida.

Stopped 1 1/2 hours in Comayagua (left Teguc
~ 1 pm), saw Deanie & Foncho & the Museo lab.
Collected PSB cooler & maps left in 1983 with
Hassmanns. Arrived San Pedro at ~ 7, staying
at Hotel Columbia. Tiring day, but generally
went well.

May 23 (Wednesday)

Called Pat to report on car, Comayagua pick-up,
and bank and asked her to call Haighs.

Got makeshift ^{front} license plate from Molinari, and talked
to Gustavo Lanza at Banco Atlantida. The money from
Mrs. Haigh is in Tegucgalpa and was just sent there for
lack of activity on the account. Sr. Lanza will look
into it and will advise SB gerencia to allow us to
reopen our account.

PSB
184-7-5
5/25-26

May 26 (Saturday)

Friday & Saturday both hectic, even at a slow pace. Rained heavily from 7 pm Fri night for about 6 hours (at least), so temperature cooler Saturday (86° in early afternoon).

House we'd taken began to be fixed up (new toilet seat, shower valve, new sink, etc) but by mid-day Saturday the water shortage problem there became all too clear. Fortunately the dueño understood the problem and released us from our verbal contract - bless him. So we got (were fortunate to get) another house which we are told we can occupy on Sunday at noon, won't handle 18 people, but maybe 12, and has better water & space allocation (outside & inside) + a kitchen (no appliances, but sink, and the other had had none).

* off duty from
ca 7 am to
ca 9 pm

Exhaustion. None of us is eating much. Thank heavens for Jorden & Bob & John & Mary of the Peace Corps, for putting us up and helping us keep body & soul together. And thank goodness for Pedro and Eva and their endless help, without which we would be homeless.

May 27 (Sunday)

Moved to new house and Pat, Ed et al arrived - we are now 10 (besides P & E, new arrivals were: Aelika, Kathleen McLaren, Allison, Maria, Sylvia). Infestation of swarming termites, but otherwise conditions seem fine for this size group. Still need a 2nd house.

May 28 (Monday)

met with Governor (news from last year - don't know his name yet) and Mayor (Roman Mejía again), and migración officer. Got bank account re-opened, with Sylvia added to us 3 as signator.

PSB

P84-7-7

5/31-6/2

Problems: overheats (Ed's hand got burned from steam & boiling water trying to add water to coolant container), brake low, back door spring (never would lock), tire rack keeps dropping (under car), and battery won't hold a charge for more than an hour.

After brief respite for Ed, he, Maria (who needs cholera booster), Mary/Bob (Peace Corps) and I left for San Pedro to get car fixed, pick up students & buy supplies. Car died in mid-quebrada (nearly dry) for no apparent reason, & heat on engine got high but not to danger point. Otherwise, besides the tire rack falling several times, trip was uneventful. Reached San Pedro about 6; stayed at Colombia.

June 1 (Friday)

Took car to Blitz to be fixed. Changed Justine's & my departure from Teguc 7/9 to San Pedro 7/9, still Air Florida. Discovered AF now flies only Mon, Wed, Sat, Sun, so cabled Julie to ask if she wanted her reservation (Fri 7/13) changed to Wed or Sat. Spoke to a public information officer at Banco Atlantida (hangar out of town): he advised us to deal through Santa Barbara office to recover our L598 from Teguc. Arranged students' Copan trip. Maria couldn't get booster; returned SB on bus.

Students arrived (~~7~~): Brenda^{Rahne}, Julie Miller, Earl Sussell, Jeff Hendricks, Alex Harris, Alex Pezzati, Colleen Murray. Some luggage didn't. All at Colombia.

June 2 (Saturday)

Bought supplies and groceries. Students (all but Earl & Brenda) went to SB on 1 pm bus. Brenda's missing luggage won't arrive till Sunday, so still meet Gene (Olevsky), whose plane (per cable rec'd ~~5/31~~ 5/31) will arrive then too - they'll come on bus to SB ~~Monday~~.

PSS
P84-7-9
6/4-

84-7-B3/4 Str 12 & playa from ridge
B5/6 Group III & Strs "16" & 24

Rainstorm ca 7 - power out. Brenda got lost trying to walk home alone from Alaska this 1st day here. Anxious moments, but she found Place Corps house by good chance, and Mary walked her home.

Rained long & hard - power resumed ca 10 pm though and water never went out. This time...

June 5 (Tuesday)

Arrived Gualjoquito ca 7⁴⁵ a.m. - divided the 17 workmen between Pat & me; she went up to small-sites area and Ed walked off to begin survey north of Gualjoquito site. He & I first spoke with Gustavo Miranda, jefe de construcción on this section of the road. He seemed to have no problem (i.e., said there would be none) with our excavating in the 10G area; he'll ask the machine-crew chief to stop & talk with us. It'll be interesting (if sad) to watch the roadwork while we're here.

85° at 9²⁰ - clear & muggy

Justine will be in charge of collateral fan excavations (under my supervision), I will do 10G ~~and~~ (Op 6) and she'll work with me on Group I (Op 3C).

Got her started on Ops 12A and 12B. Former is a 1x2 m pit perpendicular to and 1 m west of fence at base of ridge east of site. Op 12B is a 1x2 m pit ca 10 m west of that, and about 1/2 way to Str. 12. Took photos

84-7-B7/8 Ops 12A & 12B from SE at onset
(Justine & Emilio are in the picture)

Emilio is making ⁴/₂ meter sticks for us.

12A: Jaime & Reyno

12B: Eliberto & Juan Miguel

Took photos 84-7-B 9/10 Op 3C from Str 3 at onset (reopening 3A)

11/12 Op 12 area from Str 3 at onset, to show fan slope

PSB
P84-7-11
6/5-6

In Str 1: sketch perspective from NE

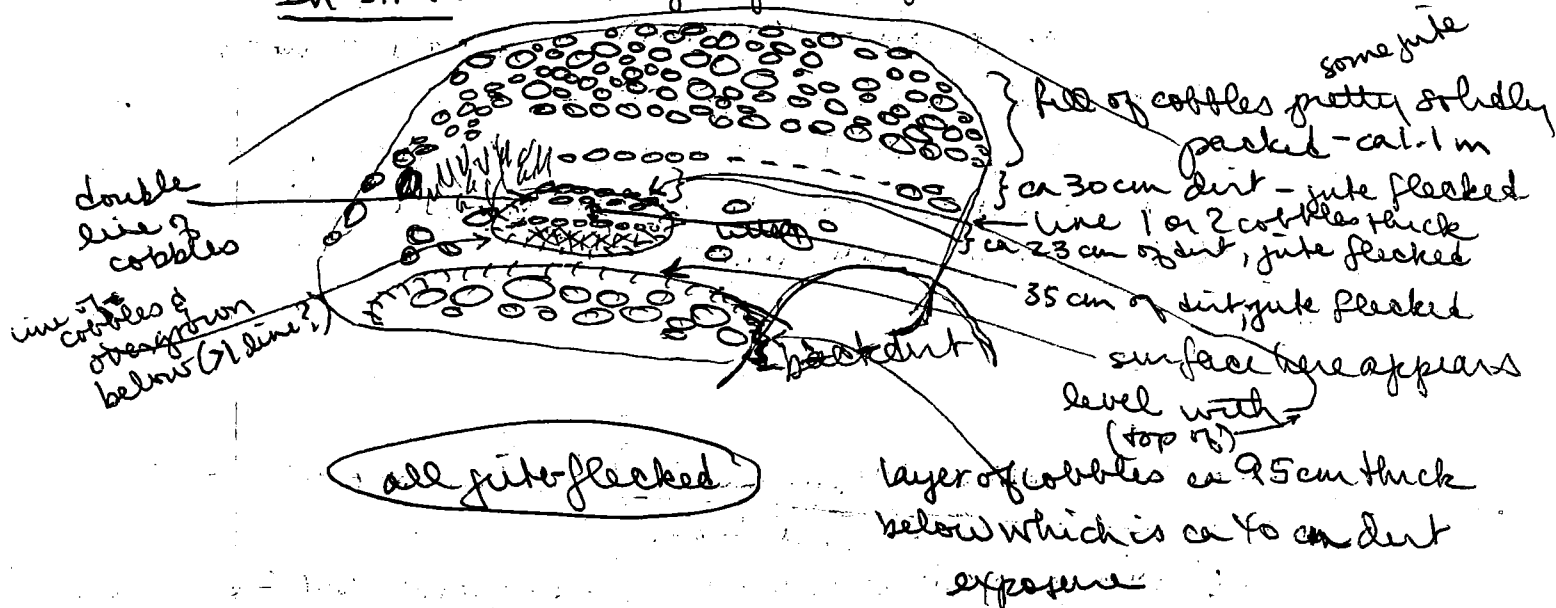

3C/2 lot 3C/2 is materials in cobble fill in extension west of 3A - for 1st 4.6 m west, ~~nothing so far~~ now a dozen or so jutes & 3-4 sherds

3C/3 lot 3C/3 is materials from backdirt of illicit excavation into str 1 - backdirt & cobbles being cleared are those just NE of the big gaping hole

June 6 (Wednesday)

Arrived at Gualjoquito at 7³⁰ - already 85° (tends to 80° in the house at night) and ~~to~~ slight dewy haze burning off. No rain here or in SB last night, save a light sprinkle

Justine back on 12A/12B

Parents will begin flotation today

given 1 lot from 3C (lot 3C/2) and 1 from 12A & B (Justine to decide)

PSB
PS4-7-13
6/6

but angles in (constructs gradually) on "right"
(positions with reference to sketch)

cut block in 3C/2 fill - just chucked in like the cobbles

26 cm deep

13 cm high

length of face ~~not yet~~ measurable 35 cm

took photos 8/7-C5/6 interior of stone "mortar" } scale 35 cm

7/8 top/mouth of stone "mortar" }

9/10 Op 3C - view of south retaining wall, ^{from east}

11/12 Op 3C block in fill, scale 35 cm

! ~~at 99-100°~~ 99-100° at 155

3C/4 breaking lot 3C/2 laterally at 7.8 m west of SE corner
of 3A excavation

to far - several sherds, including a well preserved
Ultra Polychrome rim

if some of this fill-inclusion material has tumbled
down from use contexts into the dry-laid fill,
perhaps there will be some noticeable difference
in contents as we near Str. 1. Certainly the materials
from the cobble fill of 3C are more numerous
than from 3A area's fill

marked lot limits on stones in south elevation
reaching 10m trench length

unfortunately the retaining wall is becoming more
nebulous - either it's receded southward into the section
or it's stopped (the best candidate for a corner
or edge is not yet totally convincing - it's at 9.6 m
west, but if it's a corner it has some odd semi-interdigitation
with other fill to west) - wall may yet continue

$$+ EV = I.H. + (SINE \alpha \times DIST. - mid-HAIR)$$

$$- EV = I.H. - (SINE \alpha \times DIST. + mid-HAIR)$$

PSB
P847-15
6/7

Transit points

Station	HI	Elev	Mid hair	Lower	Upper	Distance	Δ
TX1	1.475						73°
1. BS to datum			0.855	0.791	0.920	12.9	339°54'
+ 1° 45'			0.82	0.497	1.045		339°54'
+ 1°			1.100	0.790	1.412		327°15'
—			1.545	1.209	1.881		310°9'
+ 3°			0.600	0.882	0.321		170°57'
+ 1°			0.150	0.090	0.260		92°50'
—			0.561	0.454	0.670		19°54'
—			1.831	1.717	1.947		240°20'
9. TX2	1.40 HI						
—			1.505	1.415	1.597		128°32'
+ 3° 30'			0.200	0.139	0.261	12.71	174°46'
—			0.506	0.448	0.563	11.56	189°55'
+ 4° 50'			0.200	0.134	0.267	13.27	200°48'
+ 5° 30'			0.200	0.143	0.258	11.5	217°24'
TX3	HI 1.325						
—			1.288	1.262	1.307		151°25'
—			2.719	2.692	2.748		116°23'
—			1.688	1.648	1.728		112°53'
—			3.562	3.458	3.568		102°18'
—			4.295	4.241	4.358		102°55'

2A found metal fragment ~~in~~ on surface in opening between str 2 and 3, SE corner of Group I — will get next 2A set lot/cat #
2A/41-1

Q

Distance = $\cos \angle \times$ distance read
 Elev: upslope: $HI + (\sin \angle \times \text{dist} - \text{mid-hair})$
 downslope: $HI - (\sin \angle \times \text{dist} + \text{mid-hair})$

Calculating distances & elevations from points on P84-7-15:

	Datum = 160 m	Elev	Distance
1. BS to Datum		<u>160.855</u>	
2. (ground at T1 therefore: 159.38)			12.9 m
3. Op 12A SE corner	162.01		(64.8)
			64.77
3. Op 12B SE corner	160.84		(62.2)
			62.19
4. Point west of 12B	159.31		(67.2)
			67.2
5. To T2	163.18 ¹⁹ 18686		(56.1)
			56.02
6. fence point #1	160.224		22
7. fence point #1	160.294		21.6
<u>6. fence point #1</u>	161.09		(22)
			(21.996)
8. Point west of datum	159.024		22.7
9. T2: HI = 1.40		<u>164.59</u>	
10. SE corner Op 3A	163.08		18.2
11. to top of water's spoil	165.13		(12.2)
			12.18 12.18
12. saddle between T & Str. 1	164.084		11.56
13. Summit, Str. 1	165.50		(13.3)
south of 3C alignment			13.25
14. T3	165.49		(11.5)
T3: HI = 1.325		<u>166.81</u>	11.44
15. to #13	165.52		3.5
16. to #12	164.091		5.6
17. to #11	165.122		8.0
18. to top of GRUB wall	163.298		11.0 11.0
19. point on ^{south} wall	162.515		10.7

Ground elev at Sta T2 = 163.10

(stone)
ground elev at T3 =
165.485

PSB

P84-7-19

6/9-10¹¹

— though so will refer to them as south (north-facing) and east (west-facing) walls for now

MANGO is 3.35 m north of SOUTH at top of preserved height, both angle inward as they go down

3C/7 new lot to incorporate materials west of EAST wall and up to 1 m ~~west~~ south (measured at wall top) of MANGO wall — so far a metal fragment and shreds (1-2 gite)

Pat's workmen completed backfilling and arrived at Igualquinta ca 10⁰⁰ — put to moving 3C stones & backdirt (of west end of trench) ~ 5m to north

3C/8 backdirt lot (from west end of trench — from ca. 1.5m ~~east~~ of GRUB & thence westward — mix of lots 3C/3, 5 and 6)

fill west of GRUB has been consistently better packed than that to east — consistent with establishment of pen bounded by well set units on four sides, which pen then filled more loosely with cobbles

paid Pat's workers

one (Baldino) has sick wife & will be absent Monday but will send his brother, Juan Pablo, in his place

June 10 (Monday)

85° at 8⁰⁰; 90° at 8⁴⁰ — ^{recast &} muggy — rained yesterday here & SB

Went to Copan Saturday afternoon to see the ruins since latest exc & restoration — while there, saw a

PSB
PS4-7-21
6/10/11

took Jaime & Reyno to Str 1 while Justine & Brenda are drawing.

3D:

Began them clearing back (to north) the part of the Str. 1 looter pit that will link to 3C section - new Op # since cuts will be contiguous but not continuous
took photos St-7-E 7/8 of beginning Op 3D, a 2.9m cut on north side of looter pit

3C/D

ADOBE: small chunks in 3D/1 (loose) and in 3C/9 - debris from Str. 1 superstructure - 1st? - 2nd?
1 piece from 3C/9 has a flat surface & on adjacent side, a single pole impression 1.5cm diameter

(6cm long)



~~3D/43~~

large footed-cylinder, sherd from surface ^(basal break w/ footscar) ~~west~~ of looter pit on summit of Str 1 - save for ceramic analysis use (large sherds are all too rare)

3C/9 - piece of polished blackware bowl with incised design



SURPRISE! GRUB wall turns a rounded corner to run east as MANGO! in area of 3C/9 cut (1st - since 3C/9 is now continuing east to reach 3C/7), MANGO alignment is 3.5m north of SOUTH wall

PSB
P84-7-23
6/12

3C/9 picking up more adobe, another metal fragment
& sherds

fence around SW & southern part of site (east of road)
is being wired today (fenceposts went in 6/9 - see P18)
- they've left no formal gate, as such, but last
length of wire at east end of north side is not firmly
attached & can be moved

12C

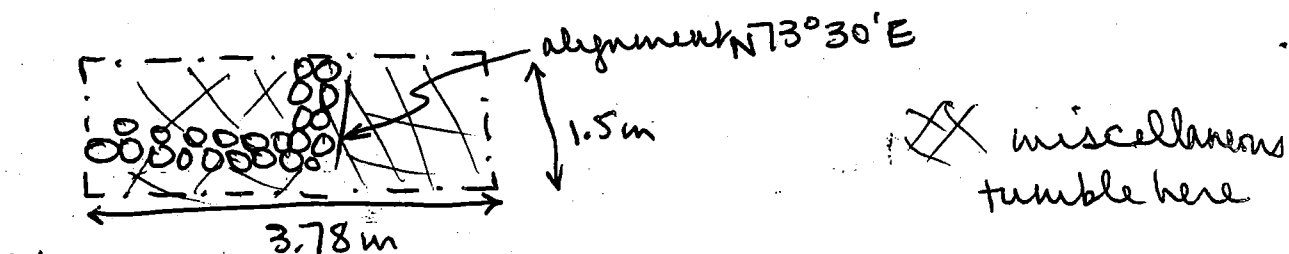

N
←

took photos 84-7-E11/12 of 12C from SW, scale $\frac{1}{50}$
84-7-F1/2 of 12C, southern
wall from west, scale $\frac{1}{5}$

Justine is having them expand 3.06 m east for
southernmost 1.98 m, to trace wall

12B reaching 2.8 m depth, which puts them at 158 m
(approx) elevation & thus at or below Late Classic
plate level west of Str. 12 - will halt this today &
move ~~the~~ Juan & Eliberto elsewhere

3C/9 some particularly large fill stones (too heavy for 1 man
to lift out (all are cobble/boulders))

38 x 24 x 25 cm

37 x 35 x 30 cm

53 x 22 x 40 cm

41 x 46 x 30 cm

54 x 28 x 36 cm

(brief heavy)

rain halted transit work^(etc) at 10³⁰ but we began work again before 11⁰⁰

12C Jaime & Reyno have cleared a lovely but inconclusive cobble array

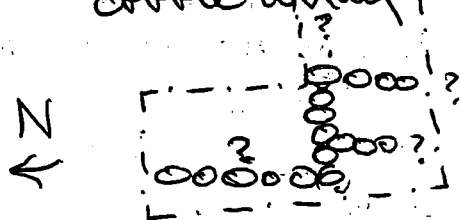

(tumble between putative lines - all within 20 cm of surface in

3C still ~~clearing~~ cutting down to SOFT floor in fill at all wall corners (EAST/SOUTH, MANGO/EAST, GRUB-MANGO)

3D Juan and Eliberto moved to here - taking down looter-pit southern exposure -

got a burned clay floor - MOP

Brenda & Justine worked on trowelling

3D/2 material within 10 cm of surface of MOP - most is really from within 5 cm - includes at least 1 plumbate sherd that was well enough back in the cut so as to be surely not recently intrusive (i.e., near ^{original} looter-pit exposure)

took photos 84-7-F3/4 of Brenda trowelling MOP

Rain began again ca 1³⁰ and didn't let up, so we all left ca 2 - DRAT!

(at least can catch up on paperwork at home)

June 14 (Thursday)

RAINED ALL NIGHT stopping only ca 6³⁰ a.m.

Excavations (mine & Pat's) postponed to drain & dry

& will do lab work at home

at Huallajunto, workers are to make a gate in fence

10¹⁰: cloudy but thus far no rain
3D Justine trowelling MOP floor for photo

3C got carbon sample in 3C/9

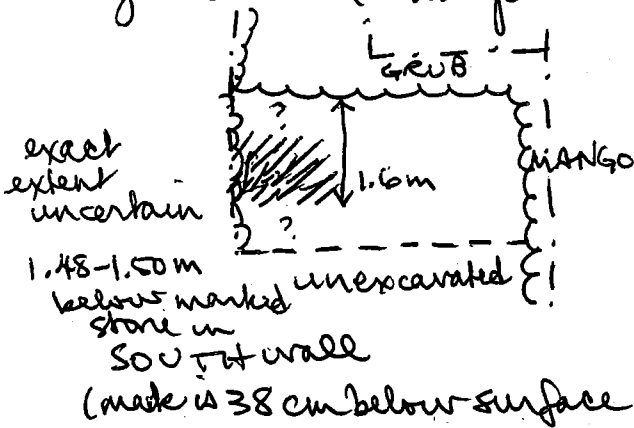

diffuse, flecks of varying size

3C/7 yielded no sherds today yet but a well fired piece of either floor (most likely) or wall - in ALL, base - Justine's finding a couple of similar pieces in 3D trowelling/cleaning (not part of MOP though)

3C/10 removing lowest 20 cm, at base of 3C/7, overlying SOFT floor - none of the material seems to be sitting on the floor but the lot is ^{more} densely (relatively) packed with "stuff" - including ^{an} inverted fragment (now further broken) of a gray (burned) floor also - center frag

3C/9 the charcoal noted above seems to be a cap (not more than 2cm thick) distributed around and overlapping what appears to be some of the same material as in SOFT floor

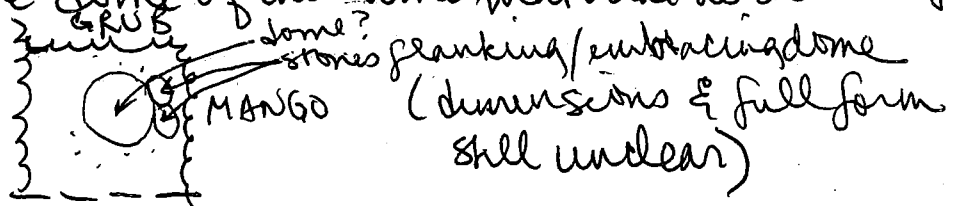

PSB
P84-7-29
6/15-16

took photos 04-7-97/8

CRUMB & SOFT floors with GRUB & MANGRO
walls, from SE, scale 50cm

note discontinuity in distrib of CRUMB
& large stones (somewhat too rectified by workmen - my
fault)
along wall edges, not completely cleaned (but
given time - 3:55 - I took the photos) looks
like SOUTH & possibly MANGRO walls do not
sit directly on either CRUMB or SOFT

Poss interp of CRUMB; SOFT was broken through
at some place beyond 3c exc limits & the
dirt & CRUMB are redeposited from pit dug
thru SOFT. If so - where's the pit &
what's in it?

3C/11 took a flotation sample from the dirt in area of
white CRUMB discontinuity (see sketch on P28)

June 16 (Saturday)

Rain at night, some collapse of loose rubble
83° at 7:50 - cloudy but looks to clear

yesterday, Justine & I were here alone w/ workmen -
today Julie M (for soil testing), Brenda (for
flour & flotation), Sylvia, Allison & Alec
have joined us

The latter three drew a 1:10 plan of extent &
placement of resurfacing at east end of 3c

Justine was shovel-clearing MOP floor to west,
and uncovered a 2-cobble-high step up
("bench") with its own earthen surface
at top ← "NEAT"

PSB
 P84-7-31
 6/18

Slope	T/HI	Elev	Mid	Upper	Lower	Distance	Δ
	T3 HI: 1.365	166.85	2.532			11.4m	
✓	1. SE CORNER WATERPIT	164.318	2.532	2.595	2.481	11.4m	145° 50'
✓	2. NE " " "	164.26	2.590	2.630	2.551	7.9 m	131°
✓	3. REAR BENCH (edge)	164.358	2.492	2.528	2.468	6.0m	180° 30' 30'
✓	4. GROUND FLOOR	164.161	2.689	2.725	2.671	5.4m	164° 5'
✓	5. JUNCTION GRUB & SOUTH	163.233	3.617	3.552	3.661	10.9m	104° 30'
✓	6. 3C/1-1/2	163.019	3.831	3.750	3.925	17.5m	90° 35'
✓	7. SE CORNER 3C	163.075	3.775	3.883	3.880	21.3 m	96° 3'
✓	8. JUNCTION S&E WALLS	162.868	3.982	4.091	3.879	21.2m	95° 6'
✓	9. JUNCTION MANGOGE WALLS	162.92	3.930	4.031	3.825	20.6m	86° 30'
✓	10. NE CORNER 3C	163.111	3.739	3.842	3.633	20.9 m	86° 11'
✓	11. 3C1 - 3C2	163.144	3.706	3.613	3.798	18.5 m	85° 46'
↓ \$.30	12. Junct. 3E1 - 3E1	162.245	4.45	4.54	4.362	17.799 m (17.8 m)	91° 15'
✓	13. SE CORNER ST5	163.555	3.295	3.443	3.144	29.9 m	69° 19'
✓	14. SW CORNER ST5	163.828	3.022	3.089	2.955	13.4 m	64°
↓ 2° 30'	15. NW CORNER ST5	161.491	4.400	4.515	4.293	22.0 m	14°
✓	16. NE CORNER ST1	162.917	3.933	3.997	3.871	12.6 m	23° 40'
✓	17. SW CORNER lot pit ST5	165.452	1.898	1.494	1.303	19.1 m	50° 37'
✓	18. N side lot pit ST5	165.528	1.322	1.419	1.235	18.4 m	45° 25'
✓	19. N side lot pit ST5	165.844	1.006	1.120	0.893	22.7 m	40°
✓	20. N side lot pit ST5	165.989	0.861	0.990	0.733	25.7 m	43° 35'
✓	21. NE corner lot pit ST5	165.364	1.486	1.639	1.332	30.7 m	48° 30'
✓	22. E side lot pit ST5	165.368	1.482	1.638	1.332	30.6 m	52° 10'
✓	23. SE corner lot pit ST5	165.54	1.310	1.454	1.164	29.0 m	56°
✓	24. South side lot pit ST5	166.28	0.570	0.705	0.44	26.5 m	56° 17'
	25 " " " "	165.856	0.994	0.870	1.021	15.1 m	59°
	26 " " " "	165.398	1.452	1.572	1.338	23.4 m	54°

Check
 1/2" step
 down

P8B
P84-7-33
6/19

June 19 (Tuesday)

no rain here or SB at night - cloudy/sun alternating

Morning began slowly - 12C new Northward extension

6A - Alex at 30cm

3C - cutting west past GLOB

3D - heath?? - Brenda cleaning -
at lower floor level in Str. 11

4C bulldozers cutting Str 24 - we went to document - someone began finding pieces of

photos 84-7-15/12

4C/3 flotation sample from inside
4C/2 shreds etc from outside

4C/4 shreds etc from Str 24 - includes C14 sample from

4C/5 " " " " 23 amid rocks (fill) at/below bulldozer scrape level

draw D84-7-3 1:10 plan of vessel mouth

took photos 84-7-J1/2 of mouth of jar in place scale 10cm

then found 2 spondylus shells ca 10cm from preserved top

cleared, added to drawing &

took photos 84-7-J3/4 of spondylus

Scale 35cm

2 more spondylus ← cloud set just at surface - ca 65cm west
con Brunton alignment 57° W

(same alignment; 15.86m to fence (post marked)

by Str. 15 - for later transit plotting)

3D/3

took photos 84-7-J5/6 of heath(?) (35cm) - "CLEAN" heath

scale readable NEAT MOP

shreds from travelling here

is material in fill in the

86-90cm between CLEAN & MOP

(2.1m EW x 80cm N/S)



Special Deposit 5

but then a reporter arrived from El Tiempo, a paper in San Pedro. Per our contract (which I read to him) I could give him no information, but Emilio gave them ^(him & photo) an interview & a brief site tour

June 20 (Wednesday)
8⁴⁰ at 8²⁵

Heavy storm with gusty high winds (piece of our patio roof blew down) in SB and heavy rain here as well.

Abgdo Navas is going to Arenales to see if he can get local teachers to postpone the hour of classes enough to solve the dilemma (which arose Monday) of our workmen having to leave at 3 to make it to class on time. (they are fined if they don't attend)

6A down ca 60cm - very muddy, but little standing water matrix yesterday began getting sandier
12C lots of standing water in ~~SE~~ SW corner

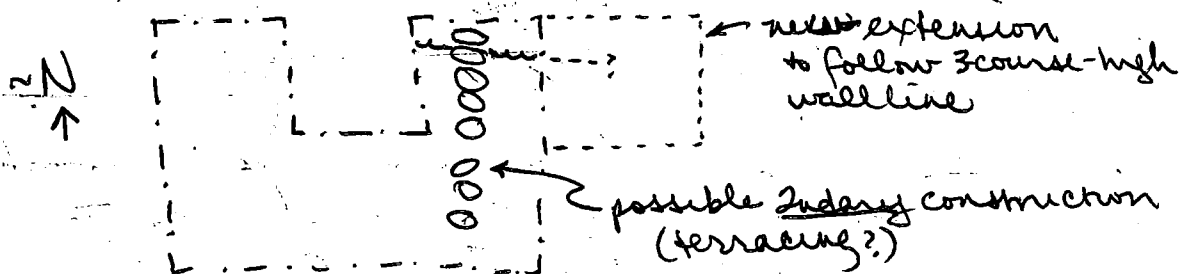

3D suspended

(west of)

3C some collapse - still taking down at E behind GRUB wall

4C Brenda flushing vessel interior sample (4C/3)
lots of tiny bones (burrowers?)

3C ^{from yesterday, before all pulled to 4C} they say the floor ends west of GRUB wall, but full the collapse is cleared, don't know if cut or peters out

west of the SE corner of the fill retaining
per. (rough measurement) the soft white floor
continues further to the west, perhaps another
0.50m - under per surface. As for the putative
east floor edge - only exposed adjacent to the
S. retaining wall.

Workers cleared back apparent buried
area late this afternoon. Really dispersed,
scattered burning - nothing extensive like
antennae tubes like a beehive but scattered
over a rather broad area. Currently measure
1.40m N-S x 3.20m E-W over the
exposed portion - probably continues further
N. under rock fill + further to the
W. under the unexcavated portion of the
trench to the S. Workers have apparently
pried some away to the surface in
currently uneven - should work at
trench; all of this push to get up true
level - base of S. retaining wall - base of
excavation, some quite large. Does not
look like fill - cache?

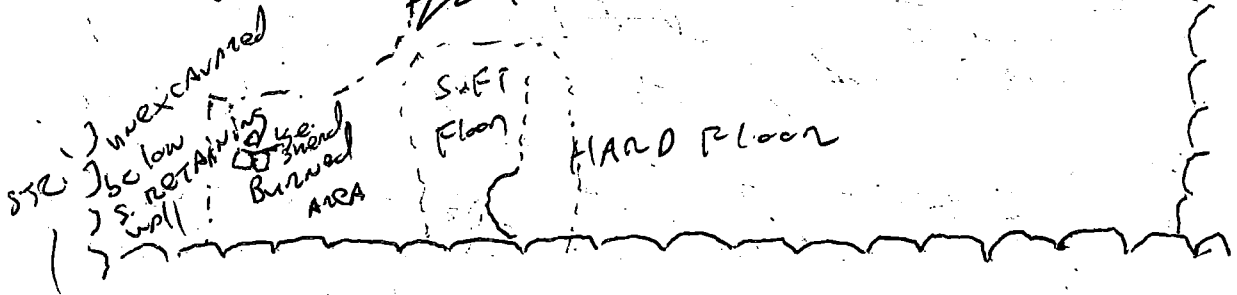

3C/17 Large shard - 3 pieces actually - 0.54 m
N. of S. retaining wall, 1.00m west
of hard floor edge + ca. 0.5-2 mm below wall
base. Embedded in burned area.

P 84 - 7-39

6/25

how do you

Yes, I'm starting a new page, think I get so many into pages.

3C - Juan + fore Estevan are following the burial wall of the 1 for ca. 0.75 m northward to try + reveal more of its extent, ensure the area available for plan, and try to ensure that something of it survives in sector - assuming they don't rip it out first. Continuation of Defied on lot 3C/14.

3C/18

3C/18 - continued found in clearing off the burial wall of the 1 to the north, on area of 1.00 m N-S. x 1.00 m E-W. x 1.40 m deep to apparent base of wall and 0.90 m below fill.

Juan + Estevan are cleaning loose earth + water out of the pit in the west end in preparation for taking out the last segment of earth here down to the level of the hard white plaster floor. Continuation of lot 3C/14. After this, should clear off area of presumed burning to judge its extent, if there is time. All preparatory to cutting down.

Rained quite a bit out here yesterday - quite muddy + the area is very up over Saturday afternoon.

12C - Juan + Renee - still searching for the SE corner of the 34. "Four short" clearing back to the north by the presumed SW corner to determine if there is one + where it is - how does ever resolve. Continuation of lots 12C/11 on the west + 12C/13 on the east.

6A - still going down in 2 E + W. 1 x 2 m with Andy's supervision. Ca. 1.50 m deep now.

PSS
P84-7-41
6/25

and the trench walls were hard-labeled + very difficult to travel. Skin stuff done pretty hard. As a result, I traveled down there where that were still pretty soft - the N5, S5, + SW corner + used them as guides for ~~recognizing~~ recognizing the stratigraphy here, which was then traced over the remainder of the sector. S4e south wall very, in general, better + clearer than the east. East + south walls drawn to conform to picture in drawing of Op. 12A.

12C - S4e S5 corner looks pretty clear now after additional clearing. Payne + Pioneer are just about picked clearing down S. of the east str. wall to see if the apparent stone "pavement" found beneath the str. is apparent S5 corner continues here. at present it looks as though this "surface" runs west + steps over with the part of the S. str. wall. S4e search for the SW corner continues - seems to have picked up a rather pavement of cobbles in the SW corner area. Only 1 worker working here today, so things are moving a bit slowly.

6A Alex has a good portion of a jar covered out at ca. 1.50 m right in the west trench wall - seems to have had gutter + lower part. Clearing out the level for a photograph.

P84-7-43

6/25

crab, claw fragments, shell, stems, charcoal flecks,
put, look into the "middle" soil as I remember it.
a trash pit from the Prethumic level? Someone's grave
good with the body to the west? have been seen stick
to at least 1 large "shard".

84-7-K-1 - GA, BASAL PIT, looking west.

84-7-K-2 - SAME

84-7-K-3 - SAME

84-7-K-4 - SAME.

84-7-K-5 - EAST extension, S. wall, STR. 34, op. 12c,
looking NORTH, showing relationship of wall to presumed
lower pavement.

84-7-K-6 - SAME

84-7-K-7 - EAST extension, S. wall, STR. 34, op. 12c,
looking EAST along wall to show relationship of upper wall
to "pavement."

84-7-K-8 - SAME

84-7-K-9 - Op. 12c, STR. 34, Line of tilted stones
running N.-S. from EAST.

84-7-K-10 - SAME

84-7-K-11 - Junction of Line of tilted stones +
EAST wall of extension of S. wall of STR. 34, op. 12c,
from SE.

84-7-K-12 - SAME.

In all of the above the meter stick (scale
was at 0.5m and the chalkboard was merely
copied.

84-7-L-1 - SE corner of S. wall, STR. 34, op. 12c,
from EAST. Meter stick at 0.5m, NO CHALK BOARD.

84-7-L-2 - SAME.

sort of like rhyolite (per 9 m. 1931? track of building material? - just a week job?)

also took a picture of the line of tilted stones which run N.-S. from the S. wall of the 34 - there, I suppose, can now be partially removed to search for the beautiful wall which lies within.

12c/3 - addition to the east extension lot - mostly (especially, let's be honest) "adobe" fragments.

12c/4 - East extension, ^{then} below the line of the S. the 34 wall to the cobble pavement, 0.29 m from line of wall to line of separation, from SE corner to line of tilted stones.

89-7-L-3 - putative earlier construction, op. 3c showing full below level, final the 1 wall shown behind, from east. Meter at 0.50m, no chalk board.

89-7-L-4 - same.

89-7-L-5 - putative earlier construction, op. 3c, showing line of S. retaining wall rising over the earlier str.'s summit, from the N, meter at 0.50m, no chalk board.

89-7-L-6 - same.

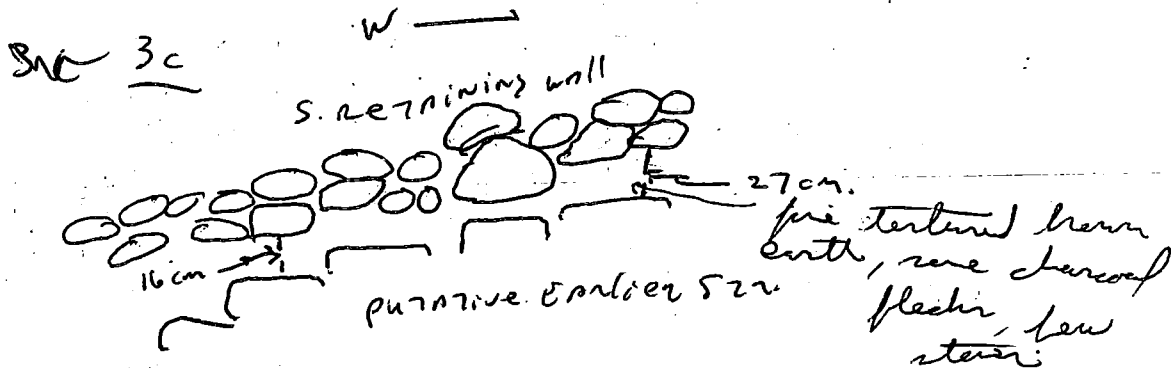

3C Medardo & Juan now clearing off CRUMB from SOFT

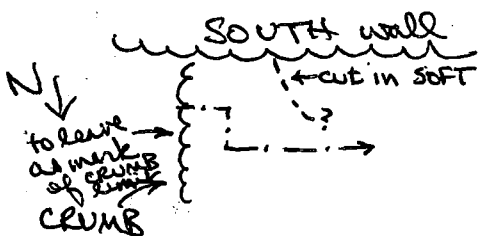

to trace cut in SOFT
then will dig into it

3D Jose Esteban & Eliberto cutting ~~at least~~ in disturbed part of Str 1, to cut (then) down to HANGING wall & eventually TRUE STR - to establish indirect link with 3C stratigraphy

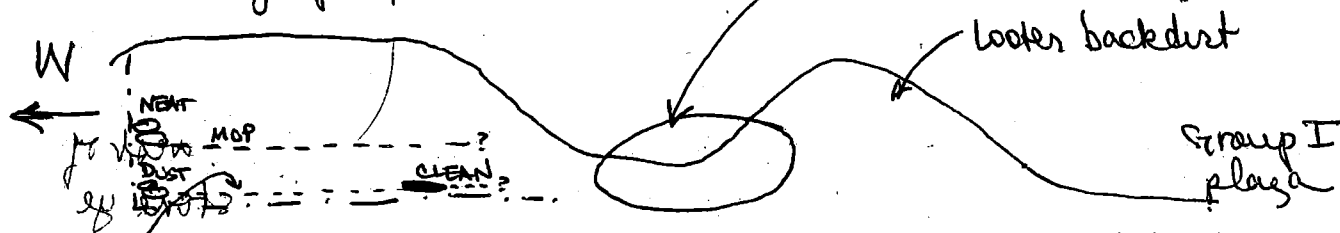

this floor marked only by presence of DUST, i.e., CLEAN "hearth" & ballast stones

12C Justine still following ^{west wall ← Saul & Grain} at before, but Jaime & Reinos are ~~cutting~~ removing tilted stones at top, to ^{define} wall line below if there

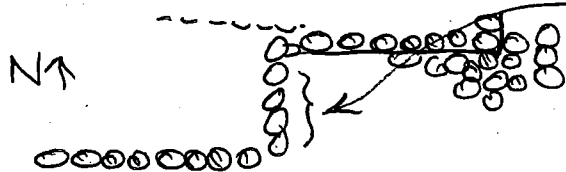

6A Alex's men finishing up the pit to draw & photograph

3C Medardo & Juan still removing cap - first "end" ^{in SOFT} seen (see top of page) was a "false alarm" - SOFT seems to continue ^{again} & then stop within 30 cm of base of GRUB wall

3C/20 materials from between CRUMB and SOFT - buried rim shield + ^{well} used frag of wide obs blade + 2 pieces of earth with bright red paint adherant

PS4-7-49

6/27

June ²⁷~~28~~ (an ednesday)

3C. Back on the pits again. 3C/22 - material from within the "cut" area to the east of the earlier construction, beginning ca. 0.25 - 0.30 m below the base of the S. retaining wall + ca. 0.80 m west of the west cut edge of the hard white floor.

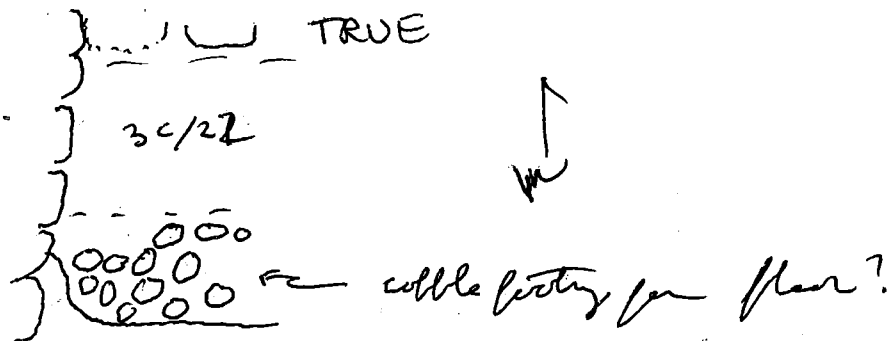

TB - 1x2 m pit (1 m N-S x 2 m E-W) located west of the fence line narrowly; the site + off the SW corner of the 11. Designed to locate construction line - final phase of the 11 - associated terminal debris material and the level of the plaza associated with this final construction / occupation phase.

TB/11 - ~~ca. 0.20~~ 0 - 0.20 m below the NE corner ground surface. S. later down to flatten out the trench + remove material piled here by bulldozer activity, which has been extensive. Subsequent level = 0.10 m.

TB - located 1.50 m west of the fence.

also designed to ~~see~~ rephase material room to be inaccessible due to road construction.

3C - 3C/22 - Extended down 0.30 - 0.40 m below the base of the S. retaining wall. ca. 0.10 m deep overall. Uncovered quite a few shards, + some bone. The earth here is mottled with charcoal

7B - She 1x2m pit off the SW corner of the 11
 has begun to hit a level of fairly large, closely
 packed stones at ca. 30-40cm below ground
 surface, NW corner. So far the artifact yield
 here has been meagre. After these 2 workers
 have finished in (6A) they'll probably extend the
 pit somewhat (ca. 1.0m) to the west to try and
 get beyond this stone level and then come
 in towards the st. I think that most of this
 material may be tumble but it's currently
 hard to tell and I want to come back and
 away from the st. before coming down
 on any of wall. Alex has been watching this pit
 today, with Brenda's help. Otherwise Brenda
 has been running soil samples.

6A - Azwiri. 6A/33 - Shovel pit within the
 pit onto the level rock level, from 1.71m below
 ground surface, NW corner to base of pit. Shovel,
 level, pit, shovel sample. will try + set a rock
 sample after lunch.

Note that the prehistoric "mudstone" level in
 6A seems rather narrow (level C ca. 0.20-0.30m
 thick except in the area of the pit). She's gone along
 with Alex's observation on the structure per
 excavations. I see one 2 fragments, in the east
 wall the bottom of this level appears to chip
 down down considerably, while in the west wall
 the pit extends a fairly good depth.

Note also that the pit walls in 6A
 were already fairly ch. when I checked them. While
 I did find a hole in the wall, it was still
 hard to discern subtle soil differences, especially the
 precise limits of the "mudstone" level. She later

P84-7-53 6/27

30/8 - 3 rem mixed fill + Marie L in bucket
in east extension of 3D to better reveal apparent
east wall related to the 1. large stones, set in
as a N.-S. running line noted right up against the
east trench line this morning. Had fore fore
Esteron + fanks (Esteron is off here cutting
Pincito trees, no replacements) cut back the
trench to the east ca. 0.75 m to better expose
this line. Ca. 0.40 m below the base of
HANGING wall here (basal the 1 wall), the stones are
ca. 0.30 m in diameter and their front face
ca. 1.10 m east of the front face of HANGING. Covered
by loose fill stones + backed by what seems to be
a flat-land cobble pavement, stones ca. 0.18 m in
diameter. Starting this all cleared off + going down
east of the possible wall to see if it continues +
later on more reality. I was wrong yesterday -
W.A. has HANGING in 3D here, but what is
this other line?

30/8 - 3 rem again - 3 rem mixed fill + bucket
for looking in east extension of 3D to reveal possible
lower wall, ca. 0.75 m S.-W. x 2.10 m N.-S. x 1.40 m
deep (approximate)

30/9 - 3 rem immediately atop the putative line +
cobble surface, my contain some adrienne for analyzing
fill.

6A - Alex + his 2 friends are down roughly
0.30 m lower in the pit into the basal rock
level. She thinks that they may have finally
reached the bottom of it. She has the notes on
this excavation though 6A/132 is now down ca. 0.20 m
below surrounding base of excavation within the
confines of the pit while 6A/137 consists of material

PS4-7-55 6/27

30 - an ell, what do you know, they have found a wall line running \pm E.-W. with a clear cobble stone pavement behind it to the west.

84-7-N-5A - 3le revealed lower cobble line + pavement from above, meter stick at 0.50m, no chalk board.

N.A. 35mm - ^{short} ~~meter~~ #3le, the revealed lower line + "pavement" in relation to HANGING wall per the east, meter at 0.50m, no chalk board.

3le line is very clear but will be obscured tomorrow as we have to take someone to the hospital.

84-7-N-7/8 - junction of FRED and GREAT walls, per, 30, looking obliquely to NW. meter stick at 0.50m.

84-7-N-9/10 - same as area, close up of wall junction, meter stick at 0.50m, no chalk board.

84-7-N-11/12 - op. 30, 3le entire ^{FALL} wall (~~stone~~) and western pavement looking at (~~FIRSTING~~), showing the relationship to HANGING wall, per the east + above.

staff photo - 84-7-01/2

PSB

P84-7-57

6/28

30 - Site fill above + east of [Fall 2] fairly
clean stone, some cut blocks. Toned in with
the cobbles, with a dark black to dark brown
earth matrix. Rather loose, I fear the effects
of the rain.

30 - Soil sample taken from 30/25.

12C - when first cut into the 34
section, she hit, in the far north end of her
trench, a wall running E.-W. The wall was
of cobbles, ca. 2 cobbles high, and seems to have
been fairly substantial - at least it was cleaner
than most. Currently Jones + Payne are clearing
this off for photos. Later will cut over and
across the str. at the level of the upper stone
to see if we can pick up the north wall for
the width. Note that this newly uncovered
wall does not seem to clearly line up with
any of the other revealed walls, not even the E.-W.
running str. wall chased out to the east + where
SE corner we have.

6A - Still going down in the apparent late
Preclassic trench pit, now just coming out. Alex
supervising, who knows where the bottom of this
monter is?

30 - 30/25 level: getting rather sandy,
still brown but much softer + less clay-like
than the upper levels. Contains a few shells,
jute, and charcoal.

PBB

PS4-7-59
6/28

3C/26 - 0.20 - 0.70 m below the base of
PLUM down in the "cut" area between TRUE str.
+ etc cut in the basal plastic floor.

They do increase in artifact yield in 3C/26
over 3C/25, we'll have to wait + see.

6A - Finished (I hope) here today. I by accident
the bottom of the pit at about 2.31 m below ground
surface about the middle of the west wall at the
pit's deepest point. I by pit itself, assuming that it
extended up to the \pm base of Level C (the middle) is ca.
1.40 m deep at its deepest point. It has a rather
irregular shape, cut back and down steeply, down on the
south while on the north it runs into a large stone
and then slopes more gradually down from there.

E.-W. the pit slopes down rather steeply on the east
while the western portion remains within the section of
the west wall. I was surprised to see how many
stones were embedded in the pit fill, some quite
large cobbles, ca. 0.30 m in diameter. The large stone
on the north which marks the north exposed pit
line seems to rise up out of the basal colluvial
layer of which it seems to be a part. Several
other similarly large stones were noted in the
base of excavation within the colluvial level
in 6A.

Drew the N.-S. surveying section to the base of the
pit in the west wall (with slope drawing, I was
measuring), an east-west section across the
appropriate center of the pit incorporating 2 of the stones
shown in the N.-S. section (I + II on that section),
and a 1:10 plan of the pit outline as it appeared
fully exposed at the ~~1.72~~ 1.72 m depth.

12c - further than hit another wall close to ^{6/28} surprise and to the north. If it's not just the back (north) side of surprise, it creates a very narrow summit, possibly a bench or some other summit feature together with surprise? They both seem to be about ± the same elevation on their summit. Also - to the immediate north of this wall, at and below the base the workers have started to dig down to into a reddish-brown soil level. They're starting to turn up lots of "barro quemado" (by bayurega, scale, whatever) and some larger stuff. General debris for the str. 12 summit (probably)? ~~we~~ we agreed to have Jim + Dennis continue cutting north within the confines of the 1.5 x 30 (E-W. x N-S. respectively) trench which contains the "equal" base of Op. 12c to the north. well carry it down to a point above the apparent soil change (staying within the previous brown soil which overlie construction). This level is ± to the base of construction noted on the newly-revealed wall. Neasey - I really can't say where we are in the str. at this point + don't want to go down any further until we find or don't find more construction.

Feopine

3c/3d show about this idea - Fall wall + pavement did one continue into 3c but stay, and whatever else was associated with them, were removed to build the fill retaining per + Hanson's wall? maybe

30 - 30 continues eastward + down. They're pretty much through the ledge + backfill and into what I think is fill. we've removed Fall, but hope they don't rip it out.

PSB
P 89-7-63
6/28

plaster floor, east of the cut in its surface. Looking at the east section of an cut we can see the plaster appearing below the level of the stones but well above PLUM. This lower level of plastering; apparently, part of the plastering of the hard floor ~~was~~, does not seem to continue west of ~~was~~ into an cut.

30/12 - east of FALL wall, Sop of Fall to base of excavation over entire trench in fill, earth + stone.

30/27 - fewer stones - may well have hit the alluvial level at 0.55m below base of PLUM.

7B - Continuing westward uncovering more large cobbles + chunks, still apparently part of a surface, possibly a terrace forming the floor the west. Stones appear at all levels, close to the surface down to 0.50m below ground surface. The lower stones seem to be more flat-laid than the upper ones, more clearly a surface. Also - as we move westward the surface seems clearer. Possibly a lot of stone tumble step a terrace surface?

31 - Clearing down to the east of Fall, leave earth + stone fill including cobbles + some cut blocks. We have a fairly good extent of Fall cleared now, N-S. and it seem to have more depth to it - i.e. more than 1 cobbles. we may also have the north extremity of a possible step in the S. end of the trench - a large stone protruding out from under the top stone of Fall base. The stones appear to be in situ, not pushed out, so it's hard to say how this stone relates

PSB
P.84-7-65
6/28

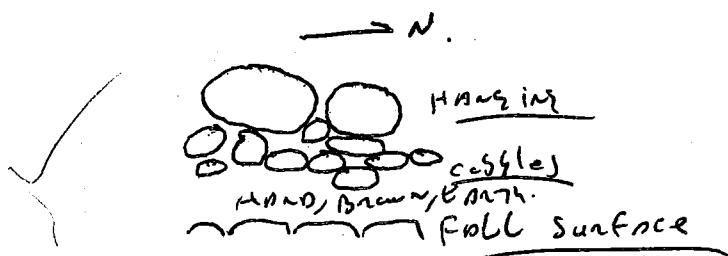

84-7-0-9/10 ^{OP} = 3D, Fall wall from due + E; note
at 0.50m, no chalk board, not as clear as we
would like.

June 29 (Friday)

Back at last! Rained here & SB at night - 1st time
since ca 6/24 (Sunday), & cooled the climate immensely
75° at 8⁵⁵ - Ed gave me the rounds on the excavations
here before proceeding to Ale's excavations & Julie M's

12C cutting north of Otkno wall to see if there's more to the
north side of the platform - at this point it seems a
cobble formalizing on the south side with probably either
substructure continuation to the north

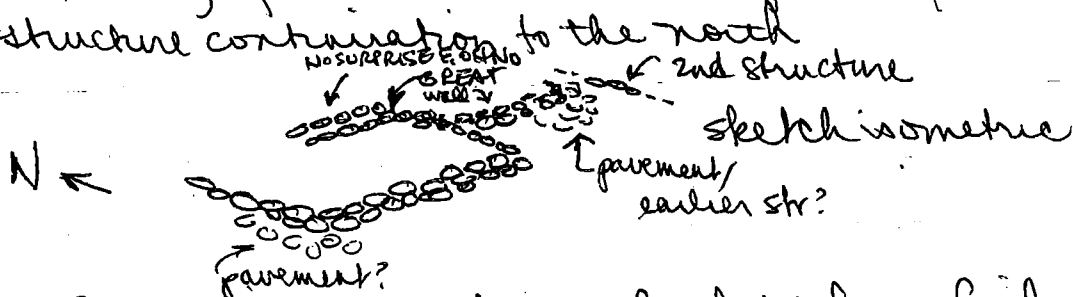

Jaime & Reyno will then clean up for photos here - final cut
may be to follow NE corner → N to seek end/resolution there -
since stone construction had been narrow elsewhere, should
peter out soon

7B edge of platform off Str II - will clean better for photo & carry
eye east to fence line & that's probably all

PSB
P84-7-67
6/29

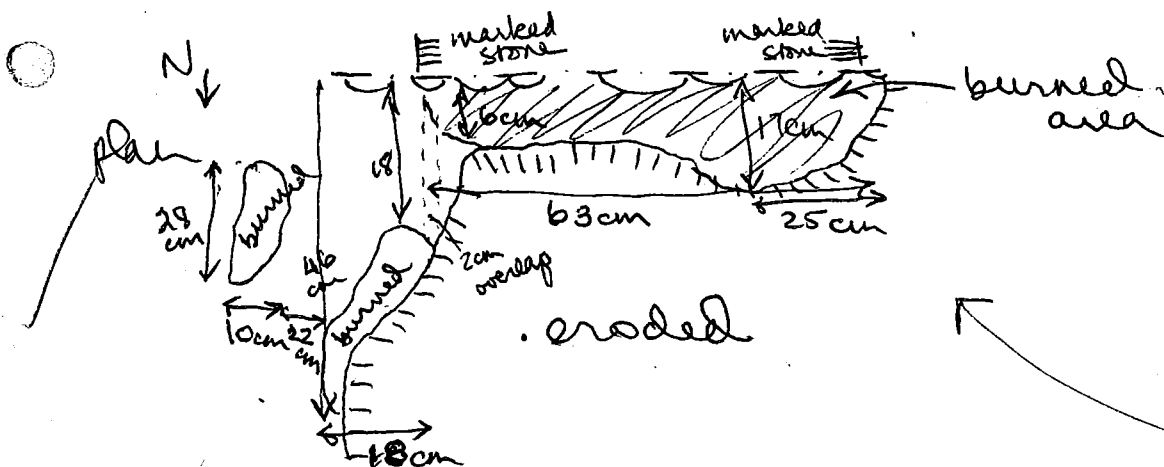

took photos 84-7-Ø11/12 SOFT at cut, w/ PLUM in background, scale 50cm - to show burned areas at erosion edge before cutting thru
was cutting thru to reach PLUM level in 3C with SOFT in cross section - to show levels of possible but not actual articulation of features

climbed ridge east of site - took photos
84-7-P1/2 Ops 12A, 12B, 12C
3/4 Ops 3C, 3D
5/6 Strs 24 E 16 remnants
7/8 Ops 6A, 7B

85° at 150' - cloudy
TB took photos 84-7-P9/10 Op TB from west showing double (?) terrace levels, scale 50cm containing exposure of NIM Terrace E toward Str 11

12c took photos
84-7-P11/12 SLEAZE wall from SW, scale 50cm
Q1/2 PREMIERE wall from WSW, scale 50cm
Q3/4 OH No wall from NW, scale 50cm
Q5/6 GREAT wall E SE corner, from E, scale 50cm
Q7/8 GREAT wall from SW showing 2 constrn levels, scale 50cm

June 30, 1984 (Saturday)
86° at 8:00 - payday of last full week of excavation

scope	T	Elev	Mid Hair	Upper	Lower	Distance	Angle
	T1 - Str. II summit						
	HI: 1.465	161.795					
1.	DATA	<u>163.260</u>	3.260	3.740	2.790	9.5m	99° 20'
2.	FAR NE CORNER TRANCH	160.56	2.76	3.090	2.315	7.75	79° 51'
3.	FAR NW CORNER TRANCH	160.47	2.790	3.170	2.410	7.6	79° 15'
4.	South East Corner "	160.46	2.800	3.185	2.410	7.75	80° 20'
5.	NE CORNER 3 COBBLE	160.495	2.765	3.165	2.375	7.9	80° 45'
6.	SE CORNER OVERALL	160.425	2.835	3.235	2.440	79.5	81° 40'
7.	South junction 3 COBBLE	159.85	3.405	3.800	3.010	7.9	81° 45'
8.	North junction "	159.81	3.450	3.845	3.060	78.5	80° 50'
9.	CORNER GREAT S TRANCH	160.335	2.925	2.550	3.310	7.6	81° 10'
10.	SE CORNER OF STRUCTURE	159.98	3.280	3.665	2.900	76.5	81° 15'
11.	Ancient Ground level 3 COBBLE	159.61	3.660	4.040	3.260	7.8	81° 30'
12.	BASE OF EXCAVATIONS SOUTH OF GREAT WALL	159.435	3.825	4.200	3.460	7.4	81° 50'
13.	BASE EXCAVATION	159.35	3.910	4.270	3.550	7.2	82°
14.	West end GREAT WALL	160.11	3.150	3.510	2.795	71.5	81° 25'
15.	North alignment EAST END GREAT WALL	160.045	3.215	2.860	3.575	71.5	81° 15'
16.	GREAT WALL INTERSECTION	160.045	3.215	3.565	2.865	7.0	81° 20'
17.	Alignment point FOR NO SURPRISE WALL ON SECTION WALL	160.09	3.170	3.520	2.825	6.6	80° 45'
18.	NE CORNER OF NO SURPRISE EXCAVATION	160.12	3.140	3.485	2.795	6.9	80° 15'
19.	EAST EDGE OH NO WALL	159.825	3.435	3.880	3.090	7.9	80° 5'
20.	BASE OF EXCAVATION JUST NORTH OF OH NO	159.605	3.655	4.000	3.310	6.9	79° 50'
21.	NE CORNER OF OH NO EXCAVATION	160.35	2.910	3.260	2.570	6.9	76° 15'
22.	BASE OF EXCAVATION NE CORNER OH NO	159.985	3.275	2.935	3.620	68.5	76° 15'
23.	NORTH WEST CORNER OF OH NO EXCAVATION	160.28	2.980	3.315	2.645	6.7	76° 15'
24.	BASE OF EXCA. NW CORNER	159.945	3.315	2.980	3.660	6.7	76° 15'
25.	West side OH NO WALL AT SECTION	159.74	3.520	3.865	3.185	6.8	79° 45'
26.	North West corner of Ex. NO SURPRISE	160.05	3.210	2.875	3.550	67.5	80° 20'
27.	West end NO SURPRISE WALL	159.775	3.485	3.825	3.145	6.8	80° 40'
28.	SIN CORNER OF EXCAVATION CUT	159.865	3.395	3.435	3.050	6.5	83° 10'
29.	EAST SIDE PREMIER WALL						

163.260
3.140
160.120

163.260
2.910
160.350

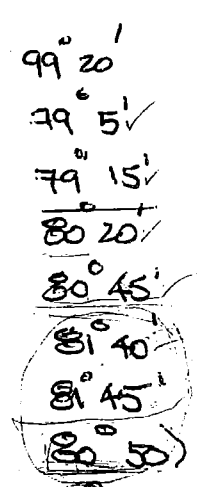

PSB
 P84-7-870
 6/30

SCOPE #	X	ELEV	HIGH RATE	UPPER	LOWER	DISTANCE	β
		Hi 1.465					
29	NE Interior CORNER OF SIAZEC PREMIERE	159.62	3.640	3.960	3.320	64	84° 10'
30	SE CORNER JAG OF SIAZEC WALL EXCAVATION	159.73	3.530	3.850	3.215	63.5	82° 30'
31	SE CORNER JAG OF SIAZEC WALL EXC.	159.745	3.515	3.840	3.195	64.5	82° 20'
32	NE CORNER JAG EXC.	159.83	3.430	3.755	3.115	64	80° 45'
33	NW CORNER JAG EXCA.	159.78	3.480	3.795	3.165	63	81°
34	BASE OF EXCAVATION South West CORNER of JAG.	159.115	4.145	4.460	3.830	63	82° 15'
35	NW CORNER - West of SIAZEC WALL	159.685	3.575	3.270	3.880	61	82° 20'
36	SW CORNER EXCAVATION limit West of SIAZEC WALL	159.555	3.705	4.015	3.395	62	85° 20'
37	NW CORNER of Southern out cut	159.57	3.690	4.010	3.370	64	85° 30'
38	SW CORNER of out cut	159.555	3.705	4.025	3.395	63	85° 40'
39	BASE OF EXCAVATION SW CORNER of out cut	159.125	4.135	4.455	3.820	63.5	85° 30'
40	SE CORNER of out cut BASE OF EXCAVATION	159.63	3.630	3.960	3.305	65.5	85° 25'
41	NE CORNER of out cut	159.635	3.625	3.360	3.950	65	85°
42	NW CORNER of 1st out cut	159.795	3.465	3.805	3.125	68	84° 15'
43	SW CORNER of 2nd out cut	159.765	3.495	3.840	3.155	68.5	84° 45'
44	BASE OF EXCAVATION SW CORNER of out cut	159.33	3.930	4.280	3.590	69	84° 30'
45	GROUND SURFACE South end of EXCAVATION cut	159.855	3.405	3.060	3.755	69.5	84° 35'
46	SOUTH EAST CORNER Main EXCAVATION	160.07	3.190	2.560	2.835	?	84°
47	NE CORNER Main EXC.	160.175	3.085	2.720	3.445	72.5	82° 15'
48	NE CORNER North of GREAT WALL	160.285	3.005	3.370	2.640	73	80° 50'
49	NW CORNER North of GREAT WALL	160.13	3.130	3.485	2.780	70.5	81° 5'
50	NE CORNER EXCAVATION limit North of PREMIERE WALL (out cut)	160.05	3.210	3.565	2.855	71	82° 45'
51	NW CORNER EXCAVATION limit North of PREMIERE WALL (in cut) lower	159.99	3.270	3.620	2.920	70	83°
52	Western Point on FENCE	159.47	3.790	4.160	3.420	74	81° 30'
53	Middle of FENCE SOUT to the South	159.45	3.810	4.190	3.430	76	81° 40'
54	EAST END of FENCE PATIO	159.61	3.650	4.040	3.260	78	81° 45'
55	NE CORNER PATIO (?)	159.895	3.365	3.760	3.985	77.5	80° 30'
56	JUNCTION of GREAT and FEED	159.60	3.660	4.020	3.300	72	81° 30'
57	South End of FEED	159.58	3.680	3.220	4.040	72	83°
58	EAST END PREMIERE WALL (?)	159.63	3.570	3.930	3.210	72	81° 40'

PSB
 84-7-71
 6/30

SCOPE #	T	ELEVATION	MID HAIR	UPPER	LOWER	DISTANCE	4
	Hi 1.465						
59	EAST END OF PREMIERE FOR SURVEY	159.37	3.890	4.235	3.550	68.5	84° 20'
60	SOUTHWEST JUNCTION RICHARDS STEAZE	157.24	4.020	4.335	3.705	63	84° 45'
61	NORTH END STEAZE	159.26	4.000	4.315	3.685	63	82°
62	SE CORNER 12A	162.085	1.175	1.535	0.815	72	55°
63	SE CORNER 12B	160.835	2.425	2.725	2.135	59	54° 50'
64	FENCE POST	161.965	1.345	1.710	0.975		49° 40'
65	FENCE POST	161.25	2.010	2.390	1.630		38°
66	FENCE POST	160.545	2.715	3.130	2.300		82° 15'
			4.542	4.616	4.470		248° 50'
163.260 4.542 <u>158.718</u>	67	NW CORNER OPT 7B	158.718	3.512	3.770		299° 45'
163.260 3.953 <u>159.307</u>	68	SE CORNER OPT 7B	159.307	3.953	3.910		289° 40'
	69	FENCE POST	159.308	3.952	4.017	3.883	183° 15'
	70	FENCE POST	158.57	4.750	4.848	4.655	170° 15'
	71	FENCE POST	158.91	4.350	4.520	4.180	229.45
	72	NE CORNER ^{OFF} 6A	158.51	4.750	4.970	4.520	231.10
	73	NW CORNER OPT 6A	158.575	4.745	4.975	4.510	229.40
	74	SW CORNER CP 6A	158.54	4.720	4.955	4.480	227.45
	75	SE CORNER CP 6A	158.64	4.620	4.855	4.390	227.°
	76	FENCE POST	158.855	4.805	5.050	4.550	249° 30'
	77	FENCE POST	158.305	4.955	5.195	4.710	173° 00'
	78	PARTICULAR FENCE POST 4C	159.59	3.670	4.285	3.060	

took till after 11 to do these plan points
 Alex took photos 84-7-~~Q~~^{11/12} of Op 7B, cleared from W, scale 10cm
 (no chalk board) - now ~~removing~~ removing stones
 for section

PSB
 P84-7-73
 7/3

July 3 (Tuesday)

Much rain at night SB & here
 75° at 7⁵⁰ - Alison, Justine & me - points for 3C/3D
 plan & sections (3C profile over Str 1)

scope Δ	T	Elev	Mid Hair	Upper Lower	Lower	Distance Δ
	T3 HI 133.5					
- 9°30'	1 W side, base Str. 1	4.000	4.076	3.927		252°45'
- 9°30'	2 Mound contours	3.150	3.203	3.097		248°30'
	3 "	3.511	3.548	3.475		241°37'
	4 "	1.795	1.818	1.772		219°44'
	5 NW corner Opt. 3D	1.373	1.393	1.352		187°52'
	6 Opt 3D Nest	2.214	2.234	2.194		181°42'
	7 Clean feature	3.483	3.509	3.458		159°52'
	8 Ballist Stone 3rd Sec.	3.500	3.536	3.482		150°39'
	9 East End Upper 3d	3.717	3.752	3.681		133°43'
	10 Toe of Fall	3.582	3.620	3.543		125°10'
-4°45'	11 Base of 3d	4.480	4.520	4.490		125°25'
	12 SE ^{corner} Opt 3d	3.498	3.550	3.448		132°20'
	13 NE Corner 3d	1.790	1.834	1.746		116°25'
-4°10'	14 NE corner Soft (on rock)	4.000	4.101	3.899		90°45'
-4°10'	15 SE corner Soft (on rock)	4.000	4.102	3.898		94°25'
-4°25'	16 East edge of bulk	4.450	4.529	4.371		90°23'
-4°45'	17 Southside of bulk	4.450	4.522	4.378		92°25'
-5°	18 West edge of bulk	4.100	4.164	4.036		87°28'

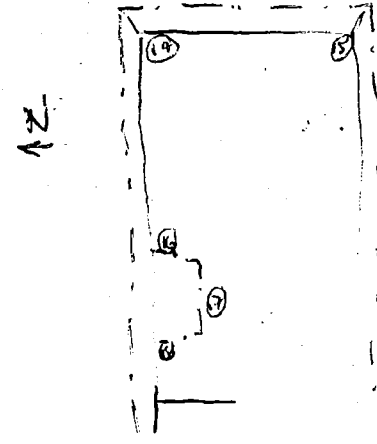
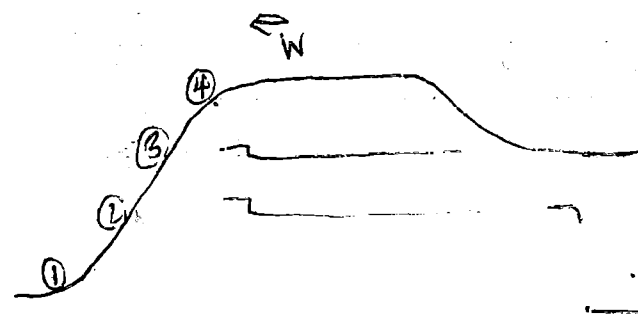

Lab Notes Concerning 1983 Season

Lots 10D/9 and 10D/10 were unwashed as of the end of the season they may have gotten mixed up. Lot 10D/9 should contain obsidian and Lot 10D/10 should contain quartzite.

There was some confusion with lots 10G/48 and 10G/47 and with their lot cards, they may or may not exist.

After lot Card 2A/40 there is a jump to 2A/100 then to 2A/110 and then to 2A/120. This is because Mark arbitrarily chose these three numbers without checking with Kathleen.

Original Cards that have been duplicated should have a star (*) in the upper left hand corner to indicate this.

About half way through the 1983 season we started putting sub totals after the descriptions of items on the back of lot cards to indicate that there was more than one bag of things.

Part way through the season we stopped numbering all of the stands in the lots due to lacks of time and man power.

Lab Notes Concerning 1984 Season

The material I called Black Rock Type A has been identified as Andesite and will now start appearing under that name. But past records will be left with the designation of Black Rock Type A (BRTA).

The lab has created OPEZC to help deal with lot tags that were severely damaged and partially unreadable due to storage in the Copan bodega during the off season.

Jute are not being washed and cleaned out of dirt as completely as last year. They are still being counted and weighed. After the weight we are putting the notation uw to indicate that they are unwashed and that the dirt content may skew the weight correlations to better washed lots.

This year our three sherd washers also did a lot of the work of numbering and counting the sherds and recording the counts on the lot cards. As a result the "brief descriptions" have occasionally been misspelled i.e. "~~and~~"andesite" for ambesite or puts in Spanish "obsidiana". We have tried to correct this when it was encountered but that didn't always happen. Also for a while one of them was numbering things with dashes rather than slashes (i.e. 6A-2 vs 6A/2) again I have tried to correct these. Also many of the sherds got numbered on the rim across the center or over part of the design.

In bagging and counting lots 6A/28, 6A/30, +6A/33 I noticed that some of the jute were noticeably larger than the average jute and also that many of them had unbroken tips. This might be worth looking at further at a later time. It might also pay to look at lots related to these and see if they have similar jute.

Lab Notes Concerning 1984 Season Cont.

Flotation contents are being recorded on the lot cards an F is being put after the lot number to indicate that it is from flotation as opposed to the normal pit contents. (This was also done in 1983).

At different times during the season depending on the pressures of time we numbered either all of the sherds or only the rims, appendages and other diagnostic or distinctive sherds.

Lot 26F/1 may be incorrectly numbered there was a mix up of tags in washing it could possibly be 26C/16

In looking through the lot cards we found some 1983 lot cards that seem to be missing. It is possible that they were misplaced during the intervening year at some point an effort should be made to locate them or an eye be kept open for them. They are Numbers 5C/7, 5C/21, 5H/23-30 + Dup.

Lots 52B/1-6 was reversed with 52D/1-6. These pits, 52B and 52D were reversed when there was a change in people working at the site. Lots 52B/1-6 were subsequently changed to 52D/1-6 and vice versa when the mistake was discovered.

~~52~~

3A: hit a hardened earth surface (slightly redder/orangier than matrix above) ca 8cm below base of SOF deposit

(see Ed's notes re: description)

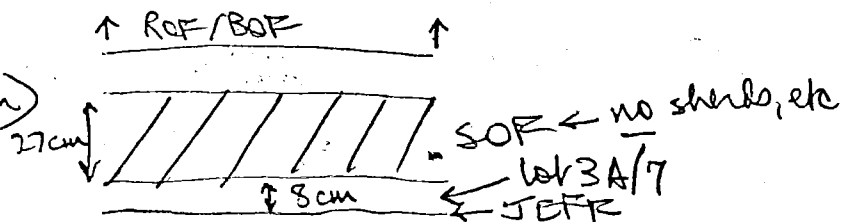

3B: finished east continuation of lot 1 (surface to 10cm, latter measured above posited position of BLAST) - now clearing down to BLAST there (lot 2)

lot 5C/45 5C: took flotation sample from slit trench, from seeming midden overlying MARINA (got 3 cloth bags full from here yesterday)

3A: layers of SOF are different in color

- ① buff/white
- ② greenish
- ③ orangey

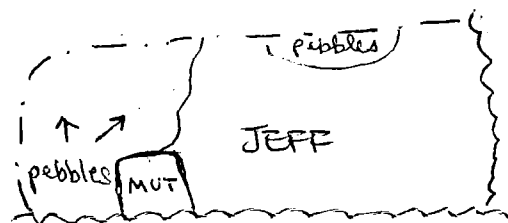
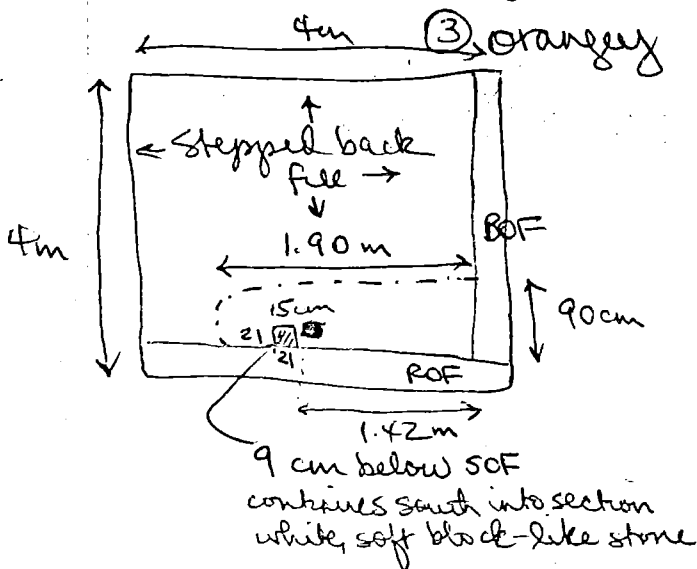

MUT could be ^{formed} edge of plaza
pebbles could be erosion
or cut

3A/7 includes sherds, jute, obsidian - took flotation sample
1 piece of possible Copador