

1984

## PSB-007-Asmore-Field Notes-1984

Wendy Ashmore

Follow this and additional works at: <https://digital.kenyon.edu/honduras>



Part of the Archaeological Anthropology Commons

---

### Recommended Citation

Ashmore, Wendy, "PSB-007-Asmore-Field Notes-1984" (1984). *Four Valleys Archive*. Paper 92887.  
<https://digital.kenyon.edu/honduras/92887>

This Field Notes is brought to you for free and open access by the Anthropology at Digital Kenyon: Research, Scholarship, and Creative Exchange. It has been accepted for inclusion in Four Valleys Archive by an authorized administrator of Digital Kenyon: Research, Scholarship, and Creative Exchange. For more information, please contact [noltj@kenyon.edu](mailto:noltj@kenyon.edu).

June 21, Thursday

Spent all morning, until 11:30, trying to get our tourist cards renewed at Migración.

Went to Gualjocuito today to take over Wendy's excavations in Op. 3 while she goes to San Pedro Sula for today + tomorrow. She + Ed spent about 45 minutes showing me the ropes.

As I understand it, here's a sketch of what's going on in Op 3C (plan).

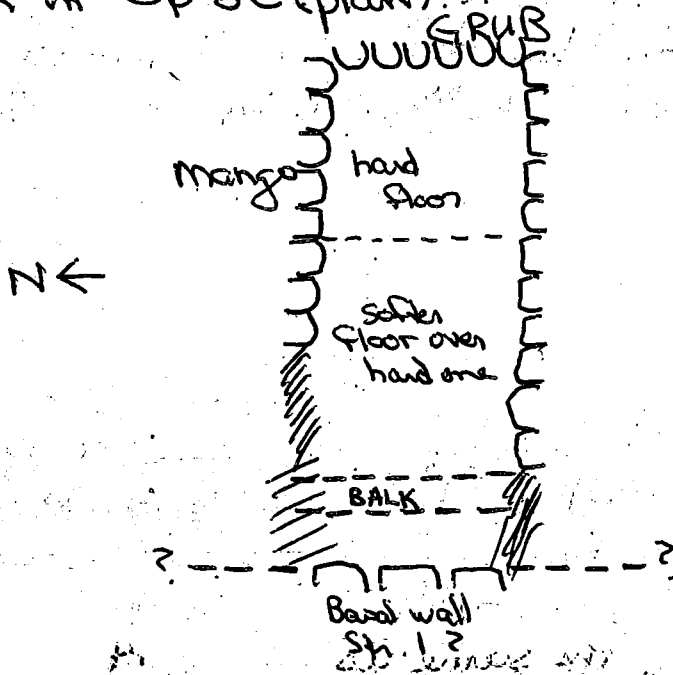

Two workmen worked on clearing + consolidating an area of fill south of mango wall to use as a step-up + out of the pit. The material they got from this is a continuation of lot 3C/9.

After they completed this, these same workmen worked on cleaning-up MANGO wall.

The other 2 workmen seem to have exposed the basal retaining wall of Str. 1. They're trying now to locate the SW juncture between this wall + the south retaining wall in op 3C. There is a balk in this area that separates this from the rest of the trench. The material

shell, ceramics, obsidian, + bano quemado. We left the majority of the bano quemado intact.

Op. 3D, lot 5 is from clearing of the eastern end of Op. 3D. It's from approximately 4.40-5.60 m east of the western end of Op 3D. The area was already taken down below the level of MOP floor. I decided to include in lot 3D/5 all material between MOP floor + the next lower floor (the one on which CLEAN feature rests), but we didn't get too far. After going down about 10-15 cm. we temporarily suspended all work on Op 3D to switch all available labor back to Op 3C.

Op 3C had a lot of collapse to clean + all 4 workers spent the rest of the day clearing cobbles + bucket-carrying dirt out of Op 3C.

It appears that the proposed basal wall of Str. 1 rests over (on) the fill retained by MANGO + GRUB walls. So, Str. 1 was built after this fill episode raised the level of the plaza. I'm not even sure that we definitely have the basal wall of Str. 1 yet, but it's suggestive. We're clearing the South retaining wall area at its west end down to the level of the soft + hard plaster floor. It seems as though the plaster floor ends some 6 m to the east, however. It's hard to say for sure now, because there's so much going on in the trench today (so much dirt + so many cobbles all over the place).

Sketch profile of south, west + north faces of trench.

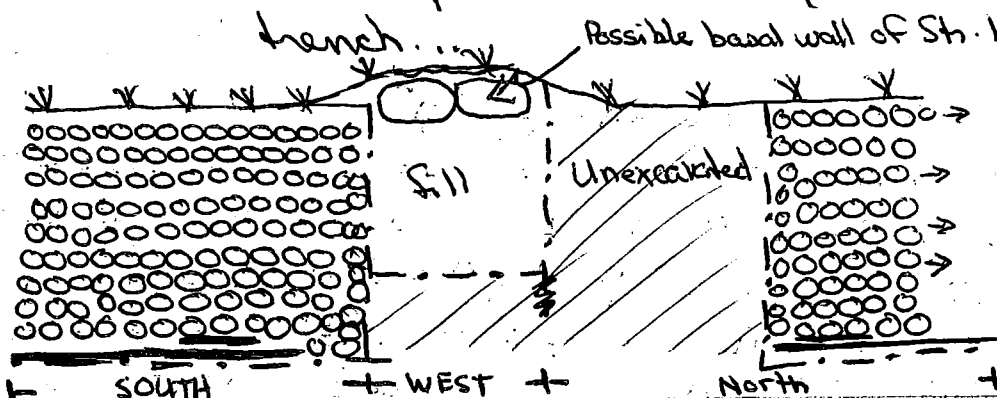

5/20

PSB

May 20 (Sunday)

Arrived with Justine and Julie at midday. One piece of Julie's luggage got bumped (plane was overweight — we had 4 pcs overweight aboard...); promised for tomorrow. All else came through all right.

Rented Bly van — seems "ok", tho' rearview mirror is busted (cracked) and no side mirrors, and no emergency brake.

Tegucigalpa seems quiet/normal. Staying at Marichal - Rms 114 (~~and~~ J&J) & 211 (me). Made reservations for Ed, Pat et al for Thursday. Parked van at IASH with guard's permission.

Meeting with Ricardo tomorrow at 8:30.

May 21 (Monday)

Noisy night (from street); poor (intermittent) sleep. Same for Julie & Justine.

To Instituto — spoke with Ricardo: he was understandably preoccupied with news story that had broken yesterday (2 page spread in La Prensa) accusing George Haseman & Ken Huth of looking at Salomon — terrible scandal, the story, ~~but~~ <sup>and</sup> utterly untrue. Will combat immediately.

Re: PSB: welcomed back. Drafted contract (essentially identical to 1983, but Texcon specified at outset & Gap I excavation specifically described) and Ed can sign on Friday. Returned artifacts and got a receipt (shells still awaited — hopefully they will have reached Ed from Feldman & he can bring down; otherwise, Ricardo said we could request an extension) Handed over Negatives PSB 83-1/146 and descriptions for PSB 83-1/208 (Ed & Pat bringing the rest of the negatives, artifact shots). All 6 staff will get credentials, so we got photos for Julie & Justine and typed up vtrac at the Instituto

P84-7-3

5/22

PSB

May 22 (Tuesday) - called Ed from Honduras  
Picked up credentials at HATT (Julie's, Justin's, & mine) and then got Land Cruiser from Molinari. Seems in ok shape except (1) hand brake is useless (as in the van), (2) right hood lock unreliable, (3) some squeak that occurs intermittently (when car is hot?), and - as we only discovered by being stopped at the military checkpoint just north of Teguc - lacks front license plate. Will check this at Molinari in SPS.

Ricardo heard back from the bank: our account was transferred to San Pedro and then cancelled for having less than L 2! A large deposit (L 500 according to Ricardo) was deposited and withdrawn - presumably the deposit we were expecting from John's mother - must pursue further with Sr. ~~Ricardo~~ Gustavo Lanza (rec. per Sr. Raul Zelaya in Teguc) of SPS Banco Atlantida.

Stopped 1 1/2 hours in Comayagua (left Teguc ~ 1 pm), saw Deanie & Foncho & the Museo lab. Collected PSB cooler & maps left in 1983 with Hasemanns. Arrived San Pedro at ~ 7, staying at Hotel Columbia. Tiring day, but generally went well.

May 23 (Wednesday)

Called Pat to report on car, Comayagua pick-up, and bank and asked her to call Haighs.

Got makeshift <sup>front</sup> license plate from Molinari, and talked to Gustavo Lanza at Banco Atlantida. The money from Mrs. Haigh is in Tegucgalpa and was just sent there for lack of activity on the account. Sr. Lanza will look into it and will advise SB gerencia to allow us to reopen our account.

PSB  
184-7-5  
5/25-26

## May 26 (Saturday)

Friday & Saturday both hectic, even at a slow pace. Rained heavily from 7 pm Fri night for about 6 hours (at least), so temperature cooler Saturday (86° in early afternoon).

House we'd taken began to be fixed up (new toilet seat, shower valve, new sink, etc) but by mid-day Saturday the water shortage problem there became all too clear. Fortunately the dueño understood the problem and released us from our verbal contract - bless him. So we got (were fortunate to get) another house which we are told we can occupy on Sunday at noon, won't handle 18 people, but maybe 12, and has better water & space allocation (outside & inside) + a kitchen (no appliances, but sink, and the other had had none).

\* off duty from  
ca 7 am to  
ca 9 pm

Exhaustion. None of us is eating much. Thank heavens for Jorden & Bob & John & Mary of the Peace Corps, for putting us up and helping us keep body & soul together. And thank goodness for Pedro and Eva and their endless help, without which we would be homeless.

## May 27 (Sunday)

Moved to new house and Pat, Ed et al arrived - we are now 10 (besides P & E, new arrivals were: Aelika, Kathleen McLaren, Allison, Maria, Sylvia). Infestation of swarming termites, but otherwise conditions seem fine for this size group. Still need a 2nd house.

## May 28 (Monday)

met with Governor (news from last year - don't know his name yet) and Mayor (Roman Mejía again), and migración officer. Got bank account re-opened, with Sylvia added to us 3 as signator.

PSB

PSB-7-7

5/31-6/2

Problems: overheats (Ed's hand got burned from steam & boiling water trying to add water to coolant container), brake low, back door spring (never would lock), tire rack keeps dropping (under car), and battery won't hold a charge for more than an hour.

After brief respite for Ed, he, Maria (who needs cholera booster), Mary/Bob (Peace Corps) and I left for San Pedro to get car fixed, pick up students & buy supplies. Car died in mid-quebrada (nearly dry) for no apparent reason, & heat on engine got high but not to danger point. Otherwise, besides the tire rack falling several times, trip was uneventful. Reached San Pedro about 6; stayed at Colombia.

### June 1 (Friday)

Took car to Blitz to be fixed. Changed Justine's & my departure from Teguc 7/9 to San Pedro 7/9, still Air Florida. Discovered AF now flies only Mon, Wed, Sat, Sun, so cabled Julie to ask if she wanted her reservation (Fri 7/13) changed to Wed or Sat. Spoke to a public information officer at Banco Atlantida (hangar out of town): he advised us to deal through Santa Barbara office to recover our L598 from Teguc. Arranged students' Copan trip. Maria couldn't get booster; returned SB on bus.

Students arrived (~~7~~): Brenda<sup>Rahm</sup>, Julie Miller, Earl Sussell, Jeff Hendricks, Alex Harris, Alex Pezzati, Colleen Murray. Some luggage didn't. All at Colombia.

### June 2 (Saturday)

Bought supplies and groceries. Students (all but Earl & Brenda) went to SB on 1 pm bus. Brenda's missing luggage won't arrive till Sunday, so still meet Gene (Olevsky), whose plane (per cable rec'd ~~5/31~~ 5/31) will arrive then too - they'll come on bus to SB ~~Monday~~.

PSS  
P84-7-9  
6/4-

84-7-B3/4 Str 12 & playa from ridge  
B5/6 Group III & Strs "16" & 24

Rainstorm ca 7 - power out. Brenda got lost trying to walk home alone from Alaska this 1<sup>st</sup> day here. Anxious moments, but she found Place Corps house by good chance, and Mary walked her home.

Rained long & hard - power resumed ca 10 pm though and water never went out. This time...

### June 5 (Tuesday)

Arrived Gualjocuto ca 7<sup>45</sup> a.m. - divided the 17 workmen between Pat & me; she went up to small-sites area and Ed walked off to begin survey north of Gualjocuto site. He & I first spoke with Gustavo Miranda, jefe de construcción on this section of the road. He seemed to have no problem (i.e., said there would be none) with our excavating in the 10G area; he'll ask the machine-crew chief to stop & talk with us. It'll be interesting (if sad) to watch the roadwork while we're here.

85° at 9<sup>20</sup> - clear & muggy

Justine will be in charge of cultural fan excavations (under my supervision), I will do 10G ~~and~~ (Op 6) and she'll work with me on Group I (Op 3C).

Got her started on Ops 12A and 12B. Former is a 1x2 m pit perpendicular to and 1 m west of fence at base of ridge east of site. Op 12B is a 1x2 m pit ca 10 m west of that, and about 1/2 way to Str. 12. Took photos

84-7-B7/8 Ops 12A & 12B from SE at onset  
(Justine & Emilio are in the picture)

Emilio is making <sup>4</sup>/<sub>2</sub>-meter sticks for us.

12A: Jaime & Reyno

12B: Eliberto & Juan Miguel

Took photos 84-7-B 9/10 Op 3C from Str 3 at onset (reopening 3A)

11/12 Op 12 area from Str 3 at onset, to show fan slope



PSB  
P84-7-11  
6/5-6

In Str 1: sketch perspective from NE

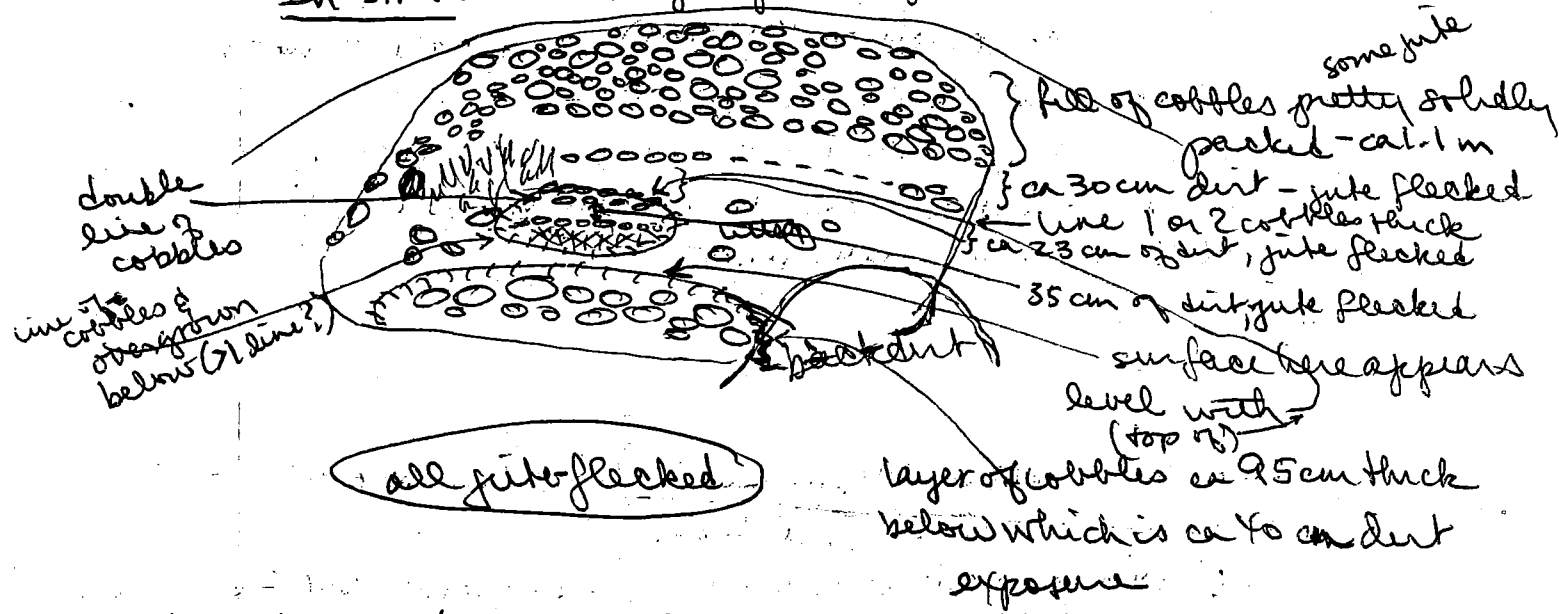

- 3C/2 lot 3C/2 is materials in cobble fill in extension west of 3A - for 1<sup>st</sup> 4.6 m west, ~~nothing so far~~ now a dozen or so jutes & 3-4 sherds
- 3C/3 lot 3C/3 is materials from backdirt of illicit excavation into str 1 - backdirt & cobbles being cleared are those just NE of the big gaping hole

June 6 (Wednesday)

Arrived at Gualjoquito at 7<sup>30</sup> - already 85° (tends to 80° in the house at night) and ~~to~~ slight dewy haze burning off. No rain here or in SB last night, save a light sprinkle

Justine back on 12A/12B  
Parents will begin flotation today  
given 1 lot from 3C (lot 3C/2) and 1 from 12A & B  
(Justine to decide)

PSB  
PS4-7-13  
6/6

but angles in (constructs gradually) on "right"  
(positions with reference to sketch)

cut block in 3C/2 fill - just chucked in like the cobbles

26 cm deep

13 cm high

length of face ~~not yet~~ measurable 35 cm

took photos 8/7-C5/6 interior of stone "mortar" } scale 35 cm

7/8 top/mouth of stone "mortar" }

9/10 Op 3C - view of south retaining wall, <sup>from east</sup>

11/12 Op 3C block in fill, scale 35 cm

! ~~old~~ 99-100° at 155

3C/4 breaking lot 3C/2 laterally at 7.8 m west of SE corner  
of 3A excavation

to far - several sherds, including a well preserved  
Ultra Polychrome rim

if some of this fill-inclusion material has tumbled  
down from use contexts into the dry-laid fill,  
perhaps there will be some noticeable difference  
in contents as we near Str. 1. Certainly the materials  
from the cobble fill of 3C are more numerous  
than from 3A area's fill

marked lot limits on stones in south elevation  
reaching 10m trench length

unfortunately the retaining wall is becoming more  
nebulous - either it's receded southward into the section  
or it's stopped (the best candidate for a corner  
or edge is not yet totally convincing - it's at 9.6 m  
west, but if it's a corner it has some odd semi-interdigitation  
with other fill to west) - wall may yet continue

$$+ \text{EV} = \text{I.H.} + (\text{Sine } \theta \times \text{dist.} - \text{mid-HAIR})$$

$$- \text{EV} = \text{I.H.} - (\text{Sine } \theta \times \text{dist.} + \text{mid-HAIR})$$

PSB  
P847-15  
6/7

Transit points

| Station        | HI               | Elev  | Mid hair | Lower | Upper | Distance | $\Delta$ |
|----------------|------------------|-------|----------|-------|-------|----------|----------|
| <del>TX1</del> | <del>1.475</del> |       |          |       |       |          | 73°      |
| 1. BS to datum |                  | 0.855 | 0.791    | 0.920 | 12.9  |          |          |
| +1° 45'        |                  | 0.82  | 0.497    | 1.045 |       |          | 339° 54' |
| +1°            |                  | 1.100 | 0.790    | 1.412 |       |          | 327° 15' |
| —              |                  | 1.545 | 1.209    | 1.881 |       |          | 310° 9'  |
| +3°            |                  | 0.600 | 0.882    | 0.321 |       |          | 170° 57' |
| +1°            |                  | 0.150 | 0.090    | 0.260 |       |          | 92° 50'  |
| —              |                  | 0.561 | 0.454    | 0.670 |       |          | 19° 54'  |
| —              |                  | 1.831 | 1.717    | 1.947 |       |          | 240° 20' |
| 9. TX2         | 1.40 HI          |       |          |       |       |          |          |
| —              |                  | 1.505 | 1.415    | 1.597 |       |          | 128° 32' |
| +3° 30'        |                  | 0.200 | 0.139    | 0.261 | 12.71 |          | 174° 46' |
| —              |                  | 0.506 | 0.448    | 0.563 | 11.56 |          | 189° 55' |
| +4° 50'        |                  | 0.200 | 0.134    | 0.267 | 13.27 |          | 200° 48' |
| +5° 30'        |                  | 0.200 | 0.143    | 0.258 | 11.5  |          | 217° 24' |
| TX3            | HI 1.325         |       |          |       |       |          |          |
| —              |                  | 1.288 | 1.262    | 1.307 |       |          | 151° 25' |
| —              |                  | 2.719 | 2.692    | 2.748 |       |          | 116° 23' |
| —              |                  | 1.688 | 1.648    | 1.728 |       |          | 112° 53' |
| —              |                  | 3.562 | 3.458    | 3.568 |       |          | 102° 18' |
| —              |                  | 4.295 | 4.241    | 4.358 |       |          | 102° 55' |

2A

found metal fragment ~~in~~ on surface in opening between str 2 and 3, SE corner of Group I — will get next 2A set lot/cat #

2A/41-1

Distance =  $\cos \angle \times$  distance read  
 Elev: upslope:  $HI + (\sin \angle \times \text{dist} - \text{mid-hair})$   
 downslope:  $HI - (\sin \angle \times \text{dist} + \text{mid-hair})$

Calculating distances & elevations from points on P84-7-15:

|                                     | Datum = 160 m                         | Elev           | Distance               |
|-------------------------------------|---------------------------------------|----------------|------------------------|
| 1. BS to Datum                      |                                       | <u>160.855</u> |                        |
| 2. (ground at T1 therefore: 159.38) |                                       |                | 12.9 m                 |
| 3. Op 12A SE corner                 | 162.01                                |                | (64.8)                 |
|                                     |                                       |                | 64.77                  |
| 3. Op 12B SE corner                 | 160.84                                |                | (62.2)                 |
|                                     |                                       |                | 62.19                  |
| 4. Point west of 12B                | 159.31                                |                | (67.2)                 |
|                                     |                                       |                | 67.2                   |
| 5. To T2                            | 163.18 <sup>19</sup> <del>18686</del> |                | (56.1)                 |
|                                     |                                       |                | 56.02                  |
| <del>6. fence point #1</del>        | <del>160.224</del>                    |                | <del>22</del>          |
| 7. fence point #1                   | 160.294                               |                | 21.6                   |
| <u>6. fence point #1</u>            | 161.09                                |                | (22)                   |
|                                     |                                       |                | (21.996)               |
| 8. Point west of datum              | 159.024                               |                | 22.7                   |
| 9. T2: HI = 1.40                    |                                       | <u>164.59</u>  |                        |
| 10. SE corner Op 3A                 | 163.08                                |                | 18.2                   |
| 11. to top of water's spoil         | 165.13                                |                | (12.2)                 |
|                                     |                                       |                | <del>12.18</del> 12.18 |
| 12. saddle between T & Str. 1       | 164.084                               |                | 11.56                  |
| 13. Summit, Str. 1                  | 165.50                                |                | (13.3)                 |
| south of 3C alignment               |                                       |                | 13.25                  |
| 14. T3                              | 165.49                                |                | (11.5)                 |
| T3: HI = 1.325                      |                                       | <u>166.81</u>  | 11.44                  |
| 15. to #13                          | 165.52                                |                | 3.5                    |
| 16. to #12                          | 164.091                               |                | 5.6                    |
| 17. to #11                          | 165.122                               |                | 8.0                    |
| 18. to top of GRUB wall             | 163.298                               |                | <del>11.0</del> 11.0   |
| 19. point on <sup>south</sup> wall  | 162.515                               |                | 10.7                   |

Ground elev at Sta T2 = 163.10

(stone)  
ground elev at T3 =  
165.485

PSB

P84-7-19

6/9-10<sup>11</sup>

— though so will refer to them as south (north-facing) and east (west-facing) walls for now

MANGO is 3.35 m north of SOUTH at top of preserved height, both angle inward as they go down

3C/7 new lot to incorporate materials west of EAST wall and up to 1 m ~~west~~ south (measured at wall top) of MANGO wall — so far a metal fragment and shreds (1-2 gite)

Pat's workmen completed backfilling and arrived at Igualquits ca 10<sup>00</sup> — put to moving 3C stones & backdirt (of west end of trench) ~ 5m to north

3C/8 backdirt lot (from west end of trench — from ca. 1.5m ~~east~~ of GRUB & thence westward — mix of lots 3C/3, 5 and 6)

fill west of GRUB has been consistently better packed than that to east — consistent with establishment of pen bounded by well set units on four sides, which pen then filled more loosely with cobbles

paid Pat's workers

one (Baldino) has sick wife & will be absent Monday but will send his brother, Juan Pablo, in his place

June 10 (Monday)

85° at 8<sup>00</sup>; 90° at 8<sup>40</sup> — <sup>recast &</sup> muggy — rained yesterday here & SB

Went to Copan Saturday afternoon to see the ruins since latest exc & restoration — while there, saw a

took Jaime & Reyno to Str 1 while Justine & Brenda are drawing.

3D:

Began them clearing back (to north) the part of the Str. 1 looter pit that will link to 3C section - new Op # since cuts will be contiguous but not continuous

took photos 84-7-E 7/8 of beginning Op 3D, a 2.9m cut on north side of looter pit

3C/D

ADOBE: small chunks in 3D/1 (loose) and in 3C/9 - debris from Str. 1 superstructure - 1st? - 2nd?

1 piece from 3C/9 has a flat surface & on adjacent side, a single pole impression

(6cm long)



1.5cm diameter

~~3D/43~~

large footed-cylinder, sherd from surface <sup>(basal break w/ footscar)</sup> ~~west~~ of looter pit on summit of Str 1 - save for ceramic analysis use (large sherds are all too rare)

3C/9 - piece of polished blackware bowl with incised design



← needs from plane of view

SURPRISE! GRUB wall turns a rounded corner to run east as MANGO! in area of 3C/9 cut (1st - since 3C/9 is now continuing east to reach 3C/7), MANGO alignment is 3.5m north of SOUTH wall

PSB  
P84-7-23  
6/12

3C/9 picking up more adobe, another metal fragment  
& sherds

fence around SW & southern part of site (east of road)  
is being wired today (fenceposts went in 6/9 - see P18)  
- they've left no formal gate, as such, but last  
length of wire at east end of north side is not firmly  
attached & can be moved

12C

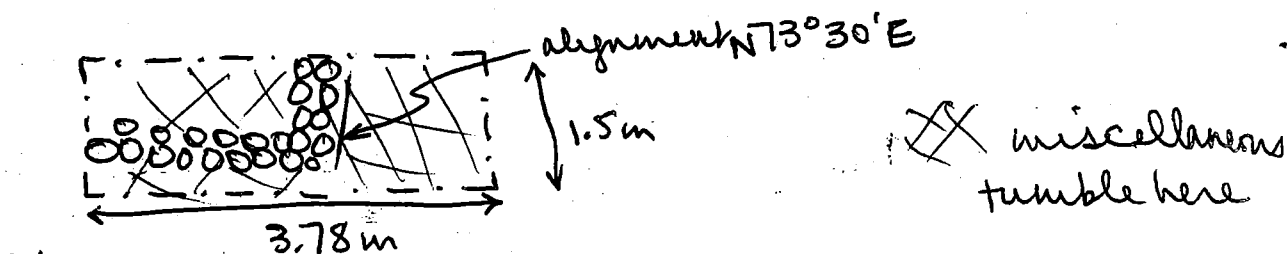

N  
←

took photos 84-7-E11/12 of 12C from SW, scale  $\frac{1}{50}$   
84-7-F1/2 of 12C, southern  
wall from west, scale  $\frac{1}{50}$

Justine is having them expand 3.06 m east for  
southernmost 1.98 m, to trace wall

12B reaching 2.8 m depth, which puts them at 158 m  
(approx) elevation & thus at or below Late Classic  
plate level west of Str. 12 - will halt this today &  
move ~~the~~ Juan & Eliberto elsewhere

3C/9 some particularly large fill stones (too heavy for 1 man  
to lift out (all are cobble/boulders))

38 x 24 x 25 cm

37 x 35 x 30 cm

53 x 22 x 40 cm

41 x 46 x 30 cm

24 x 28 x 36 cm

(brief heavy)

rain halted transit work<sup>(etc)</sup> at 10<sup>30</sup> but we began work again before 11<sup>00</sup>

12C Jaime & Reyno have cleared a lovely but inconclusive cobble array

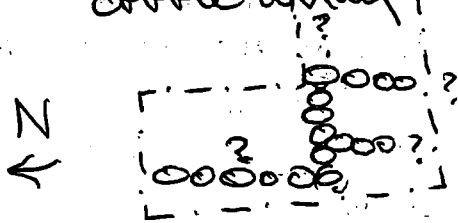

(tumble between putative lines - all within 20 cm of surface in

3C still ~~clearing~~ cutting down to SOFT floor in fill at all wall corners (EAST/SOUTH, MANGO/EAST, GRUB-MANGO)

3D Juan and Eliberto moved to here - taking down looter-pit southern exposure -

got a burned clay floor - MOP

Brenda & Justine worked on trowelling

3D/2 material within 10 cm of surface of MOP - most is really from within 5 cm - includes at least 1 plumbate sherd that was well enough back in the cut so as to be surely not recently intrusive (i.e., near <sup>original</sup> looter-pit exposure)

took photos 84-7-F3/4 of Brenda trowelling MOP

Rain began again ca 1<sup>30</sup> and didn't let up, so we all left ca 2 - DRAT!

(at least can catch up on paperwork at home)

June 14 (Thursday)

RAINED ALL NIGHT stopping only ca 6<sup>30</sup> a.m.

Excavations (mine & Pat's) postponed to drain & dry

& will do lab work at home

at Huallajuno, workers are to make a gate in fence



10<sup>10</sup>: cloudy but thus far no rain  
3D Justine trowelling MOP floor for photo

3C got carbon sample in 3C/9

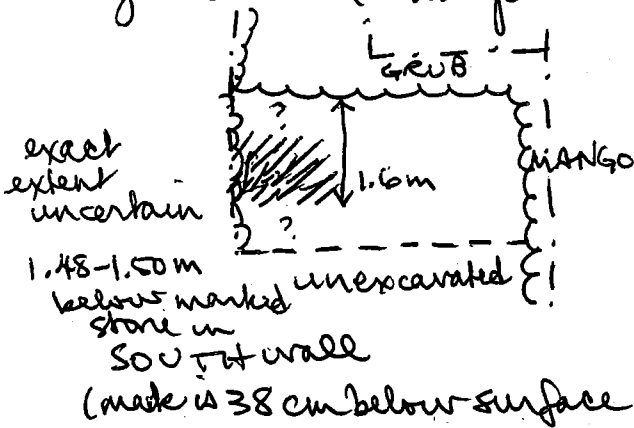

diffuse, flecks of varying size

N →

3C/7 yielded no sherds today yet but a well fired piece of either floor (most likely) or wall - in ALL, base - Justine's finding a couple of similar pieces in 3D trowelling/cleaning (not part of MOP though)

3C/10 removing lowest 20 cm, at base of 3C/7, overlying SOFT floor - none of the material seems to be sitting on the floor but the lot is <sup>more</sup> densely (relatively) packed with "stuff" - including <sup>an</sup> inverted fragment (now further broken) of a gray (burned) floor also - center frag

3C/9 the charcoal noted above seems to be a cap (not more than 2cm thick) distributed around and overlapping what appears to be some of the same material as in SOFT floor

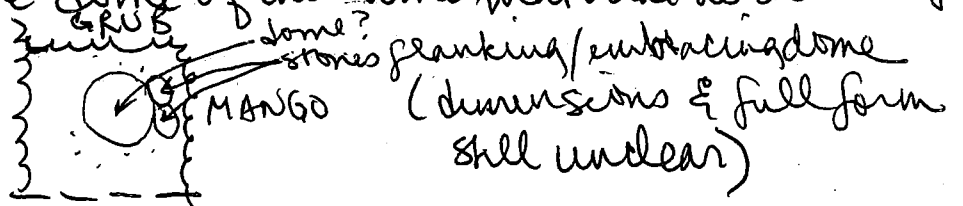

PSB  
P84-7-29  
6/15-16

took photos 04-7-97/8

CRUMB & SOFT floors with GRUB & MANGRO  
walls, from SE, scale 50cm

note discontinuity in distrib of CRUMB  
& large stones (somewhat too rectified by workmen - my  
fault)  
along wall edges, not completely cleaned (but  
given time - 3:55 - I took the photos) looks  
like SOUTH & possibly MANGRO walls do not  
sit directly on either CRUMB or SOFT

Poss interp of CRUMB; SOFT was broken through  
at some place beyond 3c exc limits & the  
dirt & CRUMB are redeposited from pit dug  
thru SOFT. If so - where's the pit &  
what's in it?

3C/11 took a flotation sample from the dirt in area of  
white CRUMB discontinuity (see sketch on P28)

June 16 (Saturday)

Rain at night, some collapse of loose rubble  
83° at 7:50 - cloudy but looks to clear

yesterday, Justine & I were here alone w/ workmen -  
today Julie M (for soil testing), Brenda (for  
flour & flotation), Sylvia, Allison & Alec  
have joined us

The latter three drew a 1:10 plan of extent &  
placement of resurfacing at east end of 3c  
Justine was shovel-clearing MOP floor to west,  
and uncovered a 2-cobble-high step up  
("bench") with its own earthen surface  
at top ← "NEAT"

PSB  
 P84-7-31  
 6/18

| Slope    | T/HI                            | Elev    | Mid              | Upper | Lower | Distance             | Δ                       |
|----------|---------------------------------|---------|------------------|-------|-------|----------------------|-------------------------|
|          | T3 HI: 1.365                    | 166.85  | 2.532            |       |       | 11.4m                |                         |
| ✓        | 1. SE CORNER WATERPIT           | 164.318 | <del>2.532</del> | 2.595 | 2.481 | <del>11.4m</del>     | 145° 50'                |
| ✓        | 2. NE " " "                     | 164.26  | 2.590            | 2.630 | 2.551 | 7.9 m                | 131°                    |
| ✓        | 3. <del>NEAT</del> BENCH (edge) | 164.358 | 2.492            | 2.528 | 2.468 | 6.0m                 | 180° <del>30'</del> 30' |
| ✓        | 4. GROUND FLOOR                 | 164.161 | 2.689            | 2.725 | 2.671 | 5.4m                 | 164° 5'                 |
| ✓        | 5. JUNCTION GRUB & SOUTH        | 163.233 | 3.617            | 3.552 | 3.661 | 10.9m                | 104° 30'                |
| ✓        | 6. 3C/1-1/2                     | 163.019 | 3.831            | 3.750 | 3.925 | 17.5 m               | 90° 35'                 |
| ✓        | 7. SE CORNER 3C                 | 163.075 | 3.775            | 3.883 | 3.880 | 21.3 m               | 96° 3'                  |
| ✓        | 8. JUNCTION S&E WALLS           | 162.868 | 3.982            | 4.091 | 3.879 | 21.2 m               | 95° 6'                  |
| ✓        | 9. JUNCTION MANGOGE WALLS       | 162.92  | 3.930            | 4.031 | 3.825 | 20.6 m               | 86° 30'                 |
| ✓        | 10. NE CORNER 3C                | 163.111 | 3.739            | 3.842 | 3.633 | 20.9 m               | 86° 11'                 |
| ✓        | 11. 3C1 - 3C2                   | 163.144 | 3.706            | 3.613 | 3.798 | 18.5 m               | 85° 46'                 |
| ↓ \$ .30 | 12. Junct. 3E1 - 3E1            | 162.245 | 4.45             | 4.54  | 4.362 | 17.799 m<br>(17.8 m) | 91° 15'                 |
| ✓        | 13. SE CORNER ST5               | 163.555 | 3.295            | 3.443 | 3.144 | 29.9 m               | 69° 19'                 |
| ✓        | 14. SW CORNER ST5               | 163.828 | 3.022            | 3.089 | 2.955 | 13.4 m               | 64°                     |
| ↓ 2° 30' | 15. NW CORNER ST5               | 161.491 | 4.400            | 4.515 | 4.293 | 22.0 m               | 14°                     |
| ✓        | 16. NE CORNER ST1               | 162.917 | 3.933            | 3.997 | 3.871 | 12.6 m               | 23° 40'                 |
| ✓        | 17. SW CORNER lot pit ST5       | 165.452 | 1.898            | 1.494 | 1.303 | 19.1 m               | 50° 37'                 |
| ✓        | 18. N side lot pit ST5          | 165.528 | 1.322            | 1.419 | 1.235 | 18.4 m               | 45° 25'                 |
| ✓        | 19. N side lot pit ST5          | 165.844 | 1.006            | 1.120 | 0.893 | 22.7 m               | 40°                     |
| ✓        | 20. N side lot pit ST5          | 165.989 | 0.861            | 0.990 | 0.733 | 25.7 m               | 43° 35'                 |
| ✓        | 21. NE corner lot pit ST5       | 165.364 | 1.486            | 1.639 | 1.332 | 30.7 m               | 48° 30'                 |
| ✓        | 22. E side lot pit ST5          | 165.368 | 1.482            | 1.638 | 1.332 | 30.6 m               | 52° 10'                 |
| ✓        | 23. SE corner lot pit ST5       | 165.54  | 1.310            | 1.454 | 1.164 | 29.0 m               | 56°                     |
| ✓        | 24. South side lot pit ST5      | 166.28  | 0.570            | 0.705 | 0.44  | 26.5 m               | 56° 17'                 |
|          | 25 " " " "                      | 165.856 | 0.994            | 0.870 | 1.021 | 15.1 m               | 59°                     |
|          | 26 " " " "                      | 165.398 | 1.452            | 1.572 | 1.338 | 23.4 m               | 54°                     |

Check  
 1/2" step  
 down

P8B  
P84-7-33  
6/19

June 19 (Tuesday)

no rain here or SB at night - cloudy/sun alternating

Morning began slowly - 12C new Northward extension

6A - Alex at 30cm

3C - cutting west past GLOB

3D - heath?? - Brenda cleaning -  
at lower floor level in Str. 11

**4C** bulldozers cutting Str 24 - we went to document - someone began finding pieces of

photos 84-7-15/12

an ostra protruding at ca. mid play in area dozer scraped on west side of road

4C/3 flotation sample from inside

4C/2 shreds etc from outside

4C/4 shreds etc from Str 24 - includes C14 sample from amid rocks (fill) at/below bulldozer scrape level

4C/5 " " " " 23

draw D84-7-3 1:10 plan of vessel mouth

took photos 84-7-J1/2 of mouth of jar in place scale 10cm

then found 2 spondylus shells ca 10cm from preserved top

cleared, added to drawing &

took photos 84-7-J3/4 of spondylus

Scale 35cm

2 more spondylus <sup>← cloud set</sup> just at surface - ca 65cm west on Brunton alignment S71° W

(same alignment; 15.86m to fence (post marked)

by Str. 15 - for later transit plotting)

Special Deposit 5

3D/3 <sup>empty</sup> took photos 84-7-J5/6 of heath(?) (35cm) - "CLEAN" heath

shreds from travelling here

is material in fill in the

86-90cm <sup>between CLEAN & MOP</sup>

(2.0m EW x 80cm N/S)

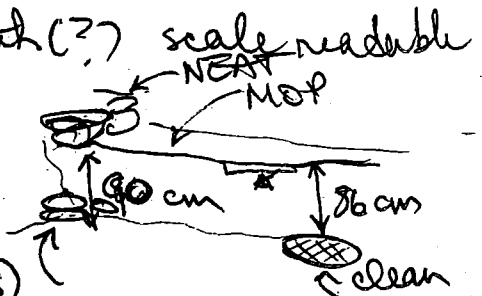

P8B  
P8C-7-35  
6/19

but then a reporter arrived from El Tiempo, a paper in San Pedro. Per our contract (which I read to him) I could give him no information, but Emilio gave them <sup>(him & photo)</sup> an interview & a brief site tour

June 20 (Wednesday)  
8<sup>40</sup> at 8<sup>25</sup>

Heavy storm with gusty high winds (piece of our patio roof blew down) in SB and heavy rain here as well.

Abgdo Navas is going to Arenales to see if he can get local teachers to postpone the hour of classes enough to solve the dilemma (which arose Monday) of our workmen having to leave at 3 to make it to class on time. (they are fined if they don't attend)

6A down ca 60cm - very muddy, but little standing water matrix yesterday began getting sandier  
12C lots of standing water in ~~SE~~ SW corner

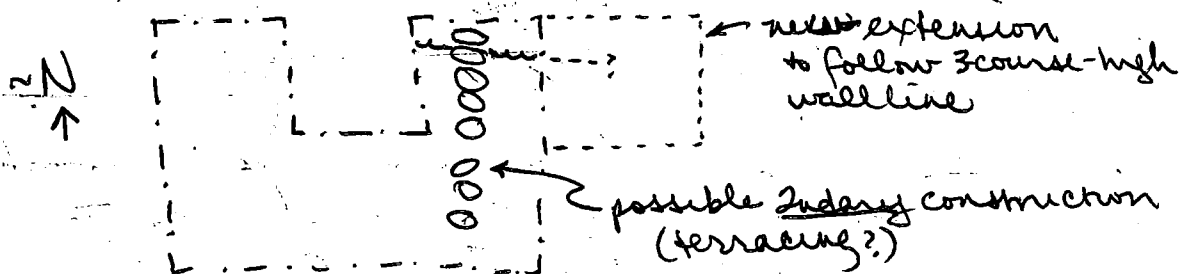

3D suspended

(west of)

3C some collapse - still taking down at E behind GRUB wall

4C Brenda flushing vessel interior sample (4C/3)  
lots of tiny bones (burrowers?)

3C <sup>from yesterday, before all pulled to 4C)</sup> They say the floor ends west of GRUB wall, but till the collapse is cleared, don't know if cut or peters out

west of the SE corner of the fill retaining  
per. (rough measurement) the soft white floor  
continues further to the west, perhaps another  
0.50m - under per surface. As for the putative  
east floor edge - only exposed adjacent to the  
S. retaining wall.

Workers cleared back apparent buried  
area late this afternoon. Really dispersed,  
scattered burning - nothing extensive like  
antennae tubes like a beehive but scattered  
over a rather broad area. Currently measured  
1.40m N-S x 3.20m E-W over the  
exposed portion - probably continues further  
N. under rock fill + further to the  
W. under the unexcavated portion of the  
trench to the S. Workers have apparently  
pried some away to the surface in  
currently uneven - should work at  
trenching all of this rock to get up true  
level - base of S. retaining wall - base of  
excavation, some quite large. Does not  
look like fill - cache?

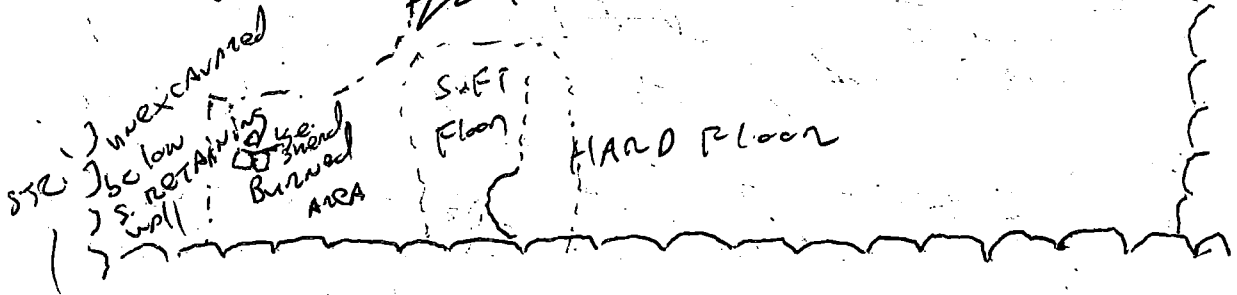

3C/17 Large shard - 3 pieces actually - 0.54 m  
N. of S. retaining wall, 1.00m west  
of hard floor edge + ca. 0.5-2 mm below wall  
base. Embedded in burned area.

P 84 - 7-39

6/25

how do you

Yes, I'm starting a new page, think I get so many into pages.

3C - Juan + fore Estero are following the basal wall of the 1 for ca. 0.75 m northward to try + reveal more of its extent, ensure the area available for plan, and try to ensure that something of it survives in sector - assuming they don't rip it out first. Continuation of Defied on lot 3C/14.

3C/18

3C/18 - material found in clearing off the basal wall of the 1 to the north, on area of 1.00 m N-S. x 1.00 m E-W. x 1.40 m deep to apparent base of wall and 0.90 m below fill.

Juan + Estero are cleaning loose earth + water out of the pit in the west end in preparation for taking out the last segment of earth here down to the level of the hard white plaster floor. Continuation of lot 3C/14. After this, should clear off area of presumed burning to judge its extent, if there is time. All preparatory to cutting down.

Rainfall quite a bit out here yesterday - quite muddy + the area is very up over Saturday afternoon.

12C - Juan + Renee still searching for the SE corner of the 34. "Four short" clearing back to the north by the presumed SW corner to determine if there is one + where it is - how does ever resolve. Continuation of lots 12C/11 on the west + 12C/13 on the east.

6A - still going down in 2 E + W. 1 x 2 m units under Alex's supervision. Ca. 1.50 m deep now.

PSS  
P84-7-41  
6/25

and the trench walls were hard-labeled + very difficult to travel. Skin stuff done pretty hard. As a result, I traveled down there where that were still pretty soft - the N5, S5, + SW corner + used them as guides for ~~recognizing~~ recognizing the stratigraphy here, which was then traced over the remainder of the sector. S4e south wall very, in general, better + clearer than the east. East + south walls drawn to conform to picture in drawing of Op. 12A.

12C - S4e S5 corner looks pretty clear now after additional clearing. Payne + Pioneer are just about picked clearing down S. of the east str. wall to see if the apparent stone "pavement" found beneath the str. is apparent S5 cover continues here. At present it looks as though this "surface" runs west + steps over with the part of the S. str. wall. S4e search for the SW corner continues - seems to have picked up a rather pavement of cobbles in the SW corner area. Only 1 worker working here today, so things are moving a bit slowly.

6A Alex has a good portion of a jar cover set at ca. 1.50 or right on the west trench wall - seems to have had gutter + lower part. Clearing out the level for a photograph.



P84-7-43

6/25

crab, claw fragments, shell, stems, charcoal flecks,  
put, look into the "middle" soil as I remember it.  
a trash pit from the Prethletic level? Someone's grave  
good with the body to the west? have been seen stick  
to at least 1 large "shard".

84-7-K-1 - GA, BASAL PIT, looking west.

84-7-K-2 - SAME

84-7-K-3 - SAME

84-7-K-4 - SAME.

84-7-K-5 - EAST extension, S. wall, STR. 34, op. 12c,  
looking NORTH, showing relationship of wall to presumed  
lower pavement.

84-7-K-6 - SAME

84-7-K-7 - EAST extension, S. wall, STR. 34, op. 12c,  
looking EAST along wall to show relationship of upper wall  
to "pavement."

84-7-K-8 - SAME

84-7-K-9 - Op. 12c, STR. 34, Line of tilted stones  
running N.-S. from EAST.

84-7-K-10 - SAME

84-7-K-11 - Junction of Line of tilted stones +  
EAST wall of extension of S. wall of STR. 34, op. 12c,  
from SE.

84-7-K-12 - SAME.

In all of the above the meter stick / scale  
was at 0.5m and the chalkboard was merely  
copied.

84-7-L-1 - SE corner of S. wall, STR. 34, op. 12c,  
from EAST. Meter stick at 0.5m, NO CHALK BOARD.

84-7-L-2 - SAME.

sort of like rhyolite (per 9 m. 1931? track of building material? - just a week job?)

also took a picture of the line of tilted stones which run N.-S. from the S. wall of the 34 - there, I suppose, can now be partially removed to search for the beautiful wall which lies within.

12c/3 - addition to the east extension lot - mostly (especially, let's be honest) "adobe" fragments.

12c/4 - East extension, <sup>then</sup> below the line of the S. the 34 wall to the cobble pavement, 0.29 m from line of wall to line of separation, from SE corner to line of tilted stones.

89-7-L-3 - putative earlier construction, op. 3c showing full below level, final the 1 wall shown behind, from east. Meter at 0.50m, no chalk board.

89-7-L-4 - same.

89-7-L-5 - putative earlier construction, op. 3c, showing line of S. retaining wall rising over the earlier str.'s summit, from the N, meter at 0.50m, no chalk board.

89-7-L-6 - same.

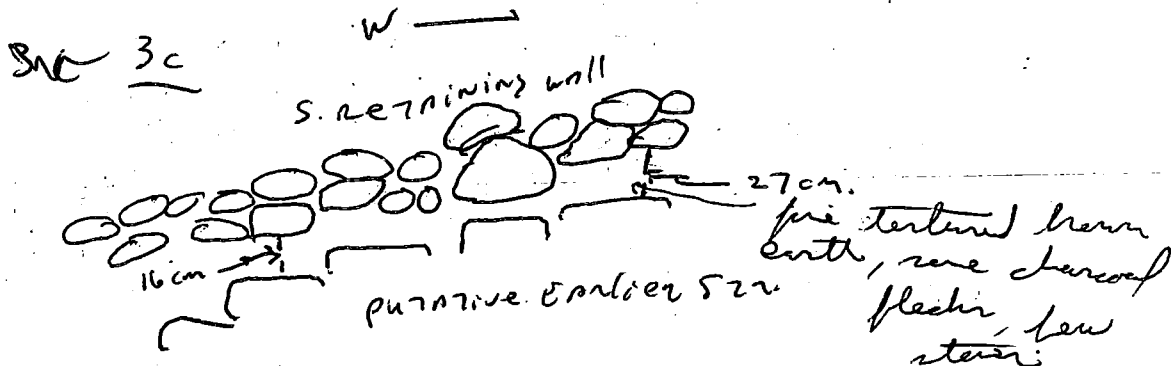

3C Medardo & Juan now clearing off CRUMB from SOFT

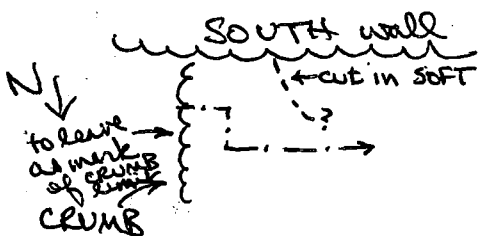

to trace cut in SOFT  
then will dig into it

3D Jose Esteban & Eliberto cutting ~~at~~ east in disturbed part of Str 1, to cut (then) down to HANGING wall & eventually TRUE STR - to establish indirect link with 3C stratigraphy

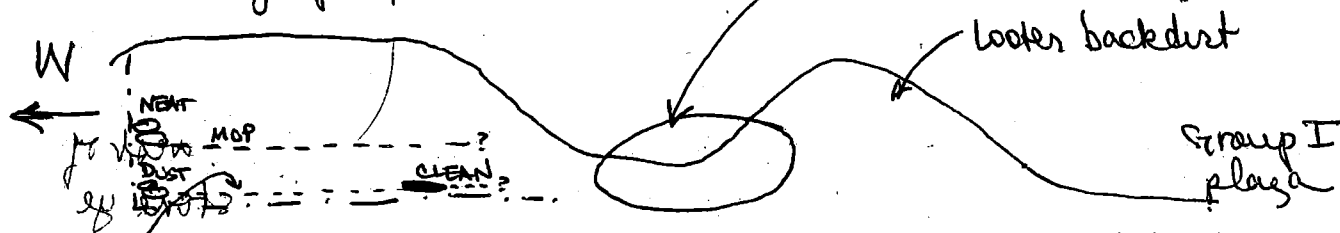

this floor marked only by presence of DUST via, CLEAN "hearth" & ballast stones

12C Justine still following <sup>west wall ← Saul & Grain</sup> at before, but Jaime & Reinos are ~~excavating~~ removing tilted stones at top, to <sup>define</sup> wall line below if there

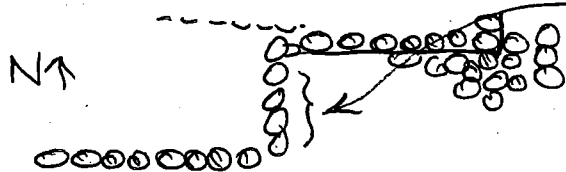

6A Alex's men finishing up the pit to draw & photograph

3C Medardo & Juan still removing cap - first "end" <sup>in SOFT</sup> seen (see top of page) was a "false alarm" - SOFT seems to continue <sup>again</sup> & then stop within 30 cm of base of GRUB wall

3C/20 materials from between CRUMB and SOFT - buried rim shield + <sup>well</sup> used frag of wide obs blade + 2 pieces of earth with bright red paint adherant

PS4-7-49

6/27

June ~~28~~<sup>27</sup> (an ednesday)

# 3C. Back on the pits again. 3C/22 - material from within the "cut" area to the east of the earlier construction, beginning ca. 0.25 - 0.30 m below the base of the S. retaining wall + ca. 0.80 m west of the west cut edge of the hard white floor.

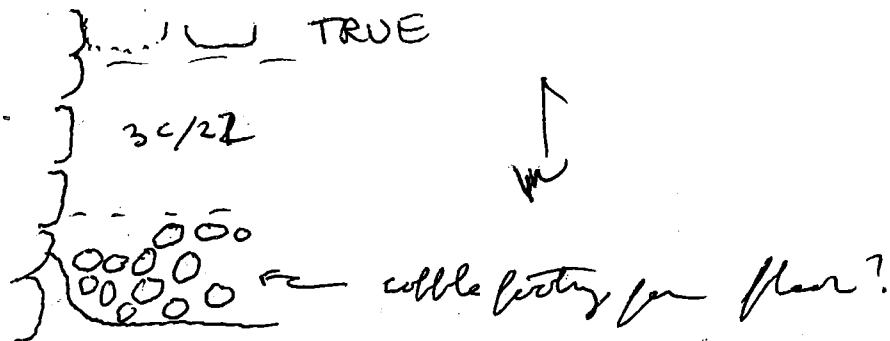

TB - 1x2 m pit (1 m N.-S. x 2 m E.-W.) located west of the fence line narrowly; the site + off the SW corner of the 11. Designed to locate construction here - final phase of the 11 - associated terminal debris material and the level of the plaza associated with this final construction / occupation phase.

TB/11 - ~~ca. 0.20~~ 0 - 0.20 m below the NE corner ground surface. S. later down to flatten out the trench + remove material piled here by bulldozer activity, which has been extensive. Subsequent level = 0.10 m.

TB - located 1.50 m west of the fence.

also designed to ~~be~~ expose material now to be inaccessible due to road construction.

3C - 3C/22 - Extended down 0.30 - 0.40 m below the base of the S. retaining wall. ca. 0.10 m deep overall. Uncovered quite a few shards, + some bone. The earth here is mottled with charcoal

7B - She 1x2m pit off the SW corner of the 11  
 has begun to hit a level of fairly large, closely  
 packed stones at ca. 30-40cm below ground  
 surface, NW corner. So far the artifact yield  
 here has been meagre. After these 2 workers  
 have finished in (6A) they'll probably extend the  
 pit somewhat (ca. 1.0m) to the west to try and  
 get beyond this stone level and then come  
 in towards the st. I think that most of this  
 material may be tumble but it's currently  
 hard to tell and I want to come back and  
 away from the st. before coming down  
 on any of wall. Alex has been watching this pit  
 today, with Brenda's help. Otherwise Brenda  
 has been running soil samples.

6A - Azwiri. 6A/33 - Shovel pit within the  
 pit onto the level rock level, from 1.71m below  
 ground surface, NW corner to base of pit. Shovel,  
 level, pit, shovel sample. will try + set a rock  
 sample after lunch.

Note that the prehistoric "mudstone" level in  
 6A seems rather narrow (level C ca. 0.20-0.30m  
 thick except in the area of the pit). She's gone along  
 with Alex's observation on the structure per  
 excavations. I see one 2 fragments, in the east  
 wall the bottom of this level appears to chip  
 down down considerably, while in the west wall  
 the pit extends a fairly good depth.

Note also that the pit walls in 6A  
 were already fairly ch. when I checked them. While  
 I did find a bit of the wall, it was still  
 hard to discern subtle soil differences, especially the  
 precise limits of the "mudstone" level. She latter

P84-7-53 6/27

30/8 - 3 rem mixed fill + Marie L in bucket  
in east extension of 3D to better reveal apparent  
east wall related to the 1. large stones, set in  
as a N.-S. running line noted right up against the  
east trench line this morning. Had fore fore  
Esteron + fanks (Esteron is off here cutting  
Pincito trees, no replacements) cut back the  
trench to the east ca. 0.75 m to better expose  
this line. Ca. 0.40 m below the base of  
HANGING wall here (basal the 1 wall), the stones are  
ca. 0.30 m in diameter and their front face is  
ca. 1.10 m east of the front face of HANGING. Covered  
by loose fill stones + backed by what seems to be  
a flat-land cobble pavement, stones ca. 0.18 m in  
diameter. Starting this all cleared off + going down  
east of the possible wall to see if it continues +  
later on more reality. I was wrong yesterday -  
W.A. has HANGING in 3D here, but what is  
this other line?

30/8 - 3 rem again - 3 rem mixed fill + bucket  
for looking in east extension of 3D to reveal possible  
lower wall, ca. 0.75 m S.-W. x 2.10 m N.-S. x 1.40 m  
deep (approximate)

30/9 - 3 rem immediately atop the putative line +  
cobble surface, my contain some adrienne for analyzing  
fill.

6A - Alex + his 2 friends are down roughly  
0.30 m lower in the pit into the basal rock  
level. She thinks that they may have finally  
reached the bottom of it. She has the notes on  
this excavation though 6A/132 is now down ca. 0.20 m  
below surrounding base of excavation within the  
confines of the pit while 6A/137 consists of material

PS4-7-55 6/27

30 - an ell, what do you know, they have found a wall line running  $\pm$  E.-W. with a clear cobble stone pavement behind it to the west.

84-7-N-5A - 3le revealed lower cobble line + pavement from above, meter stick at 0.50m, no chalk board.

N.A. 35mm - <sup>short</sup> ~~meter~~ #3le, the revealed lower line + "pavement" in relation to HANGING wall per the east, meter at 0.50m, no chalk board.

3le line is very clear but will be obscured tomorrow as we have to take someone to the hospital.

84-7-N-7/8 - junction of FRED and GREAT walls, per, 30, looking obliquely to NW. meter stick at 0.50m.

84-7-N-9/10 - same as area, close up of wall junction, meter stick at 0.50m, no chalk board.

84-7-N-11/12 - op. 30, 3le entire <sup>FALL</sup> wall (~~stone~~) and western pavement looking at (~~FIRSTING~~), showing the relationship to HANGING wall, per the east + above.

staff photo - 84-7-01/2

PSB

P84-7-57

6/28

30 - Site fill above + east of [Fall 2] fairly  
clean stone, some cut blocks. Toned in with  
the cobbles, with a dark black to dark brown  
earth matrix. Rather loose, I fear the effects  
of the rain.

30 - Soil sample taken from 30/25.

12C - when first cut into the 34  
section, she hit, in the far north end of her  
trench, a wall running E.-W. The wall was  
of cobbles, ca. 2 cobbles high, and seems to have  
been fairly substantial - at least it was cleaner  
than most. Currently Jones + Payne are clearing  
this off for photos. Later will cut over and  
across the str. at the level of the upper stone  
to see if we can pick up the north wall for  
the width. Note that this newly uncovered  
wall does not seem to clearly line up with  
any of the other revealed walls, not even the E.-W.  
running str. wall chased out to the east + where  
SE corner we have.

6A - still going down in the apparent late  
Preclassic trench pit, now just coming out. Alex  
supervising, who knows where the bottom of this  
monter is?

30 - 30/25 level: getting rather sandy,  
still brown but much softer + less clay. Like  
the upper levels. Contains a few shells,  
jutes, and chert.



PBB

PS4-7-59  
6/28

3C/26 - 0.20 - 0.70 m below the base of  
PLUM down in the "cut" area between True str.  
+ etc cut in the hard plastic floor.

They do increase in artifact yield in 3C/26  
over 3C/25, we'll have to wait + see.

6A - Finished (I hope) here today. I by accident  
the bottom of the pit at about 2.31 m below ground  
surface about the middle of the west wall at the  
pit's deepest point. I by pit itself, assuming that it  
extended up to the  $\pm$  base of Level C (the middle) is ca.  
1.40 m deep at its deepest point. It has a rather  
irregular shape, cut back and down steeply down on the  
south while on the north it runs into a large stone  
and then slopes more gradually down from there.

E.-W. the pit slopes down rather steeply on the east  
while the western portion remains within the section of  
the west wall. I was surprised to see how many  
stones were embedded in the pit fill, some quite  
large cobbles, ca. 0.30 m in diameter. The large stone  
on the north which marks the north exposed pit  
line seems to rise up out of the basal colluvial  
layer of which it seems to be a part. Several  
other similarly large stones were noted in the  
base of excavation within the colluvial level  
in 6A.

Drew the N.-S. running section to the base of the  
pit in the west wall (with slope drawing, I was  
measuring), an east-west section across the  
appropriate center of the pit incorporating 2 of the stones  
shown in the N.-S. section (I + II on that section),  
and a 1:10 plan of the pit outline as it appeared  
fully exposed at the ~~1.72~~ 1.72 m depth.

12c - further than hit another wall close to <sup>6/28</sup> surprise and to the north. If it's not just the back (north) side of surprise, it creates a very narrow summit, possibly a bench or some other summit feature together with surprise? They both seem to be about ± the same elevation on their summit. Also - to the immediate north of this wall, at and below the base the workers have started to dig down to into a reddish-brown soil level. They're starting to turn up lots of "barro quemado" (by bayuregia, scale, whatever) and some larger stuff. General debris for the str. 12 summit (probably)? ~~we~~ we agreed to have Jim + Dennis continue cutting north within the confines of the 1.5 x 30 (E-W. x N-S. respectively) trench which contains the "equal" base of Op. 12c to the north. well carry it down to a point above their apparent soil change (staying within the previous brown soil which overlie construction). This level is ± to the base of construction noted on the newly-revealed wall. Neasey - I really can't say where we are in the str. at this point + don't want to go down any further until we find or don't find more construction.

Feopine

3c/3d show about this idea - Fall wall + pavement did one continue into 3c but stay, and whatever else was associated with them, were removed to build the fill retaining per + Hanson's wall? maybe

30 - 30 continues eastward + down. They're pretty much through the ledge + backfill and into what I think is fill. we've removed Fall, but hope they don't rip it out.

PSB  
P 89-7-63  
6/28

plaster floor, east of the cut in its surface. Looking at the east section of an cut we can see the plaster appearing below the level of the stones but well above PLUM. This lower level of plastering; apparently, part of the plastering of the hard floor ~~was~~, does not seem to continue west of ~~was~~ into an cut.

30/12 - east of FALL wall, Sop of Fall to base of excavation over entire trench in fill, earth + stone.

30/27 - fewer stones - may well have hit the cellular level at 0.55m below base of PLUM.

7B - Continuing westward uncovering more large cobbles + chunks, still apparently part of a surface, possibly a terrace forming the floor the west. Stones appear at all levels, close to the surface down to 0.50m below ground surface. The lower stones seem to be more flat-laid than the upper ones, more clearly a surface. Also - as we move westward the surface seems clearer. Possibly a lot of stone tumble step a terrace surface?

31 - Clearing down to the east of Fall, leave earth + stone fill including cobbles + some cut blocks. We have a fairly good extent of Fall cleared now, N-S. and it seem to have more depth to it - i.e. more than 1 cobbles. we may also have the north extremity of a possible step in the S. end of the trench - a large stone protruding out from under the top stone of Fall base. The stones appear to be in situ, not pushed out, so it's hard to say how this stone evolved.

PSB  
P.84-7-65  
6/28

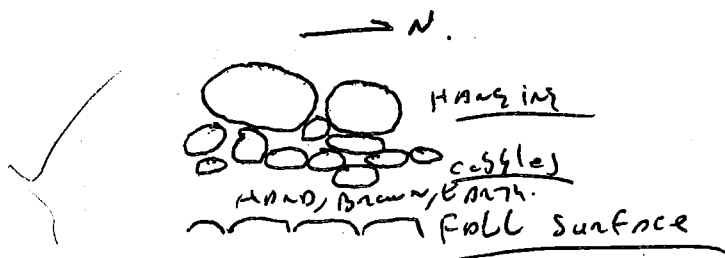

84-7-0-9/10 <sup>OP</sup> = 3D, Fall wall from due + E; note  
at 0.50m, no chalk board, not as clear as we  
would like.

June 29 (Friday)

Back at last! Rained here & SB at night - 1<sup>st</sup> time  
since ca 6/24 (Sunday), & cooled the climate immensely  
75° at 8<sup>55</sup> - Ed gave me the rounds on the excavations  
here before proceeding to Ale's excavations & Julie M's

12C cutting north of DKNO wall to see if there's more to the  
north side of the platform - at this point it seems a  
cobble formalizing on the south side with probably either  
substructure continuation to the north

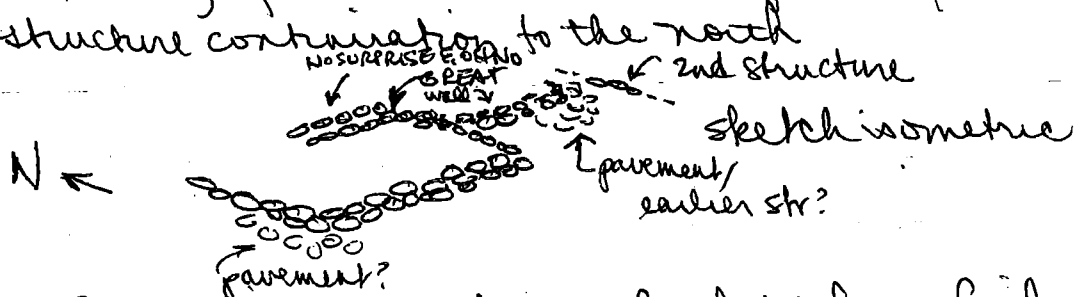

Jaime & Reyno will then clean up for photos here - final cut  
may be to follow NE corner → N to seek end/resolution there -  
since stone construction had been narrow elsewhere, should  
peter out soon

7B edge of platform off Str II - will clean better for photo & carry  
eye east to fence line & that's probably all

PSB  
P84-7-67  
6/29

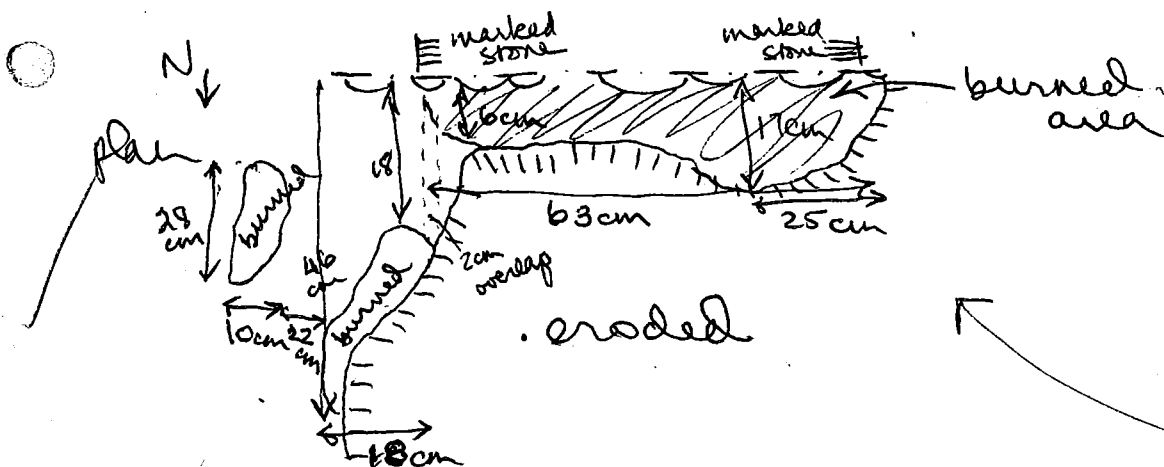

took photos 84-7-Ø11/12 SOFT at cut, w/ PLUM in background, scale 50cm - to show burned areas at erosion edge before cutting thru  
was cutting thru to reach PLUM level in 3C with SOFT in cross section - to show levels of possible but not actual articulation of features

climbed ridge east of site - took photos  
84-7-P1/2 Ops 12A, 12B, 12C  
3/4 Ops 3C, 3D  
5/6 Strs 24 E 16 remnants  
7/8 Ops 6A, 7B

85° at 150' - cloudy  
TB took photos 84-7-P9/10 Op TB from west showing double (?) terrace levels, scale 50cm containing exposure of NIM Terrace E toward Str 11

12c took photos  
84-7-P11/12 SLEAZE wall from SW, scale 50cm  
Q1/2 PREMIERE wall from WSW, scale 50cm  
Q3/4 OH No wall from NW, scale 50cm  
Q5/6 GREAT wall E SE corner, from E, scale 50cm  
Q7/8 GREAT wall from SW showing 2 constrn levels, scale 50cm

June 30, 1984 (Saturday)  
86° at 8:00 - payday of last full week of excavation

| scope & | T  | Elev           | Mid Hair | Upper | Lower | Distance | ∠       |
|---------|--|----------------|----------|-------|-------|----------|---------|
|         | T1 - Str. II summit                                  |                |          |       |       |          |         |
|         | HI: 1.465  | 161.795        |          |       |       |          |         |
| 1.      | <del>DATA</del>                                      | <u>163.260</u> | 3.260    | 3.740 | 2.790 | 9.5m     | 99° 20' |
| 2.      | FAR NE CORNER TRANCH                                 | 160.56         | 2.76     | 3.090 | 2.315 | 7.75     | 79° 51' |
| 3.      | FAR NW CORNER TRANCH                                 | 160.47         | 2.790    | 3.170 | 2.410 | 7.6      | 79° 15' |
| 4.      | South East Corner "                                  | 160.46         | 2.800    | 3.185 | 2.410 | 7.75     | 80° 20' |
| 5.      | NE CORNER 3 COBBLE                                   | 160.495        | 2.765    | 3.165 | 2.375 | 7.9      | 80° 45' |
| 6.      | SE CORNER OVERALL                                    | 160.425        | 2.835    | 3.235 | 2.440 | 79.5     | 81° 40' |
| 7.      | South junction 3 COBBLE                              | 159.85         | 3.405    | 3.800 | 3.010 | 7.9      | 81° 45' |
| 8.      | North junction "                                     | 159.81         | 3.450    | 3.845 | 3.060 | 78.5     | 80° 50' |
| 9.      | CORNER GREAT S TRANCH                                | 160.335        | 2.925    | 2.550 | 3.310 | 7.6      | 81° 10' |
| 10.     | SE CORNER OF STRUCTURE                               | 159.98         | 3.280    | 3.665 | 2.900 | 76.5     | 81° 15' |
| 11.     | Ancient Ground level 3 COBBLE                        | 159.61         | 3.660    | 4.040 | 3.260 | 7.8      | 81° 30' |
| 12.     | BASE OF EXCAVATIONS SOUTH OF GREAT WALL              | 159.435        | 3.825    | 4.200 | 3.460 | 7.4      | 81° 50' |
| 13.     | BASE EXCAVATION                                      | 159.35         | 3.910    | 4.270 | 3.550 | 7.2      | 82°     |
| 14.     | West end GREAT WALL                                  | 160.11         | 3.150    | 3.510 | 2.795 | 71.5     | 81° 25' |
| 15.     | North alignment EAST END GREAT WALL                  | 160.045        | 3.215    | 2.860 | 3.575 | 71.5     | 81° 15' |
| 16.     | Great Wall intersection                              | 160.045        | 3.215    | 3.565 | 2.865 | 7.0      | 81° 20' |
| 17.     | Alignment point FOR NO SURPRISE WALL ON SECTION WALL | 160.09         | 3.170    | 3.520 | 2.825 | 6.6      | 80° 45' |
| 18.     | NE CORNER OF NO SURPRISE EXCAVATION                  | 160.12         | 3.140    | 3.485 | 2.795 | 6.9      | 80° 15' |
| 19.     | EAST EDGE OH NO WALL                                 | 159.825        | 3.435    | 3.880 | 3.090 | 7.9      | 80° 5'  |
| 20.     | BASE OF EXCAVATION JUST NORTH OF OH NO               | 159.605        | 3.655    | 4.000 | 3.310 | 6.9      | 79° 50' |
| 21.     | NE CORNER OF OH NO EXCAVATION                        | 160.35         | 2.910    | 3.260 | 2.570 | 6.9      | 76° 15' |
| 22.     | BASE OF EXCAVATION NE CORNER OH NO                   | 159.985        | 3.275    | 2.935 | 3.620 | 68.5     | 76° 15' |
| 23.     | NORTH WEST CORNER OF OH NO EXCAVATION                | 160.28         | 2.980    | 3.315 | 2.645 | 6.7      | 76° 15' |
| 24.     | BASE OF EXCA. NW CORNER                              | 159.945        | 3.315    | 2.980 | 3.660 | 6.7      | 76° 15' |
| 25.     | West side OH NO WALL AT SECTION                      | 159.74         | 3.520    | 3.865 | 3.185 | 6.8      | 79° 45' |
| 26.     | North West corner of Ex. NO SURPRISE                 | 160.05         | 3.210    | 2.875 | 3.550 | 67.5     | 80° 20' |
| 27.     | West end NO SURPRISE WALL                            | 159.775        | 3.485    | 3.825 | 3.145 | 6.8      | 80° 40' |
| 28.     | SIN CORNER OF EXCAVATION CUT                         | 159.865        | 3.395    | 3.435 | 3.050 | 6.5      | 83° 10' |
| 29.     | EAST SIDE PREMIER WALL                               |                |          |       |       |          |         |

163.260  
- 3.140  
-----  
160.120

163.260  
- 2.910  
-----  
160.350

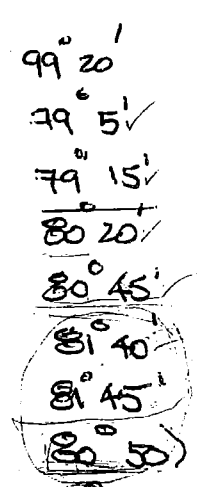

PSB  
 P84-7-870  
 6/30

| SCOPE # | X  | ELEV     | HIGH RATE | UPPER | LOWER | DISTANCE | β       |
|---------|--|----------|-----------|-------|-------|----------|---------|
|         |  | Hi 1.465 |           |       |       |          |         |
| 29      | NE Interior CORNER OF SIZAZE PREMIERE                                    | 159.62   | 3.640     | 3.960 | 3.320 | 64       | 84° 10' |
| 30      | SE CORNER JAG OF SIZAZE WALL EXCAVATION                                  | 159.73   | 3.530     | 3.850 | 3.215 | 63.5     | 82° 30' |
| 31      | SE CORNER JAG OF SIZAZE WALL EXC.  | 159.745  | 3.515     | 3.840 | 3.195 | 64.5     | 82° 20' |
| 32      | NE CORNER JAG EXC.   | 159.83   | 3.430     | 3.755 | 3.115 | 64       | 80° 45' |
| 33      | NW CORNER JAG EXCA.  | 159.78   | 3.480     | 3.795 | 3.165 | 63       | 81°     |
| 34      | BASE OF EXCAVATION South West CORNER of JAG.                             | 159.115  | 4.145     | 4.460 | 3.830 | 63       | 82° 15' |
| 35      | NW CORNER - West of SIZAZE WALL  | 159.685  | 3.575     | 3.270 | 3.880 | 61       | 82° 20' |
| 36      | SW CORNER EXCAVATION limit West of SIZAZE WALL                           | 159.555  | 3.705     | 4.015 | 3.395 | 62       | 85° 20' |
| 37      | NW CORNER of Southern out cut  | 159.57   | 3.690     | 4.010 | 3.370 | 64       | 85° 30' |
| 38      | SW CORNER of out cut   | 159.555  | 3.705     | 4.025 | 3.395 | 63       | 85° 40' |
| 39      | BASE OF EXCAVATION SW CORNER of out cut                                  | 159.125  | 4.135     | 4.455 | 3.820 | 63.5     | 85° 30' |
| 40      | SE CORNER of out cut BASE OF EXCAVATION                                  | 159.63   | 3.630     | 3.960 | 3.305 | 65.5     | 85° 25' |
| 41      | NE CORNER of out cut   | 159.635  | 3.625     | 3.360 | 3.950 | 65       | 85°     |
| 42      | NW CORNER of 1st out cut   | 159.795  | 3.465     | 3.805 | 3.125 | 68       | 84° 15' |
| 43      | SW CORNER of 2nd out cut   | 159.765  | 3.495     | 3.840 | 3.155 | 68.5     | 84° 45' |
| 44      | BASE OF EXCAVATION SW CORNER of out cut                                  | 159.33   | 3.930     | 4.280 | 3.590 | 69       | 84° 30' |
| 45      | GROUND SURFACE South end of EXCAVATION cut                               | 159.855  | 3.405     | 3.060 | 3.755 | 69.5     | 84° 35' |
| 46      | SOUTH EAST CORNER Main EXCAVATION  | 160.07   | 3.190     | 2.560 | 2.835 | ?        | 84°     |
| 47      | NE CORNER Main EXC.  | 160.175  | 3.085     | 2.720 | 3.445 | 72.5     | 82° 15' |
| 48      | NE CORNER North of GREAT WALL  | 160.285  | 3.005     | 3.370 | 2.640 | 73       | 80° 50' |
| 49      | NW CORNER North of GREAT WALL  | 160.13   | 3.130     | 3.485 | 2.780 | 70.5     | 81° 5'  |
| 50      | NE CORNER EXCAVATION limit North of PREMIERE WALL (out cut)              | 160.05   | 3.210     | 3.565 | 2.855 | 71       | 82° 45' |
| 51      | NW CORNER EXCAVATION limit North of PREMIERE WALL (in cut) lower         | 159.99   | 3.270     | 3.620 | 2.920 | 70       | 83°     |
| 52      | Western Point on <del>PREMIERE</del> Middle of <del>PREMIERE</del> PATIO | 159.47   | 3.790     | 4.160 | 3.420 | 74       | 81° 30' |
| 53      | Pointers out to the South  | 159.45   | 3.810     | 4.190 | 3.430 | 76       | 81° 40' |
| 54      | EAST END of PATIO  | 159.61   | 3.650     | 4.040 | 3.260 | 78       | 81° 45' |
| 55      | NE CORNER PATIO (?)  | 159.895  | 3.365     | 3.760 | 3.985 | 77.5     | 80° 30' |
| 56      | JUNCTION of GREAT and FEED   | 159.60   | 3.660     | 4.020 | 3.300 | 72       | 81° 30' |
| 57      | South End of FEED  | 159.58   | 3.680     | 3.220 | 4.040 | 72       | 83°     |
| 58      | EAST END PREMIERE WALL (?)   | 159.63   | 3.570     | 3.930 | 3.210 | 72       | 81° 40' |

PSB  
 84-7-71  
 6/30

| SCOPE #                            | T                                     | ELEVATION                   | MID HAIR | UPPER            | LOWER            | DISTANCE | 4        |
|------------------------------------|---------------------------------------|-----------------------------|----------|------------------|------------------|----------|----------|
|                                    | Hi 1.465                              |                             |          |                  |                  |          |          |
| 59                                 | EAST END OF PREMIERE<br>FOR SURVEY    | 159.37                      | 3.890    | 4.235            | 3.550            | 68.5     | 84° 20'  |
| 60                                 | SOUTHWEST JUNCTION RICHARDS<br>STEAZZ | 157.24                      | 4.020    | 4.335            | 3.705            | 63       | 84° 45'  |
| 61                                 | NORTH END STEAZZ                      | 159.26                      | 4.000    | 4.315            | 3.685            | 63       | 82°      |
| 62                                 | SE CORNER 12A                         | 162.085                     | 1.175    | 1.535            | 0.815            | 72       | 55°      |
| 63                                 | SE CORNER 12B                         | 160.835                     | 2.425    | 2.725            | 2.135            | 59       | 54° 50'  |
| 64                                 | FENCE POST                            | 161.915                     | 1.345    | 1.710            | 0.975            |          | 49° 40'  |
| 65                                 | FENCE POST                            | 161.25                      | 2.010    | 2.390            | 1.630            |          | 38°      |
| 66                                 | FENCE POST                            | 160.545                     | 2.715    | 3.130            | 2.300            |          | 82° 15'  |
|                                    |                                       |                             | 4.542    | 4.616            | 4.470            |          | 248° 50' |
| 163.260<br>4.542<br><u>158.718</u> | 67                                    | NW CORNER OPT 7B            | 158.718  | <del>3.512</del> | <del>3.770</del> |          | 299° 45' |
| 163.260<br>3.953<br><u>159.307</u> | 68                                    | SE CORNER OPT 7B            | 159.307  | 3.953            | 3.910            |          | 289° 40' |
|                                    | 69                                    | FENCE POST                  | 159.308  | 3.952            | 4.017            | 3.883    | 183° 15' |
|                                    | 70                                    | FENCE POST                  | 158.57   | 4.750            | 4.848            | 4.655    | 170° 15' |
|                                    | 71                                    | FENCE POST                  | 158.91   | 4.350            | 4.520            | 4.180    | 229.45   |
|                                    | 72                                    | NE CORNER <sup>OFF</sup> 6A | 158.51   | 4.750            | 4.970            | 4.520    | 231.10   |
|                                    | 73                                    | NW CORNER OPT 6A            | 158.575  | 4.745            | 4.975            | 4.510    | 229.40   |
|                                    | 74                                    | SW CORNER CP 6A             | 158.54   | 4.720            | 4.955            | 4.480    | 227.45   |
|                                    | 75                                    | SE CORNER CP 6A             | 158.64   | 4.620            | 4.855            | 4.390    | 227.°    |
|                                    | 76                                    | FENCE POST                  | 158.855  | 4.805            | 5.050            | 4.550    | 249° 30' |
|                                    | 77                                    | FENCE POST                  | 158.305  | 4.955            | 5.195            | 4.710    | 173° 00' |
|                                    | 78                                    | PARTICULAR<br>FENCE POST 4C | 159.59   | 3.670            | 4.285            | 3.060    |          |

took till after 11 to do these plan points  
 Alex took photos 84-7-~~Q~~<sup>11/12</sup> of opt 7B, cleared from W, scale 10cm  
 (no chalk board) - now ~~removing~~ removing stones  
 for section



PSB  
 P84-7-73  
 7/3

July 3 (Tuesday)

Much rain at night SB & here  
 75° at 7<sup>50</sup> - Alison, Justine & me - points for 3C/3D  
 plan & sections (3C profile over Str 1)

| scope Δ | T                              | Elev  | Mid Hair | Upper<br><del>Lower</del> | Lower | Distance Δ |
|---------|--------------------------------|-------|----------|---------------------------|-------|------------|
|         | T3 HI 133.5                    |       |          |                           |       |            |
| - 9°30' | 1 W side, base Str. 1          | 4.000 | 4.076    | 3.927                     |       | 252° 95'   |
| - 9°30' | 2 Mound contours               | 3.150 | 3.203    | 3.097                     |       | 248° 30'   |
|         | 3 "                            | 3.511 | 3.548    | 3.475                     |       | 241° 37'   |
|         | 4 "                            | 1.795 | 1.818    | 1.772                     |       | 219° 74'   |
|         | 5 NW corner Opt. 3D            | 1.373 | 1.393    | 1.352                     |       | 187° 52'   |
|         | 6 Opt 3D Nest                  | 2.214 | 2.234    | 2.194                     |       | 181° 42'   |
|         | 7 Clean feature                | 3.483 | 3.509    | 3.458                     |       | 159° 52'   |
|         | 8 Ballist Stone 3rd Sec.       | 3.500 | 3.536    | 3.482                     |       | 150° 39'   |
|         | 9 East End Upper 3d            | 3.717 | 3.752    | 3.681                     |       | 133° 43'   |
|         | 10 Toe of Fall                 | 3.582 | 3.620    | 3.543                     |       | 125° 10'   |
| - 4°45' | 11 Base of 3d                  | 4.480 | 4.520    | 4.490                     |       | 125° 25'   |
|         | 12 SE <sup>corner</sup> Opt 3d | 3.498 | 3.550    | 3.448                     |       | 132° 20'   |
|         | 13 NE Corner 3d                | 1.790 | 1.834    | 1.746                     |       | 116° 25'   |
| - 4°10' | 14 NE corner Soft (on rock)    | 4.000 | 4.101    | 3.899                     |       | 90° 45'    |
| - 4°10' | 15 SE corner Soft (on rock)    | 4.000 | 4.102    | 3.898                     |       | 94° 25'    |
| - 4°25' | 16 East edge of bulk           | 4.450 | 4.529    | 4.371                     |       | 90° 23'    |
| - 4°45' | 17 Southside of bulk           | 4.450 | 4.522    | 4.378                     |       | 92° 25'    |
| - 5°    | 18 West edge of bulk           | 4.100 | 4.164    | 4.036                     |       | 87° 28'    |

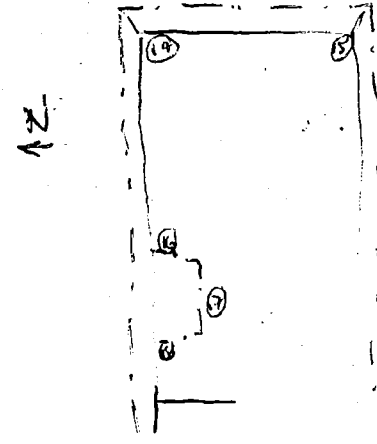
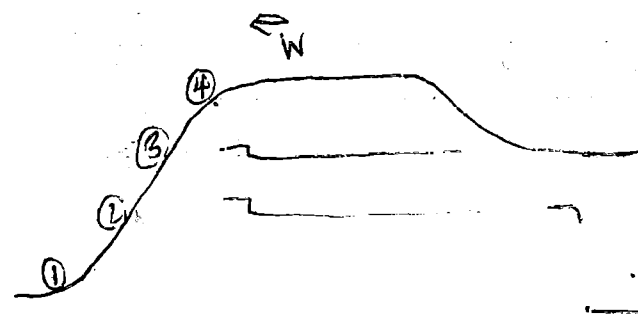

## Lab Notes Concerning 1983 Season

Lots 10D/9 and 10D/10 were unwashed as of the end of the season they may have gotten mixed up. Lot 10D/9 should contain obsidian and Lot 10D/10 should contain quartzite.

There was some confusion with lots 10G/48 and 10G/47 and with their lot cards, they may or may not exist.

After lot Card 2A/40 there is a jump to 2A/100 then to 2A/110 and then to 2A/120. This is because Mark arbitrarily chose these three numbers without checking with Kathleen.

Original Cards that have been duplicated should have a star (\*) in the upper left hand corner to indicate this.

About half way through the 1983 season we started putting sub totals after the descriptions of items on the back of lot cards to indicate that there was more than one bag of things.

Part way through the season we stopped numbering all of the stands in the lots due to lacks of time and man power.

## Lab Notes Concerning 1984 Season

The material I called Black Rock Type A has been identified as Andesite and will now start appearing under that name. But past records will be left with the designation of Black Rock Type A (BRTA).

The lab has created OPEZC to help deal with lot tags that were severely damaged and partially unreadable due to storage in the Copan bodega during the off season.

Jute are not being washed and cleaned out of dirt as completely as last year. They are still being counted and weighed. After the weight we are putting the notation uw to indicate that they are unwashed and that the dirt content may skew the weight correlations to better washed lots.

This year our three sherd washers also did a lot of the work of numbering and counting the sherds and recording the counts on the lot cards. As a result the "brief descriptions" have occasionally been misspelled i.e. "~~and~~"andesite" for ambesite or puts in Spanish "obsidiana". We have tried to correct this when it was encountered but that didn't always happen. Also for a while one of them was numbering things with dashes rather than slashes (i.e. 6A-2 vs 6A/2) again I have tried to correct these. Also many of the sherds got numbered on the rim across the center or over part of the design.

In bagging and counting lots 6A/28, 6A/30, +6A/33 I noticed that some of the jute were noticeably larger than the average jute and also that many of them had unbroken tips. This might be worth looking at further at a later time. It might also pay to look at lots related to these and see if they have similar jute.

## Lab Notes Concerning 1984 Season Cont.

Flotation contents are being recorded on the lot cards an F is being put after the lot number to indicate that it is from flotation as opposed to the normal pit contents. (This was also done in 1983).

At different times during the season depending on the pressures of time we numbered either all of the sherds or only the rims, appendages and other diagnostic or distinctive sherds.

Lot 26F/1 may be incorrectly numbered there was a mix up of tags in washing it could possibly be 26C/16

In looking through the lot cards we found some 1983 lot cards that seem to be missing. It is possible that they were misplaced during the intervening year at some point an effort should be made to locate them or an eye be kept open for them. They are Numbers 5C/7, 5C/21, 5H/23-30 + Dup.

Lots 52B/1-6 was reversed with 52D/1-6. These pits, 52B and 52D were reversed when there was a change in people working at the site. Lots 52B/1-6 were subsequently changed to 52D/1-6 and vice versa when the mistake was discovered.

~~52B/1-6~~

3A: hit a hardened earth surface (slightly redder/orangier than matrix above) ca 8cm below base of SOF deposit

(see Ed's notes re: description)

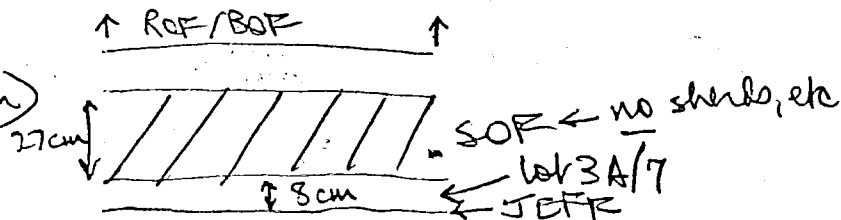

3B: finished east continuation of lot 1 (surface to 10cm, latter measured above posited position of BLAST) - now clearing down to BLAST there (lot 2)

lot 5C/45 5C: took flotation sample from slit trench, from seeming midden overlying MARINA (got 3 cloth bags full from here yesterday)

3A: layers of SOF are different in color

- ① buff/white
- ② greenish
- ③ orangey

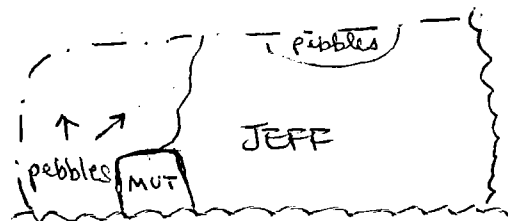
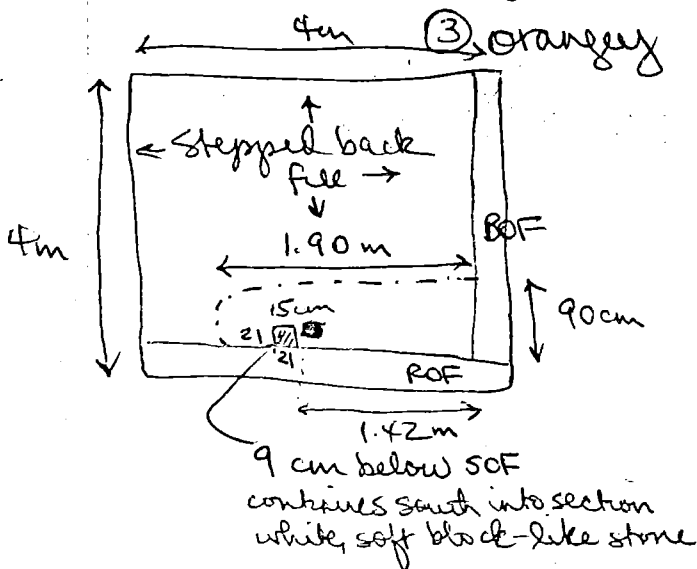

JEFF runs into MUT

MUT could be <sup>formed</sup> edge of plaza  
pebbles could be erosion  
or cut

3A/7 includes sherds, jute, obsidian - took flotation sample  
1 piece of possible Copador