

1984

PSB-013-Staneko-Field Notes-1984

Justine Staneko

Follow this and additional works at: <https://digital.kenyon.edu/honduras>



Part of the Archaeological Anthropology Commons

Recommended Citation

Staneko, Justine, "PSB-013-Staneko-Field Notes-1984" (1984). *Four Valleys Archive*. Paper 92928.
<https://digital.kenyon.edu/honduras/92928>

This Field Notes is brought to you for free and open access by the Anthropology at Digital Kenyon: Research, Scholarship, and Creative Exchange. It has been accepted for inclusion in Four Valleys Archive by an authorized administrator of Digital Kenyon: Research, Scholarship, and Creative Exchange. For more information, please contact noltj@kenyon.edu.

GUALJOQUITO (SB 2)

(Modified from Hasemann)

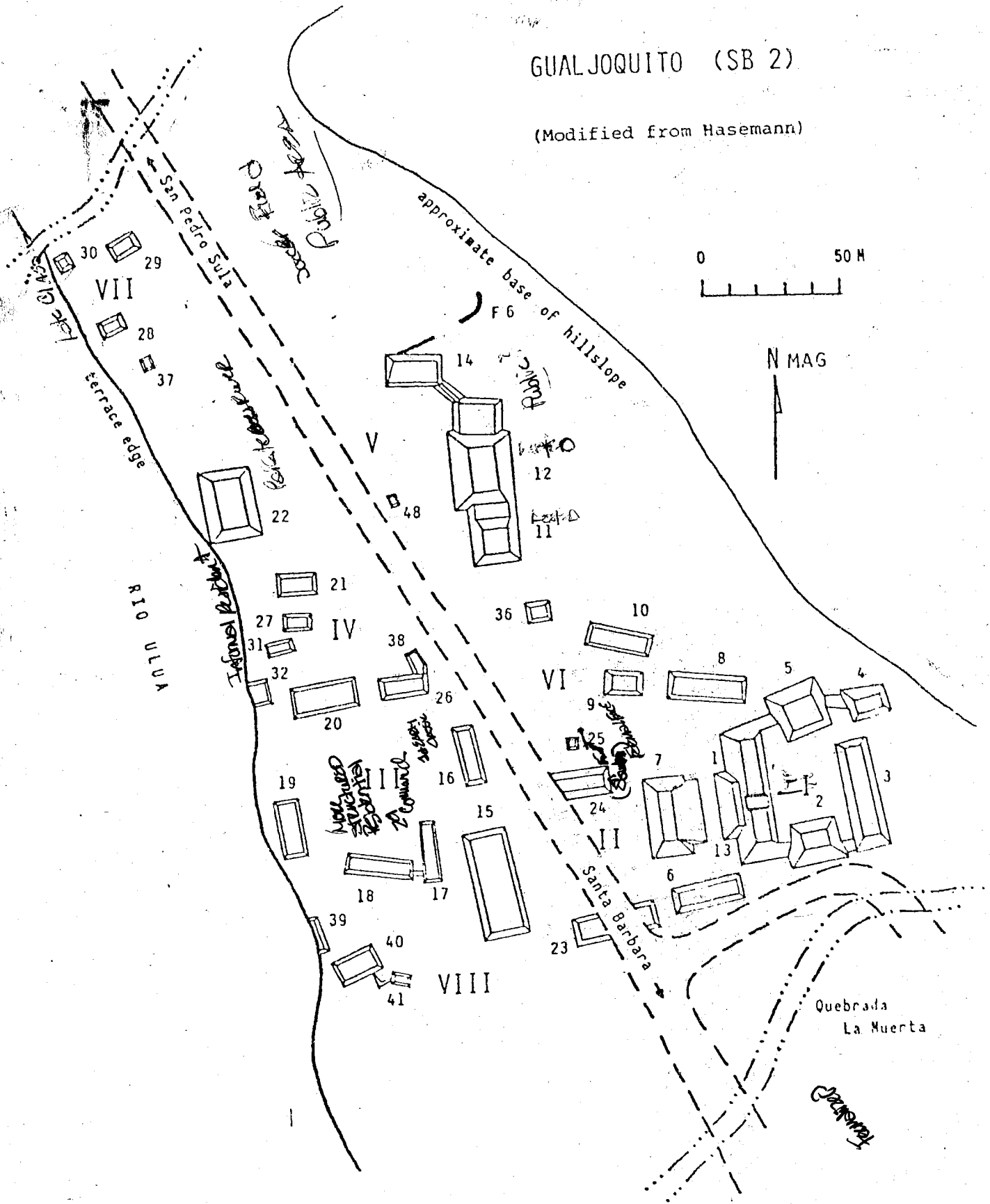

P.S.B.
 P84-13-1
 6/5

-(1x2 H. test pits)

Morning: Began operation 12, sub operations A & B. located in Coluvial fan, EAST OF STRUCTURE 11 & 12. Both suboperations aligned with existing DARB wire fence, Sub.op 12B located 10 M west of subop 12A (which is 1/2 meter west of fence. Summary Below:

Subop 12

~~Subop 12~~

Lot 1: leveling layer: 10 CM

(EAST WAY 20 CM)
 (WEST WAY 0)

- Dark rich top soil sterile

Lot 2: 20 CM. (workers had problem keeping "slope" straight)

- Top of level dark rich top soil
 continuous
 fw. Fauna fragments: (Cow bone?)

- lower part of level, start to mixing, particularly in end of trench of soil w/ fragments and particles of sand stone.

EAST WAY Profile

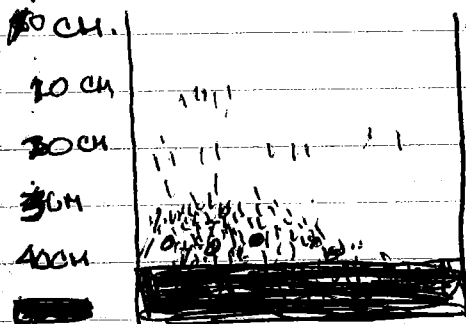

ky
 1 - sandstone particles
 0 - sandstone rocks

Lot 3 10 CM.

upper part of level were ^{frequent} mixing of dark rich soil
 Bottom of lot: complete mixing of entire floor of pit

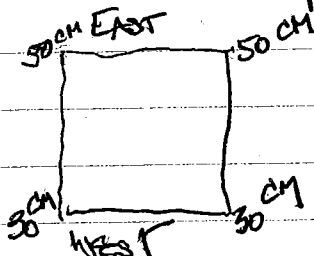

Artifacts: 1 bone fragment
 1 obsidian chip - translucent black - ~~conoidal~~ ~~fracture~~

Sub op 12 B

lot one: leveling layer
 10 CM

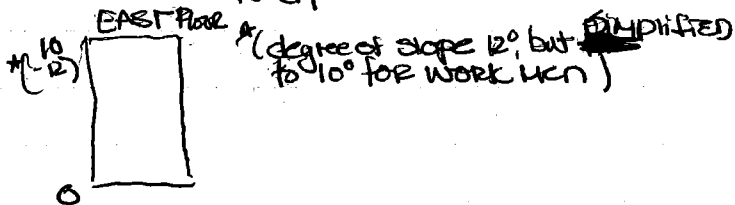

- DARK RICH TOPSOIL

ARTIFACTS: Several fragments (some large) of thick undecorated, unstripped ceramic - (body fragments? or tiles?)

(12B) lot 2: 10 CM ^{for lot 3} (again, work men having difficulty w/ leveling slope)

20-30 CM. Top of level: top soil continues
 Middle of level: ~~beds~~ (particularly at east end of pit) of sandstone begin to appear - continues to bottom of level.

ARTIFACTS: more ceramic fragments similar to lot 1.

(12B) lot 3: 20 CM.

30-40 CM

Mixing of sandstone ^{parts? particles} w/ top soil increases - ^{something} Red clay flecks
 ARTIFACTS: some more ^{undecorated thick unstripped} ceramic fragments

(12B) lot 4:

40-60 CM 10 CM

EAST WALL Floor

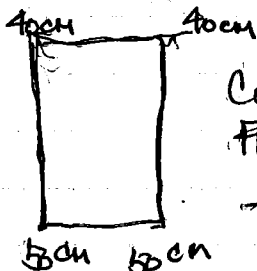

Complete mixing of topsoil & sandstone over entire floor of pit. Soil more rocky

- Steeple

Sub op 12 A

lot # 4 - Mixing continues (same as lot # 3)
 Steeple

Sub op 12 B

lot # 5 - SAME

Lot 11
(with lot 14 Fdn
west 100-110)

- No great change in stratigraphy from previous levels: except
 - Formation samples taken from lots 8 and 9 (west 90)
 - No visible ARTFACTS
 - Completion of lots 5 - 12 (each 100H)
 - (Parently 1350H)
 - EAST
- Amount of rocks increasing, beginning w/ level 7 (but rock size is much smaller than those from 12A)

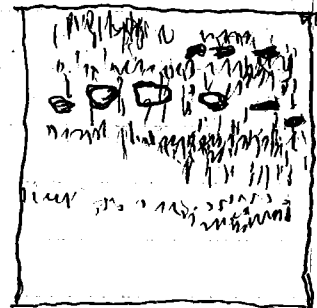

EAST WALL Profile

- No change in stratigraphy from previous level except. Amount of rocks & cobbles beginning to increase with lot 6.
- Formation sample taken of lots 6 (west: 600H) and 9 (west: 900H).
- No visible ARTFACTS
- Completion of lots 5 - 12 (each 100H)
- EAST
- (Parently 1350H)

Continuation of operation 12 sub A & B. Summary below:

PSB
PSA-13-4
616

RSB
P84-13-5
617

Continuation of operation 12A & 12B. Summary follows:

Subop 12A

Evaluation of lots 11-15. Mixture of topsoil (mums) and sandstone debris (colium) continues. Various densities found within and among lots. See final drawing for details. * lot assignment (based on Amilio's observation. I was plotting points with Wendy!)

Lot #11 - STEEL
Lot #12 - STEPS
Lot #13 - STEPS
Lot #14 - shers, one lens fragment, two carbon samples, flotation sample
Lot #15 - STEPS

Sub op 12B

lots ~~ARTIFACT SUMMARY~~
12 & 13 STEEL

lot 14 - STEPS

lot 15 - ~~STEPS~~

lot 16 - STEEL

lot 17 - STEPS Flotation sample

lot 18 - STEEL

lot 19 - STEPS

lot 20 - STEEL SO FAR!

Mixture of topsoil (mums) and sandstone debris (colium) continues. Various densities found within and among lots. See final drawing for details. * lot assignment (based on Amilio's observation. I was plotting points with Wendy!)

PSB
P84-13-6
6/8

Cont of sub operation 12A & 12B Summary follows:

Sub op²A

Excavations of lots 16 - 19 (Partial)

All lots 100%

Area Summary

lot 16 - sterile

lot 17 - carbon sample

lot 18 - sterile

lot 19 - shards (partial)

Both pits continue to show

Mixture of topsoil (moss) and Coliform

Sub op 12-B

Excavation of lots 20 - 22

All lots 100%

Area Summary

lot 20 - shards

lot 21 - sterile

lot 22 - shards (partial)

Excavations rained out: 2:30pm

PSB
P84-13-7
6/9

Cont of sub opt 12A & 12B Summary:

Sub opt 12A

Excavation of lots 19-22

Aerial Summary

lot 19: Ceramic sherds, Flakes (long chert?), obsidian(?)

lot 20: Ceramic sherds, obsidian, chert(?)

lot 21: Ceramic sherds, lithics

lot 22: Ceramic sherds, lithics (incomplete)

lot 19* Portion starting to hit rocks & cobbles -

Soil still mixture of

colluvium & fluvial

sub opt 12B

Excavation of lots 22-

Aerial Summary

lot 22: sherds, lithics(?)

lot 23: sterile

lot 24: sterile (incomplete)

Soil - Mixture of colluvium & fluvial

Subop 12 A

lot 22: speeds, position
→ completion excavation

- Photo 847E 536

- D84-13-1

Section op 12 A

Section op 12 A: D84-13-1

STRATIGRAPHY

- Level A - Rich dark brown top soil / humus (dark top - 10cm)
 - Level B - Thick deposit of colluvium (small pebbles and flecks)
 - Level C - Mostly humus - lightly flecked w/ sandstone (colluvium)
 - Level D - Thick deposit of colluvium
 - Level E - Mixture of colluvium's humus (look humus from coll.) + layer of small cobbles / scattered pebbles
 - Level F - Thick dense deposit of colluvium
 - Level G - Mostly humus scattered w/ larger grain colluvium, rock boulders
- AT Bottom of level.
- (Continued P4-13-10)

* - Broken lines indicates color change in humus soil.

* - Colluvium soil in addition to sand stone fragments and flecks contains flecks of red, orange, tan clay.

Subop 12 B
APPROX 140 cm - 150 cm - Shards
Clot # 25 (Previous lots speak)

PSB
P. 84-13-9
6/11

Subop 12 A

Section 0P12 A (continued)
(SS - SW profile)

- level A - (Topsoil 10 cm) Humus ^{sparsely} scattered up / surface 5 day tracks
- level B - thin layer of colluvial debris
- level C - Same as level A w/ a little more peckung
- level D - layer of colluvial debris
- level E - Same as level C w/ a little less tracking (Boulders at Bottom)
- level F - thin colluvial debris

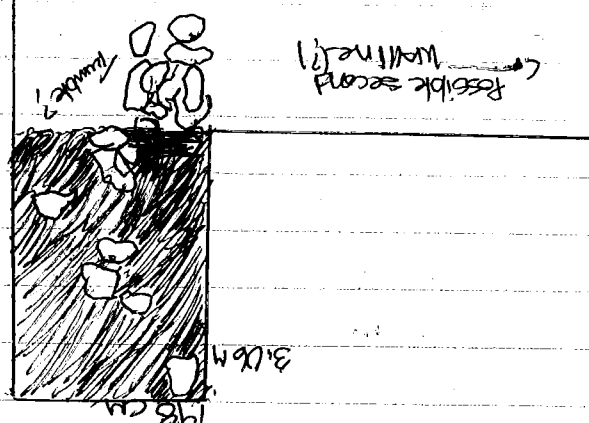

lot #2: Exc West trench running along exterior of possible main line (no picture)

Soil first locm - dark rich topsoil

Photo: 84-7-F 182 - possible wall line (orientation)

75.5

lot #26 (N 250 260) lithic-obsidian?
 lot #27 (west 260-270) sterile
 lot 28 (west 270-280) lithic

Subop 12-B - still going down at rock levels working on level #25 (w 750-250)

Artifact: shreds lithic

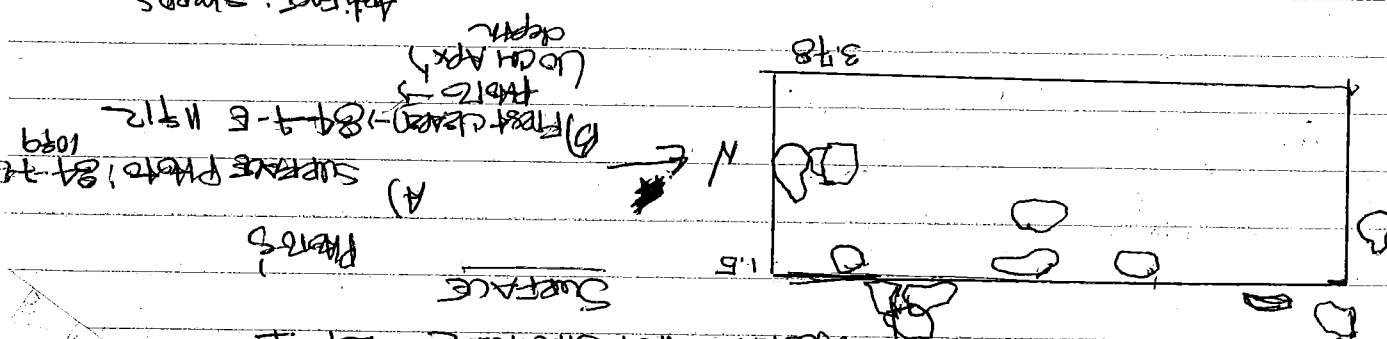

Morning: Openable structure #34 (sub 12-c), 3.78m (North-south) (East-west) trench along west wall of structure 2 = lot #1

Subop 12-c (whi structure?)

P85
 P84 13
 6/12

Surface Photo: 84-7-E 1039
 A) First cleared - 84-7-E 11912
 B) Photo 3 (Locm Aprx) depth

P.S.B.
Pg 13-11
6/12

Morning: Subop 12C, 12B cont.

LOT 12C cont.

ARTIFACTS

2 obsidian blade fragments - found close to surface. Plant

next to v.a. fragments.

STEPS

- Finishing up subop 12B at 180-190 cm. Start surface

6/13

Morning - continuation of subop 12C

lot #2

MAKE CARBON SAMPLE FROM SOUTH SIDE OF TRENCH NEAR SURFACE (APX 15 CM FROM SURFACE)
- NATURE OF THE FEATURE STILL UNKNOWN - POSSIBLE 3 WAYS READ!
- Completion of subop 12B finally! Start points of trench's pit
lot 29 (180-190 cm) - BEGAN TO UNCOVER IMPROVED FLOOR

AFTERNOON: PAINED OUT

What day pained out?

6/14

6/15

Morning: Rain has done minimal damage to subops 12B & A

Planning to backfill A soon - "B" still needs to be drained

large puddles & lots of mud in subop 12C. - draining follows.

P.S.B.
P84-13-12
6/15

SURP 126 Lots 1 & 2 - Sketch of Possible Wall Lines

Lot #2

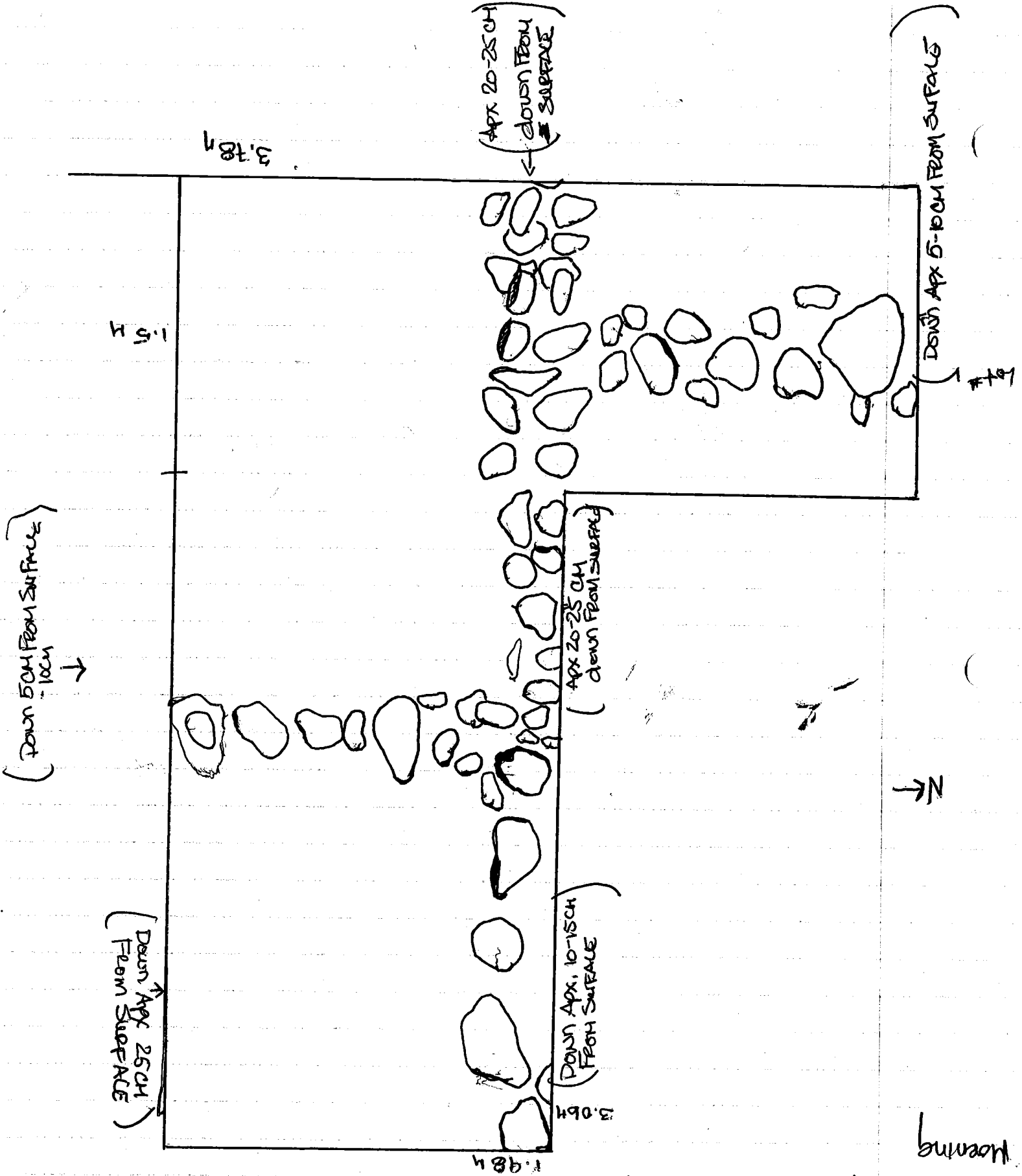

(Apx 16cm From Surface)

OP. 3d
Mop Floor Cross Section

Topped Floor - Soil combination of hard red clay and extremely hard brown/black soil (buen T) very brittle and hard in buen T areas, sounds hollow when topped.

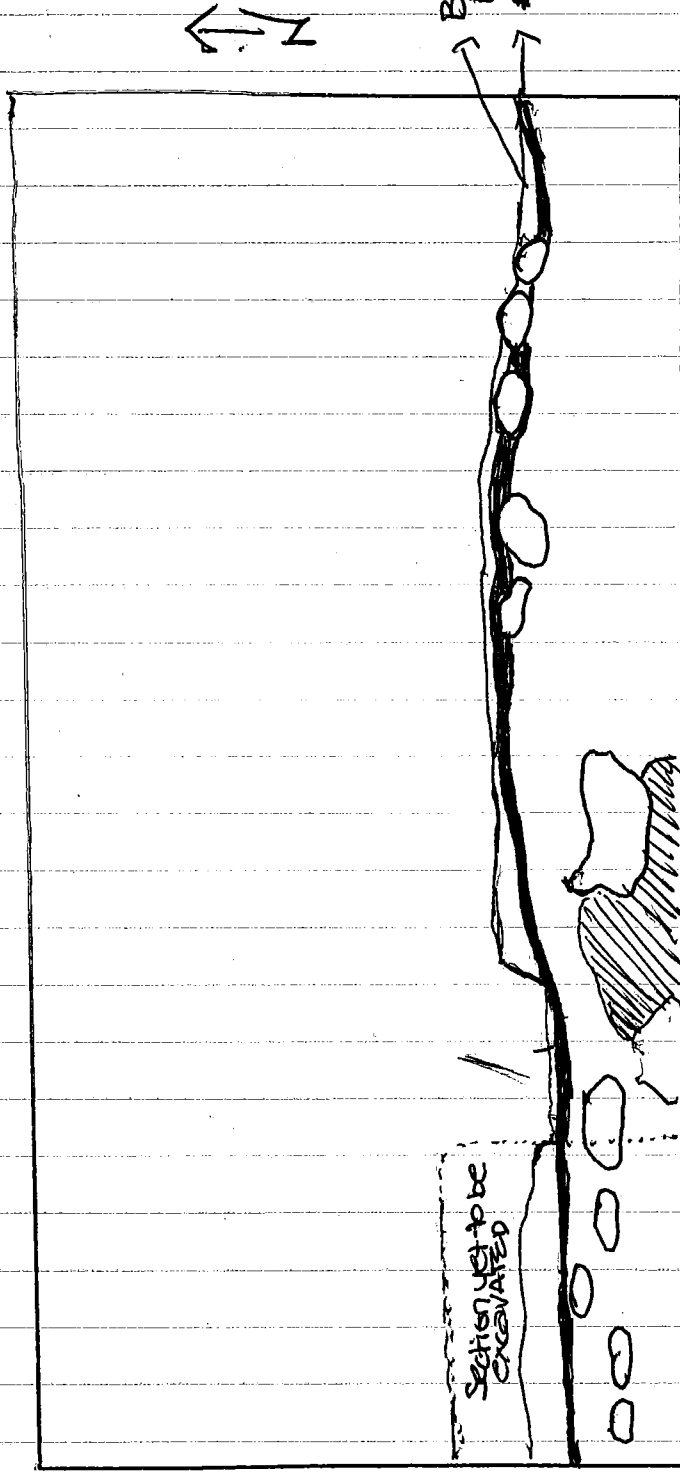

- Sloping of red clay soil & cobble line suggest continuous floor.

P.S.B.
PBA-13-123
6/15

sub
opt
12C

not being worked on too wet!

Subopt 3d

Took down unexcavated section (see P84-13-13) on west side.
Have uncovered what may turn out to be a low bench
(probably only 2' above level high) or an exterior
wall line. Floor level found above expected one. There is
probably multiple floors - Plan to cut down (to find out)
along bench line.

raised out again!

6/18/84

Hearing

Work is beginning again on sub opt 12C. Clearing of
debris not associated by ~~probable~~ wall line. Also cutting
down east end of lot 2 to see if J.C. Fletcher's continues
letting subopt 3d day a bit before continuing work on floors
and bench.

P.S.B
P84-13-14
6/18

N ←

unchanged

lot # 1

lot # 2

Subop 12c

PSB
P&A-13-15
6/16

DOWN APX 22CM FROM SURFACE
↓

DOWN 20-25 CM FROM SURFACE
↓

DOWN 8CM FROM SURFACE
↓

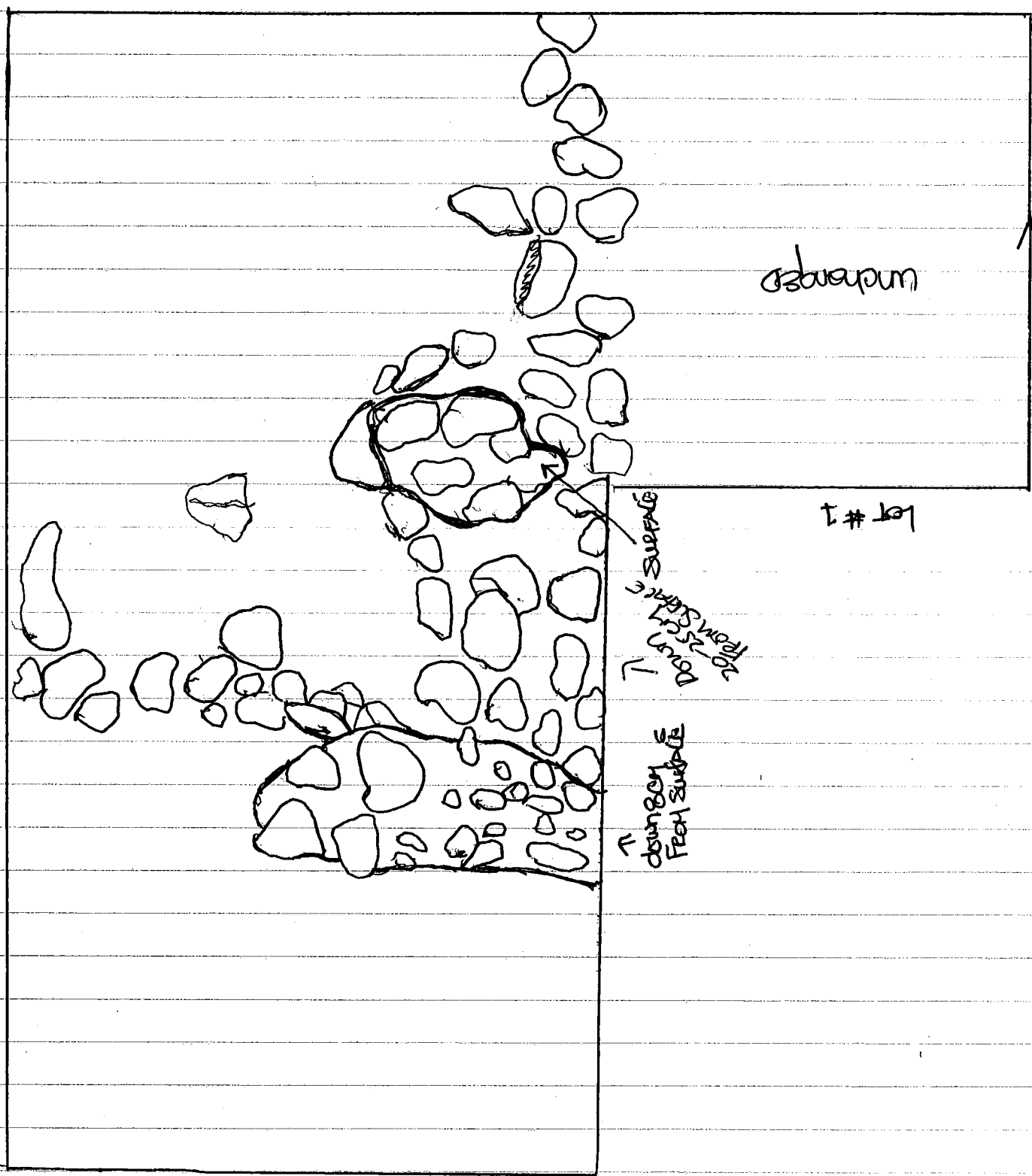

6/19

Subd 13C

OPENED NEW LOT: 12C3

SURFACE TO CONSTRUCTION

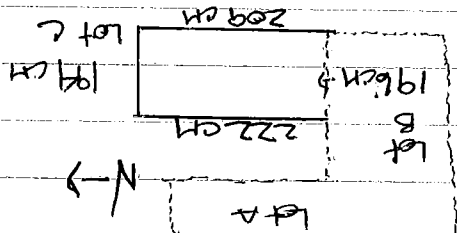

Subd 3D

Near Bench Sketch w/ Footings (DRAWN FROM WEST)

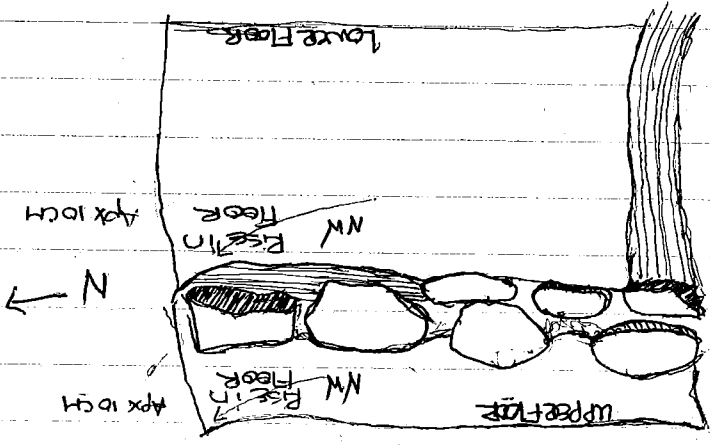

Bulldozer clearing for road (construction UNSETT A

CAKE in the middle of PRAZ II. Spent the good part of the day excavating the cake. Cake contained one broken

large upside down vessel undercarriage, piece upside down (Bull dozer had cut top off. The vessel itself was ~~also the~~ area surrounding contents of the

cake included: shell beads (both inside and surround with the heaviest concentration on the exterior north

side); Ceramic fragments (polychromes, bichrome and

vt
(1/11/2012)

PSB
P84-13-17
6/19

underground sheds) 2 Spondylus shells were found inside the vessel and 2 found approx 30-50 cm away on the west side. Small bones (probably not human) were contained within the vessel. After drawing and photograph - vessel fragment was removed and the bulldozer showed in. Nonwhite, brick or subop 12c another wall line on the west side of lot 3 was discovered.

6/20

Continuing work on 12c. Lot 3 being expanded east along wall line discovered yesterday.

Subop 12c
Sketch of possible wall lines

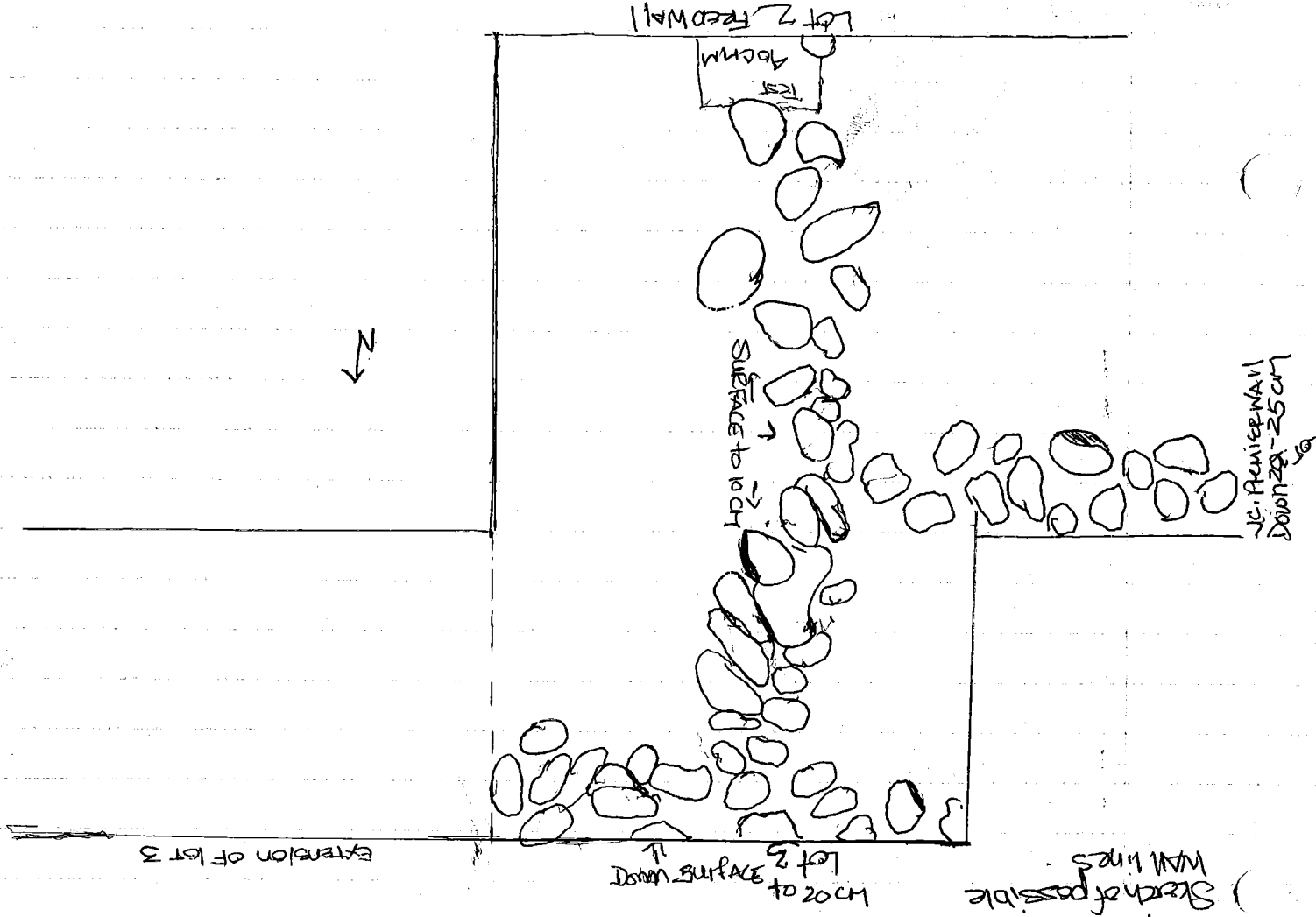

RSB
R413-18

6-21

Morning - spent most of it tracking down immigration's officer. Meanwhile Ed was overseeing excavation at Galyopuito.

Subop 12c

Extension of lot #3 continuing along the Great Wall approx. 60 cm in depth. Wall was begun to slope downward and curve south. Sloping effect possibly due to a buildup in the columnar. ~~There is a possibility of~~ another (one, chys) lower wall running north south under the Great Wall.

Afternoon - Have begun a west extension of lot 1 following U.G. Ruzic's wall line

6-22

Morning Carbon sample found 16.5% on top surface of lot #1 extension along U.G. Ruzic's wall.

in lot #1

Afternoon Continued following Ruzic's wall out westward, appears to note a definite wall line but may have picked up too narrow wall lines. One running east-west on south side of trench (near-knitman) near-south in middle of extension trench.

In lot 3 extension Great Wall has petered out and down. Possible path at a lower level. A lower line continues at an angle of great wall off to the north-east. Also another line has appeared running north-south at end of trench

Dealing with:

Preliminary
Preliminary
Guests
2 construction
operations...

with two distinct and separate

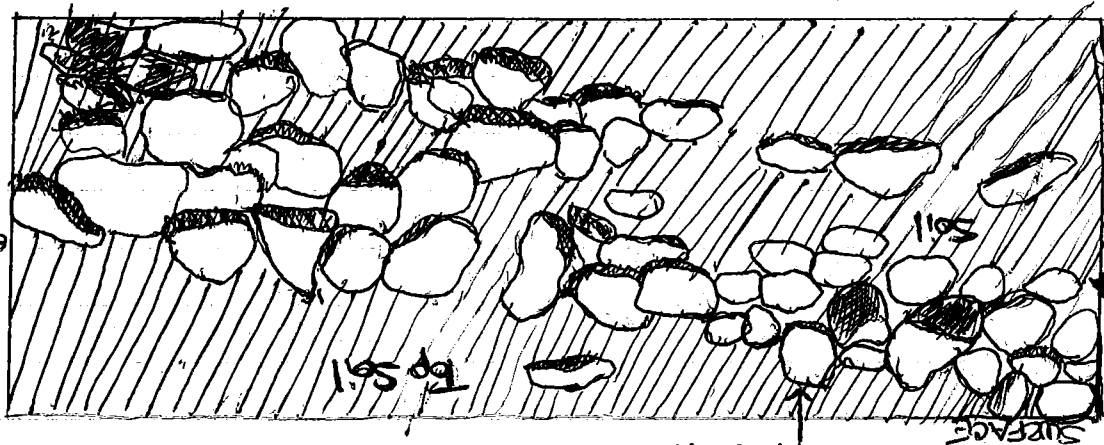

Northern continuation of lot 1 has possibly exposed the
 end of GREAT WALL.
 before cutting down
 84-7-M78
 84-7-M90
 Subop 12C Profile sketch: lot 3 EASTERN EXTENSION GREAT WALL
 10 CM FROM SURFACE
 310H
 300H
 Fill in
 two (approx. 100) phos?
 (Fill ranges from 50H - 350H thickness -
 Photo Lot 1
 Attention

looking for more clearly defined walls

Photos of Feed Wall (tumble line): 1 slides
 Vandy's
 before removal.

While I was sick, Ed open lot 12C-4 - Deposit below GREAT WALL.
 South west corner of J.C. Flewiter's
 Trench 120' x 120'

Subop 12C: (continuing)
 opening a 150cm pit at west end of GREAT WALL
 trying to catch south-west corner. Trench is a northern
 continuation of lot 1
 Western extension of lot 1 being extended northward, trying to catch
 Extension of lot 1 being extended northward, trying to catch
 eastern extension of lot 3

PSB
Pg 9-13-21
6/27

Morning: 12c

Have begun cutting thru construction in original lot 1
New lot started #5

Continuing to follow "stair" northward hoping to get
more material and maybe catch north west corner
of construction (maybe north west corner will look up w/
"great wall" trench has been jagged to the east so to
follow wall line

AFTER NOON

Cutting thru construction - lot 5 has exposed a good east-
west wall line at northern end - doesn't appear to be aligned
great wall. Might be southern exterior wall of a structure
which had a southern extending pebble-paved path
Next move to try and locate northern wall
New wall called "no surprise"

Meanwhile back at lot 1 extension - might have exposed
a north-west corner of something. The lot like this



Removed debris at corner junction of great
and feed walls, to me looks like feed wall
runs under great wall, thus may be
of an earlier construction phase

PHOTO GRAPHED
8-7-N 738

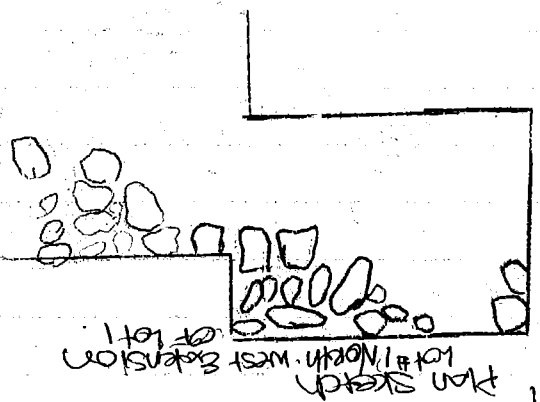

PSB
P84-13-22
6/28

Morning
12C

Cleaned up lot 5 for photographing
Photos: 84-7-0354 - lot 5 no surprise wall
84-7-0596 - lot 5 - ~~west~~ continuation of
Great Wall

Began northern extension off original lot 1. 1x3 meter trench
trying to locate northern wall line & possible diversion of structure
Near lot # 6 - ~~surface~~ surface to construction - including terminal debris/
or fill along or no line.

Have located either the (northern) ^{called on north} side of no surprise or
another wall ~~marking~~ it, lots of Buert earth & rubble
along w/ some large shreds, an occasional blade fragment
and a bones fragment. (and carbon samples!) found
in and next to wall line - Buert earth ^{down south} heavily concentrated at section
Question are we dealing w/ terminal debris, fill? Is
this an extreme wall or interior wall? Is there a ~~terminal~~ wall?
Wall? We will see, maybe. (No!)

6/29

Morning
12C

No wall found lot 7 w/ lot of fast "VADA" at all.
Cleaned up operation for Han Factors
Great Wall from ~~west~~ ^{west} - showing two beds

P84-7-0798 Great Wall from ~~west~~ ^{west} - showing two beds
P84-7-0112 Great Wall
P84-7-0152 n.c. Fenwick wall from East end AND wounded 5mm
P84-7-0354 off NO from North
P84-7-0596 - (lot 6) ~~Great~~ ^{Great} Wall from East and South East Corner

Ng 1st

Lab sheet work

Finishes Types Variety

Hot Classic

Local 2D Chopper: unslip utilization work
unclear: variety

tear surface
backward
bonds, vics

well burnished:

Matte, Incised

San Poch, red on brown

Base: same as dipped

Inquire red dipped

Wine Polychromes

color of dip
could be in light and dark orange slip
texture of past course
orange slip
Ia1 - orange slip
Ib - slip
Ia2 - slip
Ia1 - slip
Ia2 - slip
Ia1 - slip
Ia2 - slip

Texture of paste finer

(non local)

II a interior - same as slip color

II b interior - same as slip color, but much lighter (tan)

than II a

II c interior - orange, darker, same as orange

III dark orange interior - same as orange, like I a

Typing

- Surface Finish

- Decoration

- Firing: Oxidized or not

- How fired: break

- Break ref - loading

- Hose scarf

- Surface Technologies

- Rough fits

- Finishing

- Scraper

- Rapping

- Decoration

- Slips

- Dipped, brown

- Wash - very thin

- Self slips: Heavy burnishing

- Paint

- Insision

- Extention

- Relief design

- Grooving

- Round bottom

- Production

Basic Friction Waves

Graded

will be increased overall

from shallows or bays or
Trenches

Trench Unshipped

Red cause

Reds cause friction

will distinguish by bounding no bound

friction bound on lip

causes variety - unbound

Le Muetra varied - bound

friction lines
press marking

- Applye Blisks

- can't form tension

Recreation
friction marks of the
frayed marks

Group 2 - Inland w/ Red (usually around rim)

work

appears where tension decompresses

Some tension - pressure

More general - the friction continues (line) early classic because relative

work or (lip) slip - applied before tension decompresses

(like low construction)

Evolution Waves (Negative pointing)

possible impact of Salvador - characteristic M9.1

friction lines - friction

tends to be change and wave - but of range - in variation

Change of friction lines

I - large and orange

Every Classic

Espresso - Fine Paste - Body
Fine Made

Guajabito - black to dark brown heavily burnished

Fonton:

bars continuously

Chilonga

Resist / combined w/ red point

Highly Burnished

Newtypes

Valle White Slip

Paste red - red flink, inclusion: mica

4 hose seal

self slip or applied?

Pointed w/ red - angular geometric design

load line w/ red - 2 possible varieties

Temp

Waship (Painted)

Guatia unslipped

better burnished than juera unslipped

open plate like form
(previous size)

Taxi: quat

Blotchy red

Large form: coarse paste - inclusion large

thick strand firing cones

poor surface finish -

inclusion as from desiccation

swirled form: