

1986

PSB-042-Teitz-Field Notes-1986

Warren Teitz

Follow this and additional works at: <https://digital.kenyon.edu/honduras>



Part of the Archaeological Anthropology Commons

Recommended Citation

Teitz, Warren, "PSB-042-Teitz-Field Notes-1986" (1986). *Four Valleys Archive*. Paper 92933.
<https://digital.kenyon.edu/honduras/92933>

This Field Notes is brought to you for free and open access by the Anthropology at Digital Kenyon: Research, Scholarship, and Creative Exchange. It has been accepted for inclusion in Four Valleys Archive by an authorized administrator of Digital Kenyon: Research, Scholarship, and Creative Exchange. For more information, please contact noltj@kenyon.edu.

P86-4a-Pg. 4

5187 183

Distance M

Angle

Point

9.05
 12.17
 11.59
 11.25
 13.12
 15.71
 13.84
 18.79
 21.15
 18.47
 20.50

244° 30'
 250° 0'
 277° 0'
 177° 0'
 170° 0'
 188° 0'
 214° 30'
 279° 0'
 275° 30'
 265° 0'
 264° 30'

Sta.
 1. S.E. Corner
 1 S.W. Corner
 1 N.W. Corner
 2 N.E. Corner
 2 S.E. Corner
 2 S.W. Corner
 Ridge Point
 Street 3 N.E. Corner
 3 North Point + Ridge
 3 North Point + Ridge
 3 (North Point + Ridge)
 3 S.E. Corner
 3 South Point + Ridge

Site
183

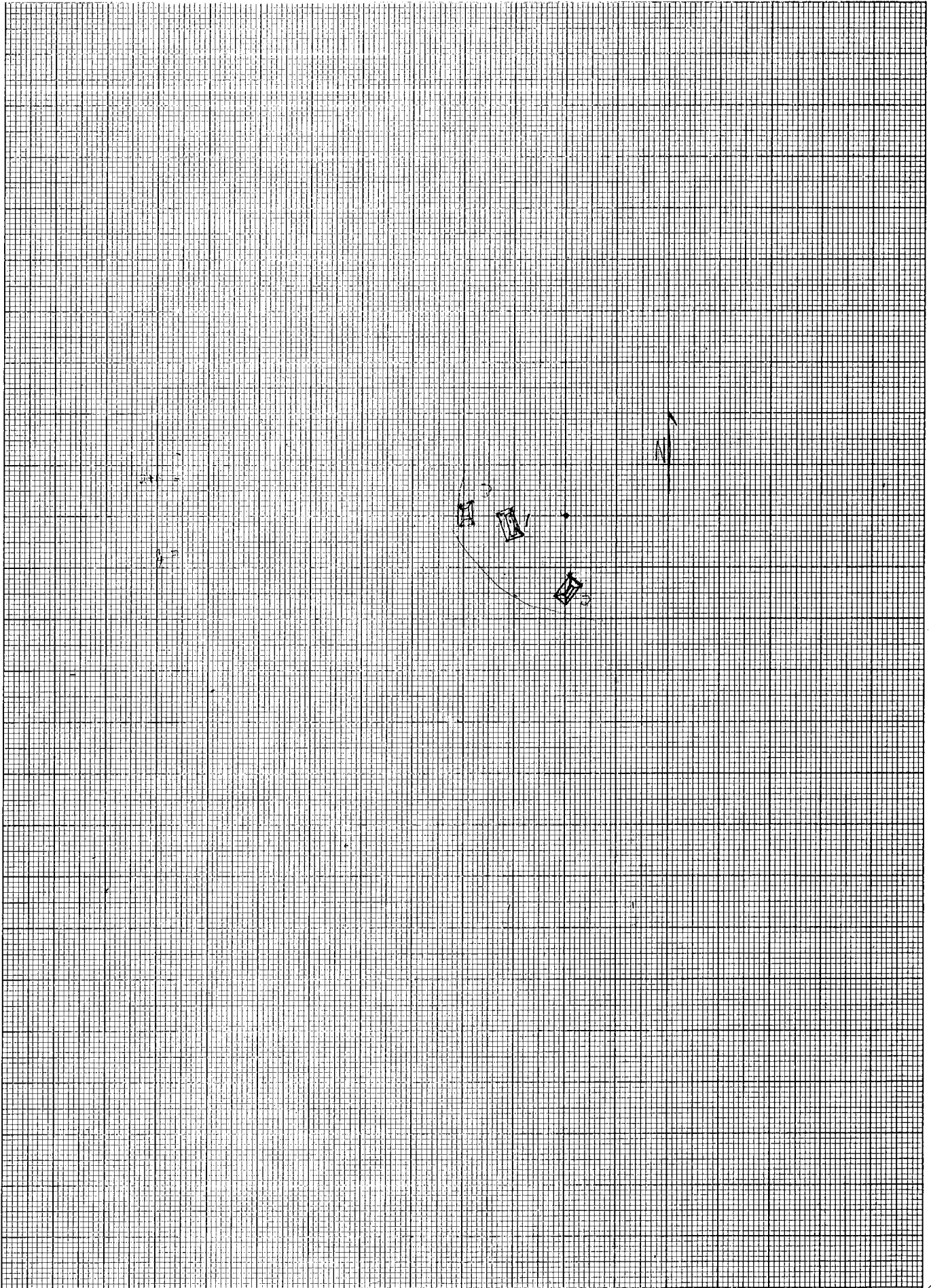

10 MILLIMETERS TO THE CENTIMETER

MEAD PRODUCTS, DAYTON, OHIO 45463

D86, 42, P1

Site 159

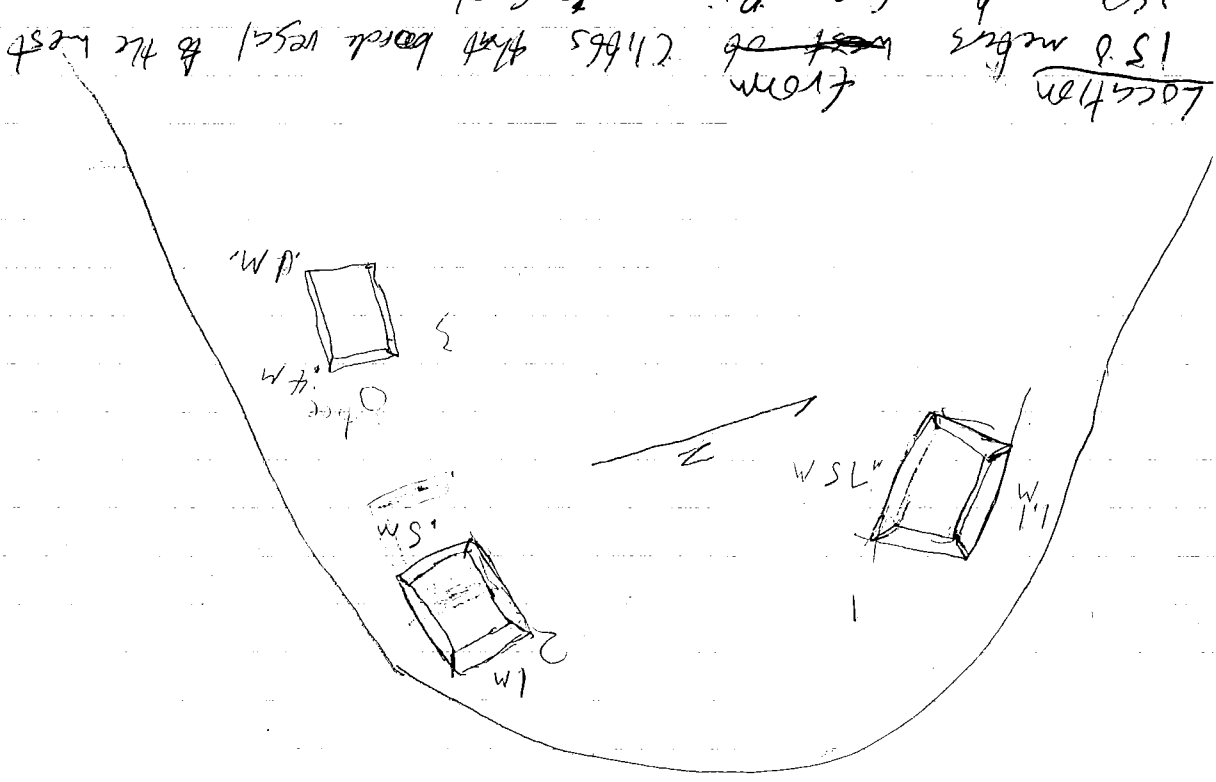

Location 150 meters west of cliffs that border vegal to the west from 180 meters from River to East 100 meters west from 158, 100 meters from Cliffs to the North

~~can pasture~~
lots of stone

Modern conditions
on tipped shaped plateau

low pasture
rather good preservation

Potential Reserve

Olva River 100 m to ~~west~~ S.E.
store for buildings

Dark Brown Soil
favourable land nearby

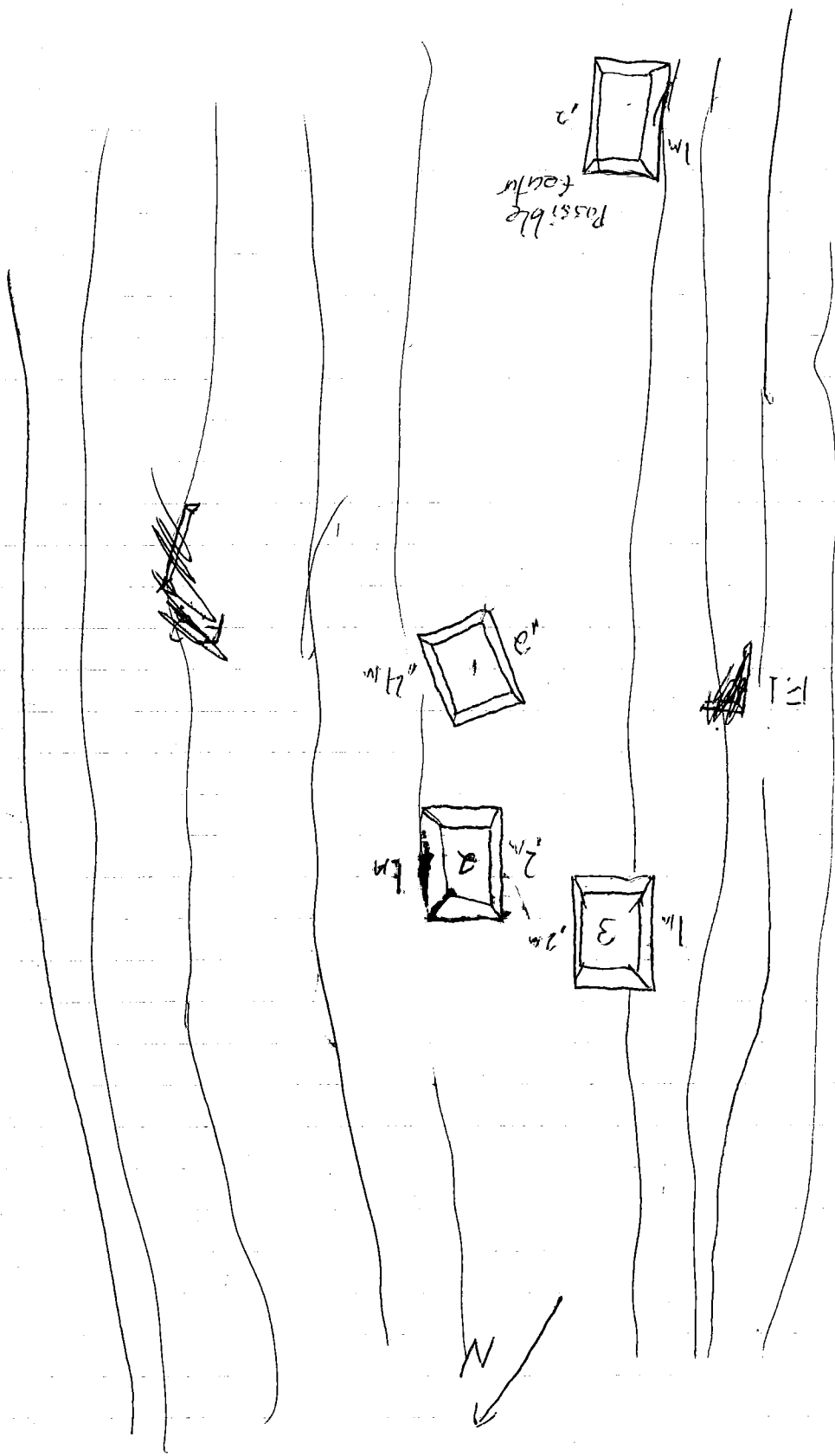

P.86-4a p5

195

Site 199 is about 30 meters from the ridge (N-S) road with a fence running through the middle (N-S). It is 20 meters from the ridge to the North. Structure 197 is 250m to the East and Site 198 is approx 180m to the East. The site is on a small ridge over top of a steep hill that overlooks the Uva which is 1.4km to the North. All the shrubs seem to be on the same plane. The vegetation is thick and to land seems to be used as some kind of pasture. The sites structures are very well preserved with hearths walls and cores plainly visible. The nearest water is the Uva - about 150 meters to the North and it is perennial. There is also a (abandoned) store for building on the slope and a limestone outcrop to the West. The soil is dry + light brown there are no crops on it but the weeds seem rather lush if you ask me. The foraging to the Area seem adequate to support in the long run.

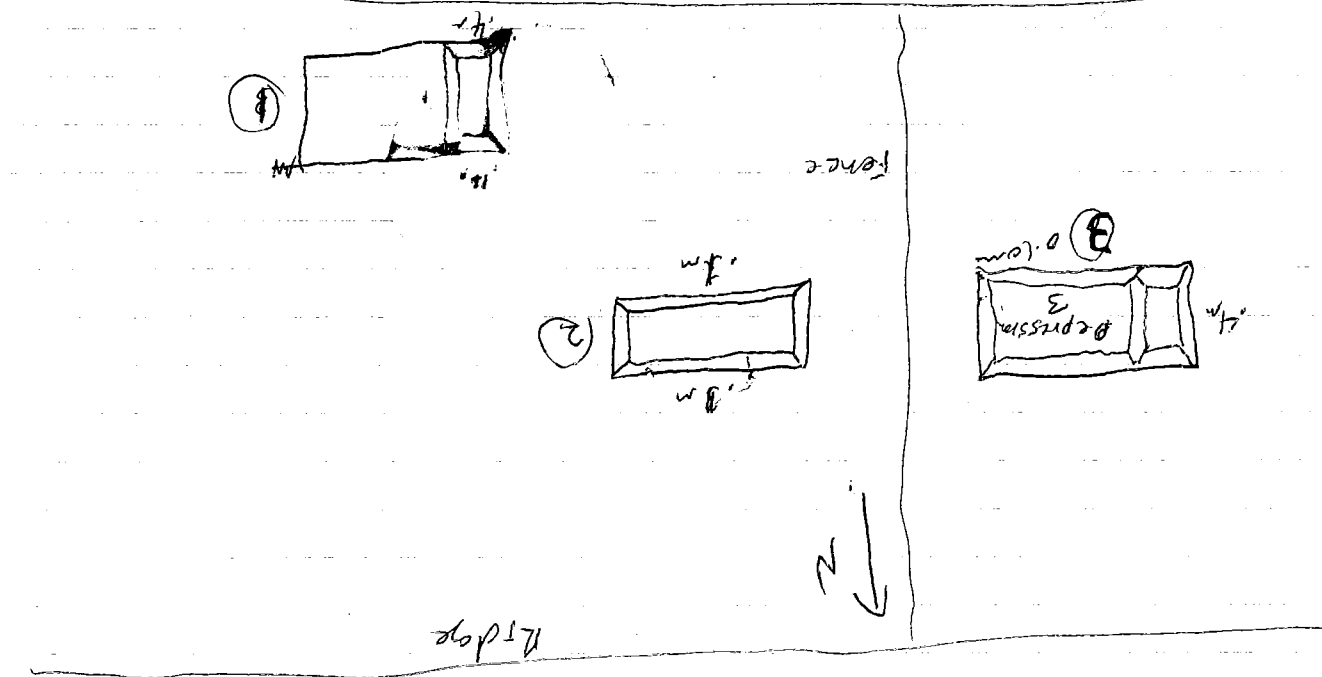

Site 199

P 186-42-P5

There are three rectangular structures arranged
with the first up and the second and one in between back
they seem to run parallel on an east-west line
this seems to be fairly regular.
The structures are fairly regular (there are only 3)
on close to each other the hearts on structures 1+3 face
west and are around 13-15 meters in height. The middle
of 1+3 are depressions. The stones are large with
cobble and larger stones from the heart. The side
is extremely well preserved too well ~~to be~~ personal
to be the side. The hearts are well considered
to the other sides nearby

86-42-R8
Dist

11.55
17.90
7.77
5.90
10.30
11.55
14.45
18.98
22.75
18.80
47.01
7.98
10.65
8.85
7.74
9.90
7.23

8° 30'
35° 30'
35° 30'
38° 6'
84° 30'
128° 30'
87° 30'
85° 30'
96° 30'
74° 0'
64° 0'
64° 0'
45° 0'
37° 30'
33° 30'
198° 30'
188°
207°
229° 30'
53°
37°
23° 30'

5 NE
1 N.W.
1 S.E.
1 N.E.
1 S.E.
1 S.W.
2 N.W.
2 N.E.
2 N.W.
2 N.E.
3 S.E.
3 N.E.
3 N.W.
4 S.W.
4 S.W.
4 N.W.
4 N.W.
6 S.E.
6 S.W.
7 N.W.
7 N.E.
7 N.W.
8 N.W.
8 N.E.
8 N.W.
9 S.W.
9 N.E.
10 S.E.
10 N.E.
11 S.W.
11 N.W.
12 S.W.
12 N.W.
13 S.W.
13 N.W.
14 N.E.
14 N.W.
15 N.W.
16 S.W.
16 N.W.
17 S.W.
17 N.W.
18 S.W.
18 N.W.
19 S.W.
19 N.W.
20 S.W.
20 N.W.
21 S.W.
21 N.W.
22 S.W.
22 N.W.
23 S.W.
23 N.W.
24 S.W.
24 N.W.
25 S.W.
25 N.W.
26 S.W.
26 N.W.
27 S.W.
27 N.W.
28 S.W.
28 N.W.
29 S.W.
29 N.W.
30 S.W.
30 N.W.
31 S.W.
31 N.W.
32 S.W.
32 N.W.
33 S.W.
33 N.W.
34 S.W.
34 N.W.
35 S.W.
35 N.W.
36 S.W.
36 N.W.
37 S.W.
37 N.W.
38 S.W.
38 N.W.
39 S.W.
39 N.W.
40 S.W.
40 N.W.
41 S.W.
41 N.W.
42 S.W.
42 N.W.
43 S.W.
43 N.W.
44 S.W.
44 N.W.
45 S.W.
45 N.W.
46 S.W.
46 N.W.
47 S.W.
47 N.W.
48 S.W.
48 N.W.
49 S.W.
49 N.W.
50 S.W.
50 N.W.

Station 2 to Station 2

slightly -
Triped dimensions

corn
corn

Point

Site 205
of reef

2