

1985

## PSB-026-Melchionne-Field Notes-1985

Thomas Melchionne

Follow this and additional works at: <https://digital.kenyon.edu/honduras>



Part of the Archaeological Anthropology Commons

---

### Recommended Citation

Melchionne, Thomas, "PSB-026-Melchionne-Field Notes-1985" (1985). *Four Valleys Archive*. Paper 92921. <https://digital.kenyon.edu/honduras/92921>

This Field Notes is brought to you for free and open access by the Anthropology at Digital Kenyon: Research, Scholarship, and Creative Exchange. It has been accepted for inclusion in Four Valleys Archive by an authorized administrator of Digital Kenyon: Research, Scholarship, and Creative Exchange. For more information, please contact [noltj@kenyon.edu](mailto:noltj@kenyon.edu).

P 85-26-1

5  
2 Feb 85

Leandro Mejia's Field; site 330; possible mound with 2 smaller mounds beside it; no cobbles, but at edge of field cobbles piled (by farmer) around tree. Mound is approx 3m x 3m. <sup>two</sup> Obsidian blades found 10m <sup>low</sup> N of mound, very 9:00 AM.

// at site 323 found 2 small sherds among beans + some more obsidian - The obsidian site was discovered during 1984 season

// 9:35 AM. 3 stones in line; site 330 by obsidian source; possible other structure

Nearest water is Quebraya Magazual, 1/2 K To N.

Took ~~at~~ transit readings

// 11:20 AM ~~site 330; corn pepper~~ Site 330A/2 in corn pepper field; found sherds, handle, obsidians, possible hammer stone + worked stones but no Architecture, a few site

// 11:45 AM surveyed open field of Bardales, found nothing; after lunch surveyed his cornfield and enclosure by his house. Owner of land gave us coconuts to eat; he also gave us a lovely obsidian core; in cornfield (1:15 pm) we found possible stone tools; site 331A Lot 1.

// 2:30 pm. site 332A lot 1; a few sherds in cornfield by side of road - probably the result of road building disturbance

P85-26-2

20 Feb 85

10:00 AM; west side of ULVA, North of road TO EL NISPERO;  
1st natural Terrace of ulva — In field ~~near~~ 2nd  
from road saw many buried + semiburied concrete,  
obviously recent structures; on Terrace There are  
many undulating mounds of earth; These, however  
run parallel with river + inasmuch as we observed  
neither cobbles, stone formations or sherds on the  
surface, + taking into account the natural contours of land,  
we decided that the area contained no sites.

Prior to this we sought permission to survey Sr. Amaya's  
land. He approached us with a pistol in his belt,  
spoke to us over the fence + refused permission under  
any circumstances.  
Spoke to Sr Amaya showed him ~~his~~ Sr. Orellana who  
(+ officer) to show him our official contract with the  
instituto. Sr. Amaya continued to refuse us entry, +  
said that if we went on his land it would mean  
trouble for us. All other land owners have been friendly +  
cooperative. SR. AMAYA Told us that All contracts were  
shit to him even if they come from el presidente.

1:15 P.M. Prior to lunch we surveyed, without success the area  
known as San ~~Antonio~~ de Jululo between confluence of Agayuu  
and Ulva. The potential for sites seemed good; access to water  
rise above flood line, flat — but without success.

We found a wall of stone along the side of a field + took Transit  
readings, but believe the wall, about 4 cobbles high, + extending  
(past the truly visible) into the sides is modern (site # 333)

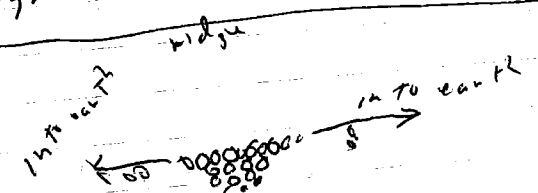

2<sup>6</sup> Feb 85 cont...

After lunch we TALKED with an old man who knew a lot of history pertaining to the conquest.

No Artifacts Thus Far Today

3:20 P.M. site 334; landowner, as yet unknown; Just west of Rio Aguagua; at foot of hill visible & just across From Ridge above site 333; in 334 in low pasture: at least 50 structures - one of which had surface polychrome sherds on surface. In adjacent cornfield closer to aguagua at least one structure.

Sketch map

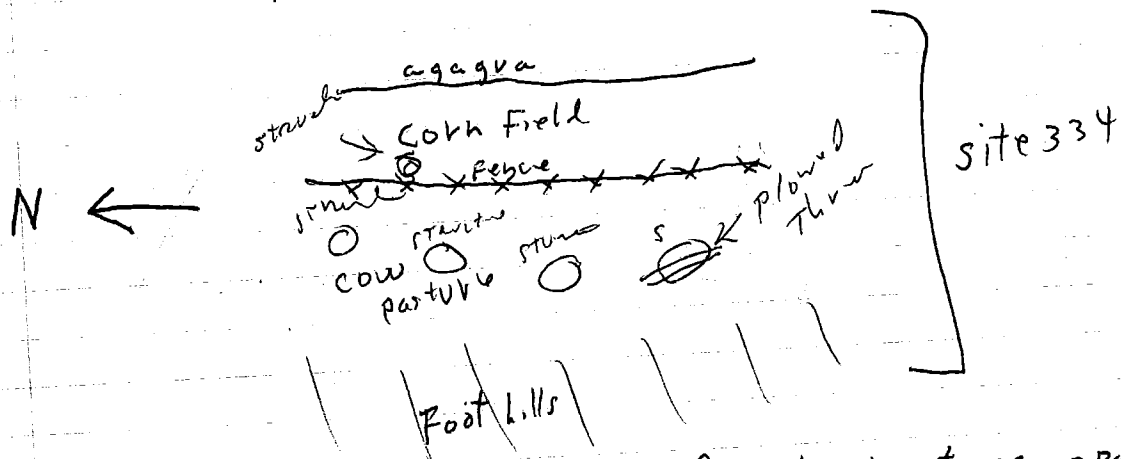

The farmer has made piles of cobbles from the structures, apparently in an attempt to remove stones from his field. Looks promising. Tomorrow we will survey area extensively & take sitings, map etc. Very curious big bull in field.

27 Feb 80

9:55 AM; after slight delay due to mechanical trouble we set out;

at site 334 we proceeded to walk about site to locate visible structures;

There are many cobbly pits about obvious made thru of Runo

Sketch map of 334

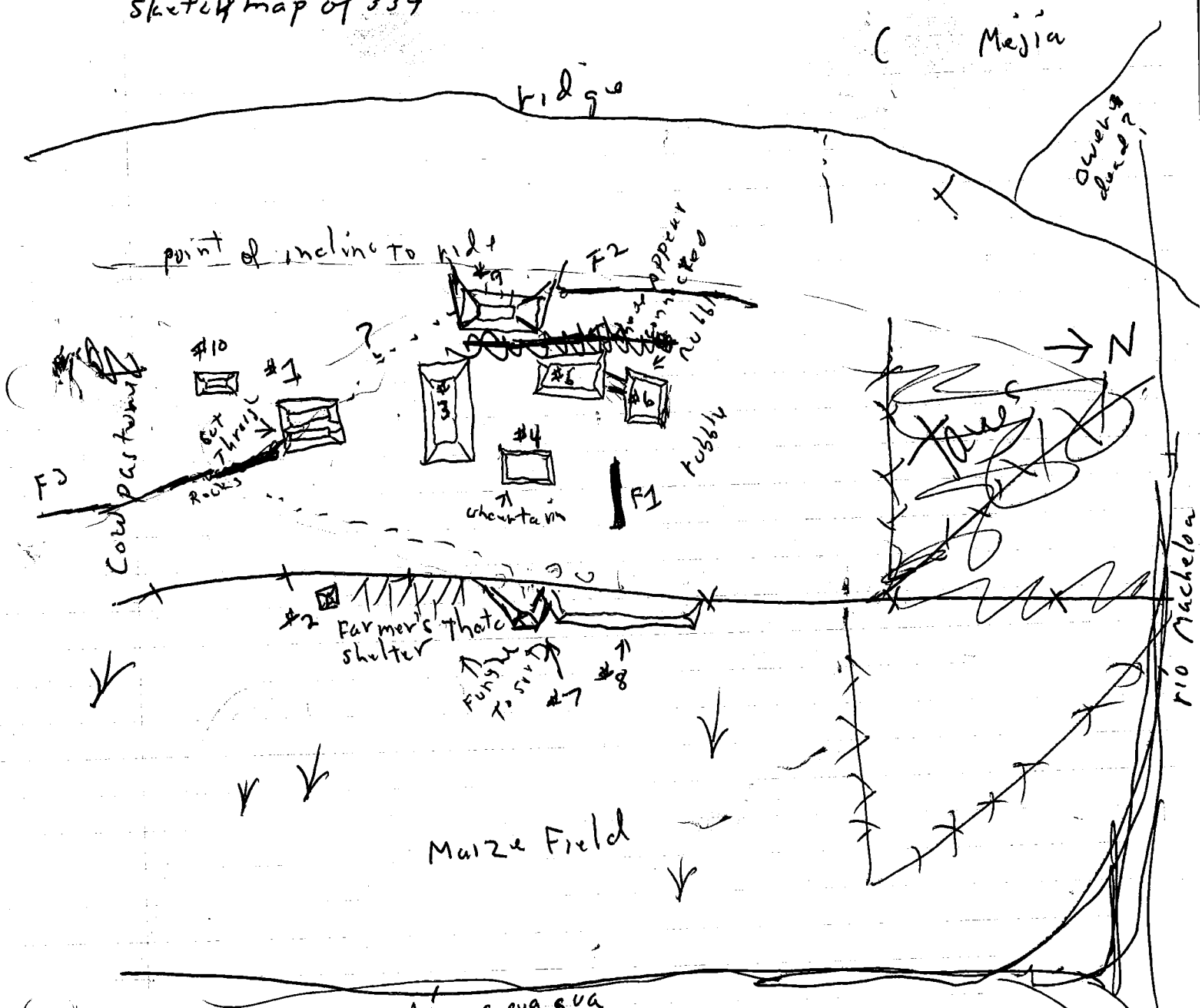

P85-26-5

27 Feb 85

Therefore we found at site 334, Ten structures (a couple less certain than the others, and two features (Walls), probably modern, but we mapped them anyway.

We then took Transit readings of structures

~~There~~ No evidence of sites in adjacent corn fields except for #7 + #8 about 2 m from barbed wire fence + 3 m from champa.

According to farmer, there are structures in the hills on ridge to our west - At least that's what I think he said, & the men that Julie talked to seemed ~~in accord~~ to say the same.

Structures #1 + #3 are tallest, but still less than one meter tall. The others are from 10 to 30 cm in elevation. Nevertheless they are clearly artifactual.

Productive afternoon; we trekked up hillsides south of Moloachoa, up the hills nothing there but beautiful views; we met several men on the high path who insisted that in the mountains to the west were "piedras anticvas". But on the south side of Moloachoa in Sri Aleman's field were 5 or 6 (probably more but we didn't see them) Beautiful mounds, we will map tomorrow morning.

28Feb85

P85-26-6

Site 335; Sr. Aleman's Land; South of Malucoa Rio.

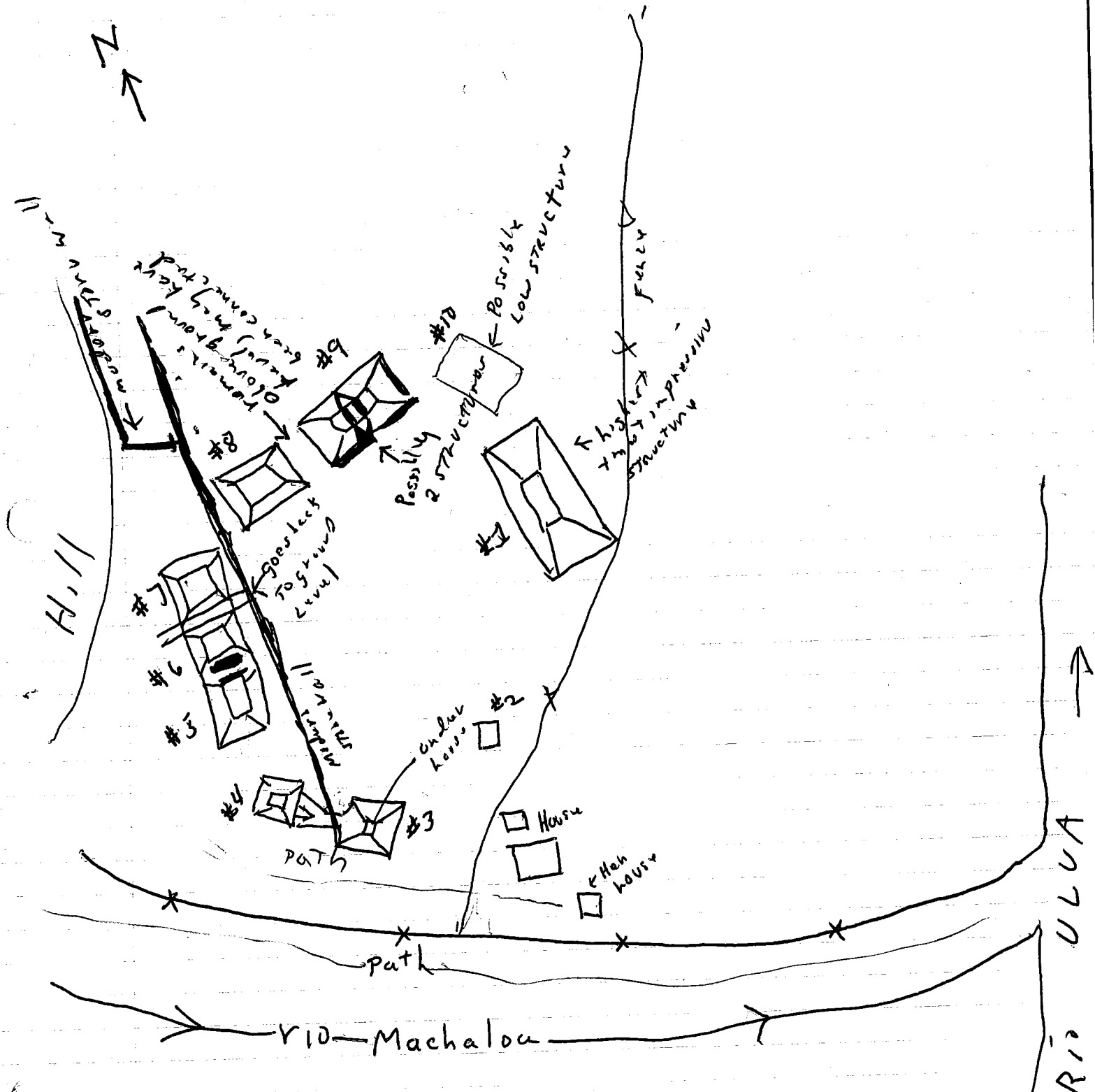

pg 6-26-7

28 Feb 85

Site 335; 10 (approx) structures

#1 -  $2\frac{1}{2}$  m high + 10 long; many sherds on surface as a result of cultivation on top.

Site is generally circular with appearance of central plaza. Sherds on structure 1 are Mexican, acised, some polychrome, + black sherds also.

The sites are clearly defined except for #2 + #10 which are low. There are a couple of other possible structures within circle but we decided the probability of being natural formations to preclude our mapping them.

Str. Aleman has made extensive stone fences around his field, which indicated that more cobbles were available a few years ago, + the site 335 may be larger than we can determine from our survey.

Outside of circle, however, we saw no evidence of structures.

#3 + #4 are surmounted by house (house itself is on #3), behind it, it drops back to machaloa.

#5 + #6 though obviously 2 structures; we know this because of dividing rock walls; nevertheless does not go down to ground level between them.

Then we took TRANSIT readings

Continued surface collection 335A LOT 1 (diverse appearing sherds but Julie says pretty much all late Classic, lot one is from structure one)

We also devalued structure #2 into Feature 1 as only a line of stones is visible



28 Feb 85

P85-26-8

site 335 cont.

Completed surface collection 335; found sherds on ~~1~~ #1, #3, & #8; surface collection most productive on structures which were most disturbed by contemporary habitation and/or cultivation, (also largest, i.e. highest) structures

Found 335A lots 1, 2, 3, & 4

~~The~~ The remainder of the afternoon we surveyed a large amount of territory, but found nothing. Starting from Aleman's land we crossed the quebrada de la Pila. There we encountered huge boulders + much rocky ground + burnt land, although it seemed to us to be a logical place for a site, being near water + some flat land, + in addition being rather near ( $\frac{1}{2}$  km?) from stone structures of site #335 — We found nothing.

We then crossed once more the quebrada de la Pila + the malucoa; intending to survey the high plateau we had encountered on 27 February. It resulted in good hiking along paths well-defined, but no sites. We walked across the altiplano to the other side of the mountain. On several occasions encountered stone walls which we suspect may in fact be the majones referred to by people in the area. We do not know the age of the stone fences but believe they are modern. We did cross two ~~the~~ stone bridges which have long since lost their <sup>walky</sup> surface + required us to detour around them.

The path brought us directly to the point on the San Vicente Road where we parked our pickup; upon reaching it we called it a day.

~~14~~ MAR 85 (Forn, Sulist, Tom)

P85-26-9

Commenced surveying the west side of Ulua (last Friday (MAR) we did not survey because of a broken van, instead we observed the excavations at Site 10~~6~~ and Gualoquito).

~~After~~ The surveying until we reached Pass de Tenon, today's principal survey site, was difficult but fruitless. We trekked up barely ~~scattered~~ trailed paths, along ridges of cliffs, through brambles, and across barbed ~~iron~~ wire fences in peculiar locations. Despite our efforts, which at least on the physical side was considerable, we observed nothing. It took three hours. We now plan to survey the flat land - cultivated on the west side of Ulua.

We spent the rest of the morning until lunch surveying Pedro Arroya's land, but found nothing. He distrusted us at first but when he ~~he~~ realized that we were not ladrones, but were legitimate, he became helpful. He claims that there are ancient features on his land - unfortunately most of his land is well plowed & so any monticulos have been destroyed at least on the surface. He did not want us to go to the features ourselves, because he said we would never find them & offered to take us this tomorrow. For lunch he offered us fried camarones, coconuts, valencia oranges & other oranges too. One of his workers then took us across the river by dugout canoe. We then trekked back to truck. On the way to Sr. Videla's house we were stopped by the cops because ~~the~~ the truck did not have a back bump plate. The cops confiscated any driver's license, but said I could get it back at the FUSEP at 4:00 P.M. today.

5 MAR 85 cont

PRS-26-11

Site #336; we found 15 structures; #15 however, though long is only possible. None are over 1 meter in height - all (except for #14, #15, + #6) are very closely clustered together and near barbed wire fence.

#5 appears to have a pavement ~~on~~ on its south side. I detected a ~~rock~~ rock feature between #5 + #11, but Tim + Julie decided against its being mapped.

In general the ~~site~~ site is a logical one - near water, surrounded by fields which are flat and arable. There is however no Quebrada + ~~so~~ over in rainy season they had to rely on the ~~fields~~ Ubra over in the rainy season.

There is no structure #9

Because the structures are low + clustered together, it is difficult to discern just where the limits of the structures actually are.

We then plotted transect points

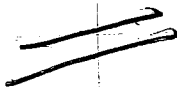

985-26-10

4 Mar 85 cont

We spent the last 90 mins at Sr. Verde's house. Found nothing all day except for a ~~stone~~ <sup>shell</sup> finding a few shells on the road near Sr. Miguel Arroyas property as we debarked the canoe.

5 MAR 85

Site #336; on Señor ~~de~~ Pedro Amayas land; went early in the morning to his land; an 11 year old boy served as our guide. This land is on west side of ~~the~~ Rio Ulva, which curves around site like this.

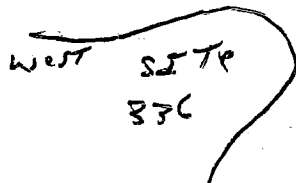

We left the dueño's farm settlement and walked across several ridges ~~across the~~ until we reached flat land on other side of ridges. There we were shown about 15 mounds, the highest of which is just under a meter in height. No surface artifacts found yet.

Mountains

Site #336 sketch map

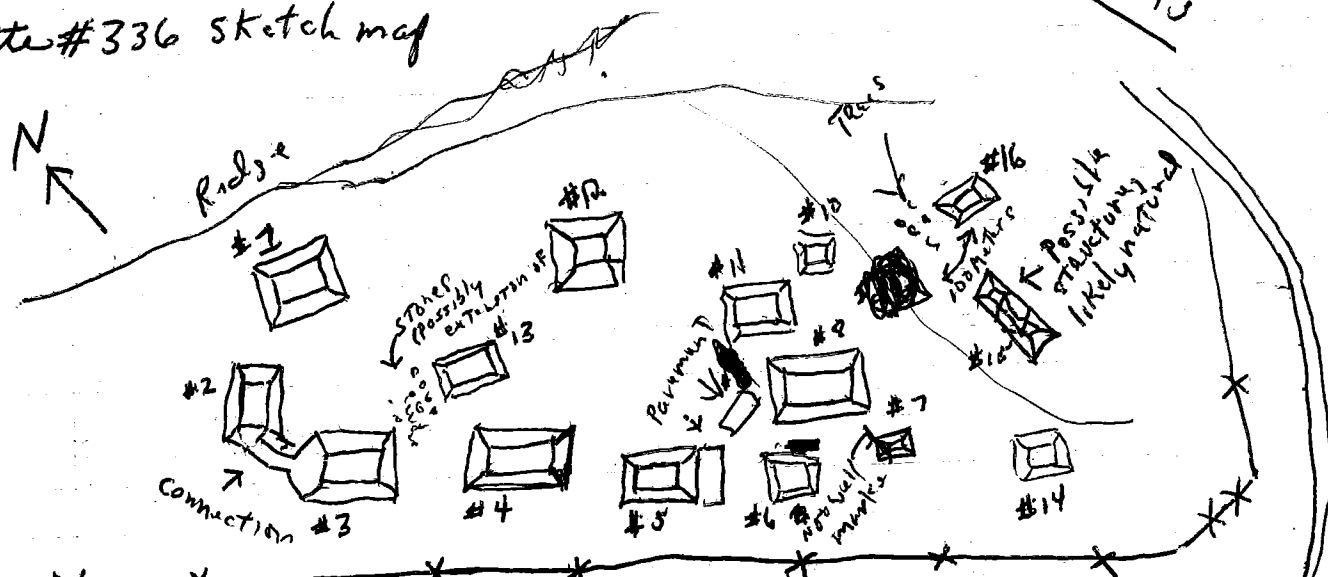

P 85-26-12

6 MAR 85

Rainy: Confined to lab + did mapping.

7 March 85

East of STA. Barbara + Taula Road + South of SR Vaide's

We ~~did~~ reconnoitered the field's and lower reaches of Mountain Behind SR. Vaide's. The landowner, a SR \_\_\_\_\_, was particularly friendly and talkative. He gave us leave to pass + survey all his holdings, which are considerable. He told us that although he knew of no montículos on his land (+ Sr. Vaide concurred with this assessment when we encountered him) nevertheless there ~~was~~ were rumors of things on the high mountain ~~on~~ behind his land (Cerro ~~de~~ Huatemulilla?). He said he had only heard from other people of such things and had never seen them himself. His wife, he claimed had seen lights at night on the ~~mountain~~ mountain. He speculated: could they be the ancients? Could it be gold? After his wife saw the lights he went up the mountain to investigate. His rumors included one concerning a TREASURE of TENC@a which he heard was on his mountain.

We did not investigate to the summit, but only along the paths to the mountainside cornfield. There are numerous quebradas + much flat land about, but we saw nothing promising, which is really a bit surprising considering the potential

just in case the lab considers  
incorrect - but it does not look

There are ruins of a modern house <sup>11.5</sup>  
from the mound (Site #337).

We will now proceed to investigate the  
same region.

---

We ~~to~~ reconnoitered the south end  
arriving at the point on the alcalde's territory  
last year. Much of the land was either  
overgrown & thus nearly impassable for our  
is worse in terms of likelihood of local  
chilly.

We found no ~~no~~ monticulos all afternoon.  
Task encounter, we met two social workers  
on a water project. In talking to them they  
old house that we should take a look at  
go start out to look for it, feeling certain  
was a few hundred years old - but  
site is a site & a lead is a lead, & some  
might turn up. On our way there  
in a cornfield ~~to~~ we asked them if  
us that <sup>the house</sup> was only one hundred years old  
this we turned around & did the flatter &

today the survey team comprised Ted  
Brennan & myself.

---

11 March 85

This morning Julie, Dan, & I set  
southern end of Tenoa that we had not  
Asilio Romero's land ~~was~~ (or Emilio  
across an obviously artifactual, &  
monticulos. Julie hypothesized that  
so probably modern. It is or a  
with a single large bull in  
be other possible monticulos along  
in the field. Sr. Romero cut (or  
assisted) the tall grass on the  
us. We told him that if the  
permission to do so ~~and~~ we will  
in the week & pay him to clear

Also: he gave us a lead which one

On the Vega which is between Rio  
that separates it from the village  
on a ridge ~~so~~ toward the south  
~~we saw~~ on edge of ridge, among  
stones we discovered SITE #338.  
small structures - some clear  
monticulos

11 MAR (CONT)

Sketch map of site # 338:

338

corn field

base of ridge

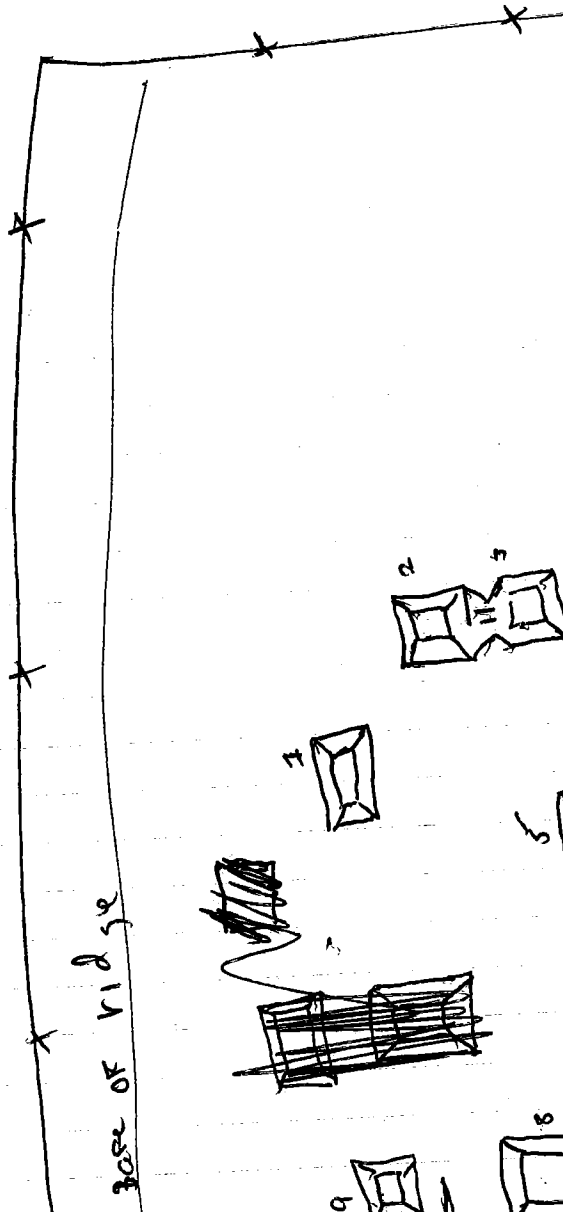



11 MAR 85 cont

After breaking for Lunch we took Tra

Basically: The construction lines of the  
surprisingly clear & easy to locate  
They are, however, low. What  
about the settlement is the number  
the compactness. The structures are  
a few meters apart. There is also  
vicinity — ~~where~~ only the Uluu,

after taking tramping points we started  
ridge & then saw another site # 33  
the day, we decided to return tomorrow

12 MAR 85

We (Julie, Don, + I) arrived first at site #339. The monticulos here seen, + the lines less clear than it is only about 100m away, but are several possible reasons for the naturally stony, so it is low less than #339 — therefore, although planted whereas #338 has been (in pasture + therefore is largely undisturbed) lying below the ridge #339 is deposits. (A ~~mass~~ mound was surface).

Sketch map of site #339

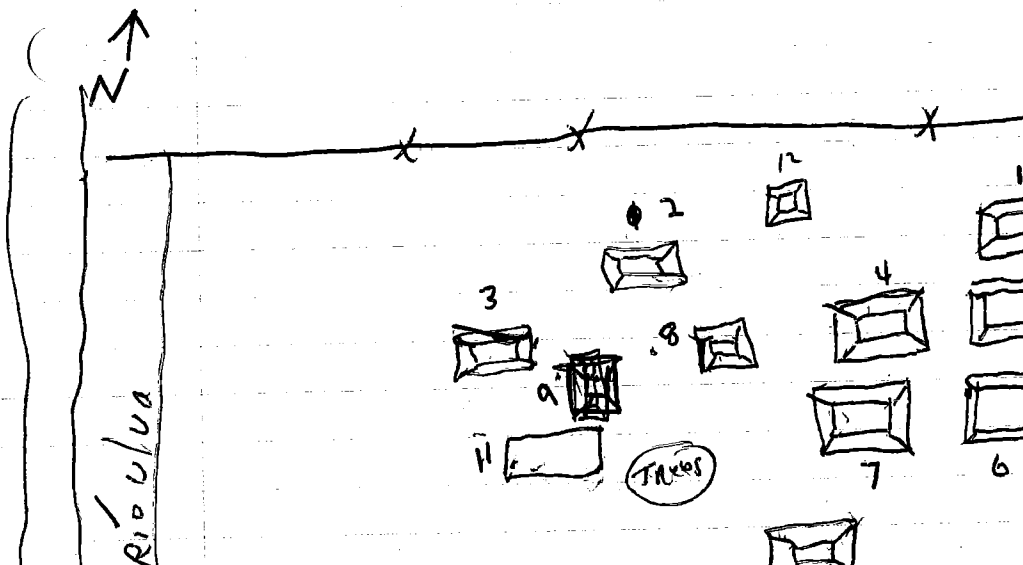

12 MAR 85 (cont.)

We then took Transit points for site #339

//

After lunch we reexamined site #340

Sketch map of Site #340:

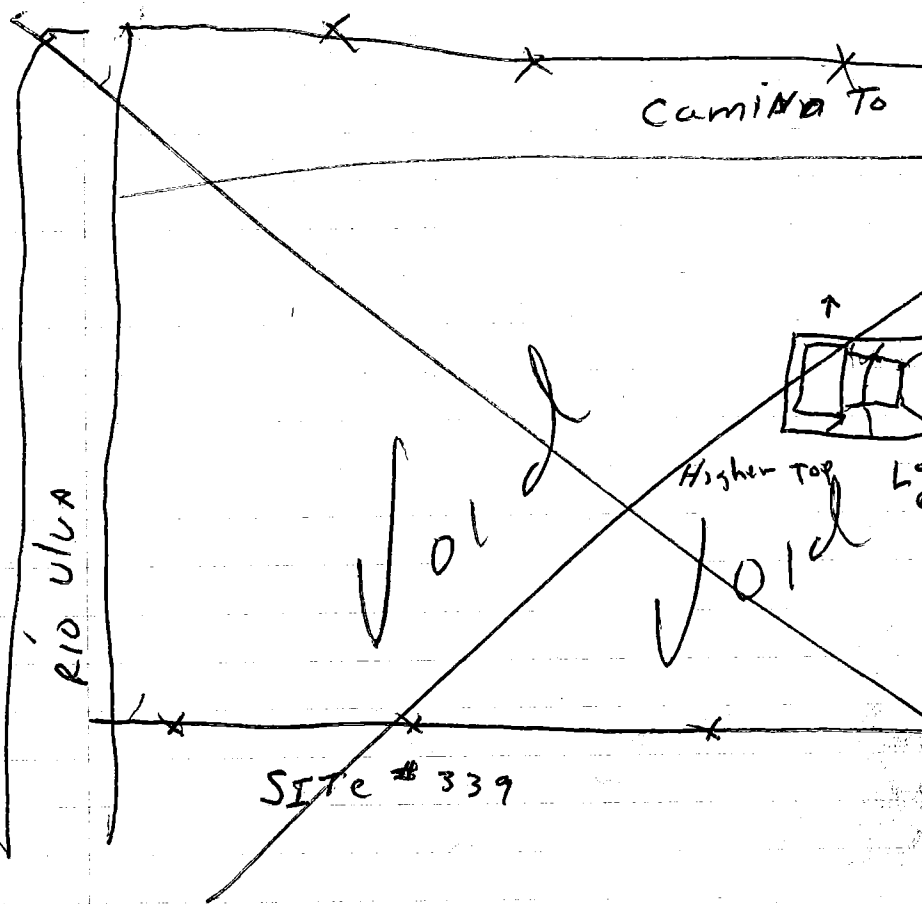

12 Mar 85 (cont)

with the guidance of two local men we  
+ large monticulos:

Sketch MAP OF #340

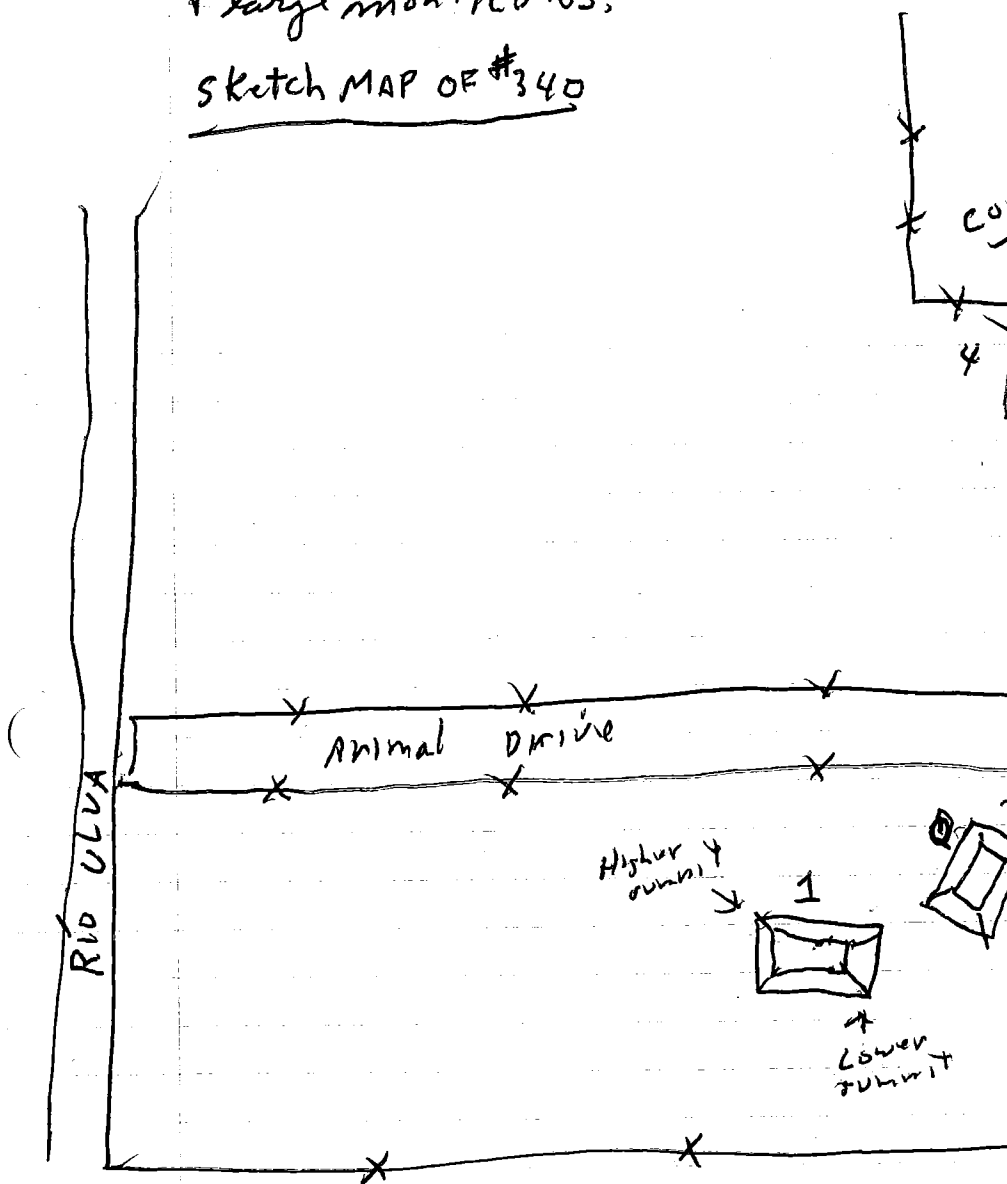

13 MAR 85

Juhé, Dan, + I took photos of  
afterwards we went a Macholobane  
church + saw it - it had in the re-  
pair. There are no monticulos vis-  
or in the town itself. However, under  
there appear to be stone foundation  
speculation, makes sense in light of  
of taking over existing communities + build on  
we then surveyed more

after I surveyed the rest of Macholobane  
NICOLAS TO TALK TO THE PRIEST. b

We found nothing all day

14 MAR 85

Today with great difficulty we looked for caves, but  
them, although we had a guide. We recommenced  
next Tuesday

<sup>18</sup>  
15 MAR 85

Today Julie + I reconnoitered  
the Land Cruiser; it took a little over  
at Viejo Celilac we saw the ruin  
Colonial church. Up the circular stairs  
still possible to climb to what was  
the bell tower.

An ~~old~~ woman living in a m...  
let us take a photo of a colonial face  
done in ceramic with a hole in...  
it was found by playing children in  
of the church, and appears to be an  
water font.

Aside from the church, and a few  
monticulos under the woman's house  
not yet come across anything, especially  
the woman said that "evergas" has a  
here. after writing these notes we will  
reconnoiter.

18 MAR 85 cont.

Site 341



Road

Stone Foundation  
Ck or clearly  
structure on  
slight rise



possible bis

parallel  
road

Parallel

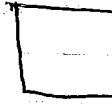

18 Mar 85 cont

we reconnoered the land to the Quebrada across  
church. There are ~~many~~ many potential  
Post-Hispanic building materials such  
plaster adhering to rock. We found  
and one metate (also broken), ~~and~~ a  
we will, after lunch, survey the ~~area~~ area  
on the ~~to~~ ~~the~~ church (east) side of the river.

Although the site is probably a center  
we were able to see little in the m  
mound. ~~we~~ we did take measurements  
for details) ~~if~~ possible as well as on  
rectangular foundation

Juke found a couple of colonial sherds  
The large scale landowner here (Sr. Cabro  
there are large mounds ~~to~~ on his  
of where we surveyed today. What  
the many possible mounds we saw  
absence of cobbles ~~to~~ to form  
It is, of course possible that more  
quarried for ~~to~~ building stones —  
Perhaps the colonials did it in  
old city.

For postclassical + colonial archaeology



19 MAR. 85

Today Julie, Dan, and I ~~so~~ did a pre-  
Cueva de Masilac. We were accompanied  
two local men, neither whom had  
cave before, and at the entrance also  
and a frightened dog, who whined & fra

The cave is big - really long - in the US  
attraction. We only travelled along to  
I did not go all the way back. We  
idea how far it goes back; the  
one that the dueño advised us to take  
not get a chance to go through it -  
with us really wanted to go up the m

No matter how deep into the cave we travel  
lots of them - some from what we  
gets. Surprisingly, we found more  
~~no~~ sherds - almost not faintly -  
of it looked like ordinary ~~the~~  
it tended to be in hard to ~~the~~ re-  
ledges, in nooks, etc. Also the  
torch sticks indicate that there has  
looting over the years.

The tone it self has magnificent lines  
worth seeing.

20 MAR 85  
sketch map of Site 343 [at La Vega, west  
on land owned by owner of Cueva Masical]

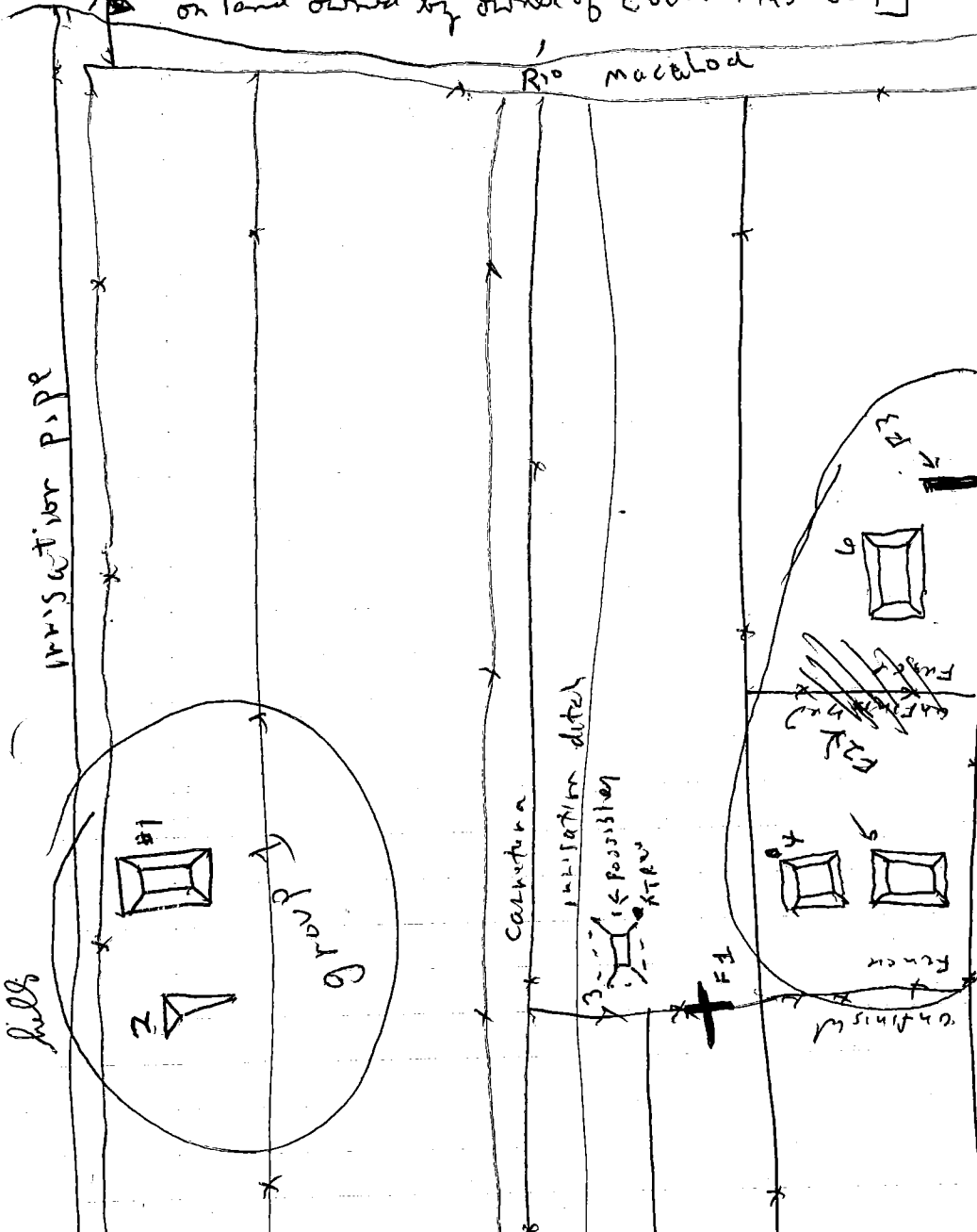

20 MAR 85

Site 343 - This site is located about 1  
on ~~the~~ don Mauro Castellon's land - he  
Cueva Masical. ~~So~~ Julie + I found  
vega ~~to~~ south of Rio Machaloo, all on  
carretas. It is possible, + perhaps  
there were originally other mounds  
of cultivation, have disturbed the site  
those which are visible are not  
the features which we mapped are  
instance F2 may in fact be several  
have tumbled inward on each other  
to distinguish ~~anything~~ anything but  
that of otherwise for F1 which is  
it may be modern. Who knows

East of the ~~Carretas~~ Carretas in the  
campesinos) we saw nothing, at a  
were jumbles ~~of~~ of stones. These,  
irregular and in the context of  
ground that we decided they were

A possible explanation for the barrier  
~~in the~~ (in an archaeological  
approaches Machaloo is that in antiquity  
the land lived in the town, indeed  
and that site #334 is far enough from  
permit a few residences there  
ion to ~~the~~ on the site. This is

21 MAR 85

This morning Julia + I completed taking recd. it is a small site in terms of numbers of same time spread out. I suspect that is only an artifact of how we came upon reflect ~~the~~ actual ~~canon~~ layout of a single period.

We will next reconnoissance the flat land ~~the town~~ between Site #343 + TOWN.

The reconnoissance of the aforementioned ~~at~~ the discovery of no mounds or sites was found on the camino ~~to~~ Mach Machobau we performed a surface roll church. Many shrubs, mostly tejas a about the church. This is Site

24 MAR 85

Today we returned to Viejo Celilac  
We anticipate making sketch maps  
near the colonial church ruins,  
the fields not surveyed last

Sketch map of #34A - church

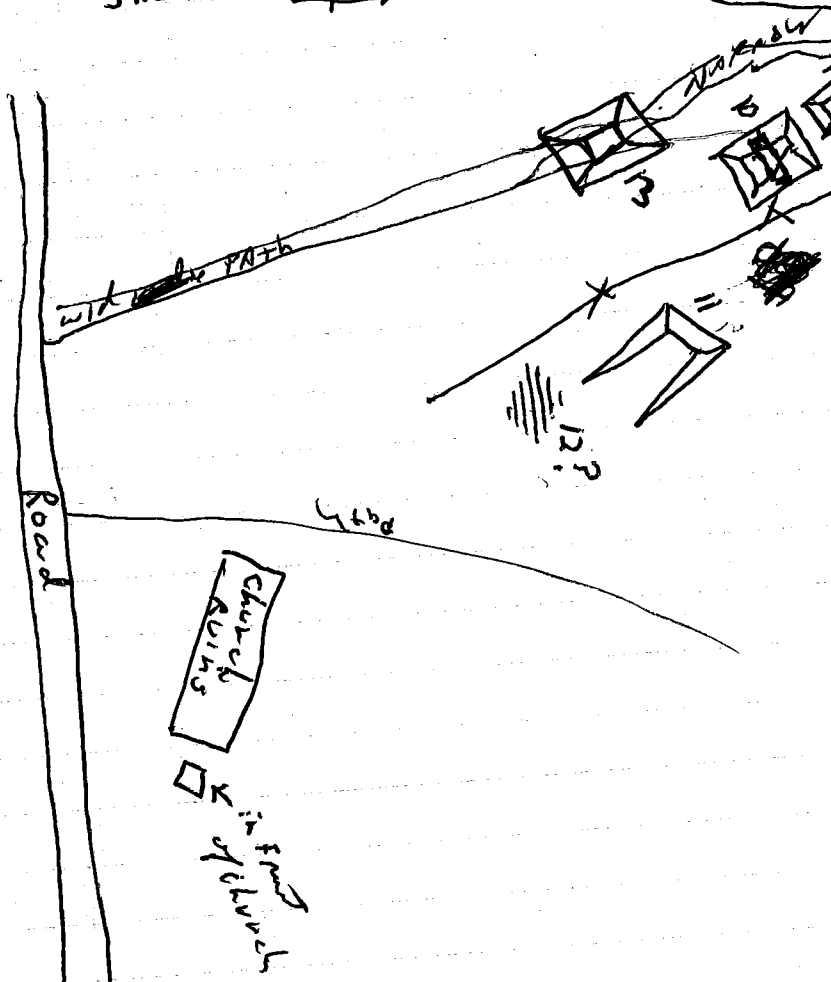

24 MAR 85  
MOOROF SITE #34A

P8

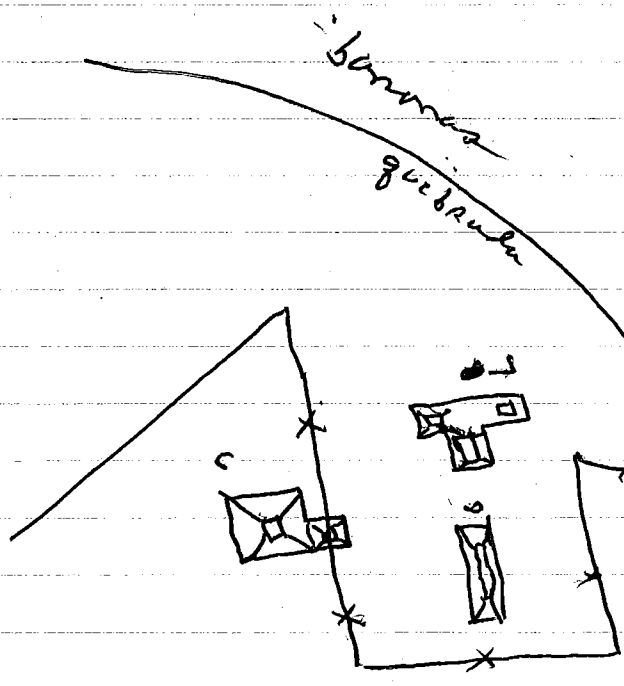

24 Mar 85

N at Viejo Celilac SE of road and  
↑ church we encountered a field  
many obvious mounds. Unfortunately  
been removed & put into piles by  
and stone lines are less of visible  
otherwise be. We named this site

Sketch map of #346 (Viejo Celilac)

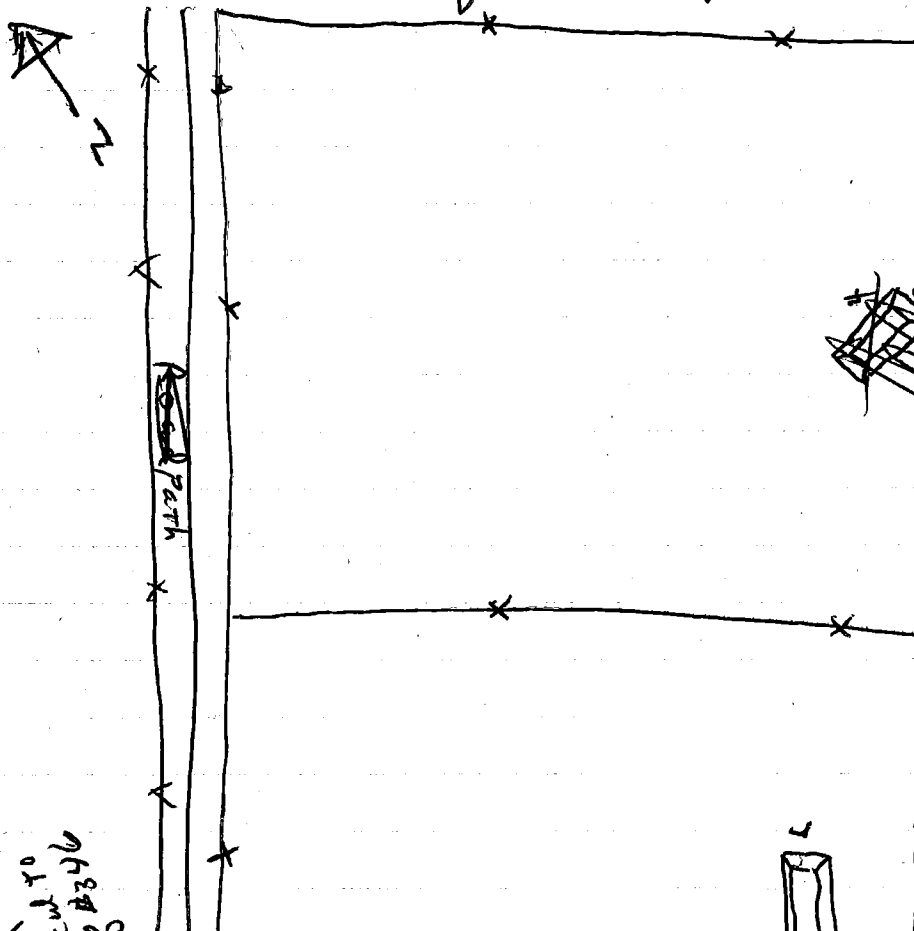

24 MAR 85

Viejo Celilac looks promising should it properly. South east of the church definite structures. There are probably but at present these are unperceptible. They have removed stones from them in their fields. This is evidenced by heaped about the fields.

We received a donation (lot 5) from a local man. There were two ceramic fragments, which were feet for some kind of vessels.

He also told us about a cave. A local woman was in accord with us about a second cave near here as well.

In my opinion the people of Nuevo Celilac are considerably more friendly than those of the other sites. They even helped us gather sherds for 40 minutes. It would be made & all other things. ~~At~~ Nuevo Celilac would be my first excavation site before Macholac.

// We mapped 346.



25 MAR 85

Not being able to start ~~so~~ surveying  
summit ~~to~~ Gualala, we were sho  
rtened.

Sketch map of site of ~~the~~ #347,

---

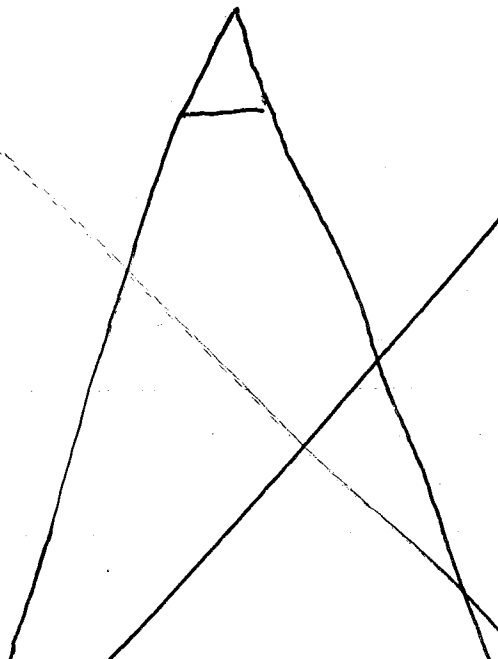

## Sketch map of Gualala

Gualala appears to be a site with mounds about a half hour of reconnoiter several, as well as a few surface as well as a mano.

Unfortunately, the landowner was his wife refused us entry to the her husband would be. Return of course that would give us little more than make a sketch on

We encountered ~~at~~ two clusters separated from each other by a we located NW of the cemetery well known by the townspeople alcalde went out to the site us. The landowner is named De

The largest mounds had two pits in it. The water source community would have been the as the local people know, all a land.

Not being able to map #347 we proceeded to El Encanto near of Rolando Gonzalez. Site #

25 MAR 85

The people who live in the nearest house there is another site across the road hills

Sketch map of site #348

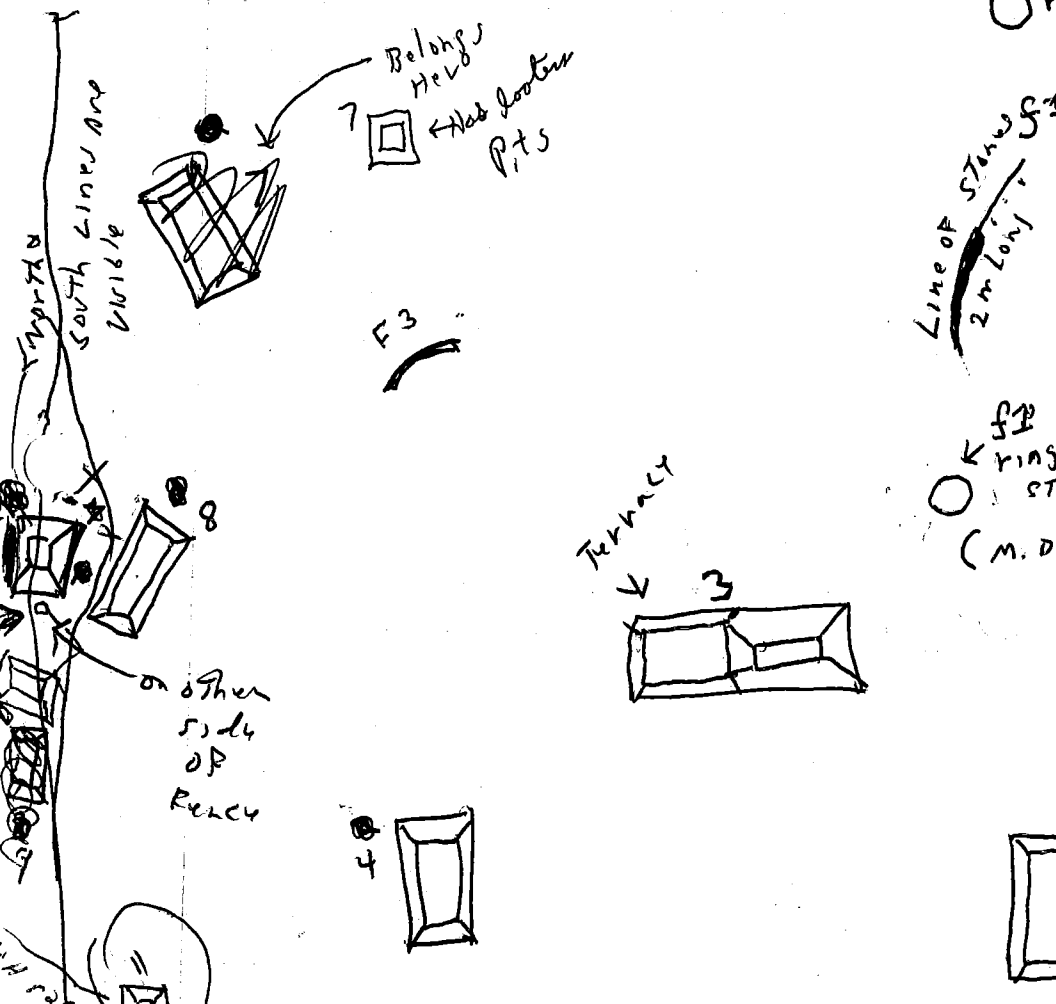

25 Mar 85

Sketch map of # 348 cont

---

16 orientation unclear



25 Mar 85

There are so many bugs, including *Ti*  
hear it for the Antarctic!

26 MAR 85

Today we obtained permission to survey  
Fernandez at Gualala. (See preceding

Sketch map of Gualala Site # 47A 15

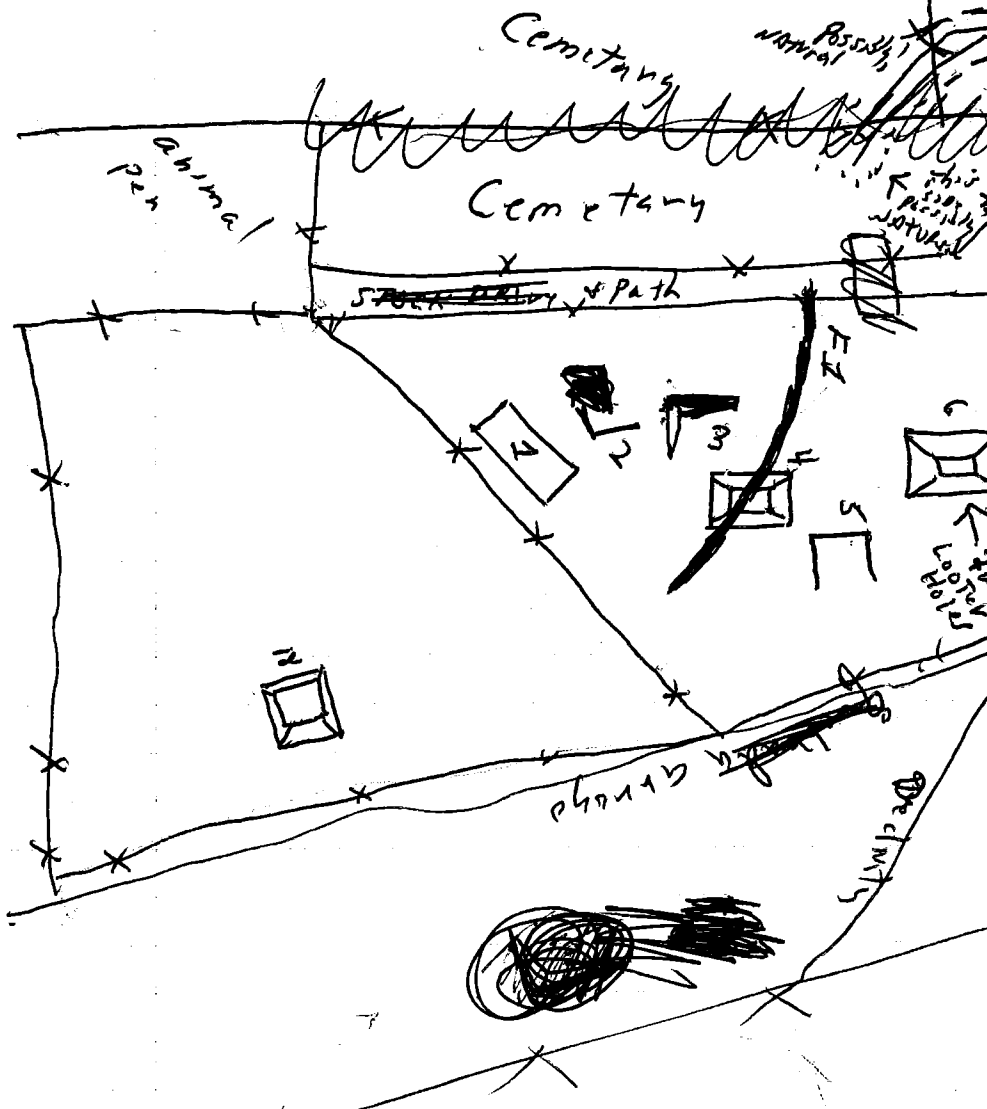

26 Mar 85

In terms of natural boundaries, T  
of the Rio Uva seemed to be a  
to our surprise, scouting resulted  
structures 20, 21, & 22. Truly, it seems that th  
we have only surveyed its core,

One structural similarity to site  
various of the low structures had  
end — in an apparent border,

Taking transit readings stands to  
of the trees & underbrush as well as  
of fence lines, none of which run  
also the Uva curve ~~but~~ here  
abound,

Sheds were found on STR 20.

27 Mar 85

Today after much in the way of pro  
Julio, Tim, & I got to survey Miguel  
had known in advance how ~~over~~ over  
— but at the same time we thought  
was a major site on his land. Now  
we have not yet completed the survey  
likely that this land contains nothing

Along the side road between Amaya's  
somewhat south of the house we discovered  
jungle, overgrown, unrecognizable, little  
clear mound. Tim, however, found the  
root of a tree.

It is certain that this (Site # 34)  
is indecipherable in its present condition  
~~no~~ road, cultivated, overgrown, full of  
stumps. The sherds are lot #1 & we

after this we proceed to survey the rest  
land.

28 MAR 85

Today (after being delayed till noon on a  
... ..)



The preceding map is exceedingly incomplete. There are several reasons for this: First, there are so many structures and so little time to get acquainted with them all. Second, this is a big vego, & in order for us to accomplish even a superficial survey, it was necessary to split up - ~~into~~ we thus have different information. Third, we decided that rather than attempt to sketch all the minor structures today and hope for a one to one correspondence on our maps, that we should take transit points on the main cluster, & simply indicate the presence of the others. Whereas, this may seem to be, from the perspective of thoroughness an ~~entirely~~ wholly ~~an~~ unsatisfactory course of action - nevertheless we in concert deemed ~~to~~ that an at ~~least~~ partial map of the major cluster which could be relied on was preferable to merely having rough (certainly rough for the ~~the~~ aforementioned reasons) sketches of the alleged whole.

There appears from my reconnaissance nothing in the north west section of the vego. However, in the vicinity of the fish pond there is a cluster to its north west, another to its north east, and approx 100 meters away another to the ~~west~~ southwest & a fourth to the SE. I do not know, if in fact the appearance of clustering reflects actual settlement patterns or not. The clusters may only be artifact of what remains ~~as~~ as a result of the vego's modern agricultural history.

In sum, this is a major site.

We then mapped with the transit as much as possible.

During lunch Fuchs confirmed the hypothesis regarding the presence of mounds under the houses and about the houses to the NW, bringing us shards (painted) a very worn maw, and a matate - which had been smashed by children.

29 MAR 85

PDS-26-36

Life is tragedy & history is one pestilence and atrocity after another. I am reminded of the destruction of the Gnostic Gospels in the mid-twentieth century when the Bedouins who found them - destroyed most of them & used them as kindling for cooking fires. "Against stupidity the gods themselves contend in vain." Of course no mistake is that important - but it is indicative of a pattern in the species to indiscriminately destroy.

After almuys we continued to map.

8 APR 11 85

PBS-26-37

Today Julie, Dan, + I started excavation on site # 320 on the Mayora land. We started out by selecting three structures to excavate in 1m x 2m by 10cm pits. My site is 320 ~~Lot 1~~ lot one will be the first batch of things. The workers names are Cruz + Alejandro. At present they are clearing 320 ~~Lot 1~~ to a depth of 10cm. They have not yet encountered tesserae or lithics - but of course this is just the beginning.

This is structure 7 of group A - we are excavating the 1x2 pit on middle of N side of structure

Since it appeared that the wall (North) of the structure(?) was further north than the 1x2m pit, we decided to extend the pit one meter further to N., thus turning it into a 1x3x10cm pit.

nothing artifactual was found in the 10cm deep extension, so the excavation was extended to a second lot of 10cm to 20cm in North Meter of 1x3 pit in STR 7 (320 Lot 2).

Nothing was found in the 10cm to 20cm level, so we continued from 20cm to 30cm or until a soil change. (Lot 3 was sterile)

Since lot ~~2~~ 3 was sterile we continued excavating North Meter square from 30cm to 40cm deep. (Lot 4)

The humus over here is surprisingly deep we have gone down to 40cm without a soil change.

PPS-26-38

Having only encountered sterility in Lot 4 we dug another 10 cm (Lot 5, is 40 to 50 cm in N sq m of 1x3m pit in North side center of STR 7.)

in this level (lot 5) at  $\sim 45$  cm we encountered a lot of rocks which may be part of a basal wall since the humus is so deep here, it is likely that the ~~base~~ base of the structure (7) will be clear

lot five (5) turned out to have no sherds, however, the rocks at 45 cm are most interesting, - from here we will proceed to lot 6.

Lot 6 is the center sq meter of the 1x3 meter pit in STR 7. ~~lot 6 is the~~

We cleared away the humus from 10 to 50 cm or until the rock line was encountered

no sign of clear walls yet, just tumble and at 50 cm deep!

after lot 6 is cleared the 1x3m pit will be extended 1 meter more to the North, i.e. away from the structure, this will be lot 7, it will be 1 meter sq and  $\sim 50$  cm deep or until stones are found which appear wall-like. Lot 7 is sterile.

In order to determine ~~and~~ where the north terminus of STR 7 actually is, we dug 10 cm deeper in the North square meter of the 1x4m pit, and will ~~do so~~ dig until we encounter the limit. This is (lot 8) was sterile

In analysis we concluded that lots one through eight (~~at~~ SITE 320 <sup>sub</sup> operation ~~10~~) were really one lot.

8 APR 85

785-26.309

After consolidating lots one through eight we dug a second 1x2m pit ~~to~~ 20cm to the west of ~~of~~ sub op B.C.

This 2<sup>nd</sup> pit is sub op F

We are carrying the digging down to the point at which rocks appear in a natural level. IT seems likely that if ~~on~~ the very jumbled terracing of rocks found in ~~a~~ sub-op B are in fact the jumbles of walls - then sub-op F should reveal it

Sub-op F pit is still being dug, and as yet there are not clear indications of walls, ~~is~~ just tumble. There are in sub-op ~~B~~ pit large rocks, almost boulders, and considerably larger than anything ordinarily used for construction thus far ~~the~~ structure 7 has this general appearance.

STR. 7 N  
↑

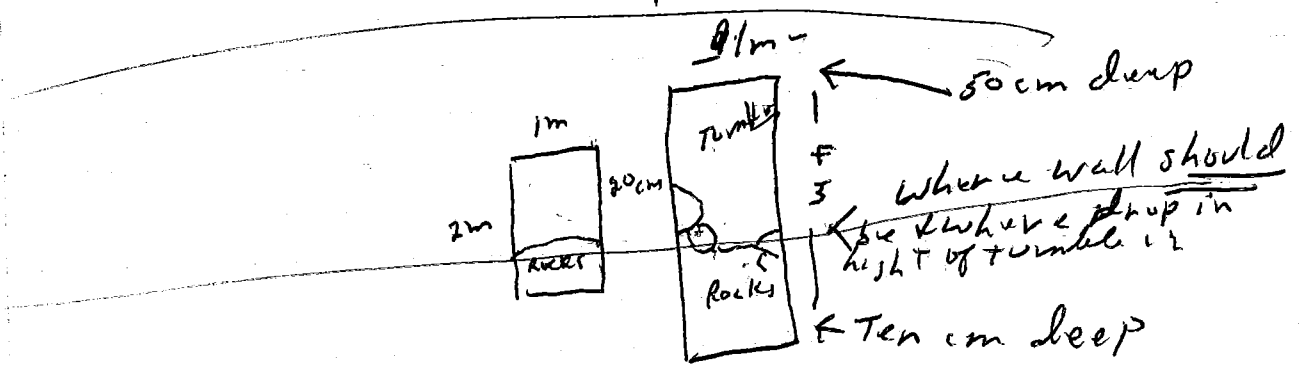

But as yet,  
nothing clear.

8 APR 85

P95-26-3940

Continuing about Site 320 group A, sub op F (†<sup>c</sup>) on STR 7.

9 APR 85

Since wall lines in structure 7 are as yet inconclusive, we decided to extend ~~it~~ sub-op <sup>c</sup> one meter further to the N, to the depth at which rocks are found. The purpose of this action is to find the limit of the tumble. We are working at a depth of 50 cm (LOT 9) + more.

Our next plan is to go over the top of structure 7 by extending the south end of ~~the~~ sub-op <sup>c</sup> by 2x1 m, to a depth of the stones: essentially just clearing away the top. We will then go onto the other side - ~~to~~ perhaps find a South ~~or~~ wall.

If however the N terminus of the str 7 is not found, we will extend the digging 1 m further N. If however the rocks at this point seem scattered, we will dig through them to sterile.

In lot 9 ~~so~~ we found a small <sup>c</sup> carbon sample, at ~~most~~ a couple of grams, & the rocks seem to continue relentlessly to the N.

In sub-op <sup>c</sup>, while cleaning the rocks, 1.5 m south of the carbon sample & 10 cm lower than it (the carbon sample was found in the East ~~end~~ ~~side~~ pit wall) we encountered a rectangular piece of red clay 15 cm by 10 cm - but on checking to learn how far it extended we ~~to~~ found out that it was only a clay blob & was not part of flooring or anything architectural.

9 Apr 85

P85-26-41

Not having encountered the Northern limit of STR 7, we have decided to extend the N end of the pit by 1x1m (lot 10) - if the cobbles do not end at this point, i.e. within this square meter, we will not pursue the terminus farther. Rather we will simply measure the depth at which cobbles commence, + then ~~take~~ take out  $\frac{1}{2}$  the cobbles + measure their depth.

at lot 10 they ~~are~~ (cobbles?) begin at  $\approx 70$  cm deep, and do not end at the Northern limit of the pit. So we will dig at lot ~~10~~ 11 - one meter ~~from~~ from Northern limit of pit to depth of stones - .75 meters pit like so

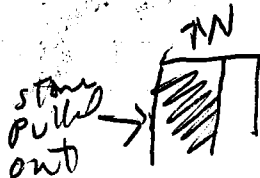

Lot 11 is what is removed from the West .75 m of North square meter ~~at~~ of STR 7 ~~PIT~~ PIT - sub-op ~~of~~.

We think that at 97 cm lot 11 becomes (in terms of depositional significance) a stream bed. The cobblelike rocks continue from 70 cm to a depth of ~~at~~ 97 cm

After abandoning lot 11, we ~~now~~ started to clear the top of the structure extending the Trench of ~~the~~ sub-op ~~of~~ first 2 meters + then another 2m to the south.

We will dig until the cobblelike ~~stone~~ rocks are revealed rather than in arbitrary units, and the resulting 4x1m extension to sub-op ~~of~~ ~~B~~ will be included ~~in~~ lot 12, since we anticipate nothing significant in terms of depositional differences from the other side.

9 APR 85

P8526-42

at this point I am quite disappointed with STR 7. Through no fault of its own we are unable to make any sense of it. Thus far, after nearly 2 full days of excavation only 1 shell had been effumed. The north side slopes in somewhat clear terraces or wide steps, but the stones are placed so haphazardly that it is difficult to imagine their function — Are they walls? Too uneven, & not really placed on top of one another. A floor? No one would have constructed such an uneven surface to walk upon. A barricade — but why right in the middle of the plaza? Then at ~70cm to 100cm a layer of rocks, but a rough one continuing for into the plaza — or at least away from what we presume is the main structure. What is it? We have gone over the top now & see things that may or may not be lines of stone. Let us see what sub-op ~~10~~ on the south side of STR 7 reveals.

Lot 12 was sterile

tomorrow we will start to dig into the north side of the summit itself, in search of some architectural (+/a artifactual) certainties.

10 APR 85

This morning we started cutting into str ~~7~~ seven, ~~at~~ in the pit (sub-op ~~10~~). The cut began at a depth of 53cm, ~~at~~ at 4.3 meters from the northern end of the pit. We proceeded southward into STR 7. (This is Lot 13) ~~up to the~~ The mid point of the summit



10 APR 85

P 85-26-43

~~was~~ on cutting into STR 7 (lot 13) we came upon a few rocks which possibly form a crude retaining wall. This we named Albania Feature:

Sketch section of Albania Feature - Not to scale

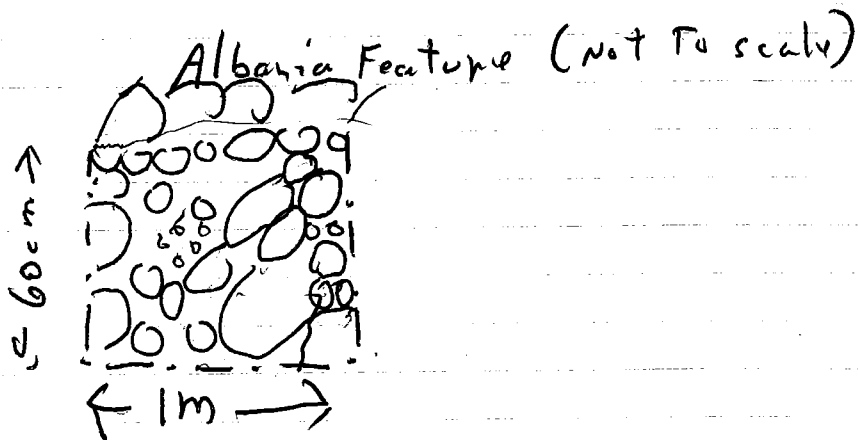
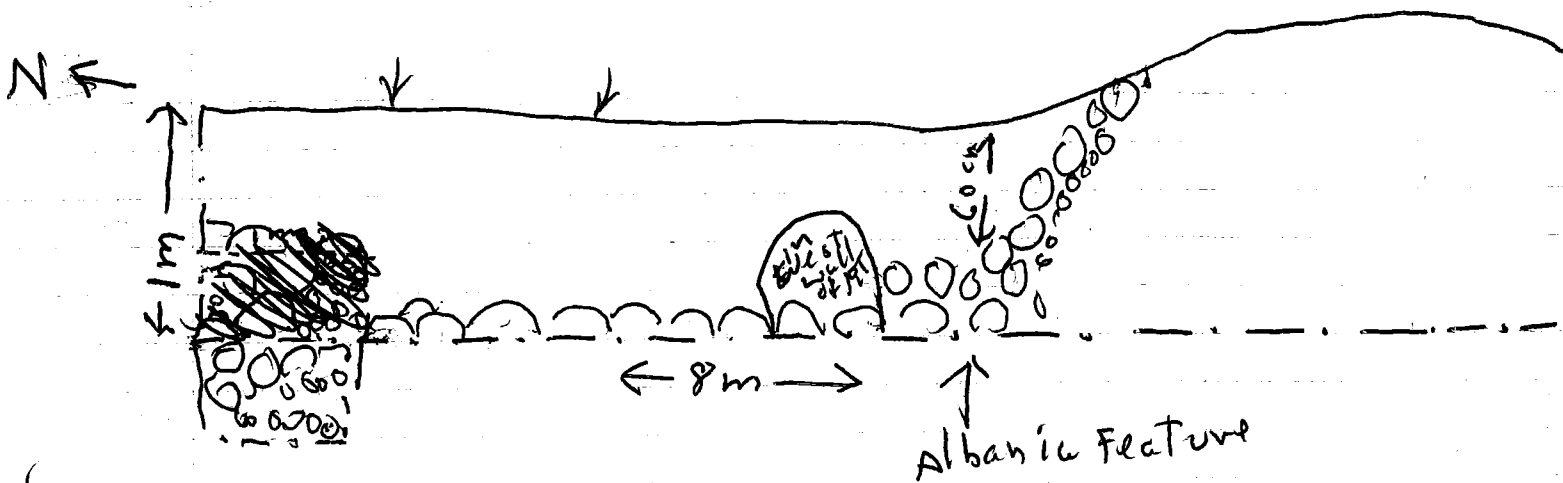

The shreds + carbon sample in LOT 13 were possibly Tumble From albania Feature.

From the sketch it is obvious that albania doesn't look much like anything. There are a few good size cobbles, but mostly fill. Nothing looks carefully laid - I am getting the strong impression that ~~albania~~ STR 7 is just a Tumble of modern rocks, possibly the result of clearing land.

If any references in the preceding pages are to sub-of B, these are incorrect — the correct designation is sub-of C.

we took 2 photos of Albania, + then took ~~an~~ transit readings of it.

like then started to excavate 8 more, extending gap-of C 2x1 m South. I told the workers to dig until finding cobbles  
a carbon sample, a small one was found in lot 14 at 30 cm

because of the lack of sherd + the gross irregularities of what we suppose to be wall lines, combined with the fact that all carbon obtained from sub-of C has been from above the tumble, + thus probably modern; ~~the~~ opening the STR 7 is NOT a STR at all — but a pile of rocks, though a large one, which in Post-conquest times was created in the process of land clearing. It seems to rest on an old stream bed — at least on the N side. near the N excavation limit the cobbles are only 1 dayr deep.

excavating the south of STR 7 has resulted in quite a surprise, or rather several surprises:

1. The soil on the south side of the structure is brown, whereas the soil on the North side is black.
2. The layer of cobbles, i.e. the tumble does not extend more than a meter beyond the structure itself — whereas on the north ~~side~~ we ~~looked~~ did not find the end to it.
3. The rocks + pebbles on the south side are similar to those under the tumble on the North side, but here there are no cobbles to be under

~~10 APR 85~~ 10 APR 85

P 85-26-45

• at the south end of sub-op C, the men are digging to the depth of one meter. This continues to be lot 14, although it is probably beyond the structural limit.

// We just redesignated the 1x1x1 southern limit of sub-op C as Lot 15. It is (aside from the first 10cm or so) where there is a sprinkling of Tumble from the structure - pre-construction.

Lot 16 - digging into structure from the south, starting 1m north of south limit of excavation

we now know that the living level (floor level) at time of construction of the south side was 50cm beneath present level of ground.

11 APR 85

Sub-op C continues today with Lot 17 - This lot is in essence a continuation of LOT 16, but much closer to the wall. I gave it a different lot number because the tumble at this point becomes more than one cobble deep + it is where ~~one finds a massive~~ the south slope of structure becomes evident. We hope to uncover S wall

We did in fact find the wall on the south side of the structure (Benin Feature). IT has the following specs:

Depth 69cm  
length N/S - 60cm (IT is a sloping Feature)  
~~the~~ + includes some Big rocks

Lot 17 was sterile

P85-26-46

11 APR 85

CS of D, Lot 18 — We are cutting into the structure from the  
Albania feature ~~and~~ going south to ~~middle~~ <sup>front</sup> of  
structure — To depth of sterility: 68cm at  
OP/ Albania + \_\_\_\_\_ at midline.

Sub-op  
320C

Feature Benin: sketch (section)  
East Wall of Excavation

NOT TO  
SCALE

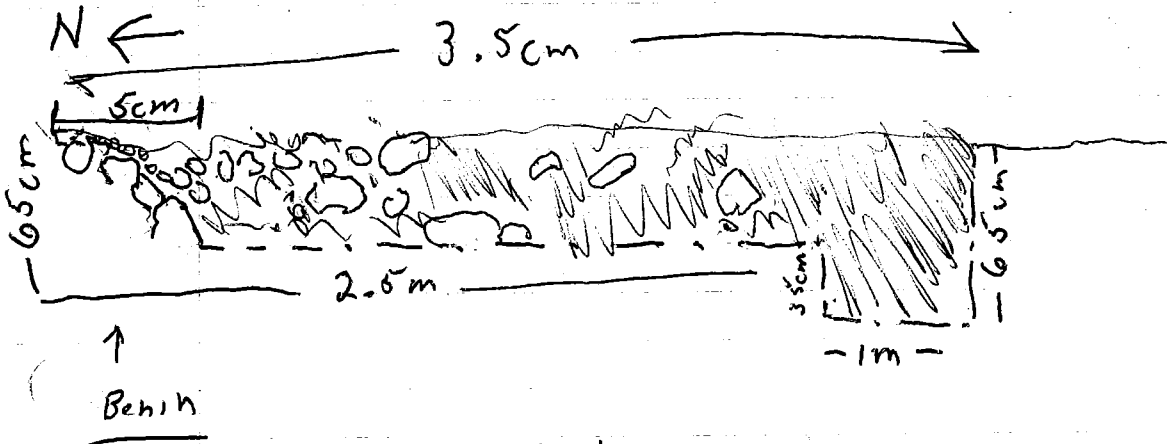

Benin

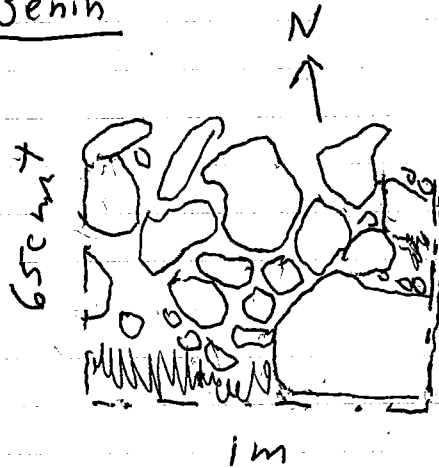

NOT TO  
SCALE



11 APR 85

P85-26-47

lot 18 appears to be sterile, & thus far contains only one Jute! we will continue it, also contains a stone with a bore in it, and ~~and~~ a somewhat cylindrical stone.

After cutting through structure 7, we make a section drawing of the East excavation wall.

Following that another excavation pit in STR 7 was opened: a 1x2 pit oriented E/W and the Western end of which is 18m East of the East wall of ~~of~~ sub-op C. — This pit is sup-op J.

Shards were found commencing at 1.9m From East end of EXCAVATION & also on ~~side~~ side Plate

Julie & I started to map 32C, a section of S. Wall

12 APR 85

in ~~of~~ 320C lot 18 in base of stream bed we found a fossilized clam or scallop shell.

Julie & I completed the ~~the~~ Drawing of 320C (section) of East wall of excavation.

The workers continued to dig 320J until reaching stream bed cobbles. Since the original 1x2m pit only yielded ~~the~~ shards at its SW corner, we extended it westward 2m & southward (in the center 2 meters of its 4m length) for another meter, giving it the following shape:

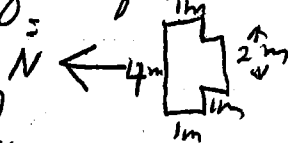

Shards were found but only in the ~~the~~ humus above the stones ~~in~~ lot (320J lot 1)

12 APR 85

P85-26-49

As much of the workers completed what we wanted them to do before Julie + I completed drawing D85-26-3 (320 group A, 320C, STRUCTURE 7) — we had ~~to~~ then clear brush from ~~a~~ ~~show~~ covering a structure in group B across the road.

We will have ~~to~~ Sub of 320C, 320F, + 320J filled in after drawing is complete

// Across the road in Group B, at STR 10, Julie started a 1x2m N/S axial TRENCH. The walls + corners of this structure appear to be clear, or at least they are on the surface. We expect to find a lot here.

// STR 7 remains to a large extent a mystery. It seems fairly clear now that our notion that it was built on a stream bed was correct: ~~however~~ The discovery of the fossilized shell in 320C/14+18 testifies to this, as does the sandy + pebbly composition of the lower soil. A few shells were found but these were in (to my way of thinking) post-occupational overburden, or at the very deepest: the top of cobbles + construction.

Then mapped 320J

and additional trench was dug in NW corner of STR 10 (Sub of L)

// 13 APR 85 - Saturday

Made drawing of 320F (section), and helped Julie with some other structures in drawing + transit point

15 Apr 85

Sub-ops K + L being dug into base of chad feature and to sterility in depth (320K lot 2) + (320L lot 2)

they probably won't find much in these lots because they are all rubble

~~In the rubble structure Sub of K~~

In ~~Sub of K~~ Sub-of 320L lot 2 we found a couple of blurs,

~~Sub of K~~ Sub of K lot 2 was sterile.

On both Sub-ops K + L (STR10) we are in lot 3 notes in ~~Sub of K~~ this means digging directly up to the ~~both~~ Chad feature

Sub-op K - now into lot 4, they are clearing an additional 2x4m extension south over the structure, the structure itself has no depth

Sub-op K, Facing south

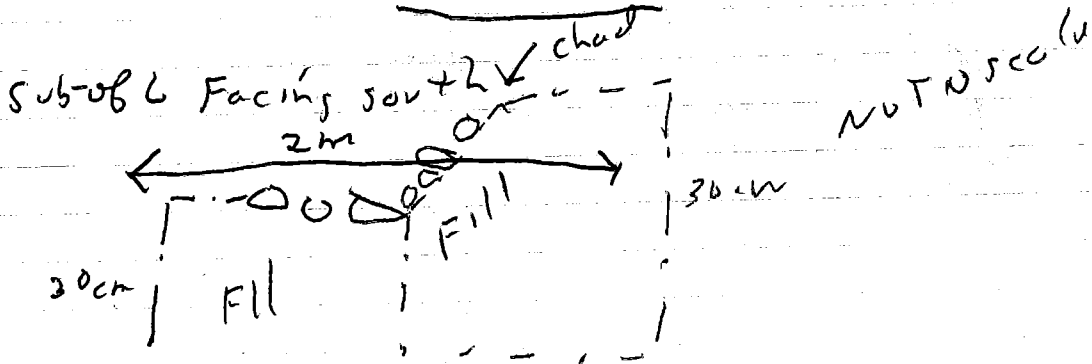
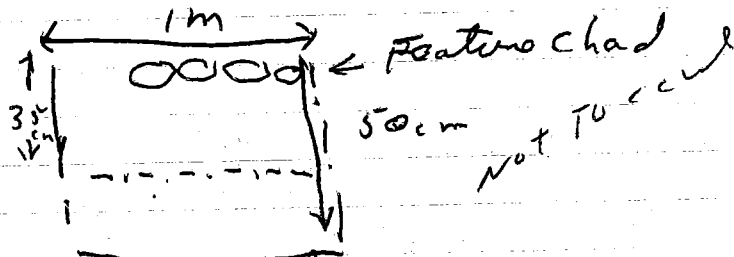

15-APR-85

P85-26-51

sub-OF L, currently lies dormant, while we clear the earth off subop K,

Then took a photo of Chad Feature at sub-plots K+L. The men are still clearing the summit of Earth at K + I am drawing L.

16 APR 85

This morning, I continued drawing section of ~~L~~ L. We excavated Two meters further south into K, <sup>in order to</sup> uncover Southern side of Chad, (lots of ~~6~~) <sup>six is [S of Chad]</sup>

~~I~~ I plan to draw ~~sub~~ K later today.

The men are now digging ~~at~~ Sub-op K lot over, which ~~is~~ takes them one Meter further to the south. There they found sherd, obsidian & other lithic

While they did this I took a look at ~~so~~ tomorrow's site



13 APR 85

P 85-76-49

This Saturday I completed drawing the sub ops for 320 (group A) STR 7, (sub ops 320C, 320F, 320J)

After which I helped Julie with her drawings + took readings (transit) on the currently active sites in Group B across the road.

14 APR 85

Yesterday Julie + I took points on the structures in group B. In my structure (STR 10) ~~we~~ we took sitings on sub-ops K + L. Chd Feature (a wall) goes E/W in sub-op K, and continues through unexcavated part through to sub-op L, where the northwest corner of Chd Feature is visible. First thing tomorrow I must get the dimensions + depositional particulars about this feature, as I had been occupied with drawing across the road while Julie on the 12<sup>th</sup> directed the workmen on the structure.

I am today at <sup>loss</sup> as to what to do. Julie is very angry at me, for what to her are very obvious reasons - the transit readings I took on one of her structures turn out to be fantastically wrong. Now this kind of accuracy is not easy, but I seem to come up with errors on transit readings much more than I should. I don't know why - I go slowly + try my damndest to be careful, being aware that such things are taken seriously. Nevertheless these readings when I take them rarely work out as they allegedly should. With all these things, I am rather ill-suited. I can understand why she is upset, but I honestly don't see. Oh well, perhaps the thing to do is just to stay out of her way + it will pass, but I don't want ill-feelings. Simply put though, I feel very much out of my element with this research.

Perhaps tomorrow will be different.

16 APR 83

P85-26-852

→ To monitor into <sup>to</sup> Tencool site 308, 307, 309, + 310, ✓  
looked at night

Site 307

~~STR 2+3 both look clear + worth doing~~  
~~so do STR 4~~  
~~STR 1 is directly under fence~~

Site 307

STR 2+3 look good

Site 308

STR 4 looks good

STR ~~2~~ 1 is directly under fence + str 3

STR 2 is a definite ~~no~~ maybe. you can see it but the  
lines are not clear

Site 309

6, 2, + 4 - but they are very low, and although there  
are ~~plenty~~ plenty of stones about, it is hard to make  
out their limits.

Site 310

STR 2 looks good, so does STR 7, 6, 8, 4, ~~but~~ but <sup>some modern</sup> ~~poor~~  
stone piles here look superficially a lot like structures

16 APR 85

P85-26-53

We are still cleaning the rocks at ~~the~~ lot seven (sub-op k). It is tedious business, but I suspect that there may be a clay surface

Sub-op k (Lot 8) is ~~the~~ the area S of S Chad to 50cm (if that does not reach sterile, then to sterile)

Sub-op k (Lot 9) is the pit between N Chad + S Chad to depth of 50cm + if that is not sterile, then to sterile

after which I drew D85-26-7 (sub-op L)

17 APR 85

P85-26-54

Today we start excavating Sites # 307, # 308, # 309, + # 310 STR

~~Site 308~~

Site 308, we opened STR 1 (sub-op 308C) + STR 4 (308B) with apical trenches

308C lot 1 is a  $1 \times 2 \text{ m} \times 10 \text{ cm}$  pit in west of STR 1

308B lot 1 is a  $1 \times 2 \text{ m} \times 10 \text{ cm}$  pit in <sup>Chandy</sup> N of STR 4.

At Site 307 plan for opening STR 2.

308B lot 2 is a  $1 \times 1 \text{ m} \times 10 \text{ cm}$  extension of Trench T<sub>1</sub> S/N of STR 4. (making pit a  $1 \times 3$ )

~~STR 1 appears to have~~

308C has already uncovered what <sup>may</sup> appear to be 3 walls or at least 2.

308B has exposed what may be 2 walls already in North side

308B - The  $1 \times 1 \text{ m}$  extension (Lot 2) reached <sup>the N limit of STR</sup> the STR ~~edge~~ so at the Northern 70cm they dug to 20cm.

308B - LOT 3 - is clearing the soil ~~to~~ from around the semi-exposed stone interior

~~308~~ 308C - LOT 2 - is ~~still~~ in  $1 \times 2 \text{ m}$  pit from 10-20cm

17 APR 55

PPS-26-55

308 B - walk away (Lot 4 is North 70cm to depth of 50cm)

308 C - walk away - ~~Lot~~ Lot 2 is going down to 50cm in Western meter because only small stones seen to be there, we may have reached the end of the structure

308 B - Lot 5 - 1x2m extension to ~~the~~ South, going over top of structure to depth of 1<sup>st</sup> layer of subsurface stones. (1x5)

308 B - extend 2 meters further south. (making it 1x7m)

308c

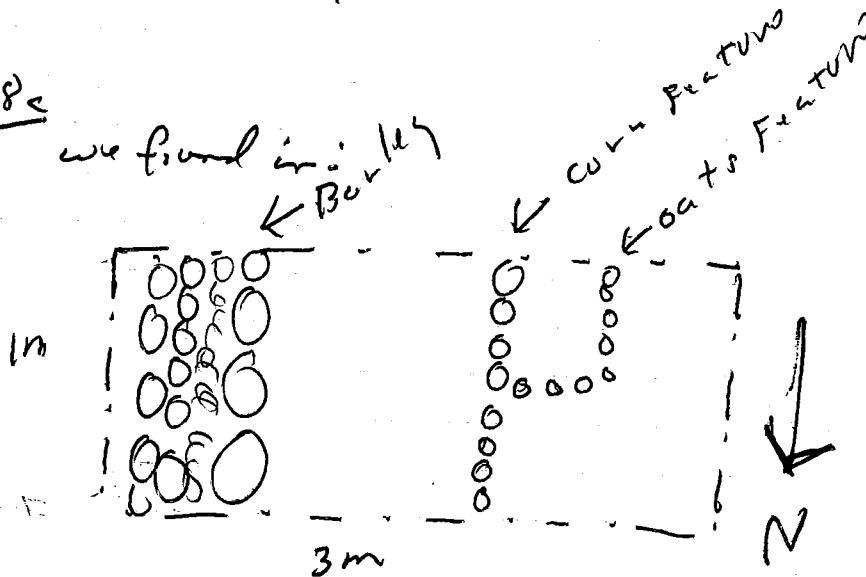

we will extend 308 C 2m to south (AT west end, making it L shaped (still lots 3+4

IS there a special deposit <sup>however</sup>?)

308 B - continue to clear over top to depth of stones

308 B - we extend lot 5 further making it 1x9ft... no clear features

205

17 APR 85

PP-26-56

It appears, however that 308C has clear wall lining all right! we even found a carbon sample (308C lot 4)

we are ~~also~~ looking for the southern limit of OATS Feature.

In order to see the limits of Oats feature more clearly, we are extending the pit ~~some~~ 2 meters further south + ~~over~~ 1.3 meters wide like so

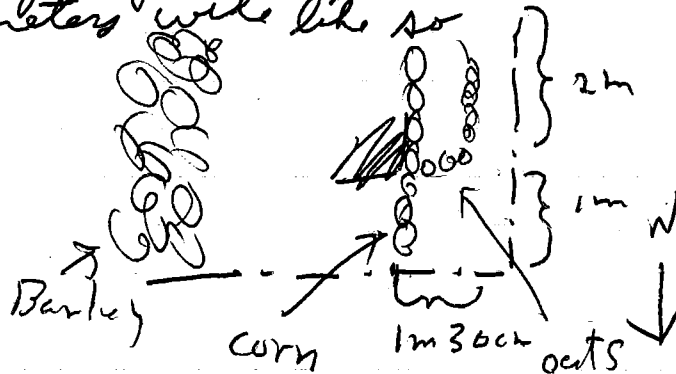

308C

~~308C~~ lot 3 - south + out side of Oats

308C lot 4 - inside limit of oats

It turns out that Oats Feature is only a ~~circle~~ circle of small stones the ~~circle~~ circle is ~~has~~ has an interior diameter of 58cm.

Immediately south of OATS feature ~~is~~ at the same depth as ~~the~~ OATS Feature is a surface of small stones, barely more than pebbles. These MAY Be part of a terrace.

308B - we have apparently reached the south end of the structure, but will continue with a 1m x 1m extension because ~~the~~ the area south of the structure in the empty pit is too narrow for a shovel

308B - Lot 6 - South 1.5m of 1x1 Trench From 20cm ~~from~~ contains sherd + a carbon sample (p. 65 on)

18 APR 75

P 85-76-57

308B - clearing dirt from cobbles to reveal structure more clearly - beginning at N end, to depth of presumed foundations of stones, southward ~~to~~ ~~from~~ from N end ~~to~~ Limit of STRUCTURE. They are also removing small ~~thin~~ chinking stones. If this ~~area~~ appears to have no natural changes, then we will continue this clearing over only top of structure. (LOT 7) [Cl<sup>M</sup> shells + sherd lithics]

308C - We extended ~~apart~~ axial trench <sup>5</sup> m to the East. It now abuts the fence. at present they are just clearing surface soil to get down to level of str. (lot 6) (at summit, the two cobbles appear at about 20cm in depth). We have now crossed to the other side of fence + continue to clear the overburden from the structure.

308B - We continue to clear the top of the structure, a few possible features are evident - but not yet clear enough to document. after clearing enters top I plan to ~~try~~ reveal features to their bases.

308C - Shards found at the level of the the cobbles revealed (i.e. between cobbles) designated lot 6. Lot 5 continues to be ~~cobbles above~~ area clearly above structural cobbles.

18 APR 85

P085-26-58

Working sketch of 308C [NOT TO SCALE]

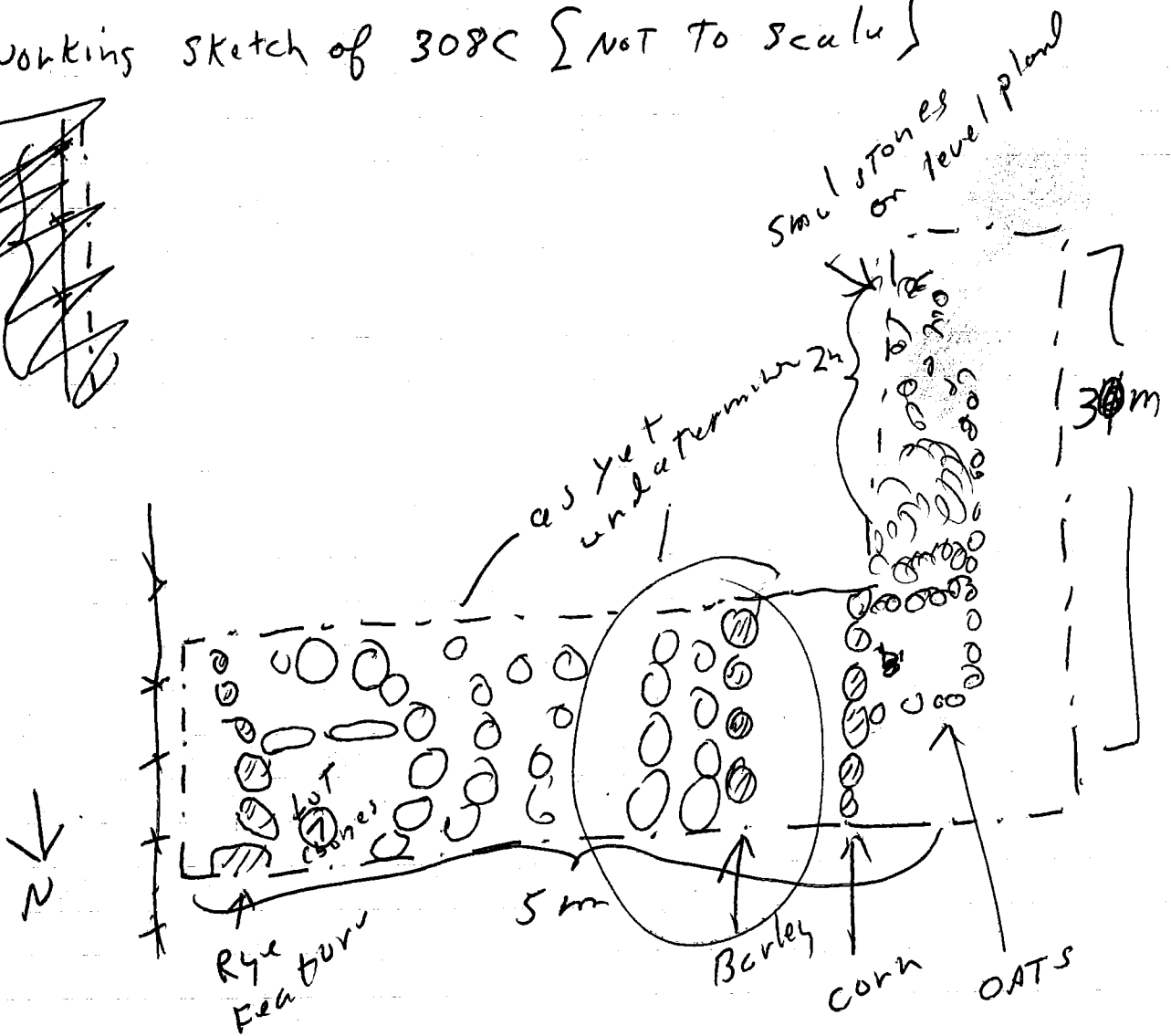
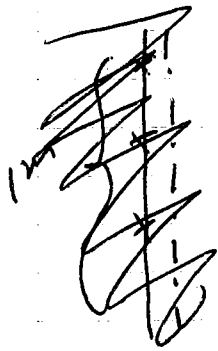

The bones are in Lot 7 in the area just to the west of Rye feature at depth of 30cm - we find long bones here now

308B - at 2.6 meters north of the structures South limit, a water pipe crossed the pit.

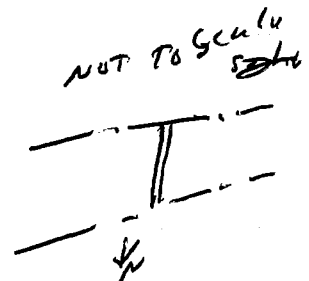
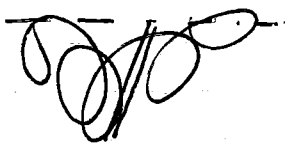



18 APR 85

P85-26-59

I had them dig around the Pipe because it was disturbed anyway to ~~stratigraphic~~ level of underlying stones.

The cobbles in this structure seem to lie over a layer of smaller stones placed ~~on~~ on one plane.

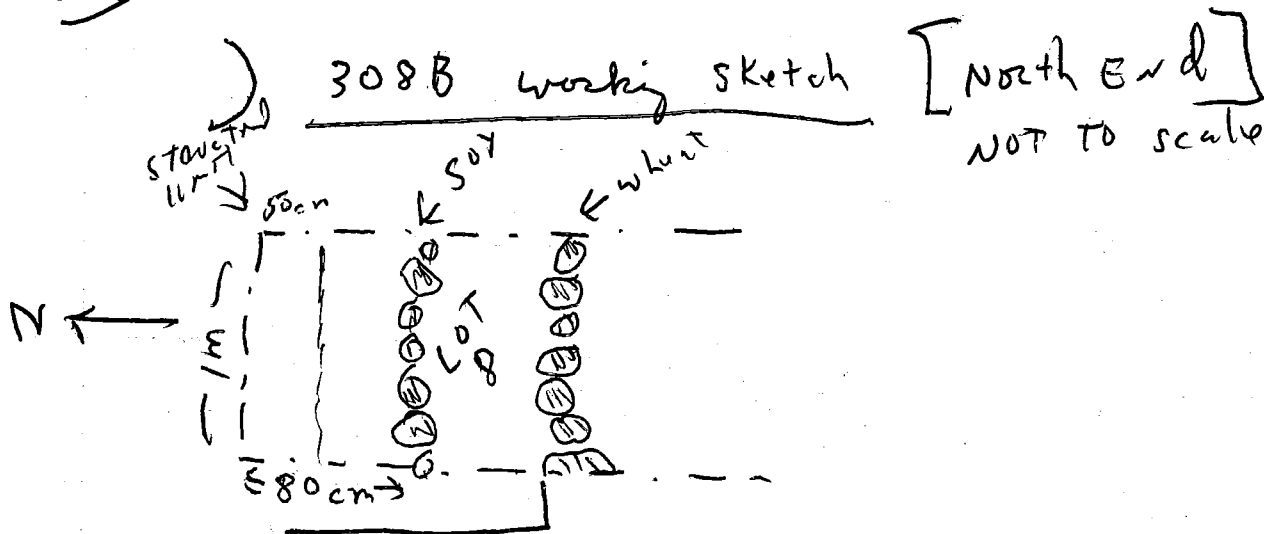

308C - Lot 4 - Carbon sample at 15 cm. Sherd on well to

308C - Fotos were taken of RYE Feature [which encloses special Deposit 2]

308B - between soy feature & wheat feature we encountered many sherds, censer fragments, jugs etc.

Thus we will take 2 Fotos of Soy & Wheat Features.

308B LOT 8 - is cutting into soy feature from N to face of wheat feature to depth of 50 cm

18 APR 85

~~PA~~ 205-20-68

308c - Sout of oats - clearing stones  
found carbon sample

Took Fotos of Barley Feature + Bulgar Feature

308c [washed sketch, not to scale

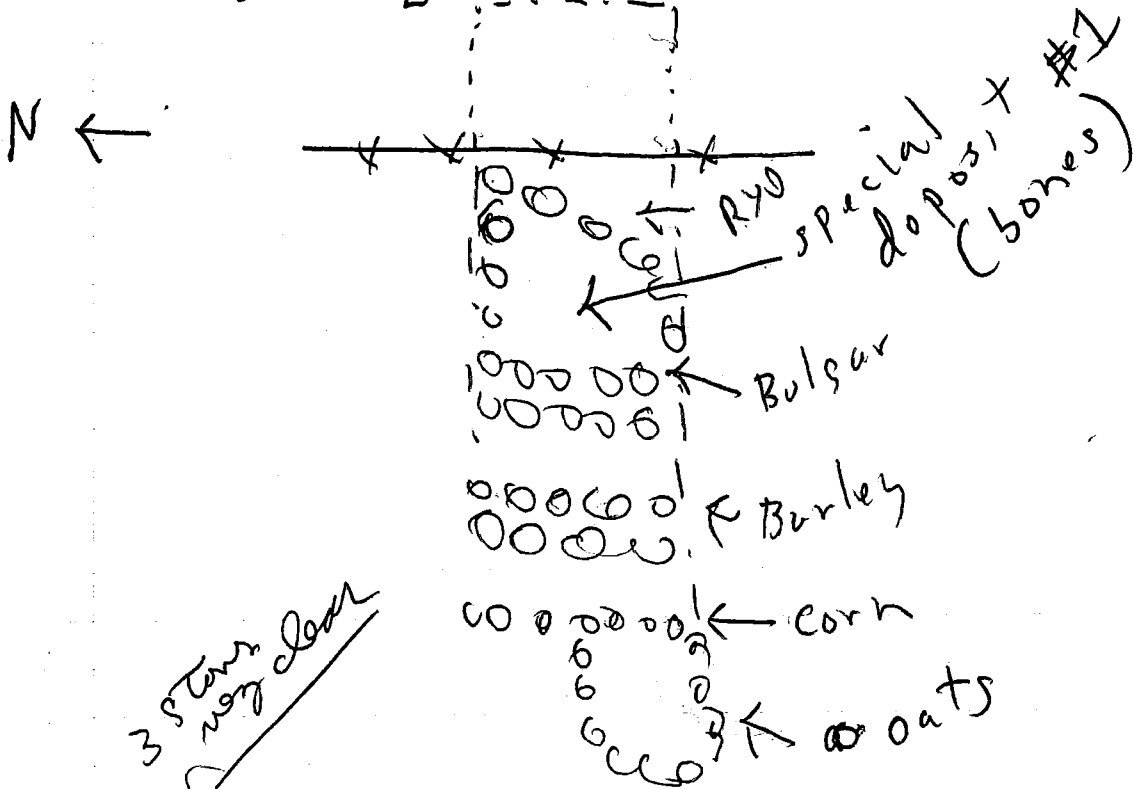

308B

Took Foto of Soy feature,  
Now will take Fotos of wheat feature

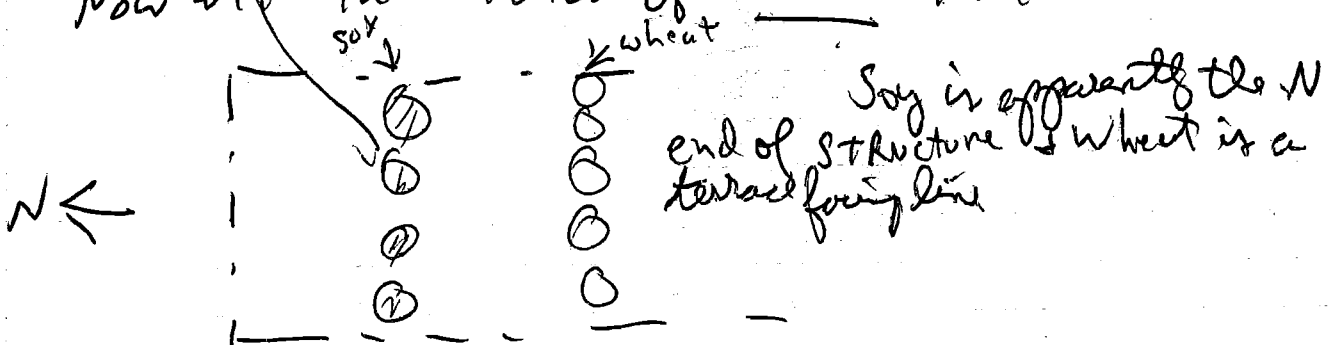

18 APR 85

P85-26-61

308C - Lot 9 - Axial trench extended 3x1 m East  
Clay very at surface - found shreds

(#1)  
308C - the special deposit is of an adult human. Thus far we have encountered no associated artifacts.

The west end appears to be a tiny terrace.  
Oats feature proved nearly sterile, it is certainly not the site of a special deposit - + its appearance as a feature now looks to be the result of excavation - but it sure seemed clear yesterday

Corn feature, Barley feature, Bulgar feature, + rye feature remain intact.

30813 - Cutting southward into the structures to the apparent depth of ~~sterility~~ we first went through <sup>the 1st 1/2 m</sup> Soy feature + then through Wheat feature.

Between the North face of Soy + Wheat we encountered ~~many~~ many large + interesting shreds. All of them appeared to me to be in fill.

Hard to say what comprised fill here, however, because the structures are not high - + sterility is revealed at a shallow depth

(took photos of Soy, wheat)

22 APR 85

P85-26-63

22 APR 85

308B-

Continued cutting through Wheat Feature until reaching N face of Durham Feature

308B - extended arial trench 2m x 1m farther East.  
(see lot 9)

Sketch of Durham Feature (Not To Scale)

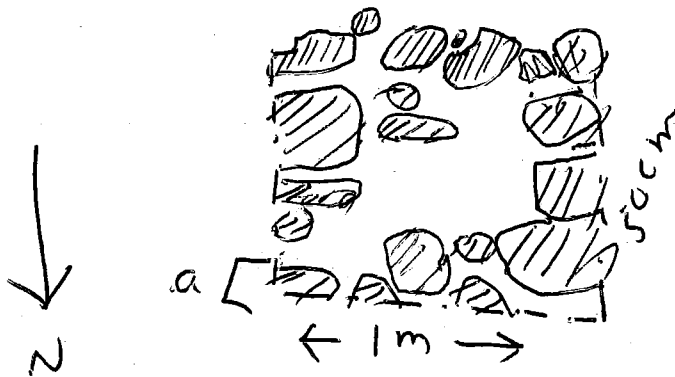

because at the depth of 50cm, at N side of Durham Feature we encountered a line of stones, (see sketch above 'a' brackets), we had to find out how deep these stones might go. ~~They~~ therefore we are digging ~~to~~ from the North of Durham Feature, at least to the levels of 80cm; ~~or shallower~~, (we are heading for sterile) - [This is lot 10]

Lot 10 (308B) commences at a depth of 50cm, ~~at~~ as far south as the stones at the base of Durham feature.

Bones were found in ~~to~~ lot 10 commencing at a depth of 75cm. (also contains shells & bits)

22 APR 85

P85-26-63

308C - Carbon found (308C lot 9) amidst rubble at depth of 15cm

LOT 10 - on at Eastern Sq meter, from 10cm to 50cm. looking for terminals of structure

308B - LOT - 11 - cutting into STRU From south until rise features, to depth of 20cm.

308B - Lot 12 - 1x1m Extension to west of AX161 trench, 1.25m south of N limit of excavation

308C Lot 11 - in east side of axial trench to depth of 50cm

TRANSIT readings were made of <sup>opposite</sup> 307 015

