

1986

PSB-045-Carpenter-Field Notes-1986

Adam Carpenter

Follow this and additional works at: <https://digital.kenyon.edu/honduras>

 Part of the Archaeological Anthropology Commons

Recommended Citation

Carpenter, Adam, "PSB-045-Carpenter-Field Notes-1986" (1986). *Four Valleys Archive*. Paper 92891.
<https://digital.kenyon.edu/honduras/92891>

This Field Notes is brought to you for free and open access by the Anthropology at Digital Kenyon: Research, Scholarship, and Creative Exchange. It has been accepted for inclusion in Four Valleys Archive by an authorized administrator of Digital Kenyon: Research, Scholarship, and Creative Exchange. For more information, please contact noltj@kenyon.edu.

Site # 195

6-5-86

Narrow stretch of land along Ulu. Directly (~1 km)

S of site # 187. Four sites (194-197) in same basic area, tied into one map (hopefully). Sites follow the pattern of being located on a small plateau above flat land alongside Rio de Ulu (probably farmland).

From site # 195, river is ~ 65 m to the west. To the east the land slopes upward again, reaching the road to Illama about 50 m to the east. Land does not appear to have been farmed - fields are fenced into relatively small fields between river and road - probably used for pasture at some point. Site # 196 is ~ 40 m S, and site # 197 is ~ 60 m S. Site # 195 consists of grass and small (1-3 ft.) plants, with the latter land by the river totally grassy and the sloping land toward the road grassy with small trees. Abundant river cobble supply (due to close proximity w/ Ulu) and many nearby limestone outcrops. Current owner unknown. Soil appears deep brown and fertile topsoil, but appears not to be farmed due to a minimum of flat areas. Structures consist of 3 definite mounds situated closely together on a narrow terrace sloping downward to the east & west.

(To the west into flat strip by Ulu to East in to ~~the~~ Cabrada before upward slope) Cabrada begins about 30 m east of the structures and runs NW intersecting river about 50 m to the N. Cabrada thus borders site on the E & N sides. Site # 194 is ~ 125 m to the North. Site visibility and preservation is very good. Several dubious rock clusters that are too ~~vague~~ vague to map. Structures 1 and 2 are higher on the Eastern (Cabrada) side. Str. 1 is about 40 cm high on E side. Str. 2 - 35 on E side, 15 on W side. Str. 3 - 12 cm high.

NOTE - Station 2 measure ~~from~~ structure point rather than from Station 1.

1 Km 187
130m 194
Cabrera, CN E, N

Site #195

86-45-6

Point		Dist	
NW corner St. 1		150° 30'	5.45
NE "		140° 30'	9.25
SE "		165° 30'	10.77
SE corner St. 2		160° 30'	12.65
NE "		92° 30'	14.60
NW "		82°	11.75
SE corner St. 3		63°	8.40
NE "		61° 30'	13.45
SW "		41°	8.45
Ridge Point (N side)		52°	23.70
Ridge Pt. (S side)		287°	32.95
Station 2 → SE corner of Struc. 1		520° 30'	49.56
Station 2 → Station 3		0390	49.86
NW corner St. 1		13° 30'	7.93
SE "		24° 30'	6.95
NE "		31°	9.31
SE corner "		30° 30'	10.85
SW "		19°	11.34
NW "		26° 30'	14.44
NE corner "		41°	22.25
SE "		38° 30'	20.14
SW "		34° 30'	20.71
Ridge Point (Bluff)		359° 30'	17.29
Sta 3 → turning pt. A		229° 30'	48.59
Sta. 4 → turning pt. A		42° 30'	26.03
NW corner		52°	39.31
NE "		55°	37.82
SW "		51°	36.04
Cabrera Pt. S		44°	43.84
Bluff Edge		03° 30'	41.64
Bluff Edge		40° 30'	28.55
St. 11 NE & Bluff		16°	10.01
St. 11 NW & Bluff		7° 30'	15.28
SW & Bluff		359°	18.07

Distance	Time	Speed
18.30	11	340
24.71	12	293
31.30	13	299
30.94	14	296
34.24	15	288
37.90	16	292
21.42	17	295
15.09	18	30
17.53	19	289
9.34	20	274
15.55	21	268
13.14	22	252
12.97	23	226
10.36	24	284
6.99	25	280
11.13	26	321
11.04	27	280
6.79	28	280
8.18	29	280
10.86	30	280
6.85	31	253
4.52	32	258
4.47	33	177
4.58	34	101
8.58	35	177
6.17	36	138
12.69	37	155
9.17	38	131
14.86	39	133
16.46	40	107

6-NE
 6-SE
 6-SW
 7-SE
 7-NW
 7-SW
 8-NE
 8-SE
 8-SW
 9-NE
 9-SW
 9-NW
 10-SE
 10-SW
 10-NW
 4-SE
 4-SW
 4-SW
 3-SE
 3-SW
 3-NW
 2-SE
 2-NW
 2-NW
 5-SW
 5-SE
 5-NE
 1-SW
 1-SE
 1-NE
 Position
 6-27

Station 5 to 11
 11-12
 12-13
 13-14
 14-15
 15-16
 16-17
 17-18
 18-19
 19-20
 20-21
 21-22
 22-23
 23-24
 24-25
 25-26
 26-27
 27-28
 28-29
 29-30
 30-31
 31-32
 32-33
 33-34
 34-35
 35-36
 36-37
 37-38
 38-39
 39-40
 40-41
 41-42
 42-43
 43-44
 44-45
 45-46
 46-47
 47-48
 48-49
 49-50
 50-51
 51-52
 52-53
 53-54
 54-55
 55-56
 56-57
 57-58
 58-59
 59-60
 60-61
 61-62
 62-63
 63-64
 64-65
 65-66
 66-67
 67-68
 68-69
 69-70
 70-71
 71-72
 72-73
 73-74
 74-75
 75-76
 76-77
 77-78
 78-79
 79-80
 80-81
 81-82
 82-83
 83-84
 84-85
 85-86
 86-87
 87-88
 88-89
 89-90
 90-91
 91-92
 92-93
 93-94
 94-95
 95-96
 96-97
 97-98
 98-99
 99-100
 100-101
 101-102
 102-103
 103-104
 104-105
 105-106
 106-107
 107-108
 108-109
 109-110
 110-111
 111-112
 112-113
 113-114
 114-115
 115-116
 116-117
 117-118
 118-119
 119-120
 120-121
 121-122
 122-123
 123-124
 124-125
 125-126
 126-127
 127-128
 128-129
 129-130
 130-131
 131-132
 132-133
 133-134
 134-135
 135-136
 136-137
 137-138
 138-139
 139-140
 140-141
 141-142
 142-143
 143-144
 144-145
 145-146
 146-147
 147-148
 148-149
 149-150
 150-151
 151-152
 152-153
 153-154
 154-155
 155-156
 156-157
 157-158
 158-159
 159-160
 160-161
 161-162
 162-163
 163-164
 164-165
 165-166
 166-167
 167-168
 168-169
 169-170
 170-171
 171-172
 172-173
 173-174
 174-175
 175-176
 176-177
 177-178
 178-179
 179-180
 180-181
 181-182
 182-183
 183-184
 184-185
 185-186
 186-187
 187-188
 188-189
 189-190
 190-191
 191-192
 192-193
 193-194
 194-195
 195-196
 196-197
 197-198
 198-199
 199-200
 200-201
 201-202
 202-203
 203-204
 204-205
 205-206
 206-207
 207-208
 208-209
 209-210
 210-211
 211-212
 212-213
 213-214
 214-215
 215-216
 216-217
 217-218
 218-219
 219-220
 220-221
 221-222
 222-223
 223-224
 224-225
 225-226
 226-227
 227-228
 228-229
 229-230
 230-231
 231-232
 232-233
 233-234
 234-235
 235-236
 236-237
 237-238
 238-239
 239-240
 240-241
 241-242
 242-243
 243-244
 244-245
 245-246
 246-247
 247-248
 248-249
 249-250
 250-251
 251-252
 252-253
 253-254
 254-255
 255-256
 256-257
 257-258
 258-259
 259-260
 260-261
 261-262
 262-263
 263-264
 264-265
 265-266
 266-267
 267-268
 268-269
 269-270
 270-271
 271-272
 272-273
 273-274
 274-275
 275-276
 276-277
 277-278
 278-279
 279-280
 280-281
 281-282
 282-283
 283-284
 284-285
 285-286
 286-287
 287-288
 288-289
 289-290
 290-291
 291-292
 292-293
 293-294
 294-295
 295-296
 296-297
 297-298
 298-299
 299-300
 300-301
 301-302
 302-303
 303-304
 304-305
 305-306
 306-307
 307-308
 308-309
 309-310
 310-311
 311-312
 312-313
 313-314
 314-315
 315-316
 316-317
 317-318
 318-319
 319-320
 320-321
 321-322
 322-323
 323-324
 324-325
 325-326
 326-327
 327-328
 328-329
 329-330
 330-331
 331-332
 332-333
 333-334
 334-335
 335-336
 336-337
 337-338
 338-339
 339-340
 340-341
 341-342
 342-343
 343-344

P86-45-8

Site #199

Distance
 7.88
 6.35
 4.10
 14.70
 11.62
 20.00
 25.30
 5.30
 6.67
 12.36

23°30'
 43°
 50°30'
 117°30'
 112°
 100°30'
 122°
 237°
 268°30'
 234°30'

Point
 2-NE
 2-SE
 2-SW
 1-SW
 1-NW
 1-SE
 1-SE
 3-SE
 3-NW
 3-SW
 fence pt. Rd-S

Site # 159
 35 M North of Path to San Miguel Lajas and hills.
 approximately 170 M East of the high hills.
 100 M due South of site # 157 also
 approx. 90 M West of site # 158.

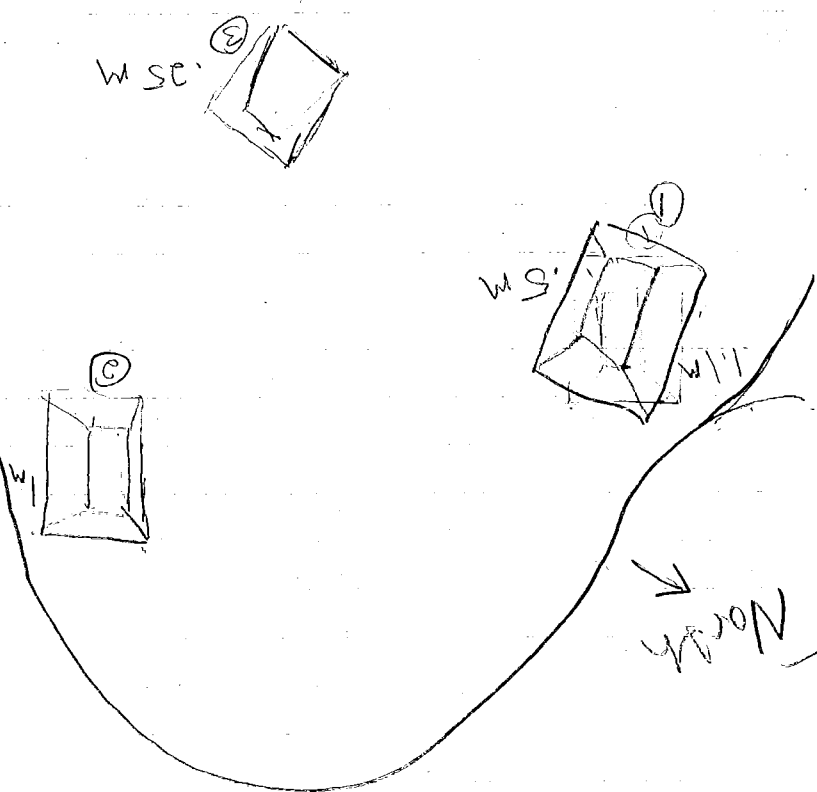

Rocky area with some tree growth. Appears to be cattle grazing area. Fairly good preservation, current owner unknown. Soil is dark & looks fertile, but very rocky & probably shallow. Appears as if structures lie above best farmland on ~~the~~ bluffs. (Best farmland ~ 50 M to the East)

886-45-2

~~886~~

Surface collection provided only 1 piece andite. Very little stone (tool manufacture) compared to Site 157 (100 M to the North).

3 (possibly 4) structures in one central area on top of bluff. Sites are around the 3x5 M range, with an elevation ranging from 0 (on some uphill edges) to about 1.5 M.

Site 160 A 1

Surface Collection - Andeite & piece of obsidian found along fence line area (~ 12 M S of ~~stone~~ structure group)

telephone pole
(40 m S)

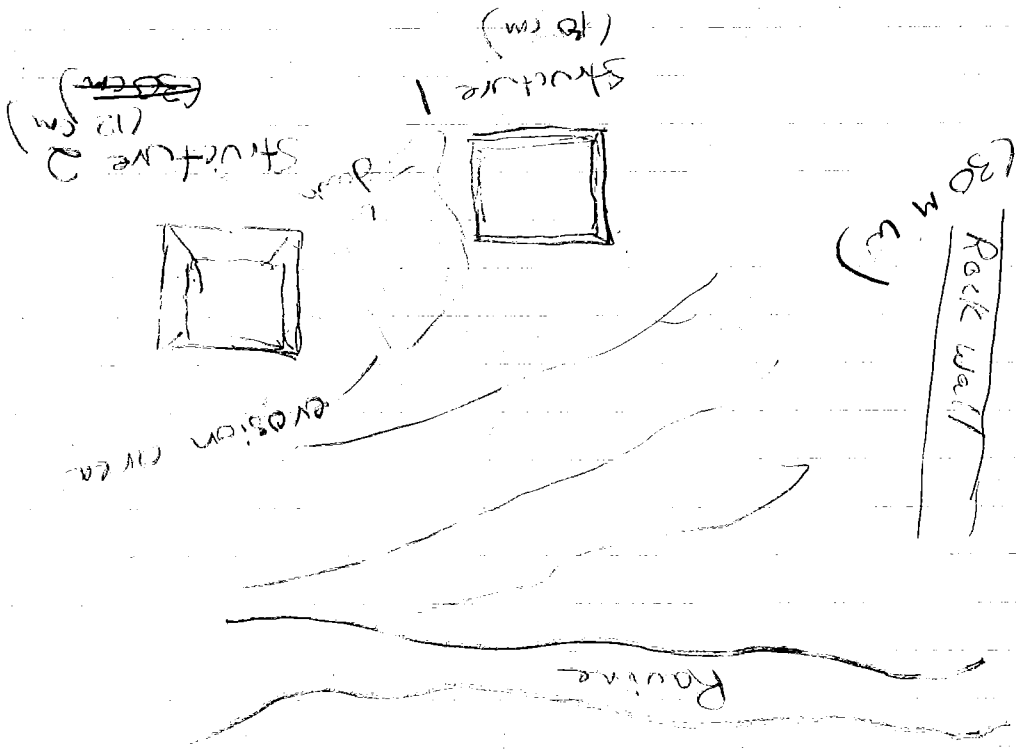

Site # 167

P86-45-3

486-45-4

Site # 167

Point	Angle	Distance
NW corner S-2 structure	37° 30'	12.73
NE "	48°	15.06
SW "	53°	9.66
SW corner, structure	217°	12.44
SE "	310° 30'	8.83
NE "	329° 35'	12.85
North-west erosion area	349°	18.37
NE "	0°	16.24
S "	303° 30'	4.13

Site # 168

Point
NW corner, St. 1
SE corner, St. 2
SE corner, St. 2
Feature 1 NW end
SE end
Feature 2, NW end

Angle
1 3330
2 3310 30'
3 3470
4 2220 30'
5 2290
6 2600
7 2560 30'
8 2460 30'
9 2410 30'

Distance
10.1
6.2
6.18
7.9
4.9
7.9
18.85
15.05
14.05
Cabrera (sp?)
SDM North

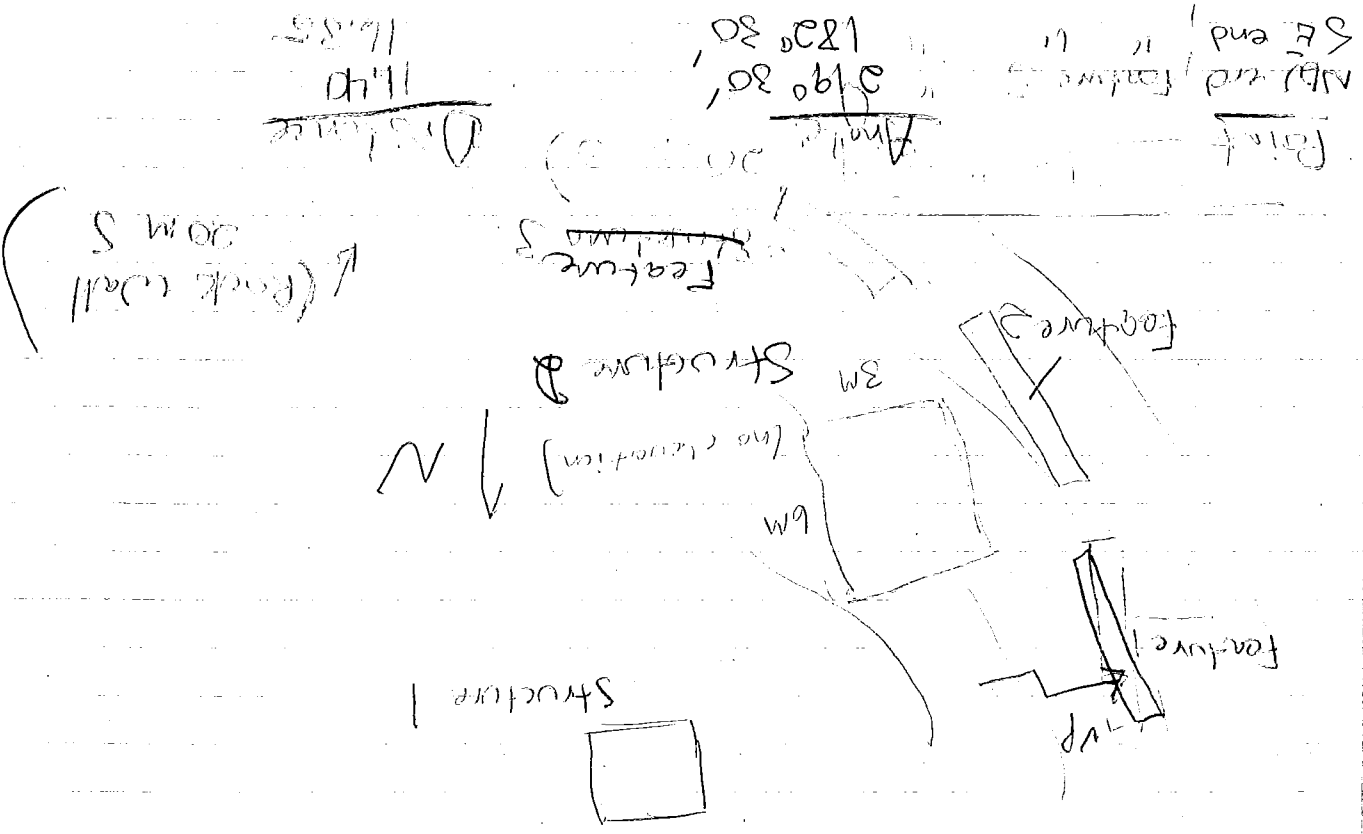

Point
NW end
SE end
Angle
1 3330
2 3310 30'
3 3470
4 2220 30'
5 2290
6 2600
7 2560 30'
8 2460 30'
9 2410 30'
Distance
10.1
6.2
6.18
7.9
4.9
7.9
18.85
15.05
14.05