

1985

PSB-029-Brennan-Field Drawings-1985

Daniel Brennan

Follow this and additional works at: <https://digital.kenyon.edu/honduras>



Part of the Archaeological Anthropology Commons

Recommended Citation

Brennan, Daniel, "PSB-029-Brennan-Field Drawings-1985" (1985). *Four Valleys Archive*. Paper 92892.
<https://digital.kenyon.edu/honduras/92892>

This Field Notes is brought to you for free and open access by the Anthropology at Digital Kenyon: Research, Scholarship, and Creative Exchange. It has been accepted for inclusion in Four Valleys Archive by an authorized administrator of Digital Kenyon: Research, Scholarship, and Creative Exchange. For more information, please contact noltj@kenyon.edu.

P85-29-2

got into pits on E side of
then w/ed looked at several
with south of Post

took sample #5 from pocket
outcrop near (limpstone?)
water weather like water
rock line seen

same back down to
sample #6 from cobbles in middle
of group, water
western part

spent afternoon with Wandy, Ed,
and Billy at outcrops on
operation - 3 E - water
N end of group, interior

2-27-85

Began following excavations at
site 106

- 106 B 1x2 N side of structure 21
N side of structure 21, near
structure 21, near structure 21
- 106 C 1x2 N side of structure 1
N side of structure 1, near
structure 1, near structure 1
- 106 D 1x1 N side of structure 13
N side of structure 13, near
structure 13, near structure 13
- 106 E 1x2 N side of structure 17
N side of structure 17, near
structure 17, near structure 17
- 106 F 1x2 N side of structure 5
N side of structure 5, near
structure 5, near structure 5

steaming - time before fossils



sample #7 a piece of weathered limestone from surface at 106
 sample #8 atwangs rock weathered by workers in pit 106c, quartz crystals in gray-brown matrix
 sample #9 even atwangs rock weathered by workers in 106c, green brown light gray crystalline matrix, sandy colored lichen, shiny iron ore-like inclusions.

observing pit 106B, workers have marked apparently laid stone about 20 cm down in side of pit
 looks like a wall - large square found call it ~~stone~~ SALVA VIDA extended 106B another m² to the found some shreds + a piece of sheet at 106B
 shreds + some dirt and large square coming out of 106c
 started down in N hole of 106B to see if there is a face to ~~SALVA VIDA~~

P85-29-3



PSG-29-4

work progressing on SALNAVIDA in
106 B trying to see how far down
the stairs go (more stairs + traps
needed)

work in 106C (N half) down to 80cm
stairs

106 D down to 20cm for 3rd 1x1 panel
large shade (in lot 4) on with
change decoration

north half of 106E down to 20cm
south to 50cm stairs

SALVAVIDA looking more like something
other and in straight line (E/W)

took 4 pictures of SALVAVIDA

started 1x2 pit showing SALVAVIDA
wall toward east

SALVAVIDA 1 atom thick, 11.7x13m down
(5x2cm) facing almost directly north (83°30')

the wall continues

started pit 106F a meter or so
E of 106E, ended 106E

-106F 1x2 side of structure 17

looks like wire on top of it

all in all a slow afternoon
- nice breeze

P85-29-5

2-28-85

cloudy today, it surely looks like rain

did my first drawing (D85-29-1)
section of pit 106F

improved NATIONAL feature
on 106F, laid stone in line

top picture of pit 106D

106F Lot 3 - sherd, lithic
on top of stone on and within
NATIONAL feature

106D Lot 6 - sherd, lithic
on and around stone in south
end of pit

possible features in 106D can't
tell yet, some stone in humus
fragments others appear confined
to second layer of soil

proceeding up str. 1 in 106C removing
topsoil

extending 106B toward east to expose
north face of str. 2 along str. A
VIDA wall

106F Lot 4 - sherd, lithic, adobe
outside NATIONAL feature in SE extension
0-30 cm

106D Lot 7 -
with over stone in SW extension

185-29-6

it really looks like we're in for rain now, dark clouds moving in over the mountains, wind has picked up somewhat and weather

106F lot 5 - about NATIONAL feature in SE extension (30-40 cm)

colite line in secondary soil of 106D, DUKE feature

extending 106B in west another 2.5 m trying to reach corner of 4HVA

VDA feature, some large north appearing above wall level in east extension

preparing to extend 106F toward west through track of 106E in order to check NATIONAL feature, weather not happy with prospect.

106C - nice about w/face turned up from earth over stone of str. (

106D - dog's head about turned up over stone of str. 17 FRONTING SLOSH feature at NE end of pit in secondary soil about 50 cm off to N of DUKE

~~106F~~ - extending toward west showing NATIONAL L feature (2 m)

106D - lot 8 - about, little end of pit 20 cm

3-1-85
 106B - POS EQUIS feature, possible road strip - mp
 106C - PILSENER feature, joint strip up to arm

106F Lot 7 -
 30-50 cm in W extension of NATIONAL in excavation

meeting in humus horizon, 2-5 cm below surface, mostly nodular, coarse, stone mangle 22x11 cm to 9x4 cm average 16x13 cm, thickness 4 to 8 cm faces south ~~45-30~~ 45-30

not to scale



106F - NATIONAL wall

106F Lot 6 - shreds, litter on and around NATIONAL feature in W extension of pit (0-30cm)
 sample # 10 - from surface near str. 17 at site 106 yellow-limestone?

85-29-7

~~106F~~ - made 2nd bag for lot 6

106D - apparent wall of str. 13 covered in 5' end of pit GALLO feature

106F - NATIONAL 75 cm from E end of pit, 68 cm from W end 16 cm above and differential

most shreds in W extension of 106F found between 15 and 30 cm

land out extension of 106F north over str. 17 (approx. 18cm wide) - lot #8 south over stone of str. 17 perpendicular to NATIONAL feature

106D - CABRO apparent N wall of str. 13

106F - photo taken of NATIONAL from 3 and 5'

106B - BLACK LABEL 5 wall of NATIONAL ends in E end of W extension of pit str. 21

106C - 2nd + 3rd step-ups to str. 1 LAGER + ALE

106F - not many shreds coming out of earth over stone of str. 17, stone are very shallow (0-10cm)

PG5-29-8

106F - total N to S length of pit 9.10 m
northern 5.70 m added today

a hot wind out of the north this afternoon, most troublesome when shuffling papers, the sun is very strong, a hot shimmer off the ground of the site, the work has undoubtedly enough, has about somewhat

~~3-4-85~~

Another morning, sun really not up for it after a weekend of advising all over the country, but it's a beautiful day for digging.

106F - lot 9 0-50 cm north of str. 17 (beyond) stone N 1.25 m of pit (2 bags) about, with

106G - across eastern projection of str. 6 1 m wide

106B - IRON CITY feature, E wall of str. 21

106C - STOUT feature, surface near top

106C - LITE and SHANDY feature below ~~back~~ wall

106F - lot 9 most shrub between 30-50 cm

PS5-29-10

106C - taking plan points

106F - PORT ROYAL feature, N wall

of str. 17 130 cm from pit
corners mostly regular
stone range 3x4 cm to 16x15 cm
average 12x10 cm, 8 to 9 cm below 65
approx. 20 cm deep, facing 95 (N)



bottom part of wall resting
on secondary soil layer

personal + project photos taken
1 m scale

PLAN POINTS FOR 106F

106F - going through at 20 cm
from south (to handle 2nd wall)

106F - Lot 11, from NATIONAL to 1.70m
from end of pit - 20 cm

106F - Lot 11, from NATIONAL to 1.70m
from end of pit (TECATE feature)
(20-30 cm)

PS5-28-11

106F TECLATE

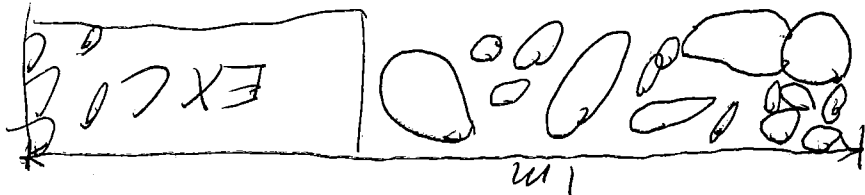

approx. 1.70 m from end of pit,
 2.0 cm deep, 10 cm below G5
 mostly nodular mass, some warts
 3x4 cm to 14x18 cm max. 15x13 cm
 nodules in furrows on secondary soil
 almost half removed

106F - 85-29-1, 2 exp. 9, 10 (3-4-85)

TECLATE feature (85-5-9-910)

106F - Lot 12 from base of TECLATE
 to 2.10 m from end of pit (2-30 cm)

sample #11 from 106F Lot 11

3-5-85

site going to be hot. Last day
 an excavation

106F Lot 13 - from 2.10 m from end
 to 2.90 m from end (10-30 cm)
 among and under stone of str. 17

106F Lot 14 - from 2.90 m to 4.60 m from end
 among + under stone of str. 17 (10-40 cm)
 excavation sample taken

106B - str. 1 getting truly exciting, evidence of earlier floor, cement

106F - lot 15 from 4.80m (approx. middle of str. 17 to 6.20m measured from end of pit, among and under stone of str. 17 (0-40cm)

106F - lot 16 from 6.20m from end of pit to north face of PORT ROYAL wall among and under stone of str. 17 (0-40cm)

106B - str. 21 is quite complicated and - restorably, simple plan below

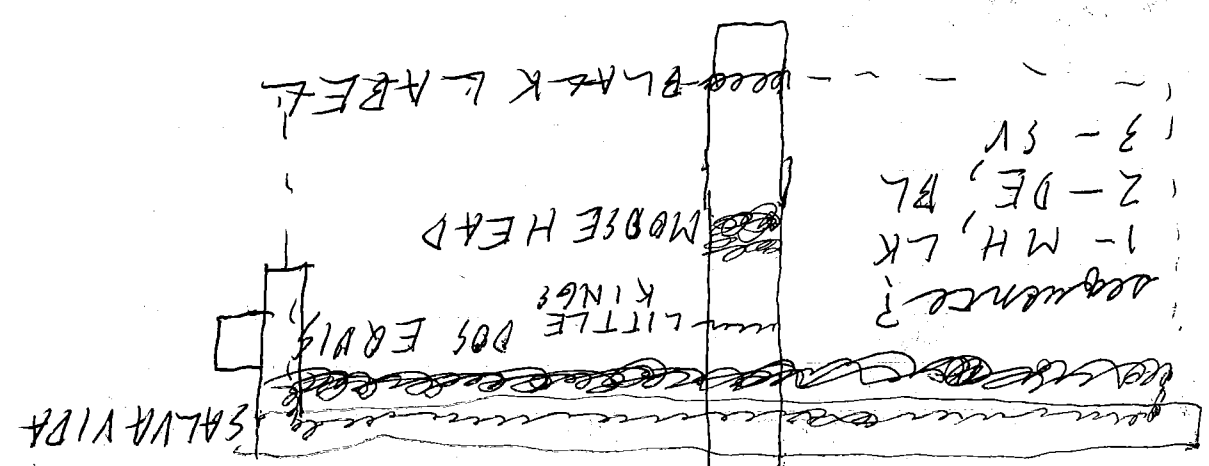

106C - monkey head bowl and dog head figurine found in summit covering cache of opening (cf. shells)

106H - net up pit (1x6m) aerial + perpendicular to main N-S pit (4.05 to 5.05m from 2 end)

106H - above stone of str. 17 (lot 1)

85-29-13

3-7-85

Surveyed land east of St. Barbara -
Baird's road and south of Seney
Baird's house, went into low hills
on land owned by Seney

found nothing except a few small
circular mounds with some
pieces of ceramic in it, and a few

at a modern, collected some
pottery, heard about treasure of
Seney and lights in the hills

from the hill, although there
is a good year-round water
supply it is very rocky here,

not much good for farming

site #37
collected lot
237A-1

3-11-85

After much walking we have
arrived at site 37, on a very
rocky ridge of Seney Valley,
end of Seney Valley.

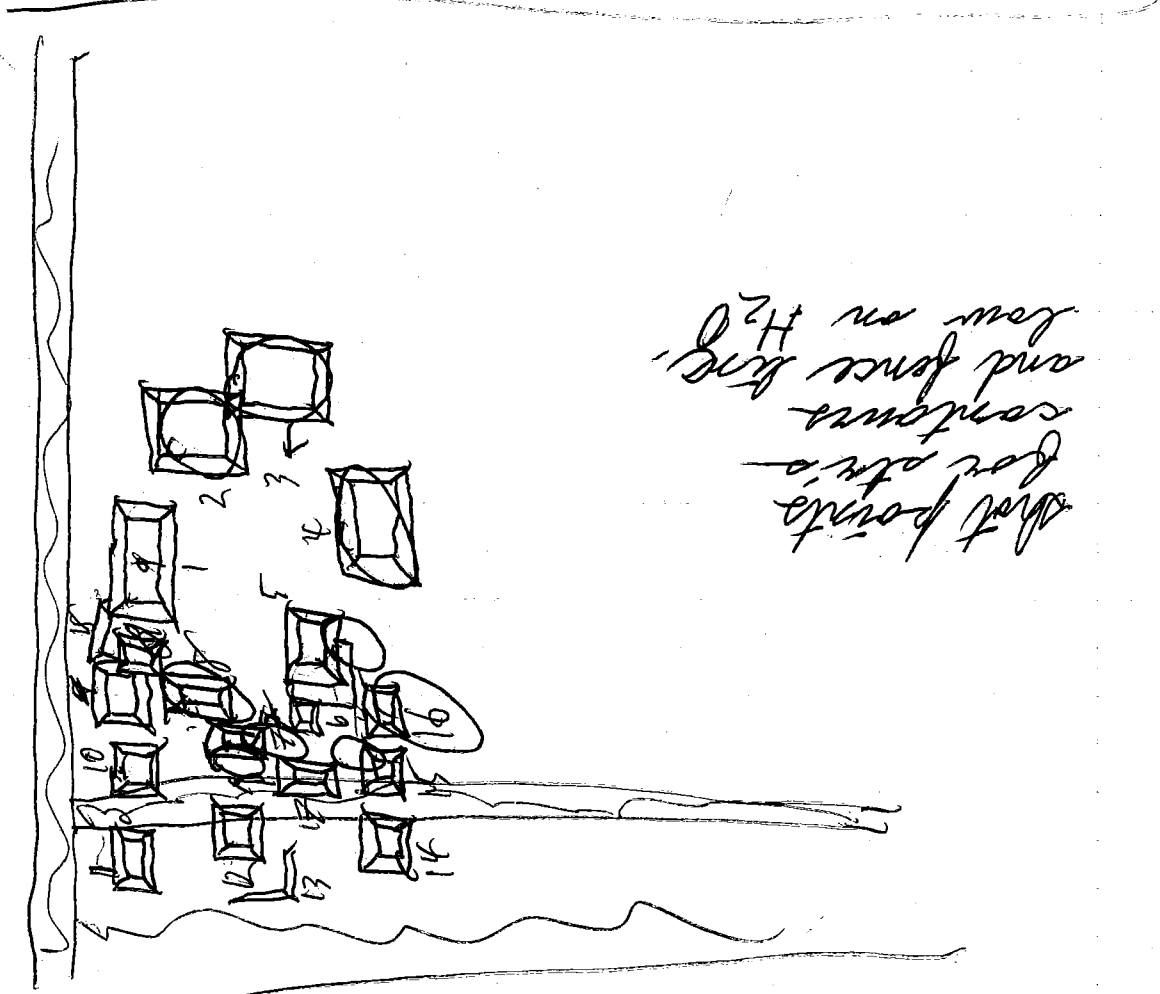
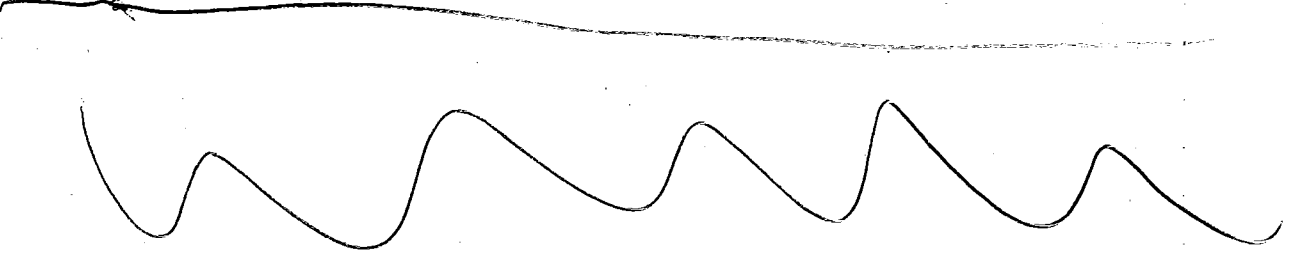

What points
for this
contour line
and fence line
low on #20

N

CLOT

88-29-14

site 338

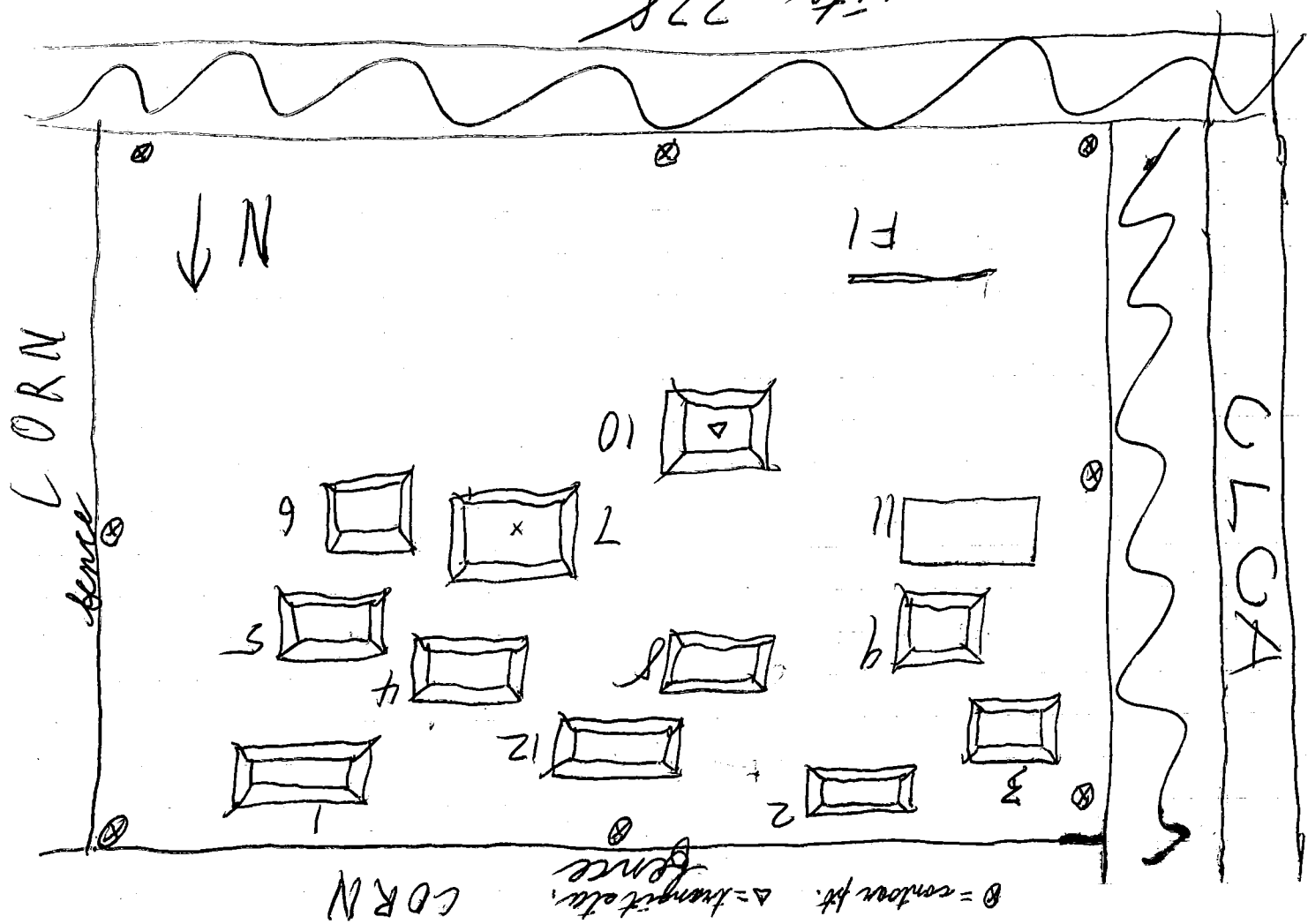

shot
 hole
 for site
 + contour

starting examination of site
 339 + 340 (downhill + N of 338)
 339 - a bunch of small low structures
 in field of weeds just N of
 338, structures are hard to see,
 look as if there may have
 been a couple more in corn
 just E of site plus probably do
 but no mound, probably do
 destroyed by farming

3-12-85

85-29-15

P85-29-16

340 - during 2 haphazard pits.
No note in N end of corn
N of 339, 2 water large mounds
(planting) fence pasture

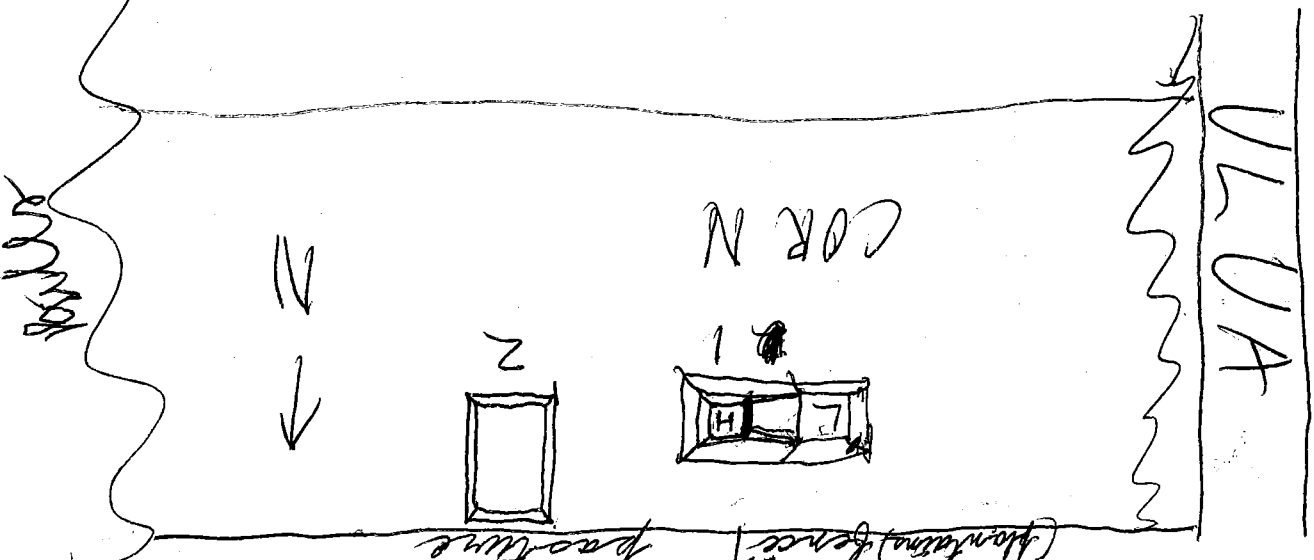

340 - in corn along E edge of pasture
cont. N of 340 might represent hills

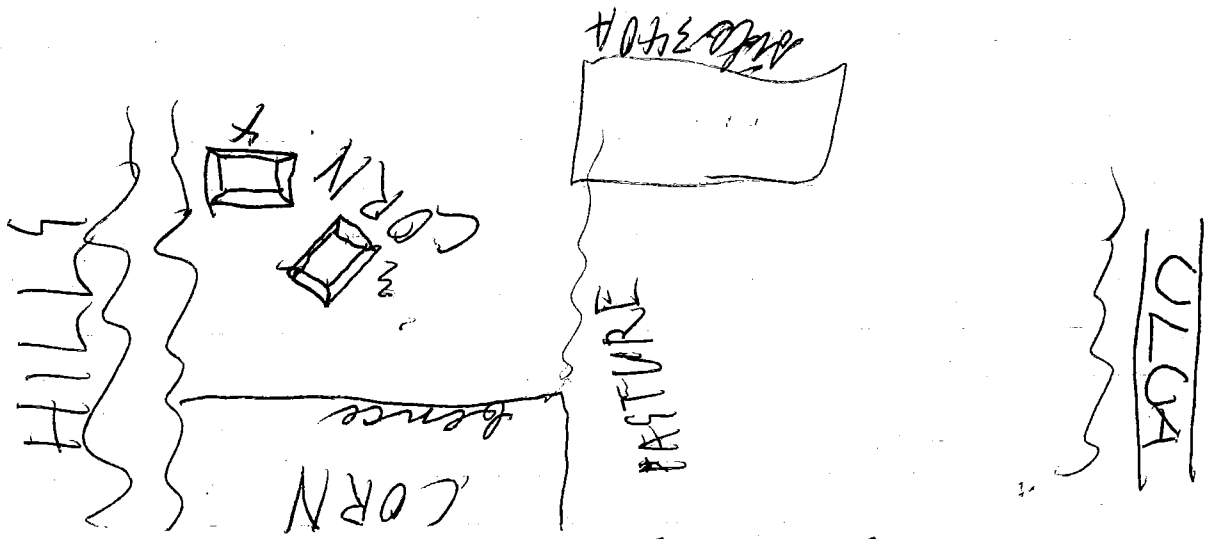

3-13-85

200 photos of water 334+335
went to Washington, D.C. just on
indications it was just on
earlier site lots of stone +
limestone pottery, hard to say, look
around in old (ca. 1500 A.D.) church
full of water but interesting.

85-29-17

3-28-85

P85-29-18

Surveyed small Amaya's camp, very overgrown many burms + ticks found
1 large mound (site 350)

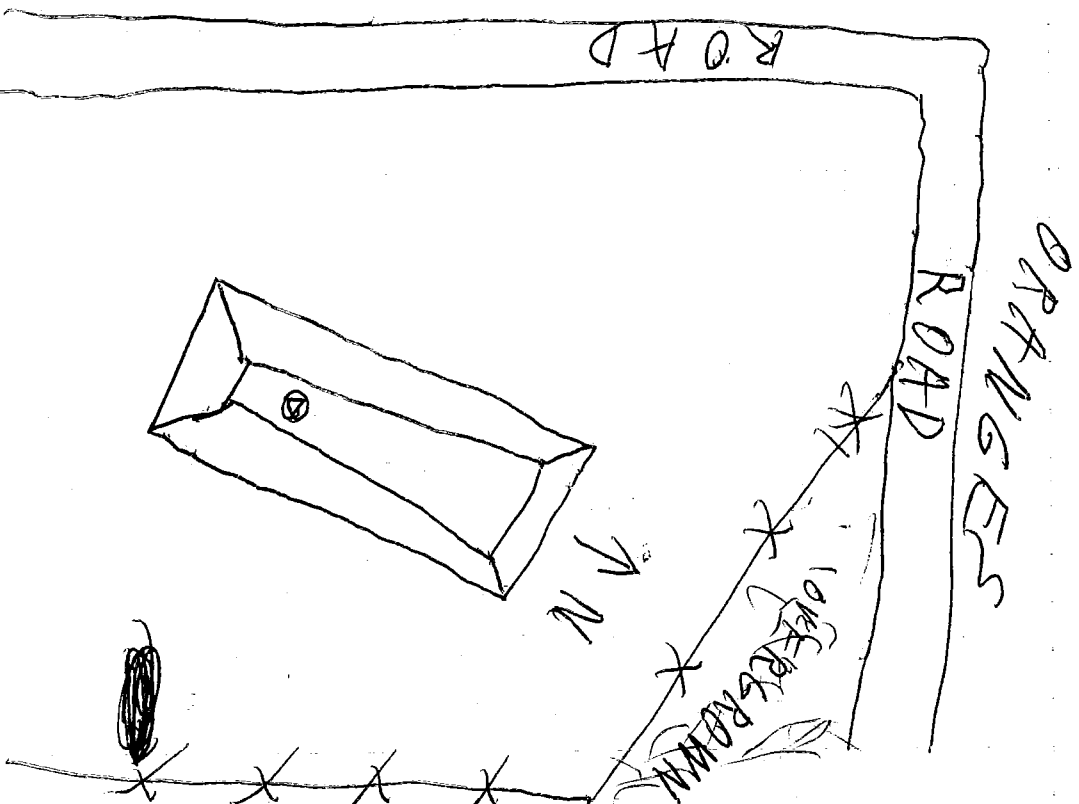

U L U A
mapped site

3-29-85

found site 351 on large veg. W side
of blue near (Amaya's) tooth surface
collected 3 large bags ~~in~~ around
undisturbed lake, 1 large mound apparent

at the 351 is quite large over 30
 structures probably, we will not
 map at all today

BSZ-28-19

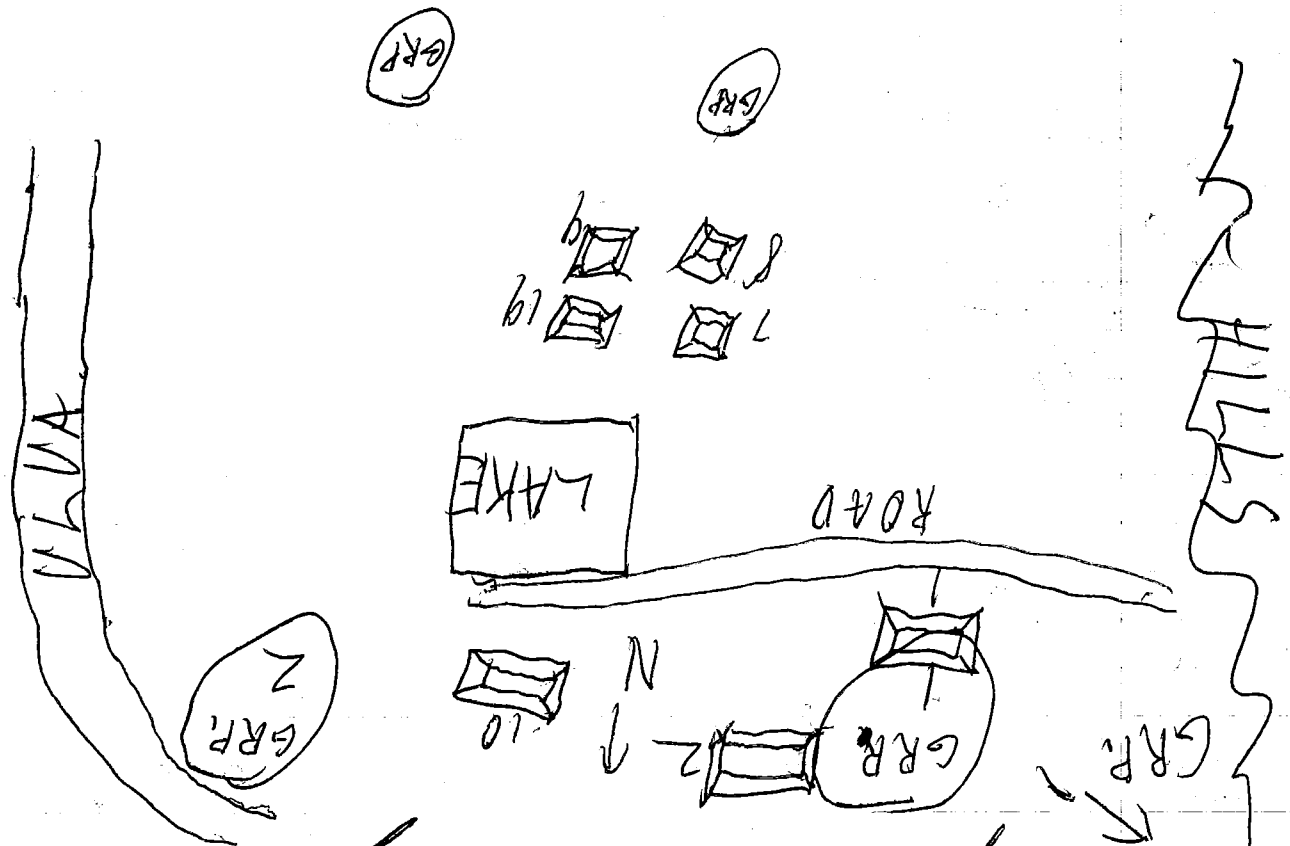

Sketch photos of BHUTAN

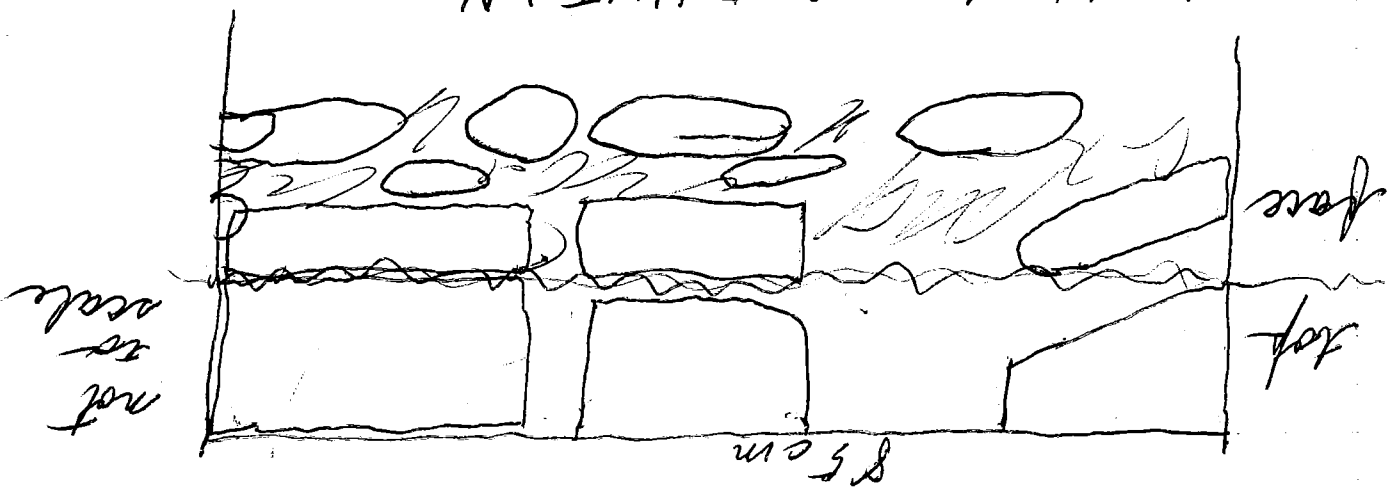

BHUTAN feature small on top up made of large, probably shaped, stones, limestone + marlstone, size range 37x35cm to 19x23cm are 24x25cm, 2 corners (33cm) thick, top 20cm B65 76 cm from SE pit corner, 74 cm from SW, orientation 290°

BHUTAN feature

320D - Lot 2; 0-60cm B65, 5 of str. 15, grp A, 2 of

320D - Lot 1; 0-10 cm B65 above stone of str. 15

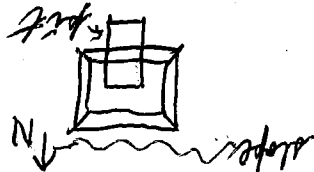

320D - 1x2m pit across small str. in SW corner of field (str. 15, grp A)

320C - 1x2m pit across low str. in center of field

320B - 1x2m pit up side of large str. in N corner of field

~~104~~ 4-8-85

885-29-21

320D - Lot 3 among tumbled stone of str. 15
 0.8m to 1.3m N of BHUTAN (face)

- extended pit 2m to N to catch northern
 limit of str.

320D - Lot 4, above stone of str. 15 in N extension

320D - Lot 5, N of summit stone of str. 15 0-50 cm BS
 10-120 cm N of LAOS feature)

LAOS feature - summit wall, 4 courses (8 cm) deep
 irregular + near-circular blocks, stone size range
 13x18 cm to 8x12 cm are 12x16 cm, orientation 110

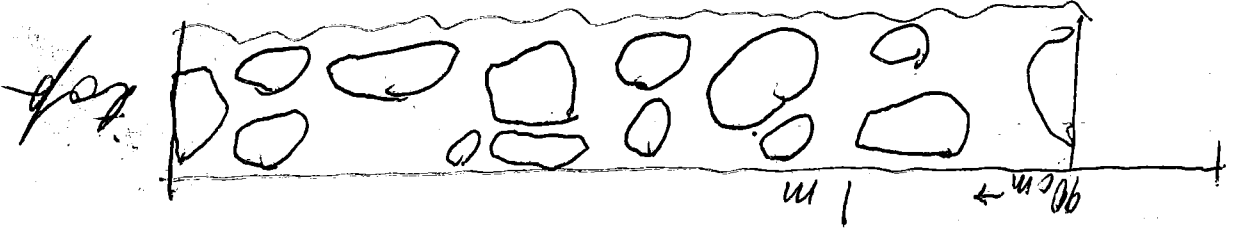

4-9-85 extended 320D 2m N

320D - Lot 6, str. 15, 0-50 cm BS, 1.2-3.2m N of LAOS

started uncovering more stone approx.
 5m N of LAOS possibly remains of re-
 taining wall, extended pit 1m to N

BURMA feature - tumbled retaining wall on
 N side of str. 15, side of hill seems retained
 by stone capping

Lot 7, str. 15, approx. 40-70 cm, between LAOS +
 BURMA, down to culturally sterile, underlain 5+6

85-29-22

3200 - still digging for striae and finding abundance at 1.2m BGS

took carbon sample N of LA05 over 1m down (lot 7 (320), 1.3m, gill)

4-10-85

3200 - lot 7 - LA05 to BURMA, under 5+6, 40-140cm mixed, some definitely early chaotic some possibly late chaotic

3200 - lot 8 - LA03 to BURMA, under 7, 140cm to striae

some striae under str. 15 possibly earlier construction

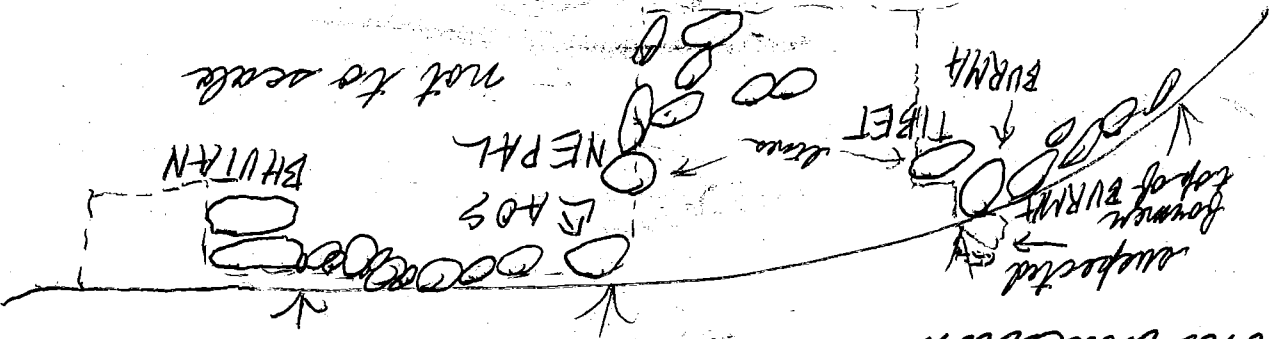

took carbon sample near BURMA, 145cm BGS fill, early chaotic, lot 320D18

NEPAL feature - incomplete line of striae beneath LA05 feature, possibly earlier construction

TIBET feature - line of striae beneath and just south of BURMA feature, almost none level as NEPAL

85-29-23

320D - ~~with~~ finding some bone, gut, and freshwater clam shells in lot 8, down to 16 m and still finding stuff. thinking it may be a midden which was sealed over with earth for con- aturston

feeling very poorly, may go home at lunch.

my strategy now is to go through str. 15 removing top stones + LADs and earth beneath to level of about 5m above NEPAL, cut through from N to back of BHUTAN (lot 9), then south above NEPAL (lot 10), then stone

4-15-85

8th drawing 85-29-2 (location of 320D) north to right of paper Picked up drawings 85-14-11 (location of 320H)

possible burial uncovered in 320H

rained out at 2:45 PM, finished

4-16-85

finished drawing 85-14-11

experimenting excavation of typical, common + long bone + many frogs, unworked, bone is very weak. earth is only thing holding it together

discussed 320D w/ gail

description of 320D (str. 15, gpl. A, site 320)

soil A - dark soil, relatively few rocks, possibly activity layer from BHUTAN, CAMBODIA, LAOS, BURMA ~~activity layer~~ abandonment post-occupation

soil B - rockier/lighter than A, sloping toward N possibly representative of pre BHUTAN hillside, BHUTAN note on B

includes
clay line
behind
BHUTAN

large rocks behind BHUTAN may be remnants of terrace leading to summit at CAMBODIA to LAOS

soil C - very rocky fill for terrace and CAMBODIA-LAOS summit

BURMA feature in retaining wall probably associated with LAOS (may have been 1 stone higher)

soil D - fill for LAOS-BURMA summit/terrace surface, possibly former midden lots of shreds

soil E - probably midden-lots of rocks, several ash lenses, many hard shelled charcoal shreds, many hard shelled shreds between NEPAL and TIBET (could also be fill taken from midden elsewhere)

pen 1 - NEPAL, TIBET, soil B + (E in cont)

pen 2 - BHUTAN, CAMBODIA, LAOS, BURMA, soil A, (D in cont)

found HABERMAS features, Wall of str. 2

307B-Lot 2: 0-100 cm ^{approx.} W of HABERMAS 0-45 cm BGS

307B-Lot 1: over stone of str. 2 between HABER
MAS + east wall

307B - extended 1m W looking for Wall, field
wall is quite rocky so it may be hard
to find

308C - 1x2 m aerial pit into W side of str. 1

308B - 1x2 m aerial pit into N side of str. 4

307B - 1x2 m aerial pit into str. 2 (west side)

Began excavation at sites 307 + 308

4-17-85

did drawing, took photos + removed
bones, not much left

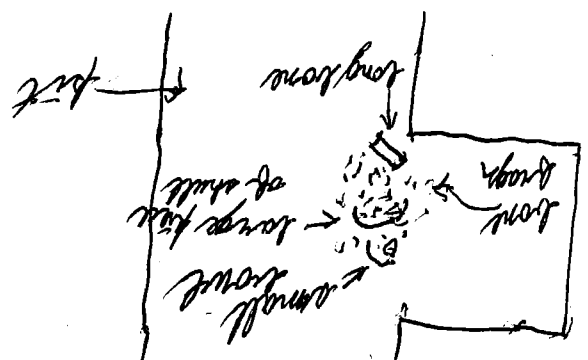

320 BH - excavation of burial continued shortly

PGS-29-25

85-29-26

307B-HABERMAS feature - Wall of str. 2
mostly limestone, some var. breccia, 1 stone dark
top 6-18cm BGS, stone fairly uniform about 21x24cm, 18-18cm
thick, runs diagonally across pit, 18cm from S, 86cm from NW
orientation

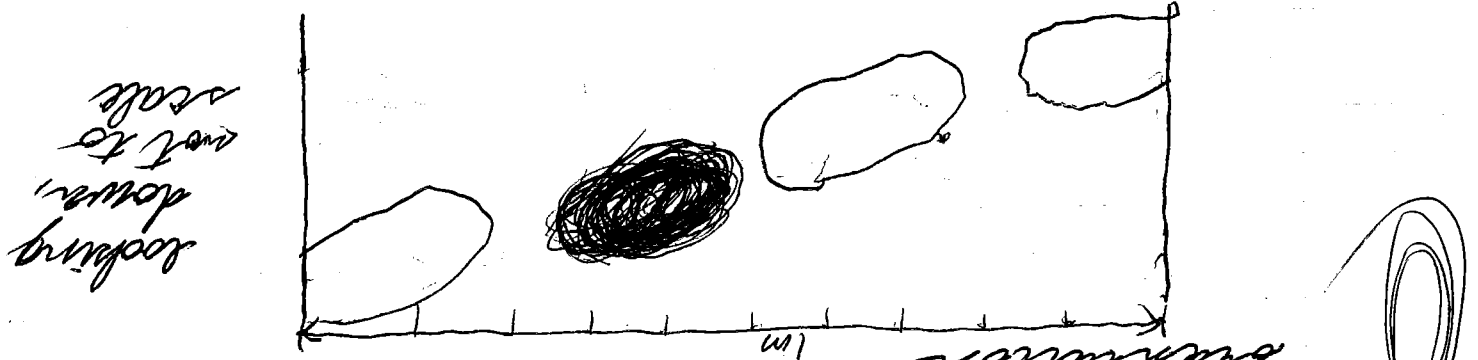

4-18-85

307C - 1m wide into str. 3 from W side

307B - having workshop chaco HABERMAS
south to get more shade

307C - some oddly shaped pebbles
than 4 sides, some mosaic found

307B - Lot 3 0-50cm BGS 0-1m E of stone
of str. 2

307B Lot 4 above stone of str. 2 in 5 ext.
of pit

307C Lot 1 above stone of str. 3

307C Lot 2 0-50cm BGS 0-1m N of stone
of str. 3

307B Lot 5 - among + under tumbled stone of str. 2 ^(E-100m) HUME feature approx. 10-40 cm BGS, tumble and/or fill another burial possible (oh joy!)

307B HUME feature - Summit wall of str. 2, irregular, calcine and limestone rubble with small stone shavings, approx. 10 cm BGS, stone size 34 x 23 cm to 12 x 16 cm, 1 corner orientation 12° took photos looking W

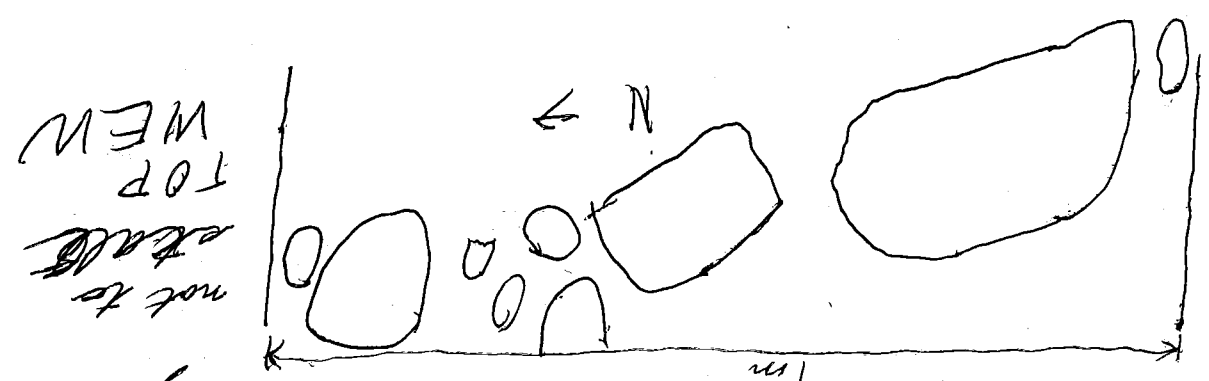

307B - ripping through str. 2, grinding lots of fill shreds, poorly interphase

307B Lot 6 below stone of str. 2 ~~W~~ of summit 10-50 cm BGS, fill

307B Lot 7 below summit stone of str. 2 10-50 cm BGS, fill

307B Lot 8 below stone of str. 2 E of summit 10-50 cm BGS, fill

307C Lot 3 E of stone of str. 3 0-40 cm BGS

185-29-28

4-23-85

DP309B - 1 m wide pit into S side of str. 4, to find objects which to date str., not so much for architecture

NIEZSCHE
SARTRE

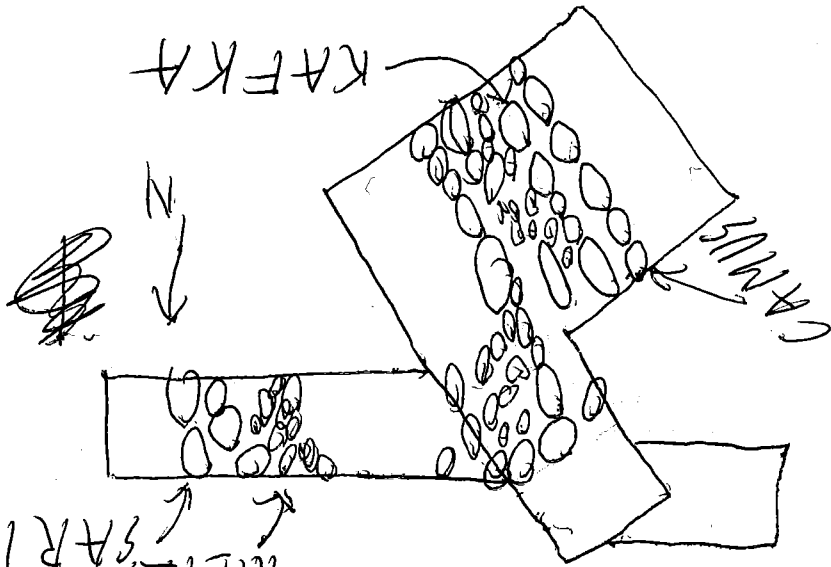

307C -

309B - ACE feature, S basal wall of str. 4 limestone + knoll, 152 cm from SW, 155 cm from SE skinned with small stones

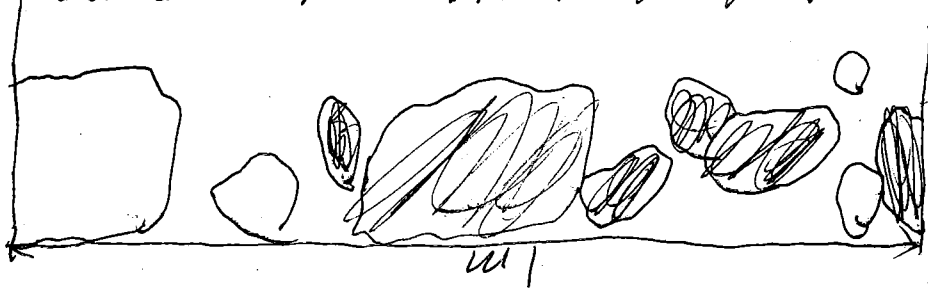

307C lot 4 W of CAMUS feature, 0-40 cm BG5

307C lot 5 E face SARTRE to E face NIEZSCHE under stone of str. 3 10-40 cm BG5

309B lot 1 above stone of str. 4
 309B lot 2 S of ACE, 0-50 cm BG5
 309B lot 3 under stone of str. 4 N of ACE to 50 cm BG5

855-29-29

4-24-85

307C - cutting through

309B - drawing section (085-29-4)

307C lot 6 - fill under stone of str. 3, E-NIETZSCHE to E-HUSSERL, 10-40 cm BG

307C lot 7 - fill under stone of str. 3, E-HUSSERL to W-CAMUS, 10-40 cm BG

309C - about pto

OP312C - 1m wide pit into str. 9 from NE, looking more low than architecture

OP312D - 1m wide pit into str. 7 from NE

307C - draw section (085-29-5)

312C - lot 2 - E of stone of str. 9. 0-80cm BG

312C lot 3 under stone of str. 9 behind PAULI feature to 80cm, fill & open

312D lot 1 above stone of str. 7
312D lot 2 NE of str. 7 stone 0-70cm BG (OPEN)

4-25-85

~~312B~~

312B - lot 10 4-6 m from N end of pit 0-30cm BG
312B - lot 11 4-6 m from N end 80-80 cm BG

185-29-30

312C PAULI feature - local wall of str. a
probably from earlier (cont.) large
masses, may be 1 m
approx 35 cm
BGS



92 cm from ~~SE~~ SE, 91 cm from NE

312C - Lot 4 from summit tumbled covering
BOHR terrace, 2.1 m to 4.0 m from E end of
pit

312C - BOHR terrace approx 15 cm BGS - 20 cm above PAULI,
~~the~~ begins 108 cm W of PAULI-E face. Leads back
toward summit, 210 cm from SE, 44 cm from NE

312B - end of excavation, no architecture, evidence
of ~~structural~~ activity found in lower levels

312B - NEWTON feature - local wall of str. 7
cm BGS
approx 15 cm from NW, from NE 130 cm



312D Lot 3 - under stone of str. 7 to 10 cm, full
(within NE WTON)

312C Lot 5 - under BOHR to 5 cm above PAULI, full
(2.1 to 4.0 m from E)

312C Lot 6 - 5 cm of earth above PAULI (2.1 to 4.0 m from E)

PS5-29-31

4-26-85

312C-PAUL1 ends 3.15 m from E pit end

BRA66 feature = lower summit retaining wall approx. 10 cm BG3 + 3.1 m from E end pit

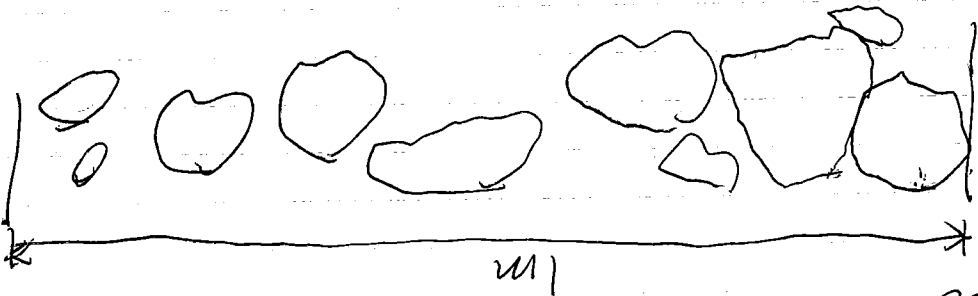

EINSTEIN feature - upper summit retaining wall approx. 4 cm BG3 + 5.15 m from E end of pit

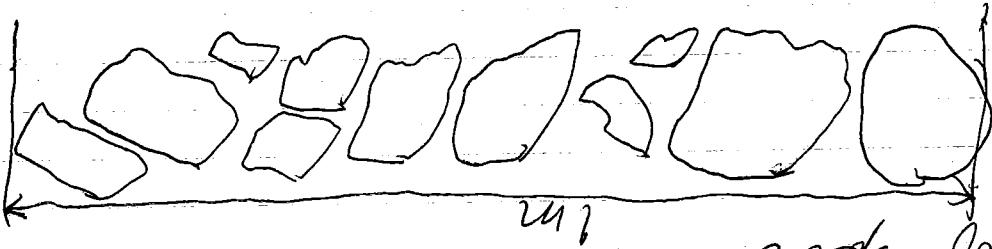

312C-Lot 7 under top stone of str. 9 from BRA66 to EINSTEIN above level of PAUL1 (approx. 10-40 cm), full (some tumbled?)

312D - evidence of earlier construction - 56 cm BG5

BOYLE feature - large flat-topped rubble



312C-Lot 8 full beneath PAUL1 terrace to 70 cm BG3 (25 cm below PAUL1) 1.9 m to 3.15 m from E end of pit

85-29-32

312C-Lot 9 known EINSTEIN E-base to W
exc. limit, under summit stone (5-40cm B68)
fill

312D-draw section (D85-29-7)

312C-HEISENBERG feature upper summit wall
probably contemporaneous with PAULI trench
appears 10 cm E and 30 cm below EINSTEIN
appears 40 cm B65, good straight line of
medium sized uniform cobbles

312C-Lot 10 50-80 cm B65, W-face of HEISENBERG
to W exc. limit, level of HEISENBERG to
80 cm B65, fill

draw section (D85-29-8)

beginning excavation at site 334 (see
log) at 3, 5, 4

334B-axial trenches into N+5 sides of str. 3
OP
334C-axial trenches into N+5 sides of str. 4
OP

334D-axial trenches into N+5 sides of str. 5
OP

334B-Lot 1 - over stone of str. 3 in 5 trench

334B-Lot 2 - over stone of str. 3 in N trench

~~334B-Lot 3 - trench 5 of str. 3 (stone)~~

~~334B-Lot 4 - trench N of str. 3 (stone)~~

334 B - hard to say what's going on
 looks like this

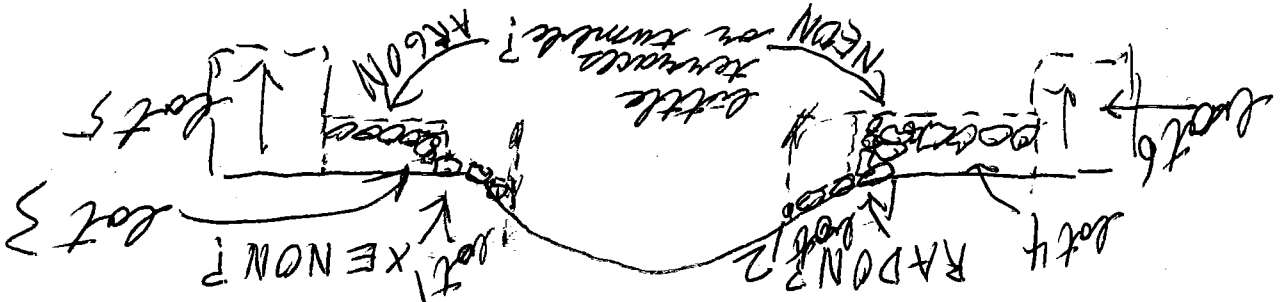

334 B + lot 3 - on top of terrace on summit
 5 of atm. (approx 0-50 cm BGS)

lot 4 - same as lot 3 N of atm.

lot 5 - 0-30 cm below level of same terrace
 5 of atm. (150-80 cm BGS)

lot 6 - same as lot 5 N of atm.

4-30-85

334 B lot 7 - 30-~~50~~ cm below ARGON (80-100 cm BGS) lot 5
 below

lot 8 - 30-50 cm below ~~NEON~~ (80-100 cm BGS) below lot 6

lot 7 + 8 0-90 cm from pit ends

lot 9 - ~~30~~ 50 cm below ARGON (100 cm BGS)
 90-150 cm from 2 pit ends

lot 10 - ~~30~~ 50 cm below NEON (100 cm BGS)
 90-180 cm from N pit end

334 B - down section (P85-29-9)

lot 17 - above NEON-ARGON level from FLOURINE to CHLORINE

lot 16 - above NEON level from OXYGEN to CHLORINE

lot 15 - above ARGON level from NITROGEN to FLOURINE

5-1-85

lot 14 - above NEON level from RADON to ~~CHLORINE~~ OXYGEN

lot 13 - above ARGON level from XENON to NITROGEN

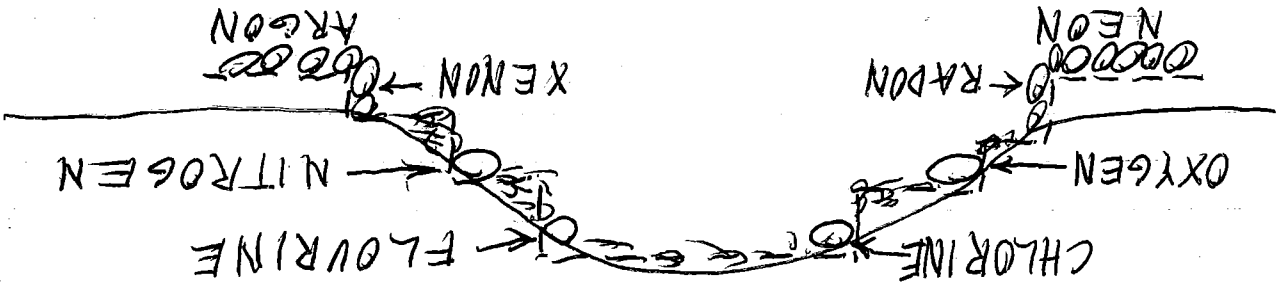

lot 12 from tumbler above NEON level just N of RADON

334 B - lot 11 from tumbler above ARGON level just S of XENON (some fill from below ARGON)

P85-29-34

P85-29-1

2-25-85
at to hot.

found a small station either on west side of Alva south of site 20 sample #1

on walk in vicinity of site 20 with Pat, Ed, Sandra, Andy & me Wandy too

correction: sample #1 ~~is~~ black dust maybe a

waited after 21 + 22 and apartment kitchen workshop

sample #2 taken from north on east side of Alva at corner crossing

2-26-85

Talked to Mayor James of site 105-106 he is rich as well to must find workers. Spoke to showe hope about workers from Muskogee

sample #3 taken from east side of road south of site 105 columnar basal

sample #4 taken from either in center of group, at Muskogee school