

1985

PSB-007-Ashmore-Field Notes 1985

Wendy Ashmore

Follow this and additional works at: <https://digital.kenyon.edu/honduras>



Part of the Archaeological Anthropology Commons

Recommended Citation

Ashmore, Wendy, "PSB-007-Ashmore-Field Notes 1985" (1985). *Four Valleys Archive*. Paper 92894.
<https://digital.kenyon.edu/honduras/92894>

This Field Notes is brought to you for free and open access by the Anthropology at Digital Kenyon: Research, Scholarship, and Creative Exchange. It has been accepted for inclusion in Four Valleys Archive by an authorized administrator of Digital Kenyon: Research, Scholarship, and Creative Exchange. For more information, please contact noltj@kenyon.edu.

5.	NW corner	OP13B	1562
6.	NE "	OP13B	1528
7.	NW "	OP13A	1279
8.	NE "	OP13A	1248
9.	SE "	OP13A	1665
10.	SW "	OP13A	1692
11.	Down slope		3.055
12.	Upslope		4.061
13.	Further upslope S of OP13C		2725
14.	NW 13B @ River slope edge		2475
15.	Near Bank drop off to SW		4200
16.	Longer drop off		4000
17.	Contour points S of station 3		1578
18.	"		1597
19.	"		0545
20.	Upslope "		0.800
21.	SW corner concrete platform		1.800

H 154.5cm
T

Station 4

1.	B.S. to previous point	1259.1
2.	Edge of dip	1359
3.	Dip shot	1749
4.	Mid-dip	3480
5.	Other edge of dip	1469
6.	Contour shots H.S.C.	1726
7.	"	2232
8.	"	2279
9.	Near river drop off	4100
10.	"	3555
11.	"	2785
12.	"	3658
13.	"	
14.	"	

1762		
1365	397	306° 15'
1720		307° 10'
1335	385	324° 25'
1411		326° 15'
1149	242	318° 10'
1376		316° 35'
1178	258	H 263° 50' V -3° 4'
1781		EVEN
1549	232	H 264° 10'
1811		265°
1571	240	306° 25'
3300		225° 20'
2898	412	H 224° 10' V 2°
4275		EVEN
3845	430	167°
2877		168° 10'
2571	306	158° 6'
8758		H 141° 50' V +30°
2180	582	H 136° 30' V 13'
4462		
3952	510	
4282		
3728	554	
1848		
1312	536	
2002		
1177	805	
0953		
1.082		
0.518	464	
2100		
1500	600	
1430		
1090	340	11° 20'
1495		2° 30'
1222	273	357° 40'
1822	147	45° 30'
1678		127° 45'
3564		166°
3395	171	203° 10'
1548		245° 10'
1390	158	H 257° 5' V -1
1817		H 226° 15' V -1
1632	185	H 200° 30' V -1
2320		H 288° 20' V -1
2142	178	
2358		
2202	156	
4371		
3829	542	
3780		
3323	457	
3037		
2540	497	
13978		
8350	628	

T

P85-7-164
6/20

358°

HI = 153.5

Vertical	↑	+BS	-FS	Elevation	Distance	Δ
	↑ 3 atop str. 18					
	BS to REF ST STR 20					
	1. BS to SE CORNER OP 6E	1049	(EVEN)	1338	0758	356° 35'
	2. BS TO REF ST STR 20	1339	"	1650	1028	348° 35'
	3. PLAZA SE OF STR 26	2419	"	2688	2142	19° 10'
	4. NE CORNER OF OP 5M	2698	"	2839	2558	356° 40'
	5. SE CORNER OF OP 5M	2650	"	2785	2516	357° 10'
	6. NW " " " "	2685	"	2825	2544	357° 35' <small>may be 357° 35'</small>
	4 SW " " " "	2652	"	2796	2520	352° 25'
	8. RIVER TERRACE EDGE <small>↑ gauge</small>	2908	"	3202	2612	325° 30'
	9. DOWN SLOPE	4188	"	4498	3878	321° 10'
	10. CONT. PT. PLAZA <small>SW</small> OF STR 20	2721	"	2975	2469	328° 15'
	11. RIVER TERRACE EDGE	2938	"	3188	2692	312° 35'
	12. DOWN SLOPE	4085	"	4336	3815	308° 45'
	13 " "	3040	"	3265	2818	303° 20'
	14. DOWN SLOPE	4340	"	4100	2657	301°
	15. NE Corner STR 17	2515	"	2393	2472	60° 15'
	16 NW " " "	2363	"	2258	(2142 T)	52° 50'
	17. PLAZA N OF STR 16	2531	"	2729	2334	36° 30'
	18. NE Corner op 5K STR 17.	2459	"	2594	2321	81° 4'
	19. SE " " "	2433	"	2570	2298	83° 20'
	20. TERRACE <small>W & BELOW</small> VAGNER	1712	"	1812	1611	80° 25'
	21 SW Corner op 5K	2273	"	2352	2299	(16.15 T) 78° 30'
	22 NW " " "	2292	"	(16.21 T)	2799	134° 30'
	23 PLAZA W OF STR 15 S OF STR 18	2648	"	2497	2876	134° 30'
	24 FENCEPOST S OF STR 18	2728	"	2579	(2426 T)	156° 15'
	25 Fence Post SW OF STR 18	3020	"	3102	2812	235° 35'
	26 " S OF STR 19	2958	"	2812	4425	248° 15'
	27 Down Slope	4250	"	4073	2990	257° 25'
	28 SE Corner STR 19	2867	"	2743	2932	298° 50'
	29 NE " " " (outset)	2799	"	2668	2798	306° 30'
	30 NE Corner op 5L	2680	"	2542	2542	25.6 305° 30'
	31 SE " " "	2670	"	(240 T) 2793	2548	24.38 350°
	32 NW " " "	1630	"	1793	1470	31.2 295°
	33. SW " " "	1640	"	1799	1481	31.2 293° 25'
	34 SE STR. 19	2460	"	2569	2351	21. 270° 55'
	35					
	36					
	37					

gnd surface
above 50m
lower
strata
ref pt
marked

P85-7-160
6/19-20

3E completing D85-7-3

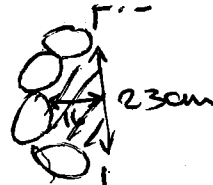
3E/48 →  } sample saved for flotation

pit is ca 1m deep total
all earth surrounding
stones is burned.

9C: stone pit

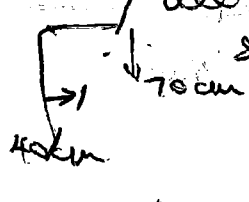
 } amount of horizontal
displacement from top to
bottom

HI = 153.0 cm
V-X T +Bs - Fs

Elevation Distance HI-X

It is just north of Op 8B

Point	Description	Elevation	Distance	HI-X
1.	P datum 3 1.232	132.6	18.8	178° 10'
2.	Op 8B SE cnr	145.1	5.30	169° 15'
3.	SW	146.6	5.15	181° -
4.	NW	150.3	3.20	181° -
5.	NE	1.495	3.38	183° 45'
6.	Op 8A SW cnr	1.618	15.90	357° 35'
7.	SE cnr	1.578	15.90	1° 20'
8.	NE cnr	0.995	19.25	0° 45'
9.	NW cnr	1.063	19.17	357° 20'
10.	pt (contour) 1/2 way to fence 20 94	219.2	19.8	291° 08'
11.	pt at fence	2.380	49.0	290° -

Backfilling

- 3F done
- 3G done
- 3E about done
- 3L nearly done

June 20, 1985 (Thursday)

8:15 8:40 and again - thank heaven - no rain
bright & steamy

The students who went to Copan over the weekend arrived back yesterday mid-day - all but Marie S, who was so upset over a variety of things (uninspected by me, I re-

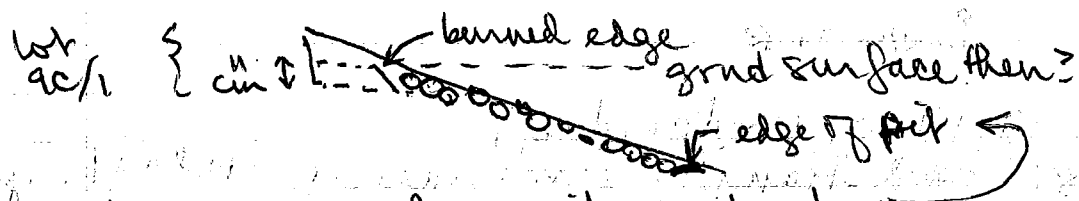
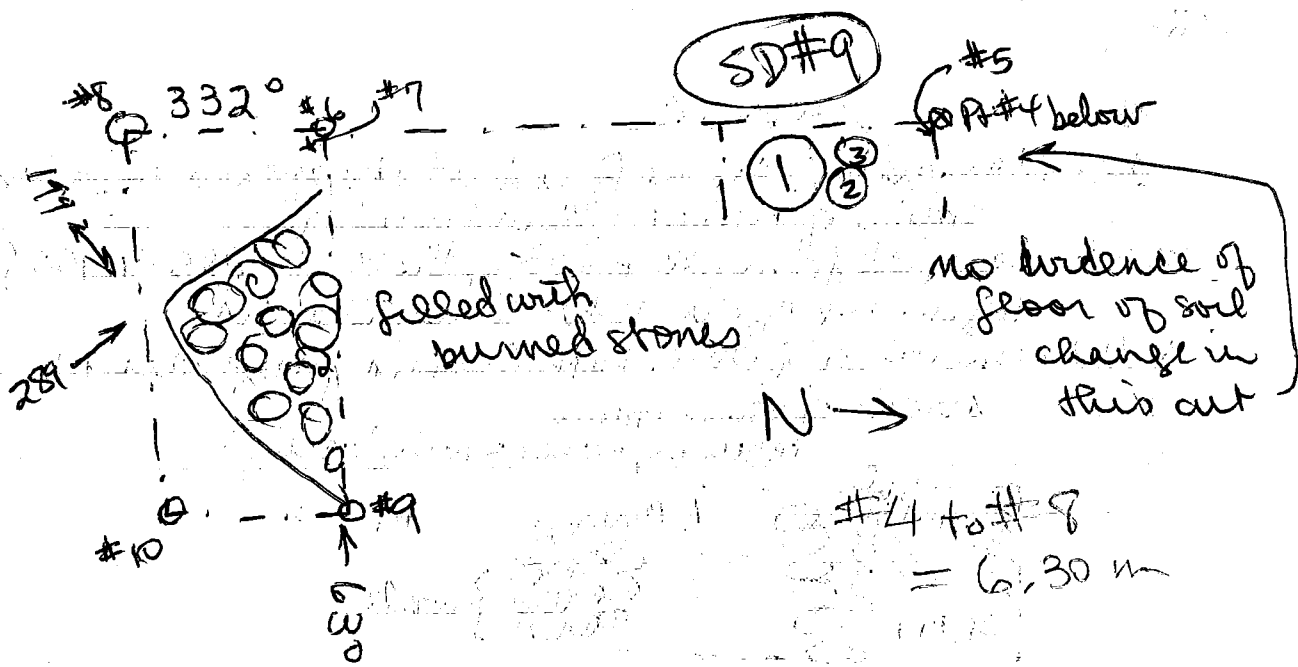

QC/2 = removal of pit contents
 QC/3 = the 3 vessels at north

HI 157.8 cm	T	+ BS	- FS	Elevation	Distance	Angle
Power pole 157.867	set up north of Op10C			ground = 177.4		
	1. BS to power pole (1.546)	159.413		scope 131.9	45.5	92°15'
	2. W edge of road	1630	157.783	169.4	12.7	
				156.7	12.55 taped	76°15'
	3. ditch bottom	2.825	156.588	286.0	6.9	73°10'
				279.1	6.49 m taped	
	4. ditch slope as shown above	1.9384	157.479	195.8	4.7 (4.52 T)	41°18'
				191.7		41°48'
	5. base of exc (clear only)	2.157	157.256			
	6. see plan	1.884	157.529	191.4	6.0 (5.5m T)	116°15'
				185.4		
	7. base of exc	2.231	157.182			
	8. SW cor	1.840	157.573		6.18 taped	112°55'
	9. NE corner	2.812	156.601	284.9	7.6 (7.48 m T)	92°45'
				277.3		
	10. SE corner	2.804	156.609	284.6	8.1 (8.04)	97°45'
				276.6		
	11. SE cor Op10C	1.450	157.963	148.8	7.5 (7.41)	167°16'
				141.3		

SD9: vessel #1 covered skull of burial - discovered so at 4'00" will float matrix (bone is mushy - but visible - orientation detectable); body seems to continue to NW beyond today's exc - will clear tomorrow

PS5-7-134

6/18

3G: Leopoldo supervising backfilling

3E: Margarito & Jaime cutting down south of PONDER (beginning ca 1m south) to try to reach beyond level of SOFT

~~3E~~ Jeronimo & cutting down the collapse mud in area of LARSE floor, for section

sherd washing - last day - cave sherds + misc.

9C: Enrique + Juan Ponones cutting to expose floor & link to pots
~ 5-6m

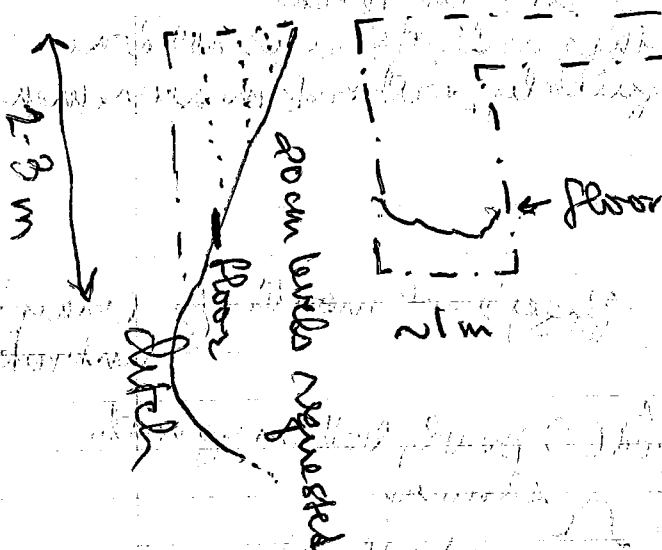

note: Op 10C shall be visible between 9C & IHAT house

dark photos 85-7-V5/6*
85-7-V7/8*
closeup of pots

(general view of Op 9C w/ IHAT house beyond both from NE, both scale 50cm)

9C/1 carbon sample charcoal/ea fist/fennis ball size amount

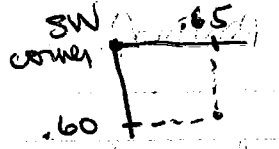

ca 30 cm below level of SW corner

sketch plan

9C/1 materials from 1st 30 cm of cut

(* PSB85-121 & 122)

P85-7-162
6/20

vert	+	-	Elev	Distance	Δ
+0°30'	18.	ref stake atop str 21	1.035	056.2 013.8 (42.4)	DAMN
(H.I. = 150cm) even	19.	T2 atop str 21, W of op 7A	1.608	6.25T	95°50'
	20.	BS to main pole on str. 11	1.980	225.82 150.8	74.84 89°45'
	21.	cont. pt in fld W of str. 9	3.026	355.0 249.0	106.0 112°15'
	22.	cont. pt in fld str 11	3.430	383.0 291.0	86.0 95°20'
	23.	BS to #7 of B161 as cross check (SWTE)	3.488	375.2 311.8	63.4 56°—
	24.	BS to #6 (NW cnr)	3.470	378.6 315.5	63.1 55°15'
	25.	Op 7A str 21 NE cnr	3.228	7.32T	26°33'
	26.	NW cnr	3.204	8.03T	(20°—) <i>man have more</i>
	27.	SE cnr	3.285	9.33T	153°—
	28.	SW cnr	3.285	8.95T	157°55'
	29.	Op 7A West summit	1.483	3.72T	112°15'
	30.	"NE corner" str. 21	3.305	11.02T	64°15'
		"NW cnr"	3.596	10.22T	297°25'
	31.	cont pt betw str 21/22	3.672	11.95T	328°10'
	32.	near terrace edge	4.438	24.98T	291°10'
	33.	over terrace edge	4.200 (-2°40')	30.31T	280°10'
	34.		3.229 (-2°40')	25.20T	262°40'
	35.	down slope	4.475 (-2°40')	29.14T	259°55'
	36.	1/2 way to tree	3.272 (-2°40')	28.98T	233°—
	37.	AT TREE FROM #36	2.100 (-7°59')	227.2 194.9	32.3 234°40'
	38.	AT TREE	4.208 (EVEN)	4.372 4.043	27°20'
	39.	DOWN SLOPE FROM TREE	4.300 (VERT -2°30')	4.457 4.115	221°15'
	40.	SW CORNER OP 6DC	3.995 (EVEN)	4.169 3.828	211°—
	41.	W TERRACE EDGE STR. 31	3.849	4.010 3.685	208°20'
	42.	SE CORNER STR. #31	3.783	3.928 3.640	188°45'
	43.	NW CORNER OP 6D	3.419	3.552 3.283	194°45'
	44.	SE CORNER TERRACE STR. 31	3.625	3.757 3.494	189°40'
	45.	NE CORNER OP 6D	3.737	3.868 3.607	185°40'
	46.	SEW " OP 6F	3.760	3.872 3.650	149°—
	47.	NW " OP 6F	3.708	3.813 3.600	147°20'
	48.	SE " OP 6F	3.754	3.872 3.688	144°20'
	49.	NE " OP 6F	3.741	3.853 3.629	143°—
	50.	SW " OP 6G	3.712	3.846 3.581	129°45'
	51.	NE " OP 6G	3.708	3.837 3.578	122°45'
	52.	SE " OP 6G	3.65	3.79 3.51	120°10'
			3626	↑ 3768	122°—

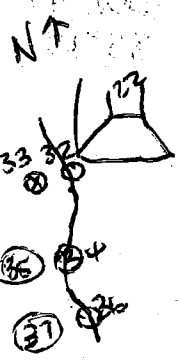

P85-7-186
6/18

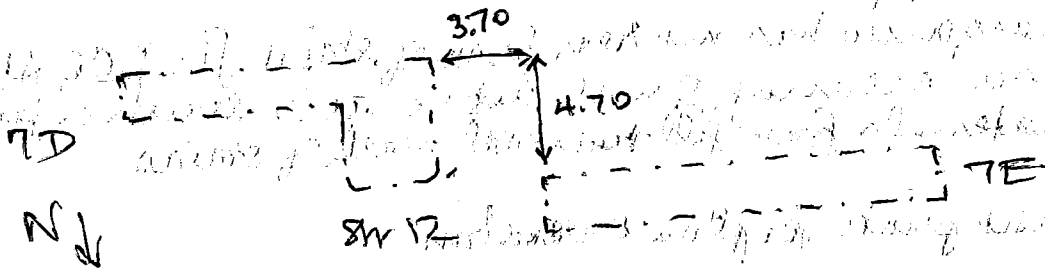

North Platform

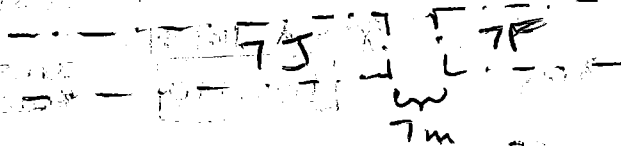

vert #	HT	+BS	-FS	Elevation	Distance	Angle	
+30	29	summit of 8v 12 (between TDE, TE)	1100	159.210	1391.3 080.9 406.9 355.8 411.2 260.0 246.2 208.8 262.0 203.6 418.2 362.8 400.3 347.5 375.8 221.1 340.4 305.8 357.2 302.5 280.0 215.3 272.1 208.2 445.0 372.1 434.0 360.8 422.1 356.8 445.5 357.0	58.4 50.9 51.2 57.4 58.4 52.4 52.8 54.7 54.6 54.7 64.7 63.9 72.9 73.2 65.3 86.5	264°05' 289°58' 290°45' 1287°45' 286°50' 289°55' 289°40' 289°35' 289°15' 285°30' 284°35' 282°15' 288°25' 285° 304°
even	30	Op 7J	SE ex limit	3.8101	159.199		
	31		NE	3.855	159.154		
	32		NW	2.375	160.8635		
	33		SW	2.328	160.682		
	34	C SCHUBERT		3.890	159.118		
	35	step #2		3.738	159.272		
	36	step #3		3.485	159.825		
	37	step #4		3.331	159.679		
		(same, head up)		3.297	159.713		
	38	Op 7F, NE ex limit		2.475	160.835		
	39		SE	2.405	160.605		
	40		SW	4.088	158.922		
	41		NW	3.972	159.037		
	42	north side of feature		3.897	159.116		
	43			4.000			

AC Tom & I worked on clearing pots - took 2 hours
took photos 85-7-V7/10 (PSB85-123)
Op 9C stone filled pit, from E, scale 50cm (PSB85-024)
85-7-V11/12
Op 9C pots from above, scale 50cm
pots = 3: 1 Ubulutan plate tetrapod upside down
1 spoked jar right side up
1 frog bowl

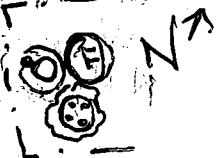

P85-7-150
6/17

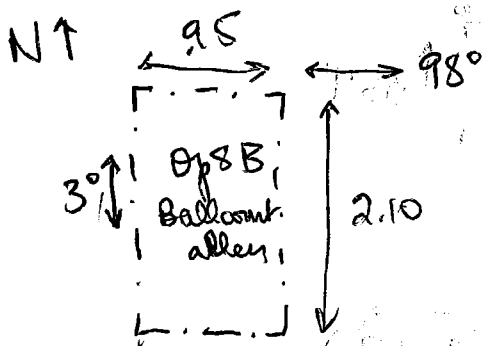
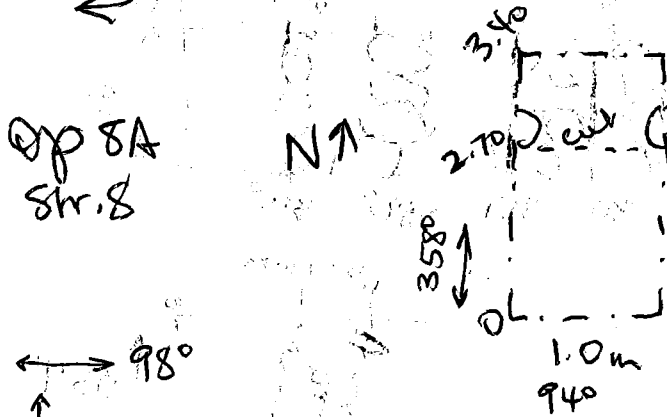
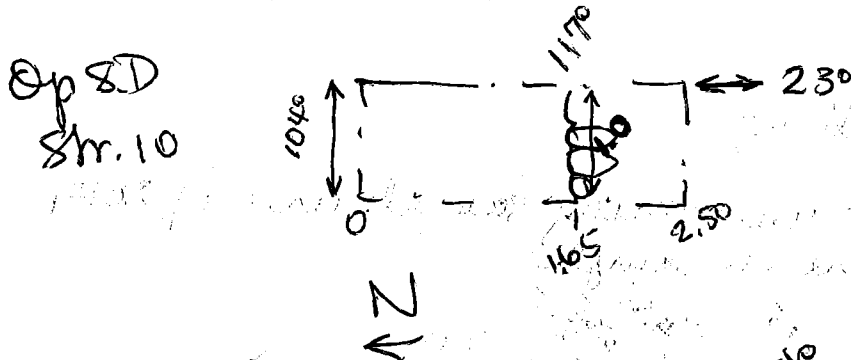
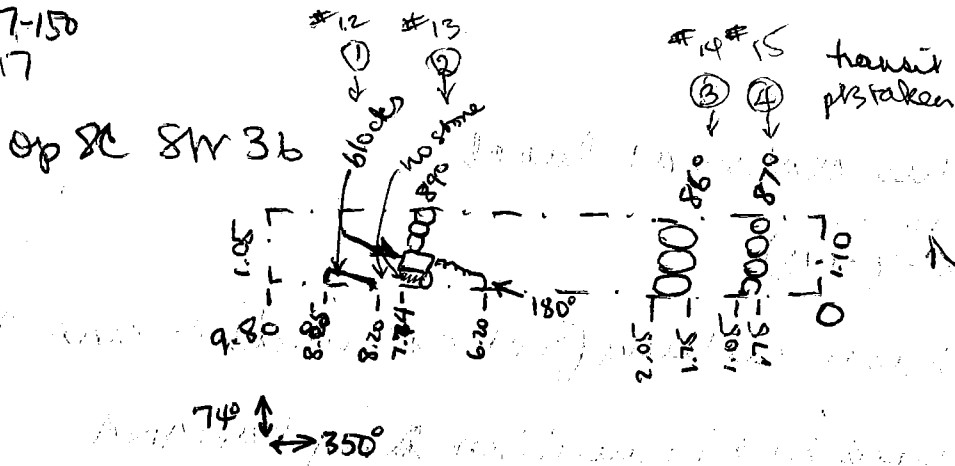

Op 5K Str. 17

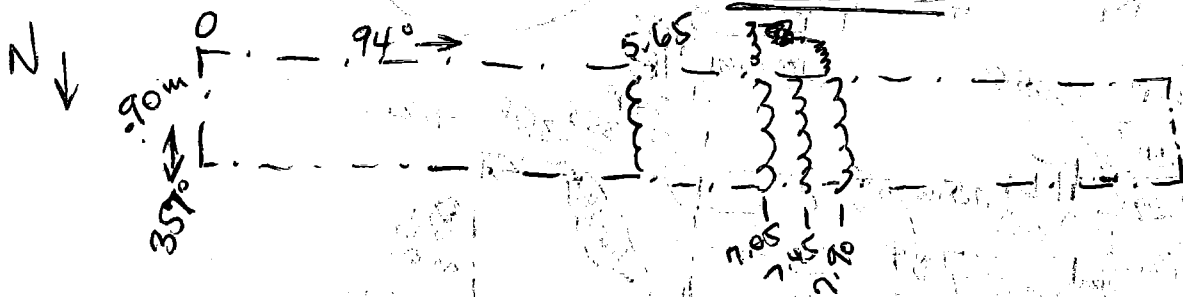

3H/18

cut is 75cm below ref pt on toe of Rasgo 13 (summit wall of 62nd)

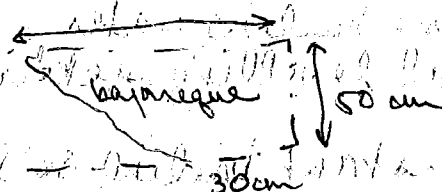
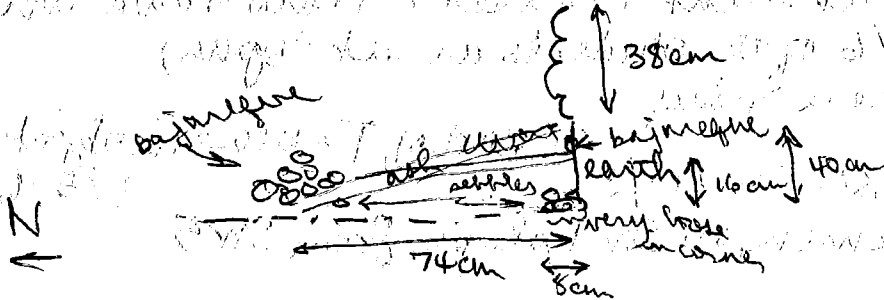

7G dimensions for trench

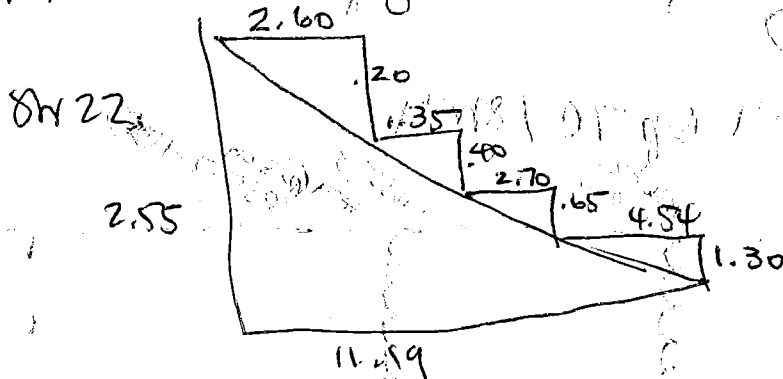

2.60	2.0
1.35	.40
<hr/>	<hr/>
+ 2.70	.65
4.54	1.30
<hr/>	<hr/>
11.19 m	2.55

June 15, 1985 (Saturday)

tom for officials at 9⁰⁰ a.m. (didn't really get under way till almost 10...) - moderately well attended (ca 30 people?)

p.m.: drew last of D85-7-9 (Op 3H/8H.6) added 2-4th to D85-7-5 (Op 3F/8H.2) completed south 1/2 of Op 3F (access trench)

June 16, 1985 (Sunday)

Tom M. & I drew D85-7-10 (Op 6E, 8H 20) in a.m. object photo in p.m. (photo list = D85-6-25)

85-7-118
6/14

Brenda worked on plants till 9¹⁵ when she ran out of newspaper (her blotter paper was lost in the between season fluff)

she's washing again

3G: beginning backfilling

took photos 85-7-T/2 Op 3E, PONDER from @ south in west section (PSB 85-107)

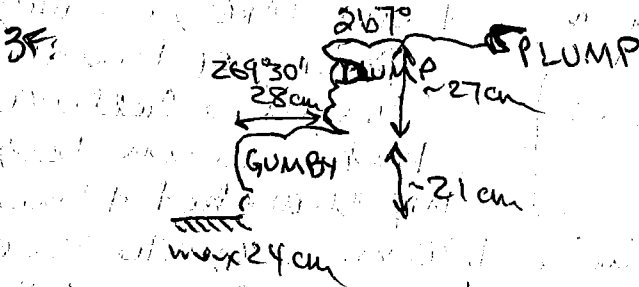

3H: cut through to S wall of Str. 6 - 2nd adobe & an ash lens, plus sherds but no evidence of intact architecture

3D: Str. 10 N wall = 110° - standing water, ~~at base~~ Leopoldo bailing now

3F: backfilling west of the lone wall feature

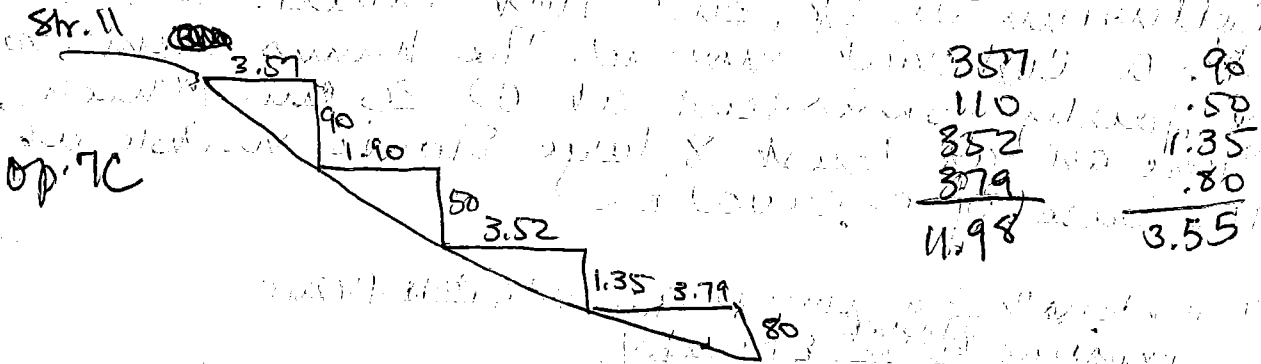

6G:

1M.

2.30 m.

6-G- Soil seems to be the usual brown silt. More Stone & adobe @ 40 cm. below surface - No depth. 60cm. apparent Soil 15cm. under water changes.

There seems to be a lens of Stones + small Stones @ 4 cm. across and the lens is @ 20 cm. below the surface. Plaza level?? Very muddy. Humus layer ends @ 30 cm. below surface.

PSB85-7-144
6/13-14

took photos

(PSB85-102/104) 85-7-~~8~~ 1/6 stone courses of Str. 1 (news not taken in 1984)
(PSB85-105) 7/8 sherd washing

Op 3H worked on D85-7-9 all morning
workers dismissed at 1:30

Op 3G worked on D85-7-3 1:30

Tom & Marie worked on D85-26-25 Op 5L (Str. 19)
Pat & Ed completed D85- - Op

150 94° no sign of rain - high clouds only
3E wall of substructure (east side of POND) is 73-74 cm
thick and as high as from surface of pond to
base of plaster on section (← east facing of
WONDER)

took photos

(PSB85-106) 85-7-~~8~~ 9/10 Op 3E circular feature from above (E to right)
11/12 Op 3E x-section WONDER wall
& POND floor, w/ 1/2" plaster
visible at right; scale 50 cm vertical

3:00 pm gave a slideshow / talk for workmen
at ITAH house

lost my square trowel around lunchtime...

June 14, 1985 (Friday)

843 - 83° steamy & overcast

rained a lot here & in SB (SB from ca 5 pm to 10:30+)

major collapse in south face of 3E

more collapse in N & W sides of 3F base pit

standing water most places

3E: Margaux & Jaime clearing collapse (backfilling into 3G)

3F: Rene & (?) cutting through RUMP to PLUMP to see if
water is also a step (i.e., 2nd-4th)

3H: Sergio cutting 6-2nd to seek any 6-3rd (E 1/2 of trench only)

P85-7-742
6/11

Izaguire & Rodriguez stopped by, let Brones
go / hired Leiva
gave us the name of a man in town who may have the
1791 Tenoca map (a copy)
"Prof Carlos Rivera vive casa de esquina frente a la casa
familiar Bueso Rodriguez a inmediaciones de los
suzgados - él tiene el mapa de Tenoca, 1791"

Sergio & Jorge sent to help Leopoldo clean for photos

took photos 85-7-Q 7/8 PSB85-93
(then backfilled) Op 11E, from SE, scale 50cm
85-7-Q 9/10 PSB85-94
Op 3E, UNDER floor, from SW, scale 50cm
85-7-Q 11/12 PSB85-95
Op 7F, trench (E/W) completed

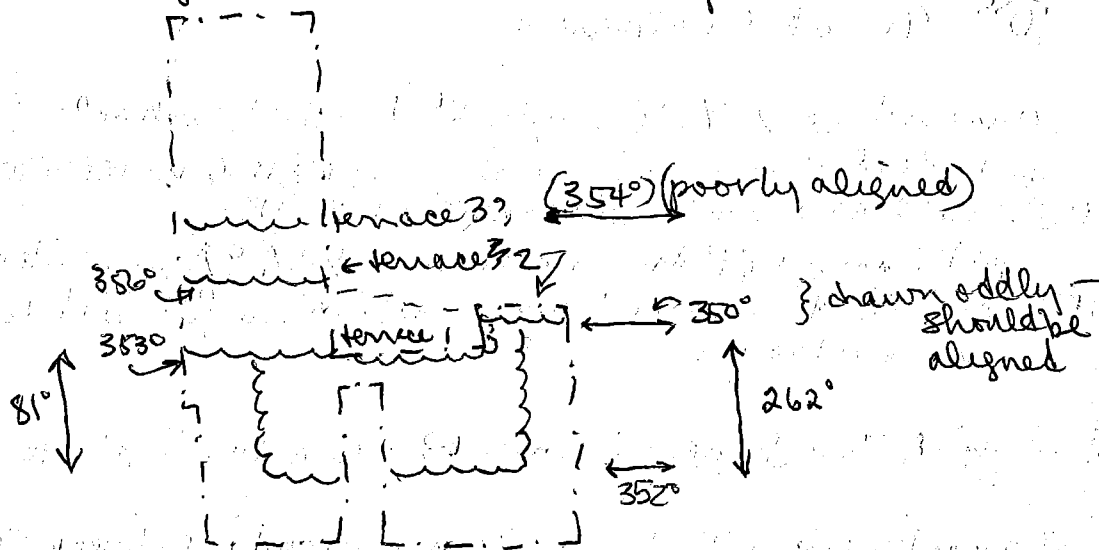

85-7-R 1/2 Op 7H, from N, scale 50cm (PSB85-96)
3/4 Op 7H, from S, scale 50cm (PSB85-97)
5/6 Op 7E, from N, scale 50cm (PSB85-98)
7/8 Op 7B, from NW, scale 50cm (PSB85-99)

Tom, Brenda & Marie worked on sketch plans
for plan points

I worked on D85-7-3 - Op 3E

→ E took photos
85-7-R 9/10 Op 6F, from SE, scale 50cm (PSB85-100)
R 11/12 Op 6G, from SE, scale 50cm (PSB85-101)

6/10

took photos

85-1-S11/12

Op 3F PLUMP etc, from NW, scale 50cm

85-7-Q1/2

Op 3L, SEES, MILKY (DUD in between)

from W, scale 50cm

~~85-7-Q3/4~~

Op 5M, from SE, scale 50cm

85-7-Q5/6

Op 6B from SE, scale 50cm

Tom & Marie drew Op 5M (D85-37-2)

rained out at 2⁴⁵

back filled today: 13A, 13C, 6B

Prof.

Abqdo

Miguel Rodriguez & Miguel Izaguirre Fallos came to investigate the break in at Mario's ex-house last Thursday - came over to our house ~~6/10~~ 6/10 evening night to discuss that:

- 1) Juan Briones is being let go (we'll hire him for these last 2 weeks)
- 2) Pedro Leiba will be the new guardian (day & night for L175/month + right to sell avocados from the property)
- 3) IHAH will put ^{barbed} wire across river side of property & cyclone fence along road side
- 4) IHAH will ask the road crews to improve the access across the ditch
- 5) Izaguirre gave Nancy Black ~~a~~ a letter of introduction to Comayagua archives & confirmed there's a good deal there (esp on Tencoa?)
- 6) Izaguirre knows of a 1791 map of Tencoa which he will try to locate here (or if not here, definitely in Tegucigalpa, for John/Nancy/Julie)
- 7) Rodriguez asked us to check ("authenticate") a collection here belonging to a Diputado del Congreso

P85-7-138

6/10

Recurring exco:

need to show

shift cut has orientations; uncut has not

13B?

5M Humus/H. brn/colluvium

5L consider cutting thru summit

7H need orientations on earlier

7C need orientations

plan pt 5 - stakes on str 17 E in Grp III plaza have been shot in - str 17 plan pt 5, none others have been done for Group III

7H stake shot + final features

op 11 self stake is on summit of str 12's N platform

Op 6 B - Soil amend, found ca. 0.56-0.70m w of the SW corner, extends ca. 0.10m n. of the S section, ca. 0.35 m below ground surface at this point, S. side of the trench. Found while cleaning.

8C - southern platform/outlet - cut blocks

Tom & Megan drew Op 8B (D85-26-23)

Megan ill - home on bus call am.

Tom & Marie drew Op 11E (D85-~~26-23~~)

37-1)

~~3E: Margarita & James's son cut thru bajareque layer
3E/42 termination of this lot
3E/44 beginning to cut below 3E/42~~

30/21: Seracino & beginning : a.70 below top of LUCY to take HALL
EOP earth matrix to level of LUCY

June 7, 1985 (Friday)

8³⁰ 9⁰ - hazy w/ a few clouds

Back at work again after nearly 2 weeks absence to attend my mother's funeral and begin to settle affairs

Ed & Pat conducted excavations at Ovalojunto in my absence

None in Group I, but see their notes for: (27 subops)

from Ed's of cards

- 5K Str 17 west
- 5L* Str 19 east & axial
- 5M ~~Grp III~~ Grp III plaza center
- 6B Str 32 east & axial
- ? { 6C Str 31 west
- 6D Str 31 west
- 6E* Str 20 west (axial? Str has long axis E-W)
- 6F Grp IV plaza center
- 7C Str 11 east
- 7D Str 12 east
- 7E Str 12 west
- 7F Str 12 north platform, west
- 7G Str 22 east
- 7H Str 21 south
- 7I* Str 12 to trace line of west basal step
- 7J Str 12 north platform, east
- 8A Str 8 south & axial
- 8B ~~Str~~ in north end of Ballcourt alley
- 8C* Str 36 north
- 11A gap in F.6
- 11B in soccer field (southern most test)
- 11C " " " (middle test)
- 11D " " " (northern test)
- 11E* south side of east arm of F.6
- 13A* Str south
- 13B* Str south
- 13C* Str west

cards
* = need data on final plan dimensions

on 7/14/85
in park
w/ Pam

p) broke into Mario's former house (upstairs, ok house) last night - removed wire panes, red - little there to steal but tried to take

P85-7-134

5/23

3F: René & Sergio extending 3F/28 farther southward, as I don't want to cut down at RMP till I can take a 2 1/4" record photo (Pat & Ed have the camera this morning)

3H: Ulises & Efrain removing fill block that begins 16 cm N & 66 cm below marked stone in section (Raigo #6) (← not certain of identification here - but will draw section today so can check)

3H/17 material from this cut - ^{down} to level to which 3H/16 was taken yesterday

STR 6 - see P85-7-123, 85-41-16 for relevant plans

3L: Pedro & Enrique

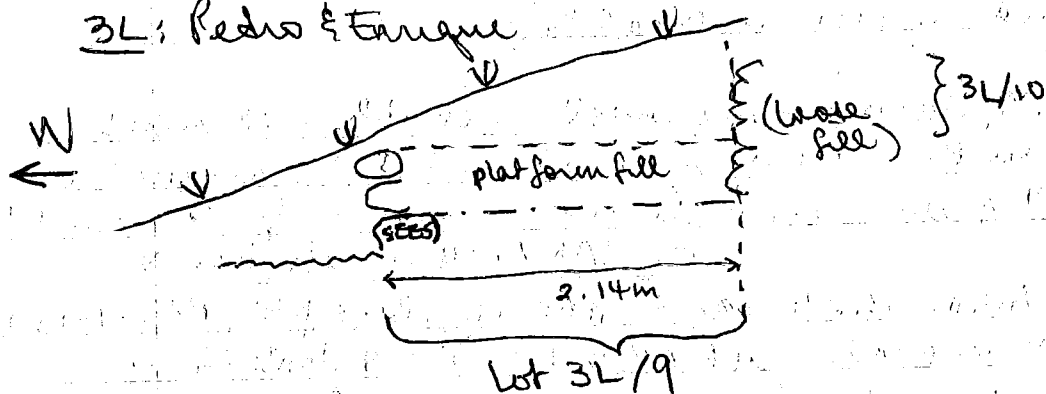

3L/10 cutting east from yesterday's stopping point (at 2.14 m east of SEES toe) but only that upper part inferred to be above SEES' terrace top

3Ø: continuing to remove to 2b to level of 3 - see P85-7-132 sketch plan

3Ø/20: still in this lot

★ Hiring 4 more men for Monday: (to advise current workers at noon)
Cristobal Sahillon
Juan Pablo Paz Piñeda
Julio Cesar Monterroso
Marco Tulio Piñeda

3E/102 7 bags of bajareque thus far - deposit ~ 15 cm thick with ash lens beneath - some bajareque flatsided, some with pole impressions - str collapse

5/22

3G cutting under BLUE, southward - so far (to S side of BLUE) the PARK "cap" seems consistent to overlie earth fill - thank heaven!

3G/38 this lot - ~~is~~ = 3G/35 contextually (PARK) without admixture of earth-fill materials contained in 3G/37

3E:

3E/40 reached 1.65 m below surface & I stopped them (no need - at least now - to reach plaster floor)

3E/41 cutting through plaster topped deposit in south end of original excavation, south of MAX/TAX - ends about at limit of original excavation - gravelled about 20 cm thick

3φ has reached 1.95 m below NE corner - silty matrix (not clayey) with some colluvial-like inclusions, but not basal colluvium yet - but should be near according to elevation

2¹⁰ 100°

3L: seems to be a more plasterly (?) floor abutting W side of SEES (as vs. gravel/pebble piso seen in 3B) - am avoiding cleaning it now till we get an influx of trowels and can do it carefully - SEES seems to be a low terrace, at least 50 cm wide (E/W) so far - still clearing eastward toward DVD - ^{later} NO, there is a wall, at least (& probably only) 3 courses high, now fallen but visible in basal course +

3F: worked on D85-7-5 (section, Str. 2) till 3¹⁵ (ca 40 mins)

3¹⁵ - 99° & breezy

3F:

3F/29

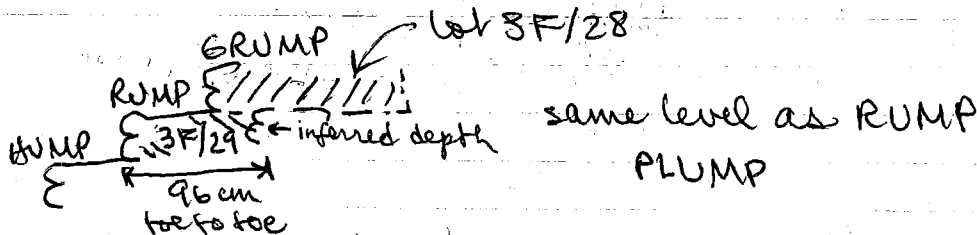

3A/16 cutting through R#8 ~~to~~ northward

3φ/20: cutting just ab from

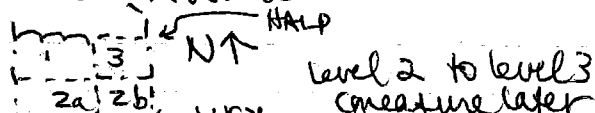

5/22

Pedro & Enrique

32: cutting through tumble west of DUD:

- downward to seek alley floor
- eastward to seek wall line

34/9 materials from tumble removal

30: Jeracimo & ? cutting down north of (in front of) LINUS to seek colluvial layer here

30/18 materials from this cut

3E/39

3E: removing 3E/39 suggests ^{sloping} all lens was a deposit followed by collapse (?) of bajareque (wall & roof?) and suggests BANANA is a wall base rather than a platform edge (or perhaps re-used subsequently as the latter)

3F: at base of 3F/27 (as defined on P85-7-129) have encountered large bouldery stone (ca 40 cm diam) that appears tumbled - no stones in area adjacent to west & lower - is this the back side of str 2-3rd?

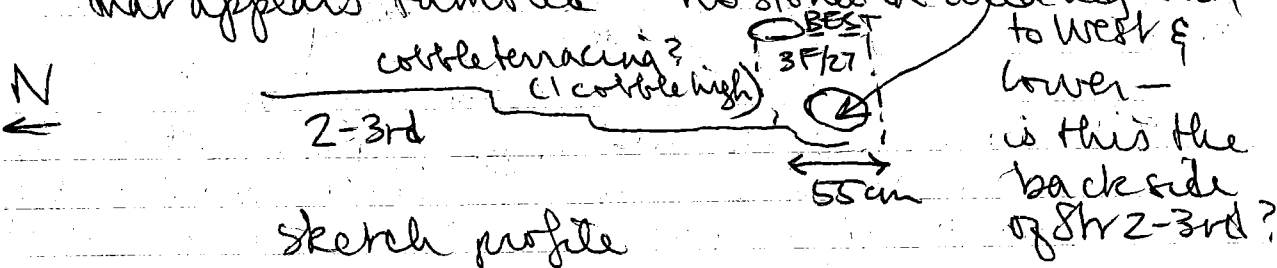

sketch profile

3H/16 cutting thru Razo #8 to seek earlier str on this side

→ 3H/15 yielded sherds & 1 thick obs blade

↖ & at base, some stones tumbled (from 6-2nd?)

↖ 40-70 cm below SE corner of excavation

↖ 50 cm below top of R. #8

approx section size

34/9: revealed basal wall line - BLOCKS (as in 3B in 1983) is this from 1-1st? - call this SEES wall - continuing to remove tumble over & east of SEES

3G

34/37 change lot from indicated on P85-7-129 to indicate change here

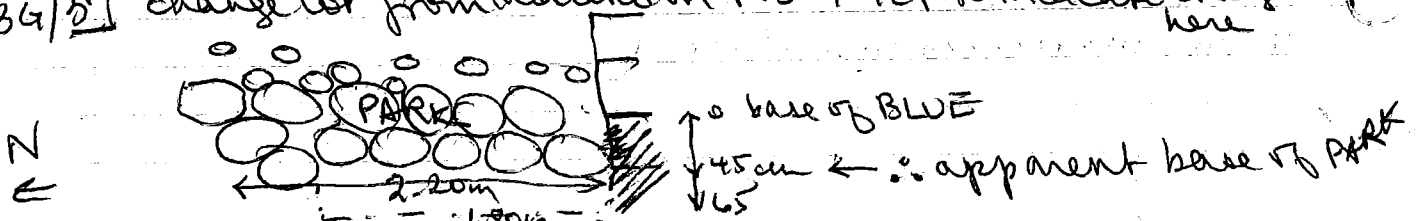

FOS-7-128

4/25-5/24

April 25 - May 3 (Thursday - Friday)
left for New Orleans - personal

May 3 - 5 (Friday - Sunday)
San Pedro Sula

no workmen
employed at
Gualojquite
4/27-5/19

May 6 (Monday)

Reviewed excavations - no substantial rain had fallen in period of absence, and no apparent vandalism, only 2-3 stones had fallen (accompanied by a few others) ^{the Japanese team working at La Tichada}
Ricardo Aguirre visited - students & Foncho & Julie & Sylvia went on to Comayagua - Ed & I stayed to talk with Ricardo, showed him the lab & the Gualojquite excavations - he seemed pleased with the state of progress - also toured Lopez house, which he would like to convert into a local museum - we urged him to hire Pedro Leiva as watchman if/when he could, as Don Pedro knows the house & grounds and seems more industrious and reliable & locally trusted than Juan Briones

May 7 (Tuesday)

Ed, Celeba & I drove to Comayagua (via Taulabe) and toured Yarumela (such as it is) while the rest of the staff (having seen Yarumela in the morning) went on to Tenampa.
Everyone joined up again in Tegucigalpa

May 8 - 10 (Wed - Friday)

Ran errands, worked on preliminary short informe, which was turned in on 5/10
Julie acquired Catastro maps (1:10,000 scale) for our area
Migration arrangements taken care of (took till 5/13 for Foncho to complete)
I left for the U.S. 5/10

May 10 - 19 (Friday - Sunday)
Harvard interview trip

May 20 - 21 (Monday Tuesday)

Departure (from Tegucigalpa) arrival & baggage retrieval - reached SB

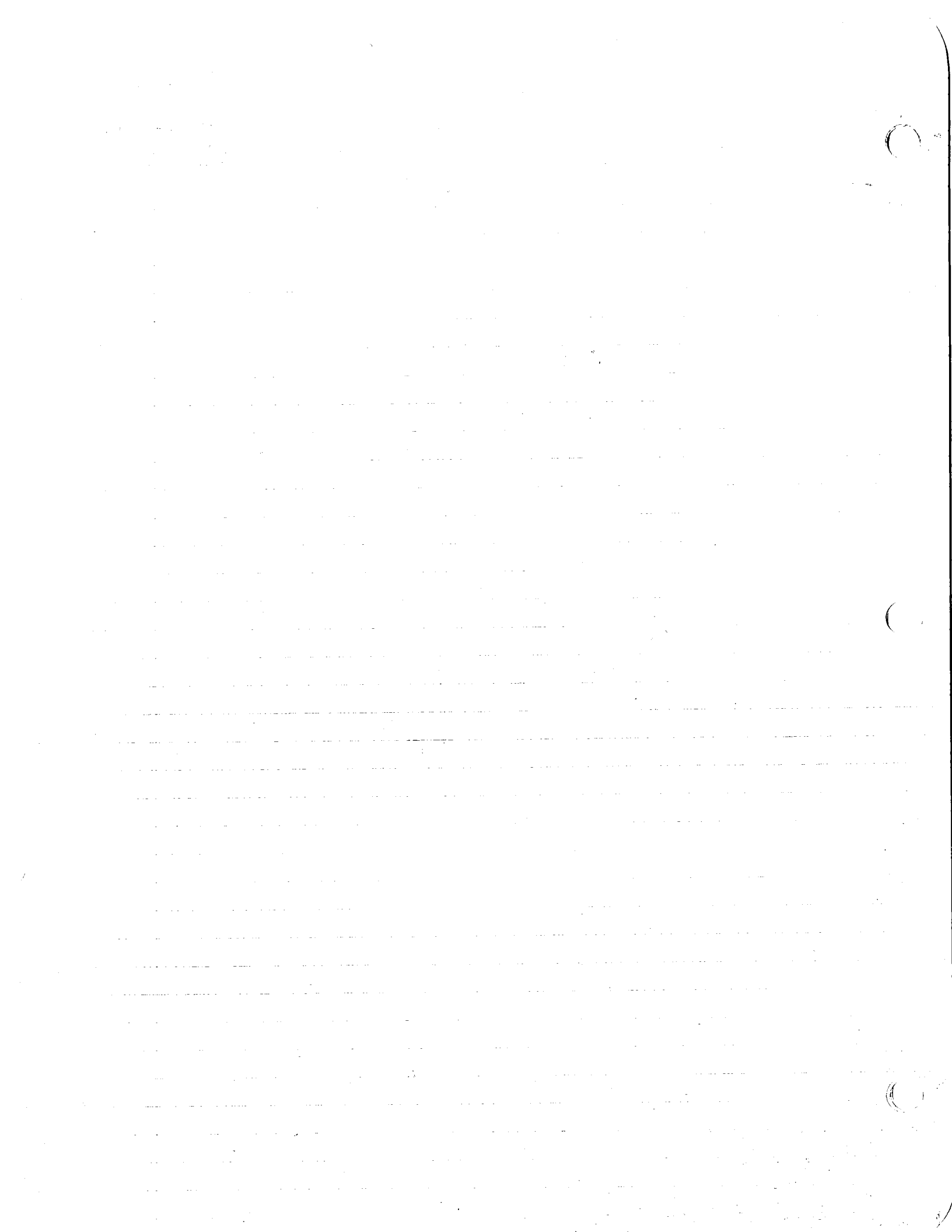

P85-7-126

4/23-4/24

3G/35
3E 37 Log²
3E 38 M
3F 25
30.16
34/8
3F 126

3F:

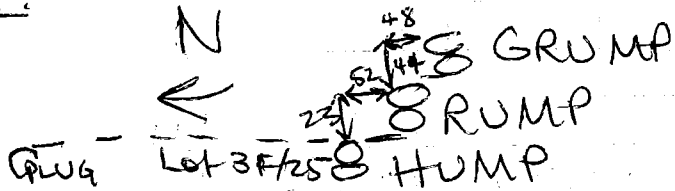

took photos 85-7-011/12

Op 3F, GRUMP/RUMP/HUMP
from ~~area~~ north, scale 50cm
beginning of next step down may be visible

3H: took photos 85-7-P1/2

Op 3H - Rasgos 10, 11, 13 from north, scale 50cm

April 24, 1985 (Wednesday)

75° 84° and misty (combo of smoke & humidity)
Foley & Valerie with me today

& Jaime

3E: Margant, straightening trench wall overlying
lot 3E 26

3E/35: materials (misc) from this straightening

3E: south extension

Lupe and Jorge straightening trench wall here too

3E/37: materials from this straightening

3G: still cutting into PARK

3G/35: still in this lot

3H: in abeyance for now

3F: ~~the~~ Ulises & Egrain cutting from PLUG south toward HUMP
to seek fourth step down

3F/25: still in this lot

3F: Sergio & Rene cutting down in area of no stones north of
BEST (see sketch plan P85-7-122), beginning 42 cm
below base of BEST - is there an 'S. D. here'?

3F/26: materials from this cut

P85-7-124
4/23

3E: south extension

continuing down behind (north of) NORTH retaining wall
3E/36: 95+ cm below surface (measured at interface of ^{south} extension and original excavation
includes pieces of plaster floor - gray (burned) with slight tinge of red on surface

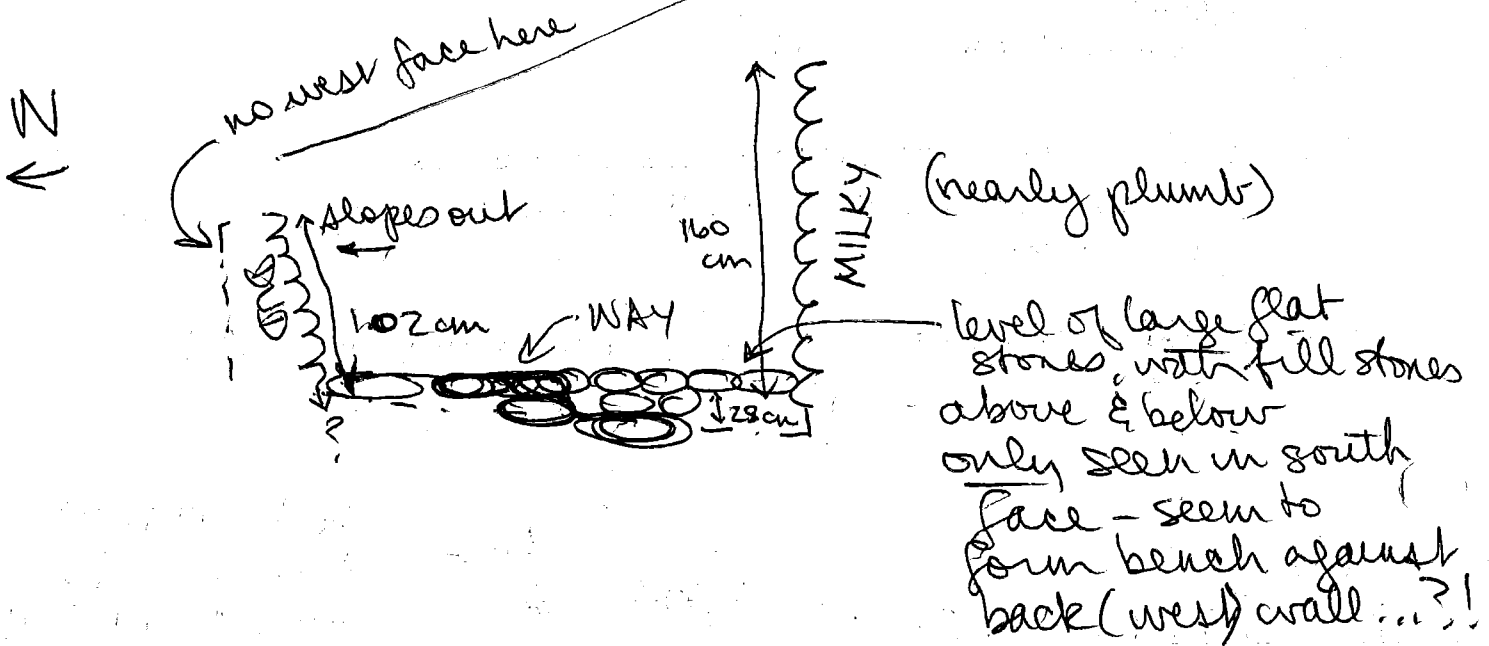

¹⁴⁰⁻⁹⁸⁰
(1245 - 130 worked on D85-31-2 section Op 30)
36: continuing to removed matrix of
36/15 →

3L: took photos 85-7-05/6

Op 3L MILKY wall, from W, scale 50 cm
85-7-07/8

Op 3L, DUD wall with WAY appendage, scale 50 cm
85-7-09/10 from NE

Op 3L, MILKY, SNICKERS & FUDGE from SW,
scale 50 cm

took plan points for Ops 3L, 3H (85-7-2nd)
(see P85-7-125)

P85-7-122

4/23

39: 258 cm north of north face of BLUE, in lot 39/35, change in soil to fine silty brown matrix FUSCHIA

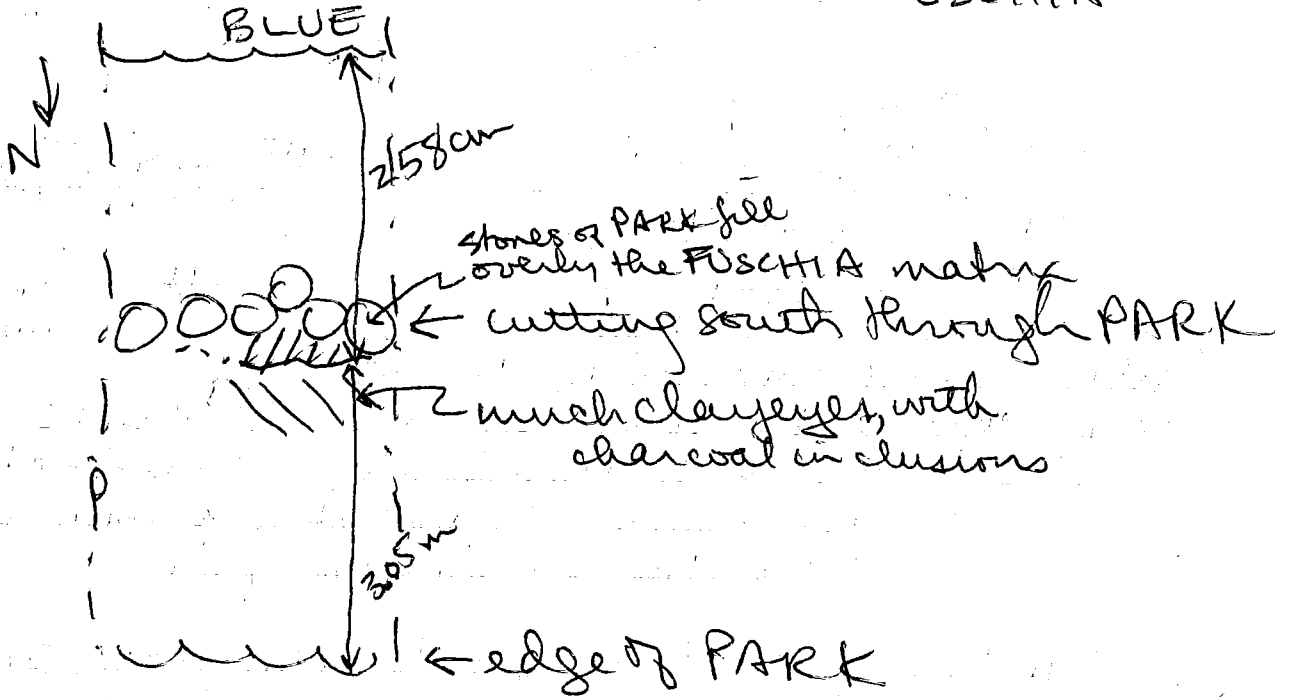

3F:

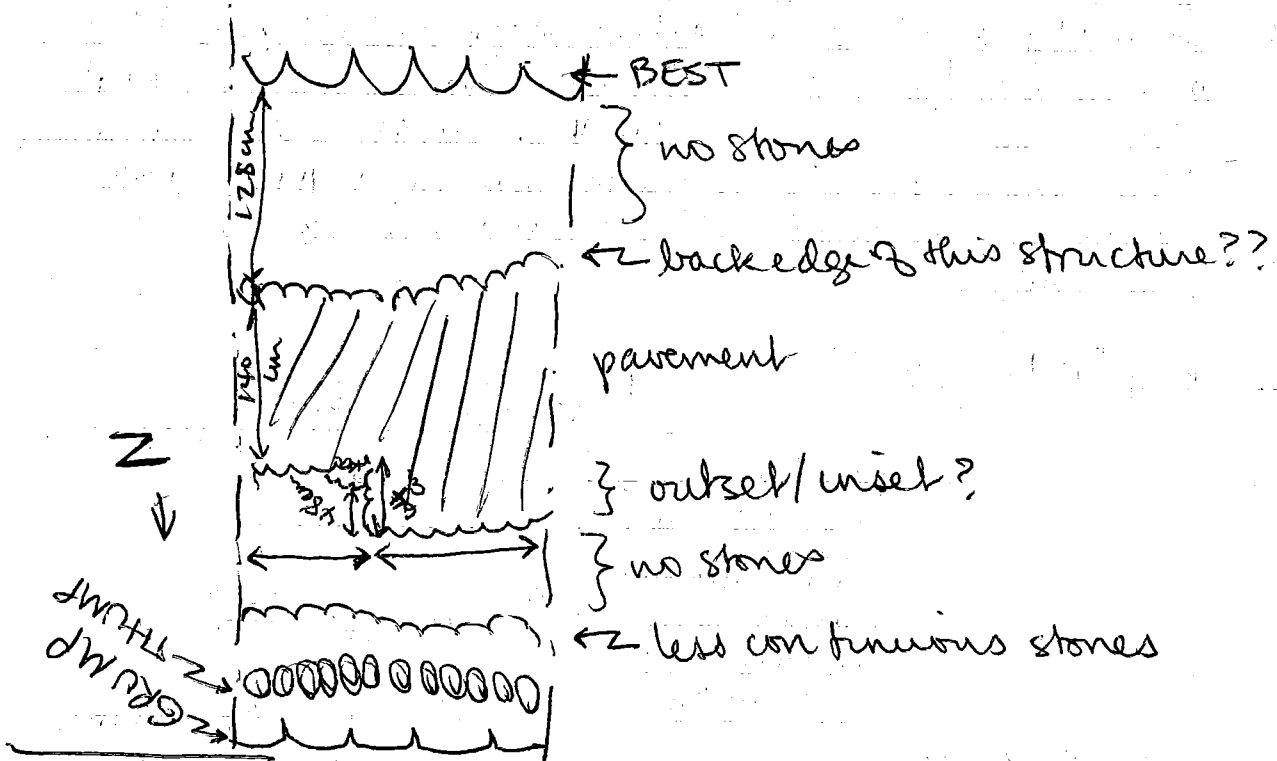

took photos 85-7-Ø 3/4

Blue river at bend, looking west - to show how low it gets & show cobble beds

P85-7-120
4/23

April 23, 1985 (Tuesday)

75° 81° very muggy & the sky is hazy from burning - still blue but altogether very April like

Folly & Valerie both here today
Plumbing in Galeras was finally fixed yesterday

3E: Margarito & Jaime Jr. travelling interface area between TEND & BANANA to reveal extent of plaster material & clarify relation of the 2 features

3E/32: materials from this cleaning

Lupe & J Jorge cutting through ~15 cm (77-93 cm below surface) down to level even with main part of trench

3E/33: separating material behind north retaining wall (mostly earth matrix) from that south of same (mostly cobbles) ↑ from 1984 exc*

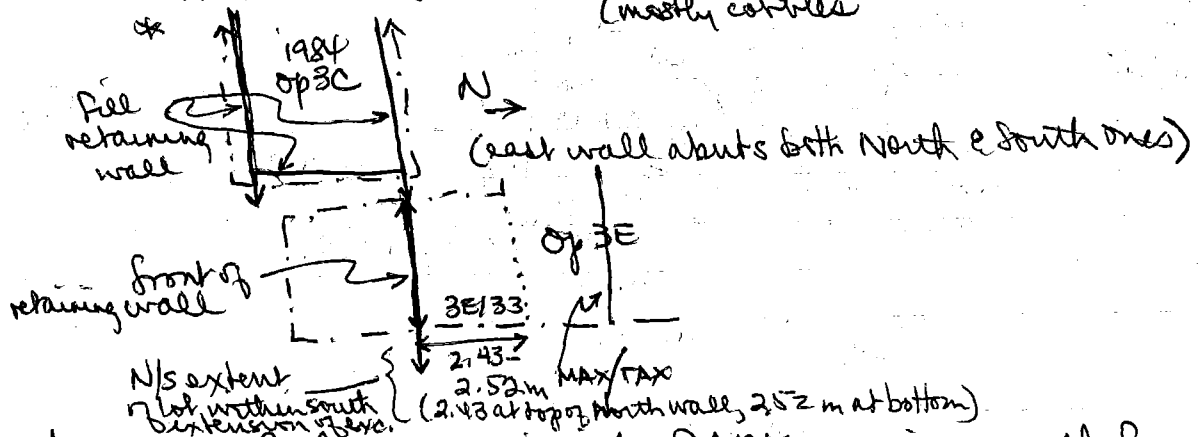

3G: Moreno & Rufino cutting into PARK, moving north from BLUE
3G/35 still in this lot (defined P85-7-114)

3F: Sergio & Rene removing/travelling final cap linking cobbles behind RUMP/GRUMP to them
3F/24P: still in this lot

3H: Alicia & Efrain still cleaning stones
3H/13 still in this lot

3L: Pedro & Enrique clearing down to base of DUD
3L/7: still in this lot

P85-7-118

4/22

15⁰⁰ m. 94°

3E: have cut back to the 3F/23 area with no further step up, so RUMP/GRUMP appears to represent summit - now to remove final 5-10 cm cap they left, to seek back wall for summit of this version

3F/24 shell in this lot

re: 3E/28 → BANANA wall is flecked with specks of white - plaster? matrix

took photos 85-7-Ø 1/2

Op 3E BANANA wall, north face, scale 50cm

3L: partial collapse of north (section...) side of trench, west of MILKY - cleaning that now

15⁰⁰ 94° & windy (breezy with gusts)

3E: Jaime Jr & Cristobal removing BANANA wall

3E/30 materials in matrix of BANANA wall
shells, Bone

3H Rereading Foncho's notes on Str 6 / Op 3H (cf P85-7-64)

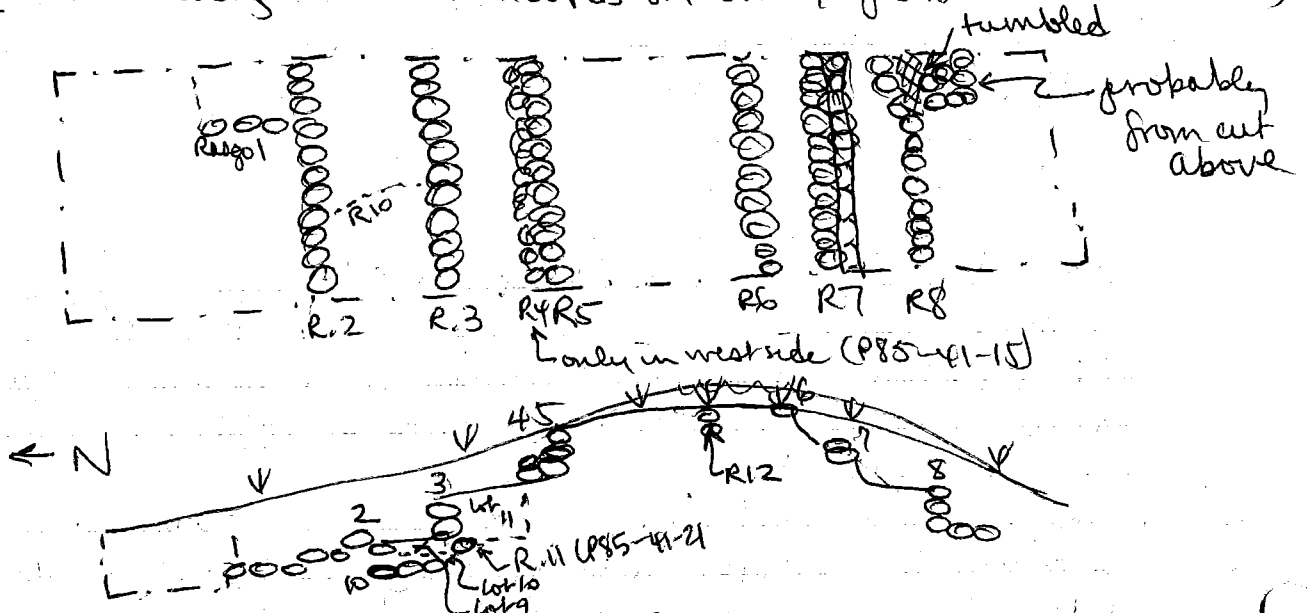

lot 3H/1: back dirt of Op 1A

3H/2: humus

3H/3:

4

5

6

7: P85-41-17

8: P85-41-17 remaining Rasgo 1

9: P85-41-17 " " 2, above R.10

10: P85-41-19 area of dirt betw 2 & 10

11: P85-41-21

12: P85-41-21

P85-7-11b

4/22

April 22, 1985 (Monday)

75° 81° high overcast cloud cover - humid, air full of water, but no rain - type clouds (cumulus)

no rain over the weekend so no trench collapse from that but VANDALISM did occur

Vandals: - Op 3E: hole dug in base of 3E (162.80 - 163.00 m. elevation; 1.03 m. N/S x 60 cm wide E/W on west side of trench)

looks to be just cobble fill

- Op 3G: removed/disrupted stones of north face of BLUE, ca 70 cm from west side of trench (essentially area to right of meter stick in 85-7-N11/12), top to bottom - looks to be just wall fill announced there'd be a 3 week hiatus in Gualiquito work (4/20)

no one but workmen here with me today

(for Jaime)

3E: Jaime Jr & Cristobal (for Margarita) continuing down through fill behind BANANA wall - beginning at 162.92 m elev at north side of BANANA & 163.00 m between 23 & 24 m south in overall trench

3E/28: material from this fill

3E ~~3E~~ J Forge (? in for Lufe) continuing down in (fill) beginning 60 cm below surface (today's beginning point)

3E/29: material from this matrix

3G: Moreno & J Victor removing west half of BLUE wall

3G/30: materials from removal of BLUE wall

3F: Sergio & Rene removing stones that underlay WAND, to reveal more of features that may be associated with GRUMP/RUMP (P85-7-114)

3F/24: still in this lot

3L: Enrique & Pedro continuing down in front (west) of MAX, to seek next terrace level down

3L/7: still in this lot

3H: Ulises & Efraim removing Rasgo #12 & Rasgo #6

3H/13: materials recovered in this lot

P85-7-114
4/19

- seems to be

3G: BLUE north side, fully exposed, to max ht of 1.20m
3G/35: cutting thru fill of PARIK, which abuts base of BLUE

3G/34: Some of this may properly belong in 3G/35 but better to mix this way than the alternative looks like ulua & other polychromes here

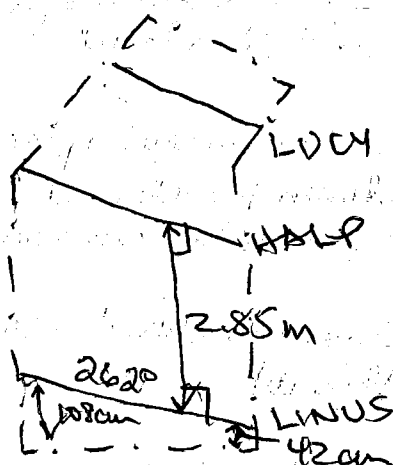
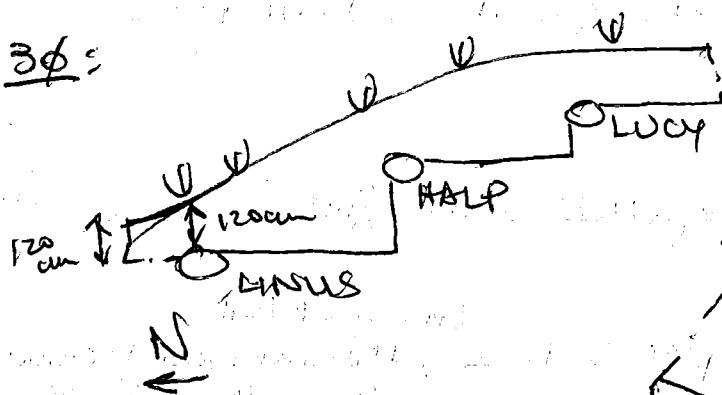

3L:

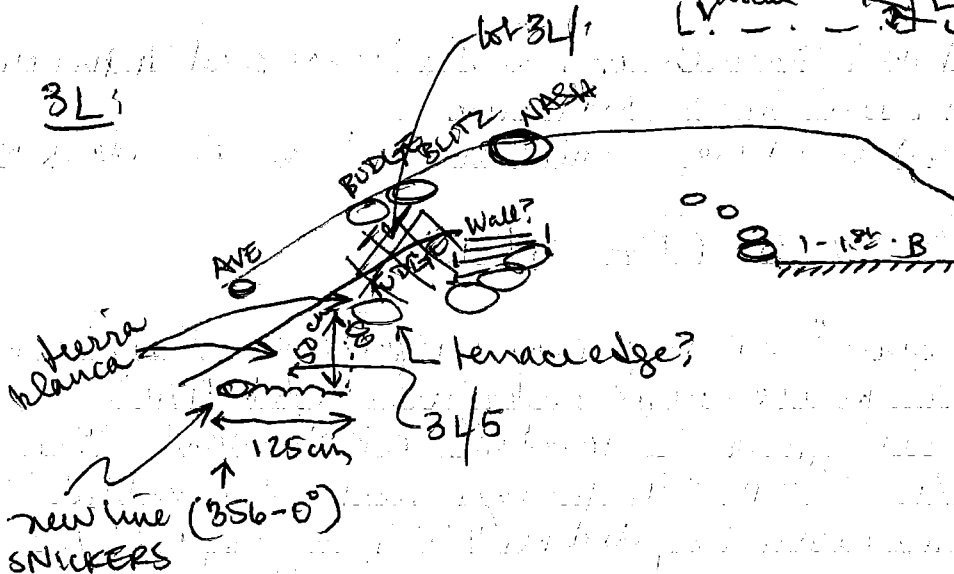

3L/6 will be cleaning west of & down from SNICKERS to seek next

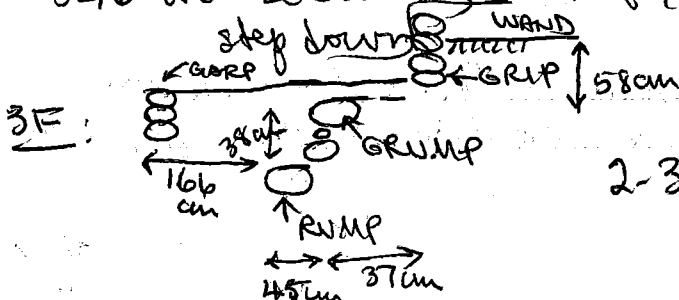

2-3rd?

P85-7-112

4/18 -
4/19

3L/4: materials from tierra blanca described on P85-7-109 ()
● some put into 3L/3 maybe from west of western line (FUDGE)
that's below BUDGE

3F/245 cutting from GARP south, removing GARP fill
back to position of GRIP

2D

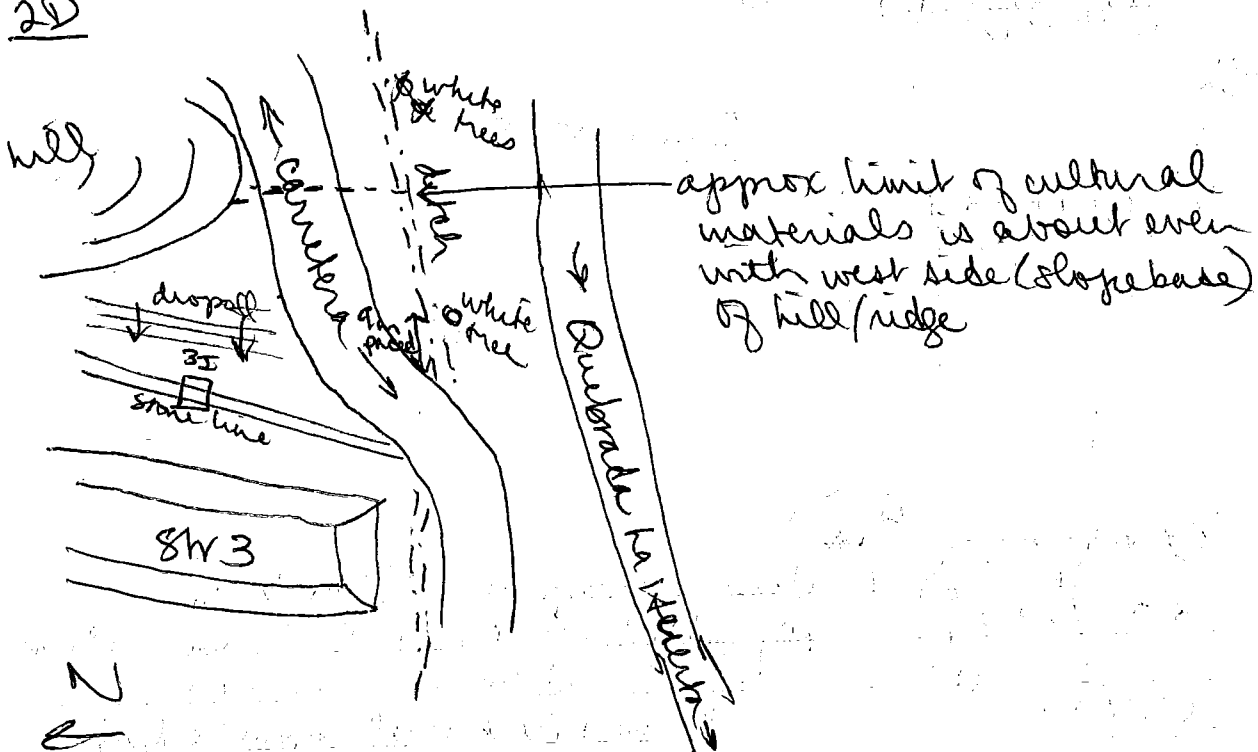

April 19, 1985 (Friday)

75° - 82° muggy & ^{very} overcast - rain heavily again in early morning hours, and was still raining in Galeras when people left to come to breakfast

No one with me (besides workmen) now.
Foley & others (Valerie, Rick, Tom, Dan, Tom) off to Copan
Sylvia helping Julie recover the rest of the burial they found yesterday

Foncho at lab house with Tulio, to await albañil and/or other repairers for the broken pipe

P85-7-110
4/18

block of matrix behind
BEST rubble

3F: removal of 3F/21 has revealed line of stones that are probably (a low (basal?) course of CREST (call them BEST) - to clean with trowels now, to define this, go down south of BEST to seek next terrace level (or whatever) behind it

3F/22: will be that cut, when they do it again horrible slippery heavy mud (also some collapse between GRIP & GAPP (both sides of trench))

3E/36

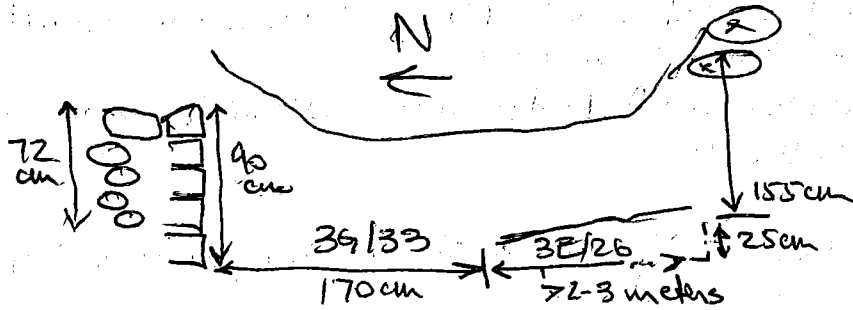

3E/26 from 170m south of BLUE to under stone shown (marked on P85-7-3 top is at 164.62 m)

3E/27 in 4.5 m extension from beginning of cobbles (continuation of debris line seen in P85-7-3 farther north) (~25 cm below surface)

3F

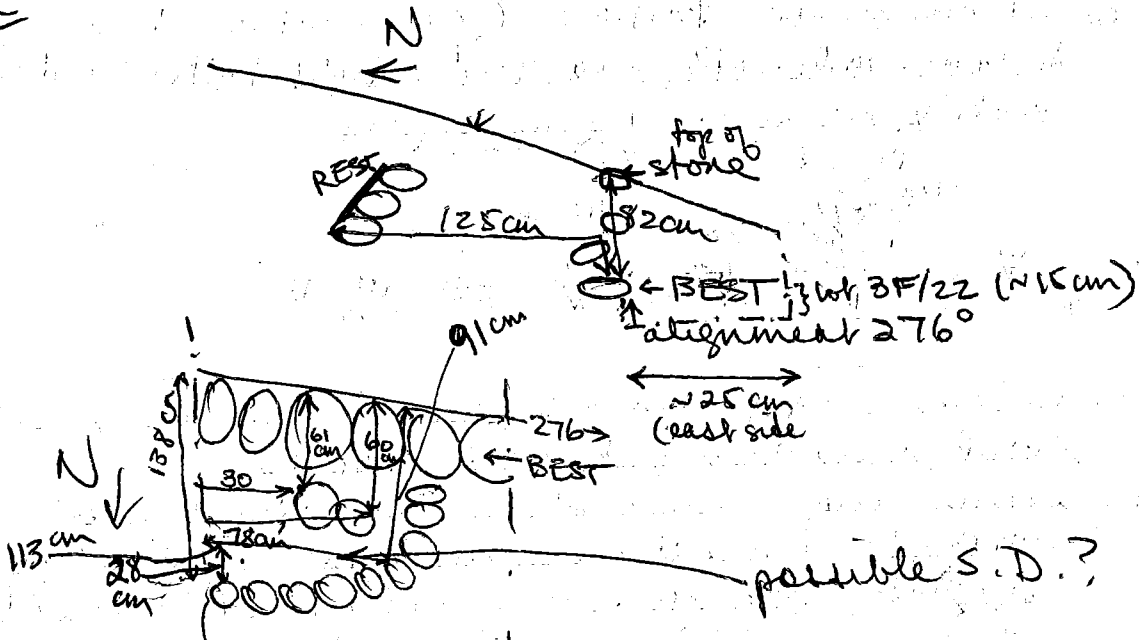

P85-7-108

4/17

2D/2 includes the red or orange plate, in it put white plumbat-like in used sherds there

3φ:

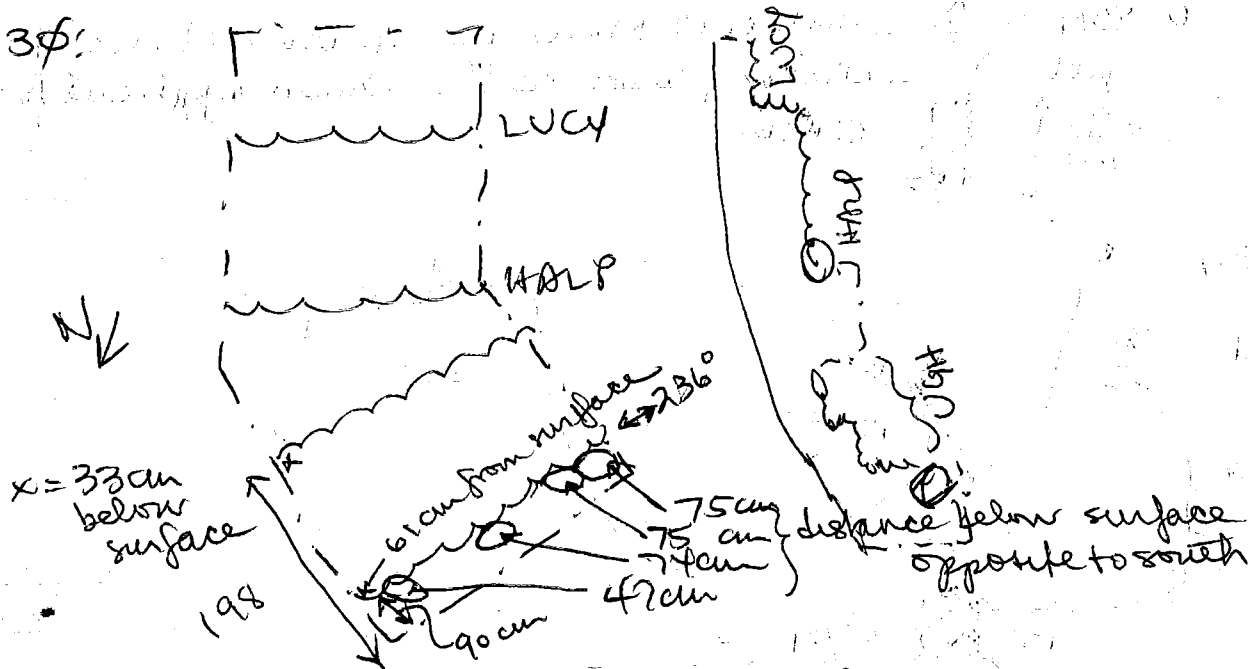

3φ/11; cutting through UGH to level of large stones seeking intact features

3L; have reached east side of BLITZ, without encountering any wall or other features to level at top of BUDGE

3G: BLUE wall

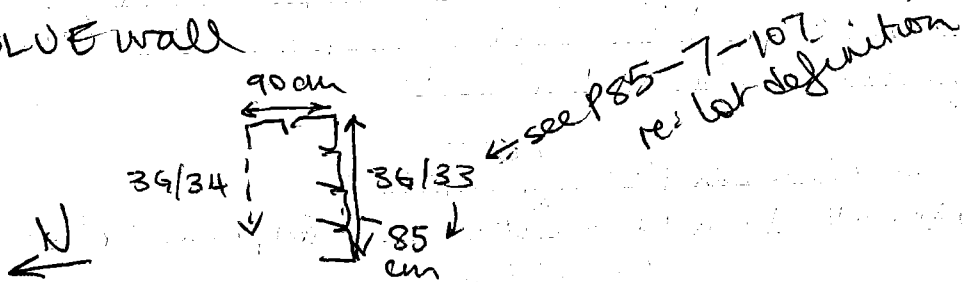

April 18, 1985 (Thursday)

755 80°

a real, heavy downpour about 2³⁰ this morning - woke us up in SB & Galeras - standing water & messy mud at Guafoguito - derrumb/collapse of east side of base pit in 3F (8r 2) - must leave as is for now, till it dries

P85-7-106

4/17

Foncho alerted me, on my return from Galeras, that a drainage ditch (just outside the site fence to south) was turning up sherds & jute & ashly soil
ditch is ca 50 cm deep (45-50 cm measured) & ca 35 cm across

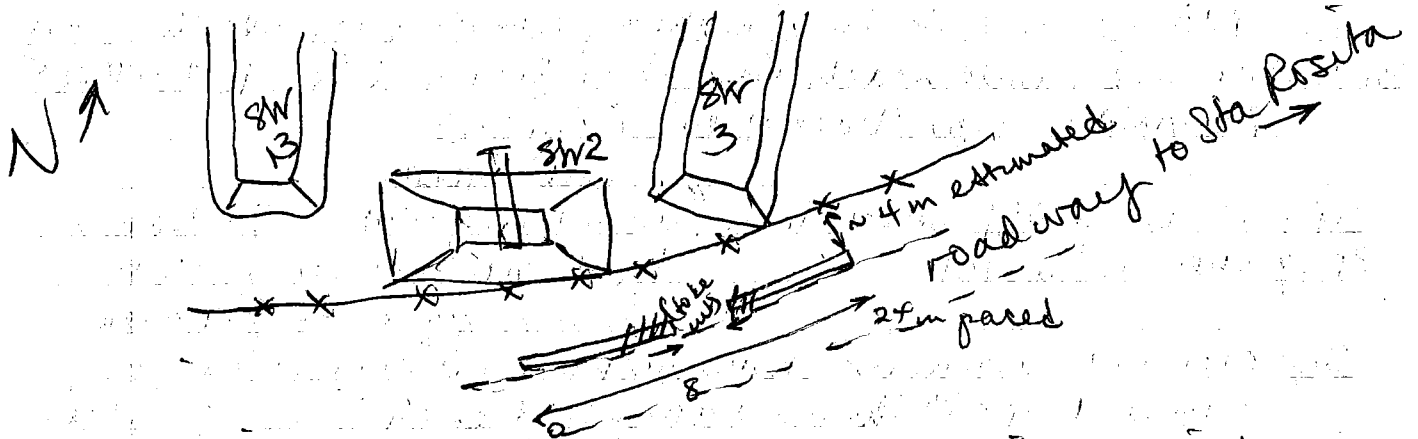

jar sherd; 2 lg presses scored center lid, animal bone (deer?), large red on orange dish rim
? midden for 8hrs 2/3 (seems so)

2D/1

— 2D (top) is materials from these excavations

2D/2

materials closer to 8hr 2

} probably meaningless distinction

(cf. Benyo-la Ceiba / Cayon & Hayden & Cannon re: trash of individual houses/households)

3L: found stone line - 1 cobble wide, preserved 6 cobbles long
water-modified cut 130 cm

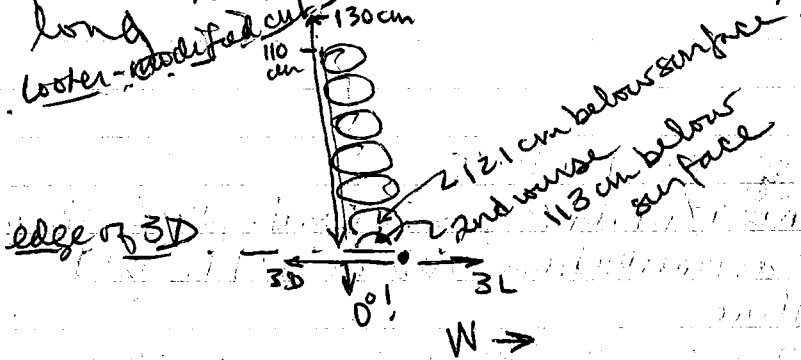

now cutting through NASH & down to level of BUDGE (i.e., through BLITZ too) - fill of 1-1st - A

3L/3: materials from this cut

seeking eventually to reach east wall/platform edge for 1-1st - B

P85-7-104

4/16 - 4/17

2 visitors ca 3⁰⁰ - both Honduran, who = unknown
(thought one might be Mario Lopez & tho' he started
off with the same question as ML had 2 years
ago [¿han encontrado algo?] he didn't look
familiar)

3L: cutting down east of NAS4

3L/2 reopened this lot - shreds & adobe but nearly down
to level of step up at west end of Op 3D (Str 1-1st-B)
but no evidence of yet

30p

30p/9 has produced 5+ bags today
have cleaned off stones that seem to show lines (ca
20 cm below surface) parallel with original orientation
of excavation, but these are skewed & way too high to
pertain to HARPE & Lucy (assuming they're even
"real")

April 17, 1985 (Wednesday)

10³⁰ - 85° in Galeras

^{the weights}
Last evening a shower bag broke a pipe in Galeras house
main bathroom - required repair (exam Tues eve / repair
Wednesday)

Also I had to go to bank again. Foncho to do migracion renewals
Folly & Sylvia stayed with Valerie to do labwork while
Foncho & I ran errands and Daisy & her albanil
worked on repairs

workmen at Gudijocuito asked to

- 1) move 3E back dirt at south end for french expansion
- 2) clear on hill east of soccer field, for map points
- 3) backfill 3N

D85-7-102

4/16

110° - 88°

3L: shell cleaning at north end

3G: added basal pit, to D85-7-3 - Polly measuring, me drawing

- TOP
- 3L: BLITZ 174°
 - BUDGE 179°
 - AVE 171°
 - HERTZ 171°
 - WRECK 9°
 - HEAP 12°
 - RENT 1°

progressively less convincing

LEASE 110° (x) n2/3 down

3F
3F/13

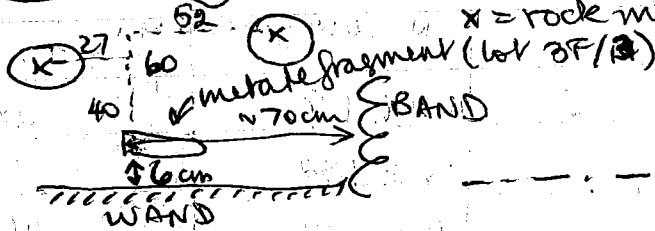

REST (up to 5 courses high) 46-60cm (3 courses / 5 courses)

slope is 52 1/2° on east side
59 1/2° on west side

3F/18 clearing down, not more than 10cm north of REST - to see if the stones emerging have any alignments to them

3E: at eyeballed-level even with top of BANANA, beginning to get cobbles again (instead of dirt)

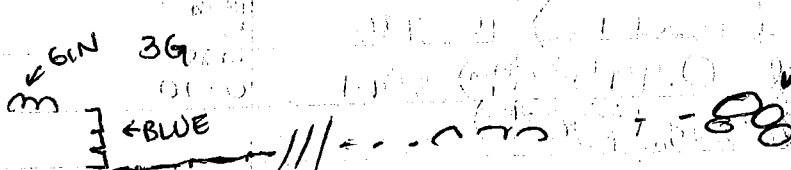

cleaning for photo of BLUE

} doesn't feel - but perhaps all associated 5-3rd??

P85-7-100

4/16

& below bank

3K: removing fill block (cobbles) immediately east of \odot

OPUS

3K/9: materials from removal of this, from top of cobbles

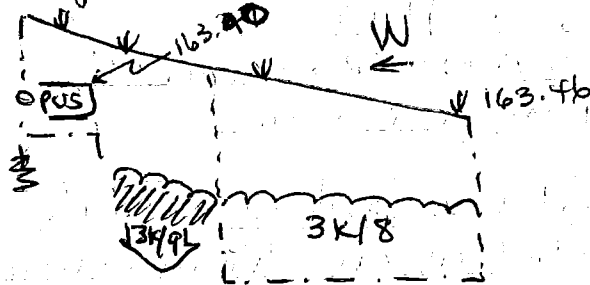

3L: Pedro & Carlos Enrique cleaning steps here & potentially redefining their positions & alignment (to reiterate: upper 3 or so are clear, but they're progressively more questionable, as now cleared, as one descends)

3L/1 reopen this lot

Folly, Sylvia & I went in to do business (bank, send cable to Vito Veliz)

returned by 10³⁰

Foncho said THAT administrator had been here (re: the Lopez house) and he (Foncho) had also pressed the case about the car (to seemingly no avail)

3K: the suggo adobe surface seems to continue back

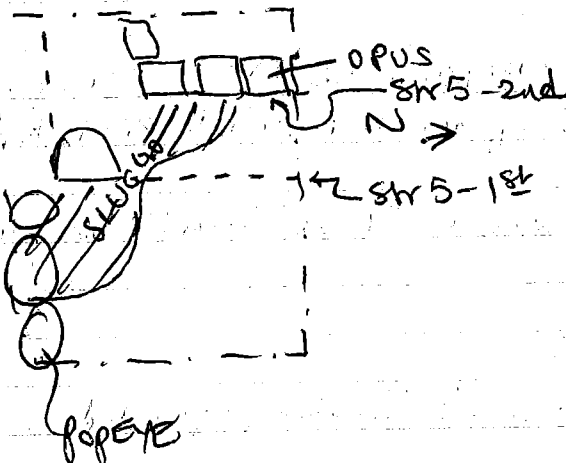

3E: cutting through BAND/REST bench - no special deposits (nearly all cut)
REST wall slopes down, ^{behind} (was abutted by) the BENCH

P85-7-98

4/15

3G: BLUE wall now at least ^{4 courses} 62 cm high - very blocky wall stones - suggests a chamber (?) more than a room, but if so no cap stones & N/S width still unknown
 am assuming south side is interior face of wall
 orientation of BLUE is $83^\circ/263^\circ$
 (as vs GIN $274^\circ - P85-7-88$)
 $/94^\circ$

3K: still lots of sherds

3K/8 0-120 cm south & 0-150 cm west of NE corner } beginning of intact
 80-110 cm down } plaza fill?

3K/6

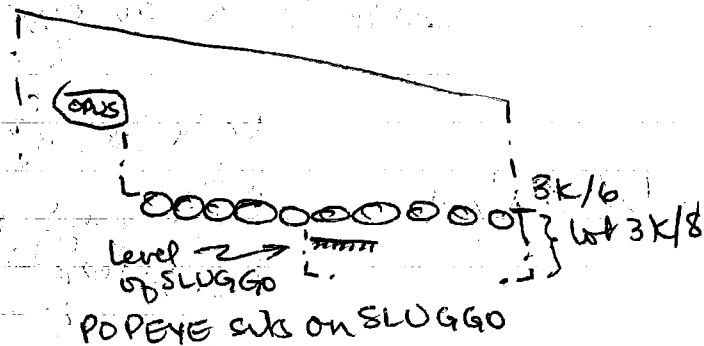
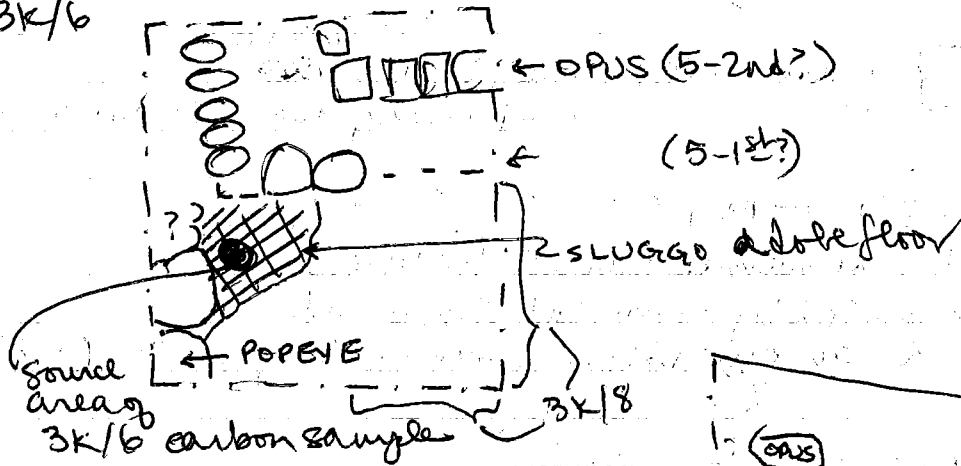

3D: took photos 85-7-M 9/10

Op 3D: HALP & LUCY from north scale 50 cm

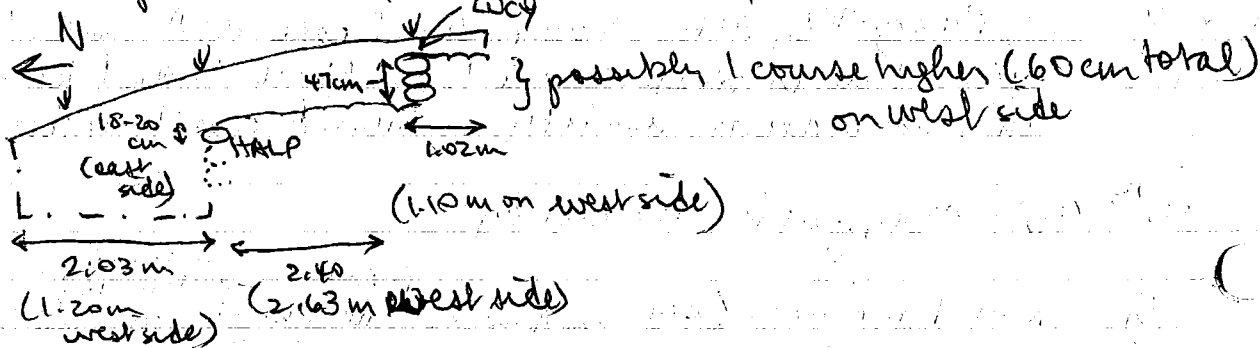

125 89° & overcast still

1.70 m E/W at north end

3F: Sergio & Rene clearing south from previous excavation
 limit to walk back (exterior) of REST wall
3F/15 — ^{laterally} continuous with 3F/14, these materials (from ↗) are
 less related to room interior or its fill & more to wall fill
 & structure collapse

3G: in abeyance

3H: Ulises has his day off today; Efrain working with Carlos
 Enrique + Don Pedro to clean off features previously
 exposed but recovered from rain

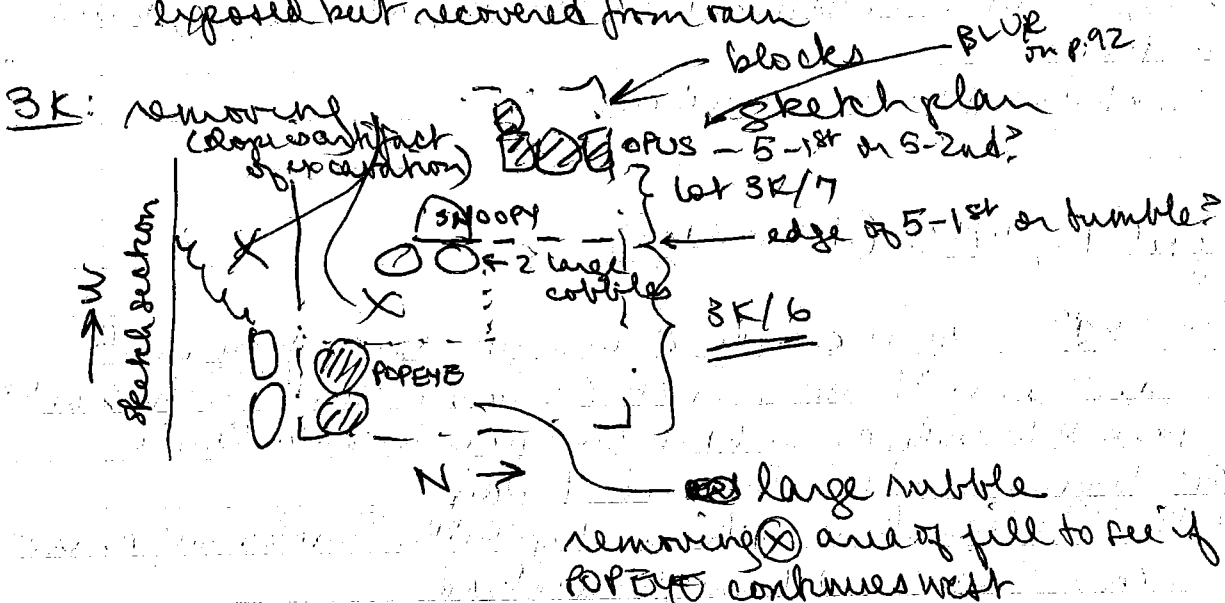

3K/6 still in this lot

3Ø: continuing south & down to find step

3Ø/7 still in this lot

3K: carbon sample

3K/6: 115 cm ~~east~~ west & 60 north from SE corner of excavation
 ca 95 cm below surface along south side of excavation

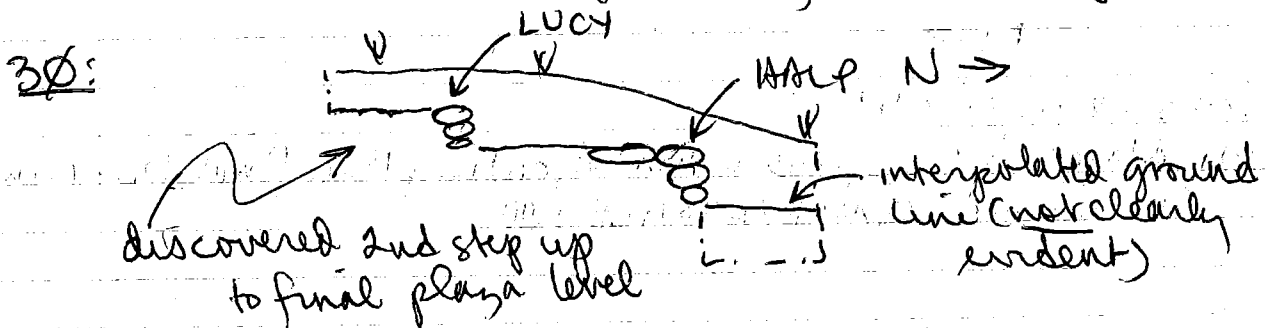

P85-7-94

4/12

worked on sketching in file in 3F/D85-7-5

10⁰⁰ 88⁰

took photos 85-7-M1/2

Op 3N, Folly drawing (east) section

worked on D85-7-3 (Op 3G) - above & N/around level of JAE

took photos 85-7-M3/4

Op 3H, Raigos 10 & 11 with 2 & 3 from North

scale 50cm

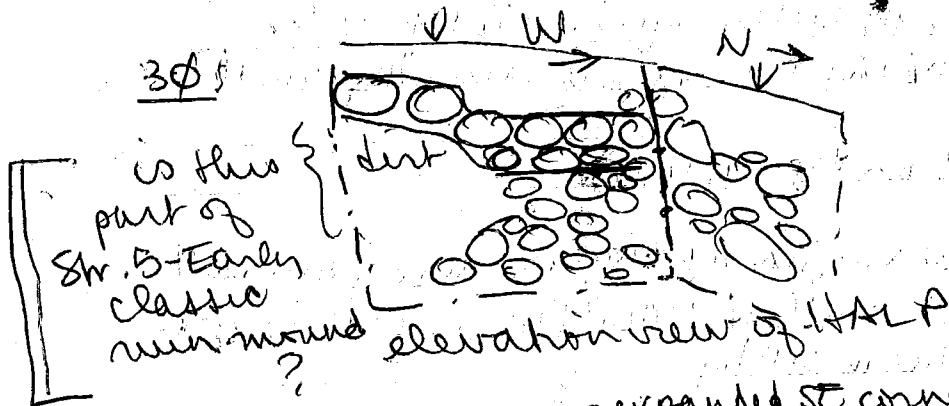

3F
3F/14

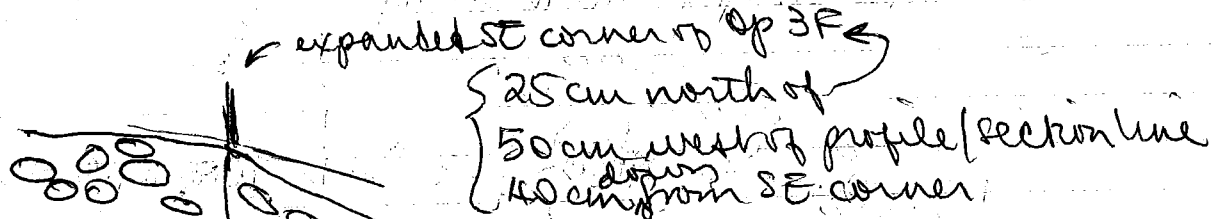

1 pair small spondyliid closed set, somewhat eroded apparently just in fill (loose) or fallen with collapse - uncertain

found at J and X more or less like this

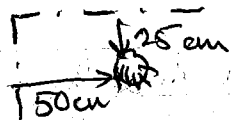

3E
3E/23

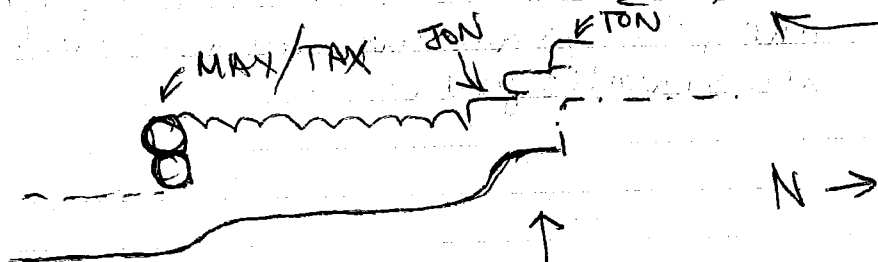

the soft white material of TEND rises to the north - eroded terracing??

P85-7-92
4/12

3K Foncho gave me measurements he took yesterday
(3E/16) on some pieces of bone (small vertebra & long-bone
s/b 3K/7 fragments) from the midden

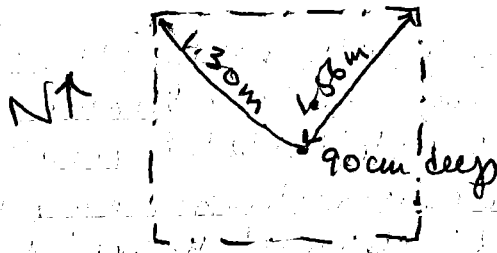

3E in cut in front (S_{side}) of MAX, have hit what looks like redeposited plaster - but at less than 20 cm below MAX/~~base~~ base?!
VERY STRANGE

3K: has hit pair of masonry (!?) wall stones that may mark alignment of east wall

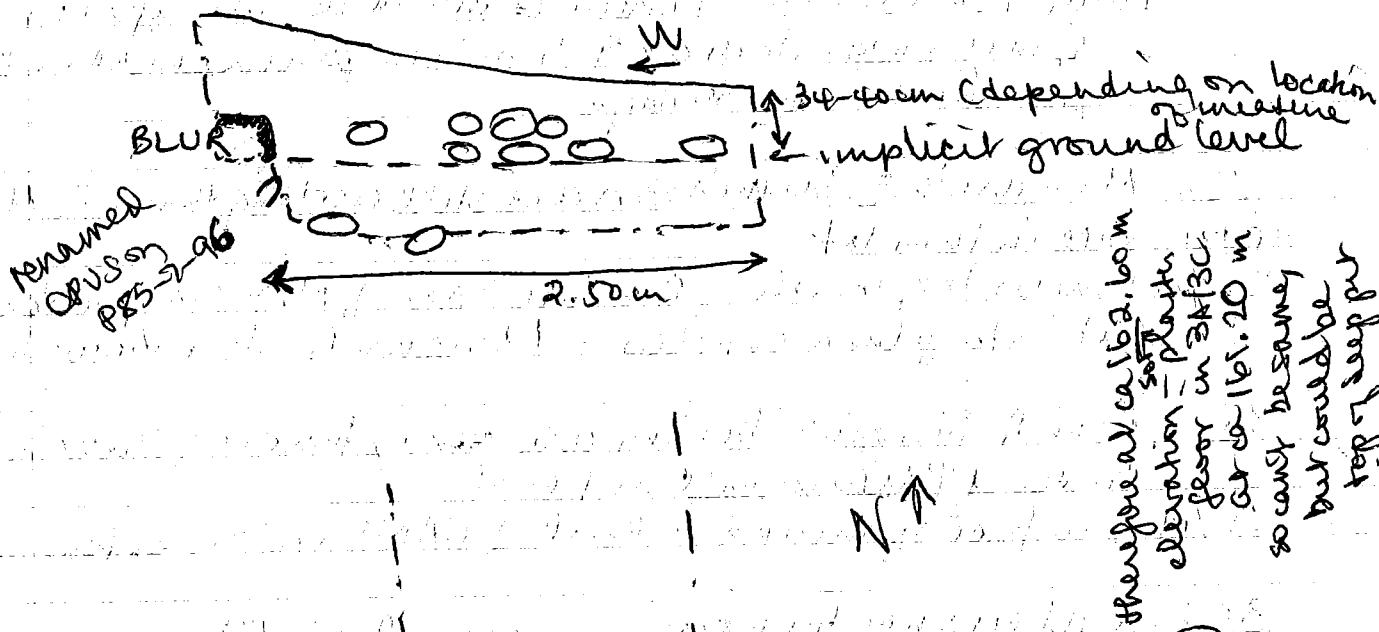

note, this area is approximately axial

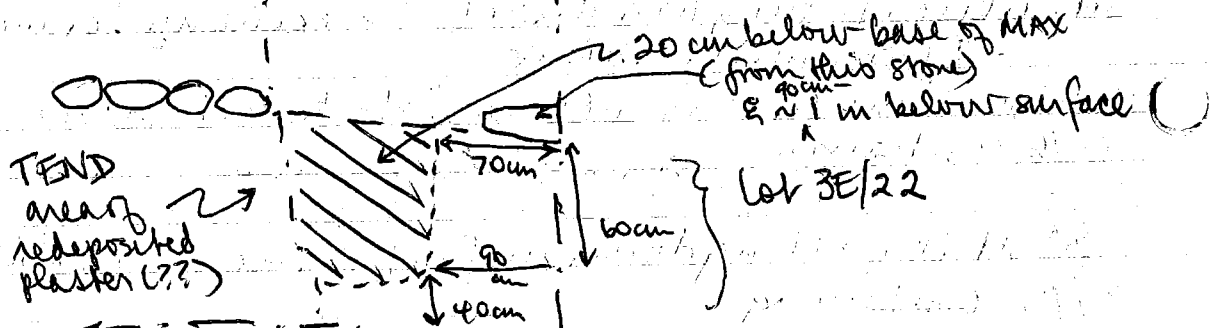

P85-79

4/11

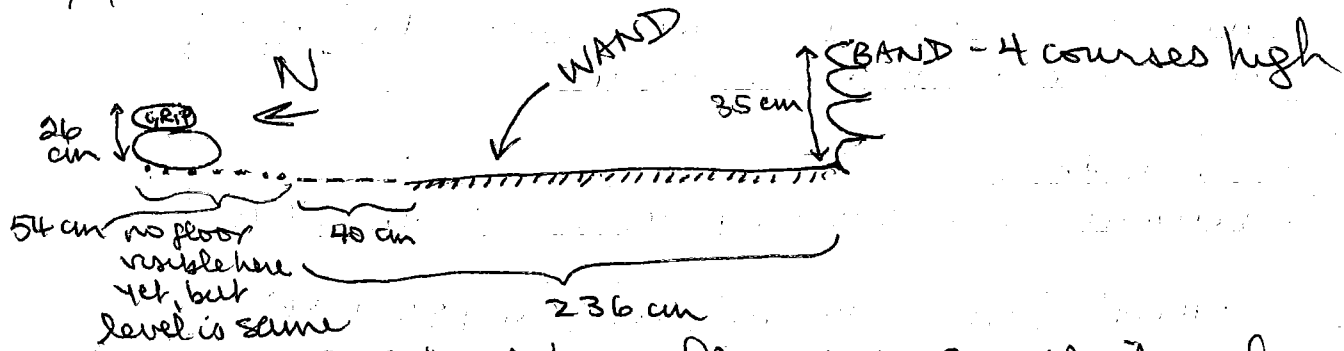

WAND is hard bare floor 1.5-1.9 cm thick - a few stone disturbances but continuous 196 cm south from BAND (to which it does seem to run up) & then can be seen in section 40 cm farther south

took photos 85-7-L11/12

op 3F BAND & WAND from NW, scale 50 cm

3F/5 cutting down from 2nd course down south of HALP to next step/surface
 3F/6 concentration of polychromes in NE corner of original exc area at level of top of HALP (dimensions of concentration vague - probably meaningless contextually, but helps to keep possible joins together)

3F/13 some of this unfortunately is from below

WAND & some from above, but Rene & Sergio say all

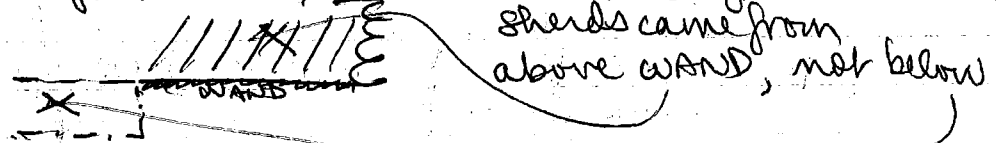

metate fragment on end in fill below WAND, west side of trench - would thus be near axial line of structure but I don't think it's a special deposit & it's broken

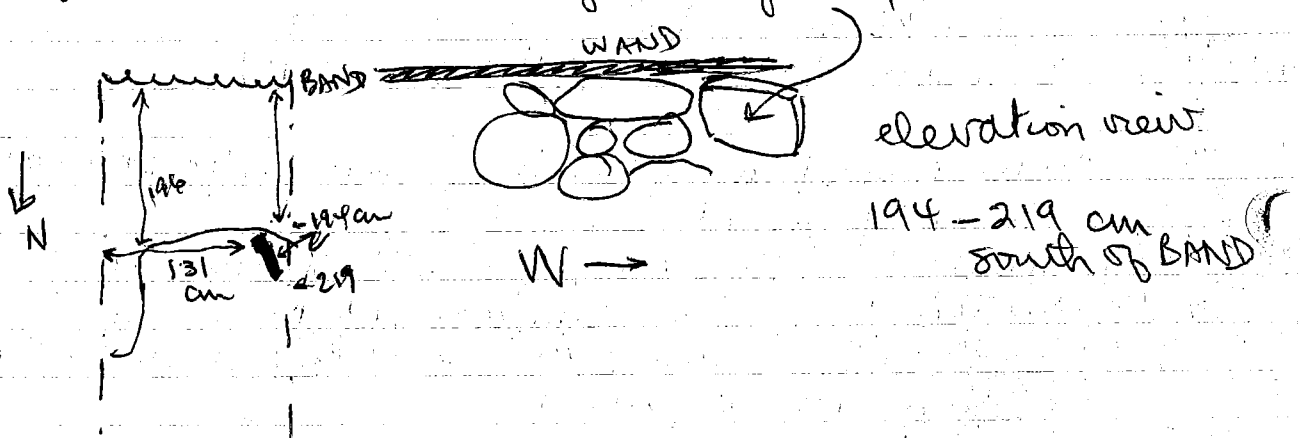

P85-7-88

4/11

at site: Foncho here, Folly ill

3E: cleaning cobbles south of

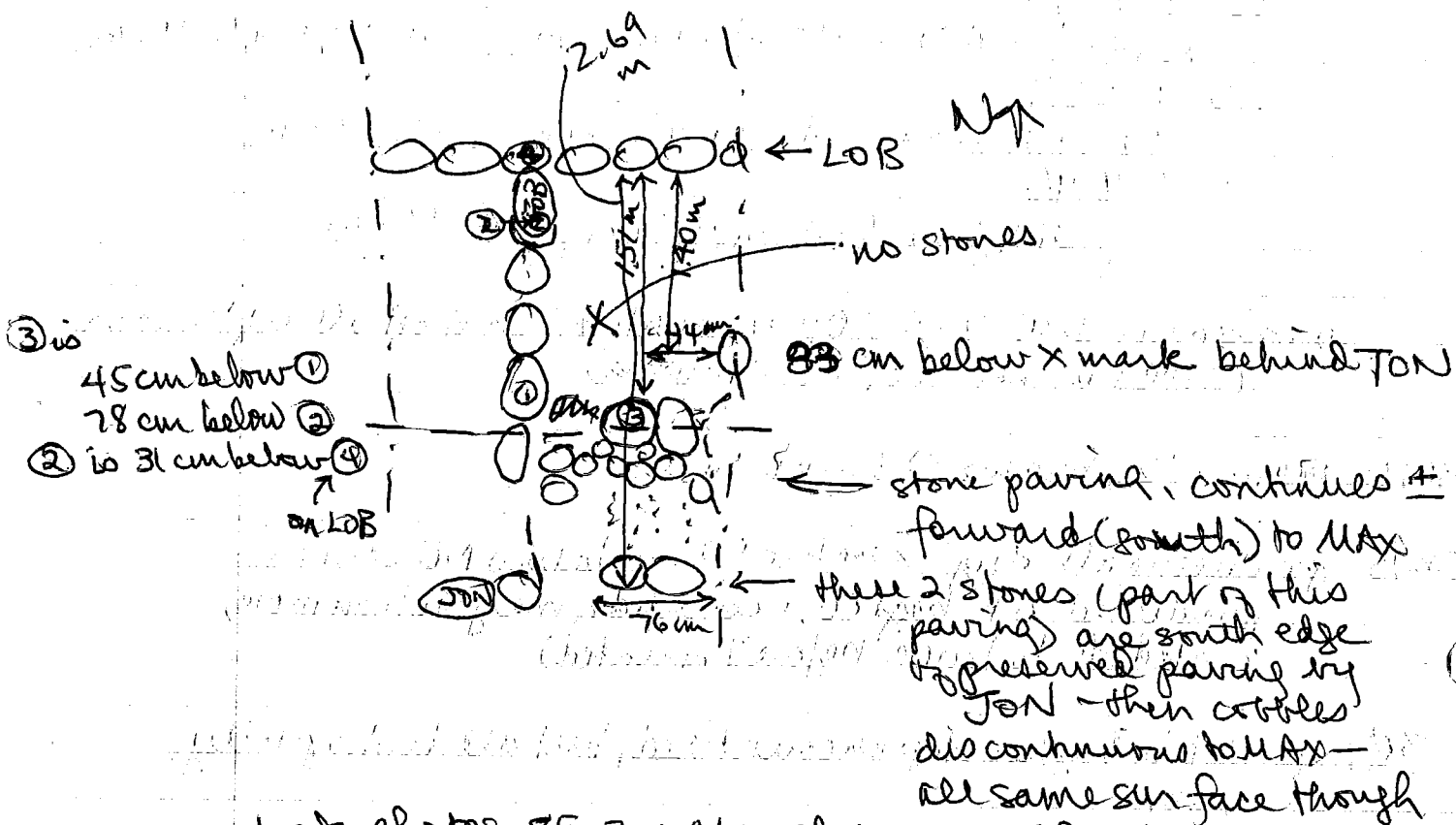

took photos 85-7-L9/10 closeup of LOB wall
scale 50 cm vert, 35 cm horizontal

3E/20 still in this lot - cutting now through the pavement described above - therefore fill of MAX

3F: Sergio & Rene cutting down ^{through} behind GRIP, to level of GARP and south as far as BAND

3G: in the dirt matrix there now appears a long band of stones crossing the trench at an angle, dit continues on north side - cleaning E will measure - covers a special deposit perhaps? wall line perhaps? 274° azimuth

3G/30 still in this lot

3E drew in ^{MOB/} LOB/FOB on D85-7-3

P85-7-86
4/10

took photos 85-7-K7/8
op 3E MOB/LOB/FOB from SSW
scale 50cm

showing problematic relation to JON/TEN/TON

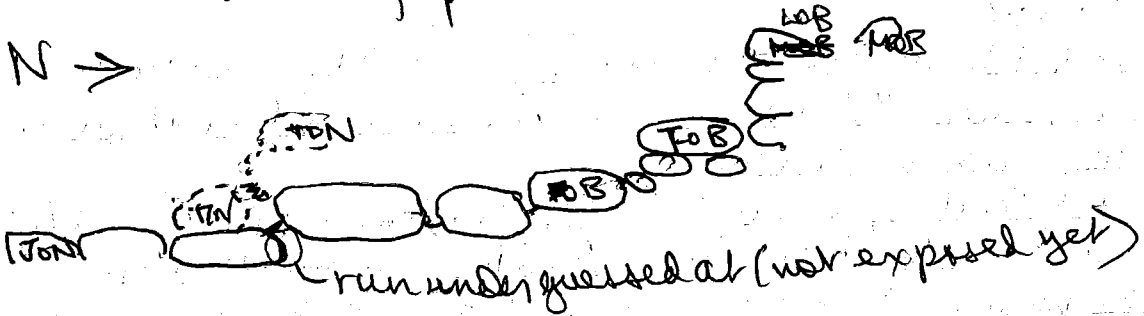

D85-7-6 did quick plan of these (1:20 by mistake
8/6 1:10)

30 continuing
3G finished 29, lot 30 began
3G/29-30 matrix mostly dirt, few stones little or no ash
top sherds in 30 are few but almost all
polychromes

3E removing part of FOB to expose full
vertical area of LOB - seems to continue
down - at least 6 courses reconstructable
in composite

3K creeping thru midden
3G Rene & Sergio moved to lower terrace to
base cut behind PULL

3H: deer scapula (fossa) 63cm N of Rango #2 (X)
3H/8 and 67cm down, 23 cm west of section line

1250 90°

very strong wind about 11:30
and breeze is ceaseless

took photos 85-7-K9/10 LOB/FOB/stones ~~80~~ - closeup
from SE, scale 50cm
85-7-K11/12 from farther south, to include
JON - scale 50cm
both show full vertical extent of LOB

P85-7-84

4/9-

4/10

changed mid morning

3E: René, JJ & Sergio's replacement (having cleared YAY westward & removed loose rocks & fallen earth in 3F plaza end) put to cutting into MAX, to level of current low point of excavation, 2m out from section

3E/20: Shards etc from fill of MAX (ca 85 cm from surface)

Comparison of elevations

	P85-7-75/76 ^{at 7:21 and 8:11}	P85-7-80	Δ
3G NE	160.812 (-6°2')	160.705	(-1.09-.11)
3G High pt	166.326	(rock gone)	
" " " (dug versus P80)	()	166.353	
3E High pt	165.869	165.853	-0.016
3E 3E	163.288 (-4°15')	163.217	-0.071
PD2	165.152	163.145	-2.007
Iron stake	160.000	159.9997	-0.0003
Ballcourt datum	160.324 (-6°2')	160.300 (-5°2')	-0.024

LPD 1 = Backlight datum

all done w/ downslope 7.5

Other

3K-SE cnr	163.356
NE cnr	163.478
Srr 5 SE cnr	163.233
SW cnr	163.229

These are not ball court elevations but presumed then to sit on MAX equivalent surface

MAX: 162.793 to 9.25 (drawing)

April 10, 1985 (Wednesday)

7:50 7:80

no rain, but cool at night cloudy but bright

Folly & Foncho with me, but Folly sent back to return Sylvia's lunch (not removed at lab house because Sylvia'd had to get out & fetch Galera's keys someone else had left in SB - chain reaction)

BUT TODAY MUST BE BETTER THAN MON/TUES

- 3E Margarito & Jaime's son clearing MOB/FOB/LOB still
- 3E/19 still in this lot
- René & Sergio still cutting through MAX to JON
- 3E/20 still in this lot - FEW Shards

P85-7-82

4/9

3φ: Lupe & Teracino
reached a "level" 102 cm below SE corner
51 cm below NW corner
(the 2 layers were at [tops at] about this level)
no features apparent, so cutting more

3φβ: shere etc from this level of fill
contextually continuous with 3φ/2 but
less fear of downward filtration/contamination

3A: 14.25m N/S. taped
13.45m NE corner to SE corner 3N

transit work - Folly on rod (as this morning) bad wind
HI 1.865

Dist & even	T on str 10	+BS	-FS	Elev	Distance	Distance checked	Δ
1.	BS to iron stake	3.190		163.190 342.2 295.8	46.4	30.15'	
2.	to PD 3		2.876	160.314 308.8 266.4	42.4	184°55'	
3.	NE corner 3N		2.976	160.214	323.0 272.0	51.0	181°05'
4.	NW corner 3N		2.962	160.226	322.2 271.2	51.0	183°30'
5.	SE corner 3N		2.988	160.202	325.2 272.0	53.2	181°05'
6.	SW corner 3N		2.979	160.211	324.7 271.2	53.5	183°20'
7.	3A NE corner		2.750	160.44	307.8 242.1	65.7	181°30'
8.	base at NE cor		3.688	159.502	401.7 326.0	65.7	181°31'
9.	NW corner		2.672	160.518	300.3 233.9	66.4	183°07'
10.	Rasgo 1-NE		2.630	160.500	297.2 229.0	68.2	180°50'
11.	Rasgo 1-NW		2.715	160.475	305.9 237.1	68.7	181°40'
12.	Rasgo 1-SW		2.409	160.783	275.6 207.6	70.0	181°20'
13.	Rasgo 2-NE		2.195	160.995	264.2 194.2	70.0	180°20'
14.	NW		2.202	160.988	255.8 185.0	70.8	181°50'
15.	Rasgo 2-SW		2.015	161.175	237.0 166.0	71.0	181°45'
16.	SE		1.953	161.237	230.8 159.8	71.0	180°14'
17.	Rasgo 3-E		1.742	161.448	210.2 138.0	72.2	180°2'
18.	-W		1.696	161.494	205.0 133.2	72.8	181°18'
19.	Rasgo 4-W		1.45(8)	161.732	183.0 109.4	73.6	181°18'
20.	5- SW		1.598	161.642	141.8 113.8	73.4	181°-
21.	Rasgo 5-SW		1.203	161.987	157.2 93.8	73.4	181°10'
22.	-NE		1.245	161.895	166.0 93.0	73.0	179°21'
23.	-SE		1.111	162.079	147.9 92.2	73.7	179°45'

P85-7-80

4/9

3F: René, JJ & Sergio removing loose dirt & stones in base

3G: Moreno (JE) & J Victor still removing earth cap over floor frags
3G/28 continuing from yesterday

3A: in abeyance in favor of 3N

3N: taking a flotation sample - see Foncho's notes

3φ: still cutting down - no coherent construction visible, just cobbles in disarray

transit work, with black transit (have been using white one) to cross-check problematic elevations

used uncorrected distances in slope sheets

Vert #	T (K _X = 1.435)	+BS	-FS	Elev	Distance	Angle
	set up again over PD 3					
-2°15'	1. BS to Iron Stake	4.224	4.224	159.9975	455.0	9°40'
even	2. PD 1 (163.430) (cutting)	3.349	166.779	389.9	65.2	78°02'
"	3. PD 2 (163.145) (-7 mm)	3.641	163.138	351.7	33.7	106°55'
-2°45'	4. NE corner 3G	4.313	160.705	318.0	27.2	23°10'
even	5. Summit 3G	0.426	166.353	449.8	36.7	52°15'
"	6. Summit 3E (rock)	0.926	165.853	413.1	25.5	63°14'
"	7. SE corner 3E	3.582	163.211	058.3	23.3	87°40'
	8. Ballcourt datum	4.298		104.3		
even	9. SE corner 3F	0.388	166.391	051.0	42.0	145°05'
+5°12'	10. Ballcourt datum (mushy ground...)	4.325	160.299	017.8	23.7	223°30'

845 84° still a good many clouds

3G levelled out & travelling - no further floor frags yet ash in only one small patch

3φ: piece of adobe w/ pole in stone impression in lot 3φ2 overlying large lajas in middle of exc

removing/levelling remaining high points of exc (NW & Southern portions) - perhaps more lajas?

sketch plan 3G summit

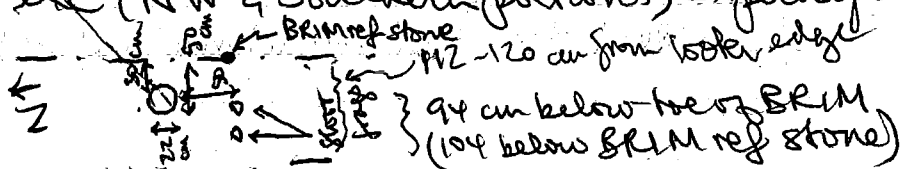

P85-7-78
4/8

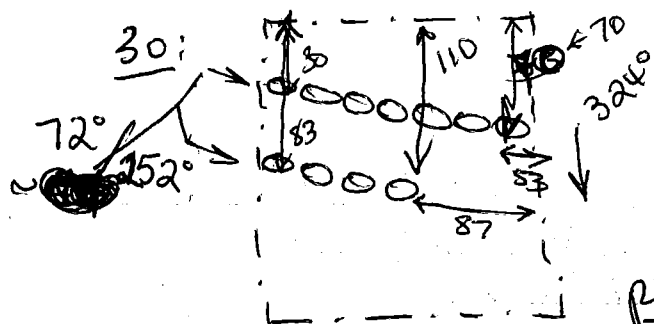

sketch plan

NOT TO SCALE!

possible step lines - will photograph but verify at best

3N: getting a layer of small stone (6-10 cm across) down ca 20-30 cm

3G: removed VIM removing fill in southernmost unit - by lunch seem to be reaching top of ashy stratum (slopes up greatly here)

~~X~~ 3I: backfilled

3E Rene & Jose Jorge put here with huzite, to straighten section face

Fabian is not here today - Ulises has evidently opted to take his day off this Friday (he & Rufino's son worked last Monday so are "owed" day off each; Rufino's son + Margarito + Sergio (who both worked Fri 3/29 when the others had off) are all taking their day off today) - therefore should be 9 men but there are 8 because of Fabian - would be all right but for imbalance on tools (lack of a pick for the 3E pair)

30 took photos 85-7-K3/4

view from NW, scale 50cm

showing putative alignments sketched above

39:

39/28

39/29

4/1 exc limits at top, to 84 cm below BRM ref (2.90 m N/S)

starting at 84 cm below BRM ref (3.40 m N/S)

ash may begin as high as 109 cm from surface at BRM ref

39/28 includes 2 pcs of floor (?) - above

sketch
up

P85-7-76

3/29

all distances checked 3/29/85

	<u>BS</u>	<u>FS</u>	<u>elev.</u>	<u>distance</u>	<u>Δ</u>	<u>vert.</u>
35. pavement east of 50W	2.218	162.944	2.332	22.8	77° 38'	-4° 15'
36. MAX (east end)	2.295	162.793	2.103	22.4	84° 10'	-4° 15'
37. MAX (middle)	2.355	162.925	2.418	23.8	84° 10'	-4° 15'
38. MAX (west)	2.552	162.876	2.179	22.4	84° 14'	-4° 15'
39. SW corner 3E	2.150	163.255	2.462	21.24	84° 30'	-4° 15'
40. S.E. corner 3E	1.867	163.258	2.249	21.3	84° 30'	-4° 15'
41. JON West end	2.298	163.130	2.649	19.247	81° 43'	-4° 15'
42. TIN West	2.009	163.456	2.456	19.247	87° 40'	-4° 15'
43. RUN	1.858	163.621	2.247	19.844	87° 40'	-4° 15'
44. SW corner str. 5	2.635	163.229	2.051	19.4	76° 35'	-4° 15'
45. N end West wall	2.518	163.322	1.983	23.35	75° 8'	-4° 15'
46. SE corner 3K	1.341	163.356	1.749	21.247	73° 40'	-4° 15'
47. NE corner 3K	1.450	163.578	2.202	21.3	68° 30'	-4° 15'
48. NW corner	1.808	163.248	2.102	18.748	64° 7'	-4° 15'
49. Reconstructed SE corner	1.878	163.233	1.914	18.8	78° 18'	-4°
50. Point W of SE corner on wall	1.900	163.309	1.951	18.549	73° 15'	-3° 30'
51. NE corner OP 3F	1.788	163.165	1.765	18.1	73° 5'	-3° 30'
52. NW " " "	1.970	163.147	2.702	18.363	76° 58'	-3° 30'
53. SW corner of big pit 3F	1.654	163.289	2.587	13.662	77° 30'	same
54. YAY wall at section	2.010	162.802	2.460	13.7	77° 30'	(
55. RUG remnant	1.432	163.306	1.498	30.924	134° 8'	-3° 30'
56. Slope above RUG	0.938	163.769	1.608	31.541	139° 42'	-3° 30'
57. PLUG	0.871	163.775	1.292	29.445	142° 34'	-3° 30'
58. GARP	2.388	164.466	1.954	29.5	137° 30'	-3° 32'
59. Slope above GARP	1.965	164.889	2.020	28.547	138° 50'	-3° 32'
60. GRIP	1.665	165.189	2.036	26.950	138° 30'	-3° 32'
61. Stone Line	1.500	165.354	1.766	27.0	139° 48'	-3° 32'
62. SE corner of excavation	0.440	166.414	1.945	31.142	141° 08'	EVEN
63. Op 3L (NE)	1.412	165.442	1.633	31.2	140° 45'	EVEN
64. Op 3L (SE)	1.428	165.426	2.013	31.7	143° 11'	EVEN
65. Op 3L (SW)	1.666	166.380	1.828	28.147	145° 0'	"
66. Op 3L (NW)	2.000	166.595	1.812	31.341	145° 0'	"

↑ a.m.
↓ p.m.

Dist

2.38 top
2.24 top

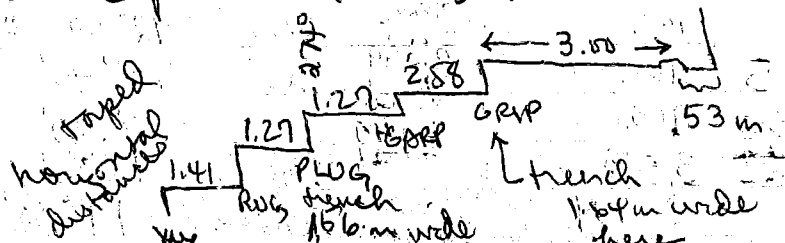

P85-7-74

3/24

March 29, 1985 (Friday)

Foncho w/ Julie to map a site on W side of Uluu at
Jusulela (he's there to investigate stones of looting)

Folly, Valerie & I replotting excavation transit points
(see P85-7-75/76) (#1-45 in a.m.; 46-66 in p.m.)

all workmen except Margarito & Sergio excused for the day

8⁰⁰ 87° E no clouds to speak of

10⁰⁰ 87° E partly cloudy/light breeze so feels cooler

plotted 3E, 3G, 3J, 3M at end of morning
3K, 3F at 3⁰⁰

3³⁰ 97°

April 1, 1985 (Monday)

9⁰⁵ 84° E muggy

Reported in to see if Ulises & Rufino were there

- Ulises & J Victor were

then returned home for breakfast (a relaxed
schedule this week, for Semana Santa - just

Ed, Pat, Sylvia, Beleka & me) and to do errands

- including buying more epoxy so Pat could finish
fixing the toilet tank

10-3 drew uppermost sectors of Op 39

3/29/85
3/30/85
30/1

April 2-7 (Tuesday - Sunday)
Semana Santa - feriados

Pat left for U.S. on 4/4 for 5 weeks