

1984

## PSB-015-Alec Harris-Field Notes-1984

Alec Harris

Follow this and additional works at: <https://digital.kenyon.edu/honduras>



Part of the Archaeological Anthropology Commons

---

### Recommended Citation

Harris, Alec, "PSB-015-Alec Harris-Field Notes-1984" (1984). *Four Valleys Archive*. Paper 92903.  
<https://digital.kenyon.edu/honduras/92903>

This Field Notes is brought to you for free and open access by the Anthropology at Digital Kenyon: Research, Scholarship, and Creative Exchange. It has been accepted for inclusion in Four Valleys Archive by an authorized administrator of Digital Kenyon: Research, Scholarship, and Creative Exchange. For more information, please contact [noltj@kenyon.edu](mailto:noltj@kenyon.edu).

Searching for structure + shards for writing

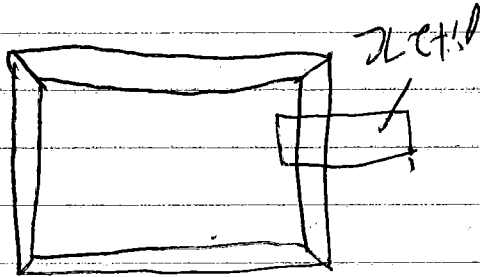

pg 151

6/5/64

We began digging this pit with a 1x1m square in the westernmost portion. After 40cm and 4 lots, a bedrock - we think - layer was hit. So we began extending the pit eastward, toward the wall. Due to a misunderstanding of the instructions, the workers removed several rocks on the way to the west wall. We were forced then to expand the pit to the north and see what it was that the workers removed.

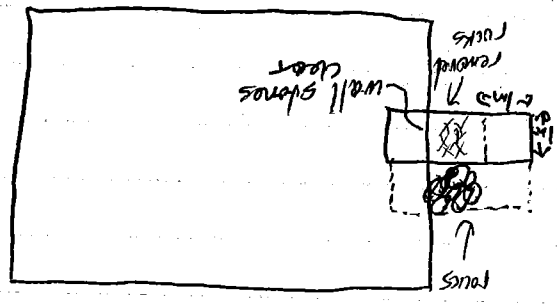

Most of the rocks, it seems, fell from the top of the structure and were not part of the wall itself. They are on angles and without order. In general, there have been scores (so far 7 shards and 27 jets). It might therefore be difficult for us to date the mound. If little more is found today, we may abandon this site and head for more fertile ground. We are trying to excavate into the wall, so that we can hit it head-on. Otherwise, we may not know for sure if we did run into a wall.

Arifacts from this pit, and the mound in general have been scores (so far 7 shards and 27 jets). It might therefore be difficult for us to date the mound. If little more is found today, we may abandon this site and head for more fertile ground. We are trying to excavate into the wall, so that we can hit it head-on. Otherwise, we may not know for sure if we did run into a wall.

Still no artifacts found here.

This pit also first began as a

1x1m square and expanded northward

into the mound.

40cm and 4 lots down, still no artifacts

were discovered. Decided to expand

the trench northward, and continuing

the 40cm. Depth in spite of

130cm. After 2 of these lots and

digging 8cm into the hill, still nothing

was found. Pat decided then to

plunge off the roof of the square in

20cm deep lots. After the first 20cm,

rais were discovered similar to those in

27C (dipped rocks). The pit is being expanded northward in

lots.

Part of what may be the wall is uncovered. To make sure that

we can get underneath the wall part of pit (western side) was

fallen down to the 40cm level.

### Soil Sampling

We are testing the soil for phosphorus content. Higher

than normal content could reflect human occupation. If

base sample was taken in 10m intervals in the field, beginning

2.75m from the southern fence and ending about

18m from the mound. The soil core at here will be

compared w/ information from other zones.

There are several other zones:

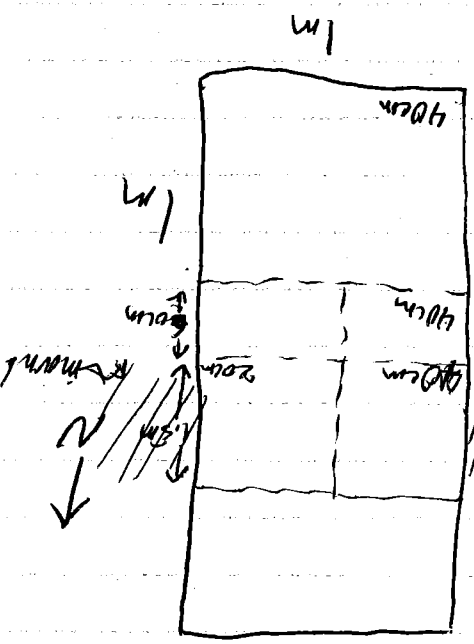

6/6

Soil sampling, cont

Jill and Alex took several other samples from the back of the mound. If one area shows a high phosphorus concentration, we will excavate it. The rear side of the mound was divided into 4 equal 5m regions, designated W, U, G, and E. Four sample cores were taken from each sample area. The easternmost was the only exception, with six cores.

Structure 7

laid in 1x1m pit off of N-S wall (westernmost) To be excavated while we map the walls.

A Little Lot (very little (a lot of little) information)

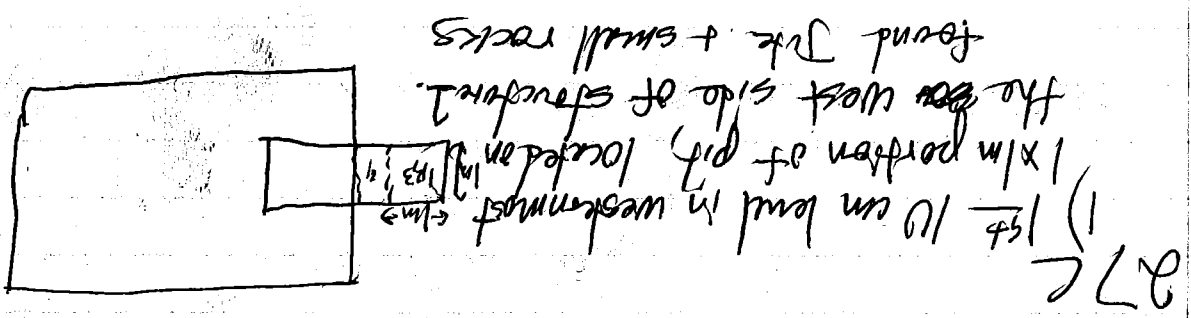

2) 10-20cm level below top 1x1m<sup>2</sup> tiles, small rocks, 2 potshards

3) 20-30cm level below top 1x1m<sup>2</sup> potshard, 2 tiles.

4) Earth above broken rock level (~20cm deep) and begins in from westernmost base and runs to probable wall of the mound.

Lots of lots (cont.)

27c

5) 11m N-S x 5m E-W extension of the pit to the north. Earth above and among tumbled rocks. Earth left cleared from an area of 1m N-S x 2m E-W. Sheds/wall/doors

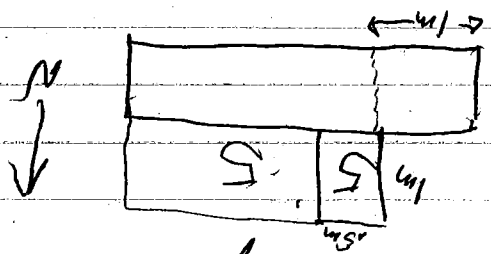

6) In Northern 1m N-S by 2m E-W extension, from earth below the tumble and west of the probable wall.

27B

1) 1st 10cm level in the southernmost 1x1m portion of the pit, located on the south side of structure 1. Empty.

2) 10-20cm below surface in the southernmost 1x1m portion of this pit, located on the south side of structure 1. Empty.

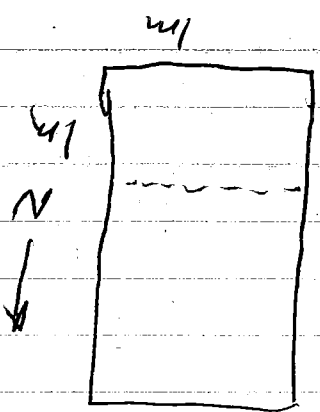

3) ditto, 20-30cm down. Empty

4) ditto, 30-40cm down. Empty

5) From ground surface to 45cm below ground surface. Begins 1.2m north of pit's south edge. Extends 1.4m north. Empty.

6/6/54

Lots of lots

27B

6) 1.4m north of pit's south edge. Extends to 4m. Beginning depth is 20cm but due to slope of mound depth at northern edge is 45-50cm. Shards not found in earth overburden, but from amongst stones cut at base of excavation.

7) Begins 1.4m and extends to 2.65m north of southernmost portion of pit. Width is 50cm excavated only. Depth is —

More on Structure 7

Pit 27D was laid just off the west wall of the structure. Excavated so far in 3 levels. 1st: 0-20cm. 2nd: 21-30cm. 3rd: 31-40cm. The sides of the walls were aligned with a bronze compass.

6/7 Out side

6/5

Still not finished

31E - 10-20m in base, big bank of earth  
 + also many shreds of things (not found)  
 + also many shreds of things (not found)

31D Maximal # shreds 1st level

31C come down on top of rocks. Tumbler or wall?

31B lot 1 - 10m x 1m lot of shreds. Dirt block

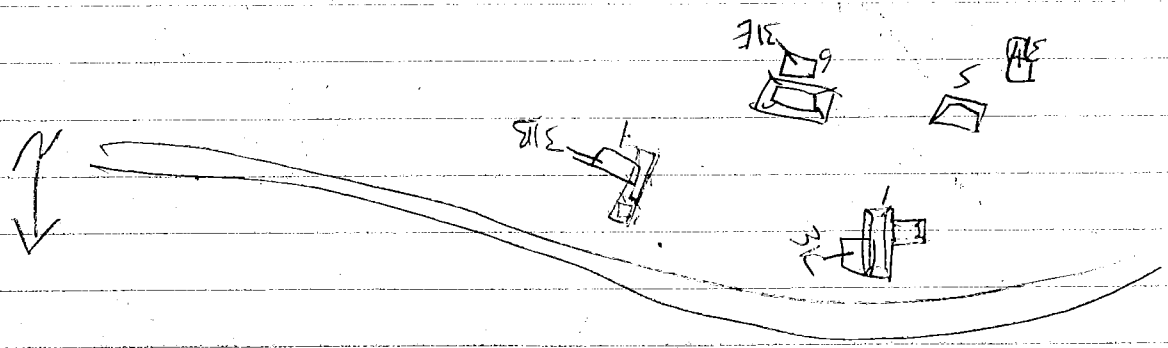

each will be excavated in 10m levels initially

31B+C - fast architecture  
 31D+E - for garbage

Open four pits

6/11 site 31

pg 157



6/12/84

21B - pit extended in north.

lots will contain stones, stands above stones

31C - Excavation terminated when no clear "base" wall discovered.

Workers moved to other side of mound in search of another wall - to pit 31F

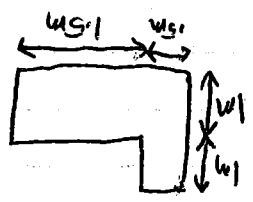

Discover we are working on private property workers tell us.

Decision discovered pit 31D  
It is a nice cool day.

Decide to move from site. Closed up holes, took maps from each end and photographs from Day 15-1 - hole 31C south wall Day 15-1 - hole 31B south wall

Moved to site that was cleared earlier by the four men. Will begin from base of oak

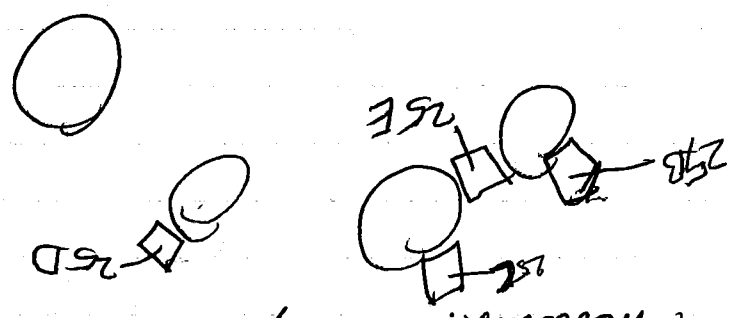

No map available, so lettered each of them

6/12/84

Sawyers

Distinct soil differentiation surface between mounds

Pit D Rocky, brown

S dark brown, smaller rocks

B Block, smooth

25 D - expanding pit in south because it is not

revealing anything

Most material is in pit B.

25 B - stopped excavation after 40cm. Nothing found. Nothing found in final lot.

25 C - stopped excavation after 30cm.

2 new pits opened. - 25P + 25Q

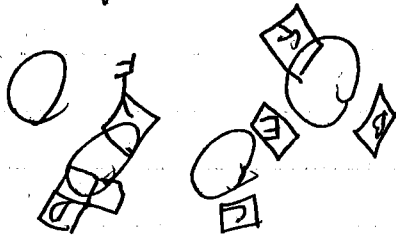

Rat were primarily to find garbage E, D, F, etc - to find structure

E found a cobblestone path between the mounds

All four pits probed smoothly  
 25 F expanded in <sup>4</sup> towards west  
 25 G

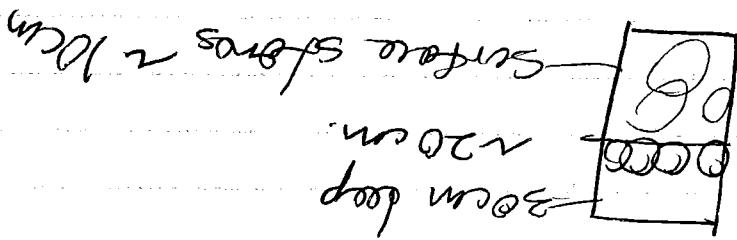

25 E possible upwardly / trace found between  
 the ends.

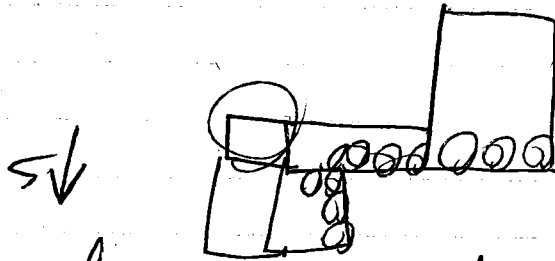

6/13/84  
 25 D Wall exposed, following ground corner

For specific lot info at site 25,  
see notes of 10/15.

Structure information

- ①
- ②
- ③
- ④

Several pits expanded.

25D Wall in found. Following wall, still

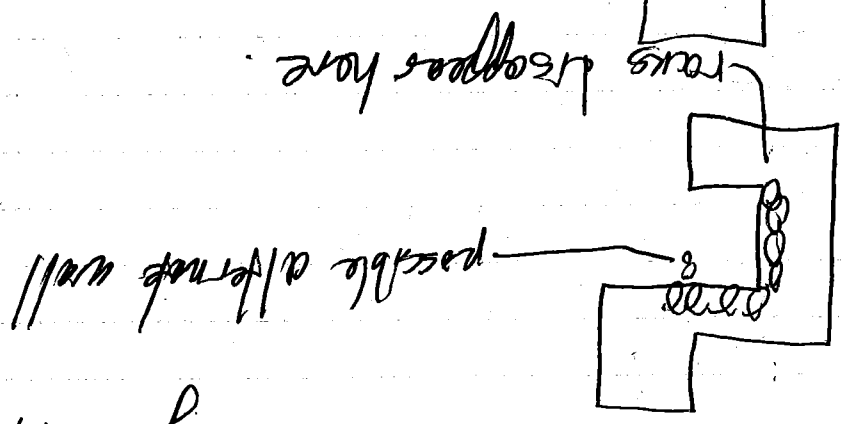

25E

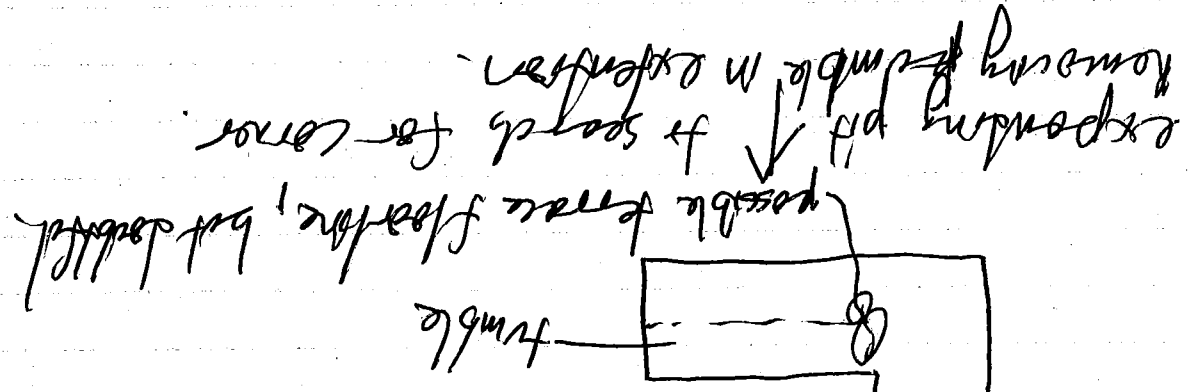

25F  
 Still searching for pass. Sth structure will keep expanding in search of wall the

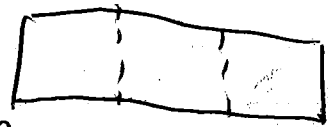

6/15/94

255 Expanding pit on search of wall line or structure corner. Should eventually go on 25E.

A good # of shads found at this pit

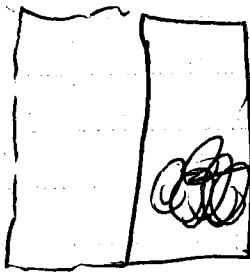

tumble

25F - lot of clay face found  
17cm E, 22cm S + 30cm down from West

Opposite pit continues to produce as marks W.

25D - The disappearing wall def.

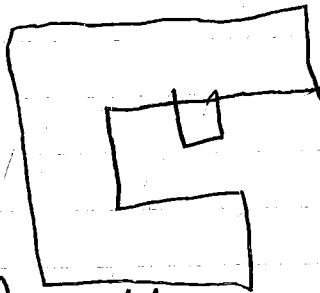

Site 300 Group B

road

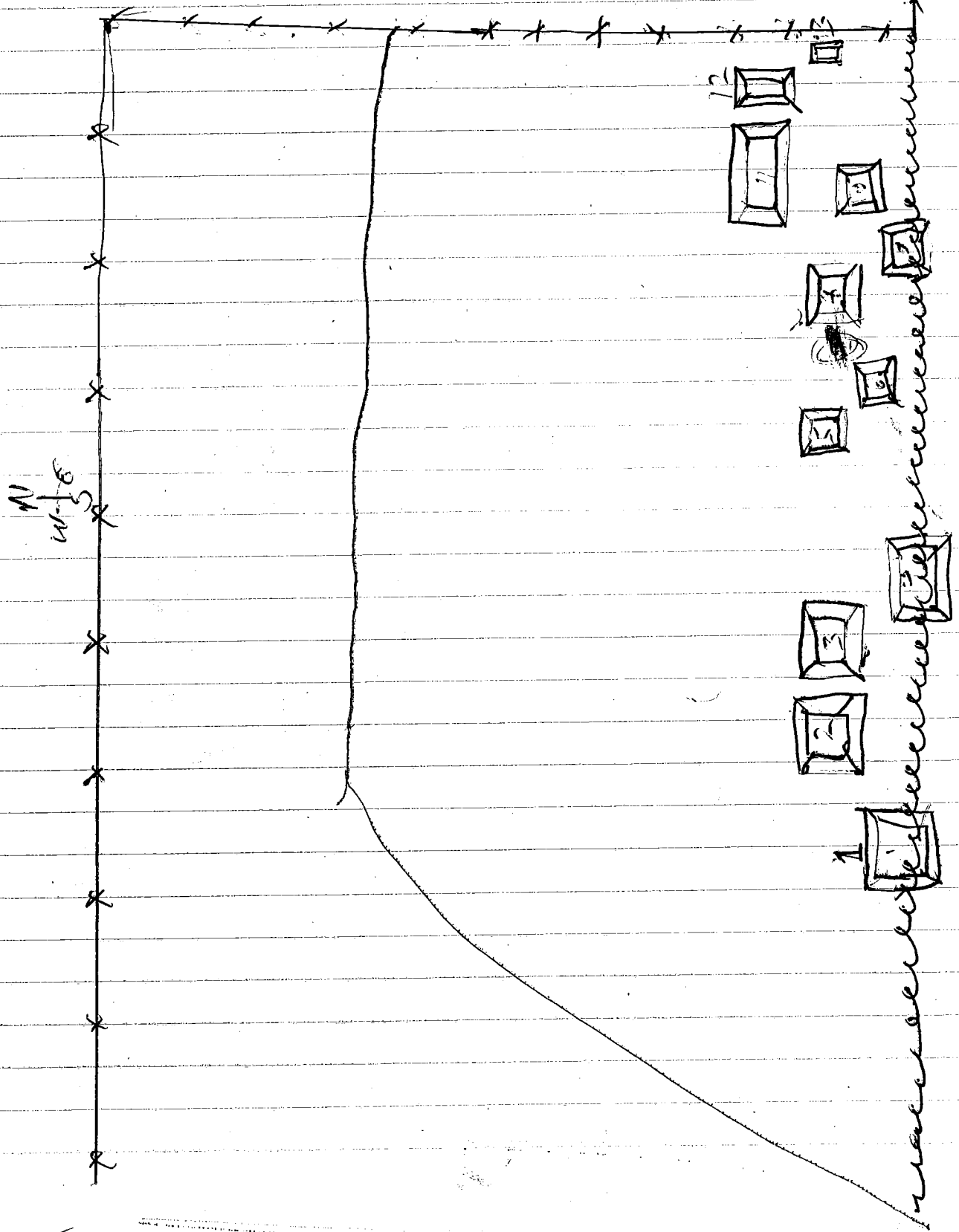

pg 15/13

Sketch map site 320

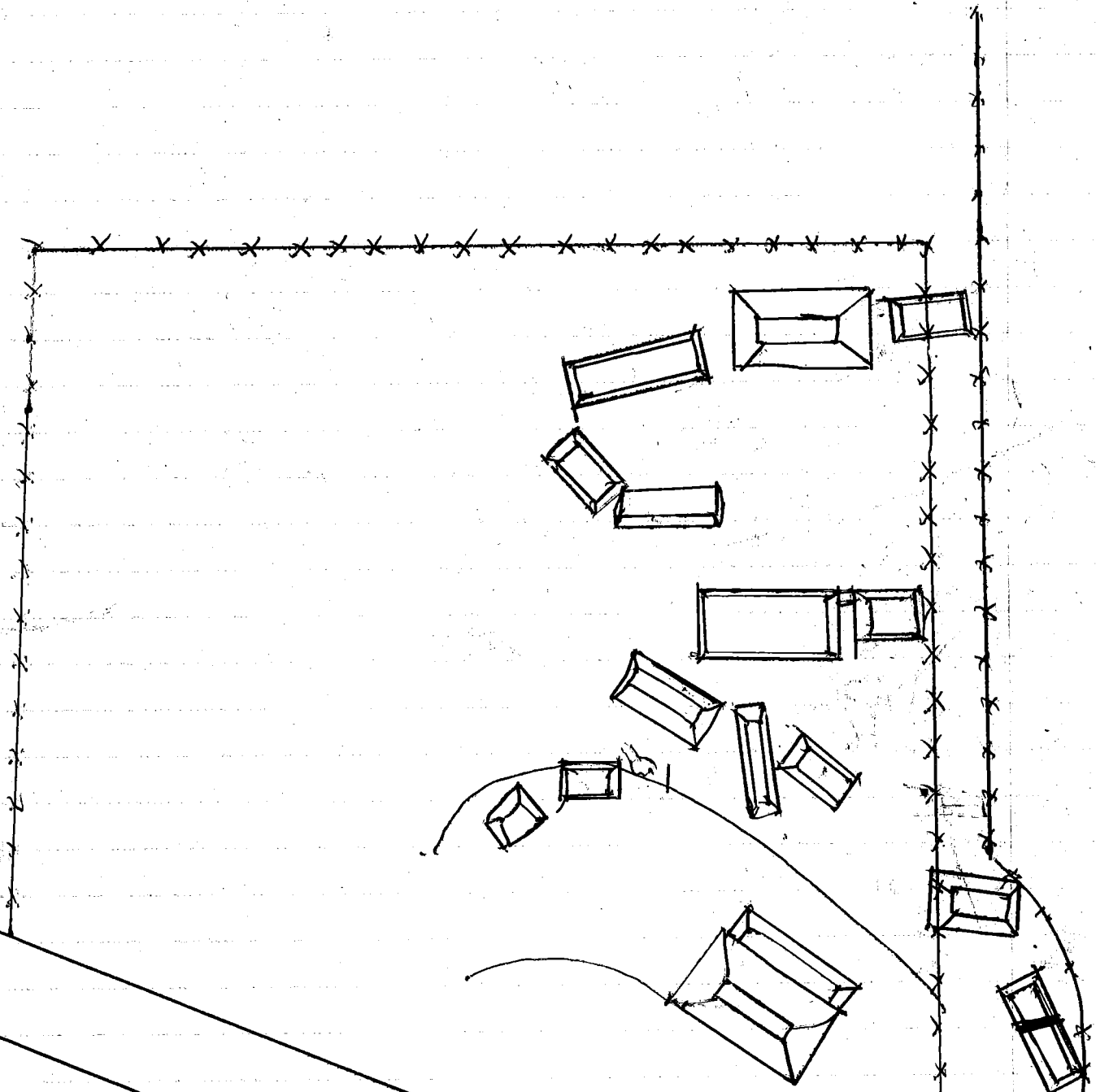

Mire over left

884-15-13/2

6/25/89

Today we began a new sub site in site #25. Two pits have been opened - 25H + 25I - around what appears to be a post classic structure (#).

We are one man short, so there are three workers up here. Julie + Pat have gone down to another site to start it up, + Pat should be making periodic excursions up here.

Right now we are one shovel short, so there are three working on 25H, which is silly, so after a shelter is built, I am going to send one down for another shovel. If I can get that access taken.

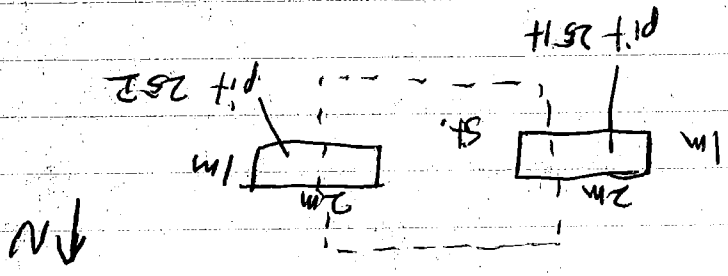

Found what could be a well line or fence just off of structure in 25H. pit in 25H empty. 25H is finding things - nice obsidian core, among other things. Out of bag cords, so using homemade tags. Looks like today is going to be a scorcher.



Finding lots of pits and other items in 2nd lot 25H. Maybe not post-classic as for all?

Soil color dark, very moist. Lots of roots near top. Slightly clay-like. Remnant of other ~~stratification~~ midden levels found at site 25.

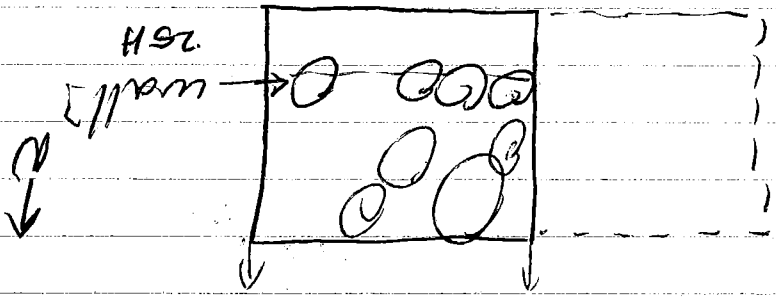

suspect possible midden to south side of rocks. Line is solid + continuous. Terrace or wall?

Possible cut stone found on surface of 25H. Double-check proposed pit later.

Lot 3 sees a marked soil color shift, much like that of other pits in site 25. ~~marked~~ Soil forms a clay-red color, becomes sandier and is spher.

Lot 4 - expanded in west instead of in N to follow possible wall/terrace line. Wall appears to continue

found around Litcher stone. From NW corner (elevation) 19-32 cm south and 7-16 cm east. ~~cut~~ beyond end faces south.

~~25H~~

25H // 1st 10 cm level in a 1x1 m pit on south side of str. — EMPTY LOT

2/ 10-20 cm below ground surface in 1x1 m pit to south of str. — Above rocks. Obsidian, chert shards, jute

3/ 20-30 cm below ground surface in 1x1 m pit to south of str. —

4/ Expanded in west. 0-10 cm below c.s.

5/ 10-20 cm below c.s. in west extent.

6/ 0-10 cm level below g.s. in 1x1 m pit extending west of 1st west extension.

25J //

1/ 1st 10 cm level in a 1x1 m pit to north of structure. Jute shards. Depth measured from north extension

2/ 10-20 cm below ground surface in 1x1 m pit north of structure. Jute shards. Depth measured from NW corner

3/ 0-10 cm below ground surface in extension in south of pit original pit.

Photo taken of Vanderbuilt wall, looking north  
 turned 2 exposures - 8416A picture 3 + picture  
 wall photo taken at 8416A photos 4 & 6.

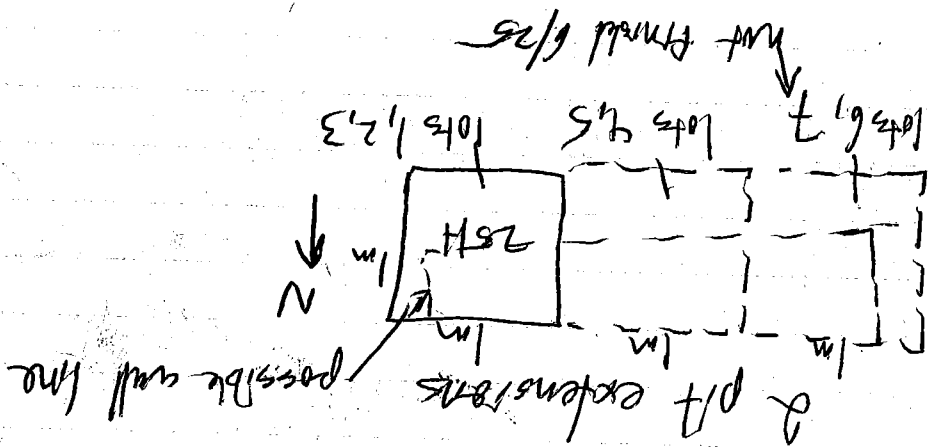
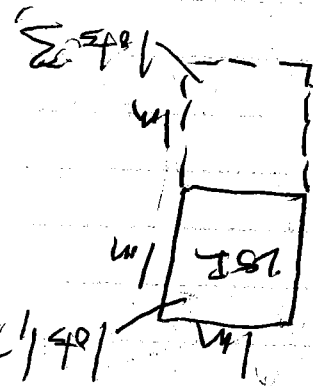

Bossalt the most likely used w/ material  
 stone for ground underneath if in lot 25H-S  
 EH together, structure is 23 cm long and  
 has a 9.5 cm diameter. Wow!

6/26/84

No rain last night pits still clean  
 25H - Finishing up lot 25HT  
 25I - cleaning off rocks.  
 - until Ed comes (pat's sick) + can advise  
 further on excavations -

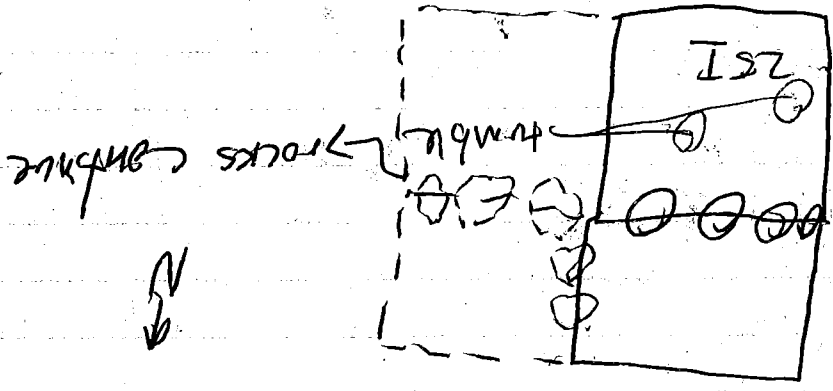

Finishing up lot in east excavation. - 25HT

0-10cm below g.f. + lot 9 (10-20cm) N

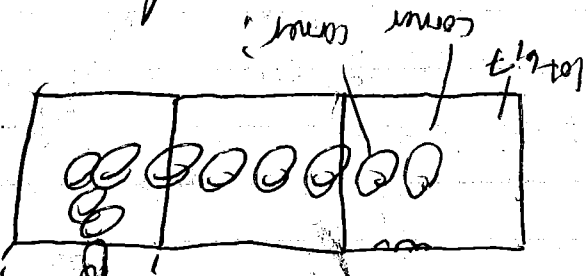

Some men removed small rocks around west corner, unfortunately decided to leave and expand pit in ~~the~~ North from original square

Looks like another scinder.

Not finding much in either 25HT or I

Expected 25I to have 20m square. Original pit is too rocky to make any sense of it yet.

A little bit info.

25A

1/7 10-20 cm level below G.S. in 1x1m pit  
extension west of 1st extension

1/8 0-10 cm level below G.S. in 1x1m pit  
in extension north of original 1x1m pit.

1/9 10-20 cm level below G.S. in 1x1m pit on  
extension north of original 1x1m pit.

25B

1/4 10-20 cm below ground surface from SW corner  
in 1x1m pit extension of original pit

1/5 0-10 cm below ground surface in 1x1m west  
of pit from southern extension. 1 shield found

1/6 0-10 cm below ground surface in 1x1m west  
extension of pit from original pit. EMPTY LID

1/7 three under rocks in northern half of pit to  
1 cm below ground surface.

1/8 10 cm below rocks in northern half of pit.

Finishing of group. Ed. of Vandenberg and K  
Section to be done later of Jordache + Blas +  
in 25I

25F Found what could be a cell on wall.

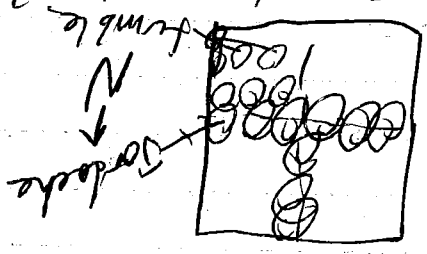

lot 7 - clear tumble check for ~~star~~ good.  
lot 8 - 10cm under tumble

Possible additional wall or stone in top of  
in SE corner of pit. 2 stones long

Moved to new structures across a dry stream  
structures on top of hill overlooking gulches  
and several mounds across the area

Single mound is near electrical post.  
Two pits - 25F + K  
1st had workers at  
morning

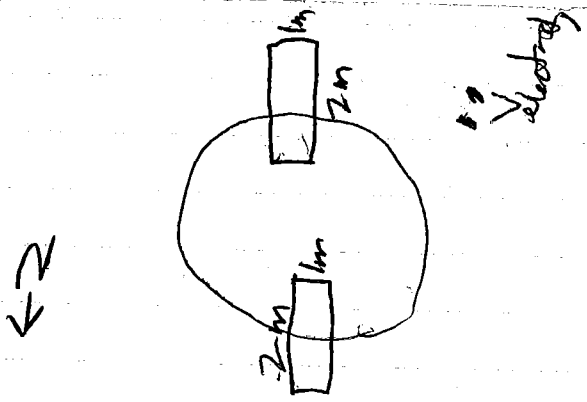

Mapped out section of wall at 25I after lunch.

angle of section

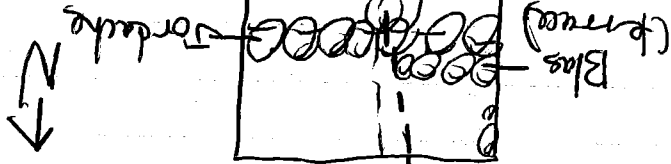

Drawing # 194-15-4

Also, 25I + K wall under way

Several photos taken today  
see Ed's notes for details  
Kols 84-16-11 + 84-16-13

~~LOT INFO~~

lot 1 is empty  
lot 2 - several shards  
lot 3 -

1 x/m pit 0-20cm measured SW South pt  
1 x/m pit 10-20cm  
1 x/m pit 20-30cm

1 x/m pit 0-20cm measured NW North pt  
1 x/m pit 10-20cm measured NW North pt  
1 x/m pit 20-30cm  
1 x/m pit 30-40cm

2nd layer red, gritty, compact + has many roots.

Top soil is dark brown fine, has plenty of roots + relatively rocks.

~~At the bottom of the structure~~

25th I After 30 cm, still very dark soil. 10 more cm to see if red rocky stuff appears. It was at the very base of pit. Will's staff now to expand towards

26th Originally planning to have it sink 30 cm, but checker, really sticky red rocky soil appears. After 20 cm. Expanding pit in both the down. Lot of gravel nearby.



27 June  
 PLAN POINTS, ASHT&S I  
 THE LIST

1  
 2  
 3  
 4  
 5  
 6  
 7  
 8  
 9  
 10  
 11  
 12  
 13  
 14  
 251  
 15  
 16  
 17  
 18  
 19  
 20  
 21  
 22  
 23

Corner well, NW corner  
 25 ft SE corner main  
 NE corner N extension  
 NW corner West.  
 NW corner only pit, joint West  
 NW corner West extension  
 SW corner West ext  
 VANDERBILT wall west  
 VANDERBILT + KLEIN corner East side  
 KLEIN meets SANDERSON  
 SANDERSON + French east  
 SANDERSON + French west  
 SE corner  
 NE corner  
 NW corner  
 SW corner  
 JORDACHE + French east  
 JORDACHE + French west  
 KLEIN + French south wall  
 KLEIN + JORDACH  
 B LASS / KLEIN corner  
 B LASS + French wall west

7  
 1790  
 1750 45'  
 170 15'  
 60 30'  
 3570 45'  
 3580 30'  
 3580 30'  
 3590 30'  
 3590 15'  
 3590 15'  
 3500 45'  
 3500 45'  
 3500 30'  
 3500 30'  
 3500 45'  
 3500 45'  
 3500 30'  
 3500 30'

710  
 3831  
 3882  
 374  
 1345  
 1378  
 1300  
 1527  
 1507  
 1605  
 1658  
 1548  
 1388  
 1413  
 1512  
 1819  
 1934  
 1403  
 1787  
 1829  
 1528  
 1718  
 1833  
 1975

Dist  
 02.4  
 02.1  
 4.94  
 6.81  
 6.68  
 5.77  
 5.98  
 4.94  
 4.85  
 5.21  
 6.32  
 6.41  
 4.11  
 9.58  
 11.68  
 11.61  
 9.48  
 10.7  
 10.72  
 9.68  
 10.26  
 11.01  
 11.03

Took only elevations. w/ transit (+ angles)  
 all distances read with tape.

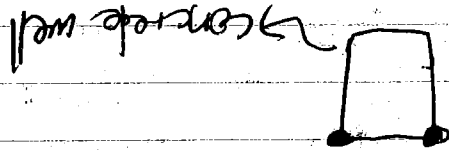

transit station

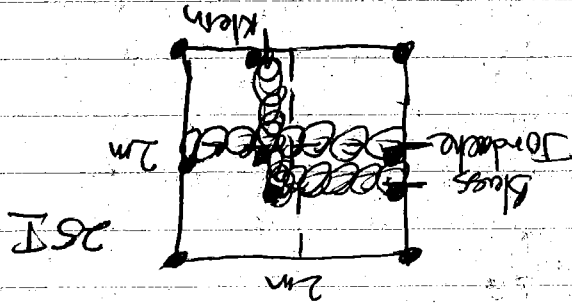
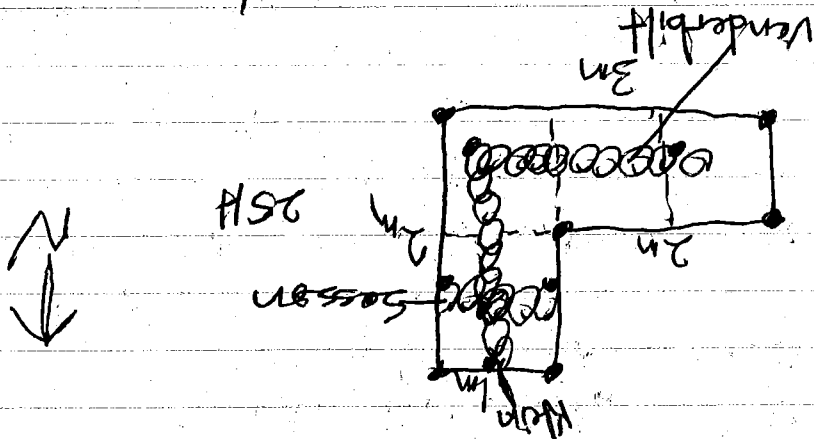

Stand off workers on job-site &  
 then headed off to take transit readings  
 of 25 H+I with PFI.

6/27/84

Meanwhile, back at the electrical pole...

251

Real when I get back, a wall uncovered. It is about 20 cm down. North extension comes down right on top of it. Few boards, however, found in area. Expanding pt east - away from pole - to search for corner.

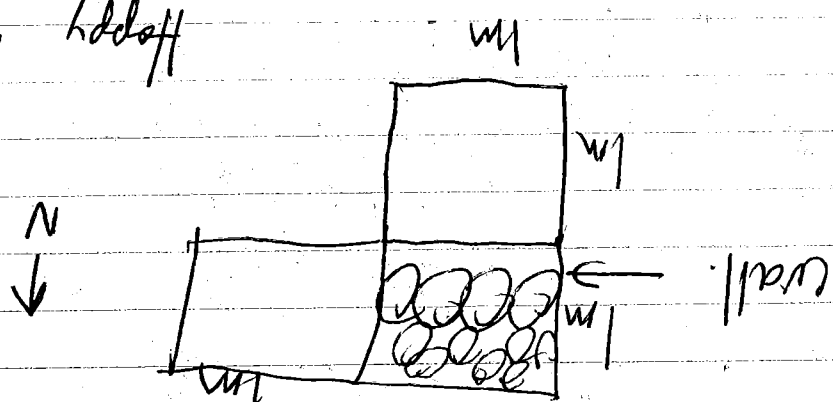

25K

Still no apparent wall, but wires remaining a good many of the smaller stones. This side of the structure looks as if it was messed up in construction of pole. There is a line of red sterile soil on top of the brown, midden-like stuff. Rocks seem very random. Might move them to search for another wall, later.

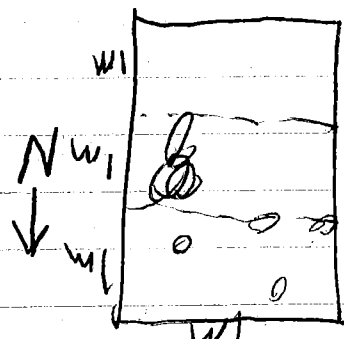

Bottom red layer very shallow

25 R, cont  
 In the south extension found what appears to be basalt more than 100 ft in lat by 25R/4-2

More problems in the south extension which is close to one of the pile anchors, is red-spike for 1st level, and last groups indicate that it continues on west side. East side however appears inverted. Sp. decided to expand pit in to east. Take the piers.

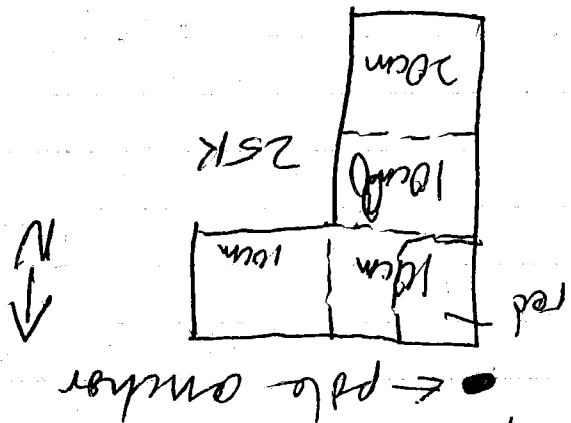

25I

What level the wall has begun to allow me. Following it to the east, it seems to disappear among a great deal of tumbles. How the pit over further east (1m) to see what happens. Will have to go down more if nothing further shows up.



Lot 2 Refinement

25J Depth measured SW corner N

25K

25L

1 0-10 cm below ground surface measured from SW corner of pt to south of str (1x1m)

2 10-20 cm below ground surface measured from SW corner of pt

3 20-30 cm below ground s. 11111111

4 30-40 cm below ground s. 111111

5 0-10 cm below g.s. in northern extension (1x1m)

6 10-20 cm below g.s. in northern extension

7 0-10 cm below g.s. in N.W. corner extension

8 10-20 cm below g.s. adjacent to northern extension

9 0-10 cm below g.s. as measured from SW corner in 1x1m eastern extension adjacent to 1x1m corner

25K - Depth measured NW corner

1 0-10 cm below ground surface measured from SW corner of pt to north of str. (1x1m)

2 10-20 cm below g.s. 11111111

3 ~~0-10 cm below g.s.~~ 0-15 cm below g.s. in 1x1m extension to south of original pt.

4 0-10 cm below g.s. in 1x1m extension to south of northern extension

5 0-10 cm below g.s. in 1x1m extension to east of 2nd south extension

6 10-20 cm below g.s. in 11111111

Pg 4-15-28

255  
 - found part of what looks like a frog fence  
 pit sherd

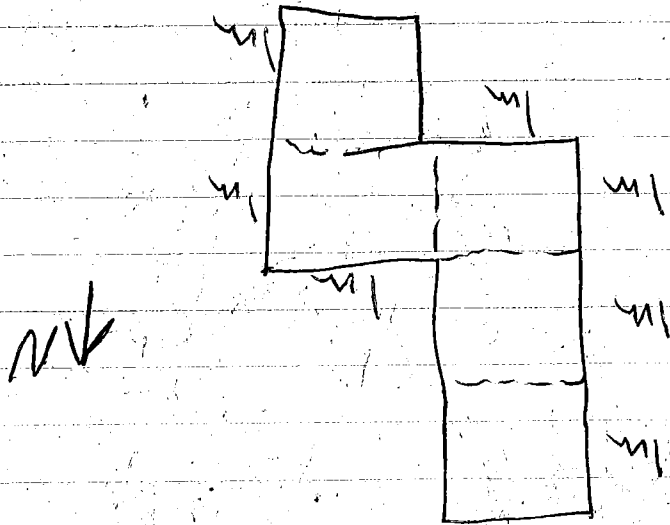

258 still just a bunch of rocks over there  
 Expanding pit again to find some  
 semblance of a wall  
 Expanding pit to North to search for  
 wall continuation. Nothing found in pit N expansion,  
 so going 5m west.

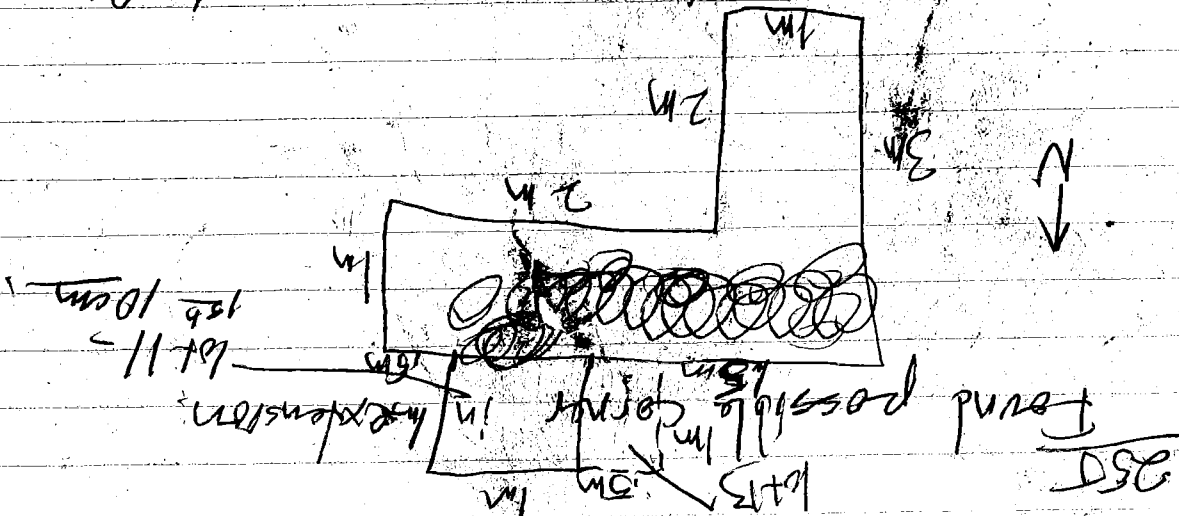

More lot info

pg 4-15-30

25T

110 10-20 cm below ground surface as measured from SW corner in 1/2 m eastern extension adjacent to lot

11 0-10 cm below ground surface as measured from SW corner in 1/2 m eastern extension beginning 5 m west of easternmost extension and going north.

12 10-20 cm " " " " " "

13 0-20 cm below ground surface in 1/2 m pit adjacent to west of northernmost extension

25K

7 0-15 cm below ground surface as measured from NW corner of 1/2 m eastern extension adjacent to lot east extension

8 0-10 cm below ground surface as measured from NW corner of 1/2 m pit to south of easternmost extension

9 5-20 cm below g.s. " " " " " " " " " " " "

Stepped up squares with increasing mound elevation on 25K too garbled to take see worthwhile section

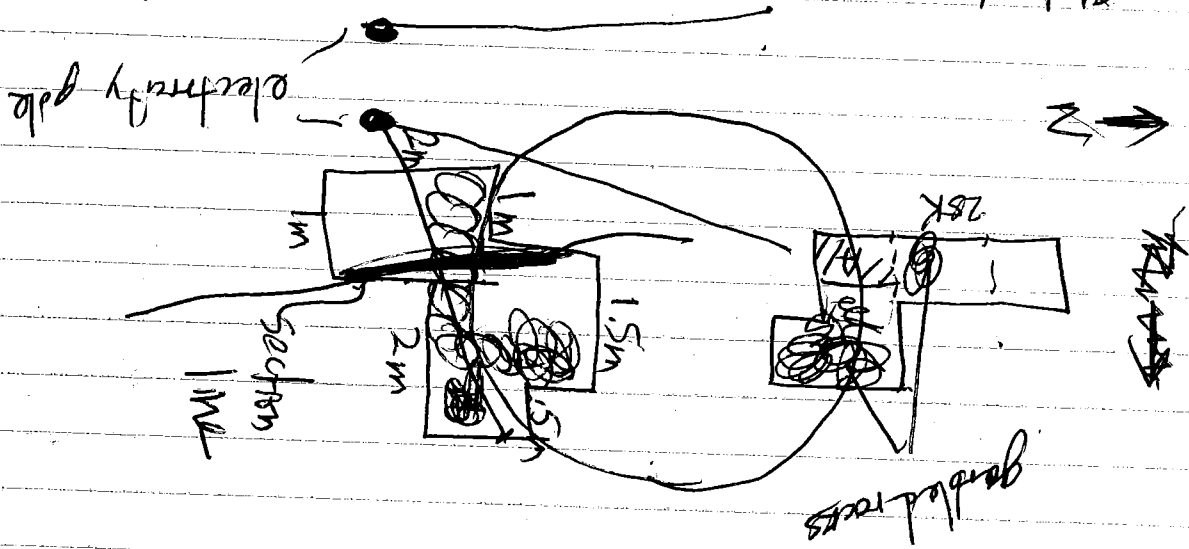

C - Spoke red soil again.

B - darker soil. Artifacts here soil like that of most occupational levels in area.

A - red, stony. Probably redeposited on top after digging on electricity pole. No artifacts found here.

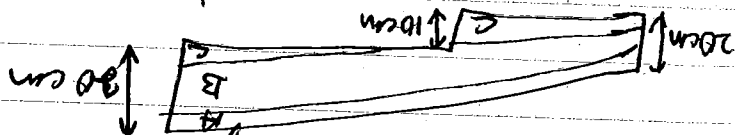

25K  
Stones garbled. No wall visible. probably due to erosion of electricity pole. Three distinct soil changes visible.

Structure excavated near electricity pole has as yet undetermined structure number.

Final notes on group "B"

6/28

PS4-15-31



251

Pg 4-15-32

Possible wall on west of pit detectors as moves east towards pole anchors. Possible due to construction disturbances possible corner in possible wall also losses organization and seems to deteriorate completely.

Section furor of east wall of original pit ~~remains~~ on into north extension. Soil changes visible. See drawing D84-15-5, Closing side up and masonry over to fill for last two days of excavation.

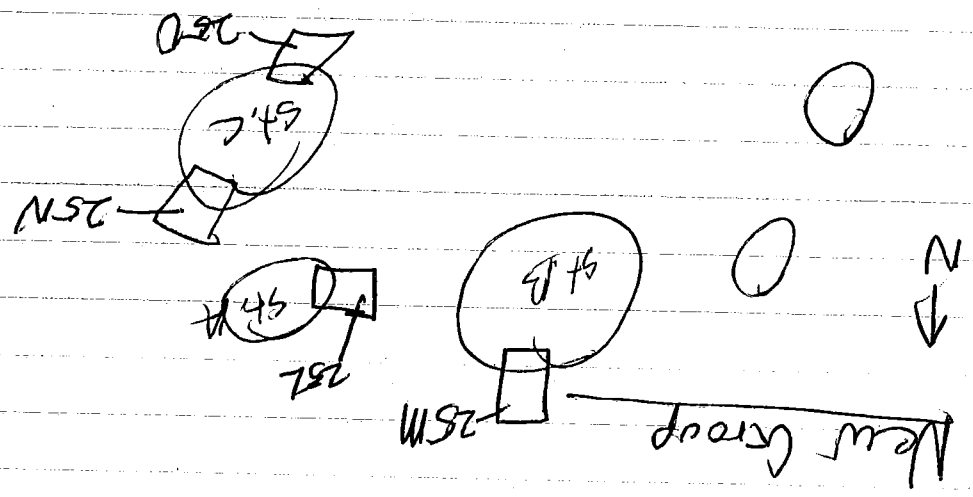

25M

excavation off "back" side in hopes of finding lots of shards for dating and record of structure. 2m x 1m

25L

Excavation off "side" of structure for architectural reasons. What looks like chert and wall should be uncovered in it expansion

25T

Continuing down to 30cm in original pit heard expanding eastwards to wall. Shards still present but much fewer in number. Lot 4 extends to wall.

25M

Lots 1+2 in original pit. Depth of 20cm. Lot 3 expands south to possible wall line. Lot 2 - very few shards. Not rocky level. Pit already there, very large boulder in middle of this pit. Lot 4 - another 10cm down in 1st extension.

Nothing so far back like a wall. Will extend pit at least 50cm west in search of only possibility.

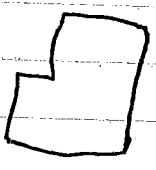

25T

Found what are probably two walls, one right after the other.

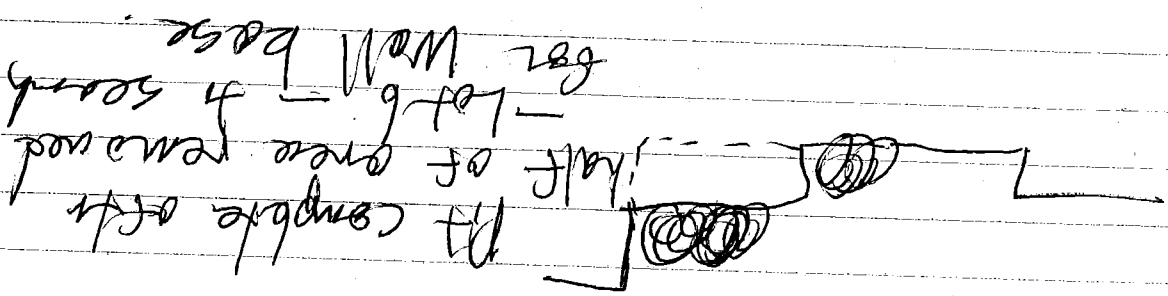

Pit complete after half of area removed. Lot 6 - in search for wall base.

Moving on to structure C for time. More pits.

854-15-31

LOT INFO

257

- 1 0-10 cm below ground surface as measured from NW corner of ~~pit~~ pit to west of str. A.
- 2 10-20 cm "
- 3 20-30 cm "
- 4 " " "
- 5 20-30 " "
- 6 20 cm to base of excavation of original pit, only in south 50 cm of eastern expansion. then below rocks.

258

- 1 0-10 cm below ground surface as measured from NW corner of ~~pit~~ pit to north of str. B.
- 2 10-20 cm "
- 3 0-10 cm below ~~pit~~ pit adjacent and to south of original pit to north of str. B.
- 4 10-20 " "
- 5 50 cm western extension of ~~pit~~ pit to base of excavation (20cm)

pat-1535

Photo record  
Roll 84-16-B

718 - photo 25K East wall to show soil color change  
94D - photo 25L showing terracing of pit  
1412 - pit 25K. unbed rocks  
eastern + northernmost portion of pit.

Roll 84-16C

142 - ~~at~~ original eastern wall - section on ~~142~~  
344 - possible wall in 1st northern extension 84-15-5  
adjacent to original pit.  
546 - photo of section in pit 25L. Photo looks NE  
718 - photo of possible wall in 25M looking west.

More lot info.

25N

110-20cm below g.s. as meas. NW corner  
of pit to North of stic  
1210-30cm " " " " " "  
not complete 6/24

25O

1610cm below g.s. as meas. SW corner  
of pit to south of stic  
1210-20cm " " " " " "  
not complete 6/24

6/29/89

84-15-36

Workers continue digging 25N + 25O  
lots 25N/25O/B continue downward excavation

Cloudy today, hoping to finish up if it doesn't rain.  
Ed should be here soon to help with drawing.

Several photos 25M + 25L taken by Ed - see all 84K-C  
photos M+L - MASTERPIECE in 25N

see Ed's notes for info on 25L

25M

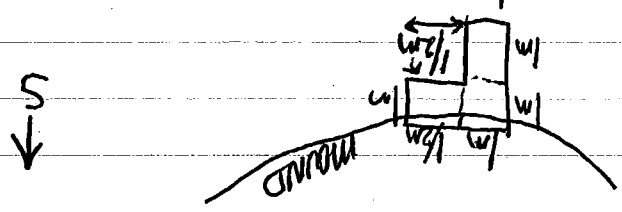

This pit hit sterile soil very early - Wall into it  
by depth of 20cm.

Topsoil (~0-10cm) is fine, dark brown, has lots of rocks  
Layer B - very coarse, reddish, lots of rocks.

Approx. drawing

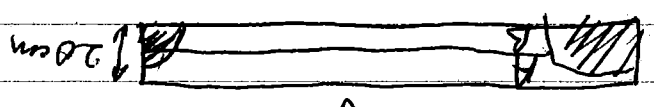

The wall was encountered in this pit.  
Followed fake lead 50m West, but only found  
more of layer B.

There is a possible wall on the surface made  
from large natural boulder and extending along the  
pit ~~straight~~ to the West. More excavation (cont pit)

LOT RECORD

PG 4-15-27

25N  
/ 3

measured from NW corner of pt to North of st. c.  
30-42 cm below ground surface as  
measured from NW corner of pt to south of original pt.  
NW corner ~~of extension~~ <sup>marked</sup> to the south of original pt.  
15 feet in front of possible wall down to 42 cm

250

20-30 cm below ground surface as measured  
from SW corner of pt to south of st. c.  
14 m down in extension ~~and~~ south, away from mound.  
15 feet under above cobbles here pavement from  
STARTED westwards 4 m.  
16 feet near possible wall ~~at~~ on north side of  
west end of pt.

# DOME

I.H. 1.505

POINT

1.25J SW con.	1235°30'	1.586	17.64m
Electric 2-125J SE u.	2229°01'	1.576	26.44m
Line Group? " NE "	3233°15'	1.507	36.23m
4y u' SR con. B. ext.	4219°30'	1.504	44.87m
5y " NE " E. "	5227°01'	1.448	54.20m
6y " SR con. B. ext.	6232°01'	1.355	64.42m
7y " NE " " "	7242°30'	1.215	73.85m
8y " NW " " "	8250°45'	1.150	85.28m
9y " SW " " "	9243°30'	1.342	96.72m
10y " NW con. B. ext.	247°45'	1.301	106.43m
11/25J poss. wall w.	241°45'	1.676	16.77m
12/ " " " "	223°30'	1.665	4.66m
Surface 13/SW con. Sta.	251°15'	1.545	9.01m
14/ Electrical Line B.	243°00'	1.642	10.71m
15/ NE con. Sta.	329°45'	1.628	4.45m
16/25K NW con.	1317°30'	2.058	18.35m
17/ " SW con. B. ext.	2300°15'	1.553	27.24m
18/ " SE corner	303°45'	1.401	36.18m
19/ " SW con. B. ext.	244°30'	1.186	45.97m
20/ " SE " " "	529°45'	1.168	55.02m
21/ " NE " " "	6316°15'	1.502	65.77m
22/ " NW H.S. "	7312°00'	1.601	76.62m
23/ " NE corner	8323°00'	2.059	88.26m
24/ " Apparent N. " 12.11' each in stone	309°30'	1.432	15.51m
25/ Surface	246°00'	1.586	28.12m

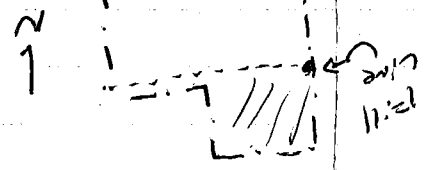
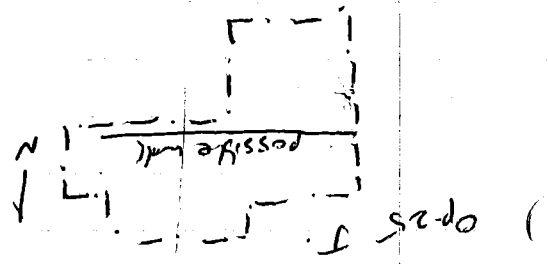

MID. HAIR

D. 57. 084-15-38

1.586	17.64m
1.576	26.44m
1.507	36.23m
1.504	44.87m
1.448	54.20m
1.355	64.42m
1.215	73.85m
1.150	85.28m
1.342	96.72m
1.301	106.43m
1.676	16.77m
1.665	4.66m
1.545	9.01m
1.642	10.71m
1.628	4.45m
2.058	18.35m
1.553	27.24m
1.401	36.18m
1.186	45.97m
1.168	55.02m
1.502	65.77m
1.601	76.62m
2.059	88.26m
1.432	15.51m
1.586	28.12m

084-15-39

0.57 acre

4.54m

3.72m

3.65m

2.56m

2.83m

4.76m

2.77m

4.31m

6.32m

4.59m

8.59m

10.34m

10.77m

9.22m

10.49m

10.06m

9.25m

9.63m

9.85m

12.18m

M10. HAIN

1.809

1.773

1.778

1.681

1.635

1.760

1.619

2.104

2.629

2.216

1.829

1.465

1.503

1.872

1.553

1.568

1.939

1.864

1.565

2.099

2

1.35901

2.3580301

3.35001

4.34830

5.22001

6.120451

7.190301

300.301

240.151

144.151

93.0151

88.0151

93.301

99.001

93.0451

289.151

92.0151

96.0151

800.01

1070301

POINT

Op. 25m NW corner

" " SW "

" " NW corner

" " SW "

" " SW corner

" " NE "

" " Pass. south wall

NW corner Sta. -

SW corner, Sta. -

SE "

Op. 25m NW corner

" " NE "

" " SE "

" " SW "

" " Monopod wall S

" " " "

" " " "

" " CLUB wall N

" " " "

NW corner Sta. -

SW " / Sta. -

L.H. 1.509

SW. comp. 510 #25

Done



DISTANCE PARTS 40

DRIVE

MID MARK

X

POINT

1 2.53m  
 2 2.42m  
 3 3.85m  
 4 4.01m  
 2.87m  
 2.85m  
 5 5.40m  
 2 5.09m  
 1 5.50m  
 2 5.71m  
 5 5.75m  
 2 5.06m  
 3 5.94m  
 2 9.18m  
 4 9.29m  
 1 9.04m  
 2 8.07m  
 3 8.05m  
 4 3.33m  
 5 4.43m

~~1.387~~ 1.335  
~~1.417~~ 1.399  
~~1.443~~ 1.405  
~~1.478~~ 1.350  
~~1.499~~ 1.449  
~~1.532~~ 1.464  
 2.359  
 2.369  
 2.691  
 2.545  
 2.935  
 2.170  
 2.513  
 2.578  
 2.741  
 2.724  
 3.035  
 3.022  
 3.065  
 1.621  
 1.521

30° 0'  
 53° 15'  
 50° 15'  
 36° 45'  
 34° 15'  
 50° 15'  
 283° 15'  
 273° 30'  
 271° 15'  
 281° 0'  
 305° 0'  
 242° 0'  
 147° 30'  
 267° 30'  
 273° 30'  
 272° 30'  
 270° 0'  
 268° 30'  
 85° 0'  
 355° 0'

by 25N, W corner  
 2 " S  
 3 " E  
 4 " N  
 5 / 25N, Masterpiece wall  
 6 " E  
 7 / 25° / NE corner  
 8 " SE  
 9 / STARBUCK wall S.  
 10 " N  
 11 EV. PT. on LITE surface  
 12 NW. corner, STA  
 13 SW " "  
 14 SE " "  
 15 / 25° / SW corner  
 16 " NW " "  
 17 / LITE NW pr.  
 18 / LITE SE pr.  
 19 / LITE + S. trench wall  
 20 / STA - surface corner. 85° 0'  
 21 / STA - " " 355° 0'

from summit of sta.

I.H. 1.432

no time.

Although this pit has not produced much archaeology, a good number of interesting shards come from here. Among them is a piece of Copal, imported from Copan. This site, I believe, (at least this structure) was occupied during the late Classic period, judging from shards.

For detail of 25N, see Ed's notes.

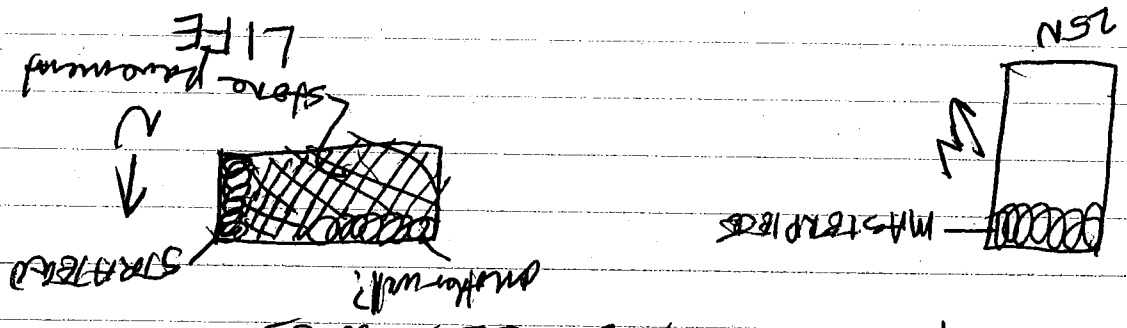

250 proving to be one of most interesting pits the sea.

Will spread on east end + then a pavement about 1m from ground surface extends in a way that could be a previously unseen structure - or it could be step in pavement

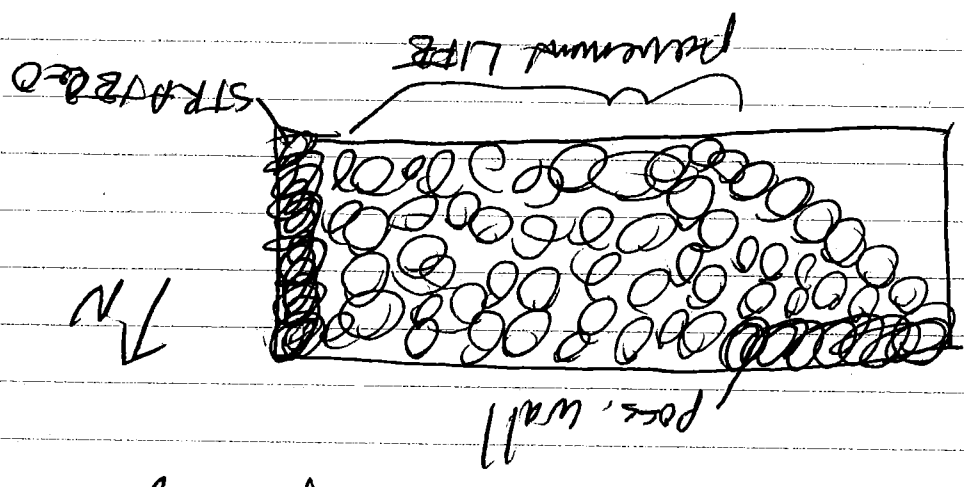

leading on to another structure. It's ashore we won't be able to find at this season.

84-13-42

More photos

84-16-C-1+2 - STRATERO wall in

pit 250 clear

84-16-C-344 - LIFE ~~with~~ pavement

in pit 250, with STRATERO in distance

250

Orientation of LIFE - 2920

Orientation of STRATERO - 3450

STRATERO - a wall or possibly a step up ft another wall in str C, which is probably S-sided.

Pit uncovered a cobbleson pavement (see D44-15-8) running away from STRATERO. Pavement Name: LIFE.

Three soil layers found in pit - a loose compacted, brown, fine soil on top of a greaser, clayey, compact variety with about the same color.

STRATERO is not // or L to MASTERPIECE, so str C is probably S-sided. Further mapping should make this point more clear.

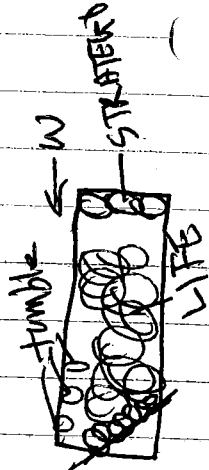

250 did not produce many shreds, except near some tumble on the north wall in the western 1.5m of pit. One interesting piece that appears as a <sup>shy</sup> pattern/sidways handle. This may be due to modern infirmation, as a brick was also found in this pit. LIFE makes a slight angle at 2920 off into ~~the~~ north wall of pit. See diagram to left.

PR415-43

Soil layer 3 is red, rocky - the most erodible  
 soil now. LIFE nests in this layer  
 size of stones in LIFE on average is about 20 cm.  
 STRATIFIED nests on LIFE ~~the~~ LIFE.  
 Average stone size of STRATIFIED is about 25 cm by 18 cm.  
 North side of STRATIFIED seems to be more graded w/ LIFE,  
 but this is less clear in south.  
 Maximum height 33 cm of STRATIFIED.  
 STONES about 5 cm thick.  
 LIFE surface rises towards middle, drops  
 east + west. LIFE STRATIFIED bordered by level 2 (K).  
 All features covered by level 1. (A)  
 Level 1 has some stones in it, but ~~probably~~  
 probably tumble from str. C. Maximum height of  
 pit in SW corner 54 cm.

Sketch plan of ZSH

Vanderbilt wall

Calvin Klein wall

