

1983

## PSB-007-Ashmore-Field Notes-1983

Wendy Ashmore

Follow this and additional works at: <https://digital.kenyon.edu/honduras>

 Part of the Archaeological Anthropology Commons

---

### Recommended Citation

Ashmore, Wendy, "PSB-007-Ashmore-Field Notes-1983" (1983). *Four Valleys Archive*. Paper 92911.  
<https://digital.kenyon.edu/honduras/92911>

This Field Notes is brought to you for free and open access by the Anthropology at Digital Kenyon: Research, Scholarship, and Creative Exchange. It has been accepted for inclusion in Four Valleys Archive by an authorized administrator of Digital Kenyon: Research, Scholarship, and Creative Exchange. For more information, please contact [noltj@kenyon.edu](mailto:noltj@kenyon.edu).

5/22

May 22, 1983 (Sunday)

Ed & I arrived Tegucigalpa; Put en route to Panama with Alaska

They had to pay ~\$136 in excess baggage charges (changed ~~me~~ 2 of total in Cleveland & balance in Miami); I only had \$24 (~~was~~ was only carrying 1 extra bag) - because my luggage was checked through, from Newark - Miami -

Tegucigalpa

HOWEVER: Ed's baggage arrived with him - none of my 3

checked pieces did...

filed claim immediately; hopefully the thing will arrive tomorrow (called Dick, and will call Travel agent tomorrow to see if anything can be done from that end)

Tomorrow:

- 1) Institute: see like Agencia (contract, letters of recommendation for Project bank account; wife)
- 2) rent car
- 3) purchase supplies
- 4) pick up my luggage if it has arrived

Other major goals of the week:

- 1) establish bank account in San Pedro Sula
- 2) rent house in Santa Barbara
- 3) get tailor and carpenter started on work (bags, tables)
- 4) select workers & laundry/cook

Scheduling:

- May 27: students arrive SPS
- May 29: Pat arrives SPS
- June 4: Sylvia arrives SPS
- June 13: Bill Sandy arrives SPS

5/24-25

P83-7-3

May 24, 1983 (Tuesday)

Went to Smith at 9 a.m. - 2d signed contract  
(no need for fat and me to sign - Insto.  
Pedro jungle named person in charge)

Picked up Toyota diesel minibus from Budget  
rent-a-car (actually a Mexican vehicle)

Left Tiquinaga 11:30 a.m.  
stopped for lunch Siguatepeque 2:30 pm  
reached Cruz (copan/SB/SFS) 4:30 pm  
reached S.B. 7 pm after repairing blown fuse in  
Trinidad (car temp tends to rise a lot while car  
is climbing hills)

trip very hot - haze from fields burning, especially  
along and near coast - also car motor is under  
driven heat!

Staying at ~~Hotel~~ Boarding House Modano  
rained hourly at night - water went off shortly after 7 pm

May 25, 1983 (Wednesday)

Water on again - was be shut off 1-4 pm today to  
fix pipes - muggy, hot, but clear blue sky

arranged Post office Box (A.P. 9) L30/year + L5

deposited for key  
arranged bank account - Ed, Pat & me all authorized

to sign checks

Pedro de Jesus Castellanos introduced us to cirangado

of possible rental house - began in quarters

(3 bedrooms, sala, kitchen, bath, [shower, toilet],

mud's quarters, Apore outdoors in back where

work could be done - has water, hook ups but

no electricity yet)

PSB

May 26, 1983 (Thursday)

Hot and muggy yet again

Bar Com. Pavia (F) SEF to whom we presented our credentials (at his office)

got spare problem on car fixed (cracked wire) - wire, hopefully, that solves the problem

new carpenter several times - paid for (and picked up in afternoon) 14 stools and four drying

screens, just advance to buy wood for 2 tables - told go with us tomorrow as far as Pavia to

average purchase of wood for bed

note Bill Sander

arranged for Linares (Chavira Pava), to begin Monday

and guardian (workman (Panchito) to begin

Monday also, except that hill also shut on the house tomorrow while we're in San Pedro

get keys to house - Gilbert is still fixing a few small things (handles on toilet for example) and

power will be turned on tomorrow

most most of our belonging to the house -

address: 0707 Avenida la Independencia

May 27, 1983 (Friday)  
hot etc - again

did preliminary house clearing (sweeping, scrubbing etc) - the latter was in a scorpion sting

packed up carpenter and left for San Pedro - left carpenter and assistant at Pavia, where we purchased wood

for bed post frame - carpenter (Don Benito) will arrange its transport to SB

on route to SBs house 5 times, as took an shortcut to airport (Buckled, tho' it's a Mexican car) -

P83-7-5  
5/26



PSB

5/29-30

PSB-7-7

May 29, 1983 (Sunday)

Hot Hot Hot - when will the rains come?

a day of organizing - picked up lumber, blocks (for beds) and tubes for solar hot-shut - all worked out well!

Began setting up camp organization (set up shelves with lab/field supplies, food water, clean dishes etc.)

Spoke with Reinaldo Canales\* who knows of a

man named Pablo Enamorado who is

supposed to be very knowledgeable about

Tanaca history (lives in S.B.)

\* dueño, Almacén La Nueva Alagosa

First donated an <sup>stone</sup> altar: black ground and

perfumed herbs, said to come from Guayaguita;

brought in by young man (name unrecalled)

who supply gear to us  
Catalogue No: PSB 28/1-1

lived cook: Trudy

(lives in Galena)

met Peace Corps people (4): Emmett, Bob, Frank, Joan  
(last names not yet known)

May 30, 1983 (Monday)

Rained at night - ca. 130-350 - long, heavy, thunderous storm  
cooled off a little but not much

Trudy made breakfast - off to a good start

Ranchito arrived and began work by running errands  
and cleaning yard

Chamita couldn't come for 11 but that's ok

Spoke with tailor (Sachreva La Elegancia) - manita prisa

P83-7+9  
5/3/83

May 31, 1983 (Tuesday)

the night was a bit cooler, though it did not rain,  
and at last I think I got more than 3 or so hours  
of sleep - others have been sleeping poorly too, due  
to the heat, but perhaps we are needing a cooler  
time

Morning: Ed, Pat & I worked on accounts, paid  
deposit on soda arrangement, got Pat's bank on  
bank account and pleads (!) with ENT to look  
up electricity as soon as possible (to help John  
particularly); took crew to Migration office to  
report in officially (they confirmed we can  
come to them (rather than travelling to San Pedro)  
to renew tourist card); fixed shower hookup  
and cleared drains - from 0 to 2 in a few minutes!  
Afternoon: Power connected at last - LIGHTS! FANS!

Also, roof leaks mended and hopefully fixed.

Electrician arrived

Briefed students on monitoring systems, note taking,  
field equipment

Planned to work on building a roof for the outdoor oven  
To side about 2:30: (Total better but not well enough to

go; Kathleen a bit woozy too, but not ill; Amy

in charge of house

Found site with students - Ed/Pat found Capador on

surface in Group I

Linear features seem to define west and south

edges to a large (currently) open space [now

the site of the soccer field] north of Group I:

Southern part seems to lead into 8m x 14 at west

end of line and a curving corner at east end

Ketch plan

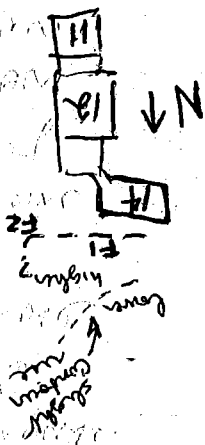

(\*) features consist of lines of low ridges and

5/31-6/1

PSB-7-11

Site located called Carranca up the Rio Honda drainage - range? well see

carpenter (Don Berth) stopped by - we communicated a more serious (gave him 1/6" mesh) and 5 bands for shavers

June 1, 1983 (Wednesday)

94 to a late start (ca 40 minutes late to site) because the crew didn't finish dishes last night and shavers underestimated time needed to get ready - must change! Army heading up well, but we must make it on better and not allow her to get dumped on

Starting date with Op. 9, Group VI, at far north end of mapped site - Ed found large shavers on surface yesterday which he thought included Proterozoic as well as clastic types, but on re-examination, the Proterozoic candidates were lost again. Still, there are abundant shavers, so with bringing in a large starter sample for Pat, plus there may be some

architectural zone

SN 29 a fairly clearly a low coralline mound, and as it is OK as well, but so many just have been identified on basis of shavers and shaver rubble in nodes. Shallow pits - going to test: Op 9A: SN 30 Op 9B: area of shavers & corals

NW of SN 29 (big large hole [space unknown])

new sample SN 35

28

25

30

after bridge map

SEALS  
Furber's  
road

119

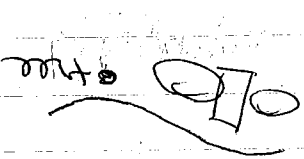

9/8/1 remove spoil heap to pre-exc surface  
9/8/2 sun face to staves of FV1 formwork

coming from QB, and there is more shade (only)

array, north of mapped part of site — I saw nothing  
presumably - looking, but God found stone cures that he

shade had a real quite hot - headache and feeling tired

we are trying screening, but it seems to us to slow things down considerably - to hard soft paper

most soil with gravelly balls - need bigger trays for

Margaret had to leave because a relative died - will return Friday - he seemed the best worker of the bunch.

Friday - he scanned the best works of the bunch

an archaeological zone  
Miguel Izaguirre Flores, Abogado y Notario  
also told them of the excavations we had yesterday  
with Don Pedro, making arrangements against them  
Miguel - it's all symphonies of 8th. Rosa vs.  
Guadalupe to Fatherman amidst which we've  
unadvisedly fallen.

Worked again by 10 am - Don Juan Miguel went into  
S.E. with IMAH people - I put Alfredo y Wilson  
on 9A to prevent truck traffic and clear for  
photo - brought Gilbert to 9B which is ready  
to draw

took 1 1/2 hrs to draw plan - DB3-7-1 (1:20 scale)

Op 9A - red soil is not stable - more shreds for lot 9A/2  
having from level it down

Op 9B: an asking Gilbert to take down another 10 cm in  
front of step, keeping it level  
this 10 cm level, north of steps

9A/2

9B/4

Op 9A - neglected to note new lot (some 6/1 but not  
determined) - at base of WIF feature (cotton, bedded  
but neither wall nor corner, in NE corner of excavation)  
a red earth replaced brown/black earth (humus)  
above - seemed lower shade, but in above noted  
leveling action, found it not stable or even nearly

988

83-7-17  
6/2

9A - the 1st 1/2 barrel is 35-36 cm below surface

and are exposed in pitted subhorizontally on 83-7-1

removed what we could, took photos

83-7-83/4 S.D. 1 in place

to place pieces + 2 missing blocks back to lab to work on

Don Pedro & his son visited found several large

shards down slope toward quebrada in cut NE

98R 35 - put in 9A/2

2A/2

June 3, 1983 (Friday)

a close, humid night but a cool heavy breezy morning

Ranchito asked to keep his friends from visiting while his

washing shards

Pat & Ed will go to San Pedro this afternoon to

(a) try to get car fixed

(b) shop

(c) pick up Sylvia

Spoke with Pedro Loba Paz regarding

(a) having 2 more workers (trying to balance factions)

(b) ok to clean vegetation tomorrow in groups II/IV

He also gave us 4 papayas

Having Margarita & Walter clean down to river of

step in 9B to see better the extent of wet light soil

More bone on 9A, so sent the other 3 workers to clean

on 8R. 15 & nearby (8A & 9A) are mapping near there

was so "old" (old than too)

more bone to "sketch" in on 83-7-1 - still clearly in texture for

the most part, but am using water to moisten the soil before

preparing it with dental pick & knife

at 4-7 cm south of rock bench wall, at 0-24 cm

west of east wall, at 35-44 cm below surface

9B/10 cm level at about base of T4N (containing)  
9B/7 10 cm level below base of T4N (containing numerous  
9B/8 20 cm level below base of T4N)  
9B/9 10 cm level below 9B/8, to bring excavation totally  
level (i.e., same as 9B/4)

9A/ having the stone ~~the~~ even out excavation  
preparing to final drawing - some more bone  
material but not with expanding trench (cutting  
it off neatly at trench edges)

### Afternoon:

9A/ excavation completed by plugging the holes  
filled with unexcavated portion of SD1 pedastals  
recently removed bones (other femur shaft & 1st  
other unidentified long bone fragment) (plus  
cancellous mass with edge curve suggestive  
of femur head or tibia head or radius/pulvis  
area of pelvis)  
took photos: 83-7-B9/10 9A excavations completed  
from west (scale 1 m, vertical)  
drawing 83-7-3 sections of north and east  
trench faces  
took soil sample from "and clayey soil at base of  
excavation

9B/ excavation completed by taking down lat 9B/9  
see 83-7-4 (begin rate - Ed helped me  
quickly draw major points - finish Monday)

183-7-25  
6/14 - 6/17

June 4, 1983 (Saturday)

short, tempestuous rain last evening - no cooler today  
spent day (collectively) working & labelling lots  
and doing a major kitchen cleanup, to try to  
cut the number of flies

June 5, 1983 (Sunday)

Hot again - still no Pat & Ed (by 10 pm) - should cable  
SFS and go on my way to try to find them - not like  
them to be late without calling and to wait a week day  
(Monday)

Day spent doing Abell mapping & labelling again  
Gomito returned before dinner

June 6, 1983 (Monday)

Hot again - still with Gomito on his motorcycle

to the site to pay worker and to advise them  
we couldn't proceed with work till tomorrow

Only last cable to Hotel Tenaga, I took 9:30 bus to  
SFS - parked the minibuses with Pat, Ed & Sylvia

about noon, just about 5 minutes onto the dirt  
road from government end - SFS proceeded into SFS

before getting on 2:30 bus to come home

Things cable did not reach the Tenaga (cable not by 1:30)

When reached home, learned PET had been delayed by  
cable total electrical failure on Sunday - also, had

sent message on Sunday afternoon but, which

didn't reach the house till 1-2 hours after SFS left

on Monday - frustration, but at least things safe

and back. good 1/2 hour or so of rain ca. 8:30 pm

June 7, 1983 (Tuesday)

Downed cooler - but will be hot again

Ed & Pat to go across river today, I will begin night of way tests



Hopefully no such mixups occurred  
10C - not yet begun

10D - all in black humic soil

10D/1 Above

10D/2 1st hole

10B - change from brownish to redder dense clayey  
soil as in 10A, but here, at ca 25 cm below surface  
in both cases, change not sudden, probably from soil  
weathering

afternoon:

Went to 1st Aug 1/2 hour late

am feeling weak/somewhat from the heat - have drunk  
nearly the whole quantity of water & the roadside fluids  
is out of sodas ...

Katherine, Mark & I went mapping in 1st hole  
I tried to climb the side of 1st hole but encountered  
a number of sta. Rosta cooperative who want on

nothing with us to day at 4 or tomorrow at 7  
Kate mentioning 10A

10A/6 - 30 stobs

10B is in lot 10B/8 and no stobs were 10B/5

frank/murray drew photograph

Went to 1st Aug 1st hole backfiring 9B

10A still getting a few stobs at 70 cm down

10B has begun getting stobs again in 10B/8 - 2,

including 1st hole sum blackness

10D/4 - 1st hole } After very organic black sand  
10D/5 - hand

10D: working on lot 8 by when I got there  
 10D/6 2 handles  
 10D/7 2 body shields  
 10D/8 1 pc of skin  
 and getting harder, easier as area down (black)  
 and brown ca 40 cm - not sharp break  
 { am not entirely confident }  
 attributed to *Microtus* *talp.*  
 covered (dark and clean structure)  
 inside a space so (large and one)  
 but most probably of

10E: begin with the 2 *Geolagus* *ordman* - *Emilio*  
 working them for me, to wonder straighten of  
 pit walls and maintenance of levels

10C: in lot 5, no more guts since lot 1  
 10C/2 handling of heads  
 10C/3 same + chest  
 10C/4 same + chest + abdominal blade  
 10C/5 same

10A: Kate has notes for yesterday here  
 in 10A/9, nothing  
 10A/10, 1 head - orange bone, body shield

→ took photos 83-7-12 of north & east facing excavation  
 note: bones near top, seen from west  
 skull stop at 1m for now - getting quite difficult to  
 remove south from the telephone-booth pit - may  
 continue to move in later - moved Alfano and Edmonds  
 to 10B, to take down lot 10 then  
 draw section (on D83-7-5) of 10A

am stopping at 1m in the technically not at a scale -  
 need to move on, as visible relation could cut our time  
 10B: still getting heads in 10B/10 so continuing cut 10B/11  
 10C: 10C/8 has gut and some glands  
 10D: patterned quarry in 10D/9 but no clear artifacts in 9a/10

106/1

105: started off a little overcast, and reached 15 cm before I could stop them - an abrupt turn they've been so caught in 10B and 10A - anyway 106/1 will be 30 cm instead of 10 or 15 stems

10C After getting started in 10C/11, so on to 10C/12

Spent 10/10 with Elliott & Adriano - it fell on north end of SRA extension - (9: new labeled SRA 38) (skipped 10F for now, to put Margarita & Guadalupe on it)

Op. 10E: still waiting scale 1.35 m vertical, 50 cm horizontal

83-7-10/10 Op 10B, North and east faces

after taking photos took soil samples from 10B/5 and 10B/12

afternoon starting in shower with transit collecting south of canal and will spend the afternoon, Mark, Amy & Barney spent a m. surface

10B: lots 10B/12 and 10B/13 sterile, so clearing

10F: Emilio continuing to observe

10D: back filling (drawing - D83-7-6 section - done)

10C: continuing into 10C/11 in stream yesterday!

they've not heard of it. (P.S. They said it was 100°F

what they were doing - asked if they had any knowledge of the local microcommunity dispute, but

1230 - gave them quick tour and general idea of 10B & track from the Peace Corps stepped by about

ASB

6/8

783-7-27

June 9, 1983 (Thursday)

turned long and hard at night - lots clouds in morning, and cooler - let's hope it stays so the rain also made the ground softer

10E: 30 cm (2 lots) to go hole 1 m depth - shall stop here for now

10C: June (Saturday) after indicated strike at 2 m on

so, shall expand this pit to 1x1.5 to go down to that depth - shall put the 2 Guelphian men out 10F: 10F/1 0-20 cm few shales 10F/2 20-30 cm few shales (more than 1) plus obsidian dark organic soil

10H: 10H/1 4 shales 10H/2 shales, matrix lig, obsidian 10H/3 shales, obsidian

dark organic soil with pebbles shales from Str. 16 beginning to increase quality at 30+ cm

10G: lit large stone, which sits on what is rather a pit on a fence edge (near this is north extension of Str 26) - lot 10G/4 is from top to top of this feature (case of D16) - possible north edge just make north face of pit - may extend northward to catch face of D16 for sure

10G/4

not damaged! wanted to scale but not me

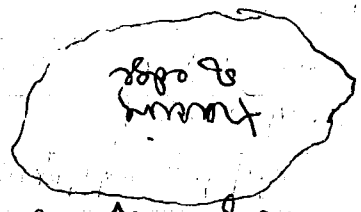

Man from Sta Pointa brought in a small bagful of ca 30-40 pieces of obsidian, including broken flakes, an irregular biface, and 2 thick core fragments, 1 piece black chert, 2 odd chunks of obsidian 3 chert (2 broken, 1 small pebble); 3 more unmarked pebbles and 2 pieces broken points - 1 top (2 x 1 cm max thickness 2.5 cm)

10g: Having them clear. Die feature still about done - arranging for walls or corners then shall move to 10c

10f: 10f/3 pile 30-40 cm

10f/4 few shreds 40-50 cm

the dark organic looking soil

10f: down but loose pebbles - far laid - fill

10f/4 shreds in this down pebbles

but fill hard down down shreds

10f/5 → shreds [see below]

took photos 83-7-12 June 8/12 from south (atop 8n-16)

A man from the Agricultural Dept (in related government agency) came by - inquiring about the photographs

woman (or other person) - I said we had no

power to say yes or no that it was for the 2 photos

to decide. There had implied that it was ok -

we must get signals straight and uniform

uniformity of our position

Se llama Ricardo (Ricardo normal)

10H: 10H/5 now getting ahead in fill took photos 83-7-12 June 8/12 of Die feature from wall 50 cm

Die feature: 3 stone visible, 99° alignment

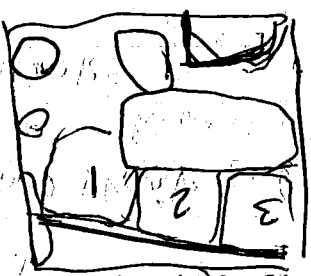

#1 chunky limestone 34 x 47 x 5

#2 33 x 43 cm

granite rubble

#3 24 x 38 cm

like #2

PSB

10H: west side of pit (at surface) is lower than east and have not been filled at 50 cm (approx) to west but not yet at 50 cm approx in east - just as I say that, the base appears in both sides  
 fill ends on 10H/6 - some shreds from that lot may come from under the fill, but would not enough to travel ahead or wouldn't get a fine distinction - just tells me I should have done so, but I think the great distinction was not sufficient

10G: 10G/7: 30-40 cm in rearrangement

Also, bits of bone (bone? deer?)

considering large bones again, here higher, and what I would have thought they should be lower if present at all

10H: 10H/7 more shreds, in brown clayey matrix 10H/8 beginning

10F: 10F/7: lots of shreds, little

Afternoon: - lot, but with coal bribe - looks like might run away? Mark containing (unmeasured) surface alterations

late drawing of 10E for me (983-9-1)

Endo monitoring 10C exposures (now in 10C/17, with a few shreds)

10F: in 10F/7 got small fragment of bone (less than 1/2 cm in any dimension) and specks of charcoal

small vertebrae (small animal)

4000x, 75-78 cm down  
 projected from opposite (south) side of pit

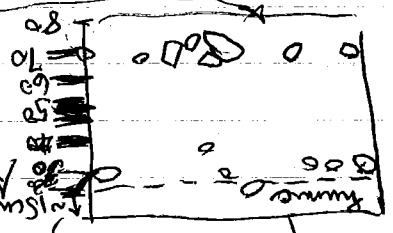

Atchuk action

P83-735  
6/9-6/10

PSB

10F: let mix up in bagging, contents of 80-90cm and 90-100cm levels get mixed, so redrawing let 10F/8 as 80-100cm no -  
 10F/11 - 1 or 2 shovels  
 see below  
 10F/9 evening: there are 2 bags of 10F/8, so don't redefine let, just make 9 (10F/9) evening - i.e. it will include the mixed material from both 10F/8's originally defined level and the 90-100 cm level

June 10, 1983 (Friday)

gave rain at night - last rain about 10 a.m., and water didn't come on till 6 a.m. (usually only by about 5-5.15) - hope power returns, but water more important - even up, cutting for 10F/8 may be tedious - day promises to be a scorcher (as Kate puts) low clouds but already bright by 7.30

Optoc: 14 shovels 0-10 cm

15	"	10-20
16	"	20-30
17	"	30-40
18	"	40-50
19	empty	50-60
20	empty	60-70
21	"	70-80
22	"	80-90
23	shovels	90-100
24	"	100-110
25	"	110-120
26	"	120-130

check against tags to be sure of which are stone and which not

George had had mounds at Southeast corner of  
 Str 19 and continued with mound south end

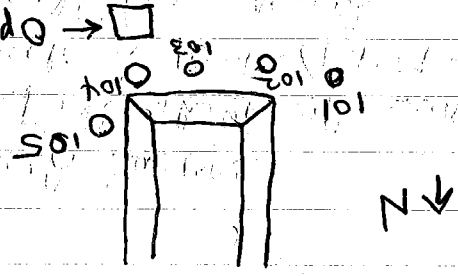

central magnetic direction

Lat 5A/1 leveling ground (cf. 5cm higher to north) - 2 A-horizons

5 A-horizon, bone + obsidian, jade, chert

Scoring (rotation assumed) (small?)

1/2 bag - large zircon bags - denture bagged

\* medium to large mammal  
 bone + debris  
 and of small mammals

Op 10C: Emilio reports they've reached 1.30m in

northward extension, Lat 2, 2A, 2B (25, 26) empty  
 have asked him to take them down in alternating levels

5A/2 - also has small bits of charcoal

5A/3 - A-horizon, bone (covered pieces), white (jade), obsidian

Next - also in dark brown matrix with jade/obsidian

bone in these lots is very fragile and often difficult to remove - pragmatic decision made to try to recover by hand but not to lose time trying to heat as if the deposit were a burial - if only the soil weren't so untractably hard!

10C: After nothing being found but for one piece burnt end  
 130-140 cm - Lat 10C/28 (mud)  
 130-140 cm - Lat 10C/27 (sand) empty



Op 10g: at a 90cm down, gite + shaka shae, in lat 10g/15

see Kate Lorenz' notes (Excavator #9)

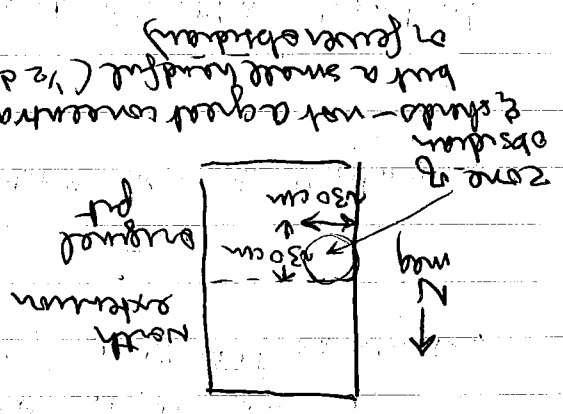

Str 16 - still clearing

aa/5 Str 19 - general surface collection:  
picked up a marble fragment at south end,  
not apparently related to gravel tests

→ Str 19: 60-70 cm - shaka, gite

starting to hit stone (chert)

Banning 3: Mark shot in NE corner of excavation SA with tracer

Someone with a small group found the fields - perhaps  
Mama Lopez? Banning pointed out his car as  
it passed since at lunch - told Kate to have  
10g but tried elsewhere/not so high (I was  
not there so did not hear tone)

10C: Banning reported they're reaching 1.60m.

- all very small lots
- South/North
- 27/28 130-140 cm
- 29/30 140-150 cm
- 31/32 150-160 cm
- 23 shaka, shaka, gravel clay
- 24 shaka, shaka, gravel clay
- 28 gravel clay
- 29 shaka, shaka, gravel
- 30 shaka

PSB

June 11, 1983 (Saturday)

Moved heavily at night in S.B. power off for an hour or so - fence markers on pre-down turn (think dry? better?)  
 No rain at all; we are told, but morning is "cast" and very humid - STAY!

10C: reaching pit below 1.70 m -  
 lots 10C/33 100-170 cm signed to over 3 shells  
~~10C/34 100-170 cm with skeleton from here~~  
 10C/34: 170-180 cm overall

(Emilio to Margarita yesterday off 4)  
 at about 1.70 m beginning to reach level of "hunt" (very sandy) rock  
 by "pit" side (west vs. south) so put in 10C/33 but not separated

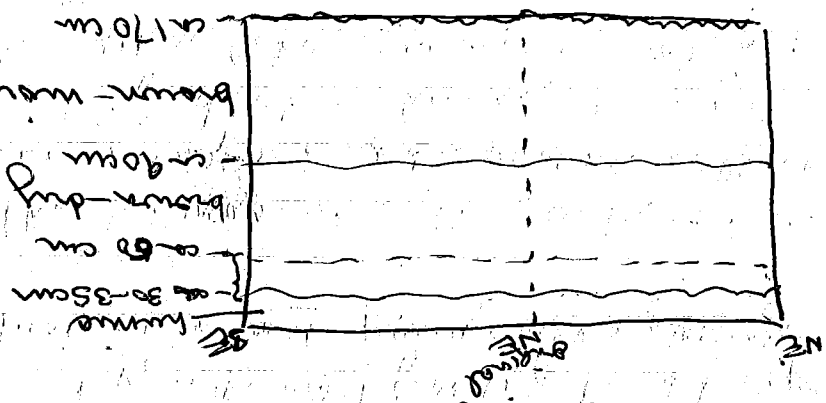

10G: Kate supposing - getting a layer of stones, no shells on shells - have asked her / them to clean it off in both halves to see if it's a "piso" feature

3A: down to 1 m (5A/12 = 90-100 cm) with no more shells

enough a <sup>layer</sup> of something - but temporarily for pit in

10I put Margarita's Guedalupo on new test, southeast corner of 8R16

Mues and Juan Miguel still cleaning that structure

P83-7-41

6/11

thoughts on 10c: possible summation of "bedrock" depth - the area covered by ancient deposits how deep was the road work cut?

near the sheds from 10c/33 hole from there - they seem so large and so anomalous (large, good condition; why found between other similar but reported identical systems and others? just examined excavation this morning??) for an excavation that produced so little, is this an attempt by workers to overcome frustration??

10c: late sounding frustrated at keeping workers

doing what's desired - Alvaro looks and does what's asked - Edilberto is less adept at same - problem with necessity of artifacts / artifacts continues - gets better but in all opt. less than 100%

10c: soil samples taken: 110-120 cm down let 35 170-180 cm down let 34 70-80 cm down let 21

10c: 10c/16 50-60 cm from surface: shreds & obsidian

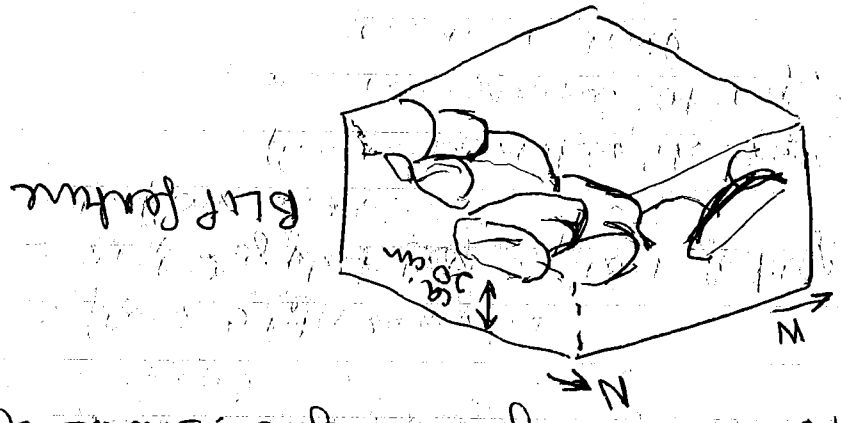

1183-7-41

11/14

Notes:

105: Kate sitting outside a sample of guano for cat  
 Bill says (a) stool not in river, discharge as  
 previously and (b) contamination factor  
 network a problem  
 101: Bill feature looked like it may be near (cave)  
 9 ~~out~~ out on terrace of 8r-16

101: killing very little  
 that while Kester north of 22 E NW of 8r 14 is  
 very unproductive of cultural debris -  
 perhaps the line west of the soccer field is more  
 than a ~~large~~ limit, but what an odd place to  
 "define out"

took Bill back to SB to ① go to Negravich and check in  
 and ② get carpenter started on roofer screws  
 while at the house a man named Alejandro Nolas came  
 by with a letter for Ed from the Instituto - Novas  
 has no office at the corner of our street and was asked  
 by the Insto for perhaps Turismo, I wasn't clear) to  
 offer no assistance

Back at site: checked out axes, and climbed hill to  
 rear of site to take photos.

83-7-E1/2 View of 8r 12 + ② 10g + Lopez house from East  
 3/4 View of 8rs 1, 7, 13 from above, looking SW  
 5/6 View of Group I from above, looking SW  
 7/8 View of 8r 12, Lopez house, soccer field, from SE  
 9/10 View of Group I from above, view to west-southwest

Afternoon:

cleared for take photos

83-7-E1/12 ② 10F, north & east faces, scale 1m vertical, 50cm horizontal  
 -F1/2 ② 10E, " " " " " "  
 -F3/4 ② 10K, " " " " " "

83-7-47  
6/15

105 - Kate's men found several <sup>adult</sup> ~~small~~ human teeth with roots, very worn - no sign of a burial -

see if they are getting confused through footwork  
and - center taken through - Kate has elevation data

5A: bucket samples starting with 5A/15

buckets filled to 9 cm from rim

5A/13 0-10 cm  
5A/14 10-20 cm  
5A/15 20-30 cm  
5A/16 30-40 cm

shards, gulls, obsidian volume  
shards, obsidian, clay, shell, obsidian volume

Took photos:

83-7-F5/6 8r16, cleared, from south  
7/8 8r16, cleared, from northwest  
9/10 8r16, cleared, from east

1052

106: Kate finding new bone - she is proceeding to clean it with pressure, brush & fine tools

Flotation: 15 216 to Brie, now filling a third bucket

with 5A/17 (40-50 cm) (5A/17 has shards, gulls, & unflaked sample)  
8r24: cleared, now all 4 of the 23/24 clearing room

are working bedrock on 8r24

unflaked segment

5A/18 50-60 cm - flaked + shards, gulls, chert

5A/19 60-70 cm - flaked + shards, gulls

5A/20 70-80 cm - flaked

8r.m.: Paul got fish underneath, tiny snails, some charred debris and minor debris in lots flaked in the morning

5B having Barney measure diameters of stone tools for plan; 2 workmen excavating north from 10F to trace 106: Kate proceeding on burial

Arch outst (coarse)

28

91-51/9  
b7c-L-88d

601

The End, Amy & Mark arrived back from survey  
 at 3:45, the rain began - Ed helped Kate  
 dress plan - P.S.D. 2, chud burial  
 (D83-9-3) - RATN RATN RATN

10I/10: ~~Sheds from within forest of Kona~~  
(edge (BLP) in northward extension - Shards  
5A: 5A121, 80-90cm - Shards } end of middle  
5A/22 90-100cm - empty }

5A: 5A121, 80-90cm → stands } end of muddier  
5A122 90-100cm - empty

June 16, 1983 (Thursday)

cof, found, breakfast morning - round house  
at night, here and in S.B.

10K 10K/11: ~~50~~ 9-Liter sample taken from barrel

not being, for location (background noise)

→ I think the top of the hill was the place

There was the face  
sur face, as also four

~~Don't know~~

~~Samuel Jones~~

Other  
set

08/14 from  
stems of female  
oaks, and nuts  
with 12/18

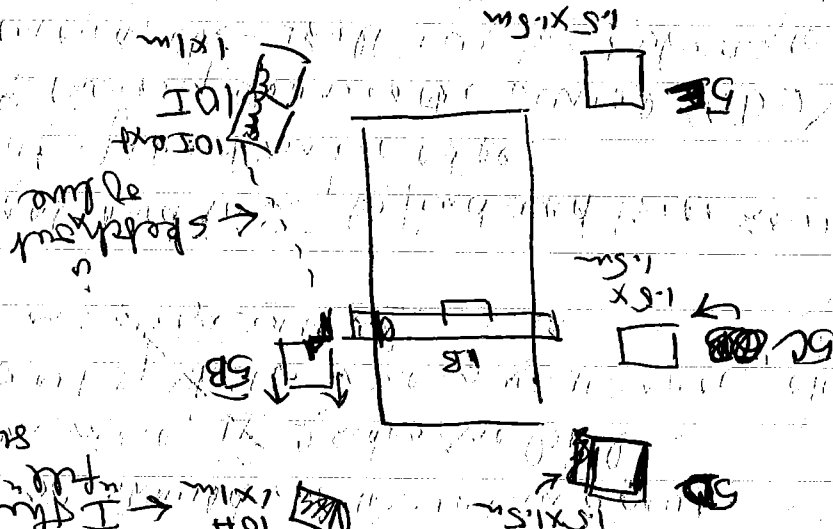

↓ N

GB: carbon sample from 40-45 cm below surface at west face of excavation, 2.54 m from north side of 1B

5C/2: 30-40 cm - shales

5C/3: 40-50 cm - shales, bone } in red-brown clayey matrix with some shales  
 } plantation sample taken (removal debris context?)

5D: 5D/3: 10-30 cm - shale matrix - shales, obsidian  
 5D/4: 30-40 cm

5E: 5E/1: 0-10 cm shales, obsidian in matrix  
 5E/2: 10-20 cm shales, obsidian "  
 5E/3: 20-30 cm shales - changing to red brown  
 5E/4: 30-40 cm shales, obsidian - red-brown  
 5E/5: 40-50 cm shales, obsidian - red-brown

some shales - shale no

construction, but for some

possible flume at NE corner  
 5F: 5F/4 = 0-20 cm (at west edge) shales, obsidian - like

petite

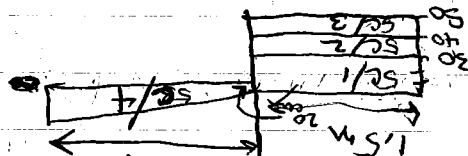

5F: 5F/6: shales, gate of rotation sample

shales

10T/11: surface to construction

10T/12: shales, south exposure

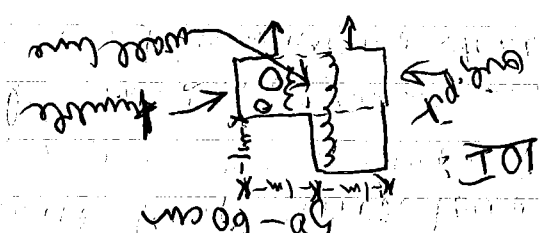

1017.5E beginning to use Bird's newly made  
 (last night, my carpenter Don Bado found)  
 1 scenario - goes slowly

10G: Kate having them level out at base of excavation,  
 to 1.50 m, preparing to carrying to level road  
 layers, at which point we deal with the stone feature  
 at south end of trench

Herne edge on east  
 but not west suggests  
 formed edge to all of  
 Group III - shall be very  
 interested to see how  
 far south it continues -  
 to SR 15, part of, turning  
 right or left?

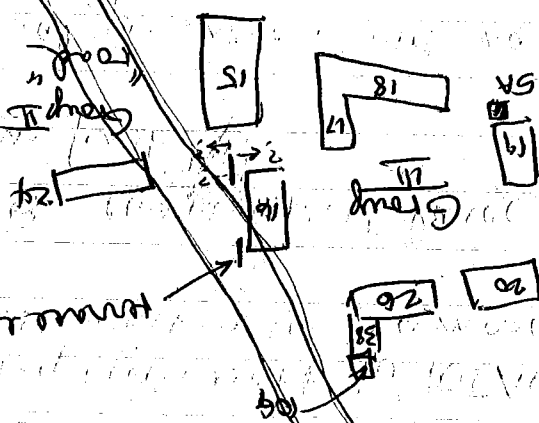

Barrow making notes on adobe found atop SR 16 summit -  
 -same archaeology?  
 (18/3) flooring and/or wall material? The nature  
 of smoothing (i.e., uneven/surfaces) + disposition within  
 south facing (18) extension, excavation suggests at  
 least some was floor surfacing

frustrated that - now I've asked him to travel clear  
 the shores of 10I, to define better these which are  
 in place 3 Kate (to east and west) which may  
 be female

28/ Kate - metal fragment from near 10G (surface)

corn in Group III has sprouted - not up yesterday,  
 today up 2"



RSB

183-7-55

6/17

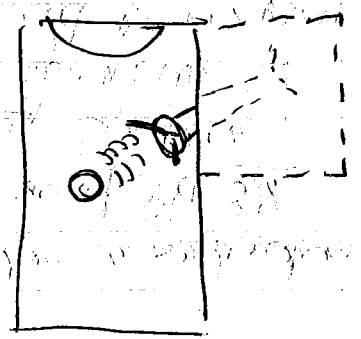

Keep one WSW of excavation - arranged  
were loose in dirt, sand quite possibly  
destroyed fine parts visible. If we  
don't go after possible grave goods  
by feel, someone else will, so  
working excavation expanded 1.5 x 1.5 m  
to WSW - and hit 3rd feature first  
and must draw, so putting for  
rapid cutting - Arranged in pit

106/

Lot 106/52: surface to D1C

Remains on knicker, Remains of Plate on  
scour.  
New Mangrove / ~~100~~ Guadalupe brought on  
to the 3rd screen

- Got to level of D1C - added to plan D83-9-1

Remains to proceed further

BE/12: 50-60 cm below surface - stands well below

top of mound

Evening, Pat has examined a number of stone lots  
As & 9B are late Classic, as expected, as is 5A

(which latter also has yielded at least 2 pieces  
of green obsidian) - but 106 & 104 are not later

than Early Classic (at least there is nothing  
that is diagnostic of Late Classic, and a number

of pieces that are likely Early Classic continuations  
of late Preclassic types/mods) - as high as  
30 cm from surface, and the rest - from  
50-60 cm or so on down - is pure Preclassic

This is especially interesting in that surface configuration

June 30, 1983 (Monday)

Little more rain - day came up with low clouds that (by 8:10) are rapidly burning off

John & Kathryn in excavation this week -

sent them 1st with Bill to see Petition work (he has a 10g sample from Friday to process)

Labor: hired 4 more people from Sra Los but -

Radio Laura's sub-caps and Ureco/Pancon immediately objected that it was unfair -

am trying to tough it through but it's not

great

Ringo objected that 16/day meant 124 to him total

for round-the-clock duty Sat noon through

Monday a.m., rather than the 12 we had understood - I said I'd talk to Ed & Pat about it

#2

#1

Excavations:

10g: shoe wet, with standing water in north-west

50 cm extension - lowering Alamo and Alamo

clear it up before proceeding with "column excavation in west extension - looks feasible but costly of time

5B: suspended - heavily mud-filled but no standing

5C: No standing water, but lowest section now

only 40 cm deep (10 cm of sitting) - Margate

and 6 made large piling, easternmost section

of it, to push eastward toward wall - now in 5C/7

suspended in favor of 5C

5D: shoe young in eastward extension

5A: not as solid as I'd found - drainage through the

beard layer, some better - heavy Ureco and

Guano's substitute for the day, Urubol, clean it

out to drain

BSTA = being called Black Stone Type A by all staff - to be formally identified geologically in US if we can take some back draft in

5A: Bill drawing section for me took photos 83-7-53/4 of hand-drawn 83-7-53/6 of 101A solid in after rain

5F: put wires and Cin to bed in following wall 3 to north to corner

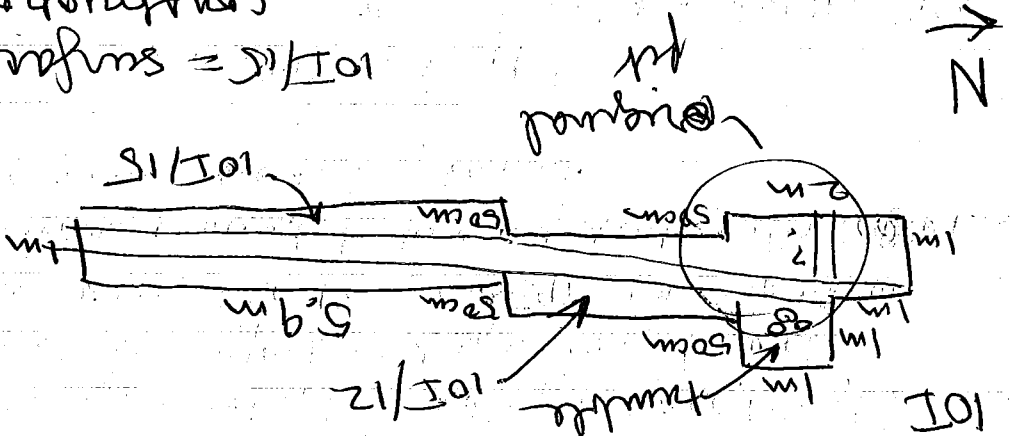

101/15 = surface to construction in and east extension

10G: 10G/56 - 70-80cm in well order of 1000's, just, short  
→ short sample for dating - flotation sample

Fail/frustration morning

pm: took photos 83-7-51/8 of 5A from SW, scale 1m  
Marius hopes here - cleared a bit by fence side  
910L: nothing coming out so abandoning screening in favor of speed

6/20-21

P83-7-61

5F/1 Surface to construction in northward  
trench facing Wall 3  
Arado, obsidian

June 21, 1983 (Tuesday) - Summer Solstice

morning cloudy and relatively cool -

Yesterday afternoon had heat so as well, after

scorching late morning - rained here and in S.B.

during the night

~~labor~~ paid watchman from last night & another L6 to

weekend watchman

hired 4 new men: Cristobal Pineda Salas

Jose Felix Ray Pineda

Kayrindo Ray

Jaime Rovenes Lopez

have 1 guy working one day to replace Jesus Benegas

who was given day off to make up for work duty Friday night

Katzen, John & Sylvia all helping today

10L: unknown continuing alone to stoke

10G: somewhat wet but the plate we put over it at 4

yesterday protected pretty well

continuing 10G/158: 100-120 cm + flotation

shells for dating  
Arado (including  
pitted blackware  
brief shreds)

inset?  
logging behind  
outset on 2?  
spans?

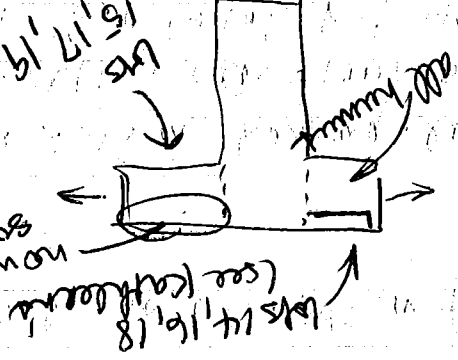



P83-7-65  
6/21-22

5H: through lots as shown in P83-7-64  
as far only humans, large roots from tree (about  
just north of trench line) and a little humbled  
debris - should hit wall tomorrow

10I: took color slide of line of BLIP - they've cleared  
at the partly larger west of BLIP - is it a surface?  
Several large chunks shown as well, which could  
be humbled

5C: most frustrating - wall seems to be intact  
until where first encountered, in main  
trench line: disappears (what corner?  
outset were the kind?) to south and becomes  
much more disturbed immediately to north  
Several roughly shaped blocks from humbled  
(see Kahl's notes for measurements &  
also for notes on lots)  
7H: had Ed reassure me that there was a wall  
there to north - that's how coming it is  
Other problem: base of the wall well above  
inferred piers - level - where with terrace  
on step?

5H: shall continue (i.e., focus) on 5H section to get  
clearer idea of sequencing of features

June 22, 1983 (Wednesday)  
8:00: muggy, warm, partly cloudy - will burn off?  
10G: Box 2 film - logging, Amy & Mark screening - to  
get buried exposed photographs & drawn (BDAH)  
(must leave early today - ca 2-230 - ~~at 2:15~~)  
must leave at migration)



P83-7-69  
6/22-23

5c: took photos of hunting area and at mouth  
end of Gr 16 - scale 1m - looking North

\* photos of 10g-SD3 and 5c wall are 83-7-H  
but notes written later and order of taking  
forgot (things began to happen quickly)  
at 8d & 9 had to leave early to return permits  
to Ken country (at Migration) - probably  
10g shots were at 2, therefore ~~also~~ instead of 7/8  
7/8 9/10

10g: no feet - Abolition ended at arches

at 4 (after returning from migration) took  
photos 83-7-11/12 - plan drawing in progress  
I 1/2 - SD3 from SW,  
scale 1.09 m, compass points  
angle of orientation 50°  
note: "pit" in photos is excavation by-product only

June 23, 1983 (Thursday)

morning & store - no rain at night or now - few  
clouds by 9 a.m.

for the on car east on the 805 in San Barbara  
(space was low for flat - i.e., going flat) as  
well as had back fixed)

Rice back on flat  
for me today to help (counts for plan of Gr 16)  
as are Katherine & John

10g: 0-10 cm = nothing but humus  
10g/2: 10-30 cm - still humus, with plants, obsidian and  
modern cow tooth  
scanning 1/4"



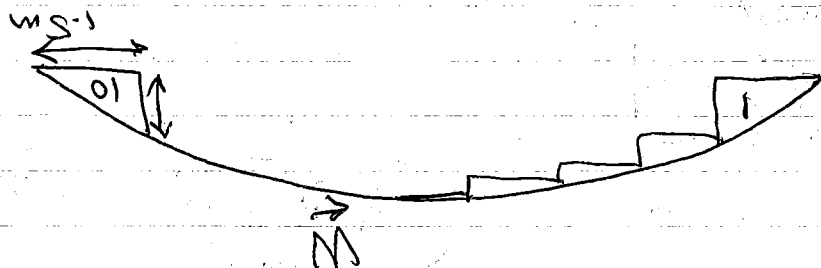

Let 11 is from 1/2 sectioning in front of Mantia  
down to even with base of let 1 (see P83-7-64  
and Kallieris notes)

10R: 30-40 cm. Archa

10Q: let 10 1/2: 0-10 cm (after leveling) (sheds, the dia

in clayey humus

10Q/3: 10-20 cm - handful of sheds, 1 shed

10Q/4: 20-30 cm - couple of sheds

10Q is WSW of SW corner of str 1, so one would  
expect well but something related to  
a plaza edge (or similar)

keep getting visitors - Peace Corps people,  
Instituto Agrario, school children - pleasant  
but so distracting; Difficult to attract  
access because so many local pass through  
habitually, to work the cornfield, etc.

3A: down about 50 cm in some places - difficult  
to proceed in levels of any sort in this "unexcavated"  
fill - asked them to clear pit faces of roots & loose  
grit - hope we can keep this excavation  
from too much collapse

P83-7-73  
6/24

P88

June 24, 1983 (Friday)  
muggy, scattered clouds - no rain but might have  
on S.B.

Op 10Q: 30-40' shal (at 100/5)  
Op 10R: 30-40' shal

Op 10P: just begun at 830 - Always & the work  
Op 10G: done - John clearing stones &  
clipping roots

Op 3A: wall feature (RPF) goes down about 1m  
so far - clearing it off for photo - shall have  
to keep up photos quickly on this as sections  
wells (corals dry but) very porous

Op 5C: Marginal/Guadalupe increasing F&D  
in southern extension (lots 40 & 41)

Op 5H: (1.95 m) →  
Bar 11 is all cement, not just 1/2 sectioned  
rotation

Op 10G: took photos 83-7-10 of N & E walls  
scale 2m

Ed has notes on 10P 10A, 10R  
waiting for last contract on other walls to take them

#18 was really a 20 cm level?  
actual depth 103 cm  
93 cm from surface at railroad  
shows

P83-7-75  
6/24

pm: (copy 13)  
5C: where 2, 1 does connect with 7C in a manner  
like 2 & 3 junction at outside

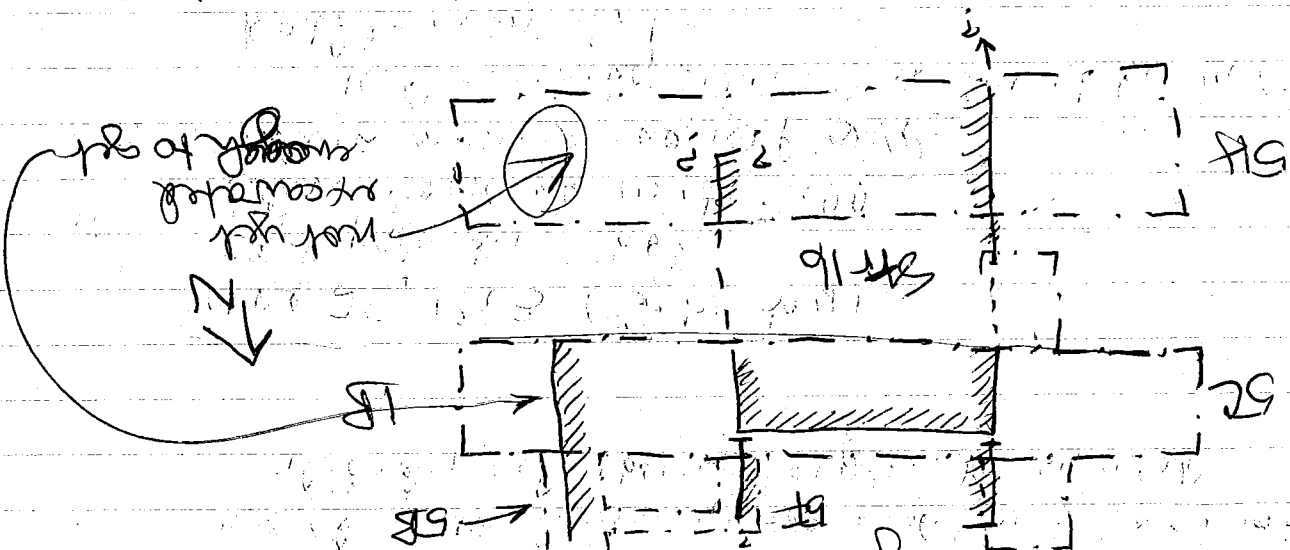

Ed's drawing 7 105 suggests there was a shallow pit, defined by pile distribution, in burial area and that stone feature at SE corner of exc is a cap on it, the water intruded into the layer ? on which the stone feature in the west section was built

3A: At 1.45 m down  
3B: some small shards, smaller stones and clay in south - took flotation sample -

looking a floor?

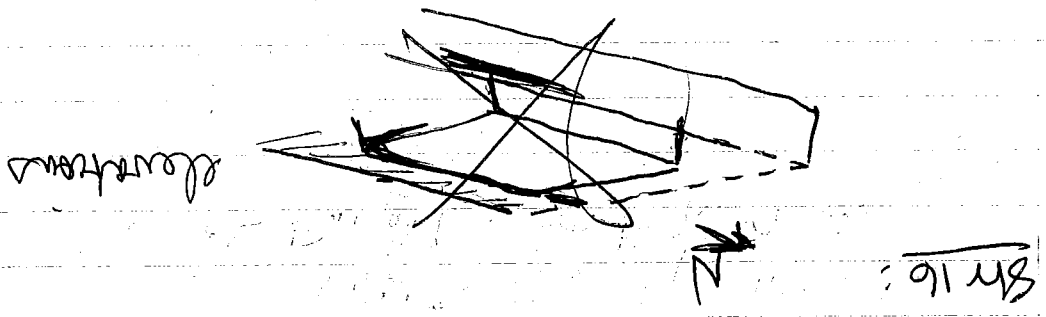





8th 16: where once we got no walls, no floor's coming  
put all over

[sent for analysis from 10/8/2]

5I/1 - floor west of  
5H/1 - fence surface

— fence surface

650956

58, 11, 11, 58

7 13

2

12/2/75

774 51

7

[illegible]

11. 11. 11

161

June 29, 1983 (Wednesday)

conf a.m. - already - no rain in our absence, at least at

Guadalupe (all requests done except 2 & 3 of 12)

3A. Expanding pit to 4x4 to step back down to 21 meter depth

10F: put Miguel & Juan Roman on 1m eastward expansion

(least conflict with milpa activities in 10m wells)

10R: Juan Miguel & Miguel T. finishing - 20-25cm

into basal rock layer and ca 1m down - well

10G. Jose Felix and Guadalupe reaching 100cm, but

from approx 2m on 10D

to 3B - no stands at 10G coming out - still

in damp clay - 2 stones in south section at 75cm down

10B: Adriano and Miguel to approaching 80cm with

brown clay and no artifacts coming out

Jose Felix & Guadalupe

10I: pulled ~~to 100cm~~ to begin

10J: trench so now just frame of Reyno

on 10I - the big cutting ~~10I~~ well in

(East wall)

10K: extent length measured 35.60m (including

portion on west of road - some slumping undisturbed)

included - estimated center line is 3.50m from

west side of ~~the main~~ trench, but we're putting

ends in 1-2.5m in wall, that way side, to avoid

or minimize problems with large tree to south

trench begins at 15 x 1.5m

1.5 x 1.5m pit put in to

bracket estimated center points

of each side; pit aligned

vertically with alley axis

N ↓

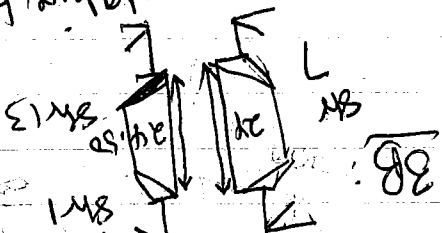

83-7-81  
6/29

100: down to 100/13 (110-120) - rounded gulls but no shreds - still some dark brown clay matrix

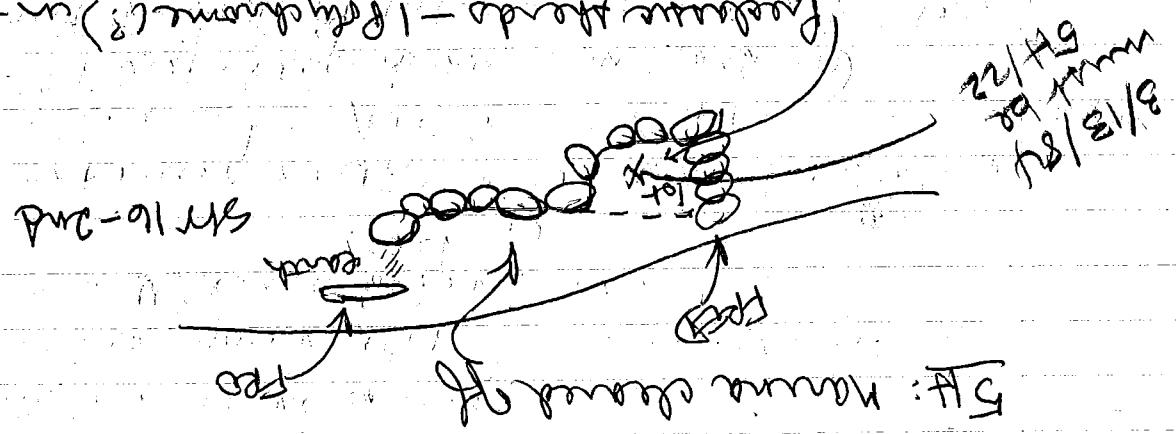

Fracture shreds - 1 Polyethylene (?) in that lot (perhaps from FPO too?)  
State 7 warrant suggests some deterioration (muglet before 8/10-101 (FPO) bust

took photos 83-7-31/12 of Op 5A Manure from SW

5C: 83-7-K1/2 of FPO/Woodget from NW scale 50 cm

4A: 83-7-K3/4 of Bon & tunnel?/piso? to west (wall from NW, with Haiman trench beyond) surface to construction north of Bon - in cludes a piece of possible pluminate

3B: 83-7-5/6 longwall from 817 } BLAST piso NW from K7/8 cleanup from NW scale 50 cm

3A: 83-7-9/10 from NNN } FPO & Bof walls scale 50 cm K11/12 from W

300 a heavy rain coming - packed up shreds - nothing can be done for excavations



PSB

PSB-7-83  
6/30-7/1

p.m.

3A: cutting through 80F floor

3B: down to 90 cm - began lifting lateral rock  
layers approx 50 cm down - ~~then~~ stopping  
cut down (getting tubes and no airlocks)  
and now expanding outward to look to  
SR 1/3 "strain" / slope (playing slope, if it a ballcount)

took photos 83-7-15/12 general view of site  
and of excavations in progress, from road  
above east side of site

Bob (Force Corps) came by - told him about 3A floor  
and in course of chat he tentatively offered to  
store some of our equipment (will be here till at  
least 11/84 and the house has been occupied by  
Force Corps personnel for past 13 years, so likely  
to remain so)

Took faint points on PSB-7-85, to record elevation  
reading and he in Ops 3A, 3B

July 1, 1983 (Friday)

no more rain, but Geologists worked in with fog cleared -  
quite cool

10F: down to 1.20 m - first shado (see Ed's notes from 6/30)  
- new straightening trench under

10G: lifting rock level at 1.00 m

10P: lifting rocks at 1.45-1.48 m

RSB

scope

Mid bottom top distance  
 ground  
 off/scope clear  
 6/30  
 P83-7-85

1470	Station 2 to:	112°30'	05	3.711	3.900	8.85	108°15'	3.775	3.654	3.890	103°58'	3.744	3.654	3.837	100°24'	3.687	3.580	3.796	163.136	160.228	161.138	163.293	164.771	165.301	161.416	162.566	165.074	166.594
1	Op 3A - SW corner	<del>112°30'</del>	<del>05</del>	<del>3.711</del>	<del>3.900</del>	<del>8.85</del>	<del>108°15'</del>	<del>3.775</del>	<del>3.654</del>	<del>3.890</del>	<del>103°58'</del>	<del>3.744</del>	<del>3.654</del>	<del>3.837</del>	<del>100°24'</del>	<del>3.687</del>	<del>3.580</del>	<del>3.796</del>										
2	- SE corner	108°15'	3.775	3.654	3.890	8.85	108°15'	3.775	3.654	3.890	103°58'	3.744	3.654	3.837	100°24'	3.687	3.580	3.796										
3	- NW corner	103°58'	3.744	3.654	3.837																							
4	- NE corner	100°24'	3.687	3.580	3.796																							
5	Op 3B - NE corner	221°30'	6.595	6.445	6.707																							
6	Op 3A - ground pt	<del>108°30'</del>	<del>108°30'</del>	<del>5.685</del>	<del>5.585</del>	<del>5.785</del>	<del>108°30'</del>	<del>5.685</del>	<del>5.585</del>	<del>5.785</del>	<del>236°32'</del>	<del>3.530</del>	<del>3.360</del>	<del>3.700</del>	<del>312°24'</del>	<del>0.400</del>	<del>0.230</del>	<del>0.570</del>										
7	T2 to T3																											
8	T3 to T2																											
9	T3 to T4																											
10	T3 to T7																											
11	T3 to T5																											
12	T3 to T6																											
13	T6 to T3																											
14	T6 to T7																											

Station 2 to:

1470

112°30'

05

3.711

3.900

8.85

108°15'

3.775

3.654

3.890

103°58'

3.744

3.654

3.837

100°24'

3.687

3.580

3.796

163.136

160.228

161.138

163.293

164.771

165.301

161.416

162.566

165.074

166.594

Op 3A - SW corner

Op 3A - ground pt

Op 3B - NE corner

- SE corner

- NW corner

- NE corner

NE corner

NE corner

SW corner

SE corner

NW corner

NW corner

NE corner

NE corner

NE corner

NE corner

NE corner

NE corner

NE corner

NE corner

NE corner

NE corner

NE corner

NE corner

NE corner

NE corner

NE corner

NE corner

NE corner

NE corner

NE corner

NE corner

NE corner

NE corner

NE corner

NE corner

NE corner

NE corner

NE corner

NE corner

NE corner

NE corner

NE corner

NE corner

NE corner

NE corner

NE corner

NE corner

NE corner

NE corner

NE corner

NE corner

NE corner

NE corner

NE corner

NE corner

NE corner

NE corner

NE corner

NE corner

NE corner

NE corner

NE corner

NE corner

NE corner

NE corner

NE corner

NE corner

NE corner

NE corner

NE corner

NE corner

NE corner

NE corner

NE corner

NE corner

NE corner

NE corner

NE corner

NE corner

NE corner

NE corner

NE corner

NE corner

NE corner

NE corner

NE corner

NE corner

NE corner

NE corner

NE corner

NE corner

NE corner

NE corner

NE corner

NE corner

NE corner

NE corner

NE corner

NE corner

NE corner

NE corner

NE corner

NE corner

NE corner

NE corner

NE corner

NE corner

NE corner

NE corner

NE corner

NE corner

NE corner

NE corner

NE corner

NE corner

NE corner

NE corner

NE corner

NE corner

NE corner

NE corner

NE corner

NE corner

NE corner

NE corner

NE corner

NE corner

NE corner

NE corner

NE corner

NE corner

NE corner

NE corner

NE corner

NE corner

NE corner

NE corner

NE corner

NE corner

NE corner

NE corner

NE corner

NE corner

NE corner

NE corner

NE corner

NE corner

NE corner

NE corner

NE corner

NE corner

NE corner

NE corner

NE corner

NE corner

NE corner

NE corner

NE corner

NE corner

NE corner

NE corner

NE corner

NE corner

NE corner

NE corner

NE corner

NE corner

NE corner

NE corner

NE corner

NE corner

NE corner

NE corner

NE corner

NE corner

NE corner

NE corner

NE corner

NE corner

NE corner

NE corner

NE corner

NE corner

NE corner

NE corner

NE corner

NE corner

NE corner

NE corner

NE corner

NE corner

NE corner

NE corner

NE corner

NE corner

NE corner

NE corner

NE corner

NE corner

NE corner

NE corner

NE corner

NE corner

NE corner

NE corner

NE corner

NE corner

NE corner

NE corner

NE corner

NE corner

NE corner

NE corner

NE corner

NE corner

NE corner

NE corner

NE corner

NE corner

NE corner

NE corner

NE corner

NE corner

NE corner

NE corner

NE corner

NE corner

NE corner

NE corner

NE corner

NE corner

NE corner

NE corner

NE corner

NE corner

NE corner

NE corner

NE corner

NE corner

NE corner

NE corner

NE corner

NE corner

NE corner

NE corner

NE corner

NE corner

NE corner

NE corner

NE corner

NE corner

NE corner

NE corner

NE corner

NE corner

NE corner

NE corner

NE corner

NE corner

NE corner

NE corner

NE corner

NE corner

NE corner

NE corner

NE corner

NE corner

NE corner

NE corner

NE corner

NE corner

NE corner

NE corner

NE corner

NE corner

NE corner

NE corner

NE corner

NE corner

NE corner

NE corner

NE corner

NE corner

NE corner

NE corner

NE corner

NE corner

NE corner

NE corner

NE corner

NE corner

NE corner

NE corner

NE corner

NE corner

NE corner

NE corner

NE corner

NE corner

NE corner

NE corner

NE corner

NE corner

NE corner

NE corner

NE corner

NE corner

NE corner

NE corner

NE corner

NE corner

NE corner

NE corner

NE corner

NE corner

NE corner

NE corner

NE corner

NE corner

NE corner

NE corner

NE corner

NE corner

NE corner

NE corner

NE corner

NE corner

NE corner

NE corner

NE corner

NE corner

NE corner

3A: cut through 50' : 28cm thick in 3 bands of small stones - color gets same darker

7cm plaster → 1st stones

- 1) 2-5cm diam in 1st - 8cm thick
  - 2) 6-8cm diam in 2nd - 7cm thick
  - 3) 4-6cm diam in 3rd - 4cm thick
- then brown earth with shade & grit
- 100' : 1.40m - rock level?

Op 10φ: 10φ/4 - nothing - brown clay loam matrix

? Op 10E: reaching 1.60m - no contact - brown clay loam matrix - Ed has lot # notes

Op. 4A: have Ten female - Ros used female described appear to exist here - perhaps the one indicator (in streamer trench, east side) was characteristic of for stones containing "X" trace" and Gon female well are just surfacing of top of Gon

Observation at Site: more important to hear from Site 12, as this is a right of way and well be gone and it's seemingly on Site 12 axis

p.m.:  
Op. 10F: reaching head nodes - 2 juts from basal level (10F/-)

Op 10φ: 10φ/4 - 30-40cm nothing  
10φ/5 - 40-50cm couple of shards  
10φ/6 - nothing yet 50-60

Op 5C: BOATING is already related to MARINA as earlier structure within 16, which deteriorated badly prior to 16's construction - therefore character str. still - 1 to distinguish. Ed suggests relative positions may indicate MARINA is out of plan

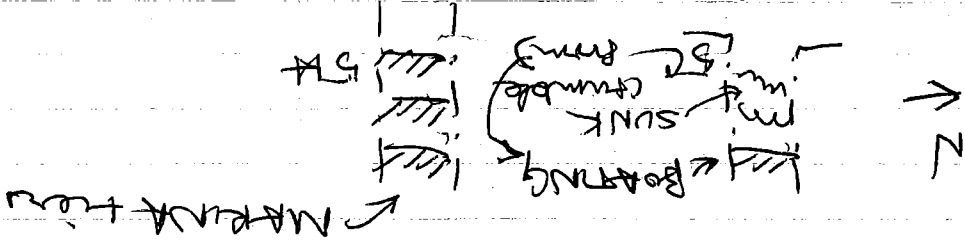

2222  
2051

PSB

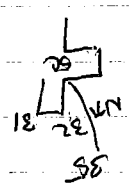

distance	elevation	mult	name
3.04	158.420	3.158	29. BOATING - SW
2.23	158.460	3.118	30. BOATING - NW
6.95	158.608	2.970	31. SW - NE corner
7.63	158.492	3.086	32. NW
6.59	158.418	3.160	33. N TOWER NW
5.95	158.454	3.124	34. NE " " "
4.63	158.868	2.710	35. NCT SW/SE
8.55	158.300	3.278	36. SW - NW corner
9.03	158.310	3.268	37. SW - SW corner
5.46	158.812	2.766	38. SW - SW/SE
8.44	159.049	2.529	39. SC - SW corner
8.04	159.406	2.172	40. SC - SE corner
9.27	158.438	3.140	41. MARINA - top step, N (not in trench wall)
9.01	158.875	2.703	42. MARINA - end step N
8.65	159.510	2.068	43. MARINA - top step
8.67	159.959	1.619	44. FRO - north
10.01	160.009	1.529	45. FRO - south
9.91	159.482	2.096	46. MARINA - top - S
10.27	159.083	2.495	47. - end - S
10.31	158.526	3.052	48. - bot - S
10.72	158.956	2.122	49. FRO - south (SH)
12.00	158.513	3.065	50. SH + SW corner
10.80	158.487	3.091	51. SH NW
9.42	158.980	2.598	52. FRO - north SH
40.8	161.406	[0.703]	53. T 16-1 to T 14

PSB-7-89  
7/1

500.908  
bot top  
PSB-5-14  
con  
172  
172  
172

scraped  
to 45'

July 2, 1983 (Saturday)  
 pretty cloudy, hot  
 cool & in some rain but still

P83-7-91  
 7/2

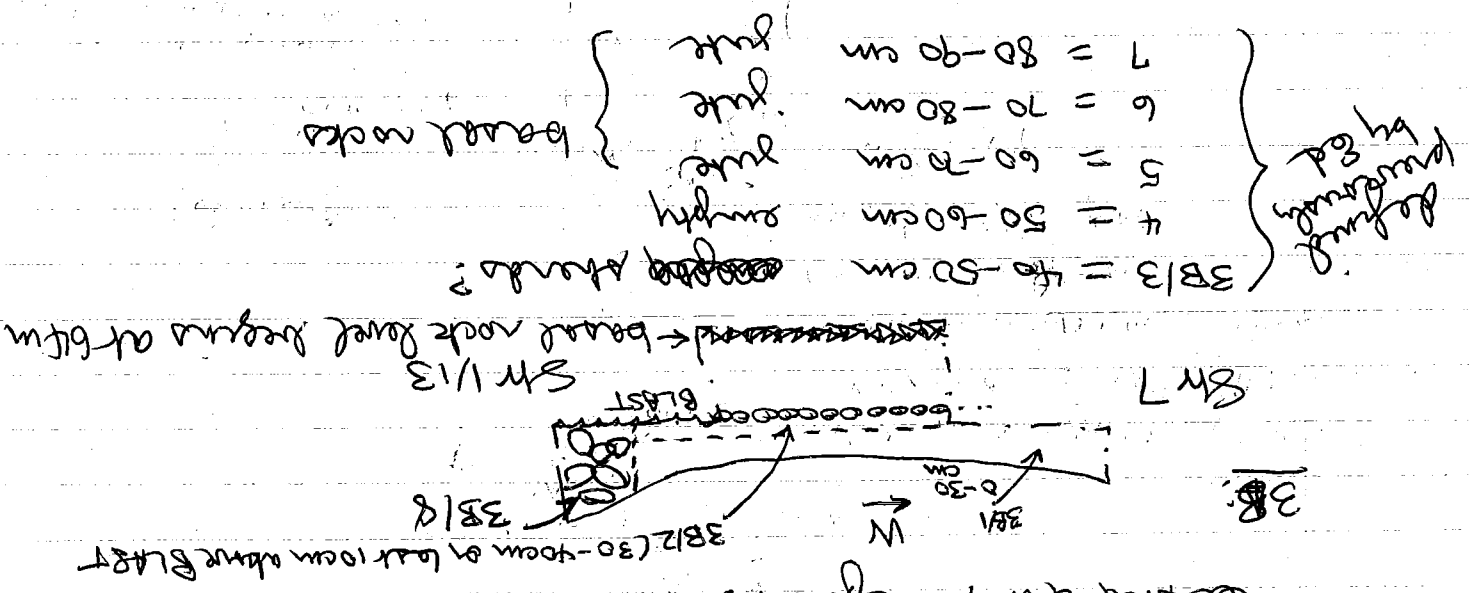

3A: clearing NAT & CAT for photos

10F/100: 3A checking - 10F is finished - 100 to 100-70cm with nothing

take photos 83-7-M 1/2 of Str 48, 100 & layers have (+Str 22) from summit Str 12 (mid ptg same)

to show proximity of Str 48 to top 100 (same distance to 10F) - yet still in the 2 tests  
 Str 48 does indeed appear to be on the axis of  
 Str 12 and therefore focus of anyone approaching  
 Str 12 from its (presumed) front on the west

3B: cutting through humule (3B/8) in soil, have encountered "washed" like parts of FTD in Str 16

with altered but mostly vertical cuttings - 2 sections to south, to see if it is washed - if so, does indeed make more sense as bedrock bench than step

Staircase

3A: took photos 83-7-M-3/4 of BOP with 50F

variable (cut) at base, 5 M 1/2 of BOP base with 50F, 50F & NAT

(WIN)  
area of no stone has very distinct, gray clay matrix, could be fine, but suggests  
1) Areas of Tuck = random mass of buried structure  
• (cf white stone of str 24 & str 16 MAR 1983)  
2) stones of Tuck represent final structure  
3) WIN gap may seal a cache structure to Tuck  
and dedicatory/antecedent to NFF (location  
is on approximate midline)  
shall see on Monday...

Op 100: down to 1.00m - nothing more let 100/6 (50 to 60 cm) <sup>Atene</sup>

July 4, 1983 (Monday)

much rain Saturday and Sunday night, but little  
damage at Anzalaguite (lots of a few stones of  
Tuck at south side of Tuck (get with S.I.); standing  
under in part of 100)

3B: clearing - Anzalaguite and  
3A: go down in 10cm levels from level of stones  
4A: standing on south side of Tuck  
100F: go down 10 or 20 more cm to demonstrate whether  
the basal Atene are the colored layer (some at  
east end turn large and are at level equivalent to  
503 in 100  
100: at 1-1.10m a large stone appeared - see Ed's notes  
where could it be from?

5H: game & foggo began taking down east end of Tuck  
5A: 930 - began on 1.5 x 1.5m pit on east edge of 5H 48  
5H: game & foggo began taking down east end of Tuck

83-7-95  
7/4

Q7A: shoe in humus and apparent parallel tumbles

3A: basal level reached!

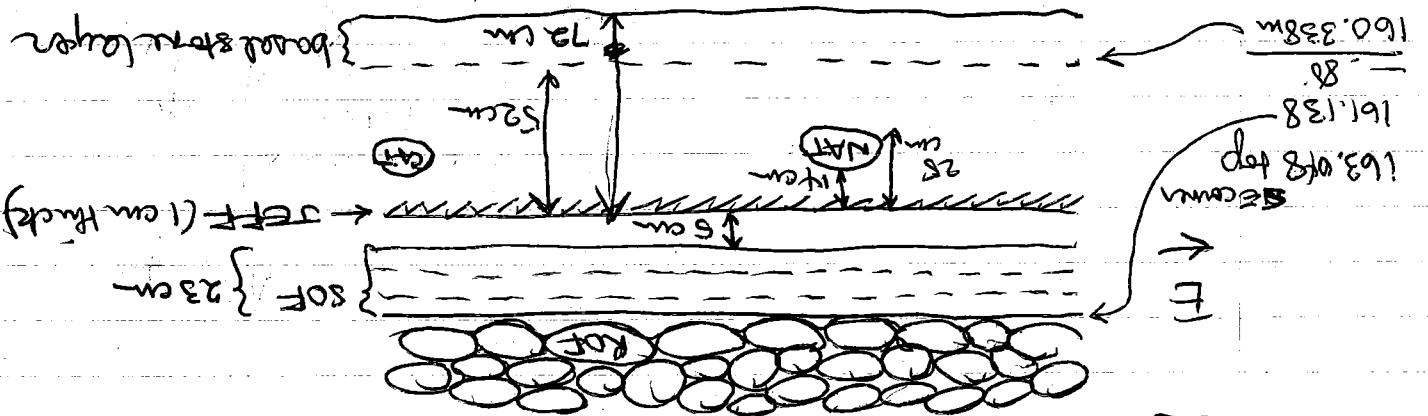

Q33: show D83-1-8: plan (1:10) of NIP/TOC/WIN

PM:

Q7A: Jar 7A/1 0-20 cm - 1 skull, 105 blade (used)

all in humus with tumbled stones

trip photos

83-7-N 7/8 QPSH - wrong label

9/10 QPSH - level fixed - first feature

from east scale 50 cm

11/12 QP7A tumbles of Jar 1 from south

scale 50 cm (compare for orientation since directed to

str 48, not magnetic directions

83-7-01/2 QP3A, excavation completed

from west, scale 50 cm

Ed beginning section/level of road & south side, 3A  
D83-1-9

083-7-97  
7/4-5

10N/1 0-10 cm Aroids (few) (late 15)  
10N/2 10-20 cm Aroids (fewer) (1/2 dozen)  
10N/3 20-30 cm Aroids (1?)

to 0: at 1.50 hitting trail collarium  
with large rocks atop it (partly embedded?  
check when do section)

Rain came on suddenly about 3:45 - heavy,  
a torrent of water & wind!

July 5, 1983 (Tuesday)  
Rain kept up for a couple of hours yesterday afternoon,  
with variable force (drizzle to pouring) but excruciating  
generally of - muggy but not standing in water  
- very recent, much in a.m. (1983)  
3A: 6d returned to drawing on D83-1-9 section/elevation  
3B: in abundance  
4A: Still numerous WOA (lot 4A/9)  
5H: lot 33: material from MIST to level with RAST  
(shards, bone)

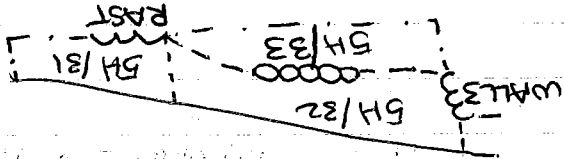

105: between 30 & 40 cm hitting turtle from str 15; humus  
above  
105/1 0-10 cm Aroids, a little  
105/2 10-20 cm Aroids  
105/3 20-30 cm Aroids  
105/4 30-40 cm Aroids, a little



PS3-7-99  
7/5

kind of cattle led into east side of site  
anthropogenic people working seen by 8r22

took photos:

83-7-07/10 Op 7A & 8r12 from 8r12  
11/12 Ops 4A & 5B/H from 8r12  
P 1/2 Op. P5, steno from North, scale 50 cm

Op 5H

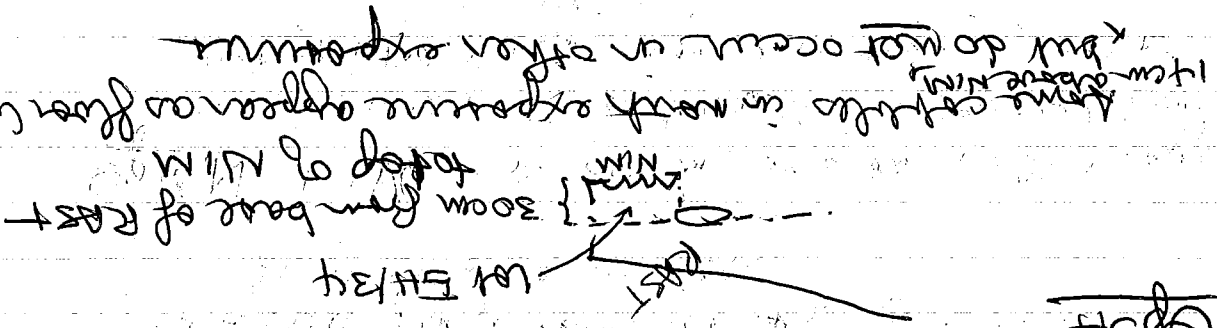

Op 105:

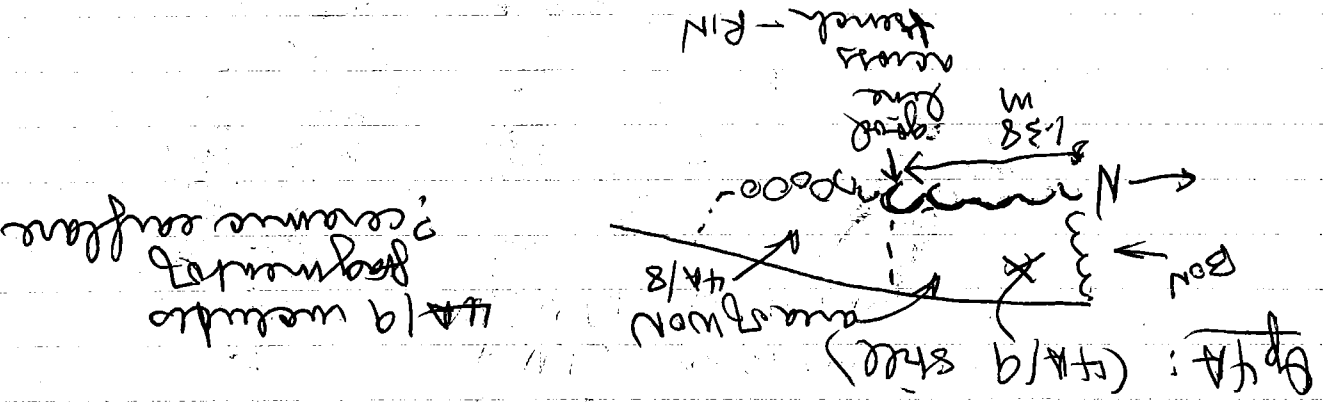
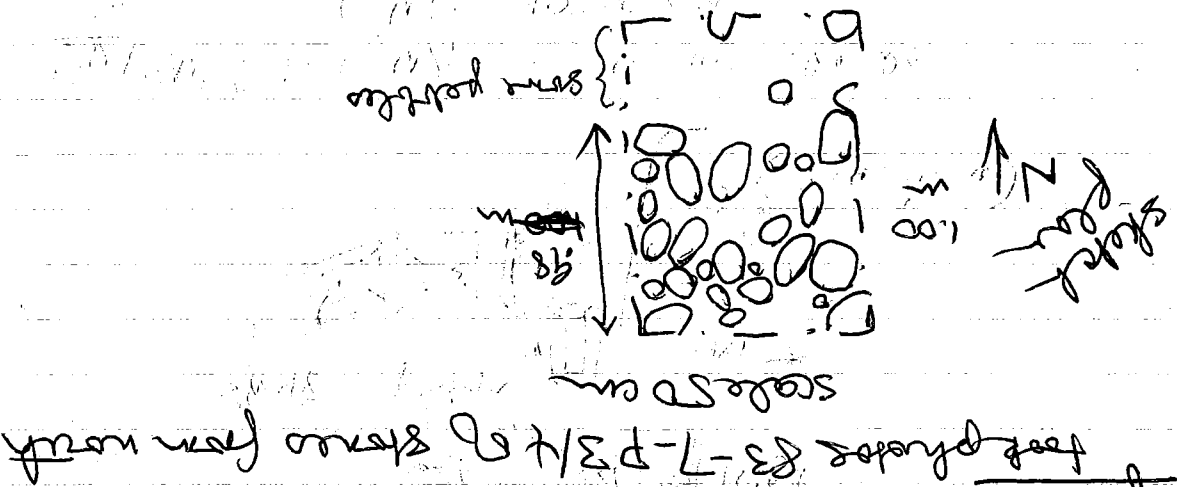

7A: lots 7A/4 0-10 cm in west ext\* - empty  
7A/5 10-20 cm (around stones) - Alreda  
7A/6 20-30 cm in west ext - shadows { plants  
7A/7 30-40 cm in west ext - shadows  
\* 1.5 x 1.5 m, we original pit

having a 2nd extension cleared, to obtain plan  
in so far as possible before roadwork (necessary)  
interrupts

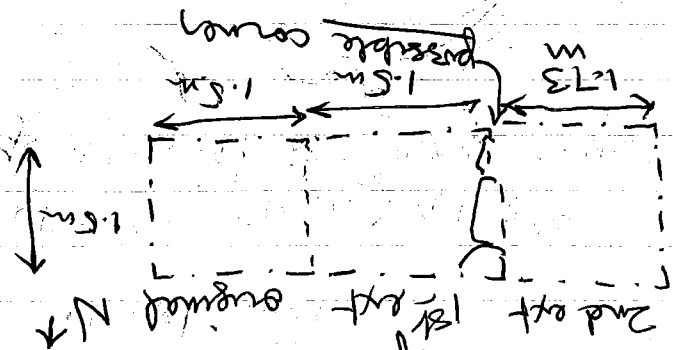

10J: 10J/5\* - 40-50 cm shadows, pile - layers of  
flat cotton root exposure -  
not a pile, but perhaps sitting on one  
10J/6 - 50-60 cm - shadows, pile  
humus = 0-30 cm ± 5

4A: Jose Felix & Cristobal did not know we were saving  
piles - are shaking to do so now

4A/10 surface to construction  
south of TIN  
Alreda (Alreda Pity?)  
Alreda

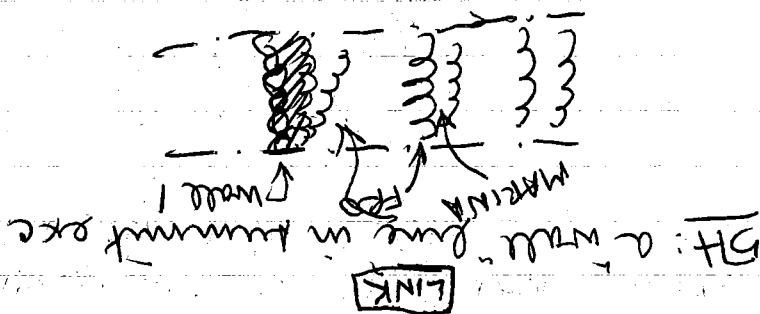

PSB

7/18/29

P837-103  
7/15-6

7A: Oct 7A/8 - weighing 8r 48 u and west extension

took photos 83-7-15/6 Op 7A 8r 48, from east in  
1st west extension: well line (scale 50cm)

7/8 Op 7A, 8r 48 top, from east

scale 50cm (after 2nd west  
extension cleared)

10S: heading apparent "stone" basal columnar

but still with striae overlapping

10S/4 30-40cm striae

10S/5 40-50cm

striae, adobe

10S/6 50-60cm

striae, gule

July 6, 1983 (Wednesday)

Ed gave Pat & students a tour of excavations

- still down 3A open a few days longer to

write Mayer, Gertner, F. 83P comparable

to see

(copied with number that coter daughter was keeping

that we were finding & smuggling gold -

why would one make up such nonsense? It's

no potentially damaging to the project & to

us, we've got to stem this - hope it doesn't reach

Ed & Mark supervising area; John doing

accumulated Petahon samples - 9' including 3B

3B: test soil sample & will save matrix for  
Petahon -

Oct 3B/10 = contents of apparent pit

poured pit (matrix changed) boundaries

and dated in on 283-1-8

WIN purplish gray clay (?) is a "cap" 13cm thick (top roughly

even with top of Tuck stones

underlain by some brown cl w/ pebbles as makes up BLAST

P83-7-105

7/7

RSB

AS=162.706m

A		(HI)		A		Top		Bottom		Elev		Dist		Slope	
+	472	1	35 to 73	15958'	1.000	1605	0.395	163.259	121.1	159.398	131.0	45'	-25'	—	—
+	4353	2	75 to 105	162010'	3.400	4.060	2.750	159.766	106.0	159.766	106.0	—	—	—	—
—	—	3	SE 44	16650'	3.965	4.487	3.427	159.766	106.0	159.766	106.0	—	—	—	—
—	—	4	Compass	16624'	3.142	3.650	2.638	160.589	101.2	160.589	101.2	—	—	—	—
—	—	5	TIN	16624'	2.912	3.412	2.412	160.819	100.0	160.819	100.0	—	—	—	—
—	—	6	RIN	16605'	2.980	3.473	2.472	160.751	99.0	160.751	99.0	—	—	—	—
4.252	7	4A NE	16524'	4.000	4.445	3.563	159.475	88.0	-10'	159.475	88.0	-10'	—	—	—
4.252	8	4A NW	16625'	4.000	4.440	3.560	159.475	88	-10'	159.475	88	-10'	—	—	—
4.021	9	NE 107	172028'	4.000	4.358	3.642	159.710	71.6	-41'	159.710	71.6	-41'	—	—	—
5.135	10	NE 102	155047'	4.223	4.448	4.000	158.596	44.8	-1010	158.596	44.8	-1010	—	—	—
5.510	11	NE 100	22614'	4.000	4.130	3.869	158.224	26.1	-3019'	158.224	26.1	-3019'	—	—	—
5.169	12	NE 107	34115'	3.500	3.620	3.330	158.522	29.0	-318'	158.522	29.0	-318'	—	—	—
<del>5.538</del>	13	<del>NE 107</del>	<del>34115'</del>	<del>3.500</del>	<del>3.620</del>	<del>3.330</del>	<del>158.522</del>	<del>29.0</del>	<del>-318'</del>	<del>158.522</del>	<del>29.0</del>	<del>-318'</del>	—	—	—
5.477	14	NE 107	298010'	3.105	3.312	2.900	158.754	41.2	-3018'	158.754	41.2	-3018'	—	—	—
5.648	15	NE 100	307024'	3.705	4.000	3.414	158.083	58.6	-1054'	158.083	58.6	-1054'	—	—	—
5.626	16	NE 101	316045'	2.875	3.500	2.490	158.105	8.0	-1050'	158.105	8.0	-1050'	—	—	—
6.149	17	NE 104	32034	2.270	2.850	1.680	157.882	117.0	-1054'	157.882	117.0	-1054'	—	—	—
6.459	18	NE 107	322045'	2.000	2.720	1.260	157.292	146.0	-1045'	157.292	146.0	-1045'	—	—	—
9.212	19	NE 107	322045'	3.000	3.890	2.110	157.579	178.0	-20	157.579	178.0	-20	—	—	—
5.769	20	NE 100	308054'	1.860	2.430	1.310	157.962	112.0	-20	157.962	112.0	-20	—	—	—
5.857	21	NE 100	301030'	<del>2.430</del>	3.375	2.545	157.883	83.0	-20	157.883	83.0	-20	—	—	—
5.532	22	NE 100	285030'	2.000	2.302	1.698	158.149	60.4	-3024'	158.149	60.4	-3024'	—	—	—
5.429	23	NE 107	25028'	2.715	2.935	2.494	158.388	44.4	-3025'	158.388	44.4	-3025'	—	—	—
5.156	25	NE 104	193030'	1.306	1.631	0.985	158.564	6.6	-3025'	158.564	6.6	-3025'	—	—	—
3.592	26	SW 16	19055	0.645	1.020	0.275	160.139	74.5	-2016'	160.139	74.5	-2016'	—	—	—
4.875	27	NE 101	18106'	1.355	1.802	0.912	158.880	89.0	-2016'	158.880	89.0	-2016'	—	—	—
14.467	28	NE 105	174029'	1.720	2.302	1.104	159.213	8	-1023'	159.213	8	-1023'	—	—	—
2.038	29	SW 24	163016	1.385	1.878	0.400	161.493	97.8	-30'	161.493	97.8	-30'	—	—	—

558

107-7-383

2/11

Δ Mud Top Bottom Floor Dist Sample

Station	Altitude (m)	Temperature (°C)	Humidity (%)	Wind Direction	Wind Speed (km/h)	Clouds (%)	Notes
1. BW 15 msc	22340	2.276	3.551	223°40'	3.551	223°40'	2.276
2. PIER - south	223°40'	3.551	223°40'	3.551	223°40'	3.551	223°40'
3. PIER - south	217°56'	3.685	217°56'	3.685	217°56'	3.685	217°56'
4. PIER - N	237°24'	2.747	237°24'	2.747	237°24'	2.747	237°24'
5. PIER - N	311°15'	3.002	311°15'	3.002	311°15'	3.002	311°15'
6. SW SD	317°04'	3.235	317°04'	3.235	317°04'	3.235	317°04'
7. NE SD	322°25'	3.220	322°25'	3.220	322°25'	3.220	322°25'
8. NW SD	310°58'	3.135	310°58'	3.135	310°58'	3.135	310°58'
9. SW SD	304°35'	3.400	304°35'	3.400	304°35'	3.400	304°35'
10. PIER - S	214°35'	2.653	214°35'	2.653	214°35'	2.653	214°35'
11. PIER - S	194°16'	2.546	194°16'	2.546	194°16'	2.546	194°16'
12. PIER - NW	195°06'	2.888	195°06'	2.888	195°06'	2.888	195°06'
13. PIER - NE	188°47'	2.806	188°47'	2.806	188°47'	2.806	188°47'
14. PIER - W	186°51'	2.946	186°51'	2.946	186°51'	2.946	186°51'
15. PIER - W	190°08'	2.935	190°08'	2.935	190°08'	2.935	190°08'
16. PIER - S	191°42'	3.013	191°42'	3.013	191°42'	3.013	191°42'
17. SW SD	189°22'	3.085	189°22'	3.085	189°22'	3.085	189°22'
18. SW SD	182°55'	2.743	182°55'	2.743	182°55'	2.743	182°55'
19. PIER - S	183°50'	2.963	183°50'	2.963	183°50'	2.963	183°50'
20. SW SD	180°25'	2.670	180°25'	2.670	180°25'	2.670	180°25'
21. SW SD	181°45'	2.375	181°45'	2.375	181°45'	2.375	181°45'
22. SW SD	177°05'	1.870	177°05'	1.870	177°05'	1.870	177°05'
23. SW SD	174°55'	2.138	174°55'	2.138	174°55'	2.138	174°55'
24. SW SD	177°20'	2.290	177°20'	2.290	177°20'	2.290	177°20'
25. SW SD	177°10'	2.420	177°10'	2.420	177°10'	2.420	177°10'
26. SW SD	181°40'	3.092	181°40'	3.092	181°40'	3.092	181°40'
27. SW SD	185°57'	3.248	185°57'	3.248	185°57'	3.248	185°57'
28. SW SD	181°02'	3.224	181°02'	3.224	181°02'	3.224	181°02'
29. SW SD	185°	3.312	185°	3.312	185°	3.312	185°
30. SW SD	154°	3.057	154°	3.057	154°	3.057	154°

PSB

Top Bottom Elev. Dist. Scept

62 NW back	45.45	2.105	159.484	3.72	—
63 NW 10ft	34.70	3.028	158.561	10.14	—
64 NE	35.39	2.978	158.611	9.90	—
65 SE	35.23	2.975	158.614	8.81	—
66 SW	34.50	3.005	158.584	8.97	—
67 fence line	28.12	2.560	159.029	9.16	—
68 fence line	10.30	2.473	159.116	9.73	—

RAIN

8448 7848 158.193 scope 159.573  
7848 158.193 scope 159.573  
7848 158.193 scope 159.573

37.2  
162.709  
158.223  
158.223

1. 8448 7848	122.30	1.350	158.223	8.23	—
2. 7A SE	242.15	1.350	158.223	8.23	—
3. 7A NE	258.20	1.370	158.203	5.15	—
4. 7A S → S	244.22	1.281	158.292	7.60	—
5. 7A S → W	240.20	1.287	158.286	7.70	—
6. 50 Nall, east	244.40	1.634	157.939	8.38	—
7. E wall, south	247.05	1.451	158.122	7.99	—
8. E wall, end	253.48	1.418	158.155	7.75	—
9. E wall, south	260.30	1.298	158.275	7.65	—
10. 7A NEpt SEcur	260.00	1.282	158.291	7.20	—
11. NE SW 18	265.15	1.358	158.215	7.68	—
12. N. apt NE cur	272.30	1.333	158.240	7.34	—
13. 8448 NW cur	263.10	1.493	158.080	11.57	—
14. NW cur N. apt	267.50	1.259	158.314	12.16	—
15. W side front	259.45	1.256	158.317	11.95	—
16. road (leg)	262.05	1.382	158.191	13.40	—
17. road (middle)	261.46	1.200	158.373	16.90	—
18. road (west side)	260.39	1.370	158.203	20.31	—
19. " "	225.00	1.265	158.308	19.92	—
20. " (middle)	225.10	1.121	158.452	16.81	—
21. road (mt)	224.50	1.350	158.223	13.24	—

983-7-109  
7/7

183-7-111

7 Aug

drat

4.98

6.87

6.89

5.83

6.58

7.78

9.37

8.57

6.87

10.07

159.451

159.460

159.466

159.466

159.466

159.466

159.466

159.466

159.466

159.466

159.466

159.466

159.466

159.466

159.466

159.466

159.466

159.466

159.466

SR 16 plan in evening

183-7-111

26 STR 24 -> ST. 5

25 NW

24 NE corner 4A

23 South edge cobbles surface

22 Tm west

21 Tm west

20 Tm west

19 Tm east

18 Mon east

17 Mon west

16 Tm north side west

15 Tm north side east

of

1.750

1.845

3.090

3.023

3.070

3.422

3.425

3.467

3.529

3.482

3.473

0.854

1.340

0.386

159.466

159.466

159.466

159.466

159.466

159.466

159.466

159.466

159.466

159.466

159.466

159.466

159.466

159.466

159.466

26 STR 24 -> ST. 5

25 NW

24 NE corner 4A

23 South edge cobbles surface

22 Tm west

21 Tm west

20 Tm west

19 Tm east

18 Mon east

17 Mon west

16 Tm north side west

15 Tm north side east

of

1.750

1.845

3.090

3.023

3.070

3.422

3.425

3.467

3.529

3.482

3.473

0.854

1.340

0.386

159.466

159.466

159.466

159.466

159.466

159.466

159.466

159.466

159.466

159.466

159.466

159.466

159.466

159.466

159.466

26 STR 24 -> ST. 5

25 NW

24 NE corner 4A

23 South edge cobbles surface

22 Tm west

21 Tm west

20 Tm west

19 Tm east

18 Mon east

17 Mon west

16 Tm north side west

15 Tm north side east

of

1.750

1.845

3.090

3.023

3.070

3.422

3.425

3.467

3.529

3.482

3.473

0.854

1.340

0.386

159.466

159.466

159.466

159.466

159.466

159.466

159.466

159.466

159.466

159.466

159.466

159.466

159.466

159.466

159.466

26 STR 24 -> ST. 5

25 NW

24 NE corner 4A

23 South edge cobbles surface

22 Tm west

21 Tm west

20 Tm west

19 Tm east

18 Mon east

17 Mon west

16 Tm north side west

15 Tm north side east

of

1.750

1.845

3.090

3.023

3.070

3.422

3.425

3.467

3.529

3.482

3.473

0.854

1.340

0.386

159.466

159.466

159.466

159.466

159.466

159.466

159.466

159.466

159.466

159.466

159.466

159.466

159.466

159.466

159.466

26 STR 24 -> ST. 5

25 NW

24 NE corner 4A

23 South edge cobbles surface

22 Tm west

21 Tm west

20 Tm west

19 Tm east

18 Mon east

17 Mon west

16 Tm north side west

15 Tm north side east

of

1.750

1.845

3.090

3.023

3.070

3.422

3.425

3.467

3.529

3.482

3.473

0.854

1.340

0.386

159.466

159.466

159.466

159.466

159.466

159.466

159.466

159.466

159.466

159.466

159.466

159.466

159.466

159.466

159.466

26 STR 24 -> ST. 5

25 NW

24 NE corner 4A

23 South edge cobbles surface

22 Tm west

21 Tm west

20 Tm west

19 Tm east

18 Mon east

17 Mon west

16 Tm north side west

15 Tm north side east

of

1.750

1.845

3.090

3.023

3.070

3.422

3.425

3.467

3.529

3.482

3.473

0.854

1.340

0.386

159.466

159.466

159.466

159.466

159.466

159.466

159.466

159.466

159.466

159.466

159.466

159.466

159.466

159.466

159.466

26 STR 24 -> ST. 5

25 NW

24 NE corner 4A

P83

July 9, 1983 (Saturday)

named, and heavily much of the night in SF but site was just flooded and low clouds continued (with periodic clearing) through the morning

The morning was largely devoted to an official tour of the site for local officials - about 20 came and seemed very interested - we are also slated to speak to the SF Rotary Club on Wednesday 7/13 at 7 pm, and a group of anthropologists and students are coming (not morning for a 1/2 hour talk

5/6 Wooden staff photo

Look photos 83-7-3/4 valley view from Alameda hill 83-7-~~4/18~~ 4/18 Op 4B, scale 50 cm - steps cleared

7/11 Mark took photos of tour

8/16: Have not possible counterpart to MATH on east - am having Walter & Raman cut down behind it - James & Regis cutting behind sub-Monika feature into fill

8/24: cutting down to scale on south

8/24/4A

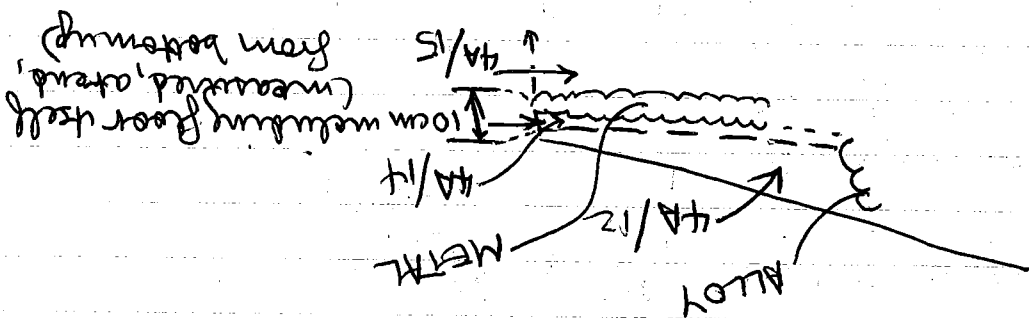

took photos 83-7-2/2, R/2 Op 10N, from SW, scale 2m

P83-7-13  
7/19



11-272  
5M-2-ESJ

...  

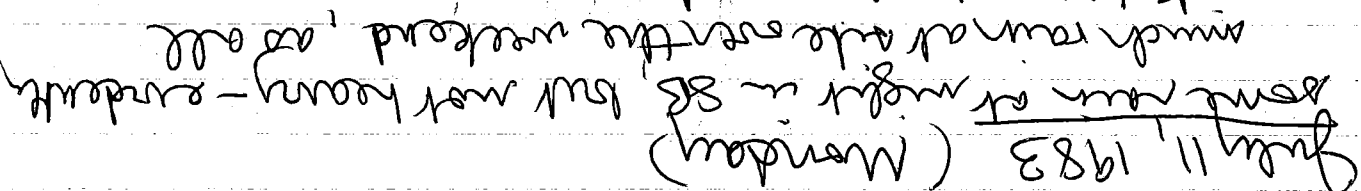
Mark & Kathleen taking soil (terrestrial) samples  
Fred will monitor 7A as Manganese (Biosediment)

took photos 83-7-R/8  
0.515 from west - R47 in foreground  
viewing relative to LNK/scatton 2  
beyond, scale 50 cm

515 from west - RATT in foreground  
 showing relation to LNK / Scttoun  
 beyond: scale 50cm

83-7-8 11/12 course further up slope

11-8/L  
5M-2-ESJ



983-7-119  
7/12

7/12/83

D.S.T. Slope 4			
	Mid	Top	Bottom Elev.
4	44°18'	1869	5.89
2 48 NW	33°37'58"	1858	5.00
3 48 SE	63°40'	1388	5.03
4 48 SW	60°20'	1402	4.05
5 east side lat wall Northface	55°14'	2659	5.19
6 west side	50°09'	2672	4.48
7 Runo upper strip north face, west side	49°21'	1819	4.37
8	50°33'	1900	5.43
9 N/E corner lc	140°	2049	4.93
10 NW lc	351°52'	2002	3.97
11 1st Ten West	9°25'	2053	2.08
12 2nd Ten West	34°55'	1760	1.38
13 3rd Ten West	119°45'	0826	2.03
14 Summit wall West Northface	146°22'	0461	6.95
15 SW corner lc	148°26'	10487	8.95
16 SE corner lc	135°58'	0986	9.59
17 Summit wall east Northface	131°50'	0458	7.74
18 * north summit wall 62 cm thick	92°45'	0750	3.38
19 3rd Ten east	80°39'	1647	3.14
20 2nd Ten east	39°50'	2049	3.34
21 1st Ten east	48°12'	1799	5.35
23 show fast east side	851°47'	1915	3.55
25 show fast east	305°35'	2088	4.54
26 show fast east	282°55'	2198	6.88
27 show fast east	256°20'	2250	8.06
28 pole + concrete datum sum	245°02'	1914	7.34
29 show fast east	232°40'	2325	8.13
30	214°50'	2342	8.28

ED on road  
W & heading  
↑ height 123.5 cm  
48 NE corner  
44°18'

988

PSB

P837-7-121

7/12

31	West side looking pt	27° 31'	1416	5.72	—
32	East side looking pt	177° 51'	1515	6.89	—
33	East side looking pt (summit str)	158° 40'	0212	4.44	—
34	North side looking pt	249° 20'	1583	3.23	—
35	Fence	338° 10'	1971	5.58	—
36	Fence corner	29° 12'	2140	10.84	—
37	road	30° 40'	2104	13.14	—
38	road & str cut north fence	56° 18'	1961	10.98	—
39	to str 4	318° 02'	1400	12.22	+1° 5'

TH 1423

Gr 16 Exca. 5H

1	5H South extension 1 SE com.	161° 17'	2236	14.94	
2	5H Sect 1 SW com	154° 25'	2185	14.80	
3	5H Sect 1 turns West	153° 59'	2038	13.50	
4	5H Sect 1 turns North	157°	1836	13.37	
6	5H Sect 1 turns East	156° 30'	1830	12.51	
6	Wall 3 south limit 5H	156° 42'	2000	12.55	
8	5H Fish well east face south	158° 22'	2239	10.7	
9	5H Fish North point east face	152° 08'	2200	<del>9.05</del> 9.05	
9	Barge Well South point East face	139° 15'	2931	11.12	
10	Barge A point East face - not much	<del>136° 35'</del> 136° 35'	3100	10.82	
11	5H East S. ext. NW corner	139° 30'	2292	11.46	
12	5H Sect 1 NE corner	143° 10'	2168	11.14	
13	5H Sect 1 East side turns West	147° 15'	2316	13.97	
14	5H Sect 1 East side turns South	149° 42'	2220	13.96	
15	5H East 5 ext SE corner	142° 08'	2372	15.17	
16	5H East 5 ext SE corner	137° 47'	2528	15.7	
17	5H East 5 ext NW corner	134° 36'	2445	11.95	
18	Road through 5H side	178°	30989	10.25	
19	Road point on curve	172° 44'	3065	10.09	
20	"	176° 32'	3091	9.93	
21	"	175° 53'	3088	9.76	

083-7-123

7/12

Scop. 4

22	Ref and step up 5 ft trench	132°38'	2931	2935	8.90
23	Ref ~ ~ ~ Northport wet track	132°	2928		8.90
24	Ref and of curve	134°20'	2970		8.96
25	Ref left & track	134°50'	3132		8.60
26	SE Next. SE corner	134°58'	2243		4.33
27	NE corner Wall 3	210°15'	2814		6.23
28	NE corner 5 F Next.	160°23'	2260		7.65
29	5 F Next. NW corner	4°08'	2362		7.14
30	5 F Next. Wall 3	6°50'	2609		5.75
31	5 F Next ext. NE corner	6°14'	2641		6.35
32	Wall 3 West Extent	173°48'	2688		8.54
33	West Ext 5 F NW corner	834°47'	2603		5.92
34	SW corner 5 F West Ext.	84°50'15"	2711		4.73
35	5 F West ext 5 corner 5 F N. Ext. NW corner	120°54'	2245		4.63
36	5 F N. Ext. SW corner	43°24'	1886		2.81
37	Shore lot east side	89°30'	2912		5.32
38		114°00'	2315		7.30
39		145°49'	2434		15.23
40		148°25'	2603		18.65
41		153°28'	2535		21.47
42		161°39'	2692		21.00
43		170°51'	2831		21.37
44		180°18'	2884		19.15
45	(Possible)	295°50'	3141		6.84
46	" " " " " "	347°42'	2738		6.89
47	Elevation on Beach		3609		
48	Backlight to Sta. 4	170°55'	0798		05787.
49			0004		+53'

PSB

#1 1.253

Y

Mudflat Eelr Distance to scrape

883-7-125  
7/12

1. Iron road	3.110	8.06	21055
2. Iron road - not found	3.246	8.55	21655
3. SWET road	3.142	7.57	21525
4. SWET road	3.083	8.23	22126
5. LEAD road	2.729	7.17	22959
6. LEAD road	2.722	6.44	22510
7. BRASS road - found	2.540	6.07	22809
8. BRASS SWAY	2.551	6.23	23055
9. Jct: BRASS/TN	2.261	5.84	23745
10. TN step-out - found	2.552	6.63	23845
11. TN step-out - not found	2.521	6.09	23742
12. Jct: BRASS/RN	2.119	4.95	25305
13. FORGE road	2.921	5.04	2720
14. FORGE road	2.700	6.06	27105
15. NW ID	3.341	9.77	32905
16. TON-ID - road	3.337	8.24	32447
17. GON-ID - road	2.867	5.83	31226
18. BON-ID - road	1.540	4.26	38705
19. SW ID	1.003	4.10	44325
20. SE ID	1.409	2.47	21740
21. BON road - ID	1.551	2.24	30042
22. GON-ID - road	2.838	4.36	32805
23. TON-ID - road	3.156	7.34	33805
24. ID - NE	3.357	9.27	34108
25. ID - SE	3.440	12.65	34215
26. ID - NE	3.477	18.35	34355
27. ID - SW - ch	3.974	18.86	—
28. ID - NW	3.384	18.83	33929
29. ID - SW	3.473	12.89	38205
30. Shared road	3.321	11.06	44052
31. "	3.220	10.51	63030
32. "	3.098	10.47	81040

PSB

July 13, 1983 (Wednesday)

working in a foggy cloud - little rain at night in S.B. -  
no standing water in trenches

Op 4A: glass points (transverse vs. longitudinal shape within trench)  
- these from transit (7/7) consistently show within trench

SMELT 91° 30'	2 colored high (34 cm)	distance to LEAD (tee to tee)	1.51 m
		TIN (top tee to top tee)	3.05
LEAD 89° 30'	3 colored high (42 cm)	distance to TIN (to top tee)	1.48
			3.15
BRASS 355° 30'	<del>59 cm north of LEAD</del> 59 cm north of LEAD to the	distance to TIN (to top tee)	1.48
	55 cm from east trench wall		3.15
	2 cables high (17 cm) - upper part	distance to the of RIN	1.71 m
	projection (23 cm south) 1 cable high (5 cm)	at least 3 steno high (35 cm)	90° -
	from base of 2nd (lower) TIN cable	87 cm wide - N/S	
		distance to BON (north	2.46 m
	FORGET		1.66 m
			5.29 m
FORGET	at least 55 cm (post 62 cm) high		95° -
	distance to TUMBAGA (north side to north side)		2.70 m
			3.83 m
TUMBAGA 90°	1 steno high (15 cm)		1.03 m
	distance to BON		5.37 m
	end of trench		

1473. II

Mid Item 4th

Dist. Scape 7

153° 15' 22.82

96'6

135051

10,63

151081

12.89

90821

8.84

173.841

7.83

100

880178

104

209

2

$\begin{array}{r} \text{\tiny 00} \\ -\text{\tiny 27} \\ \hline \end{array}$

took photos 83-7-U 11/12

Opta from N. 5000-50 cm

60N 9 TUMBA GA

83-7-11/2 Op 4A from base, scale down features 178 ft 24-2nd

SMELT/LEAD/TN/BRAZ/RUN

Lat 4A/27: LEAD to strip out of TIN, to base of LEAD leaving BRASS pediculated

Learning BRASS parallel

NU

↓ N

Large rubble stone, protruding slightly above surface of L.A.D.

Grass

37 cm

103

57

201

LS



Op 4B:

4B/16 : 165-170 cm - tubes (ca 100-150?), 1 strand

4B/17 : 170-190 cm - tubes + 1 strand

bad break (crucial base) - bunched

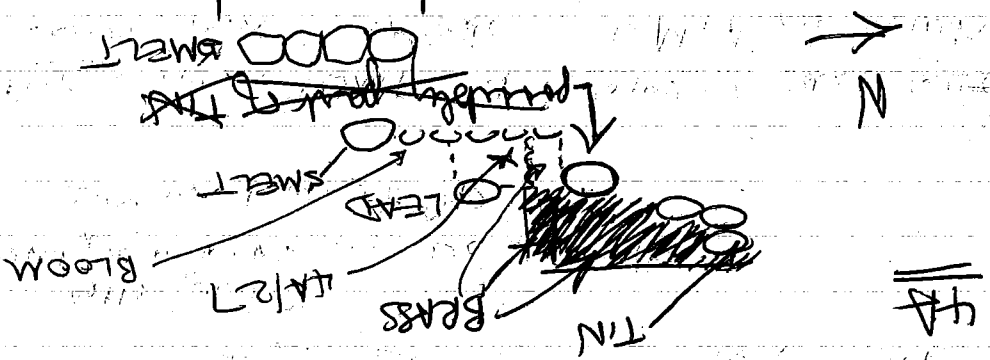

BRASS  
LEAD  
SMELT  
KILN  
TIN upper  
lower

KILN is made of stones ca 35 cm across (car as a circle) (which are mounted in pairs and TIN (which are mounted in pairs and TIN (which are not a pair of the heads, ca 17-23 cm across) BRASS continues down to level of coffee pavement Bloom tubes interposed here in a pavement between TUMBAKA and FORTGE

The stones are SMELT used/set at head and are 28-35 cm wide and 35 cm deep BRASS now stands 8 stones high, 76 cm. Its stones are 17-22 cm across.

stones of TUMBAKA are similar in appearance to SMELT (more irregular / less chunky) often to KILN TUMBAKA: both heads (44x29 cm) and shoulders (48x20 cm)

Op 4A: "new" wall "BESS"

86° orientation

2 stone high - block like (29 cm x 31 cm deep x 10 high)

2.94 m to the top of GON

tree points (see preceding page)

4A/31: from STEEL ~~to~~ south to BESS, from top of former to level of base of ~~Op 4A~~ TON

sketches - view partly included

sketch

bones from small mammal

tree photos

83-7/10, Op 5H, TUB feature from west, scale 30 cm

83-7/11/12 Op 4A, STEEL wall from north, scale 30 cm

note - modern when STEEL (2 north) floated with

charcoal - pos < 1 cm across - not enough for

carbon sample about time - could, no section

Let 4A/32: removal of BESS to level of KILN

2 TON

obscure already from to base

of POKM (see p. 135)

appears part of BESS > KILN,

through sig of KILN stone

(ca 30 x 35 cm)

deep across

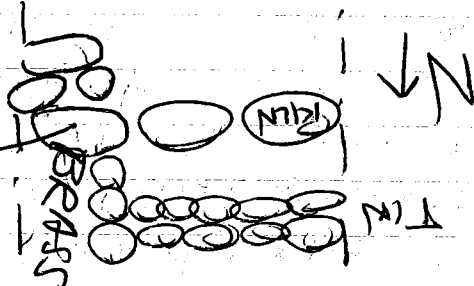

P83-7-135  
7/14

P83

Op 414

CAST wall: 7.93 cm to north of fence  
75° orientation  
25 cm high  
FORM was under KILN

2 stones (26cm) high  
Jaws BRASS base to east

carried small like TN but irregular  
TN like KILN - earlier version?

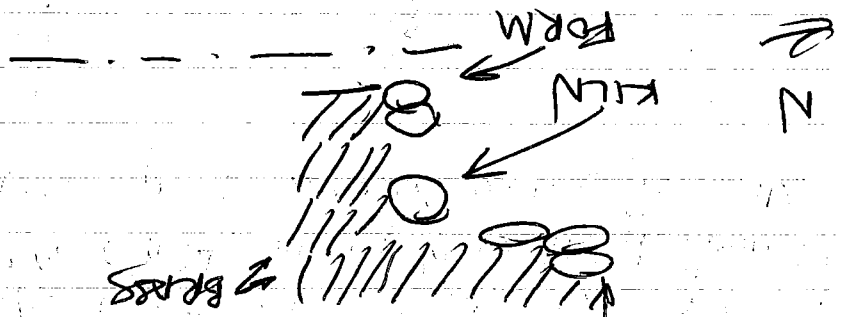

took photos 83-7-W1/2

CAST "wall" from north, scale 50cm

83-7-3/4 North wall 3 from NE, scale 50cm

Lot 4A/33: STEEL south to CAST, from top of

STEEL/CAST to base of excavation

Lot 4A/34: CAST south into pit from top of

same to base of pit to 8.25 m from north end

Op 514: Jute Feely and Cuthbert have reached

coloured layer at west end of trench (1.07 m from surface at NW corner)  
Wells and Rounen continue a limited sondage to steel pit and

Jaume and Rouno encountered a human tooth

(close in and to east of excavation) fragments at 1.78 m below

surface (pottery has horizontal

surface) - after cleaning with hand

and nose

Total length of trench 18.70m

PSB

feature is RATS

Get 4A/38 material from within & adjacent to perimeter of RATS

4A/39: 30-40 cm in 1.5 m south pit in trench

(immediately below 4A/37) - includes bone (small  
opile-like jaw) & shell (conch?), thin (narrow) obs  
bed

lots 37 & 39 seem to represent a MIDDEN -

probably ~~frustrating~~

Early Classic

many juts coming out at SW corner of RATS

(lot 38)

burned earth (adobe from within perimeter)

4A/40: 40-50 cm (below lot 39)

lots of charcoal, shell, obsidian

RATS feature is that which articulates  
with METAL floor

78N 24

HI 1485

excavated in  
P83-7-139

draw D83-7-19 (Make plotting, no reading measure -  
marks) of RATS feature (1:20)

P83-7-137  
7/14

P83-7-139

7/14

(write page)

P83

14 July

H.I.

Pt	3928	6.55	226°30'
1 mts SW			
2 south extent			
3 rd wall line	8209	6.03	238°12'
3 rd round corner	3858	5.53	253°21'
Net			
4 Rd ends section	3806	4.89	253°43'
5 Metal floor	3875		

Took Photos 83-7-11/12 Op 4A Rats  
Feature, from SW, scale 50 cm  
83-7-X 1st Op 4A Earthen trench  
from N & W  
8th from SW

Op 4A: BRASS may be related to RATS; on plan D83-7-19  
a rough sketch of bearing BRASS are shown  
at that section & should show in photos

also: METAL floor abouts sides of RATS; within  
its perimeter (RATS) is rounded(?) earth or adobe  
& some stone & rubble, but not METAL pebble floor  
possibly further surfacing of crushed stone as  
op NE corner of strig

7/14 also: today 3 officials from Reservoir  
techniques were given a 40-minute tour of  
the site; also 2 archeologists got an impression  
from an intro morning among excavations

R5B

P83-7-14  
7/15

Ed & I worked on section for str 24  
(D83-7-21) - fearful of heavy rain... got most fragile  
in the event of heavy rain... got most fragile  
section (Gow to R11F) done

Excavations completed:

Op 4A: to level of M<sup>1</sup> for most of trench,

with ~~rest~~ <sup>rest</sup> of trench 1.5 m taken to collum.

Op 5A: to level under S4 if ~~possible~~ on below -

two areas dug to circular layers

\* you feature sits virtually atop collum

Backfilling: One up 10 pits substantially done  
by days end, except 10F and 10H; 4B more  
than half done - have asked the men to  
continue and complete the rest on Saturday

Ed paid the workers for 5 days - will pay the  
balance (2 days) on Monday, at which point  
we'll also collect equipment  
if men will stay on through Wednesday  
(Margarite, Jaime, Wilfrido B. and Ramon)  
to help with odd jobs while drawings are  
completed

Pat arrived on the bus ca 2 - we all loaded about  
3:30 to leave for San Pedro - tomorrow  
to visit the Subclass Project  
Pat will ill - the coper relatively but doesn't seem to  
be getting better...

(83-7-143

7/19-20

backfilling (cont'd):

Op. 1A (84 6) - arce structure

does not appear threatened after all

all Op 10 pits have been refilled

7A

3B

3A

Op 1B

Observations at Op 1A:

- MTL floor does extend over full N/S distance there

- in looking MTL by RATS (to see if south end

stems of plan drawing are part of it), workers

cut through it and destroyed the postmort

evidence - then began to get shreds and deer (?)

bone (none collected due to date) of types / forms

suggesting a northward continuation of the middle

found at the south end - here at a higher level

July 19 1983

(Wednesday)

workers backfilled deepest parts of 5H 4A

Final pay day (M-Wed - 3 days) and thanked them

collected equipment from Juan Brincado had

been storing it in his house (8 picks, 8 shovels,

4 hammers, a length of barbed wire, wheelbarrows

collected yesterday)

helped Pat & Ed a bit with shovels - otherwise

worked on packing 2 and 4 (3 & 1 tomorrow)

must let said all ashments, typing excavation

action of infirmary