

2010

EPV Op 10-40 Lot Forms 2010

Catalina Lopez

Follow this and additional works at: <https://digital.kenyon.edu/honduras>



Part of the Archaeological Anthropology Commons

Recommended Citation

Lopez, Catalina, "EPV Op 10-40 Lot Forms 2010" (2010). *Four Valleys Archive*. Paper 96652.
<https://digital.kenyon.edu/honduras/96652>

This Lot Card is brought to you for free and open access by the Anthropology at Digital Kenyon: Research, Scholarship, and Creative Exchange. It has been accepted for inclusion in Four Valleys Archive by an authorized administrator of Digital Kenyon: Research, Scholarship, and Creative Exchange. For more information, please contact noltj@kenyon.edu.

OP/SubOp FORM

PAREP 2010

Excavator 39 (Catalina López)

Date 30 junio 2010

Op/SubOp: 10/40

Dimensions (NxE) 1x9

Site: 007

Str 1

Description/Goals:

investigate context in which space was used within and out of structure.

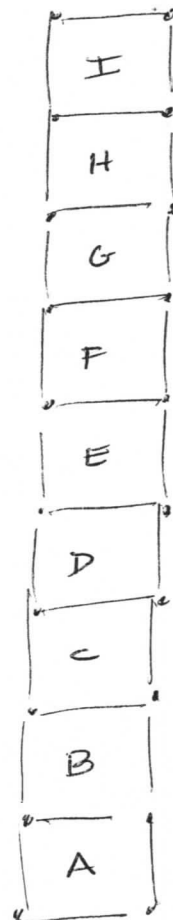

N ↑

PAREP 2010 LOT FORM

Excavator 39

Date 29 junio

Op/SubOp/Lot: 10/40/01

Ex. Unit A

Size (NxEx) 1x1

Site: 007

Str 1

Initial Lot? Y

Prev. lot —

Next lot 03

BGS: 0-21 cm

Initial elev.: NW 996.66 NE 996.70 SW 996.57 SE 996.62

Final elev.: NW 996.61 NE 996.62 SW 996.63 SE 996.62

Reference corner: 997.50 (#79) ^{E/E/NE}
N 22 E -152

Deposit / Type overburden / sediment

Soil type silty loam Munsell/Color drk brown

Drawings _____

Contents 1 obsidiana

Photo/Digital _____

Description/Sketch (with measurements):

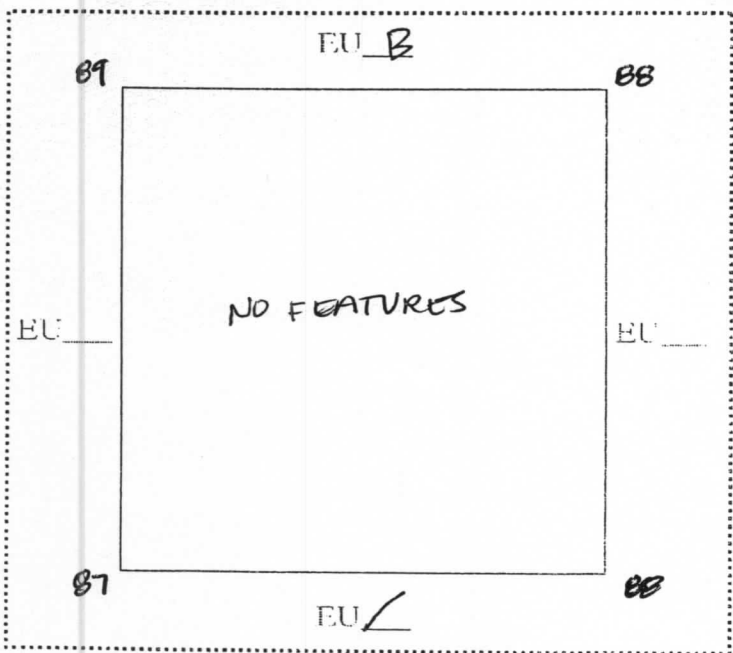

goal: uncover tumbe.

goal not met.

Note refs 2010.39.16

Op/SubOp/Lot: 10/40/02

Ex. Unit ~~A~~ B

Size (NxEx) 1x1

Site: 007

Str 1

Initial Lot? Y Prev. lot — Next lot — BGS: 0-26 cm

Initial elev.: NW 996.77 NE 996.83 SW 996.66 SE 996.70

Final elev.: NW 996.61 NE 996.57 SW 996.59 SE 996.61

Reference corner: 997.50 (+79) ^{E/E/NE} N 22 E -152

Deposit / Type overburden / sediment

Soil type silty loam Munsell/Color dark brown

Drawings _____ Contents 28 ceramica

Photo/Digital _____ 1 obsidiana

_____ 2 pedernal

Description/Sketch (with measurements):

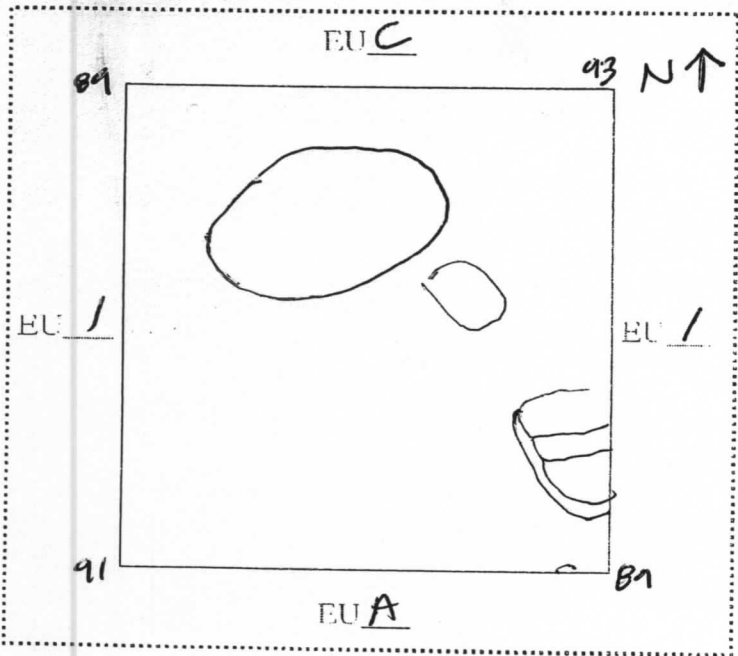

goal: discover tumble.
 none found.
 just one massive
 rock on surface
 and partly below
 surface.

Note refs 2010.39.16

PAREP 2010 LOT FORM

Excavator 39

Date 29 ³⁰ junio

Op/SubOp/Lot: 10/40/03

Ex. Unit A

Size (NxEx) 1x1

Site: 007

Str 1

Initial Lot? N

Prev. lot 01

Next lot 04

BGS: 21-41cm

Initial elev.: NW 996.61 NE 996.62 SW 996.63 SE 996.62

Final elev.: NW 996.43 NE 996.48 SW 996.43 SE 996.45

Reference corner: 997.50 (#79) ^{W. E/NE} _N 22 E -152

Deposit / Type overburden / sediment

Soil type silty loam Munsell/Color drk brown

Drawings _____

Contents 21 ceramica

Photo/Digital _____

2 toba pieces

4 pedernal

1 obsidiana

Description/Sketch (with measurements):

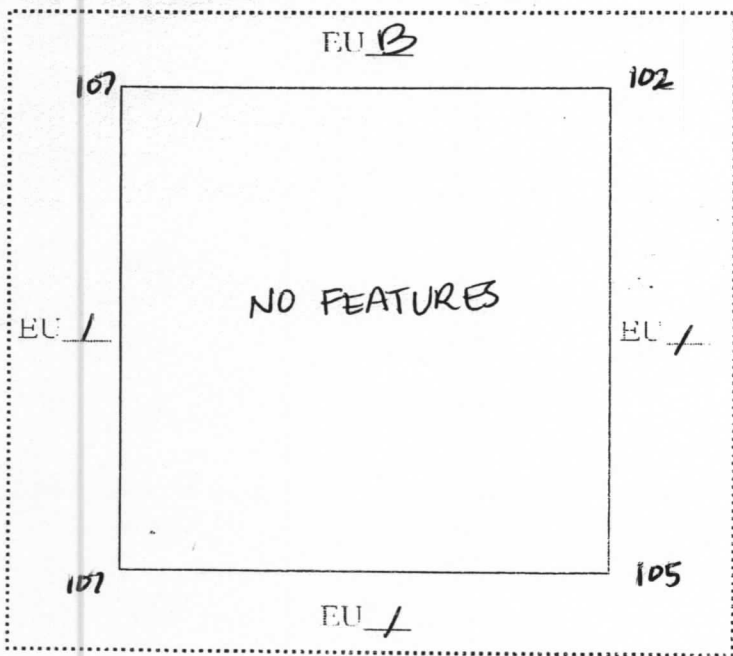

goal: uncover tumble
goal not met.

Note refs 2010.39.16

PAREP 2010 LOT FORM

Excavator 39

Date 30 junio

Op/SubOp/Lot: 10/40/04

Ex. Unit A

Size (NxEx) 1x1

Site: 007

Str 1

Initial Lot? N Prev. lot 03 Next lot 05 BGS: 41-52cm

Initial elev.: NW 996.43 NE 996.48 SW 996.43 SE 996.45

Final elev.: NW 996.36 NE 996.37 SW 996.37 SE 996.37

Reference corner: 997.50 (#79) ^{EU/E/NE}
N 22 E -152

Deposit / Type overburden / sediment

Soil type silty ^{clay} loam Munsell/Color drk brown

Drawings _____ Contents 23 ceramic

Photo/Digital _____ 1 bajalogue

1 pedernal

Description/Sketch (with measurements):

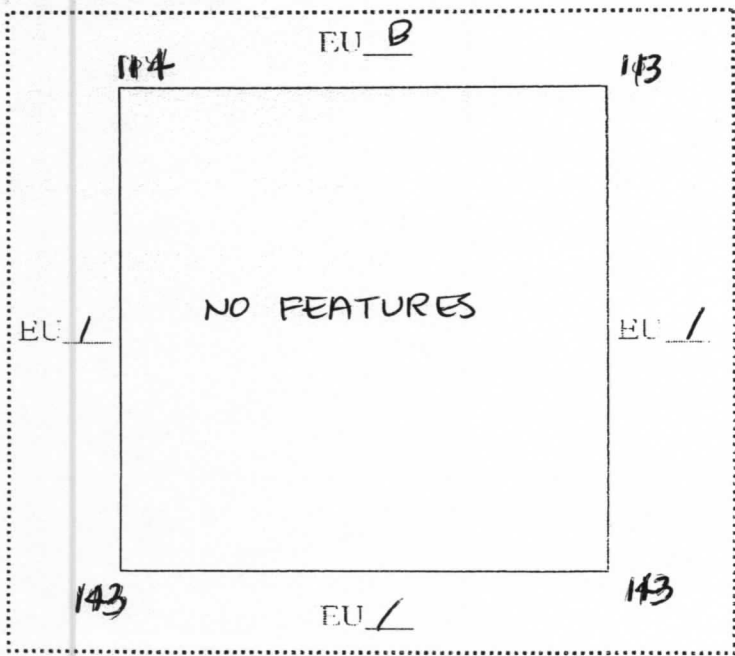

goal: uncover tumble.
goal not met

Note refs 2010.39.16

PAREP 2010 LOT FORM

Excavator 39

Date 30 junio

Op/SubOp/Lot: 10/40/05

Ex. Unit A

Size (NxEx) 1x1

Site: 007

Str 1

Initial Lot? N Prev. lot 04 Next lot — BGS: 52-63 cm

Initial elev.: NW 996.36 NE 996.37 SW 996.37 SE 996.37

Final elev.: NW 996.27 NE 996.33 SW 996.26 SE 996.34

Reference corner: 997.50 (#79) ^{EU E/NE} 22 E -152

Deposit / Type overburden / sediment

Soil type silty clay loam Munsell/Color dark brown

Drawings _____ Contents 1 ceramic
1 bajareque

Photo/Digital _____

Description/Sketch (with measurements):

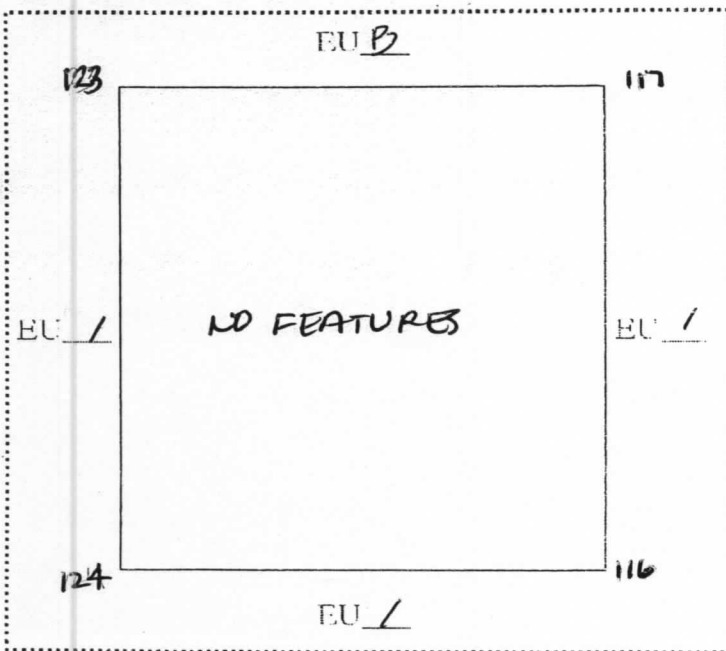

goal: to reach sterile soil
highly improbable that
tumble is here.

only 2 artifacts found
near top of lot.

will go ahead & consider
this sterile.

new worker: Maximiliano Vásquez

Note refs 2010.39.16

PAREP 2010 LOT FORM

Excavator 39

Date 30 junio

Op/SubOp/Lot: 10/40/06

Ex. Unit C

Size (NxE) 1x1

Site: 007

Str 1

Initial Lot? Y

Prev. lot —

Next lot —

BGS: 0-30cm

Initial elev.: NW 996.94 NE 997.02 SW 996.77 SE 996.83

Final elev.: NW 996.73 NE 996.72 SW 996.71 SE 996.72

Reference corner: 997.50 (#79) ^{EW/E/NE} N 22 E -152

Deposit / Type overburden / sediment

Soil type silty loam

Munsell/Color drk. brown

Drawings —

Contents 23 Ceramic

Photo/Digital —

1 pedernal

Description/Sketch (with measurements):

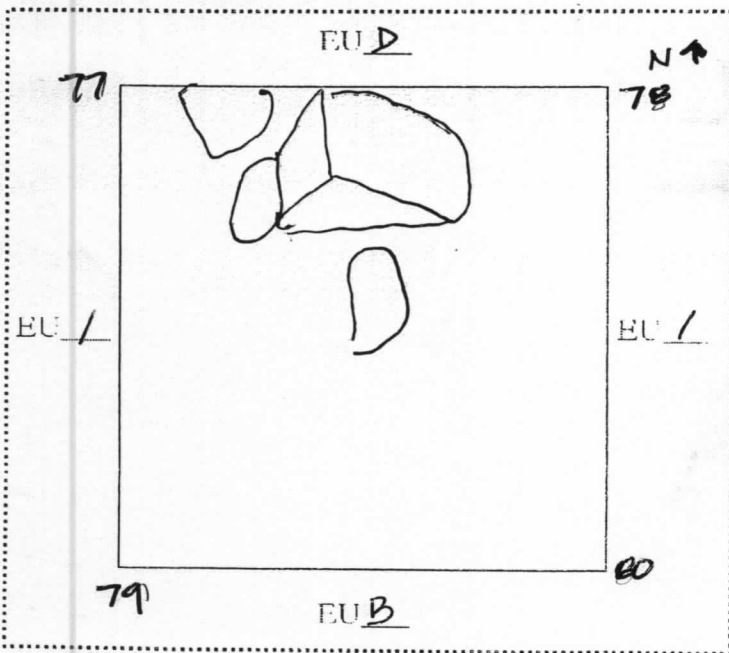

goal: locate tumble
 2 or 3 rocks that
 may be tumble. will
 move up a unit
 and investigate
 further (EUD)

Note refs 2010-39-18

PAREP 2010 LOT FORM

Excavator 39

Date 30 junio

Op/SubOp/Lot: 10/40/07

Ex. Unit D

Size (NxEx) 1x1

Site: 007

Str 1

Initial Lot? Y Prev. lot — Next lot — BGS: 0-51cm

Initial elev.: NW 997.18 NE 997.23 SW 996.94 SE 997.02

Final elev.: NW 996.72 NE 996.72 SW 996.72 SE 996.72

Reference corner: 997.50 (#79) ^{av. E/NE} N 22 E -152

Deposit / Type overburden / sediment

Soil type silty loam Munsell/Color drk brown

Drawings _____ Contents 29 ceramic

1 pedernal

Photo/Digital _____ 1 obsidiana

Description/Sketch (with measurements):

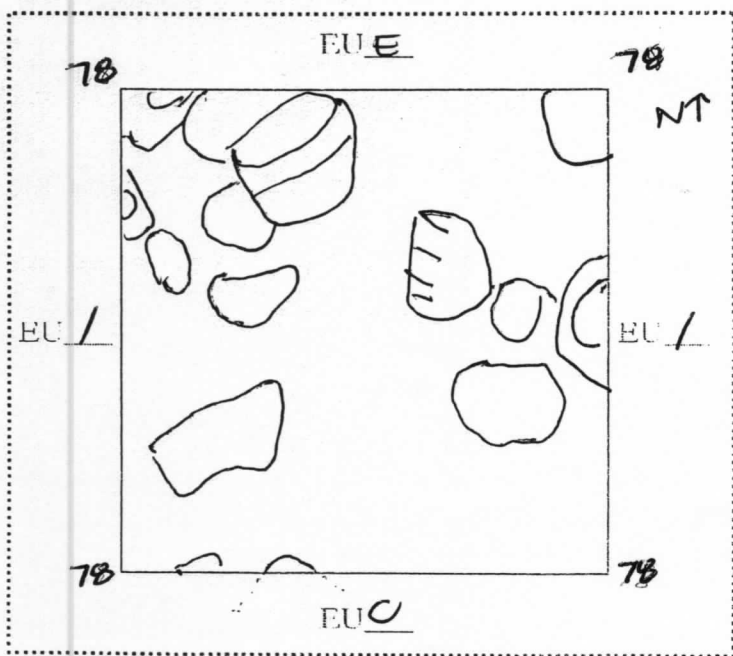

goal: uncover tumble
some tumble found

Note refs 2010.39.18

PAREP 2010 LOT FORM

Excavator 39

Date 1 julio

Op/SubOp/Lot: 10/40/08

Ex. Unit E

Size (NxEx) 1x1

Site: 007

Str 1

Initial Lot? Y

Prev. lot —

Next lot 10

BGS: 0-46cm

Initial elev.: NW 997.42 NE 997.50 SW 997.18 SE 997.23

Final elev.: NW 997.02 NE 997.04 SW 997.01 SE 997.01

Reference corner: 997.50 (#79) ^{NE} N 22 ⁴⁹ E -152 ¹⁹ ²²

Deposit / Type overburden / sediment

Soil type silty loam Munsell/Color drk brown

Drawings _____ Contents 24 ceramics

Photo/Digital _____ 1 bajareque

1 stone

1 pedernal

Description/Sketch (with measurements):

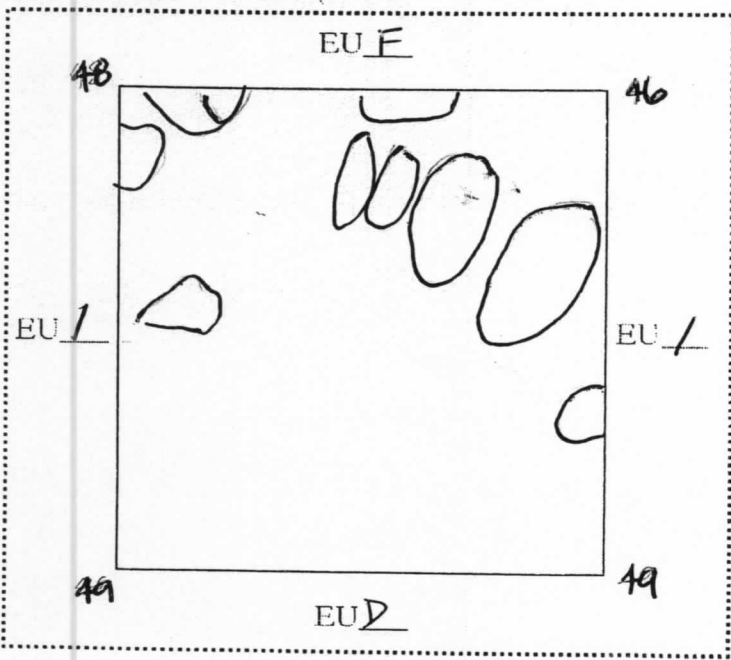

goal: uncover tumble

digger: juan angel

Note refs 2010-39-18

Op/SubOp/Lot: 10/40/09

Ex. Unit F

Size (NxEx) 1x1

Site: 007

Str 1

Initial Lot? Y Prev. lot — Next lot 15 BGS: 0-61cm

Initial elev.: NW 997.75 NE 997.96 SW 997.42 SE 997.50

Final elev.: NW 997.53 NE 997.96 SW 996.89 SE 996.89

Reference corner: 998.9 EU I/NE N 26 E -152

Deposit / Type overburden / tumble

Soil type silty loam Munsell/Color drk brown

Drawings _____ Contents 94 ceramica

Photo/Digital Y 1 obsidiana
2 pedernal
10 bajateque

Description/Sketch (with measurements):

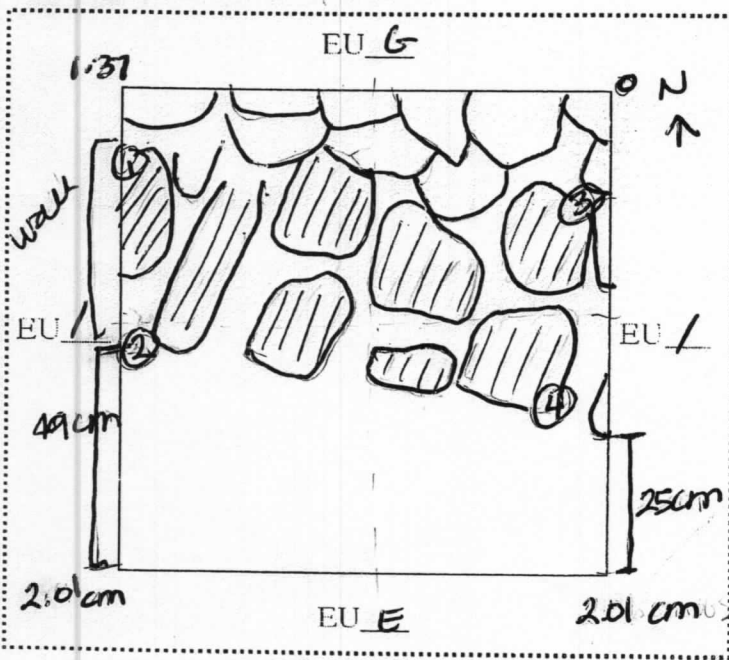

- goal: remove tumble.
- Tumble here is more densely packed than in southern most units.
- calculated 2 for EU I NE corner manually.
- wall found. will try to clear tumble to highest wall z.
- ≈ 50cm exposed (N-S) of wall
- 1 144cm BGS 3 131cm BGS
- 2 137cm BGS 4 154cm BGS

Note refs 2010.39.18, 19, 20, 21

PAREP 2010 LOT FORM

Excavator 39

Date 1 julio

Op/SubOp/Lot: 10/40/10

Ex. Unit E

Size (NxEx) 1x1

Site: 007

Str 1

Initial Lot? N

Prev. lot 8

Next lot —

BGS: 46-74cm

Initial elev.: NW 997.02 NE 997.04 SW 997.01 SE 997.01

Final elev.: NW 996.74 NE 996.72 SW 996.75 SE 996.75

Reference corner: 997.50 (#19) ^{EU E/} _{NE} N E

Deposit / Type overburden / sediment

Soil type silty loam Munsell/Color dk brown

Drawings

Contents 76 ceramic

Photo/Digital

5 bajareque

2 obsidiana

Description/Sketch (with measurements):

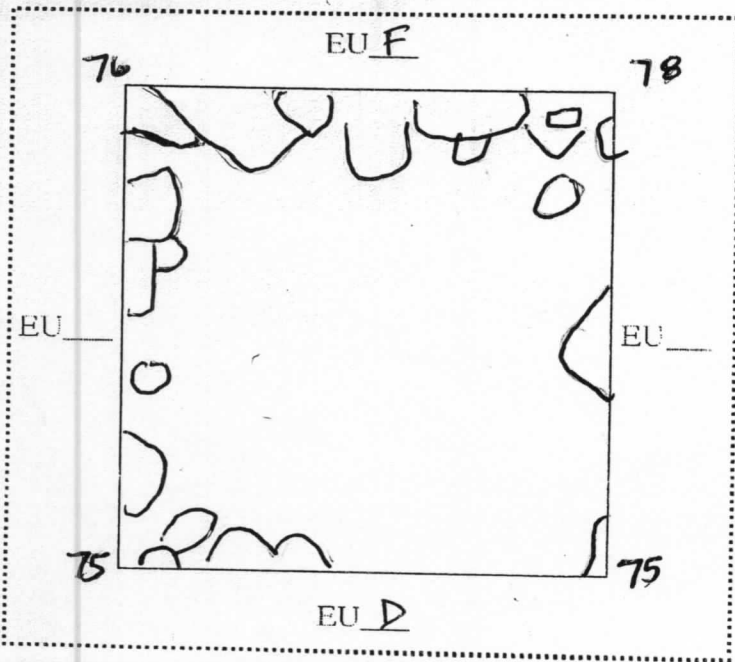

goal: continue to uncover tumble

some tumble located, but its not at its densest here.

Note refs 2010.39.18

Op/SubOp/Lot: 10/40/11

Ex. Unit G

Size (NxEx) 1x1

Site: 007

Str 1

Initial Lot? Y

Prev. lot —

Next lot 14

BGS: 0-45cm

Initial elev.: NW 998.19 NE 998.25 SW 997.75 SE 997.96

Final elev.: NW 998.19 NE 998.26 SW 997.54 SE 998.91

Reference corner: 998.91 (EU I/NE) N 26 E -152 17?

Deposit / Type overburden / tumble

Soil type silty loam Munsell/Color dk brown

Drawings _____ Contents 65 ceramica

Photo/Digital Y 9 bajareque

3 obsidiana

Description/Sketch (with measurements):

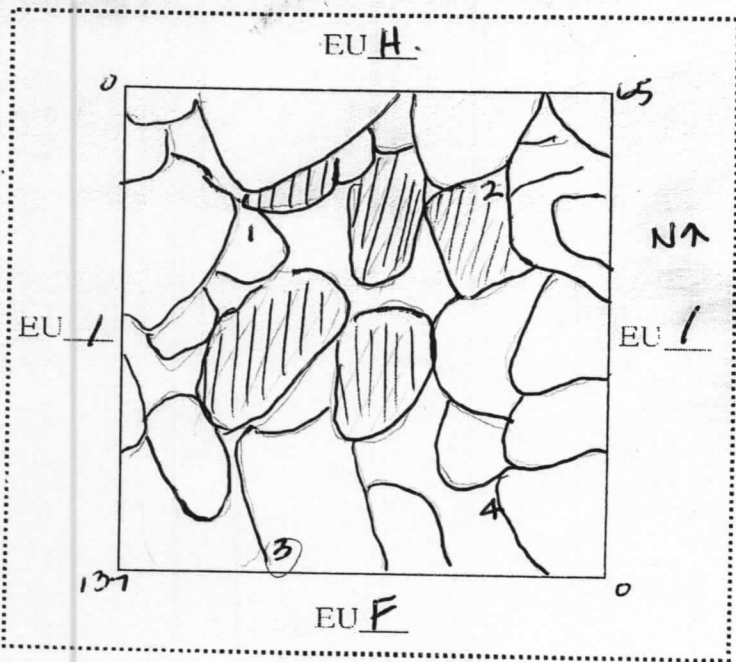

goal: remove compacted
tumble to get to
tumble in EU F.
Try to locate 2nd wall

Tumble is highly uneven, took
different Z's:

1 102cm BGS

2 141cm BGS

3 130cm BGS

4 94cm BGS

This tumble is
norm of the
1st wall.

calculated BGS for this form by using
Z for #2 on sketch = 141cm BGS.

Note refs 2010.39.19, 20, 122

PAREP 2010 LOT FORM

Excavator 39

Date 3 julio
sabado

Op/SubOp/Lot: 10/40/12

Ex. Unit I

Size (NxEx) 1x1

Site: 007

Str 1

Initial Lot? Y

Prev. lot -

Next lot -

BGS: 0-208cm

Initial elev.: NW 998.84 NE 998.91 SW 998.43 SE 998.54

Final elev.: NW 998.71 NE 998.83 SW 997.06 SE 998.37

Reference corner: 998.91 (EUI-NE) N 26 E -152

Deposit / Type overburden / tumble

Soil type silty loam

Munsell/Color dk brown

Drawings Y

Contents 29 ceramic

Photo/Digital Y

9 bajareque

2 obsidiana

Description/Sketch (with measurements):

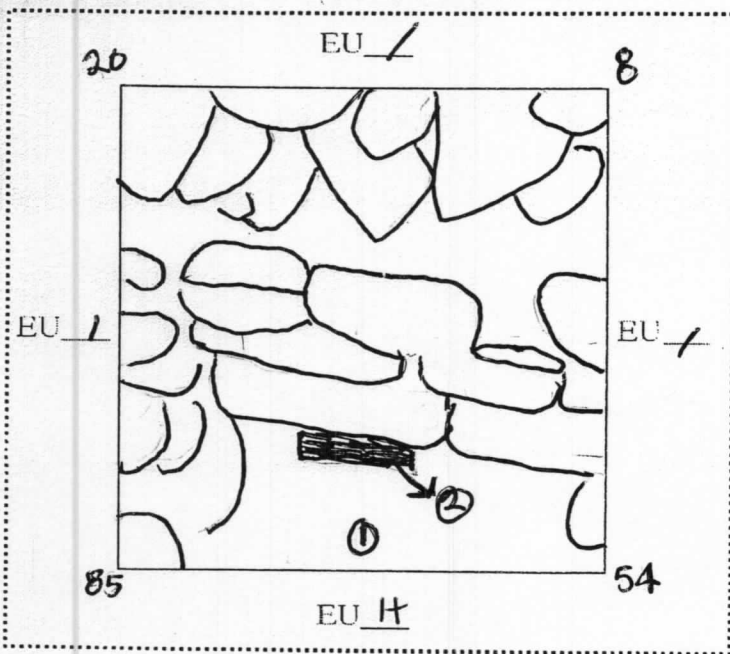

goal: uncover tumble, find more architecture. wall found here. removed tumble in front of it (to the south)

Discovered unusually large tba stone (whole) in this lot, directly in front of wall 2.

Deepest cm BGS:

① 198cm BGS

② 208cm BGS (2=996.83)

Note refs 2010-39, 21, 22

PAREP 2010 LOT FORM

Excavator 39

Date 3 julio
sábado

Op/SubOp/Lot: 10/40/13

Ex. Unit H

Size (NxE) 1x1

Site: 007

Str 1

Initial Lot? Y Prev. lot — Next lot 15 BGS: 0-75 cm

Initial elev.: NW 998.43 NE 998.54 SW 998.19 SE 998.25

Final elev.: NW 998.19 NE 998.51 SW 998.05 SE 997.76

Reference corner: 998.91 EU I/NE N 26 E -152

Deposit / Type overburden / tumble

Soil type silty loam Munsell/Color dk brown

Drawings Y Contents 148 ceramica

Photo/Digital Y 37 bajareque

3 obsidiana

2 pedernal

1 tooth

Description/Sketch (with measurements):

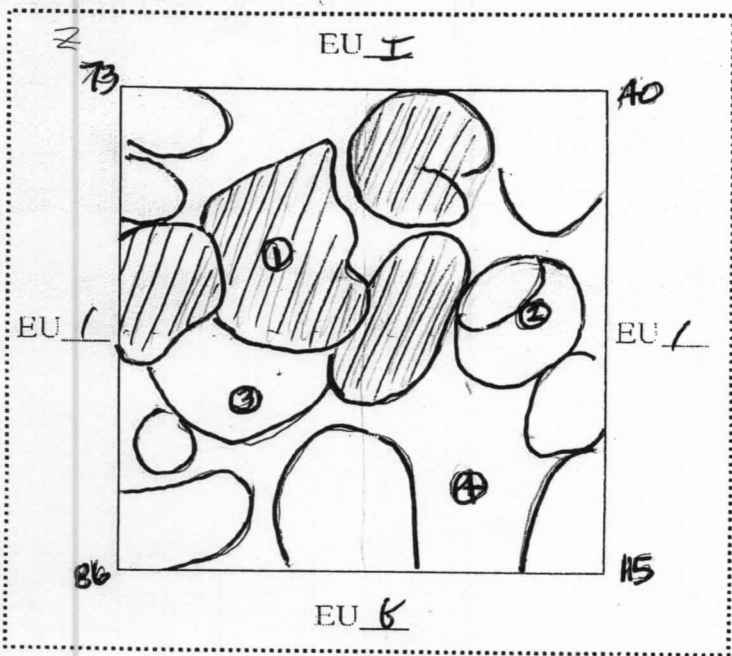

goal: remove tumble,
locate architecture

- ① 120 cm BGS
- ② 132 cm BGS
- ③ 141 cm BGS
- ④ 158 cm BGS

= stones that are similar in Z.

Note refs 2010.39-22 123

PAREP 2010 LOT FORM

Excavator 39

Date 3 julio
sabado

Op/SubOp/Lot: 10/40/14

Ex. Unit G

Size (NxEx) 1x1

Site: 007

Str 1

Initial Lot? N

Prev. lot 11

Next lot —

BGS: 45-96 cm

Initial elev.: NW 998.19 NE 998.26 SW 997.54 SE 998.91

Final elev.: NW 998.06 NE 998.26 SW 997.34 SE 997.40

Reference corner: 998.91 EU/NE N 26 E -152

Deposit / Type

Architect

Fill

Soil type silty loam

Munsell/Color dk brown

Drawings _____

Contents 106 ceramic 1 obsidian

Photo/Digital _____

26 bajareque 1 obsidian
1 big chest
1 bone

Description/Sketch (with measurements):

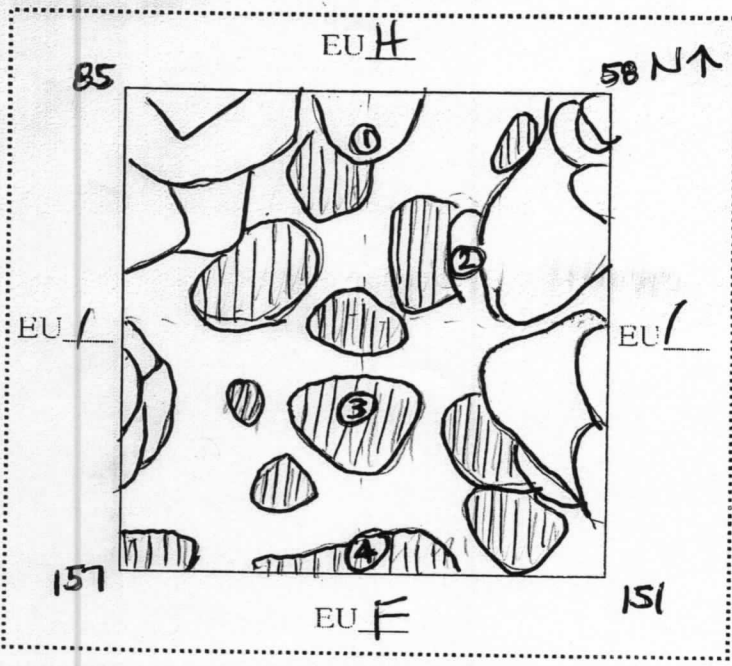

goal: remove tumble
and even out until
level w/ top of wall.

Discussed progress w/
Ellen. Decided we
were digging through
fill and any
architectural features
here were destroyed/
looted.

- 1 139cm
- 2 150cm
- 3 157cm
- 4 158cm

= stones that are similar in Z,
and all are lower than the
rest.

Note refs 290-39.19

Op/SubOp/Lot: 10/40/15

Ex. Unit F

Size (NxEx) 1x1

Site: 007

Str 1

Initial Lot? N Prev. lot 9 Next lot 17 BGS: 61-81cm

Initial elev.: NW 997.53 NE 997.96 SW 996.89 SE 996.89

Final elev.: NW 997.33 NE 997.28 SW 996.89 SE 996.89

Reference corner: 998.91 EU I/NE N 26 E -152

Deposit / Type overburden / tumble

Soil type silty loam Munsell/Color dark brown

Drawings _____ Contents 23 ceramica

Photo/Digital _____ 10 bajareque

Description/Sketch (with measurements):

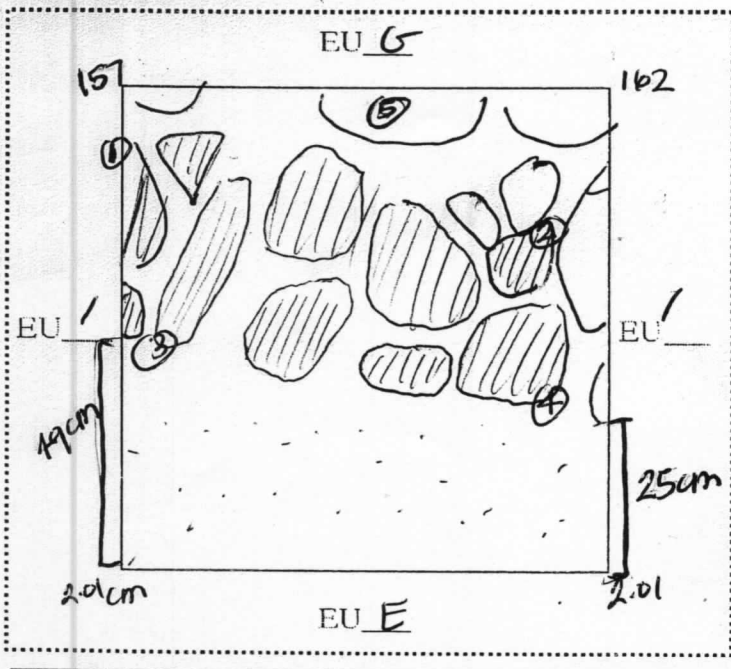

clear tumble to top of wall level.
61-81cm BGS: obtained by using (2) for point #2 in sketch.

Additional (2):
1 157 cm BGS
2 150 cm BGS
3 137 cm BGS
4 154 cm BGS
5 162 cm BGS
calculate cm BGS using one of these z's instead.

Note refs 2010 39.23, 24

PAREP 2010 LOT FORM

Excavator 39

Date 5 julio
(lunes)

Op/SubOp/Lot: 10/40/16

Ex. Unit H

Size (NxEx) 1x1

Site: 007

Str 1

Initial Lot? N Prev. lot 13 Next lot — BGS: 75-221 cm

Initial elev.: NW 998.19 NE 998.51 SW 998.05 SE 997.76

Final elev.: NW 998.06 NE 998.37 SW 998.03 SE 997.74

Reference corner: 998.91 EU I/NE N 26 E -152

Deposit / Type fill architecture

Soil type silty clay loam Munsell/Color dark brown

Drawings Y Contents 90 ceramics

Photo/Digital Y 24 vajareque
1 pedernal
3 tectn
3 carbon samples

Description/Sketch (with measurements):

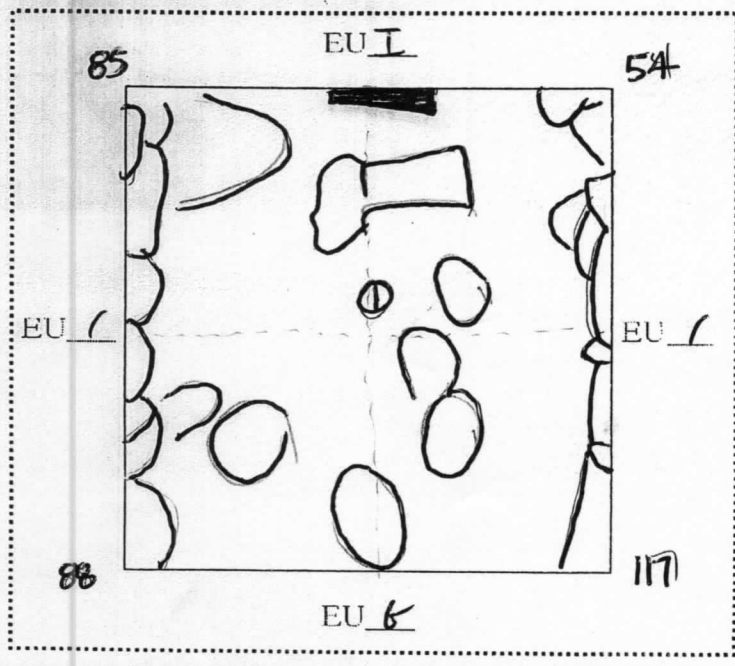

Goal: uncover basal line of wall 2 in the EU, which is lower than step/terrace in front of it. Determine # of construction phases

3 carbon samples found:
Z: 170 cm BGS
Z: 200 cm BGS
Z: 205 cm BGS
2 construction phases
① 190 cm BGS, z = 997.05

Note refs 2010-39-25

PAREP 2010 LOT FORM

Excavator 39

Date 5 julio
(Dunes)

Op/SubOp/Lot: 10/40/17

Ex. Unit F

Size (NxEx) 36 x 1m

Site: 007

Str 1

Initial Lot? N

Prev. lot 15

Next lot —

BGS: 81-94cm

Initial elev.: NW 996.89 NE 996.89 SW 996.89 SE 996.89

Final elev.: NW 994.78 NE 994.76 SW 994.78 SE 994.76

Reference corner: 998.91 EUJ/NE N 26 E -152

Deposit / Type overburden / sediment

Soil type silty clay loam Munsell/Color dk brown

Drawings _____

Contents 8 ceramic 2 bajareque

Photo/Digital _____

2 chert 1 carbon sample

1 obsidian

Description/Sketch (with measurements):

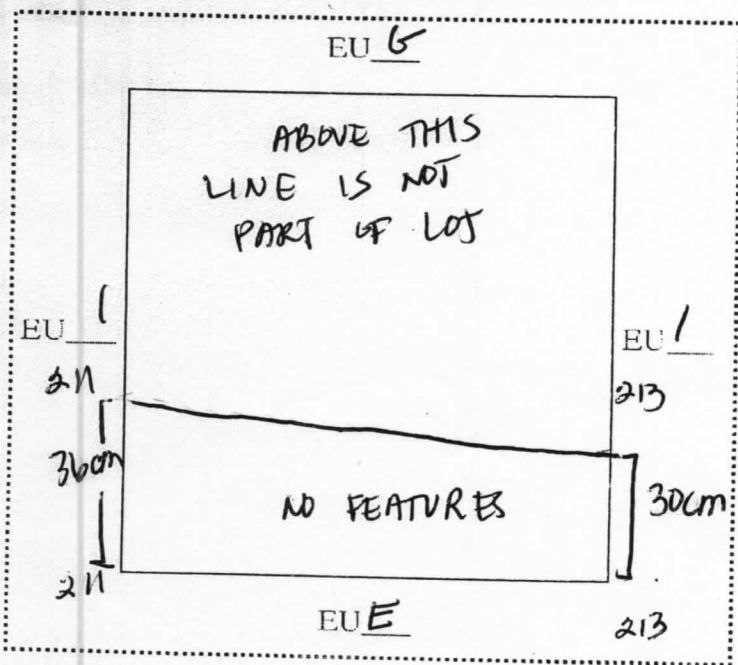

goal: confirm basal line.

goal met. Basal

line is at $Z = 996.83$

($Z = 998.91$
- 2.08m BGS)

Note refs

2010-39-25