Four Valleys Archive

Anthropology

2009

EPV Op. 10-29 Lot Forms 2009

Mary Hostenske

Follow this and additional works at: <https://digital.kenyon.edu/honduras>



Part of the Archaeological Anthropology Commons

Recommended Citation

Hostenske, Mary, "EPV Op. 10-29 Lot Forms 2009" (2009). *Four Valleys Archive*. Paper 96660.
<https://digital.kenyon.edu/honduras/96660>

This Lot Card is brought to you for free and open access by the Anthropology at Digital Kenyon: Research, Scholarship, and Creative Exchange. It has been accepted for inclusion in Four Valleys Archive by an authorized administrator of Digital Kenyon: Research, Scholarship, and Creative Exchange. For more information, please contact noltj@kenyon.edu.

Op/SubOp/Lot: 10/29/01

Ex. Unit A

Size (NxEx) 1x1

Site: S-007

Str 15

Initial Lot? yes

Prev. lot -

Next lot -

BGS: 0-31cm

Initial elev.: NW 997.38 NE 997.33 SW 997.41 SE 997.32

Final elev.: NW 997.11 NE 997.13 SW 997.1 SE 997.17

Reference corner: SW

N 88.41

E -130.63

Deposit / Type

overburden/architecture tumble/wall/surface

Soil type silty clay loam

Munsell/Color _____

Drawings _____

Contents 82 ceramica

Photo/Digital _____

6 obsidiana

3 peridermal

Description/Sketch (with measurements):

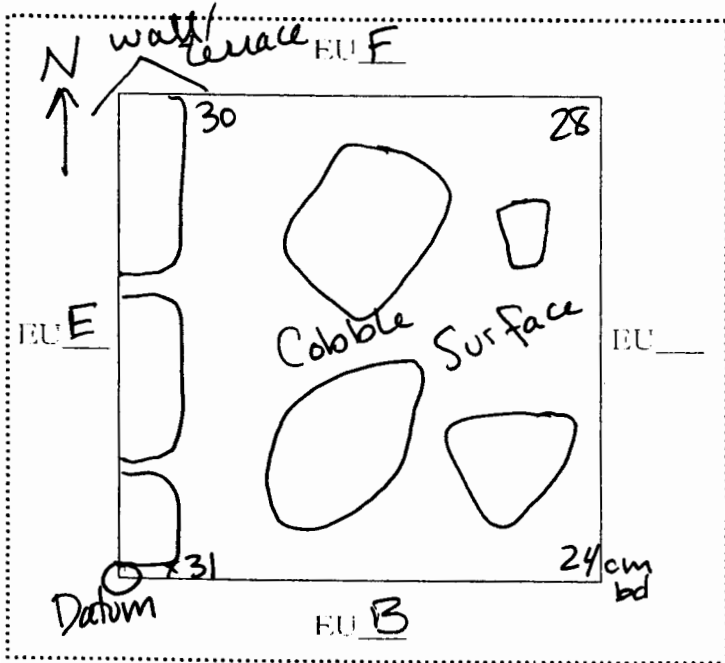

The purpose of this lot was to expose the southern extent of the eastern terrace of Str. 15. A portion of the terrace was uncovered as well as a portion of the same cobble surface that was exposed in Subop. 25.

Note refs 47

PAREP 2009 LOT FORM

Excavator 17

Date 7 July 2009

Op/SubOp/Lot: 10/29/02

Ex. Unit B

Size (NxEx) 1x1

Site: S-007

Str 15

Initial Lot? YES

Prev. lot -

Next lot -

BGS: 0-34 cm

Initial elev.: NW 997.41 NE 997.32 SW 997.36 SE 997.35

Final elev.: NW 997.08 NE 997.12 SW 997.1 SE 997.11

Reference corner: SW; EUC N 87.41 E -131.87

Deposit / Type architecture / wall/surface

Soil type silty clay loam Munsell/Color _____

Drawings _____ Contents 141 ceramica

Photo/Digital _____ 3 obsidiana

Description/Sketch (with measurements):

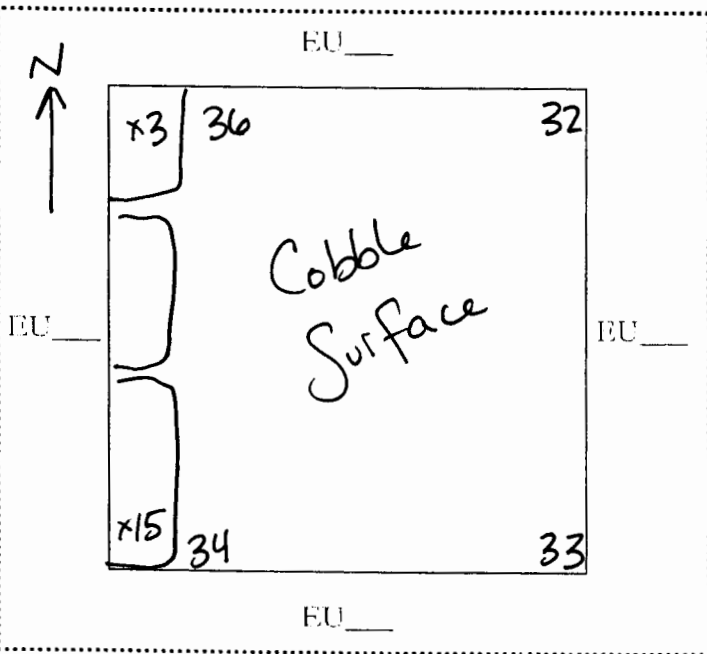

The purpose of this lot was to expose the southern extent of the eastern terrace of Str. 15. A section of the terrace & the cobble surface were uncovered in this lot.

Note refs 47, 48

Op/SubOp/Lot: 10/29/03

Ex. Unit C

Size (NxEx) 1x1

Site: S-007

Str 15

Initial Lot? yes Prev. lot - Next lot - BGS: 0-27cm

Initial elev.: NW 997.46 NE 997.91 SW 997.44 SE 997.36

Final elev.: NW 997.31 NE 997.17 SW 997.2 SE 997.27

Reference corner: SW; EUC N 87.41 E -131.87

Deposit / Type architectural / terrace/wall

Soil type silty clay loam Munsell/Color _____

Drawings _____ Contents 2 obsidiana

Photo/Digital _____ 18 ceramica

Description/Sketch (with measurements):

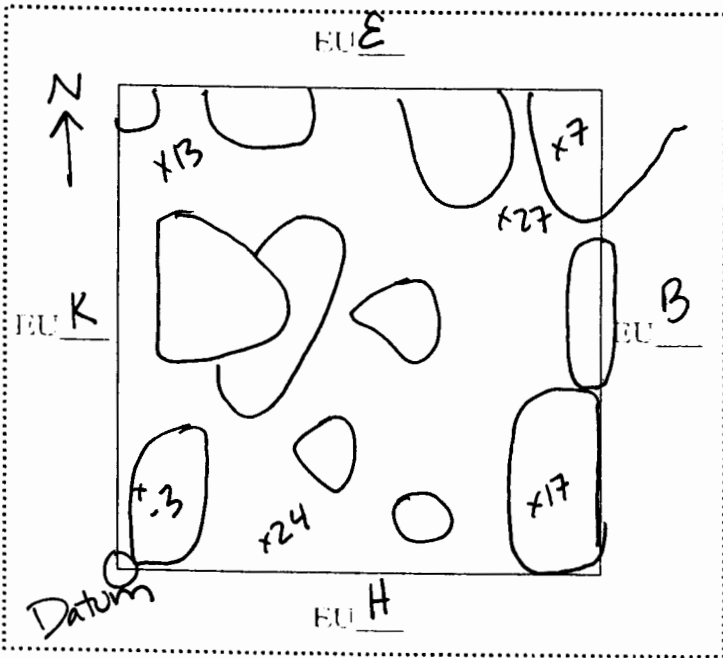

The purpose of this lot was to clarify the southern extent of the E. terrace & its relation to the E. basal wall. This lot uncovered the interior fill of the terrace & the edge of the basal wall.

Note refs 47, 48

Op/SubOp/Lot: 10/29/04

Ex. Unit D

Size (NxE) 1x1

Site: S-007

Str 15

Initial Lot? YES Prev. lot - Next lot - BGS: 0-30cm

Initial elev.: NW 997.36 NE 997.35 SW 997.38 SE 997.34

Final elev.: NW 997.08 NE 997.06 SW 997.18 SE 997.07

Reference corner: NW N 87.41 E -130.87

Deposit / Type architecture/collapse wall/tumble

Soil type silty clay loam Munsell/Color _____

Drawings _____ Contents 88 ceramics

Photo/Digital _____ 6 obsidiana
1 per dental

Description/Sketch (with measurements):

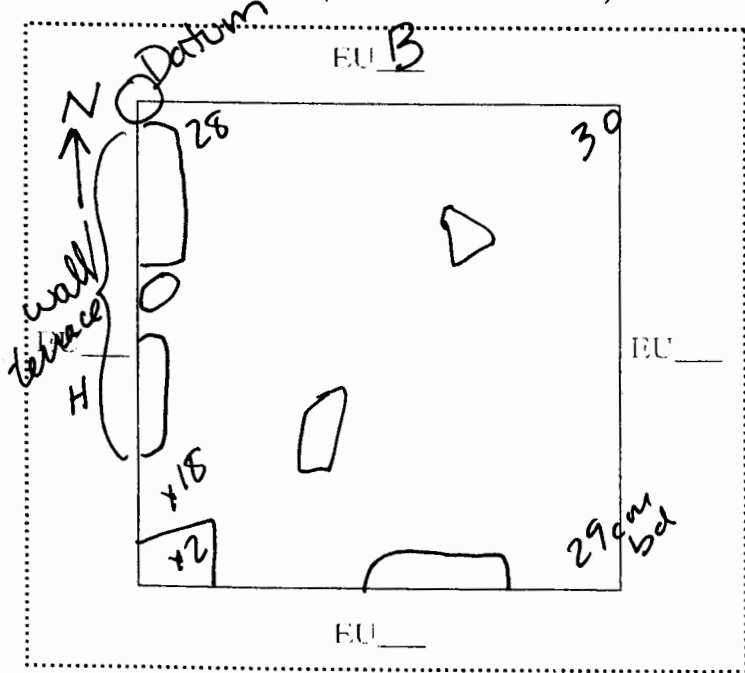

The purpose of this lot was to expose the southern extent of the eastern terrace. This lot finally accomplished this goal.

Note refs 48, 49

Op/SubOp/Lot: 10|29|05

Ex. Unit E

Size (NxEx) 1x1

Site: S-007

Str 15

Initial Lot? yes

Prev. lot -

Next lot -

BGS: 0-20cm

Initial elev.: NW 997.47 NE 997.38 SW 997.46 SE 997.41

Final elev.: NW 997.33 NE 997.26 SW 997.28 SE 997.3

Reference corner: SW

N 88.41

E -131.87

Deposit / Type architecture / wall/terrace

Soil type Silty clay loam

Munsell/Color _____

Drawings _____

Contents 20 ceramics

Photo/Digital _____

2 obsidians

1 peridermal

Description/Sketch (with measurements):

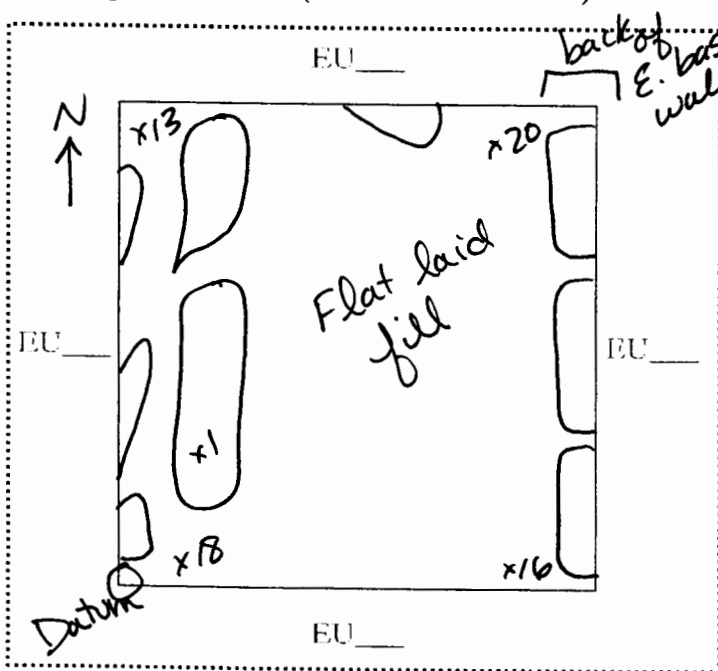

The purpose of this lot was to expose the extent of the E. terrace and to investigate the relationship between the terrace and the E. basal wall. The fill of the terrace and the edge of the E. basal wall was uncovered by this lot.

Note refs 48, 49

Op/SubOp/Lot: 10/29/06

Ex. Unit F

Size (NxEx) 1x1

Site: S-007

Str 15

Initial Lot? yes Prev. lot - Next lot - BGS: 0-30cm

Initial elev.: NW 997.36 NE 997.3 SW 997.38 SE 997.33

Final elev.: NW 997.1 NE 997.08 SW 997.1 SE 997.08

Reference corner: SW N 89.33 E -130.63

Deposit / Type architecture / collapse/wall

Soil type silty clay loam Munsell/Color _____

Drawings _____ Contents 68 ceramica

Photo/Digital _____ 7 obsidiana
2 peridernal
1 ground stone

Description/Sketch (with measurements):

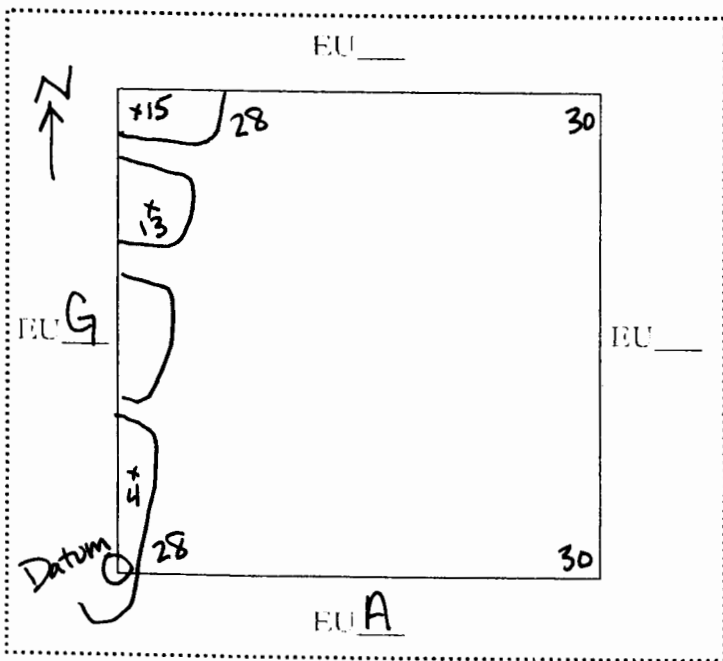

The purpose of this EU is to expose and clarify the extent of the E. terrace. A portion of the terrace was exposed.

Note refs 49,50

Op/SubOp/Lot: 10/29/07

Ex. Unit G

Size (NxEx) 1x1

Site: S-007

Str 15

Initial Lot? yes Prev. lot - Next lot - BGS: 0-40cm

Initial elev.: NW 997.49 NE 997.36 SW 997.47 SE 997.38

Final elev.: NW 997.08 NE 997.07 SW 997.36 SE 997.11

Reference corner: NW N 90.33 E -131.63

Deposit / Type architecture / fill/wall

Soil type Silty clay loam Munsell/Color _____

Drawings _____ Contents 20 ceramics
1 obsidiana

Photo/Digital _____

Description/Sketch (with measurements):

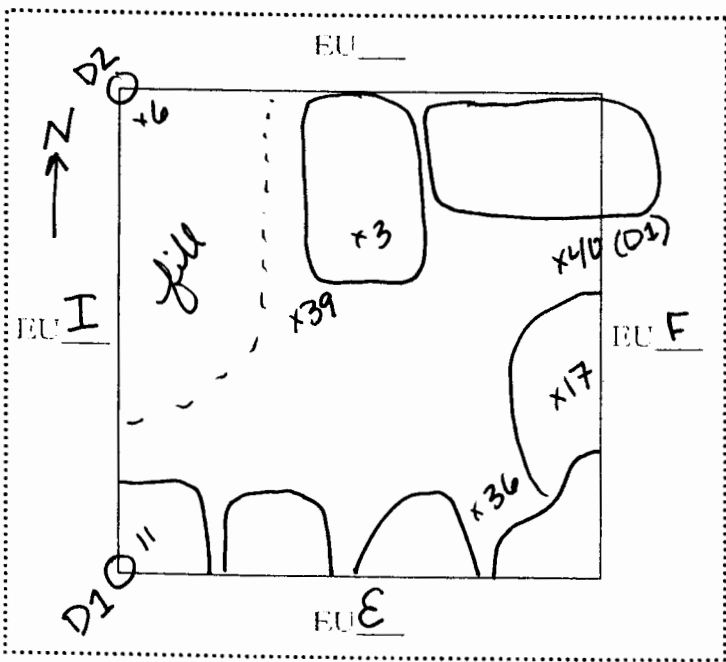

The purpose of this lot is to clarify the corner of the S. basal wall & its relationship to the fill of terrace the East.

*D2 is 10cm higher than D1

Note refs 50, 51

PAREP 2009 LOT FORM

Excavator 17

Date 7 July 2009

Op/SubOp/Lot: 10/29/08

Ex. Unit H

Size (NxEx) 1x1

Site: S-007

Str 15

Initial Lot? yes Prev. lot - Next lot - BGS: 0-33 cm

Initial elev.: NW 997.44 NE 997.36 SW 997.46 SE 997.38

Final elev.: NW 997.25 NE 997.19 SW 997.13 SE 997.14

Reference corner: SW N 86.57 E -131.87

Deposit / Type architecture / wall/terrace

Soil type silty clay loam Munsell/Color _____

Drawings _____ Contents 54 ceramics

Photo/Digital _____ 6 obsidiana
2 personal
1 metal

Description/Sketch (with measurements):

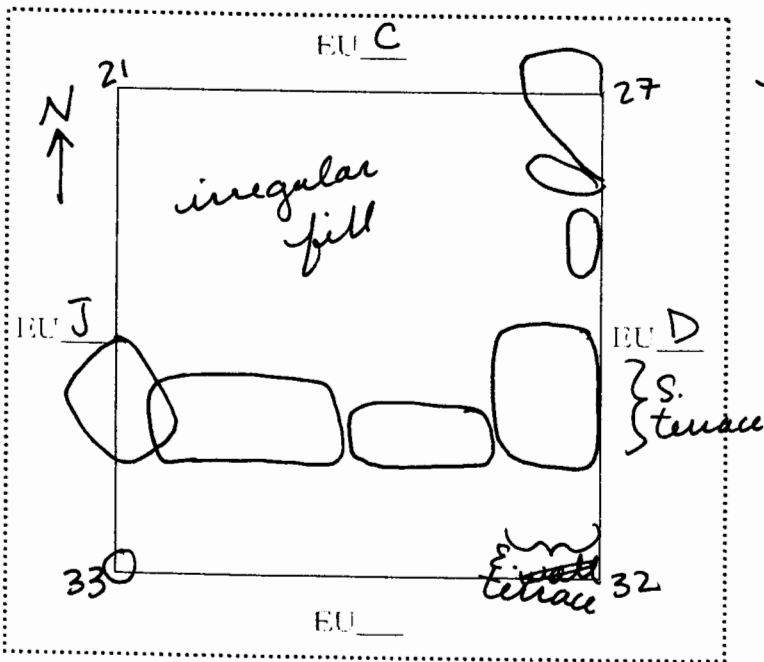

The purpose of this lot is to clarify the southern terrace wall. The corner of the S. terrace and the E. terrace walls was uncovered in this lot.

Note refs 50, 51

PAREP 2009 LOT FORM

Excavator 17

Date 7 July 2009

Op/SubOp/Lot: 10/29/09

Ex. Unit I

Size (NxEx) 1x1

Site: S-007

Str 15

Initial Lot? yes Prev. lot - Next lot - BGS: 0-14cm

Initial elev.: NW 997.51 NE 997.49 SW 997.5 SE 997.47

Final elev.: NW 997.48 NE 997.5 SW 997.47 SE 997.37

Reference corner: NW N 90.58 E -132.5

Deposit / Type architecture / fill/wall

Soil type silty clay loam Munsell/Color _____

Drawings _____ Contents 20 ceramics

Photo/Digital _____ 9 peridernal

Description/Sketch (with measurements):

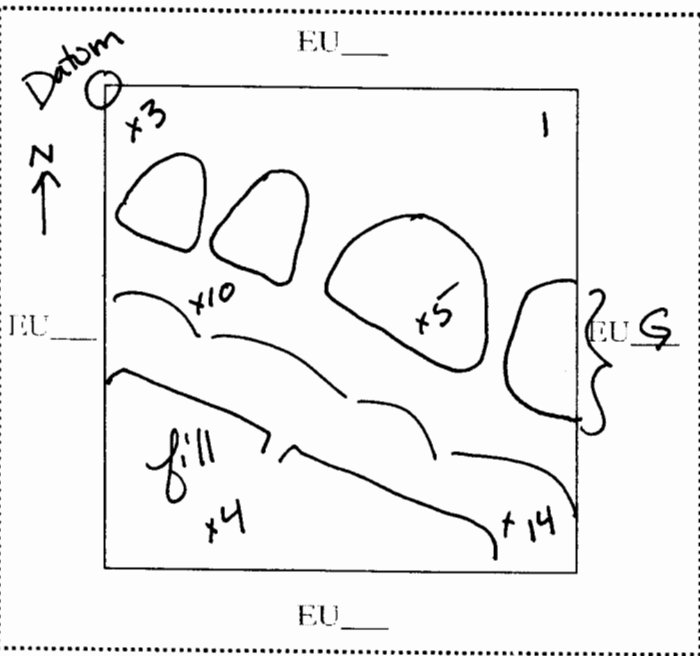

The purpose of this lot is to clarify the relationship between the E. terrace fill and the S. basal wall. The terrace fill abuts the basal wall.

ote refs 50, 51

PAREP 2009 LOT FORM

Excavator 17

Date 8 July 2009

Op/SubOp/Lot: 10/29/10

Ex. Unit J

Size (NxEx) 1x1

Site: S-007

Str 15

Initial Lot? YES Prev. lot - Next lot - BGS: 0-31cm

Initial elev.: NW 997.47 NE 997.44 SW 997.41 SE 997.46

Final elev.: NW 997.23 NE 997.26 SW 997.17 SE 997.15

Reference corner: SE N 86.57 E -131.87

Deposit / Type architectural / wall/fill

Soil type silty clay loam Munsell/Color _____

Drawings _____ Contents 2 pedernal

Photo/Digital _____ 2 obsidiana

70 ceramica
1 chip of shiny rock

Description/Sketch (with measurements):

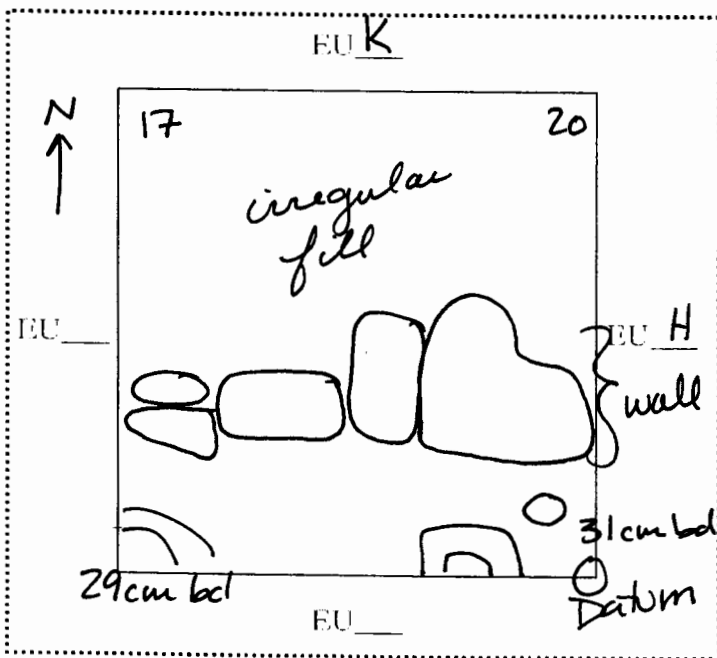

The purpose of this lot is to clarify the S. terrace wall. A portion of the terrace wall and the irregular fill comprising the terrace was uncovered in this lot.

Note refs 51, 52

Op/SubOp/Lot: 10/29/11

Ex. Unit K

Size (Nx E) 1x1

Site: S-007

Str 15

Initial Lot? yes Prev. lot - Next lot - BGS: 0-32cm

Initial elev.: NW 997.45 NE 997.46 SW 997.47 SE 997.44

Final elev.: NW 997.17 NE 997.29 SW 997.14 SE 997.19

Reference corner: NE N 88.41 E -131.87

Deposit / Type architectural / fill

Soil type silty clay loam Munsell/Color _____

Drawings _____ Contents bone

Photo/Digital _____ 50 ceramics
2 obsidiana

Description/Sketch (with measurements):

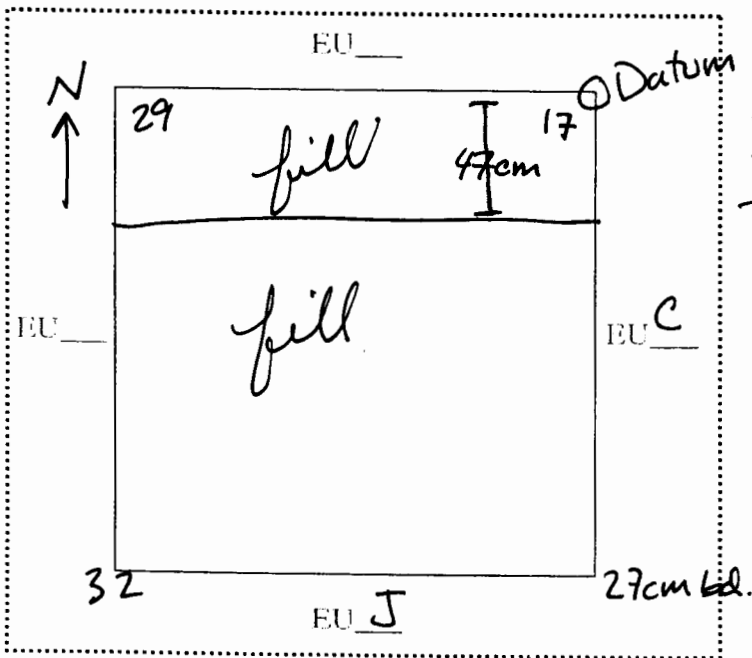

The purpose of this lot was to clarify the relationships of the E. terrace to the rest of Str. 15. This lot uncovered several layers of fairly flat laid fill.

Note refs 52