Four Valleys Archive

Anthropology

2009

EPV Op 14-05 Lot Forms 2009

Michelle Kittel

Follow this and additional works at: <https://digital.kenyon.edu/honduras>



Part of the Archaeological Anthropology Commons

Recommended Citation

Kittel, Michelle, "EPV Op 14-05 Lot Forms 2009" (2009). *Four Valleys Archive*. Paper 96665.
<https://digital.kenyon.edu/honduras/96665>

This Lot Card is brought to you for free and open access by the Anthropology at Digital Kenyon: Research, Scholarship, and Creative Exchange. It has been accepted for inclusion in Four Valleys Archive by an authorized administrator of Digital Kenyon: Research, Scholarship, and Creative Exchange. For more information, please contact noltj@kenyon.edu.

PAREP 2004 LOT FORM

Excavator #40

Date 20 June 2009

Op/SubOp/Lot: 14/5/01

Ex. Unit A

Size (NxE) 1x1

Site: 38

Str 5

Initial Lot? Yes

Prev. lot N/A

Next lot 2

BGS: 0-20 cm

Initial elev.: NW 985.29 NE 985.27 SW 985.23 SE 985.25

Final elev.: NW 985.09 NE 985.09 SW 985.09 SE 985.06

Reference corner NW-985.29 N 1393 E 186

Deposit / Type overburden / humus

Soil type clay/loam Munsell/Color Dark Brown

Drawings Contents Bajareque 37, Ceramic 2, Chert. 2

Photo/Digital 1

Description/Sketch (with measurements):

↑NW will continue on to the next lot, which will be 10cm so 20-30. It was supposed to be 20cm but this worked out because found cultural material in next lot. This lot had very little and is pretty empty, except for some ceramics in the NW corner and along the west wall

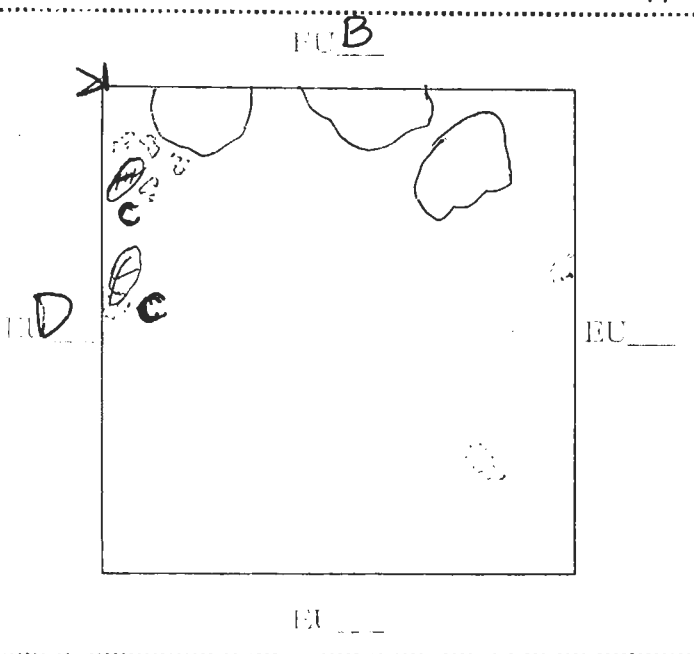

Note refs pg 2-3

p/SubOp/Lot: 14/5/02

Ex. Unit EU A

Size (NxL) 1x1

Site: 038

Str 5

Initial Lot? X Prev. lot 01 Next lot N/A BGS: 20-30cm

Initial elev.: NW 985.09 NE 985.09 SW 985.09 SE 985.06
-10 -30 -10 -30 -10 -30 -7-30

Final elev.: NW 984.99 NE 984.99 SW 984.99 SE 984.99

Reference corner: 985.29 N 1393 E -186

Deposit / Type refuse deposit on-floor deposit

Soil type clay/loam Munsell/Color Dark Brown (w/ new grey area)

Drawings _____ Contents ceramics 30 bajareque 42, chert 3

Photo/Digital yes 60 Bajareque in lot bag 2
10 ceramics in lot bag 2

Description/Sketch (with measurements):

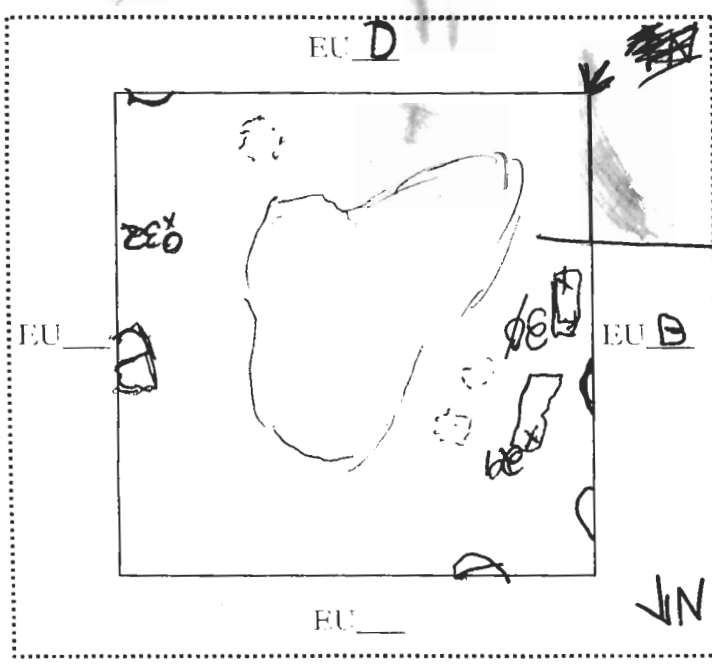

ceramic shards left in situ at 30cm, probable pot smash. Partially taken up, though. Will open new units to see the extent.

soil change - grey area (possibly ash?)
June 23 2009 - this lot is filling w/ water which change the elevations.

June 24 2009 - took ceramics out, put in a second lot bag along w/ bajareque

— = rock
X = ceramics ---- = bajareque

PAREP 2009 LOT FORM

Excavator MK

Date 22, Junio 2009

Op/SubOp/Lot: 14/5/03

Ex. Unit D

Size (NxEx) 1x1

Site: 038

Str 5

Initial Lot? Y

Prev. lot NO

Next lot 04

BGS: 0-20cm

Initial elev.: NW 985.38 NE 985.29 SW 985.26 SE 985.23

Final elev.: NW 985.29 NE 985.20 SW 985.20 SE 985.15

Reference corner: NW 985.38 N 1393 E -187

Deposit / Type overburden / Tumble/collapse

Soil type Clay/Loam Munsell/Color DK Brown

Drawings _____ Contents 2 ceramics, 2 bay reque, 1 obsidian

Photo/Digital yes + 6 bay reque

Description/Sketch (with measurements):

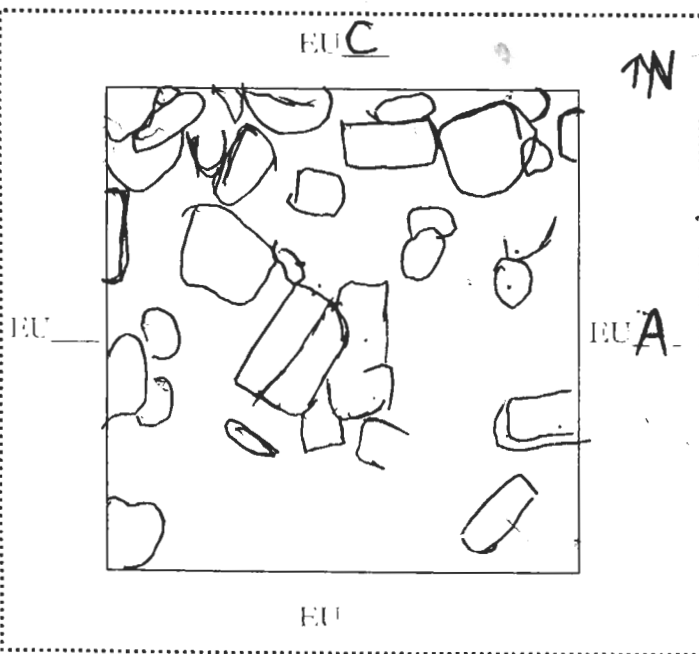

Because of the large number of rocks I was unable to take each corner to exactly 20cm. I made the flat areas twenty except where the rain seems to have made it 23cm I will continue on to 30cm, so that I can see how it links up with 30cm in unit A. will continue on to lot 4 in EUD.

2 lot bags

Note refs 4-5

PAREP 2008 LOT FORM

Excavator MK

Date 23/June/2009

p/SubOp/Lot: 14/6/04

Ex. Unit EUD

Size (NxF): 1x1

Site: 38

Str 5

Initial Lot? NO

Prev. lot 3

Next lot N/A

BGS: 20-35cm

Initial elev.: NW 985.29 NE 985.20 SW 985.20 SE 985.15
-25 -35 -35 -35

Final elev.: NW 985.13 NE 985.03 SW 985.03 SE 985.03

Reference corner: NW 985.38 N 1393 E -187

Deposit / Type overburden / Wall

Soil type clay/loam Munsell/Color DK Brown

Drawings _____

Contents Chert 3, ceramics 11, bajareque 2/2, carbon

Photo/Digital yes

Description/Sketch (with measurements):

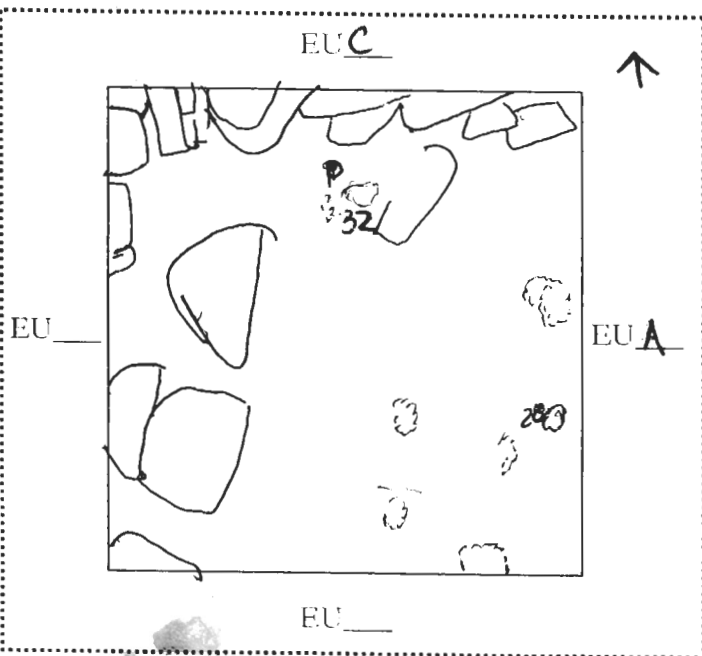

went down to 35 cm instead of 30 because EUD had been washed down to 35. Found only a few ceramic pieces that clearly correspond to EUD. Took picture showing that association as well as lot photo. Possible architectural feature, will ask Ellen

(the NW corner has a rock in the way)
E. portion of Basal Wall, will refer to as DREAM, it is one course high

ote refs 5-7

#s are dept not N+W

PAREP 2009 LOT FORM

Excavator MK

Date 24 June 2009

Op/SubOp/Lot: 14/05/05

Ex. Unit B

Size (NxEx) 1x1

Site: 038

Str 5

Initial Lot? Yes Prev. lot No Next lot 06 BGS: 0-20

Initial elev.: NW 985.36 NE 985.28 SW 985.29 SE 985.27
-20 -20 -22 -20

Final elev.: NW 985.16 NE 985.16 SW 985.14 SE 985.14

Reference corner: ^{NW} 985.36 N 1394 E -186

Deposit / Type overburden / midden

Soil type clay loam Munsell/Color DK Brown

Drawings _____ Contents Bajareque 47, Ceramic 16, Obsidian Blade 1

Photo/Digital Yes Chert 4, 1 possible artifact 1

Description/Sketch (with measurements):

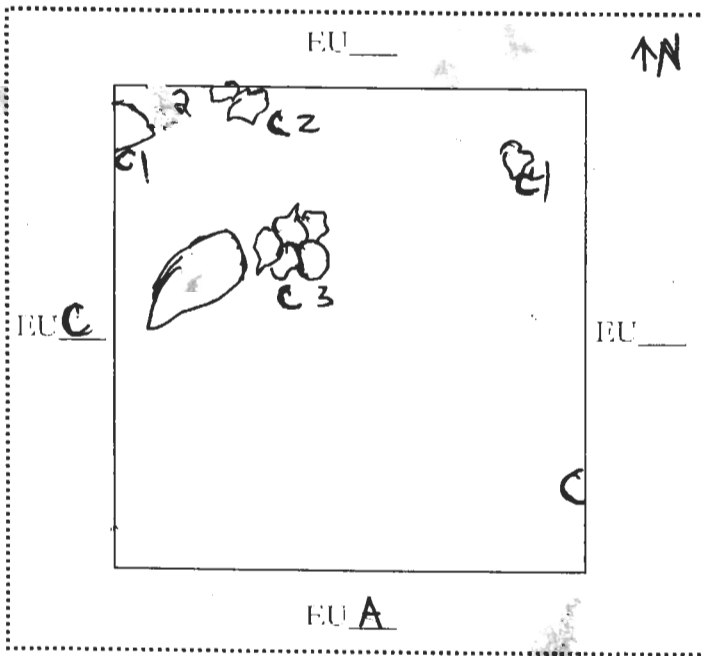

This unit had very little in it except for some ceramics and the obsidian blade that is really cool. Will continue into next lot in this unit, 20' - 35'

Possible textile needle, need further analysis
C1 = 5 E, 18 S
C2 = 28 E, 35
C3 = 35 E, 38 S
C4 = 74 E, 22 S

C = ceramic S = South

Note refs 7-8

Op/SubOp/Lot: 14/05/06

Ex. Unit B

Size (NxEx) 1X1

Site: 030

Str 05

Initial Lot? NO

Prev. lot 05

Next lot N/A

BGS: 20-35

Initial elev.: NW 985.16 -22 NE 985.16 -35 SW 985.14 -35 SE 985.14 -35

Final elev.: NW 985.14 NE 985.01 SW 985.01 SE 985.01

Reference corner: 985.36

N 1394

E -186

Deposit / Type overburden

Soil type clay loam

Munsell/Color Dk Br

Drawings _____

Contents Bijouque 149 ceramic 17 obsidian 1 chert 4

Photo/Digital yes

Description/Sketch (with measurements):

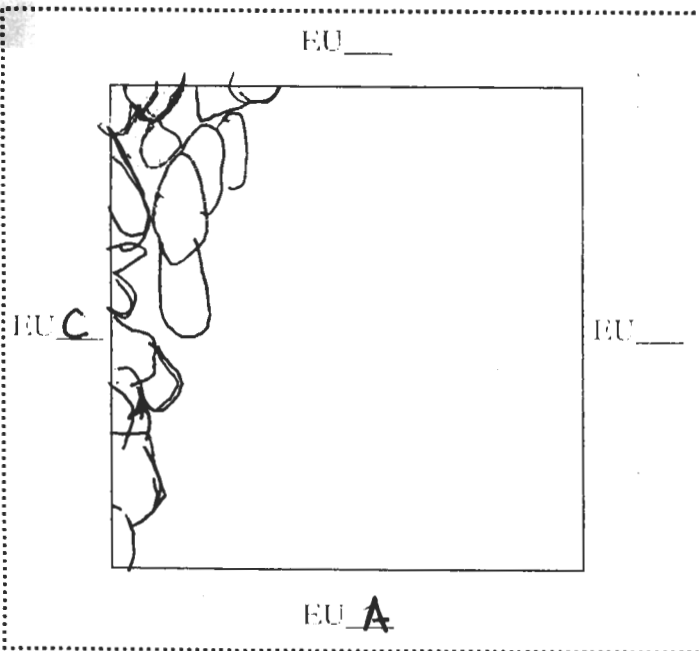

cont of previous lot,
 I think that this EU + EUA were the back
 of the str. and that they were a midden
 for this str. and maybe the rest of the site

obsidian ~~60~~ E, 22 S

S = Sath

Note refs 7-8

PAREP 2009 LOT FORM

Excavator MK

Date 25 June 2009

Op/SubOp/Lot: 14/05/07

Ex. Unit C

Size (NxEx) 1x1

Site: _____

Str 05

Initial Lot? yes Prev. lot ~~NO~~ NO Next lot B BGS: 0-20

Initial elev.: NW	<u>985.43</u> -16	NE	<u>985.36</u> -20	SW	<u>985.38</u> -17	SE	<u>985.29</u> -21
Final elev.: NW	<u>985.27</u>	NE	<u>985.23</u>	SW	<u>985.26</u>	SE	<u>985.22</u>

Reference corner: NW 985.43³/₁₆ N 1394 E -187

Deposit / Type overburden / terrace

Soil type clay loam Munsell/Color Dk Brown

Drawings _____ Contents Baja que 8, Ceramic 6, Obsidian 1

Photo/Digital yes

Description/Sketch (with measurements):

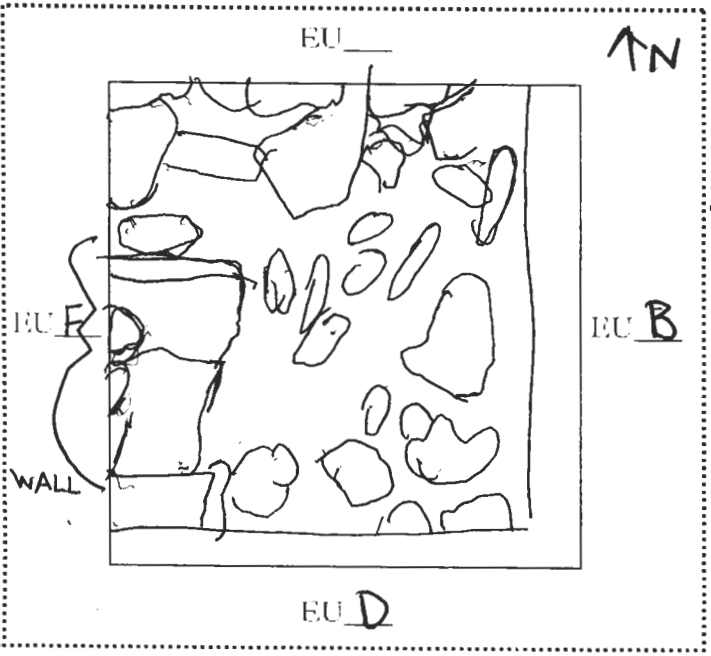

This lot will hopefully have the rest of my basal wall (which was found in EUD) in it.

This lot shows more evidence of my basal wall, as well as a lot of overburden and tumble.

-Not my wall, upper terrace

Note refs B-4

PAREP 2009 LOT FORM

Excavator MK

Date 25 June 2009

Op/SubOp/Lot: 14/05/08

Ex. Unit C

Size (NxE) 1X1

Site: 038

Str 05

Initial Lot? NO

Prev. lot 07

Next lot N/A

BGS: 20-35

Initial elev.: NW 985.27 NE 985.23 SW 985.26 SE 985.23

Final elev.: NW 985.28 NE 985.06 SW 985.34 SE 985.07
-15 -37 -17 -36
27 26

Reference corner: NW 985.43

N 1394

E -187

Deposit / Type

Overburden

Wall

Soil type clay/loam

Munsell/Color DK Brown

Drawings _____

Contents bioregion 95, ceramics 13

Photo/Digital yes

carbon 2
Chert 15

Description/Sketch (with measurements):

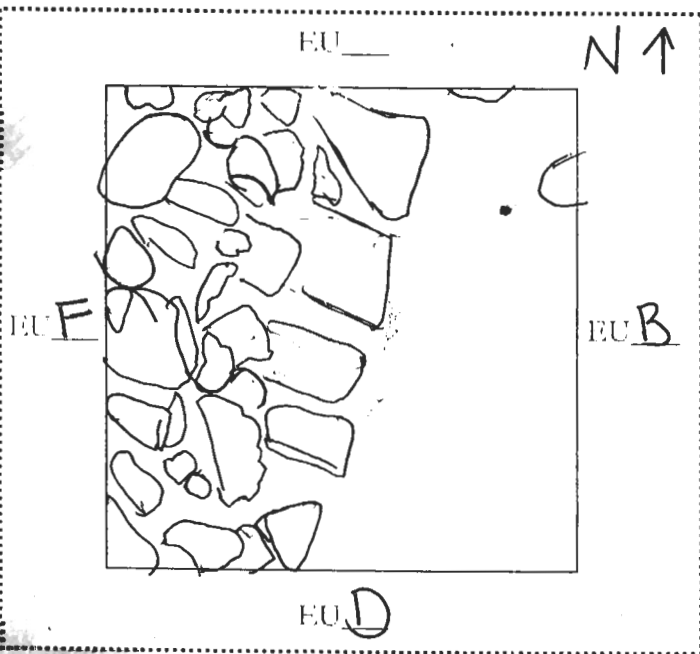

cont of previous lot. hope to uncover more of my wall.

Yay! I have more of my basal wall, plus a possible step in this unit. went down a bit deeper in 2 corners than planned, but it was done to expose the wall:

Note refs 0 9

PAREP 2009 LOT FORM

Excavator JK

Date 26 June 2009

Op/SubOp/Lot: 14/05/09

Ex. Unit F

Size (NxEx) 1x1

Site: 038

Str 05

Initial Lot? Yes

Prev. lot NO

Next lot NO

BGS: 0-20

Initial elev.: NW 985.42 NE 985.43 SW 985.39 SE 985.38

Final elev.: NW 985.33 NE 985.34 SW 985.32 SE 985.37

Reference corner: NE 985.43

N 1394

E -187

Deposit / Type overburden / floor?

Soil type clay/loam Munsell/Color Dk Brown

Drawings _____ Contents 2 ceramics 3 bajareque

Photo/Digital yes

Description/Sketch (with measurements):

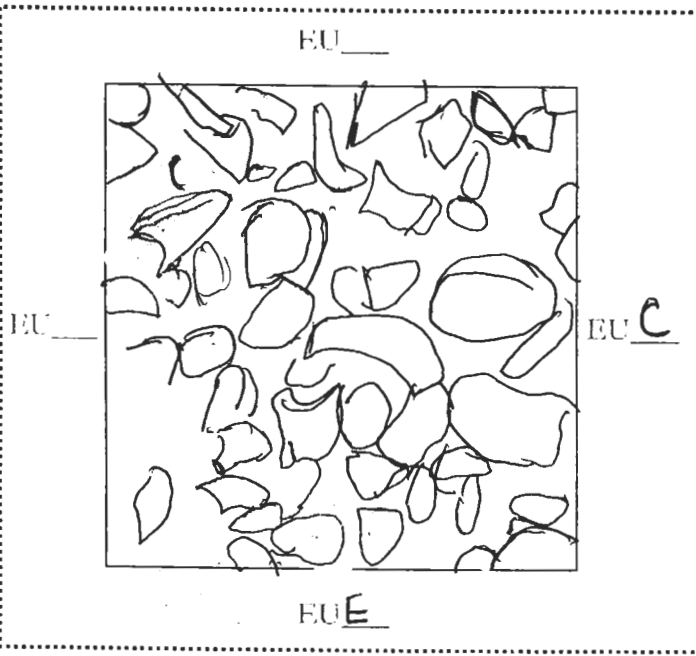

Ryan's worker came over to help, he is working on this lot, while Filiberto is working EUC, lot 8 only went down far enough to expose the first layer of rock that, according to Bell is either more tumble or the rocks that were under a tamped earthen floor.

this is not an elite str. or site

Note refs 10

PAREP 2009 LOT FORM

Excavator MK

Date 26 June 2009

Op/SubOp/Lot: 14/05/10

Ex. Unit E

Size (NxEx) 1x1

Site: 038

Str 05

Initial Lot? Yes Prev. lot N/A Next lot N/A BGS: 0-19

Initial elev.: NW 985.39 NE 985.38 SW 985.29 SE 985.26

Final elev.: NW 985.29 NE 985.24 SW 985.21 SE 985.20

Reference corner: NW 985.39 N 1393 E -188

Deposit / Type Overburden / wall? upper terrace?

Soil type clay/loam Munsell/Color DK Brown

Drawings _____ Contents 16 Bajareque, 3 ceramic, 1 chert

Photo/Digital Yes

Description/Sketch (with measurements):

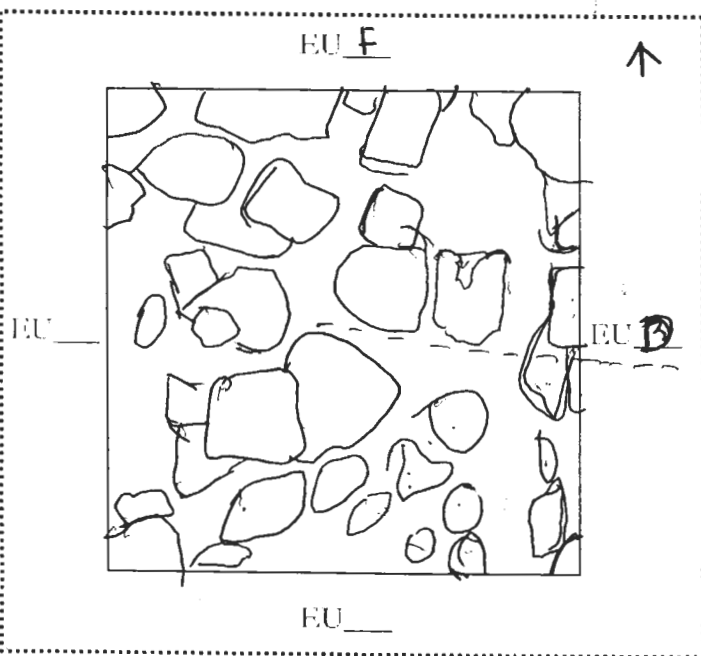

Extending from unit F to see the tumble and any other architecture that might be visible.

I guess its kind of hard to see in the drawing but the dotted line might be the upper terrace of this structure

Note refs 10

PAREP 2009 LOT FORM

Excavator UK

Date 26 June 2009

Op/SubOp/Lot: 14/06/11

Ex. Unit G

Size (NxEx) 1x1

Site: 038

Str 05

Initial Lot? Yes Prev. lot _____ Next lot 12 BGS: 0-20

Initial elev.: NW 985.29 NE 985.26 SW 985.21 SE 985.22

Final elev.: NW 985.16 NE 985.14 SW 985.09 SE 985.09

Reference corner: NW 985.29 N 1390 E -188

Deposit / Type overburden / tumble

Soil type clay/loam Munsell/Color DK Brown

Drawings _____ Contents 112 bajareque, 1 chert, 1 obsidian blade,

Photo/Digital yes 21 ceramic

Description/Sketch (with measurements):

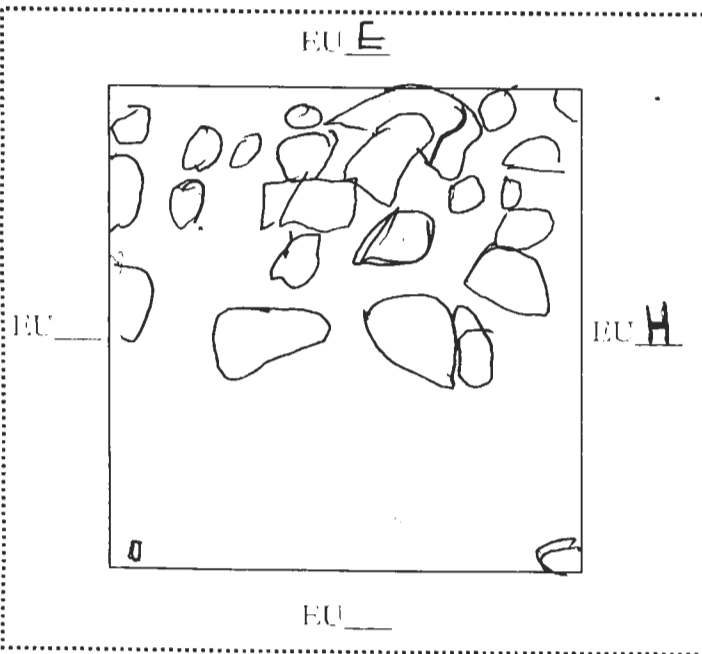

opened this lot, looking for more of the wall, plus the corners of the str. Need to go down farther though, so continuing to the arbitrary 35 cm that the rest of the site has been dug to.

11 E, 65 obsidian blade

Note refs 10

PAREP 2009 LOT FORM

Excavator JK

Date 27 JUNE 2009

Op/SubOp/Lot: 14/05/12

Ex. Unit G

Size (NxEx) 1X1

Site: 038

Str 05

Initial Lot? Yes Prev. lot 11 Next lot N/A BGS: 20-35

Initial elev.: NW 985.29 NE 985.26 SW 985.21 SE 985.22

Final elev.: NW 985.16⁻¹³ NE 984.96⁻³³ SW 984.95⁻³⁴ SE 985.96⁻³³

Reference corner: NW 985.29 N 1392 E -188

Deposit / Type overburden / wall

Soil type clay / loam Munsell/Color DK Brown

Drawings _____ Contents 378 bajareque, 6 chert, 26 ceramic

Photo/Digital yes 11 chert, 21 ceramic
+ 330 bajareque, 28 ceramic, 2 chert

Description/Sketch (with measurements):

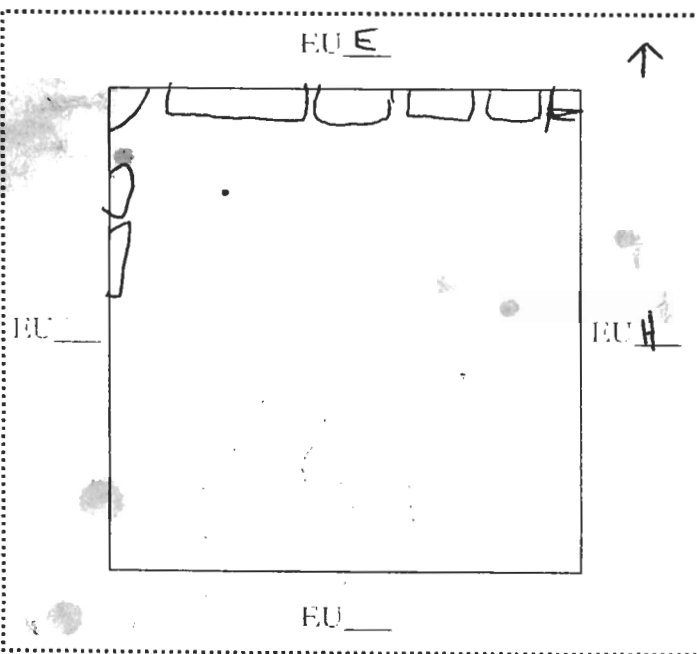

After hours of removing fymble I finally found my 2nd wall. There was a ton of bajareque in this lot. Maybe a collapsed bajareque wall?

There was a possible addition to this building, but it was removed looking for the wall. The reason I say this because there were a couple of rows/layers of what we thought was the wall, before we actually came to it.

3 lot bag

Note refs 10, 11, 12

PAREP 2009 LOT FORM

Excavator MK

Date 27 JUNE 2009

Op/SubOp/Lot: 14/05/13

Ex. Unit H

Size (NxEx) 1x1

Site: 038

Str 05

Initial Lot? Yes Prev. lot N/A Next lot N/A BGS: 0-35

Initial elev.: NW 985.26 NE 985.23 SW 985.22 SE 985.25
-20 -29 -31 -29

Final elev.: NW 985.09 NE 985.00 SW 984.98 SE 985.00

Reference corner: EU G NW 985.29 N 1390 E -108

Deposit / Type overburden / tumble

Soil type clay/loam Munsell/Color DK Brown

Drawings _____

Contents: _____

Photo/Digital Yes

6 ceramic 24 bajareque 2 chert
16 bajareque

Description/Sketch (with measurements):

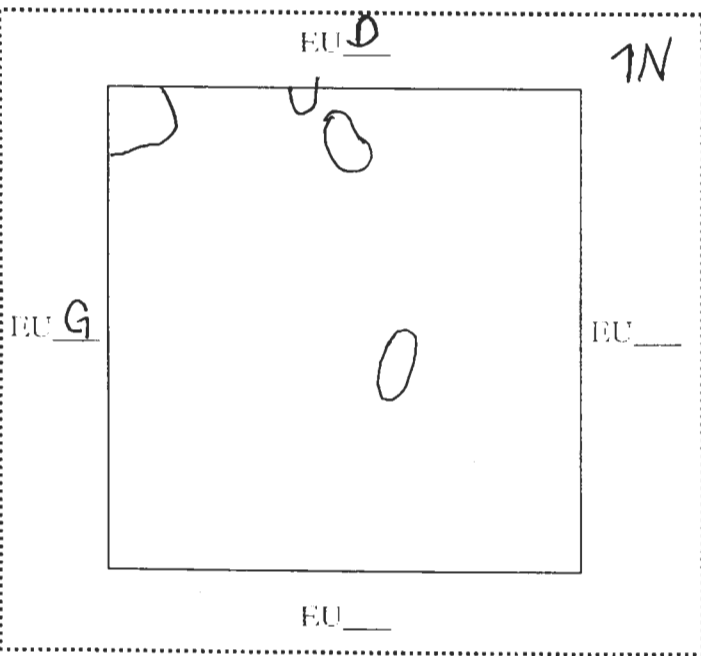

opened this unit, looking for the corner of the building

New reference corner - NW corner of EU G. ★

when I measured my lot, they had taken it down to 25 in some places and 30 in the SE corner, so I made the decision to have them finish the last few centimeters since they weren't finding a whole lot, mainly bajareque

the only the very edge of the corner of the basal wall is in this lot

Note refs 12

PAREP 2009 LOT FORM

Excavator MK

Date 29 June 2009

Op/SubOp/Lot: 14/05/14

Ex. Unit I

Size (NxEx) 1x1

Site: 038

Str 5

Initial Lot? Yes Prev. lot 0 Next lot 15 BGS: 0-19

Initial elev.: NW 985.32 NE 985.³²~~00~~ SW 985.43 SE 985.36

Final elev.: NW 985.⁻¹⁴32 NE 985.⁻¹⁷26 SW 985.⁻⁰⁹34 SE 985.⁻¹⁹24

Reference corner: SW 985.43 N 1394 E -187

Deposit / Type overburden / timber

Soil type clay/loam Munsell/Color DK Brown

Drawings _____ Contents 10 ceramic, 6 chert, 6 bayonette

Photo/Digital Yes

Description/Sketch (with measurements):

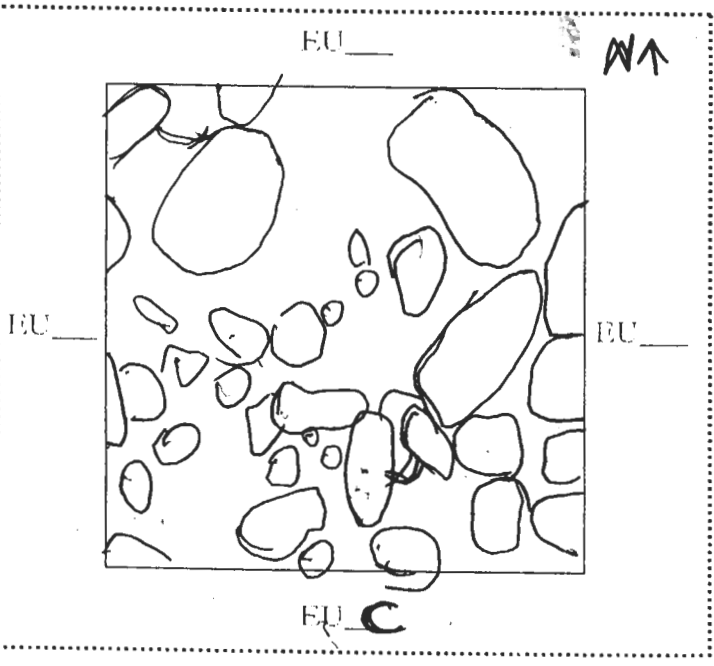

overburden, looking for more of the basal wall, will go down to next lot 19-35cm -

Note refs 13, 2p

Op/SubOp/Lot: 14/05/15

Ex. Unit I

Size (NxEx) 1x1

Site: 038

Str 05

Initial Lot? N/A Prev. lot 14 Next lot N/A BGS: 19-35

Initial elev.: NW 985.32 NE 985.26 SW 985.34 SE 985.24

Final elev.: NW 985.28 NE 985.10 SW 985.31 SE 985.04

Reference corner: SW 985.43 N 1394 E .187

Deposit / Type overburden / wall

Soil type clay/loam Munsell/Color DK Brown

Drawings _____ Contents 17 bajareque, obsidian, 4 chert, 11 ceramic

Photo/Digital yes

Description/Sketch (with measurements):

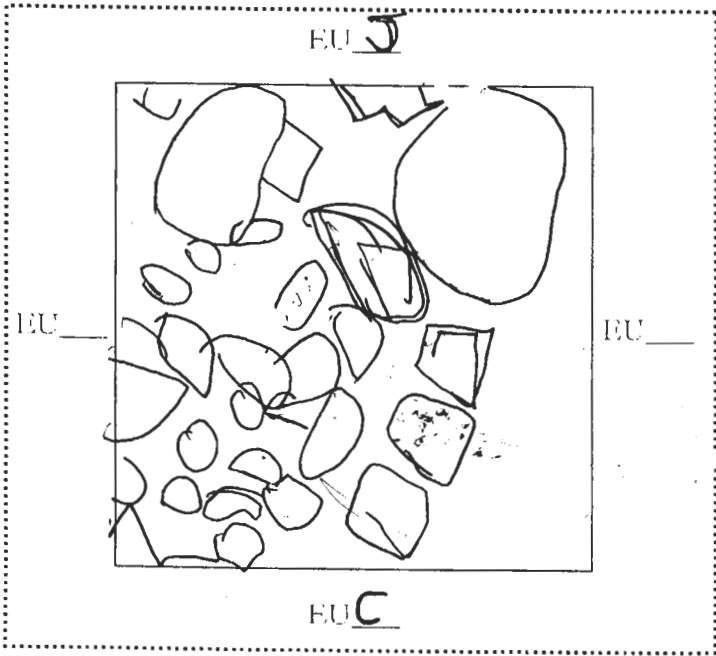

still following the wall, looking for my 2nd corner, this lot was mainly overburden again with evidence of the upper terrace.

obsidian Z: 22 S: 35 E: 80 cm flake

The large oblong rock in the drawing is the N. corner of the basal wall

Note refs 13, 20

$\frac{13}{8}$ $\frac{20}{34}$ $\frac{13}{4}$

Op/SubOp/Lot: 14 / 05 / 14

Ex. Unit J

Size (NxEx) 1X1

Site: 038

Str 05

Initial Lot? 4 Prev. lot NO Next lot N/A BGS: 0-30

Initial elev.: NW 985.31 NE 985.23 SW 985.32 SE 985.26

Final elev.: NW 985.12 NE 985.02 SW 985.15 SE 985.01

Reference corner: SW: 985.32 N 1395 E -187

Deposit / Type overburden / wall

Soil type clay/loam Munsell/Color DK Brown

Drawings _____ Contents 12 ceramics, 1 bajareque, 1 chert

Photo/Digital _____ 1 tooth (cow)
30 ceramics, 21 bajareque, 1 obsidian

Description/Sketch (with measurements):

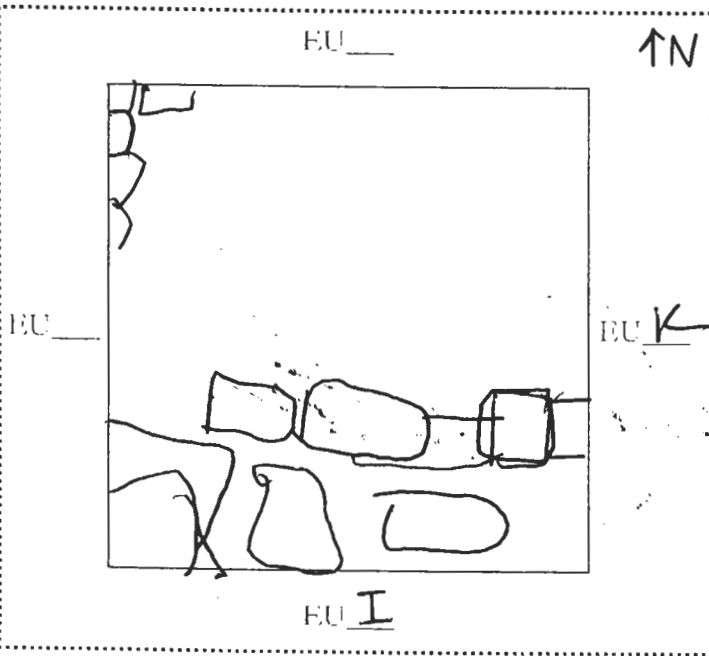

Searching frantically for the corner since time is almost up. I really want to be able to have 2 corners of my str to talk about. ~~A~~ corner is not in this this lot. It is in EU I found young cow incisor

2 lot bags

Note refs 20, 21

PAREP 2009 LOT FORM

Excavator MK

Date 30 JUNE 2009

Op/SubOp/Lot: 14/05/17

Ex. Unit K

Size (NxEx) 1x1

Site: φ38

Str φ5

Initial Lot? yes

Prev. lot NO

Next lot _____

BGS: φ-30

Initial elev.: NW 985.27 NE 985.21 SW 985.26 SE 985.31

Final elev.: NW 985.φ2 NE 985.φ9 SW 985.φ1 SE 985.φ8

Reference corner: SW of EUJ 985.32 N 1395 E -187

Deposit / Type Overburden / tumble

Soil type clay/loam Munsell/Color DK Brown

Drawings _____ Contents 4 bajareye, 4 ceramic, 1 obsidian

Photo/Digital _____

Description/Sketch (with measurements):

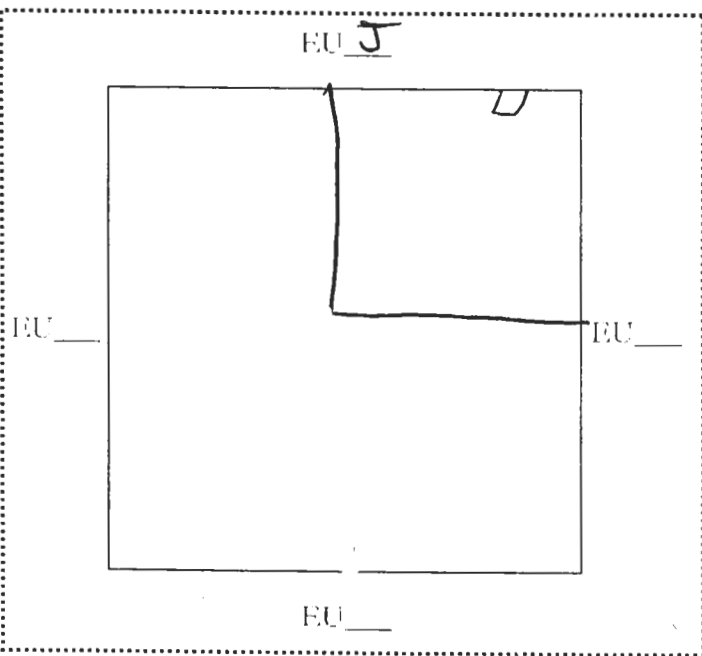

Quarter lot to find corner.
 No architecture in this lot ☆
 but it helped us narrow where the corner was.
 My reference corner was the SW corner of EUJ. I picked this for simplicity's sake

Note refs 27