

1996

PVN-102-Solometo-Field Notes-1996

Julie Solometo
Kenyon College

Follow this and additional works at: <https://digital.kenyon.edu/honduras>

 Part of the Archaeological Anthropology Commons

Recommended Citation

Solometo, Julie, "PVN-102-Solometo-Field Notes-1996" (1996). *Four Valleys Archive*. Paper 8481.
<https://digital.kenyon.edu/honduras/8481>

This Field Notes is brought to you for free and open access by the Anthropology at Digital Kenyon: Research, Scholarship, and Creative Exchange. It has been accepted for inclusion in Four Valleys Archive by an authorized administrator of Digital Kenyon: Research, Scholarship, and Creative Exchange. For more information, please contact noltj@kenyon.edu.

Site 104, Structure 4, subops C+K

P96-102-01

5-22-96

We have begun excavating a trench across the second largest of a group of 4 mounds. These four mounds make up 1 of 4 mound groups / single mounds designated Site 104. A large single mound, estimated to be ~~late~~ Middle Preclassic in date lies to the E + S. The mound group we are excavating is thought to be Late Classic — the primary goal of excavation is to confirm or refute this guess. Lateral clearing of any exposed walls will follow excavation of the trench if time permits. ~~the trench, suboperation 104C,~~

Another Late Classic? mound group is W and slightly N of our group at the edge of a ^{forested} area. The fourth component of site 104 lies somewhere to the N of our mound group, but I am unable to see it. The trench, suboperation 104C, is 12m x 1m and is oriented perpendicular to what appears to be the ^{greatest} length of the structure, at 24° E of N. We began excavation with a 1x1m unit at the S end of the trench, on what appears to be the "patio" side of the structure. Rocks at ground surface did not clearly indicate, but did suggest, a possible orientation of the structure, from which we laid out our trench.

note: 1x1m units are named by their coordinates of their NE corner.

The datum, 50N50E, was set at the NE corner of the first unit excavated, the S most unit of the trench. I assumed the grid was ~~just a~~ a true N-S grid for the purposes of naming units, though the N-S line is 24° E of N.

lot # 104C/b1 GS to 20cm BGS in 50N50E. Soil is a dark brown, silty loam? with some clay. No rock alignments were encountered. Shards, obsidian, bajareque. Soil includes some small (~10cm) rocks.

lot # 104C/b2 20-40cm BGS in 50N50E. No change in soil color or texture, until about 27cm BGS when soil becomes lighter in color and more compact. This change appears to be due to the differential water content of the upper ~25cm of soil, not to a change in soil type. Shards, obsidian, bajareque.

lot # 104C/03 40-50 cm BGS in 50N 50E. We are looking to see if artifact density drops off. The soil in this level is slightly more compact than the lot above. Artifact density did decrease in this level, with bajareque + sherds primarily coming from the upper most centimeters.

5-23-96 Thursday

lot # 104C/04 0-20 cm BGS in 51N 50E. We have moved a meter "in" towards the summit of the mound, looking for the edge of the tumble. In the lower 10 cm of the lot, rubble was found in the northern half of the unit, as well as along the E + W sides. A 35×20^{15} cm rock appeared to be smoothed on ~~both~~ sides, but is both concave (on both smoothed sides) and pitted. It was not vesicular basalt. The workers did not think it was cultural. Sherds, a worked? chert flake.

lot # 104C/05 This lot was a bit confused due to poor communication between myself and my two workers. It includes from 20 BGS to rubble (approx. 30-35 cm) in the N $\frac{2}{3}$ of the unit, and 20-40 BGS^{approx. Or the approx. base of the rubble in N $\frac{2}{3}$} in the S $\frac{1}{3}$ of the unit, where rubble was not found. From 51N 50E. Sherds, obsidian, baj., chert.

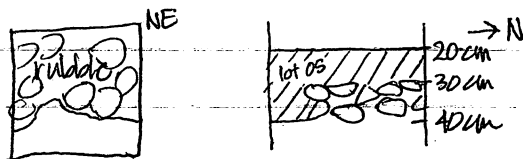

lot # 104C/06 removed the rubble from 51N 50E as this lot. approx 30/35 to 45 cm BGS. Rubble is in the northern $\frac{2}{3}$ - $\frac{3}{4}$ of unit, and shows no rock alignments. As we move in towards the first wall (hopefully there will be one), we will organize our lots by below, above, + rubble "beds". Sherds, metate/foot.

lot # 104C/07 level from base of rubble (approx 45 cm BGS) in N portion of unit, from ~40 cm in S portion of unit to 50 cm BGS. Sherds, bajareque. 51N 50E

p96-102-03

lot #104C/8 looking for sterile in 1st unit, 50N50E. 50-60 cm BGS.

The soil is fairly compact, as it was in the above 10 cm. Two fragments of bajareque, possibly fragments of a floor? have been exposed in the S wall of the unit.

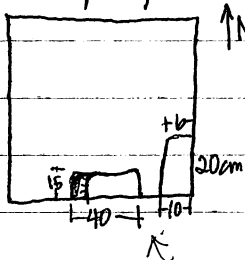

The next unit to the south will have to be opened (if time permits) to determine how far the bajareque surface extends (if it is a surface) + if it is a true floor as the workers suspect. ^{or two flat pieces / fragments of b. wall.} The bajareque is 56 cm BGS + 45 cm of its depth has been exposed.

Only 2 sherds and one small snail shell were found, suggesting these 10 cm are fairly "sterile." The ~~absence of~~ bajareque fragments of course suggest this is not sterile and the lack of artifacts in association with these fragments? / floor? is surprising.

lot #104C/9 above the rubble (0-18/20 cm BGS) in 52N50E.

Underneath approx. 5 cm of topsoil is dense, but small-sized rubble, which was removed to reveal larger rocks, some edges of which were just below ground surface. Sherds, bajareque.

lot #104C/10 the rubble layer (18/20-34-46 cm BGS) in 52N50E.

Soil color and texture still unchanged. Two large rocks in NE + NW corners. Rock in NE corner was removed. Sherds, bajareque, 1 piece chipped stone.

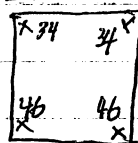

terminal elevs

5-24-96 Friday

lot #104C/11 the layer below the rubble (34-46-60 cm BGS) in 52N50E.

Soil is more compact than above, but color and overall texture are unchanged. Rocks are fewer + smaller (of course). Artifact density drops off a great deal in comparison with the rubble layer above. A small number of sherds (approx. 20).

lot #104C/12 0-20 cm BGS (above rubble) in 53N50E. The soil is dark brown, (moist) fairly loose and is denser with small (5x5 cm) rocks. Some rubble is apparent in the S portion of the unit. Sherds, obsidian blade.

P96-102-04

lot # 104C/13 This lot is from 53N50E, from 20-40 cm BGS in the northern 3/4 of the unit. The rubble is limited to the southern 1/4 of the unit and was encountered at a depth of ~16. This is odd given that I expect more rubble to be ~~at the~~ towards the summit of the mound, and soil deposition would seem to be less likely. The soil ~~is loose~~ in the N portion of the unit is loose + easy to excavate, suggesting that the S rubble, however unattractive (and only 1 "course"), may be a wall of some sort. The summit of the mound is only 1 1/2 m from the N wall of the unit. Shards, bajareque, obsidian blade. No sign of rubble in N 3/4 @ 40 cm.

We have moved to the next unit N, 54N50E, rather than continue from 40-60 cm in ~~the~~ 53N50E because it is too cramped to excavate.

lot # 104C/14 This lot is from ground surface to 20 cm BGS / rubble (from 1-10 cm) in 54N50E. There are many rocks at the surface, most small (5 x 5 cm) and some large (20 x 10 cm). We are at the summit of the mound so I expect a wall soon. The soil is the same and the rest of the trench, dark in color due to moisture or greater amounts of organic material. Artifact density is modest. A line of 4 large + other smaller cobbles is in the N end of the unit and can be read to extend either from the NE corner to the middle of the western wall, or from the NE to the SW corner. These may join up with the alignment in the next unit to the south, 53N50E. A large rock (20 x 20 cm) that didn't appear to be in an alignment was removed from the SE corner. A few smaller rocks were wedged underneath it. Shards, bajareque



lot # 104C/15 This lot is from the SE corner of 54N50E, from 30 to 40 BGS. The soil is unchanged, except for a lightening in color w/ depth, and is still easy to excavate. Artifact density is low (~25 shards). Shards, obsidian blade.

P96-102-05

5-27-96 Monday

Edwardito is sick so I'm starting his two workers on the N most unit, 61 N 50E. They will dig by 20cm levels, screening with a 1/4" screen.

¹⁰⁴
lot # C/16 in 61 N 50E. 0-20 cm BGS. Very few rocks, ^{2-40 sherds} ~~very few sherds~~ obsidian. Soil is dark (wet) and screening makes it clear that the soil is fairly clayey. Tip of an obsidian point.

¹⁰⁴
lot # C/17 in 55 N 50E. Down to rubble/broken vessel/schist slabs.

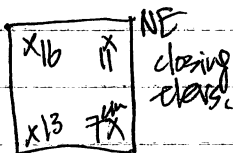

Rubble is dense in the E half of the square, with a possible line of stones (2 parallel lines forming a possible line) which we'll look for in

56 N 50E. ~~Now to look for~~ rubble also extends across the S edge of the unit. A large broken bowl is near the center of the unit. It may be placed against the W side of the possible N-S line of stones. On the W it is overlaid by a schist slab. This schist slab is overlaid by burnt earth. Burnt earth is also in the vessel & may have burned in place inside the vessel, as it appears cemented to the vessel, it does not at this point appear to have fallen in chunks on top of the bowl. See drawing D96-102-02. This lot may contain pieces of the broken bowl. I will draw the rubble/vessel/schist (D96-102-02) & then try to remove the schist & look for more pieces of the vessel — This will be a separate lot. juv?

lot # 104 C/18 in 56 N 50E. Down to rubble, looking for continuation of possible line seen in 55 N 50E. Rubble very close to surface. We may have a wall in the S portion of the square — This rubble is just under ground surface. We took the N portion of the square down to the top of the rubble (~12-13 cm) for this lot. This rubble is very densely packed. Sherds ^{approx.} rocks are large (30 x 25)

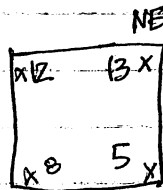

P96 - 102-06

lot 104C/19 61N50E 20-40 cm BGS. Still very few rocks.

213 Shards, obsidian. A lot of shards (more than any other lot thus far).
~~Many~~ Many pieces of obsidian. The increased density of artifacts is probably due both to the fact that this unit is being screened + to the fact that this unit is on the "trash side" of the structure.

lot # 104C/20 56N50E from 12-13 cm to BGS in the N portion of the unit. Should be our rubble layer. All the workers have decided that the rocks in the S portion of the unit are not a wall - when the N portion of the unit was excavated to greater depth it was apparent that the possible wall did not ~~have~~ have a vertical face, therefore the artifact found in taking out this rubble will be included in this lot.

A line may be apparent ~~to~~ along the N wall of the unit.

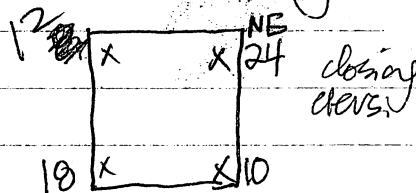

lot # 104C/21 57N50E. The unit to the S is confusing enough to warrant moving a unit N. 0 - rubble (~ 10 cm BGS).
 We'll try + see if the line of stones apparent in the N wall of 56N50E is apparent in this unit, by coming at it from the N.
 This line, at depth, does not appear to be a wall. The rest of the unit also has large stones near the surface (~ 40-30 cm) viewed from the south.

lot 104C/22

~~lot 104C/20~~ 56N50E digging in the NE corner to see if there is a wall either 1) along the N edge of the unit (no, see above) or 2) running NW-SE in 56N50E (maybe). One large piece chipped stone (chert?) came from this ~~area~~ area, also ~ 6 shards.

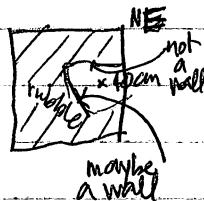

5-28-96 Tuesday

lot 104C/23

The possible wall, thus far excavated, is about 25 cm high, ~~width~~ about 4 stones high.

~~lot 104C/24~~ 61N50E 40-60 cm BGS soil sample taken. still screening. Shards, ~~potite~~ potite?, chert

P96-102-07

~~lot # 104C/22~~ lot # 104C/22 We've already cleared to rubble throughout the unit. 57N50E

This lot is taking down the N half of the square to 20cm BGS (approx 10-20cm BGS) we are checking to see if the line of stones running from the middle of the W to the middle of the E walls is a wall or not, by excavating along its N "face". Shards. This doesn't appear to be a wall, so the rubble in the center of the unit (from E to W wall) will be removed, to see if the wall running NW-SE in 56N50E continues in the SW corner of 57N50E. We also want to ~~establish if~~ ^{establish} the possible wall on the N edge of 56N50E is or is not a wall. We suspect that it intersects the NW-SE wall in the NW corner of 56N50E. The workers were looking (and still be looking) for a wall on the S wall of the unit, thus they excavated too deep.

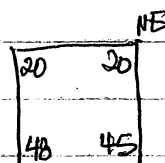

lot # 104C/23 55N50E removing schist slab, bajareque, exposed burl. bajareque/burned earth is dense w/ of large schist slab, cementing cobbles (& schist frag.) in place. (Underneath the schist slab (27 x 29 x 3cm) was approx 1-2 cm of earth, then another slab, not of schist (29 x 18 x cm). The burnt earth is still difficult to get through, especially in the area S of the former slab.

lot # 104C/24 60-70cm BGS. in 61N50E looking for stone in this unit. A sharp drop off in shards. 2 pieces of obsidian shatter. (✓ 20)

lot # 104C/25 60N50E 0-20cm BGS ~~#~~ moving S, into the mound, looking for the edge of the rubble. Shards w/ moulded nose? attached. Shards, piece of worked chert. Rubble encountered in S half of unit.

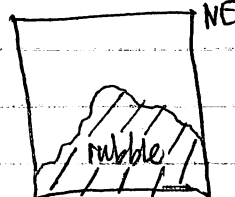

P96-102-08

lot # 104C/26 57N50E. 30-40⁺ cm BGS. Again too deep in the sand of the unit. "Wall" in sand still unconvincing. A fair amount of sherds (~40). A ^{piece of} ~~chart~~ ~~shatter~~ (core?).

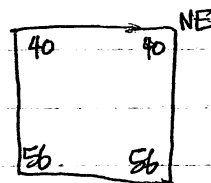

lot # 104C/27 57N50E shooting for 60 in all corners. Still investigating possible wall on S edge of unit. We left a 20 cm thick "wall" of rubble against what appears to be a true wall (along S wall of unit). Sherds, baigneque

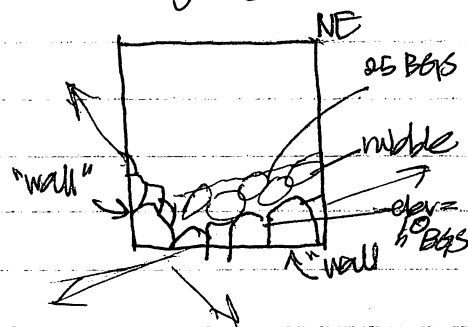

lot # 104C/28 57N50E taking out false "wall" of rubble pictured above — all one lot. Now the "wall" along the S edge doesn't appear to be a wall. Sherds. 60 cm BGS in each corner.

lot # 104C/29 60N50E 20-40 cm BGS. A large number of sherds, chert, obsidian. Rubble left in place in S half of unit. Rubble from 10-35 cm / 40 cm BGS

lot # 104C/30 60N50E 40-⁵⁰~~100~~ cm BGS. large bag of sherds (~500) piece of chert. Rubble removed.

I turned the vessel from 55N50E. I had expected it to sit on a flat surface, but it sat on a bumpy, baked earth surface. The area W + ~~partially~~ underneath the vessel burned ~~to~~ to a very bright orange. The bowl ~~seems~~ to be against, and kind of underneath the overhang of the stones forming a line E of the bowl.

More burnt earth extends out of the W wall of the unit, @ approx 70 cm S of the NW corner of the unit. A schist slab projects out about 4 cm from this wall of the unit, 9 cm BGS (22 BL) @ 60 cm S of the NW corner.

P76-102-09

lot # 104C/31 60N 50E. 50-40 cm BGS. shreds (~30).

This is as far as I think we need to take the unit.

5-29-96 Wednesday

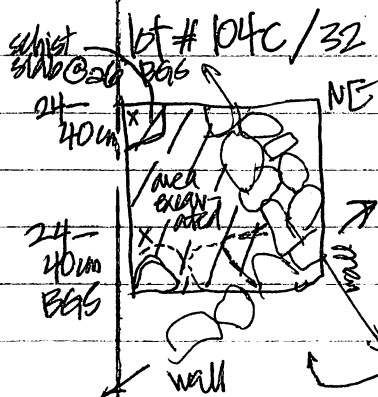

lot # 104C/32 55N 50E. We are clearing down into what should be the corner of a room. The NE-SW wall is in question - It may be part of or tangent to the possible circular structure in 54N 50 E + 53N 50E. A possible wall angled more to the N than appeared to be indicated (see dotted lines). This gives us 2 good corners for this structure (in 55N 50E + in 56N 50E)

Closed W side @ 40 cm BGS. Shards, bajareque. A second bag holds a small whistle. Shist slab stick out at SW corner @ 26 cm BGS. H is level, 22x19 cm.

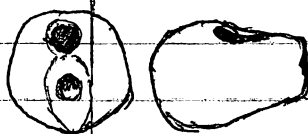

lot # 104C/33 61N 50E ~~to~~ 60 cm BGS. looking for sterile in this N most unit. Screened. EMPTY LOT

lot # 104C/34 51N 50E 0-~~20~~ ^{to rubble} cm BGS. Mostly smallish (10x5 cm) rocks in this level. Rubble is approx 20x30 cm. NE clearing cleared until rubble is reached. Shards, bajareque.

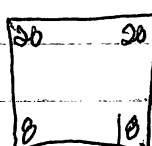

lot # 104C/35 56N 50E. clearing down SW corner of unit, to follow wall cutting NN-SE through ~~the~~ unit. Shards, bajareque.

lot # 104C/36 56N 50E clearing NE corner to reveal wall. Wall looks good. A small amount of shreds.

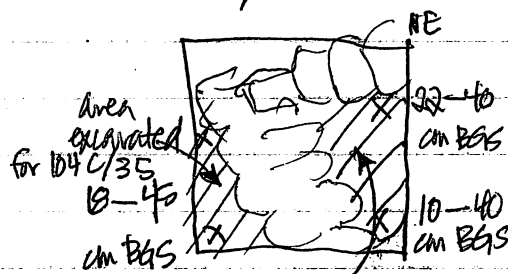

excavated for 104C/36

lot # 104C/37 51N 50E rubble (~10/20 - 30 cm BGS) ~~the~~ shreds - a possible line of 3 stones (large stones approx 35x30 cm each) from the SE to NW corners ~~the~~ Shards. Also a possible line along the S half of the W wall.

lot # 104C/38: 59N 50E. Taking out part of N half of unit from 30-50 cm BGS, looking for vertical face of possible wall. Shards, large rocks have no vertical face, but nevertheless may be a wall

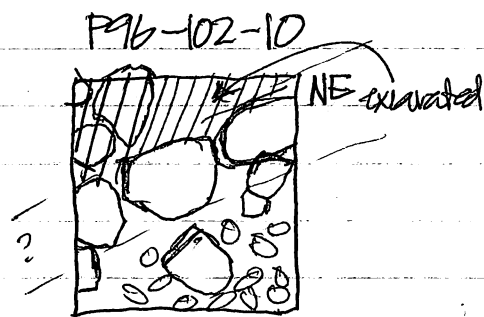

lot # 104C/39: 55N 49E. 0-rubble. Should eventually get a wall continuing from 56N 50E in the NW corner of this unit. Modest amount of shards (~12). Chert nodules ~~not visible~~ - Bagnere. Rubble in N wall, W wall.

lot # 104C/40: 59N 50E removing the SE corner of rubble pictured above (30-40 cm BGS). Shards.

5-30-96 Thursday

lot # 104C/41: 58N 50E 0-20 cm BGS. Shards, 2 large chert ~~not~~ nodules. ~~Possible~~ wall? along E wall.

lot # 104C/42 55N 49E 20-40 cm BGS in eastern portion of the unit - looking to see if lines of stones along N & W walls of unit are walls or not. Shards, ^{chert} obsidian, piece of metate (a metatlas foot is visible on the surface of 55N 49E. Schist slab removed from S wall of unit, tipped to the N (40-36 cm BLL, 29-25 cm BGS)

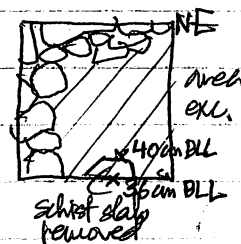

lot # 104C/43 58N 50E 20-40 cm BGS. Shards, ~~chert~~, obsidian. possible wall along E wall of unit.

lot # 104C/44 57N 51E 0-20 cm BGS. Wall running SW-NE in 56N 50E continues in the S portion of this unit 26 shards. This unit has too much rubble to continue excavating it - will move a unit to the S.
~~There are walls, they are thick (10cm)~~

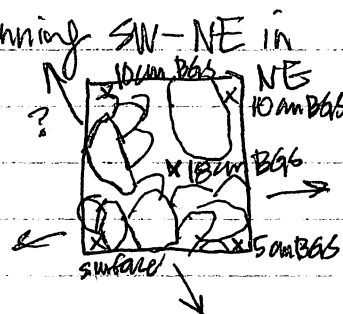

55N 50E

P96-102-11

Bayr.
slab
exc. to
10cm
(may go
deeper)

lot # 104C/45 55N 49E 40-60 cm BGS inside possible room - looking for a floor (seems unlikely) or the base of the walls. I suspect that some of the rocks in the NE corner of 55N 49E / SW corner of 56N 50E are rubble, not wall, but they will not be removed until 55N 49E is excavated. A piece of bajareque (floor?) was found in the center of the S wall of the unit. It is not fitted, but flat, suggesting this may be a remnant of the floor of this room. Shards, bajareque

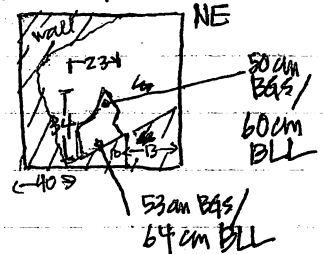

lot # 104C/46 56N 50E 40-60 cm BGS ~20 shards, rubble/ugly wall left in place along N wall of unit

lot # 104C/47 56N 51E 0-~~10~~/rubble. lots of rubble
EMPTY LOT

possibly a wall running from NW corner to middle of S wall

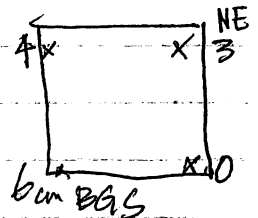

lot # 104C/48 55N 49E 0-~~10~~/rubble (approx 30 cm BGS)
rubble over entire area of unit -
olla/jar rim sticking out of SE part of S wall.
(approx. 20 shards)



lot # 104C/49 56N 49E 0-20/rubble
shards, obsidian, mano frag, carapool/butter (bagged separately)
wall should be passing thru SE corner,
upside-down nettle? in SW corner of unit, sort of on top of probable wall. (~40 shards) - highest edge 2-3 cm BGS

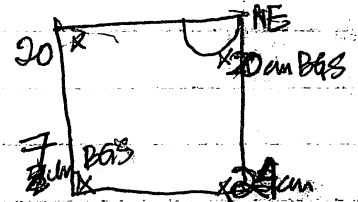

lot # 104C/50 56N 51E rubble - 20cm
possible continuation of wall (from 55N 50E) into N wall of unit. possible wall in S wall of unit. Approx. 25 shards, 1 pc. obsidian shatter.

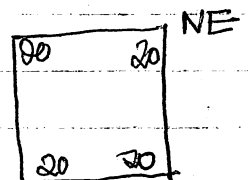

lot # 104C/51 55N 49E ~~removing rubble~~
removing rubble from SE corner of unit to see if a wall is running SW-NE thru unit. see diagram for area excavated (~15 shards). Possible wall doesn't look too good

5-31-96 Friday

lot # 104C/52: 58N49E. 20-40 cm BGS in area of unit from NE to SW corner, investigating possible continuation of large stones (in NW corner of 58N49E) from 59N50E. Aridian point (w/ only tip missing). ~50 sherds.

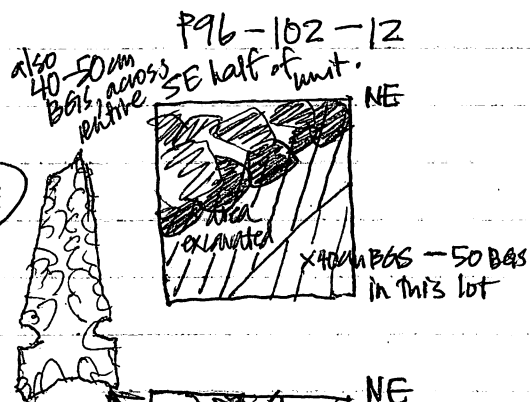

lot # 104C/53: 56N49E. 30-40 cm BGS ~30 sherds. a roundish (18 cm dia.) piece of ground stone. shreds.

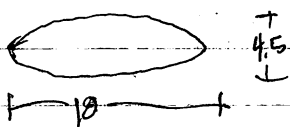

lot # 104C/54: 56N49E. 40-60 cm BGS in same area marked above looking for bottom of walls, also bringing this unit level with the ones around it. (~20 sherds).

lot # 104C/55: 59N49E. 0-20 in unit which may show signs (in its SE corner) of the wall extending from 59N50E to 58N49E.

~20 sherds. Rubble in S wall, probably continuation of line of lg stones in 59N50E.

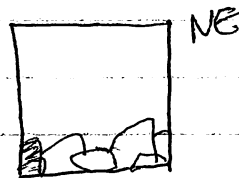

The ~~ENE~~ ENE - WSW wall (pictured above) seems to have only one course as revealed on its N "face". This course is so well set + has a parallel S course (also w/ no depth) that i'm inclined to think it's a wall anyway. Also ^{more importantly} the section of this wall in 59N50E, its continuation to the ~~ENE~~ ENE does seem to have ~~convincing~~ convincing vertical faces, both N + S. This wall is worth following in the next units to the W. The NW-SE "wall" seems to have no more than 1 course, but the portion exposed is so small (~60 cm) that it also needs to be followed

lot # 104C/56: 57N49E 0-25 (in S half of unit) / 10/15 (a probable floor ~~to the surface~~ in N part of unit) A "Z" shaped group of rubble is in the S part of the unit. I won't remove it until I know what's going on in ^{other nearby} squares. A upright schist slab ~~near~~ near W wall, separate the floor portion from the "Z" of rubble. Only abt 16 sherds (a clean floor?)

F96-102-13

We look to have a floor surface in this unit, defined by 4 schist slabs (in NW corner of unit) - a jar rim + a piece of groundstone? sit on the floor surface. bajnagwe in NE corner.

lot # 104 C/57 59N 49E. 20-40 cm BAS. A large bag of sherds.

Wall running along S wall seems to only be one course - alot of sherds (270°) found N of this wall, suggesting a trash area ~~to the~~ that this is the N wall of the structure.

lot # 104 C/58 58N 48E 0-20. Hoping to find corner of N wall + the wall extending NW-SE wall seen in 56N 49E. (24 sherds, 1 pc bajnagwe) - ~~unit to~~ non-~~visible~~ wall part of unit too small to continue excavating it, expanded N to 59N 48E.

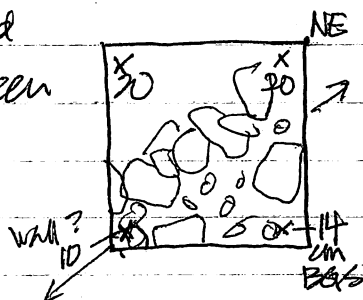

lot # 104 C/59 56N 48E 0-10/5 cm BAS rubble across entire square - suggest 3+ NW-SE lines (not at all helpful + difficult to distinguish walls, ~20 sherds)

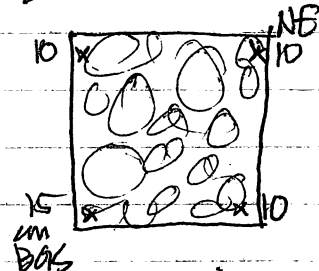

lot # 104 C/60 54N 48E 0-10/20.

metate foot (17 cm tall, platform 8x6 cm)

chart
~40 sherds
bajnagwe

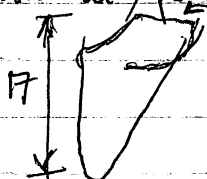

probable wall cutting across NE corner.

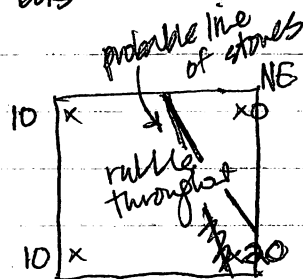

lot # 104 C/61 59N 48E. 0-20 BAS

some rubble in SE corner ~10 sherds.

should be getting heavy trash here, possibly in next level.

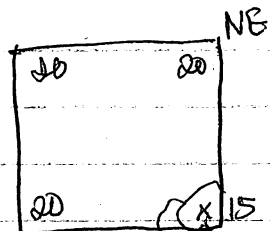

lot # 104 C/62 59N 48E 20-40 cm BAS

~15 sherds ^{more} Rubble in SE corner (wall fall, probably)

Surprisingly few sherds - it was the end of the day, perhaps the workers were rushing to finish on time.

6-3-96 Monday

Nestline + Pib (who not here) have gone to work w/ Ed + Army. Jaime + Manuel not here yet.

104C/63 Miguel + Victor ~~are~~ have started working in 55N48E. We hope to encounter the W side of our best wall, which is evident in the W wall of 55N49E. O-rubble ^{100 cm BGS}. There is alot of rubble in the unit to the N + the unit to the S, with no obvious lines emerging.

- large decision made
- 2d shards

Victorino
Thinks this maybe
part of another wall,
but I kind of doubt it.
We'll know it in 4H we
eliminate that possibility

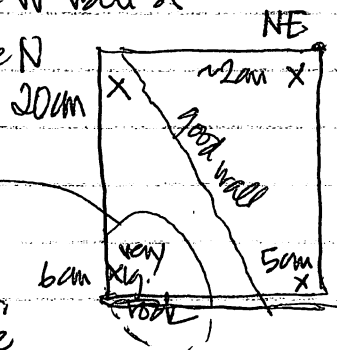

104C/64 54N49E O-rubble Manuel is working ~~in this unit~~ ^{Y/Pedro} in this unit.

We should get the width of the wall passing ENE-SSW thru 55N50E in this unit, and possibly the W ^{edge of} ~~the~~ possible are seen in 54N50E + 53N50E (D96-102-21). rubble is difficult to read, but there may be a ^{line} continuing the wall in 55N50E. I think it's necessary to move to 53N49E ^{continuing} ~~in this unit~~.

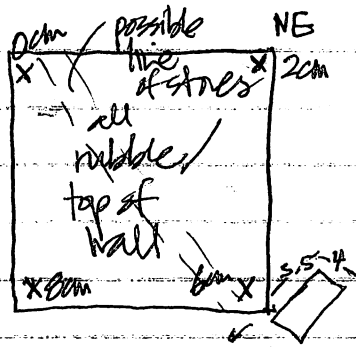

- Metate foot, probably ~~the~~ complement of the one found in 54N48E (104C/60) - it has a flat form on top; was not carved from the same piece of stone as the flat part/grinding surface of the metate

- ~ 30 shards

104C/65 54N48E

working in ~~SW~~ corner of unit, looking for vertical face of wall running SE-NW, the S continuation of the good wall revealed in 55N49E. A large rock in the SW corner is being left in place for the time being, as Victor thinks this may be another element of the wall including the very lg. rock in 55N48E. possible wall along W edge (will wait + see). Pretty good wall on E side of unit has one rock that may be part of a vertical face

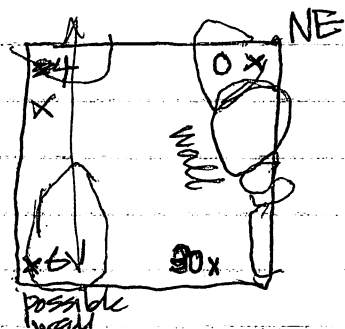

~ 50 shards incl. lg. strap handle
1 pc bajareque

P-96-102-15

104C/66 55N47E 0 - rubble/wall ~~being~~ moving a meter W to better excavate the vertical face of the wall in 55N48E,

also to investigate whether or not the large rock in 55N48E is part of a second wall or not.

There does seem to be a second, parallel wall of larger stones in this unit, parallel or maybe more to the W to the wall in 55N48E + 55N49E. The rubble in the SW half of the unit is kind of level + maybe? set into form a floor? I'll see if it continues in the units to the S. 225 shards, 1 pc. bajocque. Possible floor/ring @ 60-63 cm B.L.

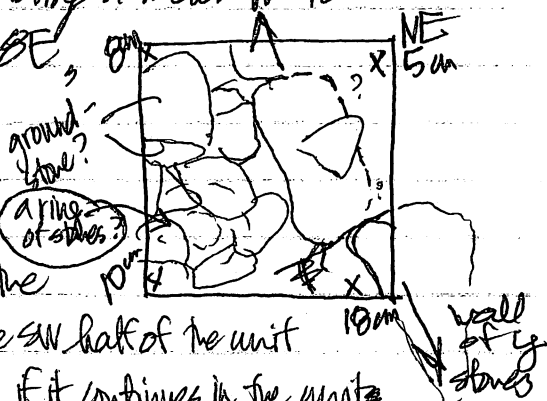

104C/67 57N48E 0 - rubble/wall 20cm BGS

hoping to pick up on floor located in 57N49E.

No nice schist as in 57N49E. ^{slab of} 'Piedra poma' or 'soft rock' is slightly above + tilting down + W of a piece of schist in 57N49E. The N wall seen in units to the N+E appears to continue in the NW corner of the unit + wall fall maybe across the SW wall of the unit. 215 shards

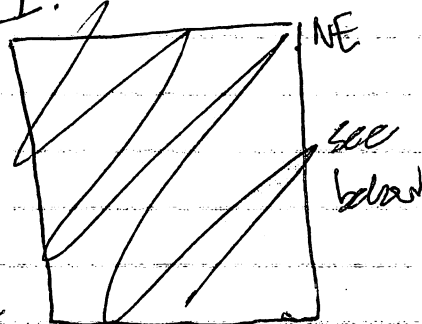

104C/68 54N47E 0 - 20cm BGS

looking to see if wall or step (per Matt) of lg stones just W of good wall in 55N48E continues to the S. 250 shards, 1 sm. piece of an Andrian blade still totally confusing + not worth illustrating yet.

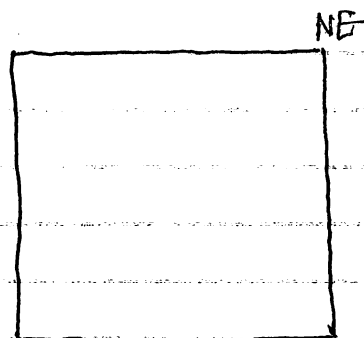

104C/69 57N48E 30-40 cm BGS

~ 10 shards, 1 pc. bajocque

checking out walls in N+S of unit

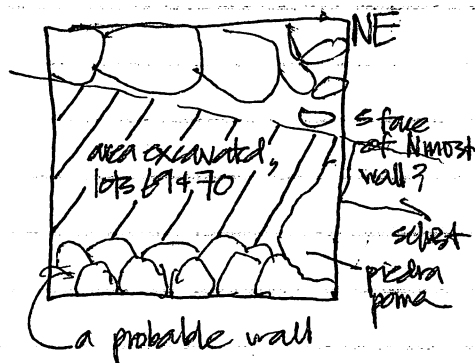

104C/70 57N48E 40-60 BGS

still checking out walls in N+S of unit.

10 shards. rubble throughout unit at this depth, neither wall is convincing yet.

104C/71 ^{SE corner} 59N48E + ^{NW corner of} 58N48E. 20-~~40~~³ cm BGS

to be level w/ rest of 59N48E + to reveal more of back wall. Also to remove rubble in SE corner of 59N48E. continued on pg. 17

6-4-96 Tuesday

P96-102-16

only 2 workers today, Miguel + Victor, which is fine because I'm confused about what to do next + have a lot of drawing to do.

lot 104C/72 53N 47E 0 - rubble/30

investigating the step? wall? rubble? seen in the 2 units to the N + the 2 units W of those 2.

~ 30 shards

I think we've at last found the wedge of the rubble, which is very helpful because it seemed w/out end. No clear lines emerged — I'll wait to clear more before removing this rubble + moving E in towards the structure.

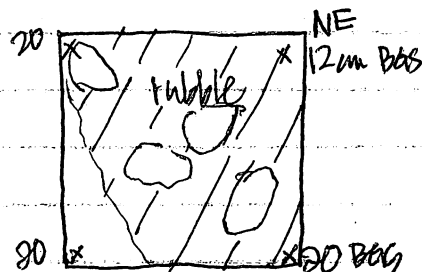

104C/73 cleaning back to wall faces in 55N 49E. Walls being cleaned are 2

ENE - WSW trending walls in this unit, parallel to each other + joined by a third wall w/ a very clearly defined vertical (side) face

104C/74 cleaning back face of wall in 56N 49E + 57N 49E. Wall

should be trending to the NNW - SSE, perpendicular to the walls cleaned in the above lot + a continuation to the N of the "very clearly defined vertical face" described above.

104C/75 53N 48E 0 - rubble/30m BGS

We should actually get the so-called step/wall in this unit, not 53N 47E as stated above. We may get a tiny piece of the W side of the S extension of the wall described above. At ~10m BGS the unit is dense w/ small boulders (from 15 to 10cm).

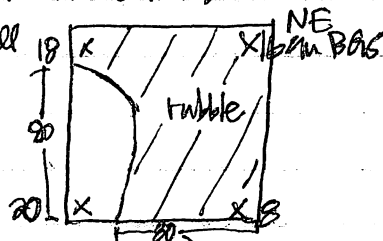

~ 50 shards, 9th unique

1 pc of possibly worked schist? (very dubious, but didn't seem entirely natural)

small pc. of a ground stone disk

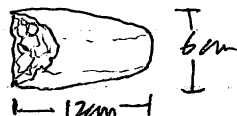

ground stone pebble?
grinding surface



possibly a broken surface

104C/76 53N49E should put us on top of a wall, may get W edge of the mysterious wall in the unit to the E.

The arc (its ^{face} W edge of W wall) is under in this unit. It's all rubble w/ no indicator that the good wall in 55N49E continues into this unit,
 * polyhedral chert core, obs. shatter, chert, 2 blade frags.
 ~ 60 sherds.

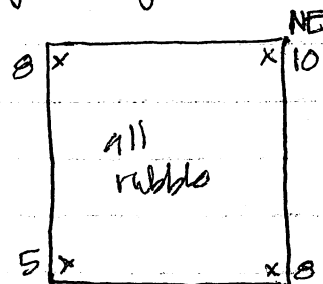

∴ it must end in 54N49E.

lot # 104C/71 cont'd.

only about 6 small sherds were removed in these units, though rushing workers + only 10m depth may have been the cause. I added to this lot the cleaning away of the rubble from the N most wall, which spilled into the SE corner of 54N49E + led up to the sketchy N face of this N wall, in the middle of the S wall of the same unit. See drawing 96-102-03 for plan of this rubble.

This area at the base of the N wall turned out to be rich in artifacts → I found a head of a figurine @ 34cm BGS (see D96-102-03) - it has earplugs, a pendant + a simple headdress. I also found an obsidian projectile point (w/out the tip) made from a long flake, a piece of ^{worked} chert?, and maybe 70 sherds. The ^{partial} remains of a large jar were also found in this area - a lg. piece w/ handle ^{trim} was among the pieces. The N face of the N wall remains ugly, however.

6-5-96 Wednesday

P96-102-18

lot # 104C/77: 55N 51E 0-20/bubble

the E face of the wall in 55N 50E is apparent along the W wall of this unit. A large amount of rubble fills the E half of the unit + was left in place so it could be looked at from the sides (at depth). There may be a line of stones or wall passing across this east half.

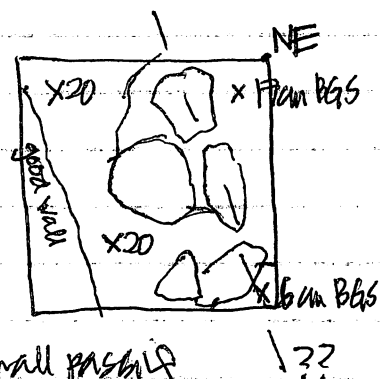

~~lot # 104C/77~~ ~60 shards, 1 very small shell, 6 frags of obs. blades, ~2 pss. obs. chert.

lot # 104C/78: 56N 47E 0-⁴⁰~~20~~ am BGS (matt's workers wouldn't stop @ 20 !!)

~~only ~8 shards. I'd expected more of a trash area, but we may not be deep enough.~~

The line of stones/possible step seen in units to the S continues in this unit. A corner - where this line joins with a possible ENE - WSW wall found in ~~55N 48E~~ 57N 48E may be represented by a rock in the NW quad of the unit (or maybe not - it was removed).

A nice wall face emerged, cutting across the NE corner - this is the W face of the ~~good wall~~ N continuation of the good wall in 55N 49E. ~70 shards, 1 p. groundstone

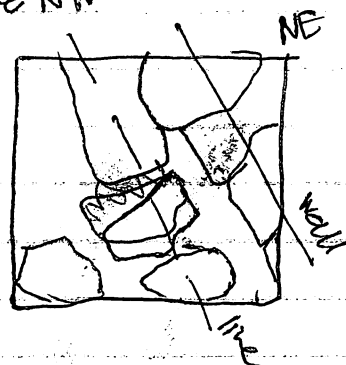
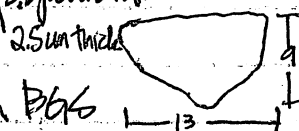

lot # 104C/79: 58N 47E 0-20 am BGS

only ~8 shards. I'd expected more of a trash area, but we're probably not deep enough. Some rocks, probably the continuation of the N most wall, are showing up in the SE corner of this unit.

lot # 104C/80: 58N 47E 20-40 am BGS
~40 shards

The N most wall does not clearly continue into this unit, although ^{packed} small rocks are found in the SE corner, where the wall should be. I told the workers to look for a wall, ~~but~~ showed them where it should be, but I think they may have still removed some rocks that may have made up this very ugly wall.

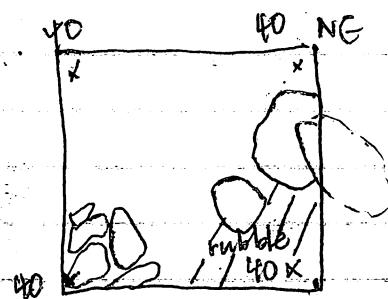

lot# 104C/81 55N51E + ~~55N47E~~ 20-50 cm BGS
 taking down the unit to better view the wall passing thru the west wall
 of 55N51E ② access the rubble in the E half of 55N51E and ~~access~~
~~the rubble in the E half of 55N47E~~ the rubble in the E half
 turned out to be of no significance + was removed as part of this lot. A flat rock
 w/ an oval shaped depression (for sharpening?) was found - not a vesicular material.
 Grinding depression approx. $2\frac{1}{3}$ cm deep. ~100 shards; 3 obs. blade bags; 1 pc red chert.



SE corner + 55N47E + SW corner 54N49E
 lot# 104C/82 55N47E. Looking to define the continuation of
 the wall + line of stones just revealed in 56N47E.
 Old Don Luis defined a very nice wall face here. SE corner
 is in 54N49E + the wall probably continues into
 57N47E. The wall appears to be deeper, but can't be
 excavated any further b/c it is paralleled by a line of
 large stones which makes working difficult.
 1 pc groundstone (19x10x4 cm); ~230 shards

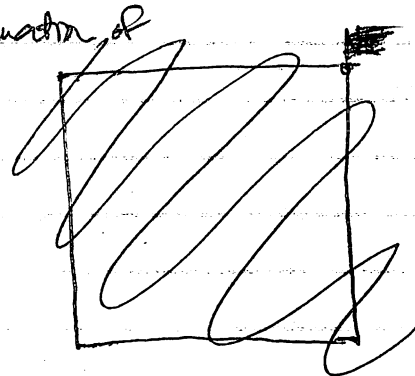

lot# 104C/83 56N51E 0-20 cm BGS/middle
 picking up an NW-SE wall perpendicular to N most wall.
 ~4 shards

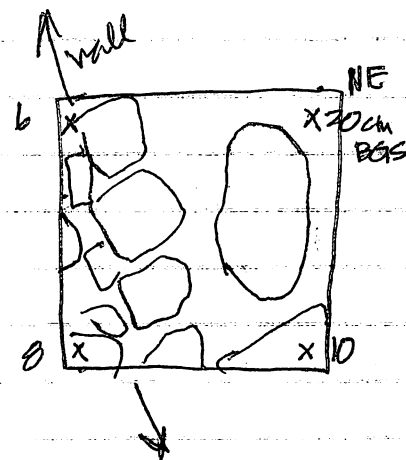

lot# 104C/84 56N51E 20-50 cm BGS
 bringing this unit level w/ those to the W + S, also trying to get
 a better look at a possible wall along the N part of this unit.

6-6-96 Thursday?

P96-102-20

bt 104C/85 57N47E. 0-

~30 shards, 1 obs. blade frag.

The corner of the N most + W "good" wall should fall in this unit.

Unfortunately there are no lg stones remaining in this corner, it is seen as a rounded outline of smaller rocks (~10x5cm), the same size rocks that seem to make up the bulk of the

N most wall, which meets the nicely finished wall at this corner.

A large ^{isolated} rock was found in the SW corner of 57N47E and may be the ~~for corner~~ corner, but they are quite detached + lower than the rest of the N most wall.



bt 104C/86 59N51E 0-

along
W
edge of
unit

Investigating possible SSE-NNW wall perpendicular to

N most wall. May pick up part of N most wall in NW

corner of unit. Will need to move into 60N51E to hit

N-most wall. Getting a ENE-WSW line of stones

~~along~~ along S wall of unit, perpendicular to

SSE-NNW wall. Very large stone in NW corner of

unit - does not seem to be in place. The unit is far

too jumbled to distinguish any walls or even lines. We'll move N to get the N most wall + eventually well move E.

1 ceramic head (5cm dia.); ~30 shards; 1 obs. blade

bt 104C/87 60N51E. 0-20cm

~30 shards. indications of a continuation of the N

most wall along the S wall of this unit are less than

robust! at this depth. We'll excavate further in the

N half of the square to better look at our possible wall.

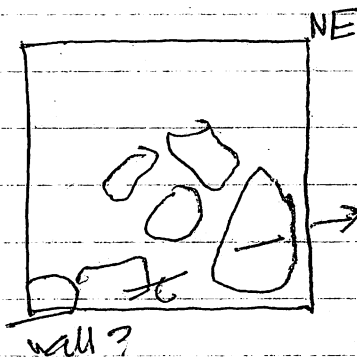
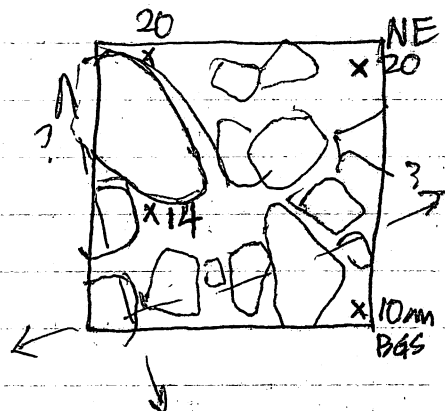

bt 104C/88 58N52E. 0-10ish cm BAS

Unfortunately this unit is full of meaningful looking

rocks. There are 2 slabs of schist, suggesting an

approximate, though badly damaged, floor surface. The slab in

the SE corner is kind of pink + lies flat @ 10cm BAS.

The slab in the NE quad dips to the S, its ^(is grey) end at or very near ground surface + its S end @ approx 10cm at the same level as the pink slab.

1 obsidian blade; ~30 shards

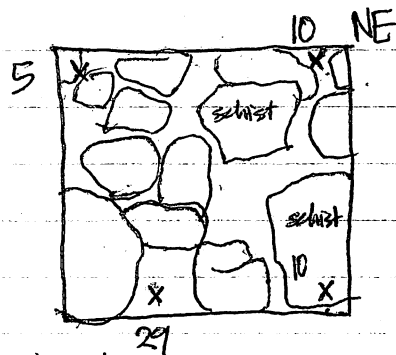

P96-102-21

lot 104C/89 20-40cm in 60N51E.

1 decision taken-like object; 1 pc. worked sheet;
100++ sherds.

excavated N portion of unit to get a look at
the E continuation of the N most wall.

It looks dubious because the rocks in line w/ rest of wall are not nearly
as large as those immediately to the west.

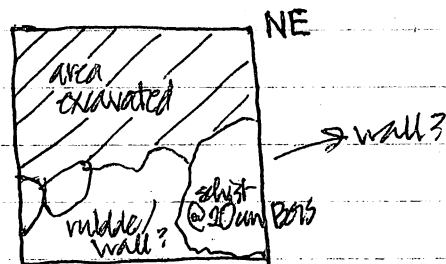

lot 104C/90 removing rubble from ~~XXXXXX~~ 57N 49E. I had left
some rubble in place because it seemed to Matt to have been a
seat or platform of some kind. This seemed untenable so
a portion of the rubble was removed for this lot. I was trying to
follow the floor surface (indicated by piece of jar, several
slabs of schist + piedra posa (?)) in the same unit @
10-15cm Bss. I left several rocks in place because they seemed
to be ^{part of} some sort of wall, though only 1 course high.

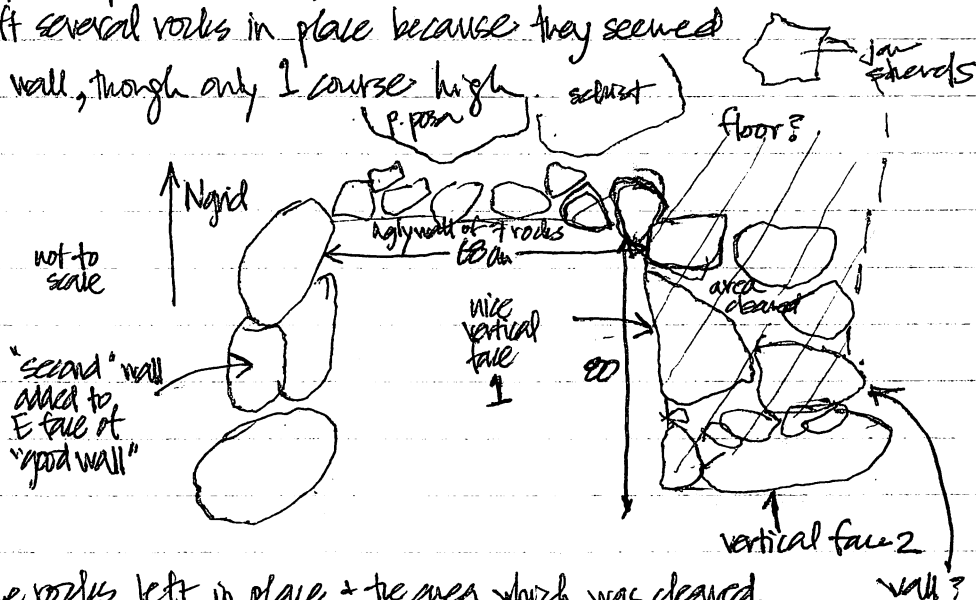

This diagram shows the rocks left in place + the area which was cleared.

These rocks project above + below the supposed floor surface so it is ~~probably~~
the rocks must not be sitting on a floor

Vertical face 2 has a complementary, similarly placed rock 35cm SSE in the
wall running ENE + WSW in 56N50E, 56N51E, + 57N50E.

The complementary stone is in 56N50E. I thought the schist + p. posa
slabs may mark an entrance - the stones in the excavated area may have
restricted/defined this entrance. 215 sherds. I did not include the jar sherds in contact
w/ the floor.

6-7-96 Friday

lot 104C/91 52E 57N ~~57N~~ 0-10ish m BGS

1 pc obsidian; 1 pc. worked chert; ~25 shards

bagged separately

ESE-WNW

We look to have the E face of a ~~57N~~ wall in the NE corner of this unit - we need to expand Eward + approach it at depth to determine if this is indeed a wall. A very ugly E-W?

Wall may intersect this ~~57N~~ wall in the SW corner of this unit, but it can't connect w/ a possible floor in 55N 52E.

lot 104C/92 56N 52E 0-20 cm
+ 57N 52E in its S central portion.

We found a nice line of stones w/ a decent vertical face in these 2 units - it is the E face of a NW-SE wall +

it is not the same ~~57N~~ wall as the ESE-WNW wall mentioned in the above lot. The 2 walls seem to meet in 55N 51E

+ diverge. We are opening up 56N 53E to see if the ESE-WNW wall continues. 2 pcs obsidian (incl. 1 lg. blade)

lot 104C/93 55N 46E 0-20 m BGS

may have W most edge of rubble

~15 shards, 1 pc groundstone

No meaningful patterns emerging.

except... possibly part of ~~57N~~ arc also seen in 54N 46E.

lot 104C/94 54N 46E 0-20 cm BGS

~30 shards

The workers think the small rubble may be a floor surface w/ the arc of larger rocks (which continues in 55N 46E) delimiting the boundary of this floor.

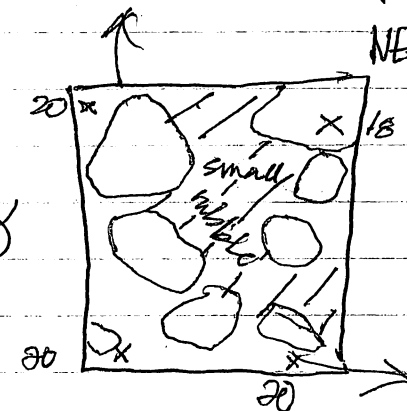
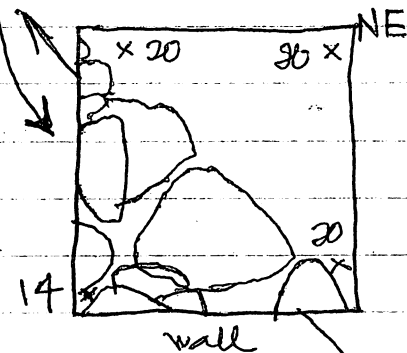
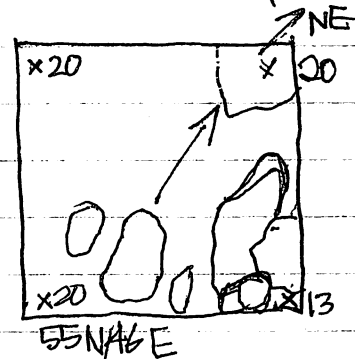
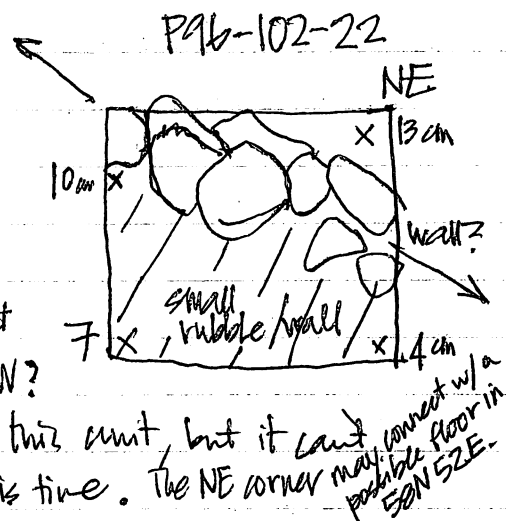

104C/95 56N 53E 0-rubble
 looking to pick up ESE-WNW also seen
 in 54N 52E. Wall didn't seem to clearly
 continue at this depth. 2 possible alignments are
 indicated on the diagram, but there is no support for
 them yet. I decided to move to the next unit S
 to get a better look at all this rubble before removing
 rubble from 56N 53E. ~30 sherds.

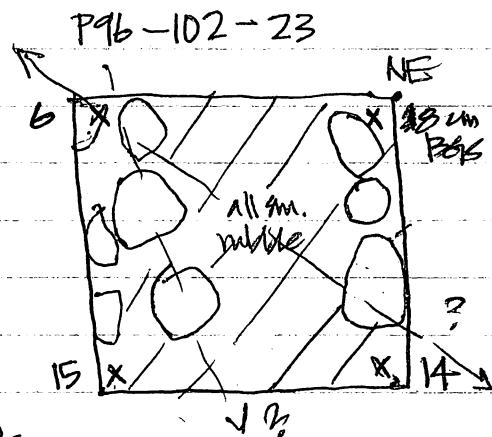

8
 104C/96 59N 47E + 56N 48E
 cleaning up the N face of the N most wall. Ed recommended I take out
 about 1/2 of the N "side" of the N most wall, back to a far more
 promising vertical faced large rock in the middle of this wall.
 Starting W of a large "good" rock in the SW corner of 59N 47E,
 I removed the smaller rocks ~~which~~ which formed a fairly
 unconvincing continuation of the line of rocks. Near the middle of
 the width of the wall I found 3 lg. ~~g~~ rocks, each w/ a very
 convincing vertical face (to the N). N of + below the E most 2
 rocks I found several fairly flat schist slabs, all at roughly
 the same elevation. This suggested a step? nicely marked w/
 this material. The original line of the wall does continue to the
 west.

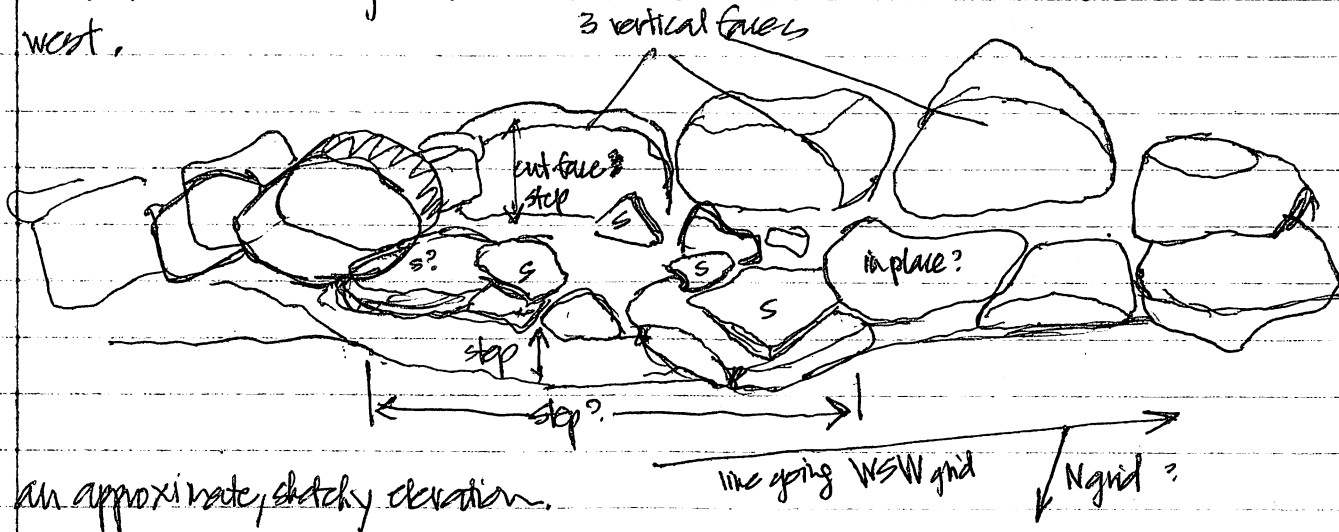

P96-102-24

lot 104C/97 53N 46E. 0-
started 6-7-96, but no artifacts recovered

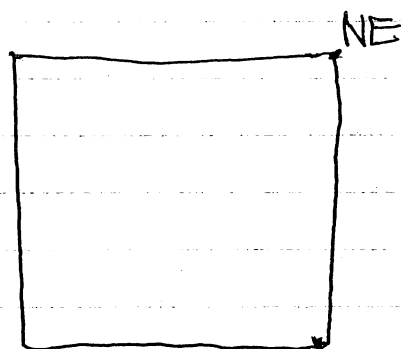

6-10-96 Monday

so far I only have Victor + Miguel working, so I've held off on lot 104C/97 in 53N 46E for the morning - it was just started late Friday and no artifacts have been recovered yet. Starting new subop, saving 104C/98 + 104C/99 for screened up bits (2@20s, 2@21).

K/01

lot 104 ~~98~~ 55N 53E 0 - rubble

We had to have a convincing corner in this unit. We have the E face of the E most wall (running NW-SE) meeting another wall, running roughly NE-SW. The status of the rubble in the NE corner of the unit is not yet known.

We're going to next start removing rubble from the unit just previously cleared to the N.

4 pcs groundstone - 1 mano fog, 2 metate bags, 1 unknown
also found a whole rubble of vesicular basalt w/ no ground sides,
2 45 shards; 1 pc. of an obsidian blade

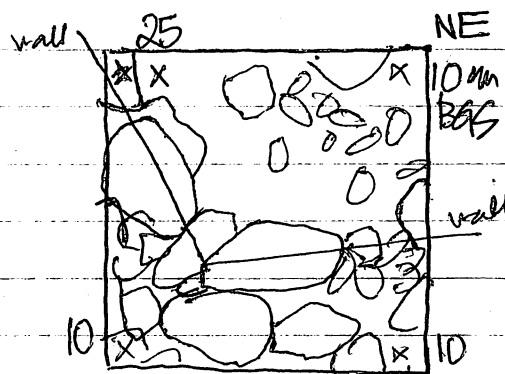

lot 104 K/02 56N 53E

clearing off some of the smaller rubble to try to reveal ESE-WNW line E of E most wall. 1 pc metate?, ~30 shards. ESE-WNW line, if it still exists in this unit, is made up of small + fairly unimpressive rocks. ~10 cm removed from center of unit.

lot 104K/03: 55N 52E 0-mubble
 should come down on top of Emost wall.
 ~6 shreds, 1 pc decision
 pretty much all important looking rocks, well
 wait to clear some units to the south before
 pulling anything.

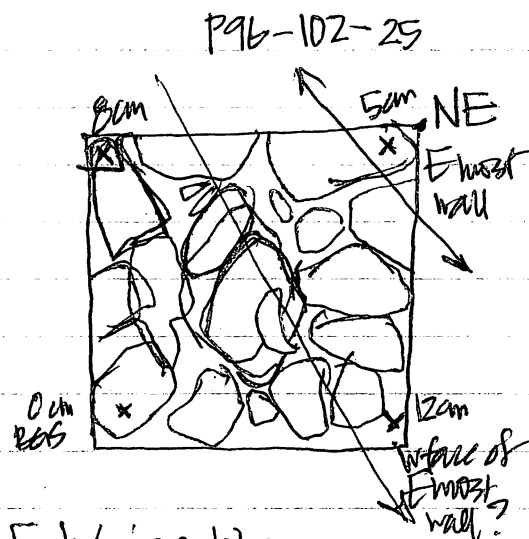

lot 104K/04 0-40 cm BGIS
 clearing of S face of wall passing a ~~kind~~ kind of E-W, more like
 ENE - WSW through the N wall of 56N 51E + the S wall of
 57N 51E. The ^{S face of this} wall is very ugly - it really lacks any vertical
 definition - the N face of the segment of wall in the units directly
 to the west is much better defined, why this side was less important
 or simply filled in w/ small rocks (which I pulled in the vain
 search for a decent face) ^{I don't know} ~ 40 shreds
 I think the S side of this wall needs to be taken down
 another 10 centimeters.

note: 6/11/96

Ed suggested that the S side of this wall is very poorly finished because
 it was set into earth - it was a retaining Terrace wall & the N face
 was the only side visible. The earth would have filled the area
 S of this ugly wall & might have also filled in the nice rooms
 directly to the W, creating a raised platform

P96-102-26

6-11-96 Tuesday

Work today - were working to understand the west side/SE corner of the structure today.

lot 104K/05 54N 53E 0-rubble

~40 shards; 1 mortar frag.
trying to open up this SE corner of the structure.



No meaningful patterns in this rubble, possibly a NE-SW line of stones. Will clear unit to the W next.

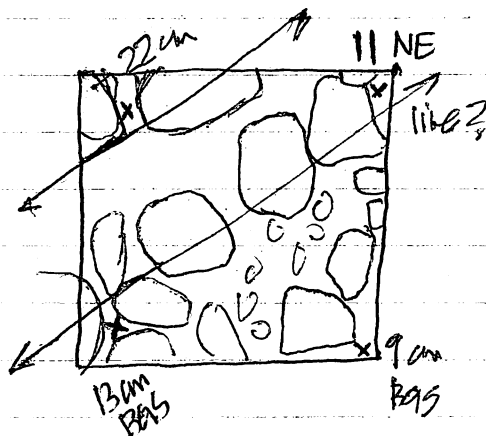

lot 104K/06 54N 51E 0-rubble

expected to pick up E side of possible oval in 54N 50E + 53N 50E but only are rock, just S of the NW corner of the unit, fit the pattern. The line (sort of) of rocks across the N wall of the unit is unconvincing, but I'll leave it in place until 54N 52E is cleared.

are does not seem to extend into this square - a NE-SW wall may cut through the SE corner. 4 ps debris, 1 pc chert; ~60 shards; bijouque

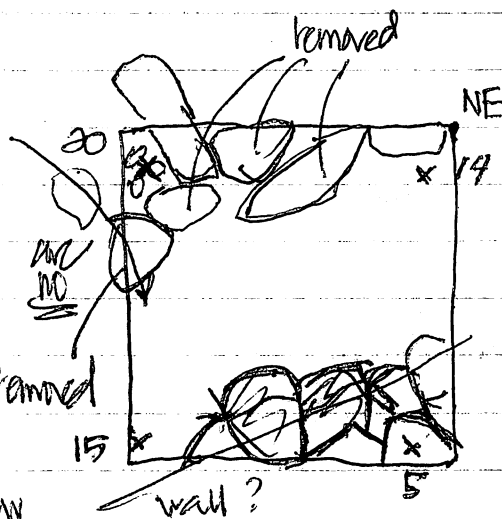

lot 104K/07 54N 52E 0-rubble

4 ps debris, 1 mortar; ~25 shards; bijouque

We may have the S side of an NE-SW wall in this unit, and also the upper line on the diagram may indicate the N side of the same wall. The wall appears to continue in 54N 51E + 53N 51E.

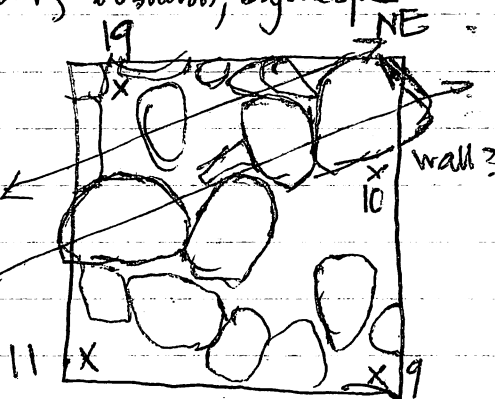

1 lg. pc ground stone - ground on one side, convex on both sides

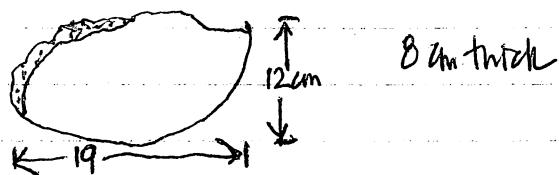

P96-102-27

lot 104 K/08

3 sherds; tip of obsidian point? awl??; 1 pc. chert.
This lot is of the few artifacts recovered in the process
of cleaning up the intersection of the E most wall
& the ENE-WSW wall running through the
N wall of 55N51E + S wall of 57N51E.

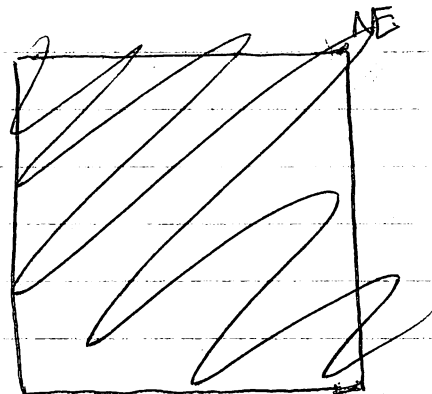

I also cleaned between the E most wall &
the ESE-WNW wall running sort of parallel & E of the E most wall.
Several rocks suggest that the E most & ESE-WNW wall were
connected by a kind of extension of the ENE-WSW wall.

~~XXXXXXXXXX~~ The E most wall gets very ugly just S of its intersection w/
the ENE-WSW wall - it is made up of closely packed small stones, not laid out
particularly flat or particularly well - this suggests that there was a gap
in the E most wall here, later filled in in this haphazard way. Why this
was done, I'm not yet sure.

lot 104 K/09

cleaning up large corner of earth ~~there~~ to better define the W face of the
E most wall, just N of (and at) its intersection w/ the aforementioned
ENE-WSW wall. A large rock, probably fallen forward (+E) of the
top of the wall was removed & the dirt below cleaned to reveal only
~~2~~ 2^{or 3} stones in line w/ this east wall - the ^{E most} wall at this intersection
doesn't exceed 2 thin, unimpressive courses - it is more impressive as a
line than as a wall. The corner is ugly too, but the upper course
or courses seem to have been damaged/removed.

~40 sherds; 2 pcs chert; 1 lg obs. blade frag, 1 pc obs. shatter

lot 104 K/10

6-26 m B&B

clearing out rubble left ~~in~~ in SE corner of 55N51E, to reveal
more promising line of stones, & the ~~W~~ most of 2 lines added parallel to
& on the W of the E most wall. ~2~~5~~ sherds, 2 pc. bajonete
40

P96-102-28

lot 104 K/11 53N 51E 0 - rubble/wall/30
~40 sherds

We've picked up a very nice section of wall in this unit. The S face is decently vertical, the N face looks less promising - will be investigated next. The big puzzle is where this wall goes W of this unit - the next unit W is part of our ~~axial~~ axial trench + the wall seems to run into a line of rocks we thought were some sort of oval. A cut block in the W wall

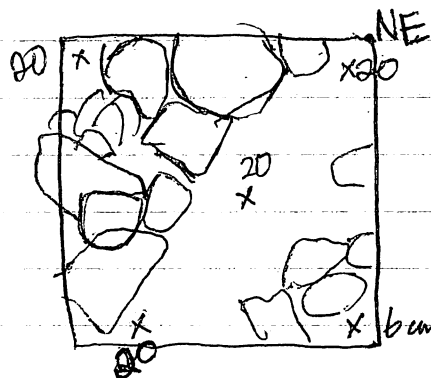

lot 104 K/12 51N 48E + NW corner of 58N 48E 30cm - 60cm BGS.

looking to further expose the back (N most) wall (fits N face) near the area that resembles a schist-lined step. ~80 sherds. There appears to be no more rocks below the course making up the step. Will excavate in 58N 47E to look at the depth of the corner next

6-12-96 Wednesday

Miguel + Victor working on lot 104 K/12, Jaime + Manuel m...

lot 104 K/13 54N 51E also strip ^{along} the N wall of 54N 52E 20-40cm BGS

to get a look at the N face of our new + S most wall.

The N face is, at best, 2 ugly courses, raising the possibility that it was also a retaining wall for soil, showing its good face to the S + holding up soil to the N. ~130 sherds; 5th century; schist; obsidian

of 52N 50E maybe part of the wall we may have chiseled through (but how could we have?) If it's a wall it's very ugly. Another point against it is the lack of any wall for it to join w/ in the SW portion of the structure - the only candidate is the terrace wall just W + parallel to the W most wall - even if the S most wall connected w/ this line of large stones, the line of stones just sort of ends at + outside of the NW corner of the structure. Very weird.

104K/14 58N 47E 25-40cm in SE corner of unit
cleaning out NW corner of structure, looking to define an inset corner.
Many large shards ~40, including 2 lg. pcs of the same? jar w/ everted
rim. Piece of a bowlish mano; 9cm long, 6 1/2 cm dia. - 2 faces are ground
flat.

I can't decide if we have just
an inset corner or an inset
corner of lg. rocks ~~is~~ a
squared or rounded corner \leftarrow
of small, densely packed
rocks.

The small
rocks
were
definitely densely
packed, but there
didn't seem to be a
great effort to lay them out flat.

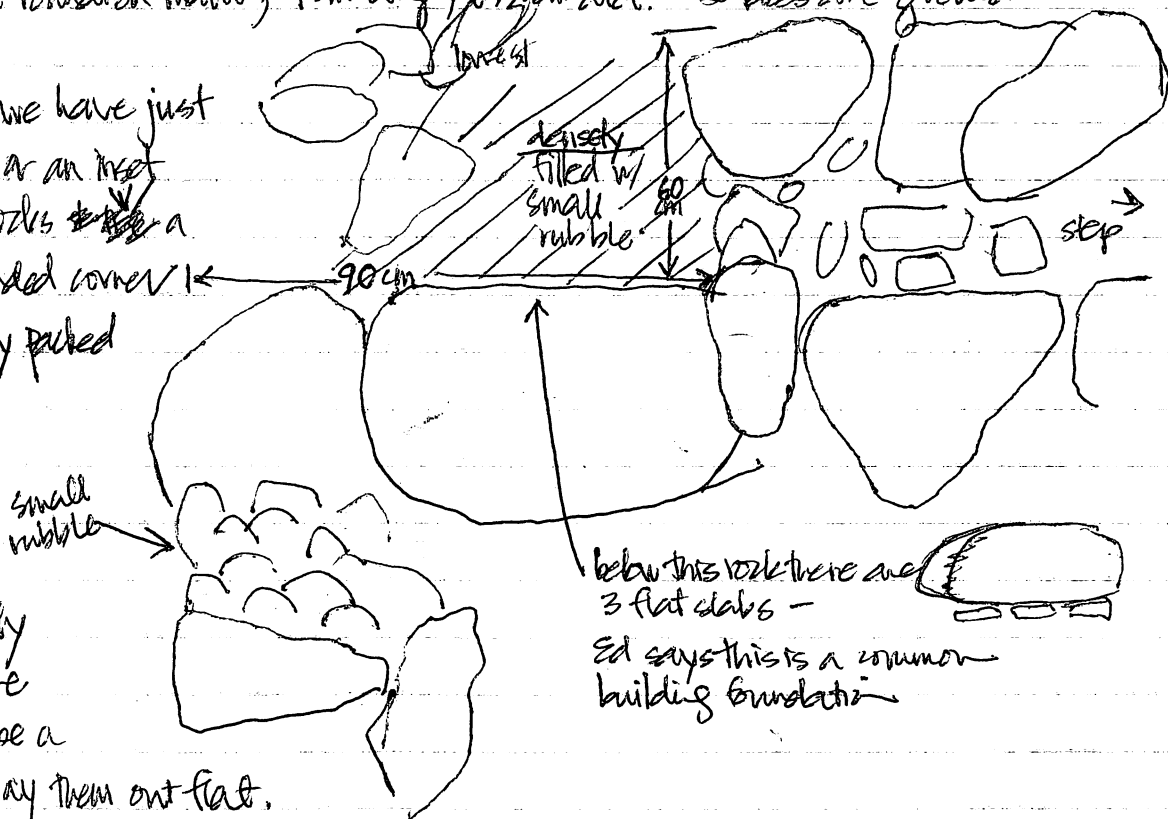

lot 104K/15 58N 47E + NW corner of 57N 47E 40-60 cm BGS

looking at the depth of the structures NW corner. 2 pcs basalt; ~60 shards. Lots of rubble? remnant wall or corner @ depth.

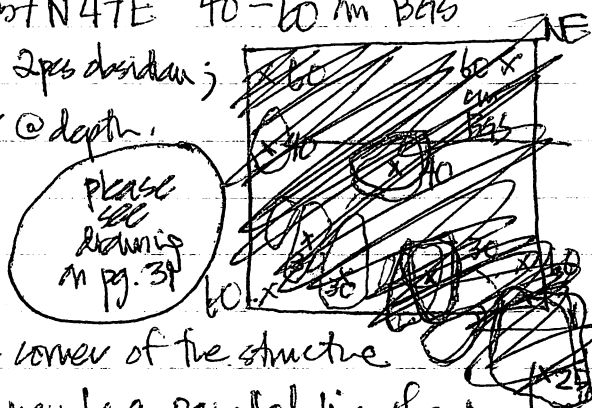

lot 104K/16 0-25 cm BGS

cleaning the S face of the S most wall, from the SE corner of the structure
to SE. 25 shards, 1 pc bayonette. There may be a parallel line of
small rocks just 20-30 cm S of the S most wall.

lot 104K/17 53N 51E 20-25 cm BGS. ~35 shards, 1 pc bayonette
looking at S face of wall passing through NW half of this unit.
wall stops near the middle of this unit w/ a cut block-out on S + W side.

P96-102-31

drawing for lot 104K/15:
(on p. 29)

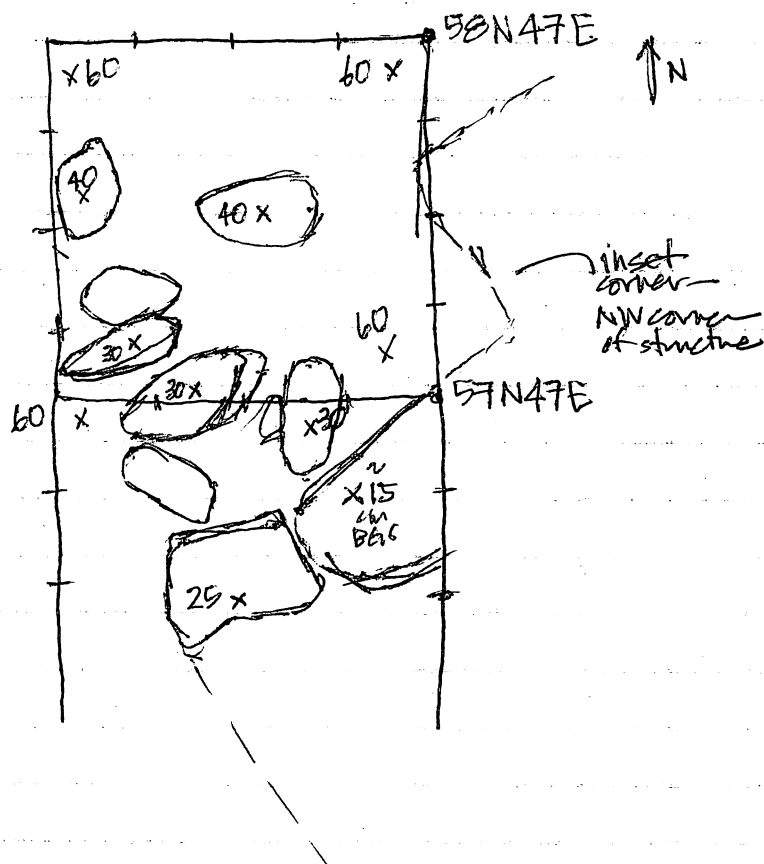

6-13-96 Thursday - 3 teams of 2 today because Amy is sick.

104K/20 Natalie & Pilo clearing off inside (^W face) of E most wall, just N of SE corner of structure. Looks good, but probably not as good as the next line of stones to the E → I think the rocks they're exposed (the ~~EW~~ most line of 3 parallel, side-by-side lines) are an addition to the 2 lines (wall) to the E forming the E most wall. 2pc chert; 2pc obsidian; ~30 shards; bijouneque

104K/21 51N49E still trying to clear up mess in SW corner of structure - moving S to get a better look at the rubble. line of very large rocks running NE-SW in this unit ~40 lg, fat shards; bijouneque (incl. 1 lg. piece)

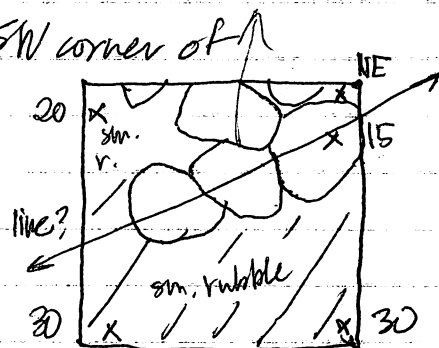

77-80 am BW
lot 104K/22 cleaning up E most wall, just south of NE corner of structure; removing sm. rocks in between wall + line to E. looking for NE corner. can see small foundation stones below some rocks.

lot 104K/18 ^{west corner} the north ~~side~~ of 53N 52E
to better see S face of S most wall.
~ 30 sherds

Mammel wasn't about to do any more work
than necessary so he cut back just enough
to give him access to the S most wall.

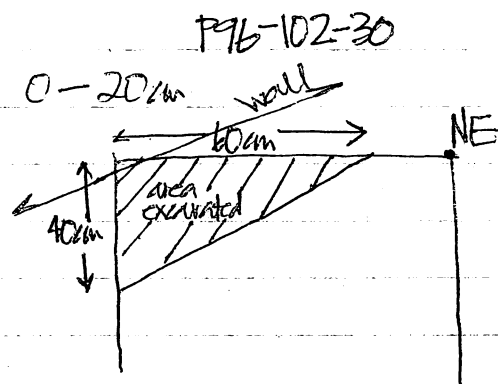

lot 104K/19 52N 49E 0-20/rubble
in BGIS

trying to clear up this complicated area
just S of our good SW corner. There is a lot of
tumble in this part of the mound - we are hoping to
see if there is a trace of our S most wall on
the other (W) side of our axial trench. It is also
possible that this S most wall may meet up w/
the line (or its S continuation, presently not distinguishable)
parallel to, & W of, the W most wall. A lot of information is expected
from this unit! but I'm doubtful the tumble will be easy to read.

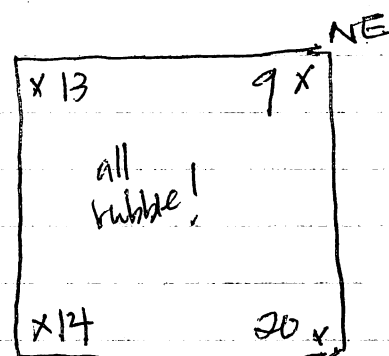

~ 50 sherds
bizarre

→ from p. 24

lot 104C/17 53N 46E 0-20m BGIS

to be continued 6-B-95

~ 40 large sherds

we'll take this down 20m more to move in on the
structure & possible lines/terrace feature from the W.

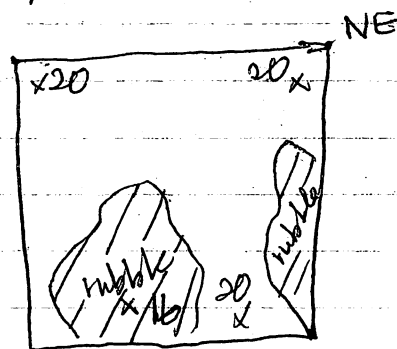

104K/22 cont'd - ~50 sherds.

P96-102-32

104K/23 removing rubble ^{over} thought to extend S in line w/ line of large rocks just E of E most wall - 56 N 53E ^{sw corner}, 57 N 53E. ~30 sherds.

104K/24 53 N 46E 20-40 cm BGS

1 pc. chert; ~50 sherds; 1 metal bit w/ portion of grinding surface. rubble left in center of S wall of unit.

104K/25 51 N 47E 30-50 cm BGS in SE half of unit,

to get a better look at line of stones running through this unit. ~50 sherds, 1 pc. briquetage. Stones appear to only be rubble - they are not laid flat.

104K/26 53 N 47E 20³ - 30 cm BGS

removing rubble, working in toward structure
~40 sherds; 1 pc. chert; 2 pcs. obsidian.

Found a ~~big~~ line of lg. stones, running N-S. Will follow into next unit over

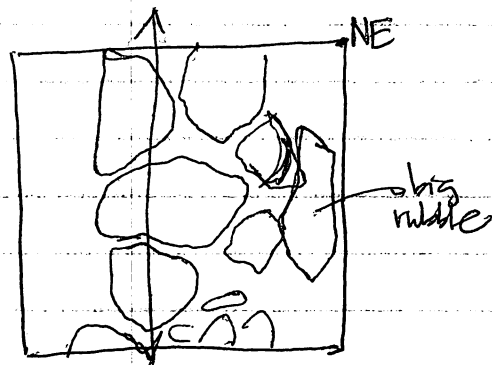

104K/27 clearing away S face of main adobe (see ~~sketch~~ P96-102-05)
E of its corner w/ shrapnel. ~20 sherds. 18-55 cm BUL

6-17-96 Monday (was sick last Friday)

M+V still finishing up lot 104K/26

104K/28 52 N 47E + 51 N 47E, clearing out rubble. May have a

N-S line running through the middle of these units. Need to look to the N and clear to N+E to determine if this line continues. 15-30 cm BGS

~30 sherds.

lot 104K/31 looking for short EW section of terrace wall W of structure, in 54N47E + the SE corner of 55N47E. This section does not appear to exist, suggesting that we have 2 roughly parallel terrace walls, ~~one slightly overlapping the other~~ slightly ~~up ~~where the other is left off~~~~ Ed thinks the terrace wall to W+S (Rose Red) may be ^{a wall} the foundation - it may continue to the S (but we'll have to open up those units). ~ 40 shards; 3⁺ pcs bijouque; 1 pc of obsidian blade

lot 104K/32 still trying to figure out the area beyond the SW corner of the structure - we suspect that there is a line of stores in here somewhere, so we're removing small rocks to see what we can make of what lies beneath. 53N 50E + 53N49E ^{to 40m} 10³⁰ - 140m in places BGS. 1 pc obsidian; 1 pc chert?; 1 pc of a memo; ~ 50 shards; bijouque

33

lot 104K/33 cleaning up the NE corner of the structure, between the wall + line of stores. 3 shards.

lot 104K/31 cont'd

2 slabs of schist are protruding out of the line just W of the W most ~~the~~ wall (The S most slab may not be set in this line properly, but that's not clear yet.)

S slab 58cm BL
N slab 19cm BL
removed 6-18-96

LL is 14cm above Datum #2
Bm above Datum #3
we average elevations
the N slab is fitted down to the E

The S slab especially may be part of a floor surface. Roughly flat fill of cobbles below + W of the slab at NS line of rocks.

lot 104K/34 51N49E - center of W side 15-20 m BGS.

cleaning out dirt, small rubble on other side of possible line of stores passing NS thru this unit. Shards

lot 104K/35 53N 47E ³⁰ - 40. m BGS, mostly E half of unit - cleaning E of line of stores. 1 pc netate (13x8x4cm); 2 pcs obsidian; 40 shards; bijouque.

lot # 104 K/29

remaining N portion of arc, cleaning up + exposing ~~the~~ S face of "main wall", the S wall of the "good" room in 54N50E, 54N49E + 54N51E. 2 pos. decision; 100 sherds (some quite lg.); biquaque (including one piece ~~very~~ showing impression of building material).

14-50cm BL



lot # 104 K/30

54N46E

20-40

in BRS.

1 pos. decision 70 sherds (some very lg.)

remaining what appears to be all rubble to get a look at possible terrace wall. Corner of terrace wall may be in this unit - it appears to run roughly parallel to the W most wall from the NW corner of the structure to same point (the NW corner of ?) 54N49E, where it turns for about a meter or meter and a half to the W - the corner we uncovered in the E wall of this unit is where the terrace wall turns S, running just E of the 52N46E stake

Notes on the NE corner of the structure:

There are really 2 corners here. ① the original, the one where the N most wall meets the E most wall. Unfortunately 3 large rocks slipped on the E most wall just S of this corner and the corner is kind of difficult to make out (it needs to be cleaned + it may be clearer after that is finished) ② the second corner was created by tacking on another rock to the N most wall to form a corner w/ the parallel-ish line of rocks just E of the E most wall.

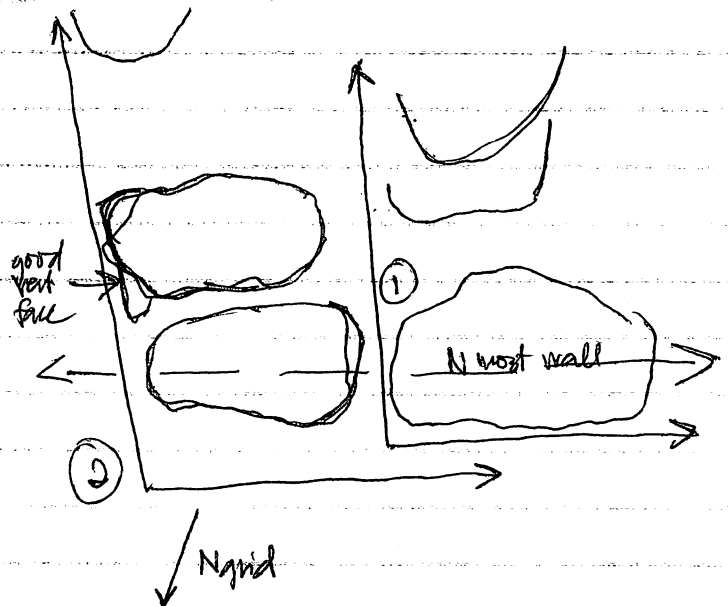

6-8-96 Tuesday Leslie stayed home, got Carlos + Santiago today

lot 104K/35 still being worked on by Miguel + Victor

Carlos
+
Santiago

lot 104K/36 taking area down ^W of E most wall, E of E wall of small room and S of the sketchy cross wall to ~~the~~ level with the S wall of the small room.

50-
70cm
BGS

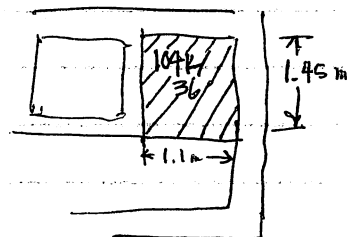

The area is about 1.45 x 1.1 m, taken down 30 cm. We want to make sure we have the base of the 3 enclosing walls. Took a soil sample (approx. 1 1/2 liter).

1 pc chert; 100+ shards; we may have a large portion of a thin-walled, handled jar in this lot. The various pieces of this vessel did not appear to rest on a uniform (floor?) surface

lot 104K/37 52N 49E (E side) + NE corner of 51N 49E.

30-50 cm BGS. clearing down level w/ other units - remaining earth on east side of possible line of rocks running N-S. ~20 shards, 2+ pcs baguette.

This N-S line, in profile, looks like:

Two rocks sit on top of each other.

Unfortunately the line worsens to the N + does not continue to the S.

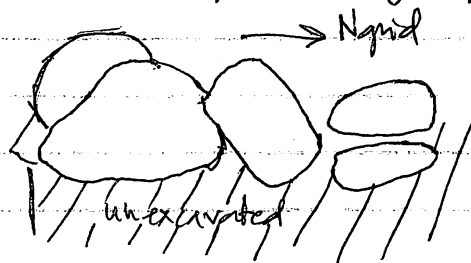

W half 30
lot 104K/38 53N 47E 30-40 cm BGS

clearing out rubble, working toward possible line of stones along E edge of unit. Line remains sketchy, with tipped stones, stones ^{haphazardly} placed atop one another, no vertical faces. It may be something, though. ~25 shards; 1 pc of obsidian blade.

O/rubble - 30 cm BGS

lot 104K/39 51N 51. SE (or the W half of 51N 52E) + W half of 50N 52E taking out the 1/2 unit to better see + remove rubble from the line of stones E of the E most wall. ~20 shards? Left possible floor surface in E half of 50N 52E intact. E line (charley) looks good.

P96-102-36

lot 104K/40 taking down area down below, W of E most wall + N of S most wall. 50-70 cm BGS

lines of stone in this area, and ^{at} the S corner of the crosswall + E most wall suggest to Ed earlier construction. that makes this lot construction fill, on which the E most wall (at least its W face ^{W wall}) was built.

1 pc obsidian; 40 shards; bajareque
see notes bottom of this page, P96-102-37

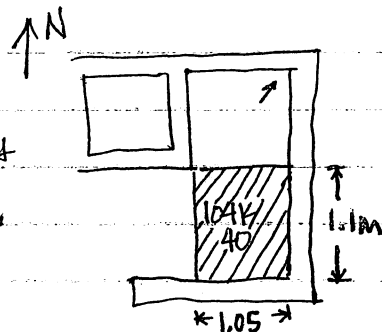

20-50 cm BGS

lot 104K/41 removing rubble from ~~SSN 46E~~ SSN 46E + the NW quad of SSN 47E - to better look at the W + N side of the 2 rings of stone in these 2 units, as well as to look at a section of the line of large stones roughly paralleling the W most wall. 200+ shards (many lg.); 1 pc. obsidian. Many large shards came out of this area - the fill below the level of checkers (the entire containing the 2 rings of stone) may have been ^{introduced} introduced to bring this area level w/ checkers + w/ possibly old Yeller + Rose Red.

also clearing around the large rings (and big circle of rock) of stone

lot 104K/42 ~25-50 cm BGS, from 1.3-2.5m S of N end of Rose Red, east removing 2 lg. stones ~~from~~ from line of rocks, roughly parallel to + W of the W most wall. ~50 shards; 1 pc. chert; 1 pc. obsidian. These stones had both fallen off this line / low terrace of stones and the tumble and slopewash that filled in the gaps was removed.

lot 104K/43 56 N 53 E

clearing around the S most stone in the E most line (parallel to E most wall) ~15 shards. 20-30 cm BGS.

notes on the stone uncovered S of crosswall + 1.1m W of E most wall: excavation to 70 cm BGS revealed 2-3 possible alignments of stone, 18-25 cm below (+ therefore previous to) the E most wall (cliffed) + its W side face / parallel wall (in tin tin). The few rocks uncovered near the SE corner of the small room (corner of marmalade + max) are 7-17 cm below the lowest course of this corner.

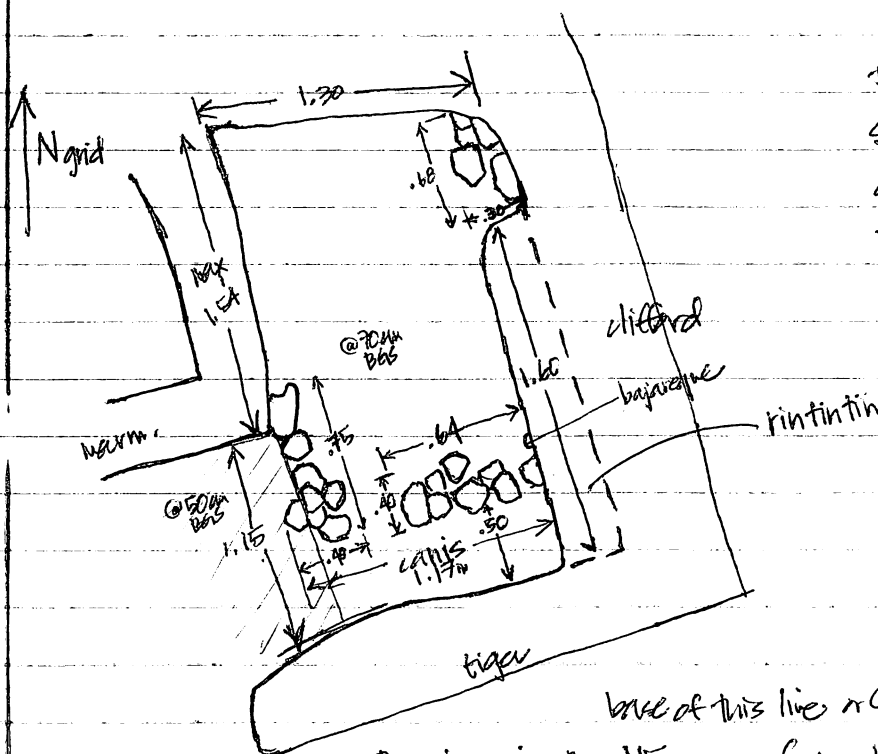

the line of stones ~~to~~ in the
 S portion of this open, L-shaped
 area is called canis.

Perhaps this is part of a
 wall ~~contemporaneous~~ w/
shoopty (or the Winmost wall)

and shoopty + canis may
 have met ^{roughly} where shoopty +
marmatuke now meet.

Unfortunately there was not
 enough time to find the

base of this line n ② to follow canis to the west.

The stones in the NE corner of the L-shaped area are not
 sufficiently uncovered to make any conclusions as to their significance.

By the way, a 8x6m chunk of bajareque is partially exposed, level w/ canis, in the west
 face of rintintin.

At 104K/44 pieces of vessel ~~was~~ on floor surface in N half of 57N49E.
 210 shards.

Site 104, Str. 4 (subops C+K)

P96-102-38

6-19-96 Wednesday

FINAL NOTES

It's about 1 pm. - I hope I can spend time tomorrow working on these too.

For the purposes of these notes I'll stick to the "funny dog names" for features, though in my excavation notes I almost always used names like "N most wall" or ESE-WNW wall in N-E. I apologize for the inconvenience - at some point (after my lot work is finished) I'll enclose a list of synonyms for features. Here are the ~~best~~ named features, w/ their main synonyms + orientations, when applicable:

lassie (N most wall)	
inside	272° - 92°
outside	272° - 92°
shoppy (W most wall, nice wall)	351° - 171°
marmaduke (S wall of room)	84° - 264°
max (W wall of room)	260 3° - 183°
underdog (cross wall)	260° - 80°
clifford (W most wall)	350° - 170°
rintintin (wall just W of E most wall)	350° - 170°
tiger (S most wall)	260° - 80°
caulis	98° - 278°
charley (line E of E most wall)	
east	352° - 172°
west	352° - 172°
rose red (line W of W most wall)	east 350° - 170°
spike	west 350° - 170°
pluto	272° - 92°
old yeller	192° + 266°
checkers	10° - 190°
aster (shot wall E of W most wall)	351° - 171°
toto	

Lassic, or the N most wall has 2 parts, "inside" and "outside".

The "inside" part is from the cornerstone at the N end of snappy to a large stone w/ a cut N face. This part is 2.3m long ^{+ approx 40 cm thick} and is made up of 5 large rocks, all w/ very convincing N faces. (rocks are from $65 \times 40 \times 20$ to $40 \times 25 \times 20$).

Beneath the second rock from the W ^{end} are 3 small (10×4) flattish rocks - this is the only indication of a second course. The Lassic continues E of the end of these "inside" rocks, but large rocks w/ clear vertical faces are no longer present. The 2 ~~most~~ ^{nearest} rocks in this line are also flat on top and may have served as a step level w/ to, the floor fragment lined with schist just S of this portion of Lassic "inside". The portion of Lassic "outside" extending 40m N of + 20m below ^{the top of} Lassic "inside" may have served as the first step into the structure. The S side of Lassic "inside" does not have clear vertical facing.

west end: top of wall/rock ~~77m BLL~~
bottom of wall/rock ~~77m BLL~~
77m BLL
7.0m BLL

east end: top of wall/rock 63m BLL
bottom of wall/rock 77m BLL - approx. elev. of first step

There may be a lower, second course to the east, blocked by Lassic "outside".

Lassic "outside" has the same orientation as "inside", but its NW corner is 80m to the E + then 60m N from the NW corner of "inside", forming an inset corner at the NW corner of the structure. Lassic "outside" is 3.1 meters long (including Lassic "inside" the wall is 3.9m long) and is 80cm wide for most of its length. It is ~~made~~ constructed of only one course and its S side is very poorly defined and ~~is~~ ^{does} not have a vertical definition. Defining the N side are large rocks ($35 \times 40 \times 14$ to $30 \times 30 \times 15$) laid flat, ~~smaller~~ medium rocks ($20 \times 20 \times 10$) + a fill of ~~small~~ roughly define the S edge and the wall is filled in w/ small rocks ($10 \times 5 \times 5$).

The 1.55m of "outside" are lower than the next 1.05m. The final rock, making up the corner of Lassic + Clifford seems roughly on level with the ~~next~~ ^{west} section of wall.

taken on N face { east end: top .77 bottom .86 ~~77~~ BLL
middle T .47 B .74
west end T .72 B .90 ~~72~~ BLL

From 1.20 to 1.55 W of the E corner, ~~the~~ Lassic "outside" is paved with schist slabs and is 30 cm lower than Lassic inside. I guess that the schist formalizes this as a step. The distinctiveness of Lassic "inside" ~~was~~ ^{suggests} that it was constructed first and the lower "outside" added on - the ~~the~~ E portion of the wall, w/ ^{the} combined thickness of both inside + outside, would appear to have been put in w/ the ~~the~~ west part of Lassic "outside".

Lassic "inside" is integrated w/ snoopy, and the E end of Lassic looks to be integrated w/ the N end of clifford, although this corner is poorly preserved.

Snoopy, the W most wall, is our "left" wall and possibly one of the earliest walls of the structure. It is integrated w/ Lassic "inside" and is abutted by the later ^{higher} wall, marmaduke on its S end. The line of stones ~~rose red~~ prevented us from definitively finding the bottom of ^{the W face of} snoopy, but I believe were within 10 ^{cm} ~~cm~~ of its base. ^{We have the base of its E face at the S end.} The east face of the N end of snoopy is covered by asta. The E face of snoopy is abutted by the later, higher wall underdog. Snoopy is 3.6 m long and is about 3 courses (W face) to 4 courses (E face) high and 2-3 courses thick. ^{→ 4m N end 75cm S end} It is made up of medium + small stones (but with no ^{regular} alternating pattern) and large stones only make up its N end.

small	7x5
medium	28x13
large	45x20

Sand outside(W) top	28cm BLL	bottom (as exposed)	75cm BLL
inside(E) top	20cm BLL	bottom	63cm BLL
N end corner of Lassic	bottom	90cm BLL	(top has been destroyed)
inside(E) top	40cm BLL		

Both faces of snoopy (the portions exposed) show attention to clean vertical faces. The pattern of snoopy's E face inside the small room created by ^{it} marmaduke, max, underdog is the most attractive vertical face in the structure. Ed noted that this wall is downslope on the artificial rise this structure is built on - it was thus, he believes, more substantially built and its base is lower than the other walls. The lines of stone (at rose red + old yellow) to the W are downslope and thus lower + each line to the E is progressively higher.

P96-102-41

Although the bottom of the W face was not exposed, the average height of the ^{exposed} wall on this face is 45 cm. The wall is approximately 50 cm high on its E face inside the small room.

Marmaduke

~~Max~~ is the S most wall of the small room. It is 2.3 m long and 38-44 cm high, made up of about 3 courses of medium and small rocks on its S face and 1-5 courses of large and small rocks on its N face (the W end of N face has 3 courses of small rocks)

small = 8×9 medium = 22×14 large = 20×20

The wall is 2 courses thick, 50 cm wide on its W end + 50 cm wide on its E end

W end	N	bottom	<u>60</u>	top	<u>17</u>
	S	bottom	<u>55</u>	top	<u>10</u>
E end	N	bottom	<u>56</u>	top	<u>18</u>
	S	bottom	<u>50</u>	top	<u>13</u>

More attention was paid to putting a good vertical face on the N face of the wall than on the S face, but the S face, particularly the lower 2 courses, is relatively flat. ^{Marmaduke} ~~Max~~ abuts and sits ~~above~~ higher than (and on top of shreds) Snoopy.

~~The corner of~~ ^{Marmaduke} Snoopy is kind of strange looking. The N course is made up of 2 very large rocks, whose pointy ends project about even with the ^S end of Snoopy. The S most ^{face} of ~~Max~~ ^{Marmaduke} starts 20 cm E of the ends of these rocks and the top 2 courses ~~have~~ ^{have} their flat faces facing to the W.

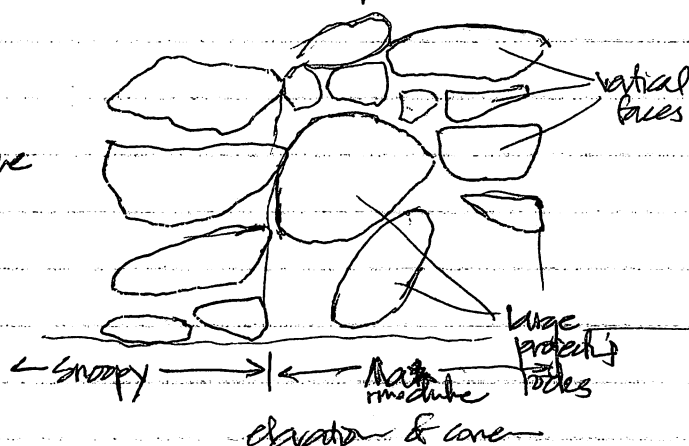
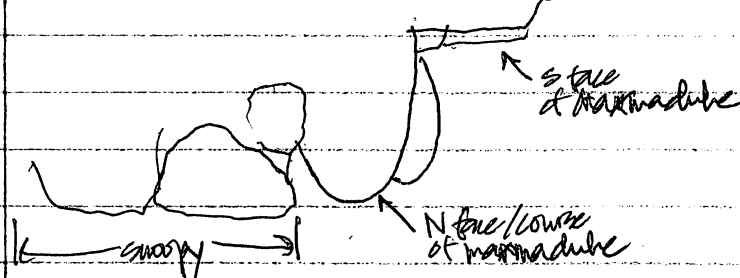

Marmaduke is well integrated with Max, the E wall of the small room, which seems to be contemporary.

57 (9/10/97)

P96-102-42

Max is the S wall of the small room. It is 1.63m long and is preserved ~~to~~ from 40 cm tall (S end) to about 20 cm tall (N end). Only 2 courses of large and medium stones are present on the W face and 3 courses of medium + small stones are visible on the E face.

small = 7×6 medium = 22×12 large = 45×18

The wall is 2 courses thick and is 50 cm thick. More effort was made to put a smooth face on the E side than on the W side (the opposite of Narmaduke)

The wall appears to tip downward to the S to its intersection with the middle of Underdog. The wall (as noted above) is much less tall on the S N end, ~~possibly~~ bringing it level with the top of what is preserved of underdog.

S end	E	bottom	52	top	16
	W	bottom	55	top	18
N end	E	bottom	57	top	37
	W	bottom	65	top	46

Max is integrated with Narmaduke and abuts Underdog, which will be described next.

Underdog or the "cross wall" stretches across the width of the structure and is extremely sketchy. It is 3.1m long and is from 1 to 3 courses high, made up of ~~mostly~~ primarily a line of medium stones, sometimes with a row of small stones beneath (at W end) or w/ medium sized flat stones placed on top (at E end). medium = 17×30 small = 7×7

25 cm high -
W end
up to 40 cm high -
S end.

A large ($36 \times 30 \times 8$) flat slab of a reddish, grainy rock sits ~~at~~ on the top course of underdog at its intersection w/ Aetz. Underdog is only 1 course wide - it fluctuates in width from 35 to 20 cm (wider on the 2 ends, narrowest near its intersection with Max.)

E end	bottom	60	top	25
middle @ Max	bottom	58	top	42
W end	bottom	58	top	24

★ important note: the construction material in all cases is river boulders.

The portion of the N face of Underdog not obscured by Asta shows some attention to vertical facing, although this face is not as "clean", for instance, as the exposed E face of Snoopy. The flat faces of the rocks were placed in this direction, whereas the irregular faces were left to show on the S face.

There is some effort, in the portion of the S face w/in the small room, to level out the face with smaller rocks. This was not ~~even~~ at all attempted for the S face of the portion of Underdog between Max and

~~the base of~~ ^{Clifford}, which is exceptionally irregular. Ed suggested that this face was irregular because it was a retaining wall for soil,

and thus Underdog would have had to be built for this purpose after the construction of Max, whose N E face would have stood

alone before also serving (w/ Underdog) as a retaining wall for soil. ^{The bases of} Max and Underdog appear to be at roughly the same depth.

^{The base of} Underdog is approx. 10 cm higher than the base of Snoopy

at their intersection. ^{The bases of} Asta + Underdog seem to be roughly level and

Asta abuts Underdog - the 2 walls are not integrated

~~Snoopy~~ Underdog abuts Snoopy, with small rocks filling in the gap between the last large ones in Underdog + the face of Snoopy. The N face of

Underdog, where it intersects Clifford is messy. The S face of this intersection is jumbled, but Underdog appears to abut Clifford, although ^{the base of} Underdog may be a few centimeters below the base of Clifford.

~~Asta~~ is a short wall built on the E side of the N end of Snoopy, just N of its intersection with Underdog. It is difficult to tell where ~~the~~ the N end of Asta is - a conservative guess is that it is 1.10 m long, and therefore ends well short of the S side of Lassie "inside" - Asta turns to difficult to read rubble after 1.10 m. The wall is approximately 45 cm tall and is 2 courses high, 3 courses in one spot. The courses aren't regularly laid out and the wall (both top + bottom) tips down to the N. The wall is 2 courses, or about 50 cm thick. The W face is of course obscured by Snoopy.

South	bottom	50	top	15
-------	--------	----	-----	----

North	bottom	62	top	34
-------	--------	----	-----	----

Asta abuts Underdog and the status of its N end is unclear.

The rocks making up ~~Atto's~~ E face are from small to medium to large

sm = 10×4 med = $25 \times 18 \times 16$ lg = $32 \times 25 \times 20$

only 3 of the approx. 10 rocks visible of this face have relatively flat faces — the wall does not have a regular, flat surface.

Lanis is a short line of stones which is 15-20 cm below, and passes under, Kintin. Lanis continues to the W, but time did not permit following it in this direction. Lanis is plotted, rock by rock, on the plan view of this structure. The exposed portion is 1.18 m long, 20-39 cm wide (up to 2 stones wide), and 23 cm tall maximum (3 stones high max). The stones are all small/medium, about 10×16 . No vertical facing or formal courses are apparent with this little of Lanis exposed.

East	bottom	<u>78</u>	top	<u>56</u>
West	bottom	<u>78</u>	top	<u>57</u>

Perhaps Lanis is contemporary with Swoopy and may have met w/ Swoopy's S end. Lanis would have been later ~~knocked down by the construction of Pin~~ knocked down? + covered, possibly with the fill placed behind (S of) Underdog, and then by (presumably) Clifford + Kintin.

Clifford, of the E most wall, is 5.90 m long. It is pretty consistently 26 cm high, 2 courses — small ^{flat high} rocks below medium or large rocks

small = $10 \times 6 \times 6$ med. = $22 \times 22 \times 16$ lg = $45 \times 30 \times 15$

Clifford is 2 courses thick, a consistent approx 47 cm thick.

Clifford's N end, where it meets Lassic, appears to be lower than its S end, where it intersects Tiger.

S end	bottom	<u>56</u>	top	<u>30</u>
middle	bottom	<u>69</u>	top	<u>43</u>

(in N of intersection w/ Underdog)

N end	bottom	<u>86</u>	top	<u>77</u>	(same as E end of Lassic)
-------	--------	-----------	-----	-----------	---------------------------

As mentioned above, the relationship between Clifford + Lassic is somewhat sketchy — Clifford runs beyond what looks to be the S face of Lassic, but this face is extremely poorly defined — ~~the~~ Clifford + Lassic only share a mass of irregularly laid out small ($10 \times 6 \times 4$) rocks.

Clifford is joined^{to}/connected with the Sand of Charby "nest" by a group of medium rocks running lengthwise between them (rocks are approx $23 \times 15 \times 8$). These rocks are present from 2.25 - 3.25 m from the outside corner of Clifford + Lassic, and are opposite/across from the intersection of Clifford and Underdog. Again, Underdog abuts Clifford. Pin Tin Tin was built ~~on the~~ against the W face of Clifford, starting approx. 30 m S of Underdog/Clifford + running to hit Tiger. The upper course at the Clifford/Tiger intersection shows that the two walls are integrated, but the lower courses may be independent (the masonry is ~~just~~ just too irregular for this to be clear). Tiger + Clifford seem to be roughly equal in terms of the depths of their bases.

Some attention was given to producing a regular, relatively vertical, flat surface to both the E + W faces of Clifford. The wall is nicely defined and was easy to follow while excavating.

The S face is from 20-25 cm tall.

Tiger, or the S most wall is 2.75 long and is constructed - on its S face - of 1-2 courses of large ($30 \times 35 \times 20$) to medium ($30 \times 20 \times 15$) cobbles, often over small ($12 \times 4 \times 6$) rocks laid flat. The S face is fairly vertical, ~~and~~ produced by setting out the flat sides of the cobbles. The N face of Tiger - the wall is 2 courses ~~thick~~ + approx. 45 to 55 cm thick - is far less easily defined. It is made of med. + sm. (same approx. sizes) rocks and can be from one medium rock (or 15 cm) high, to 4 small rocks (or 22 cm) high. The N face is far less regular and it curves to the S, about 80 cm E of its W end, producing a wall only about 42 cm wide.

W end	bottom	49	top	22
-------	--------	----	-----	----

E end	bottom	54	top	31
-------	--------	----	-----	----

The relationship between Tiger + Clifford has been discussed. Pin Tin Tin abuts Tiger.

The W end of Tiger simply stops and connects with no other walls. A line of stones, ^(only 1 stone thick) spike does extend immediately off the W end of Tiger, but ~~it~~ changes its orientation (see pg. 30) after about 60 cm.

KinTinTin is a line of stone ~~at the base~~ built up against the S end of Clifford, abutting Tiger. KinTinTin is 1.70 m long and is made up of a top course of 5 large ($30 \times 20 \times 10$) rocks, and a second ~~and~~ in some cases a third course of medium ($10 \times 10 \times 7$) and small ($6 \times 6 \times 4$) rocks laid flat — this "wall" is from 20 to 25 cm high and is only one course or approx. 30 cm. wide.

N end bottom 41 cm BLL top 16 cm BLL

S end bottom 43 cm BLL top 19 cm BLL

KinTinTin sits ^{at base} above Clifford, is higher + ~~is~~ almost certainly later than Clifford and is at roughly the same elevation as the base of Tiger.

Some effort was made to set the flat sides of rocks to be W, but the rocks are too widely spaced to create a flat vertical face.

Charley is a line of stones 4 m long. Charley has 2 separate alignments, one just east of the other. Charley "west" is 3.1 m long. Its N end is a rock w/ a N face flush w/ the N face of Clifford, making it look like an extension of this line.

10 cm to the south are 2 more rocks one placed on top of the other, with decent ~~the~~ vertical E faces. The line runs up slope, to the S ~~at~~ 4 to 6 more rocks (we shot 2 different plan points for the 2 different possible S ends of Charley west). The last 2 rocks ~~are~~ ^{sit} above the N most rock of Charley east, but this rock's east edge projects out ~~about~~ 13 cm more to the east.

(the longer estimate is the 3.1 m length)

Charley east starts 2.6 m S of the N end of Charley west and is 1.35 m long. It is made up of 3 rocks whose flat east faces are clearly in line. The rocks making up Charley east + west are all large, in the $36 \times 30 \times 15$ range. Charley west is from 36 to 30 cm wide. Charley east is narrower, about 25 cm wide.

Charley west N end bottom 83 top 56

S end bottom 46 top 28

Charley east N end bottom 61 top 50

S end bottom 64 top 50

The rocks joining Charley west to Clifford are roughly level with C. east and they project into the ~~area~~ between individual stones of Charley east.

Charley, cont'd

Charley east was not sufficiently excavated - it is possible that it has greater depth than the 3 rocks barely exposed here. Two schist slabs are located 70 cm perpendicular to Charley west at approx 2.3 m from the N end of this line. The slabs are 57 cm BL and are thus a little above the base of Charley east and are roughly level with the base of Charley west at this point along its length. These may represent a floor surface, but time did not permit further excavation to the east.

Spike is a line of stones extending W from the W end of Tiger. It is 2 m long, 1 course or approx 13 cm high, and 1-2 courses or 26-40 cm wide. It is constructed of medium & large rocks, with small rocks occasionally filling in the gaps. It is constructed somewhat haphazardly, is not obviously a line, with no vertical facing. It was somewhat difficult to follow in the course of excavation.

sm = $8 \times 6 \times 4$
med = $20 \times 10 \times 10$
lg = $30 \times 24 \times 10$

West bottom 56 top 40 cm BL
East bottom 61 top 46

It intersects and appears to be well integrated with Pluto.

Some of the rocks ^{buried} at the E end of Spike were once considered to be the S end of the mystery arc, the first possible feature that turned out not to be one.

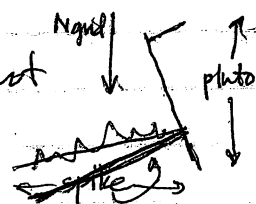

Pluto is an L-shaped line of stone - the long arm being 1.53 m & the short arm 0.70 m, terminating in the bench wall. Pluto is one stone or approx. 28 cm thick and is from one to two courses high (about 20 cm). Its N end was not completely excavated, so its true depth is unknown. These stones are not consistently laid flat, making Pluto sketchy at best. The W side of Pluto is also poorly defined.

N end bottom 69 top 59
corner bottom 73 top 57
W end bottom 81 top 47

(deepest)

Rose Red is a line of stone running roughly parallel to Snoopy. It sits downlope from (below) Snoopy. It has 2 different alignments, Rose Red east + Rose Red west.

Rose Red east is 2.7 m long, and is a line of 7 medium ($24 \times 24 \times 10$) + large ($40 \times 30 \times 20$) river cobbles, with a very few small ($6 \times 6 \times 4$) rocks placed in the interstices. Rose Red east starts about 60 cm S of the N end of Clifford and ends roughly equal with Clifford's S end. Rose Red east is 30 cm wide + 24 cm high on average.

Rose Red west is set slightly below + its W edge is 20 cm W of the W edge of Rose Red east. Rose Red west starts about 1.9 m from the N end of Rose Red east + has the same orientation. It is made up of ~~25~~ ¹⁵ rocks whose W faces are roughly in line and it is 1.53 m long. Rose Red west is one stone thick ($20-25$ cm) + one stone high (approx 15 cm). Two pieces of schist are set about level with the top of Rose Red west, suggesting that this wall/line may have retained fill for a floor surface of some kind (see notes for elev. of schist slabs).

Rose Red west is composed of 1g ($35 \times 20 \times 15$) md. ($20 \times 20 \times 10$) + sm ($10 \times 10 \times 5$)

rocks. Extending S of Rose Red west is a jumble of rocks with no clear alignment ~~and~~ - this has not been designated a feature.

<u>Rose Red east</u>	N end	bottom	86	top	71
	S end	bottom	73	top	58
<u>Rose Red west</u>	N end	bottom	88	top	70
	S end	bottom	78	top	64

Old Yeller is a curving line of stone, running mostly N-S, but curving towards the E on its N end. It is composed of 8 rocks (2 side by side in line) and is 1.65 m long - the plan view shows Old Yeller rock by rock. The width + height of Old Yeller varies by rock. It is on average 25 cm wide and 15 cm tall (narrower + shorter on the N end). Rocks are large ($35 \times 25 \times 15$) + medium ($20 \times 25 \times 12$) cobbles. Old Yeller sits lower than the other walls on the site, but sits level w/ or slightly above Checkers.

N end	bottom	90	top	88
S end	bottom	85	top	71

max height (in curve) = 61

Old Yeller may have held soil between it + Rose Red east.

P96-102-49

The N end of old Yeller was not completely exposed, but given that the S end is only one stone high, it seems unlikely that the N end would have more than one course.

Checkers is a circular shaped group of stone N of Rose Red. The S part of Checkers appears to contain 2 rings of stone, perhaps ~~two~~ upright supports. Checkers can be seen, rock by rock, on the plan view of the structure.

Plan points were taken around the inner edge of each ring - 4 points per ring.

~~west~~ ring avg. top of ~~stone~~ 60 cm BLL

east ring avg. bottom of ring 72

inside ring 72

(on top of stone in center)

~~west~~ ring avg. top of ring 66

avg. bottom of ring 79

inside ring. 71

~~on top of stone in center~~ (on top of stone on N side of inner ring)

The stones left in place N of the 2 rings were left because they seemed to slant under the ring or ^{their removal} threatened the rings in some way.

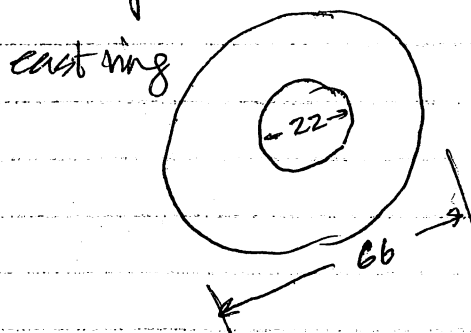
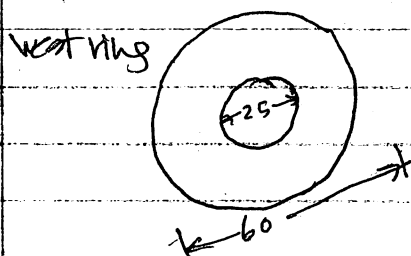

Toto is the remains of what may be a floor, in line w/ and just S of the possible steps (lower is schist lined, upper is the top side of Lassic inside) in the middle of Lassic. Toto is defined by 3 schist slabs and one slab of tuff, laid roughly flat + roughly at the same elevation. These are drawn on the plan view. The slabs, and the remains of a jar that seemed to sit on this surface are all about 58 cm BLL. The areas SE + SW of Toto remain enigmatic and difficult to describe. To the SE (see plan view) there is a group of rubble (top = 41 cm bottom = 60 cm BLL) that may have been part of a wall. The S most rock parallels one set 35 cm to the S in Underdog. A line of small (15x15x10)

P96-102-50

rocks links the SW edge of Tot to the NE end of Asta, but their significance is unclear, ~~Some~~ The tops of some of these rocks are @ 50cm BL or slightly above, raising the possibility that they were built to support the two. They may have also made a small, 40cm thick wall perpendicular to the east of Asta.

The soil seems to be consistently the same color and texture
10yr 5/4 or 4/4 silt w/ tiny mica particles (but not much)
yellowish brown or dark yellowish brown

Site 414 Str. 6

6-25-96

P96-102-51
~~810~~

414B

goal of excavation is to date this structure

laid an axial trench across the long axis of str. 6, ^{trench} oriented 26° - 1×11 m.
started excavation at the 1st + 3rd meters on the N side, screening the first meter.
working w/ Miguel + Victor, Jaime + Manuel, + D. Luis

lot 414B/01 1st meter of axial trench (0-100 cm). 0-20 cm BGS.

screening w/ $1/4"$ ^{400⁺ pcs} Bone, ^{50⁺ pcs} ~~pottery~~ obsidian (if obsidian, not like late classic obsidian), 100⁺ shards (incl. a weird long neck? of a vessel w/ an irregularly striated exterior). Bone includes a cow? phalange. Also some modern ceramic + glass, bajanque.

lot 414B/02 3rd meter of axial trench (200-300 cm). 0-20 cm BGS.

not screening. We got glass + faux porcelain ^{+ a nail} in this lot, verifying the belief that this mound ~~had~~ has been plowed. The soil in this + the first meter is a medium brown (I don't have a Munsell w/ me) silt w/ some micaceous inclusions.

Have no pieces of quartz, but in general very few rocks in this soil.

In this meter, near 20 cm BGS in the center and ~~is~~ near the middle of the east wall, hard rocky soil was encountered, ^{which looks} ~~similar~~ to be schist. It is a little like creaking bedrock. 200⁺ shards, 40⁺ pcs perlite, 1 pc bone, 1 pc bajanque.

lot 414B/03 3rd meter of axial trench (200-300 cm) 20-40 cm BGS.

Rock content has picked up a bit - mostly smallish ($10 \times 5 \times 3$) flat rocks, slate?, schist + some other kind of rock. Still some modern trash (pc. of blue glass).
Pc. of metate ($9 \times 8 \times 4$) of fine grained rock. 60⁺ pcs perlite. 150⁺ shards

lot 414B/04 1st meter of axial trench (0-100 cm) 20-40 cm BGS, screened $1/4"$

Same bits of mica in this soil. Pc. of metate ($17 \times 8 \times 5$ cm) of dif. material than late classic metates - has "wrinkles" + small vesicles. 200⁺ shards; 100⁺ pcs perlite; 1 pc quartz shatter; bajanque

lot 414B/05 3rd meter of axial trench (200-300cm). 40-60 cm BGS.

of rocks in the soil increases with depth, as does the compactness of the soil. Slate, quartz, unknown rocks included.
~~20~~ ²⁰ ps perlite. ~~60~~ ⁶⁰ sherds. No sign of a soil change, or of a feature.
 Rocks are no bigger than 15x15x10.

lot 414B/06 1st meter of axial trench (0-100cm). 40-60 cm BGS. screened w/ 1/4" baghouse; ~~50~~ ⁵⁰ ps perlite; ~~60~~ ⁶⁰ sherds. finished 6-26-96

June 26, 1996 Wednesday

rained again last night - units are very wet + soil will be difficult to screen.

notes to me -

20 more in 3rd meter; to strike in 1st meter, still screening; 1x2m @ summit; go level w/ 40cm in 3rd meter up to summit.

lot 414B/07 3rd meter of axial trench (200-300cm) 60-80 cm BGS

fewer rocks than above. A few pieces of charcoal (not saved - no soil), bone, burnt bone, chert, 40⁺ perlite, 100⁺ sherds. Rock in S end of NE quadrant.

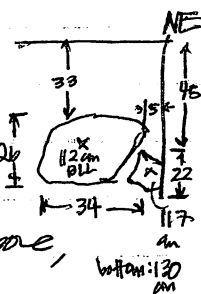

→ BLL is 10 m above Datum #1, a rock at the mound's summit.

Lg. Rock in this unit: top 112cm BLL bottom 134cm BLL

lot 414A/11 surface find at mound summit
 metate foot

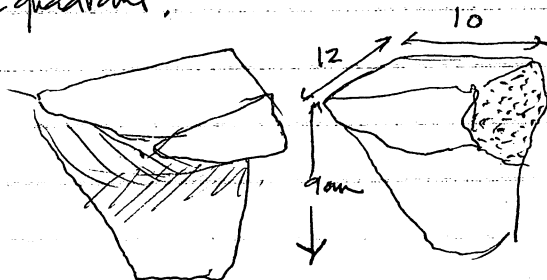

the brick these mounds are built upon + built with was constructed ~~by~~ ^{with} the deposits of the quebrada that now lies to the N of structure 6 - this accounts for its heavy rock content + for the origins of the rocks

lot 414B/08 1st meter of axial trench (200-300cm) 60-80 cm BGS. screened w/ 1/4". Burned bone, some charcoal. 200⁺ sherds, 100⁺ ps perlite. Cut metamorphosed sandstone? or natural? (not saved, because I suspect it is natural.) With this ~~mass~~ lot yielding so many sherds, it is necessary to keep digging.

lot 414B/09 10th meter of axial trench (900-1,000 cm). 0-20 cm BGS.

A lot of glass in this lot. Soil is wet, but looks the same as the soil in the 1st + 3rd meters of the trench - all silt, no clay or sand. Very few rocks in this lot, the few rocks are small (≤ 5 cm). ~200 ps perlite, ~40⁺ shards, beige/que.

lot 414B/10 11th meter of axial trench (1,000-1,100 cm). 0-20 cm BGS.

Found a battery (not saved), some plastic, ³ pieces of rusted metal (nail, blade, +?), some glass. 800 ps perlite; 20 shards. Low artifact content compared w/ lots thus far.

lot 414B/11 1st meter of axial trench (0-100 cm). 80-90 cm BGS. screened 1/4".

This lot, as well as the one above, contains a great deal of rock, mostly slate + schist, as well as some quartz / metamorphosed sandstone type stuff \rightarrow most of the rock is planar, which I can't explain very well. # of artifacts seems to be dropping off. Soil is compact. Still an obscene amount of artifacts, especially for a 10 cm level. 3⁺ ps quartz, 50⁺ ps perlite, 200⁺ shards.

lot 414B/12 10th meter of axial trench (900-1,000 cm). 20-40 cm BGS.

20⁺ ps of perlite; 150⁺ shards. ~~Rock~~ Rock content increased a bit with depth for this lot.

ground surface elevations - # cm. below level live (which is 10 cm above datum #1)			
1 st meter	NE	3 rd meter	NE
	SE		SE
	SW		SW
	NW		NW
10 th meter	NE	11 th meter	NE
	SE		SE
	SW		SW
	NW		NW

lot ~~44B/13~~ 44B/13 1st meter of axial trench (0-100 cm). 20-40 cm BGS.
still getting ^{lot} glass in this lot. Metate frag. 150⁺ shards; 50⁺ pcs of perlite; lg. nail;
black? of some sort. Hopefully this disturbed stuff will end soon.

lot 44B/14 1st meter of axial trench (0-100 cm). 90-100 cm BGS.
still finding a considerable amount of material. No apparent change in soil,
150⁺ shards; 60⁺ pcs perlite

June 28, 1996 Friday (missed Thursday - sick)

still working on lots 13+14.
no rain Wednesday or Thursday night.

lot 44B/15 10th meter of axial trench (900-1,000 cm). 40-~~63~~ cm BGS

Possible? piece of groundstone; brazierque; figurine head?

A ^{lens} patch of charcoal found in NE corner of unit,

@ 55 cm BGS, 75 cm BL. Sample taken.

A lot of shards 200⁺; animal bone;

40⁺ pcs perlite. Brazierque circle? in unit (see drawing next page).

Possible soil change ^{to pinkish} in S 30 cm of unit, only visible 0 - approx. 40 cm W of E wall before
being difficult to distinguish @ 77 cm BL or 64 cm BGS. Also getting charcoal in this pink area -
@ 57 cm BGS to?

lot 44B/16 1st meter of axial trench (0-100 cm). 100-~~105~~ cm BGS.

possible soil change @ 105 cm BGS - "more yellow" ^{+ less compact} says Jamie - will have to
wait to see it in the profile. Also @ 105 cm BGS were getting a dense concentration

of small rocks + shards. ^{+ brazierque} Rocks are still flat or angular. Just above the
change to yellow soil there is a 3-4 cm lens of darker soil. See drawing on pg. 55.

20 pcs perlite; 50⁺ shards.

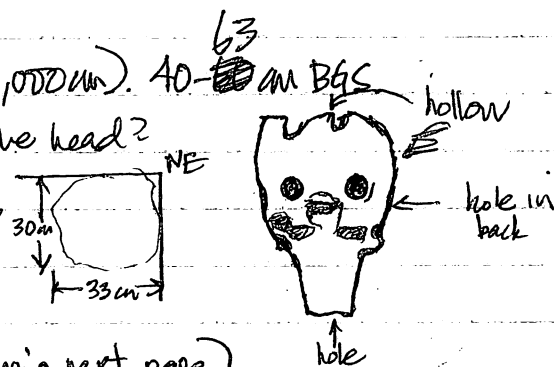

P96-102-55

lot 414B/15 cont'd

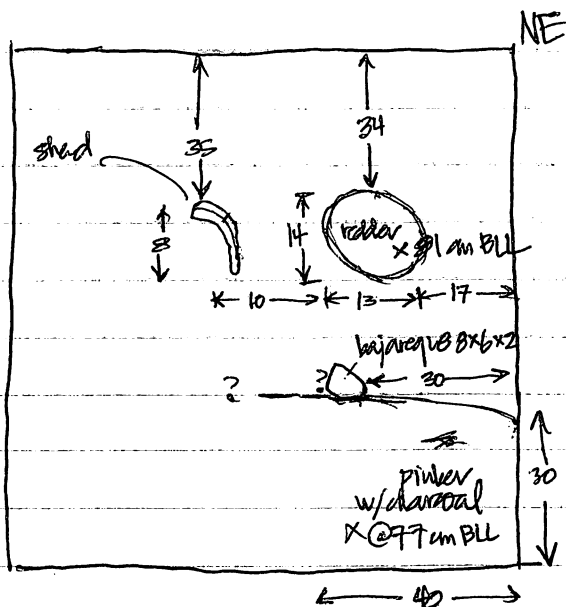

★ still need to draw
Enroll of unit to
see charcoal lenses,
once we get 20-40m
deeper

44B/16

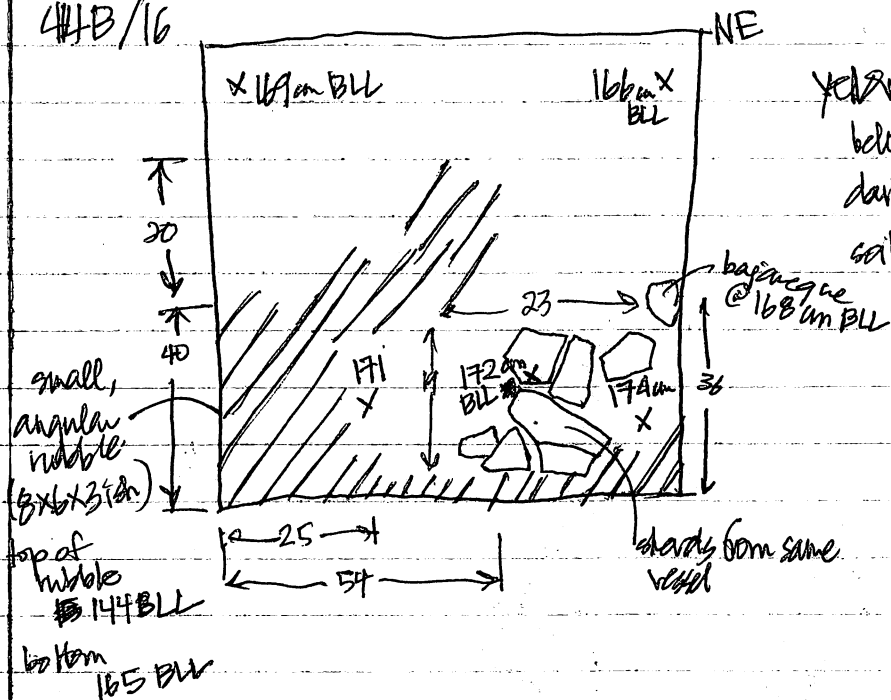

yellowish ~~brown~~ soil
below ~~3-5~~ 3-5 cm of
darker (than soil above + below)

soil

bagian
@ 168 am BL

1. hardly from same
vessel

414B/17 1st meter of axial trench (0-100 cm), taking out yellowish soil,

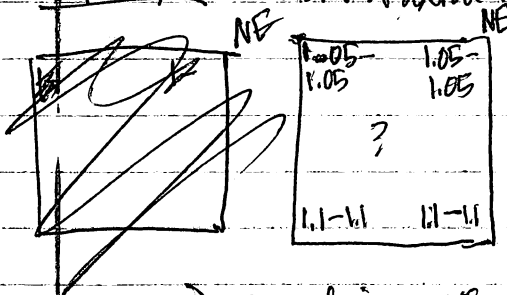

looking for a floor. I don't know how it was done, but they excavated for an hour without the corner elevations changing a bit — they took out the sherds + the rubble in the S end of the unit and must have excavated in the center of the unit only (I didn't take center elevations there). They claim artifact density is dropping. ~100 sherds. 30 pcs per lit.

P96-102-56

lot 414B/18 11th meter of axial trench (1000-1100 cm), 40-60 cm BGS.

300⁺ shards; bajaveque; some animal bone; 50⁺ pcs of perlite.

No carbon, or noticeable soil changes in this lot. No more modern trash, ~~same~~ for 40-60 in the 10th meter of the trench.

lot 414B/19 10th meter of axial trench (~~1000-1100~~⁹⁰⁰⁻¹⁰⁰⁰ cm), ~~60-80~~^{3 70} cm BGS.

bottom & bajaveque circle drawn for lot #16 was @ 60 cm BGS, 80 cm BLL, bajaveque; <10 pcs perlite; 100 shards.

July 1, 1996 Monday

lot 414B/20 1st meter of axial trench (0-100 cm).

sweered w/ 1/4". Pretty damn near sterile. 2 shards, 10 pcs perlite from these 15 cm.

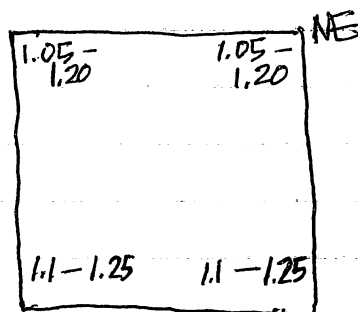

lot 414B/21 10th meter of axial trench (~~1000-1100~~⁹⁰⁰⁻¹⁰⁰⁰ cm), ~~70-80~~⁸⁵ cm BGS.

~~exposed~~ exposed a large, thick piece of bajaveque extending ~~and~~ just E of the center of the S wall.

5 pcs perlite; 1 pc red chert; ~50 shards.

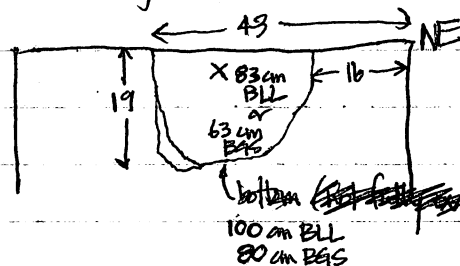

lot 414B/22 11th meter of axial trench (1000-1100), 60-85 cm BGS.

soil sample taken. 200 shards, 30 pcs perlite, 1 shell (5 cm long); 2 pcs animal bone; bajaveque; pc of pigment? or bajaveque (traces to red powder) ~~redder dirt~~ redder dirt (bajaveque?) in S portion of unit. see drawing on pg. 57

lot 414B/23 4th meter of axial trench (300-400), 0-20 cm BGS.

30 pcs perlite; bajaveque; 100 shards; 1 pc modern ceramic. 2 roots in SE quad of unit

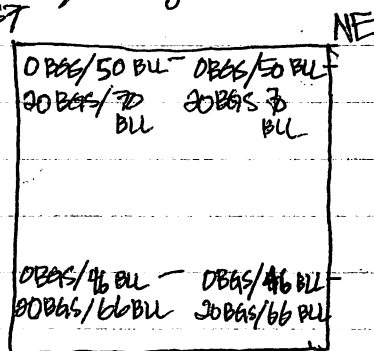

P96-102-57

picture of 414B/22 - 11th meter of axial trench

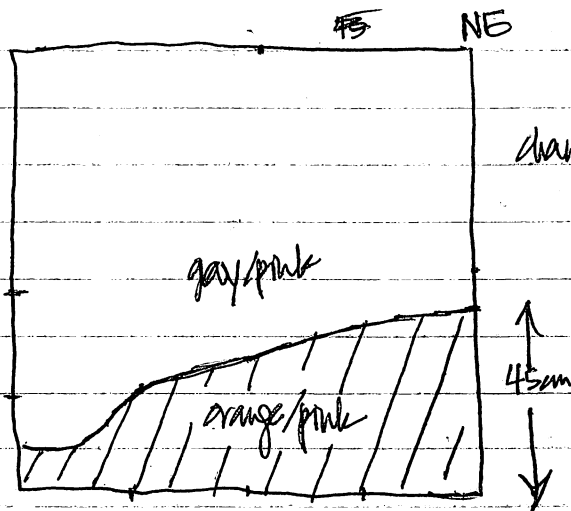

change observed at 95 cm BGS.

414B/24 10th meter of axial trench (900-1000 cm). 85-100 cm BGS

2 shells (approx 4-5 cm); 15 pcs perlite; bajoneque; 125⁺ shards. No soil change. Reached bottom of bajoneque chunk in this level. A piece of schist visible in E wall of unit, 10 cm S of NE corner @ 106 cm BGS.

414B/25 4th meter of axial trench (300-400 cm). 20-43/46 cm BGS.

We will excavate this meter level w/ tie 40 cm level in the 3rd meter of the trench. Chart (some lg. pieces); perlite; bajoneque; 100 shards.

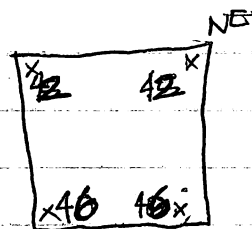

*all at 92 cm BLL

414B/26 11th meter of axial trench (1000-1100 cm). 85-100 cm BGS

<10 pcs perlite; 5 shells; 150 shards (many large). No soil change.

July 2, 1996 Tuesday brilliant lot 25 1st thing this morning. Big 2 of 2 - 6 pcs perlite 9 shards

414B/27 10th meter of axial trench (900-1000 cm) 100-130 cm BGS.

No soil change, same amt. of angular rock as above. 18 shells, bajoneque, 200⁺ shards, <10 perlite.

414B/28 5th meter of axial trench (400-500 cm). 0-20 cm BGS. Strangely, the workers say they found no modern material in this lot - it is probably safe to assume, given the prod. modern ceramic in the 4th meter from 0-20, that this level is also disturbed. 100⁺ shards; 500 pcs perlite; 3 pcs real obsidian (long, thin cutting blades) - I think!

Burial is Feature #1

P96-102-58

lot 414B/29 11th meter of axial trench (100-1100 cm), 100-120 cm BGS.

In the easternmost 20 cm of this unit, ^{+ the smallest 50 cm} the workers distinguished & removed a finer soil than the soil above & in the ~~upper~~ part of the unit. It is a little gray, has few rocks & has some very small micaceous inclusions.

A sample was taken. The finer soil is looser than the dirt remaining in the NW corner and has a low artifact content.

We ~~had~~ a burial in the SW corner at approx. 115 cm BGS. We pulled up 3 pieces of skull (probably) and a piece of maxilla w/ 2 premolars in good condition.

From this area a large obsidian blade nearly 5 cm long & nearly 2 cm wide was recovered. We don't have a 1/8" screen with us today, so we'll leave the dirt not yet removed in the unit to be screened tomorrow.

We covered the small area of exposed bone to be excavated tomorrow.

So far we've removed abt. 25 sherds, the blade ^{1 sm. pr. obsidian}, the bone, & 1 shell.

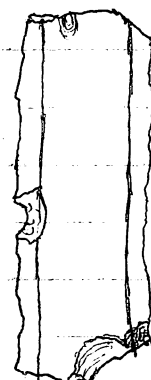
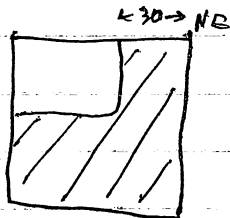

lot 414B/30 8th meter of axial trench (700-800 cm), 0-20 cm BGS.

a snake tried to crawl into the unit while Miguel was in it, possibly payment for finding the burial. 25⁺ pitite; 100 sherds.

No modern material encountered. bayfregue.

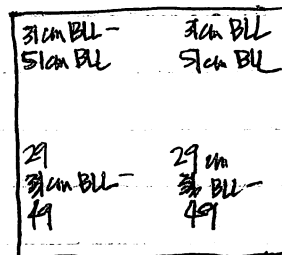

lot 414B/31 8th meter of axial trench (700-800 cm), 20-40 cm BGS.

No soil change, no evidence the soil is disturbed. 2 pcs animal bone, 125⁺ sherds; 25⁺ pitite. One very red painted rim.

lot 414B/32 6th meter of axial trench (500-600 cm), 0-20 cm BGS.

50⁺ pitite; 125⁺ sherds

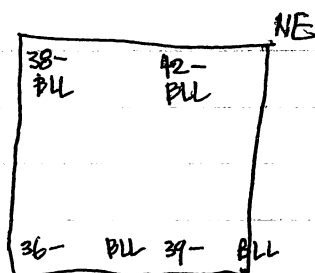

P96-102-59

414B/33 5th meter of axial trench (400-500cm), 20-46/54cm BGS.
25⁺ ps perlite, 50⁺ sherds. No soil change visible.

surface
clays:

NE 46 BLL
SE 42 BLL
SW 38 BLL
NW 46 BLL

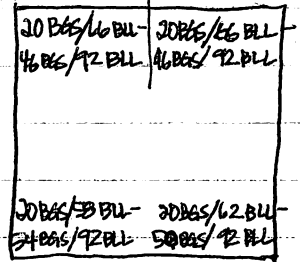

414B/34 8th meter of trench (700-800cm) 40-92cm BGS

10⁺ ps perlite, 1⁺ ps chert. 25⁺ sherds

There are a variety of rocks in this unit, with no discernable pattern. Bottom elevations are given in cm BLL.

Rocks are mostly angular & weathered - did not have a long life as a river cobble if any - limestone? quartz, one gold looking flake in SE corner

July 3, 1996 Wednesday - finishing 414B/34, starting burial

414B/35 6th meter of axial trench (500-600cm) 20cm BGS - 92cm BLL

100⁺ perlite; 100⁺ sherds

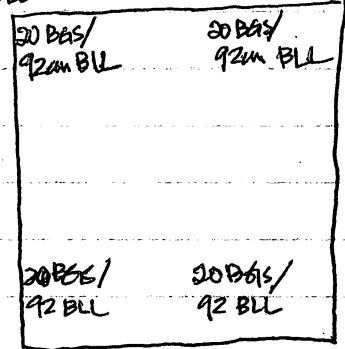
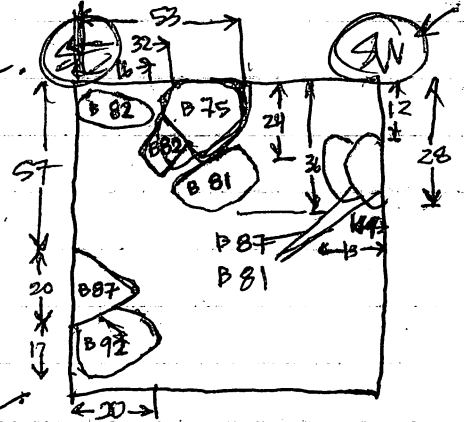

414B/36 7th meter of axial trench (600-700cm) 0-20cm
100⁺ sherds. 40⁺ perlite. Don't know if there was modern garbage

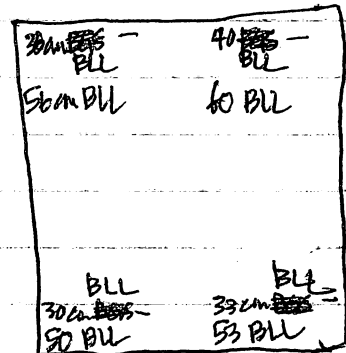

414B/37 7th meter of axial trench (600-700cm) 20-40cm BGS
75⁺ sherds. Big obs. blade

bag of 150⁺ sherds (1 of 2) turned in for bt#29, also bag of abt 6 shells, 160⁺ ps perlite & obsidian

take out
stone
in S wall

July 4, 1996 Thursday

414B/38 7th meter of axial trench (600-700cm)

40cm BGS - 92cm BLL

100+ shards; 20 pcs perlite; 1 pc dendrite

F96-102-60

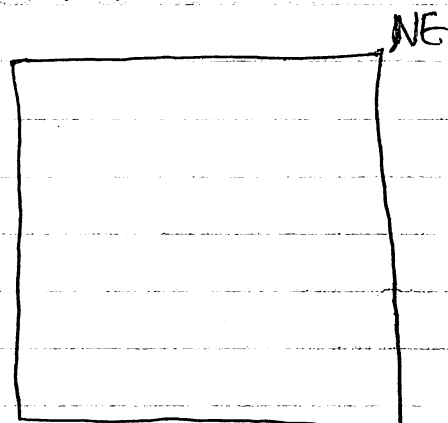

414B/39 11th meter of axial trench (1000-1100cm).

~~130-150cm BGS~~ 9 shells; 150+ shards; 20 pcs
perlite. screened w/ 1/8"

131/137 BL or 116/122 BGS to
145 BL or 130cm BGS

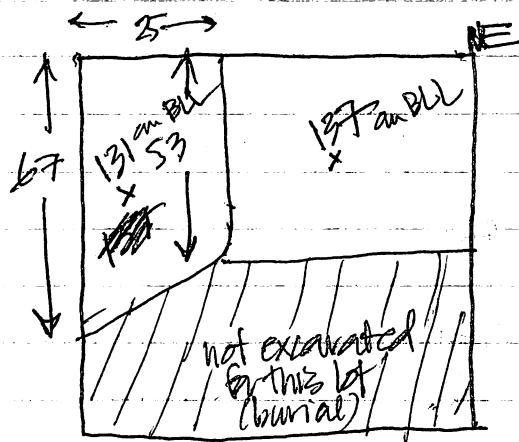

414B/40 10th meter of axial trench (900-1000cm).

130-150cm BGS. 8 shells. 5 pcs perlite. 50 shards.

The last 5cm ^{was} ~~was~~ a different soil type, with no artifacts, more compact and more orange. We consider this sterile.

Lot 414B/29 was also finished up today - the area below the burial was scraped down to 145/50 ^{BLL} or 130cm BGS. The remaining bones in Area 3, mostly ribs, were removed from the SW corner of the 11th meter. <10 pcs perlite, 1 pc chert, & 50+ shards were found. screening w/ 1/8"

The shards were put in 2 separate bags, one of the bags has 2 large shards - a black incised shard, & a black on red shard, both found in the SE quadrant of the unit, below where the vessel drawn w/ the burial was found.

An ash sample was taken from the SE corner of the unit @ 130cm BGS.

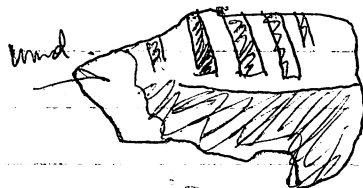

P96-102-61

Today

We screened the soil removed in the excavation of the burial yesterday w/ 1/8" screen. Soil was bagged separately ~~by~~ by area, as ^{the} bones were removed + bagged by area. ^{yesterday} the limits of these areas are shown on D96-102-07.

We found the following: Each area was assigned a new lot (7-9-96)

414B/42

Area 1

10 shards, incl. 1 red-painted rim of a plate? or shallow bowl?

1g. bowl shard
in D96-102-07

146-151 BLS

1 pc. chert or flint

126-131 BLS

9 pcs of bone, incl. a fingertip (most archaic, I think) →

h. bone excavated yesterday includes 2? feet + leg long bones

These will be included in the other Area 1 bone bag.

And some were 10+ hard concretions, oddly shaped, sometimes containing small pebbles. I'm not sure what depositional or post depositional process accounts for these

414B/43

Area 2:

60 shards

147-150 BLS

4 pcs chert, 1 pc chert



2 pcs flat schist.

127-130 BLS

2 pcs of shell

to be added to bone bag for Area 2

→ sm. bag of sm. bones, none identifiable + not necessarily all human
more concretions, some w/ bone (saved) + others w/ shell or containing nothing (not saved).

2 teeth

h. bone excavated yesterday includes significant parts of the skull, including a large number of well preserved teeth, and 2? long bones

414B/44

Area 3:

30+ small pieces of bone, to be added to yesterday's Area 3 bone bag.

141-150 BLS

5 less-than-thumb-nail sized shards (not saved)

includes 2 pcs of scapula, ribs

121-130 BLS

414B/44

rock w/ 3cm dia 1.5cm deep circular depression from S wall of 11th meter

of axial trench, 62-70 cm BLS
top bottom