Four Valleys Archive

Anthropology

2008

EPV Op. 10-14 Lot Forms 2008

Stefanie Griffin

Follow this and additional works at: <https://digital.kenyon.edu/honduras>



Part of the Archaeological Anthropology Commons

Recommended Citation

Griffin, Stefanie, "EPV Op. 10-14 Lot Forms 2008" (2008). *Four Valleys Archive*. Paper 96711.
<https://digital.kenyon.edu/honduras/96711>

This Lot Card is brought to you for free and open access by the Anthropology at Digital Kenyon: Research, Scholarship, and Creative Exchange. It has been accepted for inclusion in Four Valleys Archive by an authorized administrator of Digital Kenyon: Research, Scholarship, and Creative Exchange. For more information, please contact noltj@kenyon.edu.

PAREP 2008 LOT FORM

Excavator 38

Date 19 June 2008

Op/SubOp/Lot: 10/14/001

Ex. Unit A

Size (NxEx) 1x1m

Site: SS 07 (Los Naranjos)

Str #13

Initial Lot? yes

Prev. lot —

Next lot 002

BGS: 0-10cm

Initial elev.: NW 996.94 NE 996.99 SW 997.11 SE 997.10

Final elev.: NW 996.79 NE 996.84 SW 996.98 SE 996.96

Reference corner: 997.11

N 4.96

E -200.69

Deposit / Type overburden

Humus

Soil type Loamy clay

Munsell/Color Dark brown w/grey tint

Drawings —

Contents 1 chert, 2 obsidian, 5 potsherds

Photo/Digital —

59 Bajareque, 1 polished rock

Description/Sketch (with measurements):

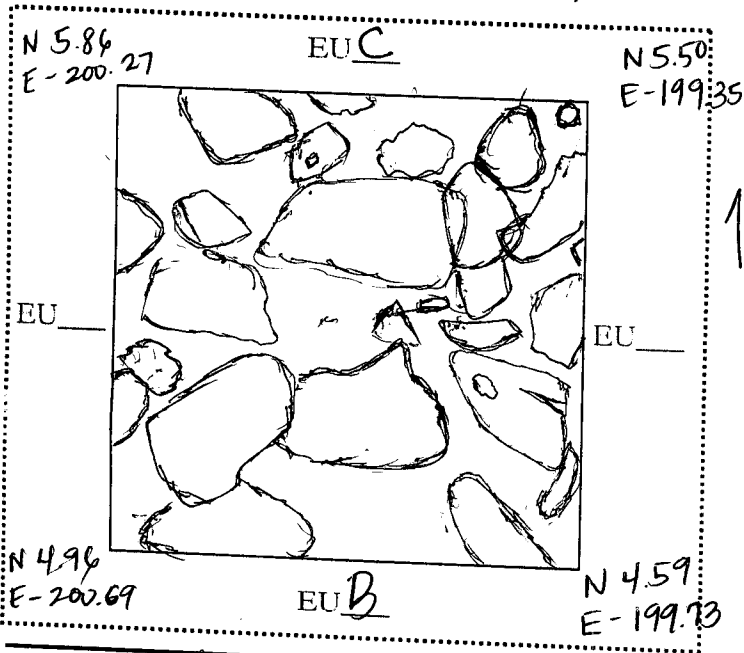

The purpose of the pit was to determine where north wall of structure 13.

This unit contains lots of tumble, bajareque and other things that are listed in the contents. Tumble indicates that a wall is in front of this unit, or in the center of this unit.

Excavation Unit A is located north of Excavation unit B of structure 13.

Note refs 2008-38-03

PAREP 2008 LOT FORM

Excavator 38

Date 20 June 2008

Op/SubOp/Lot: 10/14/002

Ex. Unit A

Size (NxEx) 1x2m

Site: SS-07

Str #13

Initial Lot? no

Prev. lot 001

Next lot 003

BGS: 20-30cm

Initial elev.: NW 996.79 NE 996.84 SW 996.80 SE 996.76

Final elev.: NW 996.86 NE 996.86 SW 996.80 SE 996.76

Reference corner: 998.90 (EVA SE corner) N 4.59 E -199.73

Deposit / Type overburden

tumble

Soil type Loamy clay

Munsell/Color Dark brown w/grey tint

Drawings _____

Contents 14 Bajareque, 2 Pot shards (ceramic)

Photo/Digital _____

Description/Sketch (with measurements):

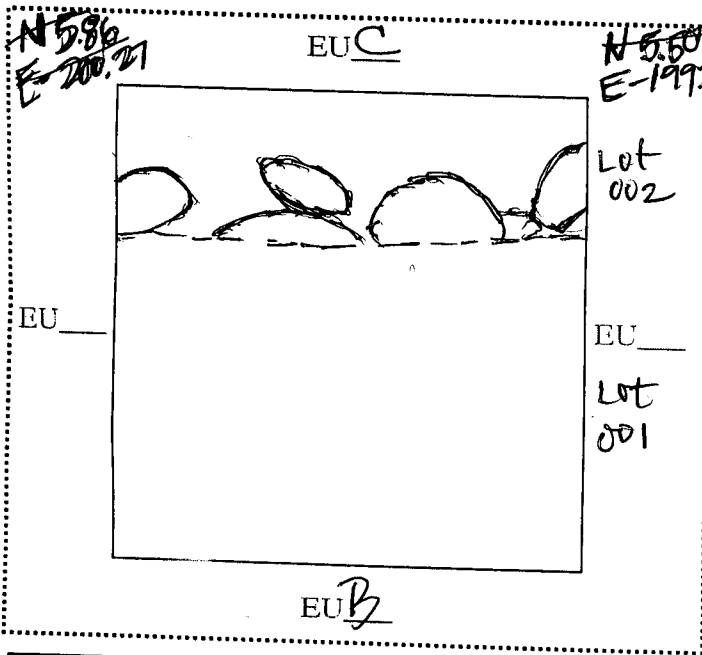

This lot is 30cm north of Lot 001. It is the front portion of excavation unit A.

30 cm south of NW corner

25cm south of NE corner

This lot was excavated in order to see if a wall was there. The unit was mainly tumble with few bajareque and pot shards.

N refs 2008-38-06 (refer to 2008-38-23 for cm measurements)

PAREP 2008 LOT FORM

Excavator 38

Date 20 June 2008

Op/SubOp/Lot: 10/14/003

Ex. Unit C

Size (NxEx) 1x1m

Site: SS-07

Str #13

Initial Lot? no

Prev. lot 002

Next lot 004

BGS: 0-20cm

Initial elev.: NW 996.76 NE 996.80 SW 996.94 SE 996.99

Final elev.: NW 996.80 NE 996.83 SW 996.73 SE 996.68

Reference corner: 997.10 EU-A (SE corner) N 4.59 E -199.73

Deposit / Type overburden / tumble

Soil type Loamy clay Munsell/Color Dark brown w/gruytint

Drawings _____ Contents 39 bajareque, 5 potsherds

Photo/Digital _____

Description/Sketch (with measurements):

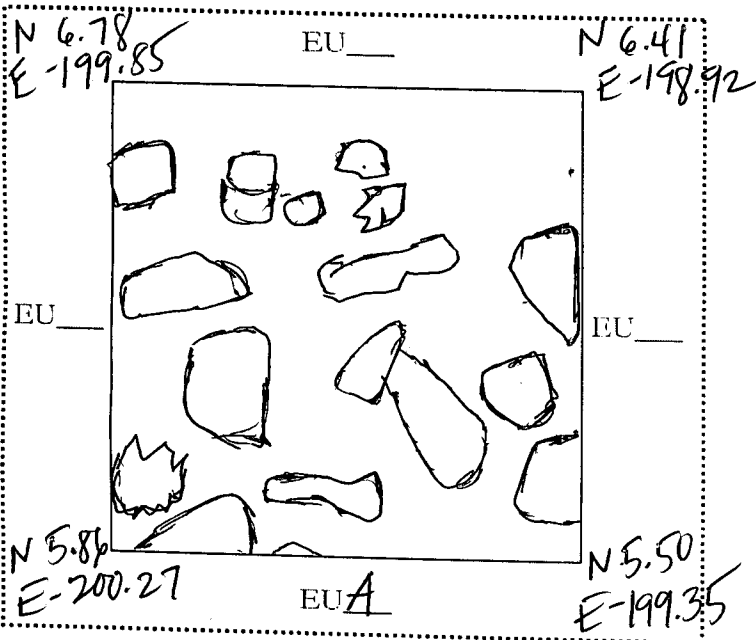

N ↑

This pit is located north of Excavation Unit A. It contains tumble and this Unit was added to sub op 14 so that the possible wall could be seen once it is found

* see notes for sketch of lot 003

Note refs 2008-38-06 and 2008-38-07* (refer to 2008-38-23 for CM measurements)

PAREP 2008 LOT FORM

Excavator 38

Date 20 June 2008

Op/SubOp/Lot: 10/14/004

Ex. Unit C

Size (NxEx) 1x1m

Site: SS-07

Str #13

Initial Lot? no Prev. lot 003 Next lot 005 BGS: 20-40cm

Initial elev.: NW (996.80) NE 996.83 SW 996.73 SE 996.68

Final elev.: NW 996.49 NE 996.56 SW 996.62 SE 996.77

Reference corner: 996.90 EVA N 4.59 E -199.73
(SE Corner)

Deposit / Type overburden / tumble

Soil type Loamy clay Munsell/Color Dark brown w/grey tint

Drawings _____ Contents 2 chert, 2 groundstone, 2 Obsidian

Photo/Digital _____ 79 Bayareque, 14 Potsherds

Description/Sketch (with measurements):

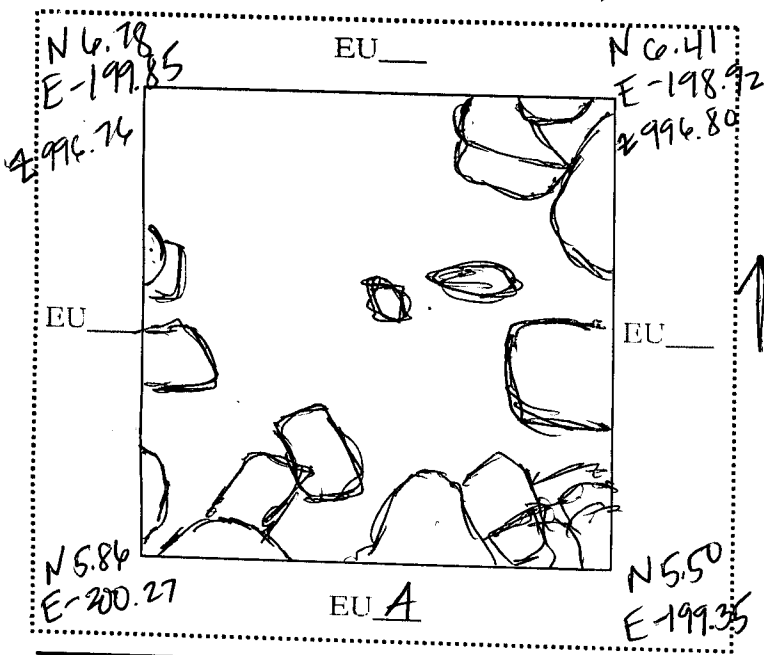

This lot is located EU-C. It contains lots of tumble, however most of it was removed. Wall is still quite ^{not} visible to determine. Further work will continue at this unit.

*also see notes for sketch of lot 004

Note refs 2008-38-01 and 2008-38-08 (refer to 2008-38-23 for cm measurements)

2008

PAREP 2008 LOT FORM

Excavator 38

Date 21 June 2008

Op/SubOp/Lot: 10/14/005

Ex. Unit C

Size (NxEx) 1 x 1 m

Site: SS-07

Str #13

Initial Lot? no Prev. lot 004 Next lot 006 BGS: Cleaning Lot 9

Initial elev.: NW 996.49 NE 996.56 SW 996.62 SE 996.77

Final elev.: NW 996.48 NE 996.48 SW 996.39 SE 996.75

Reference corner: 997.10 EUA (SE corner) N 4.59 E -199.73

Deposit / Type Overburden / tumble

Soil type clay loam Munsell/Color DARK brown w/grey tint

Drawings _____ Contents 5 obsidian, 4 chert, 22 bayareque
Photo/Digital _____ 92 pot shards, 1 serpentine stone,
1 metal fragment

Description/Sketch (with measurements):

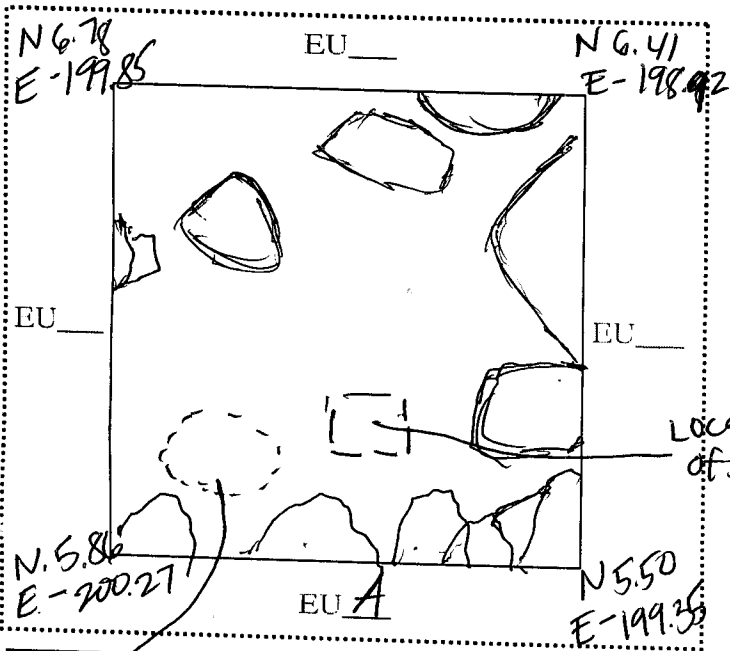

Lot 005 is now a cleaning.
 Lot. Smashed pot of some kind has been found 65 cm deep into the lot. And a serpentine stone has been clear the pottery between the SW and SE corners. A portion of the NW corner of EU-A has been dug into to see possible wall.
 *see notes for better sketch of lot 005

Note refs 2008-38-08 and 2008-38-09 (refer to 2008-38-23 for cm measurements)

Location of Smashed Pottery

PAREP 2007 LOT FORM

Excavator 38

Date 21 June 2008

Op/SubOp/Lot: 10/14/006

Ex. Unit C

Size (NxEx) 1x1m

Site: SS-07

Str B

Initial Lot? 10

Prev. lot 006

Next lot 007

BGS: 40-60

Initial elev.: NW 996.48 NE 996.48 SW 996.39 SE 996.75

Final elev.: NW 996.40 NE 996.39 SW 996.38 SE 996.39

Reference corner: 997.10 (EU-A SE Corner) N 4.59 E -199.73

Deposit / Type over burden

collapse (tumbles)

Soil type clay loam

Munsell/Color Dark brown w/grey tint

Drawings _____

Contents 2 obsidian, 1 chert, 1 metate fragment to bajareque, 69 potshards

Photo/Digital _____

Description/Sketch (with measurements):

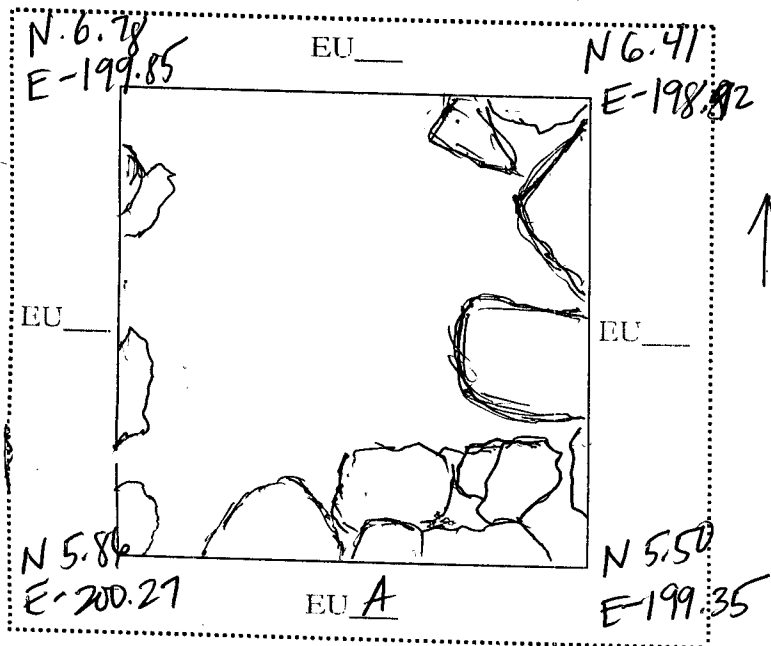

Lot 006 contains stones and rocks that will be removed clay loam dirt near the NE/SE corners. Primarily occupy this lot.

Note refs 2008-38-10

(refer to 2008-38-23 for cm measurements)

Op/SubOp/Lot: 10/14/007

Ex. Unit C

Size (NxEx) 1 x 1 m

Site: SS-07

Str 13

Initial Lot? no

Prev. lot 006

Next lot 008

BGS: _____

Initial elev.: NW 996.40 NE 996.39 SW 996.38 SE 996.39

Final elev.: NW 996.23 NE 996.21 SW 996.24 SE 996.25

Reference corner: 997.10 EU-A (SE corner) N 4.59 E -199.73

Deposit / Type Overburden / Collapse (tumble)

Soil type Clay loam Munsell/Color Dark brown w/grey tint

Drawings _____ Contents 114 potsherds 6 chert 4 hyperaque

Photo/Digital _____ 7 obsidian 1 bag full smashed potsherds
Carbon pieces

Description/Sketch (with measurements):

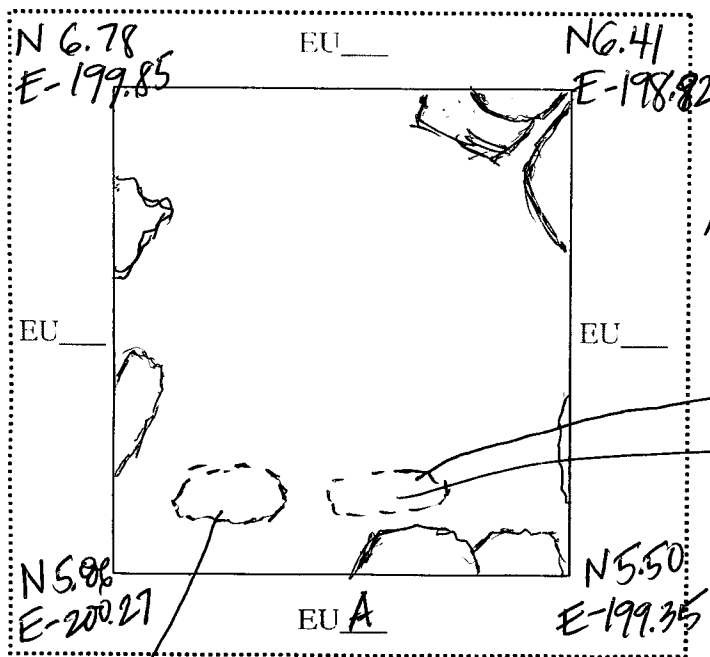

This lot is north of EU A in EU-C. It contains pottery and carbon found near the south side of EU-C. A smashed pot was found but could not be photographed because it is poorly preserved. A huge piece of chert was found as well.

Note refs 2008-38-11 (refer to 2008-38-23 for cm measurements)

Location of badly preserved smashed pot.

Op/SubOp/Lot: 10/14/008

Ex. Unit A

Size (NxEx) 1x1

Site: SS-07

Str #13

Initial Lot? no

Prev. lot 007

Next lot 009

BGS: 20-60cm cleaning lot

Initial elev.: NW 996.76 NE 996.85 SW 996.80 SE 996.76

Final elev.: NW 996.26 NE 996.25 SW 996.29 SE 996.40

Reference corner: 997.10 EVA (SE corner) N 4.59 E -199.73

Deposit / Type Overburden / collapse (tumble)

Soil type Clay loam Munsell/Color Dark brown w/ grey tint

Drawings _____

Contents 62 pot sherds, 2 bajareque, 1 toba, 1 interesting rock

Photo/Digital _____

Description/Sketch (with measurements):

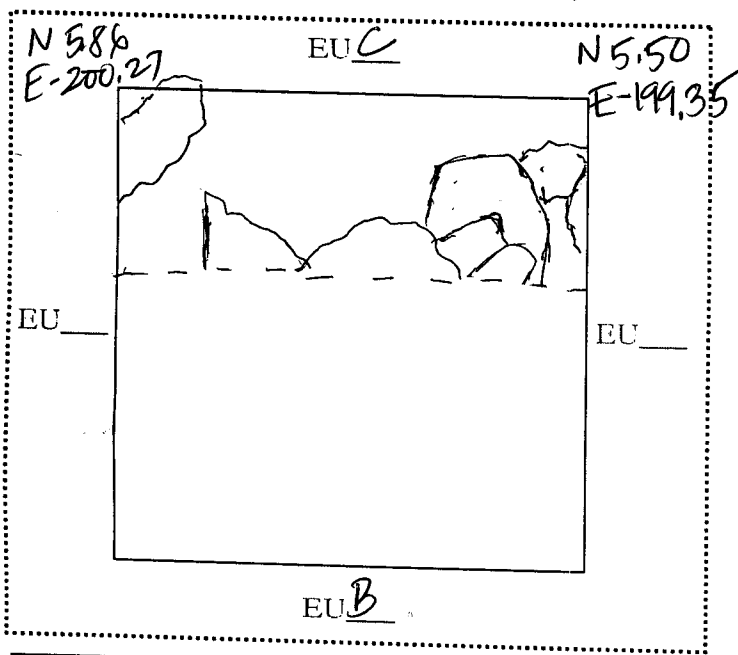

20-60cm of this lot is being excavated in EVA. It is a cleaning lot that is in the center of subop 14. EUC is north of it, and EUB is south of it. Only the north portion of the unit is being excavated. 30cm south of NW corner 25cm south of NE corner.

Note refs 2008-38-12 (refer to 2008-38-24 for cm measurements)

Op/SubOp/Lot: 10/14/009

Ex. Unit A

Size (N x E) 1 x 1 m

S-007

Str #13

Initial Lot no

Prev. lot 008

Next lot 010

BGS: 10-20 cm

Initial elev: NW 996.79 NE 996.84 SW 996.99 SE 996.96

Final elev: NW 996.78 NE 996.80 SW 996.80 SE 996.79

Reference corner: 997.10 EU-A (SE corner) N 4.59 E -199.73

Deposit / Type Architectural / collapse (tumble)

Soil type clay loam Munsell/Color Dark brown w/ yellow tint

Drawings _____

Contents 23 bajareque, 3 potsherds

Photo/Digital _____

Description/Sketch (with measurements):

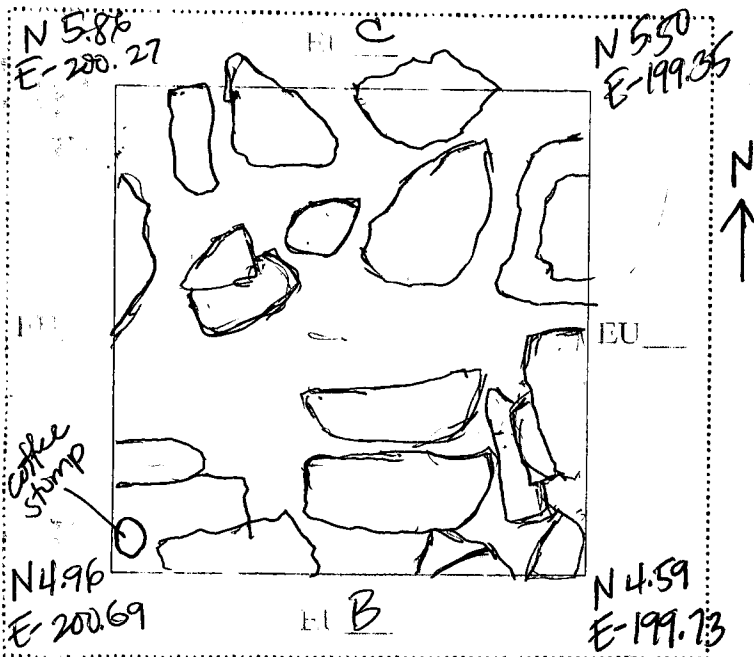

This unit which is in the center of subop 14, which has EU-C north of it and EU-B south of it. It has been excavated 10-20cm. The soil color has changed from brownish grey to brownish yellow.

FAREP 2008 LOT FORM

Excavator 38

Date 24/June 2008

Op/SubOp/Lot: 10/14/010

Ex. Unit B

Size (NxF) 1x1

Site S-007

Str 13

Initial Lot: 170

Prev. lot 009

Next lot 011

BCS: 0-10cm

Initial elev: NW 997.11 NE 997.10 SW 997.25 SE 997.23

Final elev: NW 997.03 NE 997.04 SW 997.12 SE 997.15

Reference corner: 997.25 ^{EU-B} (SW corner) N 4.04 E -201.01

Deposit type Overburden / collapse (tumble) fill

Soil type loamy clay Munsell/Color Dark brown w/gray tint

Drawings _____ Contents 12 bajareque, 2 Potsherds

Photo/Digital _____

Description/Sketch (with measurements):

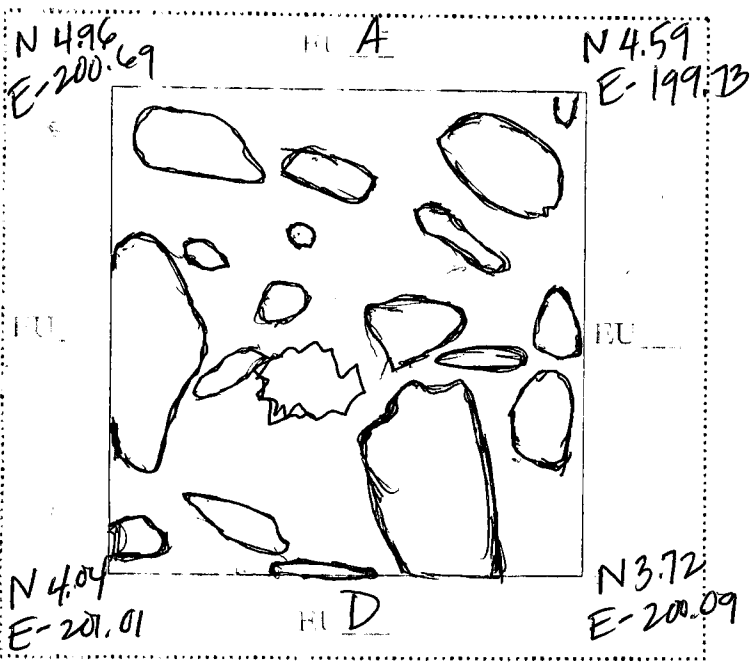

This unit is located south of EU-C and EU-A. Only 10cm have been excavated in this lot. It mainly contains lots of tumble and few artifacts. A new reference corner will be used, which is the SW corner of EU-B.

Note refs 2008-38-15 (refer to 2008-38-24 for CM measurements)

Op/SubOp/Lot: 10/14/011

Ex. Unit B

Size (N x E) 1 x 1

5-007

Str 13

Batch/Lot: 70

Prev. lot 010

Next lot 012

BGS: 10-20 cm

Initial elev: NW 997.03 NE 997.04 SW 997.12 SE 997.15

Final elev: NW 996.91 NE 996.99 SW 996.98 SE 996.99

Reference corner: 997.25 EU-B (SW corner) N 4.04 E -201.01

Deposit Type: Overburden / Collapse (tumble)

Soil type: clay loam Munsell/Color: Dark brown w/grey tint

Drawings: _____ Contents: 13 potsherds, 1 chert, 1 obsidian, 9 bajareque

Photo/Digital: _____

Description/Sketch (with measurements):

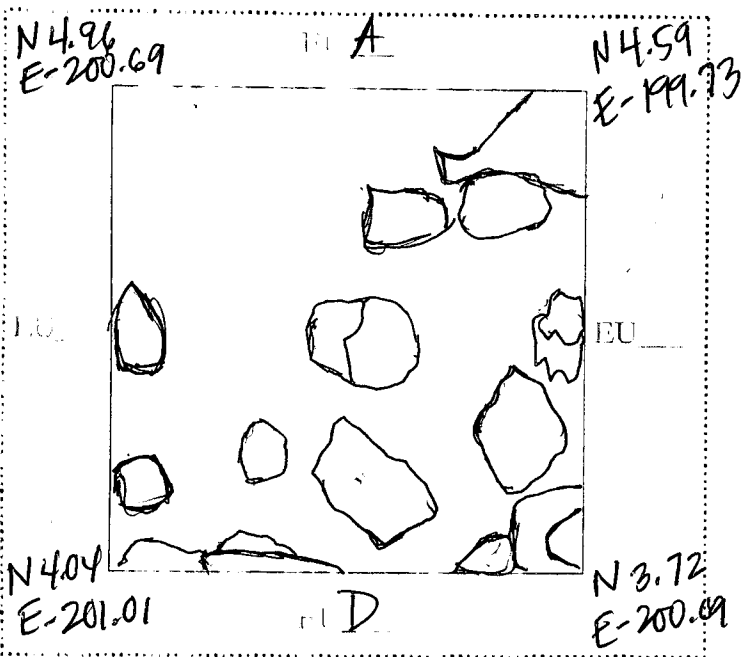

This lot has been excavated 10-20cm deep. It is south of EU-A and EU-C. This lot has been cleared in order to see if a wall present. So far it is not there.

Refs: 2008-38-15 (refer to 2008-38-24 for cm measurements)

Op/SubOp/Lot: 10/14/D12
U-007

Ex Unit A
Str 13

Size (N x E) 1 x 1

Initial Lot no Prev. lot 011 Next lot 013 BGS: 20-40cm

Initial elev: NW 996.83 NE 996.80 SW 996.80 SE 996.79

Final elev: NW 996.27 NE 996.28 SW 996.52 SE 996.51

Reference corner 997.10 EU-A (SE corner) N 4.59 E -199.73

Deposit Type Architectural/Fill / collapse (tumble)

Soil type Clay Loam Munsell/Color Dark brown w/gray tint

Drawings _____ Contents 1 obsidian, 108 potsherds, 1 chert,

Photo/Digital _____ 11 bayareque

Description/Sketch (with measurements):

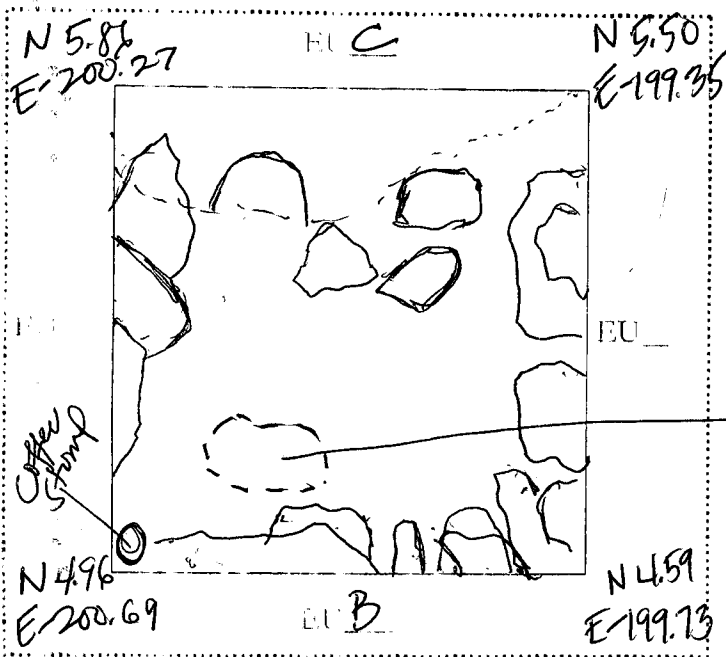

This lot is located in EU-A which is north of EU-B and south of EU-C. A potsmash was found in the SW corner along with carbon. It was excavated 20-40cm and it contained lots of potsherd.

Location of Smashed Pot
39.5cm

Op/SubOp/Lot: 10/14/013

Ex. Unit A

Size (NxH) 1x1

Site: S-007

Str 13

Initial Lot? 110

Prev. lot 012

Next lot 014

BGS: 40-60cm

Initial elev.: NW 996.27 NE 996.28 SW 996.52 SE 996.51

Final elev.: NW 996.26 NE 996.29 SW 996.31 SE 996.28

Reference corner: 997.10 EU-A (SE corner) N 4.59 E -199.73

Deposit / Type Architectural / collapse (tumble) / Fill

Soil type Clay loam Munsell/Color Dark brown w/gray tint

Drawings _____

Contents 3 Obsidian, 178 potsherds, 6 bayareque

Photo/Digital _____

Description/Sketch (with measurements):

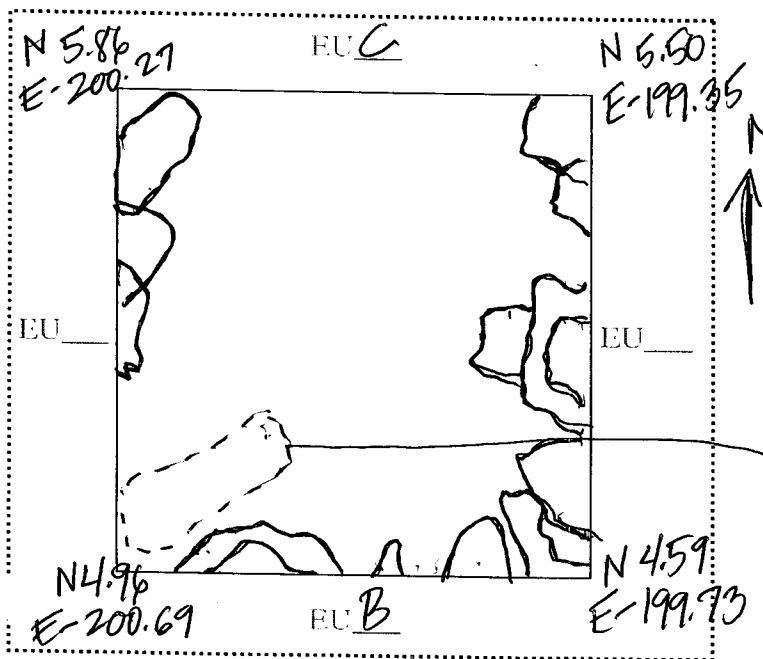

This lot is the final lot for the Excavation unit. It is located south of EU-C and north of EU-B. A Pot smash was found in the SW corner 64cm deep in EU-A. All that remains of this unit is rocks on the east, west, and south walls.

→ Location of pot smash.

Site refs 2008-38-17 (refer to 2008-38-24 for cm measurements)

Op/SubOp/Lot: 10/14/014

Ex. Unit B

Size (NxI) 1x1

Site: S 007

Str 13

Initial Lot? _____

Prev. lot 013

Next lot 015

BGS: 60-90cm

Initial elev.: NW 996.82 NE 996.83 SW 996.87 SE 996.82

Final elev.: NW 996.35 NE 996.30 SW 996.33 SE 996.32

Reference corner: 997.25 ^{EU-B} (SW corner) 4.04 N 4.04 E -201.01

Deposit / Type Architectural / Collapse/Fill

Soil type clay loam Munsell/Color Dark brown w/grey tint

Drawings _____

Contents 160 potsherds, 4 obsidian, 8 chert
2 pieces of bone

Photo/Digital _____

Description/Sketch (with measurements):

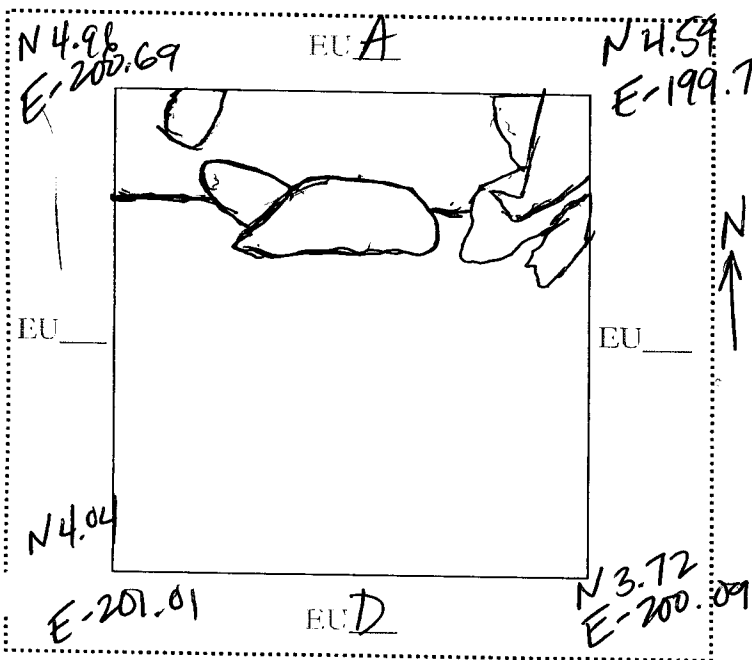

* Lot 14 is 24cm south of EU-B's NW and NE corners. This small lot is south of EU-A and EU-C. It was excavated in order to see if a wall was there. It was excavated from 60-90cm and contains potsherds and a few other artifacts which were under lots of collapse/fill.

Note refs 2008-38-17 and 2008-38-18 (refer to 2008-38-24 for cm measurements)

Op/SubOp/Lot: 10/14/015

Ex. Unit B

Size (NxE) 1x1

Site: S-007

Str 13

Initial Lot? _____ Prev. lot 014 Next lot 016 BGS: 20-60cm

Initial elev.: NW 996.91 NE 996.99 SW 996.98 SE 996.99

Final elev.: NW 996.60 NE 996.61 SW 996.62 SE 996.63

Reference corner: 997.25 ^{EU-B} (sw corner) N 4.04 E -201.01



Deposit / Type Architectural / collapse / fill

Soil type Clay loam Munsell/Color Dark Brown w/gray tint

Drawings _____ Contents 24 pot sherds, 1 obsidian, 3 bayareque
Photo/Digital _____

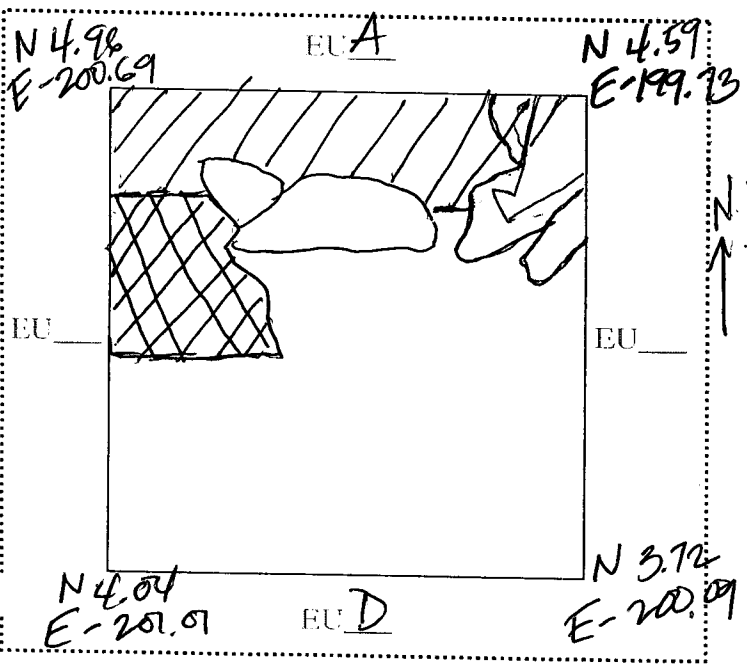
Description/Sketch (with measurements):



 - Lot 014 of EU-B
 24 cm north of Lot 015
 - Lot 015 of EU-B
 This lot is located on the west portion of EU-B. EU-B is south of EU-A. It was excavated 20-60 cm. It is 26 cm south of Lot 14 and north of the second portion of EU-B.

Site refs 2008-38-18 (refer to 2008-38-25 for cm measurements)

Op/SubOp/Lot: 10/14/014

Ex. Unit B

Size (N x E) 1 x 1

Site: S-007

Str 13

Initial Lot? NO

Prev. lot 015

Next lot 017

BGS: 20-60cm

Initial elev.: NW 996.91 NE 996.99 SW 996.98 SE 996.99

Final elev.: NW 996.65 NE 996.85 SW 996.67 SE 996.89

Reference corner: 997.25 (EU-B SW corner) N 4.04 E -201.01

Deposit / Type Architectural / collapse / fill

Soil type clay loam Munsell/Color Dark brown w/ grey tint





Drawings _____

Contents 2 obsidian, 32 pot sherds, 3 bayareque, 1 chert

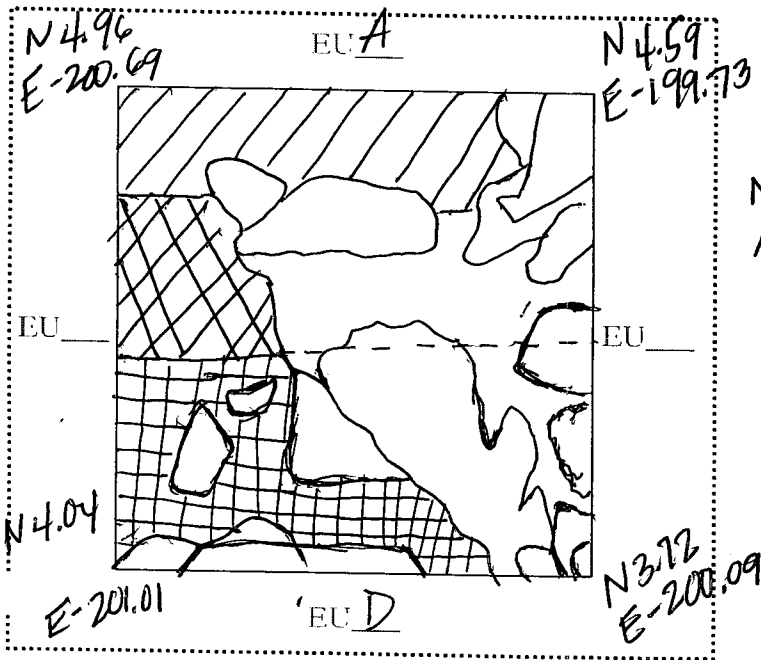
Photo/Digital _____

Description/Sketch (with measurements):



-  LOT 14
-  LOT 15
-  LOT 16 excavated stratigraphy 20-60cm (left side of unit)
-  LOT 16 excavated (right side of unit) 20-30cm due to the tumble located on this side.

This lot is located in the southern half of EU-B. It has been excavated 20-60cm so that the previous can be seen to compare.

ote refs 2008-38-20 (refer to 2008-38-25 for CM measurements)

Op/SubOp/Lot: 10/14/017

Ex. Unit D

Size (N x I) .5 x 1

Site: S-007

Str 13

Initial Lot? no Prev. lot 016 Next lot 018 BGS: 0-20cm

Initial elev.: NW 997.25 NE 997.23 SW 997.25 SE 997.22

Final elev.: NW 997.02 NE 997.06 SW 997.07 SE 997.05

Reference corner: 997.25 (sw corner EUD) N 3.51 E -201.21

Deposit / Type Overburden / tumble

Soil type Loamy clay. Munsell/Color Dark brown w/gray tint

Drawings _____ Contents 2 chert, 17 bayareque, 7 pot sherds
Photo/Digital _____ serpentine stone, 1 interesting green looking stone.

Description/Sketch (with measurements):

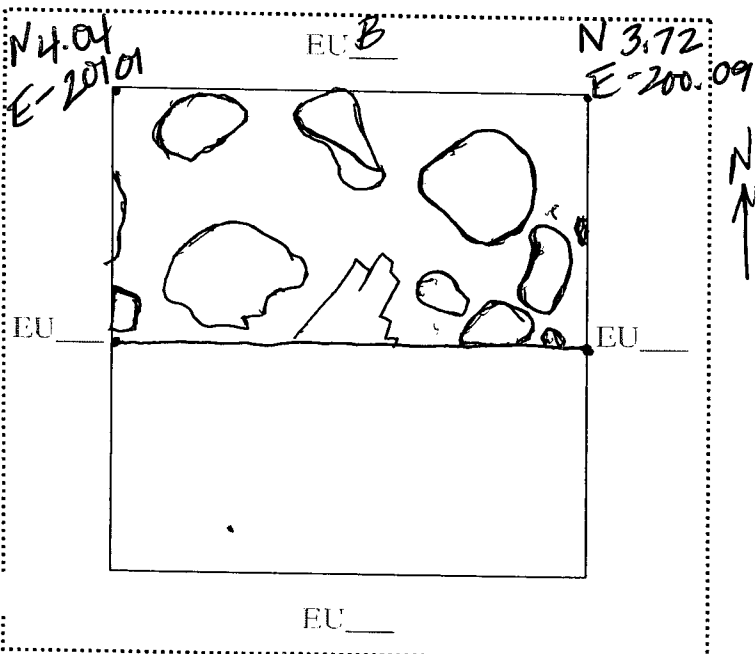

This unit was added to subop 14 as a means to see what was located at the top of the structure. This unit is south of EU C, A, and B. HG size .5 x 1 and in this lot it is being excavated 0-20cm.

Note refs 2008-38-20 (refer to 2008-38-25 for cm measurements)

Op/SubOp/Lot: 10/14/018

Ex. Unit D

Size (NxF) .5x1

Site: S-007

Str 13

Initial Lot? no

Prev. lot 017

Next lot 019

BGS: 20-60cm

Initial elev.: NW 997.02 NE 997.06 SW 997.07 SE 997.05

Final elev.: NW 996.47 NE 996.49 SW 996.64 SE 996.65

Reference corner: 997.26 (SW corner) EUD N 3.51 E -201.21

Deposit / Type Architectural / collapse / wall

Soil type clay loam Munsell/Color Dark brown w/gray tint

Drawings _____

Contents 4 chert, 1 animal tooth, 118 potsherds, 11 bayareque, 1 obsidian, 2 toba

Photo/Digital _____

Description/Sketch (with measurements):

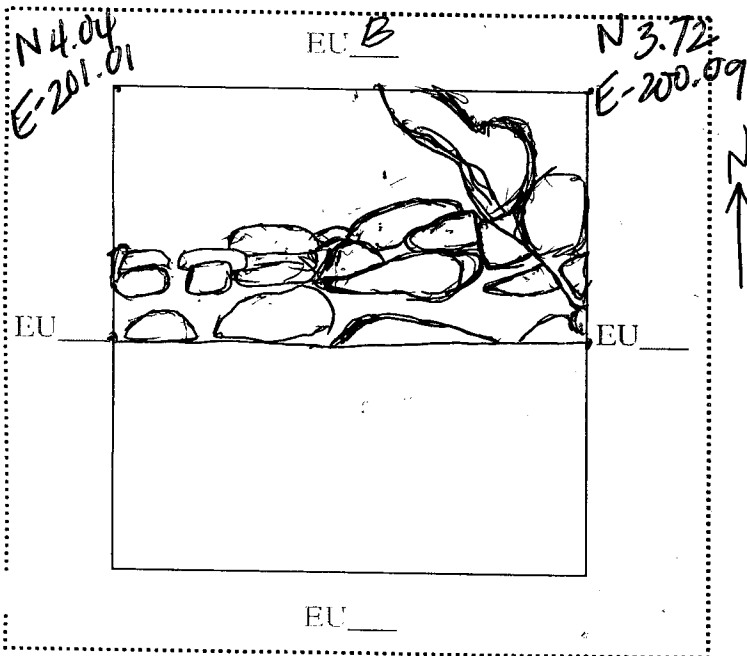

This lot is located in EUD, which is south of EU-CA, B. It has been excavated 20-60cm. The wall was found in this lot along with other artifacts.

ote refs 2008-38-20 and 2008-38-21 (refer to 2008-38-25 for cm) measurements

AREP 2008 LOT FORM

Excavator 38

Date 27 June 2008

Op/SubOp/Lot: 10/14/19

Ex. Unit B

Size (NxF) 1x1

Site: S-007

Str 13

Initial Lot? no Prev. lot 018 Next lot 20 BGS: 20-60cm

Initial elev.: NW 996.91 NE 996.99 SW 996.98 SE 996.99

Final elev.: NW 996.60 NE 996.52 SW 996.55 SE 996.49

Reference corner: 997.25 EU-B (SW corner) N 4.04 E -201.01

Deposit / Type Architectural / collapse/fill

Soil type clay loam Munsell/Color Dark brown w/ grey tint

Drawings _____

Contents 31 pot sherds, 2 obsidian, 3 chert
2 byzantine

Photo/Digital _____

Description/Sketch (with measurements):

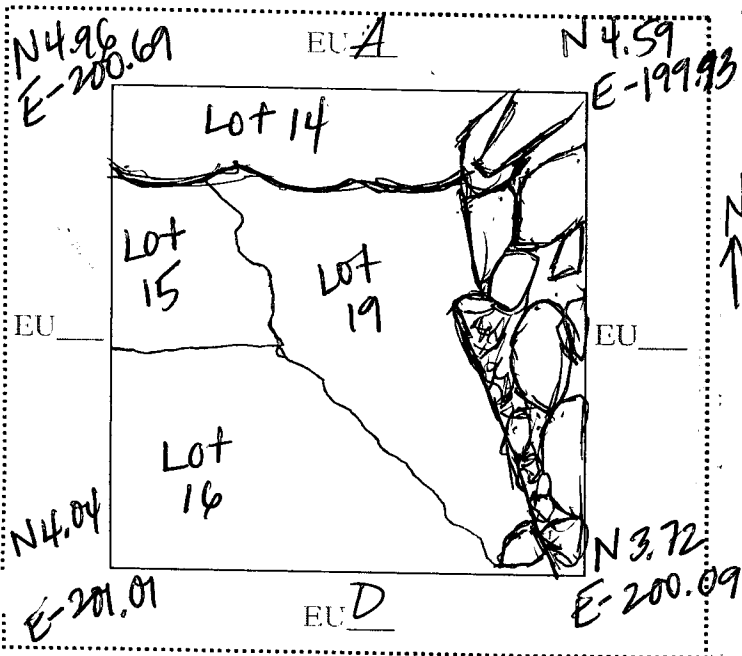

This lot is located in EU-B which is south of EU-C and EU-A and north of EU-D. It was excavated 20-60cm and is east of lots 15 and 16. In this lot the rocks that were there were removed and dirt was leveled to 60cm. In this way it is at the same level as Lot 15 and Lot 16.

Site refs 2008-38-21 (refer to 2008-38-25 for cm measurements)

Op/SubOp/Lot: 10/14/20

Ex. Unit B

Size (NxL) 1x1 m

Site: S-007

Str 13

Initial Lot? _____ Prev. lot 19 Next lot — BGS: 60-90 cm

Initial elev.: NW 996.60 NE 996.52 SW 996.55 SE 996.49

Final elev.: NW 996.35 NE 996.35 SW 996.36 SE 996.34

Reference corner: 997.25 ^{EU-B} (SW corner) N 4.04 E -201.01

Deposit / Type Architectural / wall

Soil type Clay Loam Munsell/Color Dark brown w/grey tint

Drawings _____ Contents 338 potsherds, 6 obsidian, 5 chert, carbon, 5 bayareque, 1 metal fragment, 1 groundstone
Photo/Digital _____

Description/Sketch (with measurements):

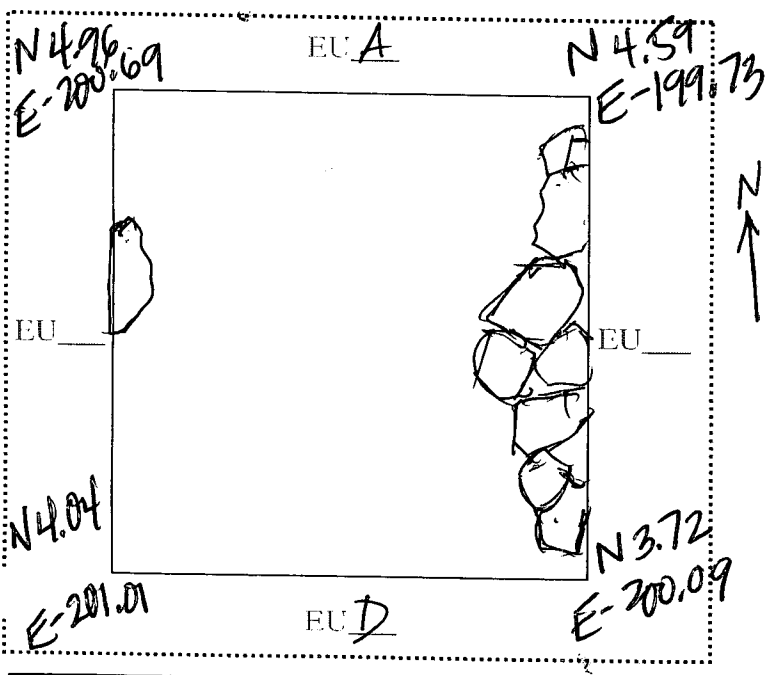

This lot is located in EU-B which is south of EU-C, A, and north of EU-D. Two potsherds have been found at 77.5 cm with carbon, and 91 cm. This lot was excavated 60-90 cm so that the base of the wall could be seen.

Note refs 2008-38-21 and 2008-38-22 (refer to 2008-38-25 for cm measurements)