

2008

## EPV Op. 10-18 Lot Forms 2008

Mary Hostenske

Follow this and additional works at: <https://digital.kenyon.edu/honduras>



Part of the Archaeological Anthropology Commons

---

### Recommended Citation

Hostenske, Mary, "EPV Op. 10-18 Lot Forms 2008" (2008). *Four Valleys Archive*. Paper 96715.  
<https://digital.kenyon.edu/honduras/96715>

This Lot Card is brought to you for free and open access by the Anthropology at Digital Kenyon: Research, Scholarship, and Creative Exchange. It has been accepted for inclusion in Four Valleys Archive by an authorized administrator of Digital Kenyon: Research, Scholarship, and Creative Exchange. For more information, please contact [noltj@kenyon.edu](mailto:noltj@kenyon.edu).

Op/SubOp/Lot: 10/18/01 Ex. Unit A Size (NxEx) 1x1Site: Los Naranjitos (S-007) Str 10Initial Lot? yes Prev. lot 6.46 Next lot 2 BGS: 0-97cmInitial elev.: NW 99 NE 996.75 SW 996.52 SE 996.77Final elev.: NW 996.17 NE 996.25 SW 996.21 SE 996.21Reference corner: NW N 25.45 E -212.52Deposit / Type architectural / collapseSoil type clayey loam Munsell/Color 7.5YR 3/2Drawings ✓Contents 39 ceramicsPhoto/Digital ✓1 obsidians  
1 bajareque

## Description/Sketch (with measurements):

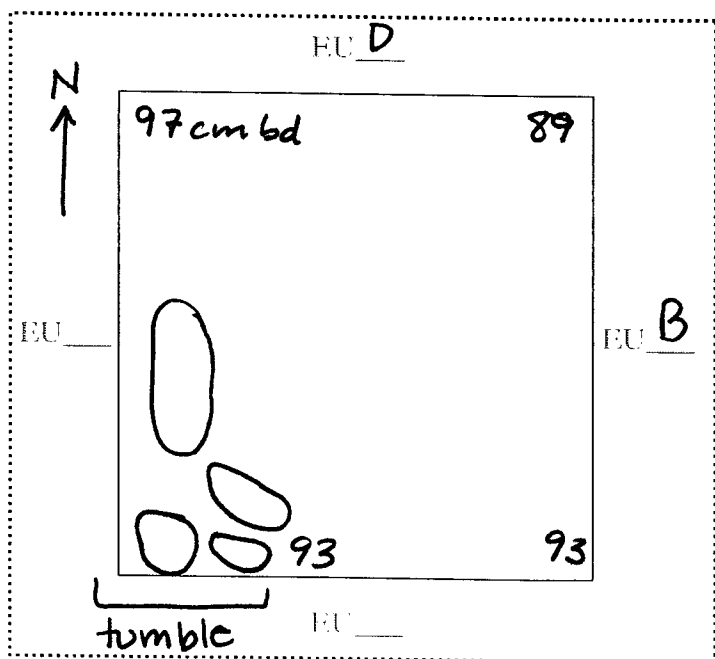

The purpose of this lot is to establish the stratigraphy associated with Str. 10 and to look for the western wall of the structure.

\*Datum located at SE corner of EU B.

Note refs 9

## PAREP 2008 LOT FORM

Excavator 17Date 23 June 2008Op/SubOp/Lot: 10/18/02 Ex. Unit A Size (NxEx) 1x1Site: Las Naranjitas (S-007) Str 10Initial Lot? no Prev. lot 1 Next lot 3 BGS: 97-117cmInitial elev.: NW 996.17 NE 996.25 SW 996.21 SE 996.21Final elev.: NW 995.97 NE 996.12 SW 996.02 SE 996.09Reference corner: NW N 26.37 E -212.89Deposit / Type architectural / lumberSoil type clayey loam Munsell/Color 7.5 YR 3/2Drawings ✓ Contents 53 ceramicaPhoto/Digital ✓ 1 peridernal2 obsidiana2 bajareque

## Description/Sketch (with measurements):

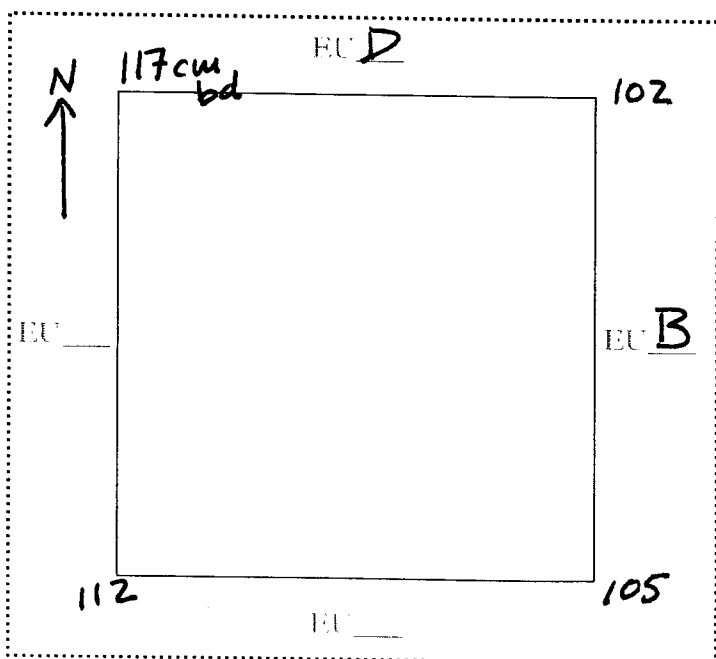

The purpose of this lot is to establish the stratigraphy associated with the back of Str. 10.

\*Datum measured from the SE corner of EU B.

Note refs 14

## PAREP 2008 LOT FORM

Excavator 17Date 23 June 2008Op/SubOp/Lot: 10/18/03Ex. Unit ASize (NxEx) 1x1Site: Los Naranjitos (S-007)Str 10Initial Lot? noPrev. lot 2Next lot -BGS: 97-117Initial elev.: NW 996.17 NE 996.25 SW 996.21 SE 996.21Final elev.: NW 995.97 NE 995.98 SW 996.02 SE 996.09Reference corner: NE N 26.67 E -211.96Deposit / Type overburden / sedimentSoil type silty clay Munsell/Color 2.5 Y 4/3Drawings ✓Contents nonePhoto/Digital ✓

## Description/Sketch (with measurements):

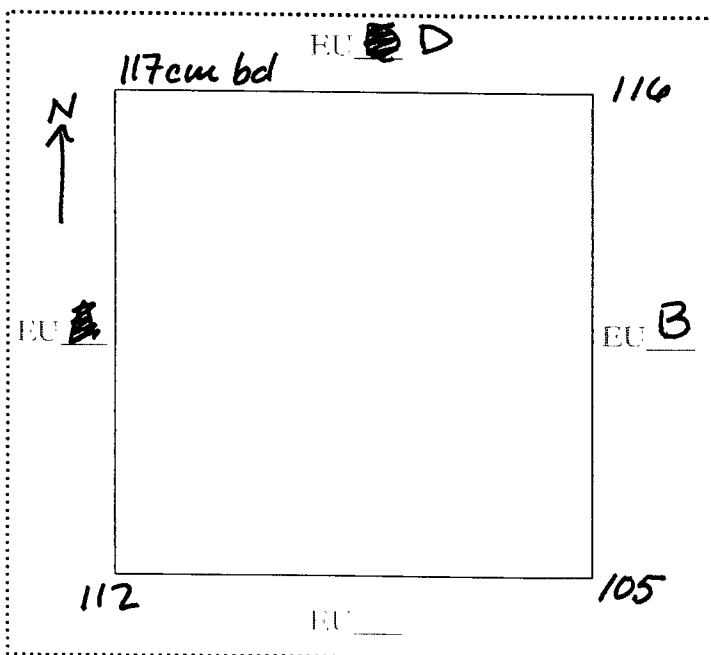

The purpose of this lot is to establish the stratigraphy associated with Str. 10.

\*Datum measured from SE corner of EU B.

Note refs 14

Op/SubOp/Lot: 10/18/04 Ex. Unit B Size (NxEx) 1x1Site: Los Naranjitos (5007) Str 10Initial Lot? yes Prev. lot - Next lot 5 BGS: 0-70cmInitial elev.: NW 996.78 NE 997.09 SW 996.77 SE 997.14Final elev.: NW 996.49 NE 996.56 SW 996.46 SE 996.46Reference corner: SW N 25.82 E -211.66Deposit / Type architecture / tumbleSoil type clayey loam Munsell/Color 7.5YR 3/2Drawings ✓ Contents ceramicaPhoto/Digital ✓ obsidianatoba

## Description/Sketch (with measurements):

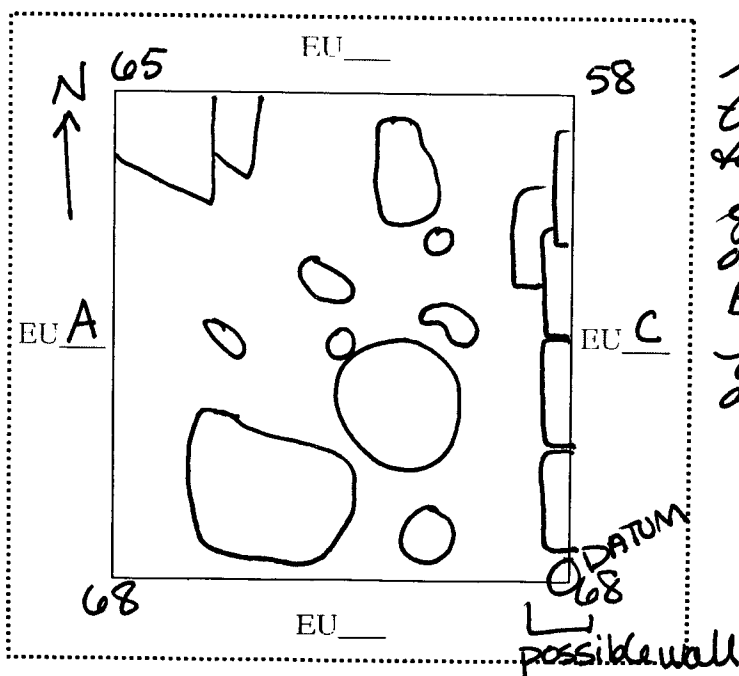

This lot involves the removal of tumble down to the level of the change to yellow brown clay. A possible wall was revealed on the eastern side of the EU. May either be exposed flat fill or a wall disturbed by root activity.

Op/SubOp/Lot: 10/18/05 Ex. Unit B Size (NxEx) 1x1Site: Los Naranjitos (S-007) Str 10Initial Lot? no Prev. lot 4 Next lot 6 BGS: 70-103 cmInitial elev.: NW 996.49 NE 996.56 SW 996.46 SE 996.46Final elev.: NW 996.11 NE 996.23 SW 996.11 SE 996.23Reference corner: SW N 25.82 E -211.66Deposit / Type architecture / tumbleSoil type silty clay Munsell/Color 2.5 Y 4/3Drawings ✓Contents 60 ceramicaPhoto/Digital ✓1 peridermal

## Description/Sketch (with measurements):

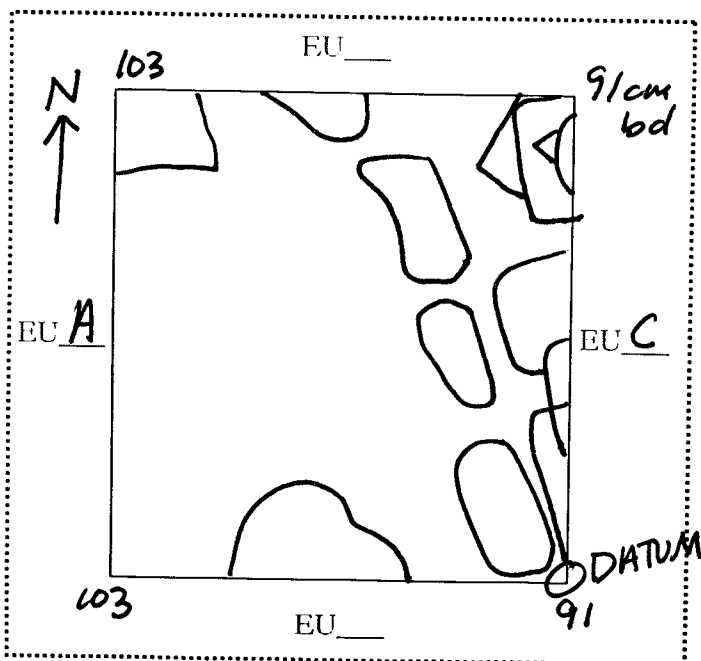

The purpose of this lot is to look for the basal wall. This involved the removal of several large tumbled rocks, in order to reach the "wall."

2008  
PAREP 2008 LOT FORM

Excavator 17

Date 25 June 2008

Op/SubOp/Lot: 10/18/06

Ex. Unit B

Size (NxE) 1x1

Site: Los Naranjitos (5007)

Str 10

Initial Lot? no

Prev. lot 5

Next lot 8A

BGS: 103-116cm

Initial elev.: NW 996.49 NE 996.23 SW 996.11 SE 996.23

Final elev.: NW 995.98 NE 996.04 SW 995.98 SE 996.03

Reference corner: SW

N 25.82

E -211.66

Deposit / Type

architecture

/ collapse

Soil type

silty clay

Munsell/Color

2.5 Y 3/2

Drawings

☒

Contents

38 ceramica

Photo/Digital

☒

5 obsidiana

2 chert

1 quartz

Description/Sketch (with measurements):

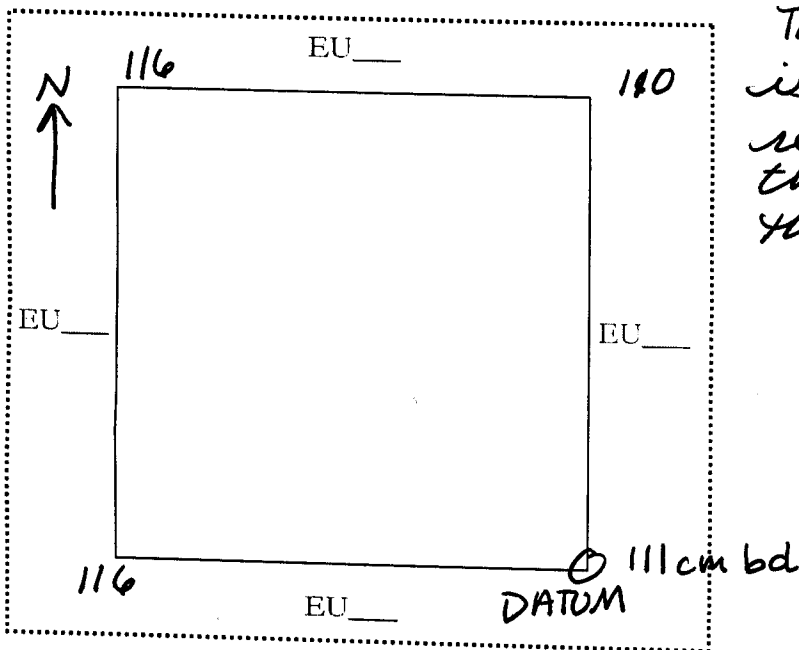

The purpose of this lot is to investigate the relationship between the yellow brown clay and the possible basal wall.

Note refs

18

## PAREP 2008 LOT FORM

Excavator 17Date 25 June 2008Op/SubOp/Lot: 10/18/07 Ex. Unit C Size (NxEx) 1x1Site: Los Naranjitos (S-007) Str 10Initial Lot? yes Prev. lot - Next lot (8b) 9 BGS: 0-77cmInitial elev.: NW 997.09 NE 997.51 SW 997.14 SE 997.49Final elev.: NW 996.96 NE 997.21 SW 996.74 SE 997.22Reference corner: SW N 26.35 E -210.21Deposit / Type architecture / collapseSoil type clayey loam Munsell/Color 7.5YR 3/2Drawings ✓Contents 17~~2~~ ceramica  
1 bonePhoto/Digital ✓

## Description/Sketch (with measurements):

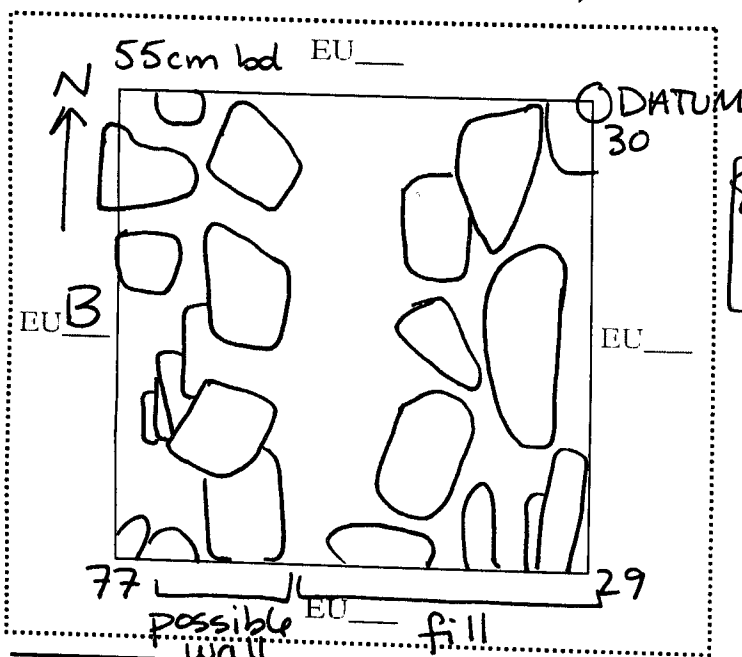

The purpose of this lot is to clean & expose tumble and possible wall rocks.

[8b recorded as 8 on the bag tag]

Note refs 18, 19



Op/SubOp/Lot: 10/18/08(A) Ex. Unit B Size (NxEx) 1x1Site: Los Naranjitos (5-007) Str 10Initial Lot? no Prev. lot 6 Next lot - BGS: 116-145Initial elev.: NW 995.98 NE 996.04 SW 995.98 SE 996.03Final elev.: NW 995.91 NE 995.89 SW 995.86 SE 995.71Reference corner: SE N 25.82 E -211.66Deposit / Type architecture / collapseSoil type silty clay Munsell/Color 2.5Y 4/3Drawings ✓ Contents 9 ceramicaPhoto/Digital ✓

## Description/Sketch (with measurements):

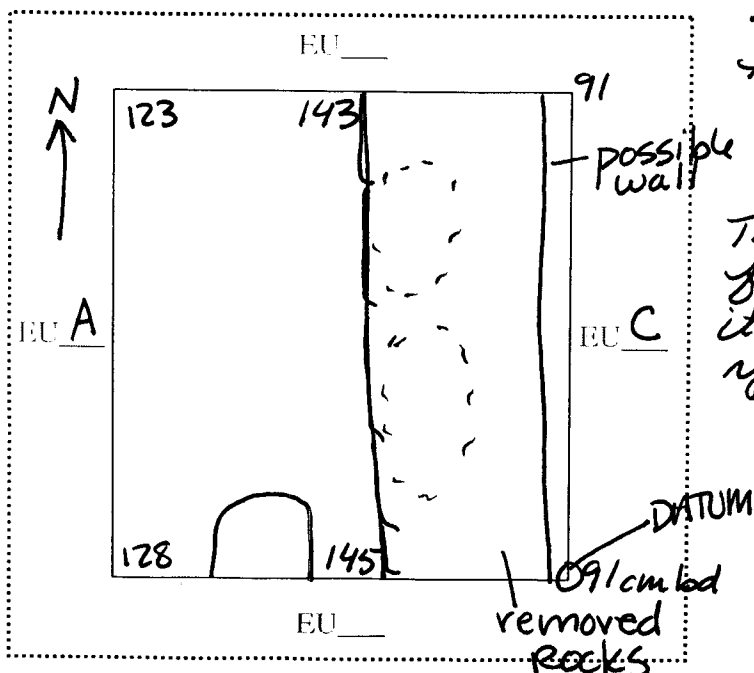

The purpose of this lot is to remove several large tumbled rocks to better reveal the base of the wall.

The soil changes to gray brown from yellow brown at 123cm bed it then ~~then~~ changes back to yellow brown at the base level

## PAREP 2008 LOT FORM

Excavator 17Date 26 June 2008

Op/SubOp/Lot: 10/18/08<sup>9</sup>B Ex. Unit C Size (NxEx) 1x1  
Site: Los Naranjitos (5007) Str 10

Initial Lot? no Prev. lot 7 Next lot - BGS: 0-57

Initial elev.: NW 996.96 NE 997.21 SW 996.74 SE 997.22

Final elev.: NW 996.92 NE 996.92 SW 997.09 SE 997.01

Reference corner: SW N 26.35 E -210.21

Deposit / Type architectural / fill

Soil type clayey loam Munsell/Color 7.5 YR 3/2

Drawings ✓ Contents none

Photo/Digital ✓

## Description/Sketch (with measurements):

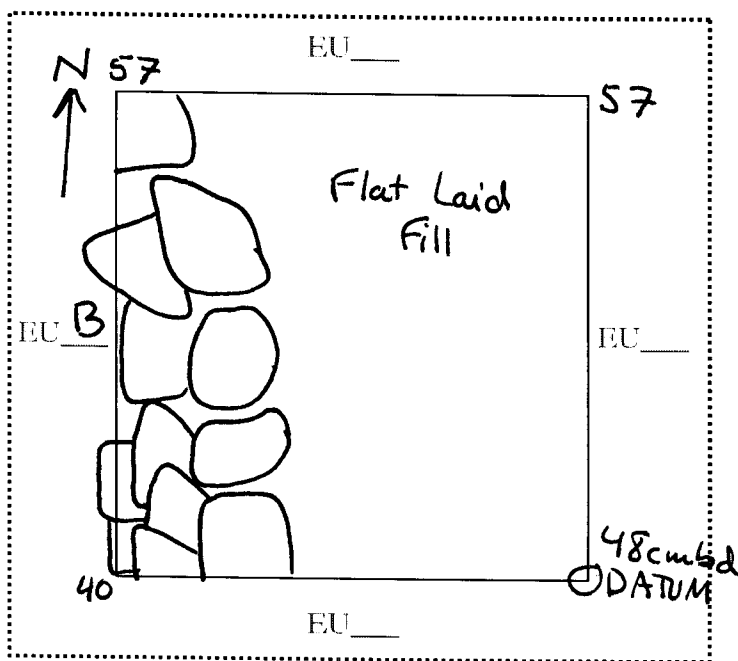

The purpose of this lot is to remove tumble & to expose the fill.

Bag tag is labeled as  
lot #8 - is actually  
Lot #9.

Note refs 23

Op/SubOp/Lot: 10/18/10Ex. Unit DSize (NxE) 0.5 x 1Site: Los Naranjitos (5007)Str 10Initial Lot? yesPrev. lot -Next lot -BGS: 0-63Initial elev.: NW 996.44 NE 996.78 SW 996.46 SE 996.75Final elev.: NW 996.17 NE 996.21 SW 996.15 SE 996.18Reference corner: SWN 26.37E -212.89

Deposit / Type

architectural/ collapse

Soil type

clayey loam

Munsell/Color

7.5 YR 3/2

Drawings

☒

Contents

16 ceramics1 obsidiana

Photo/Digital

☒

## Description/Sketch (with measurements):

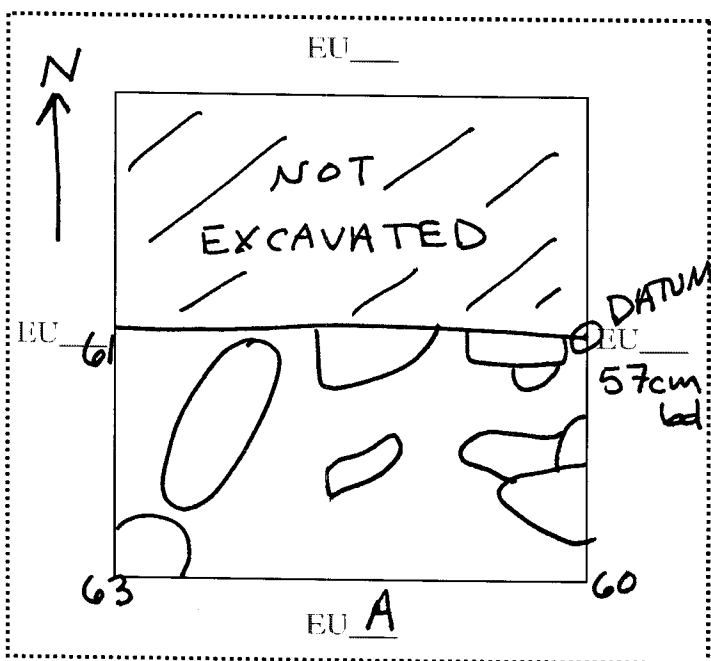

The purpose of this lot is to investigate the possible western wall/terrace that appeared as tumble.

Due to previous mislabeling on a bag this lot is lot #10 & not #9.

Note refs

23