

---

Four Valleys Archive

Anthropology

---

2008

## EPV Op. 10-21 Lot Forms 2008

Mary Hostenske

Follow this and additional works at: <https://digital.kenyon.edu/honduras>



Part of the Archaeological Anthropology Commons

---

### Recommended Citation

Hostenske, Mary, "EPV Op. 10-21 Lot Forms 2008" (2008). *Four Valleys Archive*. Paper 96718.  
<https://digital.kenyon.edu/honduras/96718>

This Lot Card is brought to you for free and open access by the Anthropology at Digital Kenyon: Research, Scholarship, and Creative Exchange. It has been accepted for inclusion in Four Valleys Archive by an authorized administrator of Digital Kenyon: Research, Scholarship, and Creative Exchange. For more information, please contact [noltj@kenyon.edu](mailto:noltj@kenyon.edu).

Op/SubOp/Lot: 10/21/01 Ex. Unit A Size (NxF) 1x1

Site: Los Navanjos (5-007) Str 9

Initial Lot? yes Prev. lot - Next lot 4 BGS: 0-43

Initial elev.: NW 996.83 NE 996.85 SW 997.03 SE 997.04

Final elev.: NW 996.6 NE 996.71 SW 996.79 SE 996.79

Reference corner: NW N 41.14 E -195.66

Deposit / Type overburden / sediment

Soil type silty loam Munsell/Color 10YR 3/3

Drawings  Contents bajareque  
Photo/Digital  perdernal  
ceramica

Description/Sketch (with measurements):

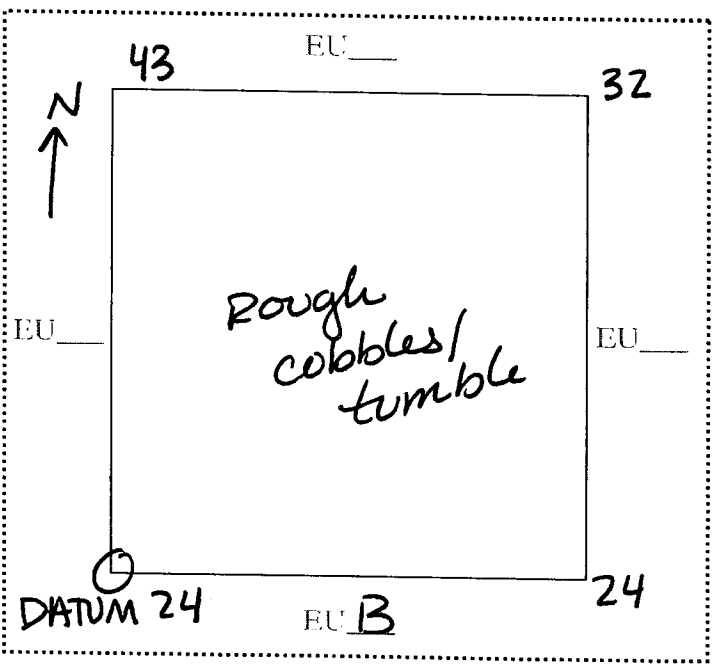

The purpose of this lot is to uncover the northern basal wall.

Note refs 26

Op/SubOp/Lot: 10/21/02 Ex. Unit B Size (NxEx) 1x1

Site: Los Naranjitos (S-007) Str 9

Initial Lot? yes Prev. lot - Next lot 4 BGS: 0-50

Initial elev.: NW 997.03 NE 997.04 SW 997.21 SE 997.24

Final elev.: NW 996.72 NE 996.82 SW 997.04 SE 996.98

Reference corner: NW N 40.12 E -195.72

Deposit / Type architectural / collapse

Soil type silty loam Munsell/Color 10YR 3/3

Drawings  Contents 4, ceramica

Photo/Digital  1, perdernal

Description/Sketch (with measurements):

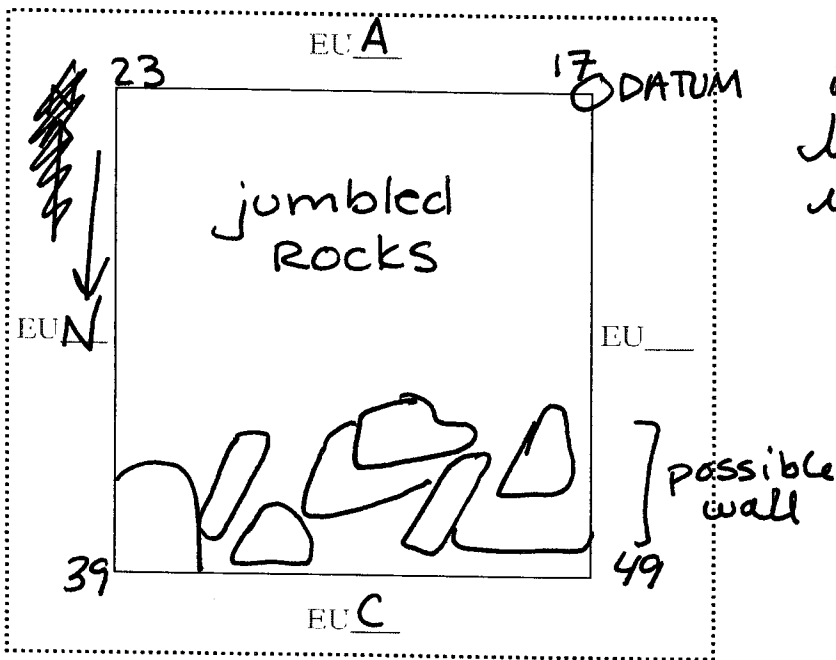

The purpose of this lot is to expose the summit & locate the northern basal wall.

Note refs 29

Op/SubOp/Lot: 10/21/03

Ex. Unit C

Size (NxI) 1x1.35

Site: Los Naranjitos (S-007)

Str 9

Initial Lot? yes

Prev. lot -

Next lot -

BGS: 0-33

Initial elev.: NW 997.21 NE 997.24 SW 997.42 SE 997.36

Final elev.: NW 996.91 NE 997.05 SW 996.93 SE 997.00

Reference corner: NW

N 39.18

E -195.91

Deposit / Type overburden

sediment

Soil type silty loam

Munsell/Color 10YR 3/3

Drawings

Contents 1 ceramica

Photo/Digital

Description/Sketch (with measurements):

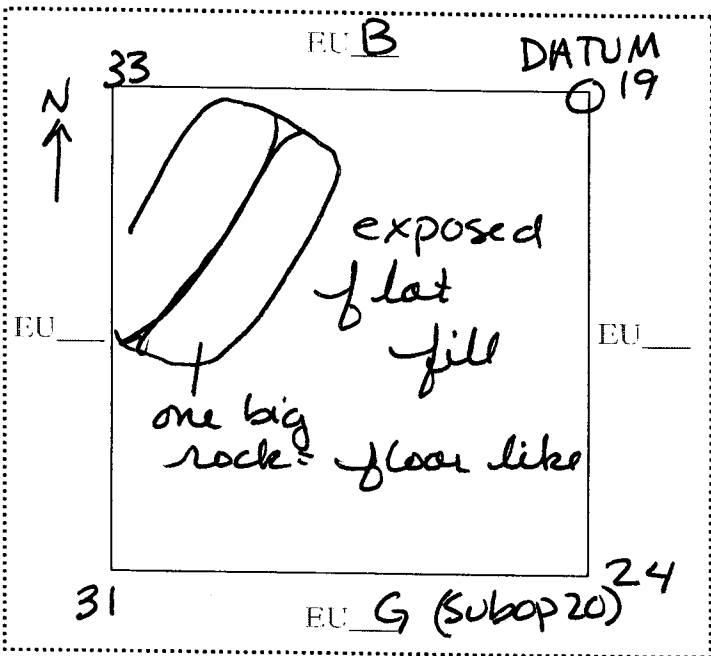

This EU is 1 meter (N) by 1.35 (E) in order to allow it to go in w/ Subop 20 & create an axial access the structure. The purpose is to expose the summit.

Note refs 29

Op/SubOp/Lot: 10/21/04 Ex. Unit A/B Size (NxL) 2x1

Site: Las Navanitas (S-007) Str 9

Initial Lot? no Prev. lot 2 Next lot 5 BGS: 50-78

Initial elev.: NW 996.72 NE 996.82 SW 996.79 SE 996.79

Final elev.: NW 996.62 NE 996.62 SW 996.46 SE 996.42

Reference corner: NW N 41.14 E -195.66

Deposit / Type architectural / collapse

Soil type silty clay Munsell/Color 2.5Y 3/2

Drawings  Contents 7 ceramica

Photo/Digital

Description/Sketch (with measurements):

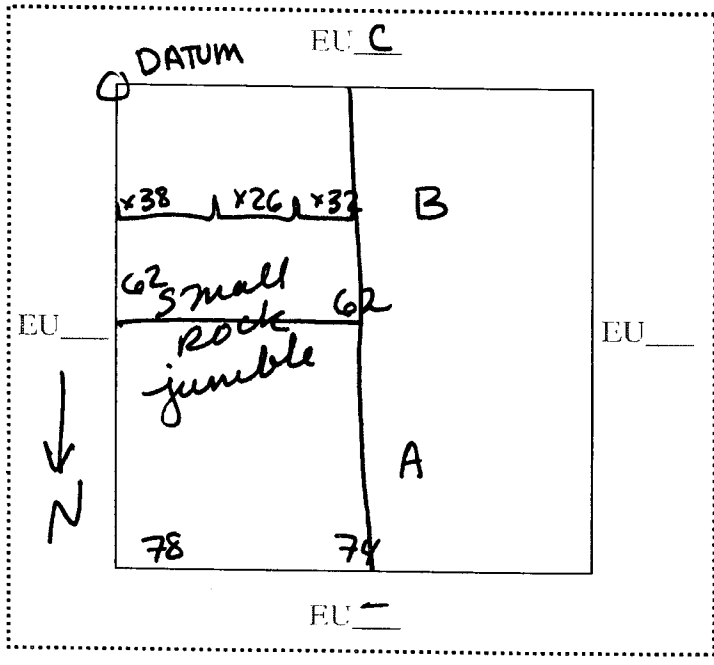

The purpose of this lot is to expose the northern basal wall.

Note refs 30

Op/SubOp/Lot: 10/21/05 Ex. Unit A/B Size (NxI): 2x1

Site: Los Nauanjitos (S-007) Str 9

Initial Lot? no Prev. lot 4 Next lot - BGS: 78 - 98

Initial elev.: NW 996.62 NE 996.62 SW 996.46 SE 996.42

Final elev.: NW 996.32 NE 996.33 SW 996.26 SE 996.30

Reference corner: NW N 41.14 E -195.66

Deposit / Type architectural / collapse

Soil type silty clay Munsell/Color 2.5Y 3/2

Drawings  Contents 180 ceramica

Photo/Digital  14 bajareque  
3 pedernal  
7 obsidiana  
carbon

Description/Sketch (with measurements):

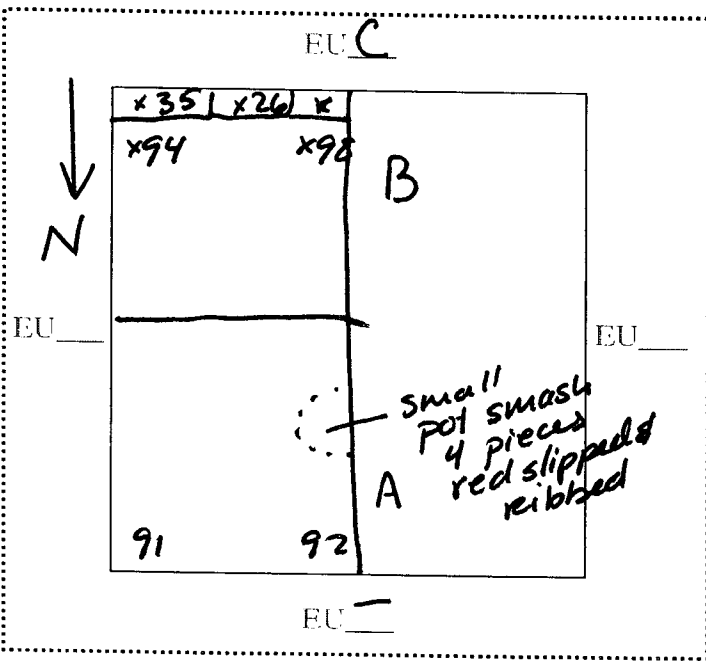

The purpose of this lot is to uncover the base of the wall.

\* Datum is at NE corner of EU BC  
Base of wall is at 90 cm bd.

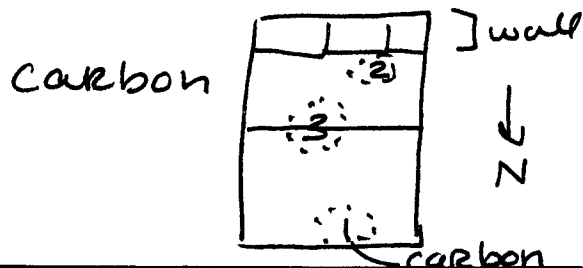

Note refs 31 - 32