

2007

EPV Op. 03-31 Lot Forms 2007

Roberto Ramirez

Follow this and additional works at: <https://digital.kenyon.edu/honduras>



Part of the Archaeological Anthropology Commons

Recommended Citation

Ramirez, Roberto, "EPV Op. 03-31 Lot Forms 2007" (2007). *Four Valleys Archive*. Paper 96745.
<https://digital.kenyon.edu/honduras/96745>

This Lot Card is brought to you for free and open access by the Anthropology at Digital Kenyon: Research, Scholarship, and Creative Exchange. It has been accepted for inclusion in Four Valleys Archive by an authorized administrator of Digital Kenyon: Research, Scholarship, and Creative Exchange. For more information, please contact noltj@kenyon.edu.

Op/SubOp/Lot: 03/31/1

Ex. Unit A

Size (NxE) 1x1

Site: El Guayabal

Str #9

Initial Lot? Yes

Prev. lot —

Next lot 2

BGS: 0 - 20

Initial elev.: NW 993.68 NE 993.66 SW 993.59 SE 993.61

Final elev.: NW 993.47 NE 993.46 SW 993.41 SE 993.42

Reference corner: NE

N 390.16

E -290.68

Deposit / Type Overburden / Humus

Soil type Humus

Munsell/Color Capee

Drawings —

Contents Ceramica (9)

Photo/Digital —

pedernal (4)

obsidiana (1)

metate (3)

Description/Sketch (with measurements):

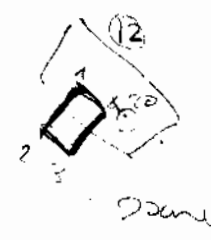
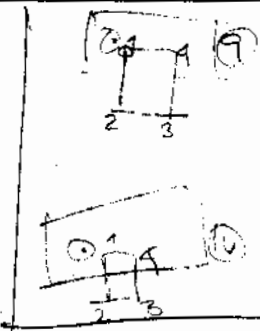
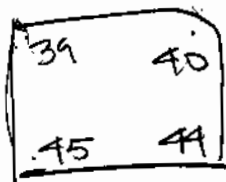
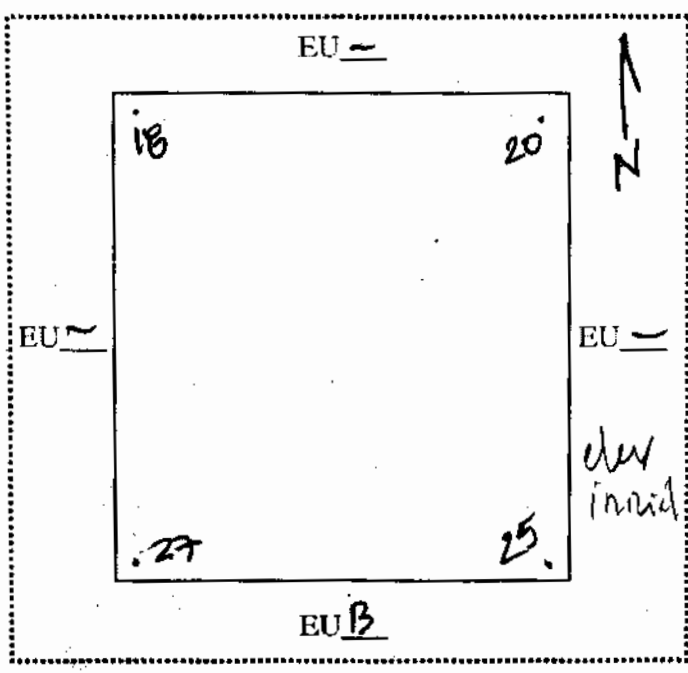

Datum: 993.86

Note refs —

PAREP 2007 LOT FORM

Excavator JRP/g

Date 22/6/07

Op/SubOp/Lot: 03/31/2

Ex. Unit A

Size (NxEx) 1x1

Site: EL QUAYABAL

Str #9

Initial Lot? NO

Prev. lot 1

Next lot 3

BGS: 20-40

Initial elev.: NW 993.47 NE 993.46 SW 993.41 SE 993.42

Final elev.: NW 993.28 NE 993.26 SW 993.22 SE 993.24

Reference corner: NE N 390.16 E -290.68

Deposit / Type _____ / _____

Soil type _____ Munsell/Color _____

Drawings _____ Contents Ceramica (4)

Photo/Digital _____ barbaque (2)

pedernal (5)

metate (1)

Description/Sketch (with measurements):

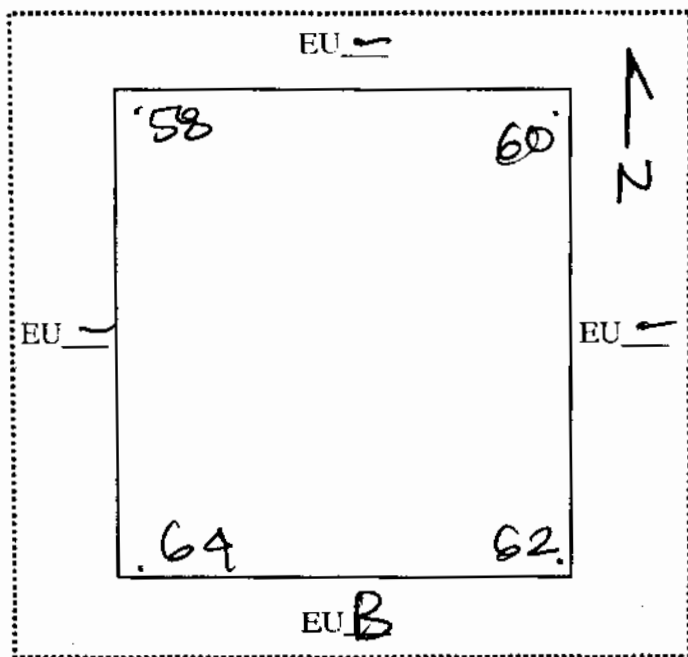

Distur: 993.86

Note refs _____

PAREP 2007 LOT FORM

Excavator JR/8

Date 22/6/07

Op/SubOp/Lot: 03/31/3

Ex. Unit A

Size (NxEx) 1x1

Site: El Guayabal

Str #9

Initial Lot? No

Prev. lot 2

Next lot 8

BGS: 40-60

Initial elev.: NW 993.28 NE 993.24 SW 993.22 SE 993.24

Final elev.: NW 993.08 NE 993.06 SW 993.00 SE 993.01

Reference corner: NE

N 390.14

E -290.68

Deposit / Type _____ / _____

Soil type _____ Munsell/Color _____

Drawings _____

Contents obsidiana (1)

Metate (1)

Photo/Digital _____

Description/Sketch (with measurements):

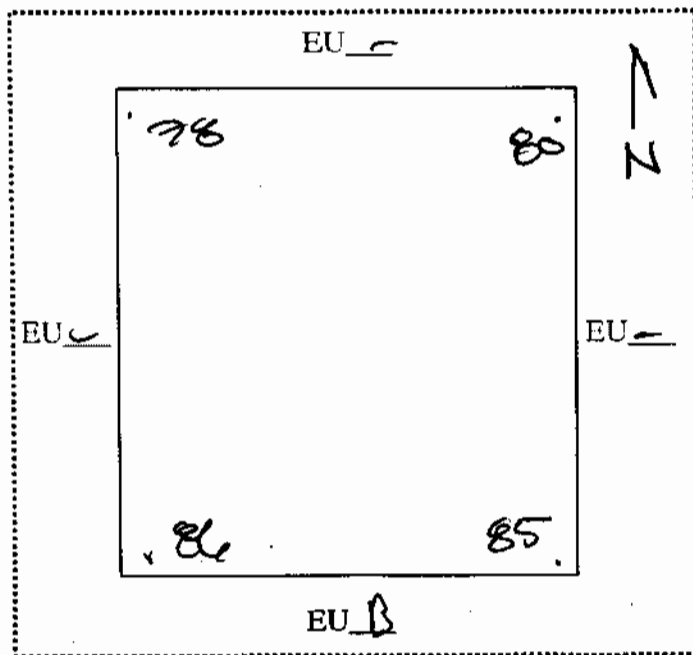

Datum: 993.86

Note refs _____

PAREP 2007 LOT FORM

Excavator JRR/8

Date 22/6/07

Op/SubOp/Lot: 03/31/4

Ex. Unit B

Size (NxEx) 1X1

Site: El Guayaibal

Str #9

Initial Lot? yes Prev. lot — Next lot 5 BGS: 0-20

Initial elev.: NW 993.59 NE 993.61 SW 993.48 SE 993.51

Final elev.: NW 993.36 NE 993.36 SW 993.30 SE 993.32

Reference corner: NE N 390.16 E -290.60

Deposit / Type _____ / _____

Soil type Humus Munsell/Color 10YR 5/1

Drawings _____ Contents Ceramica (16) + 1

Photo/Digital _____ batoreque (3) obsidiana (1)
pedernal (2)
metate (4) + 1

Description/Sketch (with measurements):

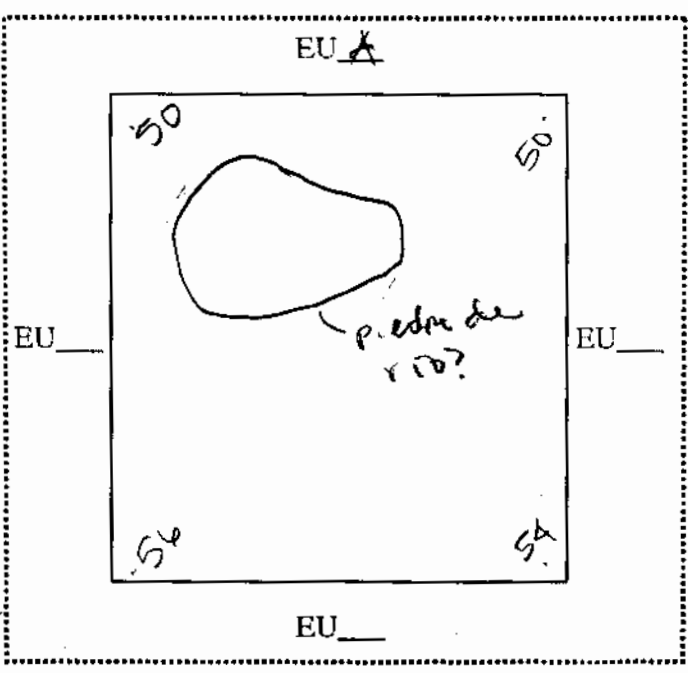

Encontramos 2 fragmentos pequeños de cerámica vidriada

Note refs _____

PAREP 2007 LOT FORM

Excavator JRP/8

Date 25/6/07

Op/SubOp/Lot: 03/31/5

Ex. Unit B

Size (NxEx) 1x1

Site: El Guayabal

Sr #9

Initial Lot?

Prev. lot 4

Next lot 6

BGS: 20-40

Initial elev.: NW 993.36 NE 993.96 SW 993.30 SE 993.32

Final elev.: NW 993.18 NE 993.18 SW 993.11 SE 993.11

Reference corner: NE

N 390.16

E -290.68

Deposit / Type _____ / _____

Soil type _____

Munsell/Color _____

Drawings _____

Contents Ceramica (1)

Photo/Digital _____

bañereta (?)

Rederol (4)

Carbon (4)

Description/Sketch (with measurements):

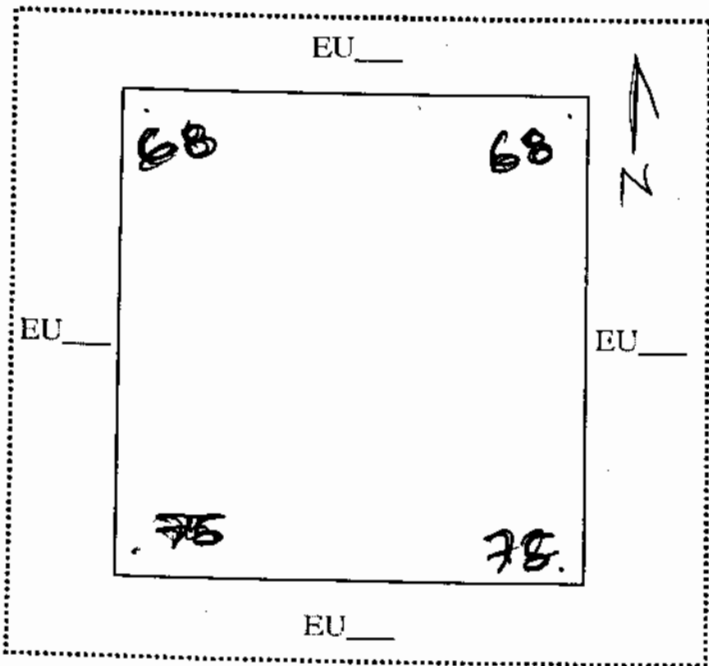

Note refs _____

PAREP 2007 LOT FORM

Excavator JPR/B

Date 25/6/07

Op/SubOp/Lot: 03/31/6

Ex. Unit B

Size (NxEx) 1x1

Site: El Guayabal

Str #9

Initial Lot? —

Prev. lot 5

Next lot 7

BGS: 40-60

Initial elev.: NW 993.18 NE 993.18 SW 993.11 SE 993.11

Final elev.: NW 993.01 NE 993.04 SW 992.96 SE 992.98

Reference corner: NE

N 390.16

E -290.68

Deposit / Type _____ / _____

Soil type _____

Munsell/Color _____

Drawings _____

Contents

Ceramica (3)

bechoreque (3)

Carbon (✓)

Photo/Digital _____

Description/Sketch (with measurements):

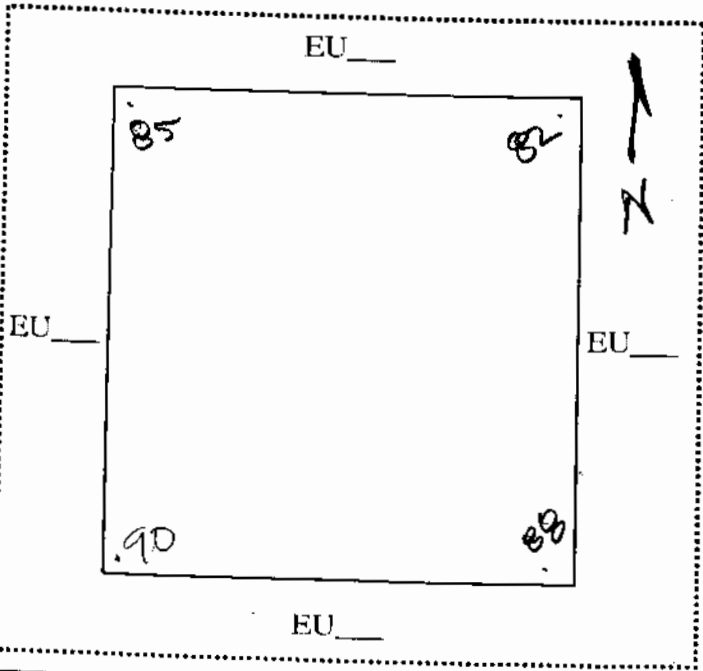

Datum: 993.86

ote refs _____

PAREP 2007 LOT FORM

Excavator

TRK/8

Date 25/6/07

Site:

FL (Quay Street)

Op/Subop/Loc:

B3/31/2

Ex. Unit

B

Size (NxE)

7x1

Initial Lot:

—

Prev. lot

G

Next lot

9

BGS:

60-80

Initial elev.: NW

993.01

NE

993.04

SW

992.96

SE

992.98

Final elev.: NW

992.82

NE

993.86

SW

992.84

SE

992.85

Reference corner:

NE

N

390.16

E

290.68

Deposit / Type

/

Soil type

Munsell/Color

Drawings

Ceramica (5)

Contents

pedernal (1)

metate (1)

Photo/Digital

Option/Sketch (with measurements):

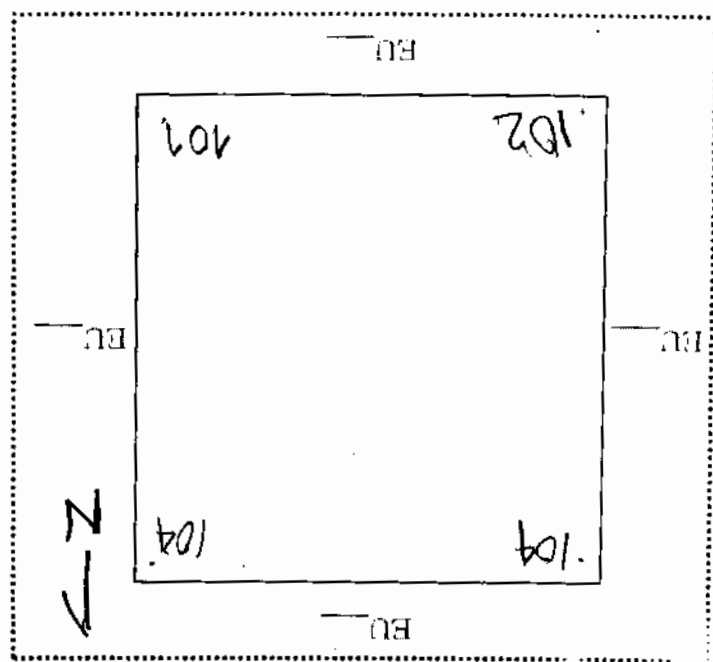

Date: 993.86

Site refs

PAREP 2007 LOT FORM

Excavator

JRE

Date

26/6/07

Site:

Guayabal

Op/Subop/Lot:

03/31/8

Ex. Unit

4

Size (NxE)

1x1

Initial Lot#

—

Prev. lot

3

Next lot

10

BGS:

60-80

Initial elev.: NW

993.08

NE

993.00

SW

993.00

SE

993.01

Final elev.: NW

992.70

NE

992.68

SW

992.71

SE

992.70

Reference corner:

NE

N

990.16

E

290.68

Deposit / Type

/

Soil type

Munsell/Color

Drawings

Photo/Digital

Contents

Bohena (3)
Ceramica (4)
Mata (1)
Carbon (4)

Description/Sketch (with measurements):

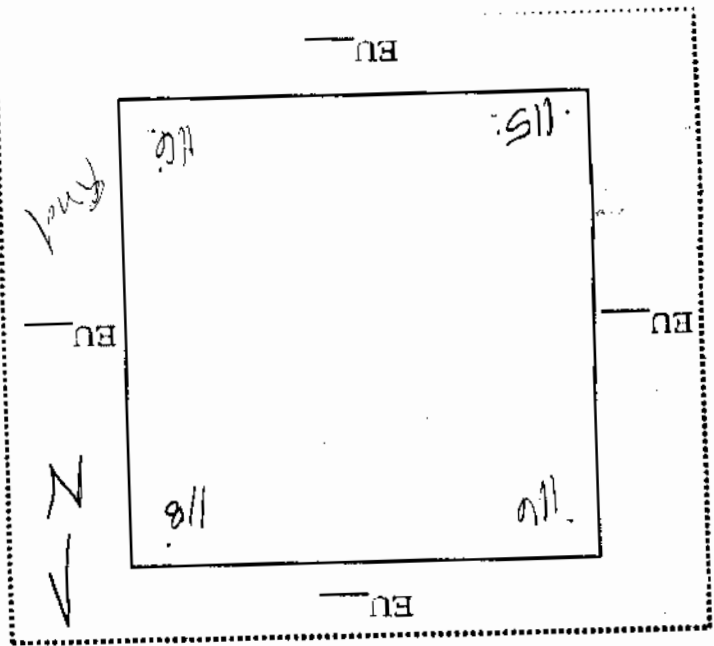

Datum: 993.86

PAREP 2007 LOT FORM

Excavator: JPR/S Date: 20/0/07

Op/Subop/Lot: 05/31/9 Ex. Unit: B Size (NxE): 1x1
 Site: El Gueyobal St # 9

Initial Lot: Prev. lot: 7 Next lot: 11 BGS:

Initial elev.: NW 992.82 NE 993.86 SW 992.84 SE 992.85

Final elev.: NW 992.96 NE 992.96 SW 992.44 SE 992.44

Reference corner: NE N 390.16 E - 290.68

Deposit / Type: /

Soil type: Munsell/Color:

Drawings: Contents: None

Photo/Digital:

Description/Sketch (with measurements):

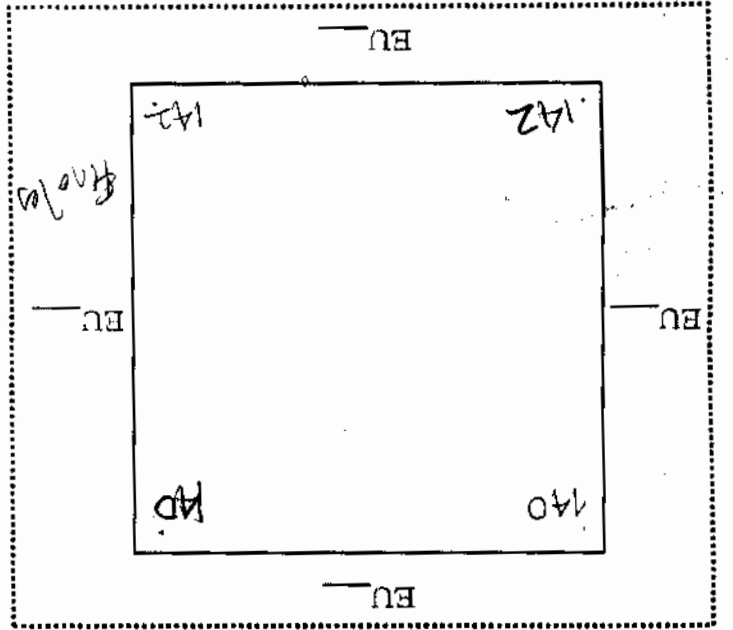

Datum: 993.86

Note refs

PAREP 2007 LOT FORM

Excavator JPR/8

Date 26/6/07

Op/Subop/Lot: 03/31/10

Ex. Unit A

Size (NxE) 7x1

Site: E2 guayabal

Str # 9

Initial Lot? —

Prev. lot 8

Next lot 12

BGS: 100-120

Initial elev.: NW 992.70

NE 992.68 SW 992.71 SE 992.70

Final elev.: NW 992.44

NE 992.50 SW 992.46 SE 992.46

Reference corner: NE

N 390.16 E -290.68

Deposit / Type /

Munsell/Color /

Soil type /

Drawings None

Contents None

Photo/Digital /

Description/Sketch (with measurements):

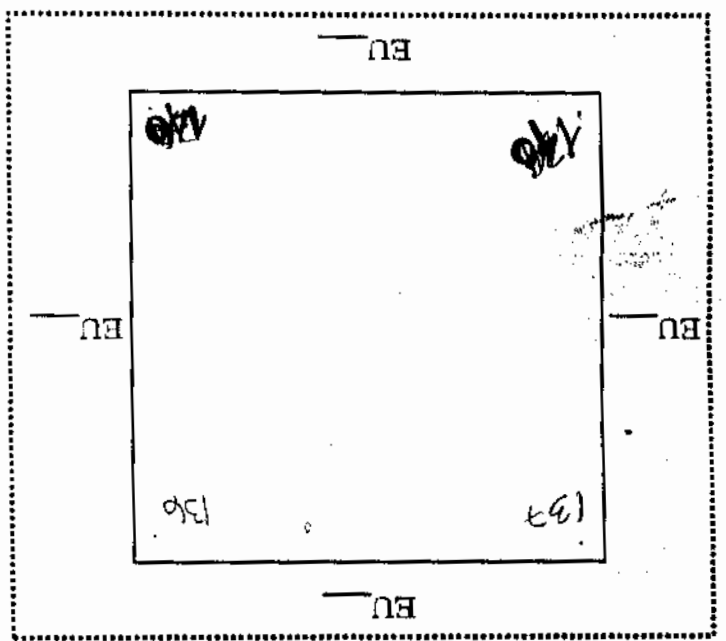

Note refs

PAREP 2007 LOT FORM

Excavator: JRF/8 Date: 27/6/07

Op/Subop/Lot: 03/31/10

Ex. Unit: B Size (NxE): 1x1

Site: E2 Guayabal

Str. # 9

Initial Lot: 9 Prev. lot: 9 Next lot: 12 BGS: _____

Initial elev.: NW 992.46 NE 992.46 SW 992.44 SE 992.44

Final elev.: NW 992.26 NE 992.26 SW 992.23 SE 992.24

Reference corner: NE N 390.16 E 290.68

Deposit / Type

Barro

Munsell/Color amarrado

Drawings

Perforado (3)

Contents

Photo/Digital

Description/Sketch (with measurements):

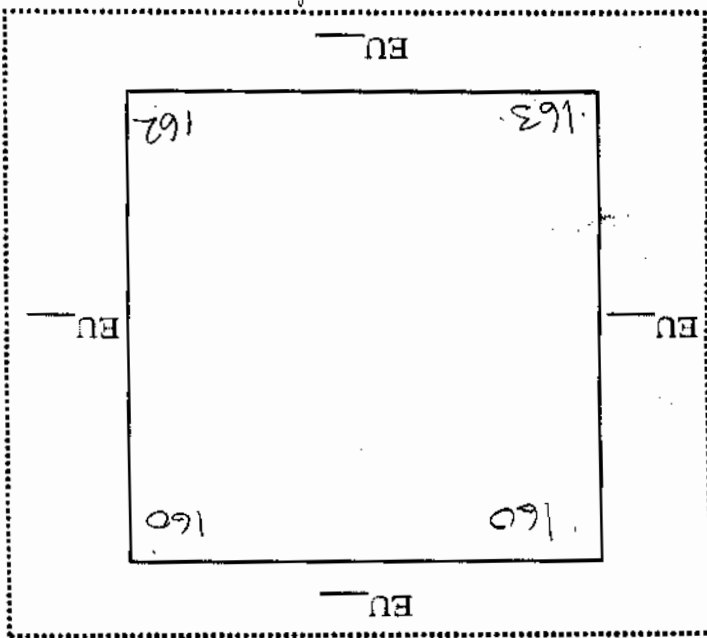

Drawn: 993.84

Note refs

PAREP 2007 LOT FORM

Excavator: Jpe/e Date: 2/16/07

Op/Subop/Lot: 03/31/12

Ex. Unit: A Size (NxE): 1x1

Site: #9

Str: #9

Initial Lot: —

Prev. lot: 10

Next lot: —

BGS: —

Initial elev.: NW 992.49

NE 992.50

SW 992.46

SE 992.46

Final elev.: NW 992.28

NE 992.29

SW 992.26

SE 992.26

Reference corner: NE

N 310.16

E -290.68

Deposit / Type

Munsell/Color

Drawings

Personal (2)

Contents

Photo/Digital

Description/Sketch (with measurements):

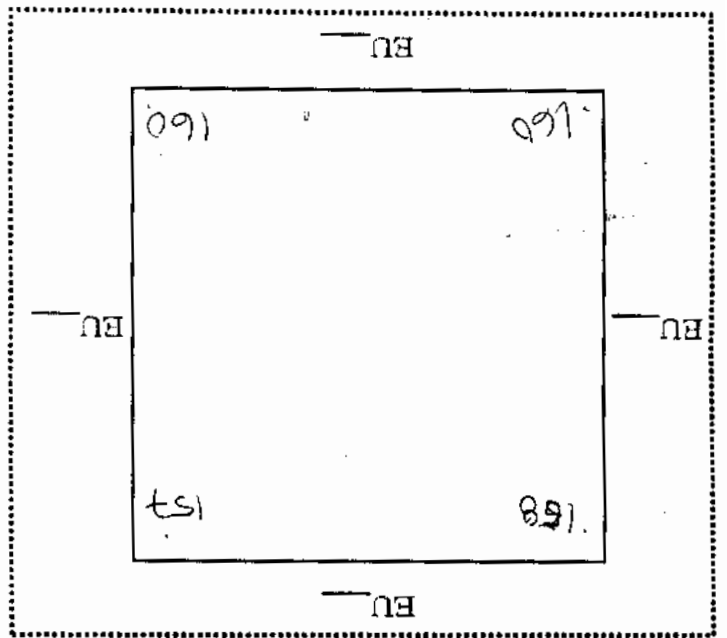

Note refs

PAREP 2007 LOT FORM

Excavator JR/8

Date 27/6/07

Op/SubOp/Lot: 03/31/13

Ex. Unit B

Size (NxEx) 1x1

Site: El Guayabal

Str #9

Initial Lot? — Prev. lot ~~10~~ 11 Next lot — BGS: —

Initial elev.: NW 992.26 NE 992.26 SW 992.23 SE 992.24

Final elev.: NW 992.04 NE 992.05 SW 992.02 SE 992.04

Reference corner: NE N 390.16 E -290.68

Deposit / Type — / —

Soil type — Munsell/Color —

Drawings — Contents Non.

Photo/Digital —

Description/Sketch (with measurements):

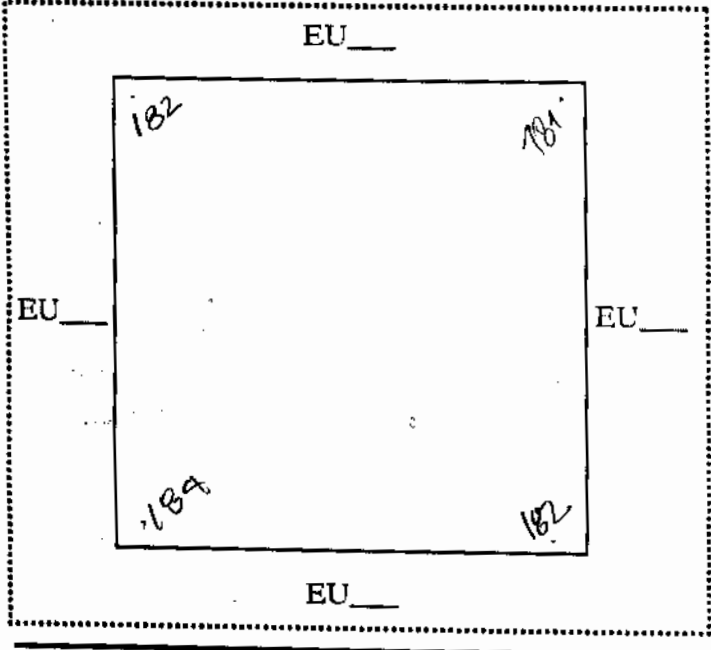

Datum: 993.84

Site refs —