Four Valleys Archive

Anthropology

2007

EPV Op. 03-33 Lot Forms 2007

Roberto Ramirez

Follow this and additional works at: <https://digital.kenyon.edu/honduras>



Part of the Archaeological Anthropology Commons

Recommended Citation

Ramirez, Roberto, "EPV Op. 03-33 Lot Forms 2007" (2007). *Four Valleys Archive*. Paper 96747.
<https://digital.kenyon.edu/honduras/96747>

This Lot Card is brought to you for free and open access by the Anthropology at Digital Kenyon: Research, Scholarship, and Creative Exchange. It has been accepted for inclusion in Four Valleys Archive by an authorized administrator of Digital Kenyon: Research, Scholarship, and Creative Exchange. For more information, please contact noltj@kenyon.edu.

PAREP 2007 LOT FORM

Excavator JRR/8

Date 22/6/07

Op/SubOp/Lot: 03/33/1

Ex. Unit B

Size (NxEx) 1x1

Site: El Guayabal

Str #16

Initial Lot? 741

Prev. lot —

Next lot 2

BGS: D-20cm

Initial elev.: NW 993.80 NE 993.82 SW 993.56 SE 993.62

Final elev.: NW 993.34 NE 993.39 SW 993.20 SE 993.18

Reference corner: NE

N 220.24 E 383.32

Deposit / Type _____ / _____

Soil type Humus

Munsell/Color Cape oscuro

Drawings _____

Contents Ceylanita (16)

Photo/Digital _____

Sahareque (2)

pasamal (6)

obsidiana (5)

Description/Sketch (with measurements):

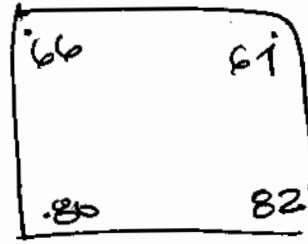
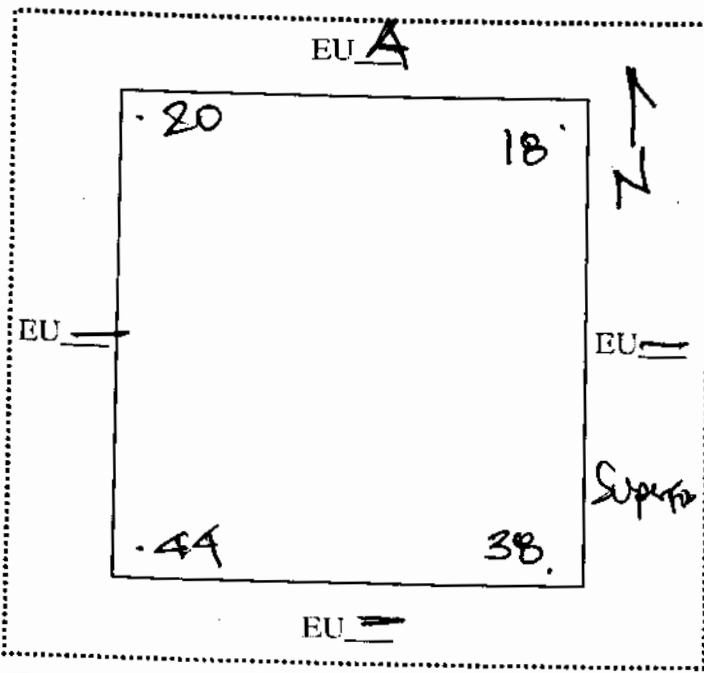

elev. Rnates.

Datum: 994.00

Note refs _____

PAREP 2007 LOT FORM

Excavator TRP/B

Date 22/6/07

Op/SubOp/Lot: 03/33/2

Ex. Unit B

Size (NxEx) 1x1

Site: El Guayabal

Str # 16

Initial Lot? NO

Prev. lot 1

Next lot 3

BGS: 20-40

Initial elev.: NW 993.34 NE 993.39 SW 993.20 SE 993.18

Final elev.: NW 993.15 NE 993.16 SW 993.03 SE 993.03

Reference corner: NE

N 220.24 E -382.32

Deposit / Type _____ / _____

Soil type _____ Munsell/Color _____

Drawings _____

Contents Ceramica (64)

Photo/Digital _____

~~Obsidiana~~ Perforated (17)

Obsidiana (5)

Description/Sketch (with measurements):

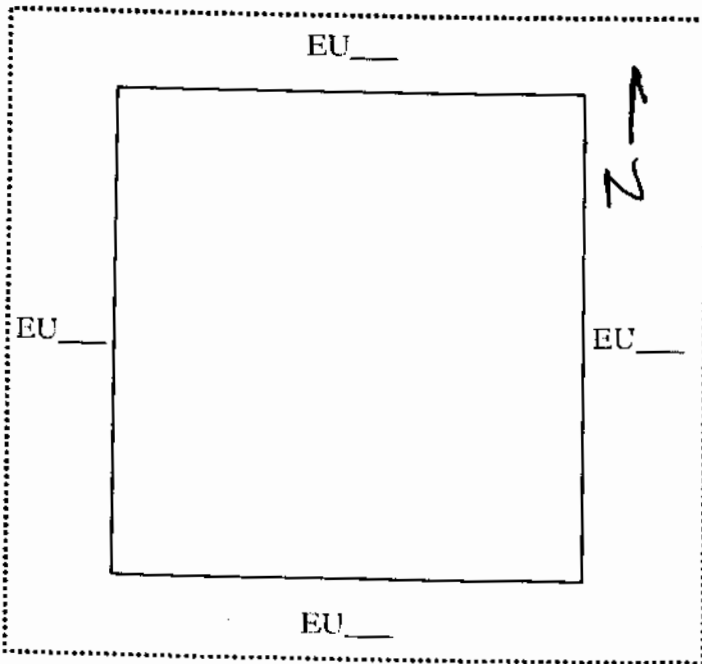

Map refs _____

PAREP 2007 LOT FORM

Excavator JRR/B

Date 25/6/07

Op/SubOp/Lot: 03/33/3

Ex. Unit B

Size (NxEx) 1x1

Site: El Guayabal

Str #16

Initial Lot? _____

Prev. lot 2

Next lot 9

BGS: 40-60

Initial elev.: NW 993.15 NE 993.16 SW 993.03 SE 993.03

Final elev.: NW 992.92 NE 992.92 SW 992.81 SE 992.81

Reference corner: NE

N 220.24

E -388.32

Deposit / Type _____ / _____

Soil type _____

Munsell/Color _____

Drawings _____

Contents Pedernal (5)

Ceramica (4)

Photo/Digital _____

Description/Sketch (with measurements):

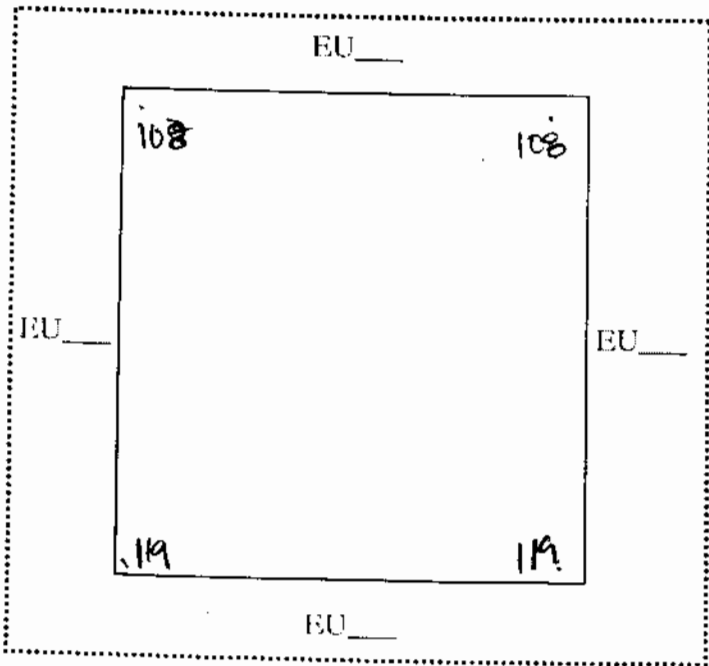

Datum: 994.00

Note refs _____

Op/SubOp/Lot: 03/33/4

Ex. Unit A

Size (NxEx) 1x1

Site: El Guayabal

Str # 16

Initial Lot? Yes

Prev. lot —

Next lot 5

BGS: 0-20

Initial elev.: NW 993.80 NE 993.82 SW 993.56 SE 993.62

Final elev.: NW 993.60 NE 993.62 SW 993.44 SE 993.50

Reference corner: NE

N 220.24

E -385.32

Deposit / Type _____ / _____

Soil type _____

Munsell/Color _____

Drawings _____

Contents _____

Obsidiana (3)
pedernal (5)

Photo/Digital _____

Description/Sketch (with measurements):

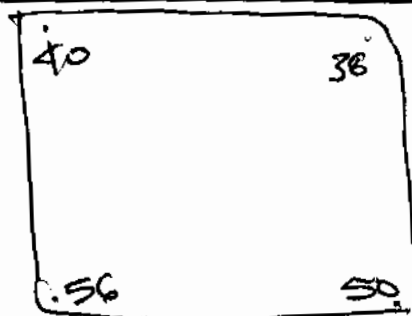
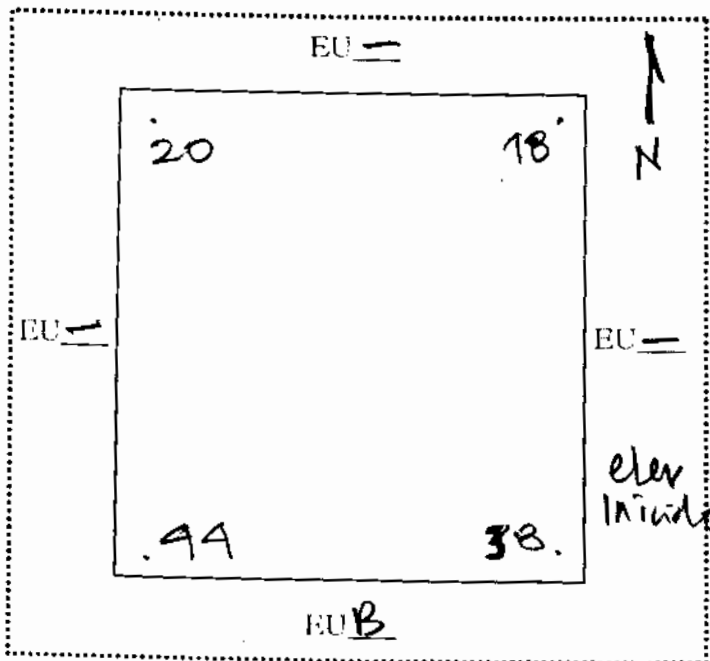

Date: 999.00

Note refs _____

PAREP 2007 LOT FORM

Excavator JKK/B

Date 25/6/07

Op/SubOp/Lot: 03/33/5

Ex. Unit A

Size (NxEx) 1x1

Site: El Guayabal

Str #16

Initial Lot? —

Prev. lot 4

Next lot 6

BGS: 20-40

Initial elev.: NW 993.60 NE 993.62 SW 993.44 SE 993.50

Final elev.: NW 993.50 NE 993.48 SW 993.40 SE 993.42

Reference corner: NE

N 220.24

E -383.32

Deposit / Type _____ / _____

Soil type _____ Munsell/Color _____

Drawings _____

Contents obsidian (3)

Photo/Digital _____

pottery (2)
ceramics (2)
bone (2)

Description/Sketch (with measurements):

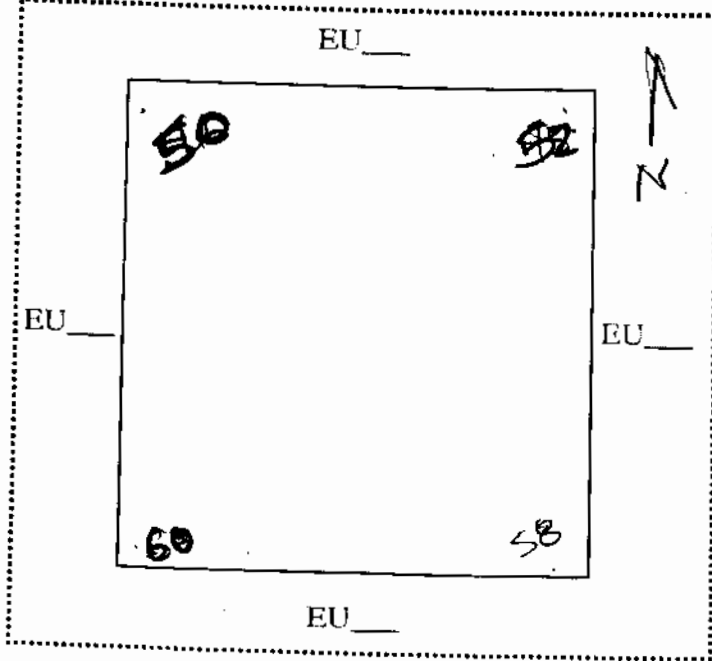

Datum: 994.00

ote refs _____

PAREP 2007 LOT FORM

Excavator JRA/B

Date 25/6/07

Op/SubOp/Lot: 03/33/6
EL GUAYABAL

Ex. Unit A
Str #16

Size (NxEx) 1x1

Initial Lot? — Prev. lot 5 Next lot 7 BGS: 40-60

Initial elev.: NW 993.50 NE 993.48 SW 993.40 SE 993.42

Final elev.: NW 993.2A NE 993.2A SW 993.20 SE 993.20

Reference corner: NE N 220.24 E -383.32

Deposit / Type _____ / _____

Soil type _____ Munsell/Color _____

Drawings _____ Contents Ceramica (76) Pedernal (5)

Photo/Digital _____ obsidiana (7) bahareque (2)

Description/Sketch (with measurements):

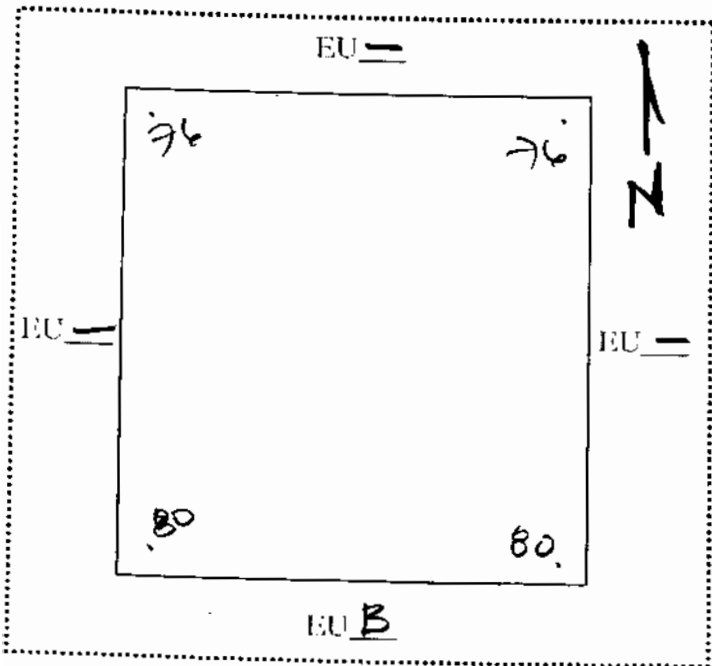

Datum: PA.00

Note refs _____

PAREP 2007 LOT FORM

Excavator JRR/8

Date 29/6/07

Op/SubOp/Lot: 63/33/7

Ex. Unit A

Size (NxEx) 1x1

Site: El Guayabal

Str # 16

Initial Lot? —

Prev. lot 6

Next lot 8

BGS: —

Initial elev.: NW 993.24 NE 993.24 SW 993.20 SE 993.20

Final elev.: NW 993.00 NE 993.02 SW 992.95 SE 992.95

Reference corner: NE

N 220.24 E -383.32

Deposit / Type — / —

Soil type — Munsell/Color —

Drawings —

Contents Ceramica (16)

Photo/Digital —

pedernal (5)

Carbon.

Description/Sketch (with measurements):

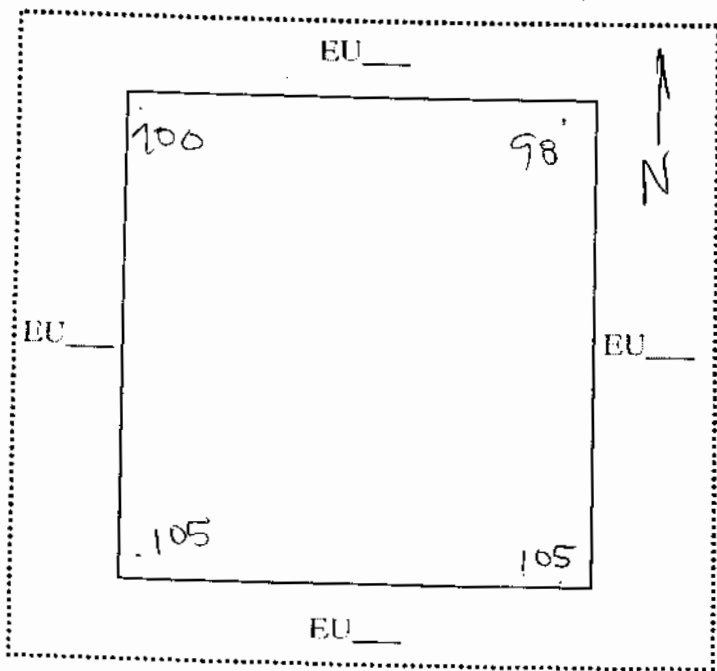

Barro con algunos pedes tierra negra.

Datum 994.00

ote refs —

PAREP 2007 LOT FORM

Excavator JMR/B

Date 26/6/07

Op/SubOp/Lot: 03/33/B

Ex. Unit A

Size (NxEx) 1x1

Site: EL Guayabal

Str #16

Initial Lot? —

Prev. lot 7

Next lot 11

BGS: —

Initial elev.: NW 993.00 NE 993.02 SW 992.95 SE 992.95

Final elev.: NW 992.72 NE 992.74 SW 992.70 SE 992.70

Reference corner: NE

N 220.24

E 383.32

Deposit / Type —

Soil type —

barro muy pegajoso
Munsell/Color —

Drawings —

Contents —

Ceramica (15)

Pebunjal (6)

Carbon (1)

Photo/Digital —

Metate (1)

Description/Sketch (with measurements):

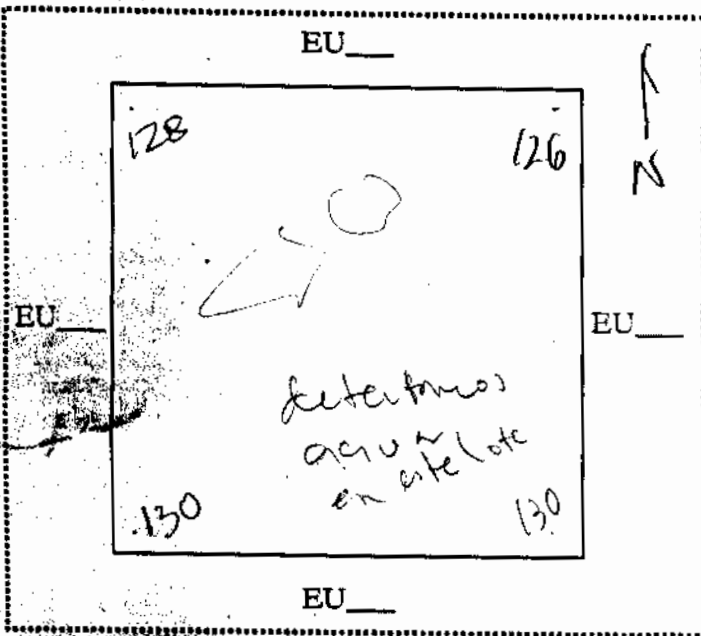

detectamos que hacia agua en este lote, la tierra era muy pegajosa, barro pegajoso.

Datumi: 999.00

Note refs —

PAREP 2007 LOT FORM

Excavator JRR/B

Date 26/6/07

Op/SubOp/Lot: 03/33/9

Ex. Unit B

Size (NxEx) 1x1

Site: El Guayabal

Str # 16

Initial Lot? — Prev. lot 3 Next lot 10 BGS: 60-80

Initial elev.: NW 992.92 NE 992.92 SW 992.81 SE 992.81

Final elev.: NW 992.72 NE 992.73 SW 992.73 SE 992.72

Reference corner: NE N 220.24 E -383.32

Deposit / Type _____ / _____

Soil type _____ Munsell/Color _____

Drawings _____ Contents Perennial (10)

Photo/Digital _____

Description/Sketch (with measurements):

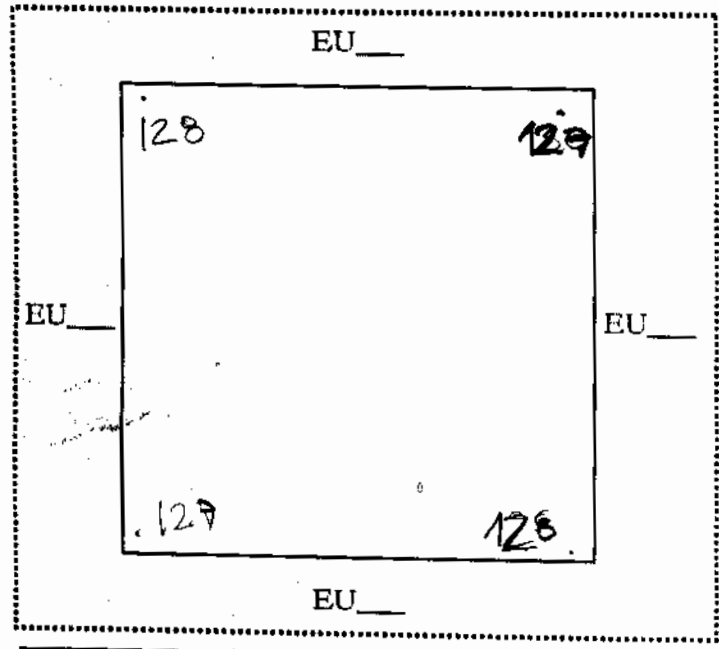

Datum: 994.00

Note refs _____

PAREP 2007 LOT FORM

Excavator JRR/8

Date 27/6/07

Op/SubOp/Lot: 03/33/10

Ex. Unit B

Size (NxEx) 1 x 1

Site: El Guayabal

Str # 16

Initial Lot? —

Prev. lot 9

Next lot —

BGS: —

Initial elev.: NW 992.72 NE 992.73 SW 992.73 SE 992.72

Final elev.: NW 992.50 NE 992.51 SW 992.48 SE 992.50

Reference corner: NE N 220.24 E -383.32

Deposit / Type — / —

Soil type Barro pegajoso
Munsell/Color —

Drawings — Contents Pedernal (1)

Photo/Digital —

Description/Sketch (with measurements):

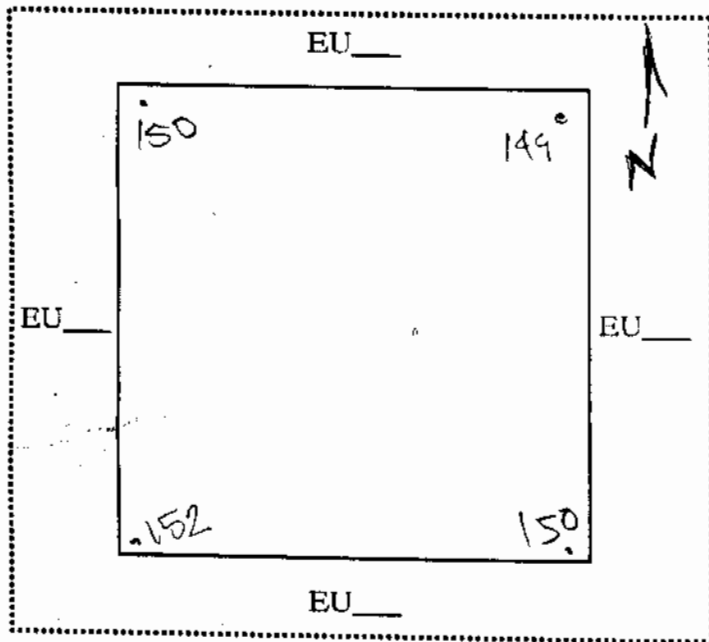

Datum: 994.00

Note refs —

PAREP 2007 LOT FORM

Excavator JRE/8

Date 27/6/07

Op/SubOp/Lot: 03/33/11

Ex. Unit A

Size (NxEx) 1x1

Site: #1 Guayabal

Str # 16

Initial Lot? — Prev. lot 8 Next lot — BGS: —

Initial elev.: NW 992.72 NE 992.74 SW 992.70 SE 992.70

Final elev.: NW 992.54 NE 992.56 SW 992.54 SE 992.54

Reference corner: NE N 220.24 E -308.32

Deposit / Type — / —

Soil type — Munsell/Color —

Drawings — Contents Ceramica (12)

Photo/Digital — Reduval (3)

bahareque (1)

Description/Sketch (with measurements):

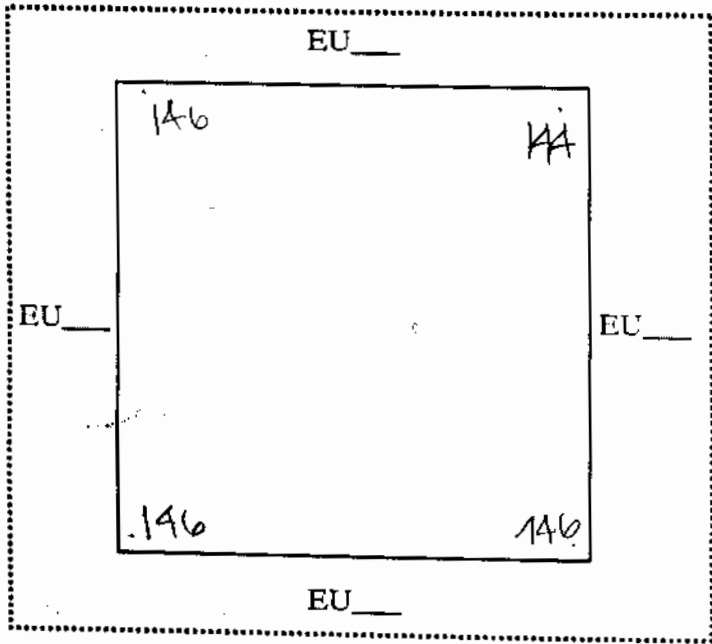

Patm: 994.00

Note refs —