

---

Four Valleys Archive

Anthropology

---

2003

## EPV 04-04 Lot Forms 2003

Jonathan Bettin

Follow this and additional works at: <https://digital.kenyon.edu/honduras>



Part of the Archaeological Anthropology Commons

---

### Recommended Citation

Bettin, Jonathan, "EPV 04-04 Lot Forms 2003" (2003). *Four Valleys Archive*. Paper 96888.  
<https://digital.kenyon.edu/honduras/96888>

This Lot Card is brought to you for free and open access by the Anthropology at Digital Kenyon: Research, Scholarship, and Creative Exchange. It has been accepted for inclusion in Four Valleys Archive by an authorized administrator of Digital Kenyon: Research, Scholarship, and Creative Exchange. For more information, please contact [noltj@kenyon.edu](mailto:noltj@kenyon.edu).

PAREP LOT CARD

SITE S-01

STR. 1

Op. 4/4/1

Level 1

Locus \_\_\_\_\_

Prev. lot Surface

Date 6/30/03

Deposit surface

Next lot 2

Excavator JPB-7

Dep type Hur. Mitch sediment

Soil type clay

Soil Color 2.5Y 4/2 dark grayish brown

Notes pg 1, 2

Drawings \_\_\_\_\_

Photos \_\_\_\_\_

Digital Images \_\_\_\_\_

Description: 2x2m test pit. East side of Str. 1

goals: determine if standing wall is ancient (preserved terrace) or modern.  
possibly find edge of str. 1

Sketch of Unit (when closed, include initial and final depths and cardinal direction of corners)

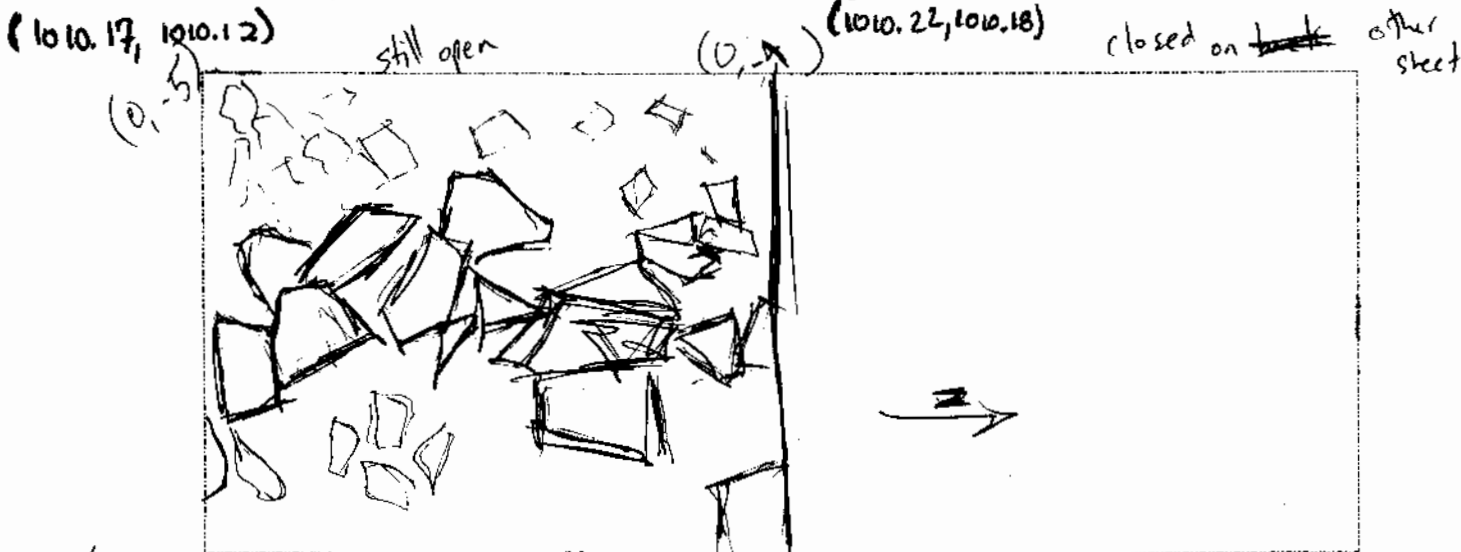

Contents: toha, barbed wire, bottles, bottle cap, 1980 coin,  
(1009.96) 1009.825

Pg 2

PAREP LOT CARD

SITE S-01

STR. 1

Op. 4/4/1

Level 1

Locus \_\_\_\_\_

Prev. lot surface

Date 7/1/03

Deposit surface / tumbled

Next lot 2

Excavator 7

Dep type Hor. Mch Sediment

Soil type clay

Soil Color 2.5Y4/2

Notes pg 1, 2

Drawings \_\_\_\_\_

Photos \_\_\_\_\_

Digital Images \_\_\_\_\_

Description:

Sketch of Unit (when closed, include initial and final depths and cardinal direction of corners)

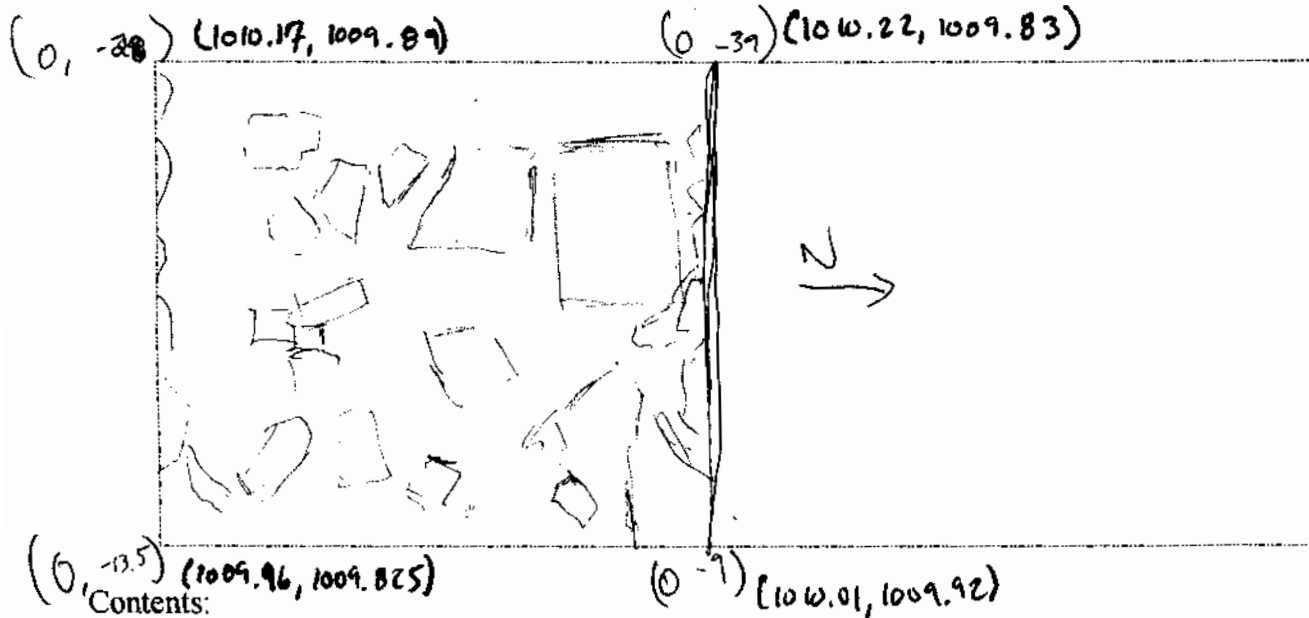

(0, -13.5) (1009.96, 1009.825)  
Contents:

(0 -9) (1010.01, 1009.92)

- 2 ceramic
- 7 toba
- 4 modern

PAREP LOT CARD

SITE S-01

STR. 1

Op. 4/4/2

Level 2

Locus \_\_\_\_\_

Prev. lot 1

Date 7/1/03

Deposit buried surface

Next lot 3

Excavator 7

Dep type Natural Humus

Soil type sandy loam

Soil Color 10YR 3/2 very dark grayish brown

Notes p2  
Photos \_\_\_\_\_

Drawings \_\_\_\_\_  
Digital Images \_\_\_\_\_

Description: fall on western edge may be platform  
clearer on Eastern side  
some large Toba blocks were found

Sketch of Unit (when closed, include initial and final depths and cardinal direction of corners)

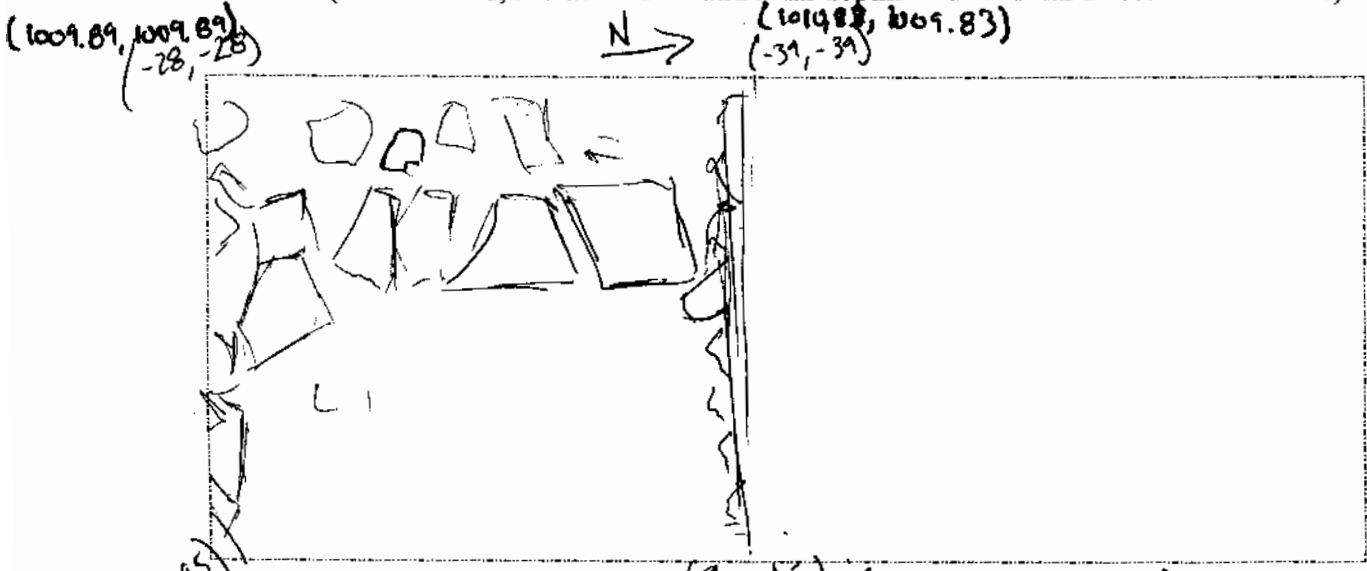

Contents: glass, Toba, Plastic, charcoal, clay, bone

(1009.825, 1009.665)

- 7 ceramic
- 111 toba
- 9 bone
- 15 fired red clay
- 6 modern

PAREP LOT CARD

SITE S-01

STR. 1

Op. 4/4/3

Level 3

Locus \_\_\_\_\_

Prev. lot 2

Date 7/1/03

Deposit over burden

Next lot 4

Excavator 7

Dep type collapse

Soil type sandy loam - clay

Soil Color 10YR 4/2 dark grayish brown

Notes 2, 3, 4, 5

Drawings \_\_\_\_\_

Photos \_\_\_\_\_

Digital Images \_\_\_\_\_

Description: Stone in ~~the~~ eastern part, small burned earth deposit <sup>was</sup> in south central part. stone fall appears to be random.

Sketch of Unit (when closed, include initial and final depths and cardinal direction of corners)

(1009.89, 1009.89)  
(-28, 28)



(37, -3) (1010.83, 1010.83)

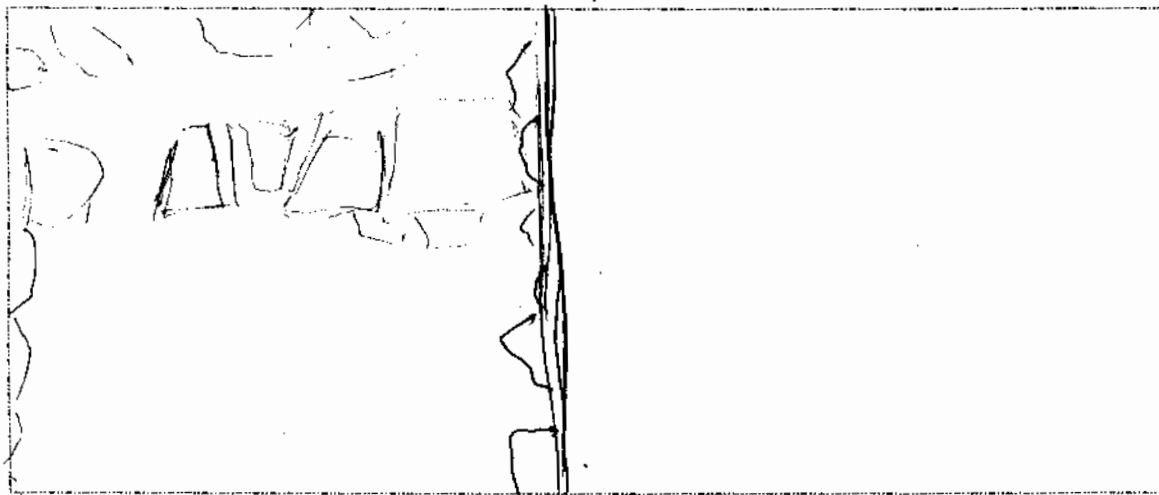

(21.5, 48)

(34.5, 50) (1009.665, 1009.51)

Contents: Toba, Toba sculpture, fired clay,

(1009.665, 1009.48)

- 33 Toba
- 69 fired clay
- 2 modern

PAREP LOT CARD

SITE 501

STR. 1

Op. 44/5

Level 2-3

Locus \_\_\_\_\_

Prev. lot 4

Date 7/3/03

Deposit overburden

Next lot 6

Excavator 7

Dep type collapse

Soil type Sandy loam-clay

Soil Color 10 YR 4/2

Notes \_\_\_\_\_

Drawings \_\_\_\_\_

Photos \_\_\_\_\_

Digital Images \_\_\_\_\_

Description:

Sketch of Unit (when closed, include initial and final depths and cardinal direction of corners)

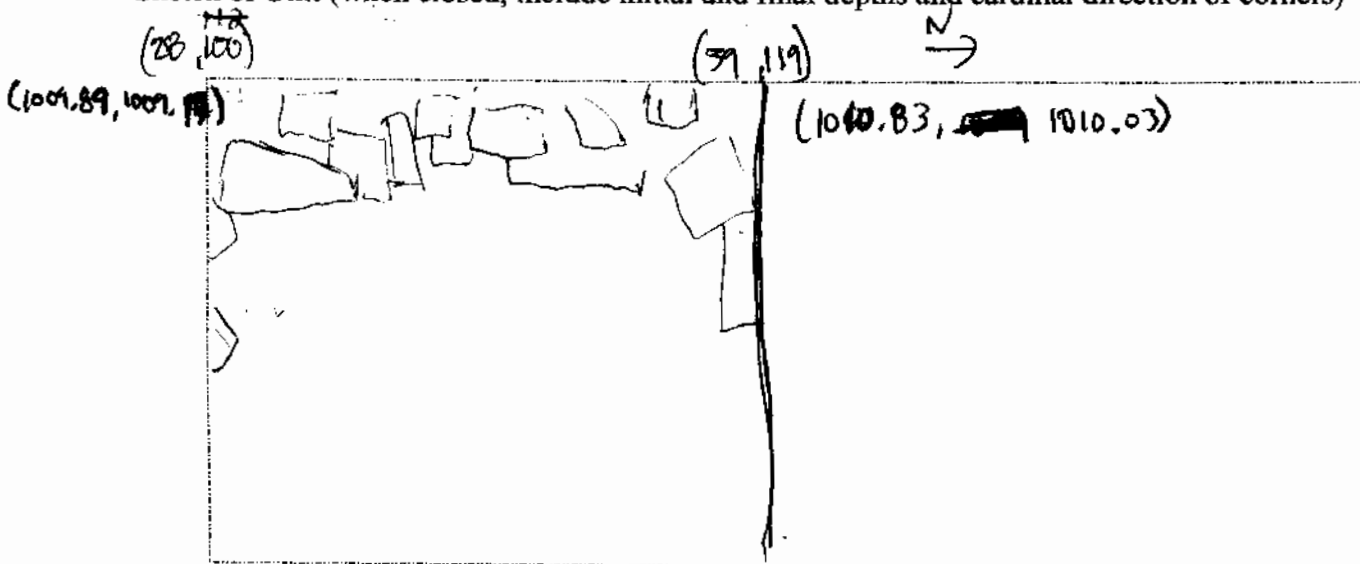

Contents:

Toba, ceramics, bone, ~~burned~~ earthen floor

(1009.23, 1009.23)

(1009.26, 1009.26)

- 30 ceramic
- 208 toba
- 3 shell
- 2 bone
- 6 fired clay

see back  
for  
drawing attention

PAREP LOT CARD

SITE S-01

STR. I

Op. 4/4/4

Level #3

Locus \_\_\_\_\_

Prev. lot 3

Date 7/2/03

Deposit over burden

Next lot 5

Excavator Z

Dep type collapse

Soil type sandy loam clay

Soil Color 10 YR 4/2

Notes 5, 6

Drawings \_\_\_\_\_

Photos \_\_\_\_\_

Digital Images \_\_\_\_\_

Description:

Sketch of Unit (when closed, include initial and final depths and cardinal direction of corners)

(1009.89, 1009.89)  
(28, 28)

(39, 39) (1010.83, 1010.83)

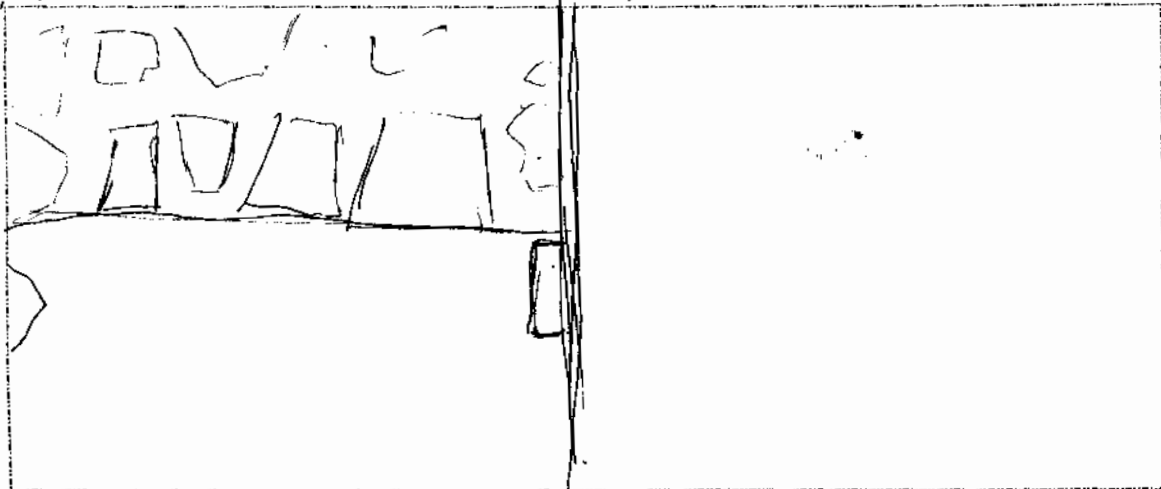

(98, 73)  
Contents:

(50, 75) (1009.51, 1009.26)

(1009.48, 1009.23) Tools, ceramics, bone

48 tools

PAREP LOT CARD

SITE 01

STR. 1

Op. 4/4/16

Level 4

Locus \_\_\_\_\_

Prev. lot 5

Date 7/8/03

Deposit surface

Next lot 7

Excavator JPB-7

Dep type floor

Soil type stucco floor

Soil Color 2.5Y 6/6 olive yellow

Notes 8

Drawings \_\_\_\_\_

Photos \_\_\_\_\_

Digital Images \_\_\_\_\_

Description: stucco floor 1m x 2m  
next to west wall  
reduced to 1m x 1m in NW corner because  
ancient wall ends @ subfloor

Sketch of Unit (when closed, include initial and final depths and cardinal direction of corners)

(1009.17, 1009.01)  
116

(1010.03, 1009.88)  
134

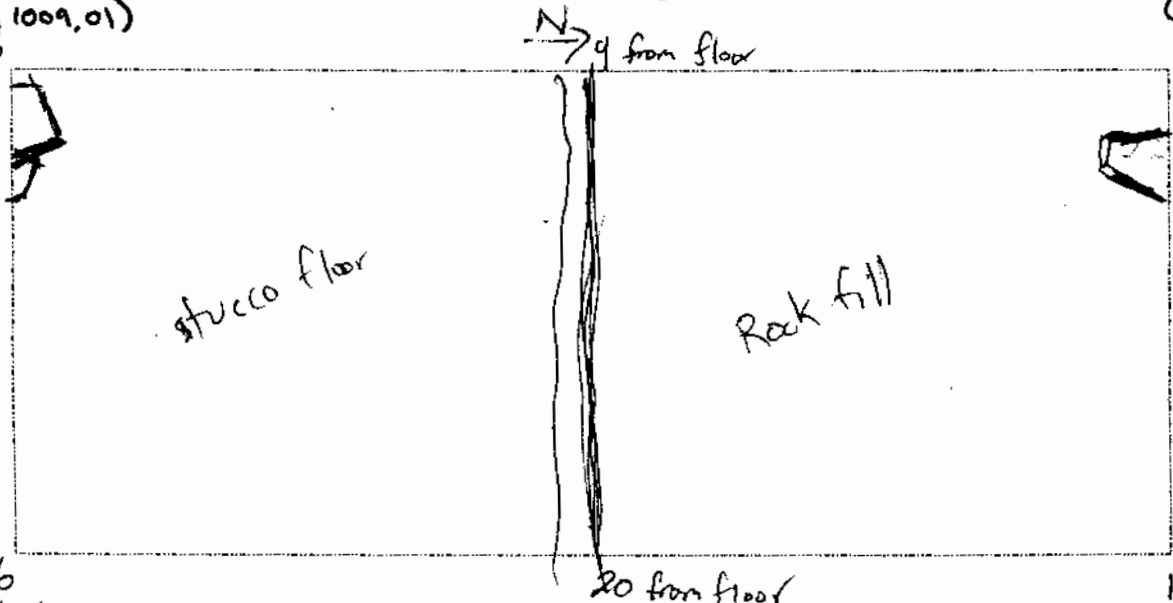

Contents: Stucco, Toba, ceramic (piece),



PAREP LOT CARD

SITE 01

STR. 1

Op. 4/4/7

Level 5

Locus \_\_\_\_\_

Prev. lot 6

Date 7/8/03

Deposit surface

Next lot 8

Excavator JPB-7

Dep type subfloor

Soil type large rock rubble

Soil Color \_\_\_\_\_

Notes 9

Drawings cobble floor plan

Photos \_\_\_\_\_

Digital Images \_\_\_\_\_

Description: large rock sub floor  
expecting water  
bottomed at small amount of water and cobble/stucco floor  
2x1m NW corner  
see cobble floor drawing

Sketch of Unit (when closed, include initial and final depths and cardinal direction of corners)

182 (1009.88, 1009.40)

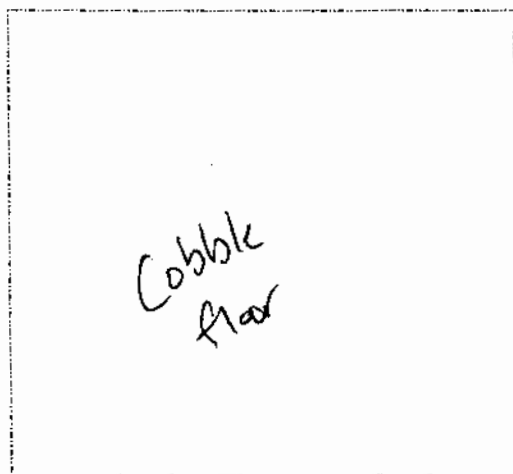

Contents: Rock