

2003

EPV 04-10 Lot Forms 2003

Jonathan Bettin

Follow this and additional works at: <https://digital.kenyon.edu/honduras>

 Part of the Archaeological Anthropology Commons

Recommended Citation

Bettin, Jonathan, "EPV 04-10 Lot Forms 2003" (2003). *Four Valleys Archive*. Paper 96893.
<https://digital.kenyon.edu/honduras/96893>

This Lot Card is brought to you for free and open access by the Anthropology at Digital Kenyon: Research, Scholarship, and Creative Exchange. It has been accepted for inclusion in Four Valleys Archive by an authorized administrator of Digital Kenyon: Research, Scholarship, and Creative Exchange. For more information, please contact noltj@kenyon.edu.

PAREP LOT CARD

SITE S-01

STR. 4/5/5

Op. 4/10/1

Level 1

Locus _____

Prev. lot surface

Date July 10/03

Deposit surface

Next lot 2

Excavator JPB-7

Dep type Humus

Soil type loamy sand

Soil Color 10YR 3/2

Notes 10/12/11
Photos _____

Drawings _____
Digital Images _____

Description: 2x2 m just south west of STR
possible midden ~~off~~ from patio.
tumble

Sketch of Unit (when closed, include initial and final depths and cardinal direction of corners)

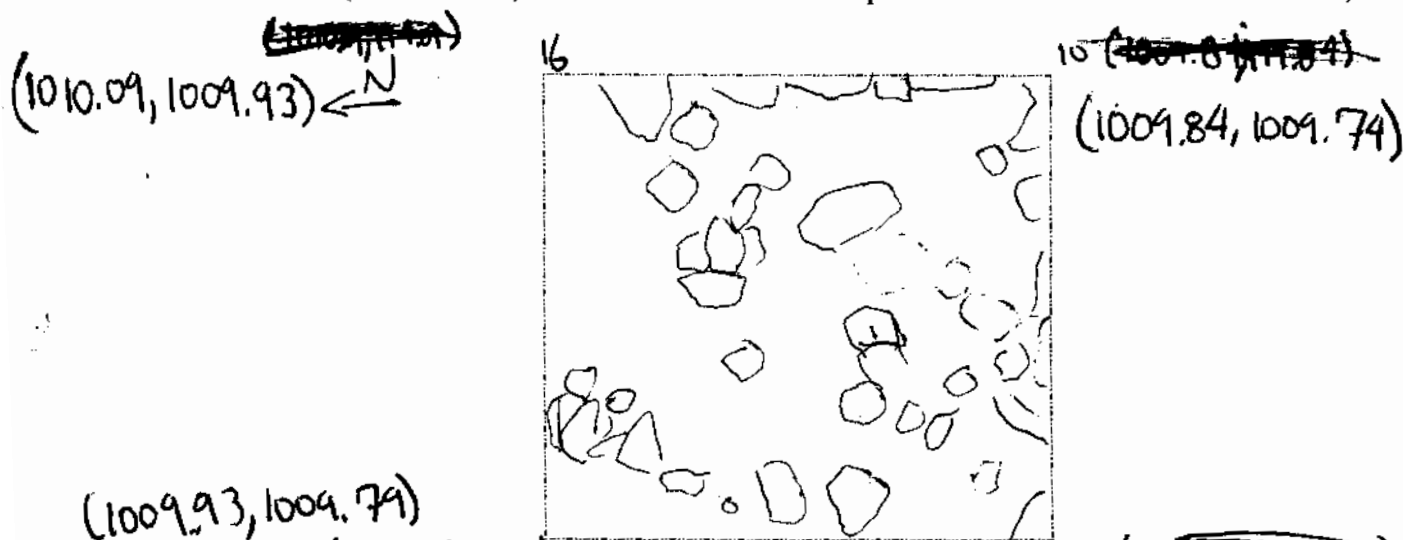

Contents: Toba, obsidian, bone, modern materials

- 59 regular ceramics
- 12 diagnostic ceramics
- 69 toba
- 16 bone
- 11 obsidian
- 1 shell

17 modern material

PAREP LOT CARD

SITE 01

STR. 9/45

Op. 4/10/2

Level 2

Locus _____

Prev. lot 1

Date July 14, 2003

Deposit overburden

Next lot 3

Excavator JPB-7

Dep type inturn

Soil type clay

Soil Color 2.5Y 5/6

Notes 13, 14, 15

Drawings _____

Photos _____

Digital Images _____

Description:

orange clay,
artifacts found near top and bottom, none in center

Sketch of Unit (when closed, include initial and final depths and cardinal direction of corners)

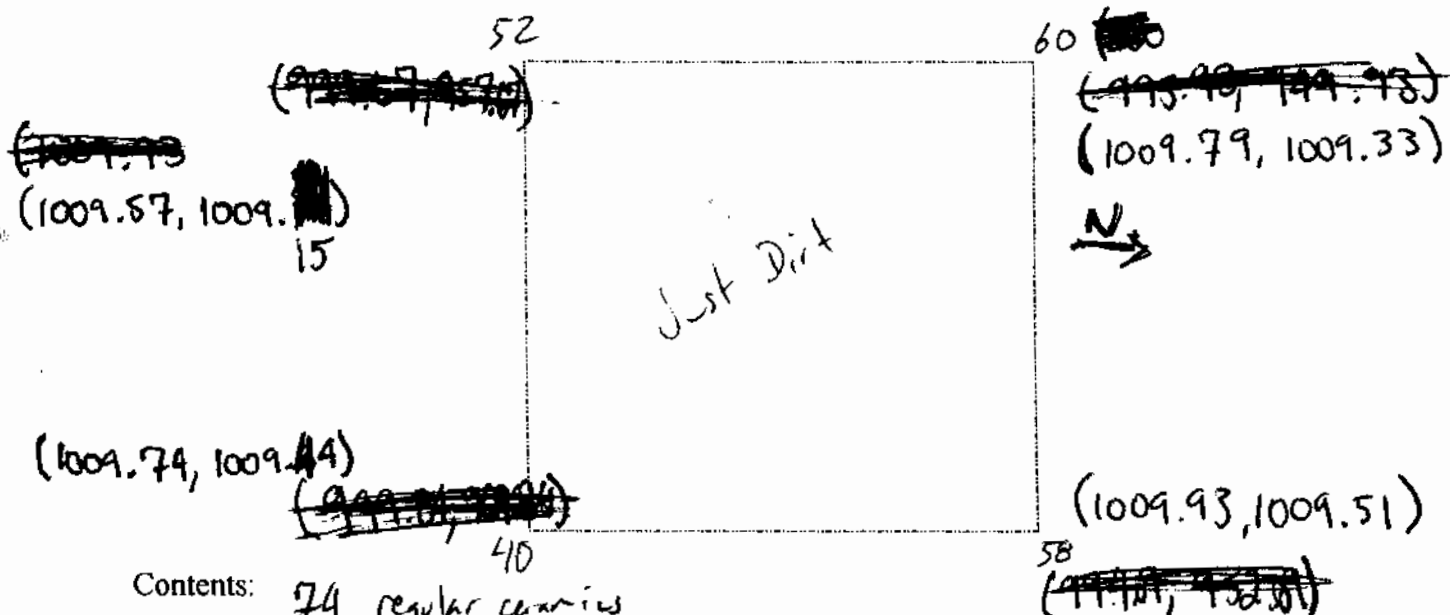

Contents:

- 74 regular ceramics
- 10 diagnostic ceramics
- 53 toba
- 2 bone
- 5 modern

PAREP LOT CARD

SITE 01

STR. 9,4,5

Op. 4/10/13

Level 3

Locus _____

Prev. lot 2

Date July 16, 2003

Deposit over burden

Next lot 4

Excavator JPB-7

Dep type collapse

Soil type clay

Soil Color 10YR 4/3

Notes 15, 16

Drawings toba blocks

Photos _____

Digital Images _____

Description: ~~bottom half of unit step down for lot~~

stucco Floor uncovered, at End of level

Sketch of Unit (when closed, include initial and final depths and cardinal direction of corners)

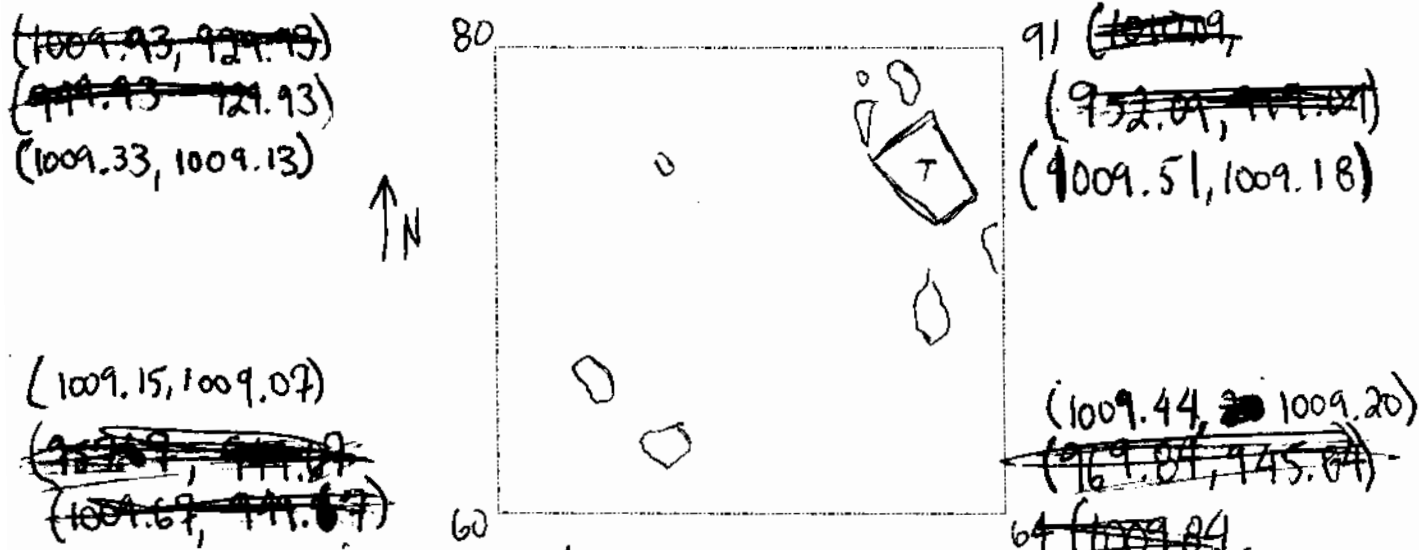

Contents: ceramics, toba, obsidian

- 185 regular ceramics
- 38 diagnostic ceramics
- 3 striated ceramic
- 14 toba
- 9 bone
- 2 obsidian
- 3 chert
- 1 hard stucco

- 4 wood
- 4 pigment stones
- 1 large metate (broken)

PAREP LOT CARD

SITE S-01

STR. 9/4/5

Op. 4/10/4

Level 3

Locus _____

Prev. lot 3

Date July 18, 2003

Deposit surface

Next lot 5

Excavator JPB-7

Dep type floor

Soil type clay

Soil Color 10YR 4/3

Notes 18, 19, 20, 21

Drawings floor plan, toba blocks

Photos _____

Digital Images _____

Description: uncovering floor completely
floor missing in NW corner
wall and sub floor on East side

Sketch of Unit (when closed, include initial and final depths and cardinal direction of corners)

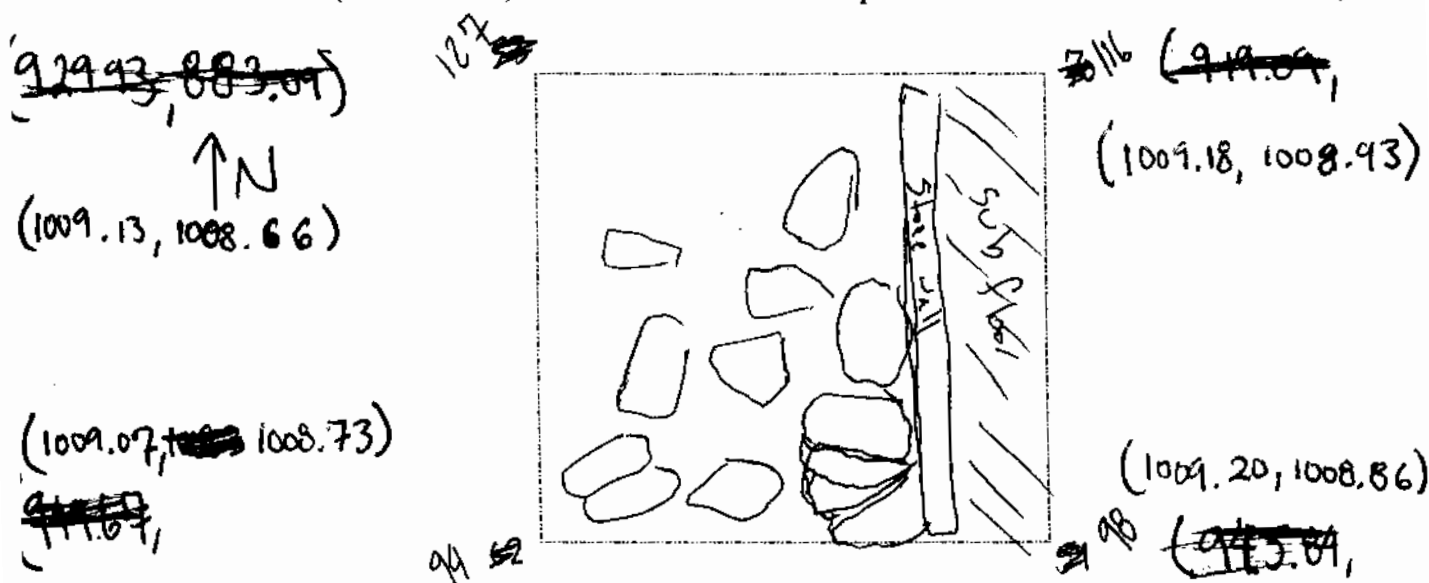

Contents:

- | | |
|--------------------------|-------------------|
| 163 diagnostic ceramics | 19 hard stucco |
| 812 regular ceramics | 6 chert |
| 7 striated ceramics | 9 obsidian |
| 5 copador ceramics | 3 wood |
| 323 toba | 17 bone |
| 3 pigment stone | 1 polished stone |
| 8 metate parts | 1 serpentine bead |
| 5 large metates (broken) | |

PAREP LOT CARD

SITE S-01

STR. 9/4/5

Op. 4/10/15

Level 4

Locus _____

Prev. lot 4

Date July 24, 2003

Deposit refuse

Next lot 6

Excavator JPB

Dep type subfloor fill

Soil type Sandy loam

Soil Color 10YR 3/3

Notes 22, 24

Drawings _____

Photos _____

Digital Images _____

Description: under stone floor
1m x 1.4m north side

Sketch of Unit (when closed, include initial and final depths and cardinal direction of corners)

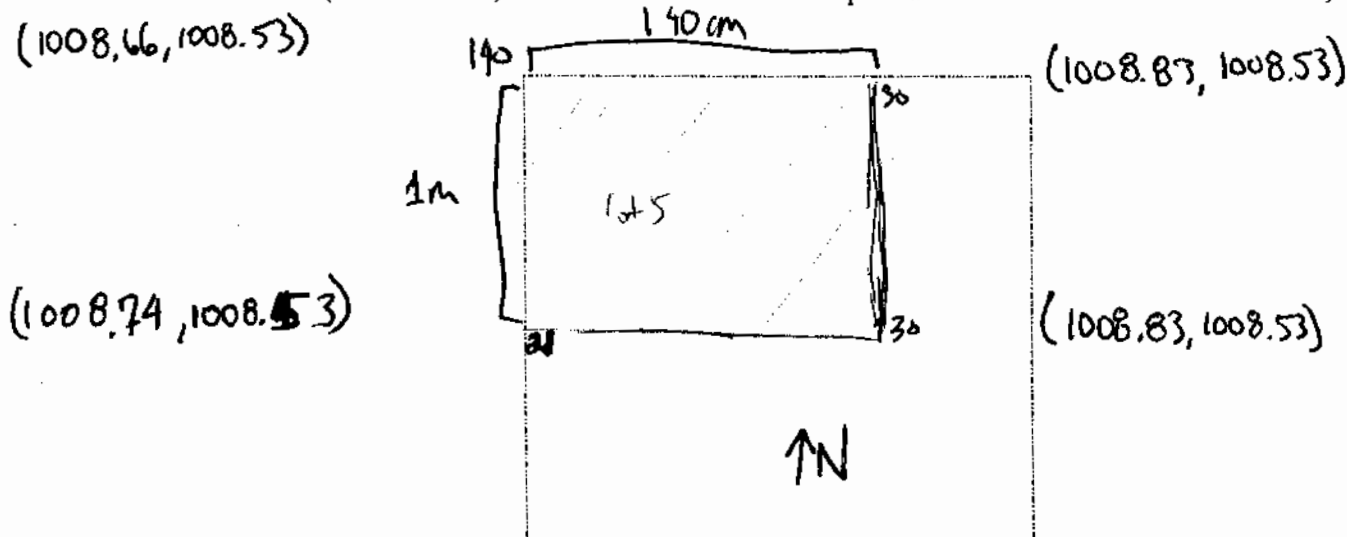

Contents: 88 Diagnostic ceramics
245 regular ceramics
27 striated ceramics
18 Copador ceramics
5 tuba
18 bone
7 chert

4 obsidian
5 metate parts
1 monkey stamp
1 incensario
1 bone bead
1 worked bone
1 ceramic ear

PAREP LOT CARD

SITE S-01

STR. ~~111~~ 9

Op. 4/10/6

Level 4

Locus _____

Prev. lot 5

Date July 26, 2003

Deposit refuse

Next lot 7

Excavator JPB 7

Dep type subfloor fill

Soil type Sandy loam

Soil Color 10 YR 3/3

Notes 24

Drawings _____

Photos _____

Digital Images _____

Description: under floor.

Sketch of Unit (when closed, include initial and final depths and cardinal direction of corners)

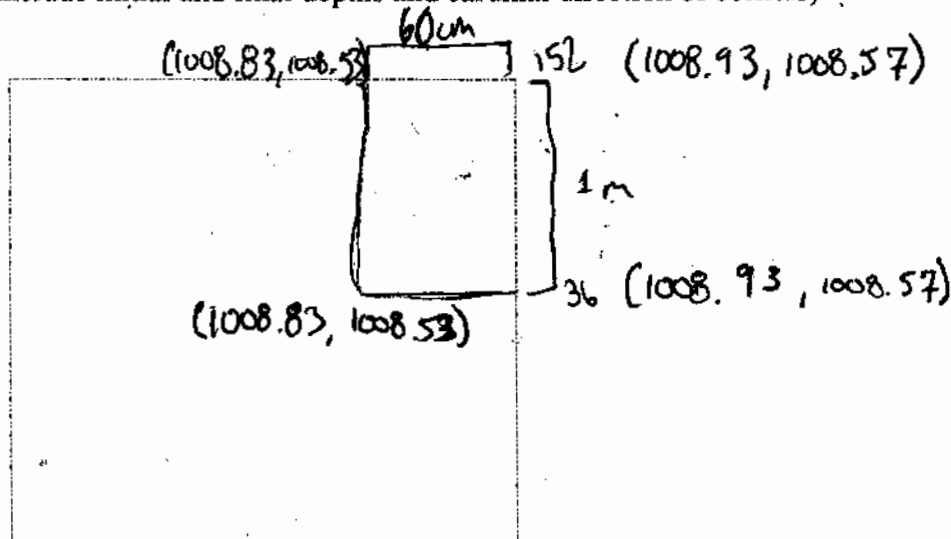

Contents: 46 diagnostic ceramics
207 regular ceramics
7 striated ceramics
13 expedior ceramics
1 toba
2 hard stucco
11 bone
6 chert

1 obsidian
1 figurine head
12 metate parts

PAREP LOT CARD

SITE S-05

STR. 9,4,5

Op. 4/10/7

Level 5

Locus _____

Prev. lot 6

Date July 26, 2003

Deposit sterile

Next lot 8

Excavator JPB-12

Dep type sediment

Soil type dry

Soil Color 10 YR 5/6

Notes 24

Drawings _____

Photos _____

Digital Images _____

Description: ~~#~~ 1x1m in NE corner.
sterile
hit water

Sketch of Unit (when closed, include initial and final depths and cardinal direction of corners)

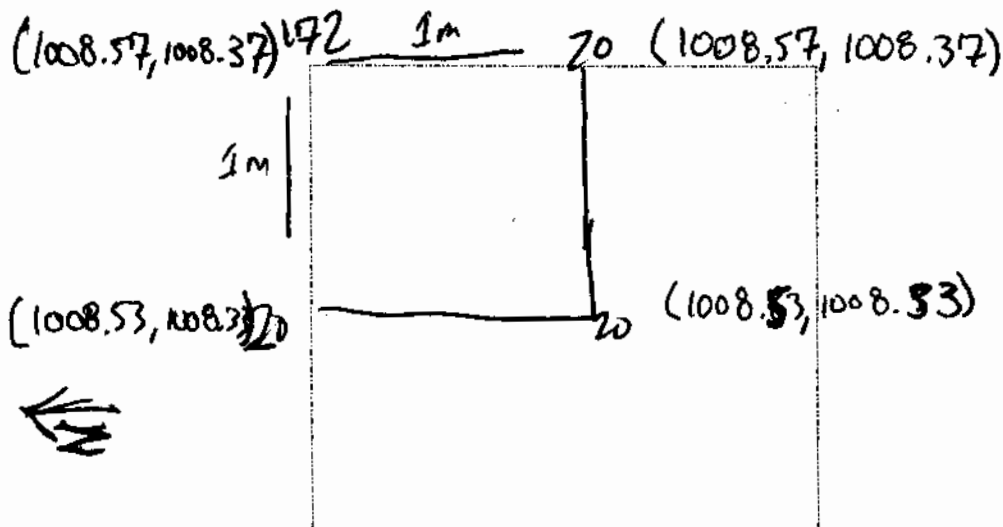

Contents: Nothing