

2003

## EPV 002 Canuto Field Notes 2003

Marcello Canuto

Follow this and additional works at: <https://digital.kenyon.edu/honduras>



Part of the Archaeological Anthropology Commons

---

### Recommended Citation

Canuto, Marcello, "EPV 002 Canuto Field Notes 2003" (2003). *Four Valleys Archive*. Paper 96900.  
<https://digital.kenyon.edu/honduras/96900>

This Field Notes is brought to you for free and open access by the Anthropology at Digital Kenyon: Research, Scholarship, and Creative Exchange. It has been accepted for inclusion in Four Valleys Archive by an authorized administrator of Digital Kenyon: Research, Scholarship, and Creative Exchange. For more information, please contact [noltj@kenyon.edu](mailto:noltj@kenyon.edu).

2003  
2-1

4/25/03

Wednesday

Spent morning at EP discussing w/ Roberts and Acacia the nature of their project. Themes regarding tourism, Guayas, archaeology, and Maya myths were raised.

Rob + Acacia will begin w/ a map of their universe (roughly the EP group and surrounding houses) and then plan out an interview strategy.

EEB, Santiago, and JPB are off mapping ER near S-18 - heading E toward the river.

MAC and PCG w/ Lito and the MAYOR are heading to the town of LAS JUNTAS where a site has been reported multiple times. The goal is to determine the veracity of the reports as well as the general atlay, orientation, size, and architecture.

→ S-206 is the next extra-EP Valley site number available.

→ TRIP to LAS JUNTAS: Ca. 35 min, using the CAFETAL breach. Terrain river crossing, but road in de shape, though relatively rough in some spots.

→ Sites at Las Juntas: S-206/7. Ca. 5 min. before reaching the center of LJ, a small intermontane pocket opens along the Oeste. It measures roughly 500-700 m in width.

Within this small pocket, 2 sites (on either side of the river) were located. Seen from the road they appeared to be cobbles masonry buildings organized in nuclear pattern groups.

We unsuccessfully sought the permission of the owners to enter on the land even though the terrain was only cattle pasture. We decided to measure and map from the road only. This decision limited our visibility of the site.

LJ seems like a cobbles masonry site in the LC tradition of Copan. Its greatest resemblance is that of El Raicod. Even the size, orientation, and placement of its mounds suggest an LC date.

Surface collection along the road at points where the mounds had been cut was undertaken.

Obsidian blades were recovered, though no patently recognizable ceramics were recovered.

We also explored across the river where the terrain was also somewhat flat though rising more steeply than on the S-206 side (E). Small high cobbles mounds were encountered (3) and a possible patio group under some very thick brush. These finds helped constitute ~~S-206~~ S-207.

Overall the 2 sites appear to compose a small community inhabiting an intermountain alluvial pocket of the Ocote. It appears LC in date. The lack of clear routes from this pocket to Copan

2003-2-3

might suggest that its placement is related to land patterns rather than strategic placement. However, though its location, in and of itself, might not have warranted settlement but combined with the local topography it was selected as beneficial.

Return to EP+ at 3:30 pm.

Mayor did not come w/ us to LI due to an emergency meeting.

PLG went home.

MAC to EP to record briefly the looter's ~~pit~~ pit atop Str. 1.

~~\_\_\_\_\_~~  
The looter's pit atop Str. 1 of EP was undertaken by several children who were frightened off once discovered in flagrante. They were, however, successful in excavating roughly 30cm from the top edge of the structure along its E edge. Stones were tumbled to the foot of the str. and a soil change was made manifest. The stones look like fill stones that compose the majority of this architectural mass.

It is possible that ~~there~~ a terrace line has been exposed along the E edge of the pit, but only more controlled excavation can answer these questions. At the moment the fear remains that there will be repeated efforts, as well as worsening state of the structure through continued and frequent rains.

A discussion with the Mayor is warranted.

2003-2-5

2003-07-03

# Reconnoiter to Rio Lindo for Agua Brena

Began at Agua Brena

Continued along ridge to W of R. Majá

Descent along ridge for ca. 1.5 km

Cerro Azul was directly N of us.

1.5 km

Descent W to small quebrada (Limon) on Arnoldo Morales's land

S-211 encountered on E side of Q. Limón

Walk along Q Limón until it debauched into R. Majá

Walk along W edge of R. Majá - following old path that followed certain hill-slopes

1 km

Descent to river's W edge

River crossing - reaching the E edge

Walk N along E edge of R. Majá

The valley is very narrow and steep-walled.

2 km

Crossing of hammock bridge

widening of valley

2003 -

2-7

S-211 Upon walking along a westerly route at fin Agua Buena parallel to the R. Maja but at a higher elevation we descended W off of the ridge overlooking the R.M. down into a small (75x75m) intermontane pocket carved by the Q. Limón where we encountered S-211 - a residential patio group with a large (3m high) structure that speaks to functions ~~and~~ and activities that, in my opinion, lie beyond the traditional purview of the household.

Could this have been a site along a route to Q from EP that was located along a smaller Quebrada?

Most likely this was one of many potential routes in and out of the EP Valley.

The main structure of 211 (Str. 1 - M01) is rather tall and large. However, the top feels very narrow, leading me to believe it has a superstructure of adobe masonry still on its platform top.

Throughout this area of the Q. Limón, there are small pockets of flat land on both sides. The Q.L. is only 1m wide in places so crossing is easy. The pockets are surrounded by very steep rises 30-50m slopes. Along this Q., the distance downriver to R.M. is equal to the distance along the ridge trail...

S-212

Artifact scatter along terrace edge on  
W side of R. Mijé.

No visible mounds - perhaps field artifact  
trash - the materials used when ancient inhabitants  
made terraces in this region.

2003-07-16

Beginning excavations at SOP 10 of Op. 2 at S-02.  
 Feliberto and Elvin are excavating.

YANN (YDC) → Op 02/05 Tulio/Elias  
 Roberto (JRR) → Op 02/07 Martin/Jorge



Placed 7 new SOPs in S-02 on 2003-07-15. Excavation commenced at SOPs 5 and 7 by YDC and JRR respectively.

Excavation at SOP 10 begun by MAC 2003-07-16.

Both JRR and YDC are screening their units - at a rate of  $1/4$  Lachets.

- The SOPs 5/6 are placed on N edge of Str. 04 to reveal architecture of S-02.
- SOP 8 is located to recover the SE corner of Str. 5.
- SOPs 10/11 are located at the backs of Strs 4/5 for potential midden deposits.
- SOPs 7/9 are located to recover PLAZA architecture.



02/10/01

Loose dark humus soil w/ very few artifacts has been revealed in the first 10cm of this unit. Screening is being completed at 1/4 rate in order to test its efficacy, and overall impact on material recovery.

The unit might be stepped too closely to Str. 4 and might therefore reveal the S facade of the structure. If so, the unit will be stepped back 1-2m south to reveal potential midden/refuse areas.

## Initial elevations

	N	E	Z
NW	-1.41	-41.88	999.53
→ NE	-2	-10	999.61
SE	-3.86	-40.54	999.04
SW	-3.29	-42.45	998.96

The NE corner will be the "GREEN CORNER"

A very humid dark humus has resulted in the first 10cm of S0P10. There is little evidence of tumbler so far - perhaps this side of the str. has been buried more deeply by soil washing from rains etc. - than in other parts of the site - vis-a-vis the thick humus layer has been found.

Artifact levels here a very low so far in the unit.

Overall the 3 Sops (5, 7, 10) are verifying the LC nature of the latest phase of S-02. The ceramics appear to reflect the COVER style at Copan. However, what appears lacking, so far, is CASACA. Perhaps more precisely, it is not as abundant as a LC deposit in Copan would be.

Certainly Utilitarian Wares should not be transported long distances, but the lack of the CASACA production sequence might be telling nonetheless.

02/10/01 Afternoon

Workers will scrape and level the unit for a lot change. There does NOT seem to be a soil color change - suggesting that the humus layer is indeed thicker in S0P 10 than in the others S0Ps... Given the general drainage patterns of this part of the ET valley, this area might have seen a great deal of accumulation over the centuries.

→ Lot will change arbitrarily though level will remain at 01.

Upon closure of Lot 1, excavation of Lot 2 is proving that the humus layer continues downward. We have not revealed a new depositional layer.

- 02/10/02

Excavation within this unit is resulting still of almost no artifacts. The soil after 12-15 cm depth is still dark humus.

2003-2-13

Checking the notes from last year, it has become clear that the "piazza floor" missing in Op 2/SOP 1 from 2002, should be somewhere at ~~998.90m~~ 998.90m.

In SOP 7, the present elevation of the unit is 999.6m. It is roughly 25cm higher than 02/01.

2003-2-14  
~~2003-2-14~~

MAC on reconnaissance to  
Sta. Cruz. See 2003-2-[26-29]  
for NOTES

2003/7/17  
YDC /10

• THEY ARE FINISHING LEVEL 1 LOT 2

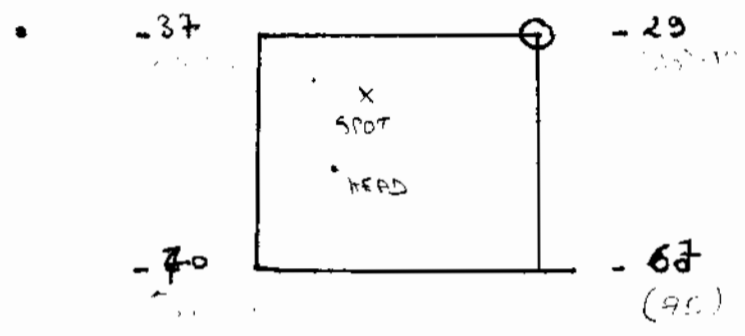

(-37 + -29 are 0.5 ft deeper than Navetta's elevations & thought stores were an artificial feature)

• THEY ARE OPENING LOT 3

• FEW THINGS ARE FOUND

- HOWEVER IN ONE SPOT THEY FOUND
  - BJ
  - CERAMICA
  - 2 NICE OBSIDIANA

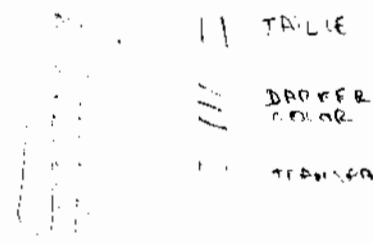

• BIG SHOCK: A HEAD FOUND CLOSE TO BJ, CERAMICA...



OBSIDIANA

17/JUL/2003

JRR / B

Feribarro y Elvin concluyeron el lote 3, inmediatamente dije que perfilaran bien el pozo para poder tomar una fotografía con la cámara de Yann, pero desafortunadamente no tenía más fotos, así que pues deude sacar o mejor dicho Hacer un dibujo sin escala, solo a simple vista de todo el pozo y bueno en el dibujo puede observarse el derrumbamiento de la estructura 4; muy pocos fragmentos se encontraron.

El color de la tierra sigue siendo el mismo un color café oscuro, poco pegajosa

2003-7-18

Excavation in SOT continues in LOT 3 in order to better reveal wall fall from Str. 4's S facade.

→ 2 pictures were taken from S and from N.

Lot 4 will commence w/ the removal of the tumble and the exposure of the surface upon which the tumble lies.

A few more ceramics have been recovered in this lot but not enough to suggest a reaction yet.

This unit has begun to produce a large number of artifacts intermingled in the backside tumble of Str. 4.

This lot will be somewhat larger than the rest because the tumble seems quite thick - especially throughout the N half of the unit. It does not appear as if we ~~will~~ will encounter the S facade of the structure in this unit.

The E/W profiles of this unit exhibit the thickness ~~of the~~ of the loam layer to the S of this structure.

---

2003-07-19

Removal of another 5-10 cm of tumble.

2003-07-18

Roberto's unit - OP 02/07/[05-06]

Excavation in S0P7 has revealed a very sandy-orange loam layer that seems almost bereft of artifacts. Some have appeared in the top part of this level, but appears to be limited to this section. I am becoming convinced that this is a natural layer underlying the surface which probably was located somewhere at ca. 35-50 cm below surface.

Excavation has found the bottom of this Lot 5 - by uncovering an underlying layer of cobbles/sand/gravel that appears naturally deposited.

Excavation of Lot 5 involved only the W half of the unit (1x2m). Given the lack of artifacts, this lot will be excavated to affirm the sterile status of these layers.

→ Lot 6 excavation of this cobble and gravel filled layer was undertaken only in the SW 1x1 m corner of the unit. Only 10cm of this stratum were excavated given the cumidity/difficulty of its excavation.

~~For the~~ No change in soil was encountered at the closure of the unit.

2003-07-19 → Drawing of W profile  
Backfilling of unit.

2003-07-21 Monday Cloudy (raining)

Beginning a 2nd week of excavations at S-02 (Cafetal).  
With a new crew of workers (Dimas/Enrique), 4 SOPs are  
currently open (SOPs 5, 8, 9, 10)

YDC - SOPs 5/9  
JCR - SOP 8  
MAC - SOP 10

### SOP 10

Termination of Lot 9. Removal of all timber from S facade of  
Str. 4. The soil has been much looser and somewhat  
lighter than ~~the~~ the primarily removed lots.

Excavation is now removing the last of the timber  
and now formal surface is being revealed. Rather, a  
somewhat harder and more compact soil underlies  
the timber. It appears to be a living surface though not  
formally finished.

The soil of this "surface" is a lighter orange-brown  
color that might suggest some construction material  
mixture - though no official flooring is present.

It appears from the 2 saturation trench covers that  
the humus layer extends almost completely  
to this original surface... ●



Op 02/10/04

Surface revealed. It is an earthen clayey surface that seems to have been tamped down by use and construction.

The surface seems to be composed of a compacted soil/clay mixture containing some smaller pebble pieces as well.

I think that I will section the unit for a 1x2m unit in the W half of the unit. This will allow the extent of this floor to be investigated without destroying the entire surface in this unit.

Furthermore, excavating below this floor will study/reveal if there are earlier phases of architecture at S-02.

The excavation here is uncovering a very clayey orange-brown soil that is sterile. Excavation will continue in this lot until a soil change.

2003-07-22

Excavation in Lot 5 of OP 02/10 continues w/  
 Felberto ~~and~~ Elvin. There appears to be no change in  
 the layer of ~~orange-brown~~ orange-brown clay. Perhaps a little  
 more sand is now included w/in stratum, but otherwise  
 it appears unchanged.

Very similar soil found at the bottom of SOP 07 -  
 Plaza Matigrahy. Excavation will continue until a  
 change of soil is recovered.

While Lot 5 is being excavated, 2 new units were  
 located - SOP 11 between STR. 3/4 and SOP 12  
 to the W of STR. 1.

SOP 11 2x2 off grid

SOP 12 1x2 off grid ~~-----~~

With the termination of work at S-01, these units  
 will be ~~comple~~ commenced ASAP.

2003-07-23

Began the day with a visit from EEB who confirmed that the architectural style of Str. 4 does conform w/ the central Yucatecan style of NACO. Interestingly, the material culture is elite Maya (Copacel) but the architecture is local.

Dona Ruperta also came to visit. She gave permission to remove some coffee plants in and around S-02. Tomorrow we will have 3 workers dedicated to cutting down the coffee trees that now populate the site's plaza. Joy.

Excavation also began at SOP 11 - a unit placed in-between Str.s 3 and 4. This unit is designed to recover more trash deposit.

SOP 11

SOP 12

NE	-9.06	-9.23	1000.20	NE	39.63	46.84	1000.28
SE	-10.68	-5.37	1000.12	NW	39.	45	1000.27
SW	-3.62	-7.08	1000.31	SW	38.12	45.32	1000.40
NW	-3	-6	1000.25	SE	38.74	47.14	1000.39

Review of SOP 8's notes by JRR found a few inconsistencies that had to be corrected. However the overall paperwork is in order. As of this morning, Dimas and Enrique are clearing and cleaning so as to render the unit more presentable for final photos.

SOP 8

Roberto's departure has left me in charge of his unit. I have reviewed some of his decisions and identifications and found slight imperfections that need some rectification.

Overall, SOP 8 consists of 4 lots, and 3 levels.

Lvl. 1	Lot 1	- Top human layer
Lvl. 1	Lot 2	Tumble - <del>high</del> and off-mound
Lvl. 2	Lot 3	Tumble - low
Lvl. 3	Lot 4	Platform fill.

Unfortunately, the arc-course wall that extends N-S through his unit was not recognized early enough to avoid the incorrect removal of one of its components. The wall (like in SOP 5) consists of various types of low flat stones with a rough face to the E.

Small amounts of probing below some of these stones has shown that it consists of only ONE course.

→ Lot 4 (mistakenly excavated initially at Lvl. 2/Lot 3) ~~is~~ represents the fill of this platform that most likely, surrounds Str. 5.

Excavation today will focus on correcting some of these errors and finishing the removal of both Lots 2+3 which have not been entirely completed yet.

2003-2-24

SOP 10

Excavation was completed yesterday and now the unit will be drawn and filled back in. Final photos were completed yesterday as well.

The unit was able to confirm that behind structures these inhabitants ~~did not~~ did not throw refuse. Moreover the construction of this building was undertaken on a thick layer of orange-brown clay that measures roughly  $\frac{1}{2}$  m in thickness.

The ~~the~~ occupation stratigraphy here is very similar to that of SOP 7 - in the middle of the plaza.

The southern unit wall will be drawn.

SOP 11

Excavation began today w/ Feliberto, Elwin and Lito (who decided to stay with us today).

This unit has begun well in that the workers are recovering a great deal of artifacts. Mostly ceramics are being found, though some ~~stone~~ lithics are also included.

The soil remains a rich loam dark brown, much like SOP 9 where the greatest number of artifacts ~~are~~ have been recovered. It is most probable that the excavations will continue at 10cm arbitrary levels until otherwise indicated by the stratigraphy.

The first 10cm revealed a few cobbles in the NW/SE corner of unit. Most likely, however, these ~~are~~ derive from structure rubble.

3pm - have now reached the 3rd Lt (same level) and the artifacts are beginning to diversify. Much more obsidian (non-blades) as well as chert has been recovered while ceramics seem similarly abundant.

2003-2-24

SOP 10

Excavation was completed yesterday and now the unit will be drawn and filled back in. Final photos were completed yesterday as well.

The unit was able to confirm that behind structures there inhabitants ~~did not~~ did not throw refuse. Moreover the construction of this building was undertaken on a thick layer of orange-brown clay that measures roughly m in thickness.

The ~~sub~~ occupation stratigraphy here is very similar to that of SOP 7 - in the middle of the plaza.

The Sathem unit wall will be drawn.

SOP 11

Excavation began today w/ Feliberto, Elwin and Lito (who decided to stay with us today).

This unit has begun well in that the workers are recovering a great deal of artifacts. Mostly ceramics are being found, though some ~~other~~ lithics are also included.

The soil remains a rich loam dark brown, much like SOP 9 where the greatest number of artifacts ~~are~~ have been recovered. It is most probable that the excavations will continue at local arbitrary levels until otherwise indicated by the stratigraphy.

The first locn revealed a few cobbles in the NW/SE corner of unit. Most likely, however, these ~~are~~ derive from structure rubble.

3pm - have now reached the 3rd Lt (same level) and the artifacts are beginning to diversify. Much more obsidian (non-Solates) as well as chert has been recovered while ceramics seem similarly abundant.



2003-7-17

Lito

Eduan

MAC

Eliou

Angelito

## Trip to Sta. Cruz

- 2 sites      Began w/ San Luis area finca
- 2 potential sites      Walk to R. Chaljá
- 0 sites      Cut to Sta. Cruz (N)
- 2 sites      Walk along R. Chaljá near Sta. Cruz (S/W)

Sites Located : S-213, 214, 215 - along R. Chaljá.

Sites reported: along R. Chaljá in areas between Cuesta de las Cucitas and Sta. Cruz. Roughly 4 sites along the N69 → N72 UTM Co-ordinates. This reporting in addition to S-215 suggests that sites along this river are distributed every 250-350m apart.

Sites unrecorded: Several potential sites along R. Chaljá that were seen from a distance, though not ground-truthed directly.

Short cut to Sta. Cruz from the Q.S. Luis R. Chaljá - no sites along this route

2003-2-27

Early morning trip directly to Sta. Cruz was cancelled as we ran into Sender Santos in St. Antonio de las Cuestas who owns a finca on which mounds have been reported.

Going directly to those mounds of him led to the discovery of S-213 - a multiple mound group of elite architecture located along the high bank of a quebrada (San Luis?).

Site was registered despite scorpions and snakes!

Some walking along this q. in the direction of the R. Chalja was discussed. Given the half-way location of S-213 bet. EP and Sta. Cruz we decided to split up - ERS, MTC, Hedman, and Angelito (regidor) went N to Sta. Cruz walking.

Following route along ridge, we descended into the Chalja valley roughly 3 km S of Sta. Cruz. We roughly walked 1 km N from S-213 along lateral ridge instead of along river - MISTAKE!

Valley along river is small but punctuated by small intermontane pockets of alluvium - much like the S-211 (Agua Buena) settlement pattern. Hedman mentioned that he found this river and the route it opens much easier to walk than that of the ridge.

For roughly 1 km we walked along the river finding scattered indices of sites/structures, though none of them were precise/reliable enough to record.

The 1 km stretch of Chalje heads off W - making a large loop around Sta. Cruz. The get to SE quickly we abandoned the river and headed straight N. We later learned that after Chalje joins w/ a Q., there lies another site. Along w/ S-215 and other potential places of mounds we can somewhat more securely suggest that this route was inhabited and early  $\bullet$  Walkable for exchange - especially for porters and merchants.

At Sta. Cruz, reports of other sites were given to us suggesting that all along the Chalje into Grate, site can be located.

Hond. / Gra.

Sta. Cruz  $\rightarrow$  Refugio  $\rightarrow$  Sta. Rosita de los Planes - Los Anates P?

This route might take up to 5-6 hours EP  $\rightarrow$  Quirigua but is also  $\bullet$  flatter and more comfortable.

It appears as if along Quebradas settlement N of EP can be found relatively regularly. However along the major rivers that contribute the routes northward to Q., only the Chalje seem settled with any regularity.

2003-07-24 Rainy, Overcast

Excavations today are happily accompanied by long-awaited coffee plant removal! With the visit from Dora Ripstein yesterday, the decisions were made as to how much, where, and how to remove. Today Enrique, Salvador, and Macho are cutting and chopping the Northern half of the plaza.

Excavation has also begun at SOP 12. This unit is being excavated by Carlos and Wilmer, who were dispatched from S-01 today.

→ It seems as if SOPs 8, 9, and 10 will be backfilled on Saturday given their progress thus far.

Excavation in SOP 11 will also continue in arbitrary levels of 10 cm. The soil there remains rather consistently dark brown. There seems no need as of yet to change level designations.

### SOP 12

Excavation has removed the first layer of loamy soil, under which lies a more compacted orange-brown layer that contains some ceramics. This layer will be considered a 2ND LEVEL. Small amounts of ceramics have been recovered - some Jordanian as well.

## SOP 11

Continuing with the excavation of this initial level.  
Artifacts remain abundant - in fact, there seem to be more in this lot of than in previous ones. This lot seems to be the last of the root-affected lots.

It seems that below (40cm+), there should be less mixture of materials.

Most of the ceramics in this lot seem quite utilitarian - though some painted sherds have appeared, the majority appear to be large water-type jars.

Small amounts of lithics are also being recovered.

## SOP 12

Now officially a 2x2 m excavation, this SOP will attempt to expand knowledge of Str. 1's base to the S where the cut was only 1m in length.

The soil here is very loose and organically rich. The first layer of humus is empty of ceramics. Underlying it, there is a layer of loose orange-brown soil with some ceramics associated. However, excavations further down reveal a more compact version of this same soil empty of artifacts.

One of the goals of this unit is to uncover the "floor" (surface

upon which Str. 1 is built. Given its size, however, Str. 1's walls might be fully covered by architectural rubble that precludes revealing the floor/surface near its basal courses.

### SOP 3

Dimer completed the final excavations / clearings required for a good picture. The area affected by incorrect or premature excavation has been altered to appear more appropriate given the exposed context.

Pictures will be taken and then perhaps a small pit to the E of the bldg. will be excavated. The unit will be closed entirely by SATURDAY.

2003-07-26

SOP 13

	N	E	Z	Unit placed in-between Sts 7 and 8 on N edge of S-02 plaza.
NW	85	-33	999.53	
NE	84.96	-32.08	999.60	
SW	84.13	-33.11	999.38	
SE	84.01	-32.10	999.61	

Soment of a rally that today gave the fencing problems at S-01. Some features were ruffled, but everything worked at fine by the end of the morning. A review of worker performance is due, however; especially since some have taken to becoming somewhat obnoxious in their "relaxed" attitude.

SOP 8 was drawn and backfilled  
SOP 10 was backfilled.

→ SOP 11 has been reduced to a test unit that is now reaching 80 cm in depth (8 levels of locum). In lot 8, large shag handles, break-neck jars, and possible redware supports are emerging. I think we are most definitely in a late Formative context now.

The soil has not really changed in color or texture - simply in consistency, which is now much more compacted and dense. The ceramics of lot 7 and 8 seem to be less dense than previous lots, but still noteworthy.

Cutting/clipping of the northern 2/3rd of Cafetal also continues with success. The site is now almost entirely visible from N to S. I think that once it is completely cleared some re-orientation of the map will be required.

The building constructed off-center from the rest - Str. 10 seems to have an East-West pair of stairs. It has been completely cleared of coffee now. Moreover Str.s 8/9/11 are now also visible as the ~~very~~ thick fence is being clipped.

By the end of next week, we should have a clear a view of this site as we will have all year/season.

→ SOP 12

Excavation of this 2x2 m unit has exposed the very limit (N) of Str. 1 tunnel, as well as a clayey surface upon which it rests.

- Lot 1 (Ll. 1) produced few artifacts
- Lot 2 (Ll. 2) produced some non-residential type ceramics.
- Lot 3 (Ll. 3) none thus far produced none.

None  
(Vegetation)  
(Timber)  
(Surface)

It seems as if Ll. 2 (lot 2) is the surface upon which Str. 1 was built. Ca. 30-40 cm below surface, this "floor" is located. However, b/c we are so far from Str. 1's facade (given the massive amounts of timber), the possibility of an apron-flooring remains open.



The rubble that constituted the majority of the S portion of the unit consists of local rocks that appear somewhat more finely cut and faced. Though they do not constitute an in-situ alignment in this unit, the rubble pattern clearly indicates that they constituted a facade - or, more likely, a step/staircase.

from N profile	0-10 cm	Lot 1	Lot 1
	10-30 cm	Lot 2	Lot 2
	30-70 cm	Lot 3-	Lot 3

2003-7-28

OP 03

SOP 5

NW	432	-602	989.89	15
SW	430	-602	990.59	40
NE	432	-600	989.95	10
SE	430	-600	990.57	40

SOP 6

SW	432	-594	989.61	30
NW	434	-594	989.33	15
NE	434	-592	989.33	15
SE	432	-592	989.58	25

SOP 7

NW	430	-590	989.89	
NE	430	-588	989.69	
SE	428	-588	990.00	
SW	428	-590	990.20	<u>OP 03</u>



SOP 5 Alfonso, ~~Angel~~ Wilmer, Carlos  
 SOP 6 Angel, Misael, Umberto

Began excavation in SOPs 5, 6 today while base mapping was completed to the SW of S-09 with EEB.

Three 3 SOPs were placed along the N side of Str. 1 - the side that possibly represents the access ramp to the structure's top.

3 units at varying heights along the N facade (all below half-way point along the rise). The goal for all three units is to recover ~~diagnostic~~ temporally diagnostic sherds as well as architectural indices that help orient and characterize the structure.

Given the nature of the Str. as well as the "experience" of our workers, it is likely that we will be recognizing architecture in profiles of units once excavations are complete. We aim to train the workers w/ these units.

→ At the moment, only SOPs 5/6 will be commenced.

Afternoon will be dedicated to removal of Lt. 1/1A 1.

2003-7-29

Closed the first lots of Sops 5, 6 of OPO3. These first lots might have been a tad large (ie they should have been divided into 2 arbitrary lots per SOP); however, no stratigraphy / construction was missed, so overall the contexts have not been compromised.

Both SOPs exposed a thin-lensed compacted orange-brown clayey layer that constitutes L1.2 for Sops.

Sop 5

Excavation in L1.2 has revealed a higher concentration of artifacts as L1.1 though this might be due to the fact that this L1.2 is much thicker (and the lenses much thinner) than previously conceived. In other words, L1.2 density is indicative of L1.2's occupational / post-abandonment relevance to S-04.

The lens layer is only a thin horizon on top of L1.2 (perhaps Lot 1 is really a mix of L1.1 and 2). This SOP is also recovering a great deal of BJ and some GS, which further enforces the occupational importance of this L1.2.

At the moment I do not believe that this L1.2 is ~~just~~ earthen fill of Str. 1. Though it does remain possible, the shallowness of the lens layer suggests otherwise. I am expecting some type of "tomb" (Slump?) from the structure above what remains of the Str.

Of course it remains also possible that we are excavating too far N of Str. 1 and will miss the architecture entirely. In that case we should encounter some type of surface ...

### SOP 06

This unit's 2nd level might prove what I was first writing completely wrong! A light (orange) brown layer - equivalent to OP 03/05/02 - was encountered after ca. 10 cm that -clarified a change of lot/level. Upon further exposure of this lot/level, a certain 3D pattern emerged:

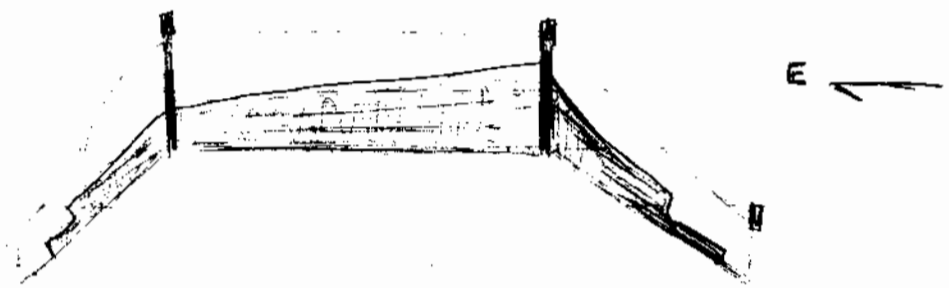

→ The 2nd level MIGHT be the fill of the structure. For SOP 5, this would mean that the thin brown covered rather fill of Str. 1. Because these units were placed along the May N grid, they will show some meaning of Str. orientation that will help define COSYASAL better.

In light of this info, SOP 5's Lvl. 2 might be fill that was covered by a much thinner layer of brown (being higher along the N fac. slope.)

Excavation in SOP 06 will continue w/in Lvl. 2 (Lot 3) in arbitrary levels to further expose the unit's profile. Artifacts seen to concentrate within the LT Br Soil in this unit.

2003-2-90

Excavations at SOP 05/06 of OP03 Continue in the afternoon w/out too much alteration. It remains plausible that the units close by Thursday.

Excavations have uncovered a light (orange brown) clayey layer (Ll. 2) in both units. Given that they are stepped one above the other, the combined profile of these 2 units (SOP 05/06) will represent <sup>a composite of</sup> the lowest 4 m of Str. 01 at Grayabul.

Both units have also uncovered a moist grey-orange clay below Ll. 2. This clay might represent (more likely) the fill of the Cenze structure. It is a fine clay with relatively few artifacts and a consistent structure. This layer (Ll. 3) is being located at different elevations in the 2 units:

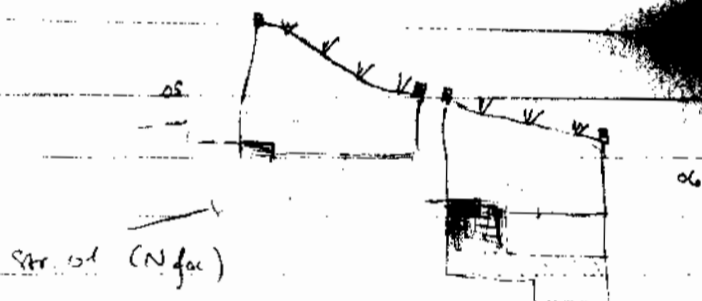

If this grey clay shows signs of being the same between the 2 units, then it will be possible to consider its composite profile as evidence for earlier construction.

2003-2-40

Excavations at SOP 05106 of OPO3 continue in the afternoon without too much alteration. It remains plausible that the units close by Thursday.

Excavations have uncovered a light (orange brown) clayey layer (Ll. 2) in both units. Given that they are stepped one above the other, the combined profile of these 2 units (SOP 05106) will represent <sup>a composite of</sup> the lowest 4 m of Str. 01 at Grayabul.

Both units have also uncovered a moist grey-orange clay below Ll. 2. This clay might represent (more likely) the fill of the Cenze structure. It is a fine clay with relatively few artifacts and a consistent structure. This layer (Ll. 3) is being located at different elevations in the 2 units:

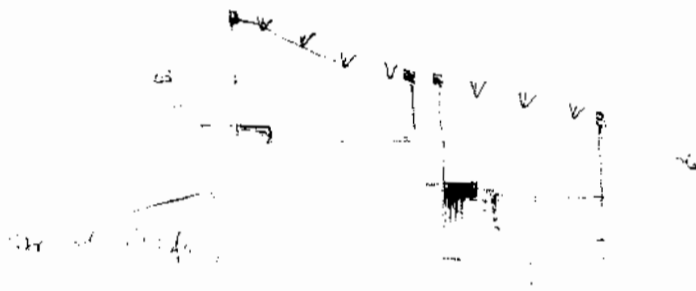

If this grey clay  shows signs of being the same between the 2 units, then it will be possible to consider its composite profile as evidence for earlier construction.

2003-2-

2003-07-30

Excavations at S-009 were suspended for the morning since preparations were required for the visit by RAF, JHR, R. Uiel, C. Dorku, etc..

Clearing and cleaning of S-001 was undertaken in the last half of the morning.

SEM (09) then took the workers to S-004 for the rest of the day where they continued excavations in both SOPS.



2003-2-42

2003-07-31

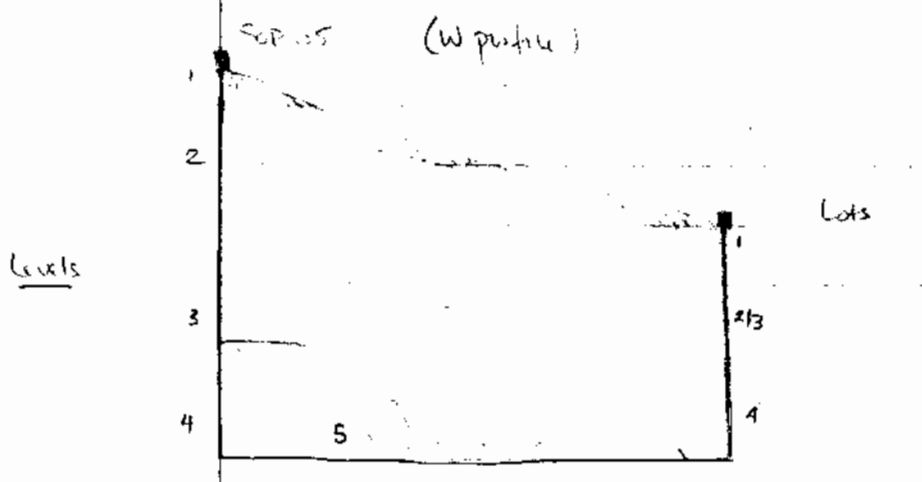
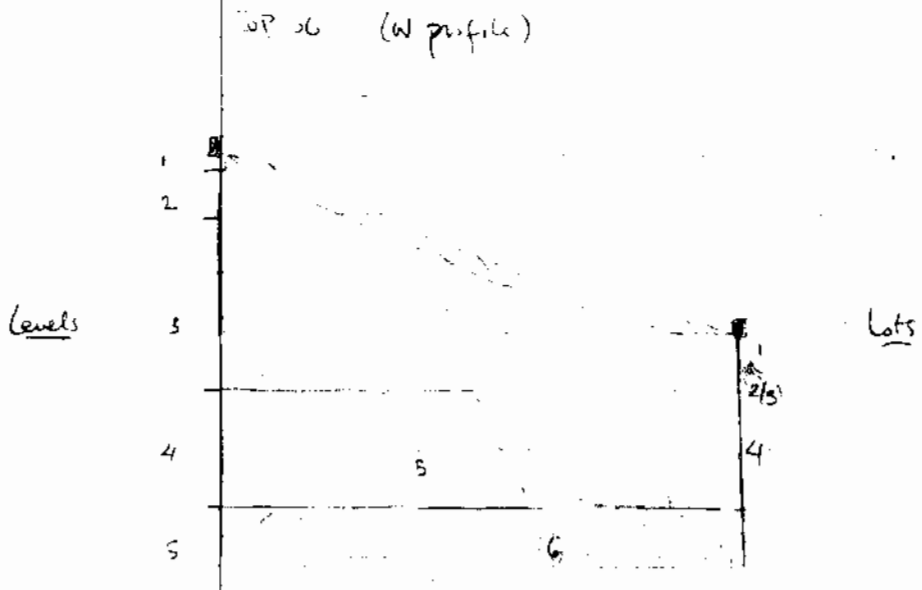

- 1 - Humus
- 2 - Light Brown soil
- 3 - Dark brown grey soil
- 4 - Light grey soil
- 5 - Dark black clay

Excavation in S-009 was completed today with the exposure of several sources of water within the units. This water limited visibility and made the clayey soil almost impossible to excavate.

Neither unit was in a sterile layer, though the stratigraphy of both led me to conclude that there were 2 distinct construction layers - a dark grey and a lighter grey. Below both lies a blackened clayey layer with a ~~higher~~ higher concentration of artifacts than ~~the~~ overlying layers.

The darker of the 2 construction layers (ie "fill") was most likely the interface w/ the surface which means that it was most affected by activities and erosion. Its darker hue might result from its greater concentration of organics that would have come into contact with the structure's surface. The lighter grey layer is lower and consists of the same material and inclusions as the higher darker layer.

Underlying both is a very humid black layer of clay w/ multiple ceramics and lithics. Some carbon was also encountered, but not collected. Sadly, the water table in this part of the valley has rendered this stratum wet and water-logged. Many of the ceramics recovered are in very bad state of preservation. It would seem from the stratigraphy that this layer was some type of surface for the inhabitants. Perhaps it represents the layer upon which the Str. was built. (988.70m).