

2009

EPV 017 Hostenske Field Notes 2009

Mary Hostenske

Follow this and additional works at: <https://digital.kenyon.edu/honduras>



Part of the Archaeological Anthropology Commons

Recommended Citation

Hostenske, Mary, "EPV 017 Hostenske Field Notes 2009" (2009). *Four Valleys Archive*. Paper 96965.
<https://digital.kenyon.edu/honduras/96965>

This Catalog Sheet is brought to you for free and open access by the Anthropology at Digital Kenyon: Research, Scholarship, and Creative Exchange. It has been accepted for inclusion in Four Valleys Archive by an authorized administrator of Digital Kenyon: Research, Scholarship, and Creative Exchange. For more information, please contact noltj@kenyon.edu.

Monday 15 June 2009

2009-17-01

Over the past few days (Friday → Monday) Ellen, Stephanie, & I have been preparing to start field work. On Friday we visited the locations where we would like to work this short season → S-009 north of Los Naranjitos (S-007) and three small rural residential groups on the El Paraíso side of the river. The S-009 site is located on Don Ernesto's land who we worked w/ last year (Str 12; S-007) and the rural sites are located on Don Jorge España's land. Since once again this morning we were unable to find Jorge España, we headed out to Cafetal to shoot points over into Don Ernesto's field. It took S & I a good 20 min to set up the machine the 1st time. Instructions => plant feet / center over dot; move legs ↑↓ until bubble is in the CIRCLE; then fine tune w/ horiz. level. We shot to the top of Cafetal Str. 8 & then shot in 2 points → one near the east side of Str 12 (S-007) & one ≈ — in NE of Str 12, next to a smaller i.e. really low mound. This way we will not have to slog through the cafetal to shoot a back sight.

Santiago arrived while we were @ Cafetal. After discussing his options for excavation he preferred to do the solares testing prog. in the neighborhoods of El Paraíso.

Chape
Dubon
Sulista Santiago

Monday 15 June 2009

2009-17-002

Since Santiago's choice is to do the solaris testing, I will now be finishing up work at Los Hornosjitos & investigating the smaller stras that form site S-009. A str that may be about the NE side of Str 12 (it is Str —) seems to have VERY well preserved lines & even some summit architecture. This is really exciting since to date we haven't really found summit arch^{@ Los Hornosjitos} - except Str 9. This str may also shed light on the purpose of Str 12. I will first investigate this str then several of the smaller (low) mounds that form S-009. Then hopefully I can turn my attention to the north side of Str 12 which, hopefully, is well preserved like the south side & is only buried in tumble. There is a lot of tumble → large irregular rocks which makes me wonder if they were part of the platform or if they formed some sort of summit architecture.

This afternoon once we gather permission from the landowners, we will probably shoot from El Paraíso to the rural sites. Provided E. gets the data collector to correctly communicate w/ the computer. This afternoon we set up a station on the top of Str 1 @ El P. in an effort to shoot over to the rural sites. Need Chema's (mayor) permission to put stakes under his H₂O tower to make an easy jump to the new sites. Got permission from Don Ernesto - need to be careful of beans.

Tuesday June 2009

2009-17-003

This morning E, S & I arrived @ Los Naranjitos (S-007) to get it set up for excavation. E made the executive decision to include what was formerly S-009 → the stes that form a patio NE of Str 12 as part of site S-007. The stes have been renumbered accordingly. I decided to set a N/E grid and layout the trenches according to that.

First we ~~lay~~ laid out a ^{Op 10 Subop 25} 1 N x 9 E m trench over Str. 15.

The trench is located approx. in the center N/S of the str. The goal is to uncover the arch which seems to be well preserved; including summit arch! There may be a slight problem w/ a tree stump on the summit. Next we laid out a 7(?) m E x 1 m N trench across Str 22. The purpose is to expose the architecture & learn more of the smaller stes that are part of S-007.

Now, after lunch, workers are clearing ~~can~~ chape from the mounds so that we can take photos that show lines etc.

We have now started excavations.

Lot # 1 EU A Op 10 Subop 25 is located on the E end of ~~Str~~ Str 25. Currently Don Dimas & Tino are excavating a 0.1 m lot to expose the stratigraphy.

Lot # 2 EU I Op 10 Subop 25 is located on the W side of the trench. Fili & Nemiger^(?) are also excavating a 0.1 m lot.

Tuesday June 2009

2009-17-004

After clearing corn debris off the site (18) the summit arch and basal walls appear to be visible, & well preserved on the surface.

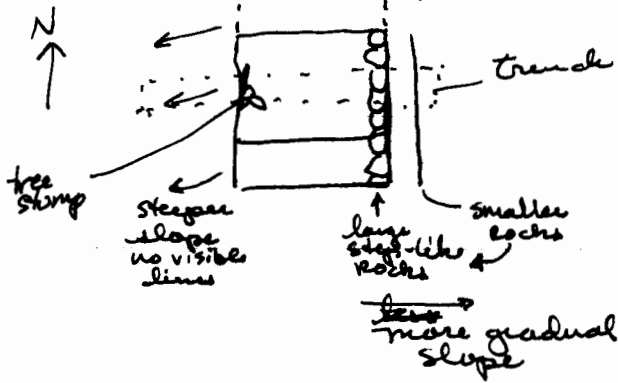

Lot #1 EU A

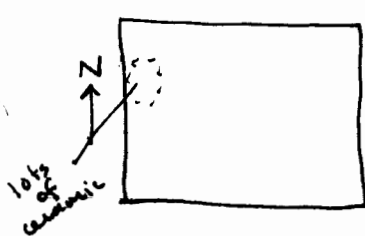

Soil:

Contents:

Not completed today see Wednesday

Lot #2 EU I

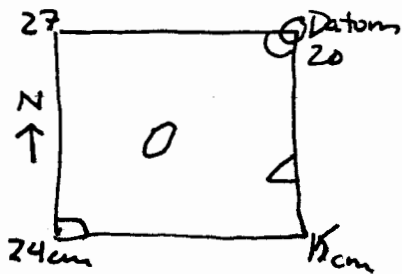

Soil: brown clayey silt lenses

Contents: 3 trestos

Tuesday 16 June 2008

2009-17-005

Started Lot #3 EU I, a 10cm lot.

Wednesday 17 June 2009

Today we were joined by Juan Angel (?), Chepe, Lionel & Jorge. We started out the day by building changas for the traps. After yesterday, my neck was rather severely burned, so I am looking forward to the shade. Took video of the construction process. Stephanie is having stomach issues today - I hope they clear up. Erlend finally realized that for his foot to actually heal he should not walk on it, so he is not here to help S today. She found 150 some pieces of ceramic in a 5cm lot less than 30cm long. Amazing! Am going to have Chepe & Lionel start on the W end of her trench. Will split Jorge & Juan Angel btwn my two groups.

Am continuing Lot #3 EU I & Lot #1 EU A. Lot #1 has revealed tumble & a fair amount of ceramics. Am making all lots "level" they will end up being deeper than they should but ok. Am removing some tumble from EU A Lot #1

Wednesday 17 June 2009

2009-17-0010

Am continuing Lot # 1 EUA & Lot # 3 EUI.
Juan Angel has joined Dimas & Tino's crew & Lionel has joined Fili & Nemias' crew.

In Lot # 1 EUA am finding ceramics ^{behind} the possible "wall". This is looking less like a wall & a lot more like tumble. Am removing some of the smaller rocks. Am also finding peridernal - including a core & some obsidian blades.

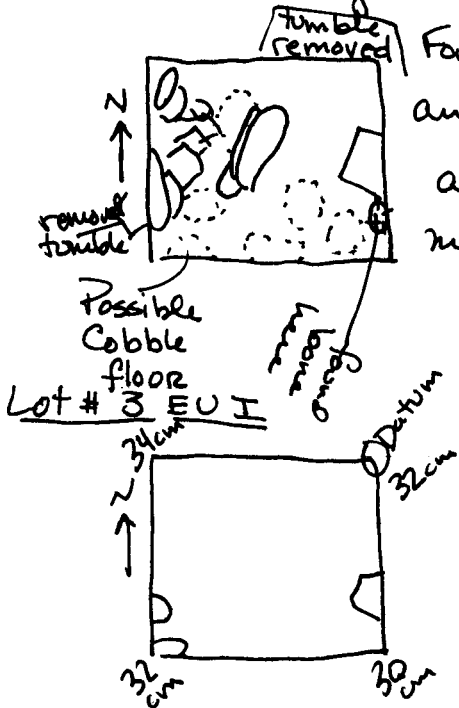

Found bone fragment. Appears to be part of and animal long bone. Definitely have a midden/dumping situation. Finding more

Soil dk bn Silty clay Contents - 38 ceramics
1 peridernal

Am starting Lot # 4 EUI, a 10 cm lot. There is no tumble to remove.

Lot # 1 EUA They have uncovered what appears to be a cobble floor.

Wednesday 17 June 2009

2009-17-007

Am continuing/finishing Lot #1 EUA. Removed all tumble & have uncovered what may or may not be a cobble floor. ~~At~~ Have found a lot of ceramics (some poss. imports); obsidian → including an almost complete blade & perdenal including cores & an animal bone & bajareque.

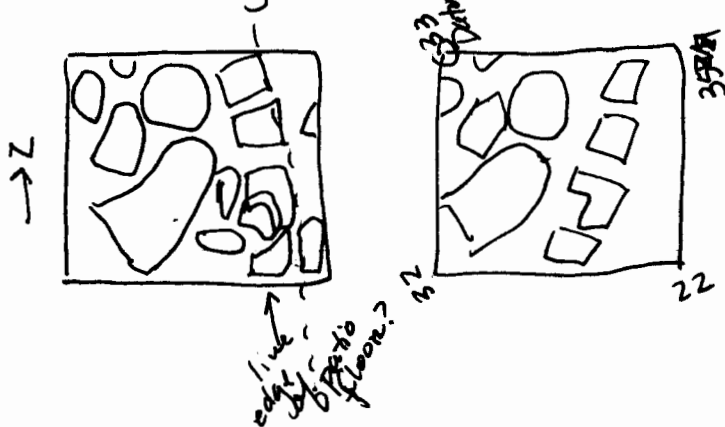

Contents:

- 1 bone
- 5 bajareque
- 11 obsidiana
- 5 perdenal

dk bn
Soil: Silty
clay
loam

52 tiestos

Bag # 2

80 tiestos

Bag # 1

Am starting Lot #5 EUJ. EUJ is located east of EUA & is a 1 N x .5 E meter unit. The purpose of this unit is to determine whether the ^{N/S} line I uncovered in EUA @ continues @ is actually the edge of a cobble surface. So essentially we are trying to see what we have found. Will be removing tumble to reach cobble surface level.

Lot # 4 EU I

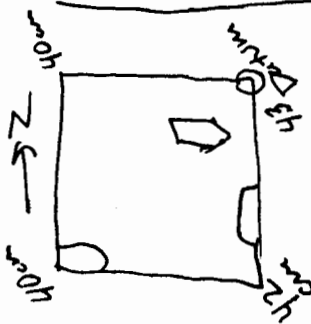

Soil: (dk) (y) bn
silty clay

Contents:

- 62 tiestos
- 1 obsidiana
- 2 bajareque

wed.

17 June 2009

2009-17-008

Am starting Lot #6 EU I, another 10m lot.
 Removed 1 tumbled rock from center of EU &
 found a tiny bit of carbon, right near the
 surface.  carbon The soil has become a
 fairly hard clay.

Stephanie found a really cool pitcher/jar
 thing w/ a spout, feet & what used to be a handle.

 It was located in front of her wall, below
 the base of the wall.

Lot #5 EU J. Removed tumble etc. What I
 thought was a line is apparently random → the
 cobble surface continues East. I think that I will
 return to investigate this later → I would have to
 destroy my champa since the post is in the next
 1/2 EU East. *Have to switch datums - stake fell*

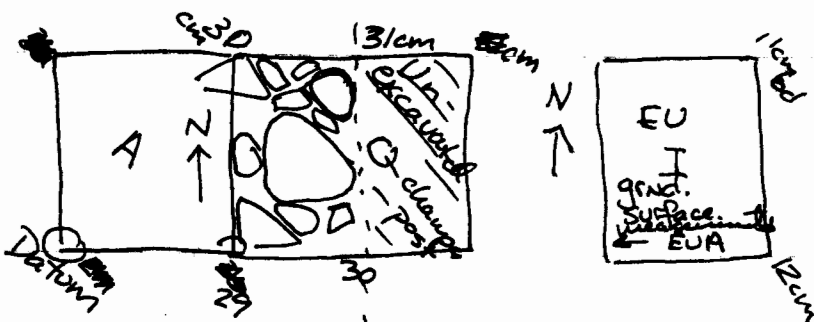

Datum is now @ SW stake of
 EUA.

Contents: 31 tiestos
 3 obsidiana

Soil: bn silty clay loam

Am starting Lot #7 EU B. The purpose of this
 lot is to uncover architecture. Based on surface lines it is
 likely that there is a wall located in EU B.

Wed. 17 June 2009

2009-17-009

Lot # 6 EU I

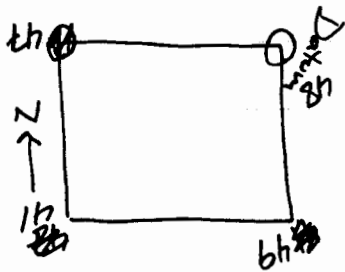

Soil (dk)(yl) bn
silt. clay

Contents:
ceramica 11
1 perdenal

Lot # 7 EU B

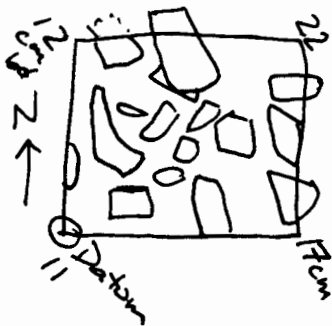

Soil: bn silty
clay loam

Contents:
22 ceramica

Am starting Lot # 8 EU I, a 10 cm lot
in an attempt to reach sterile.

Am starting Lot # 9 EU B, to hopefully
expose a terrace wall that I can see further S.

Thursday 18 June 2009

2009-17-010

* Note: Don Dimas has not arrived for work today *

Also - someone stole the tarps off of my 2 excavations; luckily they did not get Stephanie's as well. It has been recommended that we cover them w/ leaves ~~as well~~ ^{instead}.

Am continuing Lot #8 in EU I to test stratigraphy & Lot #9 in EU B to peel back tumble & search for the eastern wall.

Have removed a section of tumble from Lot #9 EU B. Apparently, at least according to Tino, have found some stucco it is sitting @ about 10cm above the cobble surface. It seems as though the stucco & a huge piece of ceramic are sitting on the same level - above the surface - may have removed 1 rock of a line.



Juan Angel is convinced that the stucco is a rock. - So we'll see when E gets back.

Thursday 18 June 2009

2009-17-011

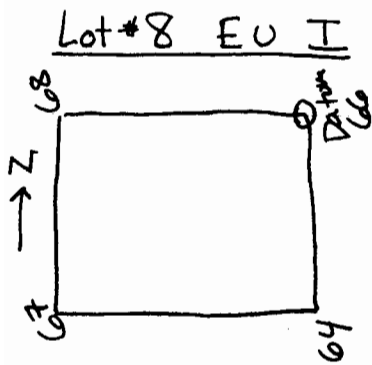

Soil:
yl bn clay

Contents: 2 obsidiana
9 tintos

They said that most of the artifacts were found in the top of the layer \therefore I am hoping we are close to sterile.

Am starting Lot #10 EU I. It will start as a 5cm lot to make sure we have hit sterile but will continue to a 10cm lot if necessary.

Lot #9 EU B

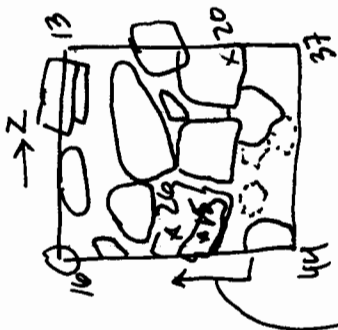

Soil:
bn silty clay loam
tan/yl bn silty clay
→ under STR

Contents:

58⁺¹⁵ ceramica
3 obsidiana
2 peridernal
2 stucco

Building appears to be constructed in same style/methods/materials \therefore poss. same construction episode as Sites 9 & 10.

Am starting Lot #11 EU C. The purpose of this unit/lot is to uncover the wall that is visible on the surface & clear up the relations btwn the steps.

Thursday 18 June 2009

2009-17-012

Am continuing Lot # 10 EU I & Lot # 11 EUC.
In the 1st 5cm of Lot # 10 EU I found 3 sherds,
so am continuing the other 5cm.

Lot # 11 EUC → may have found door → unless
it tumbled there are rocks missing in the wall.
However it rather looks like 2 rocks tumbled into
the space. There is also a huge yellow stone
under the N part of the space. Am continuing
to remove tumble/poss. fill/clean & rocks.

Lot # 11 EUC

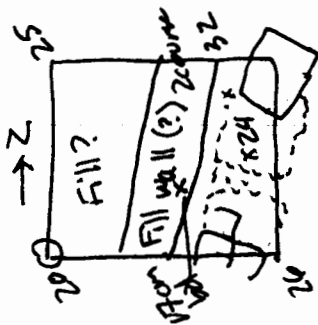

Soil:
dk bn silty clay
lean

Contents:
19 ceramics
1 obsidian
1 peridernal

Lot # 10 EU I

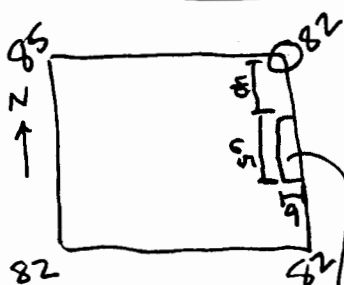

Soil:
bn silty clay
w/ gritty inclusions

Contents: 3 ceramics
Carbon

★
Poss. post
hole
with
investigate
when reached
in EU H.

Thursday 18 June 2009

2009-17-013

Am starting Lot #12 EU D in order to expose the summit architecture of Str 15.

Am starting Lot #13 EU H, a 20 cm lot, to look for the western basal wall & to work our way down to see if we can expose the rest of the possible post-hole.

Have found several possible walls / fill layers / summit floors. Several ^{nice} stones in a wall appear to have been pushed out of place by a root - both the ~~the~~ root have been removed.

Am worried about Stephanie - I don't think that she has been drinking enough H₂O. The day started off nice & overcast but now, although the cooler breeze has picked up ~~the~~ - the sun smuck up on us. She was complaining of a headache, felt like her back was burning & dizzy during lunch. This makes me really worried since we can't really call anyone to come pick us up - plus dehydration is bad in general. I sent Salva to get Gatorade, H₂O & a 3-liter for the guys.

Lot #13 EU H

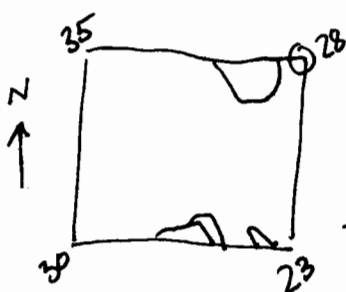

Soil: on silty cl lean Contents:

- 35 ceramica
- 5 obsidiana
- 1 perdernal

Thursday 18 June 2009

2009-17-014

Am starting Lot # 14 EU H, a 20cm lot.

To examine stratigraphy & work down to post hole level.

Lot # 13 EU D

Am continuing to remove fill/tumble in order to better define summit architecture..

Am currently sitting on door ~~step~~ ^{jamb}.

Lot # 12 EU D



Soil: ^{bn} silty clay _{loam} Contents: 11 ceramics
Removed some tumble/fill.

Am starting Lot # 15 EU E. The purpose of this lot is to help determine summit architecture.

Friday 19 June 2009,

Am continuing Lot # 14 EU H and Lot # 15 EU E.

Yesterday ended rather abruptly.

Lot # 14 EU H

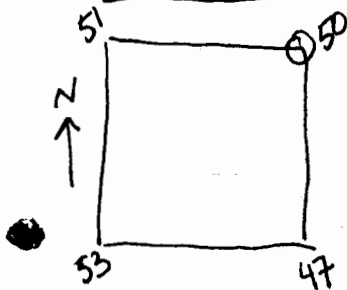

Soil: bn silty clay (loam) Contents: 33 ceramics
2 obsidiana
1 peridermal

Friday 19 June 2009

2009-17-015

Students came to visit site this morning. Ellen said it looked like I needed to remove more stuff. Stephanie's bajareque got so concentrated that it became a feature & she found a ton of carbon.

Lot #15 EU E.

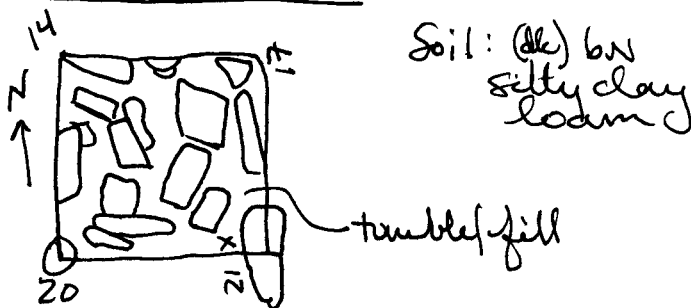

" perdenal

Am starting Lot #16 EU H, a 20 cm lot.

Am starting Lot #17 EU D - a cleaning!

tumble/fill removing lot.

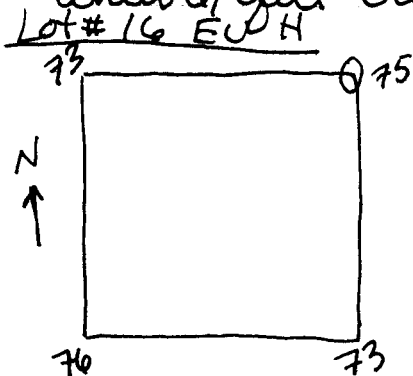

Soil:
(yl) bw silty clay

Contents:
5 ceramics
1 perdenal

Am starting Lot #18 EU H, a lot that will take us down to the same level as the other (EU I) unit.

Friday 19^{June} 2009

2009-17- 016

Am continuing to remove rocks in EUs C, D, & E.
Ellen also thinks that I need to work on the following:

- defining the steps/platform in East will draw first & then remove/investigate.
- Doesn't think it is a door just that rocks are missing
- Am removing recommended fill/tumble which has turned out to be tumble in EUs C, D, & E. Have reached a level w/out rocks that is comprised of a more yellowy/tanish brown → the same color that was found under the steps.



Soil
yl bn clay

Contents:
1 obsidiana
2 peridermal
1 tba
16 ceramica

* Am stopping Lot # 17 EUD for now since all the workers are moving to new site will continue w/it tomorrow. *

Friday 19 June 2009

Subop: 26

EU C Lot # 24

2009-17-017

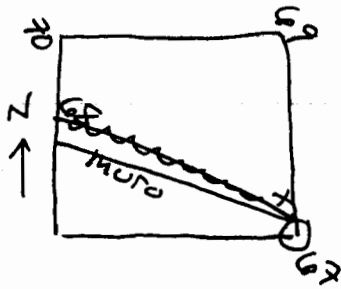

Contents: sterile

Soil: yl br clay

EU D Lot # 23

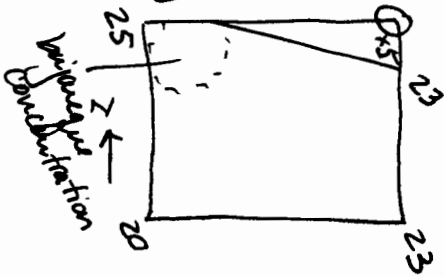

120 ticsto

280 bajareque

4 obsidiana

1 perdernal

Friday 19 June 2009

2009-17-018

Lot #25 E.U.D.

Subop
26

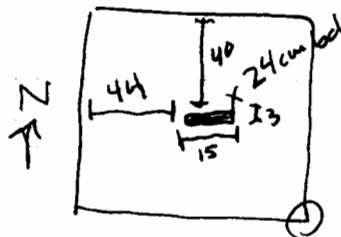

Soil:
bn silty clay

Contents:
bajargue
5/ Ceramica

The purpose of lot # 25 was to expose more of the bajargue feature to the East of where we discovered it in E.U.E. It was approx. a 20 cm lot. Found a lot of carbon (see sketch). Appears to be burnt sticks. Can even see the wood grain. Really cool!

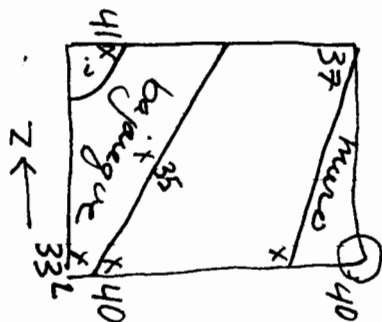

Saturday 20 June 2009

2009-17-019

Subop
25

Started Lot # 19 EU G a 20 cm lot to expose the western basal wall.

Am continuing w/ lot # 17 in EUs C, D, E removing tumble to find the floor.

Lot # ~~18~~ 17 EUs
G, D, E Contents: 4 ceramics



It is possible that part of a summit wall was removed \Rightarrow can see line on the surface. 3 course stack is still in trench held up by root.

A decent cobble fill layer was uncovered \rightarrow about 2 layers before the tanish clay fill starts.

Am starting Lot # 20 in EU F, a 10-20 cm lot in removing dirt & tumble removal.

Am having Jorge & Stefan continue down to the top of the yellow clay in one lot \rightarrow will hopefully expose the depth of the wall (Lot # 19)

While talking to Jorge about the wall was almost the victim of a landslide on the southern part of my trench EUs H & I. Took out a good chunk. \rightarrow I was standing at least a foot away from the edge. Cops!

Saturday 20 June 2009

2009-17-020

Sub op
25

~~Am starting Lot #20 in EU F.~~

Have uncovered wall in EU G it is made of huge, nicely shaped rocks; however, the tree has pushed the top (of 2 courses) forward. The guys were worried about undercutting it → so it is now supported by a stake.

The guys removed the trunk (located in EU F, which took a bit of engineering. Am now clearing the affected part of the lot.

Lot #19 EU G

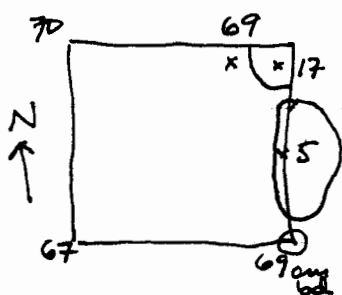

Uncovered a 2 course wall - ^{top} _{located} course pushed out by tree 1m east.

Soil. but silty clay loam

Contents: 90 Ceramica
6 obsidiana
2 periderm
3 bijareque

Lot #20 EU F

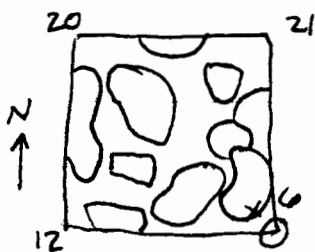

Contents: sterile tree removed to expose flat laid fill.

Lot #21 EU H & I - cleaning lot

7 Ceramica - were recovered from fall - 1 nice incised piece
Deerhide occurred ≈ 1.8m ~~is~~ long & 8" wide almost went to base of trench.



piece

Monday 22 June 2009

2009-17-021

Am starting lot #22 EU G. This lot will take the base of EU G down to the same level as EU's H & I. It will also give the guys something to do while I draw & photograph @ Str 20.

To Do Today:

- Draw Subop 25 - Do I need to do plan?
- Photograph both Subops
- Expand off the E side ^(moving S) of Str 20 to ^{continue} exposing E wall & bajareque feature.

Lot #22 EU G

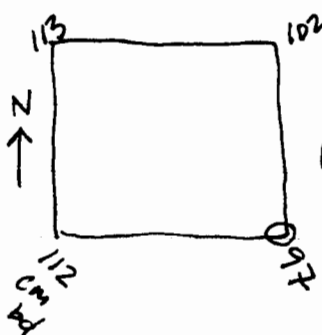

Soil: All these
Realized that at base
of EUs G, H, & I
have been hitting a
darker, sandy, more
gravelly layer - ^{river}
sediment(?)

Contents:

- 11 ceramics
- 2 peridernal
- 1 obsidian
- 3 toba

Tuesday
23 June 2009

2009-17-022

Today I have 2 more workers that will be mine to keep - Yea! Lorenzo is back and also Don Beto w/ whom I have not yet worked, but who seems really nice. They had uncovered the trenches by the time I arrived, so I set them about cleaning Subop 25 for photos. Today - hopefully, we can start expanding South on both structures. Need to finish final notes for both. Will start expanding Subop 26 laterally first, off of EU's C, D, & E.

* Subop 27 * Am starting new Subop to go laterally!

Am starting 2 EUs on Str 20 in order to follow the eastern wall. I decided to follow the eastern (non-patio) wall since it would give me good trash & the wall is closer to the Bajareque feature which will make it easier to follow it as well. I am losing the opportunity to come across activity areas & poss. ritual deposits (like the pitcher) that would be more likely on the front of the structure.

Lot # 1 EU ^A is south of EUC. It will uncover the front of the E. wall as it angles SW.

Lot # 2 EU ^B is located S of EU D; the purpose of this lot is to follow the back of the E wall & maybe pick up part of the Bajareque feature. Tumble is being removed from each lot.

water?
park?
Estiglema

Tuesday 23 Junio 2009

2009-17-023

Lot # ~~26~~ 1 EU # A

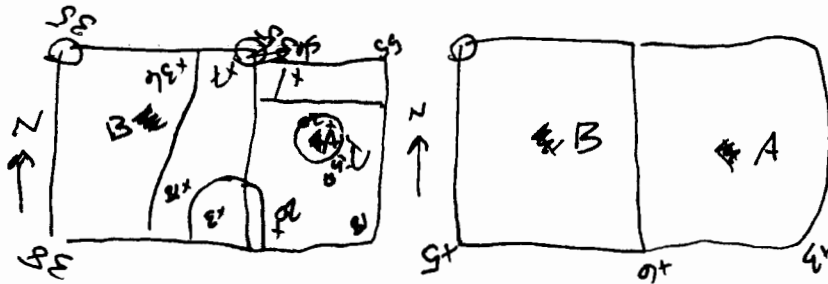

Soil: dk bn
silty clay loam

Contents: 102 ceramic
8 bajareques
1 peridermal
2 obsidiana

Cobble surface. E of the wall.

Lot # 2 EU # B

see above for measurements. All measurements from ~~the~~ ^{SW} stake of ^{Subop 26} EU D, since it was the only one still in place.

A possible ~~cash~~ cache was found in the wider part of the east wall. (the 2 bones)

It seems that the wall gets wider as it goes south.

Contents:

The bone was found under a flat rock that was sitting on top of a space created by the 2 courses & the new interior 3rd course (wide) / increase in rock size

120 ceramic
94 bajareque
2 bone (frag.)
1 basalt - metate
3 peridermal

Have created 2 new units C # A. EU # is

South of EU # A & EU # is South of EU # B

Lot # ~~26~~ ³⁰ is in EU # C & Lot # ~~26~~ is in EU # D Just found incensario fragment in EU # D.

sqote =
child
nino

Tuesday 23 Jun 2009

2009-17-024

In lot # ~~204~~ 4 EU ^D - found a nice large chunk of carbon on the W side of the wall about 8" from the base of the wall, near some bajareque & ceramics.

Have kind of come across a rock pile in both ^{new} EU's. I'm not sure that opening these EU's actually makes anything clearer. Removed some of the semi-flat (large) rock fall from EU ^D - the cobble surface seems to continue, so will use that as our base for architecture.

Found mano in EU ^D mixed in w/ the wall.

* Found another possible finger bone on the E side of the wall in EU ^D. It was at about the same level as the cobble surface which apparently is only \approx 4 courses (2") wide. - Like a path. The cobble surface is on top of both bajareque frags & ceramics.

Torget & Seafin are now going down on the S side of the surface to see if it is a wall, since the rocks on the S. side seem to be facing - flat faced south. Found another possible bajareque feature.

S of the C.S. in the middle of the EU. The bajareque layer - although not as concentrated as the 1st layer it extends out ^(S) from the cobble surface for \approx 0.4m. It may even be the bajareque we are seeing in the wall/under the tumble in EU ^D. Am finding lots of large shreds in EU ^D in the 'tumble'.

Wednesday 24 Junio 2009

2009-17-025

Am continuing both lots # ~~3~~ & ~~4~~ in EUs ~~C~~ & ~~D~~.
We are removing tumble in both EUs. Am uncovering the bajareque layer in both EUs. Found another nice big incensario fragment in EU ~~D~~ in tumble @ end of the wall.

Since discovering that the wall makes a corner & goes east this means that the 2 little pieces of bone from the other morning from EU ~~C~~ were uncovered in fill like stuff near the corner of the wall & that the bone that looks like a finger bone from EU ~~A~~ / ~~B~~ was found on/near the interior floor of the structure.

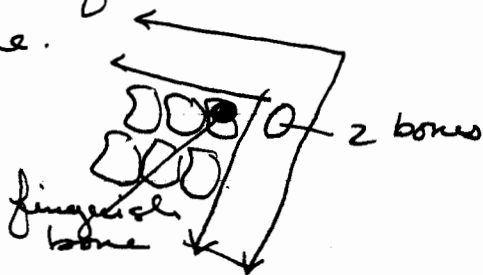

Lot # ~~3~~ EU ~~C~~ C

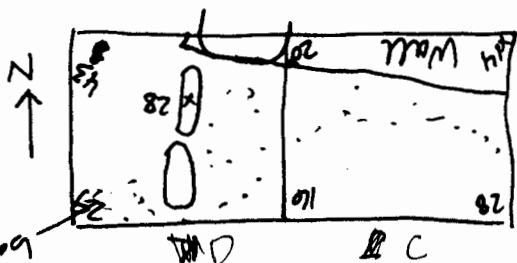

Lot #3
Stopped @ bajareque level.

Contents:

- 74 ceramica 4 peridural
- 38 bajareque
- 5 obsidiana

Lot # ~~4~~ EU ~~D~~ D
* All measurements from SE, EU ~~A~~.

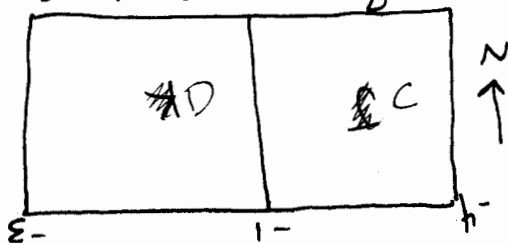

- lot #4
- Contents: 2 bugs
- 130 bajareque
 - 2 mano/metate
 - 131 ceramica
 - 4 obsidiana
 - 2 peridural

Wednesday 24 Junio 2009

2009-17-026 A-C

We are starting 2 EUs to the East of EUs ~~###~~
The purpose of these is to follow the newly discovered wall east & as well as the related fallen bajareque feature.

Starting

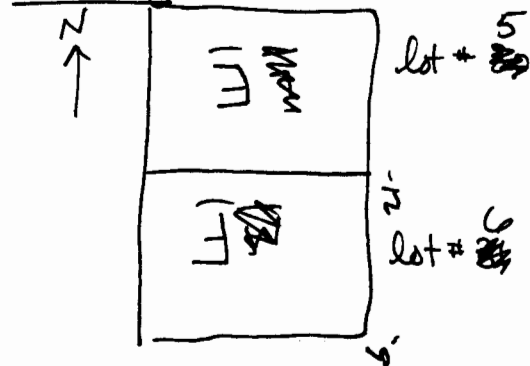

lot # 5
 Contents: 102 ceramica
 1 mano
 12 bajareque
 6 obsidiana
 2 metate
 1 pedernal

In btwn the 2 EUs have found whole vase in place. Imported Red & black w/ what may turn out to be quadrupartite kin signs. Found $\approx 4"$ off N (back side) of southern wall.

Don Beto said that he removed a flat rock that either naturally or man-made has a curve that matches the vase. Have excavated around vase. Collected all pieces of ceramic found during this & cleaning as 1 lot will be included w/ that of vase. Also found obsidian blade. Vase has figure & mask on it. Am drawing & photographing it.

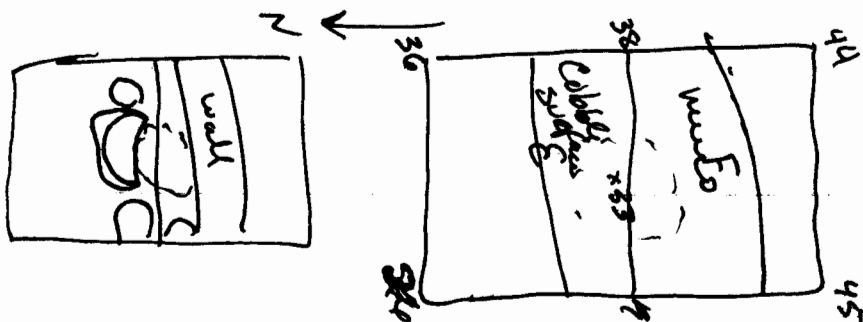

lot # 6
 10 obsidiana
 104 ceramica
 18 bajareque

Wednesday 24 Junio 2009

2009-17-027

The Vase & associated / possibly associated pottery & Chen obsidian blade ~~is~~ are being countered as lot #7 EUs E & F.

Am starting new EUs G & H south of EU A Subop 26. The purpose of these EUs is to continue following the southern wall east & to see if the cobble surface continues - which it currently doesn't appear to. Extraño. There will be lot #8 EU G & lot #9 EU H. Am taking them down to same depth as EU E, in order to ~~see~~ uncover the ^{poss.} cobble surface. Are finding less bajareque - nothing like what is on the rest of the ^(former) east & S wall.

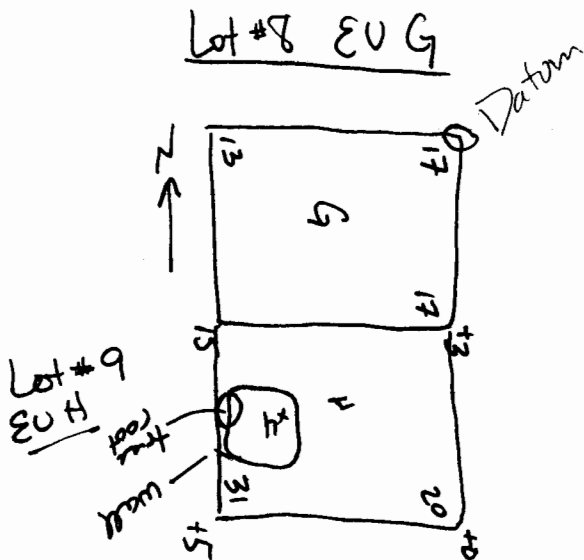

Lot #8 EU G : Contents

142 ceramica
11 bajareque
2 obsidiana

Lot #9 EU H : Contents

123 ceramica
15 bajareque
5 obsidiana

Wednesday 24 Junio 2009

2009-17-028

Ellen & I followed the following procedure w/ the vase. This was all documented through photographs & digital video.

The vase was extracted w/ the dirt still inside and was wrapped in several layers of foil. It was kept out of the sun for the remainder of the day (it was removed at 1pm). It was secured inside a cardboard box w/ balled up plastic bags and carefully transported via car to the lab. Since we had the proper equipment thanks to Jim, we were able to collect clean pollen samples which Ram might be able to test for us. We loosened the dirt using dental picks & then removed it using metal kitchen spoons. This was done in levels of several cm each. Pollen samples were taken at the following levels below the rim ^{also} ~~as~~ ~~were~~ all the soil from the bottom of the vase ~~was~~ was collected.

It appears that the vase was empty when the rim started to chip/crack, since small pieces of rim are found from 8cm down including a large piece on the bottom. This pieces were collected in a separate ~~the~~ whirlpack bag. The pollen samples were collected in sealed whirl pack bags & the tools were cleaned w/ kimwipes before each sample was taken.

Thursday
25 Junio 2009

2009-17-029

Am starting new Subop on North side of Subop 26 (the trench). The new subop will be Subop 28; w/ the purpose of following the "eastern" wall north to determine if it ~~also~~ makes the same kind of corner/form as the Southern end of the wall.

Subop
28

Lot #1 EU A Subop 28 will be a lot that takes it down at least 20-30cm bgl to the height that the wall has been exposed in the trench. EU A Subop 28 is North of EU C Subop 26.

Subop 27

Am starting new lot to clear down after removing other offering crypt capstones. This will be lot # 10 EU's A & C. Found ^{several} parts of metates → one is really well used. One was used as a capstone & another was in the hole ≈ the same level as the base it is an interesting juxtaposition. Will continue down to level of yellow clay → so far only random sherds & metate frags have been found. Have found 4 diff. pieces of metate, ~~two~~ one was under back of a rock ~~on~~ that makes up the wall. Another was stuck almost vertically in the center of the crypt. Measured @ this level 44 cm bd @ SW stake of EU B Subop 27. Am continuing down to sterile yellow ^{clay} layer. Will take the area down that was below the vase as well.

Thursday 25 Junio 2009

2009-17-030

Subop 27

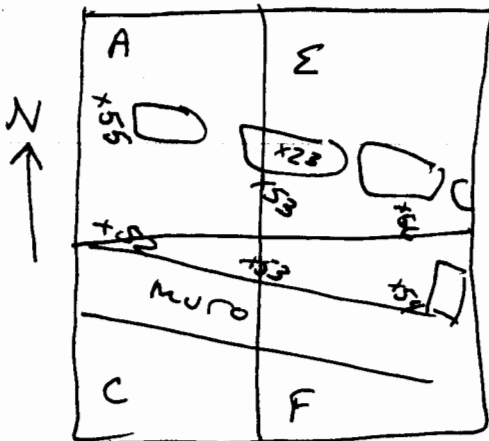

* measurements from SW corner of EU B. Subop 27

Contents: ceramica 55
metate 5
bajareque 7

not to scale

Took layer down to sterile yellow (actually 10YR3/4 brown) clay
Took photo!

Subop 28

Am starting new lot ^{EU} North of EU A. EU B will continue to follow the eastern wall North to find its possible corner. This will be lot #2.

Lot #1 EU A Subop 28

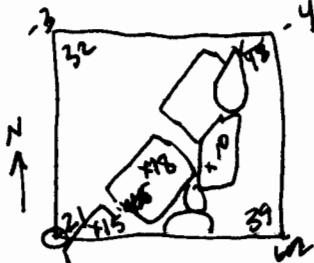

* Datum = NW of EU C - Subop 26.

Soil: dk bn w/ baj inclusions

Contents:

120 ceramica
50 bajareque
4 obsidiana
1 weird thing
↳ rock/bead (?)

3/4"
1 peridinal

Am starting new lot #3 in ^{new} EU C which is located North of EU B. The purpose is to follow the walls north.

Thursday 25 Junio 2009

2009-17-031

Subop 28 Lot # 2 EU B Subop 28

Contents:

105 ceramica

52 bajareque

4 obsidiana

1 perdernal

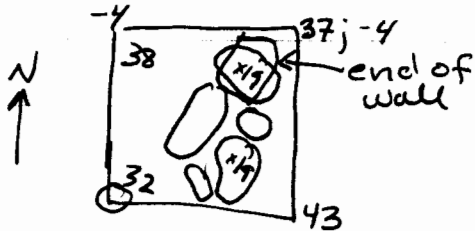

Datum = NW corner of EUA Subop 28.

Am starting new EU ^(D) ^{to the} east of EU B, Subop 28. The purpose of this is to see if our assumption that the wall ends is true - also to look for another cache area. This will be lot # 4. Don Beto is not feeling well hope he feels better since they no longer have to move dirt -> just toss it into the pile which is almost over flowing into the EU. The EU is currently 0.5m east by 1.0m north to accomodate the backdirt but satisfy my curiosity at the same time.

Lorenzo & Sergio found a nice piece of surlo in EU C, lot # 3. They are uncovering an interesting jumble of rocks, past the end of the wall. Can't quite tell if it is fall from the wall (unlikely based on location/position); may be fall from something not visible on surface; based on rock shape I would say its unlikely to be another cache cover. Lorenzo found a very nicely painted piece of polychrome - tan w/ black & red fine figures. They may be uncovering another rough ^{low} platform. The ceramics are coming from in front of the platform - not on top.

Thursday 25 Junio 2009

2009-17-032

The 1 piece of painted ^{Ube} polychrome turned out to be several & then turned into a pot smash.

The smash seems to be situated under a layer of bajareque & ^{partially} under 2 of the rocks that I suspected may be part of a plat form → I guess not. Also found a jade seed bead in same location. Will draw & photograph before removal.

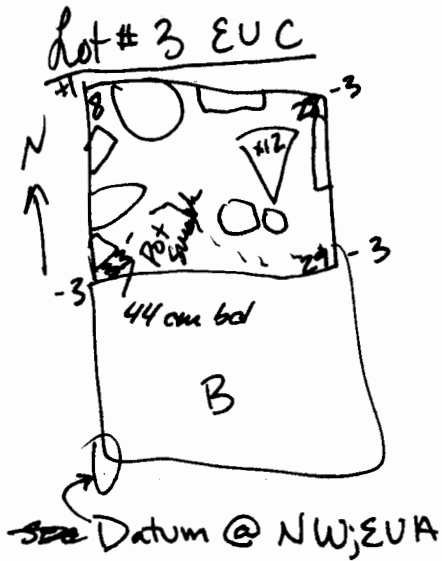

Contents:

- 50 ceramics
(not smash)
- 1 obsidian
- 37 bajareque
- Carbon under smash

Pot Smash = Lot # 5 EUC

Friday 26 Jun 2009

2009-17-033

Yea! William is arriving in Honduras today →
he can't get out of his visit now i Am continuing

Subop
28

Lot #4 EU D Subop 28

Lot #4 EU D Subop 28

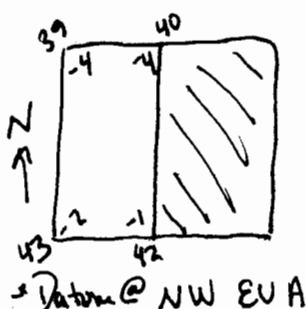

Soil: dk brn silty clay loam

Contents:

- 73 ceramics
- 10 bijouques
- 5 obsidiana
- 2 pedernal
- 2 metate

Am starting new EU E, north of EU C; this will be Lot # 6. The purpose of this EU is to expose more of the possible platform/ figure out what the rocks are from. The have found very few rocks so far, so it is looking as though the rocks uncovered in EU C may be some sort of a wall.

Am starting new EUs moving West off of EU C to follow this "wall" and to see if it meets up with ^(Subop) the western wall exposed in the original trench (~~26~~ 26). The new EU is EU ~~F~~^F, lot # 7.

Don Ernesto is back to visit. He actually asked if we only found ^{broken} sherds which makes me feel even worse about not showing him the pot → just don't know how to present it yet.

Don't know if he'd claim it/start digging up his land. Am also worried that I might destroy some of the tale tells he's been spinning ~~&~~ his rocks. Been telling Rip van Winkle-like tales of old men & women getting lost in the 5007 finca.

Friday
26 Junio 2009

2009-17-034

Lorenzo & Serafin found an interesting fairly round basalt rock in the NE corner of EU E. What makes it interesting is that there seems to be a little hollowed out area (circular) on one side. Am not ^{yet} sure if it was man-made or not. They found a pot smash in the SW corner. Also found green stone machita. Am clearing down lower in an attempt to see a pattern in the rocks in both EUs. The few rocks in EU E are either fall or are part of a cache box. -> missing a side though. Am finding a decent amt. of bajareque in EU F. -> west of the possible line.

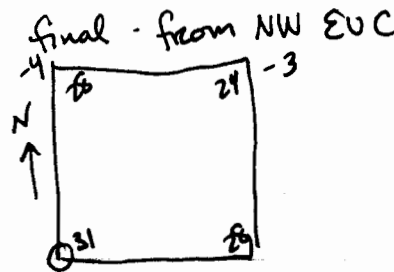

Contents:

- carbon
- 1 (hacha)
- 220 ceramica
- 11 bajareque
- 3 perdural
- 15 obsidiana

Potsmash = Lot #8

Lot # 7 EU F L -> ceramica 30

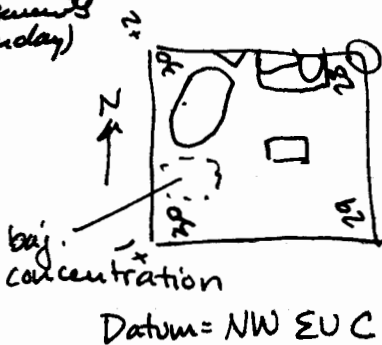
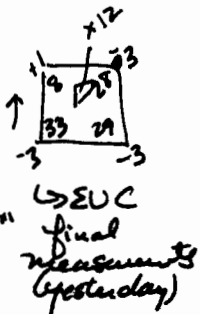

found cool curved obsidian object almost looks like it was a pendant at one time. -> See photo.



found a shit-ton of bajareque - see sketch.

Contents: 102 ceramica
5 obsidiana
175 bajareque

2 Bags

* Carbon - good sample from near bajareque

Friday
26 Junio 2009

2009-17-035

Am starting work in EU's G & H. Am uncovering jumbled rocks and a lot of bajareque. Am removing rocks carefully looking for the walls that I know have to be there somewhere. Several diff. layers of rocks. EU G is lot # 9 and EU H is lot # 10.

Found bone on top of wall line that finally appeared. The wall is on the N side of the EU's, but faces South. The bone frags. were on top of the wall on the NE corner of EU H. The bone looks similar to pieces of radius (?) but doesn't really look human - will have Melissa & Chaitan look & identify it.

thunder =
treno
like tren.

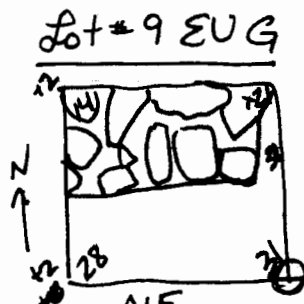

Datum @ EU F

Soil:
dk brn silty clay
loam

Contents:
120 baj.
142 ceramica
4 obsidianas

1 piedra de moler; 4 pedernal

Will continue work in EU H. Tomorrow - leaving shreds in pit.

Saturday
27 June 2009

2009-17-036

Subop
28

Am continuing Lot #10 in EU H. Am attempting to define the end of the north (poss.) wall that may end in EU G, with a nice row of three small rocks. There is a nice flat/round rock next to these in EU H, however, and so more work is needed to define the wall/platform thing.

Am starting Lot #11 EU I, west of EU H. The purpose of this EU is to find the front face or indeed even the ^N end of the western wall that was uncovered in ~~EU~~ Shop 26, the axial trench.

Lot # 10 EU H
Datum @ NE EU G (NW EU F)

Soil: dk brn
Silty clay
loam

Contents:

73 bajoreque
104 ceramica
1 metate
2 obsidiana
5 peridural

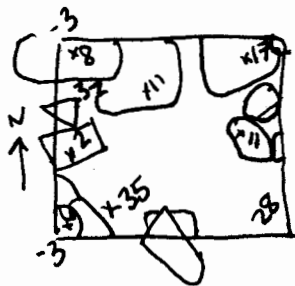

Am finding large (fist sized) pieces of bajoreque w/ very visible stick impressions.

Am starting new EU north of EU G to expose the extent of the wall/platform thing. This will be Lot #12, in EU J.

Saturday 27 Junio 2009

2009-17-037

Jorge & ~~Don~~ Don Beto found a pot smash in EU I near the SW corner. It will be separate from lot # 11 as lot # 13. They are removing tumble from the area & cleaning @ to expose all of it. Almost did splits in unexpected patch of mud under tarp → luckily there was a handy back dirt pile to keep me from going all the way down.

Lot # 13 Pot Smash EU I

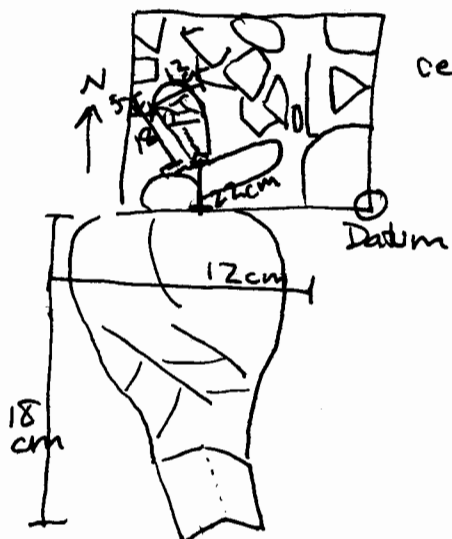

ceramic @ 33cm bd

bottom @ 38cm bd

5cm east of west wall of EU I.

Ceramica

22 cm north of south wall of EU I.

At the base of the western wall → which has been uncovered by EU I. There is a possible line that angles in from the NW to about in the middle of the EU's. This is where the paper/cloth pounder was found → its whole! May have red paint, but is probably just natural. Took photo. Has grooves on 1 side & a carved handhold/attachment area on sides. Was found at base of intersection of the lines & the wall.

Saturday 27 June 2009

2009-17-38

Lorenzo found another bit of bone - this time in EU J about 4" from the north border of EU G - centrally located.

Am going to open a $\frac{1}{2}$ EU north of EU I in order to further expose the odd line/little platform that abuts the western wall on the W. side. This will be Lot # 14.

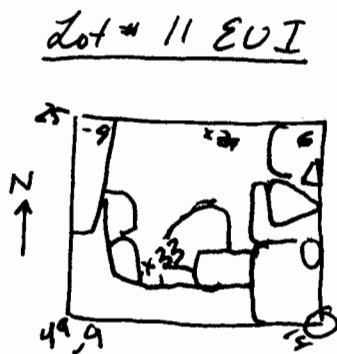

Soil: dk brn
silty clay (am)
hit skulls
yellow (brn)
clay layer

Contents:
163 ceramics
14 bajareque
3 obsidiana
1 peridural
1 ground stone - pounding stone

Lot # 12 EU J → Lorenzo & Serafin just found $\frac{3}{4}$ of a grinding stone may be related to the one the found in 10/28/10. EU H.

Monday 29 June 2009

2009-17-39

Yesterday Ellen, Jennica, William & I shot in the margins of excavations around Subops 27 & 28. We also shot in the plan points for the architecture uncovered so far. This morning we are starting out by moving the southern back dirt/rock piles to the West of the excavations, so that we can continue north towards the fence. Am continuing work in units J & K.

Lorenzo & Stefan found a section of long bone on top of a piece of ceramic under some of their rock fall in the SW corner of EU J. Am clearing around to look for more & will then take a photograph.

Lot # 14 EU K

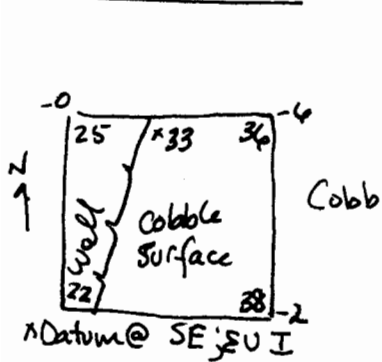

Soil:
dk gry brn
silty clay loam

Contents:

- 131 ceramics
- 13 bajareque
- 3 peridernal
- 8 obsidiana

Lot # 12 EU J

Bone at 38 cm bd (SW EU G) ←

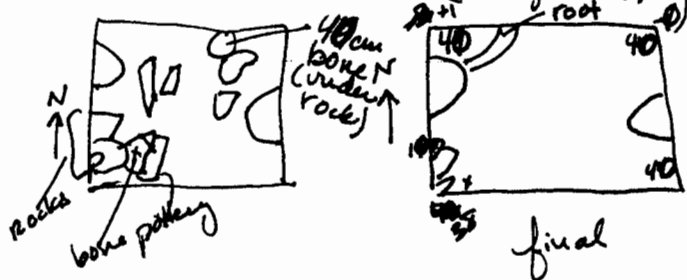

Contents:

- 19 bajareque
 - 19 obsidiana
 - 6 peridernal
 - 275 ceramics
 - 2 bone
 - 5 metate pieces
- 2 Bags

Monday 29 June 2009

2009-17-40

Am starting 2 new EVs. EV L is north of EV K and EV M is ~~west~~^{north} of EV H. The purposes of these EV's are to expose the wall/cobble surface that was uncovered in EV I further to uncover its extent. EV ~~L~~ is lot # 15 and EV M is lot # 16.

Lot # 15 EV L

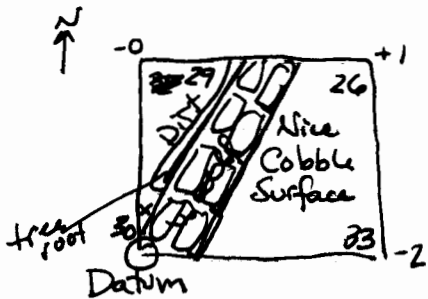

Soil:
dk grey bn
silty clay loam

Contents:

- 193 ceramics
- 13 bajareque
- 5 obsidiana
- 1 peridernal

Cobble surface ^{swall} continues from EV I. Odd that there is either dirt fill/no fill behind the wall which faces East towards the cobble surface.

Starting EV N lot # 17, north of EV M. Just inside of EV ~~M~~^N found ~~pot~~ pot smash - large jar. Seems to be under a wall/fill wall. Whole area riddled w/ tree roots. Workers are cleaning around it. The purpose of EV N is to follow the cobble surface. Am removing unidentified fill/tumble to uncover it further - think its tumble - little organization. Wonder if jar was sitting in place on cobble surface when broken? Pot Smash will be considered Lot # 18.



Rim @ 25 cm bd
 lowest part @ 33 cm bd
 altura (rim) 9 cm
 32 cm wide (E/W)
 17 cm wide (N/S)

Monday 29 June 2009

2009-17-41

Lot # 16 EU M

2

Lot # 17 EUN 3

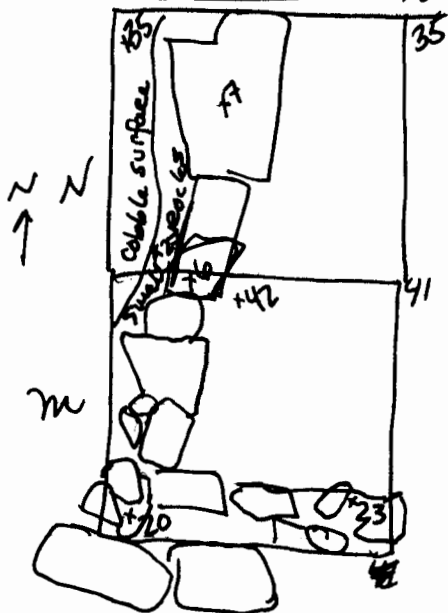

Lot # 16 Contents:

125 ceramica

6 perdernal

1 ground stone

10 obsidiana

8 bajareque

Lot # 17 Contents:

1 metate

7 obsidian

1 perdernal

14 bajareque

151 ceramica

Tuesday 30 June 2009

2009-17-42

Am starting 2 new EU's south of the west end of the axial trench. These EU's are I & J. Lot #11 is in EU I and lot #12 is in EU J. Lot #13 is a pot smash that was uncovered between the two EU's. The purpose of these EU's is to uncover the southern end of the western wall. The EU's are located 3m south of the axial trench (EU's F & G).

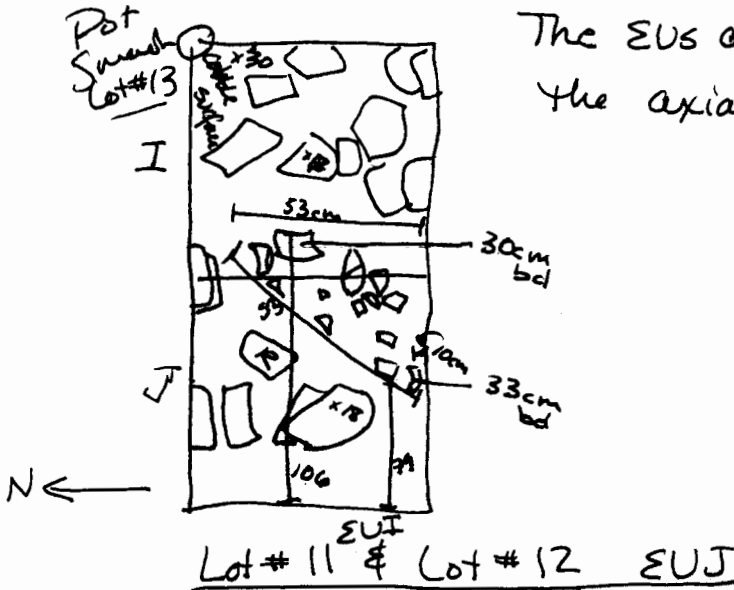

Datum is 9 cm below elevation of SW; EUB Subop 27

Lot #11 Contents:

- found ceramic long tube
- shaped head of ocarina fragment
- 132 ceramics
- 26 biquique
- 6 obsidiana
- 3 peridernal

Lot #12 Contents:

- 120 ceramics
- 13 biquique
- 3 peridernal
- 1 obsidiana

Soil:
dk brn silty clay loam

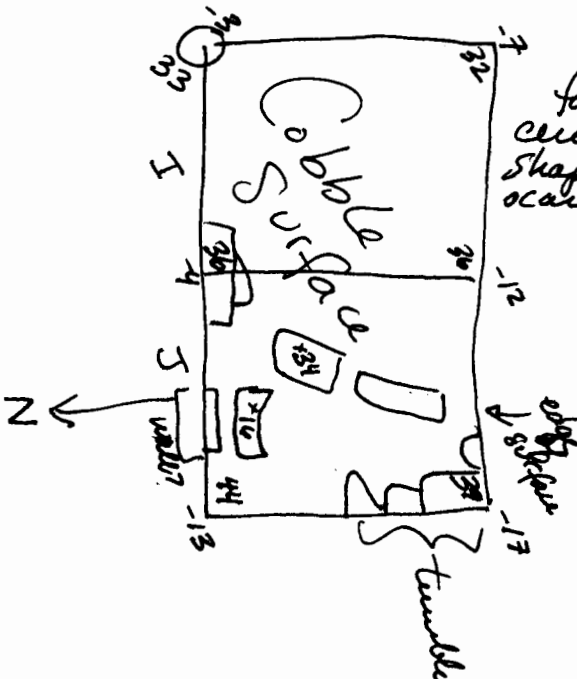

Uncovered a nice cobble surface.

Tuesday 30 June 2009

2009-17-43

EUs K & L are located south of EU G, Subop 26 and north of EU F, Subop 27.

EU K contains lot # 14 and EU L contains lot # 15

* Datum is located at SW EU B, Subop 27.

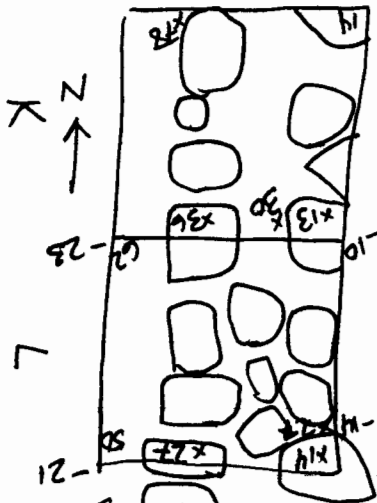

EU I Wall
Soil: dk bn
silty clay loam

Wall is basically 1 course
ends in EU I.

Lot # 14 EU K Contents:

- 75 ceramic
- 76 bajareque
- 4 obsidiana
- 3 pedernal

Lot # 15 EU L Contents:

- 38 ceramica
- 4 bajareque
- 2 obsidiana
- 1 pedernal

Monday 6 July 2009

2009-17-44

unit name	length(N)	width(E)	height	alignment	courses	top	bottom
• West Wall	3.27+1	1.03	0.3	190°	1-2	0.28	0.58
• South Cobble Surface	1m	1.30	0.03	194°	1	0.48	0.49
• east wall	4.09	0.46	0.37	196°	2	0.17	0.54
• east wall Line	0.66	0.18	0.08	194°	1	0.45	0.53
• South Wall	0.33+0	2.83	0.43	291°	1	0.10	0.53
• cache wall	0.32	1.15	0.14	295°	2	0.3	0.44
• North wall	0.50	3.42	0.08	92°	1	0.43	0.51
• West Wall/ connection	1.96	0.38	0.14	200°(20°)	2	0.22	0.41
• North Cobble Surface	1.35 2.27	0.57	-	303°	1?	0.57	-
• West Wall extension 1	0.48	0.46	0.14	111°/351°	2	0.42	0.56
• West Wall extension 2 (most west)	0.23	0.2	0.12	202° (22°)	1	0.39	0.51
• East Bajareque	exposed 1m	0.50	0.09	204°	-	0.52	0.61
• South Bajareque	0.87 exposed	1.13	0.04	291°	-	0.39	0.43

* Datum @ 0.235 m ag. s. near EU C NW corner
* in meters

faces N
N wall abuts back of West wall → ~~later addition w/ West Wall/Connection~~
to form room which was later addition

North Cobble Surface - Seems as though main part of surface stops
North of WWE1 & that the intervening space is fill/extension.
Both measurements given

Str. 20

2009-17-45

	Big	Small	Modal	Type	Shape
West Wall	44x49x19	14x12x	20x17x7	Schist	natl flat faced/rounded
South Cobble Surface	36x29	10x9	19x12x5	Schist/ river cobble	flat few rounded
East Wall	31x48x16	22x15x3	29x23x15	Schist	irregular flat faced
East Line	28x19x7	29x20x7	-	Schist	irregular flat faced
South Wall	36x27x17	21x20x6	33x29x10	Schist	irreg flat f.
Cache Wall	43x31x8	22x26x6	32x16x7	Schist	irreg/f.f.
North Wall	47x28x18	20x8x6	31x23x10	Schist basalt	irreg/f.f.
West Wall/Connection	57x33x12	16x13x4	20x13x13	Schist	irreg/f.f.
North Cobble Surface	27x12	13x6	18x12	Schist	irreg/f.f.
West Wall Ex: 1	29x17x6	10x8	24x11x4	Schist	irreg/ f.f.
West Wall Ex: 2	32x18x15	17x5x7	13x17x7	Schist	irreg/f.f.
East P (West)					

Monday 6 July 2009

2009-17-46

Today we are starting off by finishing up all work associated with Str. 20. First we are cleaning for photos, then I'll take the photos & draw the ~~then~~ constructions & then finally I do final note measurements etc. Then we will tackle final trench photos for Str. 15 and will begin a targeted excavation there to find exterior corners & summit lines. Still need to take some plan points on Str. 20 as well.

Tuesday
7 July 2009

2009-17-47

Today I have another worker - Melissa. She got enough of washing sheeps. She is currently working with Jorge.

This morning we are starting a new Subop 29 which is located South of Subop 25 on Str 15. The purpose of this Subop is to expose the southern extent of Str 15, examine its relation to Str 12 and expose summit architecture. This will be a surgical strike to limit corn destruction & in compliance w/ time constraints.

Three EU's were started as the first set in Subop 29. EU A is located 4m south of EUC, Subop 25. EU B is located South of EU A Subop 29. EU C is located west of EU B. EU A - lot #1; EU B - lot #2, EU C lot #3

In lot #2 EU B ~~dozens~~ Srajin found something that looks sort of like an ear/eye; may be the base of something seems too big to be part of a figurine - see photo.

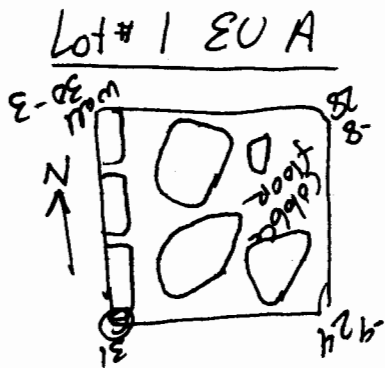
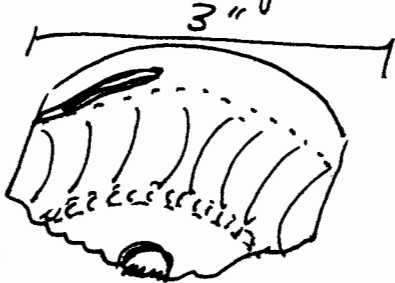

Contents:

- 82 ceramics
- 6 obsidiana
- 3 peridermal

Tuesday 7 July 2009

2009-17-48

Lot # 3 EU C

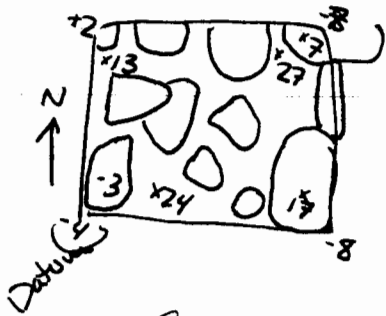

Contents:
 2 obsidiana
 18 ceramica

Am starting new EU (EU D) south of EU B.
 This will be Lot # 4. The purpose of this lot is to follow the East basal wall to its southern extent.

Am also starting new EU (EUE); west of EU A.
 This will be Lot # 5. The purpose of this lot is to better define the line - either platform or step that is west of the eastern line and also to better define the platform surface.

Lot # 4 EU B



Datum is @ SWj EU C.

Contents:
 141 ceramica
 3 obsidiana
 2 pedernal



not to scale

Tuesday 7 July 2009

2009-17-49

Am starting new EU (EU F); this will be Lot # 6. EU F is located North of EU A. The purpose of EU F is to ^{further} expose the E. basal wall/terrace and its relation to the other eastern wall.

Am starting a new EU (EU G, Lot # 7) this is located west of EU F. The purpose is to expose the corner of the nice rocks/step/E wall.

Lot # 5 EUE

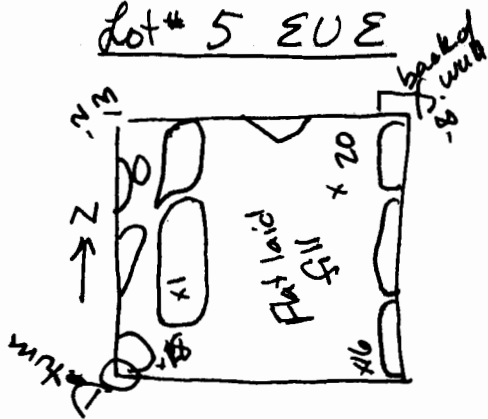

Contents:

- 20 ceramics
- 2 obsidiana
- 1 pedernal

Lot # 4 EUD

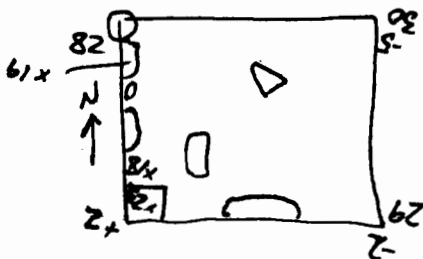

Contents:

- 88 ceramics
- 6 obsidiana
- 1 pedernal

Tuesday 7 July 2009

2009-17-50

Am starting new EU (EU H; Lot #8). This lot is located West of EU D. The purpose of this EU is to define the SE corner of Str. 15

Lot #6 EU F

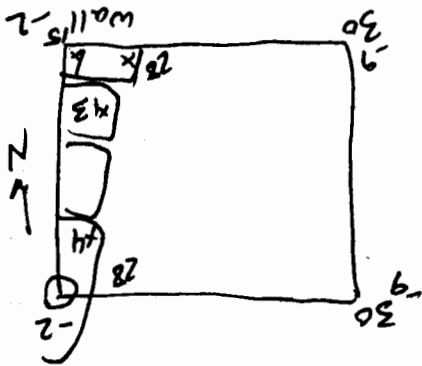

68 ceramics

7 obsidiana

2 peridernal

1 ground stone →

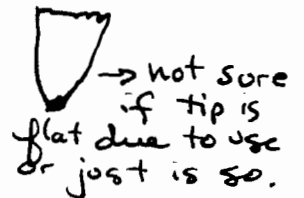

Am starting a new EU (EU I; Lot #9) to the west of EU G. The purpose of this lot is to follow the summit wall exposed in EU G to the west.

* Found carbon in between the 2 east walls about 3 courses of the interior wall down.

I am coming to believe that the interior wall was the first construction phase and that the step/terrace & the southern wall extension/platform were added later to extend the structure. The exterior fill



Tuesday 7 Tuesday 2009

2009-17-57

Lot # 7 EU G

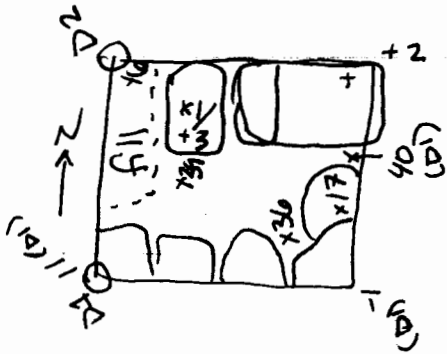

D2 is 10cm higher than D1

Contents:

20 ceramica
1 obsidiana

Lot # 9 EU I

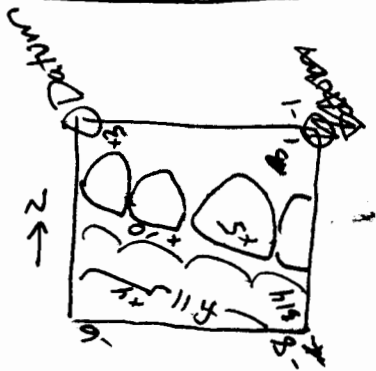

Contents:

20 ceramica
4 pedernal

Wednesday 8 July 2009

Today we are continuing EU H, Lot # 8. We are also starting EU J, Lot # 10 which is located West of EU H. The purpose of this EU is to find the S basal/extension wall.

Lot # 8 EU H

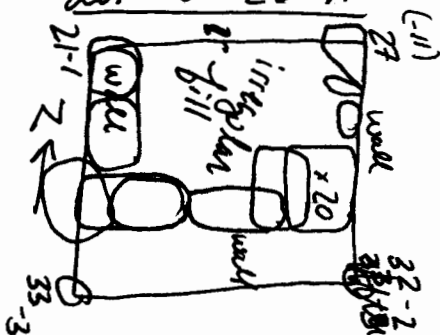

Contents:

32+ ~~32~~ (32)
6 obsidiana
2 pedernal
1 ketate

Wednesday 8 July 2009

2009-17-52

Am starting another EU North of EUJ. This is EU K lot #11. The purpose of this EU is to expose the South wall of platform extension #1.

So far we have uncovered ~~not~~ what appear to be 3 construction phases expanding the platform to the South & East.

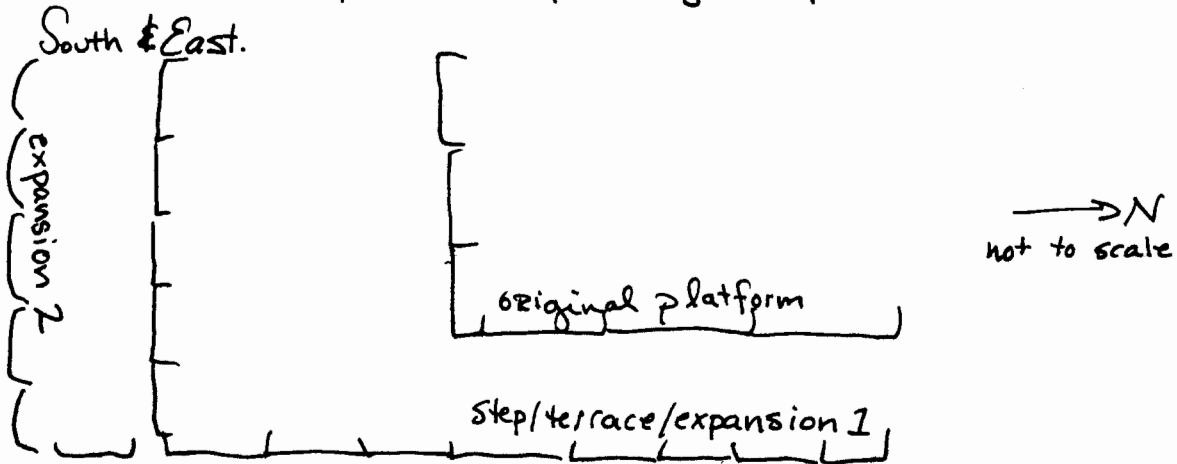

Lot #10 EU J

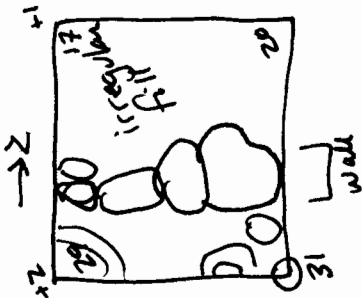

Contents:

- 2 peridernal
- 2 obsidiana
- 70 ceramics
- 1 chip of shiny rock

Lot #11 EU K

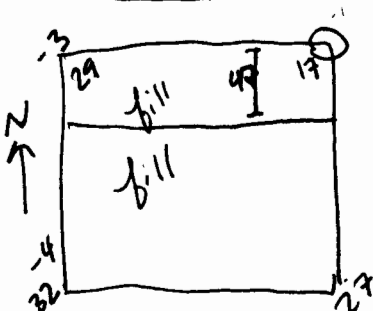

Contents:

- bone
- 50 ceramics
- 2 obsidiana

2009-17-53

Thursday 9 July 2009

	length	width	height	Courses	top	bottom	align
Basal West Wall	ex 1m	0.35		2	0.41	0.84	20°
Basal interior fill							
E. Basal Wall	3.71	0.28	0.58	3-4	0.27	0.72	20°
E. Terrace	¹ 3.67	0.77		2	0.37	0.63	200°/D
E. Cobble Surface	¹ 2.88	1.89		1	-	0.62	92°
S. Basal Wall	1.54	0.25	0.58	3	0.24	0.72	290°
S. Terrace	1.99	3.22		2-3	0.42	0.63	288°

Datum @ 0.22 cm bgs @ SW stake EU D
Base of Excavation @ 1.58 m bd.

Unit Name	Largest	Smallest	Modal	Type	Form
West Basal Wall	60x33x15	16x12x10	20x39	Schist	nat. sq. block
East Basal Wall	48x39	23x19x6	24x26x12	Schist	irregular flat faced/sq
South Basal Wall	42x29x15	20x17x7	23x35x13	Schist	irregular flat faced/sq
E. Terrace	37x17	19x20x10	28x30x8	Schist	"
S. Terrace	40x31x10	14x12x2	28x18x10	"	"
E. Cobble Surface	56x35	12x8x2	28x23	"	" flatter
Basal Interior fill					

Str 20

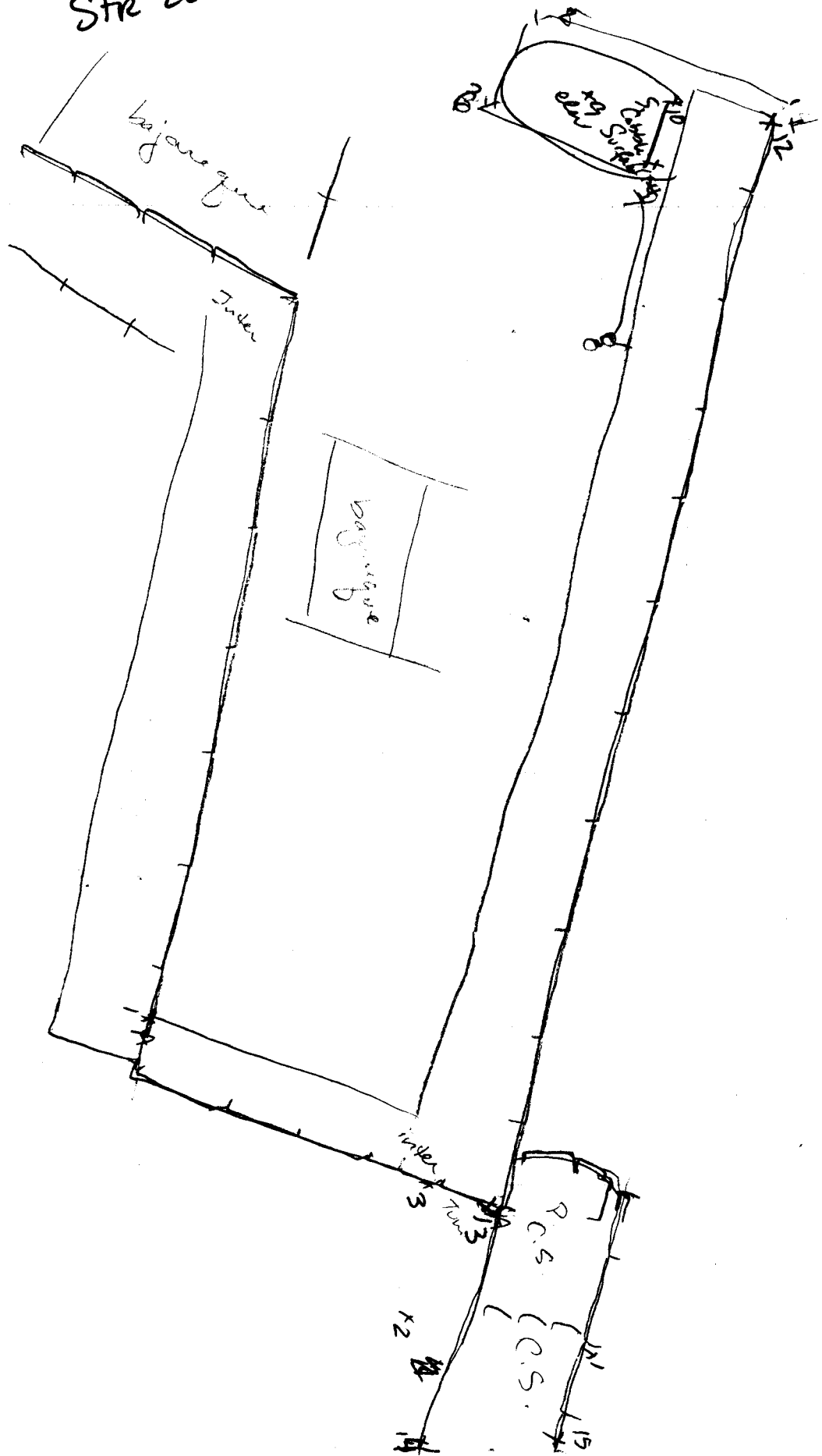

Str 15

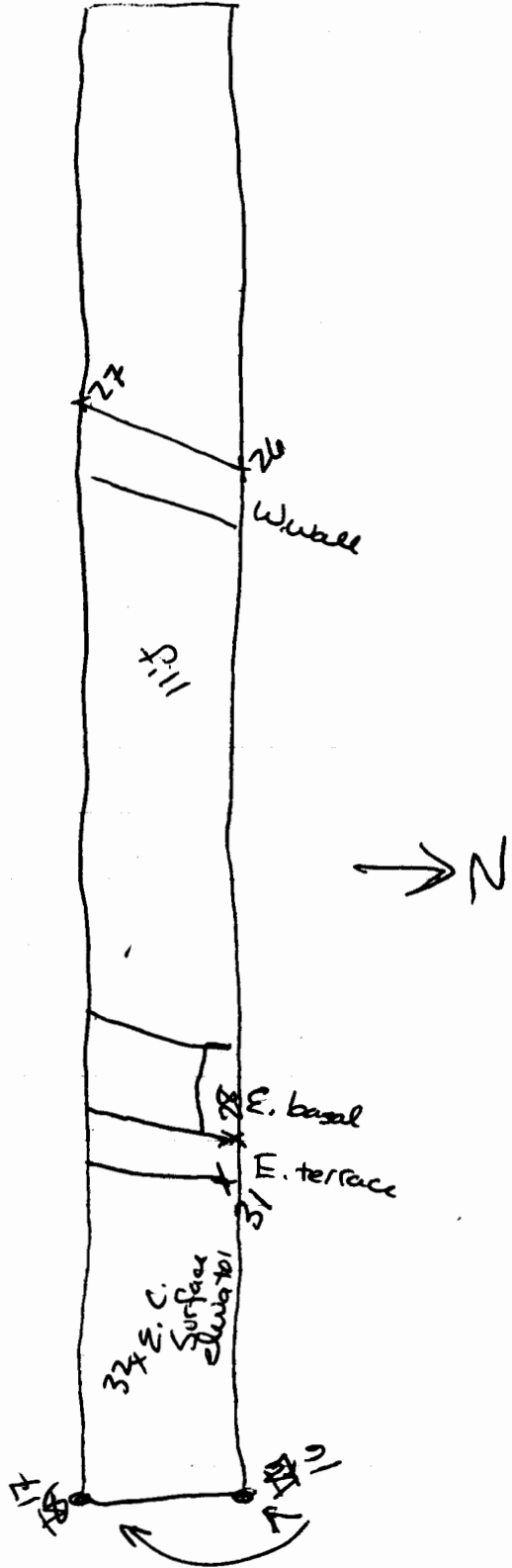
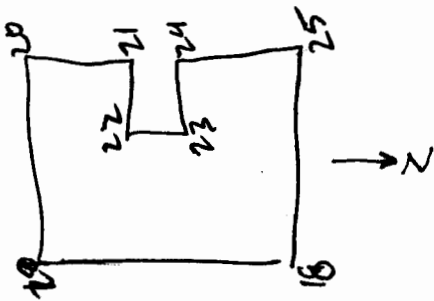
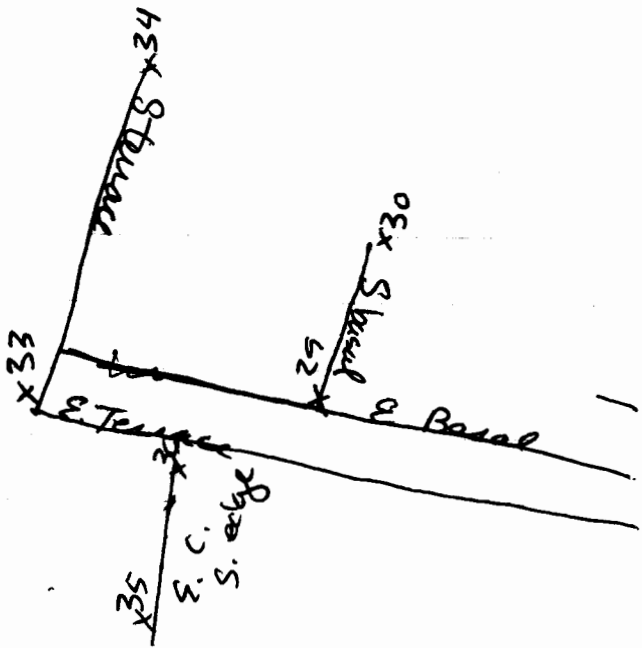

Op. 10 Slamp. 25/29

Los Navanijos

S-007

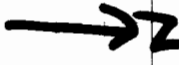
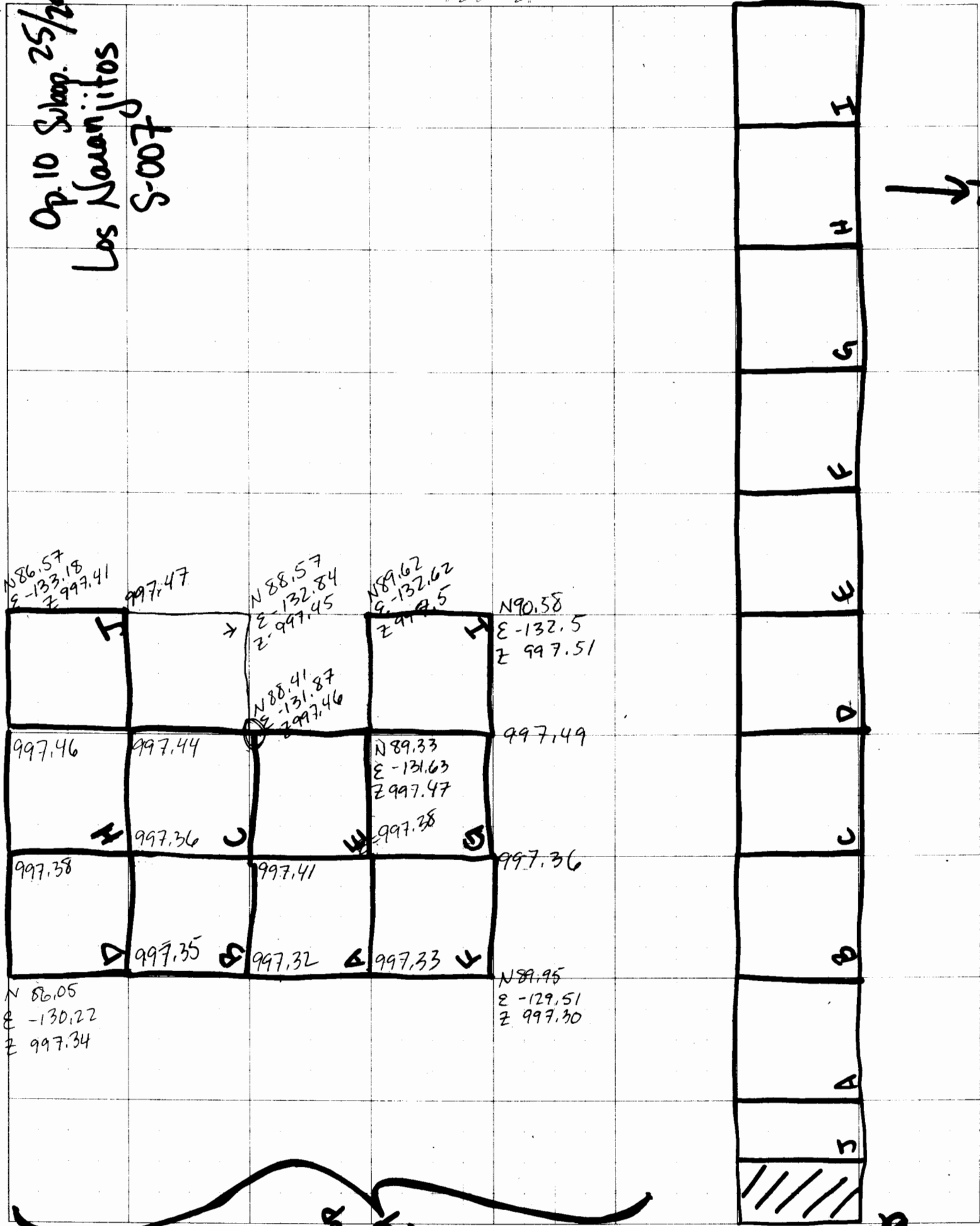

Slamp 29

Zona 60

Op 10
 Subops
 25, 27, 28
 Los Nacajitos
 (S-007)
 Ex:17 2009

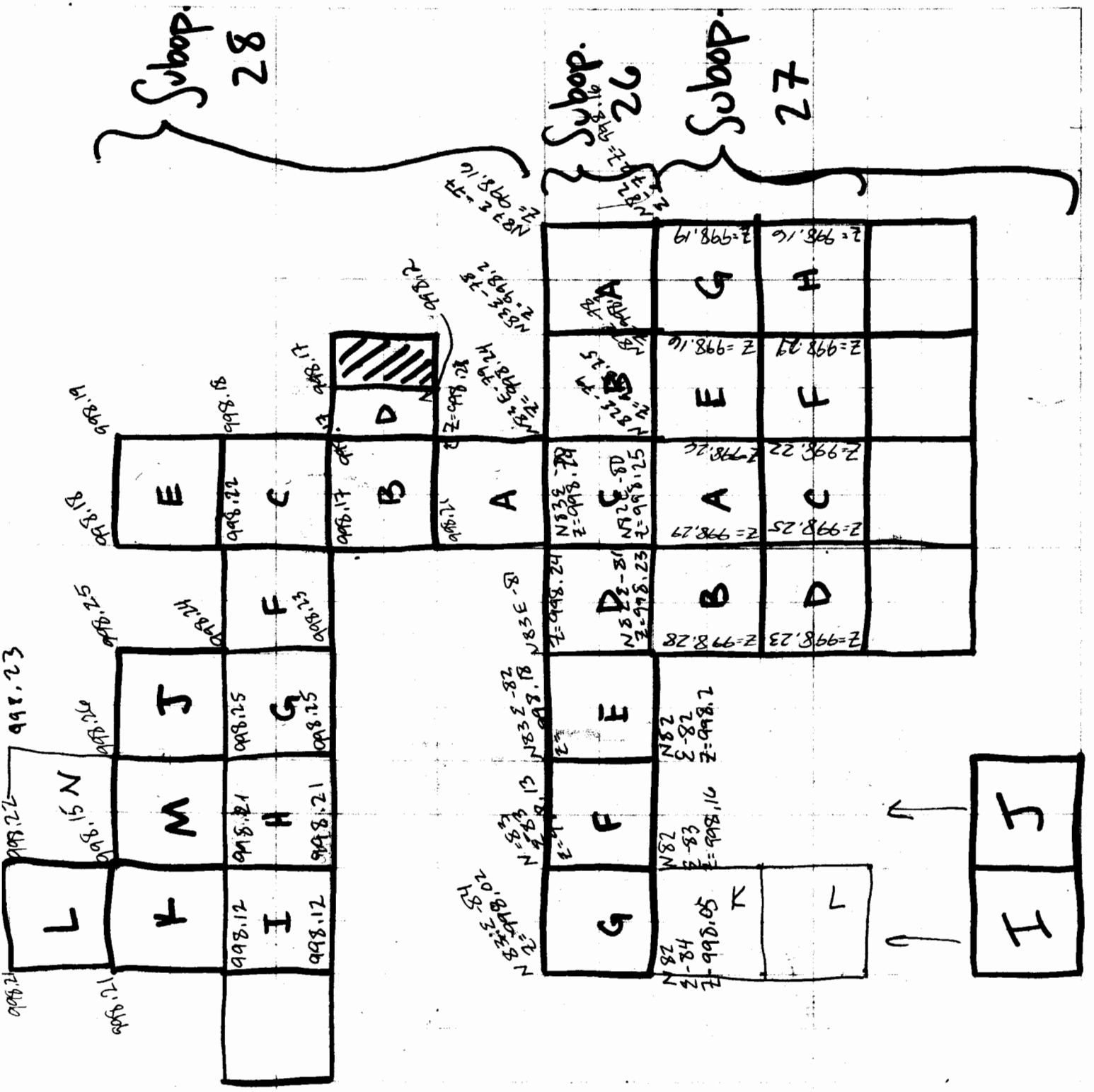

↑