

2010

EPV 040 Kittel Field Notes 2010

Michelle Mike Kittel

Follow this and additional works at: <https://digital.kenyon.edu/honduras>



Part of the Archaeological Anthropology Commons

Recommended Citation

Kittel, Michelle Mike, "EPV 040 Kittel Field Notes 2010" (2010). *Four Valleys Archive*. Paper 96978.
<https://digital.kenyon.edu/honduras/96978>

This Field Notes is brought to you for free and open access by the Anthropology at Digital Kenyon: Research, Scholarship, and Creative Exchange. It has been accepted for inclusion in Four Valleys Archive by an authorized administrator of Digital Kenyon: Research, Scholarship, and Creative Exchange. For more information, please contact noltj@kenyon.edu.

10, 2018

2018-48-01

First day back in the field feels pretty good. Weather is mostly cloudy, with moments of sun and occasionally breezy. Working S-007 sub-op 10, str. 03, at Los Naranjitos. Mary is our site director since she is working on expanding her research from the previous year. Last year focused more on the small households, while this year we will be examining what are being called "suburban elites." El Cafetal is less than 50ms to the East and yet it appears that the elites at Los Naranjitos still remained separate during ceremonial or ritual activities. We are incredibly close to where Mary located the complete cache vessel that had the pseudo glyphs, so I'm hoping that the str. (structures) we excavate will yield other interesting artifacts.

My str. is bisected E-W by a fence. The backside appears to be on the East side, where there is a portion of a wall exposed that is beautifully preserved.

Right now we are waiting on Bell + Santiago to establish a temporary datum so we can shoot in our units, which is why I'm writing up notes now rather than at the end of the day. My stomach just ~~growled~~ growled - time for Chiky's!

Site / op / sub op
Date
Fx # Str.
EU LOT

Chalk board

Op / sub op / EU A Lot
Ex: 48
Date

"Sacar la piedra por favor": please pick up the rock
an incredibly useful phrase

so at lunch ate my triple decker pbj and then took a nap.

... later.

Did not do much at all today. Bell and Mary moved my opening trench back and forth across the E

until they decided to open it where the preserved wall is visible. But the EDM had already been packed and moved to shoot in Catalina's and Jenica's pits so I had to wait for them to come back to the North side of the fence.

Basically I spent all day waiting.

I helped Becky open her trench, and Jasmine too, but my points were never shot in because by the time they came back it was well past 4. So I sat around hot and sweaty and bored all day.

19 June 2010, Saturday

did not sleep well at all last night. I tossed and turned and lay awake forever. I had read through over 50 pages of the new Sookie Stackhouse novel (it's okay =) and it was past ten, but I still wasn't tired. I think it's because yesterday was the first day I had ever spent in Honduras where I wasn't exhausted from physical or mental exertion. This was upsetting since it meant I spent most of the night thinking about everything, which has done nothing for me getting over this depression. The entire point (not the entire point but one of the major perks) of running away down here was getting away from everyone who has fucked me so badly this year.

We're starting to lay my trench so I will stop now (want cigarette) and try to look like I know what I'm talking about.

... So my trench starts at the back of the str. and is 2×6 , or 12×1 units.

19, June, Saturday

EU A
lot 1
Ø-22

EU A
lot 2
2Ø-3Ø

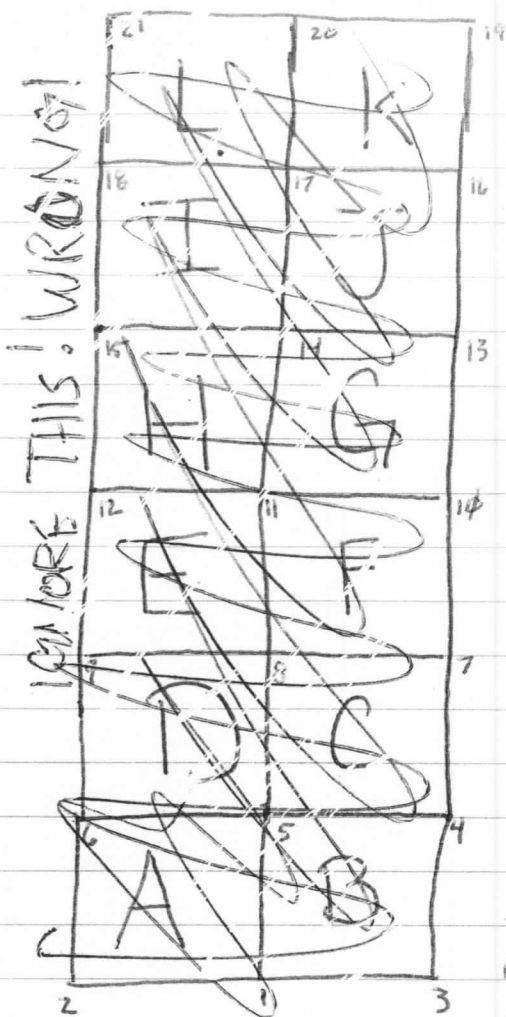

IGNORE THIS! WRONG!

2Ø1Ø-4Ø-Ø3

I opened EU A first and went down 22 cm because the highest corner (PT 5) was 22 cm above the lowest corner, pt 3. In this lot was a little bit of overburden, and the surface layer of humus. For being a 2Ø cm unit not a lot of artifacts were found. Most interesting were some small obsidian debitage blades. They were found in the SW corner. I finished this lot and continued in this unit for another 10 cm. About 5 cm down I started to see what might be the line of a wall (Mary) said it might be an apron patio. Again not a lot of

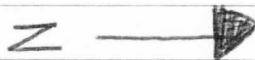

artifacts, which is surprising to me because this is the back of the building, and my experience last year was that was where the trash was thrown.

But then again I was digging a clearly residential structure, and I am not sure what the function of this building is yet. I opened up my next lot in EU B in an attempt to see if the line follows into that EU. I originally meant to do another Ø-22 lot but my math got wonky and it will wind up being Ø-28 (whoops). I was working with David and we were moving quickly I hoped to be able to finish my 3rd lot but end of the day was called before we finished evening everything out. Another 30 min would have closed the lot, but now I have to wait til Monday and I heard Monday is going to be a 1/2 day because of the World Cup

EU B
lot 3
Ø-22

2010-01-04

Match between Honduras and someone else. On Monday I will be assigned two workers. Up til this point I had been digging alone or with David. I hope I work with Chipi. He was helping string my EUs and build my Champa and seems to be friendly (if his clothes are almost always falling off and leaving disturbing images in my head)

21, Junio 2010

EU B
lot 3
0-22

Let's see. Got out to the field this morning and finished cleaning lot 3 EU B and closed it with the requisite photos and drawings. About this time Bell came over and assigned me workers. I have Nanyas / Nanyas / Nanyas (Ryan's worker last year) and Leonel (Chelsea's worker last year) Filiberto seems to have just disappeared.

EU B
lot 4
22-32

By the time I finished lot 3, No L had finished putting up my champa, and I was ready to open lot 4 in EU B. I had not discovered a line that followed from A yet so I ~~was~~ went down another 10cm (22-32) to see what I could find. There was a large square rock that was at angle and about 5cm above the possible line in EUA, so I took it out as tumble. 5cm below that, in good orientation with EUA I found what I was looking for. EU B Lot 4 ~~had~~ has two stones that fit in with the line in unit A. There are still not many artifacts, mainly a few pieces of obsidian and ceramic

EU A
lot 5
30-40

Because I had found what appeared to be a wall, Bell and Mary told me to hop back over to EUA and dig in front of the wall to make sure the soil was sterile. Sure enough ~~about 10cm~~ almost directly underneath the wall line we found more stuff. 3 large rocks set close together, Mary wonders if its a floor.

EUA
lot 5
3φ-4φ

2φφ - 4φ-φ6
Now we will call the upper course a step, if the feature in EUA lot 5 turns out to be a floor or the basal wall.

EUB
lot 6
32-42

Went back to EUB and opened lot 6 in front of the step and there was the line.

→ N

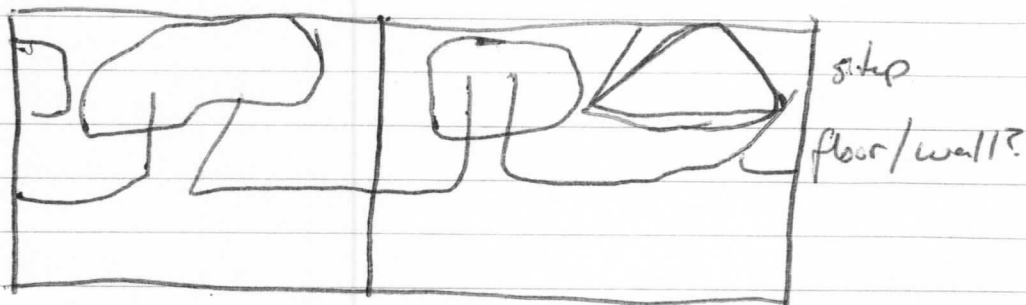

not a very good drawing, but that's the general idea. For EUB lot 6, we only dug the Eastern half of the unit, and found the continuation of the second course or step here. Decided to go down 1φ cm more in front of this line, still in EUB.

EUB
lot φ7
42-5φ

1φ cm later and it appears this ~~is~~ feature might be the E. basal wall and therefore the first feature I get to name. I will name the E. Basal wall Glooster, and the step Kent. This lot was 8cm, 42-5φ BGIS

EUM
lot φ8
φ-10

The next move was to measure out 2 new units to the E of A + B, These were named M + N. We did this to find any artifacts that might have been thrown off the back of the building. The opening lot 8, in EUM is only a 1/2 unit, so 1 X .5 N-E, to see if the feature extends, or to uncover artifacts.

EUM
lot φ9
1φ-23

Nothing was found in lot φ8, this was an empty lot. the elevation for the SW corner was given as 997.7φ8, so for ease I rounded up to 997.71. I managed to get a 6th lot open today, EUM, lot φ9, but was not able to finish. lot φ8 was roughly 1φ cm, with one of the

21-Junio-2010 Monday

2010-40-07

corners being 14, and two being 13. This was due to the difficulty of communication in explaining how to dig the opening lot. I can't say "dig to ten cm, because they will take every corner down to 10cm, rather than create an even, uniform surface in which all the elevations are the same. I'm hoping to get lot 9 EUM down to 20cm all over without too much trouble, but Tlaloc only knows how that will work out.

EUM
lot 9
T0-23

Bell came by to tell me to clean up, because this was only a 1/2 day. We are going in to watch the World Cup Match between Honduras and Spain and yay! Mac and cheese for lunch. After lunch we are washing artifacts and I'm going to put on the Big Bang Theory.

P.S. Quezetzquatl bless white out. I have to basically rewrite my lot forms to clean them up. We ran out this ~~morning~~ ^{morning} so I had to make them out of graph paper. And the chalkboard was stolen by Erlend. Even though he is only 50m away in El Capital, it was too much effort for us to try to run back and forth to get it so I was using a sharpie and graph paper to take my lot photos.

		→
K	L	
J	I	
G	H	
F	E	
C	D	
B	A	
M	N	

Spent the afternoon washing pottery... yay? I had originally thought there was a piece of bajareque, but it was actually ceramic which means that so far there has been no bajareque found at this str so far. Which makes sense with the amount of tumble that seems to be around the building.

22-Jonio-2010 Tuesday.

2010-40-08

Its gonna be a hot day yesterday I cleared 6 lots, I'm hoping to do just as good or better. Leonel and ~~Chippie~~ Nimeas both move fast.

-almost lunch and we've already cleared 7 lots. tired and need food so we can continue this pace.

-Exciting day. By the end we cleared 11 lots and found a floor which I am naming Rosalind.

EUM
lot 09

B	A
M	N

But to start at the beginning beginning. Began the day by finishing lot 9 in EUM. I was looking for any kind of extension of the basal wall Gloucester. At 23cm there was no evidence of an extension, so I decided to cont. down 10 more centimeters til I was even with EU B. I figured that if Gloucester was the basal wall then I would be at the living

EUM
lot 10

23-30

surface for the final construction phase. When I got to the end of lot 10 EUM, 23-30cm (I'm trying to keep my lots uniform, but without much success) I decided to remain in EUM and go 10 more centimeters because of a flat level rock hiding just in the next lot in the SW corner of the lot. I want to see if this is an extension or just a piece of tumble

EU M

lot 11

30-40

Lot 11 EUM, this is the first lot we've had bajareque and in 30-40 cm I found no extension of Gloucester wall and I'm beginning to think this is all of the E. side of the building, so I'm going back to B to find the bottom of the basal wall and see if there are anymore courses, and to bring it level with M. I going to start keeping my eye out for sterile soil and color change

EU B

lot 12

50-60

Lot 12 EUB 50-60 was an empty lot, and quite boring and the Gloucester wall has such long big rocks that I still haven't reached the bottom of it

I'm bouncing back and forth between B + M taking one down and then leveling the other. I will do this to A + N as well

22-Junio-2010 Tuesday

2010-40-09

noticing a significant increase in the artifact assemblage though there is still not very much considering this is the back of the building. Bell told me this was not a residential str.

EU B
lot 13
60-70

In the NE + SE corners there are large slabs of ~~concrete~~ that look like they are connected. (not to each other but farther down). Wondering if there is a pot smash. I'm going to level this lot 13 EUR 60-70 and then jump back to M to see if it extends

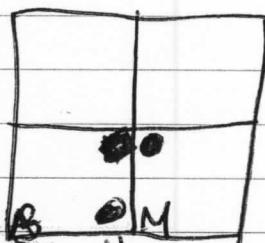

where the pottery in B + M is less also more baja reqre

EU M
lot 14
40-50

lot 14 EUM 40-50 - there is more pottery in the ~~NE~~ NW corner of M that seems to match up with B. The soil is much more clay based which makes me think we ~~should~~ should be getting close to strike. The ceramics are at the exact cross roads between my four open units so I am going to open a 1/2 unit in N and start to bring it down to see if the ceramics are a pot smash.

EU N
lot 15
0-20

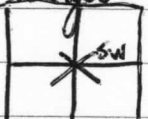
lot 15 EUN 0-20 - originally the reference corner was the SW corner, but I changed it to the NW when the stake started falling out.  should have anticipated this.

In the opening lot, not many artifacts, 1 chert 2 ceramic, but I expected this since all of my artifacts so far seem to be clumped at the bottom of the units. I expect to find steadily more in the next 2 lots.

EU N
lot 16
20-30

lot 16 EUN 20-30, kind of bored, nothing big or interesting, and so far no extension of the building. I'm gonna go back to A and get that EU level with N Uno, and just

22, Junio. 2010

2010-10-10

bounce back and forth between the EU's looking for sterile soil.

x got the unit beautifully level all across so I think it is safe to make my other two corners, the SE & NE level elevation with my known corners, and start subtracting from those.
997.36.

Bored, I'm sorry I can't help it. I'm not digging and nothing is being found. I'm just listening to a mix of Disney songs and humming along.

EU A
lot 17
lot 42-52

10/35/17 EU ~~A~~ I'm just going down in the Eastern portion in front of the steps of Gloucester Wall.

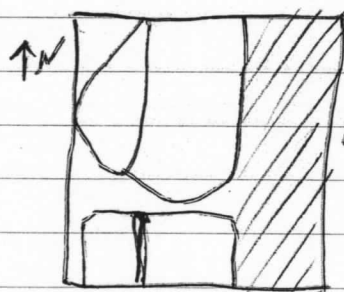

I'm down to 52 cm, and found only 4 ceramic.

EU A
lot 18
52-62

10/35/18 EU A, going down 10 more in front of steps, then I'll hop back to ~~unit~~ 1/2 unit N. and level with A. There is more ceramic here, B pieces, but still bored. This ~~the~~ unit is now level w/ B & M, so going back to N now.

EU N
lot 19
30-39

EU N 10/35/19 30-39 cm
more ceramics at this level than others, plus chert & Bajareque.

... ummm, yeah. So the pieces of ceramic I had been leaving in place in M & B got thrown away with the soil they were scooping up from N. I'm kind of angry since I had made a big deal about leaving them in place all day just to see if there is a pot smash or something.

2010-40-11
the paste is red on black ~~underneath~~ and really beautiful. I'm glad there are still ~~examples~~ ^{red} examples in situ, but I'm pissed.

All of the EU's are level now. So I'm going back to B to excavate out the rest of the ceramic.

Leonel and Navemias are not welcome.

There is an unbelievable amount of ceramic coming out of this unit now.

lot 20
EUB
70-73
FLOOR!

-Right when I was getting ready to call it a day and finish this lot tomorrow, ~~Taloc~~ / ~~Chaac~~ above we find a floor! a piso.

Bell had come over and explained to Leonel & Nymias what they had done to make us kick them out and they were digging slower and taking care to collect every piece of ceramic. When they uncovered a second course to Gloucester and then a gorgeous cobble floor that it is sitting on.

I'm going to name my floor Rosalind from "As You Like It".

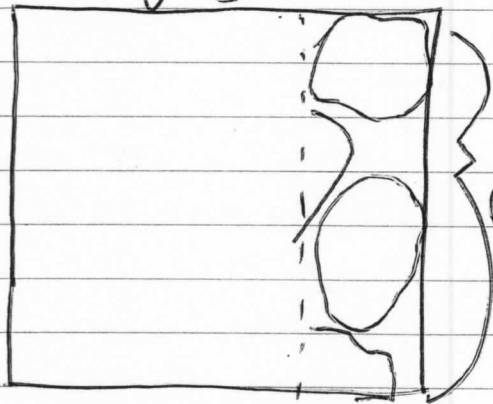

we only have her uncovered in the small eastern portion of B and the day is over ROSALIND. so first thing tomorrow I will begin to take M down to floor level

75 ceramic, 3 baryceus
1 carbon sample.

★ Carbon sample taken in great context with the ceramics that are situated just above the cobble floor which means that this artifact assemblage is in primary context (I hope :))

23 Junio 2010 Wednesday

23/06/2010 - 40 - 12

EU A

It looks like it will start raining any moment.

lot 21
62-76

So started the day by jumping over to EU A and digging in the E. portion of the Gloucester wall to find Rosalind floor. Also found the second course of Gloucester wall. Its hard to believe how large these stones are. So far the largest is:

76 cm long

18 cm high

30 cm deep, and other measurements as well!

the amount of ceramic has increased dramatically as well, which makes sense since this is the living surface. The artifacts found on top of the floor are in primary context. Which is pretty freaking awesome.

EU M
lot 14

So the next step is to go back to EU M and take down the other 1/2 of the Unit til it is level w/ lot 14 EU M and then take the entire unit down as a 1x1 m square.

EU M
lot 22
Ø-3Ø

for lot 22 EU M my reference corner is the SW corner of the entire 1x1 meter square. I started by finding out how far below the reference corner each corner of the 1/2 unit was.

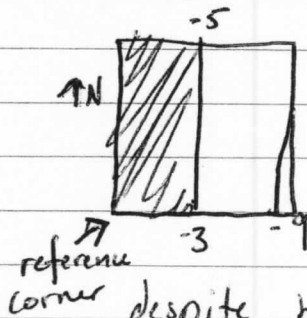

since ~~of~~ one of the corners is already almost 1Øcm below I will make this a Ø-2Ø cm lot...

make that Ø-3Ø

interestingly this is an empty lot despite being over 2Øcm deep, but that seems to be pretty normal, so I'm not worried.

EU M
lot 23
3Ø-33

There is an unbelievable amount of tumble, and pieces sticking out of each of my corners, so my corner measurements are really small, even though the floor that is exposed is as evenly 1Øcm as possible.

Hmm, I need to reapply my nail polish, its already pretty much gone. Its purple, my favorite color.

~~Monday~~ 23, Jun 24/8 Wednesday

2010-40-13

EU M
Lot 24
33-40

This is the last $\frac{1}{2}$ brick lot in this unit, so I am evening it with the West portion of M, and then I will draw it as a complete 1x1 m square. (Should I be referring to this as cube's since they are 3-dimensional and not in all actuality squares?)

Very little interesting is happening, and I'm excited about uncovering more of my piso. Last night I made a song about my floor. I started singing out PISO! PISO! PISO! on Tuesday to the tune of 'Draddle Diddle Diddle' (1'd or 2 in the middle?) and the 1st line is Piso! Piso! Piso! ~~es~~ eso de piedra (floor floor floor, you are made of rock!)

I was having trouble with the 2nd line but Bell saved me.

Piso! Piso! Piso! te voy que debojar (I have no idea about spelling but it should translate as Floor! Floor! Floor!

I have to draw you!

I don't know the rest of the lyrics in Spanish off the top of my head, so I will copy them in later.

EU M

lot 25
40-51

Anyways...
The last 9 centimeters above the cobble floor were intense. There are 2! lot bags! of ceramics. And we got another carbon sample mixed in w/ the ceramic that was in primary context on the floor.

So far this is the most ceramic found of all the lots.

The condition of the floor becomes questionable about 50cm E of the NW corner, but picks up again close to the east wall of EUM.

Is this poor workmanship? a later construction phase? rotting raw materials?

So I'm...

The bugs here are freaking fascinating! I'm watching a cricket dig a hole and lie in wait for an unsuspecting ant,
Sorry, back to work.

23, Junio 2010

2010-40-121

We're going back to N, to take down the unexcavated 1/2 unit like we did in M. We're moving so quickly that I don't have time to do field counts of my artifacts. I'll have to wait til we get home. It's pouring rain, and underneath my tarp, stopping for a moment to look across the fields to my mountain is unbelievably peaceful.

EU N
lot 26
0-20

like with the start of EUM I made my reference corner at a corner of the 1 x 1 m square cube, in this instance the NW corner. I figured out how far below the reference corner, the corners of my 1/2 unit were. The opening lot will be 0-20.

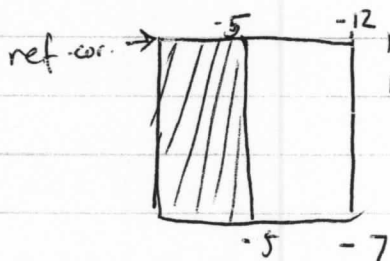

Not many ceramics or other artifacts. Next lot will be in both halves level, and then I will excavate the complete 1 x 1 m square.

EU N
lot 27
20-30

So we blew through this unit. There are more ceramics, 19. But now we are getting near the end of the day. I want to finish this last lot before pack up.

!!! The last lot of my days last 2 days have been incredibly exciting.

EU N
lot 28
30-40

So I said "abajo to piso" down to floor and down we went down and the artifacts were overwhelming.

We found bone, which is incredibly rare in this soil since it's so acidic. It's not human, maybe some kind of bird, which is evidence of feasting (maybe). We also were pulling up pottery with red slip and hematite in the glaze. It was an incredibly fine paste and reminded me of the Copan imports. I'll need to clean it off but I think we got some painted Copan ceramics. Also there was a ceramic ear, with an ear spoon (ceramic), and lids, and rims, and handles. I'm wondering if there was a broken censor thrown back here? That would be awesome. Maybe I can bribe Cassandra with my Marlboro lights.

23 Junio 2010

2010-40-15

to attempt a reconstruction. She's just been smoking the junky local cigarettes, I had one, and I might as well have just been breathing, there was nothing to it. She's been bugging off me, so I know she's getting tired of them. I'll see if I can use this to my advantage.

24 Junio 2010 Thurs.

Good Morning. Buenas Dias.

Laying out a new EU behind M to go find the extent of Rosalind.

Will open a full 1 x 1 meter unit first and if it continues extending will open 1 x .5 meter units until I find the end.

EU 0

lot 29
0-29

In the 1st lot of EU 0, lot 29, didn't find very much. But I expected that, since if the floor continues out, it will be a ways down still. I will continue down until I hit the floor or hit sterile clay. There are 2 large boulders between M+0 that the point of my stakes in the NW & SW corners of EU 0 are resting on. They are probably tumble, but they are homogeneous.

EU 0

lot 30
20-30

Not much at all. Just a handful of ceramics in the next ten centimeters. I think I'm about 10cm above Rosalind, so I should be hitting it in the next little bit.

EU 0

lot 31
30-40

Ahhh - my mp3 player died right in the middle of a good episode of "Ricky Gervais Guide to ...". Now I get to sit here in silence.

Looks like Rosalind ends in EU M. I expected to find the apron floor before 10cm was up in EU 0 lot 31, but it looks like we've passed below it. It seems to end directly beneath the 2 huge boulders/tumble, which is kinda weird. I can't guess if that might mean something, or if it's just a coincidence that these rocks tumbled down like this.

Showed it to Mary and she thinks it's kinda weird too, because they are such BIG Rocks.

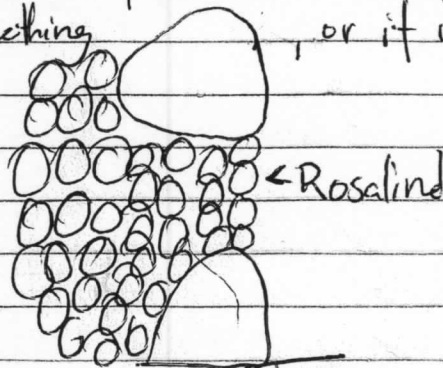

- Going to start looking for sterile now, which is boring.

24 Junio 2010 Thursday

2010-40-16

E O
lot 32
40-50
the floor might still be found. My artifacts have spiked in lots 31 & 32. In this lot I found an Hatcher, a little stone axe. Its so freaking cute. If the floor does continue, it can only be a centimeter or 2 below the surface. or this is somewhere the original living surface of the str.

Nope floor is definitely ended, there is not even tumbler.

EU O
lot 33
50-60
Noting a soil change from DK Brown to a lighter brown. The yellowish clay that usually marks sterile cannot be far below. But we found 2 ceramics so still not there. Even though we are no longer digging through loam, it is definitely clay. This stuff takes forever to excavate through, and all I can do is sit & watch and catch up on notes.

leonel is kind of annoying me today and I'm beginning to wonder if I can tell him to just keep digging down "dies mas akaja" to more down, for the rest of the day. Just to see how long before he catches on to what I'm doing.

E O
lot 34
0-60
I'm so happy to hit sterile. It means I can start excavating up the structure. I admit to being disappointed not to see the floor extend but the preserved wall in EU(H) is calling.

Going to start in structure. EUC now. Hoping to find floor or terrace wall. Its the end of the day, so I will not open C today because I will not have time to finish a lot.

25 Junio 2010 Friday.

I cannot help but think that at home, Friday would be the end of the week. Here I have to make it through Saturday to get a day off and then I have to spend 1/2 of my Sunday washing pottery. Blech.

Not that I'm actually complaining for real. I'm always excited to get back out to Str. 3. in the morning. It seems like the end of my day is always the most exciting and then I have to close and clean up.

EU C
lot 35
0-50
So the 1st lot in EUC, lot 35 is so big because there is just so much tumbler. Looking at it I cant really figure out what is going on. I'm going to open EUD to the N of C to get a bigger picture of what is going on. How this mass might relate to the basal wall cluster or the keut step

25 Junio 2010 Friday

2010-40-17

I have no idea.

EU D I have to use the SW corner of EUC (N 54, E, -136)
lot 36 as my reference corner since the SW corner of EU D is going to get
D-50 knocked out as soon as I open D.

In lot 36 I'm just going to go down in front of the Eastern portion so I can approach any architecture from the side and not plow right through it

(Bilingual students visiting, this is odd and uncomfortable having a bunch of teeny-bopping, overly make-upped girls still apathetically on as I try to explain what I'm doing up to my neck in dirt (soil $\ddot{\smile}$) and drenched in sweat. Feel very un-petty).

iii Have no idea what's going on in my units.

EU D
lot 37
50-60

An ode to EU's D+C

- Fill or feature,
That is my question.

Flat laid stones,
confound logic.

Something waiting to be found,
discovered,

uncovered,

A puzzle to be solved.

It is a shame that my only answer,

is to sit here,

in silence,

staring ahead,

and writing bad poetry.

Bad Poetry?

Oh Noetry!

Anyways...

There might be a terrace floor, there might not.
Going back to EUC to start pulling up tumbler.

25 Junio 2010 Friday

2010-40-18

- Gently removing tumbled trying to see what is going on.

EUC
lot 38
50-60

There seems to be a change in soil color. It seems to be a lighter shade of brown in lot 38 than previous lots. If this is tumbled it is all roughly flat, and fell incredibly level. The stones are also smaller size than what was coming out on top. All of which makes me think that this is Fill not tumbled, which means we must have blown through a wall somewhere. I'm very unhappy about this. I searched the profiles but I can't seem to see the wall. Anyways it is the end of the day, and I'm tired and grumpy. Listening to "Garbage" Version 2.0" and that seems to be helping with my mood.

26 Junio 2010 Saturday

Apparently get to give another tour today. The labrats are coming into the field to get an idea of what our str. look like. I'm still frustrated by my units.

EUC
lot 39
60-70

- talked it over with Bell and she agrees that this is Fill. current theory is that Gloucester would have been more courses, making a terrace wall #1 #2 Or it could be that Kent is actually the terrace wall and it is that which is missing courses. either way I think Gloucester. this means I did not accidentally dig through a wall like I thought, because there was no longer a wall to find. There is a third option that I have to explore and that is that this lot 39 which is now level with EU B is actually a terrace floor connected to the basal wall Gloucester. I am tentatively going to name the floor Beatrice with a note that it will possibly be renamed when I open EU E + F and can get a fuller view of what is happening

EU D
lot 40
60-71

Went back to D to look for wall or any evidence that Beatrice is not a floor, but at the bottom of lot 40, Beatrice looks even more like a floor.

I'll head up to F now to look for a possible wall. I think if Beatrice really is a floor then there might be another terrace up to the beautifully preserved wall in EU H

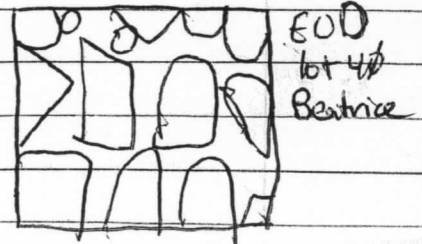

26 Junio 2010 Saturday

2010-40-19

EU F
lot 41
0-30 Facing the same problem in EU F that I was in C & D. I can't tell what I'm looking at. No evidence of a terrace floor in the 1st 30 cm where I expected I might see something. Can't help wondering again if there was a poorly preserved wall in C & D again. Because all this looks like fill.

Thank goodness it's the end of the week & the end of the day. We were supposed to go to Copan this upcoming week, but it's been pushed back to the end of excavations, so get to make it through a whole week of excavations before we get another break. And no more 1/2 days or early days to watch soccer games like yesterday or today. Going to take full advantage of tomorrow to sleep in and catch up on paperwork, notes, and naps.

Ech, just found out we have to spend part of Sunday washing artifacts. Not cool.

28 Junio 2010 Monday

EU E
lot 42
0-22 It is going to be a long week. Opening up E to compare what is going on in F. Possible wall line? Need a better line going to continue down in EU E

EU E
lot 43
22-62 So much tumble removed and still not 2a don't know what's going on. I don't think I'll excavate anymore in F for now. I'm thinking about going to H and going down til I see a floor abutting the preserved wall, or find where the preserved wall (now called Iago) ends so I can maybe find the terrace floor.

EU H
lot 44
0-105 lot 44 is over 1 meter deep and only 1 chert, 2 obsidian, & 2 ceramic have come out. We're just pulling up tumble like you wouldn't believe. As of now 9 courses of Iago are visible. I could have just kept going, but it feels so weird to have such a huge lot. Looking at the soil profile, there's nothing noticeable. I can't see a line where we might have gone through a floor. I'll keep going and level H with E. And see if what I think is Beatrice floor abuts Iago wall. That means eventually hopping back to E and levelling it with C & D.

EU H
lot 45
105 - levelled H with E. Still looking for the base of Iago

28 Junio 2016 Monday

2016-40-20

EUE
lot 46
12-126
Come back to E to level with D. Tedious. Especially when I really want to find the base of Iago. It would be great if it was sitting on Beatrice. That would mean that there weren't any missing courses from my basal wall Gloucester. But that would also mean that everything that's been being pulled up in front of Iago is tumble. And that would be a lot of tumble. It would suggest that the entire superstructure would have to have been made of cobble stones.

EU H
lot 47
124-181
EU H
lot 48
181-189
Brought the lot level with E, but Iago keeps going down. I don't know how far, but it is past the basal wall level. Rather than step down the units I will just excavate EU H, searching for the base of Iago. So in this lot, 48, I'm still going down in H, looking for the base. my lots are arbitrarily assigned.

NO MAS POR HOY! FOOD TIME!

29 Tuesday Junio 2016

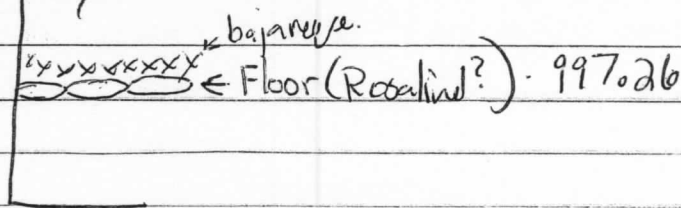

so I stopped right when I noticed that there was a soil change in lot 49, we uncovered a huge # of ceramics, & bajareque. And still more bajareque was left behind because it was disintegrating as soon as we took it out.

There seemed to be a floor layer that we pulled up (After drawings & photographing, of course). At the last minute we took an elevation on the Floor level, and on a whim, on Rosalind floor.

Rosalind - 997.25 floor abutting Iago - 997.26
It is entirely possible that Rosalind once extended out from Iago over 5ms. And then a new basal wall and terrace were later constructed. I can clearly see that Rosalind Floor extends below Gloucester.

This info will help me reconstruct construction sequences. So in lot 50 we collected all the bajareque, ceramic, & carbon that was lying right on top of the floor. I flagged this bag as being incredibly imp't for Cassandra to examine. Still looking for the base of Iago.

29 Junio 2010 Tuesday

2010-06-21

Also in lot 50 getting more & more carbon samples

- This is honestly some of the most beautiful architecture I have ever seen.

EUH
lot 01
211-224
Taps, so far 18 courses & I have no idea when this could possibly begin to stop. Speaking of stopping the day is already over. It's been such slow going. The soil is practically dry and then there is so much tumble/Fill/Floor to pull up.

Bell says that the bottom of the wall should be close. Sometimes apparently they would dig into the earth to place the 1st few courses to help stabilize the wall. If this is true and I've already dug through the living surface then the bottom should be close.

I'm tired and actually getting sick of this wall despite being beautifully preserved. We only have about 30 mins. I'm going to close this lot and then work on notes. Maybe draw pictures for a while like this one

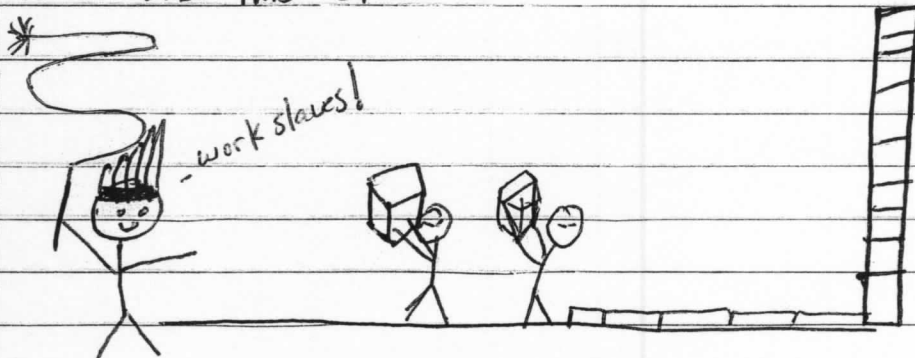

800 A.D.

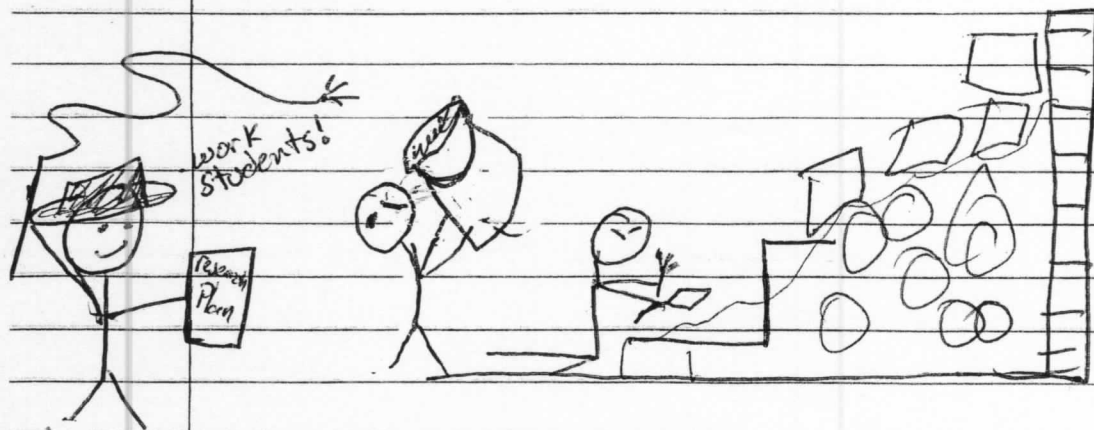

2010
Present Day

30 Junio 2014 Wednesday

2014-06-22

Woke up in the middle of the night with an excruciating Charlie Horse in my Calf and Foot. Once I walked it off, I didn't get much sleep for the rest of the night. That coupled with a stuffed nose, and that achy muscle feeling that usually accompanies a fever means I'm pretty much not in the mood to spend the day in the field.

But here I am. There's both too much to do and so little time to do it, and I don't want to spend my time here sick in bed though sometimes when Becky says its time to get up, I feel like punching her.

~~So~~ Yesterday Mary left, which was sad since this is her project, but in the evening Whitney and Alejandro, who I had heard of but not met before, arrived.

This morning we are still missing Leonel. I think he has made himself useful at another part of the site to get away from me always telling him to slow down his digging or not to pull up that rock. So it's just He and Nimeas.

Continuing to look for the bottom of the wall Iago in EU III. I had a talk with Bell about occupation phases of the building and I wanted to make sure I got this down before I forget.

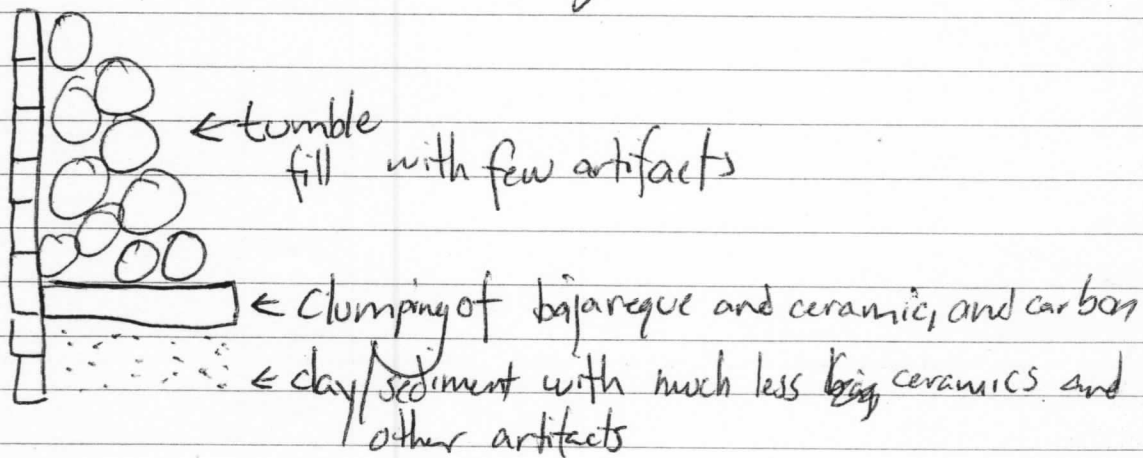

- We're digging through clay and yet the wall keeps going and ~~level~~ came back finally, with a pickaxe. I ~~can~~ guarantee my measurements will not be nearly as precise from this point on.

30 June 2010 Wednesday

3000-40-23

I must remember to do a site drawing for Bell today.

It looks like I have for sure 3 construction phases.

Iago wall was built first. Then Rosalind floor. Then Gloucester Wall.

Found the bottom of Iago_{row} Finally. The wall is 18 courses high in EU H. It looks like the bottom 2 courses were possibly put into the ground first as a foundation stabilizer, and then the actual living surface was around the 3rd course/bijarcque + ceramic layer

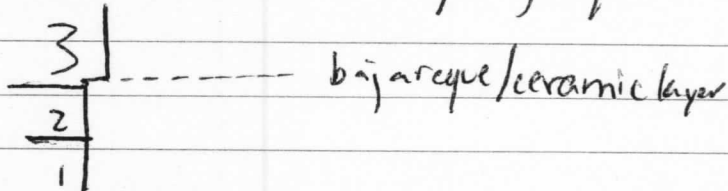

EU I
lot 53

We moved into EU I lot 53 before break at 10:30. In the 1st lot there was just the usual assortment of tumble and humus. Since we are behind Iago I went in 10cm lots so I could keep an eye

* Later that day.

did not have time to write my notes like I usually do. So its after dinner and I'm going to elaborate.

EU H

lot 52

224-230

← my last lot in H.

of course the first thing that we do when we get into the field is find what I searched for all day.

EU I

lot 53

0-68

← because we don't want to accidentally destabilize the wall we have to excavate the last 2 EUs, I + L slowly. We're not going for down here. Hoping to find the floor of a room in either I or L since this is the superstructure of the building. Or at least fill where maybe a tamped earthen floor would be.

30 Junio 2010

2010-40-24

EUI The top of this unit is 62 cm above the lowest point,
lot 54 which is why the units seem so large. Spent the opening lot
68-82 just bringing everything level

EUI - Seeing bits of Toba in the soil, but nothing huge or clearly worked
lot 55 - Measurements taken on a piece of flat-laid cobble. that may or may
82-99. not be the floor of the superstructure.

Have to close this lot
and open to get a better floor?
look.



won't be excavating in this unit
any more because it is just too dangerous

EUL

lot 56 - Whole lotta nothin
0-37

EUL - Pretty much level with I and no evidence of the floor I
lot 57 have tentatively named Lady Macbeth. Even though I can't
37-57 tell if this was actually a floor or not. I will treat it
like a floor and take all the proper measurements as if it
were a floor

EUL

lot 58
57-83

Close of Sub-OP 35
E side of Str 3.

2010-04-25

Piso, Piso, Piso se hizo de piedra

Piso, Piso, Piso te voy a dibujar

Piso, Piso, Piso no me fastidias

Piso, Piso, Piso que voy a chingar

10/35 2010-40-26

E. Side of Str. 3.

elevations are rounded up to the 10ths place where applicable.

999.287 54, -140	999.098 55, -140	998.921 56, -140
	K	L
999.618 54, -139	999.324 55, -139 (never use for elevation)	998.933 56, -139
	J	I
998.931 54, -138	999.101 55, -138	998.697 56, -138
	G	H
998.760 54, -137	998.640 55, -137	998.462 56, -137
	F	E
998.286 54, -136	998.211 55, -136	998.232 56, -136
	C	D
997.938 54, -135	997.871 55, -135	997.817 56, -135
	B	A
997.708 54, -134	997.71 55, -134	997.658 56, -134
	M	N
997.68 54, -133	997.66 55, -133	997.61 56, -133
	O	
997.49 54, -132	997.52 55, -132	

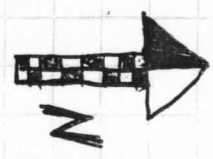

2014-40-27

Open EUs

need elevations
for M, N, & O

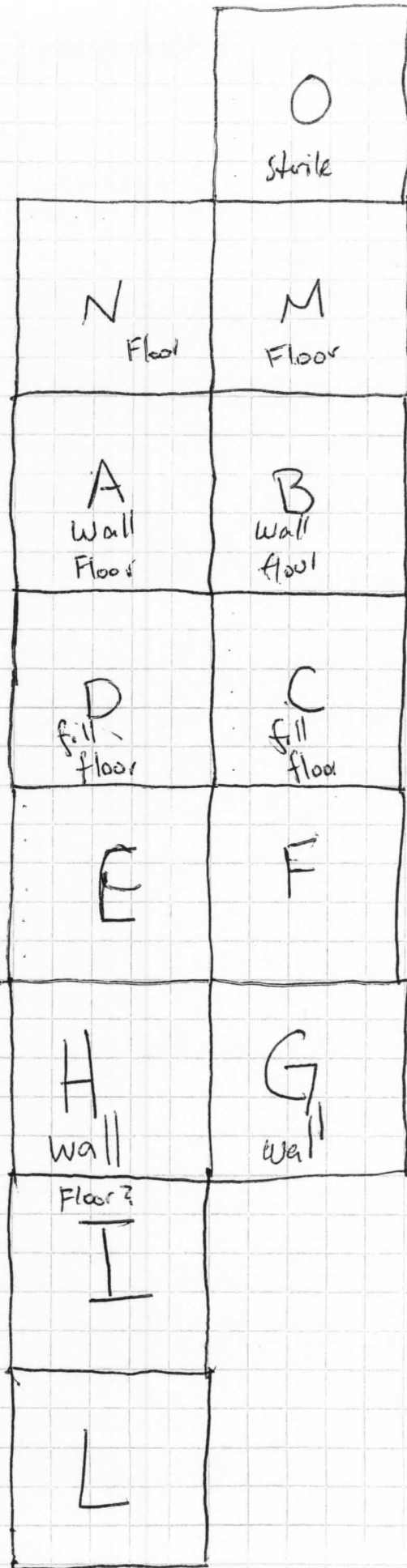

EU: B

75 ceramic
1 carbon
3 baja

12 ceramic 1 chert 1 obsidian	0 lot 3
12 ceramic 3 obsidian	10 lot 3
3 ceramic	20 lot 4
2 ceramic 1 chert 1 obsidian	30 lot 4
empty lot	40 lot 6
19 ceramic 3 baja regue	50 lot 7
25 ceramic 1 carbon 3 baja regue	60 lot 12
	70 lot 13
	80 lot 20
	90
	100

↑
Rosalind Floor

EU A

lot 21

4 ceramic 2 obsidian	0 lot 1
1 chert	10 lot 1
8 ceramic 1 Baja regue	20 lot 2
2 chert	30 lot 5
4 ceramic	40 lot 17
8 ceramic	50 lot 18
34 ceramic, 2 baja regue, 1 chert	60 lot 21
	70
	80
	90
	100

↑
Rosalind Floor

EU: M

W E

empty lot	0 lot 22
1 ceramic	10 lot 9
4 ceramic 1 chert	20 lot 10
3 ceramic 2 baja	30 lot 23
6 ceramic 1 baja	40 lot 24
	50 lot 25
	60
	70
	80
	90
	100

↑
Rosalind Floor

EU N

W E

1 chert 2 ceramic	0 lot 26
3 ceramic	10 lot 26
1 chert 3 ceramic 1 baja regue	20 lot 15
19 ceramic 2 obsidian 1 baja regue	30 lot 16
7 ceramic 2 chert 1 baja	40 lot 27
2 Bone 17 ceramic 6 obsidian 3 chert	50 lot 28
	60
	70
	80
	90
	100

↑
Rosalind Floor

EU O

5 ceramic 1 obsidian	0 lot 29
10 ceramic	10 lot 29
67 ceramic 1 ob 1 chert	20 lot 30
49 ceramic 1 obsidian 1 Hacha	30 lot 30
ceramic	40 lot 31
Sterile clay	50 lot 32
	60 lot 33
	70 lot 34
	80
	90
	100

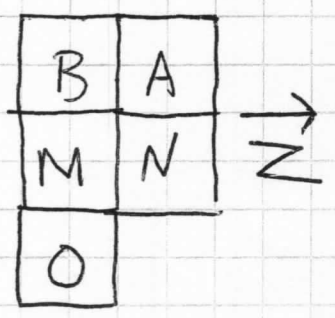

2010-40-29

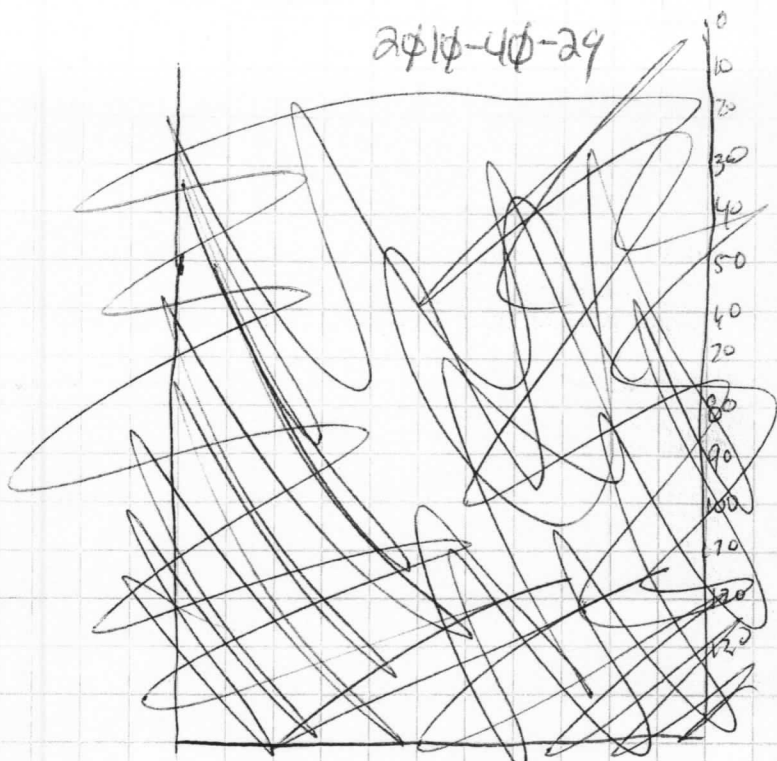

0
10
20
30
40
50
60
70
80
90
100
110
120

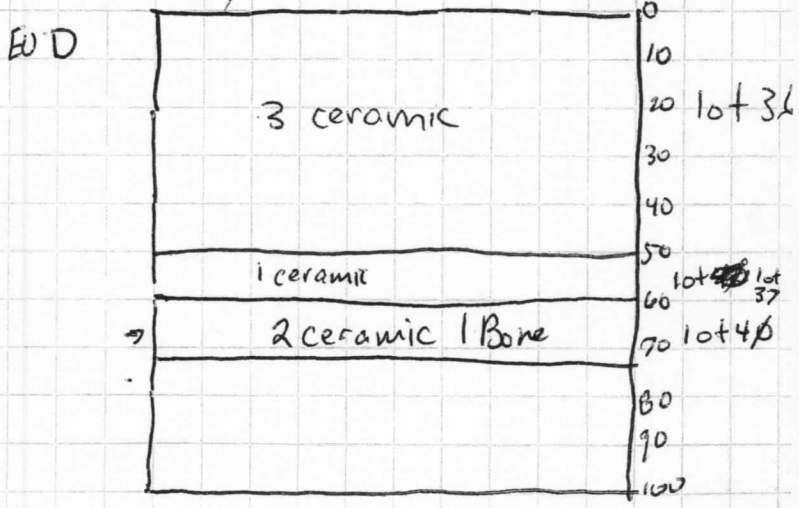
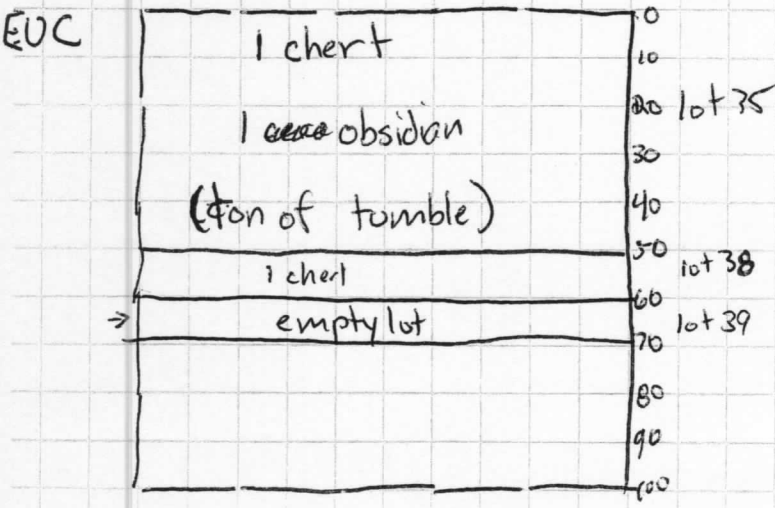
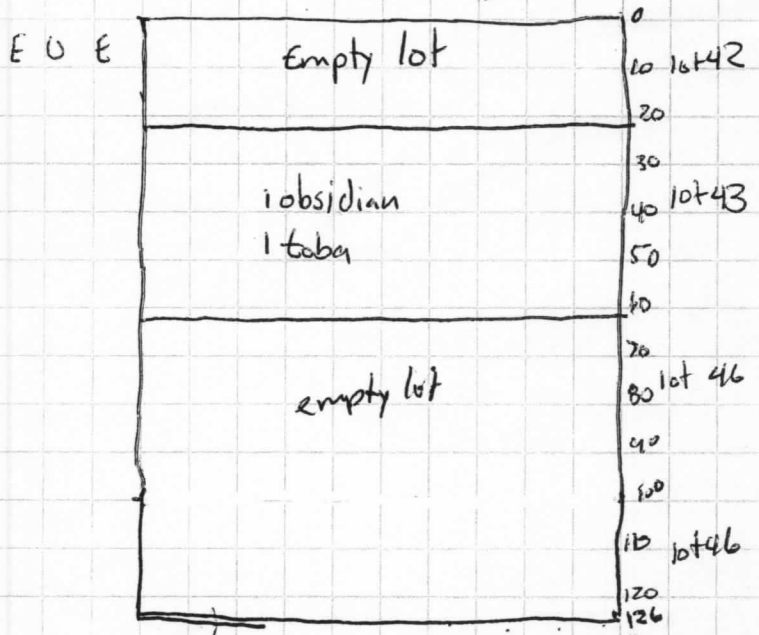
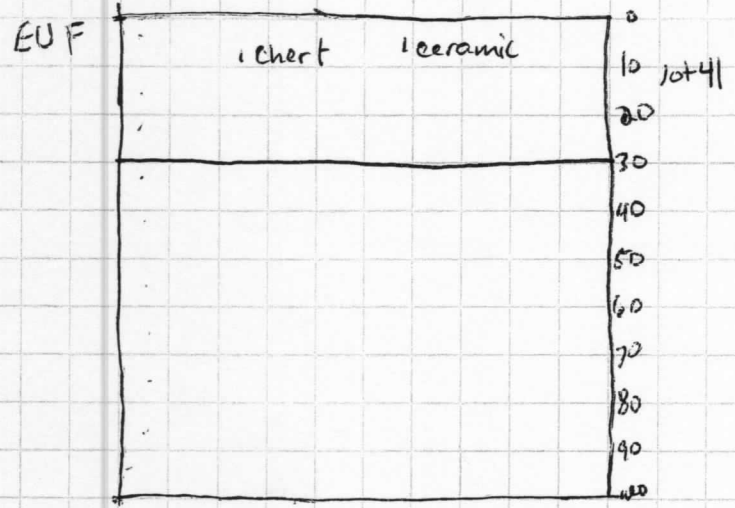

24101-40-30

EU L

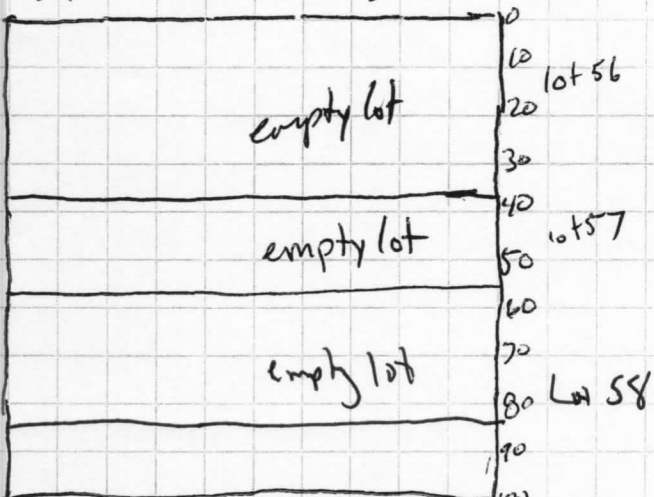

same area 2 meters to the North as Sub-op 36, where everything was torn up - looting?

EU H

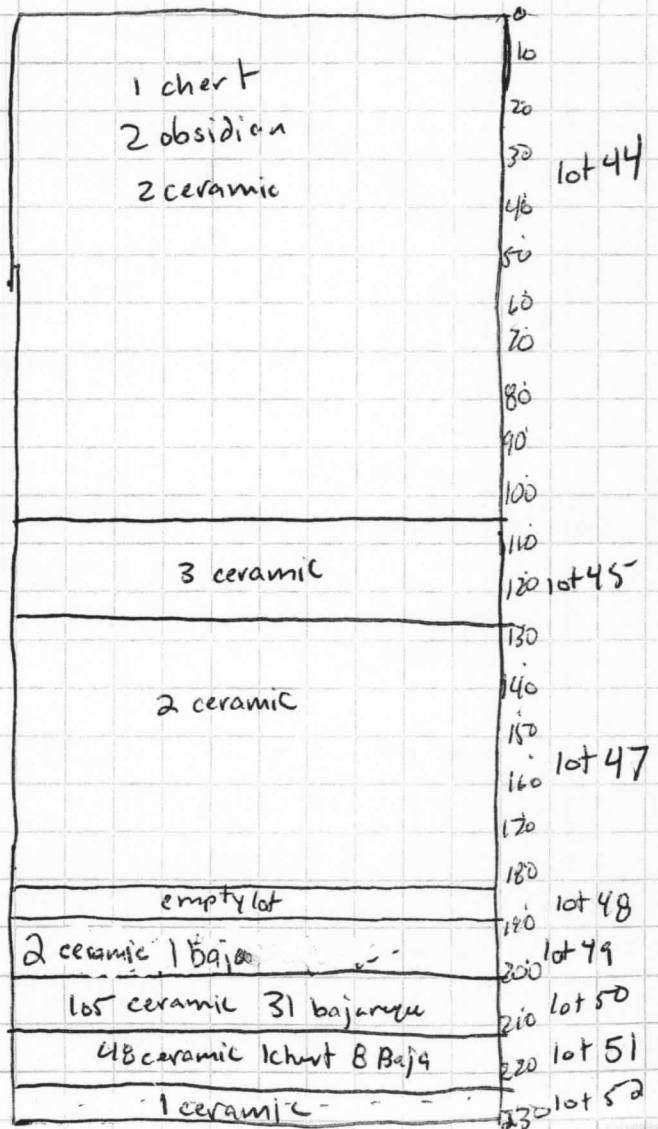

EU I

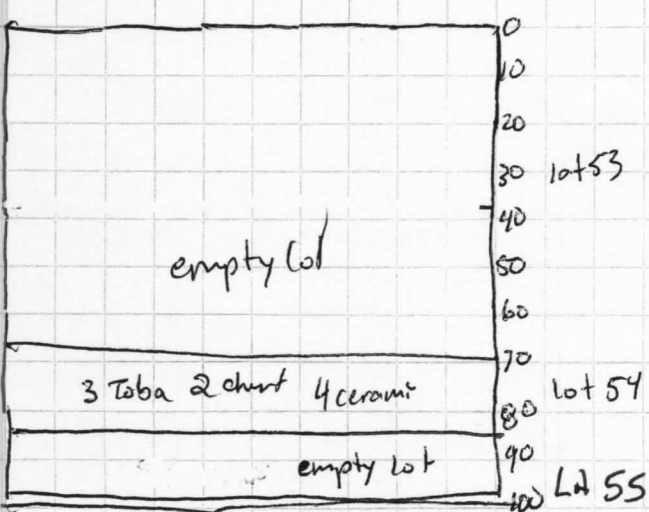

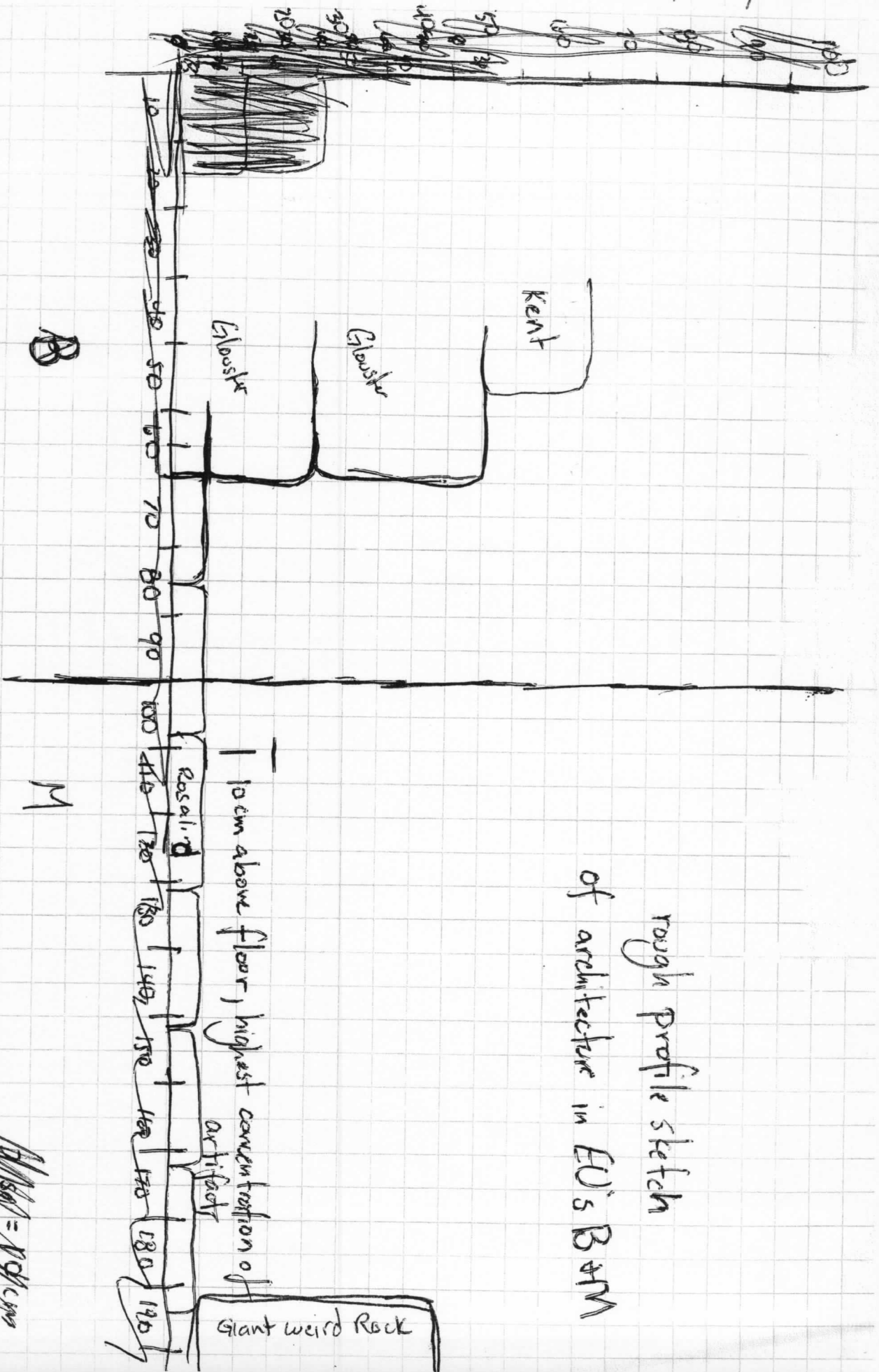

rough profile sketch
of architecture in ED's B&M

~~rough sketch~~
= red lines

1 July 2010

2010-40-33

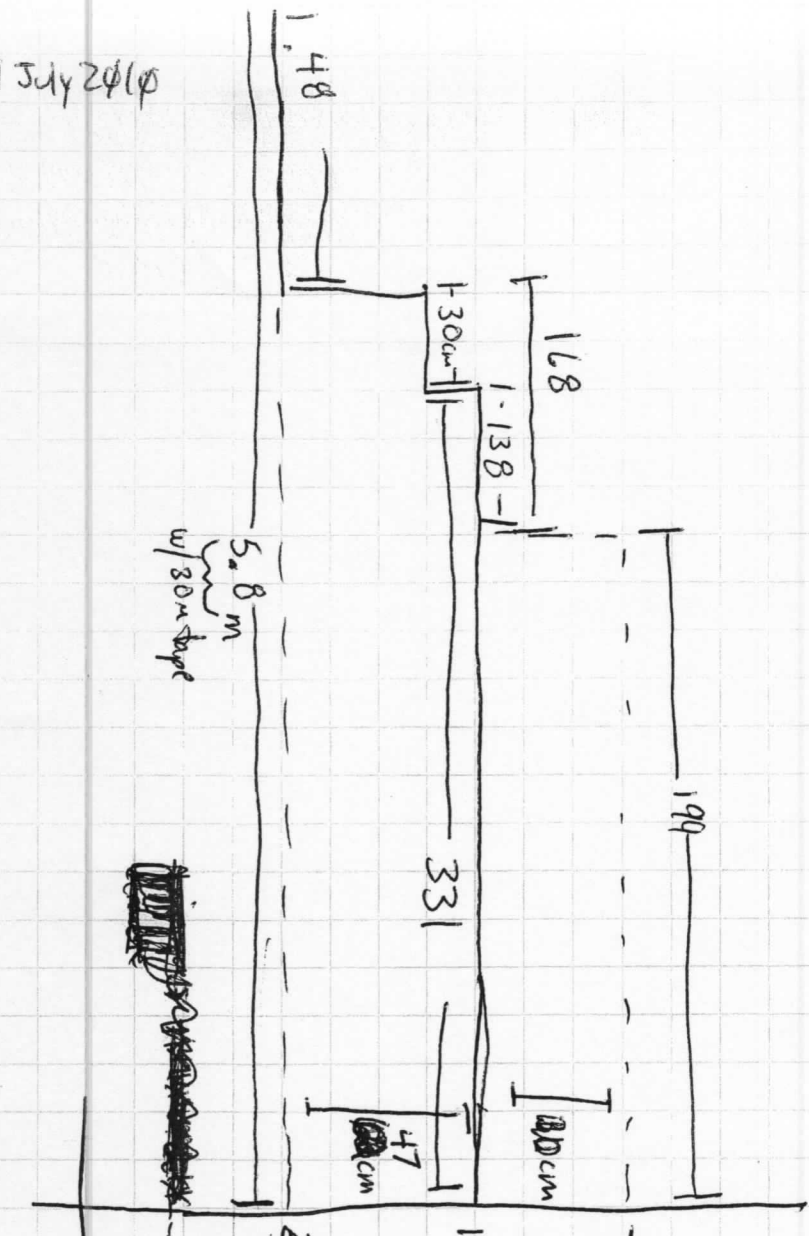
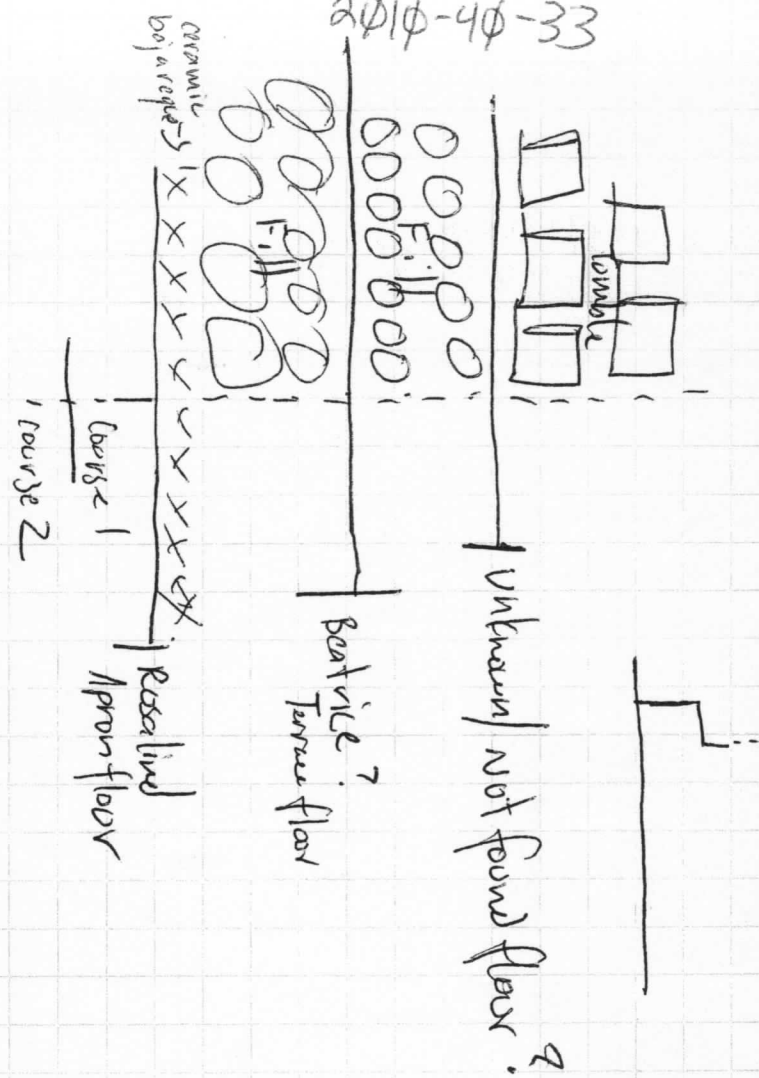

- Construction Sequence
1. I ago
 2. Rotating
 3. ~~1st~~ 5th floor
 4. ~~Beatrice~~ Fill
 5. ~~Beatrice~~ Kent
 6. ~~Beatrice~~
 7. ~~Beatrice~~ Unfound Wall
 8. ~~Unfound~~ F. II
 9. ~~Unfound~~ Floor Unfound Floor
 10. Tumble

E-PORTION OF BUILDING
 So the bairn level was on top of the 997.26 floor that corresponds with the Apron floor at 997.25

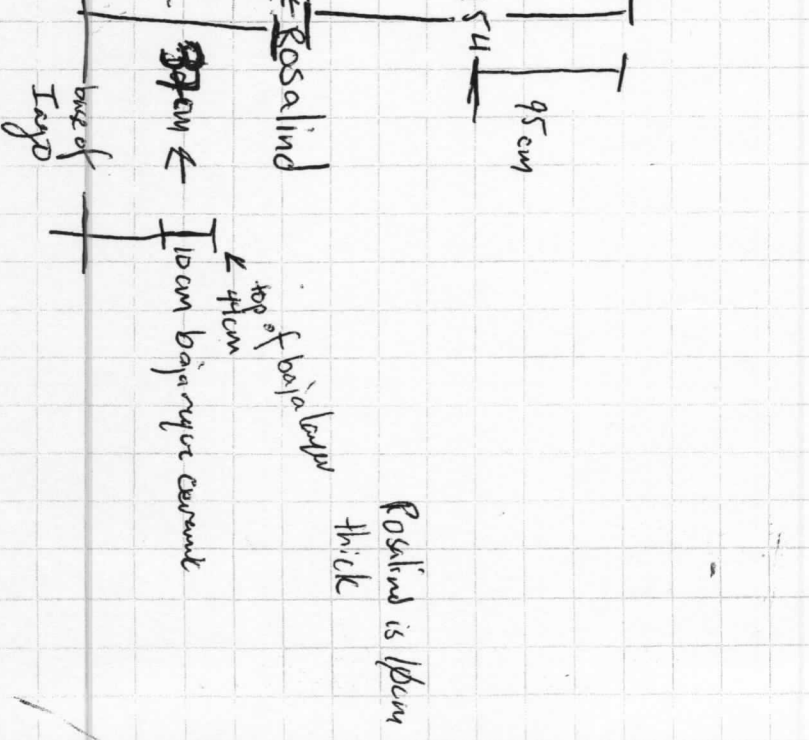
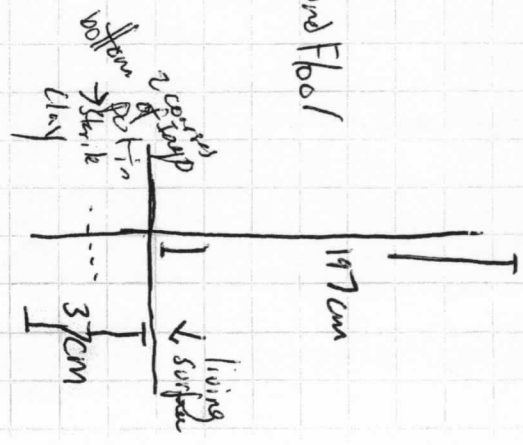

Rosalind is 10cm thick

1 July 2010

* such a complicated freaking Structure

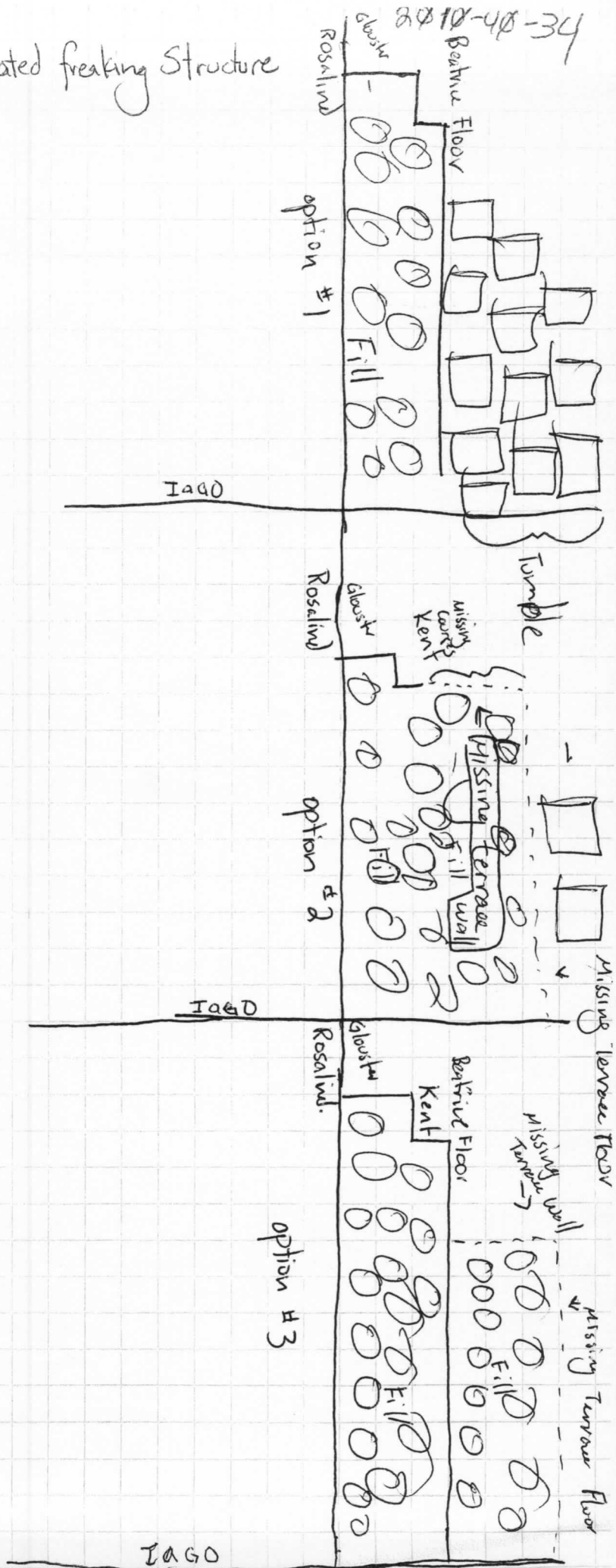

Unit name	length	width	height	Alignment	courses	Top measure	Bottom measure
Rosylind	148 EW	198 N-S	8	N/A	1	1.88	-1.96
E. Jagon Floor	5.8 EW	N-S					
Gloster	33 EW	197 N-S	31	6°	2	1.65	2.07
E. Basal Wall							
Kent							
E. Step/Terrace wall?	25 EW	196 NS	10	2°	1	1.56	1.65
Beatrice	149 EW	200 NS	N/A	N/A	1	1.63	N/A
E. Terrace Floor	3.31 EW						
Barrage Feature/Layer	80 EW	81 NS	N/A	N/A	N/A	1.75	1.85
Iago		122 NS					
E. Superstructure	22 EW	89 NS	235	8°	18	1.8	2.59
Wall							
Fill 1	200 EW	198 NS	95	N/A	N/A	67	1.62
Fill 2	300 EW	96 NS	47	N/A	N/A	1.74	2.21
Missing Terrace Floor?	195 EW	31	41	N/A	N/A	64	1.74
Lady Macbeth Summit Floor	69 EW	90 NS	N/A	N/A	1	85	N/A

5

← Prob not feature

For features that are possibly missing or were imagined measurements were taken off of all the available information For Image Set page 34

1 July 2010

2014-40-36

Unit name	Largest	Smallest	Modul	Rock Form	Material
Rosalind Edgemoor Floor	N/A x 11 x 22	2 x 13 x 8	N/A / 23 / 20	triangular rectangular unshaped	local cobble Sedimentary
Glouster E. Basin Wall	16 x 77 x 30	12 x 35 x N/A	15 x 12 x 9	rectangular unshaped	"
Kent Step E Terrace Wall	10 x 45 x 24	19 x 31 x 21	18 x 49 x 25	rectangular triangular unshaped	"
Beatrix E. Terrace Wall	N/A x 36 x 48	N/A x 19 x 12	N/A x 22 x 29	rectangular triangular unshaped	"
Bajouryur	N/A	N/A	N/A	N/A	waffle & Daul
Large E. Superstructure Wall	16 x 47 x N/A	11 x 12 x N/A	11 x 27 x N/A	rectangular unshaped	local sedimentary rock
Fill 1	15 x 33 x 34	23 x 16 x 9	14 x 29 x 33	oblong square	"
Fill 2	17 x 37 x 23	8 x 11 x 16	12 x 20 x 19	oblong square	"
Missing Floor	N/A x 44 x 9	N/A x 25 x 5	N/A x 21 x 6	square rectangular unshaped	"
L. Macbeth Summit Floor	N/A x 30 x 30	N/A x 16 x 8	N/A x 18 x 25	square oblong	"

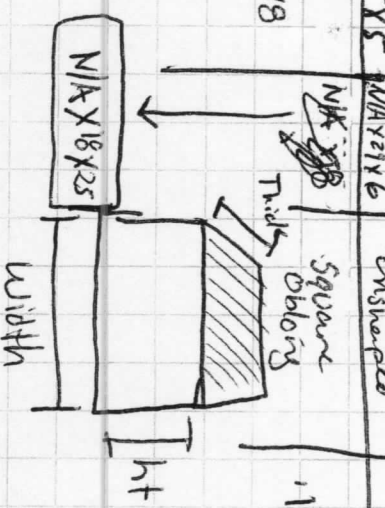

10/35

H x W x Th

1 July 2010

2010-40-37

soil profile taken in EOO where we went down to Sterile

Top soil: 7.5 yr 3/2 DK Brown

Fine Granular
moderate Hardness
Not Platy

Bottom: 10 yr 4/4 DK yellowish Brown
Soil:

Fine Granular
moderate Hardness (softer than top soil but still not soft)
Med Platy

1 July 2010
Subtop 35 Started excavating Sat 19 June 2010.
Stopped excavating Wed 30 June 2010

2010-40-38

Chose this excavation because of the preserved wall that was visible above the soil at the top of the excavation, this is Iago Wall.

Originally set up 14 excavation units labelled A-L. A 2x2 excavation running east to west.

Began with excavation unit (EU) A. Almost immediately found the step/terrace wall Kent. Kent sits on top of the Eastern Basal wall Gloucester, which was uncovered in EU's A & B. In an attempt to find more courses, found Rosalind Floor. Rosalind clearly extended below Gloucester, as well as to the East. 2 more units were laid out to find the extent of Rosalind. These are units M & N.

Another unit, O, was eventually added to the East of M. Rosalind did not extend past M and ended on the bearder between M & O. Later excavation revealed that Rosalind may have extended west as far as H, and abutted Iago wall.

This gave Rosalind a length of 5.8 meters stretching from its farthest extent in M all the way over to Iago wall. The portion that is visible beneath Gloucester is 1.48 m in length. The width was measured N-S and was the portion exposed in the 2 units, though it is hypothesized it ran the length of the Eastern 1/2 of the building. Gloucester it was later revealed, was probably higher than the 2 courses preserved. Or if not then Kent was.

I hypothesize that Kent might have been a terrace wall, which meant that there would have been a terrace floor. I could not find this floor during excavation but I searched the profile of EU F for evidence of it. I discerned a possible line, though not a very good one, and took measurements off of it as if it was a feature. This meant that there would have been 2 distinct Fill Features, Fill 1,

1 July 2019

2019-40-39

and Fill 2. Again this was only hypothesized. The floor labelled Beatrice was likely not a floor but a portion of Fill 1. Fill 2 would have been below the Rosalind Floor abutting Iago. I still took measurements as if all of these features were distinct, but in such a way that the #'s could be added together to produce an variation of the options drawn on page 34. Iago wall was a surprisingly big feature. 2.59 meters in height. The line of Iago was finally established beyond the parameters of the 2 meter NS excavation units. 2 measurements were taken for length. The 1st, 1.22 meter was preserved above the established excavation, with 0.95 being the length of the line beyond the unit. Iago was preserved up to 18 courses, and was likely more. As to the superstructure of the structure, I found little evidence as to how it was made.

In a 10cm section directly above where Rosalind abuts Iago a large quantity of bajareque and ceramics were recovered, leading us to hypothesize that not only was this the original living surface but where a perishable superstructure might have collapsed. The artifact assemblage was quite surprising. Site 007, Los Naranjos seems to be loosely associated with the local non maya site of El Cafetal, but many of the ceramics recovered seemed to be associated closely with Copan. Much of what was recovered from the two living surfaces, both on Rosalind, were Copador, as well as fragments of a modelled censor.

See page 23 for construction Sequence

See page 28-31 for artifact distribution

2 July 2010 Friday

2010-40-40

Began excavations today on op-subop 10/137, and on the South side of structure 3. I am on the South side now and Jasmin has a sub-op open on the West side #36. So by the end of this season the ~~N~~, E, S, & W side of str 3 will have been exploring.

EUA lot 1 0-20 I began with EUA lot 1 as soon as Becky and I had finished our soil chart.

Started out looking either for the 1st architectural feature or for sterile clay. Nothing really in lot 1. Its weird, I've been tired all week, but starting a new sub-op has sort-of revitalized my enthusiasm. Still, it would be nice to be in

EUA Copan right now

lot 2 - All of a lot more ceramics in this lot all of a sudden.

20-33 Noted, and still going down 10 centimeters at a time

EUA lot 3 } yep, still looking for architecture or sterile clay.

33-40 } I wonder if I'm getting close to the plaza floor. The amount of ceramics spiked. Checking the soil profile it looks like there is a distinct change in soil color. As soon as I hit sterile clay I'll take a photo

EUA lot 4 - last lot of the day. Not a lot going on here.

40-50 Going to finish this lot for the day. Think I should be very close to the old plaza living surface

EUA 3 July 2010 Saturday.

lot 5 Yay! Saturday! That means tomorrow is
50-63 freaking Sunday!

- Again the ceramics spiked. Almost 200 ceramics. I should be on or right above the plaza floor. Still no architecture so guess I'm going straight to sterile in my opening EU.
* Carbon Jappanay

3 July 2010 Saturday

2010-07-04

EUA
lot 6
63-74 ... bored. I don't really have anything to do except watch Leonard and Nimias dig.

EUA
lot 7
74-80 Hip Hip Hooray, sterile clay!
Moving up the structure opening EUB now. Hope I start finding architecture soon. Jasmine's side of the building is not looking terribly pretty. We're becoming worried that sub-op 36 is mostly junk
EUB
lot 8
8-48 * Sigh, looking for evidence of architecture... Guess I'll go through and double check my math on my elevations

OMG!!! I get a day off now. So happy to call the end of the day. Be back soon!

- Whoops, later that day. also dug EUB lot 941-51... nothing happened.

5 July 2010 Monday

EUB
lot 10
51-61 - Starting to get tumbled. Hope to start finding anything

EUB
lot 11
61-71 - Hoping up to EUC at the advice of Bell. She does not think I'll find anything more in this lot. I can't help but wonder if an extension of Rosalind might be lurking beneath the soil

EUC
lot 12
0-20 - Still hoping to find architecture. And I'm drawing up different versions of what my building may have looked like. I'll include them in my notes

EUC
lot 13
20-50 - I'm getting frustrated, so my lots are going to be bigger til I start seeing any sort of change, be it soil, architecture, or human body

5 July 2010 Monday.

2010-40-42

EUC

lot 14
50-69

Its always the same story, as soon as I'm packing up for the day, we find something awesome. We found a wall. I got so excited I actually high-fived Leonel and Nimeas. Puck Wall, elevation 997.63m

6 July 2010 Tuesday

EUC

lot 15

~~lot 14~~

69-81

EUC

lot 16

~~lot 15~~

EUC

lot 17

100-106

EUC

lot 18

106-115

EUC

lot 19

115-121

EUC

lot 20

121-133

Ahhh! I only have one day after this to excavate this plus 3 more units!

- First things first, must find base of Puck wall.

- PUCK seems like it is going to be like Tago. It just goes down.

★ Began to see massive increase increase in ceramics - hoping to find a floor in the next 10cm.

Stopped here so I could scoop up the ceramics in a lot in itself so I can see it in good context.

→ The soil is practically clay, its making it so slow to dig through no evidence of Floor... or the end of PUCK

- Still tons of ceramics.

- Still looking for base

- lots and lots of carbon

... Still looking.

And now its the end of the day, and I feel like it was pretty much a waste of a day

One left ...

7 July 2010 Wednesday
Ahhh! So much to do!

2010-40-43

EU C

10+21

133-137

Puck is 6 courses high. A terrace? Maybe this wall is the original height of Glaister wall

Going on to EUD now to look for the floor that should be on top of Puck

EUD

10+22

0-40

- continuing down looking for a floor. Hope this isn't another day of searching and not finding.

Whoa! Got 2 more workers, Chepe and Miciel came over to help. Opening up EUE too
I'll start by slowly stepping down 10cm above where D is. looking for any architecture, any at all

EUE

10+23

0-31

okay here we go. Found 2 new features. Viola Floor is the terrace floor associated with Puck. On top of Viola is Oberon wall, a Terrace wall, that might be on the same level as my missing terrace wall on the Eastern side of the structure. Going to clean the features. and move up to F which will be excavated along with E. My plan was the same as E was to D. I'm going to step F down behind E.

EU E

10+24

40-94

F is the connecting EU to sub-op 37. 37 has already finished excavations. In the top EU (I?) there is a massive amount of collapse. Bell thinks that this top level might be a room, because of the lack of anything at the top of the structure.

7 July 2010 Wednesday

2010-40-44

EUE
lot 25
31-57

- Going to keep going down till level with where a floor might be associated with Oberon wall

EUF
lot 26
0-30

- looking for any evidence of architecture associated with the top of the structure with either sub-op. wondering if the top of Oberon is the floor level that might be associated with the possible room at the top of the structure maybe something like this

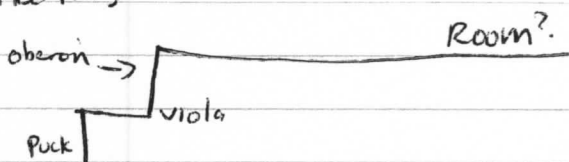

EUE
lot 27
57-94

-> levelling out EUE with EU D. No evidence of a cobble floor. Maybe tamped earth? I'll cont down with a 5-10cm lot looking for fill or soil change that might indicate a tamped earth floor.

EUF
lot 28
30-78

-> the collapse found in sub-op 37 extends into my EU F. Cleaning and closing.

Its possible that the collapse at the top of the structure had a wall to the East (more courses to lago) that fell to the West. The tumble all looks like it fell West to East

EUE
lot 29
90-103

- NO real evidence of fill or soil changes and no more time

Excavation Closed on 7 July 2010

1φ/37 Str φ3

2φ/φ-4φ-45



↑ EUD

EU C

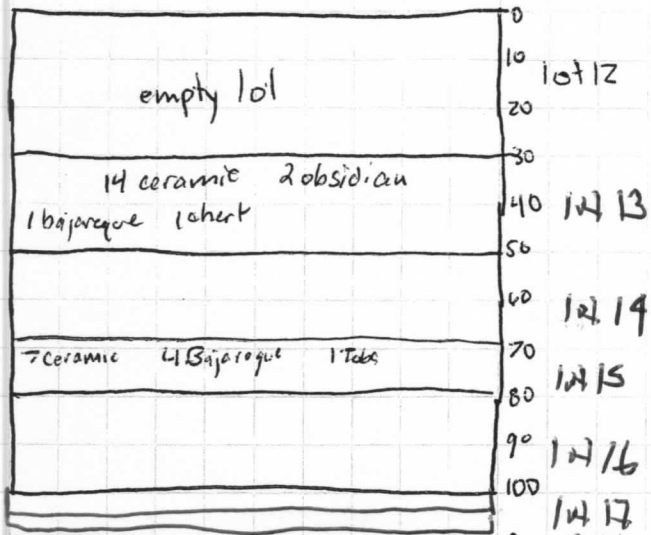

EU F

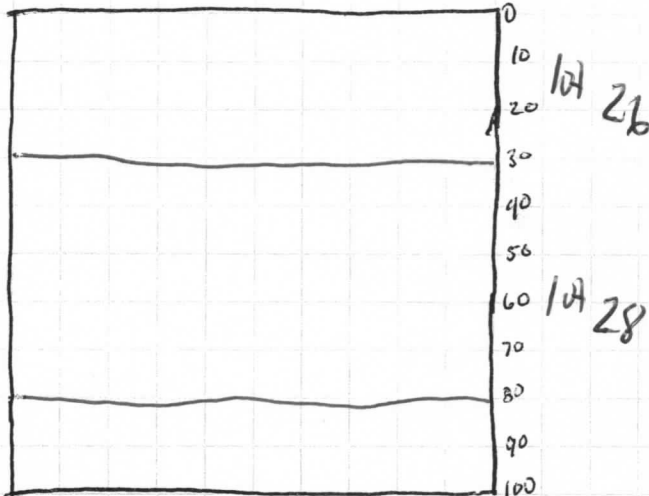

EU B

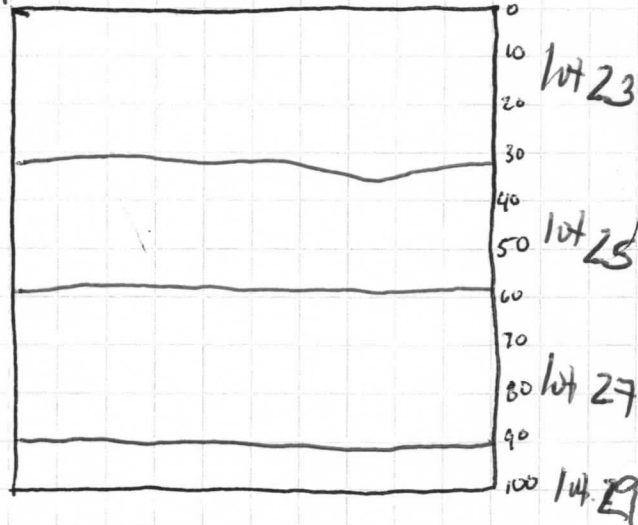
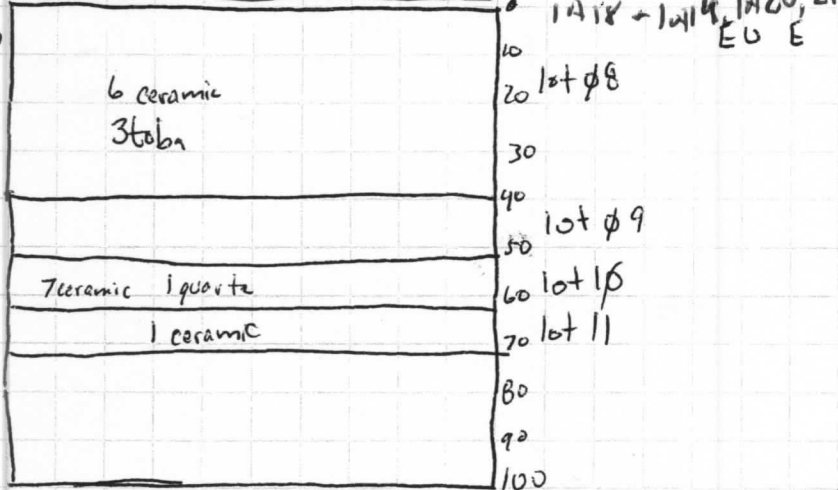

EU A

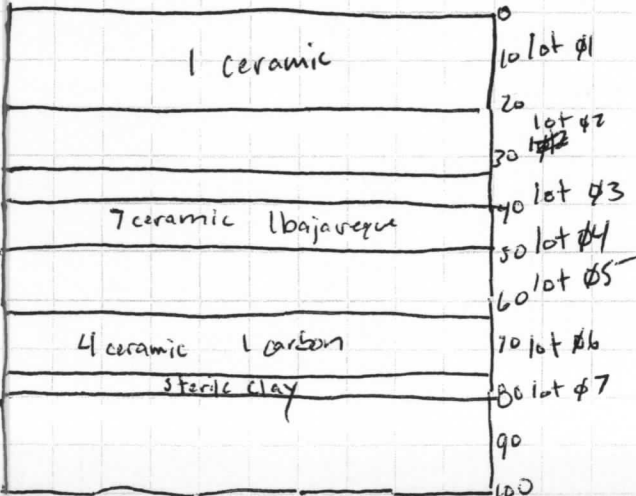

EU D

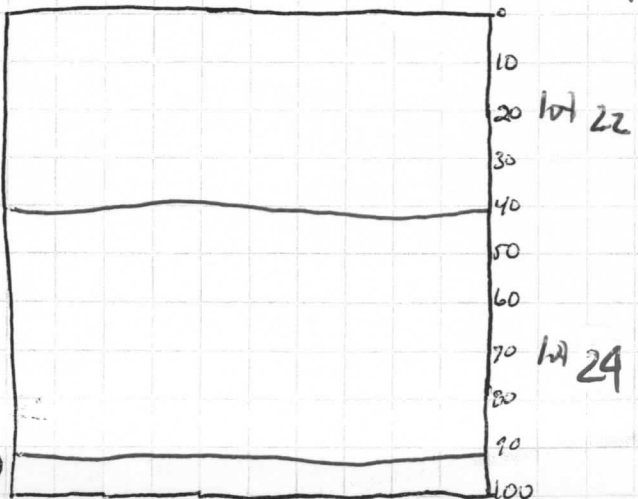

lot 20
cont? →

↓ EUD

2φφ-4φ-46
1φ/37
Ex 4φ
Mike Kitej



Shined with
subop 36 →

~~Shined with~~
~~sub op 1φ/36~~

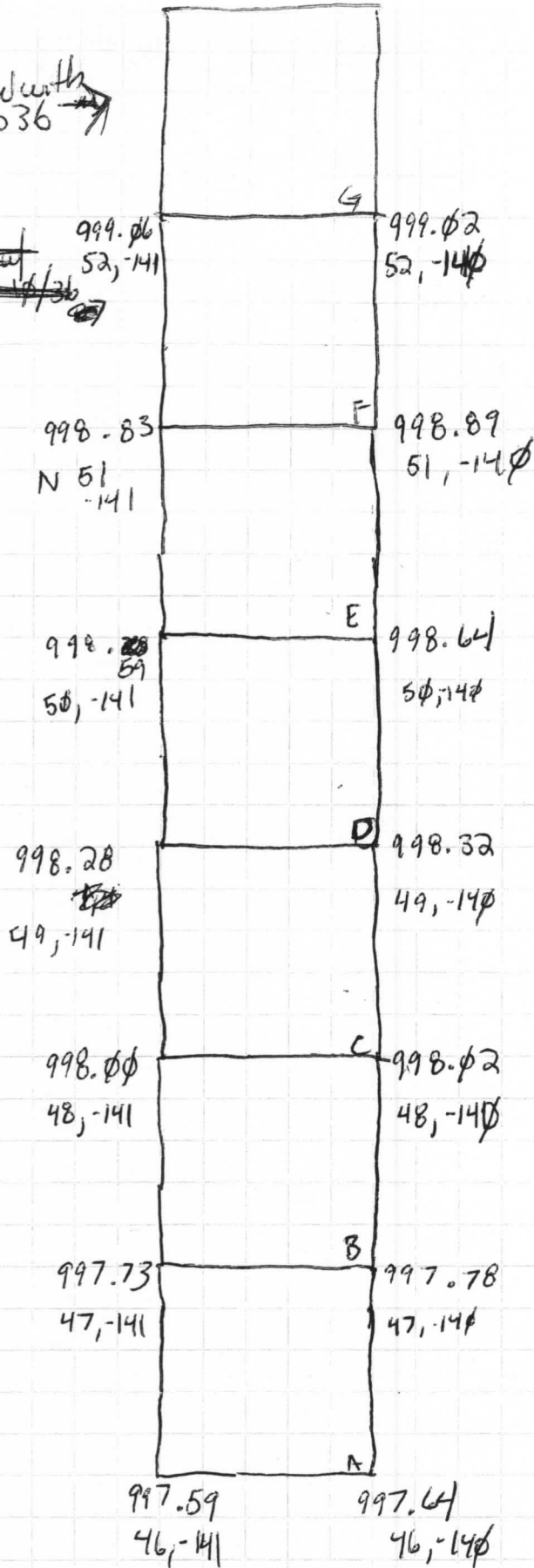

2010-40-47

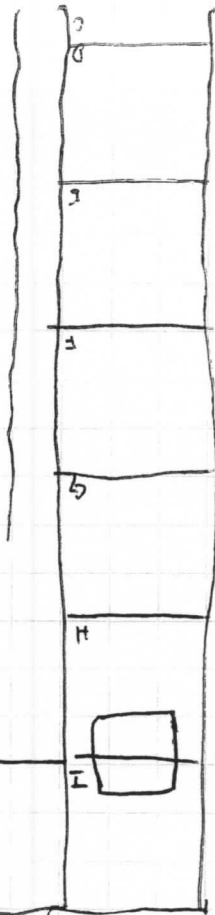

EX 40
Jasmin
Velenzueli
Caliban (Colum?)

EX 40
MIKE KITTEL

10/35

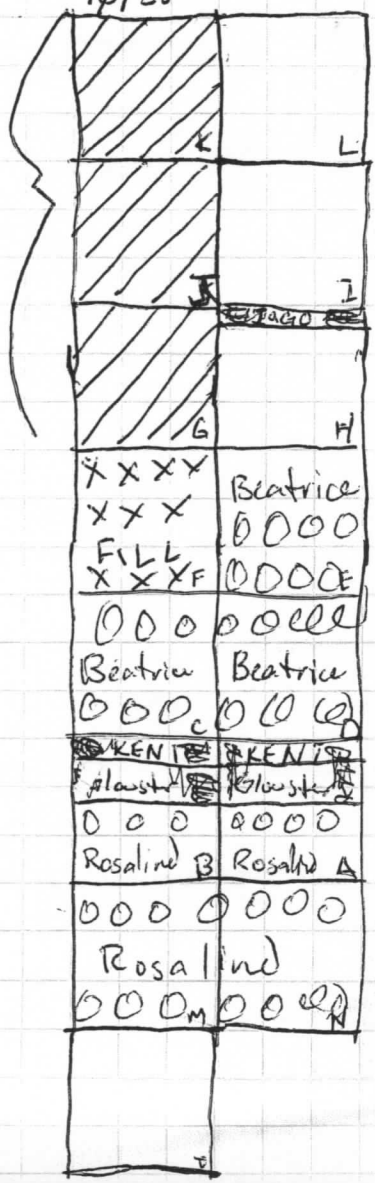

unexcavated

N ↑

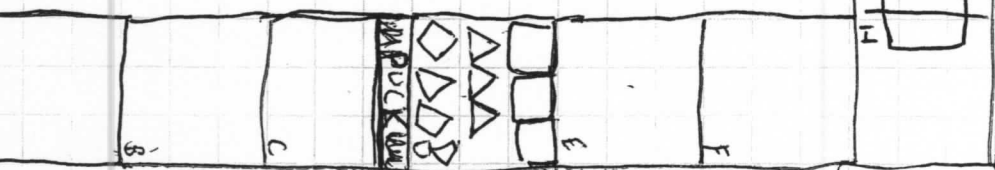

Caliban (Colum?)
E
Eburon Wall - ? tampered
earth floor?
Missing courses?
viola floor
Puck
Basal wall.

EX 40
MIKE KITTEL

2016-40-48

if Kent was more courses would it be on the same elevation as Oberon?

a back open floor - used as a midden?

Resalind does not appear to extend all the way around to the Eastern Side

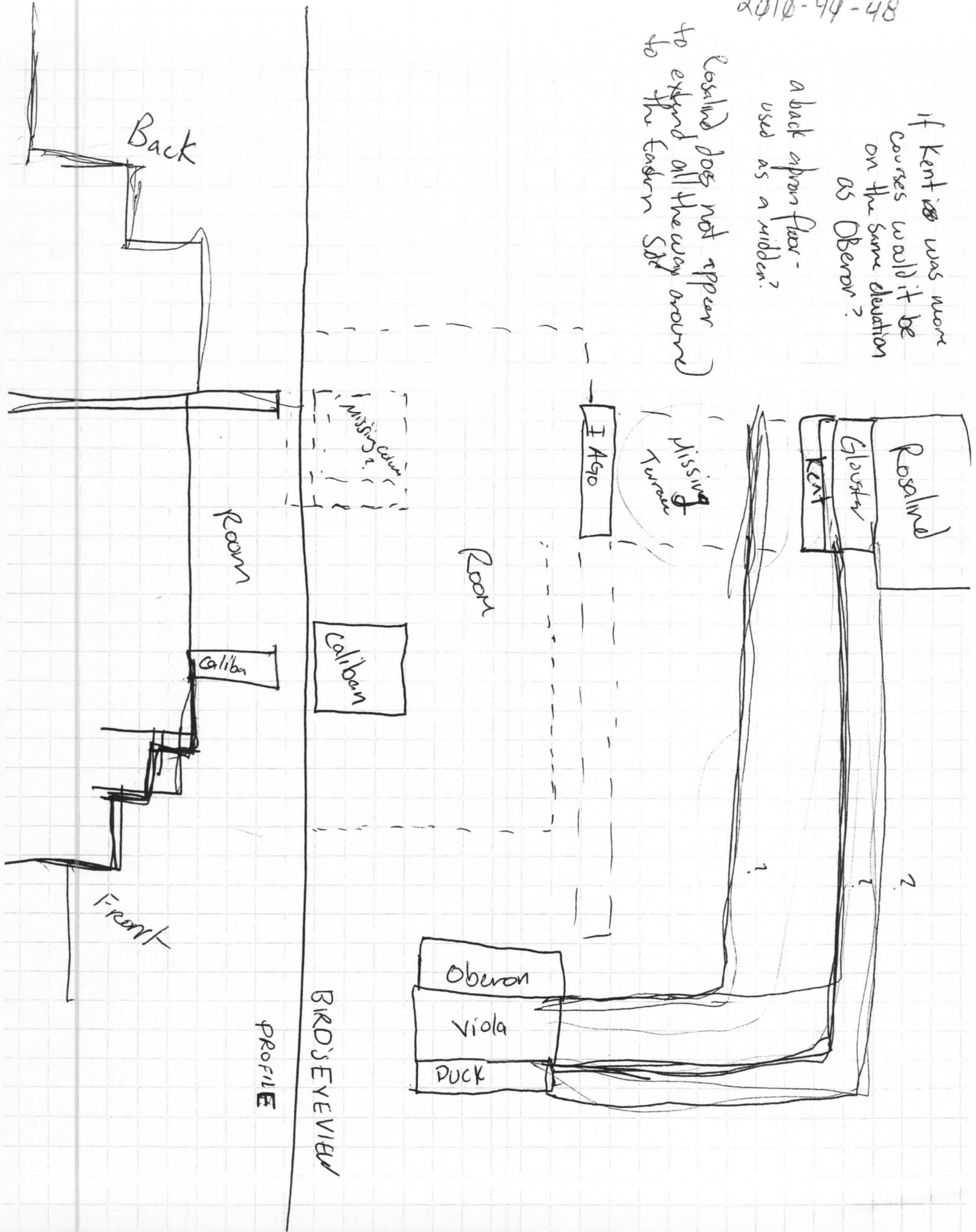

BIRD'S EYE VIEW PROFILE

Back

Front

Room

Room

Missing Column?

Callban

I 490

Missing Kitchens

Resalind
Glaston
Kent

1.

2.

Oberon

Viola

Duck

Callban

Unit Name	Length	Width	Height	Alignment	Courses	Top Measure	Bottom Measure
Puck Wall S. Basal Wall	28 NS	96 EW	76	276°	6	124	198
Viola Floor S. Terrace Floor	64 NS	98 EW	10	N/A	2	131	141
Oberon Wall S. Terrace Wall	27 NS	98 EW	52 (lin wall) 36 (lin EW)	274°	3 (lin EW) 6 (lin wall)	91 (lin EW) 78 (lin wall)	131
Collapse	114 NS	96 EW	44	N/A	N/A	38	84
Unit Name	Largest	Smallest	Modal	Rock Form	Material		
Puck	8x42x29	9x13xN/A	9x31x27	rectangular	local sedimentary cobble		
Viola	8x42x29	N/Ax21x 15	9x31x27	square rectangular	"		
Oberon	10x56x21	8x18x30	12x35x17	rectangular irregular oblong	"		
Collapse	12x25x30	8x16x20	7x34x18	square rectangular oblong	"		

Top Soil - 10 YR 3/3 DK Brown, Fine Granular, Moderate Hardness, Not Plastic

Second - 10 YR 4/3 Brown, Fine Granular, Moderate Hardness, Fine Plastic

Third - 10 YR 3/2 very DK Grayish Brown, Fine Granular, Moderate Hardness, Fine Plastic

Fourth - 10 YR 4/4 yellowish DK Brown, Fine Granular, Moderate Hardness, Coarse Plastic

reference corner
EUF

8 July 2010

2010-40-50

Excavation for this Sub-op began on 2 July and lasted until 7 July 2010.

This excavation was part of 3 subops that were opened on Str 3.

No architecture was found in EU's A or B. The first feature was found in EUC. This was the southern basal wall, named Puck. This was quickly followed by a floor, Viola, and a terrace wall, Oberon.

No other associated architecture was found on the southern side of Str 3.

Puck was 6 courses high, 76cm in height. After a comparison of the absolute elevations. I would like to see if the features on the southern side of the str can correlate to the features on the eastern side.

Puck → Gloucester Kent

Oberon → Missing Terrace

Viola → top measure of Gloucester (see notes)

Interestingly, unlike the E & W sides of the str. the southern soil profile provided 4 very distinct soil layers rather than the 2 found on the E & W sub-ops. The 1st, 3rd, & 4th layers are explainable, but the 2nd level is confusing. Essentially the colors go from DK Brown, Brown, DK Grey Brown, & Yellow Brown.

The DK Grey Brown layer is very likely the Plaza layer.

The collapse at the top of the structure seems to have fallen in a way that suggests it fell from E to W.

This same form is seen in the top

unit of sub-op 36. It looks like the part of Tago in sub-op 35.

 might have been a room at the top of the str. and this collapse was possibly a

The architecture on this side of the structure was much easier to discern than on the east side, because there was a lot less tumble and no discernable fill. If there was a room would it have opened on top the top of Oberon?

Construction sequence for this Sub-op seems straight forward.

1. Puck

2. Viola

3. Oberon