

2010

EPV 048 Valenzuela Field Notes 2010

Jasmin Valenzuela

Follow this and additional works at: <https://digital.kenyon.edu/honduras>



Part of the Archaeological Anthropology Commons

Recommended Citation

Valenzuela, Jasmin, "EPV 048 Valenzuela Field Notes 2010" (2010). *Four Valleys Archive*. Paper 96984.
<https://digital.kenyon.edu/honduras/96984>

This Field Notes is brought to you for free and open access by the Anthropology at Digital Kenyon: Research, Scholarship, and Creative Exchange. It has been accepted for inclusion in Four Valleys Archive by an authorized administrator of Digital Kenyon: Research, Scholarship, and Creative Exchange. For more information, please contact noltj@kenyon.edu.

18 JUN 2010

2010/48/001

Today is our first official day working. I am really excited to jump into my site. We were walked around Structure 12 with Mary while she described her goals for this years excavation, which is to gather information for a more complete overview. We decided who will be working in certain positions. Me, Becky, and Melissa will be working on Structure 12. I have the western wall. Melissa is taking on what we suspect to be the back (and top) which is located on the Northern side. Becky is excavating on the front southern wall. The EDM took awhile to set up and we are using a temporary datum point to grid out each sub-op. Becky and the southern wall was first (sub-op 30) and mine was second (sub-op 31). We took lunch break after staking my area. My workers are Paco and Maximillio. Jen and Catalina are helping me while the workers are finishing setting up points. Becky has Mike and Melissa. Never mind, Catalina is too cool for me and Jen. She is sitting by Becky's pit. Had some problems with elevation. Ellen and Mary are at other side of site/fence. EUA tot 1 began with the removal of humble on ground surface. We proceeded down about 10 cm. We are looking for the basal wall.

2010-48-072

After much confusion, we closed lot 1 while exposing some rocks. (possible floor wall - flat rocks). I made the decision to open lot 2 but keep the flat rocks. ~~and remain~~ I am looking for the end/bottom of the wall. Just 10 cm below the possible wall we found more flat rocks that are possible rubble. It was late and after a few raindrops we decided to head out.

$$\begin{array}{r} \text{SE} \quad 789 \\ \quad 200 \\ \hline 589 \end{array}$$

$$\begin{array}{r} \text{SW} \quad 4 \frac{1}{2} \\ \quad 521 \\ \quad -340 \\ \hline 161 \end{array}$$

$$\begin{array}{r} \text{NE} \quad 665 \\ \quad 22 \\ \hline 445 \end{array}$$

$$\begin{array}{r} \text{NW} \quad 390 \\ \quad 360 \\ \hline \end{array}$$

038

$$\begin{array}{r} \text{NW} \quad 996.688 \\ \quad - .47 \\ \hline .218 \end{array}$$

$$\begin{array}{r} \text{SW} \quad 996.751 \\ \quad .41 \\ \hline .341 \end{array}$$

19 JUN 2010

2010/48/003

Last night was horrible. I had terrible heart burn/acid reflux all night. I am pretty grumpy today and sleepy. I talked to Mary about my pit and she decided to continue further down in EU A. to find the end/bottom of wall. EU A lot 4. was pretty sterile so I believe we found the end of the Architecture. I went ahead and opened up EU B to the North of A to see if there is a visible continuation. because I was cautious I asked Pacey and Max to only go down 10 cm (EU B lot 5) but after they completed I asked to go another 10 (for a complete 20 cm initial lot.) there were no features in first 10 cm and judging from EU A it will start about 20 cm. However, there is lots of fumble. It was difficult because lots continued beyond walls. They built a "champa" or shade for us and mine is awesome. I didn't realize how big a difference it makes. We are finding some nice pieces (rather large) of ceramics. Lot 6 EU B ~~the~~ will go down to the same level as EU A lot 3 in the attempt to locate a concrete position of the wall. lot 6 was made parallel to lot 3 at 60 BGS. Western side of EU B seems relatively void of rocks which make us believe that we are

2010-48-014

right in assuming the location of the wall. We proceeded to remove rocks we suspected were humble. And to confirm found ceramics under many. Also while clearing found a soil color change from Dark Brown to yellowish.

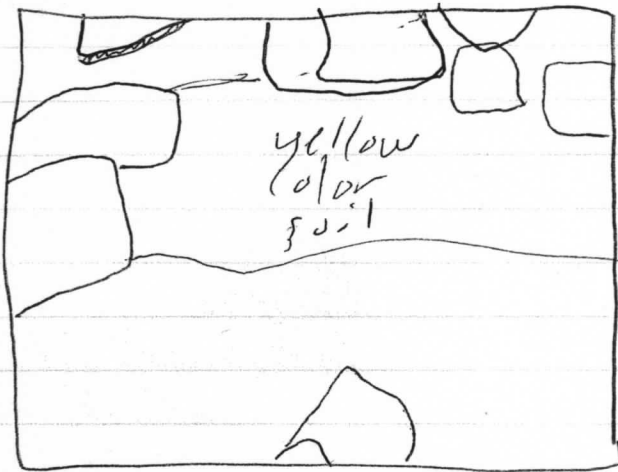

I started lot 7 EU ~~B~~A to take out more rocks that we thought were humble by comparing them to EU B. The lot (7) will be a bit funky because it is technically stuff that is occupying the same space as lot ~~2~~ 2 maybe into 3. But Mary said it was fine and to complete it as its own separate lot. Good luck to any who try and understand or do densities, which will probably be me.!!

21 Jun 2010

2010/48/005

Woke up late today, so the girls had a rough morning. Yesterday was my birthday and a rest day (Sunday) so we had an uneventful but calm restful day. Jenica was really sick throughout the day, and when we went out to dinner she hardly ate. Today she is better but she felt that it was safer to stay at the lab house. It rained pretty heavily during the weekend and because we had to remove the tarp canopy (chompas) most pits were very muddy this morning. It actually washed/cleaned my Walkin' EV A and B so it wasn't that bad. Becky, may she trip (but not hurt herself) on her butt, forgot my measuring tape... again! Because it is muddy and because of the soil change I think we hit the ground/living floor. I am opening up EV C, just East of EV A. We have a problem this morning, we have no lot forms so until we go back for lunch (Honduras is playing in World Cup today) we are using our notes. ① 5007 STR. 12

10 Op / 31 subop / Lot 8 EV C size = 1x1
initial lot ✓

Initial elevation: NW 996.86 NE 997.35
SW 996.98 SE 997.42

2012-48-006

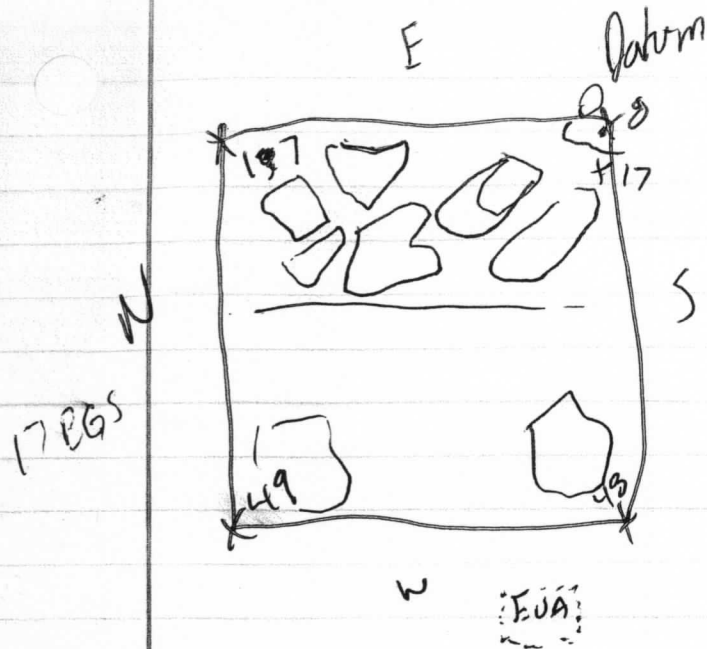

Very sloped from East to West. only cleared some top soil from western side. looks like jumble. Will take pictures and remove rocks in next lot.

ceramic

Op 10 / Subop 31 / EU C Lot 9 size: 1 x 1

initial elevation: NW 996.86 NE 997.35
 SW 996.98 SE 997.42

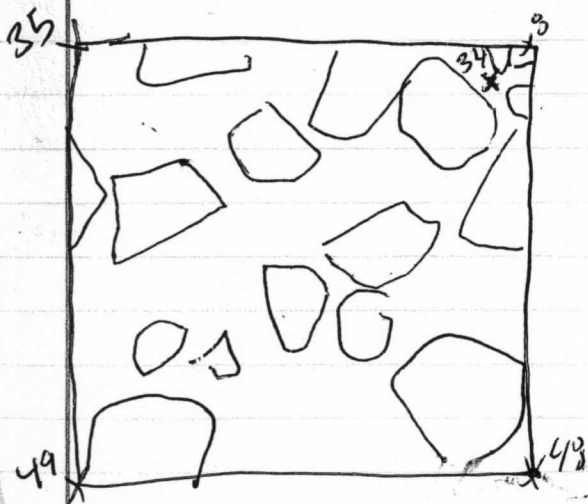

It is still at a slope so western measurements did not change. Found my black pen. After removing dirt in lot 9, we found more jumble with no artifacts.

Some nice guys came by to observe and talk to the workers. They seemed to know Paco really well and were talking and joking around about the soccer game.

Mary Smd to take next lot down to the level of the possible wall/floor of EU A.

Op 10 / Sub op 31 / Eu C lot 10 size 1x1 2010-48-007

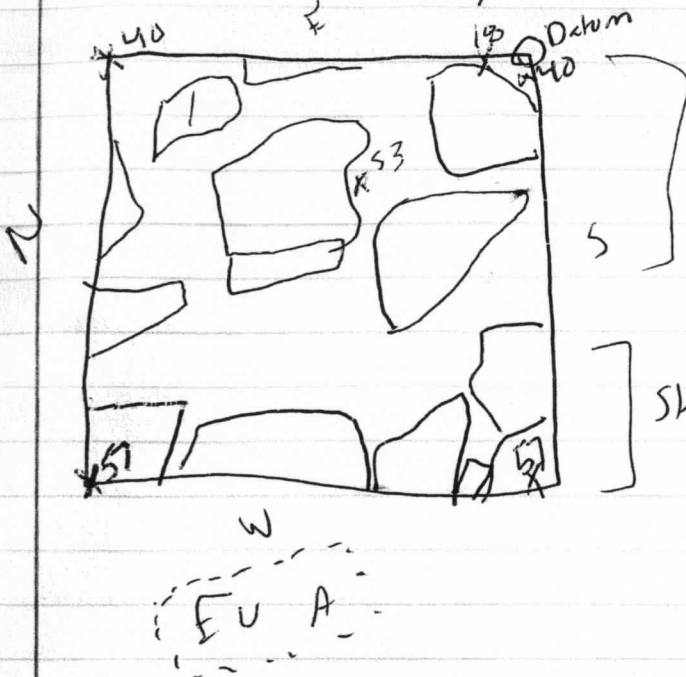

possible fill but more likely rubble. I have closed lot and begun EU D lot 11 to the north. I want step/wall to follow the line of rocks to see if they continue.

5 ceramic
1 obsidian

Op 10 / Sub op 31 / Eu D lot 11 size 1x1
initial lot

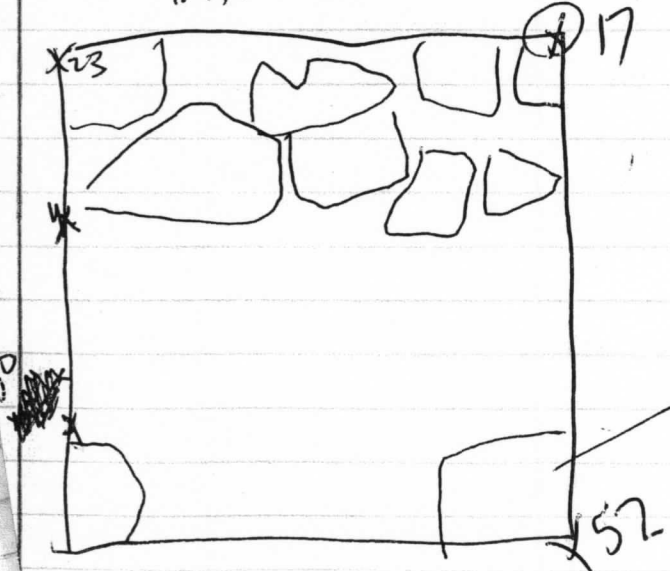

Initial lot 11 Eu D went down 10 cm clearing away top soil.

configuration of wall from Eu C. lot 10

Op 10 / Sub op 31 / Eu D. lot 12 size 1x1

2012-49-008

took out rubble, slowly
going down to find
the continuation of
step.

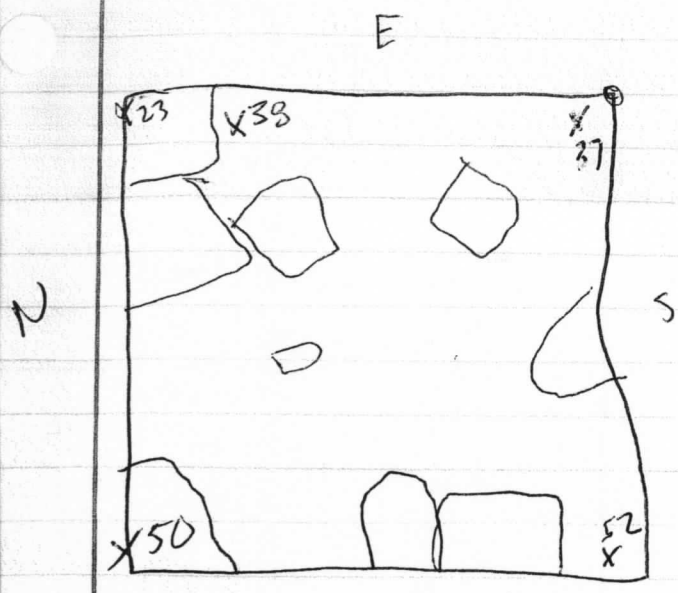

~~EU D.~~ EU D.

initial elevation	NW	<u>996.92</u>	NE	<u>997.20</u>
	SW	<u>996.86</u>	SE	<u>997.35</u>

OP10 / sub op 31 / EU D. lot 13

size 1x1

Didnt finish up lot because it was time to leave.
 We had a half day today because of the World
 Cup Honduras v. Spain. W. will continue tomorrow.
 took pics of unfinished lot before leaving.

22 Jun 2010

2010-48-009

Today everybody seems ill. Jenica seems better but Cassandra asked if she was going to stay out of the field for one more day and instead do cataloging. Jenica loves cataloging so it wasn't hard to convince her to stay. Dave is taking over her site again while she is out. We have new lot forms so I am happy, I will have to fill out ^{others} later. ~~the~~ EU D 13 was started yesterday and I am to remove some more tumble and close out today. We are slowly moving down to level with the possible terrace wall. EU D lot 14 removed further tumble and dirt, however, two major rocks go rather deep and we decided to leave them.

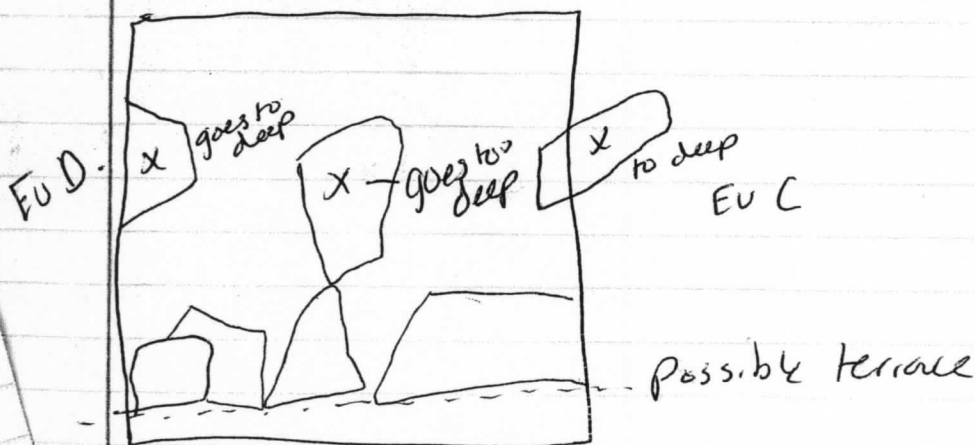

Opened EU F. Not finding much in the way of artifacts. Took break at Mike's dig because she had the most shade and sitting places. Took break while Bell and Santiago? went to visit Mayor.

22 June 2010

2010-48-010

While on break Erlind came by to tell us he found a jawbone, so we all head out to look. It was ~~so good~~ well preserved and they had found more fragments of bone around it. From where I stood it looked like the left half of a jawbone (Erlind said probably a deer). Went back to my site after that. Pico brought his dog today. He is very cute and is right now laying in EU C. on the terrace. 😊 EU F lot 19 is going down to see whether we have Bill or tumble, we only went down (from Mary's direction) from the SW corner. To get a look at the rocks. We are leaning boards fill so I will open up EU E lot 20 to check for a continuation. Just found out all my elevation calculations are wrong. I need to redo tonight. Pronto! I feel exhausted

23 June 2010

Was sick so stayed back at Lab house. Mary took over for my site.

24 June 2010

2010-48-011

I feel much better this morning and have decided to venture into the field. But I am very tired, so I'm trying to take it a bit easy. Dave has become ill today, but being the macho man that he is, he ~~is~~ is toughing it out at his site with a roll of toilet paper. Mary had done a few lots at my site yesterday while I was out sick and now she has told me I need to go down to sterile soil in EU A+B. There is an oddity in these sections, because of the rain, prior elevations are off. I didn't realise this until after I had dug about 10 cm and EU A was the same elevation as when I closed the lot before. I told Mary, we ~~thought~~ thought the best course was to record the elevation as is. Mary began the site drawing after lunch, which took awhile. She explained how to make the drawing as exact as possible. I also read her "welcome" packet that had a lot of pointers and notes on everything I could ~~ever~~ want to know. Everybody seemed to be dragging and as Mary finished up her drawing I went to help Melissa and Becky for the final hour.

25 June 2010

2010-48-012

Mary fell yesterday and had to take x-rays in the city so she is not here today. Today is also a half day because Honduras is playing in the World Cup. Thank God today is a half day. And I just heard tomorrow might be a half day too! USA vs. Ghana. While Salva worked on removing fill from EU F. I worked on correcting miscalculated elevations. My workers were having a difficult time because the rocks were so big and heavy. Poor Salva. I finished the corrections and tried to help but only got in the way, the rocks were too heavy for me. Finished getting the fill in all lots, so we now have a clear look into the building. I went over to look at Melissa's and Sheo and I ~~not~~ surprisingly have similar construction. School kids came by, they were bilingual and had many questions for us. I got sick right before they came out and consequently was in the coffee bean forest/toilet when they came by my structure. The kids went to every person's site. Me, Dicky, Mike, and Melissa took our break, then I packed up at 11:40 so we could leave in time to catch the game.

26 JUNE 2010

2010-4B-013

Today is Saturday and because the USA is playing we will have a long lunch to watch the game. I started today with removing the possible step in EU B we found about 15 pieces of ceramic directly under the rocks. yellowish clay that marked living surface was also directly under rocks (ca 5 cm) it was in this 5 cm where the soil was changing that I found the ceramics once in the yellow clay there were no more artifacts. We decided to go further east so I staked out 2 more units. EU I + J. but we don't have elevations for Eastern points. Started EU J going to calculate elevation by using datum from ~~the~~ corner. Stump right in center of unit made it difficult. Lab people (Cassandra, Jenica, and Lauren) came over for tour of site. We explained each project and after left for lunch at house. Back in field after 3pm. Game went into overtime... and we lost!! had half an hour to finish up and pack up to go home.



28 June 2010

2010-48-0014

Today is Monday, first day of a long work week. Feeling good, I didn't throw up this morning! Melissa and Mike (and Becky over the weekend) are sick with bad colds. We just learned that Mary is for a certainty, going home. She changed her flight to Wednesday morning so she will leave tomorrow to San Peedras. Today I am going to fully excavate EUJ to become level with the fill I have already exposed. Bell has told me that after this unit I will finish this sub op. All I have found is the two course basal wall and all I expect if I continue towards the center of str. 12 is more fill. Bell wants final notes and drawings so we can close up and perhaps help Mike on Str. 3 or jump to another building. I am excited to be able to excavate more than just rubble and fill. Today is nice and overcast with a good wind, feels great. On a different note, we should have paid more attention to the dirt being trampled into my site. We are having to go back and clear roads of dirt over the whole site. Bell is back! yeah! Cleaning lots is no bueno.

29 June 2010

2010-48-0015

Mary had to leave this morning to San Pedro Sula her flight is ~~tom~~ tomorrow morning. Everyone seems to be getting sick too. Today should be my last at subop 31. I am going to work with melissa on her final notes then we will work on mine. Roberto is working on finishing Mary's drawing by adding Unit J. The new sites are being set up, I am excited to start a new project. Working with melissa/with help from Bell, was hard. It has been a long time since melissa wrote her notes last season and I think I was asking for many questions. We finally got going and are waiting for Bell to go over our lot forms to make sure we did everything right. We did not get to finish everything before I but except for EU G, H, + J photos I should be ready for the new site.

30 June 2010

2010-48-016

Everyone is sick. And it really feels like everyone. Cassandra and Lauren are sick in the lab house leaving Jenica to face cleaning ceramics alone. Mike is really bad, and pecky and Melissa have running noses and sore throats. Bell said me and Melissa still need to do alot. Final pics and elevations. They will ~~fill~~ back fill our sites soon instead of waiting till we leave for Copan.

Working on fixing lot cards all morning. I used overburden for fill and Bell explained that fill is actually classified as architecture. Who knew?

Finally before lunch I go the numbers for my new project. Op 10, sub up 36, structure 3. Will begin first lot after lunch. Paco is once again my worker. He is a very hard worker and fast.

I think in the last 3 days of not really having workers I forgot all my Spanish. ~~U~~ I don't know what I said but he looked at me very weird!

Bell said we can stop early today! Yeah! We get to go home early and take a nap.

21 July 2010

2010-48-017

Today is Thursday. We only have a few more days in the field. Next Wednesday we should be done and working on our final notes again. Today is sunny and hot. And I wore a long sleeve undershirt!! Becky and Mike are working on final notes and photos today. Dave is staying home to catch up on paperwork and read up on El Hombra. Cassandra and Lauren are still sick. It feels like our numbers are dwindling. I am starting on EU A today continuing from yesterday. Starting on lot 3. We are seeing small (rounded) rocks. Small meaning around fist size up to two fists. Melissa found what she thinks is a floor at 996.96 elevation about 4 m from my site. I am proceeding slowly in hopes I do not miss anything. EU A lot 4 is continuing down, found red stone (in pieces) that we just thought was rock. However, Mike said it might be a pigment stone. I tried to find the ones we tossed with the dirt, but only found three pieces. In all I think there should have been more than a handful. Also found a possibly worked stone at the same level and close to the pigment stones. Going to bag just in case. Closed lot. EU A lot 5 continuing till sterile. Finding many coarse ceramics. Some kids are walking around watching

July 2010

2010-48-018

everybody. I feel a little bad because I can't really communicate with them. They have been watching for quite a while. The girls & were very nice, they hung around and continued to watch us and the workers. EU A lot 5 continued till we hit living surface. EU B lot 6 began after lunch. I asked to go down 10 cm. Pico had started and all (lots) fine. I went to Mike's to see how their measuring was going and when I came back the new worker (I forgot his name) had been digging and was going really deep! But since ~~we~~ they weren't finding much I told them to level it off and closed the lot. It is so freaking hot! EU B lot 7 trying to find something not many ceramics like EU A, lots of small/med roots.

~~ANT~~ I HATE ANTS!! EU C lot 8 starting one more unit up hill. Bell said she would be back before we finished. Went down about 20cm when Roberto said to pace up. Bell came by then and made a quick round to all pits. Nothing much to say about mine. We haven't found anything yet! Will continue lot & tomorrow

Ø2 July 2010

2010-48-019

I feel yucky today. Nothing is really wrong, I just am tired and achy and don't want to be here in the sun. Today is Friday very clear skies and promises to be another blindingly hot, murky day. Beley + Mike are working on final notes today. Lauren is still feeling ill, but Dave is out with us for awhile. When we arrived at our structures we noticed our choppers were in disarray and no workers were present. They are always early! But they were just a few minutes behind us. Going to go down somewhere in EUC lot 8 hopefully we find something. EUC lot 9 continued to level with lot 7 EU B. Still have not found any architectural features. Moved up one unit opened EU D lot 10. Started to find some rubble in EU E. Meli found an awesome intact ceramic vessel. Very exciting. I basically abandoned my site to observe her removing it.

July 2010

2010-49-020

Today is Saturday!! Another cloudless sunny day. Starting today with EU B lot ~~to~~ going to be bringing everything down to make sure we missed nothing. After today we only have 3 more days in the field! I feel like we have been here a long time but at the same time ... only 3 more full days to excavate is scary short. Although it is Sat. and we planned to have the lab people visit, the visit was postponed for better health (Janica is not feeling well, Cassandra is not completely recovered, and Lauren is still sick) and hopefully not so dreadful weather. Paco brought out his dog who is very nice and cute. EU C lot #7 going down to lot #6. On the EU D lot #19. Took out for giant lizards. Paco found about a dozen already hatched eggs in EU D. EU D lot #19. Taking out humbles in EU D lot #19. 6 rocks we took out were like icebergs with 90% under the soil. They looked small at first. After we

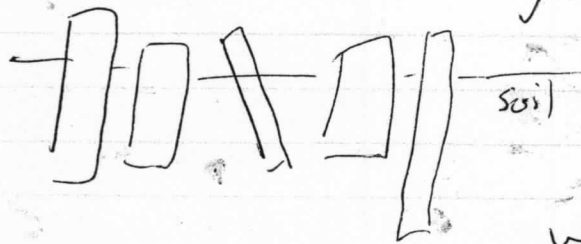

took them out they seemed very likely part of the wall because the were nice and flat some were close together like a wall fell down hard core.

July 2010

2010-49-021

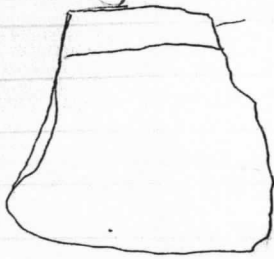

sticking up

- in dirt.

d. did not
home.

After pulling up the
rat found some nice

capacitor ceramic

underneath. EU E

lot 20 taking down more

jumble. started at end of day

finish up and had to go

5 July 2010

2010-49-022

Today is Monday. The day started off cloudy with a breeze but it's getting hotter. I am continuing from EU E lot 20. It still looks like po. EU F lot 22 has yet another cavernous pit probably caused by a enormous fantastical beast... the Iguana. Long have I yearned to catch such a beast that may have been the cause of so much destruction in my sub op. I hope they find and kill it! 

EU G lot 23 not finding any artifacts.  Is it a dragon or an Iguana poorly drawn? Going up one unit

We found carbon close to surface that Paco said was from planting. Eastern side of pit had no rocks so we may have stumbled onto the summit. EU H lot 24 initial lot had no rocks or artifacts at all. Went back to EU G opened lot 25 still no rocks in eastern side of pit at the same time we opened EU H lot 26 still no change (neither rocks or artifacts).

06 July 2010

2010-48-023

Today is Tuesday, the day started off hot with only more heat to come in the day. Bell has gone over what I need to do to finish my structure. We need to go down in G+H till we hit the bottom of possible wall or a floor.

Mike also wants a clear soil profile so I will keep going down in EVA. But that's all to it. If I finish today I might have to go to the lab tomorrow. EU G+H lot 27 + 28 we attempting to find a living surface.

The possible wall is looking more like fill which means perhaps a looters trench? I don't know! Still not finding rocks in G+H. lot 28 will go down to we hit rock.

Do or Die time! Lots are going slow because it is close to quitting time. Lots are getting bigger/deeper. G+H lot 28 went down about 1 meter down and still didn't hit rocks...

We did hit a layer of gravelly clay, that was difficult to move through. Opened up EU I lot 29 went down through top soil. Then EU I lot 30 we wanted to blow through to level with EU G+H. We hit rubble and removed all dirt, ~~the~~ but kept the rocks. However, because it was so late I had to leave before we could fully close the lot.

7 July 2010

2010-48-024

Last day digging in the field! Closed EU I
lot 30 this morning. Bell wants us to
finish up and we are going down in EU D Lot 31
~~to find~~ to find where the tumble ends and
possibly the floor. We went down to the bottom
of the collapse in lot before, we were
finding tumble but by the end there were
no more ^{rocks} and no indication of a floor.
Going up into EU E lot 32 trying to find
the base of a blown out wall. Having
lots of trouble with collapses and damn. Iguana
notes. Three collapses in less than 5 minutes
has convinced me that I am done excavating
at or to 30. We cleaned up and allowed Paul
to begin final drawings.

8 July 2010

2010-48-024

Doing final notes today!

29 June 2010

2010-42-025
~~2010-48-016~~

Final Notes

Unit Name	Length	Width	Height	Alignment
<u>Cambodia</u>	196 cm	40 cm 19 cm	22 cm 8 cm	9°

Courses	Top Measure	Bottom Measure	Datum
one	-107 996.94	-145 996.50	998.03 SE EUS

Largest Rock	Smallest Rock	Modal size	Rock form	Kind of Rock
24 x 45 x 9 cm	21 x 34 x 8 cm	24 x 45 x 9 cm	Rectangular partially shaped	River Cobble



Unit Name	Length	Width	Height	Alignment
<u>Curly</u>	198 cm	33 cm 21 cm	37 cm 28 cm	9°

2010-48-024

Courses	Top Measure	Bottom Measure	Datum
1 - EW	-107		998.03
2 tall	996.96	-140 996.57	SE E U J

Largest Rock	Smallest Rock	Modal size	Rock form	Kind of Rock
42 x 28 x 9 cm W L H	28 x 27 x 12 cm	32 x 26 x 10 cm	Rectangular (partially shaped)	River Cobble



Unit Name	Length	Width	Height	Alignment
<u>Fill</u>	340 cm 287 cm	194 cm 100 cm	104 cm 18 cm	N/A

Courses	Top Measure	Bottom Measure	Datum
8 max	-92 cm	-120 cm	998.03
1 min	997.11	996.83	SE U E J

Largest Rock	Smallest Rock	Modal size	Rock form	Kind of Rock
30 x 32 x 10 cm	11 x 10 x 5 cm	35 x 25 x 10	Misc. Flat	River Cobble

2010-48-027

Top soil - $4\frac{1}{2}$ ^{25 yr.} dark greyish Brown. (fine)
loamy ^{clay} soil - $3\frac{1}{2}$ 7.5 yr Dark Brown (fine)
Clay - $4\frac{1}{4}$ 10 yr. Dark yellowish brown
(very fine)

We started excavating on June 18 2010. I decided to excavate sub op 31 located on Structure 12 on the West side. My excavation units were set up in a 2m by 4m with 1 meter units. Unit J was added at a later time.

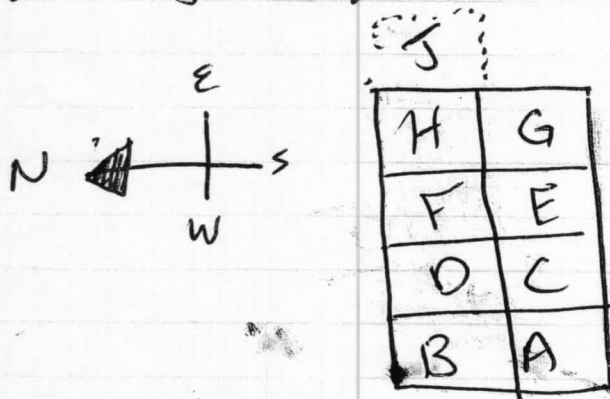

I began with units A and found my first feature Cambodia which was a possible step. Upon later inspection because it was only one course I believe there is a possibility that it was tumbled because it was ~~not~~ located a bit above the living surface clay. My second feature was Curly a basal wall consisting of 2 courses that were preserved. Curly went the ~~top~~ width of my trench and continued beyond. It looks good that it will match

200-48-028

up with sub of 30 and sub of —
"Larry" and "Mo." Preceding up the building
we were unable to find another wall
or terrace. The only other noticeable
feature were two oddly placed rock structures.

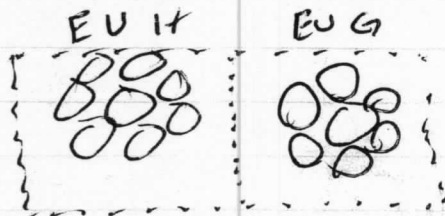

We surmised that it was either a coincidence
or it might have been post hole structures.
It was more likely a coincidence because
it was completely surrounded by fill with no
preserved architecture to point to a terrace
or wall.

July 2010

2010-48-029

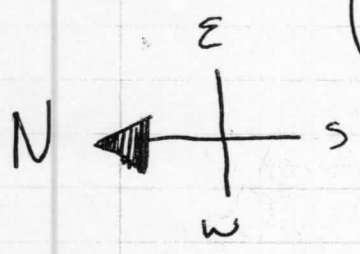

Wall Tumble

Possible column

Iguana holes

Possible tumble from wall



I
H
G
F
E
D
C
B
A

Jumbled/collapsed

Collapse

BAJA Deposits above cavern

Found in Carbon Cavern (Iguana)

Final Notes

2000-48 - 030

Tumble
Fill

Largest Rock

	H	x	W	x	T
EU E -	14	x	35	x	20
EU F -	17	x	32	x	35

Angular, mostly
cobble

local sedimentary
rock

Medium Rock

	H	x	W	x	T
EU E -	7	x	25	x	17
EU F -	7	x	30	x	30

Small Rock

	H	x	W	x	T
EU E -	3	x	18	x	13
EU F -	3	x	18	x	23

Possible
column

(Arist
~~faenan~~
Caliban)

Unit name	length	width	Height	alignment
Caliban	30 cm min	66 cm at Base	95 cm	24°
	70 cm max	90 cm at top		

↳ hole on side - possible second course

Courses	Top Measure	Bottom Measure	Datum
2-horizontal ↳ 10-vertical	-5 998.95	-95 cm 998.05	SE EU H (999.00)

Possible column (Caliban)

200-48-031

Largest Rock H x w x T	Smallest Rock H x w x T	Modal size H x w x T	Rock Form	Material
13 x 30 x 30	7 x 34 x 20	13 x 30 x 24	River cobble	Local Sedimentary rock

Wall Collapse (EU I)

Largest Rock

H x w x T

- River
cobble stone

23 x 35 x 29

Medium Rock

- local sedimentary
rocks

8 x 25 x 30

Smallest Rock

11 x 20 x 13

BAJA Deposit (EU D)

Datum SE EUD (997.95)

Top measure - 28 cm = 997.67

Bottom measure - 57 cm = 997.38

Height - 28 cm.
Width - 42 cm.

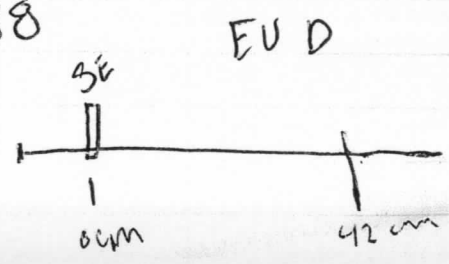

EU D

2510 - 48 - 032

Carbon Deposit

EUD

Datum SE EUD (997.95)

Top Measure - 70 cm (estimate) = 997.25
Bottom Measure - 115 (bottom of collapse) = 996.80

Height - 44 cm
Width - 50 cm

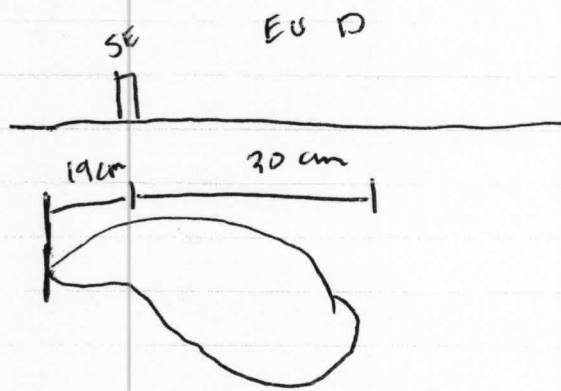

2010 - 48 - 033

Soil charts

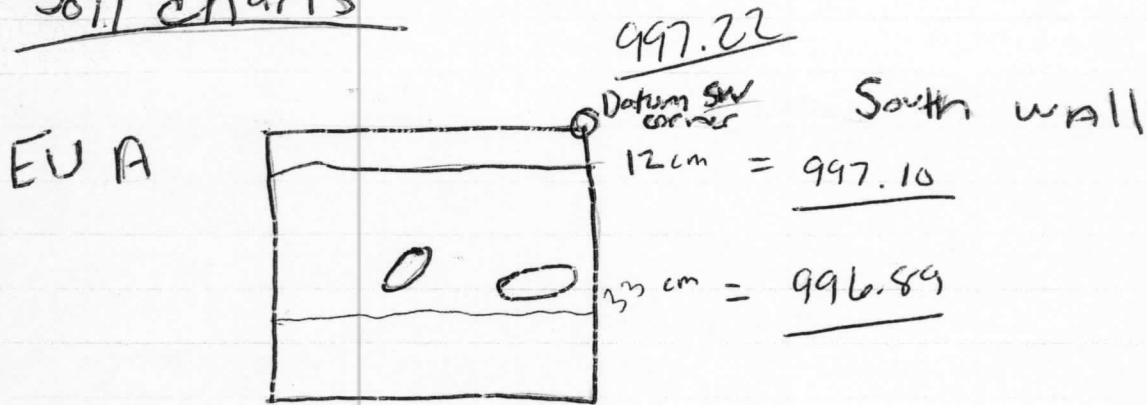

Top soil - 4/3 (10 yr) Brown

Middle Soil - 3/2 (10 yr) Very Dark-Grayish Brown

Bottom Soil - 4/4 (10 yr) Dark Yellowish Brown

Top Soil - Moderate coarse

Middle Soil - Moderate coarse

Bottom Soil - very fine (clay) with moderate coarse inclusions

Final NOTES

2010-08-034

8 July 2010

Excavation took place from June 30 2010 and final notes were completed on 8 July 2010. for Site 007 OP 10, sub OP 36 lots 1-32. Nine 1 x 1 meter units were setup in an axial trench up the western side of the mound (called structure 3). The trench was oriented East-West and EU A was the western-most unit. As a special note. EU I ~~was~~ shared two points with sub-op 37. They shared the southern points of EU I in my trench.

N ←

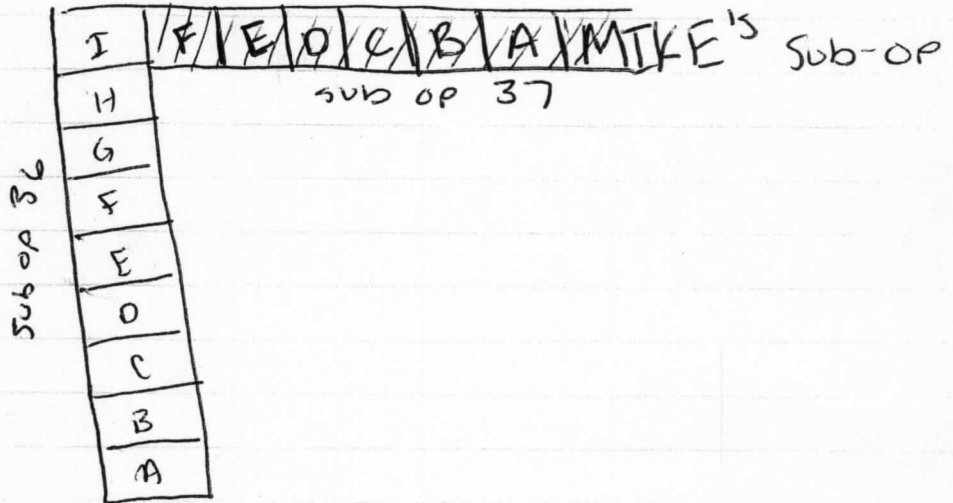

The first two units excavated were EU A+B. They were both free of tumble and we ~~presumed~~ presumed that since we were not yet to the mound, we would not find architectural features yet. In EU A we went to sterile soil which was not that deep. We hit sterile yellowish brown clay at 996.89. We began to find tumble in EU C. It was flat layed and at first we thought it might be a beginning of a floor. In EU D we began to removed tumble to level with

EU C and the possible floor. In EU D we found a huge deposit of Baja at 997.67 that was concentrated at the southern wall but spread into half the unit in 10/36/012. Going down further we began to hit the first of many tunnels/caverns. These tunnels were caused by animals, and the workers, finding a cache of about a dozen already hatched eggs, persuaded the animal in question to be an Iguana. Further down in EU D directly below the Baja deposit we found another cavern filled with carbon. 10/36/19. The tumble that we are pulling out is very jumbled and oriented in many different ways

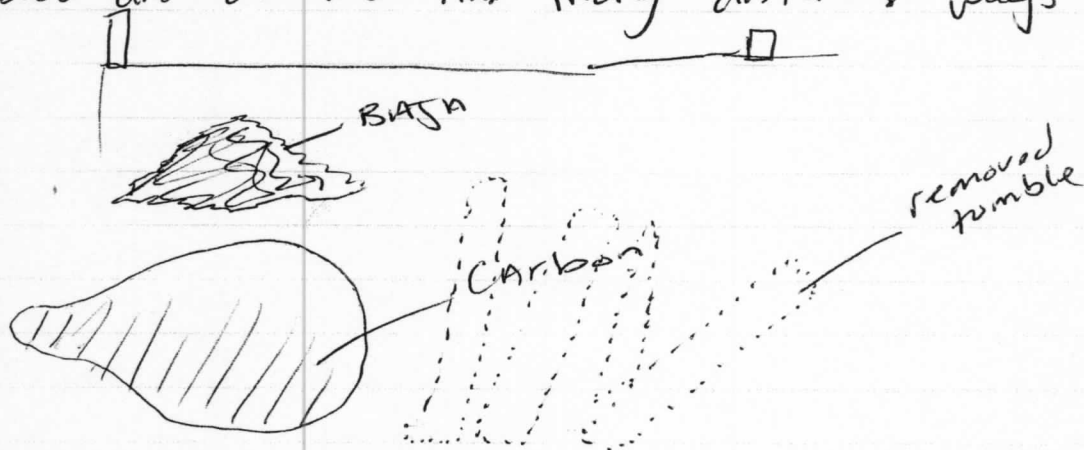

The carbon deposit was discovered when we removed tumble that ~~was~~ can be described as vertical flat rocks. However, we could not determine first it was a collapsed wall because we could not find the base of a wall and we continued to find tumble beneath. The Iguana holes became increasingly troublesome and collapses were beginning to become common. The loosely packed sediment

2010-48-036

and tumble made deciphering very difficult, and basically impossible. We left most of the tumble in EU E + F because of time constraints and safety hazards. At the top of our mound in EU G we found what we believe to be the remnants of a column. This is the only preserved feature in my sub-op. The feature is called Caliban and it was 6-10 courses high and 2 courses wide.

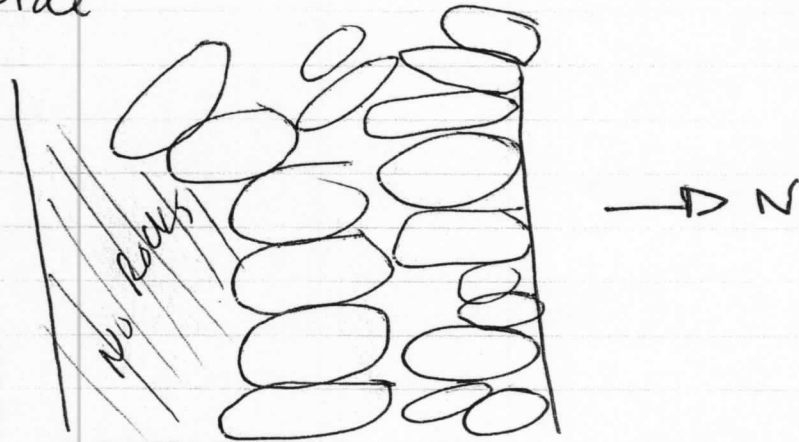

Caliban is classified as a column rather than a wall because of the fall pattern. The northern side is falling north as if there is not another course and the rocks all line up well and seem to end at the end of the wall. 10/30/28 we went down hill we hit a gravelly clay. Due to time constraints we were unable to get to the bottom of Caliban. Probing the surface we could determine that it has at least one more course. In EU I we found possible tumble from a wall, ~~with~~ with the absence of any rock from Caliban to the tumble, we believe that that indicates the presence of a room with the front of the building opening up with columns. The tumble in front of the column must have been

200-48-037

terraced before some catastrophe completely ruined any structural architecture.

The End

