

1996

## PVN-095-Robbins-Field Notes-1996

Bryan Robbins  
*Kenyon College*

Follow this and additional works at: <https://digital.kenyon.edu/honduras>

 Part of the Archaeological Anthropology Commons

---

### Recommended Citation

Robbins, Bryan, "PVN-095-Robbins-Field Notes-1996" (1996). *Four Valleys Archive*. Paper 8516.  
<https://digital.kenyon.edu/honduras/8516>

This Field Notes is brought to you for free and open access by the Anthropology at Digital Kenyon: Research, Scholarship, and Creative Exchange. It has been accepted for inclusion in Four Valleys Archive by an authorized administrator of Digital Kenyon: Research, Scholarship, and Creative Exchange. For more information, please contact [noltj@kenyon.edu](mailto:noltj@kenyon.edu).

# HzTE 128/I

Dimensions of trench (over mound) - 1 meter / 19.65 m

Trench crossing the mound in Northwest - Southeast fashion (structure 3)

## 128/I - 1 (First 10cm down) in Northwest corner

- Datum point measured from Northern-most stake
- square measures 1 meter x 1 meter

### Found

- large stone eastern corner (roughly 8-10 cm from datum)
- many root systems, soft, fine, dark brown dirt, occasional stones

## 128/I - 2

- Datum point measured from Northern-most stake, 20 cm from ~~top~~ Datum
- square ~~measures~~ measures 1 meter x 1 meter

### Found

- dark brown, soft, fine dirt
- fewer stones than before, but some
- larger, well sized stone along south-southeast wall
- large, eastern corner continues to become more defined, quite sizable and flat. Another stone, just south, may or may not connect.
- fewer root systems, one large root.

## 128/I - 3

- Datum point measured from Northern-most stake, 30 cm from ~~top~~ Datum
- square is 1 m x 1 m

### Found

- ran ~~into~~ <sup>into</sup> trouble with a thick root.
- dark brown, fine (a little clumpy), dirt.
- more stones, most about the size of a fist. One flat, square-shaped stone was found - possibly a pottery shard
- The original eastern stone keeps getting larger.

12BAN/12BAK/12BAR/12BAQ 4/29/96 Str. #4

P96-95-97

12BAN/18 0-30 cm down in a 1st measuring 70cm x 100cm in Block #8, which measures 1m x 1m and begins 7m from the SE end of the trench. This is a continuation of 1st 12BAN/07. We just removed the rest of the tumble, looking for a line or wall, but coming up short on all aspects. Tumble.

Found - 4 pieces of Sufareque - 150+ ceramics - 1 Osidian blade

12BAN/19 30-60 cm down in Block #8, which measures 1m x 1m and begins 7m from the SW end of the trench. This just levels the floor of Block #8 with that of #7. No tumble. With it having rained last night, it's tough to tell if the soil is hard.

Found - 190+ ceramics - 60 pieces of Sufareque  
- one chest core - very interesting. - 1 Osidian chip

12BAK/64 40-80cm down in Block #17 which begins 10m from the SW end of the trench. No tumble. Soil hardness is difficult to tell due to the rain. There are still lots of Sufareque in the floor but not as many.

Found - 130+ ceramics - 7 pieces of Sufareque  
- 4 Osidian chips/blades

4/30/96

12BAK/65 50-80cm down from the northernmost AP. of Block #18, which begins 6m from the NE end of a trench crossing Str. #4. Lots of tumble. We went very slow, and were careful what stones we removed. There were no lines, but who knows, ~~the~~ with the shape of this structure I've could've taken out a wall. Don't think so though. There is still quite a bit of tumble around the edges of the Block, which I left just in case there is something ahead. Lots of Sufareque in the floor.

Found 10+ pieces of Sufareque - 100+ ceramics

128AK + 128AN

Str. #4

4/30/96

P96-95-94

128AK/66 / 0-30cm down from the southernmost latim pt of a lot measuring 40cm x 100cm, ~~220~~ beginning from the SW line of Block #14, which measures 1m x 1m and begins 11m from the SW end of a trench crossing Str. #4. We hit surface rubble, the we've done before, and we'll remove it bit by bit down to the floor of the previous block to see if these stones are supported by anything.

Found 75+ ceramics

- you can see brazier in the floor

128AN/20 / We've returned to Block #6 and are clearing the backside of Arts 61more. The lot measures 60cm x 100cm, behind "Arts 61more". We've taken it 40cm deeper from the northernmost stake, making the lot 80cm deep. The backside seems to be constructed so far of 2, maybe 3, layers of medium-large cobble (avg. 18x11cm). Difficult to tell as far as the flat faces.

Found - 100+ ceramics

- a bit of brazier

- one bone chunk, probably animal, unfortunately no exact provenience, but it was found in the last 5cm of the lot.

128AK/67 / 30-70cm down from the southernmost AP of Block #19, in a lot measuring 40cm x 100cm (see 128AK/66). The Block measures 1m x 1m and begins 11m from the SW end of the trench. I'm going to end here, with 60cm unexcavated, to show what the supposed summit floor looked like. The extra 60 x 100cm shows various stones, some cobble, some seemingly cut (avg. 20x23cm) laid somewhat flat, all not very. There was not stones in lot 128AK/67 allow we did find a bone sherd in the last 5cm - no provenience though - it was by itself.

Found - 9+ pieces of brazier (plentiful)

- 75+ ceramics

- one clay piece shaped like a tooth

- one bone sherd



128AK / 128AN

Str. #4 4/30/86

P96-95-95

128AK/68/ 0-20 cm down from the northernmost datum point of Block #20, which measures 1m x 1m and begins 7m from the NE end of a trench crossing Str. #4 in a NE-SW fashion. We can see the tops of tumble.

Found - 9 ceramics - 2 pieces of biquaque

128AK/69/ 50-80 cm down from the southernmost datum point of Block #15, which begins 6m from the SW end of the trench. We removed the tumble (the layer of it) and took the block down to the floor of the previous block. Very few artifacts, which is interesting. Perhaps we'll run into something after all.

Found - 10 ceramics  
- one large chunk of biquaque

128AN/21/ 40-80 cm down in Block #7, which begins 6m from the SE end of a trench crossing Str. #4 in a SE-NW fashion. Biquaque was very plentiful, as well as shells - some of the first we've found. Chances are we're in fill.

Found - 175+ ceramics - 15+ chunks of biquaque  
- 18+ shells

128AN/22/ 80-100 cm down in a 60x100 cm lot behind "Area 6 Above" in Block #6, which measures 1m x 1m and begins 5m from the SE end of a trench. I think we might still be in fill, although the fill-soil isn't nearly as soft as that of Str. #3. There also seems to be a high concentration of biquaque.

Found - 70+ ceramics - one nicely painted picture - 5 shells  
- 15+ chunks of biquaque

128AK/22/ 50-70 cm down in Block #6, which begins 9m from the SW end. We removed some tumble, the first "layer". We still have one more "layer" to go - then just soil. Oscar said the ground was very hard.

Found - 60+ ceramics - 1 Asadian chunk

12BAN/23 100-120 cm down in a 60x100 cm lot behind Autos Gilmore in Block #6, which measures 1m x 1m and begins 5m from the SE end of the trench. Autos Gilmore's backside (let's not get prevented here) looks to be constructed of 7 layers of cobble, with the cobble getting smaller and flatter as it goes down (avg. 6x24 cm). Can't really tell as far as the flat faces go. We have not reached the base yet, but that's good for now.

Found - 10 pieces of biquaque (plentiful) - 2 shells  
- 20 ceramics

5/2/90

12BAK/71 20-50 cm down in Block #20, which begins 7m from the NE end of the trench. We hit a possible line, however so crude approx. 80cm into the block from the NE. We'll remove more rubble in front of it, just in case it is something. Lot's of rubble.

Found - one nice 1/2 of a metate - one complete biquaque head - solid  
- 25+ ceramics - 1 piece of biquaque

12BAK/72 70-110 cm down in Block #16, which measures 1m x 1m and begins 9m from the SW end of the trench crossing Str. #4 in a ~~SW-NE~~<sup>SW-NE</sup> manner. We removed the last "layer" of rubble and leveled the lot with the previous block. Ed believes these two layers of rubble (one beginning in Block #14 and the other #16) were two terraces of the summit. It's still questionable, but the layers are too consistent in their stratigraphy to be just rubble.

Found - 1 Aztecian clasp - 12+ ceramics

12BAR/02 20-40 cm down from the southernmost D.P. of Block #1, which measures 1m x 1m and begins 2m NE of Block #3 of 12BAN. We've returned once again to Sand Jack Shima. It looks as if it's a bit farther to the NW. Lot's of rubble.

Found - 40+ ceramics - 2 chunks of biquaque

128AQ/02 20-40 cm down in Block #1, block measures 1m x 1m and begins 1.5 m to the NW of Block #12 of 128AK trench. Nothing really.

Found - 3 ceramics

- 2 chunks Sajaque

\* We're going to retreat one m, so we can pick-up Rusty Staub. This'll be confusing, but it's for the best, boys and girls.

128AQ/03 0-20 cm down from the southernmost D.P. of Block #2, which measures 1m x 1m and begins 1m to the SU of Block #1. It's confusing, but you'll have to deal. Surface, roots (we're next to a tree), nothing else.

Found - 20+ ceramics

128AR/03 0-30 cm down from the southernmost DP of Block #2, which measures 1m x 1m and begins 1m from the SE line of Block #1, going NW. Lots of rubble, Jack Shuman's around here somewhere. It most likely isn't too well preserved though, judging by the rubble. We left a possible line 60cm from Block #2's SE line, just in case.

Found - 30+ ceramics

- 1 piece of Sajaque

128AK/03 50-120cm (yes, I know that's alot) down in Block #20, block measures 1m x 1m and begins 7m from the NE end of the trench. I didn't tell them to go down that far, but when they found the crude line was a wall, they went nuts. It is indeed a wall, but I'm not going to take measurements or describe it just yet. You can tell it's a wall by the bottom 40-50cm or so, and I'm not sure if the top part is rubble or if the top just isn't well preserved. Nevertheless, it runs along the SW line and extends approx. 40cm into the trench. Lots of rubble in this block. Ground was hard once again.

Found - 120+ ceramics

- 7+ pieces of Sajaque.

- Carbon sample, 110 cm down

- one mano

- one obsidian chip

128AQ, 128AK, 128AR STR #4 5/2/96

P96-95-97

128AQ/04/ 20-40 cm down from the southernmost D.P. of Block #2, which begins on the SW line of Block #1 going SW, measuring 1m x 1m. We've hit roots, some tumble, and we've stopped atop some well-implanted stones - both cobble and maybe a cut stone.

Found - 20+ ceramics - one obsidian chip

- 1 piece jaguar

\* We'll go 50 cm to the SW to hit these stones head-on

5/3/96 128AR/04/ 30-75 cm down in Block #2, which measures 1m x 1m and begins 1m from the SE line of Block #1. We've found Jack Schmitt, which begins 30 cm from the SE line rising up 40 cm from the floor. Tumble.

Found - 20+ ceramics

128AR/05/ 0-20 cm down from the southernmost D.P. of Block #3, which measures 1m x 1m and begins 2m from the SE end of the trench. Surface, we can see the tops of some tumble, and possibly the top of "Antes Glauco".

Found - 40+ ceramics - 3 chunks jaguar

- one <sup>blade</sup> of obsidian

Block #3 → 128AQ/05/ 0-30 cm down in a lot measuring 50 cm x 100 cm added on to Block #2's SW line. Block #2 now measures 1.5 x 1m. Surface, some tumble (not much), we can see the tops of a lot of tumble.

Found - 3 chunks of jaguar

- 45+ ceramics

128AQ/06/ We've found a line in Block #2, so we removed a 40 cm x 100 cm lot in front of it. We're also adding 50 cm more onto the SW end of Block #2, so we'll just say 128AQ/05 + 06 were found in Block #3, which begins off the SW line of Block #2. Tumble, some down to 50 cm.

Found - 12 ceramics

- 1 chip of obsidian

30 cm - 50 cm

12BAK, 12BAR, 12BAQ

Str. #4 5/3/96

P96-95-98

12BAR/06 | 20-50 cm down in a lot measuring 50 cm x 100 cm in front of "Artes Gilmore" on Block #3, which measures 1 m x 1 m and begins 2 m from the SE end of the trench. We've found Artes Gilmore - nicely preserved, as well as the skeleton of Jack Stone. Jack Stone seems to be 80 cm wide on top, with an extra 20 cm coming out at 30 cm down. It looks to be only of cable (avg. 20 x 16 cm). We can see 3 layers, although we weren't at the base. Angled at 38°/218°. Artes Gilmore is much nicer, although we haven't found its width yet. Its top is mostly encased in 4 medium-large cables (avg. 25 x 21 cm) with 3 (very faint) layers of smaller cable (range 24 x 7 cm - 6 x 3 cm) underneath. seems there is some additional part to the flat faces. Angled at 30°/210°.

Found - 150+ ceramics

- 5 pieces of Infanterie

12BAR/07 | 0-40 cm down in a lot measuring 50 cm x 100 cm beginning from the SW line of Block #3 (It is inside the block), which measures 1 m x 1 m and begins from the SW line of Block #2. We've leveled this lot with the floor of the previous one, so Block #3 now goes down to a depth of 40 cm. We've hit lots of rubble. Large (moderately) rubble. We've got a definite line, but with all this rubble in front, 2 m ahead we might miss something. Rusty doesn't have anything in front of it, so I guess we'll start digging west out.

Found - 50+ ceramics

- 1 obsidian Blade

12BAK/74 | 0-40 cm down in Block #21, which measures 1 m x 1 m and begins 8 m from the NE end of the trench. We've uncovered the top of "Bucky Dent", although it's not too well preserved. Its width seems to be about 1 m wide, at 90 cm tall, although there is a spot or two behind this first part that looks to rise 15 cm above the top - much like the wells on the SE side of Str. #4, although again it's not well preserved. The top (what is left) seems to be of large cable (avg. 28 x 18 cm), the underneath ranging from 2 x 6 cm to 29 x 9 cm. Layers only visible at bottom. at 311°/131°. Found - 3 obsidian biface - 3 chips of obsidian / once - 60+ ceramics

12BAR, 12BAR, 12BAR Str. #4 5/3/96

P76-95-96

12BAR/07 0-30 cm down from the southernmost datum point of Block #4, which measures 1m x 1m and begins 3m from the SE end of a trench. It seems that Art's Glimmer continues to a width of approx. 120cm with stones averaging 23x22cm in size. Approx. 30cm in from the NW line, another level appears, rising 25cm above Art's. It consists of stones averaging 20x18cm in size. Whether it's part of Art's, or a step of some sort, I'm not sure yet.

Found - 65+ ceramics

5/6/96 - It rained a lot last night and this morning. 12BAR<sup>13</sup> is still in pretty good shape, although there was standing water in the lot we were working on. Lots of mud. 12BAR (the SW end) has standing water at the ~~SW~~ end and some small stones have fallen, but we're not working here anymore, so it doesn't matter. 12BARW has standing water as well, but is in pretty good shape. 12BAR probably had the most damage, with standing water at the SE end and some stones washed off. Jack Schma (2 main beginning top row stones) and Art's Glimmer (some support cobbles, pretty small). 12BAR (the NE side) is in decent shape, there's standing water at the NE end and some mud slides have covered the top and are in front of "Bucky Dent". Overall, just a lot more mud to deal with, so going with it slow.

12BAR/75 0-30cm down from the northernmost D.P. of Block #22, which measures 1m x 1m and begins 9m from the NE end of the trench. We've found what looks to be a lane as far as 35cm in from the NE line of the block. It could be an addition on the top of Bucky Dent, or it could be something all its own. We'll ~~not~~ clean in front of it to look at. All the mud doesn't make it difficult though.

Found - 2 ceramics

128AQ/08 40-90cm down in a lot measuring 55x100cm, beginning from the SW line of Block #3, which measures 1m x 1m and begins at the SW line of Block #2. This lot is located in front of the newly discovered wall/step in Block #3, which is constructed in what seems to be 3 layers. The first is 50cm down from the D.P. We haven't found the bottom yet, but it seems to be constructed of medium cobble (avg. 20x7cm) in 4 layers with a large stone at the base (15x33cm), or the base so low. Flat faces seem to be out quite nicely, and the angle of the wall is 31°/131°. The next level is 10cm above the first, and 8cm from its edge. It is constructed of moderately large ~~large~~ cobble (avg. 23x24cm). Underneath these large top stones seems to be smaller cobble only (avg. 6x5cm). Flat faces are out, and it's angled at 310°/130°. The last level seems to be the top of the terrace, constructed of a variety of cobble (range 25x35cm to 7x4cm). It rises 8cm above the 2nd layer and 31cm back, angled at 310°/131°. We can also see another wall along the SE line perpendicular to this one, forming a corner. We'll follow this excavated one first.

Found - 20+ ceramics

2 obsidian blades

- Carbon, in the last 20cm.

128AR/08 0-25cm down from the southernmost D.P. of Block #5, which measures 1m x 1m and begins 4m from the SE end. We've hit a possible line, very different than anything else we've hit. It's angled or curved, going S-N, opposed to the SW-NE walls we've been getting. It's possible it's double though, we'll see.

Found - 200+ ceramics

- 1 obsidian blade

- 7+ chunks of  
lignite - some large

128AK, 128AQ, 128AR

STR. #4

5/6/86

P96-95-101

128AK/76/30 - 50 cm down in Block #22, Arch begins 9m from the NW end of the trench. It's a 40cm x 100cm lot in front of the newly discovered wall. We'll continue to clean it up.

Found - 5 chunks of jagware  
40+ ceramics  
1 obsidian chip.

128AK/77 50-60cm down in Block #22. We simply cleaned up the dirt in front of the new wall "Lenny Sakata". It rises 60 cm above Bucky Dent, and there is a space of fill 45cm between them. We're going to clean off the top, so I can fully describe it.

Found - 1 obsidian blade - 25+ ceramics - 1 piece of jagware

128AR/09 20-50cm down in Block #5, which measures 1m in and begins 4m from the SE end. We've found another wall, that looks to hit "Arto's Glomere's" backside. The strange thing is, it's circular. It hits Arto's 23cm away from the SW line, 48cm from the 50cm mark, and around 51-52cm from the end of the SW line. See sketch #11. I'm not going to describe it just yet, I'll wait until more is uncovered.

Found - 1 chip of obsidian - 4+ chunks of jagware  
- 1 piece of a conchero - 160+ ceramics

128AQ/09 0-30cm down from the southernmost point of Block #4, which begins at the NW line of Block #3. We're next to a tree, so there's a lot of roots, but we can see a line that looks to be a continuation of the 3rd layer of "Michael Cooper", at 18cm into the block from the NE line. We can see lots of rubble coming up.

Found - 3 obsidian blades - 1 piece of jagware  
- 35+ ceramics



128AK, 128AR, 128AQ S7R #4 5/6/96

P96-95-102

128AK/78 - We simply cleaned - off the top of "Lenny Sakata". It seems that this wall had been taller, but a substantial chunk has been ripped-out. Will go one meter ~~to~~ further to see behind it and finally smash the aerial trench. I'll describe it then.  
Found - 7+ ceramics

5/7/96 128AK/79 - 0 - 30cm down from the <sup>now</sup> southernmost DP of Block #23, which measures 1m x 1m and begins 10m from the NE end of a trench crossing Str. #4 in a SW-NE manner. We stopped at a post measuring 70cm x 100cm because we ran into what looks like a line along the SW line, though it doesn't have any support, much like the cases with the structure's SW side. We can still barely make-out the supposed back-line of ~~the~~ Lenny Sakata, even though we had visitors last night that graciously pulled some stones out for us. It seems this area isn't all that well preserved. Surface, some tumble. I guess the most logical idea would be that Lenny rose much higher and acted like a frame for the summit RM that supported the floor.

Found - 6 chunks of Sogaveque - 1 chert chip  
- 50+ ceramics

128AK/80 - We simply cleaned the front of Lenny Sakata. Yes that's a lot of cleaning for one wall, but we really have a concern for cleanliness around here.

Found - 18+ ceramics

128AR, 128AR, 128AK

STR. #4 5/7/94

PA6-95-103

128AR/10 30-85cm down from the southernmost DP of Block #4, which measures 1m x 1m and begins at the NW line of Block #3. Yes, this is a large lot, but after I told Milton only 30cm down, he grabbed his trusty pick-axe and boldly went down 55cm. I think he struck oil while he was at it, but that's beside the point. Michael Cooper is continuing nicely, the levels are very evident. I'm no expert, but I'd say this feature might be some stairs. Tumble

Found - one large pot sherd, found 85cm down, along the NW line, 30cm from the SW line, in front of Michael Cooper.

- 2 obsidian blades, one core
- 450+ ceramics

128AR/10 0-20cm down from the southernmost DP of Block #6, which begins at the NE line of Block #1. We can see Jack Shima ahead, so we'll go another meter.

Found -

128AR/11 0-30cm down from the southernmost DP of Block #7, which begins at the NW line of Block #6 and the NE line of Block #2. We've found Jack Shima, which looks to still be in decent shape although instead of large stones on its surface, it's covered in small cobbles. The layers are still evident. Surface.

Found - 50+ ceramics

\* We'll continue NE to dry and find the corner

128AR/12 0-20cm down in Block #8 (from southernmost point), which measures 1m x 1m and begins at the NE line of Block #6. Surface. We can see bits of "Jack Shima", but we'll go one more meter to the NW. As with the other blocks along this SE line (#1, #6) we can see tumble on the block floor.

Found - 2+ pieces of bifurcated  
- 42+ ceramics

- 2 chips of obsidian

128AQ/128AR/128AK

SR#4

5/7/96

P96-95-104

128AQ/111 0-60cm down from the southernmost DP of Block #5, which measures 1m x 1m and begins at the NW line of Block #4. It's not as big as it looks, but Michael Cooper strikes-out as far as 60cm from the NE line as high up as the surface level. It's still very evident, and although we didn't find the corner, I feel it's close. Or I'm just hungry. Surface, some rubble.

Found - 175+ ceramics - 15+ bezique chunks  
- 4 Asotran blades/chips - 1 piece of chert - one shell

128AK/B1 0-40cm down from the northernmost Point of Block #24, which measures 1m x 1m and begins at the NW line of Block #22. Wall "Lenny Saheta" extends 40cm from the SW into the Block. It's very well preserved here, with some rather large stones (big as 43x37cm). Surface, some rubble.

Found - a corner of a masonry - couple pieces of bezique  
- 3 chips of Asotran - ~~one "pencil" stone~~ - 120+ ceramics

5/8/96

128AR/13 0-30cm down from the southernmost datum point of Block #9, which measures 1m x 1m and begins at the NE line of Block #7, and the NW line of Block #8. Jack Shana is still going, in the same fashion it has been, two pretty clean levels, although it seems it's getting less-well preserved as we go out. Perhaps we're close to the corner. Also a lack in ceramics.

Found - 7 ceramics

128AQ/12 60-90cm down from the southernmost DP of Block #5, which measures 1m x 1m and begins at the NW line of Block #4. Michael Cooper's 3 levels are still very evident and well-preserved. No corner yet. Some rubble.

Found - 12+ ceramics - 4 pieces of bezique  
- one rectangular-shaped clay piece, smoothed corners - possibly a re-used shard.

128AK, 128AR, 128AQ

STR#4 5/8/96

P96-95-105

5/8/96 - We're beginning a new sub-op, 128AW - which is on the SE side of the road trench 1 m from the SE line of Block #8. This is to begin uncovering the Southern corner of Str. #4.

128AW/01 0-30 cm down from the southernmost datum point of Block #1, which measures 1m x 1m and begins 1 m from the SE line of Block #8 of 128AK. We removed a large stone (46 cm x 46 cm) in this lot, but not much else. Surface.

Found - 9 ceramics - 1 obsidian blade

128AQ/13 0-30 cm down from the southernmost DP of Block #6, which measures 1m x 1m and begins at the NW line of Block #5. Michael Cooper is still there, extending as far as 40 cm into the Block from the NE line. I don't see a <sup>corner</sup> just yet unfortunately.

Found - one small square of basalt, can't tell whether it's a mirror or metal.  
- 2+ pieces of biquaque - 35+ ceramics

128AR/14 0-40 cm down from the southernmost pt. of Block #10, which measures 1m x 1m and begins at the NE line of Block #8. Surface. Not much, we'll go one meter to the NW.

Found - 25+ ceramics - one obsidian blade - one bone sherd, probably <sup>cow</sup> ~~cow~~

128AK/02 0-35 cm down from the northernmost DP of Block #25, which measures 1m x 1m and begins at the NW line of Block #24. Lenny Sakata is still visible, pretty well preserved, and extends into the block 45 cm from the SW.

Found - 70+ ceramics - 1 chunk of biquaque

12BAK, 12BAR, 12BQ, 12BAW

STR. #4

5/8/96

P96-95-106

12BAQ/14 | 30-60cm down from the southernmost AP of Block #6, which measures 1m x 1m and begins at the NW line of Block #5. Michael Cooper extends from the ~~NE~~ NE line as far as 47cm into the block. No corner yet.

Found - 40+ ceramics

12BAW/02 | 30-60cm down from the southernmost datum point of Block #1, which measures 1m x 1m and begins 1m from the SE line of Block #8 in 12BAK. We removed some rubble, and can see more. We're going one more meter ahead though.

Found - 3 obsidian blades - 1 biface, one chert - 20+ ceramics

12BAR/15 | 0-45cm down from the northernmost DP of Block #11, which measures 1m x 1m and begins at the NW line of #10 and the NE line of #9. We've come to the end of Jack Stone, although Ed believes the corner is about 60cm back, which is a good idea because this section doesn't look so good and the other lines-up with "Buckley Dent" in 12BAK. This section of rubble extends 18cm into the Block along the SW line for pretty-much the entire meter, rising 25cm above the floor.

Found 10+ ceramics

12BAW/03 | 0-20cm down from southernmost DP of Block #2, which measures 1m x 1m and begins at the NE line of Block #1 and 1m from the SE line of Block #10 of 12BAK. Surface. We can see more rubble.

Found - 20+ ceramics

5/9/96

12BAQ/15 | 0-50cm (Milton couldn't stop) down from the southernmost A.P. of Block #7, which measures 1m x 1m and begins at the NW line of Block #5. Michael Cooper extends as far as 50cm into the block from the <sup>N</sup>SE line, but a large section measuring 70 x 60cm seems to be missing (starting from the north corner). This could mean the corner is here, but there seems to be two flat stones along the NE line that are in line with the rest of Michael Cooper. It could be that this area just isn't well preserved.

Found - 45+ ceramics

- 20 pieces biface

- 1 blade of obsidian

128AR/16 20-50 cm down from the southernmost D.P. of Block #8, which measures  $1m \times 1m$  and begins on the NW line of Block #6. We've gone down to the base of "Jack Skema", and it looks as though only three layers are preserved here, although there might be more above - however, not well preserved. The eastern corner of the building is 13 cm from the NE line, on the north corner of the block. We'll remove the excess rubble around it.

Found - 110+ ceramics

128AK/83 0-35 cm down from the northernmost D.P. of Block #26, which measures  $1m \times 1m$  and begins at the NW line of Block #25, 2m from the NW line of Block #22. Lenny Sakata is still evident, running along the SW line, extending as far as 30 cm into the Block. Surface, some rubble.

Found - 3+ biface

- 40+ ceramics

- 1 St. of obsidian

128AQ/16 0-50 cm down from southernmost D.P. of Block #7, in a lot measuring  $50cm \times 100cm$  off the NW line of Block #7. This'll make Block #7 measure  $1.50m \times 1m$ . No more signs of "Michael Cooper". There's a large stone in the North corner, but I think it's rubble. There was a high concentration of biface for such a small space.

Found 30+ pieces of biface

- 25+ ceramics

128AR/17 30-70 cm down in a lot measuring  $90cm \times 75cm$  off the NE end of Jack Skema. ~~We removed rubble from the~~ We removed 40 cm worth of rubble, and can now see a nice corner - stone measuring  $30cm \times 33$ , with 2 more layers on top. This side isn't as pretty as the SE side, but you can still tell it's there.

Diagram:



11 - wall Jack Skema  
10 - lot 17

Found - 150+ ceramics

- 3 chips of obsidian

128AQ, 128AR, 128AK, 128AU STR #1 5/9/96

Pg 6 - 95-108

128AQ/17 0-30cm down from the southernmost D.P. of Block #8, which measures 1m x 1m and begins along the NE line of Block #7, beginning from #7's NW line. We can see lots of cobble, may all just be rubble. There's an ugly amount of bafareque, or I guess it could be burnt earth, but ~~the~~ the way it's popping up and the location makes me think it's bafareque. I hardly ever use the word "ugly". Surface.

Found - a lot of bafareque - 1 1/2 10x16cm bags full  
- 30+ ceramics

128AK/84 90-120cm down from the southernmost D.P. of Block #10, which measures 1m x 1m and begins 5m from the SW end of a trench crossing Str. #4 in a SW-NE manner. We simply excavated the area between wall "Rusty Shovel" and the block's SW line (60x100x800x1000cm). Rusty Shovel is 54cm tall now, and is constructed of mostly cobble (avg. 26x12cm) except for a large seemingly cut stone in the middle of the bottom (24x23cm). It seems to be made up of 3 layers, the first (top) row of the stones are laid vertically (↑), and the next two are laid horizontally (↔). Very nicely made, with all the flat faces out. Ground was pretty tough.

Found - 4+ pieces of bafareque - 30+ ceramics  
- 3 obsidian blades

128AQ/18 30-50cm down from the southernmost D.P. of Block #8, which measures 1m x 1m and begins along the NE line of Block #7, starting from #7's NW line. We see a lot of large stones but only a section 20x60cm in the southern corner and along the SE line could be seen as part of, or a continuation of Michael Cooper. The area built too well preserved unfortunately, for after that section, there is no more stone in the line of the "corner".

Found - 10+ pieces of bafareque

- 30+ ceramics

- 2 obsidian blades/chips

- another stone, might be chert but I don't think so

no more  
stones of  
Michael  
Cooper

128AR, 128AK, 128AW, 128AQ Str. #4 5/10/96

PSB-95-109

128AR/18 0-30cm down from the southernmost OP of Block #12, which measures 1m x 1m and begins at the NW line of Block #7 and the NE line of Block #3. We've found the second-level corner that lines up with "Lenny Schuster's" "Arts 61 more" (the wall that meets w/ Lenny) extends 40cm from the SW line at the W corner and extends 45cm from the NW line, to form the corner. There are two major corner stones, both visible with me (29 x 23cm) separated from the other (34 x 19cm - the base) by small cillas. Surface.

Found - 120+ ceramics

- 2 chunks of Ligneque - one black (?)

128AW/04 20-60cm down from the southernmost D.P. of Block #2, which measures 1m x 1m and begins at the NE line of Block #1, and 1m from the SE line of Block #10 of 128AK. We seemed to have found a line, (doesn't look to be well preserved, but some could be tumble) that lines up with Michael Cooper. The stones, from what we can see, are medium to large in size (avg. 22 x 17cm). We'll have to go down further in front of it and remove some rubble, but 2m out of workers right now.

Found 20+ ceramics

- 2 chunks of Ligneque

128AQ/19 0-30cm down in Block #9, which measures 1m x 1m and begins at the SW line of Block #3. Surface, nothing yet. We're going to track the wall that hits Michael Cooper perpendicularly along the SE line of Block #3.

Found - 1 piece Ligneque

- 15+ ceramics

128AQ/20 30-60cm down in Block #9, which begins at the SW line of Block #3. Lots of rubble. We can see some pretty huge stones in the floor, but I think they're all rubble. We're now at the level of the top of the wall we're chasing.

Found - 50+ ceramics

- one worked stone, with two man-made dents on each side



12BAR/191 0-30 cm down in Block #13, which measures  $1.5m \times 1.0 \times 1.6 \times 1.0m$  and begins at the SW line of Block #4, connecting 12BAR with 12BAK of Block #6. This Block contains "Arctos Gilmore" and a bit of Darryl Dawkins, for Darryl feeds into Arctos Gilmore a few centimeters in from the 30 cm mark on the NE line. Arctos seems to remain in pretty good shape through this block, extending as far as 70 cm in from the SE line. Surface

Found - 350+ ceramics (probably none) - 5 Assurban blades  
- 30+ chunks of lignite

12BAK/85 110-140 cm down from the southernmost D.P. of Block #16, which measures  $1m \times 1m$  and begins 9m from the SW end of the trench. We're digging for maybe an earlier structure relative to Rusty Skull. The ground is extremely tough.

Found - 10+ pieces of lignite - 40+ ceramics

12BAQ/21 60-80 cm down from the southernmost D.P. of Block #9, which measures  $1m \times 1m$  and begins at the SW line of Block #3. It looks as though the wall perpendicular to Michael Cooper (now known as "Norm Nixon") extends from the SE line 35 cm into the block for the entire meter. Only 2 layers can be seen now, we'll excavate a bit further. Tumble

Found - 70+ ceramics - 2 chert blades - 1 Assurban blade

5/3/96 12BAK/AG 140-160 cm down from the southernmost D.P. of Block #16, which measures  $1m \times 1m$  and begins 9m from the SW end of the trench (axial). Still digging for the remains of an earlier structure. Ground is incredibly tough.

Found - 5 ceramics - 1 bead - 1 shell.

128AK/87 160-180cm down from the southernmost DP of Block #16, which measures 1m x 1m and begins 9m from the SW end of the coral trench. Again the ground was pretty tough. We found more corals this time, one of which was quite elaborately pitted. No stones or anything though.

Found - 6+ pieces of Sapiroque

- 10+ corals

128AQ/22 0-20cm down from the southernmost DP of Block #10, which measures 1m x 1m and begins at the SW line of Block #9. Surface, some rubble. We're still chasing Norm Nixon to the SW.

Found - 20 corals

128AR/20 0-40cm down on Block #18<sup>4</sup>, which measures 1m x 1m and begins at the NW line of Block #5. I know it's a large block, but remember we're on a hill, ~~so~~ so it isn't that large all the way around. We're following Daryl Sawkins to the NW, and it looks as though it might flow into "Leaving Salento". We'll go deeper.

Found - 300+ corals

- 30+ Sapiroque

- a carbon sample

- 9 Asotran chips/blades

- one chest blade

around 25cm down from the DP

128AW/05 0-20cm down from the southernmost DP of Block #3, which measures 1m x 1m and begins at the SE line of Block #2. We're following the line to the SE, to see if it is better preserved, and if it is a continuation of "Michael Cooper". Once we hit a better-preserved spot, we'll go down on south of it. Surface.

Found - 40+ corals

3+ pieces of Sapiroque

128AK, AR, AU, AQ STR#4 5/13/96

P96-95-112

128AK/88 180-200cm down from the southernmost point of Block #16 which measures 1m x 1m (although this lot, due to the toughness of the ground and a gradual slant on all the ~~sides~~ sides, measures a mere 60x74cm) and begins 9m from the SW end of the axial trench. Still no sign of any stones. Ground is still tough.

Found - 10+ ceramics - 3 pieces of S. pyroque  
- a bit of carbon, not enough for a sample at 198cm down

128AR/21 40-70cm down from the southernmost DP of Block #14, which measures 1m x 1m and begins at the NW line of Block #5. We can now see that Darryl Dawkins literally feeds into the backside of the upper-part of "Larry 'Sakata'". We're going to go to the base of "Darryl Dawkins". The ground was a bit hard.

Found - 200+ ceramics - 5+ pieces of S. pyroque  
- 2 pieces of bone from a small animal. - one wooden chip

128AK/89 200-220cm down from the southernmost DP of Block #16, which measures 1m x 1m (but see 128AK/88) and begins 9m from the SW end of the axial trench. The ground is still tough, but since we hit sterile soil, I think we'll stop. We're about at the level, if not deeper than "Rusty Stairs". Found - nada, but a soil sample was taken at 210cm.

128AQ/23 20-60cm down from the southernmost DP of Block #10, which measures 1m x 1m and begins at the SW line of Block #9. Norm Nixon continues, but is not as well preserved, for the top begins at about 55cm down. It extends as far as 50cm into the Block from <sup>along</sup> the SE line. 2 large stones (42x39cm and 38x20cm) make up this pavilion's visible top.

Found - 70+ ceramics - 2 large sherds

128AR, 128AK, 128AQ, 128AW STR #4 5/13/96

PS6-95-113

128AR/22 70-105cm down from southernmost DP of Block #1B, which measures 1m x 1m and begins at the NW line of Block #5. There are 6 weak, but visible layers of "Darryl Dawkins" / "Lenny Schemm". We're going down on the interior of where these two meet. It (the wall) looks to be made ~~so~~ solely of cobble, ranging from 20x24cm to 7x6cm. The ground seems to be rough stone, and has a large content of Lapareque (we can still see a large chunk on the floor). The wall continues going down, but is as high as 106cm from this point.

Found - 5 shells - one chert blade - 150+ ceramics  
- 15+ pieces of Lapareque - sizeable chunks.  
- Soil Sample taken 90 cm down

5/13/96

128AW/06 2050 cm down from the southernmost pt of Block #3, which measures 1m x 1m and begins at the SE line of Block #2. We can still see the line that may be "Michael Cooper", but it seems an animal has made its home underneath, pretty much destroying its preservation. There isn't any soil underneath, which causes most of the good-sized stones to come out of place, or just fall out. The line is there though, extending as far as 50cm into the Block ~~area~~ running along the NE side. Tumble

Found - one Asadran chip - 34 pieces of Lapareque  
- 100+ ceramics

128AQ/24 60-80cm down from the southernmost DP of Block #10, which measures 1m x 1m and begins at the SW line of Block #9. Norm Norm seems to end out at the end of this block (SW line). We're at its base, and can see that it's constructed of small-medium (avg 17x4cm) cobbles, with large cobbles (avg. 35x26cm) on top. The layers are unclear, but the flat faces seem to be facing out.

Found - 2 Asadran chips - one chert blade.  
- 20+ ceramics

128AK/90 0-20cm down from the northernmost pt of Block #27, which measures 1m x 1m and begins at the NE line of #23 and the SW line of #24. We can see the top of ~~Artes 61 more~~ <sup>Lenny Sakata</sup> top level (although I wouldn't be surprised if that top level wasn't a separate wall built atop ~~Artes 61 more~~ <sup>Lenny Sakata</sup> lower surface). It looks as though we're coming down on a curved row of stones again, which is quite nice. We'll go down further. Surface, a bit of rubble.

Found - 180+ ceramics - one nice figure face  
- 5+ pieces of lapidary - one chert blade

128AN/24 0-20cm down from the southernmost SP of Block #9, which measures 1m x 1m and begins at the SW line of Block #6. We're following the top level of Artes 61 more, and I think we may have a corner hitting Artes (which extends 35cm into the Block along the SE line) at the southern corner, then runs up the SW line, extending as far as 40cm into the trench. We'll go down deep in the 65x60cm square formed by these two possible walls. Surface.

Found - 300+ ceramics - 30+ lapidary pieces

128AW/07 0-20cm down from southernmost D.P. of Block #4, which measures 1m x 1m and begins at the SE line of Block #3. We can see some large stones that are kind of close to the surface, that seem to be in line with the wall we're following. We'll keep them there and go further.

Found - 50+ ceramics - 2 pieces of lapidary

128AW/08 0-20cm down from the southernmost DP of Block #5, which begins 1.5m from the SE line of Block #4. We're looking for the corner of Michael Cooper & Jack Shima. Nothing yet except for a few stones in the north corner.

Found - 1 Asdman blade - 100+ ceramics

128AK/91 20-40cm down in Block #27, which measures 1m x 1m and begins at the NW line of #23 and the SW line of #24. The top layer of "Lenny Schute" extends as far as 60cm n to the block from the NE line. The possible curved wall was apparently false. We did find an incredibly huge stone 67 x 22+cm at around 25cm down. It's 17cm to the SW of "Lenny". There's nothing else around it.

Found - 5+ pieces of Sargarene  
- 2 Asdran blades

- 120+ ceramics  
- Carbon, but no large chunks for a sample

128AW/09 20-40cm down from the DP of Block #4 <sup>which</sup> ~~begins~~ begins at the SE line of Block #3. We can still see, though pretty sketchy, a line along the NE line extending 45cm into the trench. We'll go down in front of it.

Found - 50+ ceramics

128AW/10 20-40cm down in Block #5, which measures 1m x 1m, beginning 1.5m from the SE line of Block #4. We still see stones in the north corner, no real clear lines though. It's quite possible that the corner is a bit more to the NW, or that is it and it isn't well preserved.

Found - 3+ pieces of Sargarene

- 50+ ceramics

128AN/25 <sup>20</sup> ~~40~~-60cm down in Block #9 <sup>9</sup> ~~23~~ which measures 1m x 1m and begins at the ~~SW~~ SW line of Block #6. The lot actually measures a rough 55 x 40cm because of the rounded corner. It's quite beautiful actually, made-up of medium to large stones (avg. 22 x 27). There seems to be five layers, much like the construction of Arbs in the areas before.

Found - 20+ pieces of Sargarene  
- 1 Asdran blade

- 120+ ceramics  
- 1 shell

128AK/92 0-20cm down from the northernmost DP of Block #28, which measures 1m x 1m and begins at the NW line of #27 and the SW line of #25. We're still running along the backside of Lenny Sakata. We can see the top layer of "tumble" that covers the summit. Lenny extends about 40cm in from along the NE line. Other than that, not much here.

Finds - 200+ ceramics - 20+ pieces of Soga ware

5/16/96

128AW/11 40-60cm down in Block #4 (from southernmost stake), which measures 1m x 1m and begins at the SE line of Block #3. We have a definite wall running along the NE line, extending as far as 45cm. We can see 3 layers of medium to large cobble, (avg. 20x23cm) but I don't think were at the bottom. Tumble

Finds - 2 pieces of Soga ware - 10+ ceramics

128AW/12 40-70cm down in Block #5, which measures 1m x 1m and begins 1.5m from the SE line of Block #4. We've discovered what looks to be a wall along the NW line, extending as far as 50cm into the block. I can't really tell if there are any layers underneath, it doesn't seem to be too well preserved. 3 prominent stones in a line make-up the top (avg. 33x20cm). I can't tell if this might be a corner, or another wall like the Norm Nixon.

Finds - 30+ ceramics

128AK/93 0-20cm down from northernmost DP of Block #29, which measures 1m x 1m and begins at the NW line of Block #28 and the SW line of #26. We can faintly see "Lenny" wall anymore. It seems the wall maybe dying out as we get close to the road. Surface

Finds - 200+ ceramics 15+ pieces of Soga ware - 1 Bostan Slide

128AN, 128AK, 128AR, 128AQ, 128AW STR<sup>4</sup> 5/15/96

196-95-117

128AN/26 | ~~100~~<sup>150</sup> cm down from the southernmost DP of Block #6, in a lot measuring 40x100cm behind Ards Gltone. Were simply looking for its base.

Find - 20+ ceramics, some nicely pitted - 5+ pieces of b-jarique

128AK/54 | 20-40cm down from the northernmost DP of Block #29, which measures 1m x 1m and begins at the ~~SW~~<sup>NE</sup> line of #28 and the SW line of #26. Leaky continues to run along the NE line, extending as far as 60cm into the block. No corner yet. Seems Leaky gets wider at the bottom.

Find - 50+ ceramics - 5+ pieces of b-jarique - one obsidian chip

128AW/13 | 60-110cm down from the southernmost stake of Block #4, in a lot measuring 1.5m x 60cm beginning at the SE line of Block #4 and running along the SW line into Block #3. We've found the base of this portion of "Michael Cooper", and it looks to be constructed of seemingly 4 layers, with cobbles ranging from 32x21cm to 9x3cm. It looks to be as high as 75cm, although could stand higher. Angle =  $126^{\circ}/306^{\circ}$

Find - 100+ ceramics

128AN/27 | ~~100~~<sup>150</sup> cm down from the southernmost DP of Block #6, in a lot measuring 40x100cm behind Ards Gltone. We've found the base of Ards, making it roughly 116cm high, although it's higher in other places. There are 8 (maybe 9) layers of medium-sized stone (avg. 20x13) with smaller cobbles (8x5cm avg.) mixed in. Not too much attention to the flat faces. Kind of reminds me of "Ralph Wiggan" on Str. #3.

Find - 2 ceramics - 2 chunks of b-jarique

128AW/14 | 0-40cm down in Block #6, which measures 1.5x1m and begins in between #4 + #5. Lots of rubble, but we can make out Michael Cooper along the NE line. We'll have to go deeper to see if the corner is actually in Block #5.

Find - 175+ ceramics - 5+ pieces of b-jarique



12BAK/95/ 0-20 cm down from near from southernmost DP in Block #30, which begins at the NW line of Block #29. We can't see much of anything yet, we're right on the edge of where the road cut into the hill, so I'm not so sure we will find much at all. Surface.

Found - 200+ ceramics - 10+ pieces of bafareque

12BAQ/25/ 90-100 cm down in Block #5 in a lot measuring 1m x 45 cm in front of Michael Cooper. This was solely to find the base of the wall, which evidently we'd found already, for there isn't anymore stones after the one's excavated last.

Found - 1 chunk of bafareque - 25+ ceramics

12BAK/96/ 20-~~100~~ cm down from the southernmost DP in Block #30 which begins at the NW line of Block #29. Lenny's been demolished, but it still runs along the NE line, extending as far as 50 cm into the Block. The higher level of Lenny seems to have been destroyed, only it's underside remains. No corner, and thanks to the bulldozers, we won't find one. We're at the edge of the road-cut and can go no further, nor do we have time to.

Found - 125+ ceramics - 10+ pieces of bafareque - 1 Assiran blade

12BAW/15/ 40-90 cm down in Block #6, which measures 1.5 x 1 m and is located in between blocks #5 + #4. This wall isn't very well preserved, at least the top part isn't. There's lots of tumble in front of and around it, so it was a mighty tall wall at one time. It extends 40 cm in along the NE line. As for the corner, we also removed a block of newly pronounced tumble measuring 80 x 50 cm along the NW line of Block #5, beginning at the SW line. There still isn't a real clear corner, but we can assume it's somewhere around the NW line of Block #5.

Found - 200+ ceramics - some quite large - 10+ pieces of bafareque - 7 Assiran blades

## FINAL NOTES

FOR STR #4, SITE 128

5/20/96  
#95

- Datum points -
- #1 - main datum point from the highest elevation of the mound
  - #2 - located 105cm down from the main datum, in the southern portion of the structure.
  - #3 - located 142cm down from the main datum, in the western portion of the structure.
  - #4 - located 113cm down from the main datum, in the northern portion of the structure.

Feature - Rusty Staub

Height - 51cm

Length - 94cm exposed

Depth - (from #3) top - 106cm; bottom - 157cm

Width - 41cm

Orientation - 308°/128°

Construction Type - Constructed of cobble ranging in size from 36x23cm to 4x4. The surface layer is made-up medium to large stones (avg. 30x15cm) laid in a vertical fashion. Under this top layer are 2 layers of cobble (avg. 25x17cm) resting horizontally. It looks as though special attention has been paid to the flat faces, for they are all nicely facing the SW (out). Small cobbles seem to have been used to fill the spaces between the larger stones.

Adjoining features - none.

Comments - looks to be a basal wall to an earlier structure. Nicely preserved and constructed. Rather confusing, for if it was an earlier feature, it most likely would've been taller - yet there is very little tumble around it. This might suggest that the builders of the later structure took it apart and possibly re-used the stones. We did not find anything else in the excavation that could be apart of the same structure containing "Rusty Staub".

Feature - Michael Cooper

Height - 94cm

Depth - (from #3) top - 53cm; bottom - 147cm

Orientation -  $316^{\circ}/136^{\circ}$

Length - (West portion) - 456cm exposed

(South portion) - 467cm exposed

Width - (West portion) - 103cm

(South portion) - 58cm exposed

Construction Type - Of the two exposed portions, the western portion is the much better preserved, showing 3 distinct levels: the 3rd (base) level extends out 11cm from the 2nd level; the 2nd level rises 27cm above the base and extends 31cm from the 1st level; and the 1st rises 29cm above the 2nd level. With all these levels, this portion is constructed of 5 layers of all different cobble. The top level is constructed of cobble medium in size (avg.  $24 \times 25$ ) in no real distinct direction, for most of the flat stones are either close to square-shaped or are not consistent. The 4 under-layers are of cobble (avg.  $27 \times 9$ ) laid seemingly horizontally. Small cobble seems to have been used to fill-in spaces, as well as for rows. The flat faces nicely face the SW (out) and the stones in the entire wall (this portion) ranges from  $50 \times 24$ cm to  $4 \times 1$ cm. The south portion of the wall is rather poorly preserved, making it difficult to find the definite top layer. The wall seems to be made-up of cobble ranging from  $40 \times 15$ cm to  $4 \times 3$ cm, in 4 or 5 layers (preserved). The top "layer" is constructed of medium cobble (avg.  $21 \times 17$ ) laid in the fashion of the western portion, inconsistently. The bottom layers are of medium-sized (avg.  $24 \times 15$ cm), horizontally-laid cobble. The final base layer is a row of small cobble, differing from the western portion, which is of medium-sized stones. Flat faces are to the SW (out) in the best-preserved spots, and small cobble was used to fill-in the spaces between the larger stones.

Adjoining features - In the southern portion, Michael Cooper meets with Jack Sukma to form the southern basal corner of the structure. It looks as though they intertwine, although excavation was limited due to time. Norm Nixon hits Michael perpendicularly 456cm from the west corner. It is not obvious as to whether Norm and Michael intertwine, but it can be safely guessed that Norm's connection is built on top of some of the levels of

## Michael Cooper cont'd

Michael Cooper. The west "corner" of Michael Cooper actually doesn't corner with anything. The road cut running along the NW line of the structure has demolished any sort of evidence that a structure extended that far. It's possible that Michael simply ends there, as sort of a flank for a possible entrance.

Comments - Michael Cooper is the SW basal wall, providing us with the SW length of Str. #4 at roughly 927cm. This wall most definitely was taller, judging from all the tumble. In the southern portion, the top has a 9cm slant over the mid-wall. The two portions are split by "Rusty Staub", which is rather odd, for there is no real other evidence of Michael Cooper in the trench walls around Rusty. This may suggest a possible entrance on the SW side of the structure. As far as preservation, the only trouble in the western portion was a tree growing around and through the wall, and the southern portion an animal had burrowed it's way through the wall lengthwise, destroying the supporting soil and thus knocking many of the stones out of place.

Feature - Jack Sikma

Height - 131cm

Length - 378cm exposed

Depth - (From #2) top - 56cm; bottom - 187cm

Width - 76cm

Orientation -  $40^{\circ}/220^{\circ}$

Construction Type

This wall is constructed of cobble ranging in size from 7x6cm to 38x31cm in seemingly 9 layers. The top is of medium-large stones (avg. 30x12cm) laid vertically. The next 4 layers are of large stones with small cobbles mixed-in (avg. 13x23cm) all laid horizontally. The last 4 layers extend from those above 15cm, and is constructed of the same type of cobble. The direction seems to be the same as well, except for the 1<sup>st</sup> layer of this final section, which seems to be laid vertically. The last, base-layer of the wall is of small cobble, similar to walls "Bucky Dent" and "Michael Cooper". Flat faces face the SE (out) quite nicely.

Adjoining Features - Jack Sikma joins and seemingly intertunes with Michael Cooper in the southern corner of the basal section of the structure.

## Jack Sikma cont'd

- Jack also connects to basal wall "Bucky Dent" in the eastern corner of the structure, intertwining rather nicely on a cornerstone of  $34 \times 37 \times 12$  cm. Jack is separated from wall Lenny Sakata by 70 cm of fill.

Comments - Jack Sikma is the SE basal wall of the structure, providing the SE length of the building at 9.8 m roughly. This wall was most likely higher, judging from the tumble before it and the layer of small atop it when first uncovered. The only evidence of a possible renovation lies in the base section of the wall, but I don't believe it was. The top has an 18 cm over the mid-wall. Overall, the middle of this wall (that found by trench 128AW) is very well preserved, with it diminishing ever so slightly as one goes toward the east corner.

## Feature - Bucky Dent

Height - 101 cm

Length - 210 cm exposed

Depth - (from #4) top - 76 cm, bottom - 177 cm

Width - 87 cm

Orientation - 316°/136°

Construction Type - This wall is constructed of cobble ranging in size from  $4 \times 4$  cm to  $38 \times 19$  cm, made-up of seemingly 9 layers. The surface level is made-up of medium-large cobble (avg.  $29 \times 19$ ) laid vertically, followed by 4 layers of the same type of stones (avg.  $8 \times 20$  cm) with small cobble seemingly filling-in the spaces between these stones, yet these layers run horizontally rather than vertically. The last four layers make-up the base section, which protrudes from the mid-wall 17 cm. The construction of this section is consistent with the layers above it, with one exception: The first layer of this section seems to be laid vertically. Like basal walls "Michael Cooper" and "Jack Sikma", the last layer of Bucky Dent consists of a row of small cobble. Flat faces seem to look to the NE (out).

Adjoining Features - "Bucky Dent" connects and intertwines with, Jack Sikma in the east corner of the structure, on a cornerstone measuring  $34 \times 37 \times 12$  cm. Due to the road-cut, we are unsure of Bucky's (and the structure's) northern corner. It can only be assumed that it resembled feature "Michael Cooper." Time forbade us from excavating into the road-cut to see if there were any remains. Separated from "Lenny Sakata" by 48 cm of fill.

## Bucky Dent cont'd

Comments - Bucky Dent is the NE basal wall of Str. #4, and can only be assumed to be as long as "Michael Cooper" on the opposite side, due to the road-cut on the NW line of the structure. Was most likely larger, judging by the amount of rubble surrounding it. The only possible evidence for renovation occurs in the base section, with it's extension, but I really don't think so. Overall, the wall (what is exposed) is rather well preserved. The top has a 19cm slant over the mid-wall.

Feature - Lenny Sakata

Height - 122 cm exposed

Length - 896 cm exposed

Depth - (from #1) top-65cm; bottom-187cm

Width - 122.5 cm (avg.)

Orientation - 312°/142°

Construction Type - This wall is constructed of cobble ranging in size from 5x4 cm to 56x34 cm, forming 2 major levels: the 2<sup>nd</sup> level rising roughly 40cm above the 1<sup>st</sup> (base) — although the top of the base level isn't too clear. The base section seems to be made-up of 5 layers, with the top consisting of medium to large stones (avg. 27x22cm) laid seemingly vertically, although it is again difficult to tell. The bottom 4 layers are rather well preserved, constructed of medium to large stones laid seemingly horizontally with small cobbles filling-in the spaces (avg. 23x14cm). The second level's front side (to the NE) is unpreserved, so it's back side will be described. 9 layers of the backside are exposed, consisting of cobble medium to large in size — much like the base section. It is difficult to tell, but looks like small cobble was used as fill in this portion. Flat faces on the backside aren't too consistent — doesn't look as though much attention has been paid to them, compared to the flat faces of the base section, which all nicely face the NE (out).

Adjoining Features - Lenny Sakata's joining with Art's Gilmore occurs in two places: one in the second-level east corner of Str. #4, and the other through Darryl Dawkins in the curved eastern corner of the summit. At the right-angled corner, Lenny and Art's connect and intermingle nicely, with no prominent cornerstone. Darryl Dawkins wall stems from Lenny's supposed 2<sup>nd</sup> level, curves around, and flows into the top level of

## Lenny Sakata cont'd

- Antros Gilmore. Overall, it can be said that the base levels of Lenny Sakata and Antros Gilmore join at the right-angled corner and the upper-levels connect with the help of "Darryl Dawkins".

Lenny Sakata is separated from Bucky Dent by 48cm of fill.

Comments - Lenny Sakata is the NE summit wall, and unfortunately can only provide us with an assumption of one of the dimensions of the summit. Although we ran into the road-cut in our quest for the north corner of the summit, judging by the stones left by the cut it can be assumed that the summit's NE length was around 9m.

The wall itself could be one of two things: a two-leveled wall or a wall, very large in size, that has had a substantial chunk taken off its top face. Because it correlates with the SE summit wall "Antros Gilmore", and with the eastern right-angled corner as well as "Darryl Dawkins", I support the first notion. As the wall runs toward the NW, it gets wider, going from 109cm wide to 136cm wide. This could be intentional, or due to poor preservation caused by a nearby tree. It seems rather odd for it to be intentional. Aside from possibly the second level of the wall, there isn't much evidence supporting a renovation of this wall.

Feature - Antros Gilmore

Height - 122cm

Length - 518cm

Depth - (From #1) top 87cm; (From #2) bottom 105cm

Width - 114cm

Orientation - 44°/224°

Construction Type - The construction of Antros Gilmore is much like that of Lenny Sakata, with cobble ranging in size 6x3 to 47x33 making up 2 levels, or one rather unpreserved wall. For the sake of description I'll go with the 2 level theory. The 1<sup>st</sup> level (base) is constructed of 4 layers, with the surface consisting of medium to large cobble (avg. 27x19cm) laid in a vertical fashion. The next 3 layers are of medium-large cobble as well (avg. 19x13cm), but it is more difficult to tell the direction they are laid, for it is inconsistent. The second level's front face is difficult to make out due to poor preservation, but the backside was uncovered,

### Artes Gilmore cont'd

yielding 10 present, but faint and confusing, layers of medium cobble much like the mid-wall of level #1, with some small cobble filling present. The size of the cobbles are consistent throughout the wall, top to bottom. Seemingly not as much attention paid to the flat faces of the backside when compared to the front of level #1, where they face the SE (out).

Adjoining Features - Artes Gilmore connects and intertwines with wall "Chet Lemon" on the southern corner of the summit. The first level of Artes joins with the first level of Henry Sakata in the eastern corner, intertwining forming a nice right angle. The second level is joined to Henry through wall Darryl Dawkins, which stems from Artes' top layer/level, curves around on top of the right-angled corner, and flows back into Henry Sakata. This gives the eastern corner of the summit a rounded look. Artes is separated from Jack Salma by 70cm of F.II.

Comments - Artes Gilmore is the SE summit wall, providing the summit's SW-NE length measurement of approx. 518cm. Like Henry Sakata, Artes Gilmore could either be a two-leveled wall or a single, large wall with the top rather unpreserved. I'd support the first notion, looking at the two separate connections with Henry Sakata in the eastern corner.

Feature - Chet Lemon

Height - 61cm exposed

Length - 56cm exposed

Depth - (from #1) top-116cm; bottom-177cm

Width - 46cm exposed

Orientation - 320°/140°

Construction Type - Only the backside (interior) of Chet Lemon is uncovered, and from this, Chet seems to be constructed of 4 to 5 layers of cobble ranging in size from 7x3cm to 30x37cm. The surface is constructed of medium to large stones (avg. 23x26cm) in no real consistent direction. The other 4 layers consist of medium-sized cobble (avg. 21x10cm) laid seemingly horizontally with small cobbles filling in the small spaces. It's difficult to tell whether attention was given to the flat faces because of the small section exposed, and they are rather inconsistent in that section. I would guess little attention was paid, judging from the two other summit walls.



## Chet Lemon cont'd

Adjoining Features - Chet Lemon joins and intertunes with Antis Gilmore at the southern corner of the summit. Time did not allow us to excavate and find the state of Chet's NW end.

Comments - Very little of this wall was exposed. It is however, the SW summit wall and can be assumed to be comparable in length to Lenny Sakata. We can assume that the wall was taller, even though not much tumble was found in back of it. Much of the analysis of this wall must be made through comparisons to the other summit walls. If excavation was able to continue, I'd suggest following this wall.

Feature - Darryl Dawkins

Height - 33cm

Length - approx. 175cm

Depth - (6cm #1) top - 109cm; bottom - 142cm

Width - 34cm

Orientation - 354°/174° (curved)

Construction Type - This wall is constructed of medium-sized cobble ranging in size from 3x3cm to 28x17cm, forming roughly 8 layers however so faint. The surface level consists of cobble averaging 23x17cm laid in a vertical fashion for the most part. The rest of the wall is made-up of stones averaging 17x8cm in size, seemingly laid horizontally, with small cobble used as fill. It looks as though some attention was paid to the flat faces in the interior, but not the exterior, although neither is well preserved/exposed.

Adjoining Features - Darryl Dawkins connects and combines with Lenny Sakata at its north end and does the same with Antis Gilmore at Darryl's south end, forming a rounded corner in the eastern section of the summit. Darryl Dawkins connects the 2nd levels of these two features and rises above the right-angled corner made by the joining of the two 1st levels.

Comments - Darryl Dawkins gives the summit a rounded eastern corner, very odd when compared to all the other connections of the structure. Could've been taller, judging from the tumble around it. When comparing the two different corners, Darryl Dawkins and the right corner, it suggests that Lenny Sakata

Darryl Dawkins cont'd

- and Anders Gilmore are 2 level walls.

Feature - Norm Nixon

Height - 41 cm

Length - 261 cm

Depth - (from #3) top - 121 cm; bottom - 162 cm

Width - 43 cm exposed

Orientation -  $49^{\circ}/229^{\circ}$

Construction Type - This wall is oddly constructed, with cobble ranging in size from  $4 \times 2$  cm to  $42 \times 47$  cm set in no real clear levels. The surface stones averaged  $33 \times 26$  cm in size and were laid vertically for the most part, though difficult to tell. Underneath these large stones are small, flat cobbles mixed with a few medium sized stones (avg.  $17 \times 8$  cm), all laid horizontally. There is a section 46 cm long by roughly 43 cm wide in between Michael Cooper and Norm (although it can be seen in the trench wall that the two do connect) that either was unpreserved or intentionally left out. It looks as though it was purposely done. The flat faces face the NW (out) quite nicely.

Adjoining Features - Norm Nixon hits Michael Cooper perpendicularly 456 cm in from Michael's NW end. The connection lies in the trench wall, making it difficult to tell if the two actually intermingle. It looks as though some of Norm's stones rest atop some of the levels of Michael, but no stones are clearly used in both walls.

Comments - This is a flank-wall off the SW side of structure #4, possibly suggesting a SW entrance. Judging by the tumble surrounding the wall and the stones still present in the trench wall, this wall could've stood around 80 cm high at one time. The use of large stones atop rather small stones is very odd when compared to the other features of the structure. The wall seems to be pretty well preserved with the exception of the SW end, which has the large stones slanting-off with little underneath.

## FINAL NOTES

For Str. #3, Site 128

3/28/96

#95

- Datum points -
- #1 - main datum point from highest elevation of the mound
  - #2 - 90.5cm down from main datum
  - #3 - 124cm down from #1 (main datum)

Feature - Chief Wiggam

Height - 10cm

Length - 58cm exposed from SW wall of trench

Depth - 182cm from #2

Width - 43cm

Orientation -  $34^{\circ}/210^{\circ}$

Construction Type - made-up of small to medium-sized cobble ranging from  $21 \times 12$ cm to  $8 \times 10$ cm. These stones seem to be simply laid on soil to form a weak wall. The stones are laid at a  $100^{\circ}/280^{\circ}$  angle for the most part, with the flat faces pointing up (the stones are laid flat).

Adjoining Features - None, roughly 52cm NW from Milhouse

Comments - The first feature found, could belong to another structure to the NW of Str. 3. It was badly damaged when my trench was trashed by locals, with 3+ stones taken from the wall.

Feature - Milhouse - 2 parts: Left (from NE line of trench) + Right (from SW line)

Height - L - 32cm; R - 9cm Length - L - 23cm; R - 24cm

Depth - L: 142cm from #2; R: 147cm from #2 Width - L: 49cm; R: 43cm

Orientation - approx  $38^{\circ}/216^{\circ}$

Construction Type - This is most likely a step, very poorly preserved. The front part of the step (most visible) is preserved by only 2 pieces, with a gap in the middle. From these parts, it looks as though the feature consisted of 2 rows of large, flat cobble laid the same direction as the angle of the step, ranging in width from 20cm to 43cm (lengths were not available because the stones are still embedded in the trench wall). The flat faces are facing up, not out.

Adjoining Features - Although hard to tell due to poor preservation, Milhouse most likely runs 70cm back SE to form the base of the next level, Apu.

## \* Mithouse cont'd

Comments - Very poorly preserved, the large gap in the center makes it even harder to analyze. Width was of the large, beginning stones, for they are the only real evidence that Mithouse is a step or terrace. It's most likely a step, for by looking at the rest of the structure, I don't know how else these people got into their home. Due to time, only a meter of the proposed step could be exposed within the trench.

### Feature - Apu

Height - 52 cm from surface of Mithouse

Length - 100 cm exposed

Depth - 102 cm from datum #2

Width - 79 cm (best preserved part)

Orientation -  $40^\circ/220^\circ$

Construction Type - Consists of seemingly 6 layers of cobble, most of which is stacked in the direction of  $128^\circ/308^\circ$ , and ranges in size from  $32 \times 20$  cm to  $9 \times 5$  cm, with the larger stones in a line on top, followed by rows of smaller cobble and an occasional medium to large stone mixed-in as it goes down. Although not too constant, the flat faces of most of the smaller cobble and some of the medium cobble are out (facing the NW). Along the base of the step, where it meets with Mithouse, there is a row of medium to large stones.

Adjoining Features - Apu seems to be built on top of Mithouse, although it is not totally clear. Some of Apu's stones rest on top Mithouse's, but not enough to make it real evident that Apu was built after Mithouse. Like Mithouse, Apu runs back 198 cm to become the base for Moe, the next level.

Comments - Like most of the constructions on this NW side of Str. 3, Apu is poorly preserved. The above width was taken from the best preserved part, that being the front of the step. Like Mithouse, the surface of Apu is uneven and can only be assumed to have been flat. It can also be safely assumed that Apu was a later construction than Mithouse, however, Apu is the first clear level in Str. #3, when compared to the condition of Mithouse. Apu was also badly damaged when the NW side of the axial trench was crashed by locals.

Feature - Moe - 2 portions: Vertical + Horizontal

Horizontal

Height - 47cm from surface of Apu

Length - 70cm exposed

Width - 75cm

Depth - 127cm from #1

Orientation -  $42^{\circ}/222^{\circ}$

Vertical

Height - 38cm from level Moe

Length - 137cm

Width - 28cm exposed

Depth - 85cm from #1

Orientation -  $318^{\circ}/138^{\circ}$

Construction Type - Moe has a horizontal level built upon Apu, made-up of large (avg.  $19 \times 28$ ) and medium (avg.  $19 \times 9$ ) stones, with the larger toward the edge pointing the same direction as the edge of the level. The underneath portion is made-up of medium stone in a probable 4-layer construction. There doesn't seem to be much attention paid to the flat faces.

The vertical portion is made-up of 3 squarely-shaped stones (avg.  $20 \times 23$ ) mixed with small cobble (avg.  $10 \times 5$ cm) to form a type of ramp-like construction to the next level and perhaps a bit over that. Rock flat faces are carefully faced up and to the NE. Very nicely made, looks as though this construction was built on top of the Moe-level. Approximately 4 layers of cobble make-up the construction, with one large stone being apart of 3 layers (measures  $18 \times 25$ cm).

Adjoining Features - Moe level is built atop the Apu level, and hits-but is not the base for-the Barney level. Vertical Moe is built atop Moe level and hits the Barney level and possibly goes on top of it, but doesn't intertwine.

Comments - The vertical portion of Moe makes this construction very confusing. The level was probably one in a series of steps leading to the summit. The vertical portion however could've been some sort of ramp-like construction to aid the transportation of large objects to the summit, or better, a sort of wall extending to the SW to limit/outline the access to the main entrance. If the second theory be true, then a construction much like the Vertical Moe must extend to the NE. As far as additions go, vertical Moe is the best candidate, for it intertwines with no other construction and is built atop the Moe level. The Moe level can be assumed to be later than both consider Barney and Apu.

Feature - Barney

Height - 43cm from the surface of Moe

Length - 100cm exposed

Width - 70cm

Depth - 85cm from #1

Orientation -  $66^{\circ}/246^{\circ}$

Construction Types - Barney is the last step in the succession up to wall Homer at the summit. The ~~surface~~ <sup>surface</sup> is made-up of medium (avg.  $20 \times 12$ cm) to large (avg.  $20 \times 25$ cm) stones with the larger toward the edge, pointing the same direction as the level. The top is somewhat flat. Underneath the large edge stones, there is a layer of thin flat cobble ( $9 \times 4$ cm avg.), then larger flat cobble (avg.  $9 \times 23$ cm). The next 3 layers are small cobble (avg.  $8.5$ cm  $\times$  6cm) nicely placed in rows. The last layer visible is of medium to large stones in a row. Flat faces are carefully facing out (NW).

Adjoining Features - Moe hits, but doesn't interlock with, Barney - although a part of Vertical Moe rests on Barney's surface. Barney hits summit wall Homer, but does not form Homer's base, nor is it intertumed with Homer.

Comments - Barney was most likely built next to Homer, as the last step in the grand stairs to the summit of Str. #3. Barney's base is most likely Apu, since Moe is not. This makes Barney younger than Homer and Apu, yet older than Moe. There are no additions evident. Was tampered with, but not really severely damaged when locals trenched the NW side of the axial trench.

Feature - Homer

Height - 43cm from the surface of Barney

Length - 643cm

Width - 48cm

Depth - 30cm from #1

Orientation -  $56^{\circ}/236^{\circ}$

Construction Type - Homer is the NW summit wall and consists of small to moderately large cobble (avg.  $18 \times 24$ cm). It is constructed of 6 layers, though unclear, with the longer stones set at a  $330^{\circ}/150^{\circ}$  angle. The flat faces seem to face the SW for the most part, yet only 100cm of the NW side is exposed. Homer runs 53cm past "Lionel Hutz" on the SW end, and 100cm is missing due to a looter's hole at the NE end.

Adjoining Features - Both intertumes and over-runs "Lionel Hutz" wall at the

\* Homer cont'd

- SW end. The over-run presumably rests on terrace Smitters, although the area is unclear. Hits step Barney, but there is no evidence that it sits on it — Barney ends in front of Homer (NW side). If not for the looter's hole at the NE end, it can be assumed that Homer would've intertumed with wall Flanders, much like it does with wall Lionel Hutz.

Comments - The NW wall of the summit, Homer is the longest exposed wall of the structure, providing one of the dimensions of the summit itself. Homer was most likely a part of the entrance, judging by the long succession of steps leading up to it. It's possible that Homer descends to the same depths as Ralph Wiggam; lack of time kept us from excavating further. The only possibility for a later addition to Homer lies in the over-run past Lionel Hutz at the SW end.

Feature - Ned Flanders

Height - 59 cm from surface of Martin

Length - 253 cm

Width - 76 cm

Depth - 61 cm from #1

Orientation -  $310^{\circ}/130^{\circ}$

Construction Type - Flanders is the NE summit wall and its surface consists of large flat cobble mixed with medium stones (range  $52 \times 27 - 17 \times 8$  cm). This makes the wall unusually wide when compared to the other 3 summit walls. These rocks are laid at a  $46^{\circ}/224^{\circ}$  angle, and are followed by medium to small cobble underneath (avg.  $10 \times 5$  cm). There is no real evidence of layers within the wall. The wall seems to rest, or at least part does, atop of terrace Martin Prince, and could go as deep as Ralph Wiggam, but we didn't have time to excavate to those depths. The area itself is not well preserved, much due to the fact that a looter's hole lies on the wall's NW end. The wall also ends mysteriously to the SE, possibly due to tree growth or just plain bad preservation. These factors make Flanders the least-exposed wall and the most difficult of the summit walls to analyze. Flat faces are out (to SW).

Adjoining Features - At least part of Flanders rests on terrace Martin Prince. It would've presumably hit and intertumed with Homer if not for looters.

Comments - Difficult to analyze because of the small amount exposed and

\*Flanders cont'd

The poor preservation of the area, but the small bit we do have isn't in that bad of shape. Can be assumed to have been connected with Homer, as well as Ralph Wiggam at the SE end. The only possibility for a later addition would be that which rests on terrace Martin, though we can't tell if the entire wall rests on this terrace, or if the wall does indeed go to the depths of Ralph Wiggam — we lacked enough time.

Feature - Martin Prince

Height - 122cm from top of large stones. Length - 160cm exposed

Width - 52cm

Depth - 111cm from #1

Orientation -  $312^{\circ}/132^{\circ}$

Construction Type - Martin Prince is the NE main terrace of Structure #3.

The surface is somewhat flat, with large stones taking-up most of the space back to Flanders, laid at a  $232^{\circ}/52^{\circ}$  angle and mixed with smaller cobble (range -  $26 \times 39$ cm to  $5 \times 7$ cm). Underneath this top layer, 12 layers lie consisting of rows of small cobble (avg.  $7 \times 12$ cm), with the exception of a large stone just underneath the top (measuring  $20 \times 24$ cm), and another large cobble ( $35 \times 20$ cm) down around layers 9 and 10. At the base of Martin, large stones (avg.  $29 \times 40$ cm) that are separate from the terrace itself rest, from Martin to a length of 68cm. They're laid the same direction as Martin but it's difficult to say if they were a part of Martin, another construction, a construction in itself, or simply tumble. The rock faces of the terrace are nicely facing out (to the NE), and Martin's top slants toward the NE.

Adjoining Features - Martin Prince supports part (at least) of Flanders on top.

It hits, but probably doesn't intersect nor rest atop of Krusty, although it is difficult to say because of the large stones.

Comments - Martin Prince is very well preserved, and looks to be very carefully built. The large stones at it's base are puzzling. I'm not sure if they are anything because of their placement, but they could be because of their large size and the direction in which they are laid. I don't believe Martin intersects or rests upon Krusty, mostly because of Krusty's small size and poor construction when compared to Martin. No evidence of additions.



Feature - Krusty

Height - 24cm

Width - 72cm

Orientation -  $326^{\circ}/146^{\circ}$

Length - 100cm exposed

Depth - 219cm from #1

Construction Type - Krusty is a small terrace in front of Martin Prince. It's surface is flat (somewhat) with stones ranging from  $26 \times 24$ cm to  $6.5 \times 8$ cm, with the large, flat stones toward it's edge pointing  $56^{\circ}/236^{\circ}$ . Underneath this top layer, there seems to only be one more major layer consisting of medium to large stones ( $10 \times 22$ cm) and small cobble ( $4 \times 6$ cm). Entirely constructed of cobble, Krusty's rock flat faces face out (NE), although the terrace isn't tall enough for it to necessarily matter.

Adjoining Features - Krusty most likely hits, but doesn't interweave nor form the base for Martin Prince.

Comments - Nice, small terrace on the NE side. It's hard to analyze Krusty because it's so small, but looks relatively well built. The large stones in front of Martin Prince make it difficult to tell, but I believe Krusty continues up to the base of Martin, and no further. There is no evidence of any additions.

Feature - Nelson

Height - 132cm

Width - 55cm

Orientation -  $62^{\circ}/242^{\circ}$

Length - 100cm exposed

Depth - 185cm from datum #1

Construction Type - The top of Nelson consists of medium to large-sized cobble (ranging  $36 \times 16$ cm to  $20 \times 12$ cm) laid at a  $316^{\circ}/136^{\circ}$  angle along the edge of the terrace. There are 5 of these prominent stones, and behind them Nelson continues back 55cm to Grandpa Simpson with medium to small cobble. Underneath this top layer, there is a layer of flat cobble an average of 30cm long. There are two of such stones visible. The next layer consists of smaller cobble (avg.  $9 \times 3$ cm), followed by a layer of large cobble (avg.  $27 \times 17$ cm) of which 3 stones are visible. The next 4 layers are composed of small to medium cobble (range  $9 \times 2$ cm to  $2 \times 4$ cm), laid in nice, distinct fashion. The base of the wall is comprised of

### \* Nelson cont'd

- seemingly 3 layers of flat cobble (range  $26 \times 12$  cm to  $18 \times 12$  cm) of medium to large size. 4 of such stones are visible, and protrude as far as 9 cm out from the rest of the feature towards the SE. Entirely constructed of cobble, Nelson's flat faces are nicely cut (SE). The terrace itself slants toward the SE.

Adjoining features - Nelson runs 55 cm back to the NW, to become the base for Grandpa Simpson.

Comments - One of the best-preserved constructions on Structure #3, Nelson obviously took great care in building - evident by the flat faces, the clean layers, and the alternate use of small, medium, and large stones. No real evidence of any additions, and I'd think it'd be very unlikely.

Feature - Grandpa Simpson

Height - 41 cm from surface of Nelson

Length - 100 cm exposed clearly

Width - 107 cm

Depth - 147 cm from datum #1

Orientation -  $54^\circ/234^\circ$

Construction Type - The second level of terrace on the SE side of Str. #3, Grandpa Simpson seems to be built upon Nelson. The top edge of the feature consists of medium to large cobble (range  $33 \times 30$  cm to  $12 \times 11$  cm), 4 of which are visible. Underneath these stones are small to medium-sized cobble (range  $15 \times 6$  cm to  $3 \times 5$  cm) and don't really form distinct layers. It's difficult to tell whether the flat faces were deliberately set out, for it varies. These stones clearly rest atop the surface of Nelson. The terrace surface is somewhat flat, and composed of cobble medium to large in size (avg.  $21 \times 23$  cm). This terrace runs 107 cm back to the NW, where it hits, but does not intermingle with, Ralph Wiggan.

Adjoining Features - Grandpa Simpson is built atop Nelson and runs 107 cm to the NW to hit Ralph Wiggan. It doesn't intermingle with Ralph, although it seems some of Ralph's stones overlap onto the surface of Grandpa, due to perhaps an addition on to Ralph. Grandpa also probably hits Lionel Hutz in the southern corner of the structure, although it isn't too clear. They don't interlock; the over-run of Lionel that meets with Grandpa most likely rests on top of Grandpa.

## Grandpa Simpson cast'd

Comments - Grandpa Simpson is fairly well preserved, and is most likely the next level of terrace on the SE side of Structure #3. By looking at the placement of the cobble, it can be assumed that Grandpa was built after both Nelson and Ralph Wiggam, although in the heightening of Ralph Wiggam, stones were placed on top of Grandpa and built on up, for added support. Only 100cm were exposed clearly to Grandpa's edge, although there is evidence of Grandpa's presence in front of Ralph Wiggam as far as 329cm. At Grandpa's SW end, it can only be assumed that Grandpa was built before the Lionel Hutz run-off, for the area is badly preserved. There are no clear additions to the terrace itself.

## Feature - Ralph Wiggam

Height - 182cm

Width - 57cm

Orientation -  $56^{\circ}/236^{\circ}$

Length - 329cm exposed

Depth - 110cm from datum #1

Construction Type - The largest exposed feature of the structure, Ralph Wiggam is basically made-up of cobble. The first 64cm down from the top (down to the level of Grandpa Simpson) is mainly made-up of cobble laid at an angle of  $324^{\circ}/144^{\circ}$ , in all sizes (larg.  $27 \times 23$ cm). It's clear at the bottom of this top section that some of the stones are built on top of Grandpa Simpson's surface, at least on the wall's SE side. There is no real consistency concerning the flat faces, although there seems to be many on the NW side of the wall. There are roughly six layers, although it's unclear. The remaining portion of the wall (down to the base) is constructed of mainly cobble (only 2 stones resemble schist) in all sizes (larg.  $10 \times 22$ cm). These stones seem to be laid in the same direction as the wall runs. There are roughly 8 layers, with the largest stone resting at the base. The flat faces are again inconsistent in this bottom section, though many face the NW. \*Only 1m of the bottom 90cm was exposed.

\*Comments - Ralph Wiggam is well preserved, and was most likely one of the first constructions of Str. #3, judging by it's height and depth of it's base. There was probably one addition, that portion which is on top of Grandpa Simpson, although this addition was probably at the same time the entire structure was being constructed.

\* Ralph Wiggam cont'd

- It can be assumed that Ralph was one of the 4 main walls to form the main construction at the summit of Str. #3.

\* Adjoining Features - Mr. Burns hits Ralph Wiggam's NW side at Ralph's NE exposed end, in a perpendicular fashion. Ralph, or a top portion of Ralph, rests atop the Grandpa Simpson terrace, for it's entire exposed length (most evident on the SE side). Ralph also hits and intertwinces seemingly with Lionel Hutz at Ralph's SW end, although that area is quite unclear.

Feature - Mr. Burns

Height - 68 cm (roughly)

Length - 178 cm exposed

Width - 44 cm exposed

Depth - 118 cm

Orientation - 324°/144°

Construction Type - A poorly constructed wall in the interior of the summit's main chamber. The stones, looks to be mostly cobble, have no evident consistent placement, nor do they concern themselves with the direction of the flat faces. The cobble is of all different sizes (avg. 17x14 cm), and the top shows no organization. The base is unclear as well, for it looks as if this wall was built upon the fill used to construct the summit. There seems to be bits of schist mixed-in with the cobble in some areas. Overall, Mr. Burns is a pretty weak wall.

Adjoining Features - Mr. Burns hits, but does not intertwine, with Ralph Wiggam at Mr. Burns' SE end. It does intertwine with Groundskeeper Willie at it's NW end.

Comments - Mr. Burns was probably a later feature built during the construction of Str. #3, after the 4 main summit walls were built and fill was added. It could've possibly been a flame, however so weak, for a less permanent structure on top of the summit. No evidence of any additions.

Feature - Groundskeeper Wallre

Height - 66 cm (roughly)

Length - 243 cm

Width - 77 cm

Depth - 110 cm from #1

Orientation -  $50^\circ/230^\circ$

Construction Type - The make-up of Groundskeeper Wallre is much like that of Mr. Burns. There are no distinct layers, no concern for flat faces, and the base is questionable because it seems to be built on fill. Wallre is made-up of larger stones (cobble) especially its top layer, which consists of large flat stones (avg.  $40 \times 25$  cm) laid at an angle of  $138^\circ/318^\circ$ . They are especially frequent towards the SW end.

Adjoining Features - Groundskeeper Wallre hits and intertumes with Mr. Burns at its NE end. Also hits, but doesn't intersect with, Lionel Hutz at Wallre's SW end.

Comments - Groundskeeper Wallre is probably another wall built like Mr. Burns: on fill, after the main walls, for a frame-type purpose. Not very well constructed, Wallre's large stones make it slightly sturdier than Mr. Burns. No evidence of any additions.

Feature - Lionel Hutz

Height - 81 cm exposed

Length - 430 cm

Width - 60 cm

Depth - 81 cm

Orientation -  $352^\circ/192^\circ$

Construction Type - Lionel Hutz is the SW summit wall, and unfortunately not very well preserved due to a tree at its SE end. The wall consists of mostly medium-sized cobble (avg.  $31 \text{ cm} \times 17 \text{ cm}$ ), and one can sort of make-out a pattern on top - the rocks are laid at an angle  $64^\circ/244^\circ$ . No layers can be made out, nor concern for flat faces due to tree roots and such, although some faces are out. Poor preservation also keeps us from an accurate estimate as to whether Lionel descends as far as Ralph Wiggam. Lionel seems to pass Ralph Wiggam (they do intertume) and end at the edge of Grandpa Simpson at Lionel's SE end, although this area is not well preserved at all.

\*Lionel Hutz cont'd

Adjoining Features - Lionel's SE over-run rests on Grandpa Simpson, after interlocking with Ralph Wiggam in a perpendicular fashion. Lionel also meets with Groundskeeper Willie, but they don't intersect. It also meets with Homer and intertunes at Lionel's NW end. The SW side of the wall, or least part of it, seems to be built on top of Terrace Smothers, much like Ralph does Grandpa Simpson. This is hard to tell though, again because of poor preservation.

Comments - Lionel is the SW portion of the 4 main walls of the summit of Structure #3. It's very poorly preserved - 176cm of the SE end are horrible. Roots have mangled the wall pretty well. The only possible later addition resides in the over-run at the SE end, much like Homer. Nevertheless, Lionel provides us with another of the summit's measurements.

Feature - Smothers

Height - 108cm from surface of Sideshow Bob      Length - 98cm exposed

Width - approx 52cm - not well preserved      Depth - 142cm from #1

Orientation -  $326^{\circ}/176^{\circ}$

Construction Type - Smothers is the largest terrace on the SW side of Structure #3. The top is not well preserved due to Lionel Hutz's tumble and the roots from the south tree, but the edge can be made out. 4 large (avg.  $26 \times 20$ cm) stones laid at an angle of  $58^{\circ}/238^{\circ}$  make-up the top-edge row, followed by a row of large stones and small cobble ( $6 \times 7.5$ cm). The next 6 layers consist of medium cobble (avg.  $20 \times 7$ cm) and small cobble. The following row consists of large stones, then a row of small... - this continues in the last two visible layers until it is hidden by Smothers. Flat faces are nicely all facing the SW, though the surface is again difficult to tell due to Lionel Hutz.

Adjoining Features - Sideshow Bob hits Smothers at it's base, but they do not intersect, nor does Sideshow become the base for Smothers. Lionel Hutz also hits Bob.

Comments - Nicely preserved with the exception of the top. Smothers was built before Sideshow Bob, although it is difficult to say in respect to Lionel Hutz, much due to the destruction caused by roots. The first two layers could be possible additions, though very unlikely.

Feature - Sideshow Bob

Height - 18cm

Width - 95cm

Length - 100cm exposed

Depth - 240cm from #1

Orientation - 320°/140°

Construction Type - Sideshow Bob is a small terrace in front of Smithers on the SW side of Structure #3. It consists of large to medium-sized cobble (avg. 23x26cm) mixed in with some schist. It seems that most of the rocks' flat faces are out, and the stones are laid the same direction (NW-SE) as those on the edge for the most part. It's very small - seems to only be one layer of stones set on top soil.

Adjoining Features - Principal Skinner ends roughly at the front of Sideshow Bob, and Sideshow ends at the base of Smithers.

Comments - Sideshow Bob is a very small terrace built after the construction of Smithers. The terrace provides the first real, definitive evidence of schist within a feature in Structure #3, even though it's a small amount. It can only be assumed that Bob was built before Principal Skinner. No evidence of additions.

Feature - Principal Skinner

Height - lowest point: 13cm; highest point: 38cm

Length - 354cm

Width - 56cm

\* Depth - lowest point: 147cm; highest point: 103cm

\* taken from datum #3

Orientation - 50°/230°

Construction Type - Principal Skinner is a vertical wall hitting Sideshow Bob terrace. It's mainly made up of very large stones, stacked in 3 rows, one on top of the other, in a ramp-type formation up to roughly the surface level of Sideshow Bob. These large, flat cobbles range in size from 46x38cm to 22x14cm. There doesn't seem to be much attention paid to the flat faces, and most of the stones are laid at a 324°/140° angle.

Adjoining Features - 14th, but doesn't intersect with Sideshow Bob.

Comments - Principal Skinner is one of the more puzzling features of Str. #3, and could be a part of another structure to the SW. It's not very well preserved, making it even harder to analyze. No additions evident. Most likely built after Sideshow Bob.

Site 128/I

Bryan, Lucinio, + Pedro

P96-95-2

(128/I -3 Found cont'd)

- separate stone south of the large eastern stone became more defined. It's rather oval shaped, compared to the well-cornered larger stone.
- flat, squared stone mentioned above is most likely a pottery sherd - 5 more were found, ~~two~~ <sup>two</sup> of which ~~were~~ <sup>were</sup> vms. \*
- another intriguing piece, made possibly of clay, was shaped like a large pill - very smooth.
- a stone about the size of a fist seemed to have a natural / unnatural groove in its side.
- ✓ - one piece of what looks like a figurine. Resembles a face, or a piece of one.
- \* - The workers later informed me that 5 of those pieces - one of which was a vm, was found in the 128/I/2 level.
- five more sizable stones were uncovered - most very close to the Southeastern wall - most likely the beginning of feature #3



SITE 128/I

Bryan, Lucario, + Pedro

P96-95-2

128/I-4 - 40 cm from datum point

Found - ~~was~~

- dark, brown, soil with various stone here and there
- few pieces of what looks like ~~leftover clay~~ <sup>bajareque</sup> shanks
- 38 pottery sherds, including 4 rims. Some look to be nicely burnished and slipped
- more rocks are showing up

1/30/96

Bryan, Lucero & Pedro

P96-95-4

Site 128/I

- some stakes were unearthed and the ~~the~~ string was stolen from yesterday's work.

128I/5

- Datum point measured from northern most stake, 50cm down
- square 1 meter x 1 meter from northwest side of trench

### Found -

- soil has a bit more grey color to it, is still moist due to rain last night
- some sizable ~~the~~ rocks, not all that large I guess, but larger than your fist, are turning up, as we get deeper and closer to the mound #3. Two rocks along the ~~the~~ southeastern wall of the lot were removed to allow for deeper digging. Another semi-square shaped stone was removed from the center as well.
- Pottery shreds - 300+ shreds, some nicely painted

Bajareque - 7

Others - some pieces of figurines perhaps, maybe a whistle.  
1 obsidian blade

some chunks (shapeless) of what looks like fired clay

- dirt seems softer as large rocks were uncovered along the southeast wall of the lot. They are nicely placed on a row. Judging from the number of shreds and these rocks, this is probably the level of occupation.

SITE 1281

1281/6

- 60 cm down from datum point

Found

- dirt is fine, soft, and a dark brown.
- some stones were removed from under the largest stone (uncovered) in lot #2, to allow for deeper digging.
- a chunk of ~~metate~~ metate
- what looks like a leg to a pottery piece
- a couple pieces of bajareque
- obsidian blade
- 297+ pieces of pottery sherds - some painted
- It seems we've hit perhaps the first course of feature #3 on the southeast side

1281/7

- 70 cm down from datum point

Found - bajareque under large eastern rock

- no real change in soil from the level above
- 6 sherds, signalling perhaps the end of occupation
- another lot is begun

~~END OF "DIFFERENT STAGES"~~

~~BOX~~

SITE 128I

New Lot started, 1 meter from beginning of the northwest trench going Southeast.

Datum point is measured from the eastern stake of the ~~the~~ first excavated section:

- There is a slight incline as we <sup>level - 1!</sup> grow closer to the mound, so depth may vary

128I/8 of ~~"acts of dark" block~~

- Square is measured 1m x 1m
- Datum point is measured from northernmost post of the lot, well I guess that is the Datum point.

Found

- dark, fine, dirt. Darker than the last few levels in the block before.
- I think Lucmro is having digestive trouble
- Ran into many stones, fist-size and larger, as well as a decent-sized stack of larger ones along southeast wall of the lot.

128I/29 of ~~"acts of dark" block~~

- 20 cm down

Found

- rich, dark soil w/ many stones
- pile of sizable stones (maybe a wall or fallen rubble) continue to be defined.
- 4 pot sherds uncovered.

1/31/96

Bryan, Lucero + Pedro

P96-95- 17

## SITE 128I

128I/10 (Block #2, 1 meter away from end of Northwest side

- 20cm - 30cm down in block #2 from datum point on northernmost stake.
- again, many of my stakes were pulled-out, but luckily left where they originally were.
- Lucero smoked a bit in the trench, I don't think it contaminated much on this level - he needs to keep up his Marlboro-man status.

## Found

- one large stone was removed from m. between the two blocks, most likely tumble
- 1 small pot shard
- ran into the tops of many rocks toward the southeast side, could be tumble, could be the next level of rocks from those found in block #2 (Chris Wiggam)
- soft, brown (a bit lighter than before) fine, dirt
- large root is causing trouble - could've moved many of the large rocks

## 128I/11

- 30cm - 40cm
- We've decided to connect the two blocks since we are down to the top of the aligned rocks of block #2

## Found -

- no real change in soil from above lot, hit many tops of rocks that look to be even with the Chris Wiggam construction
- 17 pot shards, 1 piece of perhaps a candlewax, and another questionable cylindrical piece that resembles Boris Karloff's Frankenstein.
- 3 pieces of Baja requé

(128I/11 (cont'd))

Found

- 1 obsidian piece, maybe a blade
- we've decided to clear the remaining dirt and define the rocks even with Chert Wiggins.
- Lucero has <sup>^</sup>pretty bad gas problem.

128I/12

- 40cm - 50cm (on units 1 rocks level with Chert Wiggins are found). I don't think will get all the way down to 50cm

Reed Van Gogh - the sketch: #1~~Reed~~ ~~sketch~~ Found

- 50-60 pot sherds
- 4 pieces of bajareque
- Chert Wiggins now well defined and looks to be 50cm wide.
- No real change in the soil

1281 - sketch #2

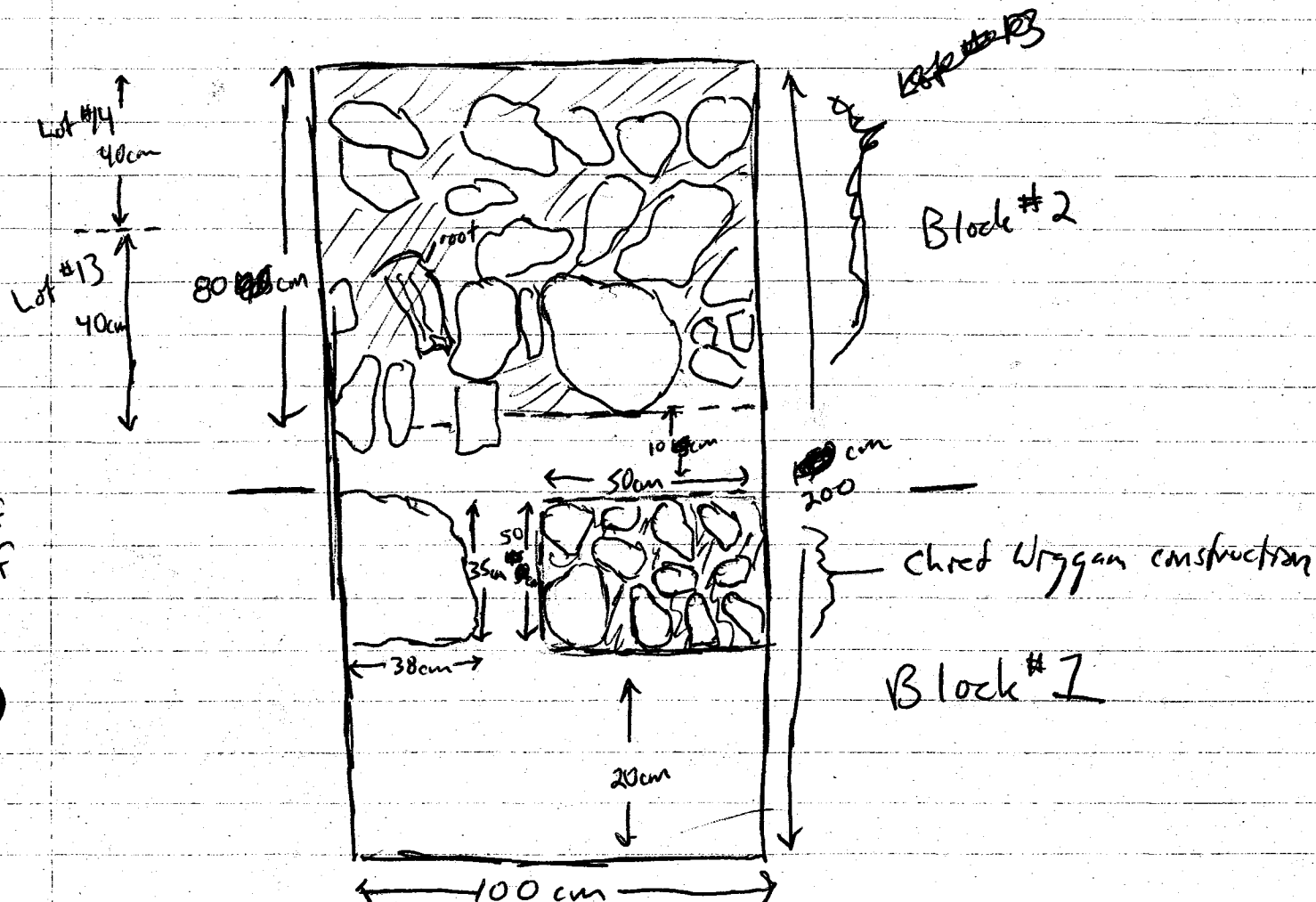

1281/13

- we've decided to remove the dumble left before, 80 cm long with depths ranging between 13cm and 30cm. We're going to excavate down to between 40-50 cm, even with Chief Wiggan, unless we've hit something else. Lot 13 measures 40 cm from the beginning of the dumble, the northwest side, going southeast. We went down as far as 50 cm.

Find

- no soil change
- around 93 pot sherds, one smoothed, roundish piece - maybe a rock
- 5 pieces of bijacogue
- No tops of any stones possibly joining or above Chief Wiggan

Chief  
Chief

1287/14

- continuing to remove tumble ~~at~~ along southeast wall of block #2. The lot measures 40 cm, and will be excavated to a depth of 40 cm - 50 cm or until we hit something relative to Chert Wiggam.

Found

- large, flat rocks along northeast side of the block, possible step
- large, flat rock along southwest side of block, possibly ~~the~~ a step. It's puzzling though, because in between these two rocks appears to be little to nothing. The two rocks are around 10 - 20 cm above Chert Wiggam
- 174 pot sherds
- 8 pieces of bijaveque

2/1/96

1287/15 new block #3

- The block measures 1m x 1m square southeast from block #2 in a trench measuring 19.65m long and 1m wide. The datum point is marked on the northernmost stake of the block. In attempt to uncover possible steps stemming from the eastern corner of block one, 0 - 20 cm will be removed, basically to remove the dirt from any stones.
- For once, all my stakes are intact, but it seems the eastern bunny and tooth fairy left a pile of sherds, slightly buried in the lot. Most likely it was the work of those meddling kids and their dog.



2/1/96 128I

P96-95-11

128I/15 cont'd

### Found

- uncovered many rocks, mostly tumble, but there is a nice alignment along the northwest wall, possibly related to the Plat, eastern rock in Block #2. We're going to remove the tumble above, down to the level of these stones (approx. 10-20cm from datum point) to look for connections.
- No connections were found, so it is assumed that the stones were were tumble.
- 1 piece Lajavague
- 15 pot sherds, two of which may be legs
- really hasn't been any change in soil throughout the lot.

128I/16

- We're removing the newly labelled tumble, which goes down as far as 40cm from the datum point. This is an attempt to find whether the second large stone of Block #2, along the south corner, is a step.

### Found -

- 60 pottery sherds
- 3 pieces of Lajavague (one sizable chunk)
- lots of probable tumble, although there is a possible wall on the northeast side which connects with rocks along the northeast side of block #2. Possible, but less likely, wall along southwest line of the block.
- Dirt is well compacted, soft + dark brown (much like above)

Sketch #3

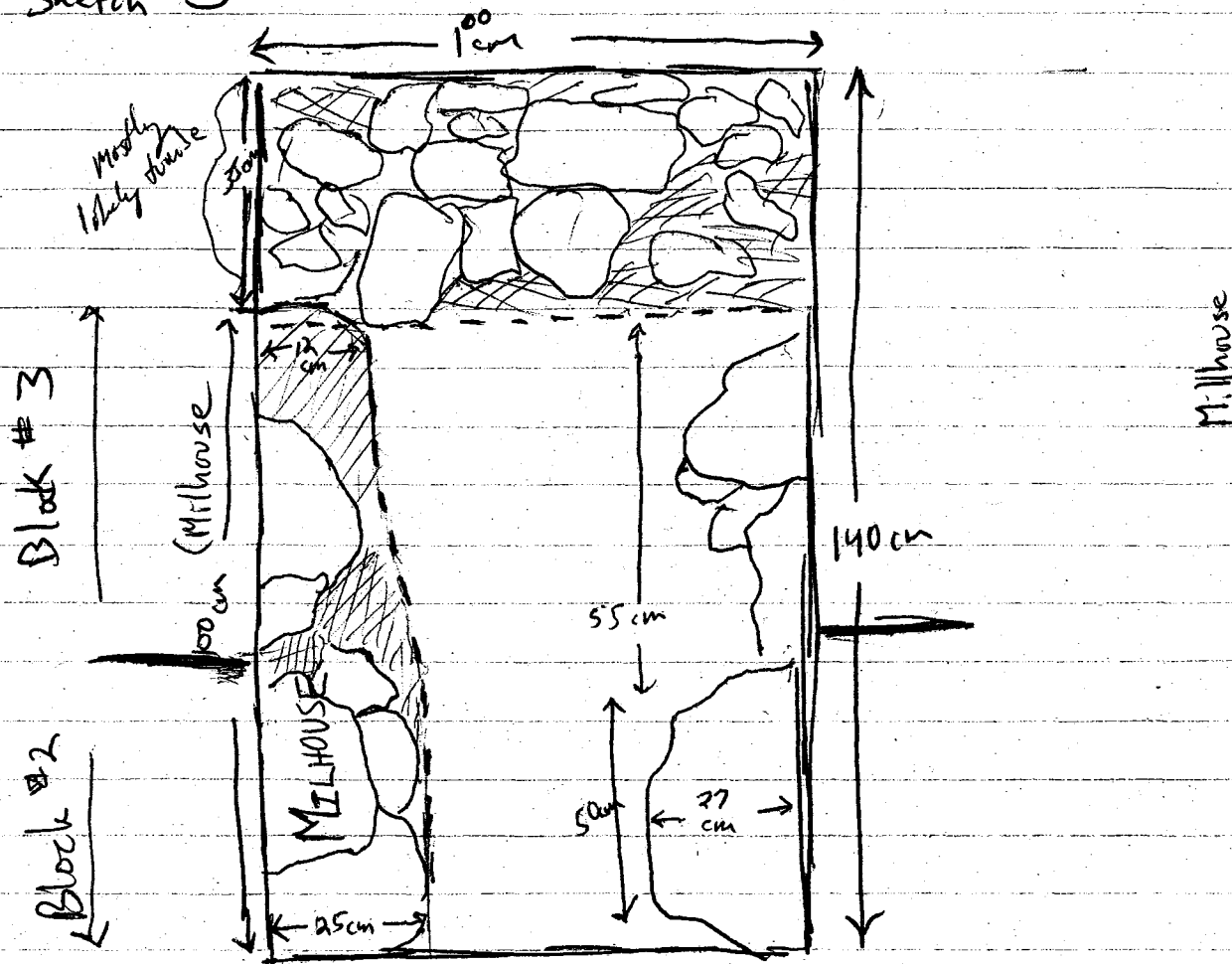

## 128I/17 (Block #4)

- In order to better remove the rubble on the southeast side of block #3, a new block has been started. This is also in attempt to better define, or define at all, the two possible walls on the northeast + southwest ~~end~~ lines of Block #2 + 3. So, 10-20 cm will be removed from Block #4, measuring from the datum point marked on the northern most stake. It measures 1 meter x 1 meter square, and is the 4th block in a trench measuring 19.65 x 1 meter, crossing structure #3 in a northwest-southeast fashion. The ~~block~~ block measures 3 meters from the northwest end of the trench.

128I/17 (Block #4 cont'd)

Found

- more rubble
- 3 obsidian blades
- 2 pieces bajareque
- 1 candelero
- 48 pottery shards
- some kind of dirt, a little more compact

2/2/96

(128I/17 cont'd)

- once again my stakes were pulled, but left close to where they were.
- Some of the above listed "rubble" could be a terrace

128I/18

- measures 30cm from NW. side of block #4, we're removing large stone in order to try and define if some of block #4 might be a terrace. We're removing stones as far down as 20-30cm. - The line was a bit more defined, so we're removing more stones approx. 50cm down to look for a possible other step.

Found

- a nice cut-stone (step?) on SW. - West corner of block #3.
- a definite step, or wall (most likely a step). Will now be known as Apu. We're ~~of~~ going to begin another block (#5) in order to perhaps find the next level.
- 21 pot shards
- 1 piece bajareque
- 1 obsidian chip

2/2/96

Byron, Lucmro, + Pedro

P96-95-14

1281

1281/19

- Block #5 is an attempt to find the next successive step to Apu, or to better define Apu if nothing is found. Due to rocks the stakes had to be moved slightly, so the lot measuring 1m x 1m square is a close estimation. Lucmro + Pedro seem to know what they're doing. The first 10-15cm will be removed, just to see what we have, from the datum pt. marked on the northernmost stake. Again, this block <sup>seems</sup> 4 meters away from the N.W. end of a 19.65m long and 1m wide trench crossing structure #3 in a N.W. - S.E. fashion.
- About 10cm were excavated.

### Found

- 29 pot sherds
- a possible next level, with tumble in front, falling into the S.E. side of Block #4 25cm. Other than that, most of the rocks are tumble. Tomorrow, we'll take out the tumble in front and find whether it is in fact the next level or not.

2/5/96

1281/20

- We're removing some of the tumble in the first lot, left by the workers because they thought it might be something. We're also removing tumble in front of a possible level, 40cm out (25cm into Block #4) and 40cm down (on the same level as the steps found in Block #4).
- It rained a lot over the weekend, some rocks had fallen out of place (most likely tumble anyway)

2/5/96

Bryan, Lucero + Pedro

P96-95-15

128I/20

- once again, all, or most of my stakes had been pulled.

Found

- 42 pieces of pottery
- 2 bajareque pieces
- We've discovered that what was believed to be a possible next level in Block #5, was most likely nothing.
- The soil is dark + moist (mostly due to the rain)

128I/21

- We're going from the Southeast excavated end of lot #20 (that believed row of stones) back the the southeast end of Block #5. The depth is approx 15cm - 40cm from datum pt. on Northeastmost stake. We're hoping to find a level - or something.
- We've decided (It was largely Lucero's idea), to split this excavation into two lots: 128I/21 is the first 50cm from the S.E. end of lot #20.

Found -

- 85+ pot sherds - one handle
- 12 pieces of bajareque (some sizable chunks. It seems bajareque was pretty plentiful in this lot.
- No possible levels - lots of tumble. Ed said that all the pot sherds found may suggest (usually suggests) we're in tumble.
- 1 Astorian blade/chip
- We're going to continue moving S.E. in Block #5

Site 120/I

Lucero, Bryan + Pedro

P96-95-16

128I/22

Lot #22 is the remaining 30-35cm ~~in~~ excavated down to 40 cm in Block #5. Since we've found nothing to write home about in the last two lots, we're continuing to move S.E., hence this lot. As said before, it will be "dig" to a depth of around 15cm-40cm from the dumpst. on the Northernmost stake.

### Found -

- around 354 pot sherds - some very nice, w/ handles
- 1 Jordan blade
- 9 pieces of Lajarcave, once again it seemed plentiful. We found one chunk the size of a fist.
- Nothing overly exciting, a nice row of large stones, but they're in an odd place. They are approx. 10cm above Apu, but there isn't anything clear after them, such as another level or terrace. Could just be tumble, or more likely a piece or the remains of something else.
- lots of tumble, many small cobbles.
- My God it's cold today. We're in Honduras and people are shivering in sweatshirts. Lucero + Pedro are under a tree covered in the ~~cloth~~ cloth they wrap their lunches in.
- According to Ed (and I guess I agree too) those aligned stones are simply the backside of Apu, which makes Apu around 60cm wide, 10cm larger than Chief Wiggam. We'll start a new block

Serie 128I

Ryan Lucero & Pedro

P96-95-17

128I/23 (Block #6)

- ~~Plot~~ Lot 23 of Block #6 measures 1 meter by one meter, beginning 5 meters from the N.W. end of a trench 19.65 m long and 1 meter wide, which crosses N.W.-S.E. over Structure #3. It will be excavated 0-20cm from the datumpt. marked on the ~~the~~ northernmost stake.

Found -

- Snake - Pedro ran into a snake, which has holes throughout the lot
- 17 pot sherds
- 1 piece biquaque
- 1 piece mafate
- Three large rocks in a vertical row

2/6/96

- (same lot)
- for 1st time the first time, all my stakes were untamped.
- we're continuing going down, starting to the left of the vertical row of rocks - exactly where the snake is located, so we're proceeding with caution.

Found (cont'd)

- 1 phop of obsidian
- a nice well (some of which has tumbled) along the S.W. line of the Block (#6). We'll excavate another block and follow it - we're getting close to the summit of structure #3
- 42 pot sherds
- 2 pieces of biquaque

add to above

check  
dark  
pile  
tomorrow

128I/24 (Block #7)

- In order to follow the newly found wall (Moe), we're starting block #7, which measures 1m x 1m square. It's 510 meters from the N.W. end of a branch crossing structure #3 in NW-SE fashion at a length of 19.65m x 1m wide. To begin, 0-20 cm will be excavated, to get rid of small tumble, and to uncover any large stones. We still need to watch for that snake.
- It's cold again today. I thought that hole in the ozone layer is supposed to heat things up... stupid hippies...
- Pedro's ~~complaint~~ complaining that he doesn't get any health insurance, and Lucmro keeps telling me he was promised a paid vacation...
- as with the last three or four blocks, I've found that many times the lot/block will originally measure 1m<sup>2</sup>, or close to it, then be increased around the sides by about 5cm, due to the removal of large stones and/or tumble.
- \* - As to the removal of tumble and Lucmro's energetic work habits, Lot 24 goes down to 30<sup>cm</sup> or 40cm (in between). We're still fighting that damn snake; ~~and~~ which can be said to affect our eye for artifacts.
- We've battled the snake and won. It was a nice coral snake, pretty poisonous - the kinda stuff you see on "Wild Kingdom". As a result, our N.E. line is a little wider, maybe just a little anyway - nothing to write home about or that would make a difference.

Found

- 120 pottery shards
- 3 obsidian blades (more)
- 5 pieces Bajareque



128I

Bryan Lucero + Pedro

P96-95-19

128I/24/ Fond (cont'd)

- no real instructions. Nothing coming off Moe. We're going to go back in between blocks #5 + #6, where Moe begins, and try to remove Moe's and the floor's tumble, and look for a wall.

Sketch #4

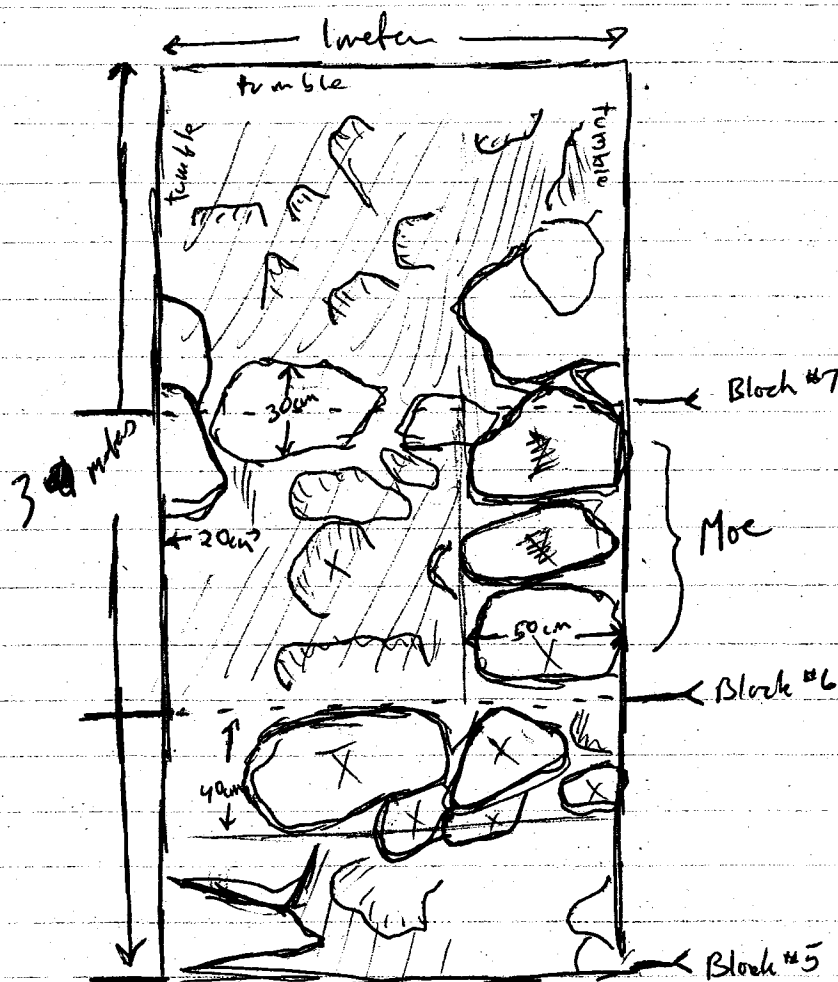

X - denotes we're removing m/d #25  
- denotes visible, but buried

128I

Boyer, Lucero + Pedro

P96-95-20

128I/25 (retreating into Block #5 + #6)

- We're going back to Blocks 5 + 6 and removing tumble. The lot measures 80 cm, 20 cm into Block number 5 from the S.E. wall, and 1 meter wide. The depth varies, 40 cm from the bottom Block #6 (roughly located 40 cm from datum pt.) and 80 cm from the top of Moe. The hope is to excavate back to some stones that may resemble a wall underneath Moe's tumble (might be the true Moe).

### Found

- 1 almost complete, beautiful stamp
- 1 chip obsidian
- 240 pot sherds
- 2 chunks metate
- ... continue tomorrow

2/7/96

- Pedro + I just made a pretty back-ass tent to avoid the rain. It's a pretty bad day. We're continuing with lot #25.
- \* - In addition to the above, we took-out some cobble along the S.E. wall of Block #6, it could be a wall - there are large, flat stones seemingly in a row. We wanted to find if they are resting on any larger stones. We also cleaned-off the floor of Block #5, just to look at the large stones

### Found

- We did indeed find a wall that runs into "Moe" at a 90° angle. We'll call this "Barney Gumble"
- 3 pieces of Sajaaveque
- 126 pot sherds
- We're starting a new lot.

add together

## 128I/26 (Beginning of Block #8)

- Block #8 measures  $1m \times 1m^2$ , and begins 7 meters from the N.W. end of a trench 19.65m long and 1 meter wide crossing Str. #3 in a N.W. - S.E. fashion. To begin, Lot #26 will be excavated to a depth of 0-20cm relative to the datum point marked on the northernmost stake. We have no real goal, maybe to see if the contours, however so weakly. As I look at my trench, it's not all that consistent as far as my line. I don't know how exact archaeology is, but if it isn't, my walls fit in fine. It would be difficult though, for anyone to keep straight lines when there is so much rubble. We can only do the best we can.
- It's raining on and off. Lucero's got his plastic lunch-cover on again... it's quite fashionable.
- We're pretty much at the summit of Str. #3, maybe just one more meter. We're pretty high though, on the mound that is.

- Found - a nice row of large stones - most likely a wall. ~~It~~
- \* - In addition to above, we'll remove 20cm of coop (20cm S.E. from the N.W. end of Block #8) from the possible wall to better define it. It goes down 60cm from the datum point. It is a wall, now named "Homer". There is a vine root growing through it.
  - 350+ pot shards
  - 2 Aztec blades/chips
  - 12 pieces of bajareque

Site 128I

Bryan, Luciano + Pedro

P96-95-22

~~128I~~ 128I/27

- we're going 10 cm deeper in Block #8, aka 20-30 cm from the datum point marked on the northernmost pole.

Found

- 38 pot sherds

- 1 piece bajareque

... continue tomorrow

2/8/96

- Seems some meddling kids visited our site. There are foot prints in the dirt piles and some of my stakes were pulled. They also knocked-out a rock from "Homer".

Found

- 53 pot sherds

- 3 pieces bajareque

- other than that, really nothing. Same sort that has been throughout the trenches.

128I/28

- new block (#9) at the summit of Structure #3.

- measures 1m x 1m sq. and is 2 meters from the N.W.

end of a branch 19.65m long + 1m. wide crossing Str. 3 in an N.W. - S.E. fashion. The beginning depth will be 0-20 cm from the datum pt on the northernmost stake.

Found

- 1 obsidian blade

- 190 pottery sherds

- 3 pieces bajareque

2/8/96

Bryan, Lucero + Pedro

P96-95-23

128I/29

- we're going 10 cm more (20-<sup>4</sup>~~10~~ cm) in Block #9

Found -

- Found -
- 320+ pottery shards
  - lots of drain chips
  - 7 pieces of ligature

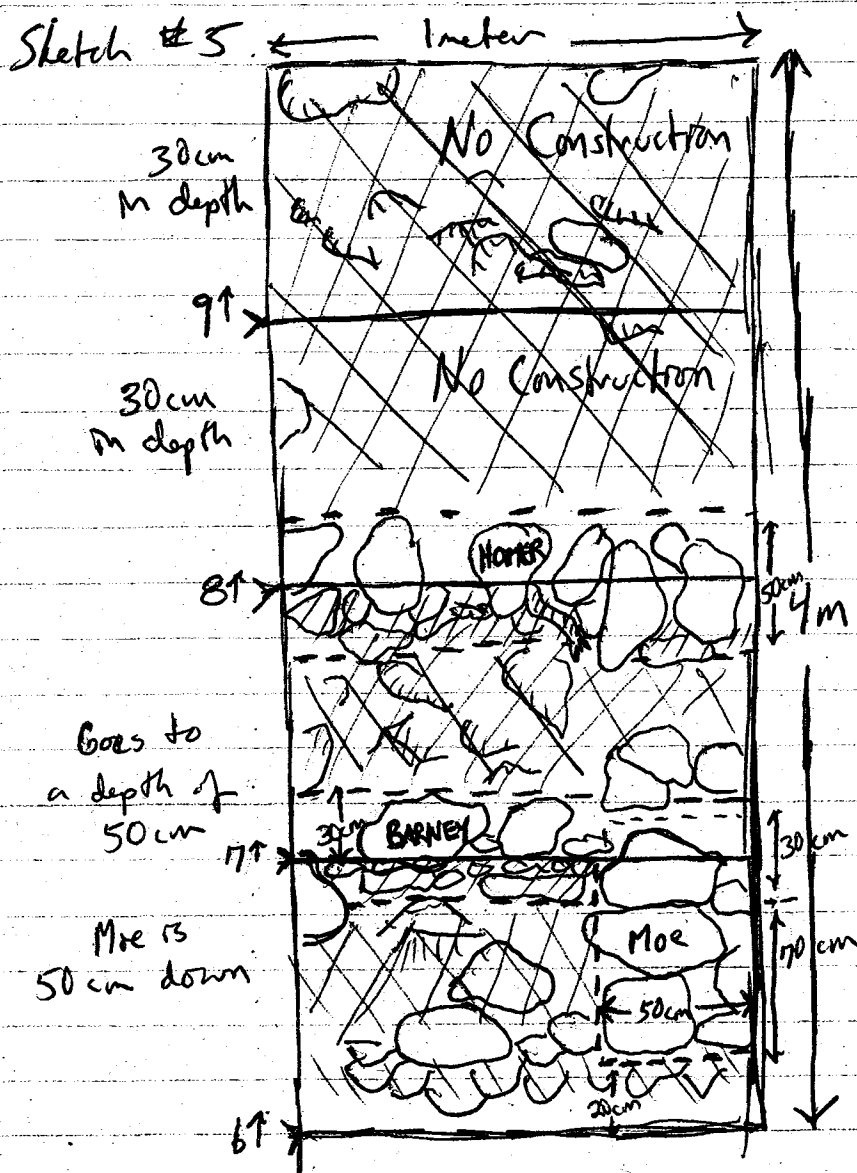

P96-95-24

- We've started on the opposite side of Structure #3, near N.W. Block #10 measures  $1\text{m} \times 1\text{m}$  square, and begins at the S.E. end of a trench 15.65m long and 1 meter wide, crossing Structure #3 in a S.E. - N.W. fashion. Lot #30 is excavated between 0-20cm from the southernmost stake.

- While dogging, we hit some brown glass - most likely from a beer bottle. Now either someone left it there while passing through, or these ancient people drank Salsu Vrode. I'd go for the latter, for who wouldn't enjoy a clear, refreshing Salsu Vrode?

- 207 pot sherds

- a few stones

- darker brown soil, fine, moist - probably because of all the rain

- We're going 20 more cm down in Block #10 (20-40cm)

- 211 pot shards - 2 with size marks made on them

- 1 chip of stone - I'm not sure, it's not asadran  
concrete

(120Z/31 cont'd)

- 162 pot shards - 1 more with rocks in it

- 1 chap of stone, I'm not sure again

- \* - These stones and pottery decorations are much different than what we found on the N.W. side

128I 2/4/56 Bryan, Lucmro + Pedro

P96-95-25

128I/32 we're going 10cm deeper (40-50cm) in Block #10.

Found - - 2 pieces of *Lygareque*

- 7 pot sherds

\* I think we're past the level of occupation.

No new blocks must be started.

- No soil change

128I/33 (Block #11)

- Block #11 begins one meter from the S.E. end of a trench 19.65 m long and 1 m wide crossing Structure #3 in a S.E.-N.W. fashion. The first 20 cm will be excavated, measured from the datum point marked on the southernmost stake.

- I've just learned that this is my last day with Lucmro and Pedro. Sorrow fills my heart as I think back to the memories we've had; of their "Buenos Dias"'s in the morning with their toothless smiles stretching over their faces; the way Lucmro utilizes his lunch-cover when the weather gets bad; Pedro's puzzled, but listening look when I try and communicate; Lucmro frowning around in a lot so deep you can only see his mighty hump; — I'm going to miss these guys. It's too bad this is Friday, I don't get to take pictures or give presents. I can only hope for guys close to as good as P+L — they're the best. But what's done is done, life goes on. The only thing to do now is to go to the El Rancho and drink myself into a coma... Lucmro and Pedro would've wanted it that way.

Found

- 47 pot sherds

- 1 piece *Lygareque*, really nothing to write home about

1281

2/9/96

Bryan, Lucinda & Pedro

P96-95-26

1281/34

- we're going 20cm more in Block #11 (20-40cm). Didn't find as much in Block #11's first lot as we did in Block #10, but hopefully we make-up for it in this lot.

Found

- 123 pot shards - another with the foot-marks. That style seems common here, at least compared to the other side of the structure.
- 1 piece metal
- some dark, fine, brown soil

1281/35

- we're going only 10cm further, since we hit a drought at 50cm last time. This'll be 40cm-50cm.  
~~When hitting a lot of artifacts, we think 2th~~  
~~extend this lot down 10 more centimeters (40cm-60cm)~~

Found

- 242 shards, including one that looks like a missile cut in half, probably a leg
- 2 pieces of bone

1281/36

- We're going down 10cm more, just until we don't hit any more artifacts. (50cm-60cm)

Found

- 74 pot shards - nothing special
- 7 pieces of bone - pretty good chunks
- looks like we'll start another block on Monday



1281 2/12/96 Bryan, Oscar, & Milton

PS6-95-27

1281/37

- I made the unfortunate discovery that some people have been playing around the trench on the NW side of the mound. Not only did they play, but they succeeded in demolishing some of each wall, pulling the rocks out if necessary. I personally don't think it was the rain - some of those rocks were quite sizeable. Moe, Homer (almost gone), Apru, and Chock Wiggins all have many stones removed and thrown on the floor. Some are even broken. Yes, I'm pissed. I would hope the shifts would have something better to do. Evidently many people's sites were disturbed, but not to the extent of mine.
- Block #12 measures 1m x 1m and begins 2 meters from the <sup>S.E.</sup> end of a trench crossing Str. 3 in a N.W.-S.E. fashion. Lot 37 will be excavated down to 20cm from the datum point marked on the southernmost stake. I can't seem to find my workers so I can get started.

### Found

- 60 pot shards - one piece of a ocarina(?)  
size, large, nose.
- 1 piece Siquaque

1281

2/12/96

Bryan, Oscar, + Milton

P96-95-28

(1281/38)

- Lot #38 will be excavated down to 40cm (20-40 cm) in Block #12 according to the datum point marked on the southernmost stake
- It's kind of raining

Found 1

Sketch #6

- Bone -  
a few chips, possibly human, found in a row pointing in an N.E.-S.W. direction. It seemingly ends 5cm from the S.W. wall of Block #12

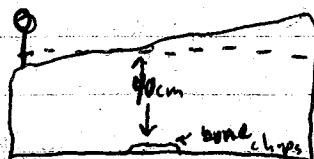
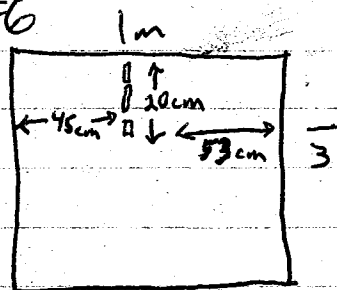

- 1 piece of chipped stone, may be nothing, but I bagged it anyway.
- We're hitting some stones, larger than those before, but probably just debris. But it might mean we're getting close to the constructions.
- 132+ pot sherds
- 7 pieces Sajareque

(1281/39)

- We're going 20 more cm. down in Block #12 (40-60cm)

Found

- bits of carbon along the S.G. line of Block #12, semi-going into Block #11 from N.W. they were under medium-sized stones. Not enough for a sample.

128Z

2/12/44

Bayan Oboe + M1760

P96-95-29

128Z/39 cont'd

Found cont'd

- 1 chipped stone, possibly chert, could be nothing, Z included it anyway
- 7 pieces of obsidian, some chips, some blades
- 334+ pot sherds - it wasn't uncommon to find one directly on top of the other, one piece to a stamp
- we'll continue tomorrow

2/13/46

- a couple stakes were pulled, but beyond that our current few blocks were untouched. Come to think of it, my workers might have pulled that stake. We're continuing with Lot #39, Block #12, removing rubble along the floor.

Found (Cont'd)

- 142+ pot sherds
- more carbon, but not enough for samples
- 3 obsidian blades - 2 are sizeable
- 1 chert chip
- 17 pieces of basalt - nothing too big.
- overall, we've found a vast variety of artifacts in these past two lots, much different than we found on the other side.
- 3-4 sizeable stones seemingly neatly placed along the N-NW wall of the block - we'll leave it in until the next lot / block.

128I

2/13/66

Bygon, Oscar + M. Alton

P96-95-30

128I/40

- Block #13 measures 1m x 1m and begins 3 meters from the S.E. end of the trench.
- Lot #40 will be excavated 20cm from the datum point on the southernmost stake
- It's raining again.

Found

- 165+ pot sherds
- 1 Jordan chert
- sizeable rocks - probably tumble
- 1 large root across the block

128I/41 20-<sup>50</sup>~~30~~cm down in Block #13, to the level of the first large stone along the N-NW wall of Block #12. This is to see if those stones represent a wall.

- roots are becoming a slight problem
- we're removing alot of tumble, so depth may vary in some places

- \* - In defining this possible stone wall, there is a plot 50cm x 50cm in the southern corner of the block that is excavated to 70cm. This plot also extends 30cm into Block #12 from the NW.

Sketch #7  
(poor scale)

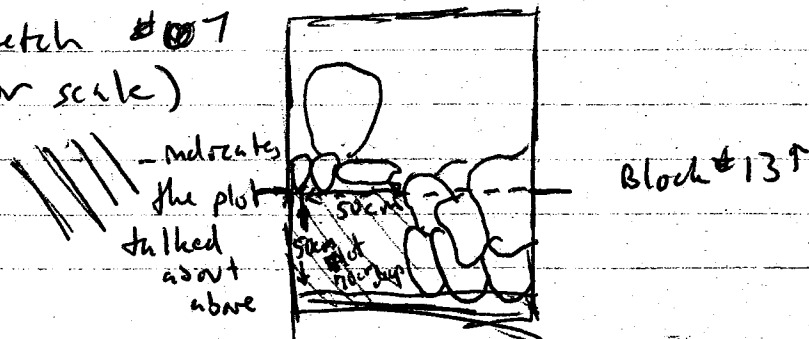

128I 2/13/96 Bryan Oscar + M/ton

Ag6-95-31

128I/41 (cont'd)

- I would've liked to make a new lot instead of having that little square, but the artifacts were combined before I found Oscar had gotten them from that depth. We had a high concentration of sherds in that 50cm square though.

Found

- carbon remnants, no sample left enough
- one chip of chert
- one clay sphere, much like a marble
- 138+ pot sherds (probably more) - some continue to have the dot-decoration
- 5+ pieces of biface
- some large stones, grouped with smaller ones (maybe that). They look as though they could represent a wall, along with the stones of Block #12, but there's also a pretty good chance it's rubble, if I've learned anything from excavating the NW side of this mound. I'm going to talk to Ed before I go on.

128I/42

- This lot is for the sole purpose of clearing rubble. Hopefully it will better define the possible wall along the NE side of Block #13. It will be excavated down to a depth of 70cm

Found

- 250+ pot sherds
- one nice piece of chert - possibly a core
- 1 piece obsidian - continue tomorrow

2/14/96

- We're not not sure about the possible wall anymore. We're going to leave it though.

1287 2/14/96 Bryant & Oscar & Milton

P96 55-32

1287/42 cont'd

- 71+ pot sherds
- 2 pieces bafareque
- 1 obsidian blade

1287/43 - we've begun a new block (#14), which measures 1m x 1m and begins ~~4~~ 4 meters from the SE end of a trench 19.65m x 1m crossing Str. 3 in NW-SE fashion

- It's raining again. I thought this place was supposed to be like a desert? It makes it hard for archaeology. And it's not a pouring rain, it's one of those kinds of drizzles/sprinkles that's just there to piss you off.
- we went down 30 cm, mostly because of all the rubble.

Found

- more large stones, most likely rubble, but we remain optimistic
- one large root growing across the block, could be a factor in what we find.
- 112+ pot sherds
- 3 pieces of bafareque
- 2 pieces of chert

1287/44

- we're removing rubble 60cm down, some of which falls into Block #13 around 30cm from the NW.

128I 2/14/56 Bryan, Oscar + Milton

96-95-33

128I/44 (cont'd) Found - 104+ pot sherds - one with the dot-decoration  
- 8 pieces of bijareque  
- 2 pieces of obsidian blade  
- lots more rubble - probably no wall

128I/45 60-100cm down, removing lots of rubble. Tumble also spills into Block #13 ~~at~~ as far as 50cm from the NW line. We're going back 30cm from the SE line of Block #14, for there seems to be a possible wall. This "possible wall" is <sup>20</sup>cm down from the datum point + 70cm long.

Found - 310+ potsherds, about 4 with the dot-decoration  
- 11 pieces of bijareque  
- 2 beads  
- 2 pieces of obsidian blade  
- 1 piece of chert  
- carbon chunks, but not enough for a sample

2/15/56

Found (cont'd) - 90+ pot sherds  
- 2 obsidian blade pieces  
- remnants of carbon - not enough for a sample  
\* The above mentioned "possible wall" was indeed rubble. We'll remove it later, for we'd already started another block before we got the final word from Ed.

128I/46 0-20cm down from the datum point marked on the southernmost slope of Block #15, which measures 1m x 1m and begins 5m from the end of the trench. Mostly rubble, with a couple roots. I think we'll go back and finish removing the rubble from Block #14 before we go further.

Found - 10 pieces of obsidian blade  
- 110+ pot sherds

1281 2/15/96 Bryan, Oscar + Milton

P96-95-34

(1281/47) We're removing a mass of tumble (the possible wall) measuring 170cm long, 1m wide, and beginning 20cm from the datum point on the southernmost stake. We'll remove the tumble down to the 1m floor level of Block #14 (this is all M #14). I don't think we'll do the same with the tumble in #15, because we'll be digging too deep, making it difficult.

- We've been doing this same lot for two hours now. I know it's big, but there aren't all that many artifacts considering it's size. Oscar and Milton also seem to be taking their time.

Found - carbon remnants, but once again not enough for a sample  
- 1 corner piece of an ocarina - pretty cool  
- 250+ pot sherds, nothing too special  
- 3+ pieces of basaltic - doesn't seem too plentiful  
- 2 chips of obsidian

(2/16/96) (1281/48) 0-60cm down from the datum point marked on the southernmost stake of the new Block #16. It's mostly tumble, and we're excavating to the level of tumble in Block #15. We're at the steep part of the mound, so we must act accordingly in order to prevent the excavation from becoming too difficult.

Found - 72+ pot sherds  
- 5 pieces of basaltic  
- 1 chip of chert  
- 1 piece of marble  
- 3 obsidian blades  
- Wall "Nelson" which begins 30cm from SE, down from the datum point.

Bryan is a "wootie head" - it remains to be seen whether I am indeed a "wootie head", but to question further, what in fact is a "wootie head". - Allenna's feeble attempt at name-calling, no doubt.



1281 12/16/96 Bryan, Oscar + Milton

PS6-95-35

1281/49 We're returning to block #5 and going 60cm down from the datum point (20-60cm). The block measures 1m x 1m... etc. We're hoping to find another well in front of Nelson, but it doesn't look too good. Most, if not all, is tumble.

Found - 85+ pot sherds  
- 4 pieces of biface  
- 3 pieces of obsidian blade

1281/50 We're removing tumble in front of Nelson, fifty centimeters toward the NW from the SE, going as far as 1.10 m down to the base of Nelson. We hit a nice, rather shiny base stone in front of Nelson and decided to stop, making Nelson 80cm high + 1m wide. There is a possible small wall running perpendicular to Nelson alongside the NE line of the Block, extending 15cm and 40cm long.

Found - 20+ pot sherds  
- 4 pieces of biface } artifacts were rare

2/26/96

- After a week of flirting with death, I'm back. A "saw" seems to have burrowed a hole in between the 12<sup>th</sup> and 13<sup>th</sup> lots. He left us some nice sherds + an obsidian blade. I'm not sure how to classify them.

1281/51 - ~~Block~~ #17 measures 1m x 1m, beginning 7m from the SE end of a trench 19.65m x 1m, crossing str. 3 in a NW-SE fashion. We're going down 20cm.

Found - row of tumble along NW line, extending 30cm in.  
- 1 obsidian chip  
- 40+ pot sherds  
- one large chunk of chert

2/26/96

[128Z]

Began, Oscar, Oscar, Pablo + Milton

96-95-36

[128Z/52] - With the addition of Oscar + Pablo, we're able to return to ~~Block #15~~ Block #15 and remove tumbler 70 cm in from the SE side, going down 50 cm. This is ~~to define "Nelson"~~ find a smaller wall or step in front of Nelson. (1.2 m from southernmost datum point of Block #15)

Found

- ~~row of tumbler along NW side, about 30 cm in~~
- ~~Assadian chip~~ - large amount of carbon in the center of the SE line of the block, 1.0 m down
- 2 snail shells - the first evidence of such in this trench
- 220+ pot sherds (probably more)
- 1 Assadian chip

[128Z/53]

- Going back to Block #17, we're going another 600 cm down from the datum point, to the top of Nelson.

Found

- wall/level "Grandpa (Abraham)" 40 cm down from the datum point, beginning at the SE line of Block #17, going horizontally
- 1 Assadian chip
- 10 pot sherds, - 3 pieces of biquaque

[128Z/54]

Block #18 measures 1.6 x 1 m, since the trench doesn't measure exactly 20 m. we're going 30 down from the datum point marked on the southernmost stake. The block begins 8 meters from the SE end of the trench.

[Found]

- 235+ pottery sherds, one with nice monkey head
- 7 Assadian blades/chips
- 6 pieces of biquaque

2/27/96

- 260+ pottery sherds; 8 pieces of biquaque; 3 Assadian blades
- 1 shell

12/26/96 128Z

Bryan, Oscar 2, M.1km + Pablo

P 96-95-37

128Z/55

This lot is merely to categorize the artifacts found by the "sarro" that survived in between ~~Blocks~~ 12 + 13 while Z was gone. The hole is 30cm wide and 20cm tall and 70cm from the surface. It's located under a large stone between ~~Blocks~~ 12 + 13. Depth was not measurable.

Found - - 1 obsidian blade

- 10+ pottery sherds

- not bad for not being on the pyrocl...

12/27/96

128Z/56

30-60cm down in Block #18, removing rubble, leveling the ~~the~~ block with the floor of Block #17.

Found

- 175+ pottery sherds

- one small, complete bone - probably of a bird or such. I'm not sure where they found it exactly, I'm not sure they do either

- 5 pieces of bajareque

- 1 obsidian blade / 1 piece of chert

- 1 snail shell

- A wall, "Ralph Wiggam" beginning along the SE line of the block, laying horizontally at 60cm - in width. 30cm down

- There's also a set of stones 40cm that run perpendicular to Ralph, along the NE line of the Block, extending as far as 50cm. We'll leave it in for now. In the small square made by these constructions, there is very fine dirt, soft and light brown.

12/28/96

128Z/57

0-20cm down from southernmost side of Block #19, which measures 1m x 1m, finishing the trench crossing Sh. 3m in NW-SE fashion. Begins 9m from SE end.

Found

- 335+ pottery sherds

- 5 pieces of bajareque

- 5 obsidian blades/chops

2/28/96 128I

Byan, Oscar<sup>2</sup>, Milton + Pablo

P96-95-38

128I/58 20-40cm down in Block #19, which measures 1m x 1m and begins ~~9m~~ from SE end of the trench.

Found - 490+ pot shards - many elaborately decorated, along with Leads, parts of figurines, and other ~~found~~ crafted objects

- 10+ pieces of bijouque
- 4 shells
- 1 bone, possibly bird
- 2 pieces of obsidian

\* most likely a SM

128I/59 40-~~50~~<sup>80</sup>cm down in Block #19 from the datum point on the southernmost stake. This will take the stake down to the same level as the possible perpendicular wall of Block #18.

2/29/96 We decided to go just under the "wall" (possible wall) to better define it.

Found - some carbon, but not enough for a sample

- 2 shell

- 1 chip of chert

- 160+ pottery shards

- another possible wall, perpendicular to the other along the NE corner

Very soft, fine sand - SM

- 1 piece bijouque

128I/60 The lot measures 50 x 30cm and is located along the south corner of Block #19, after we kind of hit a corner, off the "possible wall". Depth is 80-110cm from the datum point

Found - 25 pottery shards

- 1 chunk bijouque

- I don't think it's anything

1281

A96-95-39

Sketch #8

possible well "Abraham Simpson"  
"Mr. Burns"

NW  
↑

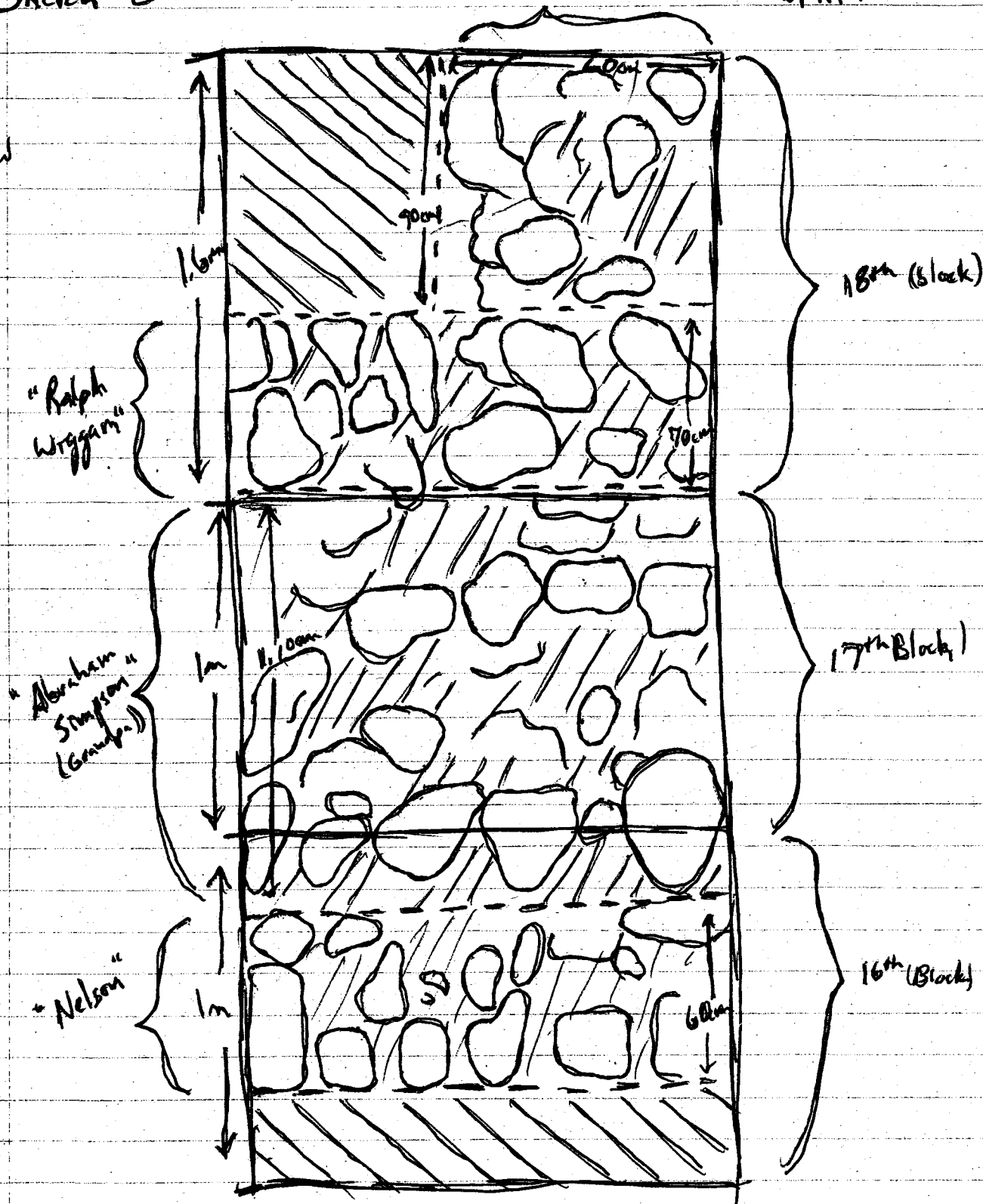

1281 2/29/96 Bryan, Oscar, Milton & Paolo P96-95-40

1281/61 - we've returned to Block #9, which connects w/ Block #19, and are going 40-60cm down from the datum point on the northernmost stake. This is in order to find a wall between "Homer" and "Ralph Wiggam".

Found - bone, rather large piece 45cm down, 35cm from the SW line, and 5cm from the northwest line. We also tapped into an animal residence, which was directly below the bones, which may or may not have affected it.

- 170+ pot shards
- 1 shell
- 3 obsidian blades/chips
- 15 pieces of biface

1281/62 60-80cm down in Block #9, down datum point on the northernmost stake.

- Found
- 5 chips/blades of obsidian
  - 2 bone pieces, probably bird - looks polished
  - 3 shells
  - one wire, solid rodent head, along with part of a whistle
  - 180+ pot shards
  - 12 chunks of biface

3/1/96

1281/63 40-60cm in Block #8, which contains "Homer", measured from datum pt. on northernmost stake. This is most likely S.M.

- Found
- 180+ pot shards
  - 1 obsidian blade
  - 1 piece of antler
  - 4 pieces of biface

1281/64 60-80cm in Block #8 from northernmost datum pt.

- Found
- +290 pot shards
  - 1 bone piece - possibly bird
  - 1 chunk of obsidian
  - 1 chunk of chert
  - 3 pieces of "hacha"<sup>ch</sup>, one complete tool
  - 2 shells

3/1/96 [128I]

Bryan, Oscar<sup>2</sup>, Milton + Pello

P96-95-11

[128I/65] 0-20 cm down in Block #20, which measures 1m x 1m and begins on the NE line of Block #8. Datum point is measured from northernmost stake.

Found - 195+ pieces of pottery - 1 piece hammer  
- 2 pieces of chert  
- 1 piece of obsidian blade

A "Homer" follows the NW line of the block, extending 20 cm

[128I/66] 20-40 cm down in Block #20, measured from the northernmost stake, beginning at the NE line of Block #8.

3/4/96

[Found] - 220+ pot sherds  
- one ceramic animal head  
- 1 obsidian blade  
- 1 possible stone bead piece (might be ceramic)  
- 1 chunk of metal - very worn

[128I/67] 0-~~20~~<sup>40</sup> centimeters down from datum point of Block #20, do to a looter's hole in the northern corner measuring 40 cm x 35 cm (NW x NE), going down as deep as 50 cm. Block #21 (what the new block is) begins 1m from the NE line of Block #8. "Homer" ends where the looter's hole begins, probably thanks to the looters.

[Found] - 335+ pot sherds, one nice ~~not~~ undecorated figurine head  
- 8 obsidian blades/chips  
- 2 pieces of chert  
- 2 pieces of bone  
- Carbon, but not enough for a sample

2/27/96 [12BT] Bryan, Oscar, Oscar, Pablo + Milton 1996-95-42

[12BT] - A new trench is started, crossing str. #3 in a NE-SW fashion. It's 1m wide x 18.7m long (roughly)

[12BT/1] This block<sup>NE</sup> begins at the end of a trench crossing str. #3 in a NE-SW fashion. We'll be going down 20cm in the 1m x 1m lot. (Northernmost point)  
Found - 5 pottery sherds

- Bone: 20cm down from surface, 17cm from SW line, 77cm from NE line. Probably cow, but Ed said there were burials down only 20cm at La Serrana. The bone is protruding from the SE line of the block 8cm. Were going 10 more cm down around it, in case we hit more

[12BT/2] 20-30 cm down in Block #1. We're only going 10 cm because of the bone found in the last lot.  
Found - We've decided to take out the bone that is visible. There seems to be more if we wanted to extend into the SE wall. - Some pretty good sized pieces were excavated.

- 25+ pot sherds, one chunk of stone, much like chalk

[12BT/3] 30-50cm down in Block #1

Found - 125+ pottery sherds  
- 5 blades/chips - 1 possible core  
- bagnet  
- 30+ pottery sherds

2/28/96



2/28/96

11287

Bryant Oscar 2 + Pablo + M. J. Jan

P96-95-43

\* 11287/4 - 0-20cm down from the Northernmost stake in Block #2, which measures 1m x 1m beginning 1m from the NE end of a trench 18.7m x 1m crossing Str. #3 on a NE-SW section.

Found - 15+ pottery sherds

- We're hitting some large stones, most likely rubble. There's also a large root crossing the lot.

11287/5 20-50cm down in Block #2, removing some of the large rubble. The soil is much like all that was in the 1<sup>st</sup> trench. Depth is measured from Northernmost stake

Found - 100+ pottery sherds

- 2 nice obsidian blades

- ran into rubble, symbolizing hopefully the beginning of the structure

11287/6 0-20cm down from northernmost stake of Block #3, which measures 1m x 1m and begins 2m from the NE end of the trench crossing Str. #3 on a NE-SW section

2/29/96

Found - 30+ pot sherds

- lots of rubble

2/29/96

Bayan, Oscar<sup>3</sup>, N. Irm + Pablo A96-95-44

128T/7 20-40 cm down in Block #3, measured from the datum point on the northernmost stake. We're getting into alot of tumble.

Found 20+ pot sherds

- 1 piece of Sargareque

128T/8 40-60 cm in Block #3, measured from the datum point on the northernmost stake. Still remaining tumble. Oscar + Pablo kind of freak me out. I go to check and see how they're doing, and they just stop and stare at me. Then Pablo usually says something I don't understand, followed by Mrs. Charlene Chan-type smile. Oscar usually follows, flashing his gold tooth. It's those times that makes me wish I spoke spanish so I could explain properly why I have to leave everytime they do that.

Found - 50+ pot sherds

- 2+ pieces of Sargareque

- lots of tumble

3/1/96

- 10+ pot sherds

- 1 nice smoothed white stone with dots, different

- 1 piece of obsidian

from anything we've seen

128T/9 0-20 cm down in Block #4, measured from the datum point on the northernmost stake. The Block measures 1m x 1m and begins 3m from NW end of the trench

- cont'd ↓

1287

3/1/90

Bryon, Dorem 2, Pablo, + M. Hott

P96-95-45

1287/9 cont'd

Found 1-50+ pot sherds

- two pieces of ossidian blade
- lots of flint

1287/10 20-40cm down in Block #4, resurveyed  
from the northernmost datum pt.

Found

- flint
- 7 pot sherds

\* It was odd, I didn't think we'd finished this lot last Friday, but I guess do to all the hard rain this weekend, the lot was down to 40cm already. There were few artifacts, and I suspect there are probably more wasted below, but I don't think it's necessary to go any lower. We should be hitting a wall or something within the next 2m.

1287/11 0-20cm down from northernmost datum pt. in Block #5, which measures 1m x 1m and begins 4m from the NE end.

3/4/90

Found

- a metal leg
- 25+ pot sherds, pieces of possibly a pendant
- 2 ossidian chips/blades
- A possible wall, judging by a row of large rocks

(128T) 3/4/96

Bayer, Oscar 2 + Milton, P. 56

P96-95-46

(128T/12) We're removing a lot 60x1m in Block #15,  
65m down (20-65cm), in order to see if the  
row of large rocks is indeed a wall.

- continue tomorrow -

(3/5/96) (Found) - only 17 pot sherds  
- 1 piece of bazarque

\* We only went down 50cm because we hit another row  
of stones. Call us wall-happy, but we're not taking any  
chances. Were going to remove the tumble from Block #14

(128T/13) 40-100cm down in Block #1, taking the  
floor to the same level as the Blocks before it. This  
is in order to remove the tumble in front of Block #5,  
which contains the possible walls.

Found - as we removed tumble, we came across another possible  
step, beginning approx 60cm from the NE line of Block #4, going  
horizontally, 45cm up from the bottom (55cm from datum point).  
We also discovered some burnt earth in an area as large  
as 50cm x 40cm along the NW side, beginning in the northern corner,  
although the highest concentration is a 30x20cm spot, 20cm  
from the NE line of the block, along side the NW line.

- 15 pot sherds - nothing spectacular.

128I 3/4/96 Bryan, Oscar 2, Milton + Pablo PG6-95-47

128I/68 - Starting Block #22, which measures 1m x 1m and 2 m from the NE line of Block #8. We're going 50 cm down by the southernmost datum point, do to the lookers hole. The hole runs along the NW line, extending as far as 40 cm into the Block. The hole reaches depths of as far as 50 cm from the datum point.

- continue tomorrow -

3/5/96 \* due to Milton's energetic work habits, the lot goes down 50 cm. Most of the larger pot sherds, obsidian, and the hieroglyph were found in the last 20 cm.

Found

- <sup>310</sup>~~210~~ + pot sherds
- small stone ball
- 1 nice "handle" with ~ hieroglyphic inscription on it
- 9 obsidian blades/chips
- 6 pieces of basaltic, one sizable chunk

128I/69 This lot joins with 128I, but not squarely:

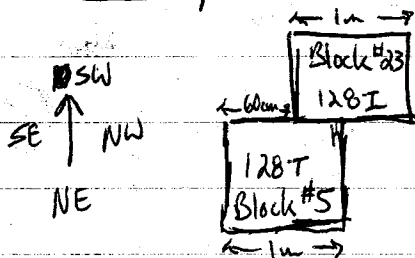

lot 69 is 0-50 cm down from southernmost datum point, measuring 1m x 1m and beginning 3 m to the NE of Block #8. (Block #23)

Found

- 18 pot sherds - not many compared to what we found on the SW side of the wall.

- 1 obsidian blade/chip

- one wall, approx. 45 cm in width, running NW-SE, beginning

"Ned Flanders" 15 cm from SW line of Block #23. Probably formed a corner with "Homer", but lookers removed the connection.

\* Flanders is slanted, 60 cm in width at largest point, the remaining 40 cm being the top of "Martin"

128I 3/5/96 Bryan, Oscar<sup>2</sup>, Milton + Pablo P96-95-48

128I/70 We're starting a new block, following the new wall to the SE. Block #24 begins at the SE line of Block #23, measures 1m x 1m, and its datum point is on the southernmost stake. We're going 10\*cm down.

example:

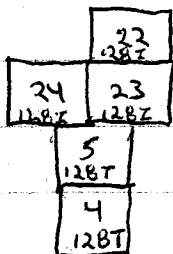

Found - 20+ pot sherds  
- at only 10cm down, we found stone, probably tumble along with the wall we're chasing. The stones took-up the full 1m x 1m. We've decided to go 5m to the SW, just to define the wall we're looking for. \* The wall we're chasing is now known as "Ned Flanders."

128I/71 0-10cm down in a lot measuring 50cm x 1m off the SW line of Block #24. This is to define the SW side of the wall joining Homer.

example: 

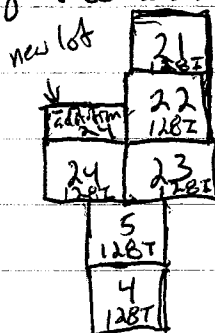

3/6/96 Found - 200+ pot sherds - carbon, not enough for a sample.  
- 3 chips/blades of Assadian  
- 7 chunks Sifareque

\* Do to possible drees, natural occurrences, erosion, etc., Ned Flanders seemingly ends at the SE line of Block #24.

1128T 3/6/96 Bryan, Oscar 2, + Milton + Piolo P96-95-49

1128T/14 We're removing a plot in Block #5 measuring approx. 55cm x 1m. Beginning at the NE line. This was believed to possibly be a wall. We're running double down to 1 full meter, level with the possible wall of Block #4.

Found - I don't think the proposed wall in Block #4 was a wall or level - too many vertical stones; it isn't too flat. However, in front of "Martin Prince" (large wall in Block #5) there are some large stones beginning 50cm from Martin and ending at the base of Martin. Martin itself is 60cm from the NE line of Block #5, one step that is, and 80cm from the middle of the wall, since it is slanted toward the NE.

- 35+ ceramics

- 2 pieces of bijouque

1128T/15 Lot 15 begins 70cm into Block #4, and ends 30cm into

3/7/96 Block #5 from the NE (for both). This makes the lot 60cm x 100cm.

We're going to remove the double 1.4m down from the northernmost datum point of Block #5.

Found - a nice row of stones close to the bottom of the Block; beginning 30cm from the SW end of Block #4 and possibly running into Martin.

This terrace will be known as "Krusty". There are a few large stones on top of this terrace, <sup>6 (at most)</sup> 20cm in width, up 40cm from the top of Krusty.

They rest at the foot of Martin. Krusty is 1.05m down, and goes to a depth of approx. 1.4m.

- 29+ ceramics

- 5 pieces of bijouque

128I 3/6/96 Bryan, Oscar, Milton + P. 510

P96-95-50

128I/72 0-20cm down from the northernmost stake of Block #25, which measures 1m x 1m and begins off the SW line of Block #8.

This is in order to follow "Homer" to the SW, where it's corner might be better preserved, ~~giving~~ giving us the approximate size of the room on the summit.

Found

- 200+ pot sherds, nothing too special
- 2 pieces of possibly chert
- 4 obsidian blades/chips
- one large chunk of carbon, could've been a sample, but Oscar handed it to me.
- 5+ pieces of biface

128I/73 20-40cm down from the northernmost stake of Block #25.

Found

- we can barely see "Homer", because he's not too well preserved. We'll probably go down ~~there~~ <sup>down</sup> more cm.

- 220+ pot sherds
- 4+ pieces biface
- 1 obsidian blade
- beginning to hit soft dirt again - fill

128I/74 40-60cm down in Block #25 according to the same datum point - we're on P.M. Homer runs along NW line, probably 30cm at most

Found

- ~~200~~ 200+ pot sherds, many elaborately decorated
- one mold for a figurine
- one obsidian blade
- 5 pieces of biface

continue tomorrow



128I 3/7/96 Bay, Oscar + Milton + Philo PG6-95-51

128Z/74/ (cont'd)

Found - 110+ pottery sherds  
- 4 shells

x add to page before  
- one stone, thought it might be jade due to its green color, but Ed doesn't think so.  
- 7 pieces of bijanque  
x Definitely F11

128Z/75 0-20 cm down in Block #26, which measures 1m x 1m and begins 1m from the SE line of Block #8. Datum point is measured from northernmost stake. We're following "Homer", which runs along the NW lines of Block #25 and Block #8, protruding 30cm into the Blocks at the largest point. It usually doesn't stretch out any further than 10-15cm.

Found - we can barely see parts of "Homer" - we'll have to dig deeper

- 120+ pottery sherds
- bijanque
- 1 chert chip

128Z/76 20-60 cm down in Block #26, from the northernmost datum point. We're still following Homer to the SE.

Found - an ungodly amount of pottery sherds - approx 200+, many elaborately decorated

- 2 obsidian blades
- one L-shaped cut stone
- 8+ pieces of bijanque

128T + 128I  
Sketch #9

3/7/96 1m

P96-55-52

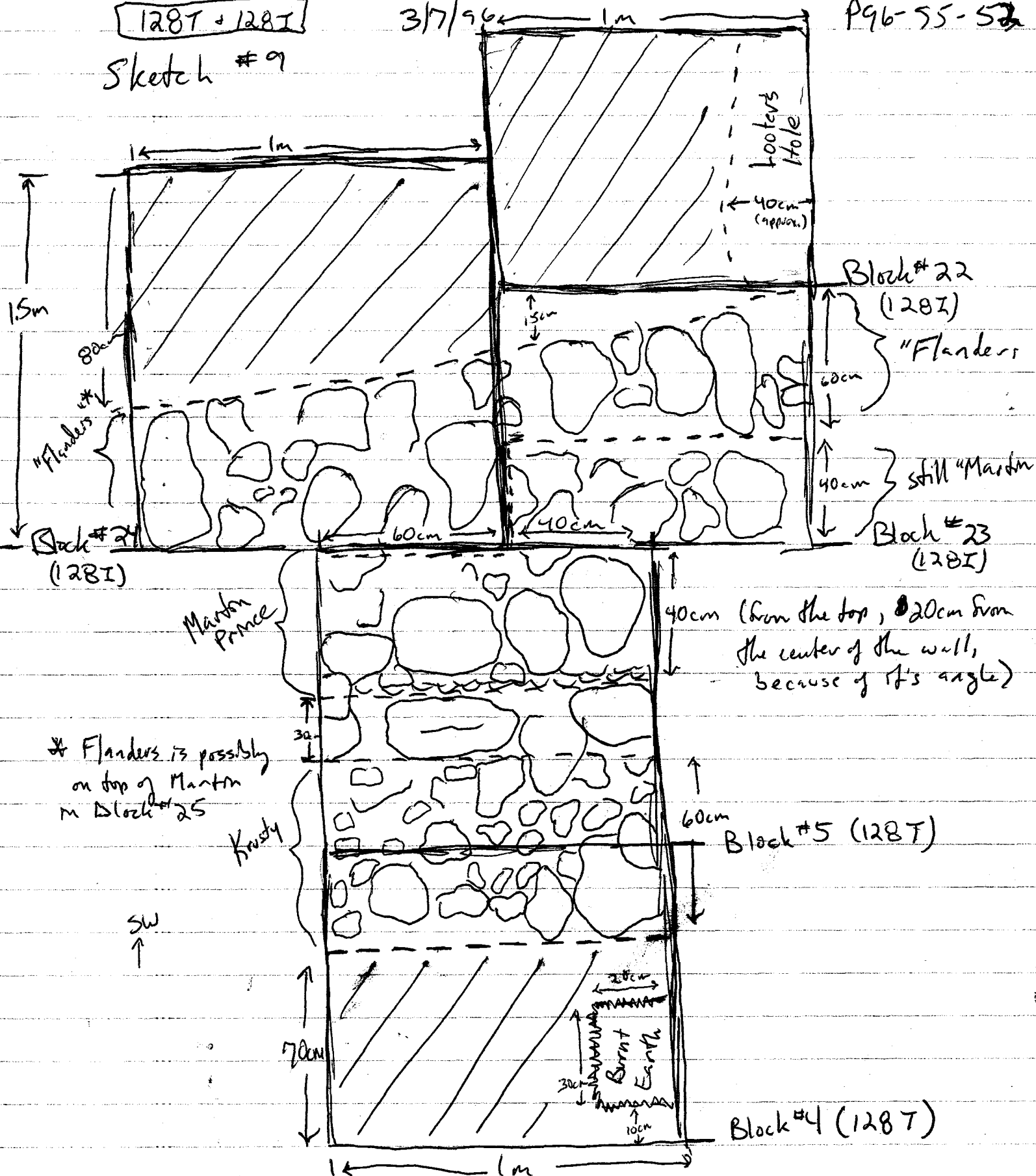

128AE

3/7/96

P96-95-53

128AE/1 Now that we've found a wall on the NE side of Str. #3, we're beginning a trench on the SW side. Block #1 measures 1m x 1m, beginning at the SW end of a trench ~~crossing~~ <sup>running</sup> NE into Str. #3. We're going ~~20-20~~ 0-20cm down from the southernmost stake (datum point).

Found - approx. 20 pottery shards  
= nothing much

128AE/2 20-40cm down from the datum point marked on the southernmost stake of Block #1

Found - 40+ pottery shards, one elaborately decorated

- 4 large rocks that we'll move tomorrow when we continue. Damn it's hot.

128AE/3 40-60cm down from the southernmost datum point of Block #1. The depth is somewhat uneven due to large tumble.

Found - 25+ ceramics

- very large tumble-stones

128AE/4 0-20cm down from the southernmost datum point of Block #2, which measures 1m x 1m and begins 1m from the SW end of a trench crossing Str. #3

Found - 75+ ceramics

- 1 large obsidian blade

- 2+ pieces of basaltic rock

- We can see the tops of what looks like a lot of tumble

428Z/26 | cont'd

- one broken piece of stone - maybe a tool
- a smoothed, disk piece of stone or pottery - very odd
- a possible shovel with the design:  - or to that effect

- chunk of what looks like room one
- 5 bone pieces, all found separately
- 1 shell
- Humer protrudes 28 cm into the block, along the NW side.
- It looks as though another wall is appearing, along the SW side that intersects with Humer. Some of the stones stick out as far as 20 cm at the bottom. We'll start following this wall.

128Z/77 this lot is to better define the newly found wall along the SW side of Block #26.

It measure 50 cm x 100 cm. \* Upon seeing that Humer continues past this wall, we continued to a full meter, making this Block #27, measuring 1 m x 1 m.

We went down as far as 50 cm, although it's uneven do to humer. Contains "Humer"

Found - a poorly-preserved wall perpendicular to Humer along the NE line of Block #27. It's 60 cm in width, and extends as far as 40 cm into Block #27. We also hit another possible wall along the SE line, but we'll pursue the first.

- 80+ ceramics
- 1 piece of polished bone
- 3 obsidian blades, one chert

3/8/76

128T 3/8/96

P96-95-55

128T/78 0-40 cm down from the northernmost datum point of Block #28, which measures 1m x 1m and begins at the SE line of Block #26.

Found - 235+ ceramics

- 5 obsidian blades
- We can see the tops of stones along the SW line, showing that the wall perpendicular to Homer, continues through this Block.
- 2 pieces of baguette

128T/79 40-~~80~~<sup>90</sup> cm down in Block #28, from the northernmost datum point. This makes the floor level with that of Block #26. The wall perpendicular to Homer, dwelling NW-SE, will be known as Lionel Hutz. It's not too well preserved, and extends as far as 30cm into the Block from the SW. We're in Fill

Found - ~~235~~<sup>300</sup>+ ceramics - rough est., probably much more

Very soft  
soft fill

- 1 obsidian chip
- 2 shells
- 1 tooth, probably of a deer or cow - definitely a herbivore
- 5 bone chips / pieces - no real provenience.
- 4 pieces of baguette

3/11/96

- continue

- It's raining and cold. It's pretty hard to take notes, so if they're messy, it's not my fault. Actually, I guess it is, but I like to pass the buck.

- 190+ ceramics
- 1 obsidian blades
- 3 shells

1281

3/11/96

Bay, Oscar<sup>2</sup>, Milton + Paolo

P96-95-56

1282/80/ 0-40 cm down from the datum point marked on the northernmost stake of Block #29, which measures 1m x 1m and begins at the SE line of Block #28. This run is a bitch. It's too much of a hassle just to keep everything dry. My workers' morale is low, they don't seem like they want to work, which I guess isn't much different than a sunny day - I just wanted to say that.

Found

- 130+ ceramics

- 4 obsidian blades

- We're getting into soft dirt, towards the last centimeters of course. I can see some stones in the same general line as Level 10tz, but I can't say whether they're part of Lm.

1282/81/ 40-<sup>100</sup>cm down from the datum point marked on the northernmost stake of Block #29. We're really getting into softer dirt. - Do to their energetic work habits now that it's quite sunny, we went deeper than expected.

Found

- 350+ ceramics, some nice pieces of figurines

- 5 pieces of jaguar

- 5 shells

- 6 obsidian blades

- Carbon sample, 40-50cm down/ as fine as we've gotten before

\* Very soft, fine soil

definitely in fill, but not quite

\* There's a wall 65cm down and as wide as 70cm that splits Blocks #28 + #29. This is most likely "Groundskeeper 4Mre". "Level 10tz" continues along the SE line, continuing as far as 30cm into the block.

[1282]

3/12/96

P96-95-57

[1282/82] 0-40 cm down from the northernmost datum point of Block #30, which measures 1m x 1m and begins at the SE line of Block #29. We're continuing to follow "Lionel Hutz", hopefully until it meets up with "Ralph Wiggam". The first 10-20 cm are moderately soft, it's surface, ~~and the rest is the same, packing, but it is associated with the fill and is~~ ~~been hitting~~. The lot is at a slant, <sup>up</sup>, so we're not getting into <sup>6.11 just yet</sup>.  
Found - 210+ ceramics - 5 obsidian chips/blades  
- 1 shell - one chunk of chert  
- no real sign of Lionel Hutz just yet, nor Ralph Wiggam.  
These next 20 cm should show something, I'd bet my life on it.

[1282/83] 40-60 cm down from the northernmost datum point of Block #30, which measures 1m x 1m and begins at the SE line of Block #29. We'll probably be getting into fill anytime soon.

Found - 485+ ceramics, many elaborately decorated, w/ fragments of figurines  
- 5 blades/chips of obsidian  
- 5 shells / shell pieces  
- 1 worked bone (polished)  
- Lionel Hutz seems to retreat to the SW, for it doesn't really fall into Block #30, however we can definitely see it. Our big find was the corner where Ralph Wiggam and Lionel Hutz intersect. Ralph extends 45 cm into the Block from the SE, and is 45 cm from the datum point. We'll extend Block #30 50 cm, to find the back of Ralph Wiggam.

3/12/96 1287/84

P96-95-58

1287/84 We've added an extra 50cm x 1m lot on the SE end of Block #30. We'll go down ~~to~~ to the same level as the rest of the Block (probably 90cm), defining Ralph Wiggum as we go.

Found - -125+ ceramics

- 3 obsidian blades/chips

- 1 chunk of chert

- "Ralph Wiggum is 60cm in width, and begins 35cm from the SE line of Block #30. A small portion (35cm from SW line) of Ralph was taken-out, destroyed, etc. because of a large root.  
- continue tomorrow -

3/13/96

Found - 3 ceramics

x We've located another wall, possibly an extension of Lionel Hutz past Ralph Wiggum. It's 35cm into the Block along the SW line, looking as though it begins off the back end of Ralph, although that may be because Lionel Hutz retreats to the SW <sup>around</sup> 70cm before hitting Ralph. The wall is 65cm from the datum point, roughly level with the area "destroyed" by the root.

1287/85 - I originally asked Milton to only go 40cm down. He decided to stop after 90. So, 0-90cm down from the northernmost stake of Block #31, which measures 1m x 1m and begins along the NE line of Block #30, starting at its NW line. Ralph Wiggum is 50cm down from the datum point, and fills 25cm into Block #31.

Found - 3 shells

- 1 hieroglyphic inscription on a pot shard

Found 40-60cm

- 5 obsidian blades/chips

- 1 1/2 of a stamp - squarish spiral design

Found 40cm

- 1 mold - Found 40-60cm

- 260+ ceramics



[128I] 3/13/96 Bryan, Oscar-2, Milton + Pablo PG-95-59

[128I/86] 90-110cm down in Block #31, from the northernmost datum point. We're down to maybe the bottom of Ralph Wiggam. We'll add 50cm on the SE line, as we did with Block #30, just to better define it.

Found - 65+ ceramics - 7 obsidian blade pieces

3/14/96 [128I/87] We've added 50cm x 1m on to the SE line of Block #31, just to better define Ralph's outer facet. We can see "Grandpa Simpson" coming from the bottom 0-65cm down from the northernmost stake of the 50cm x 1m addition. Ralph is as wide as 70cm, and rises 65cm above "Grandpa".

Found - 35+ ceramics;  
- 2 obsidian blades

[128I/88] 0-50cm down from the northernmost datum point of Block #32, which measures 1m x 1m and begins off the SE line of Block #30. This is to follow what looks like a continuation of Level 1b, past Ralph Wiggam. It appears that Level may stop at the NW line of this Block, but there are stones in line that may show a continuation. Plus, we're next to a tree whose roots are running all over the place, which very well could've destroyed much of the constructions. Milton, on one of his coal-mining stunts, removed a large rock, which was probably part of Grandpa Simpson, but other than that, we've seen no real evidence of a line between Grandpa or Nelson like I thought.

Found - 3 obsidian blades/chips  
- 75+ ceramics  
- 1 piece of chert

128AE/1 3/11/96

Bygn, Oscar 2, Milton + Pablo

896-95-60

128AE/5 20-60cm down in Block #2 from the southernmost datum point.

We've hit lots of rocks, some of which seem to be vertically aligned along the NW and SE sides, each sticking approx. 20cm into the Block. I figure these could be walls or steps, so I'm starting a new Block from the NW line of Block #2, to find the line along that way.

Found - 40+ ceramics - 3 pieces of bijouque  
- 2 obsidian blades

128AE/6 0-<sup>2</sup>10cm down from the southernmost datum point of Block #3, which measures length and begins at the NW line of Block #2. We're following, or trying to define, the row of vertical stones along the NW line of Block #2. Ed reminded me that we may be getting into backfill from something, probably the mound to the SW, as seen by the higher ground.

Found - 20+ ceramics - We're hitting some fossils  
- 1 chunk of bijouque

128AE/7 20-40cm down from the southernmost datum point of Block #2. It's probably safe to assume that we've past the backfill layer of soil.

Found - 30+ ceramics - 4 pieces of bijouque  
- 3 obsidian blades - We're beginning to see stones in possible alignment with the stones along the NE line of Block #2, as well as along the NW line.

3/11/96

128AE

Bayan, Oscar<sup>2</sup>, M/Am + Palo

PSG-75-61

\*128AE/7/cont'd (40-45cm down) on our next attempt to go 60 cm down, we hit a lot of tumble, as well as bone. We're going to group these 5cm back into 128AE/7, as we plan ~~to~~ dig a new block at the SW line of Block #3, along the NW line of Block #1

Found - 17 ceramics - Bone shards, along NW line, 50cm from Western corner, 45 cm down  
↑  
~~add to page before~~ - 1 piece bagavere

128AE/8 0-20 cm down from southernmost datum point of Block #4, which measures 1m x 1m and begins at the NW line of Block #1. After being confused by Block #3, we're reflecting to the SW and taking another approach toward what is tumble and what are walls.

3/12/96 - A cow just mistook page 47 of my notes for a free tossed-saled, chomping half the page. "A cow ate my homework" - I'm not sure how that'll hold-up. I grabbed the 500lb. beast by the horns and dragged to the ground, tweaked it's nose and let him go. I couldn't kill it. However, I think I'll eat hamburger tonight, and I hope it was someone he knows.

Found - 4 pieces of bagavere - 25+ ceramics  
- 2 obsidian blades - one

128AE/9 0-40cm down from southernmost datum point of Block #4. We've hit a lot of tumble now, and we're still perplexed by the row of stones along the SE (NW line of Block #1) line of the block. We're going to go deeper.

Found - 30+ ceramics  
- 1 piece bagavere

3/13/96

128AE

Bryan, Oscar<sup>2</sup>, Milton, + Pello

P96-75-68

128AE/10 40-70 down in Block<sup>#</sup>4, from the southernmost datum point. We removed alot of tumble, trying to distinguish if the vertical row of large stones in between Blocks<sup>#</sup>1 + <sup>#</sup>4 is/was a wall. We found no real evidence, except possible a "row" of medium-sized stones along the NW side of the stones. If they are a wall, it was a weak one, and isn't well preserved at all.

Found - 85+ ceramics

- 7 pieces of bazerque

- 1 Asdran blade + an odd turquoise stone - looks like copper

128AE/11 45-90cm down from the datum point on the westernmost stake of Block<sup>#</sup>3 (since we can't really use the southernmost, the west would be the next best thing). We removed alot of tumble, but didn't hit really any artifacts until we removed a large stone around 80cm down. There seems to be a row of stones in line with those from Blocks<sup>#</sup>1 + <sup>#</sup>4, at 50cm wide, 35m of which is in Block<sup>#</sup>3 along the SE line. The depth varies, but it's an average of 80cm from the western datum point.

Found - soil is somewhat soft, but not quite like the fill at the summit.

- 125+ ceramics

- 8+ pieces of bazerque - one sizeable chunk

- 1 Asdran blade piece.

128AE/12 60-70cm from the southernmost datum point of Block<sup>#</sup>2.

We just removed tumble and such, better defining the new "Principal Shimmer" which runs SW-NE, at 50cm wide, 15cm of which fall along the NW line of Block<sup>#</sup>2. Principal Shimmer is only 50cm down from Block<sup>#</sup>2's datum point.

Found - 70+ ceramics - some elaborately decorated

- 1 chunk of metal

3/14/96

P96-9563

128AE/16<sup>3</sup> 0-30 cm down from the southernmost datum point of Block #5, which measures 1m x 1m and begins 2m from the SW line of Block #1. Lots of tumble

Found - 3 pieces of biface  
- 70+<sup>(?)</sup> ceramics, one ring-like disk

128AE/17<sup>4</sup> 30-50 cm down from southernmost datum point of Block #5, which measures 1m x 1m and begins 2m from the SW line of Block #1. We're still in tumble.

Found - 15 ceramics

3/15/96 128AE/18<sup>5</sup> 50-70 cm down from the southernmost datum point of Block #5, which measures 1m x 1m and begins 2m from the SW line of Block #1. We removed some very large tumble, down to a row of stones that we thought might be a terrace. I don't think so anymore. The line is there, but there aren't many nice stones behind them. Principal Shmaer continues toward the NE along the NW line, extending as far as 20 cm into the Block.

Found - 1 Aztec blade  
- 5 ceramics

128AE/19<sup>6</sup> - 70-1m down on Block #5. We're evening it with the floors of Blocks #1 + #2. "Principal Shmaer" starts 30 cm out, at 40-45 cm down

Found - ~~170~~<sup>170</sup> + ceramics

- one shard with hieroglyphic inscription

3/18/96

- one odd-looking stone Ed told me to keep

- 19 pieces of biface

- 1 conch shell

1281 (3/14/96)

P76-95-64

(1281/89) 0-40cm down from the northernmost datum point of Block #33, which measures 1m x 1m and is found along the NE line of Block #29 and the SW line of Block #19. We're trying to take out the top, surface-type soil and separate it from the silt stuff we've been getting. We were pretty successful, although the soil began getting very fine and soft towards the last couple centimeters.

Found - 350+ ceramics, many decorated

- a tooth, found 40cm down, 20cm from NE and 15 from the NW - probably an animal
- 2 chips of chert
- 4 obsidian blades
- one clay marble-like sphere

(1281/90) 40-90cm down from northernmost datum point of Block #33. We're definitely in silt, and we can see the top of "Groundskeeper Wilke". Soil is very soft.

Found - 440+ ceramics, many decorated with both paint and carvings, many figurine pieces and a few stamp pieces.

- 1 candelario piece
- 1 thin piece of what may be worked shell, I'm not sure.
- a well-fired bead piece.
- 24 shells
- one chunk of chert + 2 obsidian blades
- 6 pieces of figurine
- 1 chunk of metate

3/15/96

P96-95-65

1281/91 | 90-155cm down on Block #33, from the northernmost datum point. Milton again went on a gold digging run, since he took the Block #33 level to the bottom of Block #19 + #30, he probably took everything down an extra 10cm that was within 50cm. I tell him to stop, he says okay as he digs another hole. It might be my fault, but I can't say all the artifacts in this lot were from Block #33. A majority were, but some were found just outside, around 155cm down from #33's datum point. "Gravels keeper WMA's" runs NE-SW and extends 40cm into the Block from the NW line. It's highest point is 170cm down from the datum point.

Found - 15 shells

- 1 chunk of chert, one chip
- 8 obsidian blades/chips, including one over an inch long w/ tip
- 1 piece of bone, probably animal
- 650+ ceramics, many decorated
- 11 chunks of Bajareque
- Carbon, but not enough for a sample

1282/92 | The new lot measures 1.2 x 1m, beginning 40cm from the NW line of #33, going 60cm into #31 from the NW. We'll go 20cm down from the datum point marked on the Northernmost stake of this lot (155cm down from Block #33's datum), so, in other words, this would be 155-175cm from #33's datum. Maybe I'll just use that.

Found - 215+ ceramics, some nicely decorated

Carbon, not enough for sample - 4 shells

- 1 chip of chert, 1 obsidian blade, one stone Bechet's pyramid
- 1 human molar, found M between 165-170cm down

3/18/96

P96-95-66

(1281/93) 175cm - 195cm down in the same sized lot as 1282/92 (1.2m x 1m). We're trying to find the base of Ralph Wiggan, and/or Groundskeeper W. Mc, but they keep going. We've removed some really sizable stones, which confuses me.

Found - 95+ ceramics

- 1 Osidian blade

(1282/94) 195 - 215cm down in the same sized lot (1.2m x 1m). still no sign of the bottoms of either wall, although there are some large stones protruding into the lot at most 30cm from the NW line, and 22cm from the SE line. These really don't hinder our digging through. We're still getting rubble, or fill, wherever.

Found - 95+ ceramics

- 2 pieces of chert (one questionable)

- 2 Osidian blade pieces

- 1 bone sherd

done (1287/95) 215cm - 235cm in same lot (1.2m x 1m) in Block #33 & #31. We've run into some large rubble that I'm not sure we can remove, mostly found in the northern corner, where stones extend 30cm from NW, and 20 from NE. The S-SW corner also has stones roughly 20cm into the lot. Nevertheless, we'll keep going, for Ralph Wiggan constructs, as does Groundskeeper W. Mc, which seems to have perhaps a foundation of very large stones (those from base)

Found - 2 Osidian blades

- 1 shell

- 105+ ceramics

- 8+ pieces of Sijareque

- Around the 225cm mark, the ground was peppered

with bits of carbon and Sijareque, although not enough for a sample



1281 3/18/96

P96-95-67

1281/96 235 - 255 cm down from Block #33's datum point, in

The same 1.2 x 1 m lot size as those before. Again, the Floor is peppered with carbon, but not enough for a sample. ~~At least~~ days. The mono (well, sorry I'm starting to think in Spanish), Ralph Uzzan is still going, although we're not totally done today. We'll continue tomorrow

3/19/96

The soil has changed, not as soft as before, although the ground does seem to be peppered with carbon once again. We've finally located the bottom of "Ralph Uzzan", which makes the wall approx. 2 meters high. This shows, according to Ed, that along with the lack of evidence for earlier structures, this building was built large in its first construction, rather than a succession of additions and walls on top of one another. This in turn might suggest that these inhabitants (those of this structure) might have enjoyed a short period of power.

Found

- 100+ ceramics

- 2 obsidian chips

- 1 chunk of bone, found 250 cm down

- 5 shells

- Carbon, not enough for a sample

1281/96 - We're returning to the wall "Nelson", and are removing a lot measuring 60 cm x 1 m located in front of the wall, down to the base of the wall. We're getting very fine soil, nice & soft.

Found - bone, a cranium - may or may not be human. Located in the eastern corner of the lot (70 cm from SW line) and 20 cm up from the floor of Block #15.

1281 3/19/96

Pg 6-95-68

1282/97 / cont'd

Found

- 3 shells

- 3 obsidian blades

- floor was rich with carbon, but not enough for

- sample

- 2 pieces of byzantine

- 220+ ceramics, many elaborately decorated - including

one painting of a figure dressed in Mayan-type garb from the ~~base~~ <sup>tango</sup> ~~base~~ down. Pieces of *Opzomes* were also found. In some cases I was able to "re-assemble" parts of pots using the artifacts - these are grouped in bags.

- We found the end of Nelson, making it 1.2 m high, 30m

up from the floor we took the lot down to. There was a bit of movable rubble skirting 15cm in from the NE side, thus making the lot measure 60cm x 85cm. The floor is roughly 1.7 m from the southernmost datum point of Block #16. We are quite possibly even with the base of Ralph Uggan at the summit, meaning in the construction of this structure it's possible that they constructed most of the fills together, then filled-in the summit. - This is a theory, ... I don't know where G-pe Simpson or Flanders come in.

1281/16

~~1281/16~~

We're returning to Block #4 and going down to 100 centimeters to find the base of Krusty, which extends approx 30cm in the Block from the SW. We found the base, making "Krusty" 25cm high. (100-110cm) (lot measures 70cm x 1m)

Found

- 110+ ceramics, one nice piece of a whistle

- Carbon, but not enough for a sample

of a ceramic, I probably have a piece of it. It is 55cm from Nelson. There is a spot on the side where it looks cut and perhaps grinded to a smooth finish. I think it looks like a mechanism - see cut.

128AE/17 0-40cm down in Block #6 from southern datum point. It measures 1m x 1m and begins 3 m from the SW end of a trench roughly 6 m x 1m, crossing Str #3.

Found - 90+ ceramics

- 1 Asadman blade

- 2 pieces of Lagareque

128AE/18 40-100cm down in Block #6 from southernmost datum point.

We can see "Principal Skimmer", although it doesn't extend into the block much at all. There is a row of stones 50cm in from the SW line, which we might check out.

Found

- 1 chunk of metate

- 1 slab of rock with a square punched in it - could be natural

- 1 seemingly cut stone, could be natural again

- 2 Asadman blades

- 50+ ceramics

128AE/19 We're removing a lot 50cm x 1m in front of a possible wall in Block #6. We'll excavate to a depth of 1.3m.

- It is a definite row of stones, probably a small step or terrace, much like the "Krusty" in 1285. The construction seems

to only be 15cm tall, beginning 110cm from the datum point. There is a bit of lighter, almost white soil in a line just under the construction. It's not plaster, but much more like ash. "Principal Skimmer" seems to stop before -

Found - 65+ ceramics

- 1 Asadman blade piece

- 2 pieces of Lagareque - 2 shells

"Faleshow Bob"

"Faleshow Bob"

1128AE

P96-95-70

1128AE/20 | 0-30 cm down from the datum point marked on the southernmost stake of Block #7, which measures 1m x 1m and begins 4m from the SW end of a trench 7m x 1m crossing Str. 3 in a NE-SW manner. We've connected with Block #29 at the Summit, looking for a wall behind "Soteshore Bob."

Found - 215+ ceramics - 1 shell  
- 3+ chunks of bajareque - 1 obsidian chip

3/21/96 1128AE/21 | 30"-115 cm down from the southernmost datum point of Block #7. The lot measures 45 x 100 cm (the first 45 cm from SW line) and was removed because we hit a wall. This new terrace "Smithers" measures 55 cm in width and 90 cm in height, starting from the surface of Soteshore Bob. It looks as though a part of Level IIb rests on top of the surface.

Found - 130+ ceramics - 3 shells  
- 6 pieces of bajareque - 1 chert blade  
- 1 small bone - 1 obsidian blade

128AK Structure #4 4/17/96

996-95-71

- We're now going to excavate Structure #4 on site 128. This is a large mound, not as well preserved as Structure #3, making it difficult to find its limits. Along the NW side, much of the mound has been destroyed for a road.

128AK/01 Block #1 measures 1m x 1m and begins at the SW end of a trench roughly 24m x 1m, crossing str. #4 in a SW-NE fashion. We're going 0-10cm down (surface).  
- from southernmost datum point

Found

- 3 ceramics
- soil's very dark and wet, mostly due to the rain last night

128AK/02 10-20cm down in Block #1, from southernmost datum point

Found

- Nothing
- soil still dark and moist

\* I just got an unprecedented 4 hugs from Pablo

128AK/03 0-10cm down in Block #2, which measures 1m x 1m and begins at the NE end of a trench roughly 24m x 1m, crossing str. #4 in a SW-NE fashion. Take from southernmost datum point

Found

- Nada, soil's soft and a lighter brown from the other side, probably because it's in the sun

128AK 4/17/94 Str. #4

P96-95-72

128AK/04 20-40 cm down in Block #1. We hit some large stones (2) but nothing special. ~~SEP~~

Found - dirt is rather fine + dark, but lighter than before  
- a few ceramics (7+)  
- 1 biface chunk

128AK/05 40-60 cm down in Block #1. Soil remains the same

Found

- around 10 ceramics  
- 2 pieces of biface

128AK/06 10-30 cm down in Block #2 at the NE end.

We hit a lot of flint, some rather large. Soil remains the same.

Found - 3 pieces of chert

- around 30 ceramics, nothing too ~~special~~ special  
- chunk of smoothed pebble, about size of a baseball

128AK/07 0-20 cm down in Block #3, which measures 1m x 1m and begins 1m from the SW end of a trench crossing Str. #4 in a SW-NE fashion. (Surface). Soil's the same.

Found

- 10 ceramics  
- 1 piece of biface

128AK/08 This is the intact bowl we found while excavating Lot 128AK/10. The bowl is 12 cm in diameter, roughly 3 cm from the NE line and 42 cm from the SE side of Block #2. See sketch #1 - 128AK

128AK/4 4/17/96 Str. #4

PG6-75-73

128AK/09 - 20-40 cm down from southernmost datum point of Block #3. Same type of soil, we're beginning to hit some rubble.

Found - about 9 ceramics

- one small bone, most likely animal, about 25 cm down

128AK/10 30-50 cm down from northernmost datum point

of Block #2. Lots of rubble. Soil hasn't changed.

Found - 80+ ceramics - 1 bone, probably animal, found

- 9 obsidian blades about 5 <sup>cm</sup> south from the soil

- An intact bowl (see 128AK/08), and soil sample

- There was alot of bits of carbon around the bowl, but no chunks large enough for a sample

128AK/11 40-60 cm down from southernmost datum point of Block #3. We hit a small amount of rubble. Soil's constant

Found - 40+ ceramics

- 1 chunk of biface

4/18/96 128AK/12 - 0-20 cm down from the southernmost datum point of Block #4, which measures 1m x 1m and begins 2m from the SW end of a trench crossing Str. #4 in a SW-NE fashion. (Surface)

Found - 50+ ceramics

128AK/13 - 50-60 cm down in Block #2 from northernmost datum point. The ground is very ~~hard~~ hard and soil is pretty dark.

Found - 15+ ceramics, 4 obsidian blades

128AK Str. #4 4/18/96

PG-95-74

128AK/14 20-40cm down from southern dip. of Block #4  
which begins 2m from SE end of the trench  
Found - 10 ceramics

128AK/15 0-20cm down from the northernmost dip. of  
Block #5, which measures 1m in and begins 1m  
from the NE end of a trench crossing Str. #4 in a  
NE-SW fashion. (Surface)

Found - 10 ceramics  
- 3 pieces of a good-sized bone, probably cow or something  
too near the surface to be anything all that special.  
- 1 Assirian blade piece  
- 1 piece Sargareque

128AK/16 40-70cm down from southern dip. of Block #4, making  
it level with the blocks #1 + #3. Soil really hasn't  
changed all that much throughout the trench so far. We  
hit alot of rubble in this lot.

Found - 60+ ceramics  
- 1 Assirian blade piece

128AK/17 20-40cm down in Block #5. We're seeing  
tops of rubble, and the ground seems to be getting harder.

Found - 30+ ceramics  
- 1 Assirian blade piece  
- 1 odd rock, probably natural



128AK Str. #4 4/18/96

P96-95-75

128AK/18 0-20 cm down from the <sup>south</sup>~~south~~most d.p. of Block #6, which measures 1m x 1m and begins 3m from the SW end of a trench crossing Str. #4 (Surface). We can already see the top of tumble  
Found - 65 ceramics  
- 2 obsidian pieces

128AK/19 20-40 cm down from the <sup>south</sup>~~south~~most d.p. of Block #6. We removed some tumble, and are hitting more.  
Found - 80 ceramics  
- a bit of carbon - not enough for a sample

128AK/20 40-60 cm down from northernmost d.p. of Block #5. We hit a small amount of tumble, with the ground getting very hard around 50-60, and the soil darkening when plowed-up. Kind of a brown-black-grey  
Found - 10 obsidian blades/pieces  
- 130 ceramics - nothing special  
- 1 piece of chert - bit of burnt earth

4/19/96 128AK/21 0-20 cm down in Block #7, which measures 1m x 1m and begins 2m from the NE end of a trench roughly 24m x 1m, crossing Str. #4 in a SW-NE fashion. (Surface) We're getting into one of the first small "mounds" before the main mound.  
Found - 125 ceramics  
- 1 shell.

128AK Str. #4 4/19/96

P96-95-76

128AK/22 40-100 cm (larger than I thought) down from the southernmost datum point of Block #6. We went through a lot of trouble in this lot, leveling the bottom with those blocks before it. Like the other side of the mound, the ground was very hard, and difficult to dig-up.

Found - many bits of carbon, but not enough for a sample  
- one obsidian chip - 60+ ceramics  
- 7 pieces of bifurque

128AK/23 20-40 cm down in Block #7, which measures 1m x 1m and begins 2m from the NE end of the trench. The soil wasn't too tough or anything, and the severe lack of artifacts might suggest that the small mound on the NE side of the structure, might be ~~the~~ the remains of a large chunk taken from the main structure and set down. They've destroyed many mounds and parts of such around this area, and could've easily taken a piece off Str. #4.

Found - Nothing

128AK/24 0-20 cm down from the southernmost D.P. of Block #8, which measures 1m x 1m and begins 4m from the SW end of a trench crossing Str. #4 in a NE-SW fashion. Along with the last block, this block covers the small "mound" on the SW side of Str. #4.

Found - 50+ ceramics  
- 3 pieces of bifurque

128AK / Str #4 4/19/96

PG-95-77

128AK/25 20-40cm down in Block #8, which measures 1m x 1m and begins 4m from the SW end of the trench.

Found - 50+ ceramics

- 1 chunk of Bajareque

128AK/26 40-70cm down in Block #7, which begins 2m from the NE end of the trench. They said the ground wasn't that hard (even though Pablo shook his head "yes" and the other one whose name I can't think of right now said no), so either I was a complete wuss in the past two Blocks at this level, or he wasn't admit to having a bit of difficulty in order to protect his pride. The soil color has been the same throughout, except down at those levels, where the freshly-placed soil sometimes has a greyish tint.

Found - 150+ ceramics

- 1 piece Bajareque

4/22/96 - Today I just received two more workers, Jorge and Victoriano. They're going to be working on operation 128AN, which is a trench perpendicular to 128AK, hitting it from the SE. It's roughly 9m long x 1m wide. It's also fairly close to the NW end of Str. #3's axial trench, so if that Uriguan is a part of another structure, we'll probably hit it.

128AK/27 40-70cm down from the southernmost datum point of Block #8, which measures 1m x 1m and begins 4m from the SW end of the trench.

Milton complained of the soil being hard

Found - 5 pieces of Bajareque, 25+ ceramics

- one piece of chert

128AK + 128AN

Str. #4

4/22/96

P96-95-78

128AN/01 - 0-20 cm down from southernmost datum point of Block #1, which measures 1m x 1m and begins at the SE end of a trench crossing Str. #4 in a SE-NW manner. (Surface) - We've already hit some flint, medium in size.

Found - 1 piece of biface ~~belemnite~~  
- 7 ceramics

128AK/28 70-90 cm down from the southernmost datum point of Block #8, which measures 1m x 1m and begins 4m from the SW end of the trench. The ground was tough.

Found - 28+ ceramics - one nicely worked bone with a hole ~~near~~ near one end, much like a type of needle-foot

128AK/29 0-20 cm down from the northernmost datum point of Block #9, which measures 1m x 1m and begins 3m from the NE end of the trench crossing Str. #4 in a NE-SW fashion. (Surface)

Found - 5 ceramics

128AK/30 90-110 cm down from the southernmost DP of Block #8, which measures 1m x 1m, beginning 4m from the NE end of the trench. Again the ground was very hard, and this time it was very rich in carbon around 105 cm down.

Found - piece of obsidian - 45+ ceramics  
- 3 pieces of biface - 1 carbon sample

128AK + 128AN | Str. #4

4/22/96

P96-95-79

128AN/02 | 20-40 cm down from southernmost DP of Block #1, which measures 1m x 1m and begins at the SE end of a trench crossing Str. #4. We've hit a lot of tumble, different than the first Block in the aerial trench of Str. #3 (I'll have to go back and look). No real lines, even though the tumble is medium to large in size. There looks to be more below this level, but we'll go one more meter to provide a better look. We'll most likely come back to this Block.

Found - 50+ ceramics - one that seems to be a piece of a figurine

128AK/31 | 20-40cm down from the northernmost DP of Block #9 which measures 1m x 1m and begins 3m from the NE end of the trench crossing Str. #4 in a NE-SW manner. They said the ground wasn't so hard.

Found - 15 ceramics

- 1 Asadian chip

128AK/32 | 0-20cm down from the southernmost DP of Block #10, which measures 1m x 1m and begins 5m from the SW end of a trench crossing Str. #4 in a NE-SW fashion. (Surface)

Found - 20 ceramics

- 3 Asadian pieces

128AN/03 | 0-20cm down in Block #2, which measures 1m x 1m and begins 1m from the SE end of a trench crossing Str. #4 in a SE-NW fashion. Lots of tumble, very difficult to make out any lines, if there are any.

Found - 10 ceramics

128AK/33 | 20-40cm down from the southernmost DP of Block #10, which begins 5m from the SW end. They said the soil was hard once again, but the color doesn't seem to change.

Found - 35+ ceramics

- 1 chunk of Byzantine

128AK + 128AN Str #4 4/22/94

P96-95-80

128AK/34 | 40-70cm down from northernmost DP of Block #9, which measures 1m x 1m and begins 3m from the NE end of the trench. They said the ground was a little harder, and for the first time we can see the tops of small stones, although we probably won't go further.

Found - 120+ ceramics - 3 pieces of biregure

4/23/96

128AN/04 | 20-50cm down in Block #2, which measures 1m x 1m and begins 1m from the SE end of a trench crossing Str #4 in a NW-SE fashion. Lots of tumble, no absolutely clean lines. There is one possibly, running along the SW line, protruding as far as 27cm into the block, but its direction is puzzling. I would think we'd hit horizontal lines. Nevertheless, if it is a line, it could be much like the Principal Stammer of Str. #3

Found - 1 Assorted blade

- 25+ ceramics - one possible mold

128AK/35 | 40-80cm down from southernmost DP of Block #10, which measures 1m x 1m and begins 5m from the SW end of the trench. We've uncovered a wall down 60cm that is constructed of a row of five large cobbles (avg. 31x15x10) laid at  $50^{\circ}/23^{\circ}$ , forming a line at an  $31^{\circ}/39^{\circ}$  angle. This is because of this is the angle of the building, we have to adjust the trench, and the summit, or most of it, looks to have been taken away by the construction of the road. I'm going a meter further just to be sure.

Found - 80+ pot sherds - one of which has some carbonized material on it, although I don't know how good it'll be because it's been touched a lot.

- 3+ pieces of biregure

128AK + 128AW Str. #4 4/23/96

P96-95-81

128AK/36 0-20cm down from the northernmost stake of Block #11, which measures 1m x 1m and begins 4m from the NE end of the trench crossing Str. #4 in a SW-NE manner.

Found - 15 ceramics

128AK/05 0-20cm down in Block #3, which begins 2m from the SE end of a trench crossing Str. #4 in a SE-NW fashion. (from southernmost point). Lots of Tumble.

Found - 80+ ceramics

- 5 pieces of Lagaveque

128AK/37 20-40cm down from the northernmost stake of Block #11, which measures 1m x 1m and begins 4m from the NE end. The soil wasn't hard.

Found - 5 ceramics

128AK/38 0-20cm down in Block #12 (from southernmost OP) which measures 1m x 1m and begins 6m from the SW end of a trench crossing Str. #4 in a SW-NE fashion. The ground seems pretty hard, and we are on the beginning of the steep slope of the mound.

Found - 40+ ceramics

- 1 Jordan Blade

- 1 piece of Lagaveque

128AK/39 20-40cm down in Block #12, which measures 1m x 1m and begins 6m from the SW end of the trench crossing Str. #4 in a NE-SW fashion. Oscar said the ground was pretty hard. No change in color though!

Found - 40+ ceramics

- 15+ pieces of Lagaveque - pretty plentiful

128AK + 128AN

Str. #4 4/23/96

P96-95-B2

128AK/40 40-60cm down in block #11, which measures 1m x 1m and begins 4m from the NE end. They said the ground wasn't that hard. The most astonishing find was a small glass marble, from perhaps the 1920's game "Stacy's Move". This shows one of 2 things: 1) either the inhabitants of this area were very established glass-blowers; or 2) this mound we're going through (not the main one) is simply a pile of soil and rock and sherds taken off the main mound or somewhere else. I like the glass-blowing idea, but I don't think it'll hold-up.

Found - one marble, a nice rainbow of colors

- 10+ pot sherds

128AN/065 - 20-50cm down from southernmost datum point of Block #3, which measures 1m x 1m and begins 2m from the SE end of a trench crossing Str. #4 in a SE-NW manner. We've uncovered a wall, running along the NW line, but it doesn't extend into the Block except for a small slit roughly 70cm down from northern stake. This part extends 18cm into the Block. The wall seems to consist of mostly cobble (avg. 10x2cm) and smaller stones, summing around 17 layers (including the bottom part) for around 90cm.  $58^{\circ}238'$  is it's angle.

Found - 5 pieces of beforeque

- 35+ ceramics

128AK/41 40-80cm down in Block #12, evening the bottom with the surface of the newly found wall or terrace. #12 begins 6m from the SW end of the trench. There are no signs of any walls ahead, but I expect some soon.

Found - 75 ceramics

- 1 shell

- 75+ pieces of beforeque - once again, it was plentiful



128AK + 128AN Str. #4 4/24/96

PS645-83

128AK/42 60-90cm down from the northernmost datum pt. of Block #11, which begins 4m from the NE end. After what seems like miles and miles of dirt, we finally hit some tumble, or at least can see the tops of it. We aren't going any further down because there doesn't seem to be a line or anything. We now know how far down to go.

Found - 75+ ceramics - 3 pieces of bryozoa

128AN/07 0-20cm down from the southernmost OP of Block #4, which measures 1m x 1m and begins 3m from the SE end of a trench crossing Str. #4 in a SE-NW fashion. Still lots of tumble, with bits of smaller cobbles atop the wall found in Block #3, which would mean that the top layer has possibly fallen off. It's not very flat on this level, though some stones could be removed. We'll do that later though.

Found - 40+ ceramics - 5 chunks of bryozoa

128AK/43 - We've discovered a line, practically at the surface level of the southernmost stake of Block #14. It looks to be a rather large wall, although all we've found is the top row of large cobbles. We excavated from this level back into the ground, as much as 40cm:

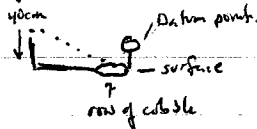

the front of this line,

the wall. It seems the top stones have slid substantially to the SW.

We'll most likely excavate to better define

Found - 55+ ceramics

- 2 obsidian blades/chips, 1 chunk

128AK/44 0-20cm down in Block #13 (from northernmost stake), which measures 1m x 1m and begins 5m from the NE end of a trench crossing Str. #4 in a SW-NE manner.

Found - 35 ceramics

(128AN/08) 50-~~100~~<sup>90</sup> cm down from southernmost stake of Block #3. We removed dirt and tumble from the front of the wall, in order to find its base. It seems the wall might've been built in two parts, the top 70cm and the bottom half, ~~which~~ whose base we're trying to find. They said the ground was tough towards the bottom, and we're getting the same type of soil we've had all throughout the structure.

Found - 120+ ceramics

- 1 bone, not well preserved, no provenience because they thought it was a stone

(128AK/45) (Roughly) 0-40 cm down in Block #14, which begins 1m from the SW end of the trench, and measures 1m x 1m. In order to find the supposed wall under the 3 large stones found in lot #43, we had to remove the large cobbles (one of which measured  $78 \times 37$  cm). But to our surprise, there was nothing underneath. The supposed tumble that was to the NE of the line was removed also, only to find no more stones. It seems those stones might've been set only on dirt, which is very odd. If it was supposed to be a well, it certainly wasn't a strong one. We'll go 30cm further down most likely. They're still complaining of the ground being very hard.

Found - 2 pieces of biquaque

- 20 ceramics

at The "wall" was at an angle of roughly  $332^\circ/152^\circ$  and wide as 37cm. It also stood 1.2m (roughly 4' 3") above "Rusty Stairs" (the first small terrace) and was virtually on the <sup>SE</sup> line of Block #14.

(128AN/09) ~~100-150~~<sup>90-100</sup> cm down from the southernmost stake of Block #3. We've found the base, making the wall "Jack Sikma" around ~~115~~ 115cm high. The bottom 45cm is constructed of small to medium cobbles (range  $10 \times 30$  cm to  $3 \times 7$  cm). No obvious layers.

Found - 50+ ceramics

- carbon (on the floor - not enough for a sample)

128AK/128AN Str. #4 4/24/96

P96-95-B5

128AK/46 70-90 cm down from ~~Block~~ the northernmost DP of Block #9, which crosses Inxian and begins 3m from the NE end of a trench crossing Str. #4. After hitting dumble in Block #13, we retreated to #9 and went 20cm further, just so we won't miss a possible Ines.

Found - carbon, not enough for a sample  
- 150+ ceramics  
- 15+ pieces of Sagareque

128AK/47 40-60 cm down from the southernmost DP of Block #14, which begins 7m from the SW end of the trench. No dumble, hard ground, and Alton had me note a change in soil color, but it was around a root. Overall the soils been brown with an orangish tint, mixed in with an occasional greyish tint. It's very tough to go through though.

Found - 20+ ceramics  
- 9 pretty good chunks of Sagareque - very plentiful  
- 1 chip of obsidian

128AN/10 - We simply cleaned off the top of Jack Schuman. Probably could take some more off, but this is okay, we'll go to the next meter.

Found - 35 ceramics - one with a potential hieroglyph  
- 4 pieces of Sagareque

128AK/48 90-110 ~~80-100~~ cm down from the northernmost DP of Block #11, which begins 4m from the NE end of the trench. We're trying to go into Block #13 at the level of the dumble. Pablo said the ground was hard at this level.

Found - 150+ ceramics  
- 5 pieces of Sagareque  
- 5 pieces of obsidian

12BAK + 12BAN Str. #4 4/25/86

P56-95-86

12BAK/49 0-20cm down from the southernmost DP of Block #15, which measures 1m x 1m and begins 8m from the SW end of a trench crossing Str. #4 in a NE-SW fashion. (Surface)

Found - 90+ ceramics - 1 chunk of b-javagoe - 1 obsidian chip

12BAN/11 0-20cm down from the southernmost DP of Block #5, which measures 1m x 1m and begins 4m from the SE end of a trench crossing Str. #4 in a NW-SE fashion. We have a possible line 40cm in from the SE line about 10cm from the DP. We'll go 20 more in front of it, and remove some rubble on top, to better define it. Tumble

Found - 3 pieces of b-javagoe - 25+ ceramics

12BAK/50 20-40cm down in Block #15, which begins 8m from the SW end of the trench. We've hit a row of stones as far as 10cm from the SW line of the block, angled much like Rusty Stab. I don't think it's anything sharp, because there's nothing underneath them, much like the line in the block before. This has another two large rocks underneath it (avg. 18x24cm), actually, but nothing else. This is all very confusing

Found - 50+ ceramics - 3 pieces of b-javagoe

12BAK/51 110-120cm down in Block #11, which is 4m from the NE end of the trench. This was to level the base with the block before.

Found - 45+ ceramics - 4 pieces b-javagoe

128AK + 128AN Str. #4 4/25/86

PG6-35-87

128AK/52 40-50cm down in Block #15, which begins 8m from the SW end of the trench. We stopped at 50cm because we hit alot of stones (avg. 18x24cm). There doesn't seem to be anything below them, and they are around the same level <sup>as</sup> the rubble and line of the block below. We're going to go to the next block and see if this pattern continues. It's still odd that all these stones are only on dirt.

Found - 12 ceramics

~~128AK/52~~

128AN/12 20-40cm down in Block #5, which begins 4m from the SE end of a trench crossing Str. #4 in a NW-SE manner. The line 40cm from the SE line of the block is indeed a wall, and will go a bit deeper to find its base.

Found - 6 chunks of bijouque

- 65+ ceramics

- one chip of chert

- 1 chip of obsidian

128AK/53 20-40cm down in Block #13, which begins 5m from the NE end of a trench crossing Str. #4 in a NE-SW fashion.

Found - 3 ceramics

- one skull - maybe rat or mouse

128AN/13 40-50cm down in Block #5, which measures 12x12m and begins 4m from the SE end of the trench. The wall in this block, "Artes 65more" consists of moderately large stones (avg. 25x10) stacked in four layers (only four layers have been uncovered so far, there seems to be a section of B11 in between Jack Shima and Artes) at an angle of 34°/219° at 45cm high (above the block bottom).

Found - 8 chunks of bijouque

- 100+ ceramics

12BAK/12BAN STR #4 4/25/96

P16-95-88

~~12BAK/54~~ 0-20cm down in Block #16 which measures 1m x 1m and begins 7m from the SW end of a trench crossing Str. #4 in a SW-NE direction. Depth is taken from the southernmost D.P. It's surface, with tumble.

No obvious lines just yet.

Found - carbon chunky, but Oscar handed it to me - 3 Assiran pieces  
- one ceramic piece with rounded edges, not a pot shard, but I can't say what it is.  
- 9 pieces of Bajareque - 100+ ceramics

12BAK/55 40-60cm down from the northernmost D.P. of Block #13 which begins 5m from the NE end of the trench. We're hitting a few sizeable pieces of tumble

Found - 7 ceramics

12BAK/56 60-80cm down from the northernmost D.P. of Block #13, which begins 5m from the NE end of the trench. Some tumble.

Found - 5 ceramics

12BAN/11 - As soon as we began Block #6, we hit a possible addition on top of Artes 61more. It rises 25cm above Artes, is 65cm wide at largest point, and is made of of rubble (avg. 15x18). There is (seems to be) nothing but soil behind it. We'll start a new square. We went as far down as 40cm from the northernmost stake.

Found - 20+ pieces of Bajareque (plentiful) - 190+ ceramics - one piece  
- 1 piece of Assiran

128AK + 128AN Str. #4 4/25/16

P96-95-89

128AK/57 | 20-40 cm down on Block #16, 9m from the SW end of the trench. Run into Tumble.

Found - 90+ ceramics

- few pieces of biface

- 1 obsidian chip/blade

128AN/15 | 0-20 cm down from the southernmost DP of Block #7 which measures 1m x 1m and begins 6m from the SE end of a trench crossing Str. #4 in a NW-SE manner. Surface

Found - - 20+ pieces of biface - pretty plentiful

- 125+ ceramics

128AK/58 | - 40-60 cm down on Block #16, 9m from the SW end of the trench. We're at, it's not close to, the summit. There are no stairs, ladders or walls, and we're at the level of the "tumble" found on the previous block. Oscar said the ground was pretty hard. I'm getting pissed here. You'd think the inhabitants would make it easy...

Found - 120+ ceramics

- 20+ pieces of biface

- Carbon sample, along NB line, 50cm down

- 4 obsidian chips/blades

- 1 chip of chert

- bits of bone, not well preserved - little chunks - no preservation

128AN/16 | 20-40 cm down from the southernmost DP of Block #7. No rocks, no nothing - just dirt. This may just be SM behind Aris.

Found - 5+ pieces of biface

- 110+ ceramics

128AK + 128AK Str. #4 4/26/96

P96-95-90

128AK/59 80-90 cm down on Block #13, 5 m from NE end of the trench. There seems to be plenty of bajareque on the floor, mixed with burnt earth. Along the SW line of the block, there seems to be a faint layer of burnt earth approx. 6 cm thick.

Found - lots of bajareque / burnt earth  
- 90+ ceramics

128AK/60 0-10 cm from the southernmost DP of Block ~~17~~ #17, which measures ~~10~~ 1m x 1m and begins 10m from the SW end of the trench crossing Str. #4 in a SW-NE fashion. We hit rubble quickly, no lines were obvious. There was a possible line, but like the other possible walls, nothing but sherds, soil and bajareque <sup>are</sup> underneath it. We went as far as 8cm underneath the line (which is on the SW line of the block) down to the floor of the ~~block~~ previous block. (8cm x 100cm x 45cm). 2m down bounded. It looks to all be rubble. There aren't any support stones anywhere. Usually if you find ceramics underneath the stones it's a pretty good sign those stones were double. Damn those masons.

Found - 1 chip obsidian - 75 ceramics  
- 5+ pieces of bajareque



128AN+128AK Str. #4 4/26/96

P96-95-91

128AN/17 - We first cleaned the dirt off the tumble on the surface.

Then after finding no lines, we began by removing a section 30cm x 100cm beginning from the SE line of the block, down 30cm from the southernmost DP of Block #8, which measures 1m x 1m and begins 7m from SE end of a trench crossing Str. #4 in a SE-NW fashion. I'm ~~not~~ afraid we're running into the same problem we're running into with the summit section of trench 128AK.

Found - 100+ ceramics

- 7+ pieces of belemnite

- 1 chip of Jordanian

128AK/61 0-20 cm down in Block #18, which measures 1m x 1m and begins 6m from the NE end of a trench crossing Str. #4 in a SW-NE fashion. We can see the top of the tumble.

Found 3+ pieces of belemnite (small) - 5+ ceramics

4/29/96

- After hitting a bunch of ~~tumble~~ <sup>tumble</sup> at the summit w/ no lines anywhere, we're beginning 2 new trenches: 128AQ, which begins 1.5 m from the NW line of Block #12 in trench 128AK; and 128AR which begins 2m from the NE line of Block #3 in trench 128AN. 128AR is for the purpose of picking up Jack Silman again, and to perhaps find a corner. 128AQ is an attempt to re-locate the line found in Block #14 that was taken out because it had no support. 128AQ might also tell us just how much we have towards the cut on the NW side of the structure.

128AK, 128AQ, 128AR, 128AN Gr. #4 4/24/96

P96-55-92

128Q/01 0-20 m Block #1, which measures 1m x 1m and begins 1.5m NW of Block #12 m 128AK. Nothing yet, Z didn't expect anything. - We're going to end here for now and return to the Summit. Ed believes all the tumble on dirt might mean there's an earlier structure underneath. We'll come back to 128Q later.

Found - 40+ ceramics - one odd stone, might have been something  
- 2 chunks of Lignite - one quite sizeable

128R/01 0-20 cm down m Block #1, which measures 1m x 1m and begins 2m NE of Block #3 m 128AN. We hit tumble, and can tell we're close to Jack Stone. But like 128Q, we're going to quit here and return to the summit. We'll be back though.

Found - 10 ceramics - 5+ pieces of Lignite

128AK/62 20-50cm down m Block #18, which measures 1m x 1m and begins 6m from the NE end of the trench. We've hit a lot of tumble, hopefully because we're close to the structure. We'll begin removing tumble strategically, down to the floor of Block #13 m sections so we don't miss a wall.

Found - 7 ceramics

128AK/63 10-40cm down m Block #17, which begins 10m from the SW end of the trench. On suggestion by Ed, we removed the tumble and continued to look for lines - nothing. There is a stack of stones along the NW line which I think we might leave for now, but I don't think it's anything. The ground seems to be rich in lignite or burnt earth (most evident in the northern corner and the NW line) and carbon (which seems to be everywhere). The highest density of lignite/possible burnt earth consists in a section 45cm by 30cm, beginning from the Northern corner.

Found - 120+ ceramics 3 wooden chips