

1995

PVN-063-Gevock Delahaye-Field Notes-1995

Cecile Gevock-Delahaye
Kenyon College

Follow this and additional works at: <https://digital.kenyon.edu/honduras>

 Part of the Archaeological Anthropology Commons

Recommended Citation

Gevock-Delahaye, Cecile, "PVN-063-Gevock Delahaye-Field Notes-1995" (1995). *Four Valleys Archive*. Paper 8726.
<https://digital.kenyon.edu/honduras/8726>

This Field Notes is brought to you for free and open access by the Anthropology at Digital Kenyon: Research, Scholarship, and Creative Exchange. It has been accepted for inclusion in Four Valleys Archive by an authorized administrator of Digital Kenyon: Research, Scholarship, and Creative Exchange. For more information, please contact noltj@kenyon.edu.

P95-63-01

~~1/30/95~~ 1/30/95

Morning:

We chose our mound, cleared it. Put the trench line down oriented E-W. The trench is 17 m long and 1 m wide. And we did a surface collection, pretty poor in this mound (St1).

Surface collection = Lot \emptyset

Afternoon:

We started digging in 400 N. 600 E Lot 1 and we took it down to centimeters (rich ceramics)

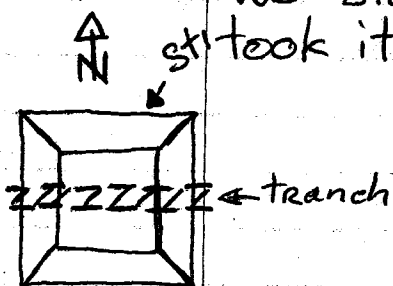

1/31/95

Morning:

we finished excavating Lot 1 and dug Lot 2 (400N-601E Level 1 0-10cm), Lot 3 (400N-

616E Level 1 0-10cm), Lot 4 (400N-600E Level 2 10-20cm) and Lot 5 (400N-617E Level 1 0-10cm)

We found a stamp in Lot 2, the stamp is in really good shape, the only pieces missing are part of the handle and a little piece on the ~~in~~ edge, the design represents dancing monkeys.

No wall coming in Lot 1, Lot 2, Lot 4

Lot 4 is really rich in Ceramics.

The Lot 3 is dense in rocks but looks like tumble and ~~apparently~~ apparently keep going in Lot 5 and 6 (400N-617E Level 2 10-20cm) but a lot less dense.

The Lots 3, 5, 6 are not really rich in Ceramics.

Lots 4, 7 (400N-600E Level 3 20-40cm*) are ~~rich~~ dense in Ceramics. it's ~~like~~ looks like the ceramics

~~were eroded down~~ were eroded down.

*we missed a level because problem communication.

P.S.: I had to expand the trench 1 more m on the East Side

P95-63-02 1/31/95

we found an obsidian blade in Lot 4 and a piece of figurine, one ceramic pearl in Lot 7.

Afternoon:

Continued the dig of Lot 7 and start digging in Lot 8 (400N-617E Level 3 20 → 30cm). We may find a platform in 400N-617E who was ~~East~~ East of St 1. there's still a lot of ceramics in Lot 7. we may be in midden in Lot 9. we got a ceramics floor in Lot 11 (400N-600E L5 50 → 60cm) refer to [Lot 9 (400N-600E L4 40 → 50cm)] draw D95-63-01

2/1/95

Morning:

we took out the ceramics floor in Lot 11. ^{we will keep} ~~excavating~~ excavating in Lot 10 (400N-617E L4 30 → 40cm) and will begin Lot 12 (400N-617E L5 40 → 50cm) there is no platform yet.

Lot 11 is still really dense in Ceramic, we may get close to the living floor. we found an over piece of figurine (Hand and Arm parts) in Lot 4.

We found also a entier incense burner (Monkey Face) in Lot 9. The obsidian is more dense in Lot 12 (1 blade ~~and~~ + a few blade fragments) so we did screen the final centimeters. we found one more piece of figurine (Face part) in Lot 4.

we started digging in Lot 13 (400N-617E L6 50 → 60cm) and screen the dirt ~~in~~ to see if we are not missing any obsidian tools.

we started excavating in Lot 14 (400N-600E L6 60 → 70cm), this lot is dense in Ceramic as the levels above it. I believe we are in a midden.

We found a whistle with a nonhuman face in Lot 13 and a fragment of figurine. No obsidian was found in the screening in Lot 13.

P 95-63-03 2/2/95

Morning:

We started excavating the Lot 15=(400N-617E L7 60 → 70 cm) and Lot 16=(400N-600E L7 70 → 80 cm).

The Lot 16 seems less dense in Ceramics.

~~There was~~ In Lot 15, it looks like we found the platform that was near to the East side of the mound (St1). This platform is predates of the mound by stratigraphy. Something seems organized in 400N-616E, like a wall.

We may get to the living floor in ~~the~~ Lot 16 because the ceramics is dense again. I'm going to open one more square meter on the north side of 400N-617E, to see what's going on with the rocks that sound organized in stratigraphy, this is going to be Lot 17=(401N-617E Level 10 → 10cm)

In Lot 16, the sediment until now has been brown top soil and changed to a silty texture. We started digging the Lot 17, nothing special right now except ceramics and obsidian.

We started excavating the Lot 18=(400N-600E L8 80 → 90 cm) and the Lot 19=(401N-617E L2 10 → 20 cm). The ceramics is still dense in Lot 18. Lot 20=(400N-600E Level 9 90 → 100cm) this Lot seems really dense in Paint Ceramics. Lot 19 don't give me more information.

Afternoon:

There's ~~some~~ a small quantity of charbon in Lot 20. We started digging Lot 21=(401N-617E L3 20 → 30cm). We had to stop digging in 400N-600E by security (too deep). The Lot 20 had also some ~~to~~ daub and we found many pieces from a single vessel. There is some ~~burned~~ daub + some charbon on the SE corner

of Lot 20

P95-63-04 2/2/95

Lot 21 gave some big and Flat rocks that ~~4~~ seem organized.

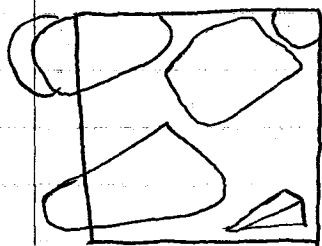

2/3/95

Morning:

We finished digging the Lot 20 that's going to be the last level down in 400N-600E. Lot 23 = (401N-

617E Level 4 30-40 cm), this Lot looks like a wall but is not consistent with the structure 1, this wall may go with another structure NE of St 1. We are not going to dig more in 401N-617E for now, but we are going to dig again in 400N-616E to see what's going on, and take out some rocks that look like tumble. ~~Start~~ We started to excavate

again in 400N-601E (Lot 22) and take it down to 20 cm. Lot 22 is dense with ceramics, no organization to the rocks right now. We started to dig again in 400N-616E (Lot 24 L2 10-20 cm), we get one of the wall of the structure 1, the wall is oriented N-S (Lot 24). We dug one quart of 400N-616E to Level 3 (20-30 cm) (Lot 26). We found a piece

of Figurine in Lot 25 (face part). Lot 25 = 400N-601E L3 20-30 cm. In Lot 26, the wall ended up being stairs, we started to dig the over part of 400N-616E L3 to see the all stairs. The stairs may keep

going farther up the mound (in 400N-615E)

Afternoon: We dug ~~the~~ Lot 27 (400N-601E L4 30-40 cm) that's still rich in ceramics. In the over quart of Lot 26, the stairs keep going and are really done. There's in the south wall ~~the~~ trench of 400N-616E a lot of rocks but most of it looks like tumble, we dug Lot

Lot 22 = L2 10-20 cm

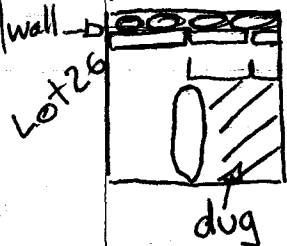

P 95-63-05 2/2/95

29 (400N-601E L5 40 → 50cm) that's is rich in Ceramics. We started ~~last~~ excavating Lot 28 (400N-615 L1 0 → 10cm) today but too early to say anything.

2/6/95

Morning:

We cleaned the surface of Lot 29 and kept excavating this Lot, we did the same thing for Lot 28. Lot 29 is rich in Ceramics. Lot 28 looks like tumble, we may get the continuity of the stairs in Lot 30 (400N-615E L2 10 → 20cm). Lot 29 doesn't have anything like a wall, there's a few rocks but they look like tumble. We may get something in the next square meter (400N-602E). Lot 30 has the continuity of the stairs but I will open one more meter in Lot 31 (400N-614E L1 0 → 10cm) to see what's going on with some of the rocks (if it's the continuity of the stairs or the start of a wall). We started excavating a little more in 400N-616E L4 30 → 40cm = Lot 33, to see what's going on with the vertical big rock. In Lot 32 (400N-602E L1 0 → 10cm) we have a wall but there's probably some tumble around it, so we excavated one more level down to Lot 34 (400N-602E L2 10 → 30cm). Lot 31 is full of tumble, we are not finding anything cultural in this Lot. Lot 34 doesn't give us much information, so we ~~open~~ excavated more down, Lot 35 (400N-602E L3 30 → 40cm).

Afternoon: In Lot 33, the Lot where the stairs start, we have a vertical big flat rock under the "First" step that looks ~~like~~ to be a support for the stairs, we dug more down with Lot 36 (400N-616E L5 40 → 50cm) to see how deep it goes.

P95-63-06

2/6/95

In Lot 35, we Found a wall with preform rocks (rectangular) in the outside wall, this wall looks really well done. Lot 36 is rich in Ceramics.

2/7/95

Morning:

We started digging Lot 37 (400N-603E L1 0 → 10cm) to get a better view of the wall, and we kept excavating in 400N-614E with 38 (L2 10 → 20cm). Lot 37 looks like tumble, same thing for Lot 38 but there is one preform rock in the S/W corner. We kept digging in 400N-614E with Lot 39 (L3 20 → 30cm). We started excavating Lot 40 (400N-603E L2 10 → 20cm) and we found an obsidian core in this Lot. We started digging in 400N-601E (L6 50 → 60cm) Lot 41 but only half of the square meter by security, to see how far down the wall in 400N-602E goes. In Lot 39, the stairs keep going and they are still made of preform rocks. I took out some rocks in Lot 30 that I thought were part of the stairs but ending up to not make sense with Lot 39. Lot 41, we don't have the continuity of the cut rock but we may get the continuity of the wall with some round rocks. We kept excavating down to Lot 42 (400N-601E L7 60 → 70cm). We started digging Lot 43 (400N-613E L1 0 → 10cm) to get the continuity of the stairs. In Lot 30 and 39 there are some steps missing that may explain the Large Flats rocks we had in Lot 23 (2 large Flats rocks and 2 over in the wall's trench). In Lot 42 we may have the base of the wall. We kept excavating in Lot 35 to find the width of the wall.

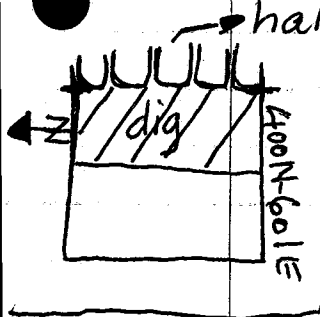

p95-63-07

2/7/95

Afternoon: Lot 43 had tumble. We may get the continuity of the stairs but not with preform rocks, but round rocks. Lot 35 looks like tumble right now. we kept excavating in 400N-613E (L2 10-20cm) with Lot 44. We excavated Lot 45 (400N-603E L3 20-30cm) but this lot had only tumble. We started excavating in Lot 47 (400N-612E L1 0-10cm) to get the continuity of the stairs. We started digging again in 400N-616E (L6 60-70cm) with Lot 48, to see the relation between the platform and the stairs. This Lot is also rich in Ceramics.

2/8/95

Morning:

We kept excavating in Lot 47 (400N-612E L1 0-10cm) and we started digging in Lot 49 (400N-603E L4 30-40cm). After we finish digging in Lot 48 (400N-616E) and find the relation between the beginning of the stairs and the platform, I will start to draw the features. Lot 47 is not rich in Ceramics (just a few sherds). We kept excavating in 400N-612E (L2 10-20cm) Lot 50. We started excavating Lot 51 (400N-603E L5 40-50cm). Lot 49 had tumble and was poor in any artifacts. I don't really know what's going on in Lot 51 if there is another wall or if it's still part of the 1st wall. After Ed's help, Lot 51 had a wall that is not really well preserved. In Lot 50, we have some flat rocks that may be the continuity of the stairs but those steps are really not well preserved. We started excavating in Lot 52 (400N-604E L1 0-10cm). We kept excavating in Lot 48.

Afternoon:

We kept excavating in Lot 48 and 52. Lot 52 had only a few sherds and looks like tumble ~~is~~ right now.

P95-63-08

2/8/95

We started excavating in Lot 53 (400N-604E L2 10-20cm). We found some strange shells in Lot 48 in The N/W Corner. Those shells are 65cm under the "First" step and are directly on the platform's floor. I drew the position of the shells (D95-63-03).

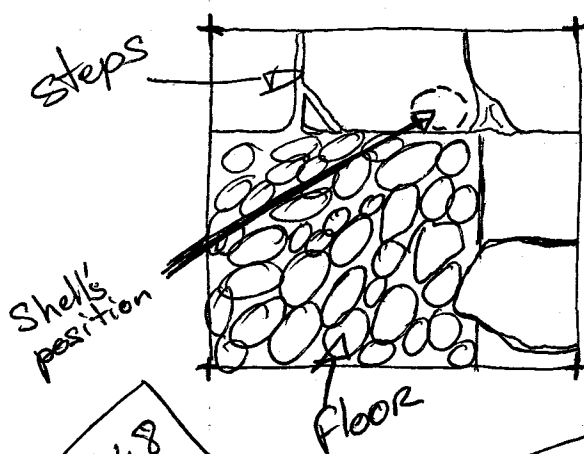

I took out the shells, there's the possibility of making some soil sample because 1 of the shells still has 2 parts together and the dirt between those hasn't been contaminated. There are no special artifacts associated with those shells. I haven't had the opportunity to draw the features today.

2/9/95

Morning:

We kept excavating in 400N-604E (L3 20-30cm) Lot 54. And we kept digging Lot 48 to find the connection between the stairs and the platform that is not clear right now. The rock that is the support of the "First" step doesn't go all the way to the platform's floor, the rock stops 30-33cm above the floor and the floor goes under the stairs. We started excavating in Lot 55 (400N-611E L1 0-10cm). Lot 55 had only a few sherds and it looks like there's a terrace but it's in pretty bad shape. Lot 54 may have a terrace ~~also~~ too, we started digging in Lot 56 (400N-605E L1 0-10cm) to see if the terrace kept going. We also started excavating in Lot 57 (400N-610E L1 0-10cm) to see if we get the continuity of the terrace. Lot 55 and 56 are really poor in Artifacts. We excavated Lot 58 (400N-605E L2 10-20cm) that had only

P 95-63-09

2/9/95

1 sherd, and this Lot doesn't look clear now so →
Afternoon:

→ We started digging Lot 59 (400N-605E L3 20→30 cm) and Lot 60 (400N-609E L1 0→10 cm). Lot 59 may have a wall and a terrace. Lot 60 had a step (the step is made with a flat rock) and may be a wall not well preserved. We excavated Lot 61 (400N-606E L1 0→10 cm) that may be a terrace. We started excavating Lot 62 (400N-608E L1 0→10 cm) and Lot 63 (400N-607E L1 0→10 cm) that is the 2 last meters of the trench. Those Lots are tumble.

2/10/95

Morning:

We kept excavating in Lot 62 and took out the rocks there were tumble. We also took out some rocks in Lot 59 (400N-605E L3 20→30 cm) than I thought were a wall line but Ed said that those were tumble. ~~We kept~~ We started digging in Lot 64 (400N-606E L2 10→20 cm) and Lot 65 (400N-608E L2 10→20 cm). Lot 65 had some ceramics and some bajareque. Lot 64 doesn't have any artifacts, we may get a wall in the west trench's wall. We also kept excavating in 400N-609E (L2 10→20 cm) with Lot 66, at the base of the wall. Lot 66 had the expansion of the wall and only had a couple sherds. We started excavating Lot 67 (400N-608E L3 20→30 cm) to see what's going on after the wall, the wall is about 1m 20 wide and it's located between 400N-609E and 400N-610E. We excavated Lot 68 (400N-608E L4 30→40 cm). We kept excavating in 400N-611E (L2 10→20 cm) Lot 69 because we may get something a little deeper.

P95-63-10

2/10/95

We kept digging Lot 70 (400N-606E L3 20 → 30cm). We found the other side of the wall in Lot 70, this wall is about 80cm wide and is located in 400N-605E.

Afternoon:

We kept digging Lots 69 and 70. We may have a terrace in Lot 69. The cobbles in Lot 70 was tumble and doesn't have any artifacts. We started excavating Lot 71 (400N-610E L2 10 → 20cm) I think This lot had the continuity of the terrace in Lot 69. We dug Lot 72 (400N-606E L4 30 → 40cm) and Lot 73 (400N-606E L5 40 → 50cm). Those lots gave the thing as Lot 70, except Lot 73 that had artifacts. We started excavating Lot 74 (400N-607E L2 10 → 20cm). Lot 74 is tumble. We started digging Lot 75 (400N-608E L5 40 → 50cm) and Lot 76 (400N-607E L3 20 → 30cm). Lot 75 and 76 were tumble and have few artifacts.

2/13/95

Morning:

We started excavating Lot 77 (400N-608E L6 50 → 60cm) and 78 ~~was~~ (400N-607E L4 30 → 50cm). We found a chert bifacial tool in Lot 77. Lot 77 and 78 were tumble and fill there's no cultural features right now. We started digging Lot 79 (400N-607E L5 50 → 60cm) and Lot 80 (400N-608E L7 60 → 70cm). Lot 79 and 80 are tumble and fill. We are done digging in this area. Now, we are going to dig in the East side based on 400N-616E and go with 2 different crew North and South at the same time, this is going to let us know where are the corners and stairs stop, but we need to move the dirt pile.

P95-63-11

2/13/95

Because we started digging perpendicular to the trench we have to verify some different points.

Afternoon:

We have to verify in 400N-611E and 400N-610E if there is a wall running perpendicular to the wall in between 400N-609E and 400N-610E. We also have to verify if the wall in the south trench's wall in 400N-608E, this wall will be running perpendicular to the wall in between 400N-609E and 400N-610E. So we started digging Lot 81 (400N-611E L3 20 → 30 cm) and Lot 82 (400N-605E L4 30 → 40 cm). We found a new wall in Lot 81 that is perpendicular to the trench. We started digging Lot 83 (400N-610E L3 20 → 30 cm). In Lot 82 we have the continuity of the wall. In Lot 83 we have the continuity of the wall 400N-609E, 400N-610E except that the remaining is confused. So we started excavating more in Lot 84 (400N-610E L4 30 → 40 cm). Lot 82 we have very nice continuity of the wall 400N-605E, this lot had some ceramics and bone. Lot 84 is confused.

2/14/95 * Lot 87 (400N-611E L4 30 → 70 cm)

Morning:

We started excavating in Lot 85 (400N-608E L8 70 → 80 cm) to see if there is a wall in the south trench's wall. We kept digging Lot 86 (400N-610E L5 40 → 70 cm)*. I think Lot 85 could be a wall. The wall in Lot 85 could be a intern wall that may turn in the south/west corner of 400N-608E. In Lot 86 we have the continuation of the wall in 400N-610E but in this Lot and Lot 87 we don't have the continuation of the wall line than we had in Lots 69 and 71. We started excavating in the East side of the mound

P95-63-12

2/14/95

perpendicular of the axe 400N. I have to let a profile block, the thing I didn't do for 401N-617E so the next meter up is going to have a decalage of 30 cm and I'm keeping the same grid system (cf: D95-63-02). We started digging in Lot 88 (401N-616E L1 0-10cm) and Lot 89 (399N-616E L1 0-10cm). Lots 88 and 89 are Fill, these lots have some sherds, we kept excavating. Lot 90 (401N-616E L2 10-20cm) and Lot 91 (399N-616E L2 10-20cm). Lot 90 had the continuity of the stairs still made in cut stones, this lot had few sherds. Lot 91 is still a mix of fill and tumble but there is a cut stone in the north-west corner. We kept excavating Lot 92 (399N-616E L3 20-30cm) and Lot 93 (401N-616E L3 20-30cm). Lot 93 had the continuation of the stairs but I want us to dig 1 more lot to see if we have 1 more step, so we started excavating Lot 94 (401N-616E L4 30-40cm).

Afternoon:

We kept excavating Lot 92 and 94. Lot 92 also had the continuation of the stairs still made in cut stones. So we kept digging to 40 cm Lot 95 (399N-616E L4 30-40cm). Lot 94 doesn't have any other steps but we are going to dig 1 more lot to make sure, Lot 96 (401N-616E L5 40-50cm). Lot 95 doesn't have any other steps either so we started excavating another lot to be sure, Lot 97 (399N-616E L5 40-50cm). Lot 96 and 97 don't have any other steps.

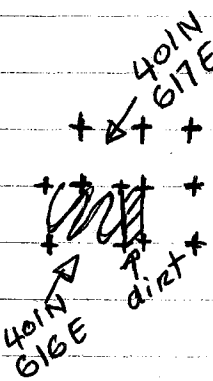

p95-63-13

2/15/95

Morning:

We ~~kept~~ set up the all trench N/S based on 400N-616E and we started digging Lot 98 (402N-616E L1 0 → 10cm) and Lot 99 (398N-616E L1 0 → 10cm) to reveal the corner of the structure. Lot 98 is Fill and has few sherds and Lot 99 is a mix of Fill and tumble and has few sherds. We kept excavating Lot 100 (402N-616E L2 10 → 20cm) and Lot 101 (398N-616E L2 10 → 20cm). Lot 100 has a wall in the south trench's wall so we started digging Lot 102 (402N-615E L1 0 → 10cm). After looking at 101, the corner is in between 399N-616E and 398N-616E so we are going to dig Lot 103 (399N-615E L1 0 → 10cm). Lot 102 has a lot of tumble (with few cut stones), so we are going to dig Lot 104 (402N-615E L1 0 → 10cm) to get more information. Lot 103 is also tumble but has a lot of cut stones. We kept excavating Lot 105 (399N-615E L2 10 → 20cm). I don't really see what's going on in Lot 105, so we started digging Lot 106 (399N-615E L3 20 → 30cm).

Afternoon:

We kept excavating Lot 106 and took out some rocks in Lot 104. Lot 104 ended up having a wall marking the end perpendicular to the stairs and this wall gets to another wall that is parallel to the stairs, so we kept excavating Lot 107 (403N-615E L1 0 → 10cm) to find the corner of the last wall. In Lot 106, we have a couple of vertical cut stones on the south part of the unit. These cut stones are perpendicular to the last step we have in this unit and they may be a limit to a wall, so we started excavating Lot 108 (398N-615E L1 0 → 10cm) to look for ~~at~~ the other side of this

P95-63-14

2/15/95

wall. Lot 108 doesn't have any cultural features right now, so we kept excavating to Lot 109 (398N-615E L2 10 → 20cm). Lot 109 has a line that could be a wall but isn't oriented as expected (it's not symmetric to the other side). Lot 107 has the continuation of the wall but still doesn't have any corner.

2/16/95

Morning:

We started excavating Lot 110 (404N-615E L10 → 10cm) to find the corner of the wall. We kept digging Lot 111 (398N-615E L3 20 → 30cm) to see if there is really a wall ~~so we started~~. In Lot 111 it's ~~hard~~ hard to see if there is really a wall so we started excavating Lot 112 (398N-616E L3 20 → 30cm) to get a better view. In Lot 110 we exposed the continuation of the wall and still have no corner, so we kept excavating Lot 113 (405N-615E L10 → 20cm). Lot 112 had a line of cut stones that goes the same direction as lines we have in Lot 109 and 111 that may be a wall that limits the structure, but this wall isn't symmetric to the wall on the other side of the stairs. We started taking down the band of dirt we left in 400N-616E to see if there ~~is~~ are more shells. Lot 113 still had the continuation of linear rocks but it could be tumble, so we started excavating Lot 114 (405N-614E L10 → 20cm) to see what's going on because we may get the corner in this unit. We also found a piece of stamps (dancing monkeys design) in Lot 113 and a lot more bone than we are used to, probably little mammal bones. After ~~we~~ we are done with 400N-616E, we are going to dig deeper in 398N-616E to get a better view of the wall and we are going to

P95-63-15

2/16/95

do the same thing for 404N-615E and 405N-615E.

Afternoon:

We kept excavating Lot 114 and Lot 48 (400N-616E). In Lot 48 there's no more shell. We started digging Lot 115 (398N-616E L4 30 → 40cm). Lot 114 is confused. We started excavating Lot 116 (401N-616E extension L1 0 → 20cm) to see how the stairs end. In Lot 115 we can't really see if there is any continuation, so we started digging Lot 117 (398N-616E L5 40 → 50cm). In Lot 117 we have the continuation of the wall. In Lot 116 we have the corner of the stairs turned in to a wall, but we need to dig deeper to have a better view of the features.

2/17/95

Morning:-

We started excavating Lot 118 (402N-615E L3 20 → 30cm) and Lot 119 (398N-616E extension L1 0 → 20cm). Lot 118 is fill and tumble and had few sherds and Bajareque. We started digging Lot 120 (402N-616E 20 → 30cm) and Lot 121 (398N-616E Extension L2 20 → 50cm). In Lot 119 and 121 we exposed the continuation of the wall. We started excavating Lot 122 (397N-616E L1 0 → 20cm) and Lot 123 (401N-616E extension L2 20 → 50cm). In Lot 120 we have a wall that is parallel to the wall we have in the other side of the stairs. We started digging Lot 124 (402N-616E L4 30 → 50cm) to follow the wall. We kept excavating Lot 125 (397N-616E L2 20 → 40cm). Lot 124 has the continuation of the wall, we started digging Lot 126 (402N-616E extension L1 0 → 20cm) to expose more

P95-63-16

2/17/95

Features. In Lot 125 we exposed the continuation of the wall but this wall may turn west because the rocks that go on the same line look like tumble. So we started excavating Lot 127 (397 N-616E L3 40 \rightarrow 50 cm).

Afternoon:

We started excavating Lot 128 (402N-616E extension L2 20 \rightarrow 50 cm). In Lot 127 we have the continuation of the wall, so we kept excavating Lot 129 (396N-616E L1 0 \rightarrow 20 cm) to expose more of the wall. In Lot 126 and 128, the wall still kept going, so we ~~err~~ started excavating Lot 130 (403N-616E L1 0 \rightarrow 20 cm). In Lot 129, we cannot tell if the wall keeps going, so we excavated Lot 131 (396N-616E L2 20 \rightarrow 40 cm). Lot 130 is tumble.

2/20/95

Morning:

We kept excavating Lot 131 that wasn't completed Friday, and we started digging the last level in 400N-607E (L6 60 \rightarrow 80 cm) Lot 132 because we are going to draw the profile of ^{the} section 400N-600E to 400N-617E with Ed. We kept excavating Lot 133 (403N-616E L2 20 \rightarrow 30 cm). In Lot 131 we have the continuation of the wall, so we started excavating the next meter Lot 134 (395N-616E L1 0 \rightarrow 20 cm). We started digging Lot 135 (403N-616E L3 30 \rightarrow 50 cm). In Lot 134 we have the continuation of the wall, but it's not really clear so we kept excavating to Lot 136 (395N-616E L2 20 \rightarrow 40 cm) to have a better view of

P95-63-17

2/20/95

the wall. In Lot 135 we have the continuation of the wall, still made out of cut stone. We kept excavating Lot 137 (404N-616E L1 0-20 cm) to expose the continuity of the wall. Lot 136 still has the continuation of the wall, but may ~~be~~ turn to an E/W orientation.

Afternoon:

We excavated Lot 138 (395N-616E L3 40-50 cm) and we kept excavating Lot 137. In Lot 137, we cannot really see if the wall keeps going so we started excavating Lot 139 (404N-616E L2 20-40 cm). In Lot 138, I think we have a corner that is made out of cut stone, so we started digging Lot 140 (395N-615E L1 0-20 cm). In Lot 139, we have the continuation of the wall but the preservation is not really good to say if it keeps going or turns E/W. ~~In~~ Lot 140 is tumble, we cannot see any cultural features right now.

2/21/95

Morning:

We started excavating Lot 141 (395N-615E L2 20-30 cm) to get the corner of the wall, and we also started digging Lot 142 (405N-616E L1 0-20 cm) to see if the wall keeps going. Lot 141 is tumble and fill, there is no apparent features so we started excavating Lot 143 (395N-615E L3 30-40 cm). Lot 142 is tumble I don't think the wall goes that far but we started excavating Lot 144 (405N-616E L2 20-40 cm). We started digging Lot 145 (395N-615E L4

P95-63-18

2/21/95

40 → 50 cm). In Lot 144 we cannot really see if there is the continuation of the wall, there is also a lot of the bajareque on the surface of Lot 144. We started digging Lot 146 (395N-615E L5 50 → 60 cm) to see if we can get a view of the features. In Lot 144, there is no wall, all the rocks are tumble and there is also bajareque on the surface of this Lot, I think we may have the corner in the square meter 404N-615E. We took out some rocks that were tumble in Lot 139.
"We had to stop working today because it was raining."

2/22/95

Morning:

After we took out some rocks in Lot 139, we found the corner of the wall, We also took out some rocks in Lot 135 that were tumble. In Lot 146, we still have the corner of the wall but the wall ~~stoped~~ stopped right after the corner. We cannot see the continuation of the wall even in the trench wall, so we started excavating Lot 147 (395N-614E L1 0 → 20 cm) to see what's going on because we also have a line of round stones in Lot 138 and 146 oriented E/W. Lot 147 is tumble, there are no cultural features, so we started digging Lot 148 (395N-614E L2 20 → 40 cm). We also kept excavating Lot 149 (404N-615E L2 20 → 40 cm 50 cm). In Lot 149 we have the continuation of the wall, but this wall is poorly preserved because the walls, in the side of the mound, are made out of round stones, we kept excavating to Lot 150 (404N-614E L1 0 → 20 cm) to see if the wall keeps going. In Lot 148 we still don't have any cultural features, so we

P95-63-19

2/22/95

excavated down to Lot 151 (395N-614E L3 40-60 cm).

Afternoon:

We kept excavating Lot 150 and 151. In Lot 150 we don't have any cultural features, so we kept excavating down to Lot 152 (404N-614E L2 20-40 cm). In Lot 151, there are no features right now. In Lot 152, there are no cultural features. We started digging Lot 153 (404N-614E L3 40-60 cm). In Lot 153, we have some ~~rocks~~ round rocks that are at the same level, but I don't know what it is right now. In Lot 151, we still have the line of rocks on the south side of the unit.

2/23/95

Morning:

We started excavating Lot 154 (404N-615E L2 20-40 cm) and Lot 155 (395N-614 L4 60-80 cm). Today I got 2 more workers, so we also started digging Lot 156 (401N-614E L1 0-20 cm). In Lot 154, there is no cultural feature, I think this is the periphery of structure 1. We started excavating Lot 157 (405N-614E L2 20-40 cm). In Lot 155, we still have the wall that runs S/N (cf: D95-63-05), this structure is older than St 1 by stratigraphy. We started excavating Lot 158 (395N-613E L1 0-20 cm) to see if we have the outside of a wall and if we can expose the side walls of the mound that stopped right after the corner. In Lot 157, we also have the periphery of structure 1. We are going to excavate Lot 159 (403N-614E L1 0-20 cm) to see if we can get a better view of the wall. In Lot 156, we exposed the continuation of the stairs, we are going to dig Lot 160 (401N-615E

P95-63-20

2/23/95

L2 20 → 40 cm).

Afternoon:

Lot 159 is tumble, we found a piece of groundstone. We started excavating Lot 162 (403N-614E L2 20 → 40 cm). In Lot 161, we exposed the side wall of the mound that is poorly preserved and only visible in the trench wall, so we kept digging down to Lot 163 (395N-613E L3 40 → 60 cm). ~~We~~ In Lot 162, we exposed the continuation of the wall. In Lot 160, we have the continuation of the stairs. We started excavating Lot 164 (394N-616E L4 50 → 70 cm) to find the relation between the platform and the wall "l'incru". Lot 163 is tumble

2/24/95

Morning:

We kept excavating Lot 164, and we started digging Lot 165 (395N-613E L3 60 → 80 cm). In Lot 164, we exposed a perfect rock line that may be the extension of the wall "l'incru". We started digging Lot 166 (394N-616E L5 70 → 110 cm). Lot ~~166~~ 165 is a mix of tumble + and terminal debris, so we started excavating Lot 167 (395N-613E L4 80 → 90 cm). In Lot 167, we exposed the continuation of the side mound wall that is in the trench wall. We kept excavating down to Lot 168 (395N-613E L5 90 → 100 cm) to see what the wall "l'incru" is doing.

Afternoon:

We kept excavating Lot 166 and 168. In Lot 168, we exposed the continuity of the wall "l'incru", it looks like there is another wall based

393N
616E

394N
616E

395N
616E

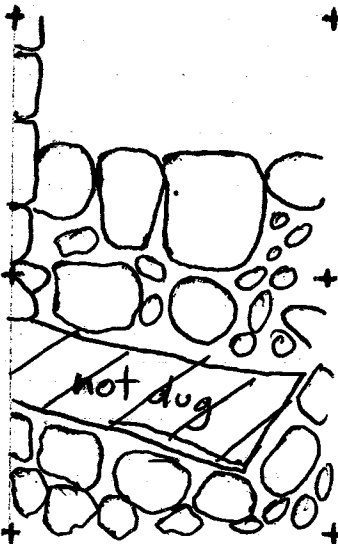

P95-63-21

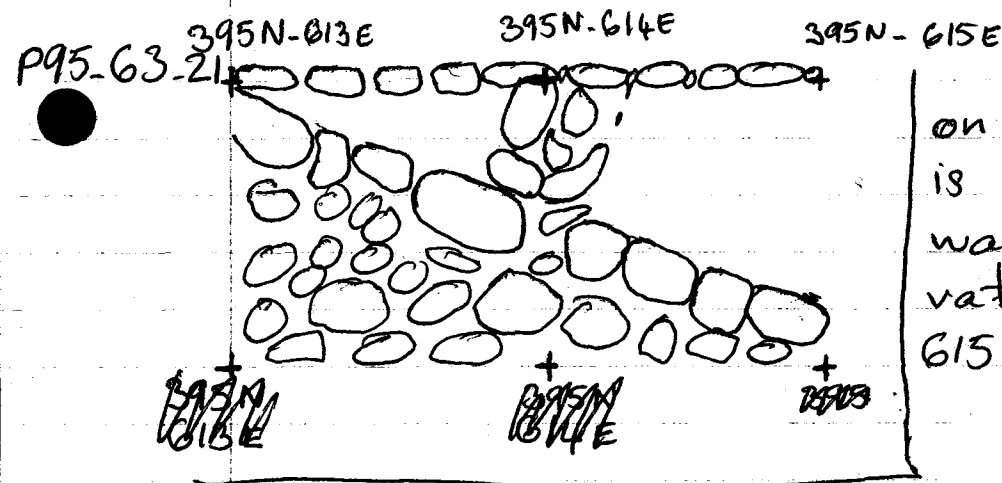

on the wall "l'inern" that is cut by the side mound wall. We started excavating Lot 169 (395N-615E L5 50-60 cm)

2/27/95

Morning:

We kept excavating Lot 169 and we started digging Lot 170 (402N-614E L1 0-20 cm). In Lot 169, we have flat rocks that look cultural. We started excavating Lot 171 (395N-612E L1 0-20 cm) to follow the side wall of the mound. Lot 170 is composed of tumble and terminal debris, so we kept digging down to Lot 172 (402N-614E L2 20-30 cm). We dug Lot 173 (401N-615E extension L1 0-30 cm) and we took out some rocks in Lot 118. We kept excavating Lot 174 (395N-612E L2 20-40 cm). In Lot 173, we exposed a wall made out of cut stones (really well done) that limited the end of the stairs, so we kept digging Lot 175 (402N-615E L4 30-40 cm / 401N-615E Extension L2 30-40 cm). In Lot 174 we have the continuation of the wall, so we kept excavating down to Lot 176 (395N-612E L3 40-60 cm).

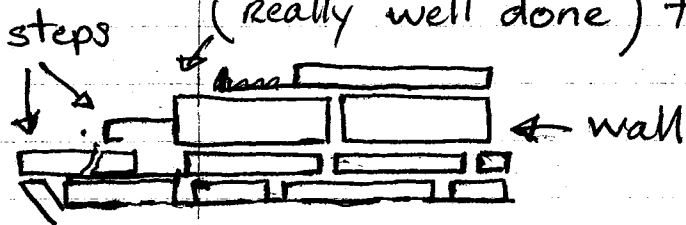

Afternoon:

We still have the continuation of the wall in Lot 176. We started excavating Lot 177 (395N-612E L4 60-80 cm). We also took out some rocks in Lot 156 to have a better view of the stairs. We started digging

P95-63-22

2/27/95

Lot 178 (402N-614E L3 20 → 50cm / 401N-614E Extension L1 0 → 50cm). In Lot 177, we still have the continuation of the wall.

2/28/95

Morning:-

We kept excavating Lot 178 and we started digging Lot 179 (395N-612E L5 80 → 100cm). In Lot 178, we have the continuation of the wall and the stairs stop at this wall. We started excavating Lot 180 (402N-614E L4 50 → 70cm / 401N-614E Extension L2 50 → 70cm). In Lot 180, the cut stone wall that marks the end of the stairs stopped and turns into a roundstone wall. We started digging Lot 181 (402N-613E L1 0 → 20cm) because Ed thinks that we may get a wall. Lot 181 is composed of tumble and terminal debris, there are no cultural features. In Lot 179, we exposed the same cultural features as in Lot 168 and we also exposed the continuation of the side wall of the mound.

Afternoon:

We started excavating Lot 182 (402N-613E L2 20 → 40cm) and Lot 183 (395N-611E L1 0 → 20cm). Lot 182 is composed of tumble and terminal debris, there are no cultural features, so we kept excavating down to Lot 184 (402N-613E L3 40 → 60cm). In Lot 183 we still have the continuity of the wall. We kept excavating Lot 185 (395N-611E L2 20 → 40cm). In Lot 184 we exposed a line

P95-83. 23

2/28/95

of rocks that could be a wall !!

3/1/95

Morning:

We kept excavating Lot 185 and we started digging Lot 186 (402N-613E L4 60-80cm) to see if the line of rocks is a wall. In Lot 185 we still have the continuation of the wall. We started excavating Lot 187 (395N-611E L3 40-60cm). In Lot 187, we have the same features as Lot 185. We started digging Lot 188 (395N-610E L1 0-20cm). I also started to help Nick draw his profile wall by taking the measurements. In Lot 186 we have a floor and the continuation of the wall.

Afternoon:

I kept helping Nick with his profile. We also started excavating Lot 189 (395N-610E L2 20-60cm) and we cleaned Lot 186 to see the relation between the wall that is running N/S and the wall that is running E/W, after we cleaned those walls I think that they are contemporary with each other. We also took down the two extensions with Lot 190 (402N-614E Extension L1 0-40cm) and Lot 191 (402N-615E Extension L1 0-40cm). In Lot 189, we still have the wall but no other feature. In Lot 190 and 191 we ended on ~~the~~ the same mess as lots 107 and 162.

p95-63-24

3/2/95

Morning:

We started excavating Lot 192 (402N-614E L5 70 \rightarrow 90cm) and we took out some rocks in Lot 189 that were tumble. We started excavating Lot 193, ~~402N-614E~~ (395N-609E L1 0 \rightarrow 20cm). In Lot 192 we found a burial associated with some sherds and worked bone. Right now we only can see a few bones, one of these is a phalange. In Lot 193, we may have exposed a wall that is perpendicular to the side wall of the mound (but it's positive). We started excavating Lot 194 (403N-613E L1 0 \rightarrow 20cm / 402N-613E Extension L1 0 \rightarrow 20cm), and we also kept digging Lot 195 (395N-613E L2 20 \rightarrow 40cm). In Lot 194 is a mix of tumble and terminal debris. The burial is probably not completed at this time. Lot 195 is not really clear right now.

Afternoon:

We took out some rocks in Lot 195 that were tumble. We started excavating Lot 196 (403N-613E L2 20 \rightarrow 40cm / 402N-613E Extension L2 20 \rightarrow 40cm). In Lot 196, we have the continuation of the wall. I had, Roberto and Manuel move a pile of rocks.

P95-63-25

3/6/95

Morning:

We kept excavating Lot 192 and Lot 197 (398N-615E L4 30 → 50cm) to see what's going on because some rocks were tumble. In Lot 192 we found a few more human bone frags. In Lot 197, we exposed a line of rocks that's perpendicular to the front wall of the mound. In Lot 192, we didn't get more human bone and we exposed the base of the wall stairs. We started excavating



Lot 198 (398N-615E Extension L1 0 → 30cm) to see if we have the same type of the wall stairs. We also kept digging Lot 199 (402N-615E L4 30 → 50cm) to expose also the base of the wall and see the relation between the front wall of the mound and the

wall stairs. In Lot 198, we exposed the same kind of wall stairs, we are going to follow this wall and the other we have in Lot 197 but we need to move most of the dirt and rock pile. We implanted more grid point and we started excavating Lot 200 (398N-614E L1 0 → 20cm). In Lot 199, we exposed the base of the wall stairs, the rest of the Lot surface is tumble. I had Roberto and Manuel move the dirt ~~pile~~ and rock pile.

Afternoon:

We implanted more grid point. Lot 200 is tumble and terminal debris right now. We started excavating Lot 201 (404N-613E L1 0 → 20cm) and Lot 202 (398N-614E L2 20 → 40cm).

3/7/95

Morning:

We kept excavating Lot 201 and 202. In Lot 201 we exposed the continuation of the wall, and we kept digging down to Lot 203 (404N-613E L2 20 → 40cm) to see the relation between this wall and the north side wall of the mound. Lot 202 is composed of tumble and terminal debris, there is no continuation of the features, so we kept excavating down to Lot 204 (398N-614E L3 40 → 60cm). In Lot 203, we don't have anything clear right now. In Lot 204 we exposed the continuation of the wall we have in Lot 197*, there is also a high concentration of bajareque in this unit (398N-614E). We started excavating Lot 205 (398N-614E Extension L1 0 → 20cm). In Lot 203, we don't have good preservation of the wall, we kept taking out rocks to get better preservation lower. ~~For~~ Lot 205 is tumble. We started excavating Lot 206 (398N-614E Extension L2 20 → 60cm).

Afternoon:

In Lot 206 we exposed the continuation of the cross wall. We kept digging Lot 207 (399N-614E L1 0 → 20cm). Lot 203 doesn't have any features preserved, so we kept excavating down to Lot 208 (404N-613E L4 40 → 60cm). In Lot 207 we exposed part of the cut stone that is forming the wall stairs, so we kept excavating Lot 209 (399N-614E L2 20 → 40cm). In Lot 208, we exposed the connection between the north side wall of the mound and the wall we have in Lot 186 and 196, this wall is ending on the north side wall of the mound. Ed made a drawing of the wall stairs that is located in 401N-616E Extension / 401N-615E Extension.

* and a cross wall N/S.

P95-63-27

3/8/95

Morning:

We kept excavating Lot 209 and started digging Lot 210 (404N-612E L1 0-20cm). In Lot 209, we exposed the continuation of the stairs, but we may get the continuation of the other steps by excavating deeper, so we dug Lot 211 (399N-614E L3 40-50cm). Lot 210 is composed of tumble and terminal debris. There is no continuation of the wall right now, so we kept excavating down to Lot 212 (404N-612E L2 20-40cm). Lot 211 doesn't have any other steps preserved. We started digging Lot 213 (399N-613E L1 0-20cm). Lot 212 doesn't have good preservation of the wall, so we kept digging down to Lot 214 (404N-612E L3 40-60cm). In Lot 213, we exposed the continuation of the stairs. We started excavating Lot 215 (398N-613E Extension L1 0-20cm). Lot 215 is tumble and terminal debris, so we started digging Lot 216 (398N-613E L1 0-20cm).

Afternoon:

We ~~excavated~~ kept excavating Lot 214 and 216. In Lot 214 we exposed the continuation of the north side wall of the mound. We need to move more dirt and rock pile on the top of the mound because we are going to dig more to determine the dimensions of the principal room. In Lot 216, we don't have any cultural features right now, so we kept excavating down to Lot 217 (398N-613E L2 20-40cm). Lot 217 is the same as Lot 216. We found an antler in the back dirt pile on the top of the mound (Lot 401), This may come from 400N-612E area. We started digging Lot 218 (398N-613E L3 40-60cm).

P95-63-28

3/9/95

Morning: We kept excavating Lot 218 and we implanted more grid points on top of the mound, to dig and determine the dimensions of the principal room. Lot 218 doesn't have any artifacts except two pcs of bajareque, so we kept digging down to Lot 219 (398N-613E L4 60 → 80cm). We also started excavating Lot 220 (399N-608E L1 0 → 20cm) to give the excavators more space to dig because the wall is 20cm to the edge of the unit. There is a big concentration of bajareque in Lot 219 and we also found a pc of ^{white} rock that is processing marble. Still in this lot, we exposed the continuation of the wall perpendicular to the front mound wall and the wall that is parallel to this last one. Lot 220 is tumble right now. We kept excavating Lot 221 (398N-613E Extension L2 20 → 60cm) and Lot 222 (399N-608E L2 20 → 40cm). In Lot 221, we have the continuation of the wall that is parallel to the front wall ~~that~~ of the mound. In Lot 222, we exposed a wall that is not on the same line as the wall we have in 400N-609E/400N-610E. We kept digging Lot 223 (399N-613E L2 20 → 60cm) and we also started excavating Lot 224 (399N-608E Extension L1 0 → 40cm). In Lot 223, we exposed the continuation of the wall that ends the stairs. In Lot 224, we exposed a wall that is perpendicular to the wall 400N-609E/400N-610E.

Afternoon: We started excavating Lot 225 (399N-608E L3 40 → 60cm). We need to move another pile of dirt to dig Lot 226 (397N-613E L1 0 → 20cm). In Lot 225, we may have exposed a little wall that may be a separating wall. Lot 226 is tumble.

p95-63-29

3/10/95

Morning:

We started excavating Lot 227 (397N-613E L2 20-40cm) and Lot 228 (399N-609E L1 0-20cm). In Lot 227, we exposed the continuation of the wall that is parallel to the front wall of the mound, we kept excavating down to Lot 229 (397N-613E L3 40-60cm) to have a better view of the feature. In Lot 228, we exposed the continuation of the wall of the principal room. We kept digging Lot 230 (399N-609E L2 20-60cm), this lot is only a 10cm strip along the wall. In Lot 230, we exposed an extension of the wall 400N-609E/400N-610E and we also exposed an extension of the wall that is perpendicular to last one. We started excavating Lot 231 (398N-608E L1 0-20cm) 398N-608E Extension L1 0-20cm). In Lot 229, we exposed the continuation of the wall.

Afternoon:

We started excavating Lot 232 (396N-613E L1 0-20cm) to see the relation between the wall parallel to the front wall of the st. and the side wall of the st. We also kept digging Lot 231. In Lot 232, we exposed the continuation of the wall, we kept excavating down to Lot 233 (396N-613E L2 20-40cm) to see the relation. In Lot 231, we have the continuation of the wall. We kept digging down to Lot 234 (398N-608E L2 20-40cm/398N-608E Extension L2 20-40cm). In Lot 233, we exposed the other side of the side wall of the mound but I not sure that it is. In Lot 234, we exposed more of the extension of the wall "PARIS". I finally named my features.

P95-63-30

3/13/95

Morning:

We started excavating Lot 235 (398N-608E L3 40- \rightarrow 60cm / 398N-608E Extension L3 40- \rightarrow 60cm) and Lot 236 (403N-612E L1 0- \rightarrow 20cm). Lot 236 is composed of tumble and terminal debris right now, so we kept digging down to Lot 237 (403N-612E L2 20- \rightarrow 40cm) to expose more of the wall "CANNES". In Lot 235, we exposed the continuation of the extension of the wall "PARIS" we still don't have the corner, so we kept excavating Lot 238 (397N-608E L1 0- \rightarrow 20cm). Note: When we followed the exterior wall "REIMS", we were going off the E/W axis, so the unit 396N-608E is equal to approximately 40cm (cf: D95-63-02). In Lot 237, we may have exposed the exterior side of "CANNES", so we kept excavating down to Lot 239 (403N-612E L3 40- \rightarrow 60cm) to see the relation of "CANNES" and "ETRETAI". In Lot 238, we exposed the corner of the wall "PARIS" and exposed the wall "POITIERS". We need to move a big rock pile to keep excavating in this area. In Lot 239, we exposed the exterior side of the wall "CANNES" and it's relation with the wall "ETRETAI". "CANNES" is sitting on the wall "ETRETAI", but farther inside. We started excavating Lot 240 (403N-613E L3 40- \rightarrow 60cm / 402N-613E Extension L3 40- \rightarrow 60cm) to see if the wall "ETRETAI" does the same thing as the wall "REIMS".

Afternoon:

We kept excavating Lot 240 and started digging Lot 241 (399N-607E L1 0- \rightarrow 20cm / 399N-607E Extension L1 0- \rightarrow 20cm). In Lot 240, we exposed the continuation of the "cobble Floor" "NICE" but there is not much to say about the wall "ETRETAI", except that it does not do the

P95-63-31

3/13/95

same thing as the wall "REIMS", so we started excavating Lot 242 (403N-614E L3 40 → 60cm / 402N-614E Extension L3 40 → 60cm). In Lot 241, we did not expose any features, so we kept digging down to Lot 243 (399N-607E L2 20 → 40cm / 399N-607E Extension L2 20 → 40cm). We are going to finish those lots tomorrow..

3/14/95

Morning:

We kept excavating Lots 242 and 243. Lot 243 is confusing, so we started digging Lot 244 (397N-607E L1 0 → 20cm). In Lot 24, we exposed a cobble floor that could be the continuation of the cobble floor "NICE" except that it is lower than this one, so we kept excavating Lot 245 (403N-615E L2 20 → 40cm / 402N-615E Extension L2 20 → 40cm) to see what's going on. In Lot 245, we exposed the continuation of the cobble floor "NICE" that goes back to the same level. In Lot 244, we exposed the continuation of the wall "POITIERS", so we started excavating Lot 246 (398N-607E L1 0 → 20cm / 398N-607E Extension L1 0 → 20cm) to see if we can expose something less confusing than Lot 243. We took out some rocks in Lot 239 to expose the exterior side of the wall "CANNES". We started excavating Lot 247 (397N-614E L1 0 → 20cm). Lot 247 is tumble and terminal debris, we kept digging down to Lot 248 (397N-614E L2 20 → 40cm).

Afternoon:

We kept excavating Lot 246 and 249 (397N-614E L3 40 → 60cm). Lot 246 is composed of tumble and fill. We started digging Lot 250 (398N-607E L2 20 → 40cm / 398N-

P95-63.32

3/14/95

-607E Extension L2 20 → 40cm). In Lot 249, we exposed a perpendicular wall "ARLÉS" to the wall "CLERNONT".

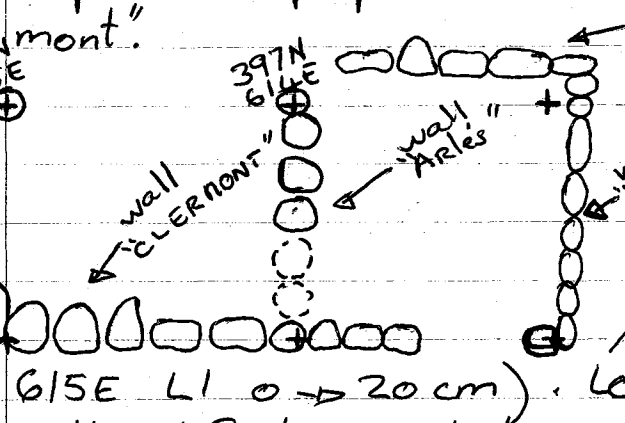

Interion side wall "REIMS", there is a possibility that we may have a little room in this Lot that is formed by those walls (cf: Draw). We kept excavating Lot 251 (397N-615E L1 0 → 20 cm). Lot 250 doesn't have any cultural Features. Lot 251 is tumble and terminal debris right now.

morning:

3/15/95

We started excavating Lot 252 (397N-615E L2 20 → 40cm) and Lot 253 (397N-606E L1 0 → 20cm). In Lot 252, we exposed the wall "NONTPELLIERS" and a sort of cobble fill within the walls "NONTPELLIERS", "CLERNONT" and "ARLÉS". We kept digging in this area with Lot 254 (396N-614E L1 0 → 20cm). We also found our first DONUT STONE in Lot 252. ~~the wall~~ I am still trying to find the exterior side of the wall "CANNES" that is still not got (lot 239). In Lot 253, we exposed the continuation of "POITIERS", so we kept excavating down to Lot 255 (397N-606E L2 20 → 40cm) to have a better view of wall. In Lot 254, we exposed the top of "REIMS", so we kept excavating down to Lot 256 (396N-614E L2 20 → 40cm) to ~~let~~ expose the interior side and its connection with the wall "ARLÉS". In Lot 255, we exposed more of the wall "POITIERS", but it's not well preserved in this area, so we started digging Lot 257 (399N-606E L1 0 → 20cm / 399N-606E Extension L1 0 → 20cm) to follow the wall "FORT-MAHON".

P95-63-33

3/15/95

through "POITIERS". In Lot 256, we exposed the continuation of "REIMS" that is around a meter thick, and we also exposed the connection in between "REIMS" and "Arlés". In Lot 257, we exposed a line of rocks that is parallel to the wall "Fort-Mahon" and 50 cm away from it (\rightarrow E).

Afternoon:

We kept excavating Lot 258 (396N-615E L1 0 \rightarrow 20cm) and Lot 259 (399N-606E L2 20 \rightarrow 40cm / 399N-606E Extension L2 20 \rightarrow 40cm). In Lot 258, we exposed the continuation of the cobble fill we had in Lot 252. The wall "Arlés" makes the end ~~of the wall "REIMS"~~ of the wall "REIMS" because we can see in the stratigraphy of this wall a clear change, after the wall "Arlés" is not so well done, so this may be an earlier stage of the building. The wall "Arlés" may go all the way across the structure because on the other side of the stairwell, on the front of the cobble floor "NICE", we have a ^{small} cobble line. In Lot 259, the wall "Fort-Mahon" stops. We started excavating to sterile in 400N-617E with Lot 260 (400N-617E L8 70 \rightarrow 90cm).

Morning:

3/16/95

We kept excavating Lot 260 and started Lot 261 (398N-606E L1 0 \rightarrow 20cm / 398N-606E Extension L1 0 \rightarrow 20cm). In Lot 261, we did not expose any features. We kept digging Lot 262 (400N-617E L9 90 \rightarrow 110cm), and Lot 263 (398N-606E L2 20 \rightarrow 40cm / 398N-606E Extension L2 20 \rightarrow 40cm). Brett gave me 2 of this excavators, so I had them work on the wall "Arlés" to see if it goes all the way through.

p95-63-34

3/16/95

the stairs, Lot 264 (398N-613E/614E L5 80 → 90cm). Lot 263 is really confusing, we took out some rocks in Lot 243 to see if the whole thing makes more sense. By digging Lot 264 we discovered that there is no doorway in the little room because the wall "CLERNONT" goes all the way through the wall "ANIENS".

Afternoon:

Brett took his 2 excavators back, so Lot 264 is not done. We kept excavating Lot 262. After Ed looks at the mess in the top room, we are going to take down everything that is west of the wall "VERSAILLES" to the same level as the units in the original trench, with Lot 265 (399N-607E L3 40 → 60cm/399N-607E Extension L3 40 → 60cm). We finished Lot 262, we kept digging down to Lot 266 (400N-617E L10 110 → 130cm). In Lot 265, we exposed a line rock that seems to be the prolongation of the wall "VERSAILLES".

Morning:

3/17/95

We kept excavating Lot 266. I got 2 excavators from Santiago, so I had them finish Lot 264. We also kept digging on top of the mound with Lot 267 (398N-607E L3 40 → 60cm/398N-607E Extension L3 40 → 60cm). In Lot 264, we exposed a cobble floor the same as "NICE" and the deeper prolongation of the wall "CLERNONT" and also the continuation of the cobble part of the wall "PIERREFONDS", and may be the continuation of the wall "Arles". We took out some rocks and cleaned in Lot 267 because we may have exposed a wall. In Lot 266, we reached sterile at 1.30m but only the last 5cm were steril, so we started dig-

P95-63-35

3/17/95

~~Now~~ going to sterile on the other side also, with Lot 269 (400N-600E L10 100 \rightarrow 120cm). We started excavating with Lot 268 (398N-614E/615E L4 50 \rightarrow 60cm). In Lot 268, the cobble floor doesn't keep going past the wall "Arles", we started digging Lot 270 (397N-613E/614E L4 60 \rightarrow 70cm). This Lot is located in between the walls "Arles", "CLERNONT", "ANIENS" and "REIMS".

Afternoon:

Lot 267 is still really confusing, so we took out more rocks. In Lot 269, we have a lot of ceramics, the first 10 cm gave one big plastic bag (15x25") of sherds. In the other 10cm we are also finding a lot of sherds + a nice whistle. Lot 267 doesn't have any more features so we are going to keep excavating West to find more information about what the summit looks like but for this we need to move again a big rock pile. In Lot 270, we exposed a cobble floor in the "room", I'm going to call the cobble floor outside the "room" ~~in~~ ^{the} "STRASBOURG" and the one in the "room", "ST-RAPHAËL". In Lot 268, we also have a burnt area that goes from a light orange color an off white color. The cobble floor that is in the "room" and the cobble floor that's in between the walls "CLERNONT" and "Arles", are two different floors because they are not at the same level. The floor in the "room" is higher than the other floor.

P95-G3-36

3/20/95

Morning:

We started excavating Lot 271 (400N-600E L1 \rightarrow 120 \rightarrow 140 cm) and we kept moving the rock pile. We also ^{started} excavating Lot 272 (399N-612E L1 \rightarrow 20 cm / 398N-612E Extension L1 \rightarrow 20 cm) with 2 of Santiago's excavators. We started digging Lot 273 (399N-605E L1 \rightarrow 20 cm / 399N-605E Extension L1 \rightarrow 20 cm). Lot 272 is tumble right now, so we kept excavating down to Lot 274 (399N-612E L2 20 \rightarrow 40 cm / 398N-612E Extension L2 20 \rightarrow 40 cm). I had to go home because I'm sick.

3/21/95

Morning:

Lot 271 is still rich in Ceramics. ~~Then~~ Lot 273 doesn't have any features. In Lot 274, we exposed part of the stairwell. We started excavating Lot 275 (400N-600E L1 2 140 \rightarrow 160 cm) and Lot 276 (399N-605E L2 20 \rightarrow 40 cm / 399N-605E Extension L2 20 \rightarrow 40 cm). Lot 276 is pretty confusing but we may have another wall that started after the corner and that is oriented N/S, so we kept excavating down to Lot 277 (399N-605E L3 40 \rightarrow 60 cm / 399N-605E Extension L3 40 \rightarrow 60 cm) to verify all of this. In Lot 275, we reached sterile at 1.50 cm, but we kept going to 1.55 m to be sure. We kept excavating in 399N-612E with Lot 278 (399N-612E L3 40 \rightarrow 60 cm / 398N-612E Extension L3 40 \rightarrow 60 cm).

Afternoon:

We kept excavating Lots 277 and 278. We also cleaned the wall "AMIENS" and created Lot 279 ~~of~~ for the artifacts we found. In Lot 277, we exposed the corner of the wall "Fort-Mahon" (turn \rightarrow W).

P95-63-37

3/21/95

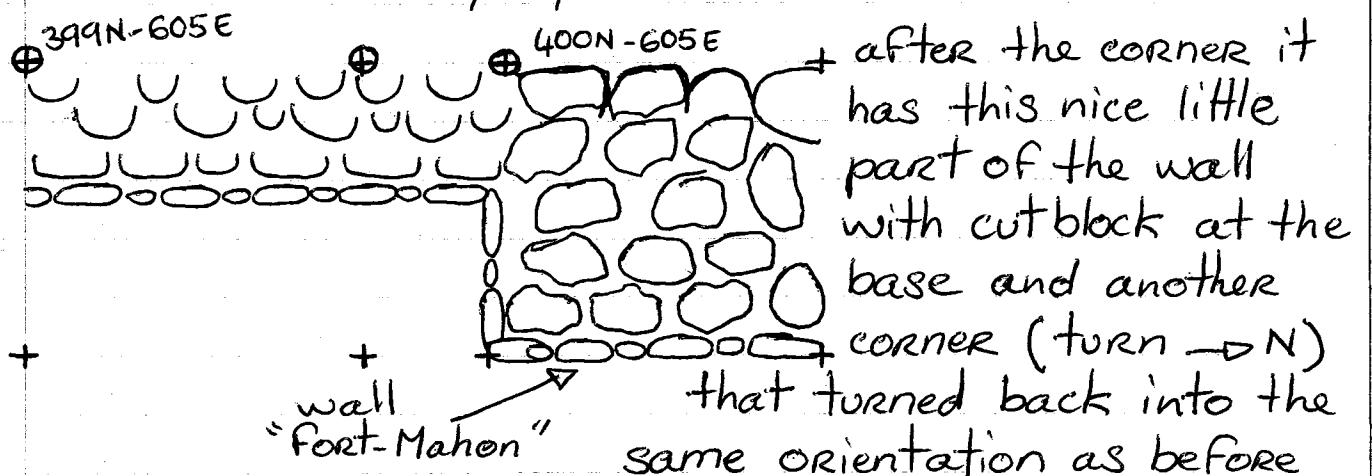

N/S, so we are following the wall "Fort-Mahon" by digging Lot 280 (398N-605E L1 0-20cm / 398N-605E Extension L1 0-20cm). In Lot 278, we did not find any features, but something happened between the wall "AMIENS" and the cobble part of the wall "PIERREFONDS".

3/22/95

Morning:

We kept excavating Lot 280 and started digging Lot 281 (399N-612E L4 60-80cm / 398N-612E Extension L4 60-80cm). Lot 280 is tumble right now, so we kept excavating with Lot 282 (398N-605E L2 20-40cm / 398N-605E Extension L2 20-40cm). In Lot 281, we exposed the continuation of the wall "PIERREFONDS"

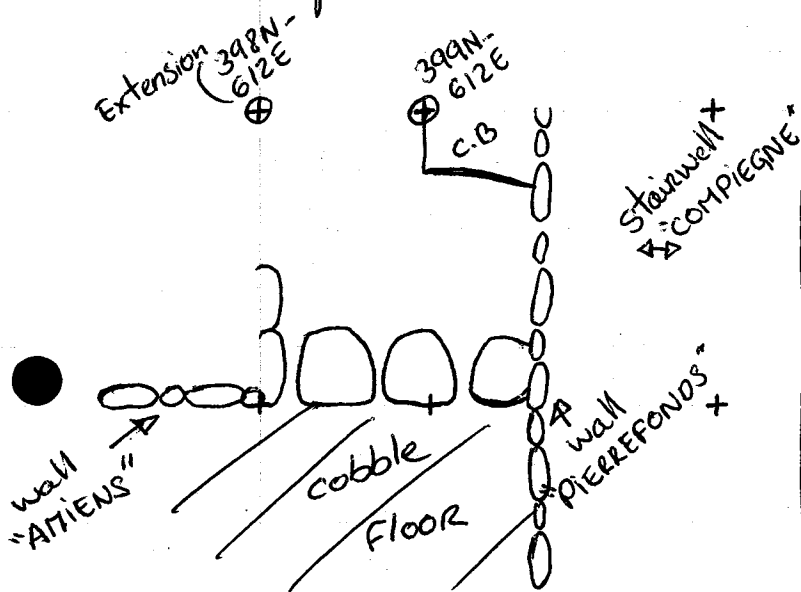

and a step that gives access to the cobble floor and may have another step made out of cut block. We started digging Lot 283 (398N-612E L1 0-20cm) to get the corner of the wall "AMIENS" and limited the hall. I added to the profile section the ~~str~~ stratigraphy to sterile

p95-63-38

3/22/95

level of both units. In Lot 282, we exposed the connection with the walls "POITIERS" and "Fort Mahon". Lot 283 is tumble right now.

Afternoon:

We started excavating Lot 284 (398N-612E L2 20 → 40cm) and Lot 285 (398N-607E/608E L4 60 → 80cm). In Lot 285, we exposed the deeper continuation of the walls "PARIS", "POITIERS" and their common corner and we also exposed a cobble surface, so we kept excavating Lot 286 (399N-607E/608E L4 60 → 80cm/398N-607E/608E Extension L4 60 → 80cm) to see if the cobble surface keeps going.

Morning:

3/23/95

We kept excavating Lot 286 and started Lot 287 (398N-612E L3 40 → 80cm), this Lot refers to a strip of dirt along the interior side of the wall "AMIENS". In Lot 286, we exposed better the corner of the walls "PARISX" and "VERSAILLESX". We kept excavating Lot 288 (397N-606E/607E L2 20 → 60cm) because there is a confusing part in the wall "POITIERS". I started to hand draw my features. In Lot 287, we exposed a cross wall named "LYON" that is oriented N/S, the continuation of the wall "PIERREFONDS", this area may be limited to another kind of room.

Afternoon:

In Lot 288, we exposed another funny turn of the wall "POITIERS", we kept excavating to follow the wall "POITIERS" with Lot 289 (397N-607E/608E L2 20 → 60cm).

397N-607E

397N-606E

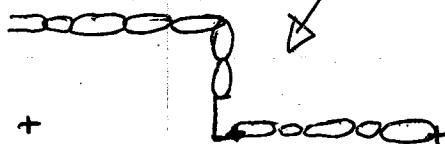

P95-63-39

⊕ 391N-
607E

⊕ 391N-
608E

3/23/95

+ In this Lot (289), we exposed another turn of "POITIERS" that meets the walls "PARIS" and "PARIS X".

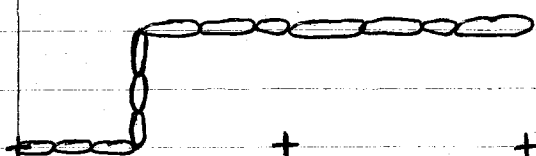

3/24/95

Morning:

I had Roberto and Manuel fill back the two units where we dug to sterile. I kept drawing my features and marked the points to shoot with the transit, I ended with 84 points.

Afternoon:

I'm going to start to describe the features we may not shoot the points with the transit today. Ed and Mike shot the points on my structure after 3.00 p.m.

P95_63_40

Description of the Features

Wall CAEN: This wall is made out of cut block (30x25x10) really nice square block with flat faces, those cut blocks are actually the basal rock, this wall is about 30 cm thick, 10 cm high and the portion of the wall exposed is equal to 1 m.
ORIENTATION: 10° E of N

Wall METZ: This wall is made out of river cobble, medium size, flat face outside, those river cobbles are the basal rock. This wall is about 55 cm thick, 24 cm high and the portion of the wall exposed is equal to 1 m.
ORIENTATION:  N

Wall BEAUVAIS: This wall is made out of river cobble, medium to small size, we just have the basal rock, thickness 30 cm, height 15 cm, portion exposed 1 m.
ORIENTATION:  N

Wall Verberie: This wall is made of nice cut block (see D95-63-6), its later part is equal to 1.6 m, after that it continues 1.35 more & this part is made of medium & small river cobbles. This wall marks the end of the stairwell on the north side. The cut block part is 72 cm high & the cobble part 64 cm high.

Orientation = 110° Wall Pierrefonds: This wall uses the same type of construction as Verberie, & has the same function. The cut block portion stops at 1.54 m & the cobble part continues to 4.1 m. The cut block part is 60 cm high, the cobble part 90 cm.

Orientation = 110° Wall Montpellier: This wall corresponds to the front wall of the mound for the later occupation. This wall is 3.8 m on the south side of the stairwell. The 2 1st m from Pierrefonds are made of cut blocks & after of big & medium cobbles. This wall is 30 cm high & 60 cm thick Orientation = 26° Wall Reims This wall is the south side wall of the mound. We exposed 7.25 m of the wall from the northeast corner to the end of excavation. The 1st 1.6 m are also part of a later ~~construction~~ ^{construction} that is visible by 2 different techniques of construction. The general method of construction is the same as the other cobble wall. It is ~~1.03 m~~ ^{1.03 m} high for the earlier phase & ~~1.03 m~~ ^{66 cm} for the later. Orientation = 100° thickness = 1 m.

Wall Clermont: This wall is parallel to Pierrefonds & starts 1.1 m from it. It is made of cobbles, the 1st 1.3 m are big & small cobbles with flat faced outsides. The other 1.35 m is made of medium & small cobbles. This marks 2 phases of construction. The total length is 2.65 m, the thickness is 35 cm for the later phase & 25 cm

P95-63-42

for the earlier. It is 15 cm high. Orientation = 110° Wall Arles: This wall was the front of the structure, based on the stratigraphy of Reims & the meeting of Pierrefonds & Verberie with Arles (both stop). This wall is made of medium cobbles & only the basal rocks are preserved. They have flat sides facing east. This wall is 2.5 m long & 25 cm thick. Orientation = 10°

Wall Amiens: This wall is one of the cross walls on this side. It is made of cobbles with the same technic. This wall started on the interior side of Reims, & is 1.65 m long & 60 cm high. This wall turned at 1.65 m from Reims, & continues for 1.2 m where it runs into the cross wall Lyon. Orientation = 1st part 10° , 2nd 100°

Wall Lyon: This wall is made of medium cobbles with the same construction technic. It is 90 cm long & 64 cm high. Orientation 10°

Wall Fort Mahon: This wall is made of cobbles, the technic used a level of big cobbles alternated with small filler rocks. We exposed the entire south part of ^{corner} the original trench. 3.6 m were exposed, it has ~~an extension~~ 1 m from the north wall of the original trench, it is oriented 90° & is 55 cm long. After this corner the wall continues with a different type of construction. The next part is composed of medium & smaller cobbles. The last part of the wall shifts to 90° . The wall is 55 cm high in the original trench & 80 cm in the other area. It is 1 m thick. Orientation = 10°

P95-63-43

Wall POITIERS: This wall has the same technique as the first part of Fort. Nahon. This wall also ~~has~~ turns 12° at 90cm. There is a little cut block in the corner. This corner is 55cm deep. South. After this the wall keeps going the same way for 1.75m and turns back to its original line. We exposed the entire wall and it is equal to 2.90m. We only exposed the interior face of this wall. The height is 70cm.

ORIENTATION: 100°

Wall PARIS extension (X) (shelf): This wall is a shelf made of medium and really small river cobbles, the same technique as the 2 other walls. This wall is 1.95m long, 60cm high and 30cm thick. ORIENTATION: 10°

Wall PARIS: Same technique as the others. This wall has a couple cut blocks w/ flat faces on the very top. The part we exposed is 3.60m long, thickness 1.20m, height 85cm. ORIENTATION: 10°

Wall VERSAILLES: This wall starts at 1m ^{from} the north wall of the original trench, ^{on the wall PARIS} the technique of building is still the same and the kind of rock as well. This wall is 95cm long but keeps going for 90cm w/ only basal rocks. This wall is 55cm high and 35cm thick. This wall also has an extension VERSAILLES X. ORIENTATION: 100°

Wall VERSAILLES X (Shelf): This wall is a shelf perpendicular to PARIS X made of medium and really small river cobbles. The shelf is 80cm long, 37cm high and 23cm thick.

ORIENTATION: 100°

Wall NOYON: This wall is perpendicular to PARIS and is the exterior face of PARIS and is 60cm from the north wall of the original trench. This wall is made of river cobbles, medium sized. There is only the basal rocks left. This wall is 1.75m long and 20cm thick. ORIENTATION: 90°

P95-63-744

STAIRWELL COPPIÈGNE: The stairwell is 3.50m long from the first step to the last one and 3.70m wide. The stairwell is made of 2 different materials, big river cobbles w/ flat faces on top and big cut blocks w/ nice flat faces. The cut blocks part for the 1st 1.90m (going \rightarrow W) is a later addition to the building. We only have 5 steps totally preserved, only 2 of them are cut blocks.
ORIENTATION: 110°

* NOTICE: PAGES 47, 48 and 49 are non-existent

the room ST-RAPHAËL: This room is defined by the walls Arles, the interior side of REIMS, ANIENS, and CLERNONT. The interior space is $1.15 \times 1.15 \text{ m}$ (1.32 m^2). This room also has a cobble floor inside, made of small and bigger river cobbles.

COBBLE SURFACE STRASBOURG: This is defined by the walls Arles, PIERREFONDS and a step ^(that is 20cm high) we have in between ~~the~~ PIERREFONDS and the corner of ANIENS. This cobble surface is made of small river cobbles. The surface area is $1.10 \text{ m} \times 1.15 \text{ m}$ (1.26 m^2).

Wall BOURGES: This wall is the other part of the front wall of the mound on the north side of the stairwell. This wall is 2.70 m long, the entire wall is made of cut blocks (big to medium size). This wall is 40 cm thick and 30 cm high.

Orientation: 10°

Wall ETRETAT: This wall is the north side wall of the mound. This wall is made of medium river cobbles. We only have the basal rock because it's poorly preserved. We exposed 4.50 m from the corner to the end of excavation. This wall is about 45 cm thick and at some point 30 cm high. ORIENTATION: 100°

Wall CANNES: This wall is a cross wall, that starts at the end of VERBERIE and turns west at 2.35 m to become parallel to ETRETAT. It keeps going for 1.25 m (to the end of excavation). This wall is 60 cm high. This wall is made of medium and smaller river cobbles. It still uses the same technic of building. ORIENTATION: 10° (after corner 100°)

Wall "ARLES" continuation: we still have a little part of this wall about 55 cm long from the wall VERBERIE. Still the same thing and ~~the~~ same orientation.

Cobble surface NICE: This cobble surface is defined by the wall VERBERIE, Arles, CANNES ~~an~~, BOURGES and ETRETAT, but we still have this empty area, like on the other side. This area is 1.60 m from VERBERIE and 1.80 m from the cobble surface to the inside of BOURGES. This cobble surface formed a big L ^{it is} made of small and bigger river cobbles.

P95-63-46

Cobble half-circle surface MEGEVRE: This cobble surface is shaped like a kind of $\frac{1}{2}$ circle. It starts at 1.10m from the corner of the wall ETRETAT and ends at 2.35m. This ~~is~~ cobble is made of medium size river cobbles.

Lot 0	→ Surface collection
Lot 1	→ 400N-600E L 1 0 → 10 cm
Lot 2	→ 400N-601E L 1 0 → 10 cm
Lot 3	→ 400N-616E L 1 0 → 10 cm
Lot 4	→ 400N-600E L 2 10 → 20 cm
Lot 5	→ 400N-617E L 1 0 → 10 cm
Lot 6	→ 400N-617E L 2 10 → 20 cm
Lot 7	→ 400N-600E L 3 20 → 40 cm*
Lot 8	→ 400N-617E L 3 20 → 30 cm
Lot 9	→ 400N-600E L 4 40 → 50 cm
Lot 10	→ 400N-617E L 4 30 → 40 cm
Lot 11	→ 400N-600E L 5 50 → 60 cm
Lot 12	→ 400N-617E L 5 40 → 50 cm
Lot 13	→ 400N-617E L 6 50 → 60 cm
Lot 14	→ 400N-600E L 6 60 → 70 cm
Lot 15	→ 400N-617E L 7 60 → 70 cm
Lot 16	→ 400N-600E L 7 70 → 80 cm
Lot 17	→ 401N-617E L 1 0 → 10 cm
Lot 18	→ 400N-600E L 8 80 → 90 cm
Lot 19	→ 401N-617E L 2 10 → 20 cm
Lot 20	→ 400N-600E L 9 90 → 100 cm
Lot 21	→ 401N-617E L 3 20 → 30 cm
Lot 22	→ 400N-601E L 2 10 → 20 cm
Lot 23	→ 401N-617E L 4 30 → 40 cm
Lot 24	→ 400N-616E L 2 10 → 20 cm
Lot 25	→ 400N-601E L 3 20 → 30 cm
Lot 26	→ 400N-617E L 3 20 → 30 cm
Lot 27	→ 400N-601E L 4 30 → 40 cm
Lot 28	→ 400N-615E L 1 0 → 10 cm
Lot 29	→ 400N-601E L 5 40 → 50 cm
Lot 30	→ 400N-615E L 2 10 → 20 cm
Lot 31	→ 400N-616E L 1 0 → 10 cm
Lot 32	→ 400N-600E L 1 0 → 10 cm
Lot 33	→ 400N-616E L 4 30 → 40 cm

Lot 34	→ 400N - 602E L2	10 → 30cm
Lot 35	→ 400N - 602E L3	30 → 40cm
Lot 36	→ 400N - 616E L5	40 → 50cm
Lot 37	→ 400N - 603E L1	0 → 10cm
Lot 38	→ 400N - 612E L2	10 → 20cm
Lot 39	→ 400N - 614E L3	20 → 30cm
Lot 40	→ 400N - 603E L2	10 → 20cm
Lot 41	→ 400N - 601E L6	50 → 60cm
Lot 42	→ 400N - 601E L1	60 → 70cm
Lot 43	→ 400N - 613E L1	0 → 10cm
Lot 44	→ 400N - 613E L2	10 → 20cm
Lot 45	→ 400N - 603E L3	20 → 30cm
Lot 46	→ 400N - 602E L4	40 → 50cm
Lot 47	→ 400N - 612E L1	0 → 10cm
Lot 48	→ 400N - 616E L6	60 → 70cm
Lot 49	→ 400N - 603E L4	30 → 40cm
Lot 50	→ 400N - 612E L2	10 → 20cm
Lot 51	→ 400N - 603E L5	40 → 50cm
Lot 52	→ 400N - 604E L1	0 → 10cm
Lot 53	→ 400N - 604E L2	10 → 20cm
Lot 54	→ 400N - 604E L3	20 → 30cm
Lot 55	→ 400N - 611E L01	0 → 10cm
Lot 56	→ 400N - 605E L1	0 → 10cm
Lot 57	→ 400N - 610E L1	0 → 10cm
Lot 58	→ 400N - 605E L2	10 → 20cm
Lot 59	→ 400N - 605E L3	20 → 30cm
Lot 60	→ 400N - 609E L1	0 → 10cm
Lot 61	→ 400N - 606E L1	0 → 10cm
Lot 62	→ 400N - 608E L1	0 → 10cm
Lot 63	→ 400N - 607E L1	0 → 10cm
Lot 64	→ 400N - 606E L2	10 → 20cm
Lot 65	→ 400N - 608E L2	10 → 20cm
Lot 66	→ 400N - 607E L2	10 → 20cm
Lot 67	→ 400N - 605E L2	320 → 30cm

Lot 68	→ 400N-608E	L4 30 → 40cm
Lot 69	→ 400N-601E	L2 10 → 20cm
Lot 70	→ 400N-606E	L3 20 → 30cm
Lot 71	→ 400N-610E	L2 10 → 20cm
Lot 72	→ 400N-606E	L4 30 → 40cm
Lot 73	→ 400N-606E	L5 40 → 50cm
Lot 74	→ 400N-607E	L2 10 → 20cm
Lot 75	→ 400N-608E	L5 40 → 50cm
Lot 76	→ 400N-607E	L3 20 → 30cm
Lot 77	→ 400N-608E	L6 50 → 60cm
Lot 78	→ 400N-607E	L4 30 → 50cm
Lot 79	→ 400N-607E	L5 50 → 60cm
Lot 80	→ 400N-608E	L7 60 → 70cm
Lot 81	→ 400N-611E	L3 20 → 30cm
Lot 82	→ 400N-605E	L4 30 → 40cm
Lot 83	→ 400N-610E	L3 20 → 30cm
Lot 84	→ 400N-610E	L4 30 → 40cm
Lot 85	→ 400N-608E	L8 70 → 80cm
Lot 86	→ 400N-610E	L5 40 → 70cm
Lot 87	→ 400N-611E	L4 30 → 60cm
Lot 88	→ 401N-616E	L1 0 → 10cm
Lot 89	→ 399N-616E	L1 0 → 10cm
Lot 90	→ 401N-616E	L2 10 → 20cm
Lot 91	→ 399N-616E	L2 10 → 20cm
Lot 92	→ 399N-616E	L3 20 → 30cm
Lot 93	→ 401N-616E	L3 20 → 30cm
Lot 94	→ 401N-616E	L4 30 → 40cm
Lot 95	→ 399N-616E	L4 30 → 40cm
Lot 96	→ 401N-616E	L5 40 → 50cm
Lot 97	→ 399N-616E	L5 40 → 50cm
Lot 98	→ 402N-616E	L1 0 → 10cm
Lot 99	→ 398N-616E	L1 0 → 10cm
Lot 100	→ 402N-616E	L2 10 → 20cm
Lot 101	→ 398N-616E	L2 10 → 20cm

Lot 102	→ 402N - 615E	L1	0 → 10cm
Lot 103	→ 4399 399N - 615E	L1	0 → 10cm
Lot 104	→ 402N - 615E	L2	10 → 20cm
Lot 105	→ 4399 399N - 615E	L2	10 → 20cm
Lot 106	→ 399N - 615E	L3	20 → 30cm
Lot 107	→ 403N - 615E	L1	0 → 20cm
Lot 108	→ 398N - 615E	L1	0 → 10cm
Lot 109	→ 398N - 615E	L2	10 → 20cm
Lot 110	→ 404N - 615E	L1	0 → 20cm
Lot 111	→ 398N - 615E	L3	20 → 30cm
Lot 112	→ 398N - 616E	L3	20 → 30cm
Lot 113	→ 405N - 615E	L1	0 → 20cm
Lot 114	→ 405N - 614E	L1	0 → 20cm
Lot 115	→ 2398 398N - 616E	L4	30 → 40cm
Lot 116	→ 401N - 616E extension	L1	0 → 20cm
Lot 117	→ 2398 398N - 616E	L5	40 → 50cm
Lot 118	→ 402N - 615E	L3	20 → 30cm
Lot 119	→ 398N - 616E extension	L1	0 → 20cm
Lot 120	→ 402 - 616E	L3	20 cm → 30cm
Lot 121	→ 398N - 616E extension	L2	20 → 50cm
Lot 122	→ 3397 397N - 616E	L1	0 → 20cm
Lot 123	→ 401N - 616E extension	L2	20 → 50cm
Lot 124	→ 402N - 616E	L4	30 → 50cm
Lot 125	→ 397N - 616E	L2	20 → 40cm
Lot 126	→ 402N - 616E extension	L1	0 → 20cm
Lot 127	→ 397N - 616E	L3	40 → 50cm
Lot 128	→ 402N - 616E extension	L2	20 → 50cm
Lot 129	→ 396N - 616E	L1	0 → 20cm
Lot 130	→ 403N - 616E	L1	0 → 20cm
Lot 131	→ 396N - 616E	L2	20 → 40cm
Lot 132	→ 400N - 607E	L6	60 → 80cm
Lot 133	→ 403N - 616E	L2	20 → 30cm
Lot 134	→ 395N - 616E	L1	0 → 20cm
Lot 135	→ 403N - 616E	L3	30 → 50cm

Lot 136	→ 395 N - 616 E	L2	20 → 40 cm
Lot 137	→ 404 N - 616 E	L1	0 → 20 cm
Lot 138	→ 395 N - 616 E	L3	40 → 50 cm
Lot 139	→ 404 N - 616 E	L2	20 → 40 cm
Lot 140	→ 395 N - 615 E	L1	0 → 20 cm
Lot 141	→ 395 N - 615 E	L2	20 → 30 cm
Lot 142	→ 405 N - 616 E	L1	0 → 20 cm
Lot 143	→ 395 N - 615 E	L3	30 → 40 cm
Lot 144	→ 405 N - 616 E	L2	20 → 40 cm
Lot 145	→ 395 N - 615 E	L4	40 → 50 cm
Lot 146	→ 395 N - 615 E	L5	50 → 60 cm
Lot 147	→ 395 N - 614 E	L1	0 → 20 cm
Lot 148	→ 395 N - 614 E	L2	20 → 40 cm
Lot 149	→ 404 N - 615 E	L2	20 → 50 cm
Lot 150	→ 404 N - 614 E	L1	0 → 20 cm
Lot 151	→ 395 N - 614 E	L3	40 → 60 cm
Lot 152	→ 404 N - 614 E	L2	20 → 40 cm
Lot 153	→ 404 N - 615 E	L3	50 → 60 cm
Lot 154	→ 405 N - 614 E	L2	20 → 40 cm
Lot 155	→ 395 N - 614 E	L4	60 → 80 cm
Lot 156	→ 401 N - 614 E	L1	0 → 20 cm
Lot 157	→ 405 N - 614 E	L2	20 → 40 cm
Lot 158	→ 395 N - 613 E	L1	0 → 20 cm
Lot 159	→ 403 N - 614 E	L1	0 → 20 cm
Lot 160	→ 401 N - 615 E	L1	0 → 20 cm
Lot 161	→ 395 N - 613 E	L2	20 → 40 cm
Lot 162	→ 403 N - 614 E	L2	20 → 40 cm
Lot 163	→ 395 N - 613 E	L2	40 → 60 cm
Lot 164	→ 394 N - 616 E	L4	50 → 70 cm
Lot 165	→ 395 N - 613 E	L3	60 → 80 cm
Lot 166	→ 394 N - 616 E	L5	70 → 90 cm
Lot 167	→ 395 N - 613 E	L4	80 → 90 cm
Lot 168	→ 395 N - 613 E	L5	90 → 100 cm
Lot 169	→ 395 N - 615 E	L5	50 → 60 cm

- Lot 170 → 402N-614E L1 0 → 20cm
 Lot 171 → 395N-612E L1 0 → 20cm
 Lot 172 → 402N-614E L2 20 → 30cm
 Lot 173 → 401N-615E extension L1 0 → 30cm
 Lot 174 → 395N-612E L2 20 → 40cm
 Lot 175 → 402N-615E L4 30 → 40cm
 → 401N-615E extension L2 30 → 40cm
 Lot 176 → 395N-612E L3 40 → 60cm
 Lot 177 → 395N-612E L4 60 → 80cm
 Lot 178 → 402N-614E L3 30 → 50cm
 → 401N-614E extension L1 10 → 50cm
 Lot 179 → 395N-612E L5 80 → 100cm
 Lot 180 → 402N-614E L4 50 → 70cm
 → 401N-614E Extension L2 50 → 70cm
 Lot 181 → 402N-613E L1 0 → 20cm
 Lot 182 → 402N-613E L2 20 → 40cm
 Lot 183 → 395N-611E L1 0 → 20cm
 Lot 184 → 402N-613E L3 40 → 60cm
 Lot 185 → 395N-611E L2 20 → 40cm
 Lot 186 → 402N-613E L4 60 → 80cm
 Lot 187 → 395N-611E L4 40 → 60cm
 Lot 188 → 395N-610E L1 0 → 20cm
 Lot 189 → 395N-610E L2 20 → 60cm
 Lot 190 → 402N-614E Extension L1 0 → 40cm
 Lot 191 → 402N-615E Extension L1 0 → 40cm
 Lot 192 → 402N-614E L5 70 → 90cm
 Lot 193 → 395N-609E L1 0 → 20cm
 Lot 194 → 403N-613E L1 0 → 20cm/
 → 402N-613E Extension L1 0 → 20cm
 Lot 195 → 395N-609E L2 20 → 40cm
 Lot 196 → 403N-613E L2 20 → 40cm/
 402N-613E Extension L2 20 → 40cm

OP12H

(Lot 401 → Back dirt pile Top of the mound
(Lot 400 → Back dirt pile West side

Appended 4

63

- Lot 197 → 398N-615E L4 30 → 50cm ✓
Lot 198 → 398N-615E Extension L1 0 → 30cm ✓
Lot 199 → 402N-615E L4 30 → 50cm
Lot 200 → 398N-614E L1 0 → 20cm
Lot 201 → 404N-613E L1 0 → 20cm
Lot 202 → 398N-614E L2 20 → 40cm
Lot 203 → 404N-613E L2 20 → 40cm
Lot 204 → 398N-614E L3 40 → 60cm ✓
Lot 205 → 398N-614E Extension L1 0 → 20cm
Lot 206 → 398N-614E Extension L2 20 → 40cm ✓
Lot 207 → 399N-614E L1 0 → 20cm
Lot 208 → 404N-613E L3 40 → 60cm
Lot 209 → 399N-614E L2 20 → 40cm
Lot 210 → 404N-612E L1 0 → 20cm
Lot 211 → 399N-614E L3 40 → 50cm
Lot 212 → 404N-612E L2 20 → 40cm
Lot 213 → 399N-613E L1 0 → 20cm
Lot 214 → 404N-612E L3 40 → 60cm
Lot 215 → 398N-613E Extension L1 0 → 20cm
Lot 216 → 398N-613E L1 0 → 20cm
Lot 217 → 398N-613E L2 20 → 40cm
Lot 218 → 398N-613E L3 40 → 60cm
Lot 219 → 398N-613E L4 60 → 80cm ✓
Lot 220 → 399N-608E L1 0 → 20cm
Lot 221 → 398N-613E Extension L2 20 → 40cm
Lot 222 → 399N-608E L2 20 → 40cm
Lot 223 → 399N-613E L2 20 → 60cm
Lot 224 → 399N-608E Extension L1 0 → 40cm
Lot 225 → 399N-608E L3 40 → 60cm
Lot 226 → 397N-613E L1 0 → 20cm
Lot 227 → 397N-613E L2 20 → 40cm
Lot 228 → 399N-609E L1 0 → 20cm
Lot 229 → 397N-613E L3 40 → 60cm

- Lot 230 → 399N - 609E L2 20 → 60cm
- Lot 231 → 398N - 608E L1 0 → 20cm /
→ 398N - 608E Extension L1 0 → 20cm
- Lot 232 → 396N - 613E L1 0 → 20cm
- Lot 233 → 396N - 613E L2 20 → 40cm
- Lot 234 → 398N - 608E L2 20 → 40cm /
398N - 608E Extension L2 20 → 40cm
- Lot 235 → 398N - 608E L3 40 → 60cm /
398N - 608E Extension L3 40 → 60cm
- Lot 236 → 403N - 612E L1 0 → 20cm
- Lot 237 → 403N - 612E L2 20 → 40cm
- Lot 238 → 397N - 608E L1 0 → 20cm
- Lot 239 → 3403N - 612E L3 40 → 60cm
- Lot 240 → 403N - 613E L3 40 → 60cm /
402N - 613E Extension L3 40 → 60cm
- Lot 241 → 399N - 607E L1 0 → 20cm /
399N - 607E Extension L1 0 → 20cm
- Lot 242 → 403N - 614E L3 40 → 60cm /
402N - 614E Extension L3 40 → 60cm
- Lot 243 → 399N - 607E L2 20 → 40cm /
399N - 607E Extension L2 20 → 40cm
- Lot 244 → 397N - 607E L1 0 → 20cm
- Lot 245 → 403N - 615E L2 20 → 40cm /
402N - 615E ^{Extension} L2 20 → 40cm
- Lot 246 → 398N - 607E L1 0 → 20cm /
398N - 607E Extension L1 0 → 20cm
- Lot 247 → 397N - 614E L1 0 → 20cm
- Lot 248 → 397N - 614E L2 20 → 40cm
- Lot 249 → 397N - 614E L3 40 → 60cm
- Lot 250 → 398N - 607E L2 20 → 40cm /
398N - 607E Extension L2 20 → 40cm
- Lot 251 → 397N - 615E L1 0 → 20cm

- Lot 252 → 397N-615E L2 20 → 40cm
 Lot 253 → 397N-606E L1 0 → 20cm
 Lot 254 → 396N-614E L1 0 → 20cm
 Lot 255 → 397N-606E L2 20 → 40cm
 Lot 256 → 396N-614E L2 20 → 40cm
 Lot 257 → 399N-606E L1 0 → 20cm/
 399N-606E Extension L1 0 → 20cm
 Lot 258 → 396N-615E L1 0 → 20cm
 Lot 259 → 399N-606E L2 20 → 40cm/
 399N-606E Extension L2 20 → 40cm
 Lot 260 → 400N-617E L8 70 → 90cm
 Lot 261 → 398N-606E L1 0 → 20cm/
 398N-606E Extension L1 0 → 20cm
 Lot 262 → 400N-617E L9 90 → 110cm
 Lot 263 → 398N-606E L2 20 → 40cm
 398N-606E Extension L2 20 → 40cm
 Lot 264 → 398N-613E/614E L5 80 → 90cm
 Lot 265 → 399N-607E L3 40 → 60cm/
 399N-607E Extension L3 40 → 60cm
 Lot 266 → 400N-617E L10 110 → 130cm
 Lot 267 → 398N-607E L3 40 → 60cm/
 398N-607E Extension L3 40 → 60cm
 Lot 268 → 398N-614E/615E L4 50 → 60cm
 Lot 269 → 400N-600E L10 100 → 120cm
 Lot 270 → 397N-613E/614E L4 60 → 70cm
 Lot 271 → 400N-600E L11 120 → 140cm
 Lot 272 → 399N-612E L1 0 → 20cm/
 398N-612E Extension L1 0 → 20cm
 Lot 273 → 399N-605E L1 0 → 20cm/
 399N-605E Extension L1 0 → 20cm
 Lot 274 → 399N-612E L2 20 → 40cm/
 398N-612E Extension L2 20 → 40cm

- Lot 275 → 400N-600E L12 140 → 155 cm
- Lot 276 → 399N-605E L2 20 → 40 cm /
399N-605E Extension L2 20 → 40 cm
- Lot 277 → 399N-605E L3 40 → 60 cm /
399N-605E Extension L3 40 → 60 cm
- Lot 278 → 399N-612E L3 40 → 60 cm / 39
398N-612E Extension L3 40 → 60 cm
- Lot 279 → Cleaning of the wall "ANIENS", area: 398N-613E
+ this extension + 399N-613E
- Lot 280 → 398N-605E L1 0 → 20 cm /
398N-605E Extension L1 0 → 20 cm
- Lot 281 → 399N-612E L4 60 → 80 cm /
398N-612E Extension L4 60 → 80 cm
- Lot 282 → 398N-605E L2 20 → 40 cm /
398N-605E Extension L2 20 → 40 cm
- Lot 283 → 398N-612E L1 0 → 20 cm
- Lot 284 → 398N-612E L2 20 → 40 cm
- Lot 285 → 398N-607E/608E L4 60 → 80 cm
- Lot 286 → 399N-607E/608E L4 60 → 80 cm
398N-607E/608E Extension L4 60 → 80 cm
- Lot 287 → 398N-612E L3 40 → 80 cm
- Lot 288 → 397N-606E/607E L2 20 → 60 cm
- Lot 289 → 397N-607E/608E L2 20 → 60 cm

March 24, 1995

op 1214 (Cecile's scan)

IH=1305

Prepared By	Initials	Date
Approved By		

	Point	°	min	Distance	
1	S side - Caen	211°05'	2573	6.61	1
2	N side Caen	216°00'	2540	5.96	2
3	S side - Metz	203°15'	2204	5.69	3
4	N side - METZ	206°45'	2087	4.94	4
5	S side - Beauvais	192°30'	1883	4.90	5
6	N side - Beauvais	195°00'	1851	4.43	6
7	SW - Fort Mahon	186°30'	1613	4.91	7
8	NW - Fort Mahon	189°15'	1503	4.14	8
9	SE - Fort Mahon	174°30'	1542	4.78	9
10	NE - Fort Mahon	177°30'	1455	3.81	10
11	NW interior - Fort Mahon	181°00'	1771	4.88	11
12	SW interior - Fort Mahon	176°00'	1865	7.23	12
13	SE interior - Fort Mahon	168°30'	1521	7.45	13
14	W Portiers	168°30'	1495	7.76	14
15	E Portiers	154°00'	1322	7.99	15
16	Portiers turn North	154°00'	1339	7.54	16
17	Portiers turn East	151°20'	1120	7.55	17
18	corner Portiers - East	149°45'	0984	7.74	18
19	SE corner Versailles	146°15'	1416	5.56	19
20	NE corner Versailles	141°30'	1113	5.46	20
21	SW corner Versailles	152°50'	1031	5.37	21
22	Far W of Versailles	161°55'	1700	4.80	22
23	S of int. wall - Albertville	156°10'	1761	7.15	23
24	N edge of Versailles	149°00'	1118	4.90	24
25	SW corner of Paris	138°45'	0988	5.21	25
26	NW corner of Paris	133°30'	1035	4.94	26
27	N edge of Paris	131°40'	0818	4.51	27
28	S middle of Paris	136°30'	0863	5.28	28
29	NE of Paris	123°50'	1047	4.90	29
30	SE of Paris	130°00'	1010	5.40	30
31	NE, of Paris (un Poco MAS)	122°30'	1143	5.20	31
32	SE, of Paris (un Poco MAS)	127°50'	1077	5.66	32
33	W of Noyon	126°00'	1328	5.59	33
34	E of Noyon	115°30'	1471	6.76	34
35	N edge of ? - extension of STRASBOURG	106°10'	1532	7.41	35
36	S edge of ? - extension of STRASBOURG	118°30'	1074	8.69	36
37	N edge of STAIR well	91°00'	1699	7.70	37
38	SE edge of STAIR well	114°00'	17107	8.93	38
39	NW edge of STAIR well	90°40'	1963	8.00	39
40	SW edge of STAIR well	112°10'	1967	9.18	40

3/24/95

ep. 1214 (cont.)

Prepared By	Initials	Date
Approved By		

1 2 3 4 5 6

	Point	Angle	Mid	Distance	
43	SE corner of stairwell	108°30'	2341	10.73	1
42	NE point of Verberie	91°15'	2144	9.49	2
44	NE corner of Verberie	89°10'	2387	9.71	3
45	SE edge of 2nd tier of stairwell	109°00'	2224	10.43	4
46	Cobble Floor - Calais (elevation of floor)		3102		5
47	East point of Montpelliers	112°00'	2464	11.36	6
48	SE corner of Montpelliers	122°30'	2473	13.18	7
49	SW corner of Montpelliers on Reims	127°15'	2243	11.92	8
50	Far W edge of Reims	154°00'	1874	9.35	9
51	W edge of Lincku	132°00'	1680	11.56	10
52	E edge of Lincku	124°15'	2751	13.32	11
53	NW corner of Lincku in front of Montpelliers	119°40'	2851	12.74	12
54	NE corner of Lincku in front of Montpelliers	118°30'	2862	13.22	13
55	Inside corner where PIERRE FOND meets ARLES	114°00'	2538	9.49	14
56	NEAST edge of Clermont	114°30'	2406	11.26	15
57	NW edge of Clermont	123°00'	2373	9.57	16
58	SE corner - S edge of ARLES	124°30'	2202	11.10	17
59	SW corner of AMIENS	128°30'	2007	10.50	18
60	ST. Raphael - cobble floor (elevation of floor)		2462		19
61	STRASBOURG - cobble floor (elevation of floor)		2560		20
62	midpoint of AMIENS	122°15'	2354	8.99	21
63	NE corner of LYON (Room)	119°30'	1175	8.52	22
64	NW corner of LYON	123°30'	1604	7.68	23
65	SW corner of LYON	139°10'	1544	8.83	24
66	S end of Bourges	89°10'	2570	9.65	25
67	SW interior near Verberie	89°45'	2637	8.06	26
68	Just north of Pt. 66	87°45'	2716	7.82	27
69	Cobble Floor in Nice	87°30'	2478	7.90	28
70	SW corner of Cannes	90°45'	1828	6.85	29
71	Just north of Pt. 67	83°25'	2175	7.45	30
72	platform in Nice - cobble floor (elevation for floor)		2546		31
73	NE corner of Cannes	73°30'	2276	6.62	32
74	NE corner of Bourges	73°30'	2696	9.61	33
75	NE edge of Megelore	71°45'	2693	8.68	34
76	N edge of Megelore	66°15'	1697	8.10	35
77	NW edge of Megelore	69°45'	2593	7.44	36
78	NW edge of Etretat	66°40'	2435	5.35	37
79	W of Point 72 / S of Pt. 77	73°15'	2169	5.35	38
80	NE Inside corner of Bourges	74°45'	2373	8.93	39
81	W edge of Verberie	89°45'	2211	9.26	40
	E edge of Verberie	91°30'	1796	6.95	

Op. 12H (Cont'd)

	Initials	Date
Prepared By		
Approved By		

Point.	\angle	Mid.	Dist.
SE inside corner of stairwell on Pierrefronds	$109^{\circ}30'$	2133	10.37
SE inside corner/wall (NORTH) of LYON	$121^{\circ}45'$	2342	8.08
South end of "wall" - Sub Point 83	$125^{\circ}00'$	2328	8.59

P95-63-50

3/30/95

Yesterday morning I finished the description of my features. At lunch, I went to the new site (# 175) and set up a trench N/S on St. 9, we also cleaned the mound of brush.

Morning:

I'm going to dig on site # 470 first. So I took 6 excavators with me. I'm going to set up 2 test trenches 2x1m on the structure 2 that seems the best preserved and a test trench 2x1m on the smaller one (St. 1) for now. Those trenches are oriented N/S or E/W. We started excavating St. 1 with Lot 1 (470B, Unit 1 level 1 \rightarrow 40cm) and St. 2 with Lot 1 (470C, Unit 1 level 1 \rightarrow 40cm) and Lot 2 (Unit 3 level 1 \rightarrow 40cm). In Lot 1 of 470C, we exposed a wall oriented N/S. In Lot 1 of 470B, it's ~~not~~ really confusing, we may have a wall but I'm not sure, so we started excavating in the other unit with Lot 2 (Unit 2 level 1 \rightarrow 40cm). In Lot 2 of op 470C, we may have exposed another wall oriented N/S, so we kept excavating to see what's going on with Lot 3 (Unit 4 level 1 \rightarrow 40cm).

Afternoon:

We kept excavating Lots 1, 2, 3. We finished Lot 1 (470B/C) and we really have a wall that is made with cut block. We kept excavating with Lot 4 (Unit 2 level 1 \rightarrow 30cm) to see if we can get the thickness of the wall and if there is anything else. In Lot 2 of 470B, we exposed another wall that is parallel to the first one, those walls are oriented 20° E of N. I named the wall in the unit "SAMIR" and

P95-63-51

3/30/95

the second one in the unit 2 "FATIMA". In Lot 4 (op 470C), we exposed another wall parallel to the first one. I named those walls (first one) "SATURNE" and (2nd one) "JUPITER".

3/31/95

Morning: We kept excavating Lot 3 and we set up one more test trench on op 470C to find a perpendicular wall to SATURNE or JUPITER. We started excavating Lot 5 (470C, Unit 5 level 1 \rightarrow 40cm). We also set up another test trench on op 470B to find a wall perpendicular to SAMIR or FATIMA, we started excavating Lot 3 (Unit 3 level 1 \rightarrow 40cm). In Lot 3 (op 470C), there is no feature. We also set up one more test trench (D95-63-08/09) to look for a parallel wall to SATURNE and JUPITER. We started excavating with Lot 6 (470C, Unit 7 level 1 \rightarrow 40cm). In Lot 5 (470C), we exposed a wall that is perpendicular to SATURNE and JUPITER than I named "VENUS".

Afternoon:

We kept excavating Lot 3 in op 470B and Lots 6, 7 in op 470C. Mike gave me 2 excavators (Don Louis and Don Enlofio), so we opened up 1 more test trench ^{in 470B} and we started digging Lot 4 (Unit 5 level 1 \rightarrow 40cm). In Lot 3 (op 470B), we don't have any features, so we kept excavating with Lot 5 (Unit 4 level 1 \rightarrow 40cm). In Lot 6 (op 470C) we may have a wall but I'm not sure, so we kept digging Lot 8 (Unit 8 level 1 \rightarrow 20cm). In Lot 7 (op 470C), we don't have any features and only collected a little bag of sherds.

P95-63-52

4/3/95

Morning:

We kept excavating Lots 4 and 5 op 470B, and Lot 8 op 470C. We also extended the test trench on op 470C to find the junction between the walls SATURNE and VENUS, with Lot 9 (Unit 9 level 1 o \rightarrow 40cm). In Lot 4 op 470B there are no features but we collected one good bag of sherds so we kept digging Lot 6 (Unit 6 level 1 o \rightarrow 40cm). In Lot 5, we found a wall named "MAHOMET" that is oriented 60° W of N. I sent 2 excavators to Mike who started on the other side near me. In Lot 8 op 470C, we exposed a wall that is oriented 8° E of N, this wall is named "MARS". And we have another wall in Lot 6 than I named "MERCURE". It is also oriented 8° E of N. We are going to ~~open extended~~ north the test trench (Units 3, 4) because I think we have part of a wall in Unit 3. But we need to move a dirt pile. We started excavating Lot 10 (Unit 10 level 1 o \rightarrow 40cm). In Lot 6 op 470B, we exposed the continuation of SAMIR. In Lot 9 op 470C, we exposed the continuation of SATURNE and a junction with VENUS, but it seems like the wall SATURNE keeps going south after the junction, so we kept excavating with Lot 11 (Unit 11 level 1 o \rightarrow 40cm). We started digging Lot 7 (Unit 7 level 1 o \rightarrow 40cm) to follow this wall.

Afternoon:

We kept excavating Lot 7 op 470B and Lots 10 and 11 op 470C. In Lot 7, we exposed the continuation of the walls SAMIR and FATIMA, we also are taking out some rocks in Unit 1 and Unit 2 that were out of place. In Lot 10, we exposed the connection of the wall JUPITER and VENUS, it looks also like there is a wall perpendicular to the prolongation of SATURNE oriented \approx E/W but it's

P95-63-53

4/3/95

hard to say because this wall is in the trench wall, so we started excavating Lot 12 (Unit 12 level 1 \rightarrow 20 cm). In Lot 11 (op 470C), we exposed the thickness of the wall NEPTUNE.

Morning:

4/4/95

We kept excavating Lot 12 op 470C and we started digging Lot 13 op 470C (Unit 13 level 1 \rightarrow 40 cm) to follow Neptune. We also started excavating Lot 8 (Unit 8 level 1 \rightarrow 40 cm) op 470B. In Lot 12, we exposed the corner of the prolongation to the wall SATURNE and part of the wall perpendicular to it, so we kept excavating Lot 14 (Unit 14 level 1 \rightarrow 20 cm). In Lot 8 op 470B, we exposed the continuation of SAMIR, but not the continuation of Fatima, so we kept digging Lot 9 (Unit 9 level 1 \rightarrow 40 cm) to find the corner between the walls SAMIR and Mahomet. In Lot 14 (op 470C), we exposed the continuation of the wall perpendicular to SATURNE that I named LUNE, this wall gets wider going Est, there is also a big cut block in the wall. So we kept excavating Lot 15 (Unit 15 level 1 \rightarrow 20 cm). In Lot 13 (op 470C), we exposed the continuation of Neptune but this part of the wall looks like tumble (on the thickness), so we kept excavating Lot 16 (Unit 16 level 1 \rightarrow 40 cm). In Lot 9 (op 470B), we exposed the corner of the walls SAMIR and Mahomet. We kept excavating Lot 10 (Unit 10 level 1 \rightarrow 40 cm) to find the corner of Fatima. In Lot 15 (op 470C), we exposed the continuation of LUNE, but we are going to dig Lot 17 (Unit 17 level 1 \rightarrow 60 cm) like this I have a full profile to draw. In Lot 17 (op 470C), we exposed a wall running in between the walls JUPITER AND MARS

P95-63-54

4/4/95

this wall is probably running all the way across.
I named this wall "TERRE".

4/5/95

Morning:

We kept excavating Lot 10 (op 470B) and Lot 16 (op 470C). I'm going to start drawing the profile of 470C. In Lot 10, we exposed the corner of "Fatima" and the wall that keeps going after the corner, I named this wall "Kamel". I had Don Luis and Don Enlofio stop because I can't have them work anywhere else before I draw the profile of this structure. In Lot 16, we exposed the corner of the walls "Neptune" and "Mars", this part of the structure is not as well as the rest of the ~~str~~ mound. I also had those other excavators stop. I finished the profile of op 470C, so now I will draw the section of op 470B. I finished the last profile.

Afternoon:

We started excavating Lot 11 (Unit 11 level 10 \rightarrow 40cm) op 470B to follow Mahomet and see if the corner is preserved. We also kept digging in op 470C with Lot 18 (Unit 18 level 10 \rightarrow 60cm) to follow the wall Mars. In Lot 11 (op 470B), we exposed the continuation of the wall Mahomet. Lot 18 is not finished.

4/6/95

Morning:

We kept excavating Lot 18 (op 470C) and we started digging Lot 19 (Unit 19 level 10 \rightarrow 40cm) op 470C to have enough space to dig the other side of wall TERRE. We also started excavating Lot 12 (Unit 12 level 10 \rightarrow 40cm) op 470B to follow the wall KAMEL. In Lot 18 (op 470C), we exposed the interior

p95-63-55

4/6/95

side of the wall "Mars" that is really poorly preserved in comparison to SATURNE and VENUS. We started excavating Lot 20 (Unit 20 level 1 \rightarrow 40 cm) to expose more of the exterior side of Mars. In Lot 12 (op 470B) we exposed the continuation of the wall KAMEL that may make this turn right in the edge of the unit, but we kept excavating Lot 13 (Unit 13 level 1 \rightarrow 40 cm) to see if the corner of the wall Mahomet is still there. In Lot 13, we exposed the continuation of Mahomet and the end, the wall is totally gone, the corner is not preserved. We started digging Lot 14 (Unit 14 level 1 \rightarrow 20 cm) to clear the top of the structure. There ^{are} ~~is~~ not ~~anymore~~ features in Lot 19, so we kept excavating Lot 21 (Unit 17 level 2 \rightarrow 40 cm) to expose the other side of the wall TERRE.

Afternoon:

We kept excavating Lot 14 (op 470B) and lots 20, 21 (op 470C). In Lot 20, we exposed the continuation of Mars, we kept digging Lot 22 (Unit 21 level 1 \rightarrow 40 cm) to expose the corner. Lot 14 is empty, so we started excavating Lot 15 (Unit 15 level 1 \rightarrow 40 cm), this unit is partially in the destroyed zone but we may get the corner of KAMEL and part of the wall after the corner. In Lot 21, we exposed the other side of TERRE.

P95-63.56

4/7/95

* that is perpendicular to KANEL, I
named this wall

Morning:

We kept excavating Lot 15 (op 470B) and Lot 22 (op 470C). We also started digging Lot 23 (Unit 22 level 1 $\circ \rightarrow 40\text{cm}$) to follow TERRE. In Lot 15, we exposed the $\frac{1}{2}$ wall *Naomi, this wall is preserved for $\approx 1.65\text{m}$. We started excavating Lot 16 (Unit 16 level 1 $\circ \rightarrow 40\text{cm}$). In Lot 22, we exposed the continuation of the wall Mars, but it looks like Mars keeps going straight after this junction with the wall NEPTUNE, so we kept excavating Lot 24 (Unit 23 level 1 $\circ \rightarrow 40\text{cm}$). In Lot 23, we exposed the continuation of ~~the~~ TERRE, so we kept digging Lot 25 (Unit 24 level 1 $\circ \rightarrow 50\text{cm}$) to expose the other side of the wall. In Lot 16, we exposed the other corner of Fatima and the wall that runs after the corner and is preserved for 75cm . I named this wall "ISMAËL". We kept excavating Lot 17 (Unit 17 level 1 $\circ \rightarrow 20\text{cm}$) op 470B to clear the top of the structure.

Afternoon:

We finished Lot 17. We started excavating Lot 18 (Unit 10 level 2 $20 \rightarrow 40\text{cm}$) to verify if the part of Fatima where we don't have any rocks is because this part of the wall is poorly preserved or it is an entrance to the top room. In Lot 24, we exposed clearly the junction with Mars and Neptune. In Lot 25, we exposed the continuation of TERRE, we also found a entire "polished axe". In Lot 18, we did not expose anything special except tumble.

P95-63-57

4/17/95

Morning:

We all are going to work ~~op~~ on op 470C now. So we opened up Lots 26 (Unit 25 level 1 \rightarrow 40cm), 27 (Unit 26 level 1 \rightarrow 40cm) and 28 (Unit 27 level 1 \rightarrow 40cm). For myself, I'm going to draw again the profile of op 470B on the length and the width. In Lot 28, we exposed the continuation of JUPITER that is really well preserved. We are taking down Unit 6 to the same level as the other units around with Lot 29. We also ~~starting~~ started digging Lot 31 (Unit 29 level 1 \rightarrow 40cm). Lot 26 is empty of features except a possible wall that we can see on the west profile of the wall trench. We started excavating Lot 30 (Unit 28 level 1 \rightarrow 40cm) to expose the wall Neptune. In Lot 27, we have the continuation of ~~Neptune~~ SATURNE but on the East trench wall, so we started digging Lot 32 (Unit 30 level 1 \rightarrow 40cm).

Afternoon:

We kept excavating Lots 30, 31, 32. In Lot 31, we exposed the continuation of SATURNE, ~~we started excavating~~ this part of the wall is composed of 2 big cut blocks (flat faces). In Lot 30, we exposed the continuation of Neptune, we started excavating Lot 33 (Unit 31 level 1 \rightarrow 40cm) to verify if there is really a wall in this Unit. We also started digging Lot 34 (Unit 32 level 1 \rightarrow 20 cm). In Lot 32, we exposed the continuation of SATURNE.

P95-63-58

4/18/95

Morning:

We kept excavating Lots 33 and 34. And we also started digging Lot 35 (Unit 33 level 1 \rightarrow 40cm). In Lot 34, we exposed the continuation of LUNE and it's ending because the rocks were removed, you can see the depression in the earth. We kept excavating Lot 36 (Unit 34 level 1 \rightarrow 40cm). In Lot 33, we exposed a little wall perpendicular to Neptune about 80 cm long, the wall Neptune seems like it stops in this little wall that I named PLUTON. We also exposed what I supposed to be the end of SATURNE. We kept digging Lot 37 (Unit 35 level 1 \rightarrow 40cm). In Lot 36, we exposed the continuation of VENUS, we kept excavating with Lot 38 (Unit 36 level 1 \rightarrow 40cm). In Lot 38 we exposed the continuation of VENUS and this corner with Mars, we kept excavating Lot 39 (Unit 37 level 1 \rightarrow 40cm). In Lot 35, we exposed the continuation of SATURNE and the beginning of the corner, we kept excavating Lot 40 (Unit 38 level 1 \rightarrow 40cm). In Lot 37, we exposed the interior corner of Neptune and SATURNE.

Afternoon:

We kept excavating Lots 39 and 40, I think we may get done today with this structure. In Lot 40, we exposed the exterior corner of Neptune and SATURNE. We took out some rocks in Lot 33 that were tumble. In Lot 39, we exposed the thickness of MERCURE and Mars, those two are apparently one wall.

Morning:

4/19/95

We kept cleaning in Lot 33 and started digging Lot 41 (Unit 39 level 1 \rightarrow 40cm) along the wall to discover the other side of the wall. In Lot 41, we exposed the other side of Mars-Mercure.

P95-63-59

Features Description

OP470B

4/19/95

Wall SAMIR: This wall is made out of limestone. Half of the wall is tilted toward the outside. The rocks have flat faces on the outside. Most of the rocks are basal rocks except at the extreme N/W end, we have two level of stone. This wall is preserved for 5.20m, the N/W corner has been destroyed, the thickness is equal to 35cm, and the height 30cm. ORIENTATION: 28° E of N.

Wall Mahomet: This wall is made out of the same kind of stone. Flat faces on the outside. 2 levels of stone are preserved. The S/E corner and part of the wall have been destroyed by plowing. This wall is preserved for 3.85m, the thickness is equal to 30cm, and the height to 35cm. ORIENTATION: 114° E of N.

Wall NAOMI: This wall is part of the ~~so~~ summit room. The same technic and material are used. Only the basal rocks are preserved. This wall is preserved for 1.75m (case plowing), the tickness is equal to 40cm and the height 20cm. ORIENTATION: 25° E of N.

Wall KAMEL: This wall is also part of the summit room. The same technic and material are used. Only the basal rocks are preserved. This wall is 1.70m long, the thickness is equal to 40cm and the height to 35cm.

ORIENTATION: 114° E of N.

Wall Fatima: This wall is also part of the summit room. The same technic and material are used. For most of the wall only the basal rocks are preserved. This wall probably has a early stage that is visible right after the corner of KAMEL because we dug deeper. This wall is 3.25m long, the thickness is equal to 25cm and the height to 20cm. ORIENTATION: 25° E of N and 20° E of N for the early stage.

P95-63.60

Features Description (continued)

Wall ISMAËL: This wall is made out of the same stone. Flat faces on the outside. Only the basal rocks are preserved. This wall has been heavily destroyed by plowing, it is preserved for 0.75m. The thickness is equal to 22 cm and the height to 30 cm.

Orientation: 98° E of N.

Wall ILLAM: This wall is separated the summit on 2 part. The first one is a room and the second one is a platform. The wall is 1.70m long, the thickness is equal to ~~15cm~~ 15cm (because made out of small rocks) and the height to 10 cm. ORIENTATION: 114° E of N.

Features Description op 470C

Wall SATURNE: This wall is made of the same kind of stone as the other structure. We only have the basal rocks preserved. Generally the wall is made of big stone but also has big cut blocks with flat faces on one spot. This wall has 2 ~~different~~ stages of construction that are made by different types of building and you also can clearly see the part of wall added about the original wall at 2.50m (measured from the N/W corner). The total length of the wall is 5.80m. The second stage of the wall is made of big and medium sized stone. That part is 2.50m long, the thickness is 50cm and the height is 20 cm. The first stage of the wall is made of big sized stone and the 2 cut stones are placed in between 3.00m and 4.60m, the length of that stage is 3.30m, the thickness is 40cm and the height is 20 cm. The extreme south end of the wall is only 30 cm thick. ORIENTATION: \rightarrow N/S

Features Description (Continued)

Wall NEPTUNE: This wall is made out of the same kind of stone as the other structure. Only the basal rocks are preserved. Medium and small rocks have been used to build that wall (really poorly made). This wall is 4.80m long. The thickness is 50cm and the height 30cm. This wall also has a little wall sticking out at 90cm from the N/W corner, the wall PLUTON. ORIENTATION NEPTUNE:  E/W.

Wall PLUTON: This wall is made of the same kind of stone (small rocks size). This wall is 70cm long, the thickness is 40cm and the height 10 to 15 cm. ORIENTATION:  N/S

Wall MERCURE, MARS: This wall is made of limestone, big and medium sized stone. This wall has 2 different stages. The 1st stage is finer than the 2nd one. This wall is 4.50m long, thickness 80cm (1st stage) and a 1m (2nd stage), the height is 20 to 25 cm. Only the basal rocks are preserved. ORIENTATION:  N/S

Wall TERRE: This wall is made of limestone, medium and small sized stone. This wall is the most nicely preserved wall on the structure, 40cm high, 2.70m long and 40 to 45 cm wide. ORIENTATION: ~~96°~~ 96° E of N

Wall JUPITER: This wall is made of the same kind of stone as the other wall, with medium and small sized stone. The wall is 2.70 long. The thickness is 55 to 60 cm and the height is 40 cm. Pretty nicely preserved. ORIENTATION:  N/S.

Wall VENUS: This wall is made of big, medium and small limestone. The wall is 4.00m long and 60 cm wide, the height is 30 cm (2 levels of stone preserved). Pretty well preserved. ORIENTATION:  E/W

P95-63-62

Features Description (continued)

Wall LUNE: This wall is made of medium and small limestone and also has a rectangular cut stone (1m x 0.4m) on the middle of the wall that is a basal rock (I presume). The wall is 3.55 long, the thickness is 40 to 60 cm and the height is 20 cm. Only the basal rocks are preserved. ORIENTATION:  E/W

For this structure, I presume that the original building was composed by the walls, TERRE, part of SATURNE, VENUS and MERCURE-MARS part of. And then were added to ~~it~~ at a ~~late~~ latest stage the walls NEPTUNE the extensions of MERCURE-MARS and SATURNE. And at same time or later one comes the addition of the wall LUNE.

470 sub op B

St.1

- Lot 1 → Unit 1 level 1 ○ → 40 cm
- Lot 2 → Unit 2 level 1 ○ → 40 cm
- Lot 3 → Unit 3 level 1 ○ → 40 cm
- Lot 4 → Unit 5 level 1 ○ → 40 cm
- Lot 5 → Unit 4 level 1 ○ → 40 cm
- Lot 6 → Unit 6 level 1 ○ → 40 cm
- Lot 7 → Unit 7 level 1 ○ → 40 cm
- Lot 8 → Unit 8 level 1 ○ → 40 cm
- Lot 9 → Unit 9 level 1 ○ → 40 cm
- Lot 10 → Unit 10 level 1 ○ → 40 cm
- Lot 11 → Unit 11 level 1 ○ → 40 cm
- Lot 12 → Unit 12 level 1 ○ → 40 cm
- Lot 13 → Unit 13 level 1 ○ → 40 cm
- Lot 14 → Unit 14 level 1 ○ → 20 cm
- Lot 15 → Unit 15 level 1 ○ → 40 cm
- Lot 16 → Unit 16 level 1 ○ → 40 cm
- Lot 17 → Unit 17 level 1 ○ → 20 cm
- Lot 18 → Unit 10 level 2 20 → 40 cm
- Lot 19 → Unit 4, 10, 12, 14 = Room 1 level 2 40 → 70 cm

OP 470 sub op C St. 2

Lot 1	→ Unit 1 level 1	○ → 40 cm
Lot 2	→ Unit 3 level 1	○ → 40 cm
Lot 3	→ Unit 4 level 1	○ → 40 cm
Lot 4	→ Unit 2 level 1	○ → 30 cm
Lot 5	→ Unit 5 level 1	○ → 40 cm
Lot 6	→ Unit 7 level 1	○ → 30 cm
Lot 7	→ Unit 6 level 1	○ → 40 cm
Lot 8	→ Unit 8 level 1	○ → 40 cm
Lot 9	→ Unit 9 level 1	○ → 40 cm
Lot 10	→ Unit 10 level 1	○ → 40 cm
Lot 11	→ Unit 11 level 1	○ → 40 cm
Lot 12	→ Unit 12 level 1	○ → 20 cm
Lot 13	→ Unit 13 level 1	○ → 40 cm
Lot 14	→ Unit 14 level 1	○ → 20 cm
Lot 15	→ Unit 15 level 1	○ → 20 cm
Lot 16	→ Unit 16 level 1	○ → 40 cm
Lot 17	→ Unit 17 level 1	○ → 10 cm
Lot 18	→ Unit 18 level 1	○ → 60 cm
Lot 19	→ Unit 19 level 1	○ → 40 cm
Lot 20	→ Unit 20 level 1	○ → 40 cm
Lot 21	→ Unit 20 17 level 2	10 → 40 cm
Lot 22	→ Unit 21 level 1	○ → 40 cm
Lot 23	→ Unit 22 level 1	○ → 40 cm
Lot 24	→ Unit 23 level 1	○ → 40 cm
Lot 25	→ Unit 24 level 1	○ → 50 cm
Lot 26	→ Unit 25 level 1	○ → 40 cm
Lot 27	→ Unit 26 level 1	○ → 40 cm
Lot 28	→ Unit 27 level 1	○ → 40 cm
Lot 29	→ Unit 6 took this unit as the same level as the others units.	
Lot 30	→ Unit 28 level 1	○ → 40 cm
Lot 31	→ Unit 29 level 1	○ → 40 cm

Lot 32 → Unit 30 level 1 o → 40cm
Lot 33 → Unit 31 level 1 o → 40cm
Lot 34 → Unit 32 level 1 o → 20cm
Lot 35 → Unit 33 level 1 o → 40cm
Lot 36 → Unit 34 level 1 o → 40cm
Lot 37 → Unit 35 level 1 o → 40cm
Lot 38 → Unit 36 level 1 o → 40cm
Lot 39 → Unit 37 level 1 o → 40cm
Lot 40 → Unit 38 level 1 o → 40cm
Lot 41 → Unit 39 level 1 o → 40cm

SITE 470 (Circle's)
4/21/95 IH ~ 1450

Prepared By	Initials	Date
Approved By		

1 2 3 4 5 6

	Point	4	mid.	Distance (m)	
1	Subpc see plan	✓ 115°45'	1713	5.77	1
2		✓ 133°45'	1713	7.28	2
3		✓ 147°00'	1600	8.45	3
4		✓ 150°30'	1702	9.28	4
5		✓ 143°45'	1645	9.10	5
6		✓ 131°30'	1310	7.40	6
7		✓ 131°30'	1406	8.02	7
8		✓ 140°00'	1744	10.15	8
9		✓ 137°00'	1684	11.53	9
10		✓ 128°45'	1640	12.00	10
11		✓ 122°30'	1678	10.21	11
12		✓ 107°45'	1669	10.18	12
13		✓ 112°00'	1826	6.87	13
14		✓ 108°30'	1876	6.47	14
15		✓ 138°00'	1607	7.15	15
16		✓ 122°30'	1354	9.39	16
17		✓ 129°00'	1479	11.21	17
18		✓ 140°00'	1466	9.11	18
19		✓ 112°15'	1459	9.30	19
20		✓ 119°30'	1494	6.56	20
21	Subpc B. see plan	✓ 2°00'	1455	12.08	21
22		✓ 346°30'	1725	7.62	22
23		✓ 12°00'	1484	6.27	23
24		✓ 10°00'	1352	9.56	24
25		✓ 6°30'	1340	7.45	25
26		✓ 353°30'	1210	8.06	26
27		✓ 358°30'	1087	9.52	27
28		✓ 1°00'	1271	11.09	28
29		✓ 3°15'	1120	10.98	29
30		✓ 6°45'	1206	10.84	30
31		✓ 7°15'	1177	9.02	31
32	middle unexcav. Str. (46.5cm diam.)	✓ 87°15'	1693	16.48	32
33	PD 470 → P.D. 471 (m. h.c.) excavations	✓ 343°00'	1057	17.95	33
34					34
35					35
36					36
37					37
38					38
39					39
40					40

P95_63_63

4/19/95

Morning:

After we finished op 470C, we moved over to op 175 St. 9 sub op D. I had already set up a test trench 8m long, so we started excavating Lot 1 (138N-235E level 1 $\circ \rightarrow$ 40cm) and Lot 2 (145N-235E level 1 $\circ \rightarrow$ 40cm). In lot 1 and 2, we exposed features, but not perpendicular to the trench, so we moved to a better angle. Now the new test trench is ~~40~~ 140° E of N.

Afternoon:

We started excavating at both ends of the trench with Lot 3 (450N-650E level 1 $\circ \rightarrow$ 40cm) and Lot 4 (457N-650E level 1 $\circ \rightarrow$ 40cm). In lot 3, we exposed a wall running across the test trench.

Morning:

4/20/95

We kept excavating lot 4 and we extended the test trench 1 more meter to get to the limit of the features and we started excavating lot 5 (449N-650E level 1 $\circ \rightarrow$ 40cm). In lot 4, there is no features so we kept excavating with Lot 6 (456N-650E level 1 $\circ \rightarrow$ 40cm). In lot 5, we exposed another wall that is parallel to the one in lot 3. We kept excavating w/ lot 7 (451N-650E level 1 $\circ \rightarrow$ 40cm). In lot 6, we may have a line but it's not clear, so we kept excavating w/ lot 8 (455N-650E level 1 $\circ \rightarrow$ 40cm). In lot 7, we may have exposed a paved terrace, so we kept digging w/ Lot 9 (452N-650E level 1 $\circ \rightarrow$ 40cm).

Afternoon:

We kept excavating lots 8 and 9. In lot 8, we exposed another wall, but it is poorly preserved. In lot 9, we exposed a wall almost perpendicular to the trench.

P95-63-64

4/21/95

Morning:

We kept excavating the test trench w/ lot 10 (454 N-650 E level 1 $\circ \rightarrow$ 40cm) and lot 11 (453 N-650 E level 1 $\circ \rightarrow$ 40cm). In lot 11, we exposed the continuation of the wall we have in lot 9 and also exposed a cross wall. In lot 10, we exposed the other side of the wall we have in lot 11. Ed came to the site to shoot the points on our structures w/ the transit, so I helped him with my structures for part of the morning. We set up another trench perpendicular to the first one.

Afternoon:

We started excavating in the new trench w/ lot 12 (453 N-653 E level 1 $\circ \rightarrow$ 40cm) and lot 13 (453 N-647 E level 1 $\circ \rightarrow$ 40cm). In lot 12, we exposed a wall perpendicular to the trench.

P95-63-65

4/24/95

Morning:

Today, We are up to 8 excavators. We kept excavating Lot 13 and we started Lot 14 (453N-652E level 1 \rightarrow 40cm), Lot 15 (450N-647E level 1 \rightarrow 40cm) and Lot 16 (449N-648E level 1 \rightarrow 40cm). In Lot 13, we exposed what could be a wall but I'm not sure. We started excavating Lot 17 (453N-651E level 1 \rightarrow 40cm). In Lot 14, we have the continuation of the wall Boulder, so we kept excavating Lot 18 (453N-651E level 1 \rightarrow 40cm). In Lot 18, we exposed the continuation of Boulder and its junction with Leiden. In Lot 15, we exposed the continuation of the wall we had in Lot 1. I named this wall AMSTERDAM, we kept excavating with Lot 19 (451N-647E level 1 \rightarrow 40cm). In Lot 17, we exposed what I suppose to be another wall. We kept excavating with Lot 20 (453N-649E level 1 \rightarrow 40cm). In Lot 16, we don't have any features, so we kept excavating with Lot 22 (450N-648E level 1 \rightarrow 40cm).

Afternoon:

We extended the grid on the N/E side and started excavating Lot 21 (454N-653E level 1 \rightarrow 40cm). In Lot 21, we exposed a wall perpendicular to Boulder, I named this wall Interlaken.

4/25/95

Morning:

We kept excavating Lots 19, 20, 22 and we started Lot 23 (455N-653E level 1 \rightarrow 40cm). In Lot 20, we exposed the continuation of Boulder and its junction with a wall perpendicular to it and parallel to LEIDEN that I named GRINDELWALD. We kept digging with Lot 24 (452N-649E level 1 \rightarrow 40cm). In Lot 22, we exposed the continuation of AMSTERDAM and BRUGGES. We kept excavating Lot 25 (449N-649E level 1 \rightarrow 40cm). In Lot 23,

P95-63-66

4/25/95

we exposed the continuation of Interlaken and its corner, we kept excavating with Lot 26 (455N-652E level 10-40cm). In Lot 19, we exposed the continuation of BRUGGES, we also exposed another wall but we need to excavate more to see what's going on, Lot 27 (452N-647E level 10-40cm). In Lot 26, we exposed a wall perpendicular to Interlaken, I named this wall WALLERTHEIM, we kept excavating Lot 28 (454N-652E level 10-40cm). In Lot 24, we exposed the continuation of GRINDELWALD, we kept excavating with Lot 29 (451N-649E level 10-40cm).

Afternoon:

We kept excavating Lots 25, 27, 28, and 29. We finished Lot 25 and kept digging Lot 30 (450N-649E level 10-40cm). In Lot 28, we exposed a little room formed by the walls Boulder, Interlaken, Wallertheim and probably another one that will be parallel to Interlaken. We kept excavating w/ Lot 31 (454N-651E level 10-40cm). In Lot 29, we exposed the continuation of the stone floor that I named Iowa City. We started excavating Lot 32 (457N-651E level 10-40cm) for artifact sample. In Lot 27, we exposed a wall parallel to GRINDELWALD that I named Denver, and probably another one perpendicular to it, but I'm not sure. In Lot 31, we exposed a wall perpendicular to Boulder that I named St Louis and we also exposed another stone floor made out of small stone. This stone floor may actually be a bench, I named this feature SAN FRANCISCO.

P95-63-67

4/26/95

Morning:

We kept excavating Lots 30, 32. And we started digging Lot 33 (455N-651E level 1 \rightarrow 40cm). Today, I have 1 guy missing so I sent the other guy to work with Nick because he also has a lone guy. Lot 32 may have a little line of rock but I don't know if it's anything. We kept excavating Lot 34 (457N-648E level 1 \rightarrow 40cm). In Lot 30, we exposed the continuation of AMSTERDAM and BRUGGES, we kept digging Lot 35 (451N-648E level 1 \rightarrow 40cm). In Lot 33, we exposed the continuation of Wallertheim. We started cleaning the other side of the structure. Lot 34 has no features. We kept excavating Lot 36 (456N-651E level 1 \rightarrow 40cm). In Lot 35, we exposed the continuation of a stone floor that I named Santa Fe. We kept excavating Lot 37 (452N-648E level 1 \rightarrow 40cm) and started Lot 38 (456N-649E level 1 \rightarrow 40cm). In Lot 36, we exposed the continuation of Wallertheim, we kept digging Lot 39 (456N-652E level 1 \rightarrow 40cm).

Afternoon:

We kept excavating Lots 37, 38 and 39. In Lot 38, we lost the wall Wallertheim, so we kept excavating Lot 40 (455N-649E level 1 \rightarrow 40cm). In Lot 39, we ~~exposed~~ exposed the part of Wallertheim that wasn't exposed. We had to move a rock pile to extend the grid on the S/E side. In Lot 38, we exposed the thickness of GRINDELWALD, it is a really thick wall. We kept excavating Lot 41 (454N-647E level 1 \rightarrow 40cm). We found a big piece of Metate in the rock pile.

P95-63-68

4/27/95

Morning:

We kept excavating Lots 40, 41. We also extended the grid in the S/E side of the mound and started excavating Lot 42 (452N-653E level 1 0-40cm). Lot 40 doesn't have any features. We kept digging Lot 43 (454N-649E level 1 0-40cm). In Lot 42, we exposed what may be the connection between St. 9 and St. 7. We kept excavating w/ Lot 44 (452N-652E level 1 0-40cm). In Lot 43, we exposed the other side of Boulder. We are going to dig deeper in this unit w/ Lot 45 (454N-649E level 1 0-40cm). In Lot 44, we exposed a line of rock made of small stone that is on the same line as the wall Interlaken, we kept excavating w/ Lot 46 (452N-651E level 1 0-40cm). Lot 41 doesn't have any features, so we kept excavating. Lot 47 (455N-647E level 1 0-40cm) for artifact sample.

Afternoon:

We kept excavating Lots 45, 46 and 47. In Lot 45, we went through the fill to see if we had anything underneath, but we don't, so we kept excavating w/ Lot 48 (454N-648E level 1 0-40cm). In Lot ~~45~~ 46, we exposed more of LEIDEN, we kept digging w/ Lot 49 (451N-651E level 1 0-40cm). In Lot 48, we exposed the continuation of Boulder, we kept excavating Lot 50 (455N-648E level 1 0-40cm). In Lot 49, we exposed an interior wall that is adjacent to the stone surface. Lot 47 doesn't have any sherd.

P95-63-69

4/28/95

Morning:

Today I have 8 excavators.

We kept excavating Lot 50 and we started digging Lot 51 (449N-651E level 1 $\circ \rightarrow$ 40cm), Lot 52 (451N-652E level 1 $\circ \rightarrow$ 30cm) and 53 (456N-647E level 1 $\circ \rightarrow$ 40cm). In Lot 52, we exposed more of the wall that is on the line as Interlaken, I named this wall DURANGO and we also exposed the corner w/ the wall adjacent to the stone floor, I named this wall LA CROSSE. We kept excavating Lot 54 (451N-653E level 1 $\circ \rightarrow$ 30cm). In Lot 51, we exposed the continuation of AMSTERDAM, so we kept excavating w/ Lot 55 (450N-651E level 1 $\circ \rightarrow$ 40cm). In Lot 53 we didn't collect many sherds, so we kept excavating Lot 56 (456N-648E level 1 $\circ \rightarrow$ 40cm). In Lot 50, we exposed the corner of Boulder and GRINDELWALD. I had Don Luis and Don Enlofio dig the room on at op 470B. In Lot 54, we exposed the continuation of DURANGO, we kept excavating Lot 57 (450N-653E level 1 $\circ \rightarrow$ 30cm).

Afternoon:

We kept excavating Lots 55, 56, and 57. In Lot 57, we exposed more of DURANGO. We kept digging Lot 58 (450N-652E level 1 $\circ \rightarrow$ 30cm). In Lot 55, we exposed more of AMSTERDAM. In Lot 56, we only collected a few sherds. In Lot 56, we ~~only~~ exposed more of DURANGO. We need to dig more unit to expose this junction w/ LACROSSE.

P95-63-70

5/2/95

Morning:

We started excavating Lot 59 (449N-652E level 1 \rightarrow 40cm). And we also started moving the back dirt to prepare to dig St. 7 and the extension of St. 9 toward St. 3. I'm helping Nick draw the profile of St. 6. I set up extensions of the grid to verify where some walls are going. We opened Lot 60 (450N-646E level 1 \rightarrow 40cm) to see what's going on w/ AMSTERDAM and BRUGGES, and Lot 61 (452N-654E level 1 \rightarrow 40cm) to see ~~what~~ where the wall that is perpendicular to DURANGO and oriented ~~AMSTERDAM~~ ~~and~~ toward St. 7 is going. We are also going to ~~set~~ set up a test trench on St. 7. The test trench is oriented 30° E of N and 7m long. We started excavating this structure w/ Lot 1 (356N-550E level 1 \rightarrow 40cm). In Lot 59, we exposed the continuation of AMSTERDAM. We kept excavating Lot 62 (449N-653E level 1 \rightarrow 40cm).

Afternoon:

We kept excavating Lots 60, 61 and 62 St. 9 and Lot 1 St. 7. In Lot 61, we found out that there is ~~no~~ no connection in between St. 9 and St. 7, that was only a fumble. In Lot 62, we exposed the end of AMSTERDAM. In Lot 1 St. 7, we exposed a wall perpendicular to the test trench, I named this wall SNOWBIRD. Lot 60 is not done.

P95-63-71

5/3/95

Morning:

We kept excavating Lot 60 and started Lot 63 (Room 1: 453N-649E/650E & 452N-649E/650E level 2 40 → 60cm) and Lot 64 (Room 2: 453N-651E/652E & 452N-651E/652E level 2 40 → 60cm). We also kept excavating the test trench of St. 7 w/ Lot 2 (355N-550E level 1 0 → 40cm). In Lot 60, we don't have any features, so we kept digging w/ Lot 65 (451N-646E level 1 0 → 40cm). In Lot 2 St. 7, we exposed the width of the wall SNOWBIRD that is 70 cm thick, its orientation is 60° E of N. We kept excavating w/ Lot 3 (354N-550E level 1 0 → 50cm). In Lot 3 St. 7, we exposed another wall perpendicular to the trench, this wall is a 1m south of SNOWBIRD. The wall is 50cm tall. I named that wall PURGATORY.

Afternoon:

We kept excavating Lot 63, 64 and 65 St. 9. And we started digging Lot 4 (353N-550E level 1 0 → 50cm). We finished digging in Lot 64 (we got to the basal rocks of the walls at 69cm on the N/W corner of the room). We kept excavating in Room 3 w/ Lot 66 (453N-652E level 2 40 → 60cm) only the part without the bench. In Lot 65, we exposed the continuation of Amsterdam, but BRUGGES stops. We extended the excavation to Lot 67 (451N-645E level 1 0 → 40cm). In Lot 63, we got to the basal rocks at 65cm on the N/E corner of the room.

p95-63-72

5/4/95

Morning:

We kept excavating lots 66, 67 and 4 on St. 7. We also opened up another unit in the test trench of St. 7 w/ Lot 5 (350N-550E level 10 \rightarrow 40cm). In Lot 66, we got to the basal rocks at 25cm on the N/E corner of the room. We opened up another unit on St. 7 but out of the test trench, w/ Lot 6 (356N-551E level 10 \rightarrow 40cm). In Lot 4, we exposed the interior face of PURGATORY, we kept excavating w/ Lot 7 (352N-550E level 10 \rightarrow 50cm). In Lot 6, we exposed the continuation of SNOWBIRD, we kept excavating w/ Lot 8 (355N-551E level 10 \rightarrow 40cm). In Lot 8, we exposed the continuation of the interior side of SNOWBIRD, the wall is higher on the units East of the test trench. (probably that by the road). In this unit, we found a lot of sherds from the same pot. We kept excavating w/ Lot 9 (354N-551E level 10 \rightarrow 50cm).

Afternoon:

We kept excavating lots 5, 7 and 9. In Lot 67 (St. 9), we realised that the extension of AMSTERDAM was in reality tumble so we took some rock in the unit 451N-646E. In Lot 7, we exposed another wall perpendicular to the test trench that wall is 2.10m away from SNOWBIRD and 50cm high, its orientation is 60° E of N, I named that wall ALTA. ~~lots~~ We kept excavating w/ Lot 10 (353N-551E level 10 \rightarrow 50cm). In Lot 9, we exposed the continuation of SNOWBIRD and also a corner that is oriented ~~to~~ 150° E of N, we kept excavating w/ Lot 11 (356N-552E level 10 \rightarrow 40cm). Lot 5 is really messy, there is a lot of tumble probably from St. 6 which is really close.

5/5/95

Morning:

We kept excavating Lots 10 and 11. We also started digging Lot 12 (350N-551E level 1 0 → 40cm). And we took out some rocks in the units 449N-652E/653E that were tumble. In Lot 11, we exposed the continuation of SNOWBIRD, we kept excavating Lot 19 (356N-553E level 1 0 → 40cm). In Lot 10, we exposed the interior side of a wall perpendicular to PURGATORY that I named SUGAR LOVE, we kept excavating w/ Lot 13 (352N-551E level 1 0 → 50cm). We finished the clearing on St. 9. We started excavating Lot 14 (355N-552E level 1 0 → 40cm). In Lot 19, we got the corner of SNOWBIRD, that is visible on the wall stretch, we kept excavating w/ Lot 15 (353N-552E level 1 0 → 40cm). In Lot 13, we exposed the continuation of SUGAR LOVE. We kept excavating w/ Lot 16 (351N-550E level 1 0 → 10cm) to clear the stop of ALTA. We kept clearing the stop of ALTA w/ Lot 17 (351N-551E level 1 0 → 10cm) &. In Lot 14, that's pretty messy, so we kept excavating w/ Lot 18 (355N-553E level 1 0 → 40cm) to have a better view.

Afternoon:

We kept excavating Lots 12, 17 and 18. In Lot 15, we exposed the exterior side of SUGAR LOVE but it seems like there is an addition to this wall, so we kept excavating w/ Lot 20 (354N-552E level 1 0 → 40cm) to have an extended view of the features. I drew the profile of St. 7. In Lot 12, we exposed the continuation of the exterior side of ALTA. In Lot 20, we exposed the continuation of SUGAR LOVE that ends on PURGATORY. In Lot 17, we exposed the top of ALTA. Lot 18 is not really clear.

P95-63-74

5/8/95

Morning:

We started cleaning St. 9 for pictures. I went w/ Mike to clean 470 and 471 and took pictures of the structures. We started excavating Lot 21 (354N-553E level 1 0 → 40cm), Lot 22 (356N-549E level 1 0 → 40cm), Lot 23 (353N-549E level 1 0 → 50cm) and Lot 24 (350N-552E level 1 0 → 40cm). In Lot 21, we exposed a wall parallel to SUGAR LOVE, I named that wall BIG SKY, we kept excavating w/ Lot 25 (353N-553 level 1 0 → 40cm).

Afternoon:

We kept excavating Lots 22, 23, 24 and 25. In Lot 23, we exposed the interior side of a wall perpendicular to PURGATORY, I named that wall SNOW BASIN. In Lot 25, we exposed the continuation of BIG SKY. Lots 22, 24 are not done.

5/9/95

Morning:

We kept excavating Lots 22, 24. We also started digging Lot 26 (352N-552E level 1 0 → 40cm) and Lot 27 (352N-549E level 1 0 → 50cm). In Lot 22, we got the continuation of SNOWBIRO on the south trench wall, so we kept excavating w/ Lot 28 (355N-549E level 1 0 → 40cm). In Lot 26, we kept exposed the continuation of SUGAR LOVE, we kept excavating w/ Lot 29 (352N-553E level 1 0 → 40cm). In Lot 28, we exposed the continuation of SNOWBIRO, we kept excavating w/ Lot 30 (354N-549E level 1 0 → 50cm).

Afternoon:

In Lot 27, we exposed the continuation of SNOWBASIN. We kept excavating w/ Lot 31 (352N-548E level 1 0 → 40cm). In Lot 24, we exposed the continuation of ALTA, we kept excavating w/ Lot 32 (351N-552E/3553E level 1 0 → 10cm). In Lot 29, we realized that BIG SKY is all tumble so we took out all the rocks. In Lot 30, we exposed the continuation of PURGATORY. We moved a dirt pile for the digging tomorrow. In Lot 32, we exposed the top of ALTA and SUGAR LOVE (JUNCTION).

p95 63-75

5/10/95

Morning:

We kept excavating Lot 31 and realized that what we thought was the interior side of SNOW BASIN in Unit 352N-549E was only tumble, so we took out all those rocks. We moved part of a rock pile to excavate the third corner of the structure. We started excavating Lot 33 (351N-553E level 2 0-40cm), Lot 34 (355N-548E level 1 0-40cm) and Lot 35 (351N-549E level 1 0-40cm). We finished Lot 31, and kept excavating w/ Lot 36 (353N-548E level 1 0-40cm). In Lot 33, we exposed the corner of ALTA and SUGAR LOVE. We sent some excavators to back fill 471 and 470. In Lot 35, we exposed the continuation of ALTA. I sent those 2 guys to help Nick and Mike on their structure because I only have 2 more square meters to dig. In Lot 36, we exposed the continuation of SNOW BASIN, we kept excavating w/ Lot 38 (354N-548E level 1 0-40cm).

Afternoon:

We kept excavating lots 37 and 38. I kept taking notes on St. 9. In Lot 37, we exposed the corner of SNOW BASIN and ALTA. In Lot 38, we exposed the continuation of SNOW BASIN. We are done digging.

5/11/95

Today, we are going to take pictures of St. 7 and St. 6, and get ready to shoot points w/ the transit, take final notes and do some drawing.

Features Description St. 9

Wall Boulder: This wall is a retaining wall. The wall is made out of tuff stones (big, medium and small ones), there is no real organization to the way the rocks are placed. The stones have flat faces on the outside. A mano also has been used on the construction of this wall. This wall is 5.00m long for its 1st stage and 55cm has been added on the N/W corner at the later stage. The thickness is equal to 65cm, and the height is 74cm at the highest point and 25cm on the lower. ORIENTATION: 70° E of N

Wall INTERLAKEN: This wall is also made of tuff stones, generally big and medium ones. The flat faces are still on the exterior side of the wall. There is only the basal rocks preserved. This wall is 2.40m long, the thickness is 65cm and the height ~~to~~^{is} 20cm. ORIENTATION: 166° E of N.

Wall WALLERTHEIM: This wall is made of tuff stone, generally big and medium. The flat faces are still on the exterior side of the wall. This wall for the most part is really poorly preserved. A metate also has been used in the building of this wall (upper level). This wall is 3.10m long but we also have a few rocks that are on the same alignment as this wall, possibly an older stage. This ~~wall~~ part is 1.10m long (add on west corner). The thickness is 90cm in general and the height is 35cm. ORIENTATION: 70° E of N.

Wall St Louis: This wall is also made of tuff stone, big sized. This wall is pretty messy. Only the basal rocks are preserved. This wall is 1.20^m long. The thickness is 55cm and the height 20cm.

ORIENTATION: 156° E of N.

These four walls form room 3 (dimensions 1.70 x 1m (1.7m²)) half of the room has a paved bench that is 1m wide, the pavement is made of small rocks. There is

Features Description St. 9 (continued)

also a big flat tuff stone in the S/W corner of the ~~was~~ room, on the bench. The bench is named SAN FRANCISCO.

Wall GRINDELWALD: This wall is also made of tuff stone, big and small. This wall is pretty messy (not really well done). Only the basal rocks are preserved except for the interior side that is 47cm high. It is 3.30m long and the thickness is 1.50m. This wall probably has different stages of construction, but they are not visible because of the bad preservation. ORIENTATION: 162° E of N.

Wall LACROSSE: This wall is also made of tuff stone, small rocks ~~are~~ on the inside of the wall and big rocks on the outside. Mostly only basal rocks are preserved. This wall has 2 different stages, the 1st stage that is 4.30 long and 2nd stage that is an addition on the east end and is 1.30m long. General height 24cm and thickness 75cm. ORIENTATION: 70° E of N.

Wall BRUGGES: This wall is also made of tuff stone, really large. Only the basal rocks are preserved. This wall and LA CROSSE have flat rocks that make me think it was probably a paved surface. This wall is 2.70 long, the thickness is 75cm, the height 25cm. ORIENTATION: 70° E of N.

Wall AMSTERDAM: This wall is made of tuff stone, medium size. Only the basal rocks are preserved. This wall is a later addition to the structure, that extends the wall BRUGGES on the west side, 88cm. This wall is 4.20m long, the thickness is 1.00m on the west end (w/ the addition to BRUGGES) and 42cm on the rest. On the east side, there is an addition that is 1.44m long, this addition is really messy. In between, this wall and LA CROSSE, there is a kind of fill composed of small rocks. The height is 21cm. ORIENTATION: 70° E of N.

Wall LEIDEN: This wall is also made of tuff stone. This wall is pretty well preserved. The method of construction is similar to BOLDER, big and small rocks are used. This wall

Features Description St. 9 (continued)

is 1.80m long, the thickness is 52cm and the height is 35cm at the highest point and 30cm at the lowest. ORIENTATION: 164° E of N

Room 1: This room is formed by GRINDELWALD, LACROSSE, BOULDER and LEIDEN. The dimensions are 1.63x 1.27m (an average) (2m²).

Wall DURANGO: This wall is also made of tuff stone. This wall is fairly well preserved for the most part. This wall is also a later addition to the structure, is out of line w/ Interlaken, but still the same orientation. This wall is 3.60m long, the thickness is 60cm and the height 18cm (Only the basal rocks are preserved). ORIENTATION: 160° E of N.

Room 2: This wall is formed by LEIDEN, LA CROSSE, DURANGO and BOULDER. The dimensions are 1.90x 1.72m (3.27m²).

Features Description St. 7

Wall SNOWBIRD: This wall is made of tuff ~~stone~~ stone, medium and small rocks are used. The wall is fairly well preserved. The flat faces are on the exterior side of the wall. This wall is 4.60m long, the thickness is 70cm and the height is 35cm at the ~~the~~ highest point and 14cm at the lowest. ORIENTATION: 126° E of N.

the Wall PURGATORY: This wall is made of tuff stone, medium and small rocks are used. The wall is fairly well preserved. The flat faces are on ~~the exterior side~~ both sides of the wall. The wall is 3.30m long, the thickness is 50cm and the height is 48cm at the highest point and 25cm at the lowest.

ORIENTATION: 126° E of N.

Wall ALTA: Same ~~characteristic~~ material used as SNOWBIRD. The wall is pretty poorly preserved. ~~There are flat faces on~~ The wall is 4.95m long. Thickness 88cm. Height 35cm.

ORIENTATION: 120° E of N.

Wall SNOW BASIN: Same material used as SNOWBIRD. Fairly preserved. 4.60m long, thickness 48cm, height 40cm.

ORIENTATION: 22° E of N.

P95-63-79.

Features Description St.7 (continued)

Wall SUGAR LOVE: Same material used as SNOWBIRD. Pretty poorly preserved, most of the rocks are tilted. 5.00m long, thickness 1.45m, height 50cm. ORIENTATION: 25° E of N.

Room 1: 1.75 x 2.90 m (PURGATORY, ALTA, SNOWBASIN, SUGAR LOVE)

Room 2: 3.05 x 0.75 m (SNOWBIRD, ~~ALTA~~ SNOWBASIN, SUGAR LOVE, PURGATORY).

* PURGATORY: There is probably an older wall underneath this one because there are rocks sticking out of the wall at the base.

175 I St. 7

- Lot 1 → 356N-550E level 1 o → 40cm
- Lot 2 → 355N-550E level 1 o → 40cm
- Lot 3 → 354N-550E level 1 o → ~~40cm~~ 50cm
- Lot 4 → 353N-550E level 1 o → 50cm
- Lot 5 → 350N-550E level 1 o → 40cm
- Lot 6 → 356N-551E level 1 o → 40cm
- Lot 7 → 352N-550E level 1 o → 50cm
- Lot 8 → 355N-551E level 1 o → 40cm
- Lot 9 → 354N-551E level 1 o → 50cm
- Lot 10 → 353N-551E level 1 o → 50cm
- Lot 11 → 356N-552E level 1 o → 40cm
- Lot 12 → 350N-551E level 1 o → 40cm
- Lot 13 → 352N-551E level 1 o → 50cm
- Lot 14 → 355N-552E level 1 o → 40cm
- Lot 15 → 353N-552E level 1 o → 40cm
- Lot 16 → 351N-550E level 1 o → 10cm
- Lot 17 → 351N-551E level 1 o → 10cm
- Lot 18 → 355N-553E level 1 o → 40cm
- Lot 19 → 356N-553E level 1 o → 40cm
- Lot 20 → 354N-552E level 1 o → 40cm
- Lot 21 → 354N-553E level 1 o → 40cm
- Lot 22 → 356N-549E level 1 o → 40cm
- Lot 23 → 353N-549E level 1 o → 50cm
- Lot 24 → 350N-552E level 1 o → 40cm
- Lot 25 → 353N-553E level 1 o → 40cm
- Lot 26 → 352N-552E level 1 o → 40cm
- Lot 27 → 352N-549E level 1 o → 50cm
- Lot 28 → 355N-549E level 1 o → 40cm
- Lot 29 → 352N-553E level 1 o → 40cm
- Lot 30 → 354N-549E level 1 o → 50cm
- Lot 31 → 352N-548E level 1 o → 40cm

Lot 32 → 351N-552E/351N-553E level 1 o → 10cm

Lot 33 → 351N-553E level 2 lo → 40cm

Lot 34 → 355N-548E level 1 o → 40cm

Lot 35 → 351N-549E level 1 o → 40cm

Lot 36 → 353N-548E level 1 o → 40cm

Lot 37 → 351N-548E level 1 o → 40cm

Lot 38 → 354N-548E level 1 o → 40cm

- Lot 1 → 138N-235E level 1 o → 40cm
 Lot 2 → 145N-235E level 1 o → 40cm
 Lot 3 → 450N-650E level 1 o → 40cm
 Lot 4 → ~~449N-650E~~ 457N-650E level 1 o → 40cm
 Lot 5 → 449N-650E level 1 o → 40cm
 Lot 6 → 456N-650E level 1 o → 40cm
 Lot 7 → 451N-650E level 1 o → 40cm
 Lot 8 → 455N-650E level 1 o → 40cm
 Lot 9 → 452N-650E level 1 o → 40cm
 Lot 10 → 454N-650E level 1 o → 40cm
 Lot 11 → 453N-650E level 1 o → 40cm
 Lot 12 → 453N-653E level 1 o → 40cm
 Lot 13 → 453N-647E level 1 o → 40cm
 Lot 14 → 453N-652E level 1 o → 40cm
 Lot 15 → 450N-647E level 1 o → 40cm
 Lot 16 → 449N-648E level 1 o → 40cm
 Lot 17 → 453N-648E level 1 o → 40cm
 Lot 18 → 453N-651E level 1 o → 40cm
 Lot 19 → 451N-647E level 1 o → 40cm
 Lot 20 → 453N-649E level 1 o → 40cm
 Lot 21 → 454N-653E level 1 o → 40cm
 Lot 22 → 450N-648E level 1 o → 40cm
 Lot 23 → 453N-653E level 1 o → 40cm
 Lot 24 → 452N-649E level 1 o → 40cm
 Lot 25 → 449N-649E level 1 o → 40cm
 Lot 26 → 455N-652E level 1 o → 40cm
 Lot 27 → 452N-647E level 1 o → 40cm
 Lot 28 → 454N-652E level 1 o → 40cm
 Lot 29 → 451N-649E level 1 o → 40cm
 Lot 30 → 450N-649E level 1 o → 40cm
 Lot 31 → 454N-651E level 1 o → 40cm
 Lot 32 → 457N-~~649~~₆₅₁E level 1 o → 40cm

Lot 100 → Rock Pile

Lot 33 → 455N-651E level 1 o → 40cm

Lot 34 → 457N-652E level 1 o → 40cm

Lot 35 → 451N-648E level 1 o → 40cm

Lot 36 → 456N-651E level 1 o → 40cm

Lot 37 → 452N-648E level 1 o → 40cm

Lot 38 → 456N-649E level 1 o → 40cm

Lot 39 → 456N-652E level 1 o → 40cm

Lot 40 → 455N-649E level 1 o → 40cm

Lot 41 → 454N-647E level 1 o → 40cm

Lot 42 → 452N-653E level 1 o → 40cm

Lot 43 → 454N-649E level 1 o → 40cm

Lot 44 → 452N-652E level 1 o → 40cm

Lot 45 → 454N-649E/650E level 2 40 → 60cm

Lot 46 → 452N-651E level 1 o → 40cm

Lot 47 → 455N-647E level 1 o → 40cm

Lot 48 → 454N-648E level 1 o → 60cm

Lot 49 → 451N-651E level 1 o → 40cm

Lot 50 → 455N-648E level 1 o → 60cm

Lot 51 → 449N-651E level 1 o → 40cm

Lot 52 → 451N-652E level 1 o → 30cm

Lot 53 → 456N-647E level 1 o → 40cm

Lot 54 → 451N-653E level 1 o → 30cm

Lot 55 → 450N-651E level 1 o → 40cm

Lot 56 → 456N-648E level 1 o → 40cm

Lot 57 → 450N-653E level 1 o → 30cm

Lot 58 → 450N-652E level 1 o → 30cm

Lot 59 → 449N-652E level 1 o → 40cm

Lot 60 → 450N-646E level 1 o → 40cm

Lot 61 → 452N-654E level 1 o → 40cm

Lot 62 → 449N-653E level 1 o → 40cm

Lot 63 → Rom 1: 453N-649E/650E & 452N-649E/650E
level 2 40 → 60cm

175D St. 9

Lot 64 → Room 2: 453N-651E/652E & 452N-651E/
652E level 2 40 → 60 cm

Lot 65 → 451N-646E level 1 0 → 40 cm

Lot 66 → ~~Room 3: 1/2~~ 1/2 Room 3: 453N-652E level 2
40 → 60 cm

Lot 67 → 451N-645E level 1 0 → 40 cm

Lot 68 → Wall Boulder

Lot 69 → Wall Wallertheim