

1996

PVN-056-Turek-Field Notes-1996

Matthew Turek
Kenyon College

Follow this and additional works at: <https://digital.kenyon.edu/honduras>



Part of the Archaeological Anthropology Commons

Recommended Citation

Turek, Matthew, "PVN-056-Turek-Field Notes-1996" (1996). *Four Valleys Archive*. Paper 7610.
<https://digital.kenyon.edu/honduras/7610>

This Field Notes is brought to you for free and open access by the Anthropology at Digital Kenyon: Research, Scholarship, and Creative Exchange. It has been accepted for inclusion in Four Valleys Archive by an authorized administrator of Digital Kenyon: Research, Scholarship, and Creative Exchange. For more information, please contact noltj@kenyon.edu.

Sub-op E Structure 11 Group 144 P96-56-01

1/17/96

Lot 01 meter # 78 0-20 cubs
empty lot

Lot 02 meter # 77 0-20 cubs
1 sherd

Lot 03 meter # 76 0-20 cubs
shell, sherd w/handle, sherds

1/18/96 Lot 04 meter # 78 20-30 cubs
empty lot

Lot 05 meter # 77 20-40 cubs
sherds

Lot 06 meter # 76 20-40 cubs
sherds, shell, groundstone,
~~obsidian~~, pieces of a plaster floor

Lot 07 meter # 75 0-20 cubs
obsidian, sherds, shell, plaster
- being screened ^(1/4") as a test unit (to the
entirety of its depth)

P96-56-02

1/19/96 Lot 08 meter # 75 20-40 cubes
bone, chert, sherds, shell, plaster, obs,
- being screened through $\frac{1}{4}$ " mesh baja

Lot 09 meter # 66 0-20 cubes
sherds, obs., baja.
prismatic obsidian blade frag. showing signs
of use

Lot 10 meter # 66 20-40 cubes
sherds, ~~bone~~, obs.
sherd, white ~~rock~~ ^{trass} stone

Lot 11 meter # 74 0-20 cubes
sherd, white limestone rock

Lot 12 meter # 67 0-20 cubes
sherds, obsidian

Lot 13 meter # 74 20-40 cubes
sherds, shell

Lot 14 meter # 67 20-40 cubes
sherds, obs.

✓

1/22/96

Lot 15 meter # 73

P96-56-03
0-10 cubs
sherd

Lot 16 meter # 72

0-10 cubs
sherd, baya, shell

Lot 17 meter # 71

0-10 cubs
empty lot

Lot 18 meter # 67

screened through $\frac{1}{4}$ " mesh
- possible dump w/ much obsidian
40-60 cubs
baya, sherds, obs,
Chert

Lot 19 meter # 70

0-20 cubs
sherds, obs

Lot ~~20~~ 20 meter # 69

0-10 cubs
empty lot

Lot 21 meter # 68
screened $\frac{1}{4}$ "

0-20 cubs
sherds



P96-56-04

1/22/96 Lot 22 meter # 71

10-20 cubs
empty lot

Lot 23 meter # 58

0-20 cubs
empty lot

Lot 24 meter # 85

0-10 cubs
sherd

Lot 25 meter # 60

0-20 cubs
sherds, kaja

Lot 26 meter # 69

10-20 cubs
sherds

Lot 27 meter # 73

sherd

10-20 cubs
~~empty lot~~

Lot 28 meter # ~~45~~ 45

0-20 cubs
sherds

Lot 29 meter # 33

0-5 cubs
empty lot

Lot 30 meter # 20

0-5 cubs
empty lot

lot 31 meter # 86

✓
P96-56-05
0-20 cmbs
sherds, baja

lot 32 meter # 32

0-20 cmbs
sherds, obs.

lot 33 meter # 99

0-20 cmbs
sherds

lot 34 meter # 78

0-10 cmbs
sherds

lot 35 meter # 19

0-20 cmbs
sherds, baja

lot 36 meter # 78

20-40 cmbs
sherd

lot 37 meter # 59

0-~~10~~⁵ cmbs
sherd, baja

lot 38 meter # 34

0-20 cmbs
sherd

1/23/96

Lot 39 meter #47

P96-50-06
0-20 cmbs
sherd.

Lot 40 meter #97

0-10 cmbs
empty lot

1/24/96

Lot 41 meter # 68
screened $\frac{1}{4}$ "

20-30 cmbs
sherd, obs, chert

Lot 42 meter # 7

0-30 cmbs
sherd, baja

Lot 43 meter # 6

0-20 cmbs
empty lot

Lot 44 meter # 68
screened $\frac{1}{4}$ "

30-40 cmbs
obsidian, sherds

Lot 45 meter 19

10-20 cmbs
sherd, baja

Lot 46 meter ~~68~~ 68
screened $\frac{1}{4}$ "

40-50 CMBS
obs.

Lot 47 - meter 71

10-20 CMBS
two sherds

Lot 48 meter 112

0-20 CMBS
Sherds, obs.

1/24/76

Lot 49 meter # 68
screened $\frac{1}{4}$ "

✓
796-56-07

50-60 cu bs
empty lot

Lot 50 meter # 73

20-30 cu bs
empty lot

Lot 51 meter # 21

0-20 cu bs
sherd: handle

Lot 52 meter # 84

0-20 cu bs
empty lot

Lot 53 meter # 111

0-5 cu bs
sherds, baja(?)

Lot 54 meter # 71

Carbon sample; baja, sherds, obs., shell

20-40 cu bs

Lot 55 meter # 60

20-30 cu bs
empty lot

1/25/96

Lot 56 meter # 110

✓
P96-56-08
0-20 cubs
empty lot

Lot 57 meter # 123

0-20 cubs
sherd, obs

Lot 58 meter # 136

0-20 cubs
sherds, bags

Lot 59 meter # ⁵⁸ ~~110~~ ~~111~~

20-40 cubs
sherds, obs

Lot 60 meter # 33

5-20 cubs
sherds, carbon

Lot 61 meter # 32, 19
cleaning walls

10-20 cubs
sherds, bags

Lot 62 meter # 137

0-20 CMBS
sherd

Lot 63 meter # 45

20-40 CMBS
sherds, bags

Lot 64 meter # 84

20-40 cubs
sherd

1/25/96

Lot 65

meter # 138

✓
P96-56-09

0-20 cmbs
sherds, obs.

Lot 66

meter # 125

0-20 cmbs
sherds, bone

Lot 67

meter # 19

20-40 cmbs
sherds, bone, shell
obs, bone

Lot 68

meter # 32

20-40 cmbs
sherds, shell

1/26/96

Lot 69

meter # 97

20-40 cmbs
sherds

Lot 70

meter # 110

20-40 cmbs
sherds

Lot 71

meter # 124

0-20 cmbs
sherds, obs

Lot 72

meter # 139

0-20 cmbs
sherds, shell, bone, obs.,
carbon

1/26/96

Lot 73

meter # 123

✓
P96-56-10
20-40 cubs
sherds, shell

Lot 74

meter # 146

0-30 cubs
sherds, obs, bays

1/29/96

Lot 75

meter # 127

0-30 cubs
sherds, obs, bays

Lot 76

meter # 126

0-30 cubs
sherds, bays, bone

Lot 77

meter # 125

20-30 cubs
empty lot

Lot 78

meter # 112

20-30 cubs
sherds, shell

Lot 79

meter # 99

20-30 cubs
empty lot

1/30/96

Lot 80

meter # 6

20-40 cubs
sherds, shell, obs

Lot 81

meter # 7

30-40 cubs
sherds, shell, obs

1/30/96

P96-56-11

Lot 82 meter # 87 0-40 cubs
east $\frac{1}{2}$ screened $\frac{1}{4}$ " sherds, obs

2/1/96

Lot 83 meter # 5 all of ²⁹⁹ 112, E $\frac{1}{2}$ of 113
SE $\frac{1}{4}$ of 100 20-40 cubs

5-10 lbs of shell, obs, sherds, baja
carbon, bivalve shell

Shell midden - photo taken
dirt screened through $\frac{1}{4}$ " screen

2/2/96

Lot 84 meter # 21 20-40 cubs
sherds, shell, baja

Lot 85 meter # 86 (~~cleaning b/w~~) 10-30 cubs
cleaning b/w rocks sherds, obs

Lot 86 meters # 125, 126 30-40 cubs
bone, baja, sherds, shell, obs

2/5/96

Lot 87 meter # 19 10-40 cubs
cleaning wall ~~carbon~~, obs, bone, sherds, shell

Lot 88 meter # 19 40-60 cubs

carbon, sherds, shell, obs, bone

2/6/95

Lot 89 meter 113 & 114 E $\frac{1}{2}$ W $\frac{1}{2}$ 0-40 cubs
sherds, carbon, obs, shell, baja

Lot 90 meter 100 & 101 S $\frac{1}{4}$ 0-40 cubs

2/5/96

Structure 11 Sub-op E P96-56-12
datum is set at the southeast corner of meter # 71
(meter 0 on the profile) at 22 cm above ground
surface (again - same distance above ground
surface as on profile at meter 8).

- orientation of ~~axial~~ trench: 95° E of N
1 x 13 m ; Sterile ^{ground} was located 105 cm bel
on the east side of the structure
- the structure is a long, thin rectangular
stone platform orientated 356° E of N
- the eastern wall measures 8.6 m in length
to the end of the wall, but ~~the~~ the total extent of
the structure (with entry feature) is 9.7 m ^{on} the
eastern side
- the western wall measures 8.65 m in length
to the end of the wall, but the total extent of the
structure (with the entry feature included) is 9.55 m
on the western side
- the northern edge of the platform measures
1.7 m in width
- the middle of the structure measures 2 m
(with evidence of some slumping of the walls)
and 2.35 m when the plaster floor on the
west side is included (meter # 73 on grid map)
- the southern end measures 1.8 m to the edge of
the platform and 4.25 to the end of the double
wall running to the west of the platform

Structure II
 Sup op E
 Plan point map
 P96-56-13

2/5/96

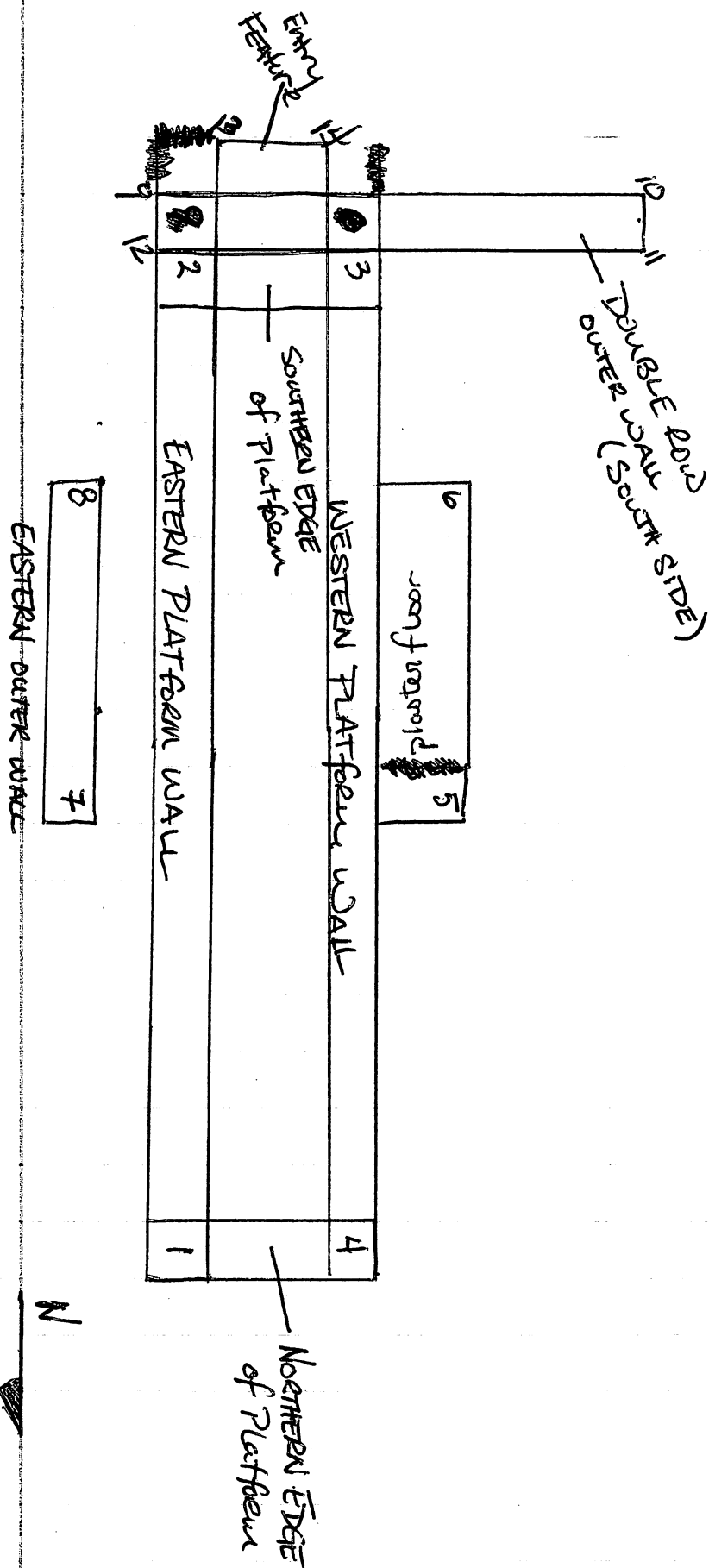

2/5/96

P96-56-14

EASTERN Outer Wall — one course wide, one course deep; runs parallel to the eastern wall of the platform; composed of medium sized (10x15 cm average) river cobbles; angular rocks; app. 2.8m in length northern end is 3.7 m from the northern end of the platform and is 0.20m east of the eastern wall of the platform; orientation: 358° E of N
North end: Top 41 cubd Bottom 58 cubd
South end: Top 44 cubd Bottom 58 cubd

EASTERN Platform Wall — The platform has presented some interesting questions concerning its construction — the southern $\frac{1}{3}$ consists of only one course deep wall and its eastern edge is not defined by any particular linear stone construction — in the first 2.5m there is a very shaky; widely separated double course wide construction (maybe); from m. 2.5 to m. 6 there is not only a 2 course wide linear construction along the eastern edge of the platform but ^{it is also} 2 to 4 courses deep as well. From m. 6 to m. 7.2 the upper courses of stone disappear and were replaced with dirt (fill) and from m. 7.2 to 8.6 only one upper course remains; whether there are one or three separate platforms later joined together is still unknown

EASTERN PLATFORM WALL (CONT.)

P96-86-15

edge of wall varies between 0 and 2 courses wide and 1 and 4 courses deep. Length of wall is 8.6 m; type of stone used in construction varies between small and medium sized river cobbles and angular stones; orientation = 350° E of N

- it appears to have been built on an earthen mound ~~of~~ with some degree of fill (obs, sherds, shell, bone) and possibly in the northern end over an earlier structure.

CASE of
stone

— SOUTH END	Top	28	cubd	Bottom	54	cubd
	Middle	10	cubd		52	cubd
	NORTH END	6	cubd		19	cubd

* — more shell found in the southwest midden
47 cubd ~~(2)~~

General notes: Under the northern corner of the platform lies a two course wide linear alignment of stone at a 30° - 45° angle of the overlying structure - it is only one ~~course~~ course tall where it exits the ~~the~~ platform in the north, but two, possibly three courses deep where it seems to reappear as part of the platform in the eastern foundation/retaining wall. (1-2 m from the northern end of the structure. At that point it looks like it may corner - heading off at a south-westerly angle.

2/7/96

Lot 91 meter # 100 : 101

P96-56-16

0-30 cubs

sherd, shell

Lot 92 meter # 87 : 88

0-30 cubs

sherd, obs

Lot 93 meter # 99

30 cubs

45 cubs bag # 1	sherd	- under 1 st plaster layer
44.5 cubs bag # 2	obs	- on 1 st plaster layer
43 cubs bag # 3	sherd	- between layer 1 : 2
42 cubs bag # 4	obs	- above layer 2

2/12/96

Lot 94 meter # 72

10-40 cubs

fill - cleaning for a wall

sherd, bone, shell

Lot 95 meter # 59

10-40 cubs

empty lot

FINAL NOTES

Str. 11 144 E

P96-56-17

2/7/96

NAME

(DEEP)
of COURSES

(wide)
of COURSES

A=ANGULAR
CB=Cut Block
RC=River Cobbles
CH=CHUNKING
Type of Stone

S
M
L
XL
Size of Stone

Length

Width

E of N
Orient.

Old Structure	1-3	1-2	RC, A	XL, L, M	2.9m - 3.8m (?)	0.5m	348°
N. Edge of P.	1	1-2	RC, A	S, M	1.65m	0.45m	272°
E.P. Wall	1-4	1-2	RC, A, CH	M-L; XL, S	8.65m	0.45m	358°
E. Outer Wall	1	1	RC, A	M L(1)	2.85m	0.17m	257°
S. Edge of P.	2	1-2	RC, A	S, M, L, XL	1.70m 2.65m (?)	0.5m	270°
Entry Feature	1-2	2	A, RC	L, XL	1.85m	0.80m	270°
Double Row (S.)	1	2	RC, A	M, L; XL	4.2m	0.45m	270°
Circular	1	1	RC, A	S; M, L	1.8m in diameter		N.A.
W.P. Wall	1-3	1-2	RC, A, CH	M, S	2.7m	0.40m	257°
Plaster Floor	N.A.	N.A.	N.A.	N.A.	N/S 2.5m	E/W 1.5m	N.A.
Corner of Southern Platform Wall	3	1-2	RC, A	M, S	1.5m	0.35m	272°

T = TOP B = Bottom N = North S = South E = East W = West
M = middle

Old STR.	T, N 38 cubs	B, N 48 cubs	T, S 13 cubs	B, S 47 cubs
N. Edge of P.	T, N 4 cubs	B, N 14 cubs	T, S 27 cubs	B, S 62 cubs
E.P. Wall	T, E 4 cubs	B, E 14 cubs	T, M 22 cubs	B, M 64 cubs
E. Outer Wall	T, N 43 cubs	B, N 53 cubs	T, S 43 cubs	B, S 56 cubs
S. Edge of P.	T, E 27 cubs	B, E 62 cubs	T, M 23 cubs	B, M 62 cubs (base of excavation)
Entry Feature	T, E 49 cubs	B, E 58 cubs	T, M 46 cubs	B, M 62 cubs
Double Row (S.)	T, E 38 cubs	B, E 82 cubs	T, M 30 cubs	B, M 55 cubs
Circular	T, S 45 cubs	B, S 57 cubs	T, E 45 cubs	B, E 54 cubs
W.P. Wall	T, N 6 cubs	B, N 15 cubs	T, M 7 cubs	B, M 20 cubs
Plaster Floor	Top of 1st layer (south end)	46 cubs	1st " North end	42 cubs
Corner of S.P. Wall	T, E 18 cubs	B, E 55 cubs	T, W 14 cubs	B, W 50 cubs
Plaster Floor - north end - tip	Top 41 cubs	Bottom 43 cubs	Length 12m	

2/9/96

P96-56-18

The circular feature, which lies off the south western corner of the structure consists mainly of shell (snail) along with some pottery fragments. This midden lies inside of a fairly circular-although not continuous, line of small stone concentrations and medium size stone concentrations. The feature is boxed in by the edge of the platform to the east, the double row of stone to the south, and the edge of the plaster floor to the north; open space to the west. The shell was tightly packed into a (roughly) one meter square area as deep as fifteen cm. in some areas.

Midden or storage? Solely a food source or possibly an additive ingredient used in the plaster floors? The fact that the clustering of shells was inside the perimeter of the structure and that many of the shells remained unbroken points away from it being a midden.

The plaster floors seem to occupy a 1.5×2.5 m area and coincide with the construction of the stone platform atop the ~~the~~ earthen mound. Evidence for that consists of a plaster lip 10 cm long and 2 cm tall roughly in line with the western edge of the platform. While bits of plaster were

2/9/96

P96-B0-19

found as far as 3-3.5 m off structure - there is no clear evidence of the floor extending beyond 1.5 m off structure. There appears to be at least two surfaces represented - the first one has a fine, red finish, the second (upper/latter) layer is very corroded leaving only the rough white paste that was later smoothed over and painted. Artifacts recovered in context with these layers include a sherd from below the first layer, a piece of obsidian which was resting on the first layer, a sherd which was pushing up and into the second layer, and an obsidian blade which was rest on a (one) cm. of dirt above the second layer. In some areas the second layer of plaster rests on a thin (1 cm or less) layer of dirt, in other areas, however, the smooth, red surface of the first layer can be exposed simply by popping off a piece of the corroded second layer.

The double row of stone running perpendicular to the south end of the platform (between the platform and the entry feature) provides yet another mystery. The northernmost row incorporates the platform into its linear alignment and is separated by its southern partner by a gap of approximately 20 cm. (twenty cm. is the same distance that the eastern outer wall is separated from the edge of the eastern platform wall.) In the cases of both walls - the rows consist of only one course (wide, deep) and the stones are set on end - forming a taller, but more narrow wall. It is possible that these rows were guides/channels for brazier-like walls to slip/fit between providing shade from the sun or to act as a screen from the wind.

1/29/96

Sub-op J structure ^{19 (2/26/03)} ~~17~~

²⁰
P96-56-01

Lot 01	meter # 190	0-20 cubs sherds
Lot 02	meter # 190	20-40 cubs sherds
Lot 03	meter # 176	0-20 cubs sherds, baja
Lot 04	meter # 176	20-40 cubs sherds, obs.
Lot 05	meter # 190	40-50 cubs empty lot
Lot 06	meter # 22	0-20 cubs sherds, obs
Lot 07	meter # 78 (obs. ppt.)	0-20 cubs sherds, obs
Lot 08	meter # 61	0-20 cubs sherds, obs, baja
Lot 09	meter # 162	0-20 cubs sherds, baja, chert, obs.
Lot 10	meter # 22	20-40 cubs sherds, chert

1/30/96

144 J

P96-30-22²¹

- | | | |
|--------|---|---|
| Lot 11 | meter # 8
screened through $\frac{1}{4}$ " mesh | 0-20 cubs
sherds, obs |
| Lot 12 | meter # 22 | 40-50 cubs
sherds, chert |
| Lot 13 | meter # 36
screened through $\frac{1}{4}$ " mesh | 0-20 cubs
sherds, baja, obs, antler, chert |
| Lot 14 | meter # 36
screened through $\frac{1}{4}$ " mesh | 20-40 cubs
sherds, baja, obs. |
| Lot 15 | meter # 36
screened $\frac{1}{4}$ " | 40-50 cubs
sherds |
| Lot 16 | meter # 64 | 20-40 cubs
sherds |
| Lot 17 | meter # 106 | 0-20 cubs
sherds, obs |
| Lot 18 | meter # 162 | 20-50 cubs
sherds |
| Lot 19 | meter # 92
baja, | 0-20 cubs
sherds, obs, chert, bone |
| Lot 20 | meter # 50 | 0-20 cubs
sherds, obs, baja |

1/31/96	Sub-op J Lot 21	meter # 50	P96-56- ²² 03 20-40 cubs sheeds, obs
	Lot 22	meter # 148	0-20 cubs sheeds, obs
	Lot 23	meter # 148	20-40 cubs sheeds
	Lot 24	meter # 134	0-20 cubs sheeds, obs, baja
	Lot 25	meter # 50	40-50 cubs sheed
	Lot 26	meter # 148 134	20-40 cubs sheeds, baja, obs
	Lot 27	meter # 64	40-50 cubs empty lot
	Lot 28	meter # 170	40-50 cubs obs
	Lot 29	meter # 78	20-40 cubs sheeds, shell
	Lot 30	meter # 120	0-20 cubs sheeds, baja, obs
	Lot 31	meter # 120	20-40 cubs sheeds

2/1/96 Subop J
Lot 32

meter # 148

1996-56-²³~~24~~
40-50 cubs
sherd

Lot 33

meter # 134

40-50 cubs
sherds, obs

Lot 34

meter # 120

40-50 cubs
sherds, obs

Lot 35

meter # 106

20-40 cubs
baja, sherds, bone, obs

Lot 36

meter # 106

40-50 cubs
empty lot

Lot 37

meter # 78

40-50 cubs
sherd

Lot 38

meter # 92

20-50 cubs
sherds, baja

796-56-25

2-16-96 HI 1.570

Shot #	Middle	Top	Bottom	Distance	\angle	Elevation	Comments:
1	2.573		2.115	91.6m	3/11/96 71°00'		S.W. Corner 5 of Test Pits #16
2	2.575	3.615	1.957	165.8	103.6m 72°11/05'		#17
3	1.791	2.859	1.281	102m?	3/11/96 78°17°30'		#18
4	2.510	3.105	1.910		21°20'		#19
5							#20
6	4.172	5.041	3.131	173.8m	3/11/96 49°45'		#21
7							#22
8	3.961	4.520	3.415	109.2m?	3/11/96 96°30'		#23
9	2.585	3.305	1.861	172.4m	3/11/96 179°10'		#27

HI = 1.573 2/19/96

Shot #	MID	TOP	Bottom	Distance	\angle	Elevation	Comments
1	2.875	3.285	2.460	82.5m	31°0'		#16

HI = 1.595

2/19/96

SET UP
SW CORNER #16

Shot #	MID	TOP	Bottom	Distance	\angle	Elevation	Comments
1	1.610	1.706	1.512	80.6m	342°30'		B.S. #17
2	2.991	3.640	2.345	127.5	42°40'		#20
3	3.172	4.161	2.610	155.1	76°30'		#22

SHOT#

HI =

1.640

Setup SW CORNER #

Shot #	MID	TOP	Bottom	Distance	\angle	Elevation	Comments
5891	5.891	6.192	5.252	94m	75°		
	1.500	2.565	1.040	152.5m	28°45'		
		704'		(3/11/96)			
		525					

2/13/96

P96-56-26

1x1 m test units; all units are screened through 1/4" mesh except for the soil samples.

Former Lot # under test pits (No super at the time)

(#1)	144 U	22	Lot 1	1x1 m N/S	0-20 cuabs sherds, obsidian, shell, bone
(#2)	144 U	22	Lot 2	1x1 m N/S	20-40 cuabs sherds, shell; 2 bags of soil samples
(#3)	144 U	22	Lot 3	1x1 m N/S	40-50 cuabs shell, obsidian
(#7)	144 U	22	Lot 4	1x1 m N/S	50-60 cuabs obsidian (one small piece - level is sterile)
(#4)	144 V	20	Lot 1	1x1 m N/S	0-20 cuabs *ache: clay "marble" sherds, shell, obsidian, bone
(#5)	144 V	20	Lot 2	1x1 m N/S	20-40 cuabs sherds, shell, obsidian, bone
2/14/96	144 V	20	Lot 3	1x1 m N/S	40-60 cuabs sherds, shell
	144 V	20	Lot 4	1x1 m N/S	60-70 cuabs empty lot

2/14/96

P96-86-27

(#6) 2/14/96 144 W 18 Lot 1 1x1m N/S 0-20 cubs
sherds, shell, baja, bone, obsidian

144 W 18 Lot 2 1x1m N/S 20-40 cubs
sherds, shell, bone, obsidian

144 W 18 Lot 3 1x1m N/S 40-60 cubs
sherds, shell

144 W 18 Lot 4 1x1m N/S 60-70 cubs
empty lot

144 X 21 Lot 1 1x1m N/S 0-20 cubs
sherds, shell, baja, bone

144 X 21 Lot 2 1x1m N/S 20-40 cubs
sherds, shell, baja, bone

2/15/96 144 X 21 Lot 3 1x1m N/S 40-60 cubs
empty lot

P96-56-28

2/14/96

144 y 16

Lot 1

1x1m N/S

0-20 cuabs

sherds, shell, bone, obsidian

144 y 16

Lot 2

1x1m N/S

20-40 cuabs

sherds, bone, obsidian

2/15/96

144 y 16

Lot 3

1x1m N/S

40-60 cuabs

sherds, obsidian

2/15/96

144 y 16

Lot 4

1x1m N/S

60-70 cuabs

empty Lot

144 z 17

Lot 1

1x1m N/S

0-20 cuabs

sherds, shell, bone, obsidian

2/15/96

144 z 17

Lot 2

1x1m N/S

0-20 cuabs

continued from 2/14/96

sherds, shell, bone, obsidian, ground stone

144 z 17

Lot 3

1x1m N/S

20-40 cuabs

sherds

144 z 17

Lot 4

1x1m N/S

40-50 cuabs

empty Lot

2/15/96

P96-B6-29

144 AA 19

Lot 1

1x1m N/S

0-20 cubs

sherds, bajareque

2/16/96

144 AA 19

Lot 2

1x1m N/S

20-40 cubs

sherds, shell, obs., bone, bajareque

144 AA 19

Lot 3

1x1m N/S

40-60 cubs

sherds, shell, obsidian

144 BB 27

Lot 1

1x1m N/S

0-20 cubs

sherds, shell, obsidian, bone, chert

144 BB 27

Lot 2

1x1m N/S

20-40 cubs

sherds, shell, obsidian, bone

144 BB 27

Lot 3

1x1m N/S

40-60 cubs

sherds, obsidian

144 BB 27

Lot 4

1x1m N/S

60-70 cubs

empty lot

2/16/96

P96-56-30

144 CC 23 Lot 1 1x1 m N/S 0-20 cuabs
Sherds, obsidian

144 CC 23 Lot 2 1x1 m N/S 20-40 cuabs
sherds

144 CC 23 Lot 3 1x1 m N/S 40-60 cuabs
empty lot

not 144

484 144 DD 1 (midden) Lot 1 1x1 m N/S 0-20 cuabs
Sherds, shell, bone, obsidian, chert

144 DD 1 Lot 2 1x1 m N/S 20-40 cuabs
sherds, shell, bone, obsidian

144 DD 1 Lot 3 1x1 m N/S 40-60 cuabs
empty lot

144 EE 2 (midden) Lot 1 1x1 m N/S 0-20 cuabs
sherds, shell, obs, bone

144 EE 2 Lot 2 1x1 m N/S 20-30 cuabs
sherds

144 EE 2 Lot 3 1x1 m N/S 30-50 cuabs
sherds, shell, obs

144 EE 2 Lot 4 1x1 m N/S 50-60 cuabs
empty lot

2/26/96

P96-56-31

144 test pits : 0.5 x 0.5 m units 50 m apart on a N/S : E/W grid; SW corner shot in with transit; all levels screened through 1/4" mesh.

144 AE 950 N ~~850~~ E Lot 1 0-20 cubs sherds

144 AE 950 N 850 E Lot 2 20-30 cubs ^{obsidian} sherds

144 AE 950 N 850 E Lot 3 30-40 cubs ^{bone} sherds, shell

144 AE 950 N 850 E Lot 4 40-50 cubs sherds, shell, ^{obs.} bone

144 AE 950 N 850 E Lot 5 50-60 cubs sherds, shell, ^{obs} bone

+ 144 AF 950 N 900 E Lot 1 0-10 cubs empty lot

144 AF 950 N 900 E Lot 2 10-20 cubs sherds

144 AF 950 N 900 E Lot 3 20-30 cubs obsidian

144 AF 950 N 900 E Lot 4 30-40 cubs sherds

144 AF 950 N 900 E Lot 5 40-50 cubs empty lot

+ 144 AE 950 N 850 E Lot 6 60-70 cubs sherds, shell, bone

144 AE 950 N 850 E Lot 7 70-80 cubs sherds, shell

144 AE 950 N 850 E Lot 8 80-90 cubs empty lot

2/27/96

PG6-56-32

144 AM 1000N 850E Lot 1 0-10 cubs empty lot

144 AM 1000N 850E Lot 2 10-20 cubs sherds

144 AM 1000N 850E Lot 3 20-30 cubs sherds, shell

144 AM 1000N 850E Lot 4 30-40 cubs sherds

144 AM 1000N 850E Lot 5 40-50 cubs empty lot

144 AM 1000N 900E Lot 1 0-30 cubs sherds

144 AM 1000N 900E Lot 2 30-40 cubs sherds

144 AM 1000N 900E Lot 3 40-50 cubs empty lot

2/27/96

P96-56-33

144AO 1050N 900E Lot 1 0-10 cubs empty lot

144AO 1050N 900E Lot 2 10-20 cubs empty lot

144AO 1050N 900E Lot 3 20-30 cubs shreds

144AO 1050N 900E Lot 4 30-40 cubs empty lot

144AU 950N 950E Lot 1 0-10 cubs baja, chest

2/28/96 144AU 950N 950E Lot 2 10-20 cubs empty lot

144AU 950N 950E Lot 3 20-30 cubs empty lot

144AP 1000N 950E Lot 1 0-10 cubs shreds

144AP 1000N 950E Lot 2 10-20 cubs shreds

144AP 1000N 950E Lot 3 20-30 cubs shreds, obsidian

144AP 1000N 950E Lot 4 30-40 cubs shreds

144AP 1000N 950E Lot 5 40-50 cubs obsidian

144AP 1000N 950E Lot 6 50-60 cubs empty lot

2/28/96 144Am 800N 950E Lot 1 0-10 cubs sherd

144Am 800N 950E Lot 2 10-20 cubs shreds

144Am 800N 950E Lot 3 20-30 cubs empty lot

2/28/96

P96-56-34

144 BF 800N 1000E Lot 1 0-10 cubs sherds

144 BF 800N 1000E Lot 2 10-20 ~~cm~~ cubs sherds

144 BF 800N 1000E Lot 3 20-30 cubs empty lot

Soils:

144 BF 800N 1000E 0-30 cubs
very few roots (only in the top 5 cm)
compacted but very fine clay soil - breaks into
moderate peds, very few stones
10YR 4/4 - dark yellowish brown

144 AM 800N 950E 0-30 cubs
no roots or stones/pebbles; highly compacted soil
very fine but with moderate peds clay soil
10YR 4/4 - dark yellowish brown

144 AU 950N 950E 0-30 cubs / clay soil
no roots or stones, highly compacted, very fine soil
with moderate peds; 10YR 4/4 - dark yellowish brown

144 AP 1000N 950E 0-60 cubs
I - 0-50 cubs few roots (0-40 cubs) very
tightly compacted fine soil; no stones 10YR 3/2 -
very dark grayish brown - silty
II - 50-60 cubs more clay than silt, no roots or
rocks, ~~highly~~ loosely compacted 10YR 4/4 - dark yellowish
brown

2/28/76

Soils

P96-56-35

144AN 1000N 900E 0-50 cmbs

I - 0-45 cmbs few roots - most in the top 10 cmbs
no stone, very highly compacted, silty soil

10 YR 3/3 - ~~very~~ dark brown

II - 45 cmbs - 50 cmbs 10 YR 4/6 - dark yellowish brown
loosely compacted, no roots or rocks

144AO 1050N 900E 0-40 cmbs

very fine soil, ver few roots, no ~~no~~ rocks

very tightly compacted very fine silty soil

10 YR 3/2 very dark grayish brown

144AM 1000N 850E 0-50 cmbs

I - 0-40 cmbs few to no roots, no stone; highly
compacted silty soil, very fine 10 YR 4/3 brown/dark

II - 40-50 cmbs no roots or rocks compacted brown
soil 10 YR 4/6 dark yellowish brown

144AE 950N 850E 0-90 cmbs

very few roots, no rocks, tightly compacted in
the first 40 cmbs and becomes less so by
90 cmbs 10 YR 4/6 dark yellowish brown

144AF 950N 900E 0-50 cmbs

I - 0-10 very ~~hard~~ hard packed silty soil with
very few roots; no rocks; 10 YR 4/4 dark yellowish brown

II - 10-40 cmbs clay soil - very compact with
few roots; no rocks; 10 YR 2/2 very dark brown

III - 40-50 cmbs clay soil - compact with few roots
and some misc. rocks; ~~5 YR~~ 5 YR 3/3 dark reddish ~~brown~~
brown

2/29/96

P96-30-36

144 BU 1050N 950E Lot 1 0-10 cmbs sherd
 144 BU 1050N 950E Lot 2 10-20 cmbs sherds
 144 BU 1050N 950E Lot 3 20-30 cmbs sherds, obs, chert
 144 BU 1050N 950E Lot 4 30-40 cmbs sherds, obs.
 144 BU 1050N 950E Lot 5 40-50 cmbs empty Lot
 I - (0-40 cmbs) loosely consolidated in the first 25 cmbs becoming more tightly compacted by 40 cmbs; few roots; no rocks, silty; 10YR 5/4 yellowish brown
 II - (40-50 cmbs) more tightly compacted, no roots or rocks, less silty 10YR 3/4 dark yellowish brown

144 BV 1100N 950E Lot 1 0-10 cmbs empty Lot
 144 BV 1100N 950E Lot 2 10-20 cmbs empty Lot
 144 BV 1100N 950E Lot 3 20-30 cmbs empty Lot
 I - loosely compacted silty soil with many roots and rocks (0-10 cmbs) very fine w/ small peds 10YR 4/3 - brown/dark brown
 II - (10-30 cmbs) more tightly compacted, less silty, fewer roots, no rocks, fine w/ moderate peds 10YR 3/4 - dark yellowish brown

144 BW 1100N 1000E Lot 1 0-10 cmbs empty Lot
 144 BW 1100N 1000E Lot 2 10-20 cmbs empty Lot
 144 BW 1100N 1000E Lot 3 20-30 cmbs sherds
 144 BW 1100N 1000E Lot 4 30-40 cmbs sherds
 144 BW 1100N 1000E Lot 5 40-50 cmbs empty Lot
 I - (0-20 cmbs) 10YR 5/3 brown, loosely compacted soil with roots but no rocks
 II - (20-50 cmbs) 10YR 4/4 dark yellowish brown; more tightly compacted in the 20-40 cmbs and very compacted in the last 10 cm (40-50 cmbs) no roots or rocks

3/1/96

P96-56-37

144 BX 1050N 1000E Lot 1 0-10 cmbs empty lot
 144 BX 1050N 1000E Lot 2 10-20 cmbs sherds
 144 BX 1050N 1000E Lot 3 20-30 cmbs sherd
 144 BX 1050N 1000E Lot 4 30-40 cmbs empty lot

I - (0-40 cmbs) very compacted soil, some large tree roots, no rocks (roots limited to the 0-25 cmbs); 10 yr $4\frac{1}{3}$ brown/dark brown

144 BY 1150N 1000E Lot 1 0-10 cmbs empty lot
 144 BY 1150N 1000E Lot 2 10-20 cmbs empty lot
 144 BY 1150N 1000E Lot 3 20-30 cmbs sherds
 144 BY 1150N 1000E Lot 4 30-40 cmbs sherds
 144 BY 1150N 1000E Lot 5 40-50 cmbs sherds
~~144 BY 1150N 1000E Lot 6 50-60 cmbs~~
 144 BY 1150N 100E LOT 6 50-60 No aparecen artefactos

144 BZ 1200N 1000E Lot 1 0-10 cmbs empty lot
 144 BZ 1200N 1000E Lot 2 10-20 cmbs sherds
 144 BZ 1200N 1000E Lot 3 20-30 cmbs sherds
 144 BZ 1200N 1000E Lot 4 30-40 cmbs sherds
 144 BZ 1200N 1000E Lot 5 40-50 cmbs sherds
 I (de 0-25 cts) Tierra café claro arenosa compactada ^{sin}
 riestas de (25-50 cts) Tierra café rojiza con piedras
 y riestas ^{poco compactado} de (50-60) No aparecen artefactos y la Tierra
 de de café rojiza. con piedras pequeños y arena. No compactado

3/4/96

410B Structure I

P96-36-38

Lot 01 93N 100E 0-20 cmbs sherds, obs., baja.

Lot 02 105N 100E 0-20 cmbs sherds

3/5/96

Lot 03 93N 100E 20-40 cmbs sherds, baja.

Lot 04 105N 100E 20-40 cmbs sherds

Lot 05 94N 100E 0-20 cmbs empty Lot
screened 1/4"

Lot 06 104N 100E 0-20 cmbs empty Lot

Lot 07 94N 100E 20-40 cmbs sherds
screened 1/4"

Lot 08 95N 100E 0-20 cmbs sherds

Lot 09 95N 100E 20-40 cmbs sherds

Lot 10 104N 100E 20-40 cmbs sherds

Lot 11 103N 100E 0-20 cmbs sherds

3/6/96

Lot 12 96N 100E 0-20 cmbs sherds, baja
~~empty Lot~~

Lot 13 102N 100E 0-10 cmbs empty Lot

Lot 14 103N 100E 20-40 cmbs sherds, baja

Lot 15 96N 100E 20-40 cmbs sherds

Lot 16 102N 100E 10-40 cmbs sherds

3/6/96

410 B Structure 1

P96-50-39

Lot 17

97 N 100 E

0-10 cmbs

sherds

Lot 18

101 N 100 E

0-10 cmbs

empty Lot

Lot 19

96 N 100 E

40-50 cmbs

sherds

Lot 20

98 N 100 E

0-10 cmbs

sherds

3/7/96

Lot 21

100 N 100 E

0-10 cmbs

sherd

Lot 22

101 N 100 E

10-20 cmbs

sherds

Lot 23

98 N 100 E

10-40 cmbs

sherds, baja., chert

Lot 24

97 N 100 E

10-30 cmbs

sherds, baja.

Lot 25

99 N 100 E

0-40 cmbs

sherds, baja., chert

Lot 26

101 N 100 E

20-60 cmbs

sherds, baja.

3/8/96

Lot 27

101 N 100 E

60-70 cmbs

sherds, baja.

Lot 28

101 N 100 E

70-80 cmbs

sherds, obs.

Lot 29

101 N 100 E

80-90 cmbs

empty Lot

Lot 30

94 N 100 E

40-60 cmbs

sherds

Screened 1/4"

Lot 31

94 N 100 E

60-70 cmbs

empty Lot

Screened 1/4"

3/8/96 410 C Structure 2 P96-56-40

Lot 01 91N 95E 0-20 cmbs sherds, obs.

Lot 02 95N 92E 0-20 cmbs sherds, bone, obs.,
chert

Lot 03 91N 95E 20-40 cmbs sherds

Lot 04 95N 92E 20-40 cmbs sherds

Lot 05 91N 95E 40-50 cmbs sherds, obs.

3/11/96

Lot 06 92N 95E 0-20 cmbs sherds

Lot 07 95N 92E 40-50 cmbs sherd

Lot 08 92N 95E 20-40 cmbs sherds

Lot 09 95N 93E 0-20 cmbs sherds, baja.

Screened 1/4"

Lot 10 95N 93E 20-40 cmbs sherds, obs.

Screened 1/4"

Lot 11 92N 95E 40-60 cmbs empty Lot

Lot 12 93N 95E 0-20 cmbs sherds

Lot 13 93N 95E 20-40 cmbs sherds, ground stone

Lot 14 95N 93E 40-60 cmbs sherds

Screened 1/4"

3/12/96

Lot 15 93N 95E 40-50 cmbs sherds

Carbon - NEC @ 45 cmbs

Lot 16 95N 94E 0-30 cmbs sherds

3/12/96 410C structure 2 P96-56-41
Lot 17 94N 93E 0-30 cmbs sherds, chert

Lot 18 96N 93E 0-30 cmbs sherds

Lot 19 94N 95E 0-30 cmbs sherds

Lot 20 93N 93E 0-30 cmbs sherds, obs.

Carbon - SEC @ 20 cmbs
Lot 21 96N 94E 0-30 cmbs sherds, groundstone

Lot 22 94N 94E 0-30 cmbs sherds, obs.

Lot 23 ~~97N~~ 97N 94E 0-10 cmbs sherds, ~~obs.~~

Lot 24 93N 94E 0-20 cmbs sherds, obs.

3/13/96

Lot 25 95N 95E 0-30 cmbs sherds

Lot 26 97N 94E 10-30 cmbs sherds

Lot 27 94-95N 94E 20-30 cmbs sherds, obs, baja
Cleaning West Wall

Lot 28 95N 95E 0-30 cmbs empty Lot

Lot 29 97N 95E 0-30 cmbs baja, sherds, groundstone

Lot 30 96N 93-95E 30-35 cmbs sherds

Cleaning walls

Lot 31 97N 96E 0-30 cmbs sherds

410D Lateral Clearing Str. 1				P96-56-42
3/13/96 Lot 01	96 N 101 E	0-40 cubs		sherds
Lot 02	97 N 101 E	0-30 cubs		sherds
Lot 03	101 N 101 E	0-60 cubs		sherds, baja
3/14/96 Lot 04	98 N 101 E	0-10 cubs		sherds
Lot 05	101 N 102 E	0-60 cubs		baja sherds, obs.
3/15/96 Lot 06	100 N 102 E	0-60 cubs		sherds, baja
	EAST HALF			
Lot 07	96 N 98 E	0-10 cubs		empty Lot
Lot 08	97 N 101 ¹⁰² E	0-10 cubs		empty Lot
Lot 09	98 N 102 E	0-30 cubs		sherds, obs.
Lot 10	101 N 98 E	0-80 cubs		sherds, baja
	NORTH WALL			
Lot 11	97 N 102 E	10-20 cubs		sherds, obs.
Lot 12	98 N 102 E	0-5 cubs		empty Lot
Lot 13	99 N 102 E	0-50 cubs		sherds, baja.
Lot 14	99 N 101 E	0-40 cubs		sherds, obs.
Lot 15	101 N 97 E	0-30 cubs		sherds
Lot 16	98 N 102 E	5-40 cubs		sherds

3/14/96	410C Structure 2	P96-56-43
Lot 32	96N 96E 0-30 cmbs	sherds, baja.
Lot 33	97N 97E 0-30 cmbs	sherds, baja.
Lot 34	96N 97E 0-30 cmbs	sherds
3/15/96		
Lot 35	98N 98E 0-40 cmbs	sherds
Lot 36	95N 97E 0-30 cmbs	sherds
3/18/96		
Lot 37	94N 97E 0-30 cmbs	sherds, baja, obs.
Lot 38	93N 96E 0-50 cmbs	sherds, obs.
Lot 39	94N 96E 0-10 cmbs	sherds
Lot 40	95N 96E 0-10 cmbs	sherds
Lot 41	93N 97E 40-50 cmbs	sherds, chert
3/20/96		
Lot 42	92N 94E 0-20 cmbs	sherds
Lot 43	92N 94E 20-40 cmbs	empty lot
Lot 44	93N 94E 5-15 cmbs	mano: metate frag.
cleaning wall		
Lot 45	94-96N 96-97E 10 cmbs	empty lot
cleaning platform surface		

3/18/96 Sub-Op D Structure 1 P96-56-44
Lot 17 101N 97E 30-50 cubs sherds, obs., chert
100N 97E

Lot 18 100N 97E 0-50 cubs sherds, baja

Lot 19 97N 102E 20-30 cubs sherds

Lot 20 100N 98E 0-50 cubs sherds, baja

WEST HALF

Lot 21 101N 99E 0-60 cubs sherds, obs

Lot 22 100N 101E 0-10 cubs empty lot

Lot 23 96N 99E 0-20 cubs empty lot

Lot 24 100N 102E 10-30 cubs sherds, baja, obs.

(clearing west end of unit)

Lot 25 99N 97E 0-60 cubs sherds, baja

EAST HALF

3/19/96 Lot 26 96N 99E 20-40 cubs sherds, baja, obs.

Lot 27 99N 97E 0-70 cubs sherds, baja, chert

WEST HALF

Carbon

metate frag.

Lot 28 98N 99E 0-50 cubs sherds

Lot 29 97N 99E 0-40 cubs sherds, obs

Lot 30 99N 99E 0-10 cubs empty lot

Lot 31 96N 97E 10-30 cubs sherds, obs., baja
North Half

3/19/96 410D Structure **1** P96-56-45
Lot 32 98N 97E 0-40 cubs sherds

Lot 33 98N 101E 10-40 cubs sherds

3/20/96

Lot 34 99N 103E 0-40 cubs sherds, baja

Lot 35 100N 99E 0-5 cubs empty lot

Lot 36 96N-98E 10-40 cubs sherds

Lot 37 98N 98E 0-5 cubs sherds

Lot 38 97:98N 97E 30/40-50 cubs sherds, obs. ^{chest}

Lot 39 100N 98E 0-5 cubs empty lot

EAST HALF

Lot 40 99N 99E 0-5 cubs empty lot

Lot 41 99N 98E 0-5 cubs empty lot

Lot 42 100N 101E 10-30 cubs * baja, sherds

cleaning walls

Lot 43 99N 101E 40-50 cubs sherds, baja, chest

cleaning walls

Lot 44 97N 98E 0-40 cubs empty lot

Lot 45 98N 98E 5-10 cubs empty lot

Lot 46 98N 103E 0-10 cubs sherds

Lot 47 96N 102E 30-40 cubs sherds, obs

Lot 48 99N 100E 10-40 cubs sherds, obs.

cleaning walls

3/20/96

Lot 49

~~Final Notes~~ 410 D Structure 1 P96-56-46
98 N 99 ~~98~~ E 50-60 cmbs sherds, bays

Lot 50

100 N 101 E

30-40 cmbs sherds, bays

- 3/21/96 410 E - TEST UNITS (South)
Lot 01 78 N 100 E 0-20 cmbs sherds

- 3/25/96

LOT 02 410 E 83 N 100 E 0-20 cmbs SHERDS

LOT 03 78 N 100 E 20-40 cmbs SHERDS

LOT 04 78 N 100 E 40-60 cmbs EMPTY

LOT 05 73 N 100 E 0-30 cmbs SHERDS

LOT 06 68 N 100 E 0-20 cmbs SHERDS

LOT 07 68 N 100 E 20-30 cmbs - EMPTY

LOT 08 63 N 100 E 0-20 cmbs SHERDS

LOT 09 63 N 100 E 20-30 cmbs SHERDS

LOT 10 58 N 100 E 0-20 cmbs EMPTY

LOT 11 53 N 100 E 0-20 cmbs ~~50-60~~ SHERDS

LOT 12 48 N 100 E 0-20 cmbs EMPTY

LOT 13 43 N 100 E 0-20 cmbs SHERDS

LOT 14 38 N 100 E 0-20 cmbs EMPTY

LOT 15 33 N 100 E 0-20 cmbs EMPTY

P96-56 pg 47

410 F
LOT 01

TEST PITS - EAST
98N 105E

3-25-96

0-20 CMBS SHERDS BAJAREQUE

LOT 02

98N 108E

0-20 CMBS SHERDS

LOT 03

98N 114E

0-20 CMBS SHERDS

LOT 04

98N 119E

0-20 CMBS SHERDS

LOT 05

98N ~~124~~E

0-20 CMBS SHERDS

LOT 06

98N 129E

0-20 CMBS EMPTY

LOT 07

98N 134E

0-20 CMBS SHERDS

LOT 08

98N 139E

0-20 CMBS SHERDS

LOT 09

98N 144E

0-20 CMBS ~~SHERDS~~ EMPTY

LOT 10

98N 144E

20-40 CMBS EMPTY

LOT 11

98N 148E

0-20 CMBS EMPTY

LOT 12

98N 148E

20-40 CMBS EMPTY

LOT 13

98N 109E

20-40 CMBS SHERDS

LOT 14

98N 105E

20-40 CMBS SHERDS, BAJAREQUE
OCARINA

LOT 15

98N 114E

20-40 CMBS EMPTY

410 E

TEST PTS - SOUTH

3-25-96

LOT 16

83 N 100 E

20-40 CMBS EMPTY

LOT 17

73 N 100 E

20-40 CMBS SHERDS

LOT 18

68 N 100 E

20-40 CMBS EMPTY

LOT 19

63 N 100 E

20-40 CMBS EMPTY

LOT 20

58 N 100 E

20-40 CMBS EMPTY

LOT 21

58 N 100 E

20-40 CMBS SHERDS

LOT 22

48 N 100 E

20-40 CMBS SHERDS

LOT 23

43 N 100 E

20-40 CMBS EMPTY

LOT 24

38 N 100 E

20-40 CMBS EMPTY

LOT 25

33 N 100 E

20-40 CMBS EMPTY

LOT 26

73 N 100 E

40-50 CMBS EMPTY

LOT 27

53 N 100 E

40-50 CMBS EMPTY

LOT 28

48 N 100 E

40-50 CMBS EMPTY

3-25-96

410 F

TEST PITS EAST

P 96-56 Pg 48

LOT 16

98N 119E

20-40 cmBS

SHERDS

LOT 17

98N 124E

20-40 cmBS

SHERDS

LOT 18

98N 129E

20-40 cmBS

EMPTY

LOT 19

98N 134E

20-40 cmBS

EMPTY

LOT 20

98N 105E

40-50 cmBS

EMPTY

LOT 21

98N 109E

40-50 cmBS

EMPTY

LOT 22

98N 114E

40-50 cmBS

EMPTY

LOT 23

98N 119E

40-50 cmBS

EMPTY

LOT 24

98N 124E

40-50 cmBS

EMPTY

3-25-96

P-96-56 Pg 50

TEST PITS - NORTH LINE			
410 G LOT 1.	111N 100E	0-20 cmBS	EMPTY SHERDS
LOT 2	116N 100E	0-20 cmBS	SHERDS
LOT 3	121N 100E	0-20 - cmBS	EMPTY
LOT 4	126N 100E	0-20 - cmBS	EMPTY
LOT 5	131N 100E	0-20 cmBS	EMPTY
LOT 6	136N 100E	0-20 cmBS	EMPTY
LOT 7	141N 100E	0-20 cmBS	EMPTY
LOT 8	146N 100E	20-40 cmBS	EMPTY
LOT 9	146N 100E	0-20 cmBS	EMPTY
LOT 10	151N 100E	0-20 - cmBS	EMPTY
LOT 11	111N 100E	20-40 cmBS	SHERDS
LOT 12	116N 100E	20-40 cmBS	LARGE ROCKS POSSIBLY A WALL
LOT 13	121N 100E	20-40 - cmBS	EMPTY
LOT 14	126N 100E	20-40 cmBS	SHERDS
LOT 15	131N 100E	20-40 cmBS	EMPTY
LOT 16 LOT 16	136N 100E 121N 100E	20-40 cmBS 0-20 cmBS	- EMPTY - EMPTY

410H	3-25-96	P96-56 Pg 51
LOT 1	TESTPTS WEST 92E 98N	0-20 cmBS SHERDS SHERDS
LOT 2	87E 98N	0-20 cmBS SHERDS
LOT 3	82E 98N	0-20 cmBS SHERDS
LOT 4	77E 98N	0-20 cmBS SHERDS
LOT 5	72E 98N	0-20 cmBS SHERD
LOT 6	67E 98N	0-20 cmBS SHERDS
LOT 7	62E 98N	0-20-cmBS EMPTY
LOT 8	57E 98N	0-20 cmBS EMPTY
LOT 9	52E 98N	0-20 cmBS EMPTY
LOT 10	47E 98N	0-20 cmBS EMPTY
LOT 11	43E 98N	0-20 cmBS EMPTY
LOT 12	67E 98N	20-40cmBS EMPTY
LOT 13	92E 98N	20-40 cmBS ● SHERDS
LOT 14	87E 98N	20-40cmBS SHERDS
LOT 15	82E 98N	20-40 cmBS SHERDS OBSIDIAN
LOT 16	77E 98N	20-40 cmBS EMPTY

3-26-96

4104

TEST PITS - WEST

P96-56 pg 52

92E
98N

LOT 17

72E 98N

20-40 cm BS Empty

LOT 18

67E 98N

20-40 cm BS Empty

LOT 19

62E 98N

20-40 cm BS Empty

LOT 20

57E 98N

26-30 cm BS Empty

LOT 21

87E 98N

40-50 cm BS ~~Empty~~ SHERDS

LOT 22

82E 98N

40-50 cm BS SHERDS

LOT 23

82E 98N

50-60 cm BS - SHERDS

LOT 24

87E 98N

50-60 cm BS - ~~Empty~~ ^E ~~SHERDS~~

LOT 25

92E 98N

40-50 cm BS - Empty

LOT 26

82E 98N

60-70 cm BS - Empty

3-26-96

P-96-56 Pg 53

410G

TEST PITS NORTH LINE

LOT 17

126 N 100E

40-50 cmBS Empty

LOT 18

111 N 100E

40-50 cmBS - Empty

LOT 19

116 100E

40-50 cmBS - ROCKS
POSSIBLY
A FEATURE
EMPTY

LOT 20

111 N 100E

50-60 cmBS - LOOKING FOR
CREEK GRAVEL
EMPTY

LOT 21

126 N 100E

40-70 cmBS EMPTY - LOOKING
FOR GRAVEL

LOT 22

151 N 100E

40-60 cmBS EMPTY - SEARCH
FOR CREEK GRAVEL

4/2/96

FINAL NOTES STRUCTURE 1

PG 6-50-54

Earliest phase of construction:

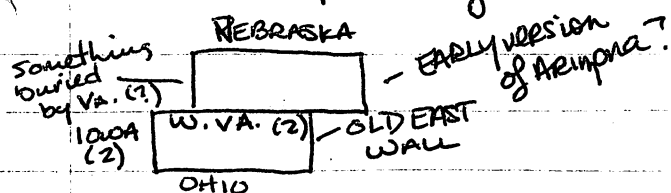

or

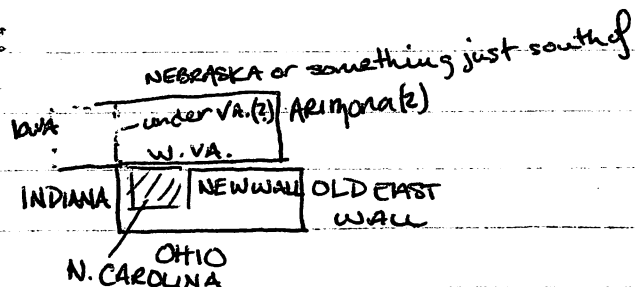

Later phases: Old East wall, New Wall, & N. Carolina are All buried. Utah: the southern extension of Arimona wrap around Ohio: Old East Wall, Ohio is extend to

Utah - Late addition - partially covers the base of Ohio Added on as extra support / long step up onto Ohio & into the formal entrance of Kentucky. Corners in the SE with the ^{southern} extension of Arimona

Arimona (Southern Extension) - late addition, Corners with Utah. forms a step/bench roughly the same width as Utah - ie wraps around the ^{south} east corner of the platform the same way Utah wraps around the southern end

ILLINOIS - Same height as Iowa (2), Abuts Iowa (2) possibly for support or maybe just for the added width.

May have abutted Utah, but Utah has since eroded away in the south west corner

New York - overruns the western half of the Arimona (Southern Extension). Abuts the later addition to W. VA. forms the eastern wall of the formal entrance (Ohio, Kentucky, Maryland, New York.)

Maryland. overruns Ohio. forms the western wall for the formal entrance

4/1/96

FINAL NOTES STRUCTURE 1 Sub-ops B,D

T96-36-55

TOP

BOTTOM
MIDTRE

NAME	Length	Width	TOP	BOTTOM	TOP	BOTTOM	
✓ Colorado	1.35	.25	S .83	S 1.05	N .79	N 1.04	
✓ Wyoming	1.00	.70	W .86	W .99	E .86	E 1.03	
✓ Idaho	3.15	.40/.50	S .64	S 1.02	N .90	N 1.31	.69-T 1.08 B
✓ Arizona ^(South)	1.80	.80	S .75	S 1.07	N .80	N .98	(.74)
✓ Arizona ⁽²⁾	(4.25) 1.85	.50/.60	S .68	/	N .69	N .96	(.74)
Rhode Island	1.00	.35	E .48	E .74	W .51	W .78	
✓ Mass.	1.35	.30	S .47	S .75	N .57	N .92	
✓ Michigan	1.00	.35	S .52	S .82	N .44	N .77	
✓ Georgia	E/W 1.10 N/S .70		LEVEL 1 E .57 LEVEL 2 S .78	E .60 S .80	W .73 N .85	W .76 N .88	
Florida	1.20	.30	W .51	W .73	E .40	/	
✓ Conn.	1.30	.25	W .55	W .75	E .59	E .75	
✓ Penn.	(2.00) 3.15	.25	E .70	E 1.06	(W .55)	W .78	(.43) (.89)
Nebraska	(3.05) 4.15	.50	E .90	E 1.31	W .78	W 1.05	.95 1.27
✓ Virginia	2.00 N/S	E/W 1.30	SURFACE	- TOP MIDDLE	.36		
Iowa	2.10	.30	N .37	N 1.01	S .47	S .84	
✓ Iowa ^(South) (2)	(4.05) 1.70	.25	S .49	S .86(?)	N .45	/	
✓ W. Virginia	3.60	.25/.30	W .38	W .89	E .66	E .78	.45 .77
✓ W. Virginia ^(North) (2)	2.60	.30	W .31	/	E .61	/	.36 .98
✓ Illinois	2.05	.30	N .45	N .90	S .58	S .97	
✓ UTAH	3.70	.40	W .85	W 1.02	E .76	E 1.13	.93
✓ OHIO	2.75	.35	W .58	W .91	E .74	E 1.05	.59 .95
✓ INDIANA	1.20	.85	S .58	S .72	N .39	N .86	
✓ TENN.	.70 N/S	.65 E/W	S TOP -	.69	N TOP -	.78	
✓ MARYLAND	.90	.30	S .59	S .73	N .64	N .83	
✓ KENTUCKY	.90 N/S	.70 E/W	S TOP -	.75	N TOP -	.78	
✓ NEW YORK	1.40	.45	S .64	S .87	N .66	N .86	.54 .83
✓ N. CAROLINA	.80 N/S	.60 E/W	S TOP -	.89	N TOP -	.95	
✓ NEW WALL	1.05	.20	W .92	W .96	E .66	E .87	
✓ Old East Wall	1.35	.30	S .84	S .99	N .80	(N .92)	

TYPE OF STONE: A-ANGULAR
CB-CUT BLOCK RC-RIVER COBBLE
CH-CHUNKING

SIZE OF STONE - XL .45m <
L .25m <
M .2m >
S .05m >

3/27/96

A/D STRUCTURE 1 FINAL NOTES

P6-56-56

NAME	# OF COURSES WIDE	# OF COURSES DEEP	TYPE OF STONE	SIZE OF STONE	ORIENTATION	INTEGRATED, ABUTTED, OVERRUN(S)
Colorado	1	2	RC, CH	S, M, L	112°	INTEGRATES w/ Wyoming(?)
Wyoming	4	1-2	RC, CH	M, L, S	274°	I w/ Wyoming: A- IDAHO
Idaho	2 (4)	4	RC, A, CH	L, M, S, XL	359°	A- by Wyoming O- by Rhode Island A- w/ ARIZONA I w/ VIRGINIA (WEST) I w/ NEBRASKA I w/ Utah
Arizona	2	2-3	RC, CH	L, XL, S, M	5°	
Arizona (2)						
Rhode Island	1-2	1-3	RC, CH	M, S, L	96°	A- MASS O- ARIZONA (2), Idaho
Mass.	1	1-3	RC, CH	M, S, L	2°	May have I. w/ Idaho A/I - Rhode Island, Conn.
Michigan	1	2-3	RC, CH	S, M, L	2°	O- ARIZONA (2), Pennsylvania
Georgia	4 (+)	2-3 (layers)	flat RC	S/M, L	/	O- OLDEST WALL A- FLORIDA, MASS, RI, WVA, IL, Z, GEORGIA
Florida	2	2-3	RC	S, M	76°	A- ORIGINAL WALL, Michigan O- by Florida
Conn.	1	2	RC, CH	M, L, S	84°	A- VIRGINIA Possibly I w/ MASS (A w/) RHODE ISLAND O- GEORGIA
Pennsylvania	1	2-3	RC, CH	M, L, S	84°	A- MASS, VIRGINIA Lies on top of Penn.
Nebraska	1 (+)	2	A, RC, CH	XL, L/M, S	84°	O- NEBRASKA I - MASS. A- VIRGINIA
Virginia	4 (+)	1	A, RC, CH	S, M, L	/	I - Iowa O- by Penn A/I ARIZONA (2)
Iowa	1	4-5	RC, CH	L, M, S, XL	1°	I - Iowa (2) may be later add. A - Conn, Penn, Iowa, Original WVA.
Iowa (2)	1	1 (+)	RC, CH	M, S	360°	Florida (2) I - TENN: NEBRASKA A - WVA (2)
W. Virginia	1	3 >	RC, CH	M, XL, L, S	90°	A - ILLINOIS, VIRGINIA I/A - WVA. A - ILLINOIS
W. Virginia (2)	1	4	RC, CH	M, XL, L, S	90°	I/A - OHIO A - NY O- OLDEST WALL, ARIZONA A - Idaho, WVA (2) O- NEW WALL
Illinois	1	4-5	RC, CH	S, M, L	350°	O- OLDEST WALL, ARIZONA A - INDIANA, Iowa, IOWA (2), ILLINOIS
Utah	1 (+ 1/2)	1-2	RC, A, CH	M, L, S, XL	87°	A - Iowa, Iowa (2) WVA (2), OHIO, WVA
Ohio	2	2-3	RC, CH, A	M, L, S	87°	A - ILLINOIS, OHIO I - ARIZONA
Indiana	2	5-6	RC, CH	S, M	359°	I/A ILLINOIS, Iowa (2), INDIANA, NY, S ARIZONA A - KENTUCKY, TENN. O - MASS A - OHIO, TENN, WVA. (2)
Tennessee	5	1	FLAT RC, CH	S, M	/	A - INDIANA, OHIO, MARYLAND O - N. CAROLINA
Maryland	1-2	2	RC, CH, A	M, S, L	359°	A - TENN., KENTUCKY O - OHIO
Kentucky	4-5	1-2	FLAT RC, CH	M, L, S	/	A - NY, MARYLAND, OHIO O - OLDEST WALL
New York	2	2-3	RC, CH, A	M, S, L	2°	A - KENTUCKY, WVA. O - NEW WALL O - ARIZONA I - OHIO
N. Carolina	4 x 4	1	RC, CH	S	/	A - INDIANA, WVA, NEW WALL O - WVA.
New Wall	1	2	RC, A, CH	S, M	91°	A - ARIZONA (2) A/O - NEW WALL (1) A - WVA. ID - by N.Y.
Old East Wall	1	1	RC	L, M, S	2°	O - UPPER COURSES OF OHIO A/O - by NEW WALL I - OHIO O - Kentucky A - NY WVA

VIRGINIA - bench or bed - raised surface NWC, rock filled

INDIANA - EAST Foundation wall for raised (dirt) surface possibly and older wall from an earlier phase

Iowa (2) - south - probably the original - abuts W. VA. on the southside, - later wrapped by ILLINOIS

Nebraska - ^{wrong - 2nd phase} Original northern basal wall - * it probably covers the original - ~~the~~ ^{the} ~~corners~~ ^{corners} just inside of it - probably ended in line with Indiana and was later expanded to the west when the northern half of Iowa was built and Virginia was constructed Idaho: Nebraska may have wrapped around Arizona and the unknown wall it corners with

Penn. - Later construction, runs over Nebraska - slightly inset corners in line with NY in the East. May have been added when the northern half of Iowa & the surface Virginia were added

Conn. - back foundation wall for bench (Florida is the front)
Florida

Ohio - originally a basal wall for a patio, but was later converted. East of Maryland it is low w/ very flat stones which integrate with the surface of Kentucky. West of Maryland it is higher, helping to define the southern extent of Tennessee and form the foundation of the raised surface area (Indiana, Ohio, Iowa (2), & W.Va. Originally it may have ended with Indiana and later added onto in the west to meet up with Iowa (2).

Kentucky - floor of entry feature which overruns Old East Wall and is contained between N.Y., Md., & Oh.

TENNESSEE - floor in front of the bench/raised surface defined by Oh., Indiana, W.Va., & Iowa (2). TENN. is defined by the raised walls of Oh., Md., & Indiana, overruns the older surface of N. Carolina.

N. Carolina - floor surface from earliest construction - Abuts Indiana and Original W.Va., and New Wall; Later overrun by W.Va. add-on and TENNESSEE.

New Wall - same level as N. Carolina - Abuts it; partially overrun by the W.Va. add-on. From the earlier phase of construction - it appears that the southern extension of Indiana abuts it.

Old East Wall - Earlier phase of construction - may continue beyond New Wall, under Michigan (?), if not it abuts New Wall - was later covered over by Kentucky - probably served as the southeastern edge of the original patio.

Colorado - late addition - corners with Wyoming. May have been meant to enclose an area east of Arizona's southern extension - either it deteriorated or was never completed

Wyoming - a wide, short, and nicely constructed extension off of the southeast corner of Idaho; corner w/ Colorado purpose of construction may never have been realized

Idaho - late addition abutting Arizona forming a very nice foundation wall - running the length of the back half of the structure

W. Va. - divides the structure along its E/W axis
 S. foundation wall for main part of structure
 later addition added to bolster the foundation (?)

Michigan & R.I. both are small filler walls which form the foundation for a small storage area in the SEC of the back half of the platform

GEORGIA - floor w. of Michigan - two levels of construction formed surface b/w shelf (Michigan & Co.), bench (Florida & Conn.), and raised platform (Virginia). Very disturbed - both levels are ^{sharply} sloped but fairly intact

MASS. forms a very weak wall along the NE edge of the structure, capping off the bench created by Florida and Conn.

3/21/96

P96-86-4
60

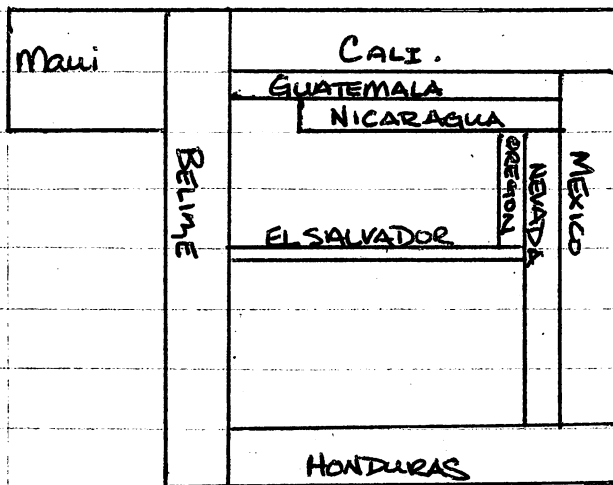

Sub opC ; Structure 2

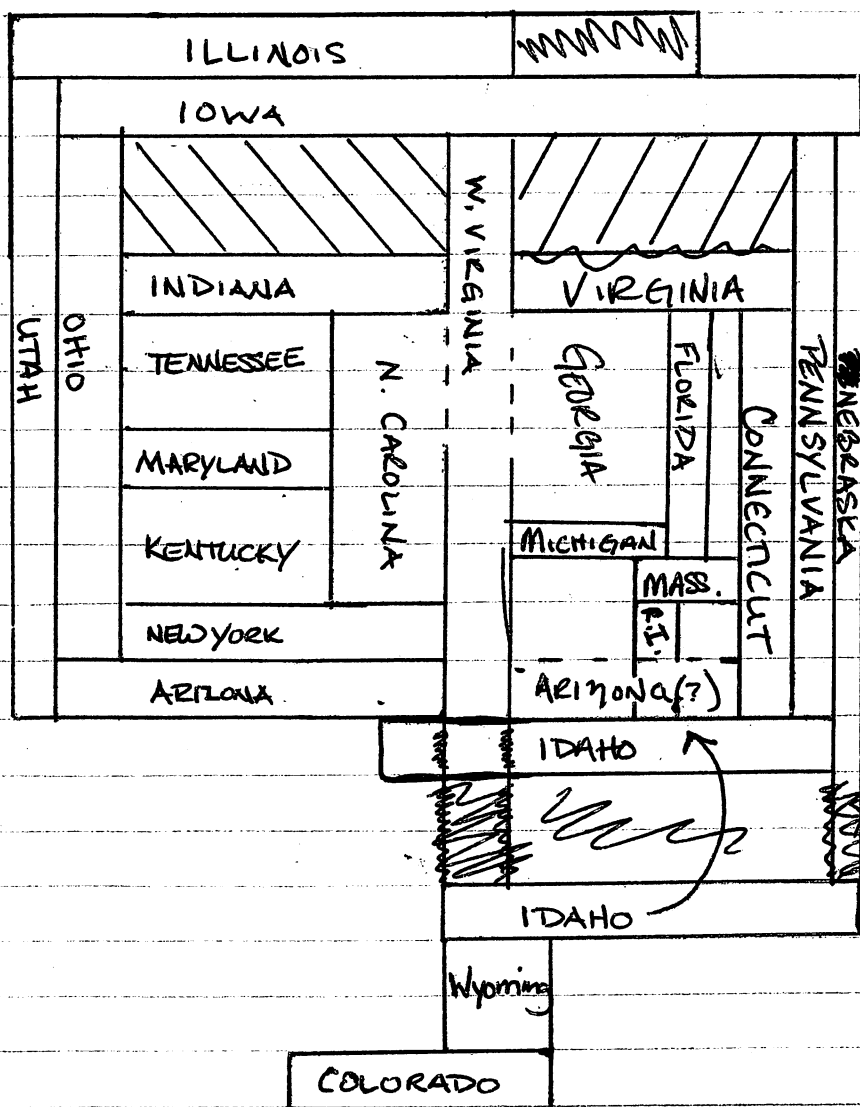

CB - CUT BLOCK
 RC - RIVER COBBLE
 CH - Chinking S - .05m > XL - .45m <
 A - ANGULAR M - .12m > L - .25m <
 A P-96-56-461

3/21/96 FINAL NOTES 410 C STRUCTURE 2

NAME	LENGTH	Width	# of Courses DEEP	# of Courses WIDE	TYPE OF STONE	S.M.E of STONE	I - INTEGRATED A - ABUTTED O - OVERLAYS
MAUI	1.4m N/S	.8m E/W	1-2	3-4	RC, A	S, M, L, XL	A - CORNER of BELIME: CALI (in N)
CALIFORNIA	2.95m N/S	.5m E/W	2	2	CH, RC, A	L, M, S	I - BELIME: MEXICO A - MAUI, GUAT.
GUATEMALA	2.1m N/S	.25m E/W	/	1	CH, RC	L, M, S	I - BELIME, NEVADA A - CALI, NICARAGUA, MEXICO
NICARAGUA	1.2m N/S	.2m E/W	2-4	1	CH, RC	M, S	I - OREGON A - GUATEMALA
MEXICO	3.5m E/W	.4m N/S	2-3	1-2	CH, RC	L, S, M, XL	I - CALI, HONDURAS A - Guatemala, HOI-AN
NEVADA	1.6m E/W	.25m N/S	/	1	RC	M, L	I - NICARAGUA A - MEXICO, OREGON, HOI-AN
OREGON	.6m E/W	.2m N/S	1	1	RC	M, S	I - NICARAGUA, EL SAL(?) A - NEVADA
EL SALVADOR	1.9m N/S	.35m E/W	1	1	RC, A, CH	L, M, S	A/I - OREGON A - NEVADA, BELIME, HOI-AN
HONDURAS	3.3m N/S	.35m E/W	2-4	1	RC, CH, A	XL, L, S, M	I - MEXICO, BELIME A - HOI-AN
BELIME	3.6m N/S	.5m E/W	1-3 ②	2-3	RC, CH	L, M, S, XL	I - HONDURAS, CALI, GUAT. A - HOI-AN, EL SALV. MAUI
HOI-AN	2.1m N/S	1.4m E/W	1	/	RC, A	M, S, L	A - HONDURAS, EL SALVADOR BELIME, MEXICO, NEVADA

NAME	ORIENTATION	* N/E	TOP MIDDLE	S/W	N/E	BOTTOM MIDDLE	S/W
		All	reading	taken	from	line level	
MAUI	354°	NW-33cm NE-39cm 33cm	33cm	SE-37cm SW-30cm 30cm	NW-51cm NE-53cm 51cm	35cm	SE-62cm SW-62cm 62cm
CALIFORNIA	2°	20cm	23cm	17cm	49cm	48cm	54cm
GUATEMALA	359°	19cm	21cm	21cm	/	/	43cm
NICARAGUA	356°	21cm	22cm	17cm	36cm	38cm	46cm
MEXICO	84°	23cm	18cm	29cm	70cm	51cm	50cm
NEVADA	82°	29cm	25cm	27cm	/	/	/
OREGON	78°	22cm	/	22cm	35cm	/	33cm
EL SALVADOR	346°	14cm	22cm	21cm	34cm	35cm	37cm
HONDURAS	353°	23cm	39cm	51cm	70cm	68cm	76cm
BELIME	89°	23cm	28cm	17cm	70cm	55cm	54cm
HOI-AN	/	NW-26cm NE-30cm		SW-27cm SE-47cm			
MAUI	354°	NW-36cm NE-39cm		SW-35cm SE-38cm	NW-51cm NE-52cm		SW-51cm fiftyone SE-59cm

* line level is 20 cm above ground surface - same as on profile

3/25/96 Structure 2 final Notes

P96-56-62

Overall the structure is orientated N/S and nearly touches structure 1 in the NEC. The overall dimensions are ^{roughly} 3.5 m x 3.5 m - though a little longer along its E/W axis. Off of the southwest corner of the structure a little addition of a small (1.25 m x 3.0 m*) stone surface abuts the foundation wall. Possibly it was used as a bench or work station of some sort.

Initial excavations of the structure cut across the western portion of the structure. These excavations revealed several interior lines which were followed and excavated to their base. It appears that the western platform wall was faced on the inside as well as the outside. Just west of center a poor medial wall was uncovered - east of this divider the platform is filled with medium to small rocks with no lines ~~is~~ visible except for the lines of the platform's ~~the~~ outer walls. Originally, the entire raised platform was covered in stone, however, in order to follow the interior lines in the western half of the structure, stones were ~~the~~ pulled leaving the western half of the structure open to further scrutiny. As already mentioned, the structure contains 4 platform walls, a bench (off the SWC), a N/S medial wall, and a very roughly "paved" surface on the ~~the~~ eastern half of the structure - ~~the~~

Descriptions:

Mani - A small bench or work station which abuts the SWC of Belipe and Cali. It consists of several large flat stones placed face up the surface sit slightly lower than the platform, but its base appears to be level w/ the base of Belipe.

Belipe - Southern foundation wall of raised platform is abutted by El Salvador (medial wall)

Beline may have originally ended with Guatemala which appears to be integrated with it. Guatemala may have originally been a two course wide wall (Guate + Nicaragua). Nicaragua appears to have lost its integrity in the south. The original platform may have consisted of Beline as the southern foundation (2-3 courses wide); Guatemala and Nicaragua forming one 2 course wide western foundation wall which then integrated with Nevada. Nevada formed the northern foundation and may have contained a second course (Oregon) - Oregon, however, appears to abutt Nicaragua in the NW. Nevada integrates with Honduras which forms the eastern foundation wall. Honduras then integrates with Beline in the SEC.

The construction of the interior of the platform remains hazy - was it a dirt filled structure first? There appears to be a medial wall which was off center if it was built along with the original foundation walls or it was laid afterwards and was fairly well centered with the new additions. Either way the result is the same - two areas of occupation separated by a wall, the floor consisting of a stone subsurface covered over by a layer of ^{hard packed} earth.

The second phase of construction consisted of the addition of California and Mexico to the west and north foundation walls. And finally Mari was added on to Beline: Cali (Guate.)

3/26/96 ^{South} 410E SOILS
TEST UNITS

P96-56-64

- #12 while there is no ^{visible} noticeable color change in the soil - 0-30 cmbs is tightly compacted while 30-40 cmbs is fairly unconsolidated
0-30 - 10YR 4/4 dark yellowish brown; 30-40 - 10YR 4/3 brown/dark brown; both are very fine soils with few roots: no rocks
- #11 0-15 cmbs 10YR 4/3 brn/dk brown tightly packed few roots/rocks, fine soil
15-35 cmbs 10YR 3/3 dk brown, loosely packed "
35-40 cmbs 10YR 4/3 brn/dk brown, unconsolidated "
- #10 0-30 cmbs 10YR 4/3 brn/dk brown tightly packed ϕ rocks few roots ^{fine soil}
30-40 cmbs 10YR 3/3 dk brown, unconsolidated, very few roots or rocks ^{fine soil}
- #9 0-15 cmbs 10YR 3/3 dk brown, consolidated, more roots, no rocks } ^{very fine soil}
15-35 cmbs 10YR 3/2 very dk gray brown, consolidated w/ fewer roots }
35-50 cmbs 10YR 3/2 very dk gray brown, unconsolidated w/ few roots }
- #8 0-30 cmbs 10YR 4/3 brn/dk brown tightly packed few roots or rocks, fine soil
30-50 cmbs 10YR 4/4 dr. yll. brown "
- #7 0-30 cmbs 10YR 3/3 dk brown tightly packed, few roots, fine soil, few rocks
30-40 cmbs 10YR 3/4 dk yll. brown, loosely consolidated, ~~few~~ no rocks, few roots
- #6 0-25 cmbs 10YR 3/3 dk brown tightly packed, few rocks or roots, fine soil
25-40 cmbs 10YR 4/4 dk yll. brown, loosely consolidated, no rocks, very few roots, fine soil
- #5 0-30 cmbs 10YR 4/4 dk yll. brown tightly "
30-40 cmbs 10YR 3/4 dk yll. brown loosely "
- #4 0-35 cmbs 10YR 4/3 brn/dk brown tightly " very few roots
35-50 cmbs 10YR 3/4 dk yll. brown loosely "

3/26/96 410E TEST UNITS (SOUTH) SOILS

P96-56-65

- #3 0-40 cmbs 10yr $4/3$ brn/dk. brn tightly packed, coarse soil, roots, few rocks
40-60 cmbs 10yr $3/2$ very dk. grayish brn unconsolidated, very fine soil, few rocks ^{roots:}
- #2 0-30 cmbs 10yr $4/4$ dk yll. brn tightly packed coarse soil, gravelly w/ few
30-40 cmbs 10yr $4/3$ brn/dk. brn roots & more rock
- #1 Not dug

410 F TEST UNITS (EAST) SOILS

- #10 0-40 cmbs 10yr $3/4$ dk. yll. brn. tightly packed w/ very few roots
and w/ some rocks at the base (where it is slightly less consolidated)
- #9 0-40 cmbs 10yr $4/3$ brn/dk. brn. tightly packed, roots, no rocks, coarse soil
(becomes more unconsolidated near the base (30-40 cmbs))
- #8 0-30 cmbs 10yr $3/4$ dk. yll. brn. tightly packed, no rocks, few roots, coarse soil
30-40 cmbs 10yr $3/6$ dk. yll. brn. " " fine soil
- #7 0-35 cmbs 10yr $4/4$ dk. yll. brn. " "
35-40 cmbs 10yr $3/4$ dk. yll. brn. " "
- #6 0-30 cmbs 10yr $4/3$ brn/dk. brn. tightly packed, few roots, rocks ^{coarse soil}
30-40 cmbs 10yr $3/6$ dk. yll. brn. loosely packed ^{fine soil}
- #5 0-35 cmbs 10yr $3/6$ dk. yll. brn. tightly packed, roots, no rocks, coarse soil
35-40 cmbs 10yr $4/6$ dk. yll. brn. more loosely packed, roots, no rocks, finer soil
- #4 0-35 cmbs 10yr $5/4$ yll. brn. tightly packed, a few roots, rocks, coarse soil
35-60 cmbs 10yr $4/6$ dk. yll. brn. less tightly packed, fewer roots, no rocks, ^{fine} soil
- #3 0-10 cmbs 10yr $5/4$ yll. brn. tightly packed coarse soil, ~~few~~ rocks, roots
10-30 cmbs 10yr $5/3$ brn. tightly packed coarse gravelly soil, roots
30-40 cmbs 10yr $4/6$ dk. yll. brn. loosely consolidated fine soil, few roots, no rocks

3/26/96 410F TEST UNITS (EAST) Soils

P96-56-66

- #2 0-10 cubs 10YR 5/3 ben. tightly packed coarse soil with roots; rocks
10-40 cubs 10YR 4/3 brn./dk. brn. tightly packed coarse gravelly soil, ^{few} roots
40-50 cubs 10YR 4/4 dk. yll. brn. loosely consolidated, fine soil, very few roots

- #1 0-40 cubs 10YR 3/4 dk. yll. brn. tightly packed coarse gravelly soil w/roots
40-50 cubs 10YR 4/3 brn./dk. brn. loosely consolidated finer soil w/few roots

410G TEST UNITS (NORTH) Soils

- #9 0-20 cubs 10YR 4/2 dk. grayish brn. tightly packed, fine soil, ^{few} roots, some rocks
20-60 cubs 10YR 3/2 very dk. grayish brn. tightly packed, coarser soil (gravelly), ^{few} roots
60-70 cubs 10YR 4/4 dk. yll. brn. very fine soil, no roots or rocks

- #8 0-40 cubs 10YR 3/3 dk. brn. roots, few rocks, coarse soil, tightly packed

- #7 0-35 cubs 10YR 3/2 very dk. grayish brown tightly packed, fine soil, ^{few} roots, no rocks
35-40 cubs 10YR 4/2 dk. grayish brn. less tightly packed " "

- #6 0-30 cubs 10YR 3/2 very dk. grayish brn. tightly packed fine soil, ^{few} roots, no rocks
30-40 cubs 10YR 4/3 brn./dk. brn. " "

- #5 0-40 cubs 10YR 4/3 brn./dk. brn. tightly packed, ^{few} roots, no rocks, fine soil

- #4 0-52 cubs 10YR 4/3 brn./dk. brn. tightly packed, ^{few} roots, no rocks, fine soil
52-58 cubs 10YR 3/2 very dk. grayish brn. loosely consolidated, gravel, ^{very few} roots
58-60 cubs 10YR 3/4 dk. yll. brn. tightly packed, no rock, fine soil, ^{very few} roots

- #3 0-40 cubs 10YR 4/4 dk. yll. brn. tightly packed, ^{first} roots in ^{first} 10 cubs, ^{fine soil} no rocks

- #2 0-30 cubs 10YR 3/3 dk. brn. tightly packed, roots, coarse soil, ^{few} rocks
30-60 cubs 10YR 4/4 dk. yll. brn. tightly packed, ^{very few} roots, coarse soil, no rocks
rests on top of possible feature (50 cubs)

- #1 0-20 cubs 10YR 3/3 dk. brn. tightly packed, roots, no rocks, coarse soil
20-50 cubs 10YR 4/4 dk. yll. brn. loosely consolidated, gravelly coarse soil, no roots
50-60 cubs 10YR 3/4 dk. yll. brn. consolidated clayey soil no roots, or rocks

3/27/96 410 H TEST UNITS (WEST) SOILS P96-56-67

- #11 0-20 cubs 10YR 5/4 yll. brn. tightly packed, very few roots: rocks, fine soil
- #10 0-20 cubs 10YR 5/4 yll. brn. tightly packed, very few roots: rocks, fine soil
- #9 0-20 cubs 10YR 5/4 yll. brn. tightly packed, roots: rocks, fine soil
- #8 0-15 cubs 10YR 4/3 brn/dk. brn, tightly packed, ^{roots in top 5cm}, rocks, ~~fine~~ coarse soil
 15-30 cubs 10YR 4/4 dk. yll. brn, more loosely consolidated, gravelly soil, few roots
- #7 0-15 cubs 10YR 4/3 brn./dk. brn., ^{hard} packed, rocks: few roots, coarse soil
 15-40 cubs 10YR 3/2 very dk. grayish brn, gravelly soil w/ roots, loosely consol.
- #6 0-10 cubs 10YR 4/3 " " " the upper 10 cm(s)
 10-40 cubs 10YR 3/2 " " " is becoming progressively more gravelly
- #5 0-10 cubs 10YR 4/3 " " "
 10-40 cubs 10YR 3/2 " " "
- #4 0-10 cubs 10YR 4/3 " "
 10-40 cubs 10YR 3/2 " "
- #3 0-25 cubs 10YR 4/4 dk. yll. brn. hard packed, fine soil, ~~few~~ roots, ^{rocks but no gravel}
 25-50 cubs 10YR 4/3 brn./dk. brn. loosely consolidated coarse gravelly soil, some roots
 50-60 cubs 10YR 3/6 dk. yll. brn. loosely consolidated fine soil - no roots or rocks
- #2 0-20 cubs 10YR 4/3 brn./dk. brn, hard packed coarse soil, root mat up 5cm, rocks
 20-35 cubs 10YR 4/4 dk. yll. brn., loosely consolidated, thinned out gravel layer, ^{few roots}
 35-50 cubs 10YR 3/2 very dk. grayish brn. loosely consolidated "river bed" fine gravel, ^{very few roots}
 50-60 cubs 10YR 3/4 dk. yll. brn. hard packed fine soil, very few roots, no rocks
- #1 0-25 cubs 10YR 3/3 dk. brn. hard packed, few roots, coarse soil, some rocks
 25-40 cubs 10YR 4/4 dk. yll. brn. loosely consolidated thinned out gravel layer, very few roots
 40-50 cubs 10YR 3/4 dk. yll. brn. loosely consolidated river bed - fine gravel w/ very few roots

3/28/96

410 I Structure 3

P96-56-68

Lot 01	117N	100E	0-50 cubs	sheds
Lot 02	116N	101E	0-50 cubs	sheds
Lot 03	115N	102E	0-50 cubs	sheds
Lot 04	116N	99E	0-50 cubs	sheds
Lot 05	116N	98E	0-50 cubs	sheds
Lot 06	116N	97E	0-50 cubs	sheds
Lot 07	114N	97E	0-50 cubs	sheds
Lot 08	113N	98E	0-50 cubs	sheds
Lot 09	113N	99E	0-50 cubs	sheds
Lot 10	113N	100E	0-50 cubs	sheds
Lot 11	112N	99E	0-50 cubs	sheds
Lot 12	112N	100E	0-20 cubs	sheds
Lot 13	116N	102E	0-50 cubs	sheds, baja
Lot 14	117N	101E	0-50 cubs	sheds
Lot 15	113N	97E	0-50 cubs	sheds

~~Lot 16~~

3/29/90

4/10 I STRUCTURE 3

P96-50-~~10~~ 69

Lot 16

115N 97E

0-50 cubs

sherds

Lot 17

115N 99E

0-50 cubs

sherds

Lot 18

115N 101E

0-50 cubs

sherds

Lot 19

114N 98E

0-50 cubs

sherds

Lot 20

114N 100E

0-50 cubs

sherds

Lot 21

114N 101E

0-50 cubs

sherds

Lot 22

113N 101E

0-50 cubs

sherds

Lot 23

112N 97E

0-50 cubs

sherds

Lot 24

112N 98E

0-50 cubs

sherds

Lot 25

114N 99E

0-50 cubs

sherds

Lot 26

115N 98E

0-50 cubs

sherds

Lot 27

115N 100E

0-50 cubs

sherds

Lot 28

117N 102E

0-50 cubs

sherds

Lot 29

112N 100E

20-50 cubs

sherds

4/3/96

410 I

Structure 3

P96-56-70

Structure 3 consists of two lines of stone running NE to SW in direction. These concentrations are 40 cm wide and roughly .80 - 1.20 m wide. about $\frac{1}{4}$ of the stones are .20 m in size, another $\frac{1}{4}$ are between .10 - .20 m in size, and the rest are all smaller than .10 m.

Originally the structure was found in the northern transect of test pits run off of 410 str. 1. The second test pit (see drawing P96-56-) revealed medium to large rocks in a linear formation. Time and manpower opened up a 36 sq m area in two days to reveal what appears to be a poorly preserved Man made structure/platform.

The northern column appears to be in better shape with more linear alignments. Most of the larger stones are dispersed with pockets of medium sized stones clumped together in between them, all of which is packed by small stones which provide the uniformity - both in the columnar & linear arrangement as well as in the distinction of the two rows from each other and from the empty soil surrounding them.

4.16.96

STR. 190 LA SIERRA

P96-56-71

46 M - EAST/WEST AXIAL over large STR.

Lot 01 200N 208E

0-20 cubs sherds, baja

Lot 02 200N 192E

0-20 cubs sherds, obs

46 N - North/South axial

Lot 01 212N 200E

0-20 cubs sherds

4/17/96

46 M - EAST/WEST axial

Lot 03

200N 208E

20-40 cubs

sherds, baja, bone

Lot 04

200N

193E

0-30 cubs

sherds

Lot 05

200N

207E

0-20 cubs

sherds, baja, obs

Lot 06

200N

194E

0-20 cubs

sherds

Lot 07

200N

195E

0-10 cubs

empty lot

Lot 08

200N

206E

0-10 cubs

sherds, baja, obs

Lot 09

200N

205E

0-10 cubs

empty lot

3/18/96

Lot 10

200N

209E

0-20 cubs

sherds, baja

Lot 11

200N

191E

0-20 cubs

sherds, baja

Lot 12

200N

209E

20-40 cubs

obs, sherds, bone, shell

Lot 13

200N

209E

40-60 cubs

sherds, shell

46M

4.18.96

P96-56-72

Lot 14 200N 192E 10-20 cubs Shards, ~~baia~~, ~~axe~~
clearing tumble

Lot 15 200N 191E 20-40 cubs shards, baia, axe
4.19.96

Lot 16 200N 193E 30-50 cubs shards
2 bad frags w/ mayan face w/ torch

Lot 17 200N 206E 10-50 cubs shards, baia

Lot 18 200N 194E 20-40 cubs shards, baia

Lot 19 ~~200N~~ 207E 20-30 cubs shards, baia

Lot 20 200N ~~206~~ 205E ~~10~~ -40 cubs shards, baia.
4/22/96

Lot 21 200N 202E 0-20 cubs sherd

Lot 22 200N 198E 0-20 cubs sherd

Lot 23 200N 205E 10-40 cubs sherd

clearing more tumble
Lot 24 200N 204E 0-30 cubs shards

Lot 25 200N 197E 0-20 cubs empty lot

Lot 26 200N 196E 0-20 cubs baia.

4.23.96
Lot 27 200N 203E 0-40 cubs shards, baia, obs.

Lot 28 200N 206E 50-60 cubs shards, baia.

Lot 29 200N 207E 30-40 cubs shards, baia.

46m

4.24.96

P96-56-73

Lot 30 200N 201E 0-40 cubs baja

Lot 31 200N 204E 30-50 cubs empty lot

Lot 32 200N ~~202~~ 203E 40-50 cubs sherds, baja, chat

4.25.96

Lot 33 200N 199E 0-30 cubs sherds, baja, cone

Lot 34 200N 197E 20-30 cubs empty lot

Lot 35 200N 198E 20-30 cubs empty lot

Lot 36 200N 196E 20-50 cubs sherd, baja

4.26.96

Lot 37 200N 196E 50-90 cubs sherds, baja

Lot 38 200N 197E 30-60 cubs sherds, baja, other ind. weed

Lot 39 200N 192E 20-50 cubs sherds, baja

Lot 40 200N 193E 50-60 cubs empty lot

Lot 41 200N 196E 90-110 cubs empty lot

4.29.96	46M	P96-56-74			
Lot 42	200N	193E	60-80	cubs	sherds
Lot 43	200N	198E	30-60	cubs	sherds, baja
Lot 44	200N	199E	30-50	cubs	sherds, baja
Lot 45	200N	194E	40-70	cubs	baja
Lot 46	200N	197E	60-110	cubs	sherds, baja
4.30.96 Lot 47	200N	195E	10-90	cubs	sherd, baja
Lot 48	200N	198E	50-80	cubs	empty lot
Lot 49	200N	198E	60-110	cubs	sherds, baja
Lot 50	200N	193E	80-90	cubs	sherds, baja
Lot 51 51	200N	192E	50-55	cubs	sherds
5/2/96 pulling tumble					
Lot 52	200N	201E	40-80	cubs	sherd, baja
Lot 53	200N	202E	20-60	cubs	sherds, baja
Lot 54	200N	203E	50-100	cubs	baja
5/3/96 Lot 55	200N	203E	100-120	cubs	sherds, baja
Lot 56	200N	202E	60-100	cubs	sherd, baja

5.3.96

46m

P96-56-75

Lot 57 200N 199E 80-110 cubs sherds, baja

Lot 58 200N 198E 50-70 cubs sherds

cleaning tumbler

Lot 59 200N 196E 110-120 cubs empty lot

5/7/96

Lot 60 200N 196E 120-140 cubs sherd, baja

soil change - dk. yll. brown to black(ish)

Lot 61 200N 198E 70-100 cubs sherds, baja, C.S.

Lot 62 200N 199E 110-130 cubs empty lot

5-8-96

Lot 63 200N ~~207E~~ 40-60 cubs sherds, baja

Lot 64 200N 206E 60-80 cubs sherds, baja

4.17.96

46 N Str. 190

PG 6-86-76

Lot 02 212 N 200 E 20-50 cubs sherds, obs.

Lot 03 211 N 200 E 0-20 cubs sherds, obs.

Lot 04 211 N 200 E 20-50 cubs sherds, baja

Lot 05 210 N 200 E 0-20 cubs sherds

3/18/96

Lot 06 209 N 200 E 0-10 cubs sherds

Lot 07 208 N 200 E 0-20 cubs sherds

Lot 08 207 N 200 E 0-20 cubs sherds

Lot 09 211 N 200 E 20-50 cubs sherds

Removing tumbler

4/19/96 Lot 10 211 N 200 E 20-50 cubs sherds

Removing tumbler

Lot 11 210 N 200 E 20-50 cubs sherds

Lot 12 209 N 200 E 10-50 cubs sherds, baja

4/22/96

Lot 13 190 N 200 E 0-20 cubs sherds, baja, shell, bone, obs
screened through 1/4" mesh

Lot 14 208 N 200 E 20-50 cubs sherds, chert

Lot 15 212 N 200 E 50-60 cubs sherds, shell, obs

Lot 16 190 N 200 E 20-40 cubs sherds, shell, bone, chert
screened through 1/4" mesh

Lot 17 190 N 200 E 40-60 cubs sherds, shell
screened through 1/4" mesh

46N

4.22.96

P96-56-77

Lot 18

191N

200E

0-10 cubs

sherds

Lot 19

212N

200E

60-80 cubs

sherds, obs.

Lot 20

207N

200E

20-60 cubs

sherds, shell, baja.

Northern half

423.96

Lot 21

207N

200E

20-50 cubs

sherds, baja.

Southern half

Lot 22

~~207~~ 191N

200E

10-40 cubs

sherds, obs, shell

Lot 23

192N

200E

0-20 cubs

sherds, baja

Lot 24

205N

200E

0-20 cubs

sherds, obs.

Lot 25

206N

200E

0-50 cubs

sherds, obs, baja, w/Carbon

obs blade @ 20 cubs

L @ 40 cubs

Lot 26

192N

200E

20-40 cubs

sherds, baja, obs

424.96

Lot 27

205N

200E

20-50 cubs

sherds, baja

Lot 28

204N

200E

0-50 cubs

sherds

Lot 29

195N

200E

0-5 cubs

sherds

Lot 30

194N

200E

0-10 cubs

empty lot

Lot 31

203N

200E

0-30 cubs

empty lot

Lot 32

192N

200E

40-60 cubs

sherds, baja

Lot 33

191N

200E

40-60 cubs

sherds, chert

46N	4.24.96	P96-56-78	
Lot 34	192N 200E	60-70 cubs	sherds
4.25.96			
Lot 35	211N 200E	50-80 cubs	sherds, baja, ds.
Lot 36	193N 200E	0-20 cubs	empty lot
Lot 37	193N 200E	20-80 cubs	sherds, baja
Lot 38	194N 200E	10-50 cubs	empty lot
Lot 39	210N 200E	50-70 cubs	sherds
Lot 40	208N 200E	50-110 cubs	sherds, baja
4.26.96			
Lot 41	207N 200E	50-110 cubs	sherds, baja
Lot 42	195N 200E	5-80 cubs	empty lot
Lot 43	211N 200E	50-90 cubs	sherd
Lot 44	193N 200E	80-100 cubs	sherd, ds
Lot 45	194N 200E	50-100 cubs	empty lot
4.29.96			
Lot 46	210N 200E	70-110 cubs	sherds
Lot 47	209N 200E	50-90 cubs	sherd
Lot 48	209N 200E	90-110 cubs	sherds, baja
4.30.96			
Lot 49	202N 200E	0-60 cubs	sherds, baja
Lot 50	203N 200E	30-70 cubs	empty lot
Lot 51	201N 200E	0-30 cubs	empty lot

5.296

46N

P96-56-79

Lot
52

205N

200E

50-70 cubs shard, baja

Lot 53

206N

200E

50-60 cubs empty lot

Lot 54

207N

200E

110m

cubs

2 bags of soil samples and 3 carbon samples
- all are individually labelled - no artifacts

D96-56-14

the feature consists of a possible hearth along with individual instances of scattered carbon - all of which occur at the same level and are contained between two walls in meter 200E at 207N to 208N - Root burn has not yet been ruled out - most of the occurrences are small in size and tightly packed/clumped together, however trowel probes show flecks of carbon in areas away from the high density area - which may indicate that the hearth was scooped out and reused. The area surrounding the hearth has signs of fire alterations - beneath the carbon is a (dark, hard) orange-red soil (like bajareque), beneath that soil is a lighter yellowish-brown soil - also fire altered but not as "cooked" as the primary soil.

The largest concentration of carbon had several stones ringed around it - hence the "hearth" - this was bisected with a carbon sample taken and two soil samples as well - taken from the eastern half - the western half remains intact pending further analysis. Another possibility is that it's not a hearth but disintegrated baja with the burnt sticks still intact - it would also explain the color & texture similarities to baja as well as the reason for the circular look of the carbon stains - the rock "ring" may just be a fluke - baja w/ intact carbon has been found on this mound.

5.3.96

46N

P96-36-80

Lot 55	200 N	200 E	0 - 70 cubs	sherds, baja
small spherical one found rock - 3 cm in diameter				
Lot 56	199 N	200 E	0 - 30 cubs	empty lot
Lot 57	198 N	200 E	0 - 50 cubs	sherds, baja
Lot 58	197 N	200 E	0 - 30 cubs	sherds
Lot 59	196 N	200 E	0 - 60 cubs	sherds
5/7/96				
Lot 60	199 N	200 E	30 - 40 cubs	empty lot
Lot 61	200 N	200 E	70 - 120 cubs	sherd, baja

5.3.96 460 Lateral Clearing P96-56-81

Lot 01 207N 201E 0-70 cubs sherds, baja
one large cylindrical stone

5.7.96

Lot 02 207N 201E 70-90 cubs baja, carbon (3) soil samples (2)
① in SWC @ 70 cubs one carbon sample - no discolored

earth or burnt rocks - against North side of wall - one large discreet chunk in the tumble - may indicate root burn

② in NWC @ 70 cubs one carbon sample - again no burnt earth or rocks - fairly discreet among all of the other rocks. - very similar to #1

③ in SEC @ 75 cubs one carbon sample : one soil sample taken - carbon was concentrated mainly in one area with burnt earth around it and a few burnt stones - many fairly large flecks of carbon were scattered around the area - carbon is on the north side of the wall (like #1) and appears to be intumble. Again - it could be tumble, but the burnt earth and stones seemed to require a soil sample

④ flecks of carbon and some discolored earth keep showing up in the meter - however, these appearances are spotty - one more soil sample will be taken over the whole meter (taken @ 90 cubs - carbon, soil, probably some before reque.

5/8/96

Lot 03 205N 201E 0-70 cubs sherds, baja

Lot 04 206N 201E 0-20 cubs sherds, baja

Lot 05 207N 199E 0-30 cubs empty lot
border left to the east for profile drawing

5.10.96

460

P96-56-82

Lot 06	205N	198E	0-20	Cubs	empty lot
Lot 07	205N	196E	0-20	cubs	bajareque
Lot 08	204N	197E	0-20	cubs	sherds, baja
Lot 09	203N	196E	0-20	cubs	sherds, baja
Lot 10	205N	197E	0-10	cubs	sherd, baja
Lot 11	204N	198E	0-10	cubs	sherd, bone
Lot 12	204N	196E	0-10	cubs	empty lot
Lot 13	203N	197E	0-10	cubs	sherd baja.
Lot 14	^{206N} 205N	201E	20-60	cubs	sherds, baja
cleaning up back of wall - fill					
Lot 15	205N	201E	@ 60	cubs	carbon filled soil sample
from the NEC - fire altered earth - large but somewhat cylindrical carbon stain (root burn?); rock w/ carbon stains - may have been blown					
Lot 16	205N	196 [±] 197E	10-40	cubs	baja
Lot 17	204N	196 [±] 197E	10-40	cubs	sherds, baja
Lot 18	203N	196 [±] 197E	10-40	cubs	sherds
Lot 19	205N [±] 204N	198E	10-30	cubs	sherds, baja
Lot 20	204N	¹⁹⁹ 198 E	0-10	cubs	empty lot

5.10.96

46 0

P96-56-83

Lot 21	205N	199E	0-10 cubs	empty lot
5.13.96				
Lot 22	204 N	201 E	0-80 cubs	baja, sherd
Lot 23	205 N	202 E	0-10 cubs	sherd, baja
Lot 24	205 N	203 E	0-40 cubs	empty lot
Lot 25	204 N	203 E	0-10 cubs	sherd, baja
Lot 26	207 N	201 E	70-110 cubs	sherd, baja
Lot 27	207 N	200 E	110- 120 135 cubs	empty lot
Lot 28	208 N	200 E	110-120 cubs	empty lot
Lot 29	204 N	200 E	50-80 cubs	empty lot
Lot 30	200 N	201 E 201 E	40-100 cubs	empty lot
Lot 31	199 N	201 E	0-70 cubs	sherds, baja, obs
Lot 32	195 N	201 E	0-30 cubs	sherds
Lot 33	195 N	202 E	0-20 cubs	sherds
5.14.96				
Lot 34	205 N	199 E	10-50 cubs	sherds
Lot 35	205-204 N	198 E	30-70 cubs	sherds, baja
Lot 36	205 N	202 E	10-60 cubs	sherds, baja

5.14.96

460

T96-56-84

Lot 37	202 N	201 E	0 - 70 cubs	sherds, bone
Lot 38	199 N	202 E	0 - 20 cubs	empty lot
Lot 39	198 N	201 E	0 - 40 cubs	empty lot
Lot 40	198 N	202 E	0 - 40 cubs	sherds
Lot 41	197 N	201 E	0 - 5 cubs	empty lot
Lot 42	197 N	202 E	0 - 10 cubs	empty lot
Lot 43	196 N	202 E	0 - 40 cubs	sherds, obs, bays
Lot 44	195 N	202 E	20 - 40 cubs	empty lot
Lot 45	195 N	203 E	0 - 40 cubs	empty lot
WEST 1/2 Lot 46	196 N	203 E	0 - 60 cubs	empty lot
WEST 1/2 Lot 47	197 N	203 E	0 - 40 cubs	empty lot
WEST 1/2 5.15.96 Lot 48	198 N	201 - 202 E	40 - 60 cubs	sherds, bays

Lot 49 200.8 N - 202.5 N 200 E - 201.3 E 40 - 120 empty lot

clearing tumble away from walls

Lot 50 200.8 N - 202.5 N 200 E - 201.3 E 120 - 140 sherds
 oja found between walls 1 soil sample taken coral
 from above and one bag of artifacts. 1 bag for the
 oja; 1 more soil sample for soil beneath the oja, and
 one more bag of artifacts for associated artifacts that
 that cannot be placed directly to the oja

5.17.96

460

P96-56-85

The olla found in situ has been drawn in section, overview, photographed in B/W? Color Slide and videotaped and plan point shot. Large tumble rested above the olla in fill, however at about the level at which the soil changes on the surrounding walls - the fill also changes to much smaller stones similar to those used in building the lower sections of the wall and a greater quantity of dirt (less - much less - stones). The top 3-5 cm above the olla was collected in a soil sample as well as a bag of associated artifacts (#1). Later a second bag of artifacts (#2) was collected - the soil was screened through 1/4" mesh, but a soil sample was not taken. After the olla was drawn (1:10 $\frac{3}{4}$ overview) it was removed and placed in another bag (#3) and a second soil sample (#2) was collected (from the area directly beneath and around the olla to the change in soil - possibly the original living surface (@ 2-5 cm $\frac{3}{4}$ below the oja). A third sample (#3) was taken from ~~under~~ the entire area below the olla & above the soil change.

After the ~~olla~~ olla was removed an animal mandible (possible deer) was placed underneath with carbon around it and fragments of either a bowl or smaller olla - the underside of the fragments were burned.

The bags of soil sampled from under the olla number 2
" from the entire area = 3

* one small bag of carbon, carbon/soil, & burned sherds was collected separately

* one bag of bone was collected.

All depths & widths, etc... are in profile P96-56-86

East side of str.: 3 terraces leading up to a large (and earlier basal wall) - the terraces consist mainly of large stones and gradually rise towards the west - no cut block none of them are faced very well. The eastern basal wall is fairly well faced on the interior (west) side - ~~a~~ The central/medial wall runs nearly the entire length of the structure - an alternate entrance to the structure may have been present on the north (the north is the east have the most extensive walls/terraces.) This medial wall appears to have been added on to - the bottom 40-50 cm of the wall ~~a~~ consists of tightly packed chinking stones and the main stones are smaller - the main stones and the chinking stones are all basically of the same material - a very smooth blue-grey stone (similar to the material used for small hachas) the fill at this level also consisted of these same stones. The following meter of construction is not nearly as solid - the stones vary in type and size and the chinking stones are not as well placed. The fill is very different - prone to cracking and falling out - there seems to be more air pockets than earthen fill. Behind the two faces of the wall (it's E & W sides) very large rocks were used for fill - again little dirt seems to have been used. On the eastern side two walls abut the medial wall - the lower (original) portion may be integrated, however, the upper portion definitely abuts the more northern wall turns out to be an earlier doorway (the oja lies just east of the doorway.) The more southern wall seems to continue to the eastern basal wall, but does not seem to have as much later construction. The Western (back) side of the structures appears to have only one foundation wall. This wall, however, may have been as much as 2.1 m wide and over 1 m tall. The fill between this and the medial wall is the same as that on the eastern side (it has been associated with Early Classic fill of the Past (cf. Ed)). At the bottom of the two foundation walls and the medial walls the fill ends and a very dark clay soil appears (parent soil). Just west of the western basal wall a line (E/W) appears - it may be from an earlier structure - but 3 stones ~~are~~ make it hard to know for sure.

- heading South

PG 6-56-87

In the north - the first wall appears to have been fairly large at one point - all that was left intact was the bottom course. Like the eastern terraces. The first two northern walls used very large stones in their construction. The fill between and in front of these two walls seems to be different from the two walls to the South of them. Between these more southern walls the fill appears to be the same as that between the medial wall and the walls to its East & West. The third wall is faced on both sides - the northern faces used larger ~~stones~~ in its entirety, but was later covered by another basal wall. The southern face however uses smaller rocks and more chunky stones in its last 50 cm. A 4th northern wall contains very similar architecture to those in the E/W trench around the medial wall. A possible hearth was found between the 3rd & 4th northern walls. Again the fill appears to be different in color as well as in stone type (same stones used as around the medial wall). The area between the 3rd & 4th wall may have been an earlier living space contemporary with those on either side ^{at the base of} the medial wall. The medial wall appears to either abut or integrate with this 4th wall (The northern face of the 4th wall exactly matches those around the medial wall whereas the southern face of the 3rd wall is similar in construction but uses very different stones - the area between may have been an open area living space that was later walled in. The area at the top of & south of the 4th wall served as another living space & may have had a stone laid floor. There is a front step, "door jam", threshold. The medial wall is cut by the "door jam" which runs ~~through~~ ^{width} through its entire ~~length~~ and extends 40 cm beyond to the east (ending in line with the front step. The medial wall continues through with flat stones raised 10-15 cm above the front step and @ 100 cm behind (to the west.) In the east west trench the fill b/w the medial wall consists of huge stones - the "threshold" however, has very small, well placed stones between the front of the medial wall and its back creating a foyer. Unfortunately the final phase architecture is too poorly preserved to tell where this all led to.

South side - North to south:

PG 56-88

The medial wall continues - both the front & back appear in the trench. To the east of the medial wall: integrating with the E/W wall that abuts the medial wall in the E/W trench a line of well placed stones appeared @ 10 cm below the remains of the medial wall (drawn in sec.) heading to the south - it may be a mirror image of the "step, dargam, threshold" to the north. Further to the south it remains unclear whether two or more basal walls/terraces existed. Looking at the profile there may have been a low terrace, a 1m thick wall ~~up~~ against a second meterish wall, up against a final wall that abutted/integrated with the medial wall. There are, however, at least two walls to the south. The more northerly one abuts/integrates with the medial wall; the thicker, ^{more} southern wall is the retaining/foundation wall. The more southern wall consists of very large stones at its base and uses large stones throughout. The more northern wall is smaller and better looking in general. Again, the summit/final phase architecture is not well preserved.

FINAL NOTES

5.16.96

P96-56-89

using
plaid points

NAME	HEIGHT	Width	# of Courses DEEP	# of Courses WIDE	TYPE of STONE CH, CB, RC, A	Size of Stone S, M, L, XL
1,2	.3m	1.0m	2-3	3-4	RC	L, M, S, XL
3,4	.6m	.5m	4	2	RC, CH	L, M, S, XL
5,6	.6m	1.0m	3-4	3	RC, CH	L, M, S, XL
7-10	.8-1.0m	1.0m	6	3	RC, CH	L, M, S, XL
11,12	.6-1.0m	.5m (?)	6	2 (?)	RC, CH	L, M, S, XL
13,14	.1m (?)	.2m	1 (?)	1	RC	M
15-18	1.5m	1.3m	9-11	3 4-5	RC, CH	L, M, S, XL
19-22	1.3m	1.2 or 2.1m (?)	11-13	4 or more	RC, CH	L, M, S, XL
23,24	.25-.5m	(?)	2-5	(?)	RC, CH	M, S, L
25,26	.3-.6m	.6m	2 (4-5)	2	RC, CH, CB	L, M, S, XL
27,28	.35-.70m	.4m	2-(3,4)	1	RC	XL, L, M
29-32	.5-1.0m	.55m	11	2	RC, CH, CB	L, M, S, XL
33		HEARTH (POSSIBLY)				
34,35	.9-1.25m	.4-.55m	12 (6 of CH)	2-3	RC, CH	M, S, L
36,37	.3 m	.35m	2	1	RC, CH	M, S, L
38,39	.1m	.3m	1 (?)	1	RC, CH	L, S
40,41	.3m	.2-.35m	3 (plus)	1-2	RC, CH	M, S, L
42-47	.3-.7m	.4-.65m	4	2-3	RC, CH	L, M, S, XL
(16,48) 48	1.10-1.60 on the S	.9-1.5m	3 (plus)	5 or more	RC, CH	M, L, S, XL
49,50	.4-.8m	.45-.65m	3-7	2-3	RC, CH ^{CB} _{2 CH}	M, S, L L, M, S, XL
51,52		BACK SIDE of	15-18			
53,54	.8m	.8m	4	2-3	RC, CH	L, M, S, XL
55		oja				

E/W TRENCH		FINAL NAME	NOTE	STR. 190	5.16.96	ORIENTATION	P96-56-90
			Top	Bottom			A-ADULT I-INTEGRATE O-OVER RUN(S)
		1,2				°10 E/N	/
		3,4				°14	/
		5,6				°16	/
		7-10				°0	/
		11,12				°108	A- 7-10 to the south east 15,16 to the south west
		13,14				°108	A- 11,12 to the North parallel to 15,16
		15-18 15,16				°8	A- by 11,12 & 16 on the East side O/I w 49,50 in the south
		19-22				°8	/
		23-24				°125	/
		25,26				°115	/
		27,28				°100	/
		29-32				°98	/
		33				/	between 29-32 & 34,35
		34,35				°100	A/I w/ 36,37 and continuation of 15,16 (38-41)
		36,37				°2	A/I w/ 34,35 & w/ 42-47
		38,39				°2	O- 42-47
		40,41				°2	O- 42-47
		42-47				°101	O's- 36-41, A- continuation of 15-16
		48				°101	A- 15,16
		49,50				°104	A/O 15,16 & 51,52
		51,52				°8	A/O 49,50
		53,54				°108	/
		55				/	OJA BETWEEN 11,12 & 15,16 - no point

N/S TRENCH

PHOTOGRAPHIC RECORD					
P-H ASSOCIATES, INC.			SALT LAKE CITY, UTAH		
PROJECT: PVN-96-56-			FILM LOADED BY: PAGE 1		
FILM TYPE:		FILM SIZE:		ASA: NO. OF EXPOSURES:	
PERMANENT ROLL NO.:			TEMPORARY ROLL NO.:		
DATE	SITE NO.	NEG	EXP	DESCRIPTION	PHOTOGRAPHER
5.17.96	LA Sierra str. 190 46 M, N, O		1	<p>ALL # in Description refers to plan point numbers</p> <p>WEST profile of medial wall with both to wall abutting (points 15, 16)</p> <p>TPN. Trowel points North Photoboard <input checked="" type="checkbox"/> Yes <input type="checkbox"/> No</p>	#30
"	"			<p>North profile of point 16 door</p> <p>note differences in soil color</p> <p>TPN Photoboard <input checked="" type="checkbox"/> Yes <input type="checkbox"/> No</p>	"
				<p>VIEW of EASTERN TERRACES facing WEST</p> <p>TPN Photoboard <input checked="" type="checkbox"/> Yes <input type="checkbox"/> No</p>	
				<p>VIEW of step, threshold, doorway</p> <p>TPN Photoboard <input checked="" type="checkbox"/> Yes <input type="checkbox"/> No</p>	
				<p>" "</p> <p>TPN Photoboard <input checked="" type="checkbox"/> Yes <input type="checkbox"/> No</p>	
				<p>VIEW of medial wall - continuation running south and line in front of it (points 12, 13)</p> <p>TPN Photoboard <input checked="" type="checkbox"/> Yes <input type="checkbox"/> No</p>	
				<p>VIEW of SOUTHERN BASAL wall w/ 2nd basal wall and abutting medial wall in the background</p> <p>TPN Photoboard <input checked="" type="checkbox"/> Yes <input type="checkbox"/> No</p>	
				<p>VIEW of WEST profile of southern basal wall(s). Are there more than one? Or is it one huge (thick) wall?</p> <p>TPN Photoboard <input type="checkbox"/> Yes <input checked="" type="checkbox"/> No</p>	
				<p>VIEW of WEST SIDE (BACK of) MEDIAL WALL (drawn in section) facing EAST</p> <p>TPN Photoboard <input checked="" type="checkbox"/> Yes <input type="checkbox"/> No</p>	
				<p>VIEW of points 23, 24 with the edge of points 21, 22 in the left side. Possible early wall of different building</p> <p>TPN Photoboard <input checked="" type="checkbox"/> Yes <input type="checkbox"/> No</p>	
				<p>VIEW of step, doorway, threshold floor facing south (medial wall = threshold, floor, back line (right))</p> <p>TPN Photoboard <input checked="" type="checkbox"/> Yes <input type="checkbox"/> No</p>	
				<p>VIEW of possible hearth (33) with basal wall (34, 35) in background</p> <p>TPN Photoboard <input checked="" type="checkbox"/> Yes <input type="checkbox"/> No</p>	

PHOTOGRAPHIC RECORD

P-III ASSOCIATES, INC.

SALT LAKE CITY, UTAH

PROJECT: PN-96-56

FILM LOADED BY: PAGE 2

FILM TYPE:

FILM SIZE:

ASA:

NO. OF EXPOSURES:

PERMANENT ROLL NO.:

TEMPORARY ROLL NO.:

DATE	SITE NO.	NEG	EXP	DESCRIPTION	PHOTO-GRAPHER
5.17.96	LASIERRA STR. 190 46M, N, O			<p>ALL #'s in description refer to plan point numbers</p> <p>VIEW of the 3 Northern basal walls with the foundation wall (34,35) in background facing South Photoboard <input checked="" type="checkbox"/> Yes <input type="checkbox"/> No</p>	56#
				<p>VIEW of oja with E/W wall (11,12) in back ground. facing South (meter stick - 2 sec = 42 cm.) TPN Photoboard <input type="checkbox"/> Yes <input checked="" type="checkbox"/> No</p>	
				<p>VIEW of oja with medial wall in background (14-16) facing WEST TPN Photoboard <input type="checkbox"/> Yes <input checked="" type="checkbox"/> No</p>	
				<p>VIEW of oja with with doorway in background (16) facing North TPN Photoboard <input type="checkbox"/> Yes <input checked="" type="checkbox"/> No</p>	
				<p>OVERVIEW of oja wall (11,12) to right of photo TPN Photoboard <input type="checkbox"/> Yes <input checked="" type="checkbox"/> No</p>	
				<p>CLOSE-UP 4 " TPN Photoboard <input type="checkbox"/> Yes <input checked="" type="checkbox"/> No</p>	
				<p>STR. overview facing North Photoboard <input type="checkbox"/> Yes <input checked="" type="checkbox"/> No</p>	
				<p>" " facing South Photoboard <input type="checkbox"/> Yes <input checked="" type="checkbox"/> No</p>	
				<p>" " facing West Photoboard <input type="checkbox"/> Yes <input checked="" type="checkbox"/> No</p>	
				<p>" " facing East Photoboard <input type="checkbox"/> Yes <input checked="" type="checkbox"/> No</p>	
				<p>Photoboard <input type="checkbox"/> Yes <input type="checkbox"/> No</p>	
				<p>Photoboard <input type="checkbox"/> Yes <input type="checkbox"/> No</p>	

PHOTOGRAPHIC RECORD

PHOTOGRAPHIC RECORD

PHOTOGRAPHIC RECORD

PROJECT: PVN 96 #50 FILM LOADED BY: #50
 FILM TYPE: 400/ColorSlide FILM SIZE: ASA: NO. OF EXPOSURES:
 PERMANENT ROLL NO.: PERSONAL TEMPORARY ROLL NO.:

DATE	SITE NO.	NEG	EXP	DESCRIPTION	PHOTO-GRAPHER
1 6.11.96	104 H			F.3 multiple levels of bajareque floor (differences in color) TRAVEL POINTS North Photoboard <input checked="" type="checkbox"/> Yes ___ No	
2 "	"			Close up of floor ? profile in adjacent unit facing WEST Photoboard ___ Yes <input checked="" type="checkbox"/> No	
3 1	"			Overview of F.3 facing North TPN Photoboard <input checked="" type="checkbox"/> Yes ___ No	
4 F	"			Overview facing South ^{EAST} with Elements of all 3 features Photoboard <input checked="" type="checkbox"/> Yes ___ No	
	one shot			↓ F1 = large stones F2 = Earthen level with paint brush F3 = Earthen Photoboard ___ Yes ___ No	
				level below F.2 & multicolored area Photoboard ___ Yes ___ No	
5 "	"			F.1-3 overview facing south Photoboard ___ Yes <input checked="" type="checkbox"/> No	
6-10 "	"			general site photos Photoboard ___ Yes <input checked="" type="checkbox"/> No	
				Photoboard ___ Yes ___ No	
				Photoboard ___ Yes ___ No	
				Photoboard ___ Yes ___ No	
				Photoboard ___ Yes ___ No	
				Photoboard ___ Yes ___ No	

46 m, n, o
meter

N/S

P-16-56-
cubs

1		34	
2	I	38	II
3		43	
4			
5			
6			
7		I	
8			
9			
10			
11			
12	I	48	II
13		39	
14		50	
15		50	
16		28	
17		34	
18	I	30	II
19		70	
20		65	
21		60	
22		40	
23		36	

gray area

85-95

136 III

65 III

0-4 I " II "

4-11 I "

17-19 I " II " III same as E/W 9-5 II soil

46 MNO

Soils:

METER
(EAST/WEST)

19

36

Cubs

18

20

17

16

38

15

14

13

37

73

12

47

11

57

103

10

40

80

142

9

45

81-112
(gray area)

140

8

69

100

7

50

94

136

6

25

5

41

4

48

3

2

1

Soils:

1-5 I - 10 y₂ 3/2 v y dk gry ben very coarse, large peds, siltII - 10 y₂ 5/4 yll ben coarse, smaller peds, clayey silt

9-5 I " II " III same as II

IV 10 y₂ 7/4 lgt gray (possibly clay class fill) fine silt, few pedsV 10 y₂ 3/3 dk ben silty clay13-10 I " II " ~~III~~

III = to 9-5 II

IV 10 y₂ 4/4 dk yll ben clayey silt

12 19 I "

II 10 y₂ 4/3 ben/dk ben clayey silt

- 1 SMOKED SALMON
- 2 GRILLED SWORDFISH
- 3 CHOCOLATE DECADENCE
- 4 TARRAGON CHICKEN
- 5 PINA COLADA MOUSSE
- 6 ALMOND CHICKEN
- 7 LEMON CREAM SAUCE
- 8 CREME BRULEE
- 9 ARTICHOKE PUREE
- 10 BAKED BRIE
- 11 CHOCOLATE TERRINE
- 12 ~~BE~~ VANILLA SOUFFLE
- 13 RACK OF LAMB
- 14 SPICED BEEF
- ~~15 BEEF ROAST~~
- 15 GREEK SHRIMP
- 16 FRENCH ONION SOUP
- 17 GASPACHO
- 18 ~~WARMED~~
- 18 LEMON SORREL SALAD
- 19 CECAR SALAD
- 20 ESPRESSO TORTE
- 21 CREAM ANGELAIS
- 22 GARLIC SHALLOTS
- 23 GRILLED POTATOES
- 24 GINGERED SQUASH
- 25 RASPBERRY SORBET
- 26 SALMON NAPOLEONS
- 27 CARMELIZED ONIONS
- 28 GARLIC FETA PASTA
- 29 ROOT CELLAR SOUP
- 30 STRAWBERRY ECLAIRS

104 E

Str. 1

5/22/96

P96-36-91

104 E consists of a 4x4m test block on the summit of Str. 1. The block is orientated N/S with a center point of 200N 200E (SWC). The 16 units were surface collected with over half yielding obsidian and one a sherd. The whole mound is awash in obsidian ~~and~~ with other types of chert occasionally mixed in. While an earthen mound is expected, there seems to be a fair amount of large stones exposed on the lower reaches of the mound (particularly in the north.) An area west of the block was cleared of artifacts for back dirt to be placed. Eventually a full (100%) surface collection will be done.

Lot 01	200N 198N 201E	surf.	empty lot
Lot 02	198N 200E	surf.	empty lot
Lot 03	198N 199E	surf.	obs.
Lot 04	198N 198E	surf.	obs.
Lot 05	199N 198E	surf.	empty lot
Lot 06	200N 198E	surf.	empty lot
Lot 07	201N 198E	surf.	empty lot
Lot 08	201N 199E	surf.	empty lot
Lot 09	201N 200E	surf.	obs.
Lot 10	201N 201E	surf.	obs, sherd

	104 E	5.22.96		796-56-92
	Lot 11	200 N 201 E	surf.	obs.
	Lot 12	199 N 201 E	surf.	obs.
	Lot 13	199 N 200 E	surf.	obs.
	Lot 14	199 N 199 E	surf.	empty lot
	Lot 15	200 N 199 E	surf.	empty lot
	Lot 16	200 N 200 E	surf.	empty lot
	Lot 17	201 N 199 E	0-10 cubs	empty lot
	Lot 18	200 N 200 E	0-10 cubs	empty lot
	Lot 19	199 N 199 E	0-10 cubs	obs.
	Lot 20	198 N 200 E	0-10 cubs	obs., modern "china"
	Lot 21	SW side of block	surf.	obs.
	Lot 22	NW "	surf.	obs.
5/23/96	Lot 23	201 N 199 E	10-20 cubs	obs sherds, shell, kaja
	Lot 24	200 N 200 E	10-20 cubs	obs, sherds, kaja
	Lot 25	199 N 199 E	10-20 cubs	empty lot
	Lot 26	198 N 200 E	10-20 cubs	obs, sherds.

5-23-96

104 E

P96-86-93

Lot 27

201 N 199 E

20-40 cubs sherds, obs

Lot 28

200 N 200 E

20-40 cubs sherds, obs

Lot 29

199 ~~N~~ 199 E20-40 cubs sherds, ^(rodent) tooth, obs, chert

Lot 30

198 N 200 E

20-40 cubs sherds, baja, obs

Lot 31

NE ^(1/4) side of moundSurf. collection sherds, obs, chert, baja, ^(1/2) stone ^(1/2) pest* stone may be a fishing weight ^(1/4)

Lot 32

SE side of mound

surf. collection obs, chert

Lot 33

201 N 201 E

0-20 cubs sherd, baja, obs

Lot 34

200 N 198 E

0-20 cubs sherd

Lot 35

199 N 201 E

0-20 cubs sherds

Lot 36

198 N 198 E

0-10 cubs obs.

5-24-96

Lot 37

201 N 200 E

0-10 cubs

, cow (?)
sherds, tooth, obs,

screened 1/8"

chert

Lot 38

199 N 201 E

20-40 cubs

sherds, obs, baja

Lot 39

198 N 198 E

10-20 cubs

sherds, obs

Lot 40

198 N 199 E

0-20 cubs

baja, ceramic-modern obs.

screened 1/4"

Lot 41

198 N 198 E

20-40 cubs

sherd, obs

Lot 42

201 N 198 E

0-20 cubs

sherds, baja, obs, chert.

screened 1/4"

Lot 43

201 N 200 E

10-20 cubs

sherds, baja, obs, chert

screened 1/8"

5.24.96

104E

796-86-94

Lot 44

201N 201E

20-40 cubs

sherds, baja, obs

Lot 45

199N 198E

0-10 cubs

sherd, obs

screened $\frac{1}{4}$ "

Lot 46

198N 199E

10-20 cubs

sherds, obs, chert

5.27.96

Screened $\frac{1}{4}$ "

Lot 47

198N 201E

0-10 cubs

sherds, obs, chert,
bajascreened $\frac{1}{8}$ "

Lot 48

199N 198E

10-20 cubs

sherds, obs

screened $\frac{1}{4}$ "

Lot 49

201N 198E

20-40 cubs

sherds, obs, chert

screened $\frac{1}{4}$ "

Lot 50

198N 201E

10-30 cubs

sherds, baja, obs, chert

screened $\frac{1}{8}$ "

Lot 51

199N 198E

20-40 cubs

sherds, obs

screened $\frac{1}{4}$ "

Lot 52

198N 199E

20-40 cubs

sherds, baja, obs, chert

screened $\frac{1}{4}$ "

Lot 53

200N 199E

0-20 cubs

sherds, baja, obs, chert

screened $\frac{1}{4}$ "

Lot 54

201N 200E

20-40 cubs

sherds, obs.

supposed to be screened $\frac{1}{8}$ " but forgot to

5.28.96

Lot 55

N.W quadrant of mound surf. collection sherds, obs,
chert

Lot 56

S.W quadrant of mound surf. collection sherds, obs

Lot 57

unprovenanced chert NE quad of 4x4 between 0-40
cubs

Lot 58

198N 201E

30-40 cubs

sherds, baja, obs,
tooth (Animal)screened $\frac{1}{8}$ "

Lot 59

200N 199E

20-40 cubs

sherds, baja, obs

screened $\frac{1}{4}$ "

104 E 5.28.96

P96-56-95

Lot 60 200N 198 E 20-40 cubs sherds, baja, obs

Lot 61 200N 201 E 0-10 cubs sherds, baja, obs,
screened $\frac{1}{8}$ " tooth (animal)

Lot 62 199N 200 E 0-10 cubs sherds, baja, obs
screened $\frac{1}{8}$ "

Lot 63 200N 201 E 10-20 cubs sherds, baja, obs,
screened $\frac{1}{8}$ " chert

5.29.96 Lot 64 201N 201 E 40-60 cubs sherds, baja, obs, chert
may be plaster - layered like schist < plus a white "stone"

Lot 65 199N 200 E 10-20 cubs sherds, baja, obs,
screened $\frac{1}{8}$ " chert

Lot 66 198N 198 E 40-60 cubs baja

Lot 67 199N 200 E 20-30 cubs sherds, baja, obs,
screened $\frac{1}{8}$ " bone

Lot 68 201N 198 E 40-60 cubs sherds, baja, obs
screened $\frac{1}{4}$ "

Lot 69 199N 200 E 30-40 cubs chert, sherds, baja, obs,
screened $\frac{1}{8}$ " rodent → bone (animal)

Lot 70 201N 201 E 60-80 cubs sherds, baja
soil change at 60 cubs - dk. yll. brn to grayish - solid to 70 then breaks up in one area

Lot 71 198N 199 E 40-60 cubs sherds, baja, bone, obs
screened $\frac{1}{4}$ "

Lot 72 200N 201 E 20-30 cubs sherds, baja, obs
screened $\frac{1}{8}$ "

Lot 73 198N 200 E 40-60 cubs empty lot

Lot 74 199N 201 E 40-60 cubs baja, obs, chert

Lot 75 199N 199 E 40-50 cubs empty lot

Lot 76 200N 200 E 40-60 cubs empty lot

104E 5.30.96

P96-56-96

Lot 77 201N 200E 40-50 cubs

sherds, baja, obs.

screened $\frac{1}{8}$ "

Lot 78 Southeast quad. of mound surf. collection obs., sherds
heavy rains exposed more obs.

Lot 79 Northwest quad. " " surf. collection obs., sherd

Lot 80 Southwest quad " " surf. collection obs.

Lot 81 Northeast quad " " surf. collection obs., sherds

Lot 82 200N 200E 60-~~70~~ cubs sherds, baja, obs

Lot 83 200N 198E 40-60 cubs empty lot

WESTERN HALF

Lot 84 201N 200E 50-60 cubs sherds, baja, obs

6/31/96 screened $\frac{1}{8}$ "

Lot 85 199~~200~~N 201E 60-80 cubs sherds, obs, chert
possible floor at 80 cubs - very hard; very different

Lot 86 200N 200E 70-80 cubs sherds, baja, shell
continuation of possible floor

Lot 87 201N 200E 60-70 cubs sherd, baja, bone, obs, shell
screened $\frac{1}{8}$ " large amount of sherds, baja & obs.

Lot 88 201N 200E 70-80 cubs 2 soil samples, sherds, obs,
screened $\frac{1}{8}$ " ~~thin~~ shell, baja

Lot 89 199N 200E 40-50 cubs sherds, obs, chert
screened $\frac{1}{8}$ "

Lot 90 198N 200E 60-80 cubs baja, sherds

southern $\frac{1}{2}$

Lot 91 198N 199E 60-80 cubs baja

southern $\frac{1}{2}$ screened $\frac{1}{4}$ "

Lot 92 200N 198E 40-60 cubs obs., sherd

EASTERN $\frac{1}{2}$ - stone surface removed

Feature 1 is the name of the rock "flow" and possible remains of a late settlement on top of the mound. The majority of the "flow" is contained on the western half of the 4x4 with a small portion (mainly large stones) extending into the farthest reaches of the southeast corner. The flow is contained between 30 and 50 cubs and seems to be in two distinct layers. The upper layer resembles tumble, i.e., it is not too tightly packed and many of the stones are not lying flat. The lower level uses smaller stones and they appear to be tightly packed and rather flat. While there are no lines to follow, there is a feeling of consistency and progress towards a predetermined goal. The rock flow was drawn (D96-56-) and photographed in order to remove it to gain better access to the floor (made of hardened earth) that lies beneath it. The beginnings of the floor were found in meter 199N 201E @ 80 cubs. We are now in the process of following it out. The Northeast corner (meter 201N 201E) experienced a color change in soil at that level - from dark yll. brown to a grayish "ashy" soil - at @ 76 cubs in meter 201N 200E a similar change in color was found - however, while the soil was very fine it was also very gravelly (very fine gravel). ~~Two~~ Two soil samples were taken - both from the same level and area (meter 201N 200E) one was the dk. yll. brn. the other was the grayish, gravelly soil. The grayish soil - at least in meter 201N 200E, seems to be a part of rodent disturbance.

104E 5.31.96

P96-98-98

Lot 93 201N 201E 80-90 cubs

sherd

Lot 94 200N 198E 60-70 cubs

sherds, baja

Lot 95 199N 200E 50-60 cubs
screened $\frac{1}{8}$ "

sherds, obs

Lot 96 198N 198E 60-80 cubs

empty lot

southern $\frac{1}{3}$ - leaving stones in place, but excavating down
to possible floor.

6.3.96

Lot 97 198N 199E 40-80 cubs
northern half screened $\frac{1}{4}$ "

sherds, baja, obs

removing F.1 stones

Lot 98 200N 201E 30-40 cubs
screened $\frac{1}{8}$ "

sherds, obs

Lot 99 201N 198E 60-70 cubs

sherds, baja, obs, chert,

~~was~~ eastern $\frac{1}{2}$ needed F.1 stones removed

bone

Screened $\frac{1}{4}$ "

6.3.96	104 H		P96-86-99
Lot 01	200N 198E	60-70 cubs	sherds, baja, obs, chert
Lot 02	198N 198E	40-80 cubs	sherds, baja
Northern 1/2	; removing F. 1		
Lot 03	200N 201E	40-50 cubs	sherds, baja, obs
	screened 1/8"		
Lot 04	201N 199E	40-60 cubs	sherds, baja, obs
	removing F. 1		
Lot 05	199N 199E	50-60 cubs	empty lot
	removing F. 1		
Lot 06	200N 201E	50-60 cubs	sherds, baja, obs
	screened 1/8"		
Lot 07	199N 199E	60-70 cubs	sherds, baja, obs
6.4.96			
Lot 08	200N / 201E	60-80 cubs	sherds, baja, obs.
	screened 1/8"		
Lot 09	199N 199E	70-80 cubs	sherds, baja, shell, obs, chert
Lot 10 10	201N 199E	60-80 cubs	sherds, baja, obs, chert
mostly rodent bone although one piece looks worked, shell, bone			
that piece, however, does not look like rodent bone			
Lot 11	199N 200E	60-70 cubs	sherds, obs.
	screened 1/8"		
Lot 12	199N 198E	40-60 cubs	sherds, obs.
	screened 1/4"		
Lot 13	200N 199E	40-60 cubs	sherds, obs.
	screened 1/4"		
Lot 14	199N 200E	70-80 cubs	chert, sherds, baja, obs.
	screened 1/8"		
Lot 15	199N 198E	60-70 cubs	sherds, baja, obs, chert, bone
	screened 1/4"		
Lot 16	200N 199E	60-70 cubs	sherds, baja, shell, obs, chert
	screened 1/4"		

104 H 6/6/96

P96-56-100

Lot 17 201N 198E 70-80 cubs sherds, baja, obs, chert
screened $\frac{1}{4}$ "

Lot 18 200N 199E 70-80 cubs sherds, shell, baja,
obs, chert
screened $\frac{1}{4}$ "

Lot 19 199N 198E 70-80 cubs sherds, baja, obs, chert
screened $\frac{1}{4}$ "

* Lot 20 199N 200E < 80-95 cubs sherds, baja, obs,
screened $\frac{1}{8}$ " 100-115 cubd shell

Lot 20 represents the first unit excavated in terms of datum 1. Because control was being lost over the true depths of the units all units whose excavations will continue will be "zeroed" out at 115cm below datum.

Up to this point the SWC was used to measure depth, however, all 4 corners of the unit will be measured to 115 cubd. This depth was taken from my deepest corner in the entire 4x4 (at the time it was the NEC of 201N, 201E).

Lot 21 201N 201E < 90-94 cubs empty lot
111-115 cubd

Lot 22 201N 200E 80-96 cubs (89-115 cubd) sherds, obs.
supposed to be screened $\frac{1}{8}$ " → screened $\frac{1}{4}$ "

Lot 23 198N 199E 80-97 cubs (98-115 cubd) sherds, obs.
screened $\frac{1}{4}$ " small amount of very loose, but very red, soil -
possibly fire altered - could be disintegrated bajareque - somewhere
between a 5YR 3/4 (dark reddish brown) or a 7.5YR 4/4 (brown/
dark brown) - a fleck of carbon was noted in the area, but
further trowelling turned up nothing else

104 H 6.6.96 P96-56-101

Lot 24 198 N 198 E 80-95 cubs (100-115 cubd) sherds, obs

Lot 25 200 N 200 E 80-99 cubs (96-115 cubd) sherds, baja, shell,
bone (animal), obs., chert

Lot 26 200 N 199 E 80-90 cubs (85-115 cubd) sherds, baja, shell,
screened $\frac{1}{4}$ " bone (animal), obs., chert

Lot 27 201 N 198 E 80-95 cubs (100-115 cubd) sherds, baja, chert,
screened $\frac{1}{4}$ " obs.

Lot 28 200 N 198 E 70-80 cubs sherds, baja, obs, chert
6.7.98

Lot 29 201 N 199 E 80-110 cubs (85-115 cubd) sherds, baja, obs,
chert

Lot 30 200 N 198 E 80-106 cubs (89-115 cubd) sherds, bone, obs

Lot 31 199 N 198 E 80-102 cubs (93-115 cubd) sherds, baja, obs
screened $\frac{1}{4}$ "

Lot 32 199 N 199 E 80-94 cubs (101-115 cubd) sherds, baja,
obs., chert, shell, bone (animal)

Lot 33 200 N 199 E 115-135 cubd sherds, baja, shell, obs.
screened $\frac{1}{4}$ "

Lot 34 200 N 200 E 115-135 cubd sherds, baja, shell, obs

Lot 35 198 N 199 E 115-135 cubd sherds, baja, obs.
screened $\frac{1}{4}$ "

6/10/96 104 H

P96-56-102

Lot 36 198 N 199 E 135 - 137 cubed sherd, baja
screened $\frac{1}{4}$ " depth of floor ~~obs~~ continuation of Lot 35
Lot 37 199 N 200 E 115 cubed - 135 cubed sherd, baja, shell
screened $\frac{1}{8}$ " depth of floor obs., chert
Lot 38 199 N 199 E 115 - 135 cubed sherd, baja, whistle
135 cubed in SWC. 133 cubed in NWC. 137 cubed in NEC
secondary floor third floor primary floor
whistle looks like a turtle with a bandolero (?) across-
crossed over its chest

Lot 39 200 N 199 E 135 - 155 cubed obs, chert

6/11/96 screened $\frac{1}{4}$ "

Lot 40 201 N 200 E 115 - 135 cubed sherd, baja, obs
screened $\frac{1}{8}$ "

Lot 41 200 N 199 E 155 - 175 cubed sherd, obs
screened $\frac{1}{4}$ "

Lot 42 200 N 200 E 135 - 155 cubed sherd, obs

Lot 43 200 N 199 E 175 - 195 cubed sherd, obs.

6/12/96 screened $\frac{1}{4}$ "

Lot 44 200 N 200 E 155 - 175 cubed empty lot

Lot 45 200 N 199 E 195 - 215 cubed empty lot
screened $\frac{1}{4}$ "

Lot 46 200 N 200 E 175 - 195 cubed sherd, obs

Lot 47 200 N 199 E 215 - 235 cubed sherd, obs.

6/13/96 screened $\frac{1}{4}$ "

Lot 48 200 N 199 E 235 - 255 cubed sherd, obs

screened $\frac{1}{4}$ "

Lot 49 200 N 200 E 195 - 215 cubed sherd

Lot 50 200 N 200 E 215 - 235 cubed sherd, obs

104 H

6.13.96

P96-56-103

Lot 51

200N 199E

255 - 280 cubd sherds, obs.

screened $\frac{1}{4}$ "

Lot 52

200N 199E

280 - 295 cubd obs, chert

screened $\frac{1}{4}$ "

Lot 53

200N 199E

295 - 315 cubd sherds, obs, chert

screened $\frac{1}{4}$ "

* Lot 54

229N 200E

0 - 20 cubd

empty lot

a comparative 1x1 m unit was dug for soil sampling between level ground off the slope of the earthen mound and the base of excavation in the center of the earthen mound (approximately 35-4 meter below datum.) The unit will not be screened.

Lot 55

229N 200E

20-40 cubd

sherds, obs

6.14.96

Lot 56

229N 200E

40-60 cubd

sherds,

Lot 57

200N 199E

315 - 335 cubd

obs., sherds

screened $\frac{1}{4}$ "

Lot 58

200N 199E

335 - 355 cubd

shell, 2 soil
sherds, obs, samplesscreened $\frac{1}{4}$ "

beneath that was a bejoreque floor
depth of one more floor (grayish clay).

Lot 59

229N 200E

60-80 cubd

empty lot

Lot 60

229N 200E

80-100 cubd

sherds

6/17/96

Lot 61

200N 199E

355 - 377 cubd

sherds, shell, obs,
chertscreened $\frac{1}{4}$ "

only the western half will be excavated - not only will this preserve the floor, but the workers will be able to dig deeper and still be able to get out of the hole

6.17.96

104 H

P96-50-104

Lot 62 200N 199E 377-385 cubd sherds, shell, obs,
screened $\frac{1}{4}$ " chert, baja, 1 soil sample

355-377 cubd = layers between floor 4 ? floor 5

377-3 cubd = top of floor 5 - bottom of layer of floor 5

- the last 3 floors seem to be bajareque floor that are later covered over with sediment floors
- floors 4 & 5 seem to be covered over more in clay than silt
- floor 5 seems to have a layer of ash (and two colors of ash in separate areas) between the bajareque & the clay layer
- floor 5 may be more ephemeral than the later versions. just beneath the clay "floor" with scattered areas of bajareque an ashy soil level was encountered rather than ~~more~~ more bajareque

6.18.96

Lot 63 200N 199E 385-395 cubd sherds, obs, chert
screened $\frac{1}{4}$ " 1 soil sample, shell (crab claw*)

Northern $\frac{1}{2}$

bajareque/sherd-like formation

- gray clay inclusion^(FL) that showed up in Lot 62 appears to be a wall/step and possible floor that is "washed/sealed" with a very fine gray clay slip

Lot 64 200N 199E 395-415 cubd ~~shards~~ sherds, baja,
screened $\frac{1}{4}$ " $\frac{1}{2}$ bead, chert, shell, crab claw, bone, obs.

- gray ash layer continued so a 4×4 m unit was excavated in the NW quad of 200N 199E
- the size of the test unit was determined by the placement of the gray washed walls (Feature 6)
- bead is red (only $\frac{1}{2}$ a bead) and may be made of shell; the color is uniform throughout i.e., no firing core; no grainy texture - does not appear to be clay

104 #

6.18.96

P96-56-105

Lot 65 200N 199E 415-428 cubed sherds, shell, obs, chert
screened $\frac{1}{4}$ "

- Artifacts dropped off tremendously and hard packed earth with gray clay "wash" completely fills the excavated area

- the area, however, is not flat - bumps and knobs of clay are formed in a rough circle in the excavated area

- the original 4x4m area was expanded for both Lot 64 & Lot 65 to encompass the area where the gray clay layer protruded a small section to the east of the gray clay wall (F.6) will be excavated next

Lot 66 200N 199E 385-410 cubed sherds, shell, obs, chert
screened $\frac{1}{4}$ "

Lot 67 200N 199E 355-375 cubed? unprovenienced ground stone

may have come from Lot 61, but don't really know (workers "recall" it coming out of that Lot, but didn't think it was anything at the time)

Lot 68 201N 201E 115-125 cubed 1 soil sample ^{no other artifacts found}
soil sample taken ~~from~~ of Feature 3 (baja floor)
2-3 cm above the floor in the NEC where the grayish gravelly soil is found

Lot 69 198N 198E 115-135 cubed 1 soil sample
soil sample taken of F. 3 - 2-3cm above floor in it SWC where the "normal" Naco valley soils are found

Lot 70 200N 199E 428-445 cubed empty lot
screened $\frac{1}{4}$ " 2x2m test pit in the NW quadrant
gray clay thickens

104H 6.19.96

P96-56-106

Lot 71 198N 201E

40-~~50~~ cubs empty lot

screened $\frac{1}{8}$ "

.5 x .5m in NEC of unit

Lot 72 198N 201E

50-60 cubs empty lot

screened $\frac{1}{8}$ "

.5 x .5m test unit in NEC

Lot 73 198N 201E

60-70 cubs empty lot

screened $\frac{1}{8}$ "

.5 x .5m test unit in NEC

Lot 74 198N 201E

screened $\frac{1}{8}$ "

70-78 cubs empty lot

.5 x .5m test unit in NEC

Lot 75 198N 201E

78-80 cubs 3 soil samples

not screened

taken above surface of F. 2 (floor)

Lot 76 229N 200E

80-100 cubs

obs.

continued from Lot 60 (6/6/96)

Lot 77 229N 200E

100-120 cubs sherds

6/20/96

Lot 78

200N 199E

34-450 cubs

Clay sample taken for testing of firing quality

clay removed from initial .2 x .2m test pit

Lot 79

200N 199E

367-381 cubs

while traveling walls for profile another floor was discovered (F. 7) the soil beneath the clay floor of F. 5 and above the plaster floor of F. 7 was removed for a soil sample - lots of carbon was noted (two mica flakes were discovered & bagged separately (so that ~~them~~ they would not be destroyed)

- Feature 6 - the earliest ~~phase~~ phase of construction was found at the base of the deepest 1x1m (about 4.5 mbd) on the northern $\frac{1}{2}$ of the unit (refer to drawings). It appears to have had two (now heavily eroded) steps leading up to a platform wall (orientated roughly north/south).

in Northern
Profile

The steps were eventually covered over by 1, possibly as many as 3 later clay floors. All of feature 6 is awash in gray clay (but very likely is formed out of the gray clay). ~~At~~ The level of the ~~bottom~~ bottom of the last step a .2x.2 m test unit was sunk in order to determine whether or not we had reached sterile. No artifacts were recovered, but it turned out that the floor was solid clay - later a soil sample was taken which expanded & deepened the original test unit to approximately 20-25 cm below floor surface - it was completely solid and sterile. The sample was taken for a firing clay sample. Although the clay beneath F.6 was sterile - no natural soil level similar to the soils in the surrounding area (at that distance below datum was found).

- Feature 7 - at a level just above the "floors" of F.6 lies a plaster floor (although while cleaning for profiles a possible earlier version was found - mixed heavily with clay - possibly F.6). Only a small section of F.7 was discovered. In profile it appears not to have extended more than 50 cm to the north and also seems to have ended just prior to reaching the west wall of the trench. A heavily carbon flecked soil sample was taken ~~found~~ between F.7 and F.5 - a clay floor which sealed F.7. It is not known how far to the EAST? South that F.7 extends.

- F.5 - A Clay floor which at first was thought to have sealed F.6, but was later discovered to have sealed off F.7 as well. The depth of F.5's clay floor varied from only 1-2 cm to as many as 5 cm. Beneath F.5 was an ashy silt heavy with artifacts: obs, chert, ceramics, shell (crab claws). Like later floors - F.5 was expected to have had a bajareque floor - that however, never materialized. Above/on top of this clay floor was a hard packed earthen floor similar to the later phases of this mound.
- F.4 - With relatively few cm of fill between F.5 & F.4 another series of ~~phases~~ construction were completed. Beginning with a bajareque floor - this first level was the cropped/washed/sealed with the gray clay layer. This was then covered over with 5-10 cm of hard packed earth. Although the bajareque/clay floor peters out in the northern profile - it does show up in all four walls. Unlike F.7, F.4 & F.5 seemed to have covered a greater area.
- Feature 3 - After the termination of F.4 2m of dirt ~~was~~ were piled on top raising the height of the mound considerably (2m). This fill did not have many artifacts - unlike the levels between F.1 & F.2, F.2 & F.3, and F.5 - F.6. This suggests that there were relatively few people in the area who could donate cultural material to the ongoing effort of raising the level of the earthen mound. Feature 3 is a beautifully preserved bajareque floor. The techniques used on this floor are similar, if not more elaborate, to those used on F.4. Underlying most of the profile of F.3 is a like gray ashy silt ranging between 0-10 cm thick. Above this layer is a bajareque lens. (photoed, videoed, drawn in profile & overview) This floor has two main colors - orange and red separated by gray "strips".

F.3 cont.

104 E : H

T96-86-109

There are possibly 2 or 3 different levels/layers to this bajareque floor. The difference in height from the lowest red floor to the highest orange floor was 3 cm over a 1 m length (m 199N 199E). All of the differing colors/shades of were "washed" in a very thin, very fine layer of ash/clay. It could be that the layers were "washed" with the same clay that is found in F.4, F.5, and F.7; or it could be that the gray is ash from each successive firing of the bajareque floor. Near the center of m 199N 199E was a large carbon stained area cutting through several layers of bajareque. However, the floor was left in ~~fact~~ as much as possible for an archaeomag. sample. Although the floor was found in all four N/S m. excavated it is not known how far to the east or west this floor extended.

The East side was not excavated in order to preserve parts of F.1 & F.2. Like F.4 & 5, F.3 is sealed/covered by an earthen hardpan (5-10 cm thick).

- **FEATURE 2.** The mound was raised another 40 cm above the level of the F.3 hardpan to the level of F.2, an earthen hardpan. The fill consisted of sherds, and obsidian as well some larger stones in the NW quad of the excavation block.

- **Feature 1** was a stone platform orientated roughly N/S and rectangular in shape. The best line was in the North and consisted of two courses - a small, tightly packed lower course set between very large stones to the east and west (pedestaled for posterity). While the center was fairly intact the NW corner was disturbed and the eastern edge seemed to have dissolved. On the whole, though, the platform seemed to have been contained within the confines of the 4x4 m excavation block. The interior stones of the platform, however, were jumbled with no flat surfaces - the platform probably supported an earthen floor.

104 E/H

P96-56-110

The northern end of the platform had interesting and very confusing fill episodes occurring on top of F.3, under F.2, possibly disrupting F.2 in the N or F.2 ended at the intersection of Fill & Floor. A later fill/Excavation between F.2 & F.1, and then possibly after F.1. Was there anything later than F.1? Was that what caused the fill episodes disrupting F.1 & F.2.

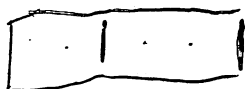

FOR NEIL: list of units screened

Matthew Turek #56

✓ mean obs.
x no obs, but
there are
artifacts

Op Sub-op Str.# Lot # Screen Size

144 E 11 07 1/4"
08 1/4"
18 1/4"
21 1/4"
41 1/4"
44 1/4"
46 1/4"
49 1/4"
82 1/4"
83 1/4"

Empty Lot

144 J 19 11 1/4"
13 1/4"
14 1/4"
15 1/4"

144 U 22 1 1/4"
2 1/4"
3 1/4"
4 1/4"

144 V 20 1 1/4"
2 1/4"
3 1/4"
4 1/4"

144 W 18 1 1/4"
2 1/4"
3 1/4"
4 1/4"

Empty Lot

Empty Lot

Structure

earthen mound

1x1m
TEST
units
over
un-
excavated
mounds

middens
NW of
144

Op	Sub-op	Str. #	Lot #	Screen Size	obs/chart
484	DD	1	1	1/4"	✓
			2	1/4"	✓
			3	1/4"	empty Lot

484	EE	2	1	1/4"	✓
			2	1/4"	x
			3	1/4"	✓
			4	1/4"	empty Lot

144 AE

1x1m test units
gridded across sites
144 = 128

	1	1/4"	x
	2	1/4"	✓
	3	1/4"	x
	4	1/4"	✓
	5	1/4"	✓
	6	1/4"	x
	7	1/4"	x
	8	1/4"	empty Lot

144 AF

	1	1/4"	empty Lot
	2	1/4"	x
	3	1/4"	✓
	4	1/4"	x
	5	1/4"	empty Lot

144 AM

	1	1/4"	empty Lot
	2	1/4"	x
	3	1/4"	x
	4	1/4"	x
	5	1/4"	empty Lot

144 AN

	1	1/4"	x
	2	1/4"	x
	3	1/4"	empty Lot

Op	Sub-op	Str. #	Lot #	Screen	Single obs/chart
144	BW		1	1/4"	Empty Lot
			2	1/4"	Empty Lot
			3	1/4"	x
			4	1/4"	x
			5	1/4"	Empty Lot
<hr/>					
410	B	1	5	1/4"	Empty Lot
			7	1/4"	x
			30	1/4"	x
			31	1/4"	Empty Lot
410	C	2	9	1/4"	x
			10	1/4"	✓
			14	1/4"	x
410	D	1	/	/	/
410	I	3	/	/	/
<hr/>					
46	m	190	/	/	/
46	N	190	13	1/4"	✓
			16	1/4"	x
			17	1/4"	x
46	O	190	50	1/4"	x
<hr/>					
104	E	1	37	1/8"	✓
			40	1/4"	✓
			42	1/4"	✓
			43	1/8"	✓
46 1/4" ✓			> 45	1/4"	✓
			47	1/8"	✓

Op	Sub-op	Str.#	Lot#	Screen	Size	obs/chart
104	H	1	13	1/4"	✓	
			14	1/8"	✓	
16	1/4"	✓	15	1/4"	✓	
			17	1/4"	✓	
			18	1/4"	✓	
			19	1/4"	✓	
			20	1/8"	✓	
			22	1/4"		Empty Lot
			23	1/4"	✓	
			26	1/4"	✓	
			27	1/4"	✓	
			31	1/4"	✓	
			33	1/4"	✓	
			35	1/4"	✓	
			36	1/4"	x	
			37	1/8"	✓	
			39	1/4"	✓	
			40	1/8"	✓	
			41	1/4"	✓	
			43	1/4"	✓	
			45	1/4"		Empty Lot
			47	1/4"	✓	
			48	1/4"	✓	
			51	1/4"	✓	
			52	1/4"	✓	
			53	1/4"	✓	
			57	1/4"	✓	
			58	1/4"	✓	
			61	1/4"	✓	
			62	1/4"	✓	
			63	1/4"	✓	
			64	1/4"	✓	
			65	1/4"	✓	

46 MNO	Soils:		
METER	19	36	Cubs
(EAST/WEST)	18	20	
	17		
	16	38	
	15		
	14		
	13	37	73
	12	47	
	11	57	103
	10	40	80
	9	45	84 - 112 (gray area)
	8	69	100
	7	50	94
	6	25	136
	5	41	
	4	48	
	3		
	2		
	1		

Soils:

- 1-5 I - 10 yr $3/2$ v. dk gry ben very coarse, large peds, silt
 II - 10 yr $5/4$ yll ben coarse, smaller peds, clayey silt
- 9-5 I " II " III same as II
 IV 10 yr $7/4$ lgt gray (possibly early classic fill) fine silt, few peds
 V 10 yr $3/3$ dk ben silty clay
- 13-10 I " II " ~~III~~
 III = to 9-5 II
 IV 10 yr $4/4$ dk yll ben clayey silt
- 12-19 I "
 II 10 yr $4/3$ ben/dk ben clayey silt

46 meter	M, N, O		N/S	46-50 cubs
1		34		
2	I	38	II	
3		43		
4				
5				
6				
7		I		
8				
9				
10				
11				
12	I	48	II	
13		39		
14		50		
15		50		
16		28		
17		34		
18	I	30	II	
19		70		
20		65		
21		60		
22		40		
23		36		

grayana
85-95

136 III

65 III

0-4 I " II "

4-11 I "

17-19 I " II " III same as E/W 9-5 IV soil