

1992

PVN-048-Brown-Field Notes-1992

Elizabeth Brown
Kenyon College

Follow this and additional works at: <https://digital.kenyon.edu/honduras>



Part of the Archaeological Anthropology Commons

Recommended Citation

Brown, Elizabeth, "PVN-048-Brown-Field Notes-1992" (1992). *Four Valleys Archive*. Paper 7459.
<https://digital.kenyon.edu/honduras/7459>

This Field Notes is brought to you for free and open access by the Anthropology at Digital Kenyon: Research, Scholarship, and Creative Exchange. It has been accepted for inclusion in Four Valleys Archive by an authorized administrator of Digital Kenyon: Research, Scholarship, and Creative Exchange. For more information, please contact noltj@kenyon.edu.

426 D Mound # 11

P. 92-48-1

1-28-92

Laid out trench on mound # 11 1 meter wide and 17 meters long. The mound is approximately $1\frac{1}{2}$ meters at its highest point. The trench runs perpendicular to a perceived line of cobbles on the (arriba) side.

In the east plaza ^{North} group, this mound is medium sized. ~~Some~~ ^{Another} interesting observations ~~are~~ ^{is} a cut block stone on the NW corner of the mound. I have ~~two~~ ^{two} workers.

One's name is Herman, with an ~~RRRR~~ sound. The other's name is Adolfo. Oh shit, I forget - I'll fill it in later. Bueno. I have asked them to dig 20 cm's. But, actually - they already knew ~~the~~ what to do. I introduced myself as Isabella.

Lot #1 426D/01 Lot #01 is $1m \times 1m \times 20cm$. North end of the trench from 0 \rightarrow 1 meters. In this first lot, we have found 5 pot sherds. 0-20cm BGS

Lot #2 426D/02 Lot #02 is $1m^2 \times 20cm$. North end of trench from 0 \rightarrow 1 meters. 345° (West of North) ~~345~~ is the orientation of the site. North Western corner is my reference point. Each depth measurement will be taken from there. (BGS) Below Ground Surface, datum. Wholly crap - is it ever HOT today. I feel like passing out, SNAFU \rightarrow head cold. fupare. Sherds. 20-40cm BGS

Lot #3 426D/03 Onto ~~the~~ depth level # 3. Sherds. $1m \times 1m \times 20cm$. 40-~~60~~ cm BGS

426D/04 - same area, ~~40-60~~ 60-80 cm BGS NW corner
7 sherds hit sterile sandy stuff at $\approx 70cm$, very lightweight & soft

426D/05 - move to next $1 \times 1m$ square to south, 1-2 m S of N end of sherd trench 0-20 cm BGS at NW corner

426D/06 - same area as 426D/05, ~~40-60~~ 20-40 cm BGS

426 D / Mound II

P-92-48-2

1-29-92

426D/07

40-60 cm BGS, 1-2 m s of N end of trench.
 Shards. - Shards and more shards.

426D/08 60-80 cm BGS, 1-2 m south of North
 end of trench. Shards. - Hit sterile - Sandyish

426D/09 0-20 cm BGS, 2-3 m s of N end of
 trench. $1m^2$

426D/10 - Pat and Ed came along and said that the trench walls
 needed to be straighter. ~~But~~ So, this lot contains ~~mixed~~
 artifacts from all the lots. It is everything that was
 scraped from the walls of a 80 cm ~~2~~ $1m^2$ trench.
 Therefore, shards ~~and~~ collected came from lots ^{426D/01 thru}

426D/08. Buena.

426D/11

20-40 cm BGS. 2-3 meters South of north end of
 trench. Shards. $1m^2$

426D/12 40-60 cm BGS. 2-3 meters south of north
 end of trench. $1m^2$. Shards. Nothing but shards so far.
 Not many big rocks or anything really really exciting. I can
 barely communicate with my workers.

426D/13

60-80 cm BGS. 2-3 meters south of north end
 of trench. Shards. $1m^2$. Sterile soil twds bottom.

426D/14

0-20 cm BGS. 3-4 meters south of the north
 end of the trench. $1m^2$. Shards

P. 42. 48. 03

1-29-92

426/D/ mound 11

426/D/15 -

20-40 cm BGS. 1m². 3-4 m south of the north end of the trench. Shards, obsidian blade fragment, grey.

426/D/16. 40-60 cm BGS. 1m². 3-4 meters south of the north end of the trench. Shards. Jenn found a really cool wall in her mound. I'm really jealous. Thus far the most exciting thing we found is a piece of obsidian. Came. Struggle on.

Muro =
wall

426/D/17 60-80 cm BGS. 1m² 3-4 m S of the North end of the trench. Rocks are beginning to be found. perhaps the 1st remnants of a toppled wall.

Viente
mas

1/30/92 426/D/18. 0-20 cm BGS. 1m². But 4-5 meters south of the north end of the trench. practically no shards in this lot. But we came down on two ~~some~~ large stones in what could be a line. One piece of chert or maybe quartz. Included b/c I thought maybe that was chert. probably not, in second opinion.

426/D/19. 20-40 cm BGS. 1m² 4-5 m S south of the North ~~then~~ end of trench. Pulling out many more pot shards ~~had~~ in this lot. 1 small piece/chunk of bahaveque and a larger piece of ceramic something, I'm not sure what. Anyway, we found some largeish vox in this lot, but as they began to take shape, we realised ~~it was~~ they did not form a Muro, rather, they are probably debris. That piece of ceramic something was part of a pot, the section where there ~~was~~ used to be a handle. Came down on some large rocks.

1-30-92426/D/20Proximo =
Next

lot 426/D/20 ~~is~~ [→] ~~an~~ 4-4.5 meters south of the North end of trench. It measures 40-80 cm BGS. And it is approximately 25 cm wide. I'm trying to ~~to~~ excavate the front portion of these rocks we've come down on. I want to see whether this surface goes down to sterile. Clean it off and understand the nature of its shape. Seems that we'll probably remove the big rocks. No architectural structure was found in this lot. Lots of sherds and some barbaque coming out suggests that the rocks etc. are depositional.

lot 426/D/21:

~~5-6 meters south of the north end of the trench.~~
~~Moved ahead 1 meter 0-20 cm BGS in order to~~
~~under see whether we come down on a wall. What~~
~~we've seen thus far is probably tumble. Decided~~
~~not to do this. Instead, we're going to excavate into a section~~
~~of dirt that does not seem to have any rocks. Hopefully, in~~
~~moving this dirt, a wall structure will be revealed. Some~~
~~rocks look lined up - let's see if they go down to sterile.~~
 { 33 cm int } 54 cm across y 40 cm deep. (40 → 80 cm BGS)
 { front to back } We took out 1 big piedra. and only one.
 Its probably cut. The workers are pulling out barbaque and sherds.

Looking down

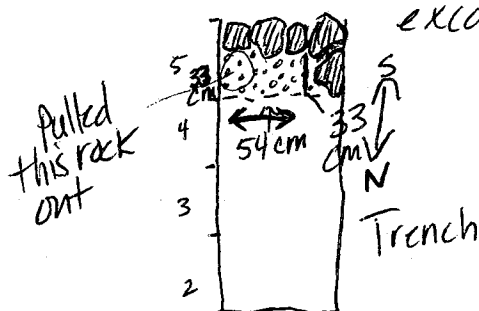

1-30-92

P. 92. 48. 05

426/D/22:

5-6 meters south of the north end of the trench.
0-20 BGS. Shovels Trying to come down on top of whatever structure may be down below. Coming down on ~~the~~ nothing ~~but~~ it still doesn't have structure. Finding a few shovels here and there. Mostly, nothing. Where the hell is my big wall?

426/D/23 6-7 Meters south of the north end of the trench.

0-20 BGS. A wall seems to be coming into shape at the southernmost end of this trench. Many shovels are turning up. Some Bajareque.

426/D/24 Contains a random sample of artifacts ~~from~~ found once we began to remove some of the rocks from meters ~~40-60~~ ~~20-40~~ BGS. Between m ~~40-50~~ 5-6 Shovels pulling rocks out.

Bajareque

Small L-shaped lot

426/D/25 55 N→S. 63 East/West. ~~40-60~~ BGS. 40-60 cm BGS.

An L-shaped lot, Between 5 and 6 meter mark; south of north end of trench. Shovels galore. We're in the process of ~~figuring out~~ figuring out how many steps are actually present in this mound. There were definitely found the top portion, summit or whatever. But the other terraces are not so easy to locate. We left in a lot of what I think may be steps, as indicated by some ^{large} schist deposits

1-31-92.

P. 92. 48. ⁰⁶

426/D/26

lot 26 is designed to uncover the major wall feature we've encountered between 6-7 meters south of the north end of the trench. I have decided to take 40 cms off the top, 20-40 cm BGS. It's raining, so I've constructed a tent over the northernmost end of the trench. 4 posts, 1 poncho and some string will work wonders. Plus, I have a pretty good view of what's going on in the trench. Think about archaeology - this culture we're digging up is so far removed from us, our world. Good god, their houses have accumulated 20-40 cms of earth. Anyway, so about this lot. They're pulling out sherds. The lot is 20-40 cm BGS. Approximately 5.8 → 7 meters south of the north end of the trench. Viente mas!

DW-
TC
DD
SW-
DD
TL
SH
MH
RH
Hormiga=
Ant
otro-
another

426/D/27 My ^{main} mura runs 254°. ^{NE-60°} East/north direction generally speaking. The other potential wall runs 60° NE ~~NE~~ NE, and it ~~is~~ ^{may} be located between 4-5 meters. The main wall is 6-7 meters south of the north end of the trench. ^{located between} We're still pulling out sherds and small rocks. We seem to have found a floor, a piso between 5 → 6 meters. And ~~otro~~ una otro muro. I'm jamming to the Red Hot chili peppers. 60-80 cm BGS. The piso is approximately 79 cm BGS. Sherds.

Piso=
floor
Baca-
cow
choocha
dog

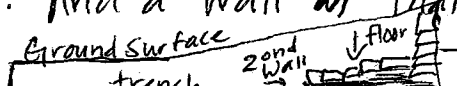
426/D/28 - Now they're leveling the rest of the trench - between 4-6 meters south of the north end. I have asked them ~~to~~ not to touch ~~canal~~ las piedras, there may be una otro mura or una piso underneath. No no sait. There is a continuous floor between 6-4 meters south of the north end. And a wall ~~at~~ that ^{may} descends from 40-80 cm BGS.  Small amount of sherds.

426/D/29

1.31-92

Ex debris / terminal from 60-80 cm BGS. 4-4.5 meters ~~at~~ south of the north end of the trench. Some sherds coming out. Not much. Revealed that the ~~1st~~ ^{1st} perceived wall is not very deep. But there are large rocks in a U-shaped position with the middle rocks indented. Approximately 4 ~~to~~ 4-4.5 meters south of the north end of the trench.

426/D/30

One meter ahead! 7-8 meters south of the north end of the trench. 0-20 cm BGS. 1m². A few sherds. May be coming down on a floor. But we'll have to check first. Shiiiit, I haven't named any of my features.

OK, the mound will be called ~~proctology mound~~ Proctology mound. 1st feature, heading south from the north end, is called ~~Hemorrhoids~~ Hemmor ~~Hemorrhoid Hill~~, proctologist point, second feature wall between 6-7 meters S. of north end of trench ~~parasite~~ ~~parasite city~~ Hemorrhoid Hill. Buena. Now were taking pictures. I have the works cleaning up the rest of this 1m² patch on top of Hemorrhoid Hill- 7-8 m 0-20 BGS.

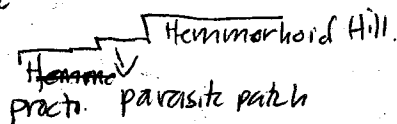

Hemorrhoid Hill.
proct. parasite patch

2.3.92426/D/31

Una metro proximo - pour faire. ⁸⁻⁹ ~~8-9~~ meters south of the north end of the trench. 0-20 cm BGS. Were pretty much coming down on what appears to be the highest level/platform in the structure. Pulling out a few pot sherds here and there, as well as some ~~bata~~ bajaraque.

2.3.92

P. 4892. P. 92.48.08

426/D/31 cont.

Collected shards and bajaraque.

NEW SUB-OP

426/G/01-

0-1 meter north of the south end of the trench. We will dig to sterile. ~~0-20~~⁰⁻²⁰ cm BGS. 1 m². New subop # 426/G/01. Shards are coming out. It's going to be a hot one today. ~~0-20~~⁰⁻²⁰ cm BGS. A lot of shards and, a punctated strap handle 0-20 cm BGS.

426/G/02 0-1 meters north of the south end of the trench 20-40 cm BGS. Pulling out some large pieces of pottery. One ^{piece of} obsidian ~~root~~ production blade. 1 m². → 2 Bags

426/G/03 0-1 meters north of the south end of the trench. 40-60 cm BGS. Pulling out shards. This probably confirms that we are now approaching from the rear end of the trench. Just found another strap handle.

2 bags again - mucho mucho shards. We are coming down on some small cobble tumble at the very southern end of 0-1 M, 40-60 cm BGS. Also, some large cut blocks - also probably tumble. 2 Bags

426/G/04 0-1 Meters north of the south end of the trench on mound 11. 60-80 cm BGS. Shards and pot pieces. 1 m². Lots is coming out, ~~at~~ although we should be coming down on sterile w/in the next lot or so. 2 Bags.

despacio - slowly, at your leisure

demasiado - too much

bad-malo

palabra-word

escoba-broom

2.3.92

426 G/07

p.92.48-10

Lot 426 G/07 is 20-40 cm BGS. It is located 17-18 meters south of the north end of the trench. It is approximately 70 cm North/South and 1m east/west. The lot is designed to ~~expose the wall~~ ^{expose} behind a small cobblestone wall. - The wall structure, heretofore called "dewormer wall" is described in lot 426 G/06 - p. 92.48.09. We need to see the structure of the wall, we are pulling out lots of sherds, and some other stuff.

sacar-
take art.

tambien →
also

426 G/08

2.4.92

40-60 cm BGS. 17-18 meters south of the north end of the trench. Approximately 70 cm x 1 meter E→W. Around 50 cm's, Adolfo pulled out some large sherds on the south. ~~side~~ side of dewormer wall. They were accidently smashed by his pick axe. Im completely bummed.

2 Bags in this lot. lots of large pot sherds and ~~and~~ strap handles. - Bajareque Bajareque coming from approximately 5-10 cm away from the wall. ~~Large~~ Excavating carefully on the ~~the~~ south side of dewormer wall because there is so much shit in there.

426 G/09 - A very large hecavo jar rim -

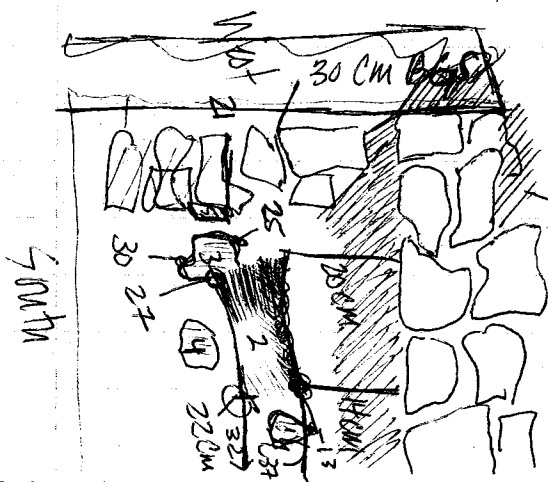

distance from North and east sides of trench from ~~North~~ east corner of trench.

10 cm between top of wall and G.S.

Sherd 1 - from N

Sherd 2

Sherd 3

Sherd 4

Sherd 5

{Continued}

flared Neck
Jicaro - unslipped plain

#2 - Shovel is approximately 20 cm ~~wide~~
long - Curved etc.

1 \rightarrow 20 cm from Newer wall

2 : 14 cm from dewarmer wall.

3. 13 cm from d.w.

4 28 cm from d.w.

5.30 cm

6. 21 cm

Distance from East side wall of trench.

1.56 cm

2. 36 cm

3.32 cm

4. 43 cm

5. 52 CM

Q. 64 cm

Small wall-
45 cm
BGS

Approx. ~~60~~ Cui
BGS

W Hey, what
do you call a
Quachopelagic in
an archaeologists
trench. ?
Phil

426 G/10

3 1/2 to 4 meters north of the south end of the trench. 0-20 cm BGS.
Shards and a bone fragment.

426 G/1A II - 3 to 4 meters North of the South end of the trench. 20-40 cm BGS. Shards. 2 bowl bases. A figurine fragment. Incenseario fragment. Strap handle. 2 BAGS

426 G/12 3 to 4 meters N of S end of trench. 40-60 cm
B3s. Swords, strap handle,

Coming down on a wall along the right side of the trench. A continuation perhaps of the wall beginning with 2 very large rocks described in lots 4269 → I don't know the #, but I'll look it up. 2 BAGS

426 G/13

P. 42. 48. 12

2.4.92

4-5 meters North of the south end of the trench. 1m²
0-20 Cm BGS. Shards. basarque. 1 piece of obsidian

quien-who

426 G/14

4-5 m N of S end of trench. 1m². 20-40 Cm BGS.
Shards, reduction in number. Were coming up on a
floor perhaps. No, sorry, its just tumble - all of it. What
a pain. Wholy cow its so god damn hot out here.

regalo-
present.

2.5.92

426 G/15

mejoreo
better

5-6 M No. of So. end of trench. 1m² ~~20-40~~ 0-40
Cm BGS. Some large rocks - probably tumble which will
be removed. Just found a mano fragment, made of
basalt. I should show it to Kirk as he'll want to know
where it is being mined. Were pulling out shards. ~~Just~~

bulsa-
pocket
estaba en
me bulsa

426 G/16

6-7 meters North of south end of trench.
1m². ~~0-40~~ 0-20 Cm BGS. A few shards. Chipping
away, little by little, day by day.

Salut-
god bless
you

426 G/17

7-8 meters N of south end of
trench. 1m². 0-20 Cm BGS. A few shards.

deparse-
slow.

426 G/18

8-9 meters North of the south end of the trench.
0-20 Cm BGS. Were still coming down on masses of
tumble with ^{micro}small amounts of shards and I'm not sure what the
hell's going on. I'm definitely going to have to find the structure
in here. Although were going to have to pull out a lot of shit
first. Furthermore, I screwed up my trench. There is ~~at~~ less
than a meter between the two trenches that should
intersect perfectly. - How lame.

Looking around here, I'm realizing how deforested things are.

2.5.92

426 G/19

p/92/48/13

Oops, a massed metro. It's approximately 75-80 cm ~~to~~ North/South. 1 meter east/west. A little bit messed up - its where the two trenches intersect. Same, not many shreds and a lot of tumble. 0-20 cm BGS.

→ 426 G/20

(20-40 cm BGS)

3-5 meters south north of the south end of the trench. ~~20-40~~ 20-40 cm BGS. Approx 54 cm wide. from left to right, West to East. East wall may continue through 3-5 meters. We must check.

Ring → ~~base~~ base 40 cm BGS 14 cm from the West ^{side of trench} ~~west~~ 3m and 28 cm North of the south end of trench. 75 cm from East side of trench.

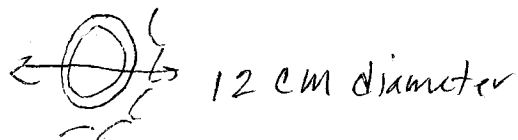

2 BGS

2 large pieces of basarague.

3 BGS

finding some bichrome shords. Strap handles,

Ring base

Between 4-5 meters North of the south end of the trench. Broken rim and tumble. Not associated with any architectural features. 4 m 21 cm North of south end of trench. 40 cm East of West wall of trench. 50 cm West of east wall of trench. (different from line wall up east side of trench. Measurement taken from 1m wall.

large rectangular piece of schist 26 cm BGS.

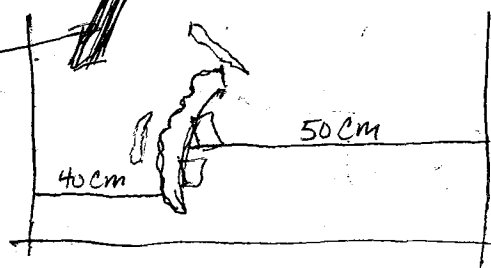

30 cm BGS.

approx 4m 28 cm north of south end. 20 cm from west wall 67 m East from east wall

P. 42. 48. 14

2.5.92

426 G/20 Continued.

large piece of schist, found in tumble at an angle of about 45° is rectangular in shape. Approximately 41 cm long (N-S) and 14 cm wide, E-W (in situ). Still finding sherds and random pieces of pottery. found the eye of a figurine, kind of interesting. 20-40 cm BGS. Meters → 3-5. 54 cm up ~~to~~ West side of trench. line on east side may continue to the summit of the mound.

2/6/92

426 G/21

3-5 meters north of the south end of the trench. taking this section down to 60 cm BGS. 40-60 cm BGS. A strip along the western wall, approximately 54 cm wide. designed to reveal a potential perceived line ~~on~~ the eastern side of the trench. Perceived line ^{along} is thought to exist, as a continuation of the wall described in meters 2-3. I'm not sure whether this wall continues. I think that I will munch into it as soon as this lot is complete. Sherds.

426 G/22

4-5 m : 24 cm ~~from~~ north of the south end of the trench. Sherds, some big pieces of schist are coming out, but they are all tumble. I'm across. 20-60 cm BGS, (40 cm down) where the hell is the structure on this mound.

2/6/92

p. 92.48.15

426 G/23

5-6 meters north of the south end of the trench. 20-40 cm BGS. Were removing alot of rocks. I cant seem to figure out where the hell the line is. There is so much tumble - its hard to figure it out. Not such a bad day though - its cool and cloudy.

426 G/24

6-7 m north of south. 20-40 cm BGS. Pulling out tons of rocks. More big pieces of schist.

426 G/25

69 cm x 50 - 69 cm North/South. 50 cm East/West. Small rectangular 20 more centerments, 30-40 cm BGS. 4m 80 cm North of the south end to 5.29 m North of S. 4.80 m → 5.29 m. Pulling out some good sized pot sherds. Some bajareque.

426 G/26

^{4.8-5.0} 35-50 cm BGS. 4.8 m → 5.29 m. North of South end. 30 cm East/West, pot sherds and a inky stamp thing. polychrome fragments, 1 obsidian blade, mano-fragment.

426 G/27

6-7 meters south North of the south end of the trench. ~~40-50 cm BGS. 1m²~~ 34-53 cm BGS. Took a huge rock art. Azios piedra. A few sherds are coming out.

426 G/28

7 to 7.30 meters North of the south end of the trench. 1m East/West. 16-52 cm BGS. Pulling out Big rock, big rock. Potential line approximately 7.30 m East/West. Schist top. Cows make a lot of noise. Empty lot

426 G/29

2/6/92

p92.48.16

found a ^{wall} line approximately 7.30 m North of the south end. Its capped with schist. This lot extends from the small wall at 5.45 m North of South to 7.3 m North of South (the new wall) it is level with the 5.45 wall at 46 cm BGS. ~~Small wall is~~ found some carbon on one perhaps at 53 cm BGS (~~around~~ the mound rises). Mano fragment. Shards. Small pieces of Bajaraque. More Bajaraque. A Huge piece. Embedded in the dirt. Some burnt looking pieces, and small amount of carbon. Bajaraque patch is @ 25-35 cm North/South and 53 cm East/West. Bajaraque is @ 70 cm BGS, 20 cm from the wall at 7.3 m, (7.10 m North of South to 6.8 m North of South.)

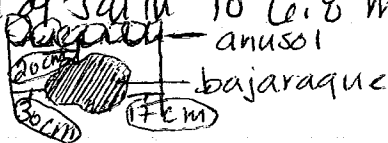

2/7/92

426 G/30

My workers handed me a piece of drilled schist this morning - My idea on its purpose is that it served as a posthole ^{to hold} the bajaraque in place. Perhaps one at each corner, that a stick was stuck into, so that it wouldn't fall over, or would be more stable. The schist came out of my backfill. ^{that} Sucked!

Evidence
- frequently found on surface on top?
- # per site.
- in ass. w/ bajaraque?

426 G/31

Tote ^{N/S} 70 cm x 1 m E/W. 70 cm South of the wall at 7.3 m North of South. (Anusol wall) lot 426 G/31 ~~Anusol~~ is located at 6.6 m North of the ~~#~~ south end it is 70 cm long → so, 6.6 m to 7.3 ~~cm~~ North of the south end of the trench. 10 cm deeper, so its about 80-90 cm BGS. Pulling out tons of bajaraque.

2/7/92

426 G/32

p. 92.48.17

Pulling out some pieces of pink schist at 90-110 cm BGS. Still following Anusol down. Lot is 6.6 m to 7.3 m ~~some~~ north of the south end of the trench. The wall stops at 1 cm BGS.

NEW OPERATION

426 K/01

p. 92.48.17

2/7/92

1m². 0-20 cm BGS. following dewormer wall west, 1 square meter. 6.6 m north of the south end of operation 426 G. 6.6 m → 10.6 cm north of the south end of trench (operation 426 G). Shit, where the hell did Lavinia go? - I need her. Help. This new op is going to tick up my section. Ahh, I messed up. Shards, strap handle,

426 K/02

p. 92.48.17

2/7/92

1m east/west x 61 cm ~~containing~~ north of the south wall of op. 426 K/02. 20-40 cm BGS. following the line of dewormer wall. It stops at 1 cm ~~2~~ west of the ~~east west east~~ end of trench.

Shards/figurine frag. strap handle.

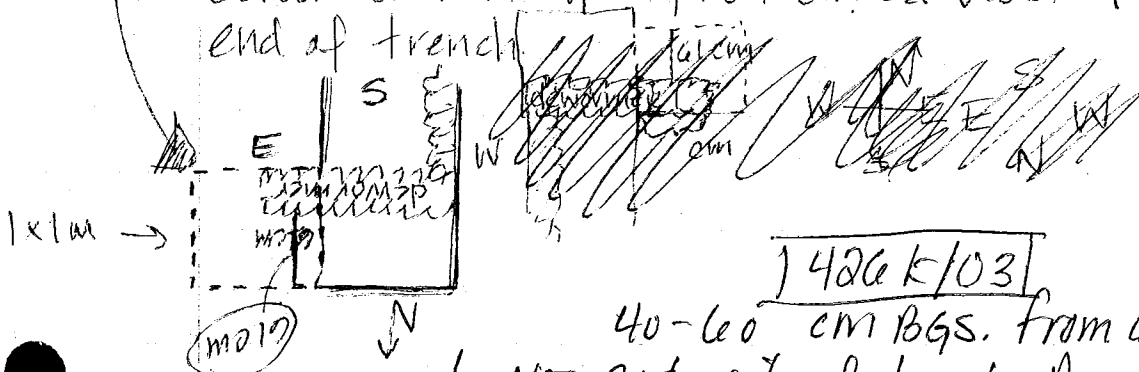

1 426 K/03

40-60 cm BGS. From dewormer wall to ~~near~~ south side of trench. Approx 60 cm south → North. and 1m. Shards, punctated strap handles.

2/7/92

426K/04

p. 92.48.18

60-80 cm BGS. 1m x 60 cm S → North.

Sherds

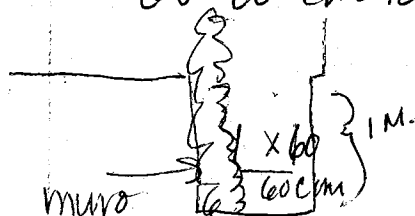

~~426K/04~~ 426G33

4 meters 20-40 cm BGS. Strip of trench between Hemmerhoid and Anusol. walls. Platform area type thing, clearing up some of the confusion with the rocks and debris up top.

Hemmerhoid Hill wall is 6.8 m south of the north end of the trench. In excavating down to ~~the~~ B Level with the top of Hemmerhoid Hill, ~~20~~²³ cm BGS, at 6.8 m. The lot extends from 6.8 m to 9.03 m from the north end of trench. Large piece of schist, 8.30 m to 8.6 m ~~west~~ south of north end. — Schist, ~~probably~~ may be a floor or an entry feature — whatever, 32 cm North/South and 43 cm East/West 25 cm East of West wall.

426G34

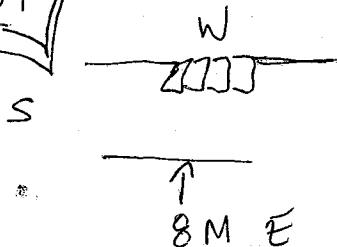

4 rocks lined up along west side of trench. In line with some other cut blocks towards northern end.

~~20 cm~~

20-40 cm BGS. from

~~7.8 m south of north end.~~

~~426G34 20-40 cm BGS. from north of the south end - 20-40 cm BGS. from north of the south end.~~

~~20-40 cm~~

~~20-40 cm~~

8 m to 8.4 m to 10.3 m south of north end.

20-40 cm BGS. 1.9 m x 1 m E/W

all together, 66 cm long
7.79 m to 8.45 m ~~from~~ south end.

7.79
66
8.45

2/11/92

426K/05Luna
maria
mericos
Jueves
miércolesSabado
domingo

p. 92.48.19

1-2 meters west of the east wall of trench at 17-18 m North/south (operation G) coming down/following dewormer. @ 0-60 cm BGS. lots of pot sherds and slint. Its possible that we've found a corner but I'm not sure.

426K/06

N
S E

70 cm west of Western wall of ^{main} trench at southern end. 1m² trench following dewormer wall around its corner. 0-20 cm BGS. 1m North of South end.

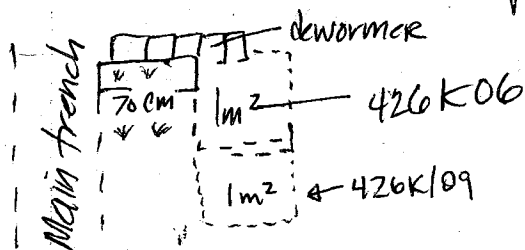

2-12-92

426K/07 - same area as 426K/06, 20-40 cm BGS NE corner bayareque, figurine fragment, sherds - large bag cleared top of wall that corners with DEWORMER

sherds

426K/08 - below 426K/07, 50 cm ^{wide} area between ^{METAMUCIL} wall & W. wall of trench, 40-60 cm BGS wall is only one rock high but continues into next m.

sherds
bayareque
2 bags

426K/09 - continuing next 1x1 m square to N, 0-40 cm BGS to top of wall METAMUCIL. 137-237 cm N of outside Front edge of DEWORMER, 70-170 cm W of W trench wall

sherds
3 bags

426K/10 - below 426K/09, 40-75 cm BGS NW corner, area is 1m N/S by ~~30 cm~~ ^{1m} E/W between possible continuation of wall METAMUCIL and W trench wall, ~~may~~ expand later if wall does not continue up here, wall does not continue, so expanded

P. 42.48.20

2/13/92

426K/11

Following pepto laterally from a point that is ~~not~~ most north. I think I'd like to know whether this is a corner or not - I may be enlightened. In the meantime, I'll be working on my section. ~~to~~ 0-20 cm BGS. 1 m² Coming down onto the top of a continued line around the corner of pepto.

I'm extending this lot - ~~area~~ - down another 40 cm in front of the continued line of pepto.

426K/12

Between 0 and 1 m west of West edge. Designed to reveal follow the line of proctologist point 1 m North of 426K/11. Pepto is probably tumble - will remove after checking this. North East corner of 1 m² is 53 cm North of proctologist point. Went down about 0-40 cm BGS. Came down onto a continuation of proctologist point. Next, we'll move all the tumble out of the way and then follow proctologist out a bit. Sheds.

Section Notes

- I'm resetting the line so that I can finish my section. There's lots of points to take. I'm marked distances on all the rocks which helps. Now I must set the level at

~~22.5 cm BGS~~

(Soils) → last occupation level Sterile

Soil extends ~~from~~ about 10 cm from approx. ⁶⁰120 cm → ⁷⁰130 cm BGS. at the northern most end of trench.

② Second band up from bottom is somewhat darker, probably the 1st occupation level at 14 cm wide from 116 → 130 cm BGS

③ 3rd band, ~~28~~ → ⁴⁸146 cm BGS - Contains lots of sherds light brown soil not as dark as ②. → at NW corner.

④ Dark band. ~~146~~ → ¹⁴⁶146 cm BGS at NW corner. 14 → 28 cm

⑤ top layer - ~~146~~ → ¹⁴⁶146 cm BGS. 0 → 14 cm BGS Very few sherds.

P. 42-48 21

2-14-92 426 K/13 - 0-1 m area in front of wall PROCTOLOGIST,
shards 0-1 m W of W trench wall, 30-70 cm BGS, from top
of PROCTOLOGIST, removing tumble-very big rocks
they are too. - took out PEPTO because it didn't look
like anything except tumble.

shards 426 K/14 - Next 1x1 m area to the west, extending 55 cm
in front of PROCTOLOGIST, coming down to top of
PROCTOLOGIST, 0-30 cm BGS at PROCTOLOGIST
1-2 m W of W wall axial trench, area is 1.10 m on W edge

shards 426 K/15 - below 426 K/14, area in front of PROCTOLOGIST
30-80 cm BGS at PROCTOLOGIST

shards 426 K/16 - Next 1x1 m square to W, extending 60 cm in front
of PROCTOLOGIST, coming down ~~off~~ on top of PROC., 0-40 cm
BGS at PROCTOLOGIST, 2-3 m W of W trench wall

shards 426 K/17 Next 1x1 m square west of west wall. Extends approx.
50 cm ~~in front of~~ in front of proctologist 3-4 m W of W wall
trench wall. ~~0-20 cm BGS.~~ 0-40 cm BGS.
This lot includes a small extension on the south and east
sides as the trench seems to have gone somewhat awry. 6 cm on
each side to even thing out.

shards 426 K/18. Next 1x1 m square west of west trench wall.
Extends approximately 40 cm in front of proctologist
still following proctologist out. 0-20 cm BGS. 4-5
m west of the west trench wall. Ant (Ant Lead.)
Continued Next page.

2/17/92

P. 92. 48. 21

426K/18 CONTINUED NOT CONTINUED

Shelds

426K/19-

Same as 426K/18 but 20-45 cm BGS.
4-5 m West of the west trench wall.

426K/20

Shelds

Moving 1m² south of 426K/19. ~~Following~~ Followed
proctologist point to its corner. Now am following revealed
corner south. Meter is ~~0-1 m south of north~~ 1-2 m south
of Western trench. ~~at approx 5-6 m~~ 4-5 m
N₂ is approximately 34 cm West East E
of the western corner of proctologist
point. Corner stone is approx 15 cm BGS, 0-20 cm BGS.

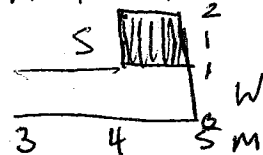

Shelds

426K/21 Below 426K/20. 20-50 cm BGS. 1m². Trying to
reveal corner of proctologist point wall →

426K/22.

53 cm x 90 / Cutting down between lots 426K/21 and
426K/20 - 1m² lot encompassing the corner of proctologist
50-70 cm BGS. Corner Top Cornerstone is called
and is approximately 53 cm North of North trench
wall & 90 cm East of East wall.

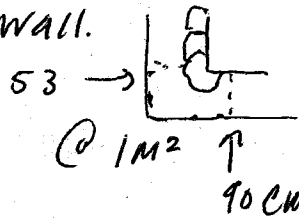

Shelds. Bajaraque.

Possible sensor base or
lid. With some decorative
moulding. Pulled large rock on apparent corner.
Revealing the real corner. Now moving on ~~to~~ south.
Lots, of schist fragments. Cleaning el esquina.

Trailblaze
with might
2/18/92

Shelds

Baj.
sens. base

take out
walk
and to left

426K/23

2/18/92

p 92.48.22

down 20.
take
down
Centerabit.
Walk way
to my site

At 3-4 m west of west trench, moving north following
the perceived line of after the corner proctologist point.
1m² - 0-20 cm BGS. ~~420~~ 1.50 m ~~east~~ south of east of
West side of trench.

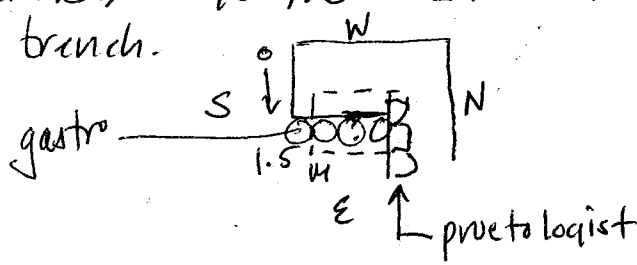

426K/24

• Ring base
• incinerario
fragment
• Shards

18 cm East of West end of trench. 1-2 m south of
North side of trench. Same lot as 20-40 cm BGS.
0 → 1.5 m east of West side of trench. Revealing
Wall, gastro → (intestinitis). Will follow this wall for another
meter or so - then its off to cut an Eastern trench tracing
the (probably) other wall. Gastro runs ~~n-s~~ North/south -
is approximately ~~cm BGS~~ and 30 to 78 cm BGS. Consists
of mid-sized river cobbles. Squarish. Gastro from corner to
furthest end of trench is @ 2 m long. @ 30 to 78 cm
BGS.

426K/25

- Bajaraque
- Shards

I have so much dust in my eye. 2-3 m south
of the north wall of West trench. Following Gastro wall.
Trench is 1m² - about 50 cm (extending) west of
West wall of trench. 0-20 cm BGS.
Large root. Aw shit. Bajaraque & shards

426K/26

Shards

- Vulture Flower yipes. Same as lot 426K/25, but
below - 20-60 cm BGS. lot extends 50 cm West from
Gastro Gastrointestinitis

426K/27

Shards
Strap handles

60-80 cm BGS - Same lot but a bit lower than

426K/26.

426K/28

P. 92. 48. 23

Next were going to make an eastern trench extending off the proctologist point - following that wall. Ya? Trench is lot is ~~0-1~~ 1-2 m East of West wall of trench. Int 2 extends 50 cm in front of proctologist point.

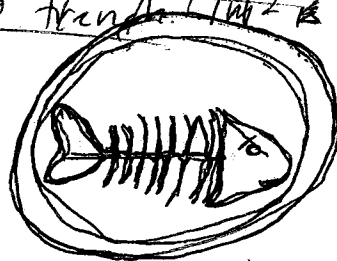

426K/28

A line of rocks has appeared running East/West, ~~is~~ perpendicular to gastropod wall. Will dig 20 cm down, ~~too~~ 80-100 cm BGS. 50 cm extending 50 cm in front of perceived line. (@ 2.5 m ~~is~~ south of North wall of west trench)

426K/29 - Eastern trench extending off proctologist point. Following that wall Ya? Trench lot is 1-2 m East of West wall of trench. Int 2. Extends 50 cm south (in front of) proctologist point.

Shards

Shards

426K/30. 1.3 m East of West end of trench. 20-80 cm BGS. Clearing small amt. of dirt, following strange line.

Bayanage Shards.

426K/31. 2-3 m East of West ^{wall of} end of trench. 0-20 cm BGS. Confused.

Shards
add
rock.

426K/32. 1-3 m East of West wall of trench. 20-40 cm BGS. Still perplexed.

426K/33 (More clearly) 426K/33

1-3 m East of West wall of trench. 1.0 → 1.5 m south of proctologist point line to 0-20 cm BGS. Creating space in front of wall so that we can come down at it.

LS

2/20/92

P. 92 48. ~~24~~ 24

³⁴
426K/34 20-40 cm BGS. Coming down ~~on eastern~~ in front of eastern extension of proctologist point. 1-3 m east of west wall of main trench. Pulling shenks—exposing proctologist point.

426K/35 40-60 cm BGS. 1-3 m east of west wall of main trench. Exposing eastern proctologist point—Coming down in front of eastern extension of proctologist point.

426K/36 0-20 cm BGS. 3-4 m east of west wall of main trench. Exposing eastern proctologist point.

426K/37 20-40 cm BGS. 3-4 m east of west wall of main trench. Exposing eastern proctologist point.

426K/38 0-20 cm BGS. 4-5 m east of west wall of main trench. Exposing eastern proctologist point.

426K/39 20-40 cm BGS. 4-5 m E of W Wall of Main trench. Corner probably found.

2/21/92

426K/40 0-40 cm BGS — Turning north following eastern proctologist point around the corner to the north. 0-1 m North of Northern ^{end} wall of eastern trench.

426K/41 → to 3 meters total same lot as 426K/36 → 426K/40. @ 40-60 cm BGS. Scraping dirt around corner

426K/42

Still going north, of northern end of eastern trench. Corner & North wall are called Montezuma's revenge. 0-20 cm BGS. 2-3 m North of North end of eastern extension

426K/43 2-3 m north of north end of eastern extension. 20-60 cm BGS.

426K/44 3-4 m north of north end of eastern extension ~~so~~ 0-20 cm BGS. Following Montezuma's revenge.

426K/45

2.21.92.

p. 92.48.25

Yca, I have 2 sets of workers now. Jenn is finished w/ her trench. So we acquired Juan and Alexander. I set them to work on the southern end of the main trench. 1-2 m east of the west wall of the main trench. Following the line of denwarmer 0-20 cm BGS. To the east

426K/46

Montezuma's revenge has cornered so we're following it up and around - towards the west. Going towards center of mound.

Montezuma corners at 2.83 cm m south of north end of eastern extension.



0-20 cm BGS - 1-2 m west of the eastern wall opposing Montezuma's revenge.

426K/47

Other workers -

Working on southeastern extension → 20-40 cm BGS.

1-2 m east of the west wall of the main trench. Following line of denwarmer. 2 BGS.

426K/48

40-60 cm BGS - 1-2 m east of the west wall of the main trench. Following denwarmer, coming down on - 2 BGS.

426K/49

finding a line approximately 50 cm west of the southern corner of Montezuma's revenge. Cutting up towards the line, 40-60 cm between line and 1st meter. 60 cm wide

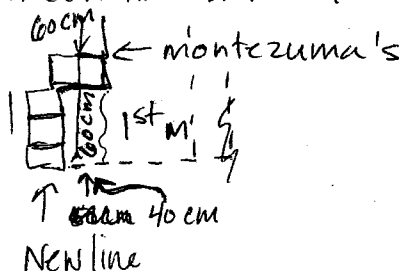

60 x 40 cm -
20 → 60 cm BGS.

Shards,
oblong clay
piece w/ hole
Shaphand

Shards

Shards

2/24/92

p. 92. 48. 26

426K/50/

Sherds

Tennis workers → at southern end of the site. Following the corner of dewormer back towards the north. 0-20 cm BGS.
1-2 m north of the southern end of the south ^{western} ~~eastern~~ extension.

426K/51-1 Adolfo Herman →

Sherds
stamp

Next m to the south of 426K/49. following Montezuma's revenge. Up a bit too high. 0-20 cm BGS. ~~1.5 m west of south 1.4 m~~ 1.4 → 1.4 m south of southwestern corner of Montezuma's revenge. Sherds/stamp. (North western extension)

426K/52/

drilled
Schist
clean
foss.
sherds.

1-2 m north of the southern end of the ~~southwestern~~ ^{trench.} In southwestern extension. 50 cm east/west x 1 m north/south. 20-60 cm BGS. Coming along the side corner of dewormer - flush with the perceived end of the wall on the ~~east~~ western side.
~~2 BAGS~~ 3 BAGS.

426K/53 Next meter forward. Have moved ~~down~~ 52 52 m west of 426K/51. and 1.4 → 2.4 m south of the southwestern corner of Montezuma's revenge 0-20 cm BGS.

Sherds

426K/54 Next meter north following low dewormer around the corner in a northern direction. 2-3 m north of south end of trench. In southwestern extension. following dewormer parallel with main axial trench. 0-⁴⁰ cm BGS.

426K/55

2 BAGS
Sherds,
bejarque,
ring base

20-40 cm extending 55 m to the front (west) of Montezuma's ~~re~~ revenge and approximately, 2.4 → 3.2 m south of southwestern corner of Montezuma's' revenge (at the indentation).

426K/56 Southwestern extension, 2-3 m north of south end of trench. following dewormer parallel to axial trench. 40-60 cm BGS.

drilled
Schist
Sherds.

2/24/92

P92.48.27

426K/57 Southwestern extension 3-4 meters north of south end of trench following dewormer parallel to axial trench
0-20 cm BGS

426K/58

Shards attached. Shards SW extension - 3-4 m north of south end of trench following dewormer parallel to axial trench 20-40 cm BGS.

426K/59

3.2 → 4.2 m ~~at~~ south of the south/west corner of Montezuma's revenge (where the dip is).
~~at~~ 0-20 cm BGS ^{trench} extends approx - 1 x 1 m²
50 cm in front of Montezuma's 20-60 cm BGS - coming in at level of ~~at~~

2/25/92

426K/60

Shards
mano frag.
smooth burnishing
stone

50 cm ~~at~~ E/W x 60 cm N/S. Small patch being cleared in front of ~~at~~ Montezuma's revenge. approximately 3.2 → 3.8 cm South of SW corner of Montezuma's. 20-60 cm BGS. Clearing earth around what is probably tumble.

426K/61

Shards
mano frag
strap handle
poss. figurine
mold.

SW extension → 3 → 4 m N of south end of a trench. Following dewormer north on the one side of trench. Another wall structure is developed on the eastern side of the trench. ~~40-50 cm BGS~~ 40 → 50 cm BGS. 1 x 1 m². Leaving in rocks. 2 BAGS.

426K/62

3-4 m N of S end of trench. Following dewormer. ~~50-60~~ 50-60 cm BGS. 1 x 1 m. 2 BAGS.

426K/63

40 cm N/S x 50 cm E/W. Small patch being cleared in front of Montezuma's revenge. The wall looks like it's about to tumble. Digging through lots of rocks. 3.8 → 4.2 ~~at~~ m South of SW corner of Montezuma's. 20-60 cm BGS. Big rocks coming staying in an axial line.

426K/64

~~0-40~~ 0-40 cm BGS. 4-5 m N of S end of trench. SW extension. Following dewormer.

Smooth
Shards
occurring
frag
face / Bird

426K/65

2/25/92

p. 92.48.28

sherds

Next meter \rightarrow 4.2 \rightarrow 5.2 m south of the SW corner of Montezumas at the dip. 0-20 cm BGS.

Sherd

426K/66

4.2 \rightarrow 5.2 m south of the SW corner of Montezumas at the dip. 20-60 cm BGS.

426K/67

4-5 m N of S end of trench SW extension. Following Dewarner.

426K/68

5.2 \rightarrow 6.2 m south of the SW corner of Montezumas's revenge at the dip. 0-20 cm BGS.

426K/69

sherds.
obsidiana
bajaraque

50-60 cm BGS. 4-5 m N of S end of trench. SW extension. Following dewarner North.

426K/70

~~6.2~~ 5.2 \rightarrow 6.4 m S of SW corner of Montezumas's revenge - 20-40 cm BGS.

426K/71

5-6 m N of S end of branch. SW extension following dewarner North. 0-20 cm BGS.

426K/72
bajaraque
obsidiana
sherds
strap

5-6 m N of S end of trench. SW extension. Dewarner North - Ran into preparation H running towards the East. Clearing 50 cm section extending in front of prep H. 20-60 cm BGS. Huge chunk of bajaraque & BGS.

426K/72
426K/72
sherds

~~0-20~~ 0-20 cm BGS. following Hemmerhoid hill, trench extends approximately 75 cm in front of the wall. Heading east.

426K/73

sherds

~~20-40~~ 20-40 cm BGS. Following Hemmerhoid Hill. Trench extends approximately 75 cm in front of the wall and 35 cm East of East side of axial trench.

426K/74

sherds

Following prep H to the east, 2-3 m east of east wall of axial trench. 0-20 cm BGS. Approx

2/26/92

426K/75

p. 42. 48. 29

80 cm east 1 m wide (N-S), 0-20 cm BGS.

Shards

Following Hemmerhoid Hill to the east. I feel awful, I just yelled at Adolfo - I'm in a horrible mood and I'm taking it out on him. I feel like such a shit. @ Corners near Monterummas

426K/76

Following preparation H to the east. ^{extending} approximately 60 cm in front of the wall (south).

Shards.

Rims
Ring bone
fragment
bichrome frag.

20-60 cm BGS. 1 m to east - ~~2-3~~ 1-2 m East of east wall of axial trench.

426K/77

80 cm east, 20-40 cm BGS. Same lot as 426K/75. Extends approximately 40 cm

Obsidian Shards

in front of Hemmerhoid hill wall. Approximately ~~60 cm~~ 1.4 m East of east wall of axial trench.

426K/78

~~20-40 cm BGS. In front of~~

Strap handle Shards

Following preparation H to the east. Extending approximately 40-50 cm south in front of the wall. 0-20 cm BGS.

426K/79

Following Hemmerhoid Hill to the east. 0-20 cm BGS. 1 m east and extending 40 cm North of the wall. Last section 60 cm E/W → trenched thru Monterummas

426K/80

Following preparation H to the east. Extending approximately 40 cm in front of the wall to the south. 20-40 cm BGS. Slow going.

Shard

426K/81

Last 30 cm Between ^{preparation H} ~~Hemmerhoid Hill~~ and Monterummas final corner in the Southeast. 0-60 cm BGS. 1 m N/S. To the east.

426K/82

1.5 m east of East side of axial trench. In front 0-1.5 m east of " " 40-60 cm BGS. → following Eastern Hemmerhoid hill down.

Obsidian Strap handle Shards

~~2/26~~ 2/27/92

P 92.48.30

426K/83

Mano frags.
Shards.

1 m west. Following ~~Hemmarhoid~~ Preparation H
to the west 0-1 m west of western wall of axial
trench. 0-30 ~~cm~~ ^{cm} BGS. Extends approximately 40 cm
South (in front of Western preparation H.). 0-30 cm BGS

426K/84

0-1 m west of west wall of axial trench. Hemmarhoid
Hill. 0-20 cm BGS. Extends approximately 60 cm North
of front edge of Hemmarhoid.

426K/85

0-80 cm BGS. 50 cm South of lot 426K/33.
approximately ~~1.5 m South~~ ~~1.5 m~~ ~~1.0-1.5~~
m South of ~~5.6 cm South of pierced front line of~~
preparation H. following wall to the west. 0-80 cm BGS.
2 mano fragment / figurine frag / shards / ring base fragment.
Large mano 426K/85 A small 426K/85 B

426K/86

ring base
shards.

1-2 m west of west wall of axial trench. Hemmarhoid
Hill west. 0-20 cm BGS. Extends approx 60 cm North
in front of edge of Hemmarhoid line.

426K/87

0-1 m west of axial trench. 40-60 cm BGS. 50 cm
South of lot 426K/33. 56 cm South of pierced front line of
prep. H. following wall to West. Obsidian, ring base, figurine frag.
~~the~~ ornamented strap handle, 2 strap handles.

2 BGS

426K/88

0-40 cm ^{1 m²} approximately 70 cm in front
of (South of) preparation H. 1-2 m west of West wall of
axial trench. 0-40 cm BGS

426K/89

0-2 m west of West ^{axial} trench side. 20-40 cm
BGS. 60 cm North extension in front of Hemmarhoid line.

shards
obs.

2/27/92

p. 92. 48. 31

426K/90 0-20 cm BGS - 2-3 m west of west axial trench. Cruising along in front of Hemmerhoid about 60 cm north of the wall.

426K/91 1-2 m west of west ^{side} end of axial trench. 20-40 cm BGS.

2/27/92

2 BAGS. Ring bone frag. / polychrome / obsidian frag. Shards. In front of preparation H. A few ~~shards~~ found - possibly human about 67 cm BGS. 2m west of west wall of axial trench. 30 cm south of wall. May not be bones at all given who knows? 3 BAGS

426K/92 2-3 m west of west side of axial trench. 0-20 cm BGS. 1m² following prep H west

426K/93 2-3 m west of west ^{end of} axial trench. In front of Hemmerhoid @ 60 cm north. 1m² @ 20-40 cm BGS.

strange bird shaped rock found - not basalt. possibly carved.

426K/94 - 3.0 → 3.3 m west of west end of side of axial trench. ~~0-60 cm~~ BGS. 0-20 cm BGS. Last chunk between hemmerhoid and gastro-intestinitis.

426K/95 2-3 m west ^{end of} axial trench. 40-60 cm BGS. Ploughing west in front 60 cm in front of preparation H.

426K/96 20 cm - 60 - ~~80~~ ⁹⁰ cm BGS. from 1.10 m west of west side of axial trench in Hemmerhoid to 2.80 m further 1.10 → 2.80 m west of west along Hemmerhoid.

426K/97 following prep H around the corner. toward esquina at approximately 3 m west of west side of axial trench. 0-2 m North of corner. at prep H. 0-40 cm BGS.

426K/98 50 cm west of 426K/97. A lot of tumble is, a wee bit confusing. Ploughing thru from a diff angle. 0-20 cm BGS.

①
people always asking what the phenomenon is? ya what's going on?

Shaphanille Shards

Production flake of obsid. shards

Shaphanille Shards

2/28/92

P-42-48-32

426K/99 2.8 → 3.3 m west of west ~~side~~ side of axial trench. 60-90 cm BGS. Coming in perpendicularly to ~~the~~ behind gastrointestinal -

426K/100 50 cm North of north ~~side~~ side of preparation. Anusol digging in ~~perpendicularly~~ ^{parallel w/} the wall - revealing inside of structure. 1m² - 0-20 cm BGS.

426K/101 Moving down - same lot as 426K/100 - 1m² North of corner of preparation H. following corner of prep H around and about - 20-60 cm BGS.

426K/101 100 cm North, parallel with axial trench.

50 cm west of west corner of preparation H. 0-1 m North of corner. Wall is called Irregularity N/S orientation.

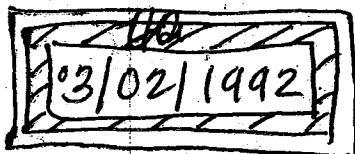

426K/102 Buenos dias - como estas? Monday morning:

uqah. Pedro and the other guy. → 0-20 cm BGS. 1-2 m

North of prep H western corner. following Irregularity

1m North. Approximately 50 cm (extending) west in front of Irregularity. Parallel w/ axial trench.

0-3 m west of west wall of axial trench.

426K/103 20-40 cm BGS. parallel with Anusol - ~~reve~~ revealing inside of structure on north side. 0-1 m

~~east~~ east of east wall of axial trench. ~~app~~ lot extends approximately 50 cm north of the wall. 1m². Root has disturbed the tumble/wall structure. ~~Can't remove one rock which is clearly tumble~~ Removed it.

426K/104 20-40 cm BGS. Removing some tumble in front of Irregularity. 1-2 m North of prep H corner.

Continuing to remove dirt down in front of, west of wall. Extends Approximately 50 cm west of wall -

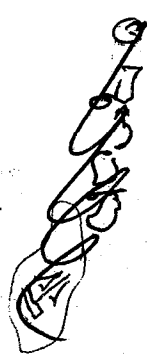

p 42.48.33

3/02/92

426K/105

0-20 cm BGS. 1-2 m east of east ^{axial} trench

wall. North side of Anusol - parallel with it. Moving ahead a meter, revealing inner structure of the mound. Drilled schist piece rectangular. Apprx 34 x 13 cm. w/ Hole ~~at one end in center~~ between 27 cm and 6 cm. Center. BIG.

426K/106

40-60 cm BGS. 1-2 m north of ~~SW~~ corner

of prep H. following Irregularity north. lot extends 50 cm west of in front of wall. Removing tumble. ~~found corner~~

426K/107

0-~~20~~⁴⁰ cm BGS. 2-3 m N of SW corner of prep H.

Following Irregularity N. lot extends 50 cm west of pierced front line of wall. — 1m².

426K/108

Turning north, found corner of the Northern side of Anusol. will follow 90° to the north. 1m². 0-20 cm BGS. 50 → 1.5 cm North of front line of N side of Anusol. Doing the Summit thing. Cleaning dirt from the rocks to get a better view.

426K/109

40-60 cm BGS. 2-3 m N of SW corner of prep H. 50 cm west in front of Irregularity N.

426K/110

~~Approaching~~ Irregularity from the ~~S~~ North end, along gastrointestinal line. 0-20 cm BGS, heading in a Southern direction.

426K/111

0-1 m east of east wall of axial trench. going along the South side of Anusol wall. following to the east. 0-20 cm BGS. Temporarily gave up on dealing with the summit. lot extends 40 cm south of the South side of Anusol. 1m² —

426K/112

ble they are so thick, what we in fact reveal is the mid section of the wall, pulling tumble off of Irregularity. 50 cm E/W along length of wall. 20-60 cm BGS. Revealing nice wall underneath.

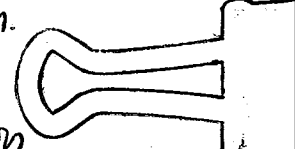

3/3/92

[3/3/1992]

80
154
320
360
P. 92.48:34

3/3/92

426K/113

1-2 m East of East side of axial trench. 0-40 cm BGS. following the ~~S~~ side of Anusol to the E. We really need to understand how these walls were built. The structures that we are revealing can't be understood in terms of their archaic/prehistoric appearance. The tumble probably did not fall from much higher than the height of the wall today. It seems more likely to me that what we are actually revealing is the middle of the wall, rather than its archaic exterior. That's why finding the base is so important, not only in terms of first occupation, or actual occupation level, but also in terms of the Actual/Original exterior face of the wall. Further, I think that it is possible that Bajaraque was built from the ground, base of the outside wall, up. So that the outside of the walls were stuccoed in bajaraque. — This would help explain the size of the int interior of the structure. Perhaps the walls, covered in schist were benches along the interior wall of the structure, rather than simply walls.

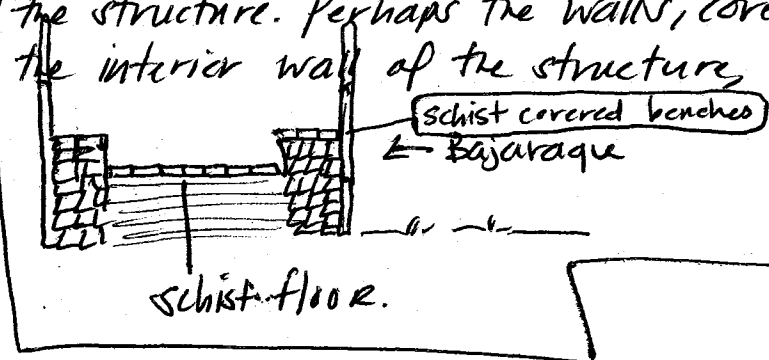

426K/114

Following Irregularity to the North. Chopping through the last section between Irreg. and Gastrointestinalis. Approximately 30 cm N/S and 80 cm E/W. 3.7 → 4.0 m South of SW corner of Irregularity and prep H. 0-60 cm BGS.

Empty Lot

426K/115

Removing tumble from the exterior of Southern Montezumas reveng. 0-2 m north of southeastern corner. 0-60 cm BGS to level w/ trench.

426K/116

Moving in a ~~western~~ eastern direction 1m² - Going through the last section of dirt between Montezumas and Anusol. On southern side of Anusol, 50 cm south of back of Wall. 0-20 cm BGS.

Empty

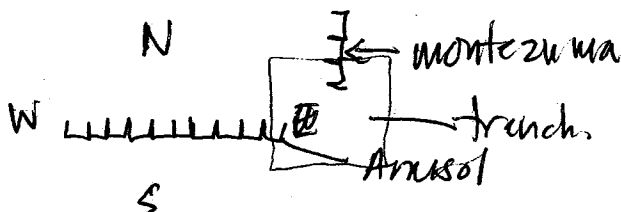

3/3/92

p92.48.35

426K/117

Pedro and Alexander have been set to work on the ~~Western~~ side of Eastern side of Anusol wall. 0-80 cm BGS. lot is currently 1m² But extends approximately 50 cm south of Anusol. Found some particularly Organic baharague

426K/118

Near the base of Anusol, approx 10 cm west of West axial trench 1m² 0-20 cm BGS. 1m² at the juncture SE wall approx at 75 cm BGS. juncture, corner of structure where Anusol and Montezuma's meet. Doing the summit thing.

Shells / Ocarina fragment /

426K/119

3/4/92

Pedro = Alexander - on Eastern Western side of trench. 1-2 m west of West An wall of axial trench. 0-20 cm BGS. Anusol, S side.

* Over in Larinia's trench, we found some baharague stuck in the wall. Bueno evidencia.

426K/120

1-2 m west of SE corner of Montezuma and prep.H. Clearing some of the summit. 0-20 cm BGS. 1m².

426K/121

~~60 cm~~ 70 cm N/S. 60 cm E/W. 0-20 cm BGS. following wall mats been exposed, possibly the Rear end of Anusol. Now following it along to the south. Approx Trench is approx 40 cm East of the face of the wall.

426K/122

Removing Huge Rock from a confusing Corner where Irregularity and Gastrointestinalis may come together with Hemmerhoid

Gastro

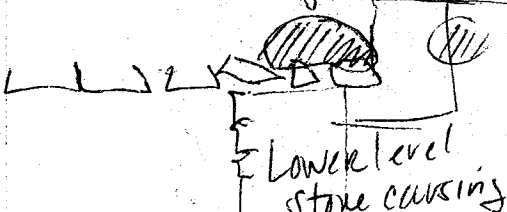

= Rock removed cleaning around where the rock was ~~excavating~~ Roots found, large enough to have disturbed coursing.

Slightly cut block. Probably limestone but more siliceous. 44 x 30 x 24 cm Just sitting on the corner where 3 walls may meet. Excavated 0-30 cm BGS

✓ 426 K/122 continued ...

P. 92.48.36

Shards Excavation 0-30 cm BGS. 40 cm E/W. x 40 cm N/S. At approximately 2.13 m South of the NE corner of Proctologist point.

Shards ✓ 426 K/123 60 cm x 60 cm Square. 2.13 m South of the NE corner just found a scorpion. of Proctologist point. ~~50-100~~ 50-100 cm BGS. Possible corner of irregularity and ~~gastrointestinal~~ ~~Metate fragment~~ Huge bowl fragment, Shards

426 K/124 Clearing down 20 more cm's. ~~80-100~~ 80-100 cm BGS. Small 40 cm ~~E/W~~ E/W x 1.2 m N/S. in front of wall (to West)

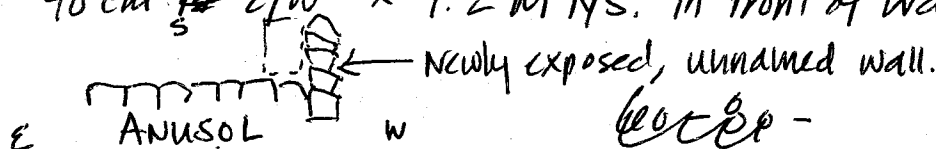

✓ 426 K/125 Following North side of Anusol to the east. West.

Shards. 0-1 m west of west side of axial trench. 0-20 cm BGS. but extends approximately 40 cm to the N of Anusol's N side.

~~426 K/126 Same as 426 K/123. 80-100 cm BGS~~

426 K/127 1 m NS x 70 cm E/W. 0-20 cm BGS.

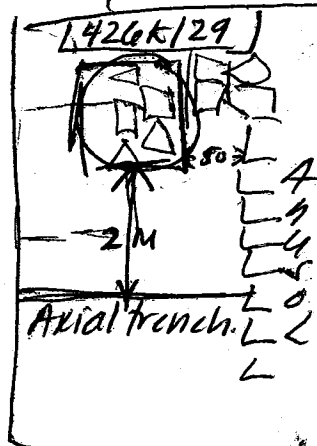
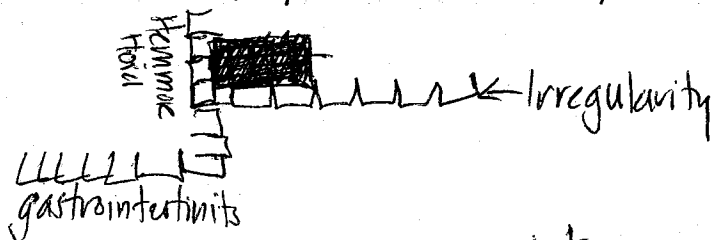

426 K/128 Found a small wall running parallel with the axial trench. Approximately 25 cm west of the west wall of the axial trench. Lot is 30 cm North of the North side of Anusol wall. 1m². 0-20 cm BGS.

426 K/129 Removing roots from ~~the~~ an Area approx 2 m East of east side of axial trench and ~~the~~ 50 cm N of N side of Anusol

ELIZABETH

Gypsy King

P. 92 48 37

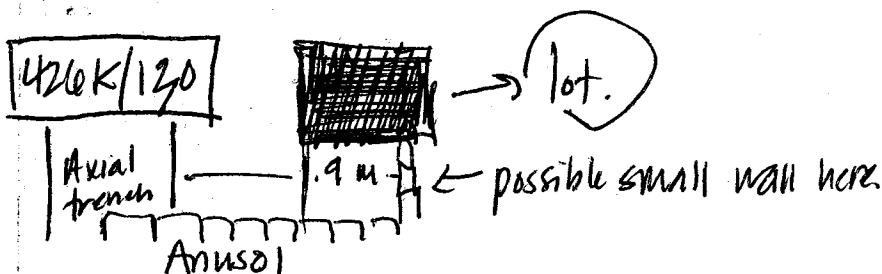

40-60 cm BGS. 50 cm North of the North side of Anusol wall. ~~1.10 m East of the east side of Axial trench~~ 1.10 → 2 m east of the east side of axial trench. 1 m².

~~426K/121~~

3/5/92

426K/131

Anusol, N side twds east w ~~west~~ East w/ Small abutment. No name yet.



pulling out there in Anusol b/c probably not here 80 cm ~~cm~~ x 100 cm ~~cm~~ E/W. 20-40 cm BGS. Expect to reveal small abutment line.

426K/132

Empty Lot.

Following line on ~~west~~ ^{East} side of Axial trench ~~no~~ name of small wall Abuts anusol is say no to crack.

426K/133

Dropping in in small ~~south~~ western corner on interior where small wall meets with Anusol. 50-90 cm BGS. 66 cm N/S x 72 cm E/W.

426K/134

dropping in 20 cm ~~BGS~~ more 80 x 1 m pit

Sheds. Obsidian

Where say no to crack and the interior of Anusol meet. In NE corner of interior, 80 cm E/W and 1 m N/S. 50-70 cm BGS.

426K/135

Same as 426K/134. 20 more cm Below. 70-90 cm BGS. Small band of bijaraque 25 cm ~~cm~~ Below top of Say no to Crack. A surface below that wall? Maybe prev. structure burned.

and new - say no to crack built on top

3/5/92

p. 42-48-38

426K/136

Summit thing - between Sayno to Crack and Gastro.

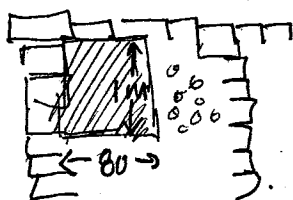

→ Hemmerhoid

to be excavated

80 x 1m rectangle to be

excavated - 80 cm E/W by 1m N/S. 0-20 cm BGS.

40 cm south of Hemmerhoid.

426K/137

1m E/W x 40 cm N/S. Small section to be excavated 0-1 m East of East side of axial trench. 50 cm North of front edge of protoqu point.

Clearing Between Hemmerhoid and protoqu point

426K/138

10 cm E/W x 40 cm N/S.

Strip being cleared 20-60 cm BGS. Possible

Rims

Wall 10 cm East of East axial trench. Removing dirt to find out.

426K/139

Meter to the right of Next meter south of

426K/136 - 1.40 m → 2.40 m S. of Front edge of Hemmerhoid. 0-20 cm BGS. Located between Sayno to Crack and Gastrointestinitis.

426K/140

pulling out 10 more cm East of 426K/138

20-60 cm BGS. Essentially same as (138), but 10 cm Easter. Peeling dirt away from large rocks. found what P. & call a balustrade.

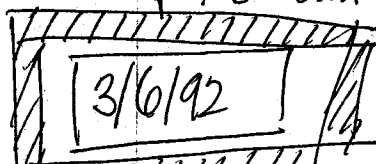

Structure
Bajaraque
Sheds

426K/141

70 cm E/W x 118 N/S. Small patch being excavated on potential balustrade. 0-118 m west of West side of West axial trench. Between Hemmerhoid and front line and Rear side of protoqu.

426K/142

Shank
Rims

Following Anusul to the bone. 1m E/W x 55 cm N/S. Small section 0-1 m East of East side of axial trench. 40 → 60 cm BGS. encountered a little wall-

3/6/92

P424839

426K/143

Small section by balustrade ^{→ on the West side of trench} 90 cm E/W x 80 cm N/S.
~~30-50 cm BGS.~~ 30-70 cm BGS.

426K/144

Same as 426K/142. Excavating to the west of a newly revealed wall that is perpendicular to Anusol. Same area 50 cm x 1 m, 20 more cm's. Wall is called Pain in the butt and is 95 cm east of east side of axial trench. 75 → 95 cm BGS.

426K/145

50 x 50 cm @ ~~20~~ level 0-10 level w/ potentially important rock. On west balustrade 1-1.5 m west of West side of axial trench. Between proctologist and Hemmichoid walls.

426K/146

50 x 50 pit dropped in corner of Anusol and Pain in the butt. Will be used to determine true base of Pain in the butt and ~~stratigraphy~~ stratigraphy for later final notes information. Pain in the butt is approximately 106 cm ~~W~~ East of East axial trench wall. N/S direction 100-120 cm BGS.

426K/147

0-40 cm BGS. Clearing last patch of dirt between 50 cm South of Anusol and ~~prep~~ between prep. H. Approx 50 cm E/W and 90 cm N/S.

426K/148

0-40 cm BGS. Continuing to clear last patch of dirt. 50 cm S of Anusol between Prep H. 80 cm E/W and 85 cm N/S.

426P/01

Dropping a ~~30~~ 30 x 50 cm test pit in front of Montezuma, 1.8 m N → 2.3 m North of the SE corner of Montezuma's and preparation H. From bottom of trench to cm ~~BGS~~ Below trench surface.

* do line level & get bases of all walls.

3/6/92.

P. 92.48.40

426K/149 On the northern side of Anusol, on the E interior small wall running N/S called burning and itching. We are following it N, approx. 65 cm N of Anusol. 65 → 1.45 m N of N side of Anusol. Approx. 70 cm E/W. 50-70 cm BGS.

426K/150 Following Burning and Itching to the N approximately 65 cm N of Anusol.

F S S
6 7 8

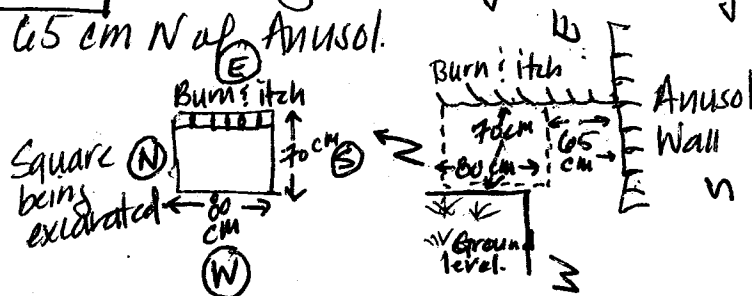

3/9/92

426K/151 Following burning and itching 1.5 m North of Anusol's N side. Summit. 80 cm NS x 1 m E/W. 0-20 cm BGS. 1.65 → 2.45 m N of N side of Anusol.

BGS.

426K/152 40 cm E/W x 80 cm NS. 20-40 cm BGS.

Incensario
bras.
sheds.

Trying to come down in front of perceived continuation of Itch and burn. 1.65 → 2.45 m N of Anusol.

426K/153 40 cm E/W x 80 cm N/S. 40-80 cm BGS.

Again, coming down in front of (west of) perceived line of Itch and burn. Moving down to get base. 1.65 → 2.45 m N of Anusol.

426K/154 Small potential Niche along line of Burn and itch. Will dig out ~~door type~~ perceived door type structure 60 cm N of North side of Anusol - 60 → 120 cm N of W anusol.

@ approx 60 cm NS x 55 cm E/W. 0-40 cm BGS.
70 55

426K/155 Same region. Pulling rocks and dirt out from the perceived door or niche in burn and itch. Clearing same 0-40 cm. But 40 → 120 cm N of W anusol N side of Anusol. 90 cm NS x 55 cm E/W. Removing many rocks.

p. 42. 48. 41

3/9/92

426P/02 Dropped a 50 cm x 50 cm test pit in front of Irregularity. total of 50 cm below trench bottom. Hopefully this will help us figure out whether the "previous occupation" rocks coincide with a stratigraphical soil change. ~~1.4 → 1.9 m North of the SW corner of Irregularity and prep H.~~

Pulling out tirstos.

Ocarina fragment (Jaguar) bajaraque.

* need data chronology from this pile of sherds, may indicate relative chronology were looking for.

3/10/92

65 → 1.15 m North of the SW corner where ~~7~~ prep H and Irregularity meet. 50 cm x 50 cm. 50 cm below trench, 123 cm BGS. Trench is 73 some odd cm BGS.

426P/03 50 x 50 in front of Irregularity - 50-70 cm below trench bottom. 20 more cm in test window. Going down to sterile.

426P/04 60 x 75 cm window in front of Gastrointestinitis to the north of small previous, earlier wall that runs perpendicular to Gastro. 65 to 140 cm North of the N edge of this wall. 0-20 cm below trench bottom, next to bajaraque

75
65
14

known window

426P/05 2 windows have become one. 0 → 140 cm North of the North edge of the small wall running perpendicular to Gastrointestinitis. 20-50 cm below trench bottom.

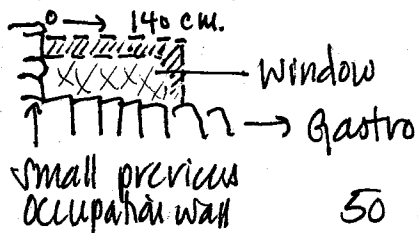

In this window were finding incredible amounts of ashy deposits. A ceramic bead and a quartzite flake. Now at approx.

50 cm below trench surface. Taking a 3 kg sample off the bottom of the trench. Pulled an ocarina fragment out of the ash. Tirstos too.

3/10/92

P. 92. 48. 42

426P/06 Same as 426P/05 but 70-90 cm Below trench bottom. Still plugging along through the ash deposit pulled out some bajawaque, bichrome fragment, and regular tectos. Very loose, fine grained grey ashy ~~ash~~ soil. Chunks of light brown baked earth, different from orange bajawaque. Shell. piece. ^{provenience}

426P/07 Same as 426P/06 but 90-110 cm Below trench bottom. Have begun to get into a very orangy soil that is probably sterile.

3/11/92 Empty Lot

426P/08 1x1 m 0-1 m south of the North end of axial trench. Window to the stratigraphy. Checking to see if ash layer is consistent in this trench. 0-20 cm below trench level.

Empty Lot

426P/09 Same as 426P/08 but 20-40 cm below trench level → moving down. Empty lot. Have moved into sterile soil and will arrest excavation at this point.

426P/10 Following pain in the Arse south, away from Anusol's s. face. 0-110 cm south of s. face of Anusol. Approx 65 cm West of West front edge of pain in the arse. Sp. a 0-20 cm ~~±~~ 65 E/W x 60 cm N/S trench following pain in the Arse.

426P/11 20-40 cm below ~~pt~~ 426P/10. following down. May be revealing more of pain in the Arse. Same provenience, just 20 cm deeper.

426P/12 0-40 cm BGS. 30 cm south of the south edge of 426P/11. Moving ~~to~~ 110-340 cm south of south front edge of Anusol.

426P/13 65 → 140 cm West of ~~the~~ south of south front edge of Anusol. 65 cm E/W. 20 more cm - (40-60) total area.

426P/14 → 50 cm E/W. Excavating niche in Hh and burn.
to level with 2nd course. Approx 40-120 cm North of the
north side of Anusol. 40-70 cm from 2nd course in Burn and Hh.
(Shards, ring base).

426P/15 / ~~15 cm~~ 120-150 cm South of the south face of
Anusol. 30 cm N/S x 40 cm E/W. ~~70 cm~~ 40-80 cm BBS
Following last section of Bismuth towards preH. Level w/ rest of the
Hh trench.

Final Notes. Maud II. p. 92. 48. 426

p. 1-25

Appendix A-1 → ~~AGB~~ A-5

Elizabeth Brown.

1FN p. 01 3/03/92 p. 12.48.426/mound II

Proctologist point.

Oriented ~~28~~ 292° West of North. Compass is set on Magnetic north. The wall appears to be the front basal. It is the first wall we encountered in the axial trench. The axial trench essentially bisects the structure. On the

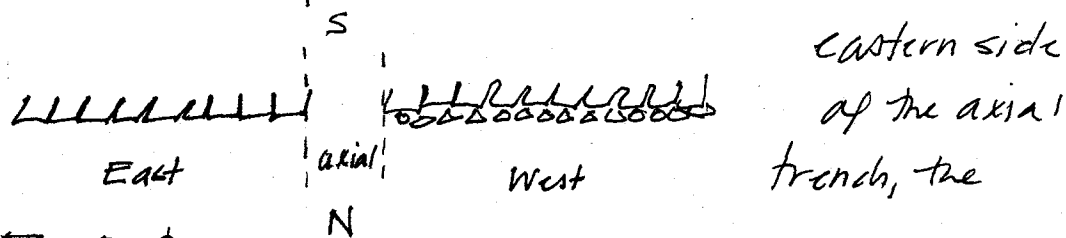

Rocks ~~are~~ on the

top most portion of the wall are large and cut to an extent.

The face of the rocks wall is clearly been shaped, although other sides of the rocks are less square. This is "typical rock  cut face with ~~other~~ ^{semicircular} other sides. All the cut faces are oriented in a Northern direction.

The uppermost course of proctologist point as it has been excavated is angled down. Clearly upper portions of the wall have tumbled. It is likely that the wall actually stood a few feet higher in ~~later~~ prehistoric times. The ~~the~~ top most course sits on top of much smaller cobbles. Top most blocks are cut while underneath is not. On average, the top course ~~is~~ consists of stones that are approximately 35-40 cm front to back (N/S) and approx. 10-15 cm up and down. Stones below this are small cobbles and clearly do not take any coursing form. Top course E/W width is approx. 30 cm E/W.

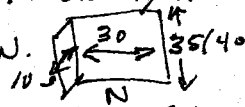

~~The Eastern side~~ The total length of the wall from corner to corner is 7.89 meters.

Axial trench 1m wide cuts E and W sides at ~~5.8~~ 4.8 meters (~~East~~ measured from ~~West~~ West to East).

On the ~~eastern~~ ^{axial trench} Western side of the ~~wall~~, the coursing is a bit different. In the top course ^{the} stones are smaller, with cut faces: less cut rear and side. Average size is 25-30 cm N/S (Back front) and approx 15-20 cm E/W. Average depth of 10 cm in 1st course.

p. 92. 48. 426 FN 3/5/92

Final notes, p. 2

The second course of stones on the Western side of proctology is more defined than that on the east. There is a clear distinction in their size and the 2nd course shows cut in front of the 1st course. 2nd course is approximately 15-20 cm more NORTH. A small bench of sorts. Side view:

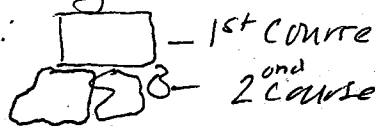

In general the size of the 2nd course is smaller when compared w/ 1st course. The stones are more like cobbles rather than cut blocks. The faces tend to be flattened, on the exterior. But my guess is that they are rounded and cobblelike on the exterior. Believe that ~~the~~ behind the second course it is more of the same.

The wall is approximately ~~62 cm BGS~~ 47 cm deep, 15 to ²⁵ 62 cm BGS. Underneath the second course is a band of cultural deposit consisting of ~~to~~ soils. a blend of silicious ^{organic} soils and cultural deposits. Cultural deposits stop at 99 cm BGS. It have test pitted down to 130 cm BGS.

Cultural stops at 99 cm BGS. We hit a organicky/silicious mix w/ no cultural remains that seems to ~~be~~ be between. 99 cm → 113 cm BGS.

113 → ~~130 cm BGS is organic/silicious blend, but~~ 113 → 125 cm BGS is more organic, darker soil. 125 → 137 becomes the silician sterile we've found in other parts of the excavation. My thinking is that Under the course of stones is a band of cultural material. → Approximately to 99 cm BGS.

Underneath this is the organic silicious, a mix of 125 → 130

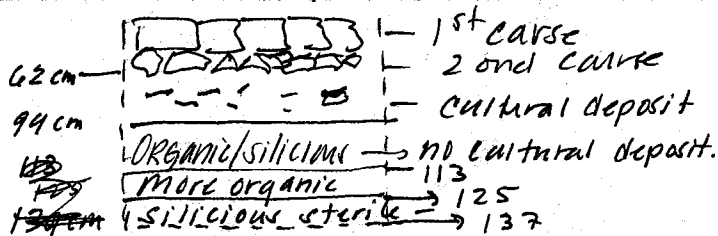

pure organic with silicious. Perhaps cultural ground surface, ORG/sil at 113 → 125 disturbed. Organic, 125 → 137 99 → 113 disturbed.

Organic down below not so effected by disturbances of culture. Silicious way down below is sterile, untouched by human completely. Proctologist point corners on the east side with Montezuma's revenge - On the west it corners with gastrointestinitis.

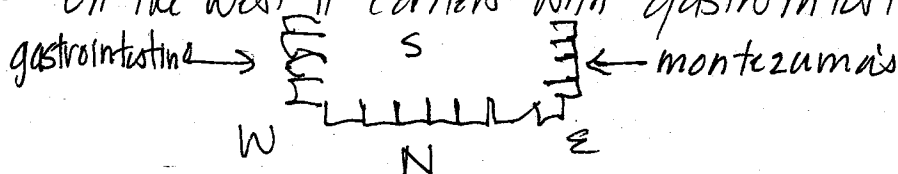

FN P. 3 / p. 42. 48. 426 / 3/5/12

Montezuma's revenge: 22° East of North. Compass is set on Magnetic North. Montezuma's revenge is the basal wall on the East side of mound II. It corners with proctology on the north side and with Preparation II on the south eastern side. The length of Montezuma's is measured from the cornerstone at proctology: Montezuma's at the NE end. The cornerstone is 51 cm N/S x 30 cm E/W x 22 cm top to bottom. The total length of Montezuma's, corner to corner is approximately 7.3 m.

Montezuma's is shaped like this

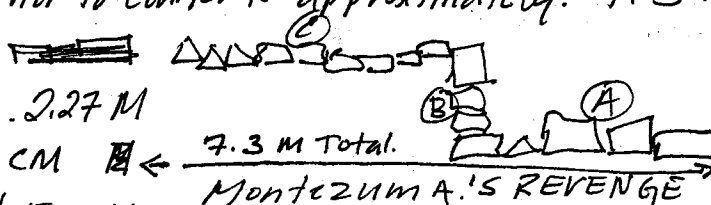

(A) - distance between N end and dip. 2.27 m

(B) - distance between E/W dip 77 cm

(C) - distance between dip and S end. 5.03 m

From now on, I must differentiate between Montezuma's N of dip and Montezuma's S of dip. Henceforth Montezuma's North = All north of dip and vice-versa for south. North end of M's is made constructed of large cut blocks as is the E/W dip. The 1st course of rocks, (top most, that is) are large. ~~They are~~ The average size is approximately $34 \times 32 \times 15$. 34 E/W x 32 N/S x 15 deep. There is a break in the 1st course, probably root disturbance. Top large by course in this section is non-existent, smaller cobbles fill the gap, possibly tumble.



tumble section w/ root disturbance.

The second course of stones in section (A) consists of large cut blocks interspersed with smaller cobbles. The cut blocks are well defined. Face measurements average approximately 32 cm [35-30] cm N/S and 15 cm deep. [10-15]

The 1st course essentially rests directly on the 2nd. My thinking is that there may have been some mud placed between courses for stability. The blocks are essentially flush w/ each other on all sides.

Below the 2nd course in section (A) are some small cobbles. No real 3rd course. Cultural deposits to 66 cm below wall. top course is 67 cm above trench surface. 2nd course begins at approx. 50 cm above trench surface and terminates @ 32 cm above trench surface.



1st course
2nd
cultural deposits.

3/6/92

P. 92.48.426 Mand II. FNP. 4

only

Montezumas revenge continued:

Will do test in front of section (A) to document soil levels and to understand how far down cultural deposits go. Cultural deposits stop at approximately 66-68 cm below the top surface of the wall. Below that, there is a soil change to a more organic and darkish - possibly indicating ~~pre-occupation, or occupation~~ surface. That last cultural depos. is 1st occupation. Organically blended in differential spots (bands too) with more silicious soils w/ cultural stuff. Organicky extends from 66 → bottom of test pit at ~~91~~ 91 cm below surface of wall.

Section (B) contains the dip section of Montezumas - ~~run~~ runs s/w direction, on compass, is 116° East of South. Top view.

The cornerstone between (A) and (B) has another

cut course block underneath it. (B) generally consists of arguably unshaped large cobbles. → The stones are of various sizes, ranging from 20×15 cm faces to 2×3 faces.



Section (C) is a tumbling and fallen row of medium sized cut blocks in the first course. From beginning of (C) at 2.2 m south of NE corner of Montezumas and proctologist, to approximately 3.7 m (1.5 m total), the 1st course is fairly straight, not tumbling. From 3.7 → 5 m, the wall is highly unstable with the 1st course clearing ~~and~~ clearly slanted a good 15° - 20° in front of its base. From 5 → 7.3 m at the end of Montezumas, the wall no longer has the 1st course - which had tumbled and was removed during excavation. The second course of stones from 2.2 → 5 m is consistent with what has been exposed as second 1st course during excavation.

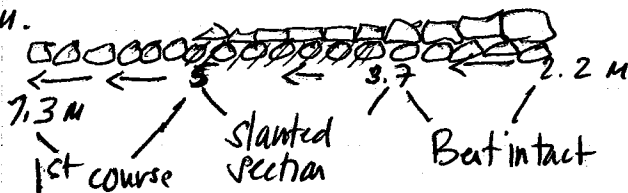

1st course tumbled? partially removed during excavation due to instability.

2nd course in section is med cobbles average size is about 15 cm w/s by 12 cm depth. Consistent throughout.

1st course - 0-¹⁵ cm below top of wall. 2nd course 15-25 cm below top.

2nd course and below is mixed with cultural deposits and very small cobbles.

FN p. 05

~~FN p. 92-48 p.~~

3/6/92

p. 92-48-426



Dropped a small test pit in front of Montezuma's, 1.8 M N of the Southeastern corner where M meets prep H. From trench surface to 50 cm down. Finding bajuraque, ceramic fragments and general evidence of cultural occupation down to 80 cm below top of Montezuma's.

Then, ~~one~~ ^{small} below, ~~no~~ evidence of cultural stuff. Nor are there any. Below 80 cm below the top of Montezuma's, there is a slight soil change. To a darker more organic looking soil.

In all, Montezuma's revenge seems to be sitting on other cultural material. Indicating perhaps that there ~~were~~ ^{were} in fact several occupations of this site. There are cultural deposits both within and just below the wall, to several 40-cm below the wall.

Listo

15
32
4721
2 | 42

PREPARATION H.

Wall Running in an East West direction
118° East of South. Preparation H meets with

Montezuma's revenge on the SE side and with irregularity at the South Western side. It has been bisected by the axial trench. Preparation H seems to be the basal wall on the Southern side. Perhaps a small walled in area - b/c I'm not so sure that. Preparation H is approximately 7 m long - measured to its furthest point which extends beyond its intersection with irregularity. Meets with axial trench at approximately 3.5 → 4.5 m E. West of SE corner of Montezuma's; prep H's meeting. The wall extends approximately 52-~~to~~ cm above trench level. The first course of the wall consists of medium sized & face cut blocks. - not as well defined as those in Sections A and B of Montezuma's - Very similar to section C of Montezuma's. Nice 2nd level cornerstone at intersection of Montezuma's and Preparation H.

Double coursing continues from corner of SE corner to approximately 1.2 m West of SE corner. 1st course in this section is approximately (mean) 12 cm thick (deep)

The range is 8 → 14 cm. In terms of width & W, the average size is, 18-~~25~~ 32
Width NS, ranges 15 - 32 w/ a mean of about 23.5 cm. Range. mean Range

The second course in the first meter is approximately 20-26 cm deep. Large face cut cobbles. Again, beyond 1st meter of corner of prep and Montezuma's, there is no real 2nd course. The second course picks up again at →

FN p. 06

3/9/92

p. 92. 48. 46

6.5 m west of prep H: Montezuma ~~SE~~ SE corner.

2nd course is only apparent for 50 cm → where Irregularity and prep H meet. Interesting that only at the corners is there a 2nd level.

Underneath the entire distance of preparation H are cultural deposits, there is a discernable band ~~cm below~~ 29 to 34 cm below the 1st

course. off the southern edge of (Rear edge) of the structure is what appears to be a midden deposit. → lots of sherds. ~~and~~ A soil flotation sample has been taken from this region. In the profile of the axial

trench this midden takes on a triangular shape. It is common for middens to be found off the backs of the structures in the Naco Valley.



Abutment →
one coming up against another
Junction →
(interdigitate masonry)

Superposition →
(chronologically joined)

Irregularity

Runs in a N/S direction. Measurements begin at the Southern end.

from corner where preparation H ~~meets~~ junctions with Irregularity. The wall's total distance from this southern point to the Northern most junction with proctology point is approximately 7.3 m. Irregularity is similar to Montezuma in that it contains a dip.

The dip occurs at 5.2 m North of SW corner of Irreg and prep H.

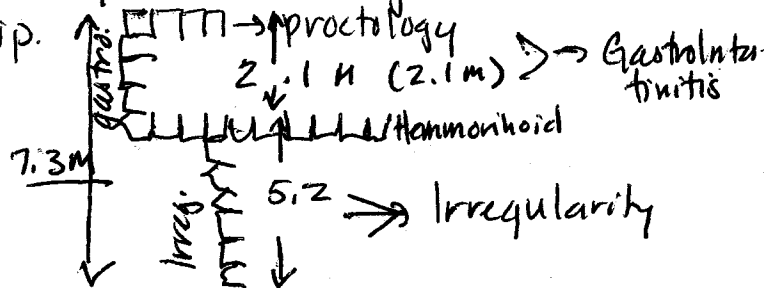

The northern section of Irregularity is actually called gastrointestinitis - it is a subset of the actual length of the wall which is overall known as Irregularity. Actually Irregularity is just 5.2 m long. It consists of several courses of stones. Pat has just told me that the rocks in this area have good cleavage, meaning that they fracture along fairly regular lines. So the limestone rocks in Irregularity may have been cut - or it is possible that they naturally occurred sort of squarish. The first course of stones is fairly irregular. At 1.3 → 3.2 m N of SW end of Irregularity, there appears to be the evidence of a previous occupation. Large cut blocks occur in this area and extend up to 60 cm west of the front edge of Irregularity. A test pit will be done to correlate soil ~~low~~ stratigraphy with the proposed "previous occupation" blocks.

FN p. 7

P. 92-48. 426 Mound 11

3/9/92

● Irregularity Continued

It is clear however that Irregularity was built over top of the previous occupation. A cross section would look something like this. There is a fairly clear bending of the course of stones, they

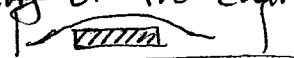

bridge up over the tops of

the previous occupation and then bend back ~~two~~ towards the ground.

Anyway, so the first level of coursing in Irregularity is fairly irregular. Not only in that there is no clear cut straight line in terms of the walls height (probably caused by differential tumbling) but also in that the coursing is not regular. It is possible that this wall was 1st built with regular cut blocks on either side and then filled w/ large and small river cobbles (Then perhaps the bottom "previous occupation"

is not in fact an earlier occupation but actually the bottom of the

● Wall as it is today — Hence the search for ^{still} banding that corresponds with the rock layers).

1st course The longest width N/S. is 42 cm, but that rock is outstanding

the range of sizes is 32 cm → 11 cm N/S. Most rocks are averaging about 22 → 25 cm wide. In terms of their depth, (up and down) the first course has a range of 10 cm to 18 cm. — a mean of about 14 cm. Most are approximately 12 → 14 cm deep.

2nd course — The 2nd course is flush with the 1st course. ~~in the~~ from 0 to

1.9 m, North of the SW corner of Irregularity the 2nd course is very distinct.

Large cut blocks somewhat curved over the "previous occupation". After 1.9

m N of SW corner, the 2nd ~~course~~ course becomes smaller and less well

defined. — Is reduced to cobbles above the previous occupation. 4 rocks make

up 2nd course of 1st 0 → 1.9 m All are cut, approx 25 cm NS and

18-20 cm deep. After 1.9 m, the rocks ~~area~~ range from 4 cm 24 cm N/S.

and 4 cm to 17 cmⁱⁿ depth. Mean N/S is about 12-15 cm, Mean depth is @ 12-15 cm.

● From 2 → 3.4 m ~~se~~ N of the SW corner of Irregularity there is actually a third course of rocks. Very similar to the 2nd course. Cobbles med and small sized with flattish faces. Will drop a test soil pit ~~by~~ in front of Irregularity after lunch.

FNP.08. 3/9/92. p. 42-48. 426 Maud II

- * drop test 50x50 at 40 cm → 1.4 cm North of SW corner of Irreg.
- * do Gastrointestinitis, and include description of Junction between Gastro, Irreg and Hemmerhoid.

* do line level measurements of wall heights

50x50 results → Wall, goes to approx 60 cm BGS. From there there is a 43 cm very light, kind of dusty deposit that contains cultural artifacts, tics in the profile. Soil becomes only slightly darker at 105 cm BGS. Soil change at base of "previous occupation". Goes lighter

426P/02

dropping a 50x50 cm tester for soil stratigraphy. To the right of the "previous occupation" blocks in front of (to west) Irregularity. Hopefully the test pit 50 cm below trench level will

yield stratigraphical information. ~~426P/02~~ 1.15 m North of the SW corner of Irregularity and prep prep preparation H. Notes also in p. 48 & p. 42-48-41 65 cm → 1.15 m N of SW corner of prep and Irreg.

→ Irregularity.

The dip that comes between Irregularity and Gastrointestinitis seems to be the natural extension of ~~preparation~~ Hemmerhoid Hill.

The Walls, ~~Hemmerhoid~~ Hemmerhoids

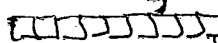

→ Hemmerhoid

backsides and Irregularity seem to junction. That is

they mesh. A course of large rocks and then a layer of mud and schist pieces ~~for a while~~ or other

small, very flat Rocks followed by another course of larger stones?

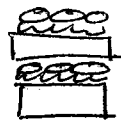

Its possible. Anyway its my contention that Gastro, Hemmerhoid and Irregularity were all built at the same time.

Hemmerhoid extends approximately 66 cm west (perpendicular)

West to Irregularity - Then corners with Gastrointestinitis. ~~Gastrointestinitis~~ Hemmerhoid extension has about 3 courses of rocks. Large cut face w/ smaller stones coursed in between.

1st course	0-15 cm	20-45
2nd	20-45 cm	
3rd.	53-70 cm	

Again, courses are

seem to be separated by courses of small cobbles and mud.

Gastrointestinitis

Extends North from its corner with hemmerhoid.

Gastro is approximately 2.3 m in length. from Corner w/ Hemmerhoid to North West equina at preatology point. Gastro runs in essentially a N/S direction, 26° East of North. w/ compass set on Magnetic North.

Rocks in the 1st course range from N/S approx N/S 52 cm to 14 cm. Most

FNP9 3/9/92 Mound 11 p. 92.48-426

average cut at about 22-26 cm NS. Their measurements

E/W range from 14 cm to 36 cm E/W. They're mostly medium sized as said before and most hit a mean distance E/W of about 24 cm. There are 2 courses of ~~small~~ medium sized rocks. Some a bit larger or smaller, mostly medium sized semi-cut blockish shapes.

2nd course rocks are averaging 20 cm up and down. 2nd course is separated from the 1st course by a row of ~~smaller~~ small rocks, probably packed in with mud. Approximately 10 cm below 1st course is the 2nd course. Anyway, so the 2nd course is about 20 cm up and down, flat faced medium sized cobbles with N/S is ~~cm~~ ranges from 24 cm to 32 cm. Most mean cut at about ~~28 cm~~ 28 cm. Underneath and interspersed with the large cut blocks in the 2nd course are small 4cm x 8cm cobbles. Underneath the 2nd course also, is a cm deposit layer of cultural material. In

the wall profile, we have sherds and splinters of bajaraque.

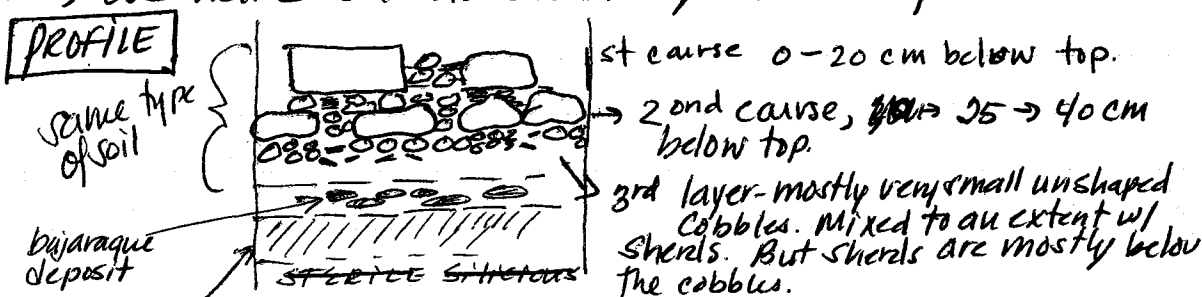

Mixed bag. Siliceous sterile stuff and more organic soil found just above.

The bajaraque deposit is approximately 10 cm wide. It is below any cultural remains, and level with the top of a stone wall running perpendicular to Gastrophysa in an E/W direction.

close up profile

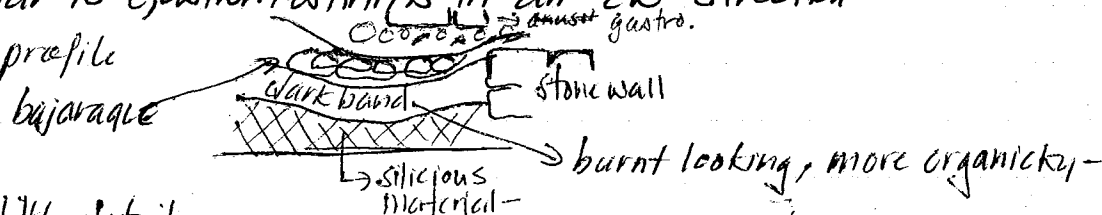

Interesting little detail.

Bajaraque lens w/ convex concave organic lens w/ siliceous loam underneath.

Will follow this down and out

Gastro - to 50 cm below top of wall

Cultural - 48-58 cm below top of wall

bajaraque - 58-64 cm below top of wall

dark/organic lens - 64-78 cm below top of wall

siliceous loam - 78-85 (bottom of trench).

alluvial
stuff.

FN p.10 3/9/92 Mound 11 p-92-48 426.

Taking the 50 x 50 down another 20 cm. - 50 x 50 in notes,
p-92 48.41. Trying to bring it down to sterile. [426p/03]
Will also chop & widen window in front of gastroutestnitis, ~~and~~
where the bajavique lens is.

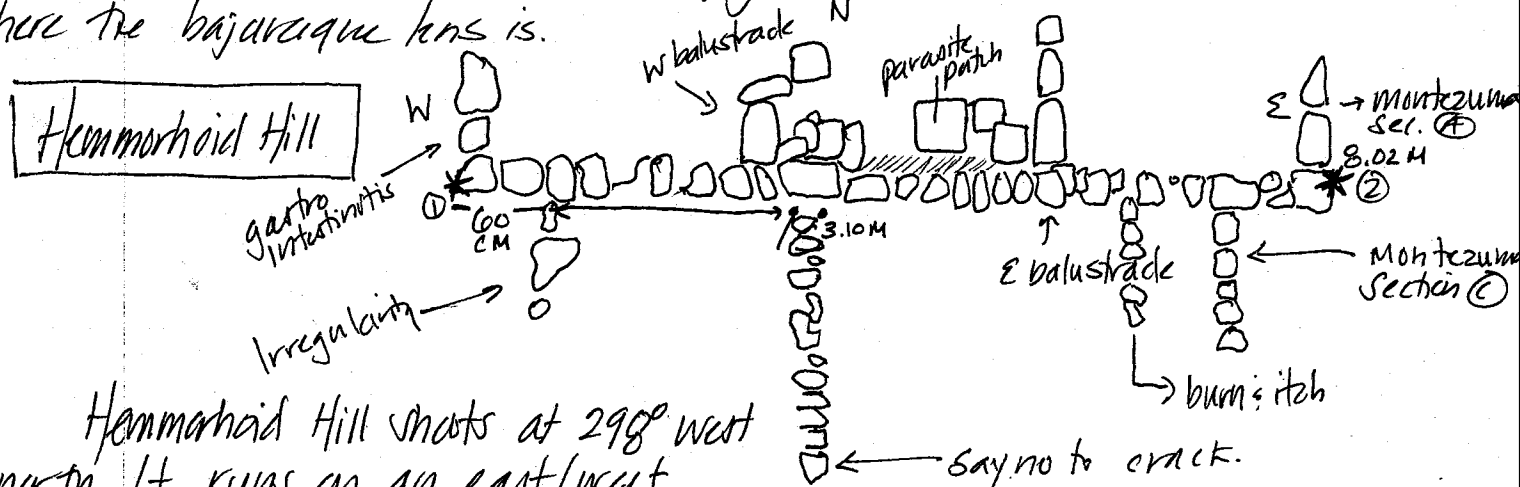

Hemmarhoid Hill shoots at 298° west
of north. It runs on an east/west

axis. (The compass was set on magnetic north for the reading. The entire length
of the wall, as measured from the west side ~~by~~ where Hemmarhoid
junctions with Gastroutestnitis (* marks where measurements were taken).
to the far east on side where hemmarhoid ^{has a} junctions with Montezuma's revenge.
The total distance of the wall measures approximately 8.02 M. From point ①
measurement to ② Hemmarhoid is joined w/ Gastro. ~~and~~ It intersects ~~at~~
Irregularity at 60 cm east of West measuring point. The wall continues to approximately
where the axial trench was placed where it meets a balustrade on the N side
and 'Say no to crack' on the ~~west~~ south side. This point is 3.10 M East of West
measuring point (end of Hemmarhoid). The wall then meets with the eastern
balustrade on the North side at approximately 4.8 meters east of west end.
The wall junctions w/ 'burn and itch' at approximately 5.7 m east of West end.
And then continues to meet w/ section ② of Montezuma's at approximately
7.3 m east of west datum. Finally, Hemmarhoid becomes section ② of
Montezuma's and terminates at approximately 8.02 M east of West
datum.

Rock size and coursing in Hemmarhoid are fairly consistent throughout
the wall. Distance (width East/West) has a range of 10 to 32 cm. with most
rocks falling in the mean range of 22-24 cm wide. The first course has tumbled
in some areas - It is not really continuous the entire length of the wall. Where it

3/10/92.

does occur, however it is approximately 0-20/22 cm from the top of the wall. This first course is followed by a 9-10 cm layer of dirt and cobbles. The cobbles in this between courses section ~~are very~~ are small, averaging 4×6 cm. Uncut.

After 20-30 cm below top of wall, there are

mixed with larger cut cobbles. — medium sized at about 8×18 cm

there are sort of differentially mixed for 40 cm, extending total from about 30-70 cm below top of wall. From 70-85 cm

is a layer of more medium sized stones 10×15 cm. with cut flaws intermixed with more cobbles and dirt. The apparent layering of the wall ends at approximately 90 cm ~~between~~ below the top of the wall.

Things are somewhat different, however between 2.6-5.3 m east of west datum where hemmarhoid junctions with the east and west balustrade.

Depth measurements taken from top of 1st course of Hemmarhoid Hill

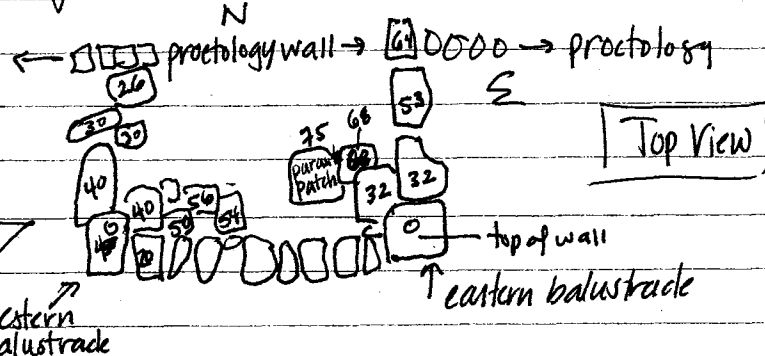

View (profile) facing towards the south, facing Hemmarhoid Shanking in North end of axial trench.

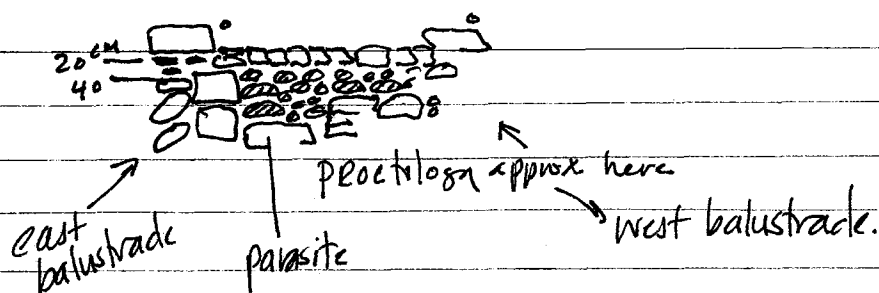

After this confusing portion of Hemmarhoid, from 5.3 to 8.02 at the Hemmarhoid's termination at the east side, the wall is quite similar to the stretch between 0 and 5.3 m east of west datum point. See description above for more information.

FN p. 12

3/90/92

Mound 11

P. 92-48.4/26

The Balustrades

The balustrades extend in a northern direction away from the northern edge of Hemmerhoid hill. There is an east and west balustrade, both consist of large cut blocks running in a north/south axis. The balustrades span the distance between Hemmerhoid and proctology point.

[Eastern balustrade] - Extends north from the front edge of Hemmerhoid 1.79 meters to the front edge of proctology. It is my contention that the 3 were built at the same time b/c they all junction, that is, mesh together. There are a total of 3 rocks in the 1st course of eastern balustrade, #1 is 65 cm #2 is 80 → 1.35 m #3 is 1.5-1.8 m

Hemmerhoid

[20° East of North]

Compass set on magnetic North. 20° East of North

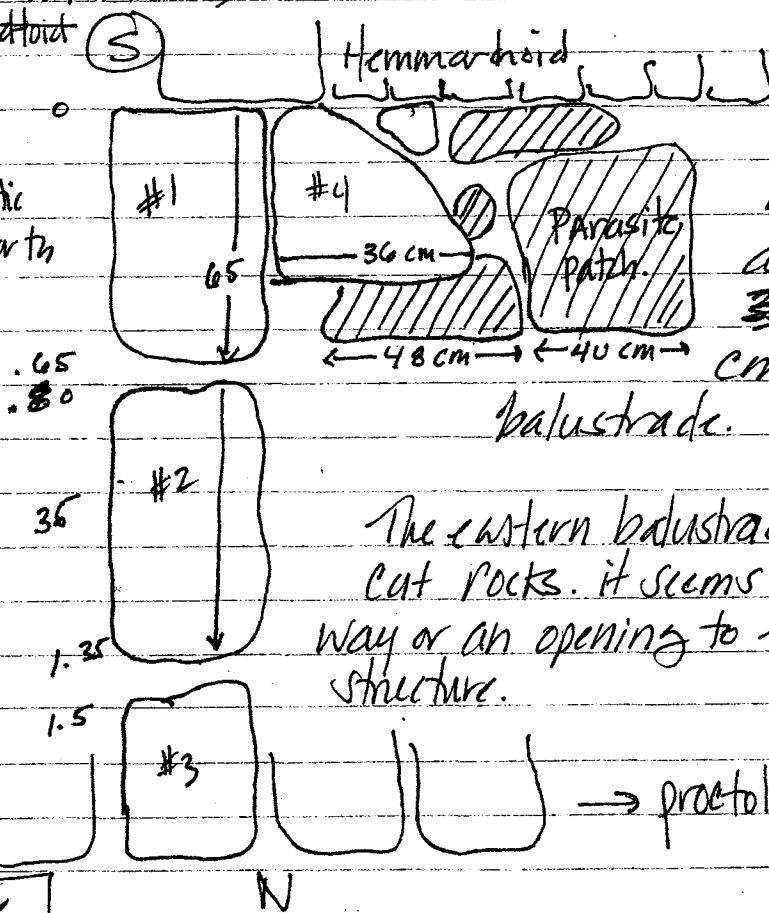
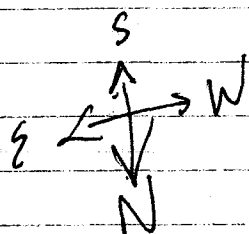

The shaded rocks are at a depth approximately ~~20~~ ~~30~~ 30 cm below the balustrade.

The eastern balustrade contains large cut rocks. it seems to frame a door way or an opening to the summit of the structure.

Western balustrade.

Compass set on magnetic North. 20° East of North.

Western balustrade extends north away from the northern edge of Hemmerhoid. to the northern edge of proctology. Total length is 0 → 1.8 m N of N edge of Hemmerhoid. The balustrade is not as clean cut as the Eastern its eastern counter part. Large rocks, though, rectangular and long lengthwise N/S they are →

FNp121 / 3/10/92 / Mound II /

The conglomeration of rocks in anusol is variable ranging from large to small. — Medium sized in the between.

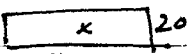
Large = 20×50 

Medium = 12×24

Small = 2×4 

Random order.

Anusol ~~is~~ was probably capped w/ schist pieces. Have found many slabs on top of it.

Anusol junctions with Pain in the arse on the East and Bismuth on the West. These walls are of similar construction, with a matrix of sizes cemented together. Underneath Anusol and Bismuth ^{are} is a couple of large cut stones. They are either foundation, or evidence of a previous occupation. Cultural material is coming out of the trench in the immediate vicinity therefore I conclude that they are most likely part of a previous occupation, although may not be part of a ~~str~~ previous structure on this spot. It is entirely possible that this site was occupied by non-foundation building (mound building) people, and that these rocks were moved from another area near here or from an abandoned casa ~~a~~ in the same complex. Anusol is built on top of these stones — slight wall banding indicates a ripple over these largish, previous blocks. It will be interesting to note their depth as compared with the cut "previous occupation" blocks off the West edge of Irregularity — If they are at the same level, perhaps we can draw some interesting parallels or conclusions from the information.

1.35 from Anusol to junction w/ prep ^{H. stretch all the way to Prep H. Symmetrical w/ Bismuth}
[Pain in the Arse] Small stretch of wall of which only a portion has been excavated. 2 reasons, it probably mimics its Symmetrical counter part, Bismuth — and we're running short on time. At any rate the wall will be described in terms of what's been uncovered. Pain in the arse runs perpendicular to the southern front edge of Anusol. It seems to abut Anusol; there is no evidence of junction — on the other hand, I can't rule it out. Pain in the Arse, the top course that is, is at a depth of approximately 40 cm below the top course of Anusol. The wall runs in a N/S direction approx. 26° East of North taken w/ a compass set on magnetic North.

Pain in the arse is 45 cm N/S. And goes to a depth of approximately 32 cm below its Top 1st course. There is a semi-distinct banding in the sample:

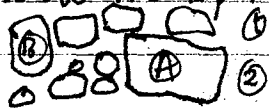

Essentially 2 courses of large rocks A & B. Mixed in with small flat faced and rounded cobbles. The trench in which

3/11/92. Mound 11. p. 92. 48. 426 FN p. 13¹⁶

pain in the arse was discovered has been dug to a depth of ~~30~~⁵⁵ cm below the top of the wall and 30 cm below the wall structure. There are cultural remains still ~~at~~ being to found at the bottom of the trench, and no real evidence of banding in the soil levels. Although, it would be necessary to dig deeper in order to be sure. The depth of the wall caving is approx. 25-30 cm. As was said earlier, the wall probably extends further to the north and may abut or junction with preparation H on the southern end.

BISMUTH

Anusol: bismuth are approximately the same height 24° East of North, on a compass that is set on magnetic North. The wall junctions with Anusol at the north side and then junctions with preparation H in the south. Its total length is approximately 1.5 m. As is typical of the wall on this side, the south side, there is no readily apparent caving. The wall seems to be a conglomeration of medium cobbles and with flat flints and small squarish cobbles packed into it. The medium sized cobbles run around 12 x 18 cm, while the smaller are 2 x 4 to 6 x 8. Bismuth runs over the "previous occupation" ~~rock~~ cut rocks that are beneath it and anusol. See drawing below: Birds Eye perspective. "previous occu" rocks shown as shaded - approx. 65 cm below top of anusol and bismuth. Bismuth stands approx. 75 cm high.

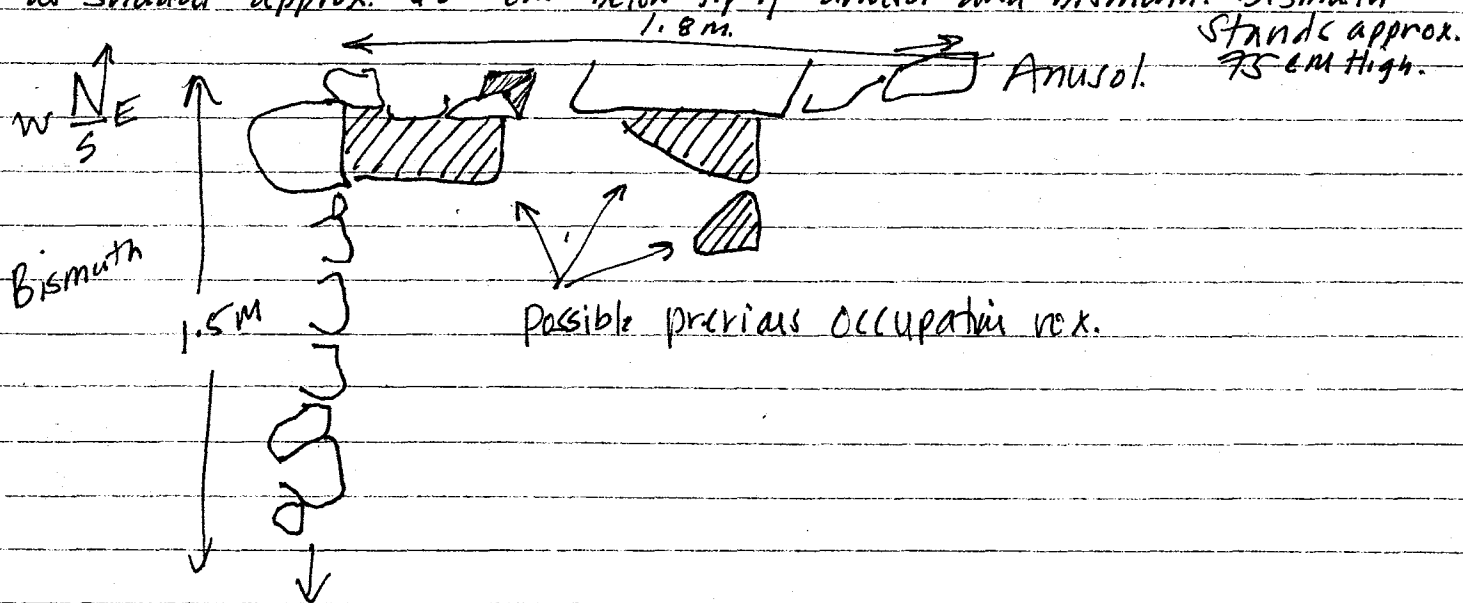

Holy SHIT

Runs in approximately a north/south direction 24° East of north. Holy shit peeks out of the trench wall, approximately 18 cm on its northernmost point and 2 cm on its southern most. See drawing (sketch).

3/11/92. 422 p. 92.48.426. Mound II. FNP. pp. 16.

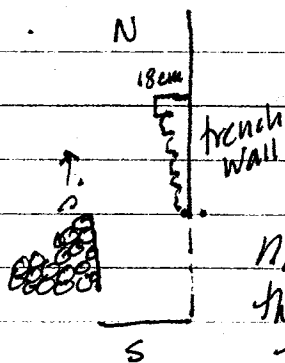

So anyway, holy shit consists of a total of 8 rocks lined up in a wall like fashion in the first course. Rock length N/S is med → 16 cm, small - 10 cm and large 32 cm there are representative measurements for holy shit.

1.85
+ 1.45
3.30

There is cultural material sticking out from underneath the wall. It is only a single course of stones approximately 14-16 cm deep. Holy shit is approximately 40 cm below ground surface. It relates only to the trench wall and does not appear to be having a relationship with the rest of structure. If ~~Dewormer~~ more time, would be good to follow it out. Holy shit comes out of the trench wall at about 1.85 m North of the south end of the axial trench. and extends total from 1.85 m N of S to 1.85 m to 3.30 m N of S end of axial trench. The wall is approximately 1.45 m total length.

Compass

DEWORMER

108° E of South - dewormer
13° E of North - poop.
14° E of N → South Central dewormer
16° E of North - dewormer NW

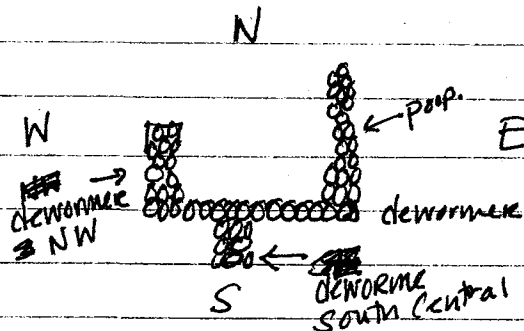

Dewormer runs in an east/west orientation. → 108° East of South to be exact, on a compass set at Magnetic North.

2.3 m measured total length of the wall. from SW corner w/ "dewormer NW" and to the Southeast corner of junction w/ poop. Dewormer consists of 2 courses of medium sized rocks with cultural material popping out underneath. The first course consists of semi-cut blocks of med/large size ranging from 49 to 12 cm E/W (width) most averaging at a happy 20-24 cm. 1st course depth averages at about 12-15 cm range is 10 cm to 20 cm. The 2nd course is a b consists of stones that are medium sized, flatish faces stick out of the side of the wall - most are averaging 10^(w) x 12^(d) cm. There are small cobbles smashed in between. Dewormer has been excavated on both sides, its over N/S width is approximately 40 cm. Its overall depth is approx. 28 cm from top to bottom. SE dewormer is 80 cm → 128 cm west of east junction of dewormer and poop.

South Central dewormer

A 47 cm southward projection off of dewormer. Runs in a N/S direct orientation, is perpendicular to dewormer. Consists of med. and

3/11/92. Main Hall. p. 92-48-424. FNP. 1st 17.

14° 20' N Small seemingly uncut cobbles populate this small projection.

South Central dewormer E/W width is approximately 51 cm.

The overall depth of the wall is approximately 15 cm from top to bottom with cultural material poking out underneath it.

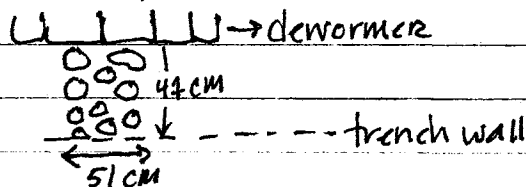

Dewormer NW Runs in a N/S orientation at 16° East of North on a compass that is set on magnetic north. The total length of the wall is approximately 1.5 m from junction w/ dewormer at Southern end to apparent end point at the north end of the wall. The wall consists of one course of large to semi cut blocks. 3 large blocks.

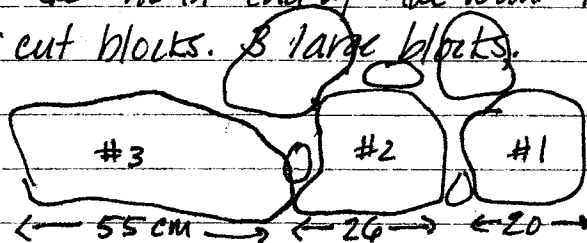

42 cm The wall is approx. 42 cm thick, 2 rows of stones. 2nd Row, towards east is smaller stones.

The

Overall depth of the wall is approx. 18 cm - relatively small. It is likely, or at least it's possible that these 'dewormer' walls and 'poop' were cubby storage type areas. What was stored, I have no idea. But they're off the back of the structure, are not for habitation and are somewhat still within the midden range off of preparation H.

Poop Runs in a NS orientation, 130° East of North / magnetic North.

Total length: 0+1.73 m measured from junction with dewormer at SE end. → to the front edge of preparation H.

Formation: Made up of randomly piled, uncut, uncarved rocks ranging from Very large at 30 cm to 46 cm → to ~~small~~ med 30 cm to 13 cm → to small 8 cm to 10 cm. Consists of limestone rocks mostly uncut.

Height: The rocks are piled approx. 25 cm high w/ cultural material underneath.

The wall has been measured all the way to its perceived intersection with preparation H. My feeling however is that the wall is not intact this long, rather I think that in excavation, we found the 'poop' line at the southern end and traced it going in a Northern direction. I believe that 'poop' actually ends at approx.

18

3/11/92. Maind II. Fr P. 18. p. 92.48.426

3.01 m North of its SE corner w/ Newmarker. My thinking is that in excavation, we arbitrarily sifted through the rubble of the structure (the tumble) and picked out the rocks that were not part of the extension. In other words that we wanted to see a line that met with preparation H, but so in removing tumble, we did not remove the rocks where we thought the line of poop ought to be. I think the line actually ends earlier than it appears to, specifically at 3.01 m N of SE corner w/ Newmarker.

The wall is approx 40-50 cm wide (E/W) and consists of 2 Huge rocks from 0-1.2 m North of SE corner. From then on, it's a mixed bag of small and medium uncut cobbles and rocks. For the most part, they are 2-3 courses deep depending on their size. Smaller cobbles approx 3-5 cm in height are in 3's. Larger 7-10 cm high rocks are in 2 courses. No real layers or coursing.

[SAYNO TO CRACK] Lies in a N/S orientation, 25° East of North. Total length is approximately 2.88 m. Measured from front edge of Hemmarhoid in the North, to the front edge of Anusol in the South. The 'Sayno' junctions w/ Hemmarhoid in the N and also junctions w/ Anusol in the S. ~~That's why~~ The measurements were taken from the junction points w/ these other walls. 'Sayno' consists of ~~an upper~~ approximately 4 courses total. The 1st course is the thickest in terms of its depth. It also contains the largest cobbles w/ flat faces facing outwards.

Top course: Medium sized cobbles w/ flat faces. Pretty well uncut. Averaging 15 cm in ~~width~~ ~~Approx~~ length (N/S). Approx 10-12 cm deep. And approx 20 cm wide (E/W). 2nd, 3rd and 4th courses are very much similar to each other. They consist of small flat faced cobbles measuring on average 10 cm length: 6 cm heightwise. The coursing is not readily apparent, it is just that 2nd, 3rd & 4th 'courses' are perceived b/c these small cobbles are stacked approx 3 deep, below the ~~top~~ topmost course. From top to bottom, the overall height of the wall is approximately 30-32 cm. Cultural material extends below this depth, and continues (probably) beyond the depth of the trench in the corner of Anusol and Sayno at 74 cm Below top of top course in Sayno.

FNP. 19. Mand II. p 42. 48. 426. 3/11/92.

Burn and Hch

N/S orientation: 26° East of North.

Burn and Hch runs approximately 2.80 M measured from ~~the~~ its junction w/ Anusol on the south side to its junction with Hemmarheid on the North side. The wall was probably laid in two courses. A 1st course which is made up of 4×8 and 2×4 cobbles with flat faus about 3 deep, ~~and~~ this course has a small ~~ben~~ break in it from ~~2.20~~ 1.5 to 2.20 (70 cm) where there is no 1st course. ~~A~~ A small niche of sorts or perhaps entry way? where only the 2nd course of stones exists.

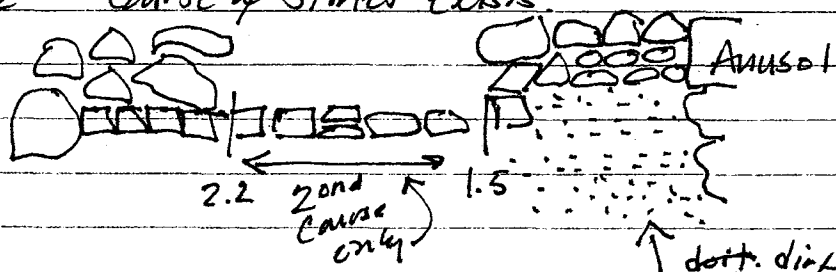

The first course extends approx. 0 \rightarrow 25 cm below the top of the wall.

2nd course. from

25 \rightarrow 42 cm Below the top portion of Burn and Hch.

On the Northern side of the niche, the cobbles forming the 1st and 2nd courses are medium sized - and there are fewer of them. They're averaging at about 10×12 to 12×15 with smalls packed in. width $4/W$

KAOPECTATE

Small, probably previous occupation wall running perpendicular to Gastromutshnitic. Bores underneath Gastrom - Rocks are medium sized and small cobbles. 2 courses - 12×24 and 15×12 . Type size: KPII is 168 to 188 cm south of the NW corner of Gastrom. and proctology. Wall is approx 20 cm thick - In association w/ soil changes, ash deposits. in test trench.

The level where soil is a blend of organic and ash would probably have been the living surface or for the inhabitants of the KAOPECTATE time.

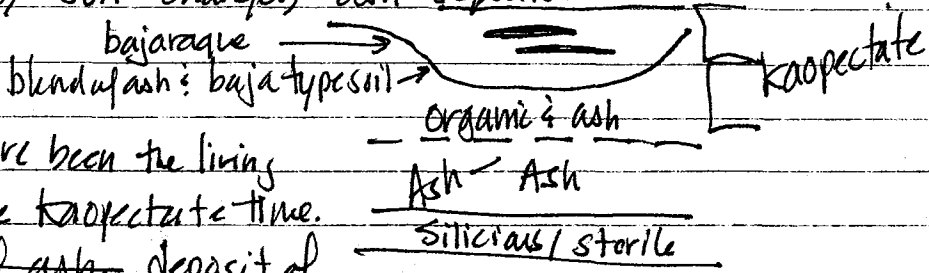

Below that is a great pile of ash - deposit of

Ash, w/ silicified underneath. Approximately a 12 cm lens of dirt between top of KAOPECTATE and bottom of Gastrom's South corner. This suggests that 2nd occupation either buried remains of 1st - or that time elapsed - or there was an organically/alluvial deposit. (Probably a mix of the latter 2) bajaraque deposits is level w/ KAOPECTATE suggesting living surface depth.

FN p. 12

Chart of wall measurements.

Mound 11 P. 92-11.424

Wall Name	Orientation	* Line level depth of wall	Wall's total distance	Construction: Stones & average sizes * width, depth, length (parallel to wall)
Proctology point	292° W of North (EW)		7.89 M	Large & medium partially cut blocks. W = 35-40 cm / D = 10-15 / L = 30 cm
Montezuma's Revenge -	22° E of N (NS)		7.3 M	Large and medium semicut stones. Average W = 34 cm, depth = 15 cm, L = 32 cm.
Preparation H.	118° E of S (EW)		7 M	W = 23.5 depth = 12 cm, L = 25 cm Medium semi-cut, flat faced stones
IRREGULARITY	23° E of N (NS)		7.8 M 5.2 M	W = 15-20 cm depth = 14 cm, L = 22-25 cm Limestones. Medium semi-cut blocks.
Epistomastinitis	26° E of N (NS)		2.3 M	Medium to Large semicut Limestones and soft white rocks. Average → W = 24 cm depth = 20 cm L = 22-26 cm
Hemmerich Hill	298° W of North (EW)		8.02 M	W = 15-20 d = 20-22 L = 22-24 cm Medium, semicut, flat faced. cut Limestone w/ white soft rocks. w/ good cleavage.
Eastern Balustrade	(NS) 20° E of North		1.79 M	Large cut blocks. Limestone W = 21-30 D = 30 cm L = 40-65 cm
Western Balustrade	20° E of North (NS)		1.8 M	Large cut semi cut blocks. W = 40 cm D = 25-30 cm L = 35-40 cm
Anusol	292° W of N (NS)		3.25 M	Large, medium and small cut and uncut Rocks. Large cut. Med = flat faced; Small packed in. Average measurements in FN p. 13 & 14.
PAIN IN THE ARSE	26° E of N (NS) (SW)		1.35 M	Conglomeration of medium & small cobbles. Cut faces (flatish). Large - L 30, D 35, W = 34 cm (2 on top & 1 on side) Medium - D = 16 cm, L = 20 cm Small - D = 2 cm L = 4-6 cm
Kaopectate	298° E West of North		70 cm	Medium semicut rocks. Limestone.

* - see notes -

* width - perpendicular to wall's orientation.
 * Line level depth all walls read from the
 same point, cm above ground surface on top
 of mound.

21
 For p. 119. Chart of Wall measurements. Mound 11 p. 92-48. 426.

Wall Name	Orientation	Line level depth	Wall's total distance	Construction: stones & sizes (average) * Width, Depth, Length (parallel/wall)
Bismuth.	24° E of N (NS)		1.5 M	Conglomeration of medium and small cobbles. Flat faced Medium = d = 12 cm, Length = 18 W = @ 15-20 cm small = d = 2-4 cm, Length = 4-6 cm
Holy shit	24° E of N (NS)		1.45 M	Med: small uncut rocks w/ flattish faces - 16x10 and 4x6. depth of vox @ 8-10 cm.
Dewormer	108° E of South. (EW)		2.3 M	2 courses of med: small stones. 2 large uncut vox in 1st 1.45 M. Average med → 20-24 cm x 12-18 small = 4x6 or 2x6.
South Central Dewormer	14° E of North (NS)		4.7 M	Med: small uncut cobbles. 4x6 and 6x10 cobbles. No coursing. Vox seem to be piled.
Dewormer NW	16° East of North		1.5 M	3 large semi-rectangular shaped blocks. 1 course. W/ 42 cm x L 55 → 20 cm. depth = 18 cm
poop	(NS) 13° East of North.		4.73 M { 3.01 M }	piled, uncut, uncoursed vox. Large - 2 large vox occupy 1st 1.45 M. Rest are Med averaging 20 cm W → 30-13 → 8-10 D → 13 25 25
Say no to Crack	25° East of North (NS)		2.88 M	Med. cobbles w/ flat faces. Average L = 15 cm, W = 12 cm, D = 20 cm D = 10-12 cm. In 1st course only. 2nd: 3rd: 4th → small 4x6 cobbles.
Burn and itzh	(NS) 26° East of North.		2.88 M	4x8 and 2x4 cobbles. Small, w/ flattish faces. No coursing but approx 3 cobbles deep all along. Break 1.5 → 2.20 @ M N of N edge of Anaxa).

Datum
28 cm
above
High pt on
Summit

Fr p. 22. Line level depth. * BDP = Below datum point.

Wall or feature	Top of wall	Bottom of wall	Depth of wall.
Say no to Crack	South end 55 cm	117 88 cm	33 cm cm
	North end 49	75	26 cm
N. Anusol. →	West end 49 cm	94 cm	45 35 cm
	East end 69 cm	117 cm	48
Burn: Hzh	South end 73 cm	117 cm	44
	North end 65 cm	93	27
Parasite patch	189	144	15
Eastern balustrade	North end 74 100	122 115	22
	South end. 114 79	122 115	36
Western balustrade	South end 79	129	50
	North end 79	109	30
proctology point	East end 100	131	31
	West end 122	146	24
Hemmer-	East end 45	140	95
hoid Hill	West end 63	149	86 86
Irregularity			
Gastrointestinals	North end 63	144 146	83
	South (where it meets w/ South 91 Proctology Hemmerhoid)	139	48
Irregularity	North end 188	120 120	12
	South end. 74	120	46
Hemmerhoid	West 74	121	47
prep H	East 100	138	38
Montezuma's (S)	South 100	138	38
Just w/ ^{prep H.} Hemmerhoid	North 91	123	32
North Montezuma	114	144	
South end	96	136	40
North end	91	143	52
Bismuth	E. end 60	162	102
South Anusol	W. end 39	116	77
Kapeotate	E end 133	161	28 cm
	West end 134	164	30 cm

John stopped
intensity
Hi

FN p. 21²³

Live Level depths. BDP. 3/13/92

p. 92-48-426

Wall or feature		top of wall	bottom of wall	total depth of wall
St. Anne's East				
Bismuth West N		50	128	78
S		60	122	62
Pain in the Arsc N		97	133	36
S		62	125	63
Constipation		69	69	69
POOP N		143	167	24
S		144	190	46
dewormer E		164	178	14
W		167	190	23
dewormer NE N→		157	171	14 cm
S→		167	190	23 cm
S.C. dewormer (Mid)		178	188	10 cm
<hr/>				
Test pit Trench depths. (BDP)				
Provenience:		top of trench.	bottom of trench	Overall depth (BTS)
Test pit (A) West of Irregularity 70-120 cm North of S front edge of prep H. 0-55 cm W of W front edge of Irreg.		137	2.30 M	.93 cm
Test pit (B) West of Gastro 0-80 cm West of Gastro. 36→ 165 m S of N corner of Gastro: proctology.		156.	2.41 M	85
Test pit (C) 110-160 cm W of West side of axial trench. 0-40 cm N of N edge of proct.		172 179	2.01 M 2.085	28.01 28 cm
Test pit (D) 0-1 M S. of N end of trench 1x1 m.		189 1.89	2.55	66 cm
Test pit (E) 85-130 cm S of NE corner of Montezuma 0-50 cm E/W of Montezuma's E of M		162	193	31
Test pit (F) 120-170 cm N of SE corner of Montezuma's. 50 cm E/W E of M		146	190	44 cm

FN p. 22^M 3/13/92 mound 11. p92.48.420

TEST PIT (B)

West of Gastrointestinitis. 0-80 cm. 36 → 165 m south of the NW corner of proctology and Gastro. ~~the~~ Total distance from bottom of test pit to the top of Gastro is approximately 1.5 m. Line level datum is set at 93 cm above trench ~~at~~ bottom. Approximately 3 cm above the ~~at~~ top of the trench. test pit.

Gastro ends at approx Line level datum will be zero from now on. The bottom of the wall, →
→ Gastrointestinitis is found at approximately 14 cm above zero. A thin layer of cultural deposit is directly underneath Gastro - extending from 14 cm above 0 to 3 cm above 0. 23 cm stretch of bayarque and bayarque colored soil approximately

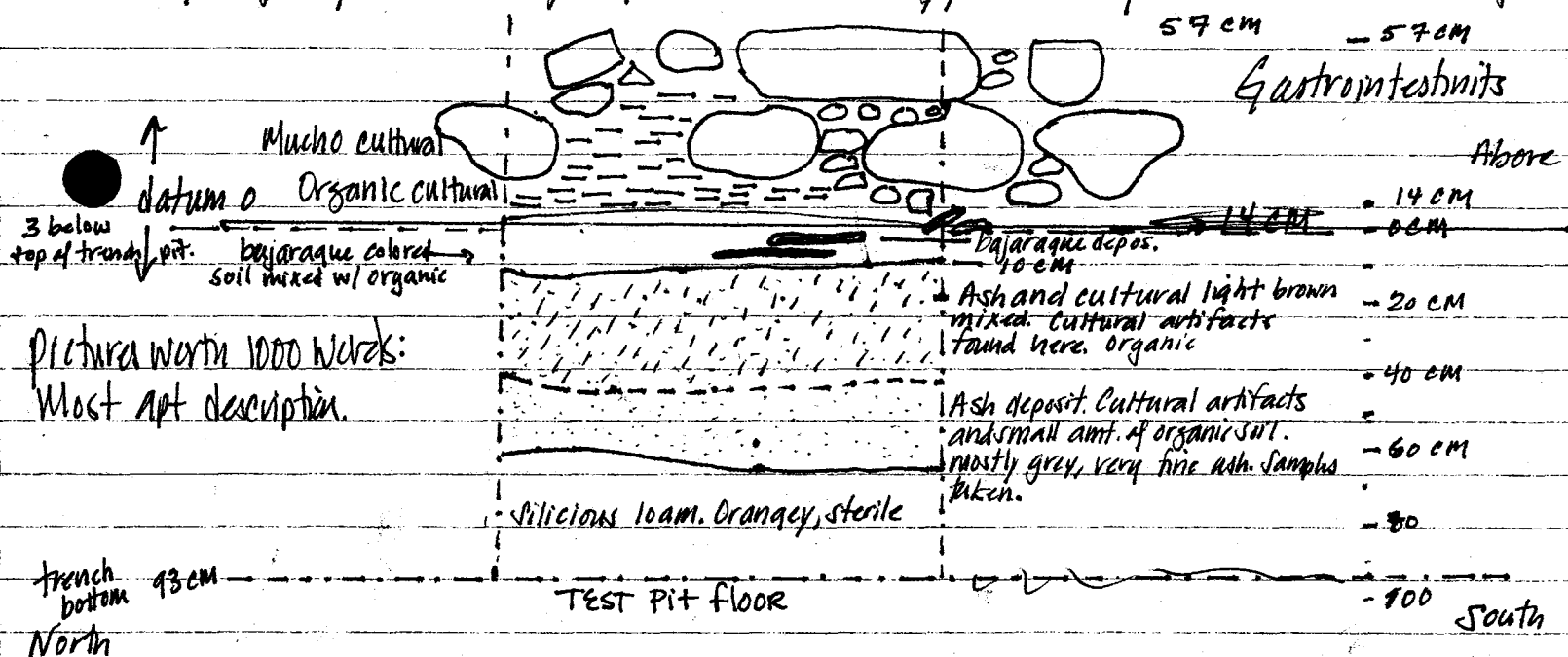

Pictures worth 1000 words:
Most apt description.

Test pit (A) West side of Irregularity 50 x 55 cm test pit. ~~1.3 m~~ .93 m deep.

* points measured Above test pit bottom * 150 cm

* 70 → 90 cm
* Probable previous acc. →

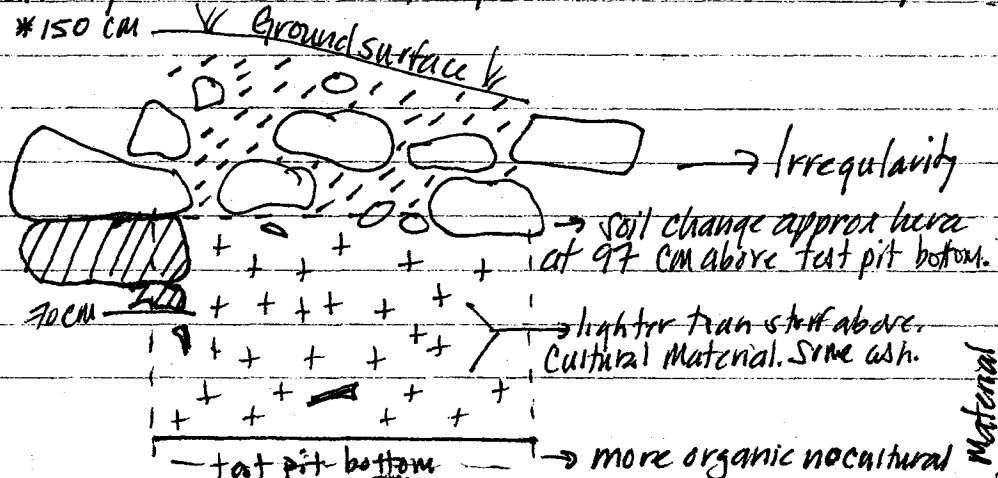

Material

25

FN p. 218 Test pit descriptions. Maind 11. P. 92. 48. 426

Test pit ① 110-160 cm West of the west side of Axial trench. 0-40 cm N of the north front edge of proctologist point. .29 m from top of pit to bottom. 40x50 window.

Cultural material all the way down. No apparent soil change.

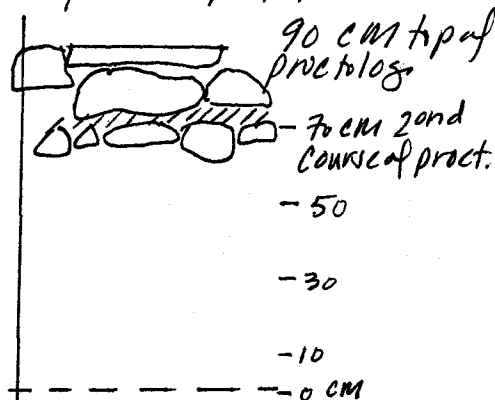

Test pit ②

0-1 m South of the north end of Axial trench. 1x1 m. 150 0-150 cm below ground surface 66 cm from top of test trench to bottom. drawing includes originally exposed axial trench. Total of 1.5 m BGS of 0-1.3 m BGS.

from top of test trench to bottom. drawing includes originally exposed axial trench. Total of 1.5 m BGS of 0-1.3 m BGS.

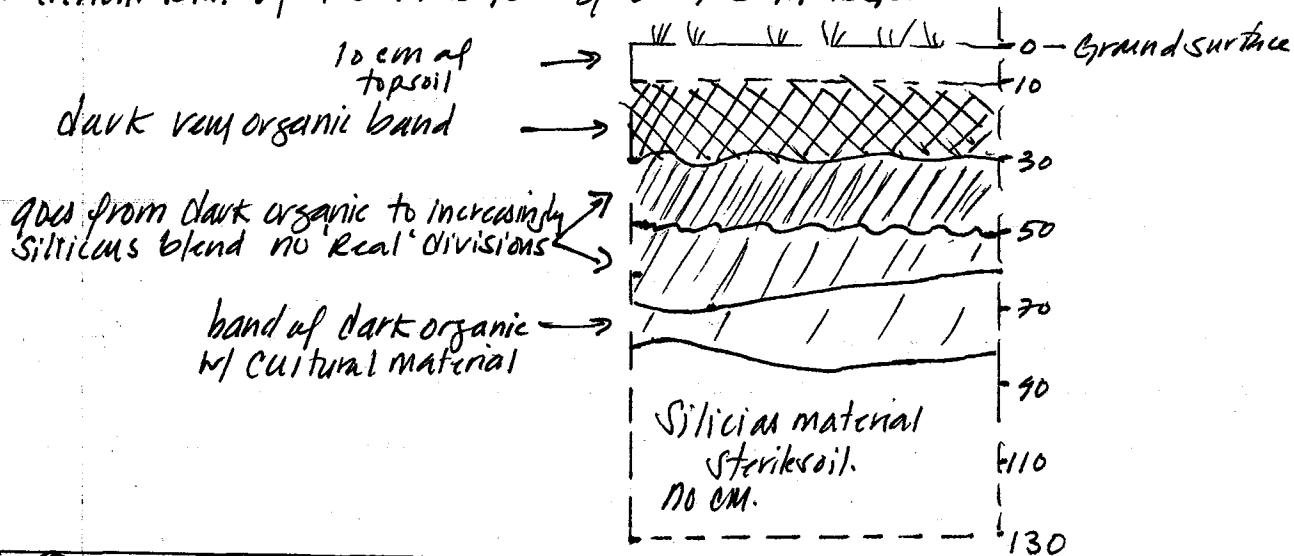

TEST PIT ③

85-130 cm S

of NE corner of Montezuma's 0-50 cm E/W of M-East of Montezuma's. 50x45 cm

Window. 0-28 cm

below trench top to bottom

test pit area

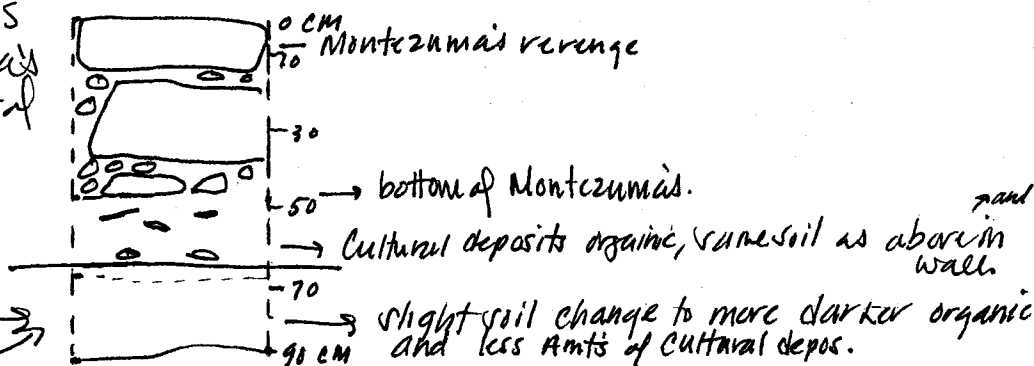

FN P. ~~20~~²¹ Maund II. p 42-48-426. Test pit descriptions
 Test pit ① 120-170 cm North of the SE corner of Montezuma's
 veranda. 40 cm N/S x 50 cm E/W. Approx 44 cm deep.

on Montezuma's Veranda →

All soil levels contain artifacts.

Cultural material totos.

trios and the rest's.

Nice cloudy day.

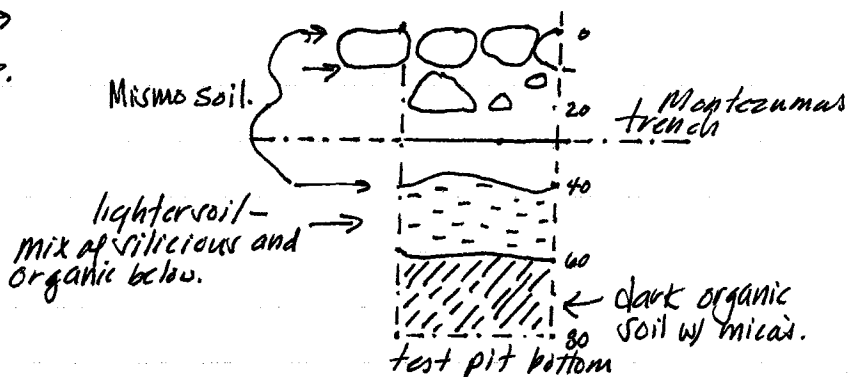

Probably the case that this structure ~~is~~ was a residence. There is
 no heavy/big indication of massive production of anything. The people who
 were here were clearly fairly successful/or had a large family. The
 structure is among the largest in the complex. Most of the walls were built at
 the same time → ~~built~~ on top of a previous construction (The site itself has
 been occupied more than once, probably twice given soil change evidence of
 irregularity and test window ~~in~~ to the west of gastrointestinalitis. ~~The~~ It seems
 as if all wall mesh except for the poop ~~down~~ the southern extension
 poop ~~down~~ abuts ~~hemmer~~ preparation H. I think that the poop, dewormer, dewormer
 NE and S.E. dewormer complex were ~~at~~ a later addition to the
 main structure. The balustrades, E & W are a symmetrical entry
 feature, probably further adding to the evidence of a fairly complex
 domestic structure - Either wealth of large family, probably both. Walls -
 especially basal Anusol and proctology & Hemmerhoid are nicely
 constructed w/ coursing and well formed cut blocks. Montezuma's
 and Irreg? Gastro are not quite as nicely formed but are fairly
 regular, have cut cornerstones and coursing. They too are
 symmetrical with a dip that coincides with the junction of Hemmerhoid
 trids. the north end. That's all folks.

Reshot

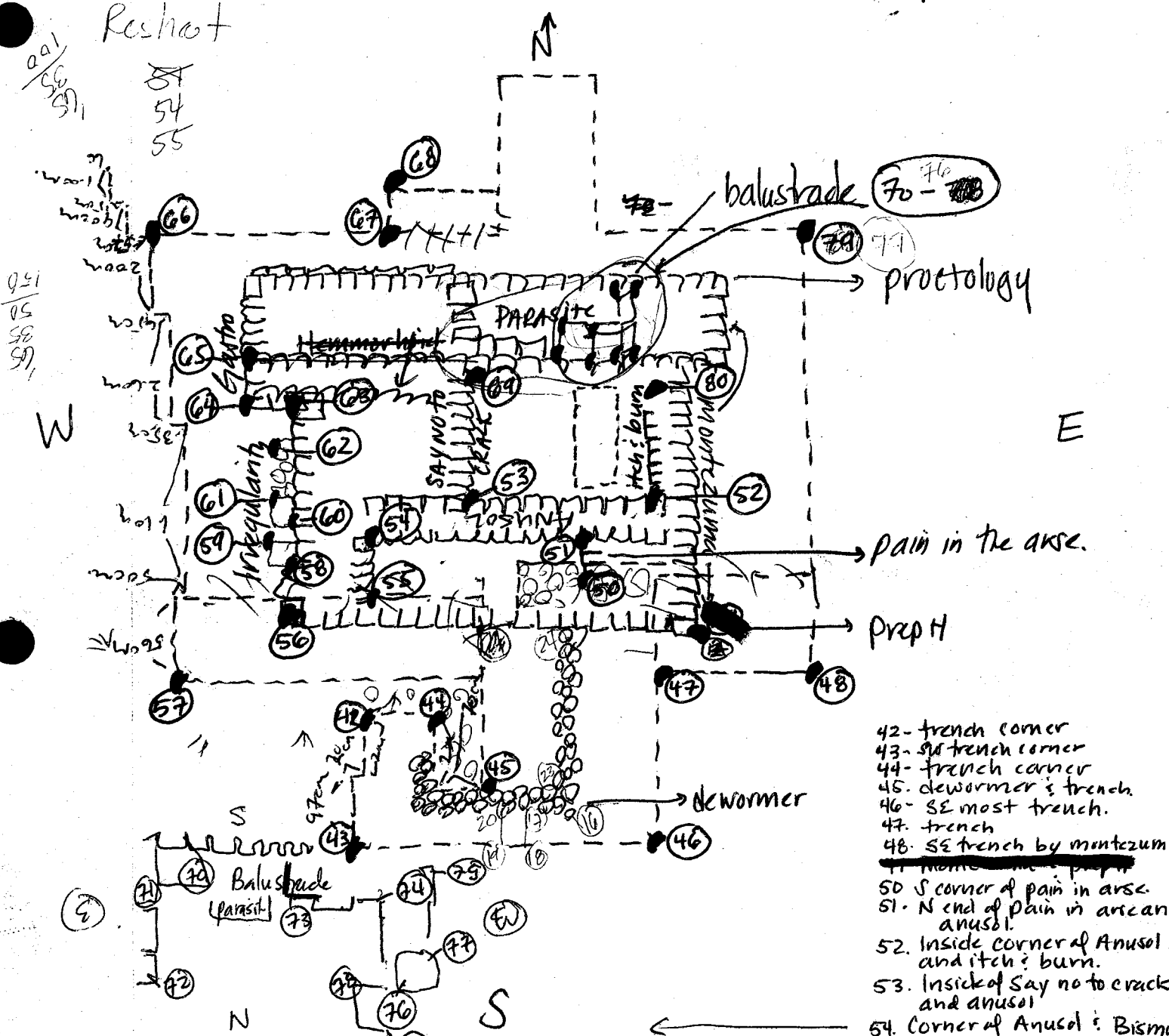

- 42- trench corner
- 43- SE trench corner
- 44- trench corner
- 45- dewormer & trench
- 46- SE most trench.
- 47- trench
- 48- SE trench by monteum
- 49- home
- 50- S corner of pain in arse.
- 51- N end of pain in arse an anal.
- 52- Inside corner of Anusol and itch & burn.
- 53- Inside of Say no to crack and anusol
- 54- Corner of Anusol & Bismu

- 55- Where bismuth and prep H meet
- 56- Corner of prep H and Irregularity
- 57- SW trench corner.
- 58- → G2 → previous occupation points
- 63- Corner stone of Gastro & Irreg & Hemmerhoid (Inside & Irreg & dip corner
- 64- Outside corner of Gastro, Irreg & Hemmerhoid Gastro & dip corner.
- 65- Gastro & Hemmerhoid Intersection
- 66- NW trench corner
- 67- trench.
- 68- trench.
- 69- Say no to crack & Hemmerhoid
- 70- Cornerstone
- 71- → 77 Balustrade

70/71 w. side - B. Balustrade.
0.25m wide.

0.53m wide. 74+76 - E. side, w Balustrade
75 - w side, " " " " " "
w 74 H. 641.

Sketch Map

Appendix A-2

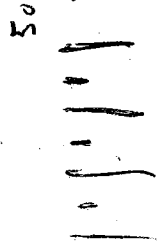

- Balustrade
- Newly revealed walls
- Outline of trench.

Squares indicate where new points should be taken.

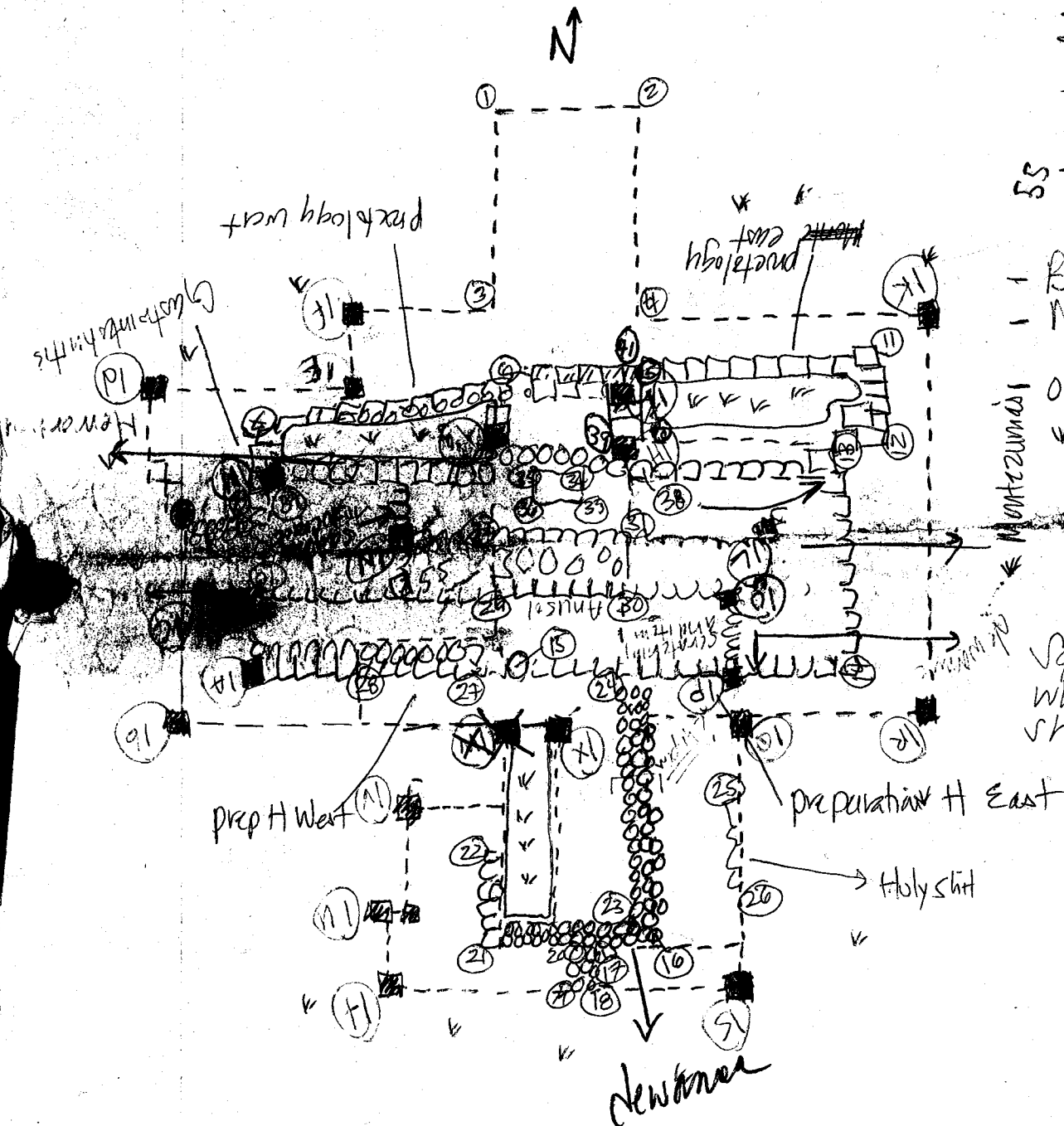

Temp Repts. points Re begin at (42) 1st # (last was 41)

Appendix A-3

DIR -
to head

1A - West corner of precip H

1b - ~~West~~ SW corner of trench

1c - Corner where Irregularity and dewarmer meet SW

1d - trench corner ~~of~~ on NW side by proct. W and Gastrointestinals

1e - trench wall NW side

1f - trench wall NW side

1g - ~~at~~ roadside W side

1H - point on E balustrade

1I - point on E balustrade

1K - NE trench corner by proct. East and Mantozumas

1L - ~~SE~~ Summit - ~~SE~~ corner where Anusol and meet at interior.

1M - point NW where gatin, hemmeroid & Irregularity meet.

1N - point where Say no to erect and Anusol meet - SW interior.

1O - point where Anusol and itching & scratching meet

1p - itching & scratching meets dewarmer

1Q - trench corner by 1p

1R - trencher corner by mantozuma and dewarmer - SE

1s - ~~SE~~ most trench corner

1t - SW most trench corner

1u - near (1t)

1V - near (1u)

1W - ~~near 1V~~ ✓

1X - near 1W (across from)

1Y
1Z

Appendix A-4

Axial trench.

North

3/4/92

p. 92-48-1

p. 92-48-2

p. 92-48-3

p. 92-48-4

p. 92-48-5

p. 06

West p. 07.

1	0-1 m / 426 D 01-04. 0-80 cm 1 m = 1 cm
2	1-2 m S of N end. 426 D/05-08. 0-80 cm BGS
3	2-3 m S of N end. 426 D/09-426 D/13. 0-80 cm BGS
4	3-4 m S of N end. 426 D/14-426 D/17
5	4-5 m S of N end. 426 D/18-19-20-21-22, 29
6	5-6 m S of N end. 426 D/22, 25, 28, 27
7	6-7 m S of N end 426 D/23, 26, 28
8	7-8 m S of N end. 426 D/30,
9	8-9 m S of N end. 426 D/ 31
10	9-10 (80 cm long) 426 G/19.
11	8-9 m N of S 426 G/18, 33 (p. 18)
12	7-8 m N of S 426 G/17, 28, 33 (p. 18)
13	6-7 m N of S end 426 G/16/32, 31, 29, 24, 27 33,
14	5-6 m N of S end 426 G/ 15 15, 29, 23,
15	4-5 m S of N of S end. 426 G/ 13 13/14, 20, 21, 22, 25 26,
16	Skip 2-3. Begin describing as 3-4 b/c gained extra meter on S end. 3-4 m N of S end. 426 G/10, 11, 12, 13 20, 21
17	0-1 m N of S end of trench. 426 G/01-05
18	17-18 m S of N end - 426 G/06, 7, 8, 9

East

p. 9

p. 10/11

Original S end of
trench. Extended
in excavation.

←

→ or

PAGES: p. 92-48-01 → 17. OPS. 426 D : 426 G
1/28/92 → 2/7/92

South

Appendix A-5

SUBOPK

Following Dewormer Wall West

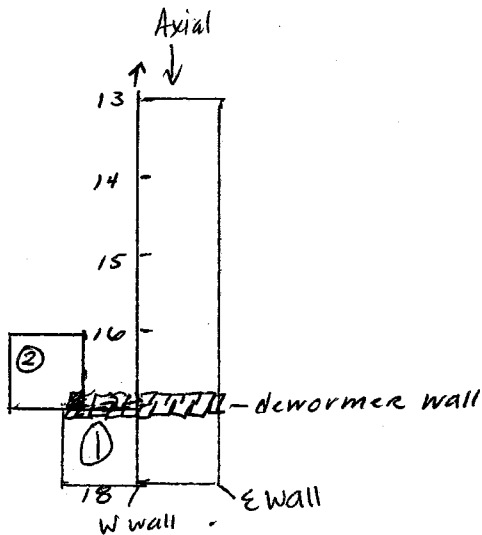

1cm = 1m

① 426 K/01, 02, 03, 04, 5, 6

② 426 K/06, 7, 8,

Points for structure 11 - 426

Station

Angle

distance

2/27/92

Middle

2

55° 40' ~~55° 30'~~ 40 min.

9.55

2689

3

56° 50' min.

10.65

2705

4

77°

9.90

2580

5

~~78° 34'~~ 78° 34'

10.20

2563

6

85°

10.39

2681

7

84° 50'

9.34

2669

8

~~98° 10'~~ 98° 10'

5.99

2578

9

112° 30'

6.64

2960

10

116° 10'

6.82

2992

11

111° 20'

7.44

2388

12

78° 55' ~~78° 55'~~ ~~78° 55'~~ ~~78° 55'~~

13.17

2715

13

86° 18'

13.78

2466

14

88°

13.25

2404

15

~~100°~~ 104° 25'

16.83

2566

16

117° 26'

13.04

2474

17

125° 10'

17.21

3164

18

127° 20'

16.76

3101

19

128°

17.31

3377

20

129° 32'

17.12

3311

21

128° 30'

16.47

3082

22

130° 22'

16.22

3068

23

129° 40'

14.94

3032

24

125° 20'

16.71

3117

25

114° 50'

13.32

2643

26

117° 30'

15.71

3036

27

120° 10'

16.89

3082

28

117° 25'

12.98

2485

29

109° 55'

11.85

1964

30

109° 58'

12.49

1991

31

106° 33'

11.35

2023

32

104° 10'

11.94

1899

PT

1# = 137

②

		E	M.D	DIST
✓ 42	Trench pt	130 ⁻	2605	13.85
✓ 43	"	136 ⁵⁰	2865	16.32
✓ 44		126 ³⁰	2609	14.41
✓ 45		128 ["]	2788	16.23
✓ 46		124 ⁵⁰	2997	18.48
✓ 47		113 ⁻	2292	15.00
✓ 48		103 ⁵⁵	2519	16.82
skip 49				
✓ 50	structure pt.	107 ²⁷	2372	13.38
✓ 51	"	106 ⁰⁴	2318	13.22
✓ 52	"	100 ⁻	2081	13.31
✓ 53		108 ²²	1924	10.95
✓ 54		111 ⁴³	1842	10.93
✓ 55		120 ¹⁸	2240	12.04
✓ 56		126 ¹²	2250	11.96
✓ 57	trench pt.	131 ⁴⁰	2391	11.95
✓ 58		125 ⁵³	2604	10.58
✓ 59		122 ⁵²	2480	10.86
✓ 60		123 ¹⁰	2424	10.30
skip 61				
✓ 62	structure pt.	118 ⁴⁵	2398	9.12
✓ 63		107 ⁴³	2112	7.79
✓ 64		111 ⁻	2241	7.43
✓ 65		107 ¹⁵	2391	7.23
✓ 66	trench corner	101 ³⁰	2247	4.54
✓ 67	"	84 ²⁵	2352	7.20
✓ 68	"	75 ³⁰	2472	7.32
✓ 69	structure pt.	95 ⁴⁵	1913	9.38
✓ 70	"	88 ⁴³	2259	10.83

⑦

(2)

#	point	angle	mid	distance
71	✓ structure pt.	90 ⁰⁰	2133	11.10
72	✓ "	82 ³⁰	24 8 78	10.58
skip 73	✓			
74	✓	95 ⁻	2267	9.30
75	✓	96 ⁴⁰	2316	9.01
76	✓	88 ²²	2126	8.68
77 VIN'S STR. #7				
1	✓	50 ¹⁵	2719	11.30
2	✓	376 ¹²	2515	10.45
3	✓	354 ⁰⁵	2484	10.45
4	✓	349 ²²	2461	9.94
5	✓	335 ⁴³	1911	10.35
6	✓	335 ²⁵	1689	9.52
7	✓	331 ⁰	1409	10.29
8	✓	330 ²⁵	1495	9.43
9	✓	327 ³⁰	1407	10.38
10	✓	326 ⁴³	1388	9.60
11	✓	327 ⁰	1581	10.23
12	✓	325 ²⁶	1498	10.32
13	✓	326 ⁰	1531	10.78
14	✓	326 ⁰	1684	11.15
15	✓	322 ¹⁴	1591	11.38
16	✓	321 ⁴⁶	1632	11.04
17	✓	320 ⁵⁴	1445	10.57
18	✓	311 ⁰²	1348	11.17
19	✓	308 ³⁰	1390	10.33
20	✓	305 ⁰⁴	1520	10.60
21	✓	309 ¹⁶	1455	11.82
22	✓	305 ⁴²	2121	12.19

The original intent of this project was to collect data on the modern traditional domestic structures in the Naco Valley. A few objectives were loosely strung together in the beginning. These were:

- to collect data from the many examples of bajaraque structures in the naco valley.

- to understand the materials used, phases of construction, and the maintenance as well as the longevity of such a structure.

- to understand the relationship among structures in the same compound.

- to collect data on the construction of hornos and hornilla's, as well as their relation to the structure.

One of the problems encountered in the comparison of this data, and its organization into neat bits of information is that

it has been difficult to make generalizations. I can determine that there are indeed general patterns, but in all cases there is an example that is contrary to the generalizations. I will state here then that all assertions are tentative but true to the best of my knowledge. I will do my best to provide evidence both supporting and countering each claim.

The materials used in the construction of a Bajaraque house in the Naco Valley are fairly limited due to the nature of the construction method itself. Bajaraque houses are constructed of mud, rocks, large wood posts, small 1 inch diameter sticks, string, nails and wire. Roof construction is much more variable and to an extent depends on socio-economic circumstances. The choices of roof materials however are limited to corrugated sheet metal, thatch and Spanish roof tiles supported by a wood construction in all cases.

The basic construction of a Bajaraque involves first the selection of a site. As far as has been determined this not based on any specific criteria. Samples of bajaraque have been selected at random and will be analysed in order to determine the quantity of clay in the soil. Soils that contain a higher percentage of clay will endure weathering better, will require less maintenance, and may play a role in the selection of a site.

Once the site has been determined, the materials to be used in the first phases of construction are collected and deposited at the site. The first phase involves positioning the large corner posts in the ground. The corner posts range in size, but they are generally more than 6 inches in diameter. The posts are placed approximately 50 to 70 cm below ground surface. Generally, there are 4 major corner posts placed in the ground. In some cases, additional constructions will be placed off the structure, such as an outdoor kitchen. During the initial phases of construction all posts are placed in the ground. In general, the structure is a simple square or rectangle.

After the initial placement of the corner posts, the wooden roof beams are built. First, 4-6 in diameter beams are placed along the periphery, connecting the corner posts in a square. The next phase involves placing cross beams on the box-like structure. At this point, the roof is built. There are however several options as far as roof construction. It is not necessary to go into an indepth description here. The options do include the following:

- raised, peaked spanish tile roof
- raised, flat Spanish tile roof
- corrugated sheet metal
- peaked 4 angled thatch (trapezoidal)
- peaked 2 angled thatch (prism)

In most bajaraque constructions, there is a 2 to 12 inch gap between the top portion of the wall and its abutment with the roof.

After the construction of the roof, 'a small ditch is dug around the periphery of the house, it will provide an anchor for

the araque (foundation). The ditch is usually 4-5 cm BGS. First a layer of medium to large sized cobbles is placed in the ditch, followed by a layer of lodo, (mud). Alternating layers of mud and stones are added until the desired height is reached, usually 2-4 courses. The araque is then smoothed over in a 2-3 cm casing of lodo. The araque is constructed around the large corner posts. An average araque would be approximately 30-35 cm wide and about 40 to 50 cm above ground surface.

The final phase of construction involves putting together the "aquaquin y vara". The "aquaquin" is the 2-3 in. diameter wood framework that rests on the araque. "Aquaquin" are vertical posts that are spaced approximately 35-40 cm apart. The "vara" run perpendicular to the "aquaquin". Vara consists of a series of small 1 inch diameter sticks that are somehow fixed to the vertical posts. They can be attached by means of nails, string or wire. Vara are generally spaced 5-7 cm apart, and are placed on both the interior and the exterior of the aquaquin.

What has been created in the overall construction of the framework are small cubicles, spaced by the distances between the wood construction.

The first layer of bajaraque is the next phase of construction. There will be three layers total, but the first is the most important. Small cobbles that can fit in the cubicle spaces are collected from the surrounding area (nearest possible). Lodo is made directly on the ground surface usually with the dirt and water that are readily available at the site. The mud mixture is stirred by hand until its texture becomes fairly consistent. The small cobbles are put into the cubicles one by one as the lodo is packed around them. Rocks are inserted into the walls for two reasons, strength and durability. This first layer of bajaraque is allowed to dry for two or three days. It is followed by the application of two more layers of lodo, which are smoothed over the exterior and the interior of the walls. The second and third layers provide a nice finishing touch to the construction.

Most of the bajaraque houses under construction during March and early April of 1992 had floors made of stamped dirt. It is possible to build a bajaraque with a cement floor. The cement is poured after the construction of aquaquin y vara. The araque is incorporated directly into the floor, a form is built around the base of the wall, and is slightly raised above floor level. Cement araque's tend to be approximately 10 to 15 cm thick.

RR

Photo Record

Elizabeth Brown
Bayanque Project

CAMERA A

Roll # 92A R25

dates 3/17 → 3/19

Photographer

48

Frame	Subject	Film- Orientation	Structure	Time	Processing- Exposure	Distance	DATE	NOTES
Frame	Subject	Orientation	Structure	Time	Exposure	Distance	Developed	date
1	adobe bricks drying in the sun.	92AR25	Casa #1	1:45	250 @ 5.6	2 M	3/16	BA.P. 1 ÷ 2
2	Embankment from where dirt is collected to make bricks (Eduardo)		Casa #1	2:00	250 @ 5.6	1.5 M	3/16	BA.P. 1 ÷ 2
3	bajaraque frame.		Casa #1	2:05	250 @ 5.6	2 M	3/16	BA.P. 1 ÷ 2
4	Exterior Manuel's casa		Casa #2	3:30	125 @ 5.6	3 M	3/16	BA.P. 2 ÷ 3
5	Interior R corner mud baja: frame		Casa 2	3:40	600 @ 5.6	1 → 1.5 M	3/16	BA.P. 2
6	S front wall w/ ORNO		Casa #3		250 @ 5.6	3 M	3/17/92	BA.P.
7	East side of structure		Casa #3		250 @ 3.5	2.5 M	3/17/92	BA.P.
8	Closeup of N wall rear of casa		Casa #3		250 @ 3.5		3/17/92	
9	Eduardo making an adobe brick (gradilla)		Casa #1	3:05			3/17/92	P 4
10	Exterior S wall		Casa 4		125 @ 3.5		3/17/92	P. 4 ÷ 5
11	Interior S wall		Casa 4		125 / 3.5		3/17/92	P 4 ÷ 5

Camera A

Rolls 92AR25 & 92AR26

dates 2/19 → 2/20

photos 48

Frame	Subject	film	structure	time	Exposure	dist.	date	Notes
12	Casa #5 N rear wall		Casa #5	5:15		2.5 m	2/19/92	Come back tomorrow BAP 8 p. 7
<div>92AR26</div>								
1	Geophucks	12400 tripan		8:00 AM	125/11	2 m	2/20/92	BAP-8 Testing light meter & graycard scale.
2	East wall (rear of house)	↓	Casa #6	9:30 8:30	125/22	3 m	2/20	East rear wall
3	Gen. landscape		Casa 6	10:05	125/22	15 m	2/20	family & gen site
4	Roof thatch		Casa 6		15/4	1.5 m	2/20	Roof thatch.
5	Total house. East ^{from}		Casa 6		250/11	15 m	2/20	East side
6	Bajaraque frame (same)		Casa 7		250/16	5 m	2/20	facing twds N (P9)
7	bajaraque frame		Casa 7	9:30	250/16	4 m	2/20	facing S [P10] Notes, p. 8 & 9
8	bajaraque - Santo Domingo		Casa 8	1:15	125/11	3 m	2/20	Towards N → front of house for S. face

Camera		Roll # 92AR 26: 27		Date 2/20		photog. 48		
frame	subject	film	structure	time	Exposure	distance	date	notes
9	MESS up at casa	B						
10	banjo, Adobe -	TriXpan 400	Casa 8	1:00	250/16	1 1/2 m	2/20	P. 90
11	N face of house Rear.		Casa 8	1:10	250/11	2 m	2/20	P. 90
12	S face of casa. blue door.		Casa 9	2:00	250/16	3 m	2/20	P. 11
92AR 27		TRIX PAN 400						
1	Rear of casa. N face		Casa 9	2:15	250/11	1 1/2 m	2/20	P. 11
2	Rear of Casa, Unpainted N face to W		Casa 9	2:20	250/11	1 m	2/20	P. 11
3	detail of S front of Casa -		Casa 9	2:30	250/11	1 m	2/20	P. 11

Camera D (or 4) Roll# 92D 01 date 3/23/92 photo# 48
 exp Structure Subject film structure # time. exposure dist. date notes

Kodak
 Gold 200.
 24 Exp.

92D 01

- | | | | | | | | | |
|---|--|--------|---------|---------|-----------------------------------|------|-------|----------|
| 1 | Western front
face of house. | 92D 01 | Casa 10 | 9:00 AM | 1000 / 8 ²² | 5 M | 3/23/ | p. 12 |
| 2 | Western front
face of House & de
Road. | | Casa 10 | 9:05 | 500 / 5.6 | 5 M | 3/23 | p. 12:13 |
| 3 | S side of house
w/ window | | Casa 10 | 9:10 | 500 / 11 | 2 M | 3/23 | p. 13 |
| 4 | S side of house
w/ window. | | Casa 10 | 9:11 | 500 / 22 | 2 M | 3/23 | p. 13 |
| 5 | East face of
62 yr. house in ctf. | | Casa 11 | 9:15 | 500 / 5.6 | 20 M | 3/23 | p. 13 |
| 6 | Close up shot of
E face. w/ board | | Casa 11 | 9:30 | 500 / 5.6 | 2 M | 3/23 | p. 13 |
| 7 | Front of house. | ✓ | Casa 11 | 9:40 | 500 / 5.6 | 2 M | 3/23 | p. 13 |

Camera		D (4)	Roll #	92D01	dates	3/23/92	photos	48
exp.	Subject	film	structure	time	exposure	distance	date	Notes
8	DENILLA Campo San Jose 5.	Kodacolor Gold 200	Casa 12	10:00	1000/5.6	2m	3/23/	p. 15
9					↓			
10					500/5.6	2m		
11						2m 2m		
12	Bank East side of highway N # completed skeletal of house	↓	Casa #2	4:00	250/5.6	2m	3/25	p. 18 & 19
13	Layer of rock and mud.	↓	Casa #2	4:05	125/5.6	3m	3/25	p. 18 & 19
14	Casa 14	↓	Horno Casa 15 Horno	8:30	500/5.6	5m	3/26	p. 18 & 20
15	Main House and Cocina		Casa 15	8:40	500/8	10m	3/26	p. 18 & 20
16	Main house & Cocina (12)		Casa 15	8:45	1000/5.6	10m	3/26	p. 20
17	Inside of the horno		Casa 15	8:50	600/5.6	1/2 m	3/26	p. 20

NALC
14

Camera D: A		Roll # ^{92AR27} 92D101	date 3/26		photog. 48			
expos.	subject	film	structure	time	exposure	distance	date	Notes
18	Inside, looking straight up in the an Horno.	200 Gold.	Casa 15	8:45	15/5.6	1/2 m	3/26	p. 21.
19	West wall of casa (A)	↓	Casa 16	9:00	500/5.6	1 m	3/26	p. 21
20	Horno/hornilla		Casa 16	9:10	500/5.6	1 m 5 m	3/26	p. 21
1 4	East wall of Casa.	BL: W Camera A-	Casa 17	10:00	25 500/16	5 m	3/26	p. 21 p. 22
5	East wall of Casa		Casa 17	10:05	1000 500/11	5 m	3/26	p. 22
6								p. 23
7								p. 23
21	Owners of casa 17 in the cocina window	camera d → Spitzer 92/D R 01	Casa 17	11:00			3/26	

Camera D

roll # 92DR02/1-3
92DR0122-25

dates 3/26

photographs 48

exposure	subject	film	structure	time	exposure	distance	date	Notes
22	Horno / Hornilla opening	Kodak Gold 200	Casa 18	11:00	125/5.6	1m	3/26	p. 23
23	Horn/Hornilla w/ fresh tierra blanca	↓ ↑	Casa 18	11:00	500/5.6	3m	3/26	p. 23
24	DL's - Along N-front face of house	92DR01 ↓	Casa 19	11:30	500/5.6	1 → end of house	3/26	
25	DL's entry structure	↓	Casa 19	12:00	250/5.6	3m	3/26	

92 DR/02 Ektachrome 200 Slide film

1	recycle element w/ ambiguity of DL's entry feature.	92DR02	Casa 19	1:15	1000/5.6	2m	3/26	p. 24 & 25
2	Entry feature	92DR02	Casa 19	1:16	500/22	3m	3/26	p. 25
3	Interior of Horno access	92DR02	Casa 20	1:30	15/2.8	50cm	3/26	p. 25

Camera D: A		Roll # 92AR27 : 92DR02	dates 3/26 - 3/27		photos 48			
exp.	subject structure	film	structure #	time	exposure	distance	date	notes
4	Inside of Horno - one side	92DR02	Casa 20	1:40	8/2.8	50 cm	3/26	p. 25
5	Straight up - Inside of Horno	92DR02	Casa 20	1:45	8/2.8	50-60 cm	3/26	p. 25
6	East side of Horno	92DR02	Casa 21	2:00	125/5.6	2 m	3/26	p. 25
7	West side of Horno	92DR02	Casa 21	2:10	500/5.6	2 m	3/26	p. 26
8	?	92AR27	Casa 19	1:30 or so			3/26	p. 25 : 24
9	DL's wife	92AR27	Casa 19	1:30 or so	500/11	2 m	3/26	p. 24 : 25
10.	Horno/Hornilla Inside Cocina	92AR27	Casa 19	1:40	30/3.5	5 m	3/26	p. 25
11	front outside of DL's - S front of house.	92AR27	Casa 19	1:45	250/8	25 m	3/26	p. 25
12	SE corner of Casa	92AR27	Casa 21 (mistakenly/cliff date, though)	8:00 AM	500/22	10 m	3/27	p. 27

Camera ⁹² A & D		Roll # ^{92DR02-8-12} 92AR27 13-15		dates ^{3/27}		photo ⁴⁸			
exposure	Subject	film	structure	time	exposure	distance	date	Notes	
8	SE CORNER of house.	92DR02	Casa 21 (mis)	8:15	500/22	2m	3/27	P. 27	
9	Horno/Hornilla inside cocina of Casa 21 (mis)	92DR02	Casa 21 (mis)	8:30	8/22	50 cm	3/27	P. 27	
10	Front of Same Horno/Hornilla	92DR02	Casa 21 (mis)	8:40	60/4	5m	3/27	P. 27	
13	East side of house	92AR27	Casa 22	9:30	250/22	3m	3/27	P. 28	
14	SW corner of house	92AR27	Casa 23	10:00	125/11	2m	3/27	P. 29	
15	S front of house.	92AR27	Casa 23	10:05	500/11	12m	3/27	P. 29	
11	SW corner of house	92DR02	Casa 23	10:15	125/5.6	2m	3/27	P. 29	
12	SE Corner of house.	92DR02	Casa 23	10:20	250/11		3/27	P. 29	

Camera A: D

Roll # 92AR27 16-17 92DR02
13-16

dates 3/27

photo 48

frame exposure	Subject	film	Structure	time	exposure	distance	date	Notes
16	SW corner	92AR27	Casa 24	11:00	500/11	10 M	3/27	p. 29
17	West face	92AR27	Casa 24	11:05	250/8	3 M	3/27	p. 28 29
13	S front face of house.	92AR 92DR02	Casa 24	11:15	250/8	10 M	3/27	p. 29
14	N side of Hornilla (Rear)	92DR02	Casa 24	11:16	250/11	2 M	3/27	p. 29
15	2 pans - H ₂ O and dirt (mixed)	92DR02	Casa 24	11:20	?	1 1/2 M	3/27	p. 29
16	Side view trying to show construction of wall - part where wall has fallen away	92DR02	Casa 24	11:25	15/5.6	30 cm	3/27	p. 30
18	Overall view of house & facing face of house	92AR27	Casa 25	8:02	125/8	20 M	3/31	p. 32
19	East side of Horno	92AR27	Casa 25	8:15	250/11	5 M	3/31	p. 32

Camera	A4D	Roll #	92AR27: 92DR02	Dates	3/31/92	photos	48		
frame	subject	film	structure	time	exposure	distance	date	Notes	
20	Ash deposit at SW side of Horno	92AR27	Casa 25	8:30	250/11	2-3 M	3/31	p. 32	
17	East side of Horno Casa 25	92DR02	Casa 25	8:40	250/11	5 M	3/31	p. 32	
18	East West face of Horno inside - really nice arch	92DR02	Casa 26	9:30	60/5.6	4-5 M	3/31	p. 33	
19	W/ face	92DR02	Casa 26	9:40	30/5.6	3-4 M	3/31	p. 33	
20	West face	92DR02	Casa 26	9:45	30/5.6	3-4 M	3/31	p. 33	
21	East face of Casa	92AR27	Casa 27	10:00	250/22	8 M	3/31	p. 35	
22	Kitchen, facing N. S side of house.	92AR27	Casa 27	10:15	125/11	5 M	3/31	p. 35	
23	"Misano"	92AR27	Casa 27	10:20	250/11	5 M	3/31	p. 35	
24	Rear side of house West side	92AR27	Casa 27	11:30			3/31	p. 35	
24	messed up.								

Camera 42AR28 A

Roll 42AR28 12AR28

date 3/31/92

photo. 48

frame	subject	film	structure	time	exposure	distance	date	Notes
1	Wst side	42AR28	Casa 27	10:30	250/8 250/8	2m →	3/31	p. 35
2	SW corner	42AR28	Casa 28	10:50	250/11	2m	3/31	p. 35-36
3	Twds NE	42AR28	Casa 28	11:00	250/22	4 →	3/31	36.
4	Facing NE Wall of casa drangue	42AR28	Casa 29	11:20	250/8	4-5m	3/31	p. 36
5	Hornilla - S side	42AR28	29	11:30	250/8	3m	3/31	p. 36 37
6	Tabla w/ cement keys	42AR28	29	11:45 12:00	250/5.6	2m	3/31	p. 37
SANDOSE								
7	NW corner of hau.	42AR28	30	8:30	250/8	2m 3m 2m	4/1	p. 37-38
8	West front of hau.	42AR28	30	8:45	500/4	10m	4/1	p. 38
9.	Inside, looking at Horno/Hornilla	42AR28	30	9:00	1/4	3m	4/1	p. 38

Camera <u>A and D</u>		Roll # <u>92AR28</u>		dates <u>4/1</u>		photo. <u>48</u>		
Frame	Subject	film	structure	time	exposure	distance	date	Notes
10	metate off SE side of house	92AR28	30	10:00	250/11	1 1/2 m	4/1	p. 38
11-	Inside casa/Horno/Hornilla-	92AR28	30 - Corina is wood structure off house. dirt floor.	11:00	15/4	2 m	4/1	p. 38 39
CAMERA D								
21	S face of Casa	92DR02	31 - Cal peeling away	11:15	500/22	2 1/2 m	4/1	p. 39
22	S face of casa to right of #21.	92DR02	31 → Cal peeling	11:15	500/5.2	2 → 4 m	4/1	p. 39
12	NW corner	92AR28	32	1:00	500/11	2 m	4/1	P. 41
13	SW corner	92AR28	32	1:05	125/?	3 m	4/1	p. 41
14	Southern wall as she builds it	92AR28	32	1:10	250/5.6	1 m	4/1	p. 41
15	S. wall as it is built. Hands	92AR28	32	1:15	60/11	1 m	4/1	p. 40 p. 40 p. 41

Camera frame	Subject	Roll film	structure	time	dates exposure	distance	photo. date	Notes
16	Inside along wall twds. SE. SE.	92AR28	32	1:20	60/8	1-5M	4/1	p. 41
17.	250 ft total casa 32	92AR28	32	1:30	250/16	11M	4/1	p. 41
23	WOMAN WORKING	92DR02	32	1:50	500/2.8	3-4M	4/1	p. 41
24	Araque? woman N/mud	92DR02	32	2:00	500/5.6	1-4M.	4/1	p. 41
	<u>92DR03</u>							
1	Southside w/ Platform.	92DR03	33	9:00	500/5.6	1-10M	4/2	p. 42
2.	line in construction of platform. platform built at same time.	92DR03	33	9:15	500/5.6	1-3M	4/2	p. 42
3	SE corner of old walls.	92DR03	34	10:15	500/5.6	4M	4/2	p. 43
18	SE corner of old walls	92AR28	34	10:20	500/11	4M	4/2	p. 43
4	NE corner of New walls	92DR03	34	10:30	125/2.8	5M	4/2	p. 43

Camera frame	subject	film	Roll structure	time	dates exposure	distance	photo date	Notes
19	^{SE} NE Corner of New Walls	42AR 42AR28	34	10:30	125/11	4 m	4/2	p. 43
20	N side of house w/ platform step up.	42AR28	34	10:30	125/8	0 → 10	4/2	p. 43
21	West front of house.	42AR28	34	10:40	125/16	15 M	4/2	p. 43
22	S side of house	42AR28	35	11:00	250/86	15 M	4/2	p. 44
23	East side S side of house.	42AR28	35	11:15	250/ 250/22	10 m	4/2	p. 44
3	N side of house.	42DR03	35	11:20	60/4	2 → 7 m	4/2	p. 44
4	W side of House	42DR03	36	2:00	60/16	8 M	4/2	p. 45
5	East side	42DR03	36	2:15	60/8	5 5 M	4/2	p. 45

Camera A-D		Roll 92AR29 / 92DR03		date 4/3 -		prints 48			
frame	subject	film	structure	time	exposure	distance	date	notes	
1	SW corner of house.	92AR29	Casa 37	8:00	250/8	8 m	4/3	p. 45 & 46	
2	N side of house w/ window.	92AR29	Casa 37	8:30	500/8	6 m	4/3	p. 46	
3	S side of kitchen. rear of Horno/ hornilla w/ brick exposed.	92AR29	Casa 37	8:40	500/5.6	4 m	4/3	p. 46	
6 ⑥	S side of kitchen	92DR03	Casa 37	8:45	600/5.6	4 m	4/3	p. 46	
7 ⑦	N side of kitchen w/ table in front of horn.	92DR03	Casa 37	8:50	125/5.6	3 2 1/2 m	4/3	p. 46	
8	E side of Horno	92AR29	38	10:30	600/11	3 m	4/2	p. 47	
9	E side of Horno	92AR29	38	10:45	600/11	3 m	4/3	p. 48	

Camera	subject	film	structure	time	exposure	distance	photo	notes
A		92AR29			4/21		48	
frame	subject	film	structure	time	exposure	distance	date	notes
6	East side of casa 39	92AR29	39	10:00 10:20	Fucked up	17 M	4/21	last pg. of P. 2nd bk: book III
7	East side of casa 31	92AR29	39	10:05	500/22	17 M	4/21	
8	S side of casa 39	92AR29	39	10:15	500/11	15 M	4/21	
9	N side of Hume.	92AR29	40	11:00	250/22	11 M	4/21	
10	old kitchen of casa 40 old arangue running N/S.	92AR29	41	11:15	500/16	3 M	4/21	
				4:25	500/16 500/16			
11.	Arangue of old house from NW corner of main house.	92AR29	41	11:30 12:00	500/16	5 M from Cam to NE corner where chalk N is	4/21	

Camera frame	subject	film	Roll	structure	Time	data exposure	distance	notes date	Notes
12	S front of Casa 42. Notice Shape of Arangue.	92AR29		Casa 42	2:00	250/8	4m	4/21	
92AR30 - VERICHROME 120									
1	SE side of the house	92AR30 92AR30		Casa 42	2:15	250/8	15 m	4/21	
2	E side of house	92AR29		Casa 42	2:30	250/8	3m	4/21	
3	detail of ^{mini} Arangue	92AR29 30		Casa 42	2:35	250/5.6	3m	4/21	
4	N front of house.	92AR29 30		Casa 43	10:00	250/11	15 m	4/22	p.
5.	West side of Arangue- detail-	92AR29 30		Casa 43	10:05	250/8	3m	4/22	
6	NW corner of house	92AR29 30		Casa 43	10:15	250/8	7m	4/22	

Camera film	subject	Roll film	structure	time	exposure distance	distance	photos date	Notes
7	Inside kitchen of Casa 43	92AR20 ³⁰ 92AR20	43	11:00	125/5.6	3 m	4/22	
8 9 10 11	NW corner NW face of house 2 messes, felt	92DR03	43	11:05	250/8	2 little girls		
			obligated to please the crowd.			250/8	towards. Cocina, N side -	
10 12	NW corner	92DR03	43	11:15	250/4	10 m	4/22	
11 12	Ararque East side - protected	92DR03						
11 13	Ararque East side - protected	92DR03	43	11:30	250/2.8	4 m	4/22	
11 14	West side Ararque - where it has fallen off corner	92DR03	44	12:30	250/5.6	15 m	4/22	
15 13	West face by new baja addition 1979	92DR03	44	12:30	250/5.6	15 m	4/22	

Camera		Roll		dates		photo			
frame	subject	film	structure	time	exposure	distance	date	notes	
16	Inside kitchen - old araque	92DR03	44	12:40	60/2.8	3.5 M	4/22		
17	East side of house w/ smaller araque. → SE corner of House	92DR03	44	12:40	60/8	0-5	4/22		
18	North face, rear corridor corridor incl. ceiling and pile of repair dirt	92DR03	45	2:30	60/8	10 M	4/22		
19	Close up of N face near NE corner.	92DR03	45	2:40	60/5.6	3 M	4/22		
20	Rear retaining wall - and pile of repair dirt.	92DR03	45	2:45	60/5.6	5 M	4/22		
21	Gen. expos. of front of house, East	92DR03	45	3:00	60/8	8 M	4/22		
22	Same - birds would dirt more		45	3:00	60/8	4 M	4/22		

Camera

Roll

date

photo

frame

subject

film

structure

time

exposure

distance

date

notes

frame	subject	film	structure	time	exposure	distance	date	notes
1	NE Wall rebuilt 12 years ago. w/ 2 yr. old araque	92DR04 92DR04	46	10:15	60/16	5-15	4/23	
2	Old bajaraque foundation from SE corner.	92DR04	46	10:30	60/16	8 m	4/23	
3	Rear of house - covered in cal	92DR04	46	10:30	60/16	4 m	4/23	
4	NE detail of fixed wall	92DR04	46	10:45	250/8	4 m	4/23	
8	Old bajaraque foundation facing SE front of house.	92AR30	46	10:45	500/11	6 m	4/23	
9	NE wall of house	92AR30	46	10:50	500/11	5 m	4/23	
10	Araque of old Bajaraque church - 1/2 part of wall.	92AR30	47	11:00	500/11	5 m	4/23	
5	Same as 10 above	92DR04	47	11:05	250/5.6	5 m	4/23	

Camera frame	Subject	Roll Roll film	Structure	Date time	exposure	dist.	photo date	notes
6	Old church facing West	92DR04	Casa 47 old church	11:55	250/8	10 m	4/23	
17	old church facing East.	92AR30	Casa 47	12:00	550/11	20 m	4/23	
7	Forget # of house, will look up - More work done - Aguarique is up.	92DR04	N face # 32	2:20	250/8	20 m	4/23	
8	East side junction of old & new part of house.	92DR04	Casa 48	2:30	125/4	4 m	4/23	
9								
1	East and South corner of casa 48.	92DR04	Casa 48	2:35	125/4	5 m	4/23	
10	N side of Casa 48 w/ stone platform outside house. facing West	92DR04	Casa 48	2:40	125/5.6	10 m	4/23	
11	N side, focus on stone platform	92DR04	Casa 48	2:45	125/8	10 m	4/23	

Frame	subject	film	structure	time	exposure	distance	date	Notes
18 12	Gen. scape of Cava 48 facing N side.	92AR30	48	8:00		20 m	4/23	
12	Gen. scape to ^{to} NW corner of the house	92DR04	49	8:30	250/4	12 m	4/24	
13	Gen. scape - SE corner of hse.	92DR04	50	10:30	125/2.8	10 m	4/24	
14.	Front portion of basa that looked like repaired part before repairs. and owner of house.	92DR04	50	10:30	125/2.8	6 m	4/24	
12	West side of house. Cocina made of tableras	92AR30	50	10:35	250/8	10 m	4/24	
15	236° E of N - SE wall arranged dirt lens in east.	92DR04	51	11:30	125/8	0-10 m	4/24	
16	Kids outside	92DR04	51	11:45	125/8	4 m	4/24	

Camera

Roll

date

photos.

~~Camera~~ frame Subject

film

Structure

time

Exposure

dist.

date

notes

13

Eastern front of
house.92AR30
~~92AR31~~COSA
92 51

12:00

250/16

20 m

4/24

21

~~Southern~~ ~~Western~~1 Southern end of
house facing kitchen

92AR30 31

52

9:00

60/11

5 m

4/27

BK 4

22

SW corner
of bajaraque next
to kitchen (23 closed
aravaque)92AR30
92AR31

52

9:00

60/11

3 m

4/27

17

Northern end
of house. sm.
trench of dirt aravaque.

92DR04

52

9:15

125/8

6 m

4/27

18.

West side of house
front, w/3 layers of
terra blanca

92DR04

52

9:20

125/5.6

8 m

4/27

19

Square

92DR04

52

9:25

125/5.6

8 m

4/27

20

20 m N of front
of house is trench
from whence dirt is
taken to make adobe
and herra.

92DR04

52

9:30

125/5.6

5 m

4/27

Camera

Roll

date

photographer

frame	Subject	film	structure	time	exposure	dist.	date	notes
21	South side of house w/ fallen baja wall.	92DR04	53 A	11:40	125/5.6	8 m	4/27	bt 4.
22.	Arangue Old Arangue ©	92DR04	53-C	11:40	125/8	4 m	4/27	
23	W front of house	92DR04	53-B	11:45	125/5.6	10 M	4/27	
24.	W front of Corina now Used.	92DR04	53-A	11:50	125/5.6	8 M	4/27	
24 4	Arangue W side of Casa	92AR30	53-B	11:55	60/11	8 m	4/27	
5	NW corner	92AR31	53-B	12:00	60/11	1 m	4/27	
6	W corner	92AR31	53-B		60/11	1 m	4/27	
7	family	92AR31	53		60/11	5 m	4/27	
1	Horno, facing South side.	92DR05	54		250/4	5 m	4/27	No fire, stones put in yard, not where buildings are.

Camera		Roll	dates		photo			
frame	subject	film	structure	time	exposure	distance	date	notes
2	E side of hse. Cal covered. Cobbles against base. araque. visible on inside of house. Small on the inside.	92DR05	54	2:30	250/4	4 m	4/27	
3 and 4	Inside Casa 54 - post w/ araque.	92DR15	54	2:30	4/2.8	3 m	4/27	
5	Gen view of N side of hse	92DR07	54	2:45	250/5.6	15 m	4/27	
6	Gen. Inside from hse. from W facing S.	92DR05	54	2:45	60/2.8	.	4/27	
7	Post hole/looking area → 101/D.	92DR05	4	5:15	15/5.6	3 m	4/27	Berrios 8/2
8	101/D	92DR05	4	5:20	15/4	3 m	4/27	11
9	101/D	92AR31	4	5:20	30/3.5	4 m 320	4/27	Ber's

Camera		Roll	date		photo		date	notes
frame	subject	film	structure	dist. time	distance	exposure		
9	101/D	92ARB1	101/D	5:20	4/M	30/4.8		
10	101/D	92ARB1	101/D	5:25	3.5M	30/4.8		
11	101/D	92ARB1	101/D	5:30	4.7M	30/4.8		
12	CASA 55-A Corn's Adobe Storage wood nec. south Side door facade rest of compound in line	92ARB1	55-A	9:50	6 M	250/8	4/28	
13	West front facade up hand	92ARB1	55-B	9:50	10 M	250/8	4/28	
9	W front facade up nec. CASA 101/D detail	92DR05	55-B 2nd	9:55	10 1/2 3M	60/4	4/28	
10	W front Cain a to right	92DR05	55 B: C	10:00	8 M	60/4	4/28	
11	area 10 M behind house where they get dirt	92DR05	55	10:05				

Camera	A	Roll	92AR32	dates	4/29	photo.	43		
frame	Subject	film	structure	time	exposure	dist.	date	notes	
1	S Side of Casa 56	92AR32	56	10:00	250/8	10 m	4/29		
2	West front of hq. Cocina to N	92AR32	56	10:05	250/86	12 m	4/29		
3	End of dirt on N Side w/ Casa 57 & dirt	92AR32	57	10:30	250/11	3 m	4/29		
4	No board or ruler	92AR32	57	10:35	1/3.5	80 cm	4/29		
5	No board or ruler	92AR32	57	10:40	500/16	3 m	4/29		
6	Horno, base West side	92AR32	58	11:20	?	3 m	4/29		
7	Horno base West side	92AR32	58	11:30	500/8	3 m	4/29		
8	N Side Front porch.	92AR32	58	11:45	500/6	2 m	4/29		

Camera		film		date		photo		notes
frame	subject	film	structure	1 am 1600 cm film	exposure	dist	date	
9	Horno - Casa 59 N side	92AR32	59	2:00	125/11	4 m	4/29	
10	S - side	92AR32	59	2:10	125/11	3 m	4/29	
11	N side of horno ash cut here.	92AR32	60	10:30	125/16	3 m	4/29	
12	E side of horno.	92AR32	60	10:40	125/16	4 m	4/29	



ORNI

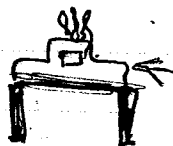

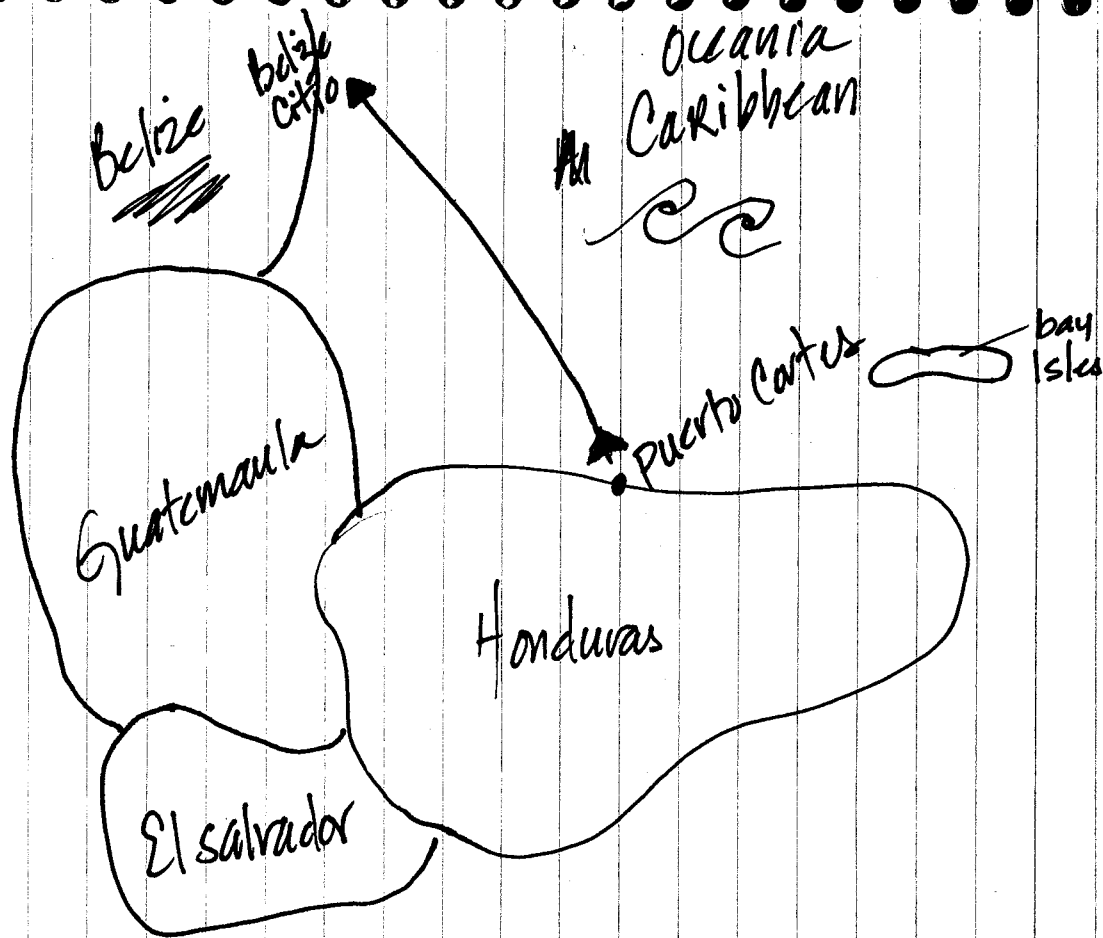

How to organize

Construction and dilapidation of a structure -

- be able to trace upkeep, materials, and falling apart.

- What kinds of data are quantifiable?

of posts, aquaquin i vara sizes.

Size of structure

Room divisions

Height of walls

Height of araque

~~Size~~ Type of roof construction

Size of harno, size of hamilla - materials used.

Cal covered, not, # of repairs, use of houses,

Clayey new of soil.

Collect
more

Need - description of harno/hamilla.

Bendover cause yar screwed.

3/23/92

Questions to answer/Things to do.

1. San Jose - Lavinias area. bajaraque turn!
2. ~~Source tierra blanca~~
3. photo central cal. painted (houses. : chmo. data
4. ~~Ask p.e. about excavating the adobe. What would that tell us?~~
5. Go check on houses being built over near Texaco road.
6. Talk to p.e., what do you want me to focus on.
7. photo Campasinas houses. by Laura's Quebrada site. Buy Friday
8. Check out Ted's Sanias papers on Briseus: late ^{post} classic ^{Friday} off platform structure.
9. TODAY → Texaco check
photo houses in cal.
10. Cal - source material. do ya have da buy it
11. ^{Hornilla} ~~SENA~~ vs. ^{Hornio} ~~SENA~~ - Whats the construchã?
12. Go w/ Ricardo to meet w/ Engineer.
13. Section of Unburnt bajaraque w/ cal stuck to it.) what is preserved when immersed in a H₂O for 24 hr. period.
Section of " bajaraque w/ paint on it.
Section of bajaraque w/ tierra blanca
Section of bajaraque w/ ash stuff on it.
14. ~~Have p.e. look at photo record and note taking system. : give suggestions.~~
15. ~~Mention Adobe abandoned casa on Santos farm~~
16. Where do you store food
Where do you get wood, clay,
What do you use for foundation, where's the kitchen
How many people does it take, How long. rest of sticks

1930 - 62 años

Saturday March-21. Meet w/ Santos san
at Santos house 11:00 to see
Abandoned house.

S	M	T	W	Th	F	S
	16	17	18	19	20	21
22	23	24	25	26	27	28
29	30	31	1	2	3	4
5	6	7	8	9	10	11
12	13	14	15	16	17	18
19	20	21	22	23	24	25
26	27	28	29	30	31	2
3	4	5	6	7	8	9
10	11	12	13	14	15	

MAK
April
MAY

David Conolly

March →

✓ M T W Th F S

23 24 25 26 27 28

29 30 31

~~MELVIN~~

Melvin

~~George~~

Isabelle

April

1 2 3 4

5 6 7

8

9

10 ^{Cal} ^{cortu}

11 ^{cortu}

12 ^{cortu} ^{beliz} ^{dangris}

13 ^{San Ignacio} ^{Southern}

14 ^{cortu}

15 ^{cortu}

16 ^{cortu} ^{beliz}

17 ^{beliz} ^{Camp}

18 ^{beliz}

19 ^{cortu}

20 ^{cortu} ^{Hond.}

21

22

23

24

25

26

27

28

29

30

May

[1 2 Copan

7-22 0 W

3

4

5

6

7

8

9 - Cal.

10

11

12

13

14

15

16

lab.

17

18

19

20

21

22

23

Colonial Model

12D-R01 Kodacolor Gold 200 print film.
35 MM.

2/23/92

Log's Log

FRAME	Lens	EXPOSURE	SITE #.
1	35MM	1000/22	N face Casa 10) same
2	↓	500/5.6	Casa 10 N/ face
3		500/11	Casa 10 S side) same
4		500/22	Casa 10 S. side
5		500/5.6	Casa 11 E. front
6		500/5.6	Casa 11 E front close up w/ board.
7		500/5.6	Casa 11.
8		500/5.6	Vanyorc 5 ORNILLA
9			
10			
11			
12		250/5.6	Casa 2 E side
		125/5.6	Casa 2 S side

92 AR 33

Frame	exposure	PHOTO
1	125/8	BONANZA JELLYBEAN " (WEST FACE)
2	125/11	
3	125/8	SISSY HANKSHAW (SOUTH SIDE)
4	125/11	" "
5	125/8	DR ROBBINS (NORTH FACE)
6	125/11	" "
7	125/8	JULIAN AND CORPSE CORNER
8	125/11	" "
9	125/8	LEIGH - CHERI
10	125/11	" "
11	125/8	CHINK corner w/ MAX
12	125/11	CHINK corner w/ MAX

92 AR 34

1	125/8	BONANZA JELLYBEAN EAST
2	125/11	" "
3	125/8	SISSY HANKSHAW NORTH FACE
4	125/11	" "

92A R 25

<u>3/16/92</u>	Exp.	Subject/ structure	Notes-
1	250 @ 5.6	Casa #1	
2	250 / 5.6	Casa #1	
3	250 / 5.6	Casa #1	
4	250 / 5.6	Casa #2	
5	60 / 5.6	Casa #2	
6	250 / 5.6	Casa #3	
7	250 / 5.6	Casa #3	
8	250 / 3.5	Casa #3	
9	250 / 3.5	Casa #3 #1	
10	125 / 3.5	Casa #4	
11	125 / 3.5	Casa #4	
12	125 / 3.5	Casa #5	
13		Casa #6	

92A R 20

1	125 / 11	Lauro : Tim
2	125 / 22	CASA 6

92A26

P. 2

3. ~~Open~~ 125/22

CASA 6

4 15/4

CASA #6

5 250/11

C. 6

6 250/16

Casa 7

7 250/16

Casa 7

8 125/11

Casa 8

9 — MESS up.

10 250/16

Casa 8

11 250/11

Casa 8

12 250/16

Casa 9

PB 92AR27

1 250/11

Casa 9

2 250/11

Casa 9

3 250/11

Casa 9

4 250/16

Casa 17

5 500/11

Casa 17

	Exp.	
6	500/16	Casa 17
7	500/16	Casa 17 ^{NA10}
8	?	Casa 18 Casa 19
9	500/11	Casa 19
10	30/3.5	Casa 19
11	250/8	Casa 19
12	500/22	Casa 19 21
13	250/22	Casa 22
14	125/11	Casa 23
15	500/11	Casa 23
16	500/11	Casa 24
17	250/8	Casa 24
18	125/8	Casa 25
19	250/11	Casa 25
20	250/11	Casa 25

92AR27

~~3/27/92~~ 3/31/92

FRAME

Exp.

Subj

21

60/5.6

26 (Horn)

22

125/11

27

23

250/11

27

24

———— MISTAKE ————

92AR28

1

250/8

27

2

250/11

28

3

250/22

28

4

250/8

29

5

250/8

29

6

250/5.6

29

7

250/8

30

8

500/4

30

9

1/4

30

10

250/11

30

Frame Roll-92AR28
CASA

exposure

11	30	15/4
12	32	50/11
13	32	125/7
14	32	200/5.6
15	32	60/11
16	32	60/8
17	32	250/16
18	34	500/11
19	34	125/11
20	34	125/8
21	34	125/16
22	35	250/16
23	35	250/22

92AR29 120

1	37	250/8
2	37	500/8
3	37	500/5.6

92AR29 CONTINUED

4	38	60/11
5	38	60/11
6		
7	39	500/22
8	39	500/21
9	40	250/22
10	41	500/16
11	41	500/16
12	42	250/8

92AR30 Verichronne.

1	42	250/8
2	42	250/5.6
3	42	250/5.6
4	43	250/11
5	43	250/8
6	43	250/8

7	43	125/5.6
8	46	500/11
9	46	500/11
10	47	500/11
11	47	500/11
12	50	250/8
13	51	250/16

92AR31

1	52	60/11
2	52	60/11
3	52	60/11
4	53-B	60/11
5	53-B	60/11
6	53-B	60/11
7	53	60/11
8	Bennis' structure → 4/101/D	15/5.6
9	101/D 4	30/48
10	101/D 4	30/4.8

11 101/D 30/4.8

12 55-A 250/8

13 55-B 250/8

92AR32

1 56 250/8

2 56 250/16

3 57 250/11

4 57 1/3.5

5 57 500/16

6 58

7 58 500/8

8 58 500/8

9 59 125/11

10 59 125/11

11 60 125/16

12 60 125/16

92D/01
3/20/92

FRAME	Exposure	SITE #
14	500/5.6	Casa ¹⁴ 15 ^{Notes} P. 20
15	500/8	Casa 15
16	1000/5.6	Casa 15
17	60/5.6	Casa 15
18	15/5.6	Casa 15
19	500/5.6	Casa 16
20	500/5.6	Casa 16
21	owner of Casa 17 -	Casa 17
<p>(order of photos may be askew here. Before 21 all labeled, I think I shot the lower R. Hand corner of Casa A by the fence w/ the color cam. (at Casa 17).</p>		
22	125/5.6	Casa 18
	500/5.6	Casa 18
	500/5.6	Casa 19
2	250/5.6	Casa 19

92D1R02 Ektachrome 200 slide film

Frame	Exposure	Site #
92DRO2/ Ektachrome		
1	1000/5.6	Casa 19
2	500/22	Casa 19
3	15/2.8	Casa 20
4	8/2.8	20
5	8/2.8	20
6	125/5.6	21
7	500/5.6	21
8	500/22	21 Mis
9	8/22	21 Mis
10	60/4	21 Mis
11	125/5.6	23
12	250/11	23
2	250/8	24
	250/11	24

FRAME	<u>Roll</u>	Card	Exposure
	92DR02		
15	↓	24	?
16		24	15/5.6
17		25	250/11
18		26	60/5.6
19		26	30/5.6
20		26	30/5.6
21			
22			
23			
24			

92DR03

1	33	500/5.6
2	33	500/5.6
2	34	500/5.6

92DR03

4	34	125/2.8
<u>Misnumbered, probably correct here)</u>		
5	35	60/4
6	36	60/16
7	36	60/8
8	37	60/5.6
9	37	125/5.6
10	43	250/8
11	43	250/8
12	43	250/4
13	43	250/2.8
14	44	250/5.6
15	44	250/5.6
16	44	60/2.8
17	44	60/8
18	45	60/8
19	45	60/5.6
20	45	60/5.6

21

45

60/8

22

45

60/8

92DR04

1

46

60/16

2

46

60/16

3

46

60/16

4

46

250/8

5

47

250/5.6

6

47

~~2~~ 250/8

7

32

250/8

8

48

125/4

9

48

125/4

10

48

125/5.6

11

48

125/8

12

~~48~~ 49

250/4

13

50

125/2.8

14

50

125/2.8

92DR04...

15	51	125/8
16	51	125/8
17	52	125/8
18	52	125/5.6
19	52	125/5.6
20	52	125/5.6
21	53-A	125/5.6
22	53-C	125/8
23	53-B	125/5.6
24	53-A	125/5.6

92DR05

1	54	250/4
2	54	250/4
3	54	4/2.8
4	54	4/2.8
5	54	250/5.6
6	54	60/2.8

7	#101/D	15/5.6
8	101/D	15/4
9	55-B	60/4
10	55 B:C	60/4
11	55	

10th

426 5 supers 10 gugs
1sr

423 12 supers 26 gugs
4sr

gugs
total
+DL
+washers

17th

Steve + Ellen to lab

6

John to 428

2

Vinny Jan to Sto. D

4

Neil stays

12

need

426 12 supers

12

needed

423 9 supers

36

needed

48

John 4

V+J 6