

1992

PVN-022-Bell-Field Notes-1992

Ellen Bell
Kenyon College

Follow this and additional works at: <https://digital.kenyon.edu/honduras>



Part of the Archaeological Anthropology Commons

Recommended Citation

Bell, Ellen, "PVN-022-Bell-Field Notes-1992" (1992). *Four Valleys Archive*. Paper 7505.
<https://digital.kenyon.edu/honduras/7505>

This Field Notes is brought to you for free and open access by the Anthropology at Digital Kenyon: Research, Scholarship, and Creative Exchange. It has been accepted for inclusion in Four Valleys Archive by an authorized administrator of Digital Kenyon: Research, Scholarship, and Creative Exchange. For more information, please contact noltj@kenyon.edu.

28 enero 1992
 Setting up student training projects - the gate was locked so we
 hoofed it - Arriving in the Am. what a concept. P+E are
 on the way and we're going over lot cards.
 'Gotta love organized religion!

Students -

N. Group: ²⁵⁵ Crockett:

*52 Kathy:

*51 Stacie:

*53 Kim:

S. Group: Matt:

Bevin:

Jon:

Suzanne:

Guy are chopping the mounds + making stakes. We've started + numbered
 each mound.

Masate - burs

el garrobo - mediano lizard

el iguana - big lizard

la lagartija - chiquito lizard (quijín)

Lot List: Site 423

423A/10 - Surface collection, N. cluster of site 423 on top of Str. 17

423A/20 - Surface collection, N cluster site 423 on top of Str. 15
on one fragment

423A/22 - Surface collection, N-cluster site 423 on top of Str. 18
lots o' shrs, some large pieces

423A/23 - Surface collection, N cluster, site 423 on top of Str. 20
1 shrd

423C/01 1st 1x1m square of 423C 0-20 cm bgs - measured from SHC
of sub-op

423D/01 1st 1x1m square of 423D; 0-20 cm bgs; measured from WLC
of trench

423A/24 Surface collection, N group of site 423 on top of Str. 17
empty lot

423A/25 Surface collection, N group of site 423; on top of
Str. 18. Empty lot

423A/26 Surface collection, N group of site 423; on top of
Str. 19. Empty lot

~~423A/27~~

Josino
Folpe

St. K: 1st 1x1 20m trench 100° E of North



10m

423C/01 - 1st 1x1 m square of sub-op 423C - 0 = 20m
bgs measured from the SW corner of sub-op 423C - Small chunks
of Carbon are coming out of the SEC at 20m bgs, small hole
of basaltic from center of square at 20m bgs

423C/02 - Stepping trench (Sub-op 423C) back 1m to the
S side where were coming out in the 1st 1x1 m. I have marked
the SWC station as the end of the trench w/ black magic marker
and the line for the leveling stuy is at 35 m above bgs.
Shards & more rocks are coming out - Nice run

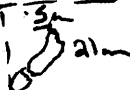

5-10m D of N wall of lot (SWC of Sub-op 423C); 10-21 m E of W wall
of 423C; + 21 m bgs. Tumble is coming out of W side
of trench

SWC 423C
Shards

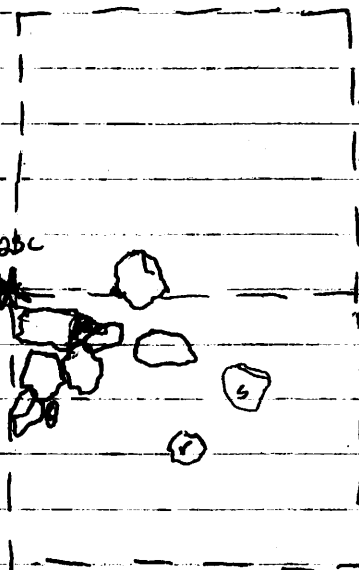

10-21

tumble appears to be coming from another str to the W-

Site 423 Sub-op D 1x1m Trach Oriented 130° E of N
 from play side of Str 20 (216° E of N when N is set at upper end)

423/01 - 1st 1x1m square of Sub-op 423D @ 20m bgs
 measured from the NW corner of the Sub-op. Sheds - do
 Chaper (20m) NW

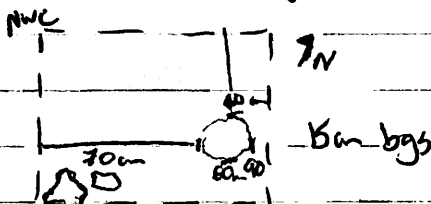

Small circular stone, soil is darker & damper than the sandy
 earth. There are also a few rocks in the SW at 10-15m bgs
 the 'stone' has now dried up & disappeared - it was just
 a damp patch. Oh well - dei es de vida. A few sheds
 are coming out at the SW end 87-94m from NW end, 90-47m
 E of west wall at 20m bgs - - - - - mixed in w/ rocks



423D/02 - directly beneath Northern 50m of 1st 1x1m of 423D (423D/01)
 20-40m bgs. Tumble in S E of 423D/01 which we want to
 cut down in front of.

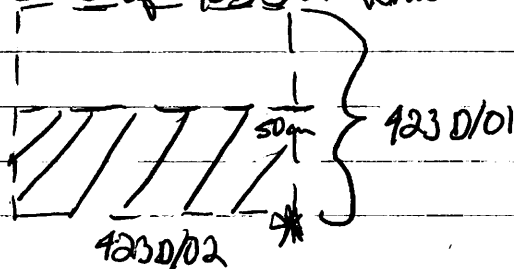

The first of these is the 100° F. H.

good - 100% for the 1st 100% of the
 1st - 100% for the 1st 100% of the

100

[illegible][illegible]

1000 200 800

1000 200 800

DAM

possibly ^{for} a str. Not visible on the surface. Closed lot at 20 m (tops of rocks) 0-20 m bgs

423C/03 beneath 1x1 m stepped back from SWC of 423C (423C/02) clearing beneath 423C/02 - pebbles - rocks to get a better look at the tumble. 20-30 cm beneath ground surface at SWC (orig) of trench. Shards, Censer fragment SWC continuing to clear. Tumble really appears to be coming off a different structure - a wall, possibly 2 different structures.

— 423C/04 — 423C/06 — See Crockett's notes

423C/07 - 3rd 1x1 m square of sub-op 423C; 0-20 cm bgs opening up another meter before pulling tumble in 2nd 1x1 m square may be coming down on the top of a wall. Piece of what came out at 10 m bgs in SWC - 3 shards - probably Javan

423C/08 - 3rd 1x1 m square of sub-op 423C; 20 - a bgs. Dig out tumble in front of a possible wall 80-100 cm N of S wall of 3rd 1x1 m square of sub-op 423C. A very queer sale. Digging out a lot of of tumble, there is also a lot of quartz coming out, - bazaarish tumbler

Looting Notes: On the evening of the night of Jan 30, 1992, looters disturbed the 3rd + 4th m of sub-op 423C. The looting disturbed a fair amount of the 4th m, as well as the E wall of the 3rd 1x1 m. The looting has revealed a possible wall line in the 3rd 1x1 m square.

to the fact that the surface is not smooth (shape of hole) - 90-60-CP9

90-60-CP9 is a very good example of a hole in a wall. The hole is about 1/2 inch in diameter and is located in the center of the wall. The hole is not smooth and is not round. It is a very good example of a hole in a wall.

90-60-CP9 is a very good example of a hole in a wall. The hole is about 1/2 inch in diameter and is located in the center of the wall. The hole is not smooth and is not round. It is a very good example of a hole in a wall.

90-60-CP9 is a very good example of a hole in a wall. The hole is about 1/2 inch in diameter and is located in the center of the wall. The hole is not smooth and is not round. It is a very good example of a hole in a wall.

90-60-CP9 is a very good example of a hole in a wall. The hole is about 1/2 inch in diameter and is located in the center of the wall. The hole is not smooth and is not round. It is a very good example of a hole in a wall.

90-60-CP9 is a very good example of a hole in a wall. The hole is about 1/2 inch in diameter and is located in the center of the wall. The hole is not smooth and is not round. It is a very good example of a hole in a wall.

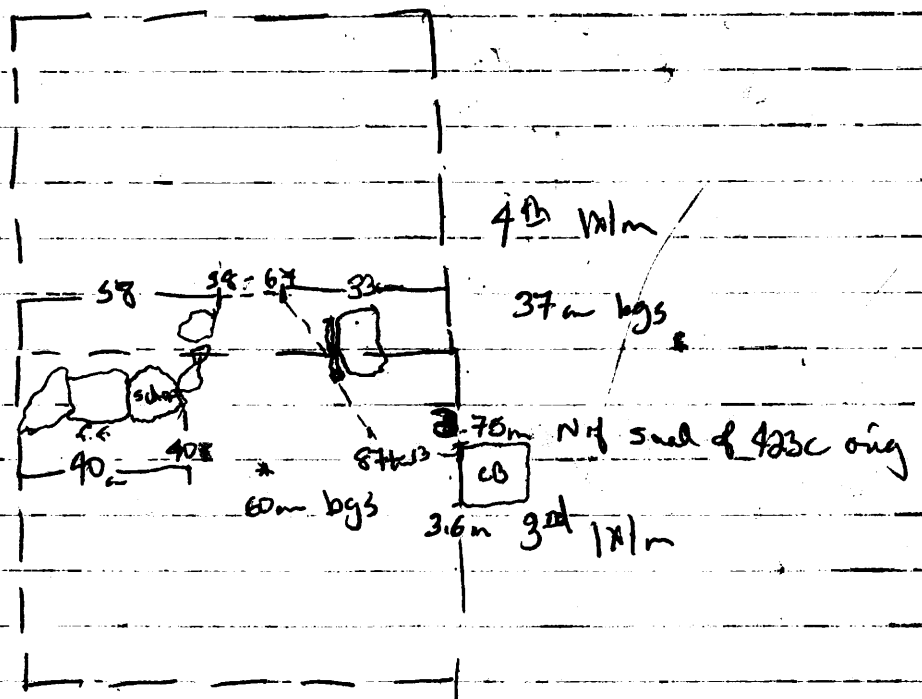

looting has revealed a possible wall line & surface level so we are cutting back into the mound at that level there are 3 strays in the 4th 11m - which have tumbled "uphill" - i.e. fallen back toward the interior of the str.

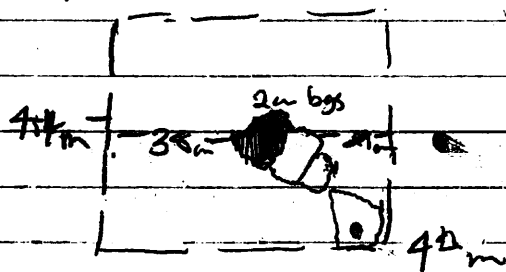

423C/11 clearing - tumble over 4th 11m & last 20m of 3rd 11m - 15m bgs

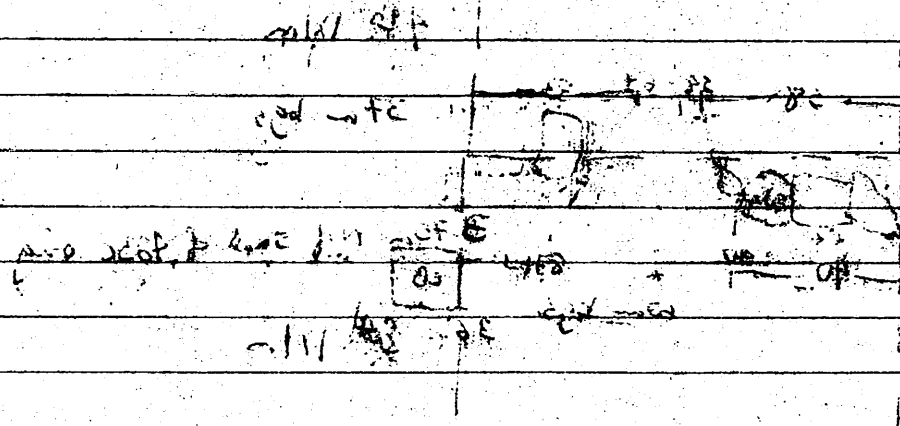

we have a large number of small pieces of wood and metal
 which are scattered all over the place and are not
 in any order or arrangement. The only thing that is
 clear is that they are all of the same size and shape.

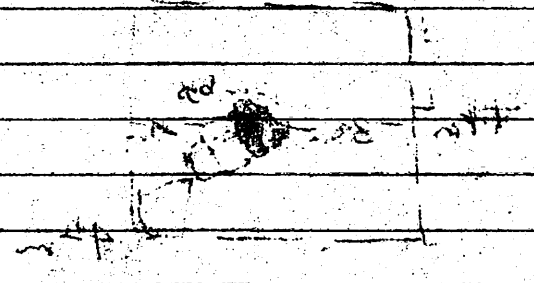

11/11 11/12 11/13 11/14 11/15 11/16 11/17 11/18 11/19 11/20 11/21 11/22 11/23 11/24 11/25 11/26 11/27 11/28 11/29 11/30 11/31 11/32 11/33 11/34 11/35 11/36 11/37 11/38 11/39 11/40 11/41 11/42 11/43 11/44 11/45 11/46 11/47 11/48 11/49 11/50 11/51 11/52 11/53 11/54 11/55 11/56 11/57 11/58 11/59 11/60 11/61 11/62 11/63 11/64 11/65 11/66 11/67 11/68 11/69 11/70 11/71 11/72 11/73 11/74 11/75 11/76 11/77 11/78 11/79 11/80 11/81 11/82 11/83 11/84 11/85 11/86 11/87 11/88 11/89 11/90 11/91 11/92 11/93 11/94 11/95 11/96 11/97 11/98 11/99 11/100

Site 423 Sub-op P

Sub-op P has been defined as the S. end of the trench over Str 20 which has been defined as Sub-op D. The orientation is 36° E of N at the end.

423P/01 - 1st 1/4 m square of Sub-op P at site 423

0-20 cm bgs. ^{NWC} Sheds. Coming down on a few rocks. will clean around them & then step back a meter as we are only about 1.5 m S of the slope. Handle of a little denser (unburnt) come out at 17 cm bgs in the NE corner. We're going to take the measurements from the NW corner of each lot.



423P/02 - Stepping back 1 m to the S as we can down directly on a sea of rock in the 1st 1/4 of Sub-op 423P. 1/4 m square directly S of 423P/01 (referred to hereafter as the "stepped-back square" or "423P South"). 0-20 cm bgs NWC, Small bag of Sheds

423P/03 - directly below 423P/02 (in the 1 m step-back of 423P) 20-40 cm bgs on NWC. Micro, broken primitive chert black more obvious as coming out of Str. 19 + 20 than elsewhere in the group. Took out 4 loose rocks & now a lot of Sheds are coming out from beneath them (25 cm bgs NWC)

30 cm bgs

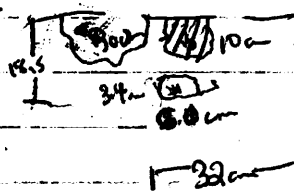
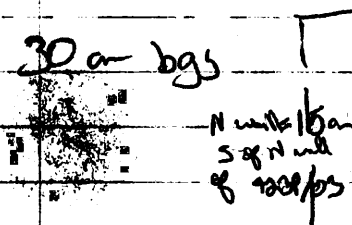

sh. strip of golden soil, very fine, highly micaceous, small patches plus lg. (unm) bgs of golden quartz

1/10/2000

4 go down 26/12/22

$\frac{1}{2} \log \frac{1}{2} \geq \frac{1}{2} \log \frac{1}{2}$ as $\log \frac{1}{2} \geq \log \frac{1}{2}$ and $\frac{1}{2} \geq \frac{1}{2}$
 $\frac{1}{2} \log \frac{1}{2} \geq \frac{1}{2} \log \frac{1}{2}$ as $\log \frac{1}{2} \geq \log \frac{1}{2}$ and $\frac{1}{2} \geq \frac{1}{2}$

[illegible]

Thanks very much for all at all good night - 20/8/64
 I hope you will be well & happy as always
 I hope you will be well & happy as always
 I hope you will be well & happy as always

[illegible]

<p>1. <u>1000</u> - 1000</p> <p>2. <u>1000</u> - 1000</p> <p>3. <u>1000</u> - 1000</p> <p>4. <u>1000</u> - 1000</p> <p>5. <u>1000</u> - 1000</p> <p>6. <u>1000</u> - 1000</p> <p>7. <u>1000</u> - 1000</p> <p>8. <u>1000</u> - 1000</p> <p>9. <u>1000</u> - 1000</p> <p>10. <u>1000</u> - 1000</p>	<p>1. <u>1000</u> - 1000</p> <p>2. <u>1000</u> - 1000</p> <p>3. <u>1000</u> - 1000</p> <p>4. <u>1000</u> - 1000</p> <p>5. <u>1000</u> - 1000</p> <p>6. <u>1000</u> - 1000</p> <p>7. <u>1000</u> - 1000</p> <p>8. <u>1000</u> - 1000</p> <p>9. <u>1000</u> - 1000</p> <p>10. <u>1000</u> - 1000</p>
--	--

Site 423, Sub-op O

Sub-op O is a 1x11 m trench over Str. 19, site 423. It is oriented at 114° ^{E of N} and ~~the~~ excavations were begun at the NE end - the non-play side of the mound. AS mound is small, (less than 50m in elevation) & surface slope is ephemeral at best the orientation of the structure is Angier's guess. Orientation = 114° E of N

423O/01 - 1st 11m of Sub-op O, site 423, beginning at NE end of Sub-op O (0" as in Oh my God it's hot!) Birds are beginning to come out at approx. 10m bgs. 0-30m bgs. The soil is light-brown with a slightly orangish tint to it, fine & almost powdery with a slight bit of mica (silica) present. All particles are well under .5mm. There is a large fragment of a Jicora neck in the NE corner - actually in the N wall at 15m bgs. All measurements will be taken from the NE corner of each lot. No rocks yet!! They took it to 30m bgs in the NW by mistake (measured from NEC rather than NW). Nice dirt-patched handle

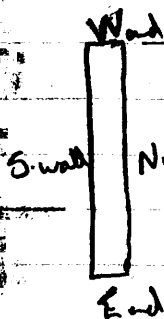

423O/02 - Directly below 423O/01. 30-40m bgs in NWC. Birds. There is a large root in the NW quadrant of the lot. 15 to 20! Birds - 2 bag (big size) 2 new primitive obsidian blades. Soil change at 35m bgs. in NEC of trench - Harder, more densely packed with fleck (or chunks) of basalt. A few more sherds than before. The obsidian blades are really tan up along the edges. ^{North of trench} brownish ^{to orange, fine, granular}

Q 90 d/c 164/2

[illegible]

I am so glad you are all well & happy. I hope
 you will have a very successful year. I am
 always thinking of you and hoping for your
 happiness. Love from all.
 Mother, Father, Sister, Brother.

[illegible]

423P/04 - Drilling beneath 423P/03; 40-~~46~~⁴⁸ cm bgs. in NWC
 Stopped but because a concentration of sherds came out at
 46 cm bgs. (Sherds are in soil but measurement is taken in
 NWC)

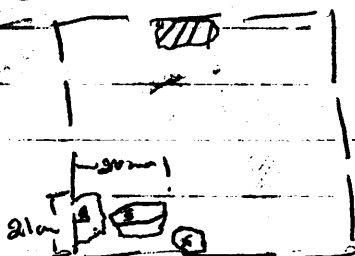

S = Sherd
 21 = bryozoan at 25cm bgs

423P/05 - ~~drilling beneath 423P/04~~ ~~at 46 cm bgs~~
 Broken vessel - mark G and G-1(?) found within step 1X1m
 step-back of 423P at 46cm bgs. I believe it may be
 lying on the surface as the earth beneath it is much
 more densely packed + flecked with bryozoan, carbon, and white
 bits. The vessel fragments were also lying flat + there appear
 to be more beneath the ones we recovered today.

423P/06 - Claim above floor/possible surface 46-60 cm bgs
 The surface was Non-existent so the group cut down further
 before we got here.

1964-1965
to the ...
...

...

...

...

4230/03 - Directly beneath 4230/02; w/in 1st 1x1m square;
40-60 cm bgs NWC 1 bag Sheds

4230/04 - 2nd 1x1m; 0-20 cm bgs in NWC; Sheds

4230/05 - 2nd 1x1m; directly below 4230/04; 20-30 cm bgs
NWC. We took it down to the top of the soil change
(orangeish w/ Sheds, white flecks, + hyaline bits) 1 bag
of Sheds

4230/06 - 2nd 1x1m; directly below 4230/05; 30-60 cm ^{NWC} bgs
taking it down to sterile soil in 1st 1x1m. Sheds, Sheds, +
more Sheds. Well, actually only @ 1/2 a bag of Sheds.

4230/07 - 3rd 1x1m; 0-30 cm bgs. Sheds 1/2 bag - 1, mys,
One rock

4230/08 - 3rd 1x1m; 30-60 cm bgs NWC; looking for rocks -
there have to be rocks - No here don't. Clean - still nothing
moving up to next square.

4230/09 - 4th 1x1m; 0-9 cm bgs ^{NWC} Yes! we have finally
come down a rock & it looks as if it might be some sort
of bio as well. We are clearing off the top of the rocks
and will soon be pulling timber. If there is a bio
present, it's 40 cm W of the E wall of 4230/09 at 12 cm bgs
Empty 1st

10/10/80 - 10/10/80
 10/10/80 - 10/10/80

10/10/80 - 10/10/80

10/10/80 - 10/10/80
 10/10/80 - 10/10/80
 10/10/80 - 10/10/80

10/10/80 - 10/10/80
 10/10/80 - 10/10/80
 10/10/80 - 10/10/80

10/10/80 - 10/10/80
 10/10/80 - 10/10/80

10/10/80 - 10/10/80
 10/10/80 - 10/10/80
 10/10/80 - 10/10/80

10/10/80 - 10/10/80
 10/10/80 - 10/10/80
 10/10/80 - 10/10/80
 10/10/80 - 10/10/80
 10/10/80 - 10/10/80

9-60

4230/110 - Pulling Tumble 40-49 m W of E wall of 4230/09,
(4th 12m square) 10-49 m bgs MOC. Only going down to
base of tumble

Sail Notes

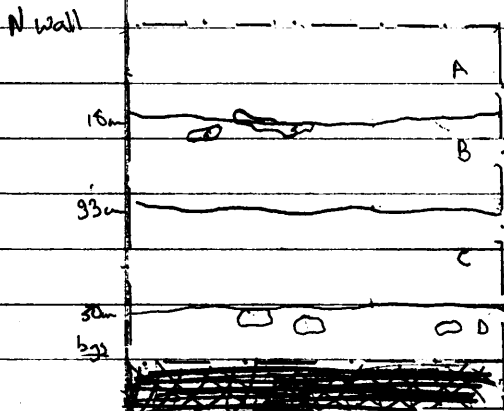

Soil A - Brown, loamy dark brown, a few streaks but for the most part, slightly organic soil w/ few inclusions

Soil C Darker, almost black, there is a line of shreds at the top of this level and shreds with it as small fragments.

201C slightly darker than B. white flecks, bayangee birds
fairly fine texture

soil still hard, sandy green, pretty lg white inclusions, a few small, white pebbles, some gray in color than the A, B, & C strata.

11-1-1954

to state the value of the material, 11/1/54
and not for the material at present, but for the
material at present (11/1/54)
to state the value of the material, 11/1/54
and not for the material at present, but for the
material at present (11/1/54)
to state the value of the material, 11/1/54
and not for the material at present, but for the
material at present (11/1/54)

to state the value of the material, 11/1/54
and not for the material at present, but for the
material at present (11/1/54)
to state the value of the material, 11/1/54
and not for the material at present, but for the
material at present (11/1/54)

11/1/54

4230/12 - Clearing off tumble on top of CHAYANNE 49-100
W of E wall of 4230/09 (4th 11m square) 10-15m by NW
metre long, worked quarry.

4230/13 - 5th 1x1m; 0-23 - a bys NW clearly down to
rocks before putting more tumble over CHAYANNE, possible rock with
very few studs; possibly within a room (rocks facing wrong way)

CHAYANNE - The 1st wall line encountered in 4230 over Sta 19,
Sta 423, CHAYANNE appears to be a shallow, ~~very~~ line preserved
to two courses in some areas and limited to a single preserved
course in others. The flat facing of the rocks are very well defined
and most are fairly flat. The presumed upper course (where present)
is composed of a thick schist slab with a flat upper surface.
The wall lies at 3.45 to (possibly) 4.25 m W of E wall of 4230.
The back side is still rather uneven, and the lower - relatively
well-preserved course lies at 20 m bys (NWC of 4th 1x1m)
(15m bys at 3.5m W of E wall of 4230) while the single stone
preserved in the upper course rises to 7m bys (NWC of 4th 1x1m)
(6m bys at 3.6m W of E wall of 4230). Wall is oriented at
24° E of N (Declination set at 0°). There may be a step-out
on the N side of the trench 62-77m N of S wall of trench.
A step-out ring 3.12-3.45 m W of E wall of 4230 at 24m bys
(NWC of 4th 1x1m) or 18m bys (NWC of 3rd 1x1m).

Rock Sizes: 21x29x9 12x10x1-
7x28x? 4x4x1.5m
29x17x? 17x17x1m

001-PA 31 MAY 44 to get no info - 6/10/44
info 21-01 Camp 4) POW 6/10/44 to get
status about your return

at 21-01 Camp 4) POW 6/10/44 to get
info about your return

PI 21-01 Camp 4) POW 6/10/44 to get
info about your return

1-100-1 P. 123-16 info about
1-100-1 P. 123-16 info about
1-100-1 P. 123-16 info about

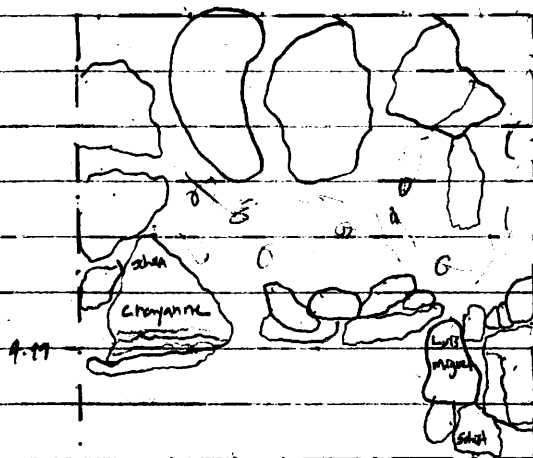
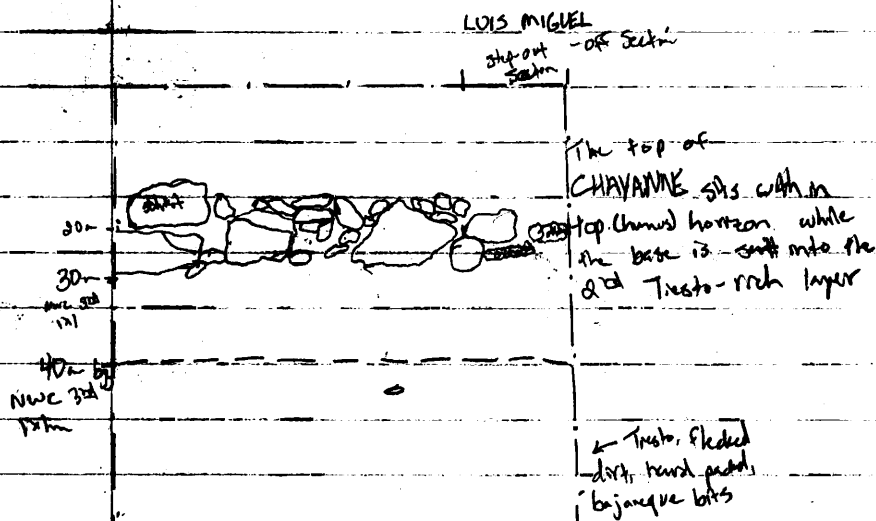

CHAYANNE, Rather than being a wall with small bits of tumbled rock above it is a terrace which extends from 3.45-4.05 m w of E wall of 4230. The flat-faced rocks (which face E) are topped & backed by a lot of small, generally rounded cobbles or small, flat disk-like pebbles which are densely packed and present a relatively flat surface.

[illegible]

4330/14- 6th 1x/m; 0-9 on bgs in NW. Almost perfectly clear
Empty lot

Stop: Description: We have a very sweet occurrence here. There is a terrace with a step-out which the open area which is just dirt - with the exception of two flat, well-placed rocks, one of which is rounded like the rounded basalt cricket band on Str. 16. We then have a line which cuts away across the terrace with the pointed ends facing back into the empty space. Gravelly enough this is a lot of beds coming out although there was a bit of matrix on top of the terrace.

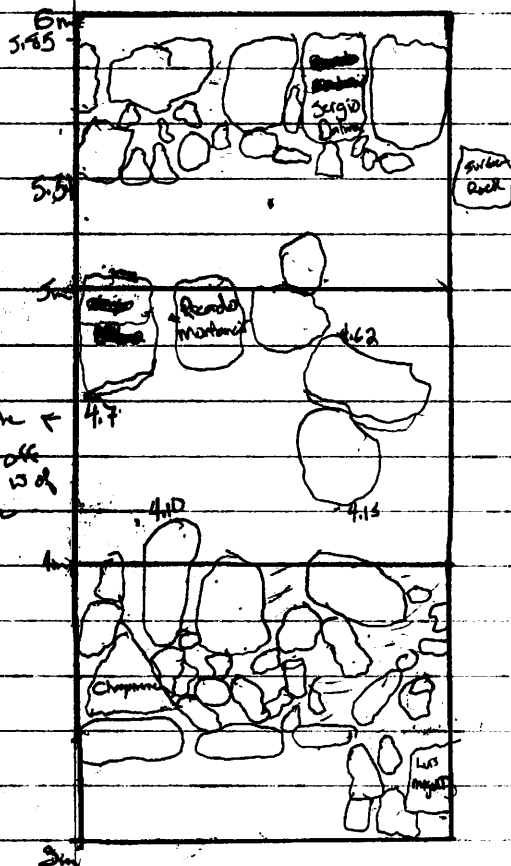

4230/15 - 7th 1x1m; 0-9m bgs show stepping shallows rather than rock cutting through a surface without a basal wall line to use as a guide. Drop back to the W end of the trench; designate it as 423T. Very few shreds.

8-66-67

after a while ~~the~~ with ~~and~~ $P=0$ in the $\#F$ - 21/0064
Many ~~times~~ a ~~small~~ ~~surface~~ ~~a~~ ~~small~~ ~~surface~~ ~~with~~
for ~~the~~ ~~at~~ ~~the~~ ~~surface~~ ~~the~~ ~~surface~~ ~~as~~ ~~well~~ ~~as~~ ~~and~~
which ~~may~~ ~~not~~ TE64 as ~~the~~ ~~surface~~ ~~the~~ ~~surface~~

LUIS MIGUEL - Step out from CHAYANNE depicted in the drawings of CHAYANNE (P92-22-) Run from 317 to 349 m W of E wall of 4230 at 17-27 m by NW. It's a step-out for the wall terrace. Orientation 80° E of N (declination set on 0°)

RICARDO MONTANER - Small wall line - 1 course. Oriented at 15° E of N. Very upturned line which stops half-way through the trench 4.75 - 5.0 m W of E wall of 4230, Oriented by NW. Wall stops at 75 cm N of S wall of trench

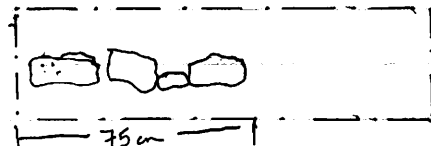
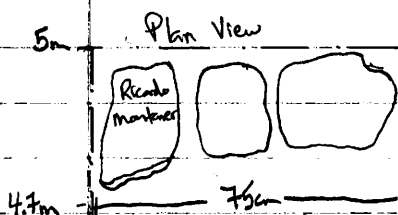

16 x 83 x 3 m

18 x 21 x 10 m

27 x 23 x 6 m

Sergio DALMA

This is a large rock wall which hasn't been fully defined yet. It's flat face are pointing W & it probably runs from 5.5 m - 6 m W of E wall of 4230. Well cut down in front of it (to W of it) when we reach the 7th km of 4230 coming in from the W side.

6m

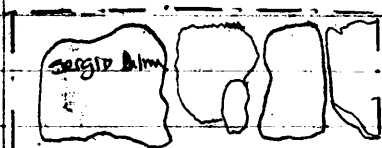

There are other rocks to the E, but, as of now, I'm not positive they're part of the feature.

4230/16 - See P92-22-20 (w/ sub. of T)

4230/17 - Clearing out 2 nodes between CHAYANNE & RICARDO MONTANER w/in 5th 1x1m having surface to 23 in bgs NEC
Santos Almeida

4230/18 - 1st Lateral Clearing lot - Following out CHAYANNE Directly S of 4230/09. 1-2m S of NW of 4230, 3-4m W of E end of 4230, 0-18' on bgs. From W side face of CHAYANNE to 4E on E of W face of CHAYANNE. Cutting down to top of CHAYANNE

4230/19 - Clearing between E face of RICARDO MONTANER & W Face of SERGIO DALMA w/in 6th 1x1m of 4230. 9-20 m bgs NEC. Defined E face at 5.4 m W of E end of 4230

4230/20 - Stepping back up to 7th 1x1m of 4230 to exam
Pass line between SERGIO DALMA & JLG. 13-25 m bgs

(T gauras k) 15-28-69 22 - 21/0.66

4350/F- (Cleaning and 9 other features) CHAIRMAN & RICARDO
WILLIAMSON 1001 AVE WLS 2nd floor furnished conference to 33 in job for
about 1 month

[illegible]

45301/18 - (Cont) From E face of RICHARD MOUNTAIN *
to base of Section D/LMA where E face of 45302 (J-20)
is top of E face of 45301

10/10/1950 - 10/10/1950

Sub-op 423T: Opened to begin W end of trench defined
as sub-op 4230 over str. 19, site 423. Trench is oriented at
288° E of N (Declination set at 0°)

423T/01 1st 1x1m of 423T (11th 1x1m of 4230); 0-20 cm bgs
NEC. Tiny bag of seeds. Very dark soil

423T/02 1st 1x1m of 423T; 20-40 cm bgs NEC. Seeds
small bag. took out 1 lg. rock

423T/03; 1st 1x1m of 423T; 40-60 cm bgs NEC. 3 seeds
hit the steel level, so we're moving up to the next meter.

423T/04 2nd 1x1m of 423T; 0-20 cm bgs NEC. A few
seeds.

423T/05 2nd 1x1m of 423T; 20-40 cm bgs NEC. Seeds, large.
this level is much more productive than the others have been.
Seeds, large, with some stick impressions - straight sticks
& gumie frag - chest fragment

423T/06 2nd 1x1m of 423T; 40-60 cm bgs NEC, hit rock
at 40+ and continuing down to discover it well. Slightly darker
softer earth.

highly likely to be a copy of the original (TCSA 90-100)
to which is about 10% of the original (TCSA 90-100)
(0 to 100% intervals) 1/1000000

2nd to 100% (TCSA 90-100) TCSA 90-100 1/1000000
has not yet been found yet

check 1, 2nd to 100% TCSA 90-100 1/1000000
has not yet been found yet

check 2, 2nd to 100% TCSA 90-100 1/1000000
has not yet been found yet

check 3, 2nd to 100% TCSA 90-100 1/1000000
has not yet been found yet

check 4, 2nd to 100% TCSA 90-100 1/1000000
has not yet been found yet

check 5, 2nd to 100% TCSA 90-100 1/1000000
has not yet been found yet

423T/07 - 3rd 1x1m. 0-20 cm bgs Yes! We're finally hitting rock again in the E 30 cm of the 3rd 1x1m. Sheds

423T/08 - Cutting down in front of the tumble line to establish a shallow base of excavation. Lot runs from 2.0 - 2.7m from W end of 423T. 20-40 cm bgs. Metatrypa, a few shubs, fig frag, bayesian flakes in soil, Oceanic frag. Hit base of tumble layer at 3.8 cm bgs NEC. Chert "flake"

423T/09 - 4th 1x1m of 423T; 0-20 cm bgs NEC Shubs

* 423T/10 - Putting tumble within the 3rd + 4th m of 423T. Measurements run from 3.8 - 5m E of W end of 423T. 20-38 cm bgs.

layer Shubs are coming
4m light pink pyramidal stone - 1st
3.7m true pyramidal stone have seen
here. FLAGGED coming down on a huge Lunell or, larger than usual patch of bayesian.
stopped lot at level of bayesian concentration.

423T/11 - Directly below 423T/10; 3.8-4 cm bgs. Cutting down below level of bayesian to see if the shell goes deeper (it doesn't).

allured... look... 00-0... 478 - FO/TEGA
... 00-0... 478 - FO/TEGA

... 00-0... 478 - FO/TEGA
... 00-0... 478 - FO/TEGA
... 00-0... 478 - FO/TEGA

... 00-0... 478 - FO/TEGA

... 00-0... 478 - FO/TEGA
... 00-0... 478 - FO/TEGA

... 00-0... 478 - FO/TEGA
... 00-0... 478 - FO/TEGA
... 00-0... 478 - FO/TEGA

... 00-0... 478 - FO/TEGA
... 00-0... 478 - FO/TEGA

423T/12 = Clearly tumble above JUAN LUIS GUERRA
in the E 70 m of 8th 1x1m 4230 (4th 1x1m 423T)

NEVER Excavated

423T/16 in 7th 1x1m of 4230 (5th 1x1m 423T) lay it down
to level of JLG 9-15 m bgs NEC floor - cobbles - coming
out ~~behind~~ behind (to E of) JUAN LUIS GUERRA took out
one huge rock between SERGIO DALMA &
JLG. Probably chipped through a cobble
surface (Very elemental) at 13 m bgs NEC

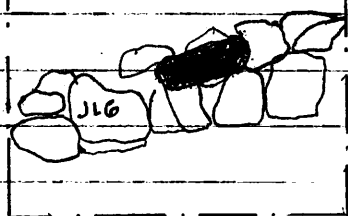

9-13 m bgs NEC in the center

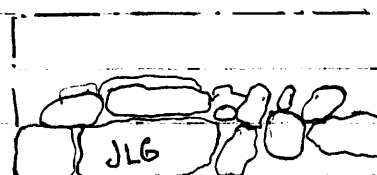

4230/21- From E face of CHAYANNE to 30 m E of E wall
from 1-2 m S of N wall of 4230. 20-30 m bgs.

4230/22- From 2-3 m S of N wall of 4230 ~~to~~ 3rd 1/2 m
of 4230 (lateral), 0-20 m bgs following CHAYANNE. Chayanne
comes 2-3 m S of N wall of 4230.

4230/23 clearly around S corner of CHAYANNE

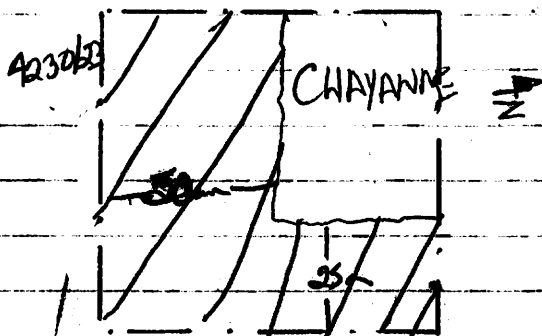

from E wall of CHAYANNE to 25 m E of corner. From S end
of CHAYANNE to 50 m S of corner. 20-33 m bgs.
Dents, Prograde obduction blade

4230/24- clearly ALEJANDRA GUZMAN wall which comes
with CHAYANNE. 25-125 m E of W face of CHAYANNE, over
to 0 of CHAYANNE to .5 m S of S face of ALEJANDRA
0-13 m bgs. There another possible W-S line coming out

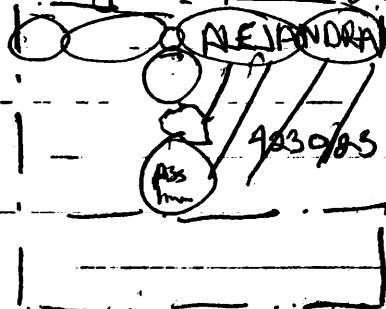

From N side of
ALEJANDRA

1930/191 - 1930/191
 1930/191 - 1930/191

1930/191 - 1930/191
 1930/191 - 1930/191

1930/191 - 1930/191

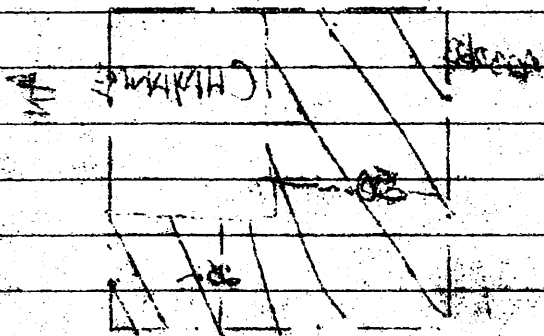

1930/191 - 1930/191
 1930/191 - 1930/191

1930/191 - 1930/191
 1930/191 - 1930/191

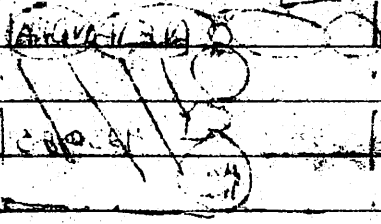

423T/13 - Following JLG to S. 3rd 1km of 423T; 1-2m S of N wall of 423T 0-18 on bgs NEC. From E side of JLG to 20m W of W face of JLG.

423T/14 cutting down in front of (40 E of) JLG from W face of JLG to 30m W of W face (from 3-33m E of W end of 423T) 1-2m S of N wall of 423T 18-37 on bgs Sheds. There are a few sheds coming out this time. There may also be a surface of some sort running into the plaza - but as there are rocks which are obviously tumbled a few centimeters below, I think the old ground surface must have been close to that level & they just fell there. Whoever takes over on this structure should check it out. There is also a large root eating through the wall line 1.7m S of N wall of 423T so were going to take it 1m further S. Hope to find the corner there.

423T/15 Following JLG to S. 2-3m S of N wall 423T; 3-4m E of W end of 423T 0-15 on bgs JLG comes S of N wall of 423T

423T/16 below 423T/15
ALEJANDRA.

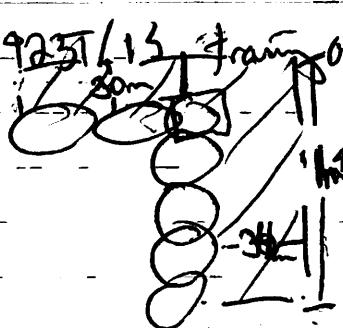

framing outline of JLG's corner of Only A didn't corner 423T/16 so we just cleared the E 34 cm leaving the rocks with 3 cm

2-11-1961 TEST for water in oil at 216 psi 2-11-1961
2-11-1961 TEST for water in oil at 216 psi 2-11-1961

1. The first part of the paper is a review of the literature on the topic of the effect of the environment on the development of the human brain. This part is divided into two sections: the first section discusses the effect of the environment on the development of the brain in general, and the second section discusses the effect of the environment on the development of the brain in specific areas, such as the motor cortex and the language cortex.

[illegible]

(for some) & d/c for culture - must d/c test - what d/c TEST
some) think it's a p/d

the bacteria say are w/directly
with good, no PE →

- some & into incubator

H₂O

4230/25 - Clay to S of ALEJANDRA directly below S 50m of 4230/24. 13-30 cm bgs - line wasn't real ^{maybe it was caps} so I took it out. Dirt is much harder, tumbler more densely packed. Caps - JLG doesn't cover a 2.56 m soft wall & it continues and the line (well, stone) I rapped in 4230/23 appears to continue to S as well. See in view! Possible full lot

4230/26 - 1.21m directly S of 4230/24 0-20 cm bgs following remnants of possible step-out. Fly fly, birds, scored, censored. lot fly

4230/27 - ^{below} E 50m of 4230/26; 20-35 cm bgs cutting down to E of possible step-out.

4230/28 1.11m directly S of 4230/26 - ^{4.5} 1.8m S N wall 4230 4-5m W of E wall 4230) 0-20 cm bgs shade

4230/29 directly below 4230/28; 20-40 cm bgs - looks like the surface might have ended Rock concentrations ends

4230/30: 1.25m x 1m to follow out N side of CHAYANNE (1.25 is E-W) 2.75-4m W of E wall 4230; 0-1m N of N wall 4230. From 50m E of ~~E~~ face CHAYANNE to ~~W~~ face of CHAYANNE. From 2.54 to 3.54 - N of S face of ALEJANDRA GUZMAN - following out LUIS MIGUEL + CHAYANNE to N. 0-20 cm bgs

2nd 2nd place ASHLEY to 2 at 100 - 20/100
 2nd 2nd place ASHLEY to 2 at 100 - 20/100
 2nd 2nd place ASHLEY to 2 at 100 - 20/100
 2nd 2nd place ASHLEY to 2 at 100 - 20/100
 2nd 2nd place ASHLEY to 2 at 100 - 20/100

2nd 2nd place ASHLEY to 2 at 100 - 20/100
 2nd 2nd place ASHLEY to 2 at 100 - 20/100
 2nd 2nd place ASHLEY to 2 at 100 - 20/100
 2nd 2nd place ASHLEY to 2 at 100 - 20/100

2nd 2nd place ASHLEY to 2 at 100 - 20/100
 2nd 2nd place ASHLEY to 2 at 100 - 20/100
 2nd 2nd place ASHLEY to 2 at 100 - 20/100
 2nd 2nd place ASHLEY to 2 at 100 - 20/100

2nd 2nd place ASHLEY to 2 at 100 - 20/100
 2nd 2nd place ASHLEY to 2 at 100 - 20/100
 2nd 2nd place ASHLEY to 2 at 100 - 20/100
 2nd 2nd place ASHLEY to 2 at 100 - 20/100

2nd 2nd place ASHLEY to 2 at 100 - 20/100
 2nd 2nd place ASHLEY to 2 at 100 - 20/100
 2nd 2nd place ASHLEY to 2 at 100 - 20/100
 2nd 2nd place ASHLEY to 2 at 100 - 20/100

2nd 2nd place ASHLEY to 2 at 100 - 20/100
 2nd 2nd place ASHLEY to 2 at 100 - 20/100
 2nd 2nd place ASHLEY to 2 at 100 - 20/100
 2nd 2nd place ASHLEY to 2 at 100 - 20/100
 2nd 2nd place ASHLEY to 2 at 100 - 20/100

4230/31 - Cutting down in front of the E face of WIS-MIGUEL
2.75-3.25m W of E end of 4230, 0-1m N of N wall 4230
from E face of LM to 50m E of same 4.54-3.84m ^{N 70° E} 20-27m
bgs. possible line; possible tumble loose meter!

4230/32 - 1.25x1m N of 4230/30 2.75-4m W of E end
4230, 1-2m N wall 4230. 3.64-4.34 m N of S face of
the GUE, from W face of CHAYANNE to 1.25m E of same. 0-19
m bgs

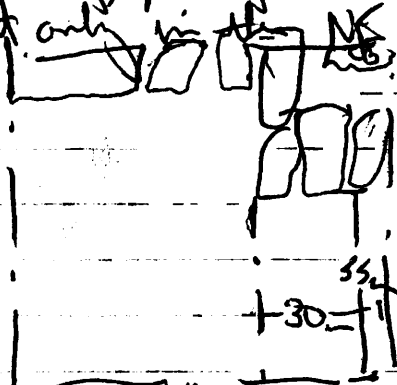
4230/33 - clean/pulling tumble below 4230/32; ~~4230~~
a bgs but only in the NE corner and possible step-out
 1.25m E of W wall
4230/32; 30m S of N wall
same

2.75 3.3m W of E end 4230, 1.4-2 m N of N wall 4230
19-30 m bgs

4230/34 - Clean tumble to find E face of CHAYANNE below
the rest of the square defined by 4230/32 2.75-4m W of
E End of 4230; 1-1.7m N of N wall 4230 19-25m bgs
cutting down in front of CHAYANNE. were encountering harder
lignum-flecked sil. This could indicate a bit of tumbled
rock

[illegible]

~~1000~~ 82/0EEF volad elat pilleq/vindly 82/0EEA
two-jkt. along two rivers 24-~~26~~ in the forest road
Kauai 107-066-DE
Kauai 107-066-DE
~~one~~

free
H=DE

[illegible]

Net is defined as 2-3m S of N wall 423T; from W face to E of W of W face of JLG 15-37m bgs.

423T/17 3-4m S of N wall 423T, 3-4m E of W wall 423T
0-20 m bgs, falling JLG to S. Sheds

423T/18 3-4m S of N wall 423T, 3-4m E of W wall 423T, directly below 423T/17 - clearing down deeper over rocks possible corners. 20-30 m bgs Sheds

423T/19 4-5m E of W wall 423T, 3-4m S of N wall 423T; 0-30 m bgs. Sheds

423T/20, 5-6m E of W wall 423T, 3-4m S of N wall 423T
0-20 m bgs. Found Sweet wall within 423T/19 - Very lg rocks which might corner with ALEXANDRA GUEZ (or not - that's what we're going to look at, OK?!) Sheds

423T/21 - 5-6m E of W wall 423T, 2-3m S of N wall 423T; 0-25 m bgs clearing out lg. line which cornered w/ JLG - disappeared N in 423T/21

423T/22 Clearing beneath 423T/21 + 423D/30 pulling rocks over possible platform 25-30 m bgs. I'm not sure if

at ... TEST ...

TEST ...

TEST ...

TEST ...

TEST ...

TEST ...

TEST ...

4230/33 W of 4230/34 (32) 4-5m W of E wall 4230; 1.2m N N wall 4230; following possible turn of CAAYANNE - no clear corner but the wall dies before the large concentration of rocks on the NW corner of 4230/34. We should have shot it out but, right now, if there is a corner, I've got to find it. 0-20 on bgs

4230/36 Excavating in the N 50m below 4230/35, checking possible corner on CAAYANNE 20- on bgs 1.5-2m N; 4-5m W.

4230/37 Pulling those other rocks I left to E of CAAYANNE - they just didn't look like anything & I needed a good wall-line. 0-1m N of N wall 4230; 0-50m W of E face CAAYANNE 40-50m bgs.

4230/38 Sil-Gm W of E wall; 1-2m N N wall 4230. 0- on bgs

100-66-679

100-66-679 (66) 100-66-679
on 100-66-679 to 100-66-679
The 100-66-679 is 100-66-679
two 100-66-679 is 100-66-679
top 100-66-679 is 100-66-679
100-66-679 is 100-66-679

100-66-679 is 100-66-679
100-66-679 is 100-66-679

100-66-679 is 100-66-679
100-66-679 is 100-66-679
100-66-679 is 100-66-679

100-66-679 is 100-66-679
100-66-679 is 100-66-679

it's a surface or not so I'm going to leave all of the rocks and the edges & take it down to see if we had anything in the center. All of the rocks were really tilted & tilted beds, as nothing coming out underneath I may have guessed. If so, I'll shoot in the corners and define it as a terrace. I did have to cut down in front of the wall, anyway, to define it. ~~Oops! Nothing there~~ ^{into 30m by}

423T/23 - Falling out SERGIO DALMA to S S. 3-6.3m W of E and 4230; 1-2m S N wall 423T; ~~from~~ E face SERGIO to SO on W of Sine 0-6m by

423T/24 Chasing out W face of SERGIO 0-50m W w face; 1-2m S N wall 423T; 6-20m on by; looks good. Caves w/ the GUZ

423T/25 0-50m W W face SERGIO DALMA 2-3m S N wall 423T; 0-20m on bys LO-1m N of S face GLORIA TREVI

423T/26 SO-12m W of W face SERGIO DALMA; 1-2m S N wall 4230 LO-1m N S face GLORIA TREVI 0-20m on bys facing corner of GLORIA TREVI + JLG. Sheds 6.3-7m W

423T/27 12-29m W of W face of SERGIO DALMA; 0-1m S of N wall 4230 LO-1-2m N S face Gloria Trevi 0-20m by Ben Bonto el cuato!

Mini Final Notes Str. 19, Site 423					
Feature	Orientation	hgs ^{top}	E-W	N-S	Rock Sizes
Luis Miguel	100° E of N	43-57m	3.0-3.48	14-32m	22x16x9m, 12x20x9m, 28x28x18m 10x15x2m
Chapman	30° E of N	36-61m	3.48-4m	1.3-2.54	24x14x8; 10x7x4, 22x12x20m
Alexandra Green	286° E of N	30-53 ^{base} m	3.6-5.8m	2.15-2.5	50x15x30m, 29x22x8m 24x17x9 4x6x2m
Gloria Trell	287° E of N	30-55m	5.6-7.5	2.5-3m	40x30x20, 36x26x12, 39x24x22 35x20x10
Ricardo Montano	23° E of N	26-38m	4.7-5m	22-94m	25x15x9m, 19x15x6m, 20x24x3m
Sergio Dalmia	29° E of N	30-42 ^{base} m	4.35-5.85	0-2.6m	33x20x9m, 18x30x10m, 24x15m
Juan Luis Green	18° E of N	19-55m (30-55 sand)	7.03-7.70	0-3m	13x15x10m, 80x13x6m, 13x18x6m

BGS DATUM: hgs datum has been set up at (X) on DERSIO
DALMA 5.80m W of E end of 4230; 9m S of N wall 4230
Datum = 20m above (X)

Datum = 20 cm above (X)

Secondary datum is 15m above (X) on Surface-Visible rock at
5.48m W of E end 4230, 12m S of N wall 4230

884 22 Pl. 212 206/1 1007 1011

[illegible]

12832 to (X) to get the next end match of: MUTAD 228
 0888 then in for up, 0888 then in for up AMUTAD
 (X) end of match

⑧ $\text{mols} \rightarrow \text{GL} = \text{mols}!$

24.8.1962 1st and 2nd 1962, 1961, 1960, 1959, 1958, 1957, 1956, 1955, 1954, 1953, 1952, 1951, 1950, 1949, 1948, 1947, 1946, 1945, 1944, 1943, 1942, 1941, 1940, 1939, 1938, 1937, 1936, 1935, 1934, 1933, 1932, 1931, 1930, 1929, 1928, 1927, 1926, 1925, 1924, 1923, 1922, 1921, 1920, 1919, 1918, 1917, 1916, 1915, 1914, 1913, 1912, 1911, 1910, 1909, 1908, 1907, 1906, 1905, 1904, 1903, 1902, 1901, 1900, 1899, 1898, 1897, 1896, 1895, 1894, 1893, 1892, 1891, 1890, 1889, 1888, 1887, 1886, 1885, 1884, 1883, 1882, 1881, 1880, 1879, 1878, 1877, 1876, 1875, 1874, 1873, 1872, 1871, 1870, 1869, 1868, 1867, 1866, 1865, 1864, 1863, 1862, 1861, 1860, 1859, 1858, 1857, 1856, 1855, 1854, 1853, 1852, 1851, 1850, 1849, 1848, 1847, 1846, 1845, 1844, 1843, 1842, 1841, 1840, 1839, 1838, 1837, 1836, 1835, 1834, 1833, 1832, 1831, 1830, 1829, 1828, 1827, 1826, 1825, 1824, 1823, 1822, 1821, 1820, 1819, 1818, 1817, 1816, 1815, 1814, 1813, 1812, 1811, 1810, 1809, 1808, 1807, 1806, 1805, 1804, 1803, 1802, 1801, 1800, 1799, 1798, 1797, 1796, 1795, 1794, 1793, 1792, 1791, 1790, 1789, 1788, 1787, 1786, 1785, 1784, 1783, 1782, 1781, 1780, 1779, 1778, 1777, 1776, 1775, 1774, 1773, 1772, 1771, 1770, 1769, 1768, 1767, 1766, 1765, 1764, 1763, 1762, 1761, 1760, 1759, 1758, 1757, 1756, 1755, 1754, 1753, 1752, 1751, 1750, 1749, 1748, 1747, 1746, 1745, 1744, 1743, 1742, 1741, 1740, 1739, 1738, 1737, 1736, 1735, 1734, 1733, 1732, 1731, 1730, 1729, 1728, 1727, 1726, 1725, 1724, 1723, 1722, 1721, 1720, 1719, 1718, 1717, 1716, 1715, 1714, 1713, 1712, 1711, 1710, 1709, 1708, 1707, 1706, 1705, 1704, 1703, 1702, 1701, 1700, 1699, 1698, 1697, 1696, 1695, 1694, 1693, 1692, 1691, 1690, 1689, 1688, 1687, 1686, 1685, 1684, 1683, 1682, 1681, 1680, 1679, 1678, 1677, 1676, 1675, 1674, 1673, 1672, 1671, 1670, 1669, 1668, 1667, 1666, 1665, 1664, 1663, 1662, 1661, 1660, 1659, 1658, 1657, 1656, 1655, 1654, 1653, 1652, 1651, 1650, 1649, 1648, 1647, 1646, 1645, 1644, 1643, 1642, 1641, 1640, 1639, 1638, 1637, 1636, 1635, 1634, 1633, 1632, 1631, 1630, 1629, 1628, 1627, 1626, 1625, 1624, 1623, 1622, 1621, 1620, 1619, 1618, 1617, 1616, 1615, 1614, 1613, 1612, 1611, 1610, 1609, 1608, 1607, 1606, 1605, 1604, 1603, 1602, 1601, 1600, 1599, 1598, 1597, 1596, 1595, 1594, 1593, 1592, 1591, 1590, 1589, 1588, 1587, 1586, 1585, 1584, 1583, 1582, 1581, 1580, 1579, 1578, 1577, 1576, 1575, 1574, 1573, 1572, 1571, 1570, 1569, 1568, 1567, 1566, 1565, 1564, 1563, 1562, 1561, 1560, 1559, 1558, 1557, 1556, 1555, 1554, 1553, 1552, 1551, 1550, 1549, 1548, 1547, 1546, 1545, 1544, 1543, 1542, 1541, 1540, 1539, 1538, 1537, 1536, 1535, 1534, 1533, 1532, 1531, 1530, 1529, 1528, 1527, 1526, 1525, 1524, 1523, 1522, 1521, 1520, 1519, 1518, 1517, 1516, 1515, 1514, 1513, 1512, 1511, 1510, 1509, 1508, 1507, 1506, 1505, 1504, 1503, 1502, 1501, 1500, 1499, 1498, 1497, 1496, 1495, 1494, 1493, 1492, 1491, 1490, 1489, 1488, 1487, 1486, 1485, 1484, 1483, 1482, 1481, 1480, 1479, 1478, 1477, 1476, 1475, 1474, 1473, 1472, 1471, 1470, 1469, 1468, 1467, 1466, 1465, 1464, 1463, 1462, 1461, 1460, 1459, 1458, 1457, 1456, 1455, 1454, 1453, 1452, 1451, 1450, 1449, 1448, 1447, 1446, 1445, 1444, 1443, 1442, 1441, 1440, 1439, 1438, 1437, 1436, 1435, 1434, 1433, 1432, 1431, 1430, 1429, 1428, 1427, 1426, 1425, 1424, 1423, 1422, 1421, 1420, 1419, 1418, 1417, 1416, 1415, 1414, 1413, 1412, 1411, 1410, 1409, 1408, 1407, 1406, 1405, 1404, 1403, 1402, 1401, 1400, 1399, 1398, 1397, 1396, 1395, 1394, 1393, 1392, 1391, 1390, 1389, 1388, 1387, 1386, 1385, 1384, 1383, 1382, 1381, 1380, 1379, 1378, 1377, 1376, 1375, 1374, 1373, 1372, 1371, 1370, 1369, 1368, 1367, 1366, 1365, 1364, 1363, 1362, 1361, 1360, 1359, 1358, 1357, 1356, 1355, 1354, 1353, 1352, 1351, 1350, 1349, 1348, 1347, 1346, 1345, 1344, 1343, 1342, 1341, 1340, 1339, 1338, 1337, 1336, 1335, 1334, 1333, 1332, 1331, 1330, 1329, 1328, 1327, 1326, 1325, 1324, 1323, 1322, 1321, 1320, 1319, 1318, 1317, 1316, 1315, 1314, 1313, 1312, 1311, 1310, 1309, 1308, 1307, 1306, 1305, 1304, 1303, 1302, 1301, 1300, 1299, 1298, 1297, 1296, 1295, 1294, 1293, 1292, 1291, 1290, 1289, 1288, 1287, 1286, 1285, 1284, 128

200 00 27

Sketch map Str. A, Sate 423; AS of 14 febrero, 1992

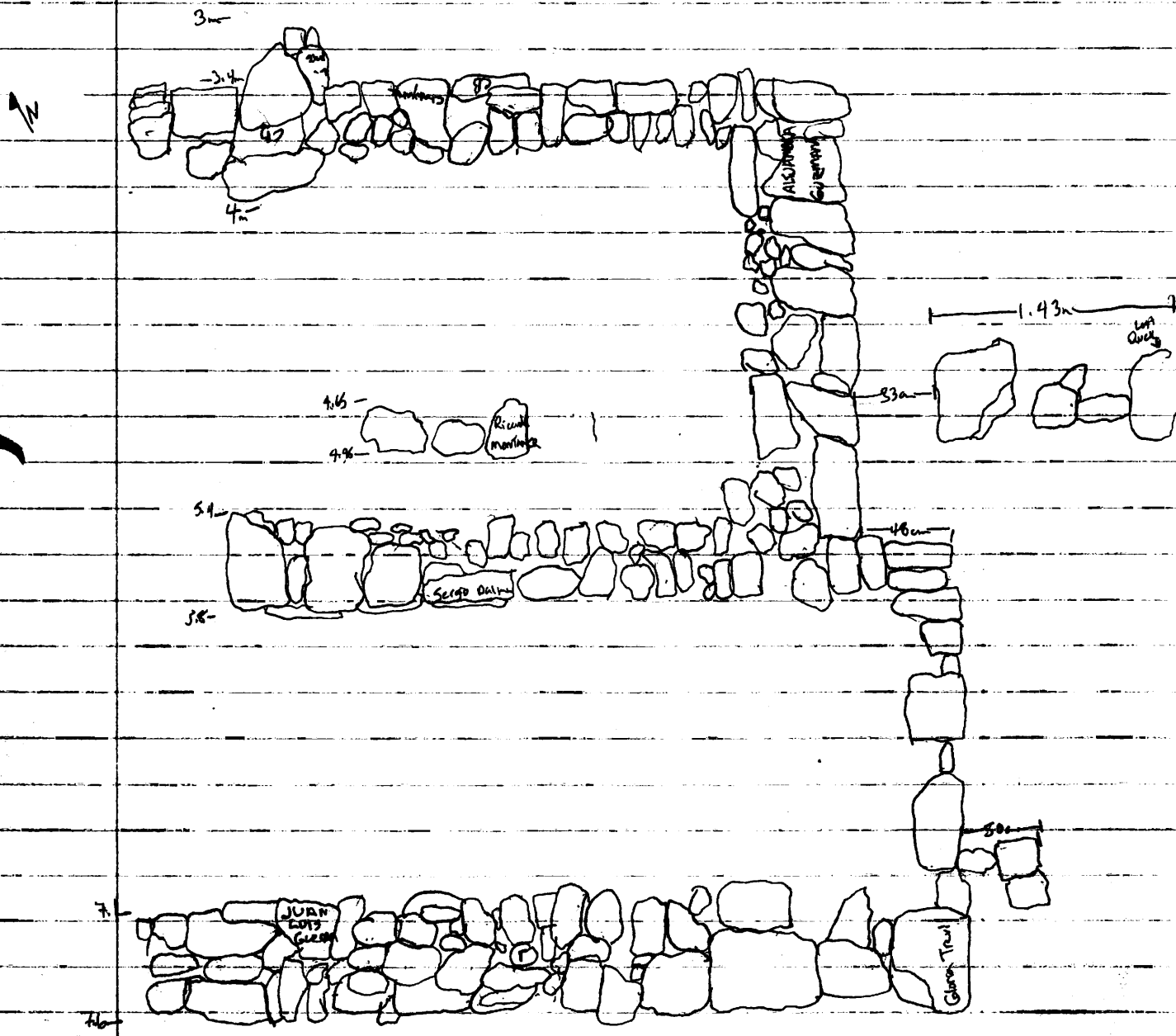

FA 88 000

SNY, number 11 to 24, 1962, 17 1/2 per cent

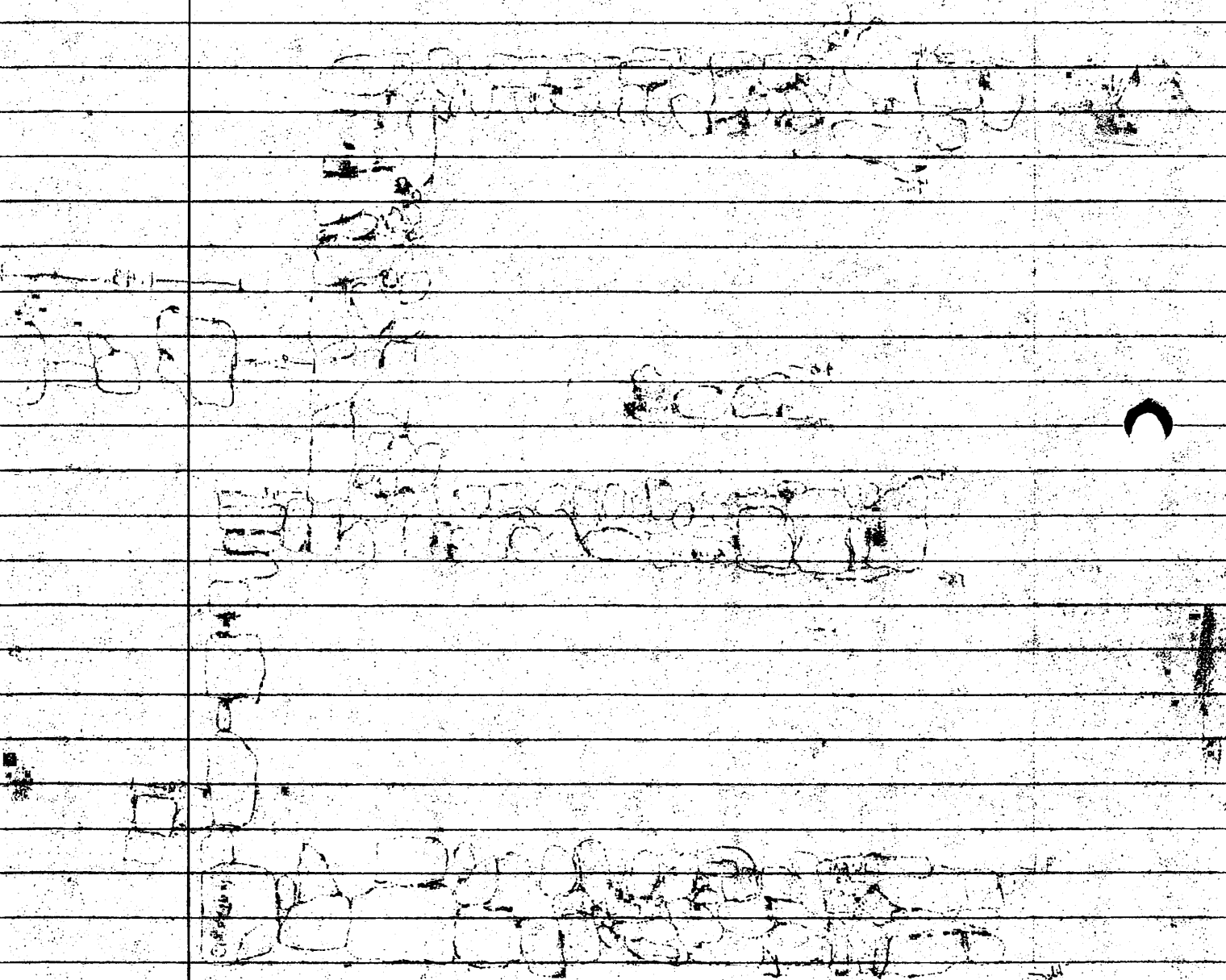

Possible Wall Names Site 19, Site 423

✓ Luis Miguel

✓ Chango

✓ Sergio Dalma

✓ Ricardo Martinez

Kian

Glain Tavi

✓ Alejandra Gump

✓ ~~Jose~~ Luis Guerra

✓ Luis Enrique

Magneto

Mecano

Banda Blanca

✓ Banda Blanca

✓ Franco de Vita

Emanuel

Marta

✓ ET General

✓ Lucero

Miguel Gallardo

Miriam Hernandez

Flans

403E/38

Inscribed Trough Flung Headings
w/

Site Description Site 464

098-22-

We are approximately 2 km N of San Antonio and about 200-250 m SE of Site 461 (from Site 464 Site 461 is down a slight slope to the river and up the next hill. If there were less vegetation it would be possible to see Site 461 from here). This site is composed of 5 mounds which range in size from 1 km to 50m in elevation. The mounds lie in a field which until this morning lay under moderate to thick vegetation - scrubby bushes with grass and occasional small trees mixed in. There is a large tree in the SW of Str. 2. The site was still smoldering when we arrived. There are also a few cacti and some burnt corn stalks present. The river is about 100m to the N of the Northernmost mounds and the entire site is built into a bluff which overlooks a plain (lightly planted with corn) which leads down to the river. Str. #1 is a strikingly large mound (about 11x10m) and approx. 1.5 m high. It is the southernmost mound in the group and appears to be constructed of river cobbles which are fairly evenly scattered about the surface. There may have been a patio/terrace platform jutting off the non-patio (S) side. No looty is apparent on this structure. Str. 2 lies to the NE of Str. 1. It is slightly lower and includes a number of tiny, med rocks scattered on the surface which looks slightly disturbed, as if someone removed the dirt & left all of the small rocks. There is a large tree in the SW. This mound looks as if the fill has been pulled to the surface & left there. 5x6' and 1m high this structure seems to face W into the plaza area (it faces Site 461 on the hillside above) It really does seem to be disturbed. Str. 3 lies to the NW of Str. 2 opening onto the plaza facing SW - it rises up the NW side. It is smaller than the other structures and is built along the N edge of the bluff/rise. There are med. sized river cobbles here with a few occasional large rocks.

There may be a terrace on the NW side of Str. 2

(Although the field has been lightly planted in corn, there are a number of good-sized rocks scattered throughout the area (mainly cobbles). Str. 3 is about 3×2 m and 50 cm high. There is one large boulder set into the S.W. and there are a few scrub stumps on A as well - the pebbles seen on Str. 2 are not present here. Str. 4 is a very small / rather dubious mound which may in fact be a small (1×2 m) structure built onto the NW side of the rise. There is a possible line visible on the N (running E-W) but that's really about it. No appreciable elevation ^{sees} into the plaza. No apparent looting damage. Str. 5 may have been attached to the W side of Str. 1. It is a smaller mound than mound A1 and is built into the SW side of the rise. River cobbles (med-sized) but none of the small stones seen on Str. 2. It is about 1 m W of Str. 1 + it forms the W side of the plaza.

Site 464 Mapping Points:

Distance (m)	X angle	Point
9.40	120°	Str. 1 NE cor. 1
14.90	134°	SE 2
14.65	144°	inset cor. NE 3
19.15	146°	SE cor. inset. 4
19.24	160°	SW cor. inset 5
16.95	159°	NW cor. inset 6
18.10	188°	SW cor. 7
16.00	197°	Str. 5 SW cor. 8
12.00	216°	SE cor. 9
17.47	228°	NE cor. 10
16.54	244°	Str. 4 NW cor. 11
14.40	240°	SW cor. 12
12.35	259°	NE cor. 13
6.42	295°	Str. 3 NW cor. 14
3.80	341°	SE cor. 15
3.11 4.30	350°	SE cor. 16
8.40	28°	Str. 2 NW cor. 17
17.35	56°	NE cor. 18
7.13	115°	SW cor. 19

Some may have to subtract 180° - may have read wrong end of compass needle

五

Station	Depth (m)	Temperature (°C)	Salinity (‰)	Density (σ _t)
1	0.4	15.0	34.1	1.020
2	0.4	13.4	34.1	1.020
3	1.4	14.4	34.1	1.020
4	2.1	14.4	34.1	1.020
5	4.5	14.0	34.1	1.020
6	12.4	12.4	34.1	1.020
7	18.1	18.8	34.1	1.020
8	19.0	19.4	34.2	1.020
9	15.3	15.0	34.2	1.020
10	17.4	15.5	34.2	1.020
11	17.4	15.4	34.2	1.020
12	14.0	14.0	34.2	1.020
13	15.3	15.2	34.2	1.020
14	14.0	14.5	34.3	1.020
15	12.8	14.4	34.3	1.020
16	14.0	14.0	34.3	1.020
17	14.0	14.0	34.3	1.020
18	14.0	14.0	34.3	1.020
19	14.0	14.0	34.3	1.020

pen. wood
or snail
- 301 twitt-due
bush snail farm
to live person
every day was

PNN Figurine Lists 1992 (cont.)

Ocarinas + Figurines

Lot #/cat #	Part #	Object	Measurements + Description
4884/18-2 - ocarina -	J	Solid rectangular Support	width 9.3- Length 2.9- wall thickness .5- Broken. Solid ocarina support which opens into a large, mold made spherical sandy chamber. What broke along the cut mark. Paste interior is completely fire-cured. No paint or slip.
30680/03-4 - figurine -	G	2 Solid. Nubbin Supports	ht 1.1- width .8- Length 2.8- Thickness 2.3- Two closely placed. Solid nubbin supports which open into a rounded - but not mold made chamber. Supports are worn at the bottom (firing core shows through). Probably represent nubbin legs on a small figurine. No paint or slip.
4884/19-2 - Ocarina -	G	Solid, conical Nubbin Support	width: 2- height: 1.7- thickness: 1.5- Solid conical support which opens into a mold made spherical sandy chamber. No visible cut marks. Very rounded surface. No paint or slip. No firing core.
816/02 - Ocarina -	F	Solid, conical Support	width: 3.9- height: 2.3- thick: 1.2- One complete or partial conical support which opens into a mold made spherical sandy chamber with a horizontal cut mark. Paste Cured by Core. No paint or slip.
423M/10-1 - ocarina -	G	Solid, rectangular Support	width 2.9- ht: 1.6- thickness: 2.6- Solid, rectangular support which opens into a mold made SSC. With a vertically oriented cut mark whose edges are very ragged + rough. Two stops punched from the outside toward the inside at the level where the support joins the chamber. No paint slip, or firing damage.

<p> The first thing I noticed when I stepped out of the plane was the cold. It was a sharp contrast to the warm, humid air of the tropics. I shivered slightly, pulling my jacket closer. The ground below was a patchwork of green fields and small villages, looking so peaceful from up here. </p>	<p> 10/1/79 10/1/79 10/1/79 </p>	<p> 10/1/79 10/1/79 10/1/79 </p>
<p> As we descended, the view became clearer. The fields were a vibrant green, and the small houses with their thatched roofs were scattered across the landscape. I could see the winding paths that cut through the fields, leading to the small clusters of buildings. </p>	<p> 10/1/79 10/1/79 10/1/79 </p>	<p> 10/1/79 10/1/79 10/1/79 </p>
<p> The plane touched down with a soft thud, and the engines slowed to a idle. I felt a slight jolt as the plane came to a stop. The ground was firm but had a slight give to it. I looked out the window again, taking in the sight of the small town below. </p>	<p> 10/1/79 10/1/79 10/1/79 </p>	<p> 10/1/79 10/1/79 10/1/79 </p>
<p> I stepped out of the plane and took a deep breath. The air was cool and fresh, a welcome change from the stale air of the cabin. I looked around, taking in the sights and sounds of this new place. The people walking around seemed to be in a hurry, but there was a certain calm about them. </p>	<p> 10/1/79 10/1/79 10/1/79 </p>	<p> 10/1/79 10/1/79 10/1/79 </p>
<p> The journey had been smooth, and I was looking forward to what was ahead. The small town below seemed like a perfect place to start my new life. I took another look at the landscape, feeling a sense of peace and tranquility. </p>	<p> 10/1/79 10/1/79 10/1/79 </p>	<p> 10/1/79 10/1/79 10/1/79 </p>

PVN Figure & Ocarina Lists 1992 (cont)

Lg/Cat #	Pete	Object	Description & Measurements
386K/31-1	F	Rectangular Support (Solid)	width: 2.2 Solid rectangular support which opens length: 1.7m into a mold made J.S.C. thick: 1.1m
423R/49-1	G	Solid conical Support	width: 2m Solid conical support which opens ht: 1.7m into a m.m. J.S.C. with one cut mark. Central fig core. No paint or slip.
356G/10-2 Ocarina	G	Solid ocarina limb	diam: 1.4m Solid, cylindrical ocarina limb with length: 1.4m a single piece (b. by through fragment) Central fig core - No core in piece) No paint or slip.
426H/50-1 Ocarina	G	Solid ocarina limb	diam: 1.5 Solid, conical (tapers to a point) ocarina limb. hole at tip, attachment scar at broad end. Central fig core. No paint or slip.
386E/34-2 Ocarina	G	Solid ocarina limb	diam: .9 Solid, cylindrical ocarina limb with length: 2.8- roughly shaped hand. The interior part of the arm is flattened & entire limb is slightly curved. One of the limbs which sticks straight out. Central fig core. burnt or exterior.
262C/02-3 Ocarina	F	Solid ocarina limb	diam: 1.5m Solid, fork, conical ocarina limb. length: 2.7m limb curves sharply at "elbow". tip broken. NO paint or slip. NO fig core.
445/68-3 Ocarina	G	Ocarina limb attachment scar	width: 1.6m Attachment scar for an ocarina. Length: 2m limb. 1 fractured stop present behind an opening into a m.m. SSC. Central fig core in scar.
262L/19-2 Ocarina	G	Solid ocarina limb w/ a portion of m.m. SSC to which it connects	diam: 2m Part of a Taper Solid, conical ocarina limb. length: 2.9m Limb is slightly curved (one of the arms that sticks straight out from the body) Part of the m.m. SSC with a cut mark through center line of limb (long) and No. had most (not broken, just not visible) one scar.

<p>1-10-1971</p>	
<p>1-10-1971</p>	<p>1-10-1971</p>
<p>1-10-1971</p>	<p>1-10-1971</p>
<p>1-10-1971</p>	<p>1-10-1971</p>
<p>1-10-1971</p>	<p>1-10-1971</p>
<p>1-10-1971</p>	<p>1-10-1971</p>
<p>1-10-1971</p>	<p>1-10-1971</p>
<p>1-10-1971</p>	<p>1-10-1971</p>
<p>1-10-1971</p>	<p>1-10-1971</p>
<p>1-10-1971</p>	<p>1-10-1971</p>

Figuring + Occasion Lists (Cont) PIN 1992

Figuring + Occasion	Object	Measurements + Description
423 A0/05-3 -Occasion-	F Solid conical support	width: 2.2m height: 1.3m wall thick: .3m diam: .7m Solid conical support which opens into a m-m SSC w/ a cut mark which bypasses the margin of the support. No paint slip or firing damage.
386 C/17 -Figuring-	G Plain body Frag	width: 2.9m length: 2.9m thick: .3m Absolutely plain, curved fig body frag. Interior shifted fig core. No paint slip
386 B/13-1 -Fig-	F Plain body Frag	width: 2.3m length: 5.7m thick: .7m Absolutely plain curved, thin body frag. Light interior shifted fig core. No paint slip ended
386 G/13 -Fig-	F Plain body Frag	width: 1.7m length: 3.9m thick: .3m Plain, curved body fragment. Eroded. No paint or slip
423 A0/02-1 -Fig-	G Face Frag	width: 2.7m length: 5m thick: .5m Face fragment with the upper portion of an almond shaped eye. Curved back surface. No paint or slip. No firing damage.
423 V/10-1 -Fig-	F Plain body Frag	width: 2.8m length: 3.2m thick: .8m Plain, curved body frag. No paint or slip. No firing damage.
423 B/05 -OC-	G Body Frag w/a slip	width: 2.8m length: 3.5m thick: 1m Oc body with a cut mark, a pitted head joint, and a smoothed marginal area where head joins foot. No paint or slip. Very bad posture.
423 D/07-2 -Fig-	K Body Frag w/ raised band	width: 2m length: 3.3m thick: .6m Fig body with a raised band on the interior surface. Central fig core. No paint or slip.
423 J/13-1 -Fig-	F Plain body Frag	width: 2m length: 2.3m thick: 1m Fig body fragment with a small protrusion (Wulfer - like) interior shifted fig core. No paint or slip.
423 H/14-1 -Fig-	G Plain Body Frag	width: 1.7m length: 2m thick: .5m Plain body frag. Smooth interior. No paint or slip. No firing damage.
423 R/16-1 -Fig-	G Box	width: 1.3m length: 1.8m thick: .4m Plain flat box. No paint or slip. Tiny frag.
423 F/05-2 -Fig-	G Plain Body Frag	width: 1.9m length: 2.3m thick: .6m Plain, curved body frag. Central fig core.
	G Anthropomorphic Facial Frag (Hollow)	width: 3.5m length: 3m thick: .9m Very cracked Face Frag. Shit eyes, slip in mouth. Rough interior surface. Face is hollow.

	<p>1000/1000</p>	<p>1000/1000</p>	
	<p>1000/1000</p>	<p>1000/1000</p>	
	<p>1000/1000</p>	<p>1000/1000</p>	
	<p>1000/1000</p>	<p>1000/1000</p>	
	<p>1000/1000</p>	<p>1000/1000</p>	
	<p>1000/1000</p>	<p>1000/1000</p>	
	<p>1000/1000</p>	<p>1000/1000</p>	
	<p>1000/1000</p>	<p>1000/1000</p>	
	<p>1000/1000</p>	<p>1000/1000</p>	

DVN 1992 Figures + Objects List

Label	Post	Object	Measures + Description
423K/11	F	Plain Fig Base	width 3.1~ Plain fig base. Flat base, rounded side length: 4.2~ thickness: 1.3~ Orange slip. Possibly a Los Culeros vessel. ^{no} fig
426B/49	I	Plain Fig Base	Fig
423Y/47-1	B	Fig Flange - Triangular, hollow	Fig
423Y/40-1	G	Curved, slightly flange	Fig
426G/152	F	Rounded Protrusion	Fig
101J/11-1	G	Fig	Solid Face Frag, Raised band, Flat Fretted Solid
423AO/27-7	G	Fig	Triangular Flange Headless w/ punctated sphere surface
335B/29	G	Fig	Plain body frag
262Y/19-1	G	Fig	" " "
423D/59-1	F	Fig	Mouth w/ raised lips.
386M/37-1	F	Fig	Headless flange
101L/57-4	G	Fig	1/2 figure (left side) of a F-F, F-B, Solid fig by + plain an
423Y/172	G	Fig	Minced Protrusion - head?
4236/52-1	G	-OC	part of side-by-side double channel - probably a fig
423H/33-1	G	Fig	Long band we've seen so far - leg looks right
386N/36	G	Fig	Rounded protrusion, possible face
423M/64-9	H	Fig	Rectangle foot protrudes from flat base.
426E/16-1	G	Fig	Incised rectangle flange hollow
426K/64-1	G	Fig	defined 6 ear w/ ear fluke.
423Y/102-1	F	OC	Mold-made medallion (an headless?)
426H/33-3	F	Fig	Neck frag from ? - joins head + torso
423X/3-1	G	Fig	1 sm round protrusion
423K/105-1	G	OC	punctated sphere ^{under crude} Tri. Flange headless
101J/353	G	OC	Raised rounded area
101L/24-7	F	Fig	Plain head chub, 1 stop
426E/16-1	G	OC	Raised, rectangular head
423Y/102-1	G	OC	OC limb canal
426M/172	G	Fig	Curved fig joint w/ minced head (figure defined)
423D/103	F	OC	broken OC limb, curved head - no flange
426C/172	G	OC	OC

Figure 1 Ocean Drift (Cont) PIN 1992

Lat/Lat	Depth	Depth	Description
4238/20-1	F	OC	1 mm SSC directly into a modeled cluster
4264/44	B	OC	2 mm SSC w/ a channel connecting the
2625/10-1	F	OC	2 m-m SSC w/ a channel connecting the
3866/13	G	OC	2 cluster; 1 m-m SSC the other verbal lip into four
4236/84-1	G	OC	2 m-m SSC w/ a connecting channel
4234/19-2	F	OC	2 cluster; 1 m-m SSC the other verbal - flattened may no indicator of other cluster
4238/27-4	G	OC	2 m-m SSC; channel connects the
4238/48	F	OC	2 m-m SSC w/ channel; 1 vestigial lip from 3rd cluster seen opposite surface w/ limb
4251/36-2	F	OC	2 m-m SSC, connected by a channel
3866/69-2	G	OC	" " " " " "
4266/75	G	OC	8 pair, some instrument; Zig-Zag Sagittal crest 13 Sand not for real category
2624A/03-1	B	OC	Crusty OC w/ 1 stop, no mold, mod cluster
2621/16-7A	F	OC	mm SSC w/ an sub & petal sector to not an jet into cluster
426K/101-1	G	OC	2 mm SSC - 1 m-m the other not chond pulled m-m into
4251/36-4	F	OC	1 m-m SSC; 1 modeled cluster 1 channel pulled to
4260/14	F	OC	fig w/ canin image profile face + foot not in
2621/16-2	F	OC	1 cluster, 1 stop, mod, mod, mod
4234/30-1	G	OC	Rectangular opening MP below a MP upon Chy sep V-shaped
3866M/31-3	G	OC	Plain Body frag
426 m/2-1	G	OC	m-m SSC 2 stops oriented at 60° w/ 1 end other
423 m/8-2	G	OC	1 stop; no mold made cluster (OK, its modeled)
423 C/08	G	OC	Plain fig frag, could be a FF, FB, Scaled fig - a
423V/13-2	F	OC	m-m SSC: for mounted broken at cut mark
8 C/02	F	OC	m-m SSC & broken current leg
423 K/1	F	OC	2 clusters, at least 1 is m-m, 1 is m-m, 1 is m-m
426E/28-1	G	OC	1 g, m-m SSC 1 stop opposite it
426E/28-1	F	OC	15 modeled cluster 1 stop opposite it

Date	Time	Remarks
1947	10:00	10/1/47
1947	10:00	10/2/47
1947	10:00	10/3/47
1947	10:00	10/4/47
1947	10:00	10/5/47
1947	10:00	10/6/47
1947	10:00	10/7/47
1947	10:00	10/8/47
1947	10:00	10/9/47
1947	10:00	10/10/47
1947	10:00	10/11/47
1947	10:00	10/12/47
1947	10:00	10/13/47
1947	10:00	10/14/47
1947	10:00	10/15/47
1947	10:00	10/16/47
1947	10:00	10/17/47
1947	10:00	10/18/47
1947	10:00	10/19/47
1947	10:00	10/20/47
1947	10:00	10/21/47
1947	10:00	10/22/47
1947	10:00	10/23/47
1947	10:00	10/24/47
1947	10:00	10/25/47
1947	10:00	10/26/47
1947	10:00	10/27/47
1947	10:00	10/28/47
1947	10:00	10/29/47
1947	10:00	10/30/47
1947	10:00	10/31/47

Figure + Object List (cont) A/N 1992

Figure + Object	Figure	Object	Description
3664/352	F	OC	2 mm SSC 1 channel NO decoration
3374/35-1	F	OC	1 mm SSC
423AN/351	F	Fig	Plain based frag
4164/30-2	F	OC	1 m-m SSC w/ a protected sphere on ext ^{True on cut line} _{Back on cut line}
3664/69	F	OC	1 m-m SSC w/ channel
366m/84-3	F	OC	head modeled chamber, channel to other, 1 rectangular dip
4260/35-1	F	OC	1 m-m SSC, 1 step 1 solid rubber support
423T/35-1	G	OC	1 SSC (m-m) w/ lots of space between it + next chamber 1 step
3664/14-1	F	OC	1 cut mark
3664/24	G	OC	1 m-m SSC w/ incision (100% radius in pin)
3664/143	F	Fig	1 plain body frag
423B/483	F	OC	1 m-m SSC, 1 cut line (at break)
3913/01-1	F	?	1 tiny ended piece
423L/24-1	F	Fig	Possibly a fin pectus, tiny moldy piece pulled to cut
3668/3A	G	Fig	Plain body frag
4230/46-2	F	Fig	" "
423m/03-2	F	Fig	Body frag w/ 1 groove + orange slip
3664/142	F	Fig	Plain body frag w/ leg sea
423Y/32-2	G	OC	1 mm SSC w/ cut line
423m/163	F	OC	1 mm SSC + cut mark
423/103	B	Fig	Possible ladder frag mixed tough potash w/ a dig line
423A/83-3	B	ind	Brick
1060/03-1	G	Fig	Plain body frag
262E/412	G	OC	OC frag, 2nd elongated area / chamber (MP?) ^{ext}
426J/13	G	Fig	Protected sphere callus
1060/2-1	G	Fig	Plain body frag
423AS/104	F	OC	Red. opig MP
426m/114	G	OC	" " "
423V/21	G	OC	Red opig MP, cut M.P. opig chy gocher ^{present}
4239/642	G	OC	Red opig MP
4239/642	G	OC	" "

1944

1944

1944

1944

1944

1944

1944

1944

1944

1944

1944

1944

1944

1944

1944

1944

1944

1944

1944

1944

1944

1944

1944

1944

1944

1944

1944

1944

1944

1944

1944

1944

1944

1944

1944

1944

1944

1944

1944

1944

1944

1944

1944

1944

1944

1944

1944

1944

1944

1944

1944

1944

1944

1944

1944

1944

1944

1944

1944

1944

1944

1944

1944

Figure + Ocean List (cont) QVN PPA

Label	Am	chert	Description
423N/1163	G	α	Rect. opaj m.p.
262D/116	C	α	" " "
426E/143	G	Fig	Plain body frag
386C/14-9	G	Fig	" " "
423N/33-1	F	Fig	" " "
386J/36-1	●	Fig	" " " w/ attached sea
426G/101-	F	Fig	Plain body frag
262J/21-1	G	Fig	" " "
386N/43-1	G	Fig	Fig body support/basal fragment; rounded foot
423E/85-1	G	Fig	1 fig hole
423E/16-1	A	Fig	Crudy plain body frag
386K/33-1	G	Fig	" " "
423L/155	F	OC	M-m SSC w/ cut marks / orange slip
423L/05-2	F	OC	lg, chunky frag w/ one smoothed chunk
386M/32-2	D	Fig	Very crudy plain body frag
423M/05-1	F	Fig	Plain body frag
418E/06-1	F	Fig	" " " curved
426H/13-2	F	Fig	Body frag; Narrows then opens into a large chamber
423N/116-1	F	Fig	Basal frag, (broken protrusion)
101 L/5-1	-	-	Bejaque Decomposition (only 10/100)
101 I/31-2	F	Fig	Plain body frag
386M/52-1	F	Fig	Am, but no leadless decarbs present
386N/21-1	F	Fig	Plain body frag
101 J/15-1	F	Fig	" " "
386E/15-1	F	α	Take body into a m-m SSC
423O/25-1	G	α	SSC crudy
423J/α-6	F	α	m-m SSC broken at cut marks
386N/35-2	F	Fig	Plain body frag
386H/01-2	G	Fig	Possible basal frag.

Figure + Occurrence List (Cont)

PVN 1990

Lat/Lon	Sex	Object	Description
2624/60-1	G	OC	1 mm SSC in a pouch
230/36-1	F	Fig	Other small things Los Cuchas Jan body <u>Recoms</u>
386E/64	G	OC	2 hand modeled clunks / clunked 1g clunks on. clunked
386E/344	B	fig	Plain Body fig
426E/162	G	fig	"
386N/061	F	fig	1 protrusion on an otherwise plain body fig
386B/45	F	fig	rounded fig foot. flattened on bottom
1016/62	F	OC	1 hand modeled clunk
426H/153	F	fig	Plain body fig
4234/60-1	G	fig	Body fig. fb
423W/26	F	fig OC	1/2 of punched MP fig into a state period tube
4230E/45	B	Adms	Adms Sued *
262I/1875	G	ind	face w/ protruded spine cables, T-Tooth (No min) Tri-protruded
386P/04-1	F	fig	fig. Noa gun, face captured
386B/302	F	fig	Body fig, 1 protrusion
31N/24-1	F	fig	flange
423W/463	F	fig	Old god face - Sued out
426H/012	F	fig	1/2 fig w/ 1g fig, Am & 1g fig. pictorial on peculiar
262J/143	G	OC	rounded foot.
416L/08-1	G	fig	M-m SSC + another ind clunk / pin into mm SSC
386M/061	G	fig	Rounded emmerance w/ grease
4230/132	G	fig	Poss foot (red) or headless flange
423H/21	C	fig	Redd field w/ protrusion possibly part of a recty figt handle
101I/134	F	fig	Ching fig but, muffed have a diagonally inward belt.
862E/422	G	fig	Plain body fig
101D/051	G	OC	"
4230/2-1	F	OC	clunk 5-F, 5B Sued fig 2a & 1g clunk
337L/31	F	OC	am 8th, lib (bush) 1 hand modeled clunk
318/264	G	fig	Redd gray mp
			headless fig with redness & added Redd Body / Redd head

1969 10 1 - 2000

Date	Time	Location
10/1/69	0800	1000 ft
10/1/69	0830	1000 ft
10/1/69	0900	1000 ft
10/1/69	0930	1000 ft
10/1/69	1000	1000 ft
10/1/69	1030	1000 ft
10/1/69	1100	1000 ft
10/1/69	1130	1000 ft
10/1/69	1200	1000 ft
10/1/69	1230	1000 ft
10/1/69	1300	1000 ft
10/1/69	1330	1000 ft
10/1/69	1400	1000 ft
10/1/69	1430	1000 ft
10/1/69	1500	1000 ft
10/1/69	1530	1000 ft
10/1/69	1600	1000 ft
10/1/69	1630	1000 ft
10/1/69	1700	1000 ft
10/1/69	1730	1000 ft
10/1/69	1800	1000 ft
10/1/69	1830	1000 ft
10/1/69	1900	1000 ft
10/1/69	1930	1000 ft
10/1/69	2000	1000 ft
10/1/69	2030	1000 ft
10/1/69	2100	1000 ft
10/1/69	2130	1000 ft

Elgine + Ocarin lists Apr 1992

Lat/Lon	Date	Object	Description
386 E/07-1	E	OC	Conical support w/ raised but inwardly it
423 E/95-2	F	OC	Plan by fig
4230/34-1	G	fig	fig by w/ picture & inwardly groove
4234/27-1	F	OC	m-m SSC w/ ext but leg end but density for it broad nose - cat on back
3520/04-1	F	OC?	pro part of a puffy ladden on a FF, FB SF
4234/4-1	G	OC	w/ strong force and
4260/27-1	G	OC	FF, FB, SF leg rect.
4232/33-2	G	OC	m-m SSC Face?
4234/34-1	G	OC	1 m-m SSC, lateral leg on, Crat - Lin type? and
386 G/01-6	F	fig	Rapid but
4264/25-1	G	fig	2 body arm + leg (w/ belt)
337 E/06-1	G	OC	m-m SSC bump on ext
423 m/05-2	F	OC	Pinched M.P.; 2 pines open into wide tube
423 T/11-1	G	fig	Conical ladders, 1 fig hole
386 H/35-1	F	fig	defined on w/ protected sphere surface
4232/20-4	F	fig	amorphous, bump fig
423 m/2-2	F	fig	ladder ladders w/ groove (humped at base of ladders)
426 E/51-1	F	OC	ladders w/ 11 but (2 of them) + a TP chert done
4236/27-1	F	fig	indented (small)
4236/25-1	G	OC	Verticalized OC arm
426 d/02-1	F	OC	stupid indented (hump) but still no color what it is
4230/34-1	F	OC	FF, FB SF w/ good sign club, 1 rectangle leg
4235/36-1	F	fig	flame design surface ☹️
423 V/15-4	G	fig	protected sphere w/ no protrusions
423 E/35-1	G	fig	2 protos on top of what could be a rounded face
426 K/07-1	G	OC	1 m-m SSC which <u>doesn't</u> open into the club
4264/33-2	F	fig	inward but.
3860/05-4	F	fig	body body fig, over but parts still ext w/ protected part, the end of raised but flat gold

Figure 1 & Ocarina Lists (cont)

Fig #	Fig	Fig	Description
425E/41	B	Fig	Partial fig w/ an indentation
386K/36-1	G	OC	m.m. SSC w/ a <u>putting</u> , flattened foot.
386N/42-2	G	Fig	eroded body fig
423T/45-2	F	Fig	body fig
426.4/39-1	G	Fig	body fig
1010/09-2	G	Fig	Body fig w/ clay scrap on interior
425D/14-1	I	Fig	Oblique foot w/ incision on bottom
1010/15-1	E	Ocarina	1/2 of s-f-f, f-b, seated fig. Pointed for Phil. ppl. <u>partial</u> Carina
1010/15-2	B	Fig	Seated, foot fig w/ inc
425E/41	G	OC	OC w/ rectangular foot. Seated fig. Cat marks on back 1 Carinal <u>steps</u> , multi modals
4230/12-1	F	OC	m.m. SSC Broken on exterior
4235/16-1	G	OC	Channel between 2 mm SSC. 1 stop
4260/17-1	G	OC	1 stop hind = modeled chub.
4236/18-2	G	OC	by channel between chubers
4251/15-1	G	OC	Channel between 2 m.m. SSC
4230/12-2	G	OC	m.m. SSC + <u>scrap</u> on <u>ext</u> , <u>irregular</u> oval <u>partial</u>
4238/16-1	F	OC	2 mm SSC <u>w/o</u> ^{u/s} <u>curvature</u> channel 1 chub hole & cut line
386C/34-1	G	OC	2 <u>chubers</u> at least 1 mm channel
4231/10-1	G	Fig	incised: hind or foot, <u>spiky</u> curved oval, <u>inc</u> fig on
3320/31-1	F	OC	m.m. SSC eroded, <u>curved</u> ext.
4235/15-1	G	OC	* m.m. SSC w/ stop <u>scrap</u> on int. - when they picked the stop or channel for other chubers the <u>stop</u> bit the for wall <u>helps</u> completely <u>grown</u> - as as the curbs are on the main <u>surface</u> they <u>plugged</u> it up later - <u>not</u> stop <u>int</u> <u>steps</u> . <u>Seated</u> <u>not</u> the stop or channel for other chubers the <u>stop</u> bit the for wall <u>helps</u> completely <u>grown</u> - as as the curbs are on the main <u>surface</u> they <u>plugged</u> it up later - <u>not</u> stop <u>int</u> <u>steps</u> . <u>Seated</u> <u>not</u>
4230/12-1	G	OC	m.m. SSC <u>w/</u> <u>cut</u> <u>and</u> <u>incised</u> <u>stop</u> (stop due <u>apex</u> at <u>ext</u>)
4260/17-1	G	OC	1g oc w/ 1 mm SSC 1 modeled <u>round</u> <u>area</u> on <u>ext</u> <u>at</u> <u>ext</u>
386N/42-2	F	Fig	Fig fig w/ <u>fin</u> <u>hole</u> - <u>fig</u> <u>help</u> <u>pl</u> <u>ext</u>
386C/34-1	F	OC	m.m. SSC w/ attached <u>scrap</u> to <u>int</u> and <u>chubers</u>

Figure & Ocarina list (cont) PVA 1992

TA #	date	sex	descr
356W/212	G	fig	chubby body fig
391Q/22	G	fig	ly rect fig foot fig
356I/73	G	fig	headless fig w/rectangular flange & a groove on building
423R/06	G	fig	fig w/ w/ curved rect support or a less Cubes 4 x 6
386J/73	G	fig	fluffy headless w/ a raised head & groove along base
108E/25	G	OC	2 msh SSC w/ cut mark, throat divides
4288/09	G	fig	T-shaped tooth w/ central groove, almost 8-sided eye. Chi + disk
4280/09	G	fig	Chubby body fig
108F/01	G	fig	Very crinkled solid, slit eye
428D/10	G	fig	3 raised, solid spheres on ext
426L/11	G	fig	head, ly rect. figs fused on a curved surface by grooves
4220/12	F	OC	m-m SSC broken all around w/ Petaloid pupil pulled corner eye margin of eye are grooves only by face plain body fig
262E/94	F	fig	"
356N/95	F	fig	thru, happy concid. flange, flange
426H/84	F	fig	Red open MP
423L/11	F	OC	

DATE: 10/1/2017

Year	Month	Day	Time	Location	Remarks
1964	1	1	10:00	10000'	10000'
1964	1	2	10:00	10000'	10000'
1964	1	3	10:00	10000'	10000'
1964	1	4	10:00	10000'	10000'
1964	1	5	10:00	10000'	10000'
1964	1	6	10:00	10000'	10000'
1964	1	7	10:00	10000'	10000'
1964	1	8	10:00	10000'	10000'
1964	1	9	10:00	10000'	10000'
1964	1	10	10:00	10000'	10000'
1964	1	11	10:00	10000'	10000'
1964	1	12	10:00	10000'	10000'
1964	1	13	10:00	10000'	10000'
1964	1	14	10:00	10000'	10000'
1964	1	15	10:00	10000'	10000'
1964	1	16	10:00	10000'	10000'
1964	1	17	10:00	10000'	10000'
1964	1	18	10:00	10000'	10000'
1964	1	19	10:00	10000'	10000'
1964	1	20	10:00	10000'	10000'
1964	1	21	10:00	10000'	10000'
1964	1	22	10:00	10000'	10000'
1964	1	23	10:00	10000'	10000'
1964	1	24	10:00	10000'	10000'
1964	1	25	10:00	10000'	10000'
1964	1	26	10:00	10000'	10000'
1964	1	27	10:00	10000'	10000'
1964	1	28	10:00	10000'	10000'
1964	1	29	10:00	10000'	10000'
1964	1	30	10:00	10000'	10000'
1964	1	31	10:00	10000'	10000'

QVN Figure Lists 1992 : Bits, Bits, + More Bits 20 June, 1992

Lot #/Date	Box	Object	Description + Metrics
306C/05-1	G	Oblong Support	Width: 2.2cm Oblong Figure support which opens into a rounded chamber. Solid Support. No paint, slip or firing damage.
386G/06-2 Ocarina -	G	Solid, conical Support	Width: 2.2cm Solid, broken conical support; opens into a smooth, based chamber. Central firing core in solid section. Interior shifted in hollow area. No paint or slip.
386G/06-1 Ocarina -	G	Solid, conical Support	Width: 2.5cm Solid conical support which opens into a mold-made spherical sounding chamber which broke along the cut mark (flattened surface present) central firing core eroding out of support. Interior shifted firing core in chamber. No paint or slip.
101B/02-1	G	Solid conical Support	Width: 1.5cm Solid conical support which broke cleanly from the surface to which it was attached. No paint slip or firing damage.
262I/33-1 -Ocarina-	F	Solid conical Support	Width: 1.8cm Solid, conical support, wide at top. Length: 1.6cm Tapers to tip. Opens into a spherical sounding chamber - mold made - with a cut mark along top of support. No paint or slip. Exterior is burnt.
106/06-1	G	Solid, nubbin Support	Width: 2.1cm Solid, nubbin-like support with a height: 2.2cm wide rounded tip (tip is same diameter as connecting surface) No paint, slip, or firing damage. Opens into a smooth, hollow chamber.

[illegible]