

1988

PVN-002-Goebbels-Field Notes-1988

Rich Goebbels
Kenyon College

Follow this and additional works at: <https://digital.kenyon.edu/honduras>

 Part of the Archaeological Anthropology Commons

Recommended Citation

Goebbels, Rich, "PVN-002-Goebbels-Field Notes-1988" (1988). *Four Valleys Archive*. Paper 6285.
<https://digital.kenyon.edu/honduras/6285>

This Field Notes is brought to you for free and open access by the Anthropology at Digital Kenyon: Research, Scholarship, and Creative Exchange. It has been accepted for inclusion in Four Valleys Archive by an authorized administrator of Digital Kenyon: Research, Scholarship, and Creative Exchange. For more information, please contact noltj@kenyon.edu.

P88

#2 / pg. #1

2/02/88

NS EW

Very hot day / Sunny = 50x100m Slashed field #232 A1
Surface Foot survey, found cobble clusters = 13 possible
distinct structures / pottery sherds few.
definite structure perimeters unknown = field destruction
all at ground level / no elevation (via plowing)
located just above flood plain of Chamelacon Rio

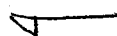
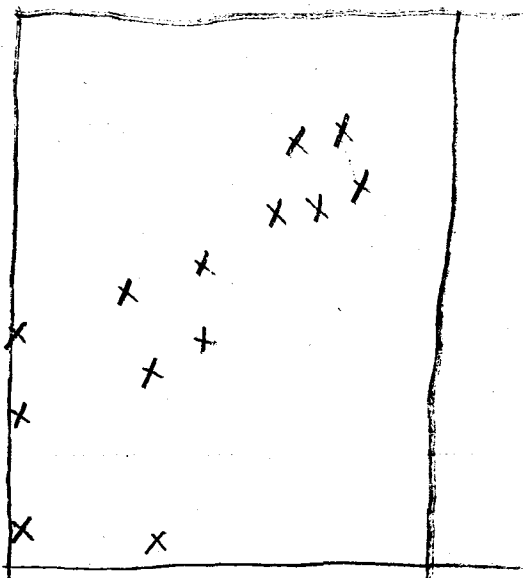

Points marked in field with
flagging tape

#232 A2 Surface survey / 10 possible structures
scattered cobbles do not indicate definite structure
perimeters, few pottery sherds.

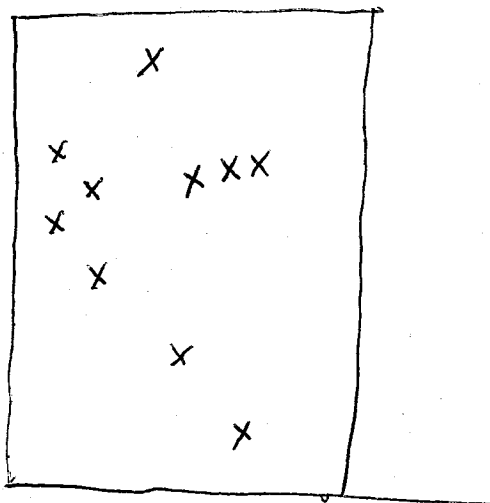

Julie Rich
David
Pat R.
Myrna

P88
Pg. #2/#2

03/02/88

Slightly overcast field with NW rise to be covered.

low growth of sugar cane / in danger of irrigation

weather to sun hot

surface survey of field app. ^{NWSE} 200 x 150 m

possible 5 lead structures found

4 other lots of sherd located

1 mano 1 possible leg of metate found on main ditch wall

transit readings done of all concentrations

So disturbed that we were unable to make accurate assumptions

Members David & Julie have sketch maps and readings

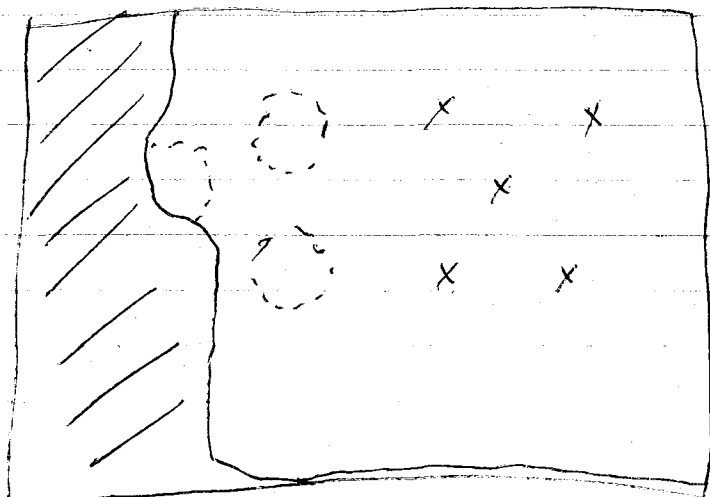

⌘
Rough disc plowed

P88/2/P9-3

04/02/88

Site B

Sunny/hot cow pasture 1/2m tall grass dense

App. 350m from la Sierra to ~~E~~ West

~~175m from site B to west~~

SW of A 75m S of Site C 175m

80m S of access road

60m N of ~~the~~ Quebrada / the sits on natural rise
about 50cm / another Quebrada to N 250m

Even if dry good location for agriculture.

difficult to determine features of structures due to overgrowth

Structures made of river cobbles; Rio Chamezon to E 1K.

One mound larger than the others, of 9 structures.

Did take dimensions for rectified map - refer to #9

P-88/#2/pg 4

11/02/88

18 CE | Survey area app. 1K NW of La Sierra. ^{Dry} Quebrada
11 NC | on SE perimeter, Cow pasture with 25cm overgrowth
2 RG | App. 1K from Chamelecon Rio to E. Area covered app
250m E-W * 300m N-S. * One concentration of
structures.

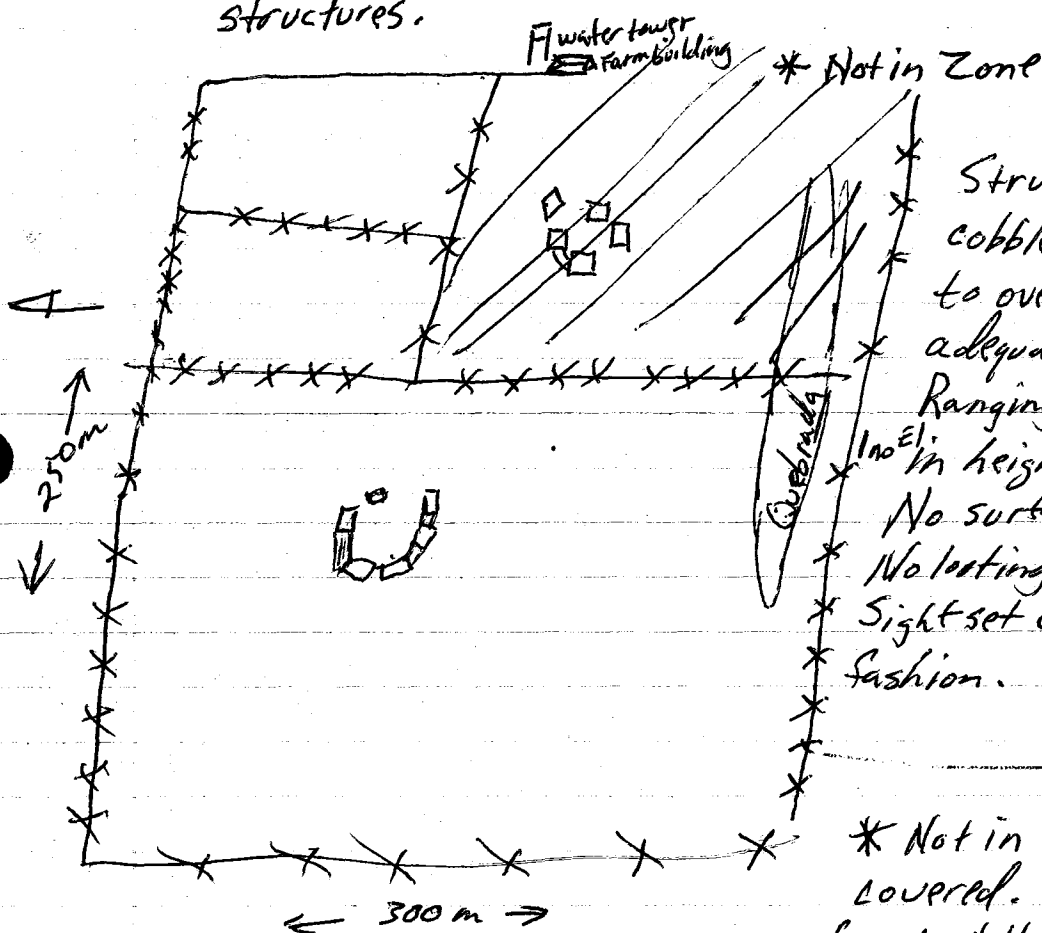

Structures have river
cobble content, vegetation
to overgrown to get
adequate wall lines.
Ranging from 1m - 1.75m
1m^{El} in height, fairly intact.
No surface collection made
No looting pits visible.
Sight set up in semi circular
fashion.

* Not in zone area
covered. 5 structures located
refer to #11 pgs. 16-17 and #18
pgs. 18-19.

P88/#2/

Feb 19/88

Group U (see #9 sketch map for U) was examined for purposes of mapping. We are attempting to define and survey accurately. Many structures have odd terraces as well as well destruction. It is hard for me to see some of the true lines. 34 structures are known here. This site runs from app. 10 m from Chemelicon on the river ~~edge~~. It is 1.2 k from main group of La Sierra. Its boundaries are confined to an app 300 m N-S 200 m E-W. it is about 200 m North of group V. Most structures are fairly large. Some measuring 3 m in verticality. Several longer than 10 m in length. A number of dead structures.

P88 2/4pg.

8/3/88

Overcast warm.

E Field covered surface survey 100mX125m app.
grass cover 1-1.5 m.

initial walk produced 5 concentrations of structures
2-3 isolated ones. ~~the~~ corner adjoins Quabrada.

More prominent structure about 1-2 m in height

Access road ~~the~~ south of field

NW of Main group La Sierra app 100 m

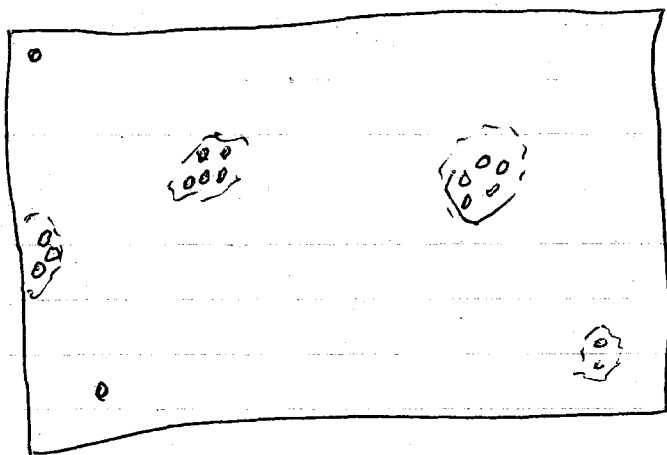

App 1 km from Rio

No structures show significant status

Some wall line visible, but grass has impaired most
of the visual of structures.

Largest structure group cleared of vegetation largest of these
is 1.5 m in height with terrace extending north and west
side .25 m from ground level.



P88/#2 /

18/03/88

Examining river bank washouts. Collecting sherds app 1.2 Km N of La Sierra. Decided to follow the Chamelicon a bit further down stream and discover a chain of midden washouts previously unknown, above on the field no indications of these. They lie app. 50 m due N of La Sierra Group U. Stratigraphy very visible millions of sherds literally. Well defined floors of pot sherds and river cobbles. What appears to be some intact vessels, handle & claw pieces in large numbers. Accurate measurements and sketches are forth coming. Slopes of Palisades measure app. 3.5 m with occupation levels accounting for 3 m. At one point 8 levels are definable. This site has no designation at this time. It runs for about 50 M, then fades to several interval single structures. The distance from present Chamelicon R. is app. 12-15 M.

P88/#2/pg.
1/03/88

Excavation / 12c progress checked. 12a", 12d"

Under supervision of #17

12d being excavated to ~~20~~³⁰ cm for purpose of identifying wall lines if any in sq. meter to East

12c/18 down to 60 cm / 2 laja removed

Bag lot 12c/18 - 12d/4

18A go down 20 cm more then work inward to structure. measures to 30-32 cm presently for 1x1 m sq.

15/A define summit wall follow platform - lot 32

17/A Broad wall - two lesser defined walls + 2 more several cut blocks on Broad wall, not necessarily associated to structure pertaining to other walls.

17/A/12 to go down for the sq. meter / 70 cm depth at this point to find base of Broad wall "Chevy" 20 cm more.

12d/4 unusual stone with groove running across surface of it. ~~Possible part of canal found 9 cm to S. of ground~~

~~stone~~. To SW high concentration of rim sherds, continuation of concentration 29/2/88. Grooved stone 39x34 cm.

34 cm from surface / 13 cm from ^{base} str. wall to the E / 16 cm from ^{base} str. wall to the W. Groove on stone 5 cm wide 2 cm deep.

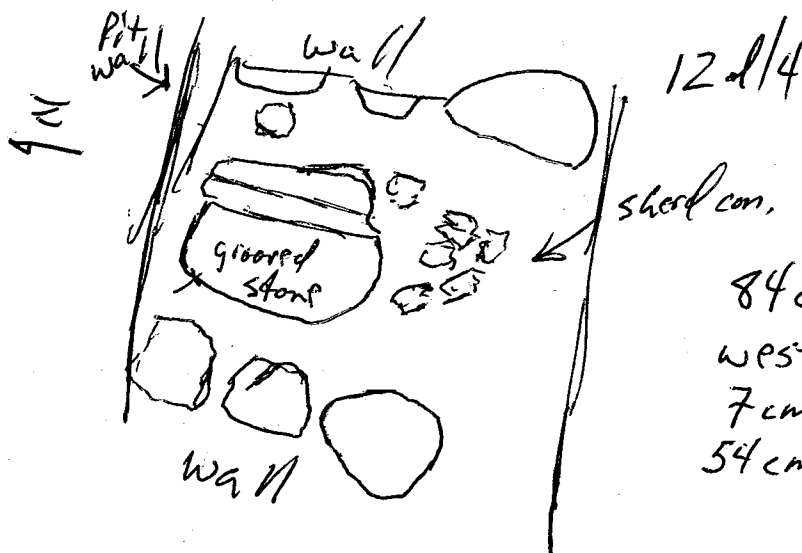

84 cm from north corner of west excavation wall

7 cm from N excavation wall

54 cm from S. excavation wall

P88/2/19.

01/03/88

12d-4 piece of landkarru found in lot as well as
baharece. Several obsidian blades (broken) found, possible
bone fragment. One piece of laja.

Lot 4 defined at 70 to 140cm N. of W wall to E ^{corner}
22 to 110 cm S. of W. wall to E
depth 32-43cm

Lot 5 defined at 70 to 140cm N. corner of W wall to E
22 to 110cm S corner of W wall to E
43cm-50cm

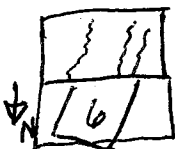

12d/5 40cm E of the NW corner of excavation wall
measured 1m at 68° angle to follow both wall lines
in pit 12d proper. 20cm depth from surface level.

A number of sherds extracted, one piece of obsidian
and figurine fragments bone fragments & stamp.

12d Feature wall to the west named Pathi Smyth
Feature wall to the east named Sid ~~Provision~~

Extended pit 6 to 1x2m adjoining original
pit.

Stamp

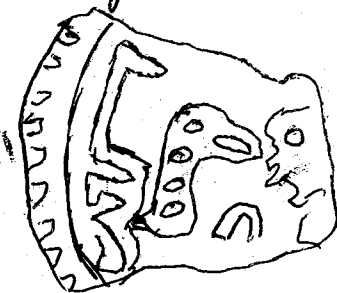

1988 #2/pg 3

07/03/88

12d/11 - 37cm to 47cm app

17A/17 - cleaning for stones/extract cut block 2 piece of Laja (50cm)

18A/10 40cm-60cm same horizontal area

15A/38 Moving to East to define line 130cm N-S 46cm E-W

12e/29 150-170cm

15A/39 50-70cm 0-120cm E to W wall 130cm S to N wall
Candaleto found

17A/17 cut block 50cm length broken width 12cm thickness

12d/4 Human finger bone extracted - found due E of Patti Smyth
found Thursday?

18A/11 68cm-80cm same horizontal area Sub-Wrestler
First moving toward S Valiant

17A/18 16cm NW corner

12d extension projection in
hopes of finding corner

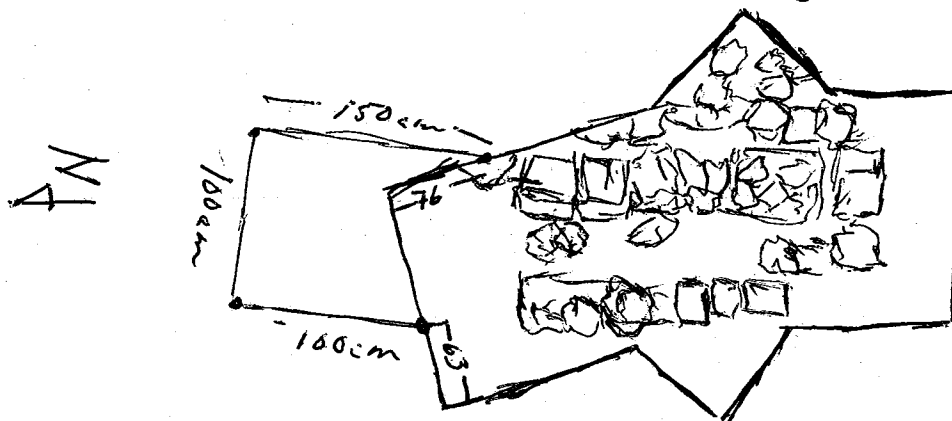

P88/#2/pg. E4

07/03/88

15A/40 - 140cm from NW corner → 114 to South
176cm from W wall at 140cm / 146cm from SW corner
stake — 39cm at West side depth 20cm depth
0-10cm depth

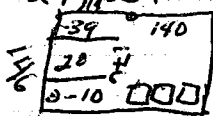

18A/12/1 m. extension to the South 0 - 18/A71 ended at 90cm

17A/18 to 20cm 0-30cm wall on N edge

17A/19 same horizontal 30-50cm

12d/ Extension brought down to app. 30cm,
indication of corner, certainty after 20cm more
depth

15A/40 shows wall extending, brought to depth of 50cm
at about 20-30cm large concentration of sherds found
which was the trend in adjoining pit

17A/19 shows edge of wall, brought down to 59cm
carbonized flora remains



17

P88/#2/pg#E5

08/03/88

12d/13 extend to 50 cm to find corner for Syd Viscious.

18A/12 continued bag 2

18A/13 1x1m to North continue to define architecture

15A/37 continue bag 7 503

15A/40 35-50cm down halt

15A/41 in front of Mutton 110 from W face of mutton 140-254cm
from NW corner

17A/20 60cm-80cm

17A/21 to South 1x1m. at 20cm/40cm

~~17A/21~~ 1x1m ext. to S down 0-20cm to define arch.12d/32 down 20cm 5 of Zucchini 98-140cm
5 of Carrot N of Green beans

15A/41 Rim sherd with handle

12d/14 Extension to N of 13 to 1x1m ~~20cm~~ 20cm depth
following Syd - 50cm70cm
17A/21 to 60cm - 80cm15A/42 to follow mutton N 1x1.46m E-W 40
20cm

18A/19 Extension to 1x1m SQUARE 6

82
18A/15 480-550 N of south out 20cm from W wall12B/25 New Lot over in 12B going between Zuke
and Cauliflower to find base of G. Bean

17A/22 Extend S 1x1m

P88/#2/Ag.E6

08/03/88

12B/25 whistle fragment found

12d/14

18A/16 Bones found 20cm S of the King
30cm N of the Bruiser
depth of 60-64"
69cm N of SW corner of 18A
30cm W of 70cm mark

188/2/E7

617

12B/15 1x1m extension to E of Syd
1m S of NE corner

18A/16 Extending deeper at 80cm

15A/42 to 53cm in SW corner E-W

15A/43 Extended to S 1.1m x 1.4m

17A/22 still clearing at 62cm

18A/16 wood fragments found at depth of 88cm
15cm from point 1.15m N of SW corner to E
15-19cm S of corner of King & Exc. wall
More bone & human tooth from sitting, hate

18A/17 100cm downward ^{110cm} / 30cm N of Bruiser
Baharec & few sherds

18A/18 3.5-4.5m S of SW wall of Exc pit 16
1x1m sq 0-30cm

~~18A/19 30- Same extension as 18~~

18A/19 2.5-3.5m S of SW wall of Exc
pit 16 1x1m sq 0- cm
2 bones children frag

P88/2/E8

14/03/88

17A/31 112 cm triangular unit 80 cm - 57 cm - 1 m x 50 cm^{SE}
Feature wall there Cars NGB to south of trench

15A/48 1 m N of 15A/47 1 x 2.3 m depth 0 -
chasing Mutton per corner

Barf Bator found

17A/32 137 cm¹⁴⁹ continue square 1 m x 50 cm
Carbon found

12B/34 ^{EW NS} 1 x 3.6 m Ext. to W Mptate log

17A/33 0-87 cm^{N-S} N of MGB 1 m E-W 143-167 cm

12A/34 41-64 cm

12A/35 64 cm depth NE corner (70 cm N to south 1 m E-W)
to gray ash lense

12B/34 Extended 1 x 1 m to N of NW end of trench

18A/27 Area below Babo and Hulk w wall N-S 88 cm
E 90-94 cm depth 40 cm -

P88/#2/E9
15/03/88

12A/34 continued 50cm to south por corner

18A/29 Backdirt lot candlepro & shaped pumous
1/2 trench Bobo 70cm so. metatp fragment
starting 22-70cm in Sw corner fragment of whistle? Baharecā

15A/49 1m extension to the N for to define ~~the~~ ^{Mutton}
2m wide 0-65cm depth Sensor fragment

17A/ Screening

15A/Arca Cut stone measurements

40 x 20 x 10 thick

38 x 44 x 10 thick

24 x 34 x 8 1/2 thick

36 x 19 x 11 thick

36 18 11

18A/30 1 x 1m unit S of J. Valient 24-50cm ⁻⁶⁰ depth
removing tumble

C 5 33 1/2 x 34 1/2 x 10

At 36cm see soil color change to reddish as if once
baharecā.

18A/31 83cm S of 30 x 1m

30cm depth

1/2 MANO

15A/50 1m extension to N same 2.1m width E-W
depth 0- cm Bone found
C 5 39 x 33 x 10

P88/#2/E10

15/03/88

18A/31 END AT 55 cm

V U

15A/50 END AT ~~44~~ cm continue new des. Wellington

17/03/88

→ √ 18A/32 1x1m extension 50cm from South corner
0-20 cm depth i prob lid exotic pottery whittle frag!

√ 17A/35 continued ~~20x1m~~ ~~start at 50~~ end 44 cm

→ √ 12B/40 continued .8x1m start 0-50 cm

→ 12A/38 for doorway clearance complete MANO ^{E-W} _{N-S}
extends west 80 cm now 130 x 90 cm

12B/41 50 cm same matrix as 12B/40

15A/50 1x1m ext to E 60-160 S of the NE corner of 15A/50
to follow wall line per Mutton & Wellington

17A/36 1x1m ext S of 35

18A/33-35

110 BBS
cm

P88/17/35

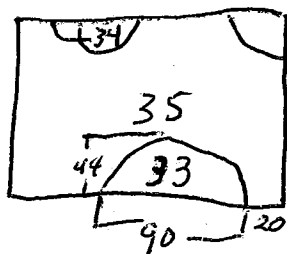

15A/51 same as ext. for 50cm 60-160 at 23 cm depth

12B/42 extension to E of 41 1m x .8m following walls
0-20 cm for now

P88/2/E11
17/03/88

12B/42 ext to E 1m from 41 ^{E-W N-S} 1x.8m 0-47cm depth

17A/36 Ended 40 cm

18A/33 Soft soil much shreds Ended 136

18A/34 sherds, huf, ^{16 cont.} ended at 130

15A/52 1x1m sq. 4-5 m SE corner of trench starting
Notches at 0-

17A/37 157-206 cm triangular to NW of burial 0-71 ~~AKES~~ XKE

12A/38 Expanded for purpose of finding pebbles
floor, burnt clay
Area below 12A/33 included

18A/35 132 End Shards, Candakero frag, figurine frag

18A/36 same as 35 132- om

12A/39 cleaning SW corner of summit room

12B/43 same as 42 47-76

15A/52 1x1.6m ext. to N from ^{orig.} 52 O- cu

17A/38 ¹⁷⁰ 270 S ~~W~~ of N Edge 1x1m 0 - can

P88/#2/E12
21/03/88

12E/3 40-60cm in N 1x1 of original 1x2
Chert found -

44 12B/45 continued extend to 50cm

53 15A/55 ^{E-W} 1x2.7 ext. to E looking for edge of Mutton
39 18A/40 Same as 38 concentration 144-154 Sand appearing
End 163 Lobo ^{N-S} whistle sensor lid

39. 17A/41 1x.75 ^{N-S} Exact prominence in Lot list
Antler base ^{E-W} found. + .75 x 1.6 83-

^E 12B/40 (~~E~~ 1x2) from ³ ~~4~~ 0- cm
1x1 W of N 1x1 of 3

18A/41 163-168cm same matrix as 40

Antonio 12E/5 ^{E-W} 1x.30 20-40cm - 68cm
E 30cm of 4

~~18B/1 2-4m N on E wall from NW corner of 18A/39
out to the E from ^{N-S} 2-4 3-4 m to E 1x2cm pit~~

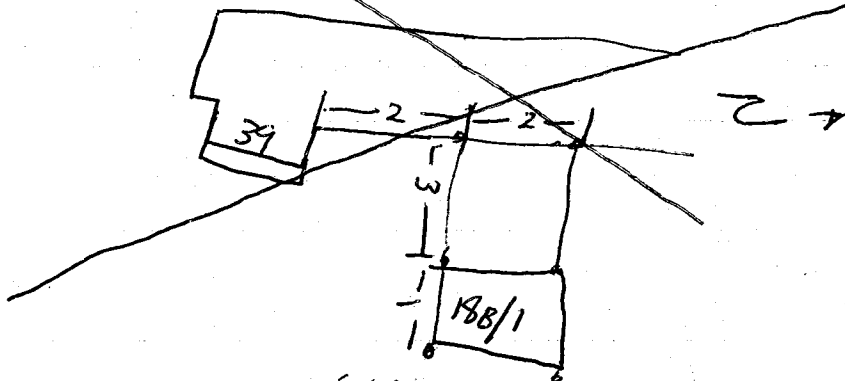

^{N-S} ^{E-W} 12B/46 60-87cm between Caulislower & Zhuchini
W edge 285cm from W limit subplot B refer to P88/17/39
depth 71- cm

P88/Z/E13

17/03/88

18A/38 Big sherd deposit at 138 cm

Z

ANTONIO

P88/2/E13
21/03/88

✓ 188/1 1x1m 195cm from NE corner at 50cm to
E of E excavation wall - 0 - cm depth

12B/46 end at 90cm

12B/47 same matrix as 46 from 90 - cm

12E/5/E12

12E/6 ~~EW~~ 65cm of N-S 1m 22cm - cm

17A/42 60-160 S of the N end of trench 1m to E
0-

^{EW}
✓ 18A/42 1x.62m N of Valient 190cm S of N limit
refer to P88/17/38/113 below ground surface

12B/48

49 - 120 same as 48

12B/50

120cm - same as 49

1/4
1/2

P88/2/E14

22/03/84

✓ 12E/6 14 BGS Censor frag.

✓ 12B/51 1x1m placed to N of Zuchini to find IV face
between 110 and 210 from S face of Zuchini 0-35 BGS

12E/7 ^{N-S} 1m x ^{E-W} 5m 66-88 BGS Subject of 12E, Famous Anth.

E ^{Basil.} ~~summit~~ boundary wall named Dart 1x5 due E of Dart

15A/56 ended at 20 BGS

✓ 15A/57 ^{E-W} ~~2m~~ 80cm N of SE corner along E wall to 180
and 2m extended to E ^{E-W N-S} 2x1 0-18 BGS

17A/42 ended ⁶⁶⁻ 94 BGS

17A/43 ^{E-W N-S} 1.74 x 1m E area of 17A/1 ^{1.74} E of Ford N of Chap
to better define Chap

18A/43 Ended at 146

✓ 18A/44 No shreds 146-170 BGS

12E/8 ^{E-W N-S} 1.65m x 1m W of Dart wall 18- cm BGS

✓ 15A/58 ^{E-W N-S} .75 x 1m on E most .75 of 15A/57 18-40 BGS

12E/8 26x33 x 14 thick
28x39 x 13
20x25x10

✓ 12B/52 same as 51-10cm from S ^{N-S} .9x1.0m 35- BGS

12E/9 1x1 due W of 12E/8 0- BGS
searching for summit

18A/43 1x1 on N most end of ex. pit beginning at 146-
Süvelo - Orcaýedo

P88/2/E15

22/03/88

V15A/⁵⁹~~58~~ extended 1m x 1m to E of 15A/57 O- BGS
bone, fis. frag.

✓ 17A/43 ended 115 BGS

✓ 17A/44 cleaning N side of Chevy & E side of Ford

✓ 12B/53 western 70 cm of area below 12 B/52
20-65 cm S of N wall on west 15-80 cm
south of N wall on E 55-72 BGS (SW corner)

✓ 12C/33 1x1m N of Zucchini O- BGS
sea shell

✓ 17A/45 1x1m S of original trench O-

P88/2/E16

23/03/88
✓ 17A/45 1x1m South of orig. exc. pit to 0-47 cm BGS

✓ 12C/33

~~12B/54~~ ended 28 cm BGS

15A/59

✓ 12D/34 1x.5m ^{N-S} adjoining N end of 33 0-43 cm

✓ 12B/54 1x1m From NE corner of exc. pit E following Zulu

NS ~~12B~~ 0-25 cm BGS

12E/10 1x.7m E of Howell 40- (NW corner)

Summit wall Howell clean up

✓ 15A/60 40-60 cm BGS same as 59 matrix

✓ 17A/46 1x1 to E of (320-420 from ^{W trench} wall) 0-48 cm BGS
(previous unit)

12E/11 W of 12E pits 1x1m 0- cm Step named Johansen

✓ 12C/35 same matrix as 34 43- cm BGS

✓ 15A/61 1x1m to E of previous exc. (15A/59) 0-46 cm BGS
Soil chg. to gradient dark with pebbles much like that of 17 N end at 40 cm, some bone

✓ 15A/62 same 1x1m as 61 40- cm BGS

✓ 17A/47 same as Matrix as 45 47 cm - cm BGS

✓ 12B/55 25 cm BGS same as 54

P88/2/E17

22/03/88

12B/55 25- cm BGS same area as 54
Big rim wedge 65 x 89 50 x 33 BGS 44

~~12E/11~~

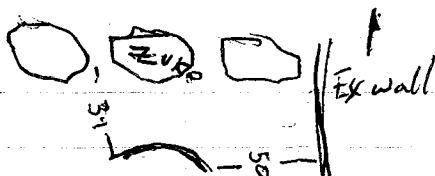

✓ 12E/12 ^{N-S E-W} 60 x 100 Nedge of Schick, N. 6m of 12E/11 wedge

✓ 17A/48 same area as 47 90- cm BGS

✓ 15A/62 same matrix as 61 40 cm - 60 cm BGS (SE corner)

✓ 15A/63 60-160 W of SE wall of 61 55-60 cm BGS

✓ 12A 42 ^{N E-W} 130 x 100 70 cm extension

✓ 15A/64 same area as 63 60- cm BGS

P88/2/E18
6/09/88

14E/7 1x2m 36-60cm BGS
(N-S)

19D/9 1.2x1m 20-37cm BGS 0-120cm along the E wall
of original pit from NE corner - E of pit 19D or pit

19E/6 1x1m due north of 19E/5

13A/97 1x1m from NE corner of towards
N 0-7cm BGS

19E/7 1x1m 1-2 E of the W wall of orig.
19E exc. pit 4.8-5.7m from SE corner extending
E following VALAS & BURRO

14E/8 0-1.75m E along from ^{west wall} ~~SE corner~~
(N-S) (E-W)
1x1.75m pit extending to south 0-90cm BGS

14E/9 same area as 14E/7 60-90cm BGS

19A/16 same area as 19D/9 37- cm BGS

~~14E/10 same area as 14E/9 110-~~

14E/1 same area 14E/8 follow clove & EVA 20-40cm BGS
continued N-S E-W

14E/10 Due N of 9/14E 1x1.9m 0- cm BGS
1m

7/03/88

P88/2/E19

✓ 13A/98 ext. N from 97 ^{N-S} 50cm x ^{E-W} 1m 0-37cm BGS

19E/7 ^{E-W} 1x2m E of W wall of orig. pit
4.8-5.8m from SE corner extending E following
wall/s Vaca & Burro

14E/10 Due N ext. ^{E-W} 1x1.9m ^N of 14E/9 0-50cm BGS

14E/11 same area as 14E/8 40-60cm BGS following
Dove & EV9

19A/10 same area as 19D/9 37-56cm BGS

14E/12 same area as 14E/11 60-80cm BGS

13A/99 same area as 13A/98 37-⁵⁵~~50~~cm BGS

19D/11 ^{E-W} area .8 x .5 ^{N-S} due South of ^{19D/10} ~~19A/99~~ 0-26cm BGS
^{shell and/or}

19E/8 ^{N-S} ^{E-W} 1x2m due N of 19E/7 0-cm BGS

13A/100 Extension to the E ^{Due} ^{N-S} ^{E-W} 1x1.1 0-cm BGS

14E/13 same as 14E/10 50-cm BGS

14E/14 extension 1x1m to the E of 14E/12
0-cm BGS

19D/12 same area as 19D/11 26-cm BGS

198/2/E 20

7/03/86

19E/9 1.1 N-SX 1^{EW} m 0- cm BGS adjoining
19E/8 on W 1m.

14c/44 1x1m starting forward summit
220cm - 320cm on interior E wall
from interior NE corner 0-40cm BGS

19E/8 extended 50cm to S

13A/101 same as 13A/100 20-65 BGS

13A/102 50cm from NE corner of 13A/100
running S 1x1m following blank wall
0-

14c/45 extension due W of 14c/44 1x1m
0- cm BGS

18/04/88

P44/2/E21

Setting transect from large structure at L.S. 1.

Direction ~~48~~° 10 at 100m, 90m, 80m, 70m

22A 100m pit taken to 120cm BGS
no sherds Strata

22B 90m taken to 100cm BGS
no sherds Strata samples taken

22C 80m pit to 135cm No sherds

Height
119

Bottom 2.68 middle 3.10 T. 3.51
300° 40 - 1½°

all
1x1m
from
ground
level

22D 70m structure found sherds at 40 BGS structural
info unavailable, tumble no definition of stones

22E 50m out 80cm BGS solo soil

22F 30m Nada soil & few sherds to 75cm BGS
at 40cm

22G 0m Str found no floor few sherds 50 BGS

1 22H 20m Soft transit solo soil stopped at 65cm BGS

W 22I 40m Soft str. found at 30cm BGS - 45 BGS stop

1 many Broken no def. to str. some sherds

✓ 22J 60m Soft solo soil 60cm BGS

✓ 22K 80m Soft solo soil stopped at 55 BGS

22L 100m Soft solo soil 40cm BGS

21/04/88

P88/2/E22

22m at 120m soft 55cm BGS solo soil

22n at 140m " to 60cm BGS solo soil

22o at 160m " to 40cm BGS odd soil coloration
sample taken

22p at 180m " to 60cm BGS a few contemporary
pieces of roof tile a 20cm discarded

22q 200m " taken to 60cm BGS solo soil

28/04/88

P88/2/E23

L.S. 2 set compass for 180° transect at 10m intervals

compass set to landmark 340cm at 24°

22R 1x1m pit set 10m from compass 180° 0-40cm BGS

22S 1x1m set 20m/due S. of 22R floor of str.
found a 35cm BGS excavation halted at that
point, one large cut block on the SW corner of pit

22T 1x1m set 40m/due S of 22S 20mas
45 BGS

22U 1x1m set 60m/due S of 22T 20mas
60 BGS

P89/2/E2#
11/05/88

22V 80m S of ~~22V~~ set point 20m S of 22V
1x1m to 0-85 cm BGS sherds in between str. no
walls solo tumble

22W 100m S of set point 20m S of 22V 1x1m
0-85 cm BGS sherds, pit fill between
str. tumble no wall lines.

12/05/88

P88/2/E24

22x	Depth	Soil/chg.	Sherds	Soil sample
10m Pit 1	62 cm BGS	2	6	60-62cm ✓
20m Pit 2	60 cm BGS	2	0	X
30m Pit 3	60 cm BGS	3	0	X
40m P4	60 cm BGS	2	3	X
50m P5	60 cm BGS	2	0	X
60m P6	60 cm BGS	3	0	X
70 P7	66 cm BGS	2	5	X
80 P8	68 cm BGS	3	0	✓ 58-60
90 P9	65 cm BGS	2	0	X
100 P10	65 cm BGS	2	2	X
110 P11	65 cm BGS	3	1	X

26/04/88

P88/2/E25

22x Transect set at $208^{\circ}10$ through quebrada toward ballcourt, intervals of 10m. joining 22w at road

X1. 0-45cm BGS mixed cobbles at 30cm BGS 2 strat differences A-B 2m off of fence landmark at $208^{\circ}10$

X2 0-80cm BGS 3 soil chgs ABC 10m at $208^{\circ}10$ from X1

X3 0-80cm BGS 3 soil chgs ABC 10m at $208^{\circ}10$ from X2

X4 0-20cm BGS 1 soil mixed river cobbles few sherds 10m at $208^{\circ}10$ from X3

X5 0-30cm BGS 2 soil chg. A-B river cobble wall of quebrada apparent no sherds 10m at $208^{\circ}10$ from X4

X6 0-85cm BGS 3 soil chg. new cat. of soil Q1 pebbly exclusive to quebrada. 10m at $208^{\circ}10$ from X5

X7 0-25cm BGS 1 soil Q1 10m at $208^{\circ}10$ from X6

X8 0-40cm BGS 2 soil Q1-Q2 (another exclusive pebbly). 10m at $208^{\circ}10$ from X7 in bottom of quebrada

X9 0-60cm BGS 2 soil Q1+A - 10m at $208^{\circ}10$ from X8

X10 0-45cm BGS 2 soil A+B - 10m at $208^{\circ}10$ from X9

X11 0-45cm BGS 2 soil A+B - 10m at $208^{\circ}10$ from X10

X12 0-50cm BGS 2 soil A+B 10m at $208^{\circ}10$ from X11

26/04/88

P88/2/E26

- X13 0-50cm BGS 2 soil chg A+B 10m at 208°10 from X12
- X14 0-40cm BGS 2 soil chg A+B 10m at 208°10 from X13
- X15 0-60 cm BGS 3 soil chg ABG plus cobbles + sherds
10m at 208°10 from X14
- X16 0-50cm BGS 3 soil changes ABC 10m at 208°10
from X15
- X17 0-50cm BGS 2 soil chg. A-B 10m at 208°10 from X16
- X18 0-45cm BGS 2 soil chg A-B 10m at 208°10 from
X17

28/04/88
P88/2/E27

22Y transect set 270° from corner post at 21° at
16m 10m intervals towards ball court from road
✓Y1 0-40cm BGS 2 soil chgs. no sherds

✓Y2 0-60cm BGS 2 s chgs sherds no

✓Y3 0-50cm BGS 2 s chgs. no sherds

✓Y4 0-65cm BGS 2 s chgs poss Struct.

✓Y5 0-50cm BGS 2 s chgs no sherds

✓Y6 0-60 cm BGS on str. 2 s chgs. no sherds

✓Y7 0-60 cm BGS 2 s chgs no sherds

Both Y6-7 have white material in 2nd level

Y8 0-50cm BGS poss str. 2 s chgs. no sherds

Y9 0-58 cm BGS 2 s chgs no sherds

Y10 0-42 cm BGS 2 s chgs no sherds back side of
B court

Y11-Y12 unopened to date

Y13 0-25 between str. rocks - 1 soil

Y14 0-26 cm BGS on str. common fill

23/5/88

P88/2/E 28

Y15 0-36 cm BGS edge of str. sherds 1 soil

Y16 0-30 cm BGS edge of str. sherds 1 soil

✓ Y17 0-30 cm edge of str. 1 soil no sherds

✓ Y18 0-25 cm BGS on str. 1 soil ~~no~~ sherds

✓ Y19 0-60 cm BGS w. edge of same str. 2 soil
sherds

✓ Y20 0-40 cm BGS 2 soil chg no sherds

Y21 0-30 cm BGS on edge of rise much cobble
some sherds

Y22 0-20 cm BGS some sherds on str.

25/05/88

p88/2/E29

ZZZ transect at 250°10 in 10m intervals toward the West to possible clay deposit. from set point on summit of structure (# 30cm circular pits

Z1 0-46 cm BGS 1 soil

Z2 0-58 cm BGS 2 soil at 49

Z3 0-58 cm 2 soil some sherds at 46

Z4 0-44 cm BGS on edge of str. 1 soil

Z5 0-31 cm BGS on edge of same str. 1 soil

Z6 0-50 BGS 2 soil chg at 37

Z7 0-55 cm BGS 2 soil A-C at 40

Z8 0-58 cm BGS 2 soil A-C at 38

Z9 0-49 cm BGS 2 soil AB at 41

Z10 0-55 cm BGS 2 soil AB at 38

Z11 0-46 cm BGS 2 soil AB at 35

Z12 0-50 cm BGS 2 soil AB at 39

Z13 0-55 cm BGS 2 soil AB - 30

22AB1 depression 0-60 cm BGS

AB2 depression 0-50 cm BGS

30/05/88

P88/2/E30

Z14 10m at 250°10 from Z13 0-60cm BGS 2 soils
A-D at 38cm

Z15 10m at 250°10 from Z14 0-55cm BGS 2 soil
A-D 35cm

Z16 10m at 250°10 from Z15 0-63cm BGS 2 soil
A-E

Z17 10m at 250°10 from Z16 0-58cm BGS 3 soil
A-F-E 27-45-58

Z18 10m at 250°10 from Z17 0-48cm BGS 2 soil
A-E 34cm

Z19 10m at 250°10 from Z18, 0-57cm BGS 2 soil
A-E 40cm

Z20 10m at 250°10 from Z19 0-36cm BGS 1 soil
A poss str.

Z21 10m at 250°10 from Z20 0-49cm BGS 2 soil
A-E at 41cm

Z22 10m at 250°10 from Z21 0-57cm BGS 3 soil
A-E-F 39-51-

Z23 10m at 250°10 from Z22 0-60cm BGS 3 soil
A-E-F 37-48-

30/05/88

P19/2/E31

Z24 10m at 250°10 from Z23 0-54cm

Z25 10m at 250°10 from Z24 0-63cm

Z26 10m at 250°10 from Z25 0-47cm

Z27 10m at 250°10 from Z26 0-62cm

Z28 10m at 250°10 from Z27 0-59cm

Z29 10m at 250°10 from Z28 0-61cm

Z30 10m at 250°10 from Z29 0-47cm

Z31 10m at 250°10 from Z30 0-55cm

225 Bottom view

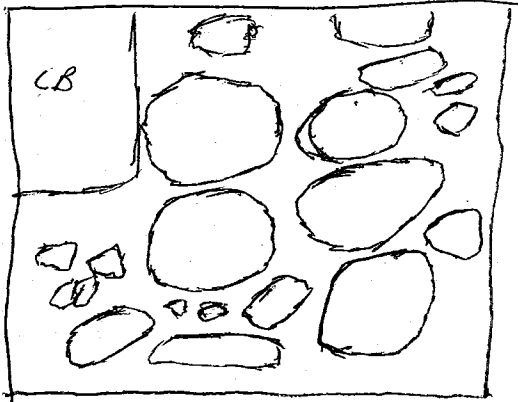

The goal of my project is to establish subsurface material, in the form of soil (strata), structures, sherds, and other artifacts & ecofacts that lie therein. Originally my plan was to set forth transects at certain points, then to at set intervals place post holes for the information.

Due to problems with equipment, I chose to set 1x1 meter pits at set intervals along established transects. My project has left no doubt that there are many subsurface structures undetectable from ground level. As well it is allowing information to be gain on human activities between these and other known structures.

Some soil samples are, and have been taken, to be float tested. I have hopes that vital information on agricultural systems, and natural strata details, can be attained.

In total the project should benefit the project in large, for information that previously was uncollected. With assistance from other group members accurate information of these areas between groups of structures should be attained.

I am planning to post hole sample in the future, when equipment is made available. I feel that this method will increase the efficiency of my project, and allow a much broader sample of the total valley.