

2000

PVC-029-Wendt-Field Notes-2000

Jen Wendt
Kenyon College

Follow this and additional works at: <https://digital.kenyon.edu/honduras>



Part of the Archaeological Anthropology Commons

Recommended Citation

Wendt, Jen, "PVC-029-Wendt-Field Notes-2000" (2000). *Four Valleys Archive*. Paper 29058.
<https://digital.kenyon.edu/honduras/29058>

This Field Notes is brought to you for free and open access by the Anthropology at Digital Kenyon: Research, Scholarship, and Creative Exchange. It has been accepted for inclusion in Four Valleys Archive by an authorized administrator of Digital Kenyon: Research, Scholarship, and Creative Exchange. For more information, please contact noltj@kenyon.edu.

14 Feb. 2000

Sunny, warm

Jennifer Wendt = Excavator #29

Structure 61

originally thought OP/SUBOP/OLT
to be 5B should be→ 5D = axial trench

Other structures in the vicinity are Chris to the NW (struct. 23), Roger to the north (struct. 261), Veridy & Imogen to the north, Rich to the SE and Stacy and Alicia to the East

- sharing SUBOP # w/ Roger, Imogen & Veridy

- some surface rocks appear. There seems to be a fairly distinct summit line on the surface. I will put my axial trench perpendicular to that line. It should bisect the structure at a 90° angle if oriented correctly. orientation: 117°

10m in length x 1m width

Square #1 eastern most in axial trench:5D/001

0-20cm bgs as measured from NW corner ~~all~~ measurements will be made from NE unless otherwise stated
med. brown ~~clay~~ silt clay loam → topsoil
- some sherds, pieces of chert, obsidian

5D/002

20-30cm bgs Sg. 1

- some sherds may be refit → thick, plain
- obsidian

Change SUBOPS when moving laterally dividing the struct. into Quads giving each a SUBOP

15 Feb. 2000

Sunny, warm

continuing Sg. #1

5D/003

30-40cm bgs

terminal debris

- sherds → thick, coarse → many from same vessel
- lg rim sherd 0-12 S, 5-15 W more uncovered but not in place or on surface of any sort. significance unknown.

cont. Feb. 15, 2000

- some large angled rocks presumably tumble from ~~the~~ wall to the west ground

Sq. #1: - possibly some sort of line appearing that was not present on surface in middle of Sq. 1

5D/004 40-50cm bgs terminal debris

- some sherds → quantity has decreased

- obsidian

- matate piece

5D/005 50-60cm bgs

- some sherds → rims quantity continues to decrease

- obsidian, chert

- green rock found in northern wall of trench. I'm not sure if it has a special purpose or just used for construction. It will be kept just in case.

Square #2: west of Sq. 1 in axial trench 1x1m

5D/006 Sq. 2 0-20cm bgs topsoil

- some sherds, big, ugly

this lot was not finished it will continued tomorrow

This level has many small rocks that may be part of some sort of fill.

16 Feb. 2000 Sunny, warm

cont. 5D/006 Sq. 2 0-20cm bgs

- some sherds

* green obsidian, bl. obsidian

There are many small (8x8x5cm) rocks almost solid. There are some larger rocks, but they seem to be all jumbled. If this is fill I have not yet found a retaining wall.

→ they came across another rim sherd and some more pieces to the same vessel. They aren't that careful. I'm working on that but they've never dug before.

5D/007 Sq. 2 20-30cm bgs

- sherds

- obsidian

Soil changes
to red brown
sandy clay when
one of these lots

cont. 16 Feb 2000

Square #2: The layer of small rocks starts @ ~10m bgs and continues below 30m bgs. It covers the entire Sq. but doesn't appear in profile of south wall of axial trench.

There are 2 lg. rocks almost diagonally aligned, flat faces towards the this layer ends @ 25-30m bgs

Some larger rocks ~~appe~~ have been uncovered below the rock layer.

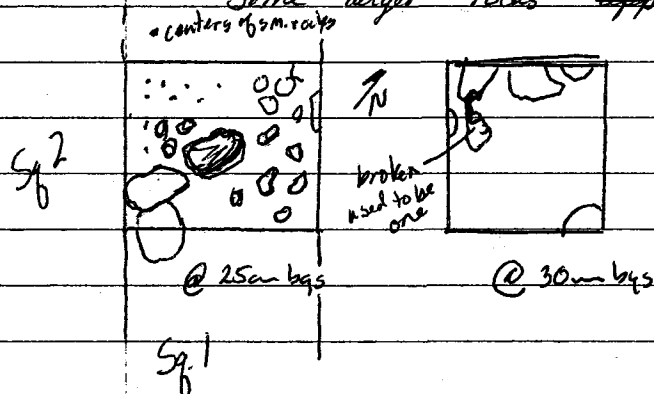

SD/008 Sq. 2 30-40m bgs t. mble
- sherds

part of
probably rocks on end
feature later determined
to be REDWOOD

* There doesn't seem to be much of a line, but there are many rocks that ~~are~~ look as if they have slid ^{east} off something to the NW

SD/009 40-60m bgs t. mble ~~accidentally~~ went 20m instead of 10m
- sherds

- obsidian and some flaking debris: chert

SD/010 60-70m bgs t. mble

- some sherds \Rightarrow handle \Rightarrow they seem to be finer quality thinner, possibly polychrome in this lot.
SD/011 scrapings from western wall of excavation of Sq. 2 to straighten out the square.

SQUARE #3

SD/012 0-20m bgs Sq. 3 west of Sq. 2 in axial trench
- sherds

REDWOOD * Many more large rocks that seem to be tumbled.

The first wall should be in the next Sq. or possibly the western edge of this one.

SD/013 10-30m bgs Sq. 3 \rightarrow sherds \rightarrow t. mble

Thurs. 17 Feb. 2000 sunny, hot

Still working w/ 2 guys on axial trench. Francisco & Firmin
Square #3: west of Sq. 2 in axial trench

5D/014: 30-40 cm lgs in Sq. 3 just started @ end of day yesterday

-sherds

-obsidian, chert core

Soil changes @ 26 cm lgs

0-26 cm lgs topsoil, some rubble

26- brown, coarse grained sandy clay

6D/015 backfill from Sq. 2 → obsidian

5D/016 40-50 cm lgs brown, coarse grained sandy clay

-sherds

→ rubble

-obsidian

5D/017 50-60 cm lgs → rubble

-sherds → highly eroded, many just crumbs

-obsidian

towards bottom of level sherds are better preserved and seem to be of higher quality

5D/018 60-70 cm lgs in Sq. 3 → rubble

-sherds

There is a stack of 3 rocks on the northern side of the square. Looks to be a wall that is slanted to the east starting at 60 cm lgs and going to a depth of at least 50 cm lgs referred to from now on as ELM.

Sq. 3
@ 40 cm lgs

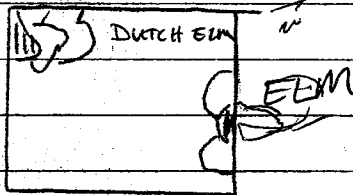

There are also some rocks on the ^{west} southern side of the square some appear to be in line w/ ELM w/ some gap in the wall. But with the amount the stacked rocks are tilted it is conceivable that we lost the entire wall here.

There are also some more rocks being uncovered as we go deeper. These seem to be an earlier construction and

they continue across the entire Sq. with no gaps, ^{overlap by 20 cm deposition} at a depth of ELM. This line will be DUTCH ELM.

6D/019 Sq. 2 70-80 cm lgs → rubble - sherds, chert, obs, matate piece

Square #10 Hoping to find base of rocks in Sq. 3 to look at them from a diff. angle

5D/020 Sq. 10 west of Sq. 9 in axial 0-70 cm lgs topsoil - sherds

cont. Thurs. 17 Feb. 2000

Square #3

DUTCH ELM is a wall

2 courses thick @ ~55 cm bgs
to a depth of @ least 70 cm bgs
large fairly flat rocks overlain
by soil deposition before ELM
was constructed

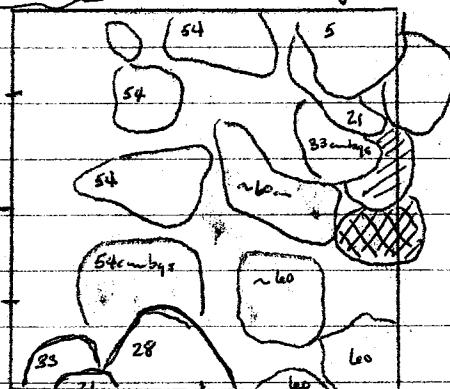

ELM a wall 3 courses high and 1 course thick. There is a gap from one side of the trench to the other... doorway?

Constructed of mainly rounded cobbles of some irregular rocks. Single course of rocks laid on top of one another. All of them slumping to the east away from the main struct. at almost a 30° angle. More may have been taken out b/c of the slump. The thickness made it hard to see.

top @ ~5 cm bgs bottom ~42 cm bgs

Square #3: REDWOOD
ELM
DUTCH ELM

I have

Francis's workers while she works on her burials.

5D/021 Sg. 10 west of Sg. 9 in axial trench → terminal debris
10-20 cm bgs

- sherds → possible polychrome, decorated ave. size 3x5 cm

* large quantity of sherds

5D/022 Sg. 4 west of Sg. 3 in axial trench
0-20 cm bgs

- sherds - bijareque 7 obs. - chert

Possibly coming onto another wall in Sg. 4 b/c of the amount of rubble we removed. In this level, there is a possible line of rocks along the southern side of this Sg. could it be holding fill in?

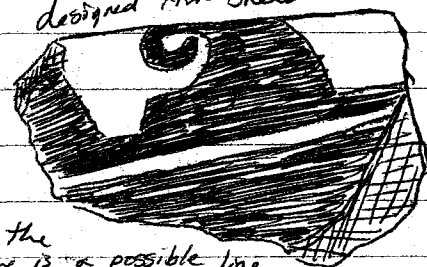

5D/023 Sg. 10 west of Sg. 9 in axial trench

20-30 cm bgs - sherds → av. size 5x5 cm → almost a solid layer
→ not excessively eroded
→ fairly flat lying deposit.

- obsidian, chert flake

5D/024 Sg. 4 west of Sg. 3 in axial
20-30 cm bgs - sherds

cont. famorous

5D/025 Sg. 10 west of Sg. 9 in axial trench

30-40 cm bgs → terminal debris

* - sherds → handle → incised * high quantity

- obsidian

2 BAGS

18 Feb. 2000 sunny, hot

Francis' workers again today: Brian and Thomas

5D/024 cont. from yesterday Sq. 4 20-30cm bgs

-sherds -obsidian

5D/026 surface find Sq. 5 in axial trench on the summit

-chert flake → possibly chalcedony

5D/027 Sq. 10 west of Sq. 9 in axial trench → terminal debris

40-50cm bgs → quantity of sherds is decreasing

a line of med. sized rocks has been uncovered in the southern side of the square @ ~45cm bgs It appears to be a wall possibly to a substructure to the SW of Struct. 61. This wall is MAPLE oriented 124°

~~5D/028 Sq. 4 west of Sq. 3 in axial trench~~

→ many decorated pieces

→ prong 10cm long ~5cm in diameter slightly irregular

-sherds -chert -obs.

2 BAGS

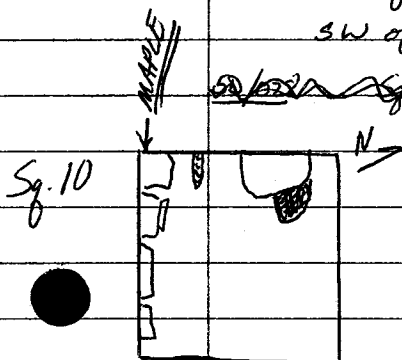

5D/028 Sq. 4 west of Sq. 3 in axial trench → table

30-40cm bgs

-sherds → finer quality, possible polychrome
-obsidian

not much going on in this Sq. so far. There is some table

5D/029 Sq. 4 40-50cm bgs → table

-sherds

-obsidian

There are some flat lying rocks in the southern side of this Sq. Their depth is ~45cm bgs with the bottom deeper than 50cm bgs. The rocks' average size is 25x20x5cm on the northwestern end there seems to be another rock underneath these. We'll have to excavate more to look at this "feature's" relationship to BUTCH ELM

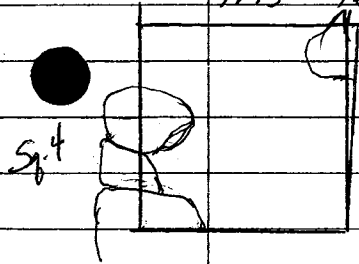

5D/030 Sq. 10 west of Sq. 9 in axial trench 50-60cm bgs

→ terminal debris

- density of sherds continues to decrease

→ ~~MAPLE~~ continues to go deeper
MAPLE

cont. 18 Feb, 2000

SD/031 Sg. 4 west of Sg. 3 in axial trench → Lbl
50-60 - bgs - shreds

The Lbl seems to coming from something higher up to the west l/c of its sample.

SD/032 Sg. 10 west of Sg. 9 in axial trench → terminal debris
60-70 - bgs next to MAPLE
- shreds

SD/033 Sg. 3 in axial trench in front of ~~MAPLE~~ (west of) behind ELM next to (north of) SCOTCH PINE
~30-40 - bgs obsidian blade: complete 10cm long x 1.5cm wide
- shreds

SD/034 Sg. 9 0-10 - bgs west of Sg. 8 in axial trench
- shreds → chert - obsidian fish or bird-like head

SD/035 Sg. 9 10-20 - bgs
- shreds → handles many shreds
- obs. - chert 2 BAGS

Same sherd layer as in Sg. 10

It seems to be 20-25cm thick fairly dense, now eroded flat-lying shreds.

SD/036 Sg. 4 west of Sg. 3 in axial trench: 60-70 - bgs → Lbl
- shreds, - obsidian

These The rocks in the SE and NW are still puzzling

SD/037 Sg. 4 70-80 - bgs → Lbl
- shreds → bird-like head 3-5cm
- obs. core piece

- green stone → pigment stone? construction stone?
degraded → not kept.

SD/038 Sg. 9 west of Sg. 8 in axial trench → Lbl
20-30 - bgs - shreds
- biquingua 2 BAGS

same sherd layer as in Sg. 10

SD/039 Sg. 4 80-90 - bgs → Lbl
- shreds → possible foot of vessel
- obs, chert

SCOTCH PINE is short line of ~4 tracks in the S half of Sg. 4 flat lying
~45 bgs - 65 - bgs 90cm long 40cm wide

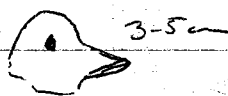
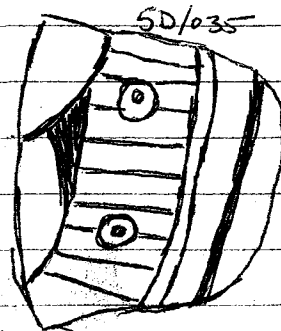

cont.

5D/040 Sg 9 west of Sg 8 30-40 cm bgs → Lbl

-sheds concentration of Lbl in S end of Sg. ~26-35 cm bgs

Mon 21 Feb, 2000 partly cloudy, warm it rained over the weekend.

Some rocks in Sg 9 have been removed. ^{It} ~~They~~ appears that they were just Lbl anyway.5D/041 Sg 9 west of Sg 8 in axial: 40-50 cm bgs → Lbl
more
-sheds

-obs. - chert Plate

SQUARE #515D/042 Sg 5 west of Sg 4 in axial Lbl 0-10 cm bgs → Lbl from wall to the west
-sheds - obsidian

Some Lbl appear at the surface. Angled as though they came from something to the west.

5D/043 Sg 5 10-20 cm bgs → Lbl
-sheds - obs.5D/044 Sg 9 50-60 cm bgs → Lbl / Lbl
-sheds - Some signs of carbon, but mainly small flecking5D/045 Sg 5 in front of wall to west OAK → Lbl
30-40 cm bgs - sheds - obsid.SQUARE #615D/046 Sg 6 west of Sg 5 in axial trench → Lbl
0-10 cm bgs on top of BIRCH - sheds

there is a line of rocks running // to axial trench on south side of the square. that connects to OAK to a wall oriented roughly N-S.

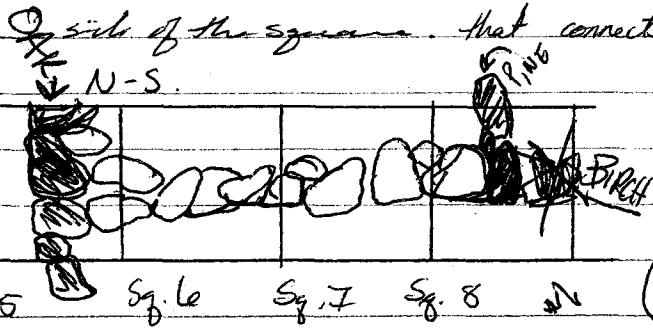

In Sg 5 BIRCH meets OAK.

OAK can be seen on the surface in Sg 5 trending N-S. It is 2 courses thick, Sg rocks on top of fill? width of 50 cm height of ~20 cm fill: med brown coarse grained sandy clay w/ small rocks

BIRCH is a wall roughly E-W // to axial trench. constructed of large rocks overlain by small rocks. Appears on the surface in Sg. 6, 7, & 8 to actually be in front of wall. It appears @ 5-10 cm bgs in Sg 5. trends 109°

5D/047 Sg 9 60-70 cm bgs → Lbl
-sheds - obs.

cont. Mon 21 Feb 2000

5D/048 Sg. 8 ^{west} ~~north~~ of Sg. 7 in axial trench 0-20 cm lgs → table
-shards on and around PINE
-obsidian

5D/049 Sg. P 20-30 cm lgs
-shards -obsidian, -chest

The back wall of the summit. 3 aligned rocks ~~add~~ add to sketch
This would be the western wall of the summit trending approx N-S.
PINE ~~can~~ BIRCH seems to abutt PINE... not sure about
this relationship right now.

Images left... I don't know what her hot tub was. I'll have to find out before I move laterally.

5I/001 Sg. 11 north of Sg. 3 0-20 cm
following ELM to the NE
-shards

5I/ new subop for NE quad of structure moving laterally following ELM

Feb. 22 sick → rain day

Feb. 23 sick

24 Feb. 2000 sunny, warm

Somehow I lost one of my workers leaving me with only one of my own
and 2 of Stacy's which she will come to claim around 9. This isn't
going to work...

5I/001 cont. yesterday's bag may ~~be~~ be mis-labeled, but I
couldn't find it.

5D/049 An A tag was found with this label. It had been disconnected
from its bag for awhile, but has since been re-united.

5D/050 Sg. 7 west of Sg. 6 0-20 cm lgs backside of PINE
-shards -obsidian interior

5I/002 Sg. 11 20-30 cm lgs around ELM
-shards → lg. rim shards / prong or lg

5I/003 Sg. 11 30-40 cm lgs -shards -obs

24 Feb. 2000 cont.

5D/051 Sq. 8 west of Sq. 7 in axial trench in front of PINE
30-40 cm bgs. tumble

- sherds may continue lot on top of PINE

5D/052 Sq. 8 west of Sq. 7 in front of PINE
40-50 cm bgs

- sherds → lg. sherds, some rim pieces, Average size 5x8cm

→ they are probably from the same vessel

→ handles

* may want this lot looked at first.

5D/053 Sq. 7 west of Sq. 6 in axial; directly east and on top of BIRCH
20-30 cm bgs → tumble

- sherds → handles, rims

5D/054 Sq. 7 west of Sq. 6 east of BIRCH
30-40 cm bgs tumble
- sherds

25 Feb. 2000 sunny, warm

We will continue clearing on and around BIRCH

5D/055 Sq. 7 east of BIRCH
40-50 cm bgs
- sherds

* SUBOP 5D should be finished today, but * may go deeper in certain areas later

W/64 LIST NEEDS TO BE DONE

Clearing ELM

5I/004 Sq. 11 1x1m sq. north of Sq. 3, north of ELM
40-50 cm bgs
- sherds → handle, rough, eroded
- obsidian

5I/005 Sq. 12 north of Sq. 2, S of Sq. 11 southern side of ELM
0-10 cm bgs → tumble
- sherds → handle, eroded
- obsidian, chert

Cont. 25 Feb. 2000

SUBOP 5K - SUBOP 5K will be the NE quad of struct. 61
 - SUBOP 5I is the SE quad of struct. 61
 - the western edge of the axial trench will be drawn soon until then I will only work on the eastern 1/2 of the struct. to keep the western profile intact.

- It looks as if OAK, ELM, & PINE continue to the west and east whereas BIRCH & MAPLE trend ~ // to the axial trench ~ NW-SE

5K/001 Sq. 19 north of Sq. 9 tumble
 0-10 cm bgs

- sherds
 - obsidian
 - chert

2 BAGS

5K/002 Sq. 19 10-20 cm bgs
 - sherds

2 BAGS

5K/003 Sq. 19 20-30 cm bgs table
 - sherds

2 BAGS

5K/004 Sq. 19 30-40 cm bgs
 - sherds
 - obsidian

2 BAGS

5I/006 Sq. 12 north of Sq. 2, E of Sq. 11 south of ELM
 10-20 cm bgs
 - sherds
 - obsidian - chert

5I/007 Sq. 12 south of ELM
 20-30 cm bgs
 - sherds

* Again in the axial trench there is a massive amount of small rocks. This time we will follow this layer to the south opening Sq. 13

5I/008 Sq. 13 north of Sq. 1 E of Sq. 12
 0-20 cm bgs - sherds

- obsidian * green obs.

5K/005 Sq. 19 40-50 cm bgs - sherds

* A large amount of sherds coming out of Sq. 19. 20-30 cm bgs seems to be a layer of flat lying non-eroded sherds. This sq. will be excavated to give more room in front of PINE

* all measurements from NE ^{terrace}28 Feb 2000 sunny, warm, (hot, humid) maybe rain5I/009 Sg. 13 ^{north} east of Sg. 1 E of Sg. 12

20-30 cm bgs → table

- sherds, chert

2 BAGS5Q 12 has a layer of small rocks packed in together @ ~35-40 cm bgsWe will see if that continues in Sg. 13. There was a layer in the axial trench as well, but it was taken out to see what was underneath looking for a retaining wall for the fill.5K/009.5 cont Sg. 19 40-50 cm bgs table/T.D.

- sherds - 8 cm diameter 3 cm high base

- chert

2 BAGS5K/006 Sg. 19 50-60 cm bgs table/T.D.

- sherds

- chert

3 BAGS5K/007 Sg. 18 east of Sg. 19 north of Sg. 8

0-20 cm bgs in front of and on top of PINE → table

- sherds, obs.

3 BAGS

* The sherd layer as seen in profile of Sg. 17 is ~30-60 cm bgs

5I/010 Sg. 13 north of Sg. 1 → table30-40 cm bgs - mano 7 cm long x 6 cm in diameter
one side flattened

- obs.

- sherds foot: 6 cm in dia. 5 cm tall

5K/008 Sg. 18 20-30 cm bgs behind PINE table

- sherds, obs.

5K/009 Sg. 20 N of Sg. 18 0-10 cm bgs 2 BAGS

- sherds

5K/010 Sg. 20 10-20 cm bgs 3 BAGS

- sherds

5I/011 Sg. 12 east 1/2 of Sg. 12 30-40 cm bgs in front of what might be a terrace

- sherds, obs, chert

→ table

COTTON WOOD

29 Feb. cloudy, warm

5K/011 20-30cm bgs
terminal debris/trble

Sg. 20

- sherds, obsidian, ocarina

Pedro → new guy, was giving me looks again this morning. I had talked to Pent about it yesterday and she said it would get taken care of. This morning I had to ask Garrett to switch. Nobody wanted the guy so he ended up with Roger.

5I/012 Sg. 12 40-50cm bgs terminal debris/trble
- sherds, obsidian, chert

It looks as if there may be a line of rocks in Sg. 12 @ approximately 40cm bgs 60cm from the eastern edge of the Sg. trending approx SW-NE. The line in Sg. 13 has become more defined. COTTONWOOD - line of rocks - wall and terrace - compact small rocks

5D/056 Sg. 1 60-70cm bgs → soil change: med brown sandy clay
- sherds, obsidian, chert

following the line in Sg. 13 we are digging deeper in Sg. 1 of axial trenches. Hopefully, we'll find that the line continues to the SW.

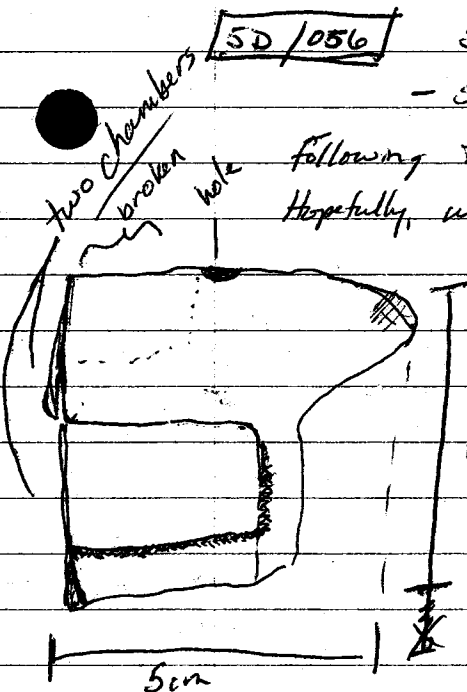

broken ocarina from 5K/011

broken stamp?
5K/012

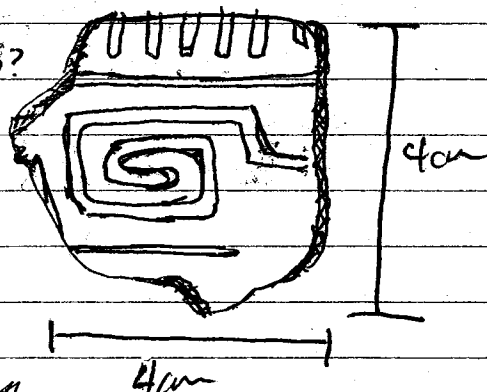

5K/012 Sg. 20 30-40cm bgs. ↑
- sherds, obsidian, chert - stump
- trble/terminal debris

5K/013 Sg. 21 ^{North} of Sg. 17 E of Sg. 20
0-20 cm bgs

5D/057 Sg. 1 70-80cm bgs
- sherds, chert

the line of rocks goes deeper. We are looking for the bottom.

cont. 29 Feb. 00

5D/057 70-80cm Sq. 1 The line of rocks in the southern half of this Sq. looks to go deeper
5K/013 0-20cm Sq. 21 MAGNOLIA

Sq. 1 there was some sort of soil change around 60cm bgs. The line of rocks is at least 80cm bgs. If it is not a part of this structure there is a structure to the SE of my structure 61. If this wall is part of my structure, I may have had them dig into a terrace surface. Unlike the layer of packed rocks in Sq. ~~12~~ 12, there was nothing to suggest there was a terrace surface. The amount of sherds has decreased dramatically as we dig deeper. This line is MAGNOLIA.

5D/058 80-90cm bgs Sq. 1 sherds - tumble/t.d.

5D/059 Sq. 2 in arial trench ^{west} ~~east~~ of Sq. 1 80-90cm bgs
 -sherds

* 5K/014 10-20cm Sq. 21 tumble/t.d.
 sherds, chert → censor prong

* 5K/015 20-30cm Sq. 21 tumble/t.d.
 sherds, chert, obsidian → handle, lg. rim

~~5I/013~~ 5I/013 Sq. 12 north of Sq. 13 40-50cm bgs - sherds
 - trying to find a more definite line of

5K/016 Sq. 21 30-40cm bgs tumble/t.d.
 sherds, obsidian

5I/014 Sq. 11 cleaning in front of ELM sherds

The stack of stacked rocks that is ELM may fall, but we want to find the relation between COTTONWOOD and ELM.

Does the surface abut ELM or is ELM on top of COTTONWOOD?
 needs to be cleaned more in order to tell, but rocks may tumble. I will draw a plan view before we clean more.

5I/015 Sq. 27 ^{north} ~~east~~ of Sq. 13 ^{east} ~~south~~ of Sq. 26
 0-20cm bgs

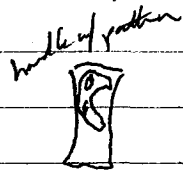

Nelson &
 Osman

- sherds
 - obsidian, chert
 - bone
 - handle, rim sherd

Fermion 5I/016Sq. 25 ^{north} ~~east~~ of Sq. 11, ^{east} ~~north~~ of Sq. 26
0-20m hys

following ELM & cottonwood sheds chest obs

Francisco 5K/017

Sq. 20

40-50m hys

obs. sheds

015-bone
sheds obs

After discussing things with Ed, it seems there may be a couple different ^{phases of} constructions here and a different structure all together.

The 2 rows of rock in the axial trench that I thought were the base of ELM may be an earlier construction with ELM placed on top at a later time. ELM seems to ~~what digging~~ have its flat face towards the North instead of the south as I had first thought. The lower construction is DUTCH ELM.

While digging to find the base of COTTONWOOD a line of vertically placed rock appeared in Sq. 2 @ a depth of 80-85m hys. It may be same phase as the lower ELM with upper ELM and cottonwood on top. There is a layer of dirt separating these 2 ~~constr~~ phases of construction. The rocks on end will be REDWOOD.

The summit is still not certain. Francisco & company are working on PINE as it turns to the east and hopefully will connect to OAK or another summit wall. BIRCH trends // to the axial trench in Sq. 8 it may abutt an earlier constructed wall. ~~and~~ There may be an earlier wall that extends ~~to~~ to the NE and run into the E-W wall ^{that would connect it with} PINE.

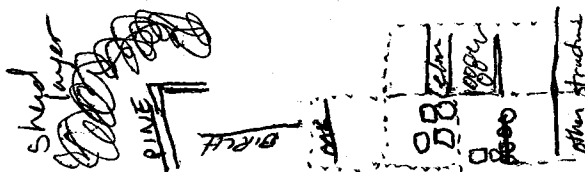

March 1, 2000 sunny, v. humid

6I/017 Sg. 25 20-30 → table behind PINON
-shards, obsidian

5K/016 cont. Sg. 21 30-40 → table BAG 2
-shards, obsidian

- more rocks were removed. There are an abundance of med sized rocks in this lot.

5I/018 Sg. 25 30-40 bags → table
-shards

5K/018 Sg. 17 west of Sg. 16 0-20 bags → table
Hopefully, this Sg. will help define the western summit wall PING
-shards

5K/019 Sg. 17 20-30 → table
-shards, obsidian

5I/019 Sg. 27 20-30 → table
-shards, obsidian

I'll be working with Bill and the mapping for awhile.

2 March transit

3 March

Backpack was stolen with most of my equipment,
some lot cards and a few pages of notes that I
will have to reconstruct.

6 March sunny, hot

5I/020 Sq 27 30-40 cm bgs → table / d
- chert, shuds

following MAGNOLIA to the north it seems to corner
in this square. another line trends to the east. ALMOND

5K/020 Sq 17

30-40 cm bgs

→ table behind PINON

- shuds

5K/021 Sq 16 west south of Sq 17 north east of Sq 6 → table
0-20 cm bgs shuds

5I/021

Sq 27

40-50

- shuds, obs.

5I/022 Sq 26 north of Sq 12, east of Sq 25
0-20 cm bgs

10 March, 2000

5I/023 Sq 26 20-30 cm bgs S, obs.

5I/024 Sq 26 30-40 shuds

5K/021 cont BABS 2 shuds

5K/022 Sq 22 0-20 cm bgs shuds 2 BABS

5K/023 Sq 22 20-30 cm bgs 1 BABS - shuds
westside: wall not evident, small rock w/ clayey
matrix fill. some large rocks in center
which is probably wall fill.

VACATION

excavator
#30

22 March, 2000

hot, sunny

5I/025 Sq 24 north of Sq 14, east of Sq 25
 0-20 m by s → table
 - sherds: ^{part of} figurina
 - obsidian 2BAGS

NEW SUBOT5M NW quad of struct. 61

5M/001 Sq 35 west of Sq 34, south of Sq 8
 0-20 m by s → table
 - sherds
 - obsidian

- following PINE to the west South west

5I/026 Sq 12 50-70 m in front of Cottonwood → table
 - sherds, obsidian

COTTONWOOD - retaining walls and floor that forms a small possible storage room
 in front of ELM

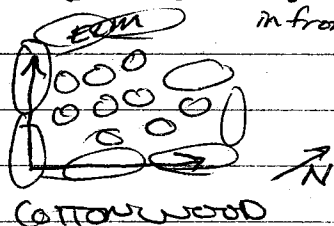

5R/024 Sq 21 north of Sq 17, east of Sq 20, north of PINON
 40-50 m by s
 - sherds

5I/027 Sq 27 north of Sq 14 east of Sq 23
 20-30 m by s → table
 sherds, obs., chert

5M/002 Sq 35 20-30 m by s
 sherds, obs.

5I/028 Sq 24 30-40 m by s → table 2BAGS
 sherds → repair strap handle
 Rocks on end → MULBERRY in Sq 23
 Sq 24 eastern edge of MULBERRY

22 March 00

5D

I need to go deeper in the axial trench ~~between~~ to define the ^{interior} ~~bottom~~ of the summit walls. R^WON, BIRCH, PINE & OAK. Sg. areas 5, 6, 7, & 8

In front of PINE needs to go deeper as well.

We also need to find the outside base of the basal walls. This has been hard to do because of the other walls that may be part of another structure some subsurface struct. to the SE

5M/003

Sg. 36 0-20cm lgs t.d.

shards, obsidian, chert

2 BAGS

NEW SUBOP

5N — SE quad of struct.

5N/001

Sg. 30 0-20cm lgs

-shards, obsidian

Hopefully we'll follow ELM to the west in this Sg. ELM seems to have 2 different constructions.

The first phase is a 2 course wide wall that appears at ~50cm lgs. Then there was an episode of deposition or fill was placed on top of it. ~10cm of dirt. a single width wall was built on top of the dirt.

The first construct. may be related to the rocks on end in Sg. 2 of the axial trench.

5I/029

Sg. 24 40-50 —

shards, obs.

5M/004

Sg. 36 20-30cm lgs

shards, obs. d

22 March 2000

5I/030

Sg. 24

50-60 cm bgs

- shnds. (polychrome mudls)

- obsid

2 BAGS5m/005

Sg. 36

30-40 cm bgs

baja roque, shnds

✂

5N/002

Sg. 30

20-30 cm bgs

- shnds

✂ green obs.

[March 23]

✂ 5N/003

Sg. 30

30-40 cm bgs

shnds, chert, obs.

✂ 5m/006

Sg. 36

40-50

- shnds,

→ table

✂ 5I/031

Sg. 14

0-20 cm

- shnds, chert

✂ 5N/004

Sg. 32

0-20 cm

shnds, chert

✂ 5m/007

Sg. 36

50-60

shnds

→ table

✂ 5I/032

Sg. 14

20-30 cm

shnds, obsidian chert

→ table

23 March 2000 cont. Hot, sunny

5M/008 Sg 35 south of Sg 8 east of Sg 34

20-30 cm bgs

-shards, obs

5M/009 Sg 35

following PINE to the SW

30-40 cm bgs -shards

→ L66

5M/010 Sg 35 40-50 -shards

5M/011 Sg. 34 Sg south of Sg 35 following PINE

0-20 cm bgs

-shards, obs.

5M/012 Sg 40 20-30 cm bgs -shards table

5N/005 Sg. 38 south Sg 32

0-20 cm bgs following OAK to the SW

-shards, chert

5N/006 Sg. 29 south of Sg 2

0-40 cm bgs -shards

5N/007 Sg. 39 south of Sg 38

0-20 cm bgs following OAK

-shards

5I/034 Sg. 14 north of Sg. 4 40-50 cm bgs -shards, chert

Possibly on top of terrace surface. The surface was not apparent, but it seems as though they are digging through fill at this level. * rim shards → shard layer

5I/035 Sg. 14 50-60 cm bgs shards, obsidian

I continue to have many small rocks.

5I/036 Sg 23 north of Sg. 15

0-20 cm bgs

-shards

-chert, obs.

ON TOP of
MULBERRY

5I/037 Sg 23 20-30 cm bgs

BAG #1

-shards

cont. tomorrow

5M/013 Sg. 40 20-40 -table

-shards

24 March, 2000 partly sunny, hot, breezy

5I finish clearing the NE $\frac{1}{4}$ of struct. looking for corner of ELM and COTTONWOOD and how they relate.

5M following PINE to the SW

5N following OAK to the ~~SW~~ SE SW

5M/016 Sg 40 40-50m bgs - table
- sherds

5M/014 Sg 40 50-60m bgs - table
- sherds, obs.

5M/015 Sg. 41 south of Sg. 40 following PINE
0-20m bgs - table
- sherds, obs.

cont.

5I/037 Sg 23 20-30m bgs BAG #2
- sherds - many rim sherds possibly some sort of surface of small rocks on end \rightarrow MULBERRY

5I/038 Sg. 43 north of Sg. 22
0-10m bgs [2 BAGS] \rightarrow t.d.
- sherds - decorated handle
- obs., chest

5N/028 Sg. 27 40-70m bgs on top of vertical rocks
- sherds REDWOOD

5N/009 Sg. 42 south of Sg. 39 on top of OAK
- sherds 0-20m bgs
- bijouque
- chest

5M/017 Sg. 41 20-30m bgs
- sherds : censor handle
- obs.

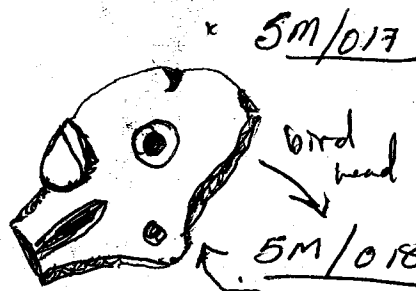

Sg. 41 20-30 cm bgs
- shreds cencer rubble
- obs.

5M/018

Sg. 41 30-40 cm bgs t.d./rubble
- shreds obsidian
→ handles
→ bird head

5N/010

~~5M/019~~

Sg. 32 on top of OAK 20-30 shreds
OAK heads to the South, but it appears that
there is another line coming off of OAK.
We'll open another square to get in front of it.

5M/019

Sg. 44

~~030~~
~~40-50~~ cm bgs rubble
sh to obs.

5N/011

Sg. 31

0-20 cm bgs
shd 1

5I/039

Sg. 48

~~20-30~~ cm bgs shd 3
10-20 cm

5I possible surface in Sg. 14

5N following OAK to the SW :

- hard to find the definite edge of OAK. We will work on FLIM
and comm. exc. towards the front of
OAK on Mon.

5M following PINE to the SW

- still haven't found the corner.

Mon. 27 March 00

sunny, mild

I have 6 workers today.
4 of my own and 2 from
various people.5I/040

Sq. 43

20-30

~~30-40~~ bgs

→ tangle

3 BAGS

In 5M → we possibly ran into the corner of the structure to the south.
 - obsidian, sherds
 If it is the 2 struts are connected.

5N/012

Sq. 31

20-30 m bgs

sherds

5M/020

Sq. 44

~~30-50~~ bgs~~50-60~~ bgs

30-40

- obsid., sherds

5I

Sq. 43 is being excavated to get in front of a surface
 attached to the northeast side of Piñon. The surface is
 composed of numerous med-small rocks standing on
 end. It appears to be about 1x1m square. It will

5N

be referred to as MULBERRY from now on. There are some v. lg.
 sherds coming out of 5I/040. Some maybe refit. I'm not sure if it is a surface
 or just that layer of sherds that appears to the N of the strut.

Sq. 31 excavated to find the front of ELM and
 take a look at some flat lying rocks found in the
 wall of the axial trench @ about 50cm bgs.

5M

Sq. 44 is following PINE to the SW looking for its corner.
 Instead of finding a definite corner there is another
 possible wall. The strut to the south may be connected.
 We will excavate to the S and W

5M/021~~Sq. 44~~

Sq. 44 40-50 - bgs sherds, obs.

5M/022

Sq. 49

0-20 - bgs sherds

5M/023

Sq. 49

20-30 - bgs sherds

5I/041 Sg 43 $\frac{1}{2}$ 30-40cm bgs

there are ⁽³⁾ some large rocks in a line. They don't appear to be connected to MILLBERRY, but they could be a continuation. So we are excavating another 10cm to see if there are any rocks below these.

→ rubble, t.d.

- shreds

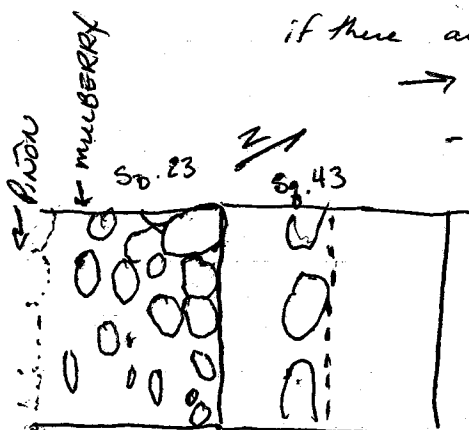

5I/040
figurina

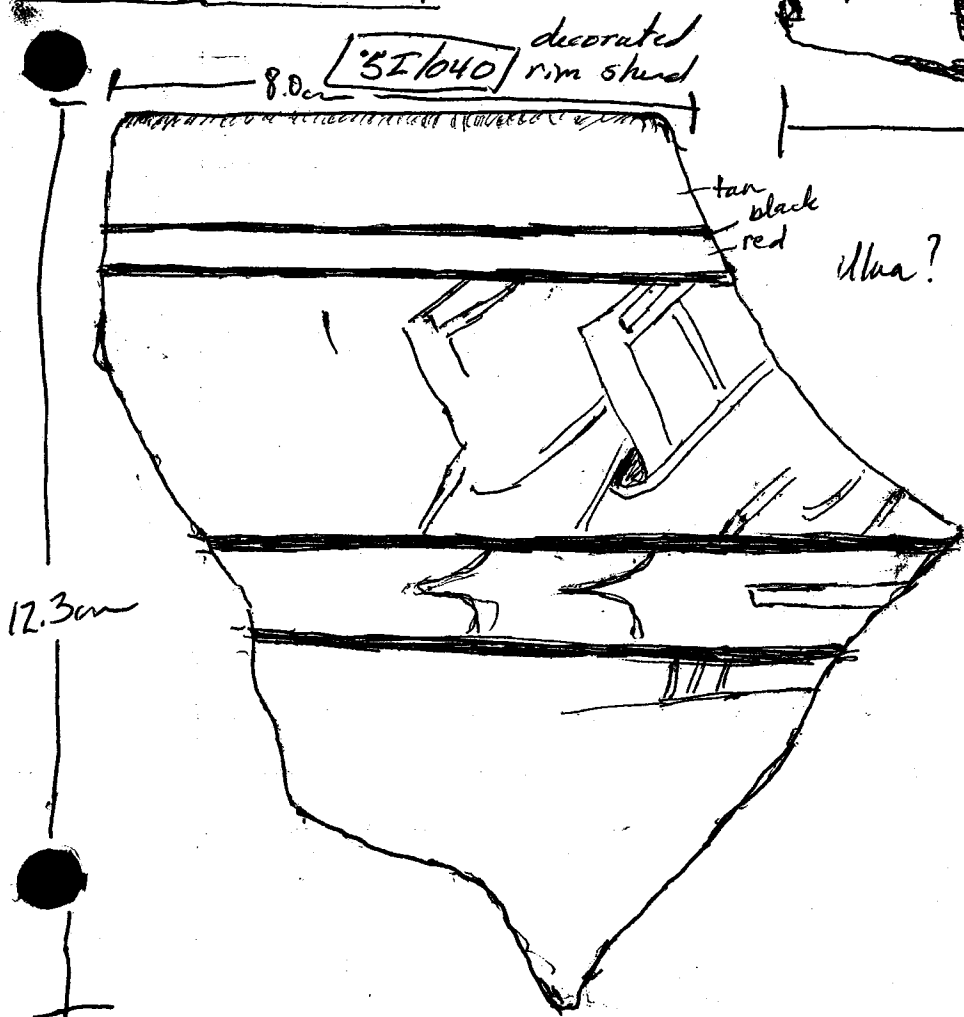

27 March 2000 cont.

5N/013 Sg. 43 30-40 -sheds

5I/042 Sg. 23 in front of PINON on top of MULBERRY
~30-35 cm bgs

-sheds, obs.

5M/024 Sg. 50 south of Sg 48, west of Sg 42
southern side of ASPEN (outside) 0-20 cm bgs
-sheds, obs.

5M/025 Sg. 50 20-30 cm bgs - sheds → table

5D/060 Sg. 889 50-60 cm bgs - sheds
→ cleaning & excavating to the base of PINE

28 March, 2000 sunny, hot

2 moving dirt
2 on summit
2 on south side

5M/026 Sg. 50 30-40 -sheds, obs.

5M/027 Sg. 34 south of Sg 7 west of Sg 33
0-30 cm bgs → table
sheds

5M/028 Sg. 49 30-40
sheds, obs. in front of ASPEN

5N/014 Sg. 51 south Sg 31 east of Sg 38
0-20 cm bgs in front of (east of) OAK
-sheds
-obs.

* 5N/015 ~~Sg. 30~~ Sg. 31 30-40 ~ logs
in front of OAK

Under some timber I found a small amount of
carbon associated with some shreds

2 ~~7A~~ (5M/029 Sg. 41 40-50 ~ logs west of PINE
shreds, obs.

(5N/016 Sg. 51 20-40 ~ logs shreds

* 5N/017 Sg. 42 20-30 ~ logs
shreds, obs.

5M/030 Sg. 54 0-20 ~
shreds, obs.

5M/031 Sg. 45 0-20 ~ Sg. 46
shreds, obs.

29 March

✓ 5M/032 Sg. 54 20-30 ~ 2 BAGS
shreds, obs, chert

+ d.

Sg. 54



There is a line of rocks that are aligned with
the corner of PINE. We are trying to get behind it.

PINE

+ 5N/018 Sg. 31 5' shreds, Lble possibly still
in front of OAK

5N/019

Sq. 53

1m x 50m south of Sq 52, east of Sq 42

0-30 km bgs

- sherds → table

looking for corner of OAK/ADPEN

5M/033

Sq 54

30-40

- sherds

→ candelero piece similar to another piece already found, but can't remember the other lot. #



- obs.

5M/034

Sq 54

40-50 - bgs

- sherds, obs.

5M/035

Sq 54

50-60

- sherds

5M/036

Summit

Sq. 48

south of Sq 46, west of Sq 39

0-20 - bgs

- sherds

5N/020

Sq 53

30-40 - bgs

- sherds

30 March, 2000

hot, sunny

5N/021

Sq 53

40-50 - sherds

Looking @ the street, I was trying to figure out how many different phases of construction there are. Some are defined B/c some walls are superimposed on ~~previous~~ construction, but those that aren't have unknown relationships

5M/037

Sq. 47

south of

Sq 45,

east of

Sq 41

0-20 - bgs

- sherds, obs.

Summit

cont. 30 March, 2000

SD/061 Sg 5 wall scrapings from in front of (east) OAK
40-60 lbs - shreds

OAK is ~~striking~~ falling towards the east

OAK
SD/061
side profile east

SI/042 Sg 55 north of Sg 23, south of Sg 43 0-10 shreds

SI/043 " 10-20 shreds, chert, obs.

SI/044 " 20-30 shreds

(2 BAGS)

SM/038 Sg 54 40-50 - shreds

SN/022

shreds, obs.

SN/023

shreds, obs.

SN/024

shreds

31 March, 2000

SM/039 Sg 33 south of Sg 6

0-30 lbs

- shreds

SN/025

Sg 60

east
south of Sg 59

0-20

shreds, obs.

SI/045

Sg 56

north of Sg 21

0-10 lbs

- shreds

SI/046

"

10-20

shreds, obsidian

SI/047

"

20-30

shreds

(2 BAGS)

SN/025 → Hopefully corner of OAK

SN/026

Sg 60

20-30 lbs

shreds, obs.

looking for
corner of
MULBERRY

cont.

The summit has alot of rubble on it. We are slowly removing it. We are doing the whole summit in levels. There aren't many artifacts coming out of it so far.

As of right now, BIRCH is ~1m thick. OAK is not well defined. The NE corner is escaping me as is the SE. We are adding a row of 1x1m on the southern side to see where the outside of ADPEN is.

SN/027 Sg 60 30-40 - bgs
- shreds, obs

2 BAGS

SI/048 Sg 56 30-40 - bgs
- shreds
- bcj, a regue
- chert, obsidian
tube, handle, figurine

I'm going to draw some of the eastern side of the structure in order to make a little more sense of it. Hopefully, it will help.

Pat & Ed suggested trying to find the relationship of my terraces to those of Roger's structure to the north. I'm not sure how we would do that. Possibly follow one of Roger's terraces (Struct 261) towards the south, or a test pit somewhere in between.

SN/028 Sg. 59 south of Sg 42 0-30 - bgs
- shreds
- matate

2 BAGS

3 BAGS

SN/029 Sg. 28 east of Sg 29 0-30 - bgs shreds
... trying to get a better look @ the lower construction rocks on end in Sg. 2

cont.

5N/030

Sg. 28

30-40 m bgs - sherds

5N/031

Sg 59

30-40 m bgs - sherds

3 April, 2000

sunny, v. hot.

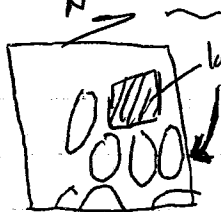
Flat stone possibly tumbled from
on top of line to the east5N/032

Sg. 28

40-50 m bgs

-sherds

Hopefully, we'll know more about the rocks on end in Sg 2
REDWOOD5N/033

Sg 59

40-50 m bgs

-sherds

Still looking for the front of ASPEN. We might have come
across another wall to a different structure to the SW
rocks look as if tumbled from something in Sg 58 to
the North. CEIBAI've been working on Roger's structure at the same time as mine.
I kept the notes separate and will number them at the end
of mine.5M/046

Sg 48

south of Sg 46. west of Sg 39

Summit

defining interior dimensions of the summit.

4 APRIL, 2000 hot, humid, hazy

Today SURDP 5M - defining summit

5N - defining SW edge of ASPEN & Sg 28

Roger's struct. 261 5E - summit

50 - eastern terrace walls

On the summit BIRCH seems to be built on top of a surface

BIRCH may have had an earlier construction which was then filled in and built on top of.



Phases of construction are still
confusing, but are unfolding

5N/032 cont.

shards, chert, obs.

5N/033 Sg. 59 40-50m lgs shards

5N/034 Sg. 58 30-40 outside of ASPEN
-shards, obs.

5N/035 Sg. 61 south of Sg. 29
0-30m lgs shards, obs.

5N/036 Sg. 29 S of Sg. 2 60-70 lgs shards

5N/037 Sg. 52 S of Sg. 49 east of Sg. 54 Rocks major may not be
a true CEIBA
0-20m lgs in front of ASPEN 3BAbes
-shards, chert

5N/038 Sg. 61 south of Sg. 29
30-40m lgs shards

5N/039 Sg. 61 40-50m lgs shards

4 APRIL, 2000 not, humid, hazy cont.

the notes for Roger's strud will be separate

SUMMIT: we are still trying to define the interior of the summit. It appears that the SE corner of the structure has slumped quite a bit, shifting the southern and eastern walls. The corner of ASPEN and PINE and ASPEN and OAK will be difficult.

OAK has a somewhat distinct interior at this point. That will help as we try to find the corner.

The entire summit seems to be covered with med-sized rocks... not sure if it is tangle or large fill. There may have been a stone floor some of which has subsequently been removed. The summit may have been filled with small-med rocks that are difficult to determine from the floor rocks. The matrix is a red-brown coarse grained sandy clay.

cont. 5M/040

5N/039 Sg 61 40-50 cm bgs shreds

5N/040 Sg 61 50-60 shreds, wajan

5N/037 Sg 57 ^{south} ~~east~~ of Sg. 2849

0-20 cm bgs - shreds, chert

✗ This one should actually be 5M, but I already found it. some of it is yesterday

Here we are trying to follow a small line of shallow rocks. It is probably part of a sub structure

5N/041 Sg 57 20-30 cm bgs - shreds

5N/042 Sg 61 60-70 obs, chert, shreds

5N/043 Sg 57 30-40 s, obs.

5N/044 Sg 62 south of Sg. 30

0-30 - shreds, obs.

Threading out the tangle, there is some definition ... a line or surface

5M/041 Sg 54 south of Sg 44

-shreds : clay mantle?

bird head

4 APRIL 2000 cont.

5M/042 Sg 54 50-60 - bgs

- shreds, obs. → larger rim & handle

5K/026 Sg 19 50-60

- shreds

5N/050 Sg 62 40-50

shreds, obs, chert

west (behind) **NATCH ELM**5N/051 Sg 64 west of Sg 62 & Sg 52

0-30 cm bgs

DUTCH ELM continues South

shreds

5N/052 Sg 37 6-7 Sg 28

0-40 - bgs

- shreds, chert, obs.

5M/043 Sg 44 0-30 - bgs

shreds, obs.

cont. 5K/027 Sg 19 60-70

- shreds

cont. 5M/044 Sg 44 30-50

- shreds

5M/045 Sg 49 47 45 Summit INT. OF PINE

70-90 - bgs - shreds, obs.

There is a floor that covers the interior between OAK, PINE, ASPEN, and BIRCH. PALM floor

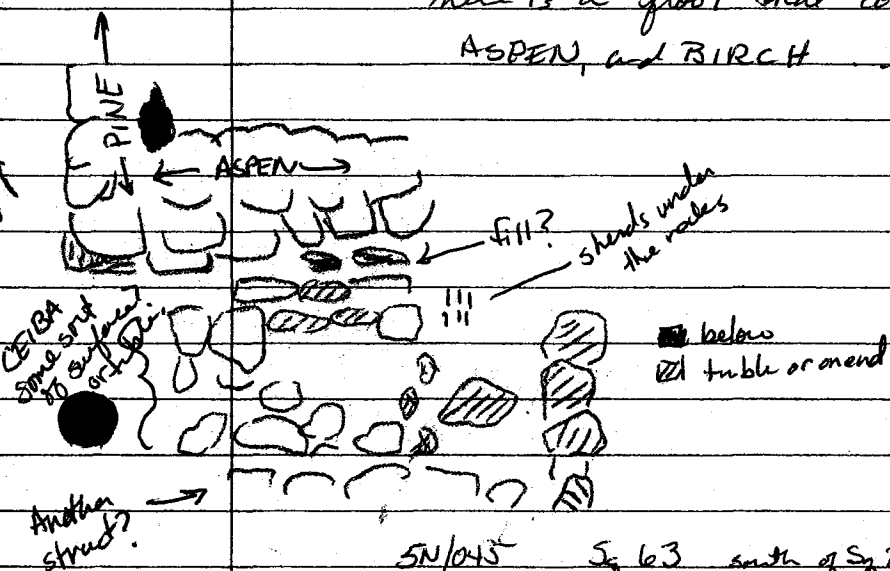

There are 4 rocks on end - probably not a feature of rocks on end, but the rocks seem to be in line whether they're tumbled or not. I do not know.

5I/049 on top of CARTONWOODS

Sg 26 bgs, shreds

40-50 - bgs

5N/043 Sg 63 south of Sg 285N/046 Sg 62 30-40 shreds, chert, bgs

5 APRIL 2000

Not in the field, took Monday to the airport.

6 APRIL 2000

hot, sunny

5R/025

Sg 19

40-50 m bgs

looking for base of PINE

2 BABS

-sheds

5N/047

Sg 62

South

of Sg 30

E 1/2 of Sg

40-60 m bgs in front of DUTCH ELM

-sheds, obs, baja

It would appear that DUTCH ELM continues in this Square:

* @ ~45 m bgs. From here we will work back to the north clearing the top of DUTCH Elm only where Elm no longer exists. In Sg 62 @ 50-60 m bgs there was some bajareques that has eroded and is falling apart. We collected what we could but it was very eroded (5N/047)

5N/048

Sg 63

50-50 m bgs

sheds, chert, obs.

There are many rocks at this level some of which are on end and are probably part of the feature to the north (REDWOOD) but it is hard to tell where it ends.

5N/049

Sg 30

on top of DUTCH Elm

40-50 m bgs.

-sheds, obs.

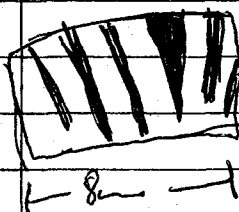

black on red rim shed

← 5N/0485N/053

Sg 52

40-50 m bgs

-sheds, obs, chert, baja.

5N/062

Sg 9

70-100 m bgs

looking for the ext. base of PINE

-sheds

5N/054

Sg 37

40-50 m bgs

-sheds

5N/046

Sg 44

50-70 m

sheds, metal pieces, rest of PINE

5E/050 Sg 12 below cottonwood some rocks on end between
60-70 - bgs - shnds COTTONWOOD & MAGNOLIA

5N/055 Sg 65 E of Sg 63 Sg 37
0-30 - bgs shnds, chnt, obs.

5N/056 Sg 66 50 x 1 m w 1/2 south edge of rocks on end ^{DO NOT} (COTTONWOOD)
0-40 - bgs
- shnds ~~obs~~ green obs.

5M/047 Sg 42 ~~obs~~ in front of ASPEN
30-50 shnds, obs.

5N/057 Sg 65 30-40 - bgs
- shnds, chnt, obs.

crude looking bifaces

10 APRIL 2000

* 5M/048 Sg ~~51~~ 50-20 - bgs in front of ASPEN
- shnds

* 5N/058 Sg 51 40 -

5N/059 Sg 65 40-60 - bgs

* 5N/060 Sg 51 60-70 - bgs

- shnds, obs. core - - - caudex

5M/049 Sg 60 shnds t.d. (50 x 1 m) Sg Sg 53 east of Sg 59
0-50 - bgs

5N/061 Sg 64 shnds t.d. / 1/2 Sg Sg 62 & 61 east of Sg 52

5N/062 2 haches, carbon and some shnds

found when clearing next to line PLUM

The haches were found at ^{45°} angle the larger one directly on top of the
other. @ ~ 36 - bgs 2127 m below the top of PLUM
in the NW corner of Sg 65

Small hacha

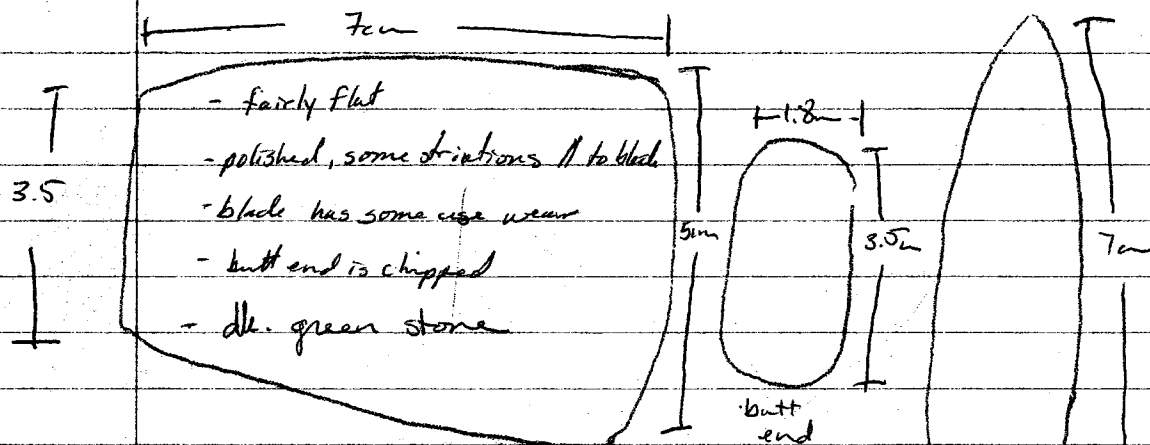

larger hacha

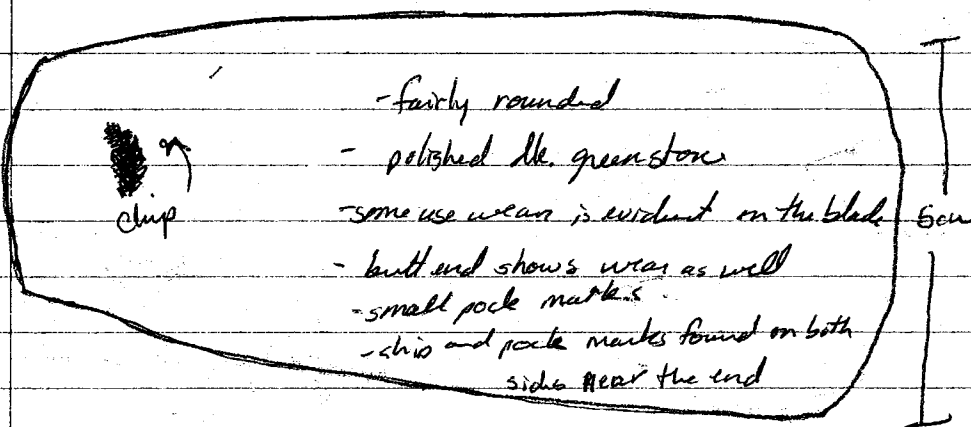
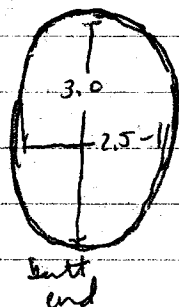
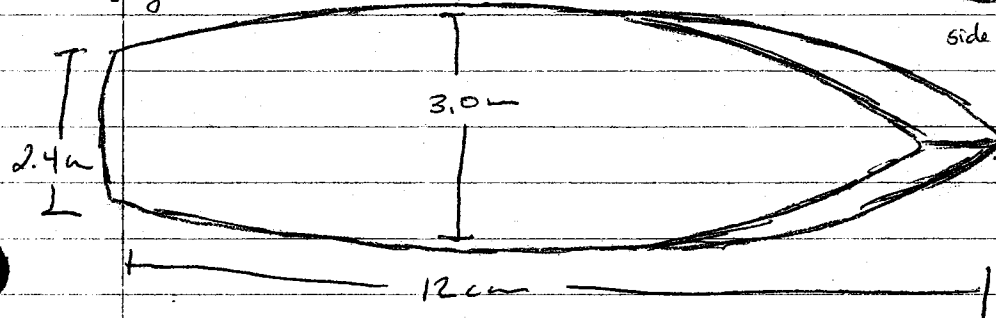

FINAL NOTES → JEMANA SANTA

ROGER'S STRUCT.

SN/063

BACKFILL

OKS.

| | Feature: | length | width | height orientation | orientation | Dist. Ft. | |
|----------|-------------|--------------------------|---------------------------|-----------------------|-------------|------------------------------|-----------------------------------|
| | | | | | | NE | SE |
| SUMMIT | OAK | lower upper 5.10/5.70 | .91-.85 | | 16 | 95 145 | 147 165 197 |
| | PIÑON | 3.55 | .30 | | 98 | ext. NW 144 100 115 25 | NE 148 76 |
| | PINE | 5.70 | .90 | .90 | 11 | ext. N 102 25 | S 118 170 |
| | ASPEN | mt. est. 2.90/3.33 | .68 | 1.15 | 105 | ext. W 118 mt. 143 | ext. E 177 137 142 |
| | BIRCH | 2.45 | .38 | .85 | 104 | NW 88 38 | mt. 144 96 144 |
| | BLACKCHERRY | 3.25 | 1.10 | | 104 | 88 97 | |
| | PALM | 2.70/3.00 | .70/1.40 | | 16 | SW 143 | SE 142 NW 147 NE 144 |
| | MULBERRY | 1.90/.90 | .70/1.30 | | 113/202 | 77 66 | 83 103 89 92 79 98 |
| | MAYLE | 1.10 | ? | | 300/216 | W 53 70 | NE 45 76 S 46 76 |
| | CRABAPPLE | .50 | .40 | | | | 102 150 |
| EASTSIDE | SUGAR MAYLE | .75 | .25 | | 16 | | 124 133 |
| | JACK PINE | .75 | .30 | | 289 | | 78 147 |
| | ELM | 3.15 | .25/.75 ^W /1.1 | | 9 | | NE 114 156 133 148 |
| | DUTCHELM | 5.30 | .57 | .25 | 15 | N 171 194 | S 206 226 |
| | NORWAY PINE | 1.50 | .40 | .60 | 292 | | 137 184 |
| | COTTONWOOD | 1.50/.80 | 1.08/.50 | .30 | 17 | SE 164 180 | NW 161 169 NE 161 192 |
| | SCOTCH PINE | .90 | .35 | .25 | 22 | | 164 171 |

| | | | | | | |
|------------|------------|------|-----|------|---------------|---------------------------|
| SPRUCE | 1.00 | .30 | | 20 | NE 107 132 | SE 103 140 |
| FICUS | 1.50 | .30 | .50 | 18 | N 119 157 | N 115 164 |
| SEQUOIA | 2.54 | 1.30 | | 194 | NE 182 | SE 206 SW 187 |
| MAHAGONY | 1.30 | .15 | | 14 | N 114 142 | 130 156 top 131 157 |
| DOGWOOD | .60 | .30 | | 20 | | 206 226 |
| IRONWOOD | .80 | .85 | | 284 | | |
| LAUREL | | .30 | | 18 | S 147 156 | N 125 145 |
| HAZELNUT | 1.40 | .40 | .20 | 274 | W 147 156 | E 146 157 |
| WALNUT | .80 | .20 | .30 | 84 | N 146 157 | S 143 173 |
| ALMOND | .90 | .20 | .40 | 286 | E 175 173 | W 143 175 |
| MAGNOLIA | 1.90 + .70 | .25 | | 19 | NE 175 221 | |
| PEACH | 1.40 | .20 | | 283 | | 230 |
| PLUM | 2.0 | .26 | | 288 | | 230 |
| FIR | .60 | .50 | | 19 | | 170 |
| WHITE PINE | .15 | .20 | | 292' | W 74 85 | E 72 89 |
| CEIBA | | | | | NW 110 146 | NE 150 180 |

PINE western summit wall trending N16E. The length is 5.70m and width is .90m. In the NW the bottom depth is 1.02m bd, but in the SW it is 1.07m bd. It has a total excavation height that varies but on average is .90m. It conjuncts with PINON in the north and ASPEN in the south. Construction appears to be constant with no breaks. Materials used are small-med. sized cobbles interlain with layers of cobbles average size of small pebbles 5x5x5cm, med sized 10x12x5cm and large 20x15x15cm. The first couple of layers are small pebbles and fill ~20cm. There is then a layer of med. rocks followed by small fill, followed by med rocks topped with large rocks.

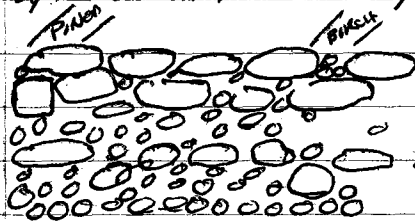

There may have been a layer of rock wrapped around the outside that would explain the thin area enclosing the northern room.

From the conjunction with PINON until the intersection with BIRCH at 1.25m from the NW corner is .30m, 1 course thick.

From the corner of BIRCH/PINE to the corner with ASPEN in the SW the thickness is ~.90m ~3 courses thick.

The addition to the wall is hard to distinguish from a plan view. It is well integrated. ASPEN and PINE are interconnected ^{and PINON & PINE} whereas BIRCH abuts PINE. At least part of PINE was built after

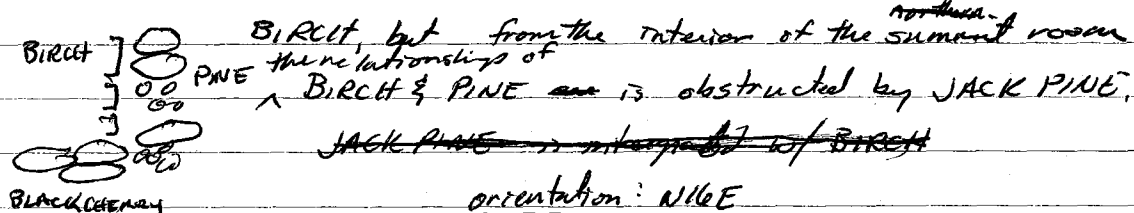

BIRCH, but from the interior of the ^{northern} room the relationships of

^ BIRCH & PINE are is obstructed by JACK PINE.

~~JACK PINE is interconnected w/ BIRCH~~

orientation: N16E

DATUM PTS.

| | | | | | |
|------------|----------|-------|-----|------------|------------|
| North ext. | 25 m bd | South | 118 | int. depth | N 147 bd |
| | 102 m bd | | 170 | " | S 143 m bd |

length: 5.70m(ext.) width: .90m height: .90m

PINON the northern summit wall trending ~~W 80°~~ 98° has an excavation height of ~.75m. Datum points as low as 402cm bsl in the NW and height of 25cm bsl in the NW and 76cm bsl in the NE. This wall seems to be a continuation or addition to PINE. There is no break in construction but it is thinner and possibly later constructed as a facade in front of PINE in order to connect and enclose the northern summit room. It is 3.55m long. At the NW corner where it intersects w/PINE it is 1 course thick, .25m. After 1.75m ~~to~~ from the western corner towards the east, the interior line is hard to distinguish as it blends into the cobble floor. It is here where MULBERRY is attached to the exterior of the wall. Another 1.75m to the intersection w/OAK, the eastern wall of the summit, but the wall seems to continue for another 1.0m after OAK. This may enclose a small terrace or room including SPRUCE and connecting to FIGUS which trends more or less N-S. construction is similar to PINE, but only 1 course thick.

orientation: 98°

Datum Pts. ext. NW 25 bsl NE?
100cm bsl 76cm bsl
l: 3.55m w: 30

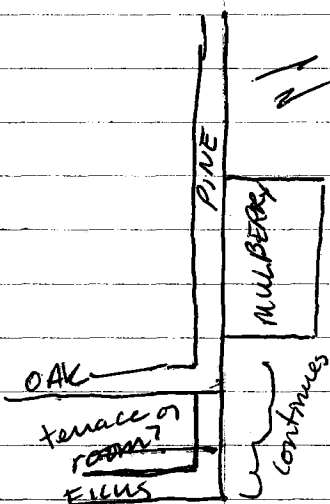

OAK is the eastern summit wall. It connects PINON in the north to ASPEN in the south trending 16° . Width ~~varies~~ varies from 91-85m due to slumping to the SE. The SE corner ASPEN/OAK is almost completely gone only the very base corner rock remains. At one point it was thought to be an inset corner. Excavated height also varies from .60-.80m. The SE corner has a height of 147m bd and a depth of 197m bd. The NE corner has a height of 95m bd and a depth of 145m bd.

On the NE end the definition of OAK gets confused. In profile you can see the corner, but from plan view it isn't so easy. BLACK CHERRY, the surface added to the north of the structure is at the same height as the top of OAK making it hard to see where one ends and another begins.

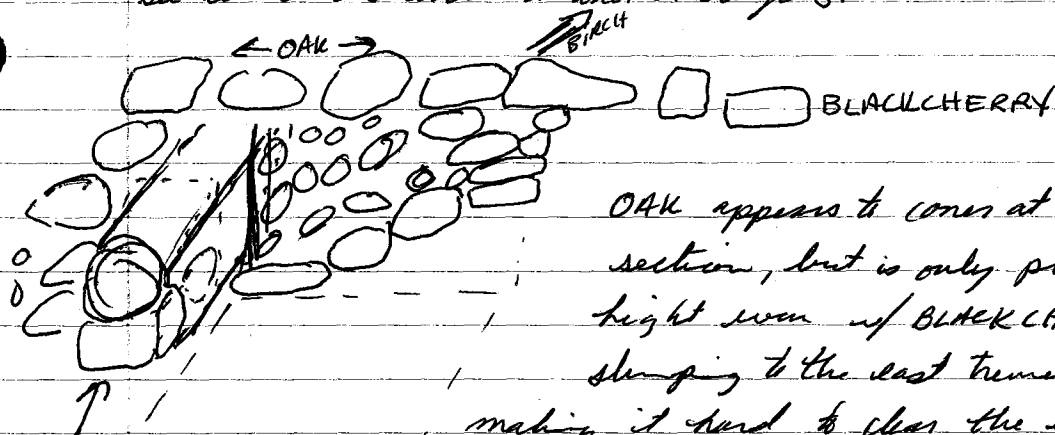

NORWAY PINE

OAK appears to corner at BIRCH in cross section, but is only preserved to a height even w/ BLACKCHERRY. OAK is slumping to the east tremendously (at least 45°) making it hard to clear the eastern ext. surface. The SE corner is marked by very lg. rocks (40x50x60)

@ a depth of 197m bd. This corner is not well preserved. The NE corner is at a depth of 145m bd but dips to 165m bd. It seems as though this may have been ground surface @ the time of construction.

Construction of this wall is different from the exterior surface of PINE and PINON. There are med-small cobbles intermixed and not "layered" as PINE is. The average rock size is 30x25x20cm with smaller chinking stones in between.

| | | | |
|------------------------|-------------|---------------|-------------|
| NE 95cm bd | SE 147cm bd | h: .50m | w: .91-.85m |
| 145cm bd | 197cm bd | i: int. 5.10m | |
| orientation 16° | | e: ext. 5.70 | |

ASPEN is the southern summit wall trending 105° . It has a thickness of .68m and a presumed height of 1.15m with a date height of 1.77m bed E and 1.8m bed in the W. Depths of 1.97m bed in the east and 2.00m bed in the west. It is 3 courses thick with a width of .68m.

The depth of the SW corner w/oak is not excavated. This wall consists of large river cobbles stacked on one another. There are not many chiling stones most are used to stabilize the base. Average rock size is $\sim 20 \times 30 \times 15$ cm. It has 3.33 ^{ext.} long height and 2.90m interior depth. Flat faces appear to the exterior and interior.

| | | | | | | | |
|------|------|---|-----|------|---------|--------------------------|----------|
| Date | ext. | W | E | Int. | 143 - W | l: 2.90m | w: .68m |
| | 118 | | 197 | | | 3.33m | h: 1.15m |
| | 200 | | 197 | | 142 - E | orientation: 105° | |

CRAB APPLE is a stack of rocks on the interior of the summit. It is .75m from the interior corner of PINE/ASPEN. It is .50m wide and .40m thick and ⁵⁰cm high. It is oriented 289° . Possibly built to stabilize PINE or ~~part~~ ^{possibly part} of fill from one of the late phases of construction. It appears to abutt the interior of PINE. It sits on top of the summit floor, PACK. Date ~~ext~~ 102cm bed l: .50m h: .48m
150cm bed w: .40m

PALM is the summit floor which encompasses area enclosed by PINE, ASPEN, OAK, and BIRCH. It is constructed of 2 layers of flat laid rocks averaging in size from $20 \times 15 \times 10$ cm - $10 \times 10 \times 5$ cm. They ~~were~~ are packed tightly with little fill between them. Some of the surface was removed during excavation. BIRCH appears to be built on top of this floor, but the other walls ~~are~~ look like they were built first. It is 3.00m x 1.40 and encompasses the entire summit room.

l: 3.0m h: ? 2 courses of rocks
w: 1.4m

| | | | | | |
|------|----------|----|-----------|----|-----------|
| Date | pts. top | SW | 143cm bed | SE | 142cm bed |
| | | NW | 147cm bed | NE | 144cm bed |

MULBERRY is a surface that was added to the NE end of the building. This feature is rectangular ^{for the most part, but} and abuts ^{is slightly} PINON. It is 1.90 x .70 m. It consists of irregular river cobbles set on and possibly added as an entrance feature. It steps in and out possibly due to excavation.

L: 1.90/90

W: .70/130

Dist. Pts.

| SE | NE | NW | SW |
|-----|----|----|----|
| 85 | 74 | 89 | 77 |
| 103 | 78 | 92 | 86 |

h: ~.20m

orientation: 113°/202°

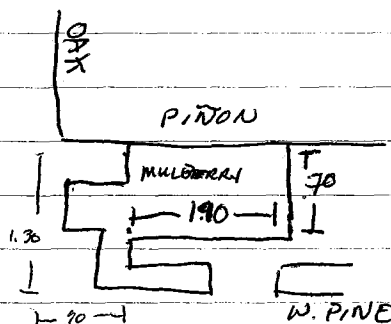

WHITE PINE is a line of 3 river cobbles trending 272° 65m long x .20m wide. It may continue further into one of the areas. It is 10m north & .05m west of the NW corner of MULBERRY.

EASTERN TERRACES

SPRUCE is a line of cobbles in front of OAK. It is 2 courses high and 1 course thick with a length of 1.1m, a height .45m and width of .30m. It may be a retaining wall for fill to the west of it in front of BL. CHERRY/OAK. It is oriented 20° and situated on top of 5m of deposition on top of FICUS with a depth of 132 Bd and height of 107 Bd.

L: .40m L: 1.00

W: .30

orientation: 20°

| Dist Pts. | NE | SE |
|-----------|-----|-----|
| 107 | 103 | 145 |
| 132 | | |

FICUS is a line of rocks with flat faces to the east. It is 1.50m long and .30m wide. PINON may have extended to corner with this line although depths may not match now. The slope of the hill at the time it was built may have varied from present dry surface. This line is slightly higher than NORTHERN PINE and SCOTCH PINE.

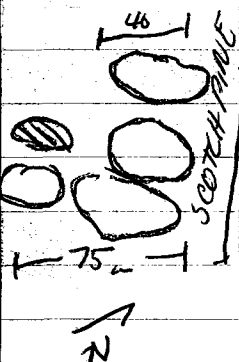
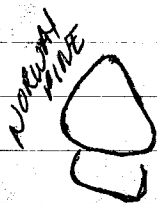

NORWAY PINE is a wall that abuts OAK. It has a base @ 184 cm bd and a presumed height of 137 cm bd. It starts at about 1m from the NE corner of the structure.

Construction is simple with med. sized river cobbles stacked on top of one another. It may be a continuation of SCOTCH PINE, but the gap may also have been a doorway into a surface room. It is 1.50m long and .40m wide and .60m high. Oriented 292°

90m

SCOTCH PINE is a line of rocks oriented 296° that may be a continuation of NORWAY PINE. The eastern most rocks sit on top of DUTCH ELM. It forms an L shape and may have been a retaining wall for fill or an external wall of a small room. Within this is there is a rock on and that is aligned with Mahogany. It is .35m wide, and .70m long. Single course laid next to one another average rock size $40 \times 30 \times 15$ cm Basal depth of 17 cm bd. and height of 164 cm bd.

SEQUOIA is a floor and fill feature 184 cm bd at its base. It may have been enclosed by OAK to the west SCOTCH & NORWAY PINE to the north and ELM to Dutch Elm to the east. The southern edge is not clear. It seems to correspond to ASPEN the same way. med. small river cobbles packed with coarse grained, and brown sandy clay. Fairly flat lying, but not quite possibly fill placed on top. It is 2.54m long & 1.30m wide oriented 174°

MAHAGONY is a line of med river cobbles oriented 14° . It is 1.30m long and .15m wide. Single course of vertical rocks aligned on top of 15 cm of deposition that is on top of Dutch Elm. It may be the back side of ELM

| | | | | |
|------------|-----|-----|-----|-----|
| Dist. Pts. | 114 | 130 | gap | 131 |
| | 142 | 156 | | 157 |

ELM is a terrace wall that expands 3.15 m at an orientation of 009°. It is preserved to a height of .50 m, 3 courses. It may have been 2 lines of rock with fill in between, but it is hard to tell. Mahogany may have been the backside of ELM or ELM is just a superficial wall. The wall slumps ~30° to the east. There is a small gap where the aerial trench cuts through it, but it is thought to continue south after that. It may be .25 m thick or .75 m of fill & MAHOGANY. Base at 156 $\frac{1}{2}$ ~~156~~ height @ 114 m. 6d

This feature is ~~eventually~~ ^{eventually} is ~~appearing~~ ^{appearing} on top of DUTCH ELM and ~15 m of fill or deposition leading one to believe to some time went by between these 2 phases of construction. It would appear that COTTONWOOD was built in front of ELM as it abuts it. DUTCH ELM is the lower terrace wall that is overlain with deposition and eventually ELM. It trends 015 for 5.30 m @ a width of .57 and a preserved height of .25 m. It is two - one course thick of large river cobbles (30 x 40 x 20 cm). Although REDWOOD is at a lower elevation, I think ^{DUTCH} ELM was in place first with REDWOOD filling in at a later date. If the SE there are shreds underneath this ^{base of this} wall. SE corner is @ 206 / 220 8d. NE @ 171 8d. 194. The shreds may be part of the fill that is part of REDWOOD.

COTTONWOOD is perched on top of 30 m of fill or deposition that overlies REDWOOD. COTTONWOOD is a floor and wall. The walls consist of large 20 x 30 x 15 river cobbles laid one to one courses high and wide. preserved height is approx. 30 m with width being ~30. It forms an L retaining the floor in front of ELM. COTTONWOOD contains the floor to the east and south. ELM on the west and HAZELWAT to the north. The It trends 019 N-S and 282 E-W. The floor is at a height of 166 60 and is constructed of mud - small river cobbles packed together. This may, at one time have filled further south as well, but was not maintained when excavating. Primary rock size 10 x 7 x 5. It is preserved to a width of 1.20 m. length approx. Flat faces out to the east & south.

DOGWOOD is an area of flat laid stones in front of DUTCH ELM. It is .60 x .30 in dimension with the base of 226 BD and the top at 206³⁰ Bd. It is oriented 020 and consists of big cobbles 20x20x10. It may be a step up of some sort. Flat faces out to the east.

REDWOOD ~~is~~ as a feature is hard to describe. It seems that it is a rock on and surface possibly filling in the space between 2 structures. The rocks encompass the area between MAGNOLIA and COTTONWOOD along with the area in between MAGNOLIA & DUTCH ELM. Although there are some rocks that are not vertical most of them are or very close to vertical. The dimensions are 50 x 1.30 - 1.60 x 1.52. It has a depth of 226 BD and a height of 201 Bd. Constructed of large stones 40x30x20.

IRONWOOD is an area south of MAGNOLIA that may or may not be a part of REDWOOD. This area is .80m x .85m in dimension. The rocks that make up this feature are fairly flat-lying separating this area from the rest of REDWOOD. It is, however, enclosed by rocks on east. Its base is at 226 Bd while the top is at 201 Bd. The rocks are med sized approx. 20x15x7.

SUBSTRUCTURE?

PLUM is a wall that trends 288° it is 1 course thick and only presumed to one course tall. Its width is .26 and height is 2.0m not including IRONWOOD. It was not completely excavated. Construction seems to be of med sized rocks 10x8x5 laid next to each other with no chinking. The top is at 225 Bd and base at 230 BD. Behind it there are many rocks laid

to form what could be a terrace floor between PILLAR and PEACH. Directly to the South of PILLAR where PILLAR meets ROANWOOD is where the 2 haches were found.

PEACH is another small wall trending 283. Constructed of one course thick and high med sized river cobbles averaging in size $15 \times 10 \times 5$ in. Flat faces are towards the south where there may be some sort of surface between there and PILLAR. It is 1.40 in long and .20 in wide with a base @ 230 Bd. It corners w/ MAGNOLIA in the west.

FIR

At the junction of PEACH and MAGNOLIA there is a built up area that at one time had a cut stone perched on top of it. The stone has since fallen off to the NE. This area of rocks is .60 x .50 in dimension and has a base of 170 Bd. and top of 165 in Bd.

MAGNOLIA is a wall that is oriented 019°. It is 3 courses high and only one thick. It has a base @ 221 Bd and reaches a height of 175 Bd. Constructed with med-large river cobbles most of which are oblong as is the case in PEACH, PILLAR, ~~ALMOND~~, HAZELNUT, WALNUT and CHERRY as well. $10 \times 20 \times 5$. There may be fill behind (to the east) of this wall, but it is unexcavated. WALNUT may be a continuation of this wall. It is 2.60 in long and 30 in wide.

There is a lower line that where the rocks are laid oblong in the direction of the wall. There is only one course of this and then the direction of the rocks changes to L to the direction of the wall.

note river
looking east

50000

ALMOND ^{is a wall that} trends 286° . It is $.90^+$ in length and $.20$ m in ~~width~~ ^{It} with a presumed height of $.40$ m. It ~~comes with~~ ^{MAGNOLIA in the west} ~~PEACH~~ ^{MAGNOLIA'S} abutts ~~at~~ ^{at} 2.60 m from ~~the~~ ^{corner with} ~~LAUREL~~ in the north ~~of~~ ^{Bed.} The wall extends into unexcavated ground to the east. It is one course thick, ~~and~~ ² courses high and built of med sized rocks. Almond's presumed height is with the base @ 133 Bed.

WALNUT is a wall oriented 024° . It corners with ALMOND in the SE at 175 Bed and continues into unexcavated ground after $.80$ m. It is $.20$ m thick and presumed to a height of $.30$ m. Constructed with med sized river cobbles laid next to and on top of each other. It may be a continuation of MAGNOLIA.

HAZELNUT is a wall trending 274° . It is constructed of lg. rocks with smaller inf. rocks to stabilize around the base. It is approx. $.40$ thick and 1.40 m long. It is one course tall and 2 courses thick one course of large rocks one course of small. It appears to abutt WALNUT/MAGNOLIA @ 157 Bed. and corners with LAUREL @ 156 Bed.

LAUREL is a wall that corners with Hazelnut @ 156 Bed and trends 018° for $.40$ & $.26$ into unexcavated ground. It is $.30$ wide one course thick one course tall. over rock size of $15 \times 8 \times 5$ similar construction to MAGNOLIA.

SUGAR MAPLE is an alignment of rocks. One course tall and 2 courses wide. It is .67m long + unexcavated and .40m wide. It trends 109° and is .40m ^{± .05m north} west of the corner of PINE/ASPEN. Its base is @ 133 Bd and top @ 124 Bd. From the table in the cross section it looks as if it may have been at least 3 courses high. Possibly struct. to the S.

CEIBA is a rectangular feature possibly ^{part of} another structure to the south. It is 1.10 x 2.0 in dimension trending 290° . It is on the south of ASPEN. This gap was filled with rock before it was cleared during excavation to define ASPEN. It has a base of 180 Bd and top of 150 Bd. The rocks vary in size from med. large.

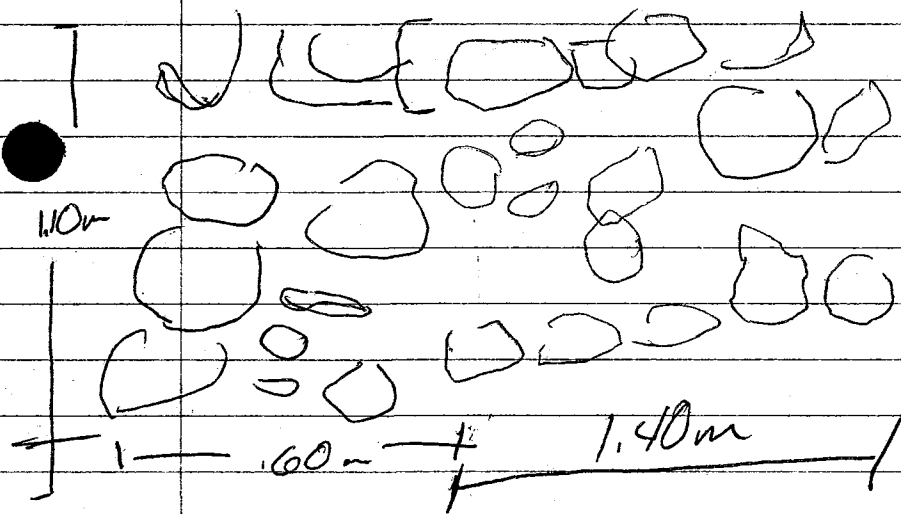

WHITE PINE is a line of 3 rocks trending 292° . .65m long x .20m wide may continue into unexcavated area (.10m north) of MULBERRY. .05 west

SE/041 0-20-695 int. IGUANA N end ~~70~~ 50
 SE/038 40-50 ext. TURTLE S of Sg 4 S, 0
~~032~~
 039 50-60 ext. TURTLE S of 4 S, c, 0 2 BAGS
 040 0-20 SW of Sg 5 / Sg Sg 6 S, 0
 042 20-30 Sg Sg 7
 043 30-40 int IGA. Sg Sg 7 S, 6
 044 0-20 int. IGA E end S. of 7 S
 045 20-30 int. IGA E end S. of 7 S, L, 0
 046 0-20 3ms of Sg #8 S, L, 0
 047 0-20 Sg #6 int. TURTLE S, c, 0
 048 20-30 " S, L, 0
 049 0-30 on top of TURTLE Sg #5 (x2m) S
 050 0-30 Sg #4 S
 051 0-30 ext. TURTLE N end S
 052 0-30 top of FIRE LIZARD E end N. of S, L, 8, 7 S
 053 0-30 top of ant, clearing S
 054 0-30 S end of ant S
 055 30-40 " S 3 BAGS
 056 40-50 " S 2 BAGS
 057 40-50 east of TURTLE / FIRE LIZARD corner S

✓ SE/022 top of IGA. clearing 50
 023 top of F. LIZARD W. end S
 024 E end of F. LIZARD E end S 3 BAGS
 north of Sg #8 7
 north of #5 & 6

SE/001 0-20 Sg 1 S. of 6A: Sg 1 following A S
 002 0-20 Sg 2 E end Sg 1 S, 0
 003 10-20 Sg 3 S
 004 0-20 Sg 5 S
 005 20-30 Sg 2 S, 0, c

AP

| | | | |
|-----|------|-------|------------|
| 006 | Sg 4 | 10-20 | S, C, O |
| 007 | Sg 5 | 20-30 | S, O, C |
| 008 | Sg 3 | 10-30 | SEC |
| 009 | Sg 6 | 0-20 | S, O, C |
| 010 | Sg 8 | 0-20 | S, b, C, O |
| 011 | Sg 6 | 20-70 | S |
| 012 | Sg 9 | 0-20 | S, C, O |

Roger's strat. 261

I'm not sure where he left off. I don't even have a current map of his excavations with SUBOP's and Sq. #'s. I'll start with 5E on the Summit.

5E/041 0-20 - bgs (east)
interior of IGUANA (north end)
→ table 1x1m directly adjacent to the south of Sq 7
-shards, obs.

5E/038 ext. of TURTLE ~40-50 - bgs
→ loose dirt: dirt was already excavated, but not sorted
-shards → candelero 2 full holes, 4 partial rough
7m height
6m diam.
-obs.

⇒ table

5E/039 ext. TURTLE 50-60 - bgs
-excavating to same level as sq 4 in axial trench
hopefully this will be the base of TURTLE
-obs., chert
-shards → candelero: 1 full hole; 3 partial ~6m tall
some etching around holes

(2 BABES)

5E/042 20-30 - bgs int. of IGUANA adj. to S of Sq 7
-shards

5E/040 directly SW adjacent to Sq. 5, in axial trench
0-20 - bgs - chert, shards, obs.

5E/043 30-40 int. of IGUANA adj. to the sq Sq 7
-shards, bajareque

5E/044 int. of IGUANA 2m to the S of Sq. 7
0-20 - bgs - shards

5E/045 int IGu. - S, C, O
20-30

5E/046 Sq 3m South of Sq #8 ~ axial
0-20 - C, S, O

ROGER'S STRUCT. #261

SUMMIT

- 5E/047 Sg Sg #6 0-20 - eggs int. TURTLE (north end of summit)
- S, C, O
- 5E/048 Sg Sg #6 20-30 - eggs
- S, C, O
- 5E/049 on top of TURTLE Sg Sg 5 1 x 2 m south of Sg 5
- sheds 0-30
- 5E/050 on top of TURTLE 3 and 4 m south of Sg #5
- sheds, obs. 0-30
- 5E/051 ext. of TURTLE north end
- sheds
- 5E/052 on top of FIRE LIZARD 2 m north of Sg 8, 7, 5, 6 m north
0-30 - eggs
- sheds
- 5E/053 Top of Summit clearing
- sheds

30 March

- 5E/022 on top of IGUANA clearing
- sheds, obs
- 5E/023 on top of FIRE LIZARD west end north of Sg # 8, 7, 5
- sheds
- 5E/024 on top of east end of FIRE LIZARD north of Sg # 6, 5
- sheds 3 BAGS
- 5E/054 South end of Summit W.
- sheds
0-30
- 5E/055 30-40 South end of summit 3 BAGS
- 5E/056 40-50 S end of summit 2 BAGS

AP. 20-29-54

ROGER'S structure #261

3 APRIL

Today on Roger's street. we will finish the unit and move some backfill so that we can follow the lower terrace walls or at least define them better.

I will draw a map to describe the new squares using a new SUBOP. 50° eastern terrace walls

50/001 ^{5A: Sq 1} Sq. 1 south of ~~ARMADILLO~~ following ARMADILLO south
0-20 - bgs. Sheds

50/057 front of TURTLE ~~ARMADILLO~~ FIRE LIZARD corner
~ 40-50 bgs.
- Sheds

50/002 Sq. 2 6 m south of ^{5A:} Sq. 4
6-20 bgs. - S. obs.

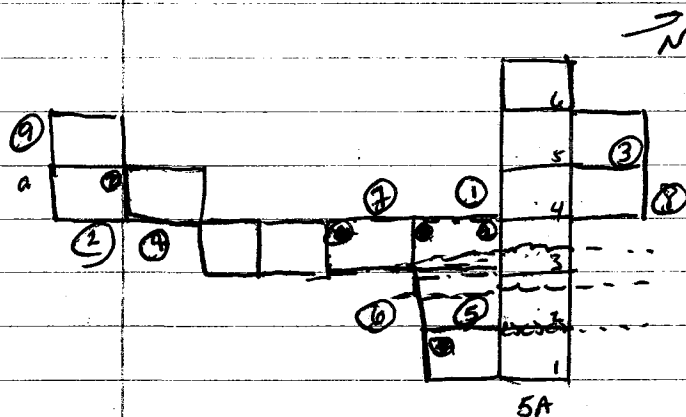

4 APRIL 2000

hot, humid

ROGERS

Following TURTLE to its corner. There are several rocks that look as if they continue to the next structure to the north. We will try and define this line. It will probably not be completely uncovered, but to get a better idea of the relation between this structure and the one next to it we'll look at it. Part of it has already ~~be~~ been uncovered. I don't know what Sq. or SUBOP it was excavated under. I'm going to use SUBOP 50 from now on for any part on the east or southern ends of his structure.

x 50/003 Sq. 3 ~ 10-20m logs.

x 50/004 Sq. 2.5 0-20m logs

following ARMADILLO

x 50/005 Sq. 2 20-30

corner of TURTLE/~~FIRE LIZARD~~
sheds, obs, chert

SUMMIT~~50/010~~

have defined

We are ~~still defining~~ the summit which appears to be fairly simple. There might have been an earthen filled bench on the western side. IGUANA's interior is defined and then there is another line of rocks that probably held the fill in.

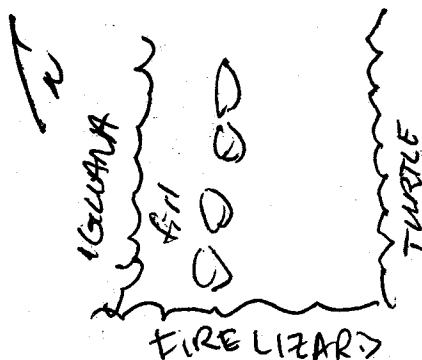

x 50/006 Sq. 4 ~ 10-20m logs
sheds, obs, chert

x 50/007 Sq. 2.5 20-30m logs
sheds, obs, chert

x 50/008 Sq. 3 20-30 s, o, chert

2

10

11

12

13

56

14

15

5E

003
005
TURTLE

16

AMARILLO

001

17

002

18

004

GECKO

19

006

20

007

21

008

22

009

23

010

24

011

25

012

26

013

27

014

28

015

29

016

30

017

31

018

32

019

33

020

34

021

35

022

36

023

37

024

38

025

39

026

40

027

41

028

42

029

43

030

44

031

45

032

46

033

47

034

48

035

49

036

50

037

51

038

52

039

53

040

54

041

55

042

56

043

57

044

58

045

59

046

60

047

61

048

62

049

63

050

64

051

65

052

66

053

67

054

68

055

69

056

70

057

71

058

72

059

73

060

74

061

75

062

76

063

77

064

78

065

79

066

80

067

81

068

82

069

83

070

84

071

85

072

86

073

87

074

88

075

89

076

90

077

91

078

92

079

93

080

94

081

95

082

96

083

97

084

98

085

99

086

100

087

101

088

102

089

103

090

104

091

105

092

106

093

107

094

108

095

109

096

110

097

111

098

112

099

113

100

101

102

103

104

105

106

107

108

109

110

111

112

113

114

115

116

117

118

119

120

121

122

123

124

125

126

127

128

129

130

131

132

133

134

135

136

137

138

139

140

141

142

143

144

145

146

147

148

149

150

151

152

153

154

155

156

157

158

159

160

161

162

163

164

165

166

167

168

169

170

171

172

173

174

175

176

177

178

179

180

181

182

183

184

185

186

187

188

189

190

191

192

193

194

195

196

197

198

199

200

201

202

203

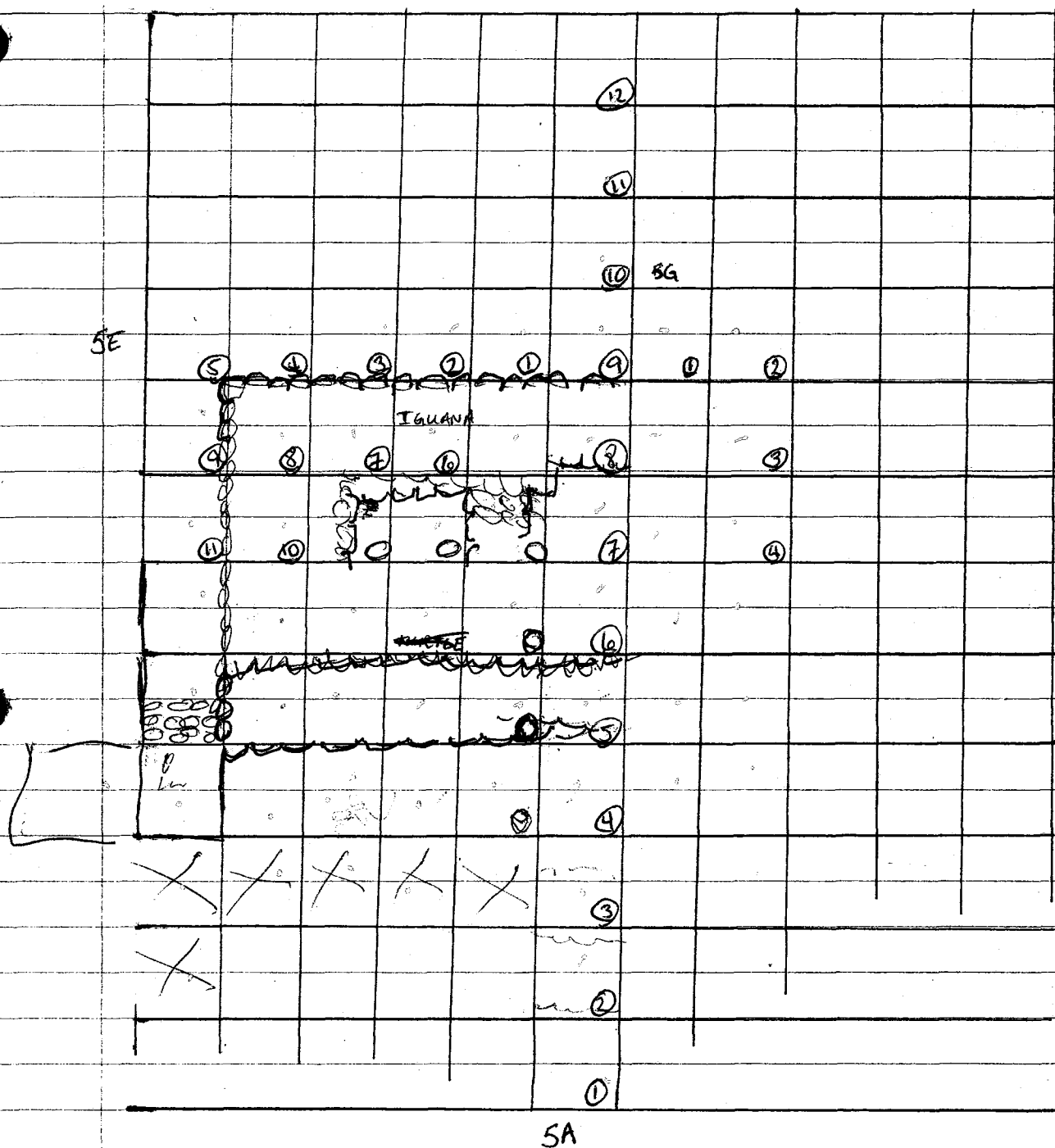

SE/041 0-20cm bgs directly adjacent to the south of Sq. 7 in aerial trench
east side of IGUANA, North end

SE/042 20-30cm bgs "

SE/043 30-40cm bgs "

Struct. 61

AP-00-29-59

Datum 32 m

FEATURE: DATUM PTS: LENGTH: WIDTH: ORIENTATION:
type/name Top/Bottom

Summit walls

| | | | | | |
|---------------|-------|----------------------|-------|-------------|------|
| IGUANA | SW NW | 82 68 4 65 | 6.30 | de0 1.30 | 029 |
| DRAGON | NW | 4 65 | 4.20 | .53m | 302° |
| | NE | 57 135 | | | |
| TURTLE | NE | 57 135 | 6.30m | 1.20m | 032° |
| | SE | 116 146 | | | |
| NEWT | | 33 45 int. SE 110 | .40 | .65 | 302° |
| FIRE LIZARD | W | 68 82 | 4.20 | .95 | 294 |
| EAST TERRACES | E | 116 146 | | | |

| | | | | | |
|-----------|--|----------------|---------------------|------|------|
| ARMADILLO | | 115 197 | 4.20 m ⁺ | .85m | 031° |
| GECKO | | 197 112 162 | 1.0 m ⁺ | .25m | 031° |
| TOAD | | 168 135 | .80 | 1.0 | 032° |
| PROG | | 120 132 | .80 | 1.20 | 032 |

Summit FEATURES

~~CRATER~~
~~bench ALLIGATOR~~
~~bench ALLIGATOR~~
~~floor~~
bench CAYMAN 92 88 2.20 .30 030°
diver wall snake 53 77 1.15 .30 026°
w. floor crocodile 50 75 1.10 1.40
E floor ALLIGATOR 166 83 1.20 1.10

Shard layer 40 55-66
Bayo layer 50 63
Bnd 112
65 NE 18
NW -8

SE
SW 40

The western summit wall is IGUANA. It has a length of 6.3m and width of .60m in the N and 1.30m in the S trending 029°. It is 2-5 courses thick and ~5 courses high. The base is ~~65~~ 65m Bld in the NW where it corners with DRAGON and a slight @ 4m Bld. In the SW where it corners with FIRE LIZARD the base is ~~68~~ 82 Bld and top at 68 Bld. It is constructed using ¹⁰river cobbles laid in courses with small rocks as stabilizers. The wall is only 2 courses thick but at approx 2.15m from the NW corner the interior of the wall juts out to the east .70m and continues at that thickness to the south. The average cobble size is 30x30x20cm. The presumed height is 75cm.

| | | | |
|-----------------|-------|----|----|
| h = .75m | Datum | T | B |
| l = 6.3m | NW | 4 | 65 |
| w = .60 - 1.30m | SW | 68 | 82 |

The eastern summit wall is TURTLE. It is oriented 032° with a length of 6.30m and width of 1.20m. It corners with DRAGON in the NE @ 57 Bld and 135 Bld. It corners with FIRE LIZARD in the SE @ 116 Bld and 146 Bld. It is constructed with med.-lg. river cobbles that are stacked 2 courses high and 4 courses wide. The average rock is 30x30x20cm and the presumed height of the wall is .45m. Flat faces out towards the east. The wall slumps in this direction as well. The interior corners are at a higher elevation ~~to~~ 66 Bld in the SE and 66 Bld/NE.

| | | | |
|--------|--------|-----|-----|
| h .30m | Datum | T | B |
| l 6.30 | NE | 57 | 135 |
| w 1.20 | ext | | |
| | SE int | 116 | 146 |
| | ext | | |

The northern wall of the summit is FIRE LIZARD oriented 394° . It commences with IGUANA @ 168 & 82 Bd in the SW and TURTLE @ 116 & 146 Bd in the SE. It is preserved to a height of .50m which is 2 courses tall. The width is approx. 3.4 courses and .95 m. Construction is stacked river cobbles $30 \times 40 \times 20$ with small stones used as stabilizers.

h .50

d 4.20

w .95

The northern wall of the summit is DRAGON which is oriented 302° . Its length is 4.20m with a width of .53m. The construction is similar to the other summit walls, ~~flat for~~ courses of fairly flat river cobbles ($30 \times 30 \times 20$) with flat faces to the exterior and the interior. The corner with TURTLE it is 57 & 135 Bd exterior and 66 Bd interior. The corner with IGUANA it is @ 4 & 165 Bd.

ARMADILLO is a terrace wall that trends 031° . It is approximately 5 courses thick and 1 course deep. It has a thickness of .85m and height of .80m. The construction is not well preserved but appears to be large river cobbles $40 \times 30 \times 30$ intermixed with medium sized $20 \times 25 \times 20$ river cobbles. The entire wall was not excavated so the total length is not known. It trends ~ 11 with the eastern summit wall TURTLE it runs at ~~least~~ ^{as far as} the NE corner of TURTLE in the north. The southern end is probably at least as far south as the ^{south} end of TURTLE, but not known. GECKO is a rather eastern terrace wall. It is as far as I can tell 1 course thick and 1 course deep sitting on small rocks & fill. The rocks are placed \perp to length of the wall on their sides. The wall trends 031° and again was not excavated fully. Excavated length

plan view
0000

side view

0000
-009

is 1.0m ^{with} preserved height of 80m and thickness of .25m

^{some after before} Crocodile is a summit feature. It is a floor ^{consisting} of lg rocks laid flat. The average rock size is $20 \times 20 \times 15$. They seem to be laid in ~~the~~ as the DRAGON. It may at one time have been one room on the northern end of the summit which was then divided by SNAKE on a added wall that splits the floor into 2 CROC & ALLIGATOR. The floor is 110 m wide \times 140 m in length.

The floor is enclosed by IGUANA to the west, DRAGON to the north, SNAKE divides it ⁱⁿ the east, (TURTLE being the eastern boundary of the site) and the feature CAYMAN to the south.

Some of this floor may have been taken out during excavation.

Alligator is ~~the~~ the continuation of Crocodile on the eastern side of SNAKE. It is constructed the same and its dimensions are 1.20m \times 1.10m. Dragon enclosing the north, TURTLE to the east. It seems to end with a line of ~~the~~ rocks, flat faces south. The floor is 2 courses thick deep.

SNAKE is a wall that is built on top of Crocodile/Alligator and trends 026° . It is 1.15 in length and .30m in width. It is approximately 1 course wide and one course tall, consisting of 4 rocks in length abutting DRAGON. Flat faces are west.

^{1 1/2 thick}
^{3 x 2} CAYMAN is a summit feature consisting of 2 walls ^{retaining} and some fill. It trends 030° and is 88m deep. It covers the SW 1/4 of the summit. There is a northern retaining wall that is .30m thick. It is 3 courses wide and 2 courses deep. The western retaining wall is IGUANA and FIRE LIZARD in the south.

CAYMAN is the 1 course thick & deep retaining wall in the east. ~~Between~~ ³⁰⁰ ~~enclosed~~ that is .30 m

m length and 1.30 m. wide. Enclosed by these walls ~~is~~ what appears to be the remnants of an earthen bench.

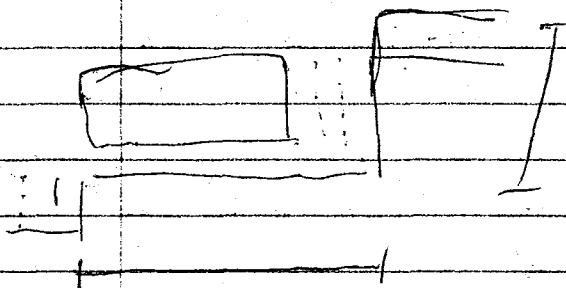

FROG is an addition or small connecting wall to the south. It is .80 m. wide, 1.20 m. thick, 4 courses. It trends 032° and extends from the corner of FIRE LIZARD and TURTLE.

TOAD is a small connecting wall to the north that extends .80 m. to at 032° from the NE corner of the structure. The corner where DRAGON & TURTLE connect. It is .80 m. wide / 1.20 m. in length.

NEWT is another small wall facing from the NW corner, DRAGON & IGUANA.

.40 m. x .65 m. and is oriented 302° . It is constructed of med. sized river cobbles stacked w/no fill or chinking stones only 2 courses wide and 1 course tall.

1 May 2000

Starting test pits in the west. The layer of shreds that we will be investigating is approx. 20cm thick. to the W of Struct 61 it begins at 10m bgs - 25m bgs. to the SW of Struct 261 it is ~5m - 25m bgs. The structure to the west of 261 also has the shred layer present @ ~5-25m bgs. Looking at the soil profile the shreds

The testing will start ~5m ~~W~~^{1.5m} west of Struct. 61. One transect E-W with a test pit every 10m. Approximately 4 pits E-W.

An intersecting transect will be set up N-S. Again 1x1m test pits every 10m until we reach the end of the area when we have a negative pit, we will move back 5m to start again until we find the approx. edge dimensions of the shred layer.

I don't want op #. Test pits will be #ed in the order from E to W and then S to N.

measurements
from NW corner

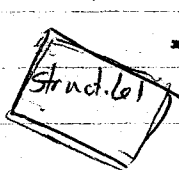
#3 ☐5 ☐#2 ☐4 ☐#1 ☐

| | | | | |
|----|-------------------|-------------|--------------|---|
| #3 | 20-30 s | 005 | 50-60 - 4.5 | 0 |
| | 30-40 s | 006 | draw profile | |
| | 40-50 s | 007 | | |
| #2 | 10-20 s | 003 | 30-40 | |
| | 20-30 s, 0 | 004 | | |
| #1 | 5m W of Struct 61 | | | |
| | 0-10 0.5 | 001 | | |
| | 10-20 0.5 | 002 | | |
| #4 | 0-10 | obs. shreds | 008 | |

Structure 61

Needs to be video taped & photos today.

We will follow Plan to the west a little more
BONES! not sure how many

SN/067

Sq. 67

50-60 60-70m Burial, shreds, etc

~~50-60~~~~60-70~~

10 May, 2000 (cont.)

F Sg J-2 10 m east N of J-1

x 0-20 Ø

x 20-30 shnds 51J/007

60-70 51J/006

x 30-40 S.O. 51J/002

30

x 40-50 S.O. 51J/003

70-80 51J/007

50-60 51J/004

80-90

JH Sg J-2 5 m N of J-1

0-20 ~ 1 shnd 51I/009

20-30 ~ Ø

30-40 S 51I/014

50 S 51I/013

S Sg J-1 5 m east of J-2

0-20 ~

20-30

30-40

51J/005

S.O.

x Sg I-1

70-80 51I/007 S.O.C

80-90 51I/008 S.O.C

90-100 51I/012 S.O.

NG

Sg I-3

50-60

51I/010

shnds, obs. core, chert

60-70

51I/011

shnds, obs. core, chert

70-80

cont.

11 May

hot, hazy, humid

F Sg J-2 70-80

51J/007

shnds

80-90

51J/008

NG

Sg

I-3 x 70-80

shnds, obs.

51I/015

x 80-90

shnds

51I/016

90-100

WS

Sg

K-1

60-70

51K/005

shnds

Sg

K-2

0-20

51K/006

shnds

20-30

51K/007

51K/010

Sg

I-2

60-70

51I/017

S

12 June

11 MAY 2000

Set up more test pits to the N & E. in transect I, J, K, ... L?

Hopefully, we'll get to most of them today. The sherd layer is deeper in the north than in the South by struct. 261 f'ly.

□ □

J4 S_g I-2 ~~60-70~~
70-80 S₁I/018 shreds
80-90 S₁I/020 shreds

X S_g F-3 90-100 S₁I/019 ~~large~~ sherd chert, obs.

S_g J-1 40-50 S₁J/009 sh. chert shards
50-60 S₁J/011

X S_g J-2 + 90-100 S₁J/010
S_g J-3 0-40 S₁J/011 10m N of J-2

S_g K-1 50-55 ~~50-60~~ K oof 60-
~~60-65~~ 65-70 R oof S₁K/002
55-60

S_g L-2 30-40 S₁L/008 S
40-50 S₁L/009 S, O 50-60

S_g L-3 0-20 S₁L/010 20-30 shd S₁L/011

11 MAY 2000

J-1 50-60 S1J/011 S1D
J-2 0-40 S1J/012 Ø
30-50 S1J/013 ~~Ø~~
X J-2 90-100 S1E/021 shreds, baja

K-1 60-65 S1K/012 shreds, obs. ~~Ø~~ large pieces many fit together
65-70 S1K/013 lg. shreds, rims, handles ~~Ø~~ almost whole
strap handle, but broken
can be refit, randed
ceramic head dress

K-2 50-60 S1K/014 shreds, obs.
50-60-70 S1K/017 shreds

K-3 X 20-30 S1K/011 shreds
30-50 S1K/015 S
50-60 S1K/018 obs. shreds

K-1 70-75 S1K/016 S

I have to assign lot #'s to empty lots

Possibly go deeper in F-3 stopped @ 60 with nothing, but F-1 had nothing until
50 and F-2 nothing until 40. F-4 have to look closer @ the profiles

12 MAY 2000

B/c of the fiesta tonight, some workers are elsewhere...
and the rest are leaving @ lunch

| | | | | | | | |
|---|---------------|--------------------|---------|---------|--------|---------------------|-------|
| X | <u>Sg J-1</u> | 100- 80 | S, ch | SIJ/014 | 90-100 | SIJ/018 | Ø |
| | | 80-90 | sheds | SIJ/015 | | | |
| X | <u>Sg K-1</u> | 75- 80 | S, O, C | SIK/019 | 90-100 | SIK/023 | sheds |
| | | 80-90 | S, O | K/022 | | BONES found in | |
| X | <u>Sg K-3</u> | 60-70 | S, CST | SIK/020 | | southern wall @ 100 | |
| | | 70-80 | S, O | SIK/021 | | | |

| | | | | |
|---------------|-----------|---------|----------------------|-------|
| <u>Sg J-3</u> | < 40-50cm | SIJ/013 | cont. from yesterday | sheds |
| | < 50-60 | SIJ/016 | sheds | |
| | 60-70 | SIJ/017 | Ø | |

| | | | | |
|---------------|-----------------|-------|---------|-------|
| <u>Sg K-4</u> | 5m north of K-1 | | | |
| | 0-10 Ø | 10-20 | SIK/024 | sheds |

| | | | | |
|---------------|-------------------|---|---------|--|
| <u>Sg L-1</u> | 5m east of Sg K-2 | | | |
| | 0-10 | Ø | SIK/001 | |

15 MAY, 2000 partly cloudy, breezy, wet

S Sg. K-4 0-10 \emptyset ~~10-20~~ 51K/004 2BAGS ~~shds, ovs~~ ~~lots of ovs~~
20-30 51K/005 5, 2 2BAGS

WS Sg. ~~K-4~~ L-1 5m east of Sg K-2

0-20 51L/001 \emptyset shds

20-30 1 shds 51L/002⁺ 3BAGS
1BAG

shds: conch, figuina head

tabe hands, ocarina decorated rim

Sg. J-4 10m north of Sg J-3

51J/018 { 0-30 \emptyset
30-40 \emptyset shds, chert, ovs.

~~40-60 shds~~

F Sg. L-2 5m N of L-1

x 0-20 \emptyset
x 20-30 51L/003⁺ shds, ovs \emptyset
x 30-40 shds, chert, ovs

51L/004⁺
40-50 shds, chert, ovs, bja 51L/007

JA Sg. L-3 10m N of L-2

x 0-50 \emptyset
x 50-60 shds 51L/006
60-70 shds 51L/008

EIP Sg. M-1 10m east of K-3

x 0-20 \emptyset 51M/006
x 20-30 shds, chert 51M/001
x 30-40 shds. 51M/002

WS Sg. L-1 30-40 51L/005 shds

40-50 51L/009

lithic - wh/red
skirtly chert

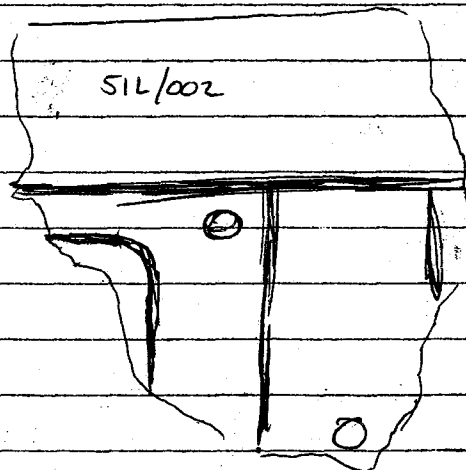
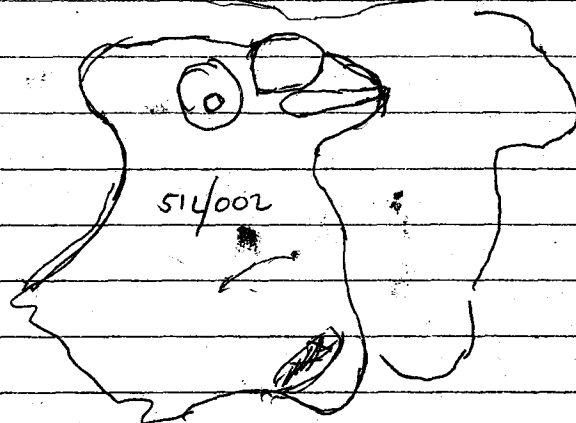
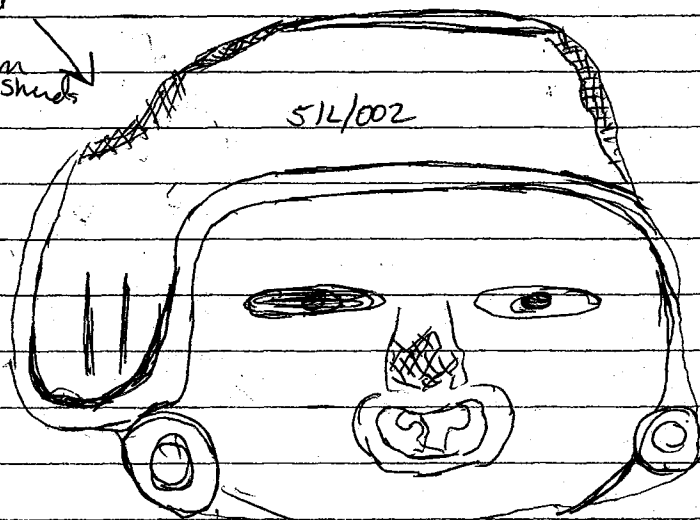
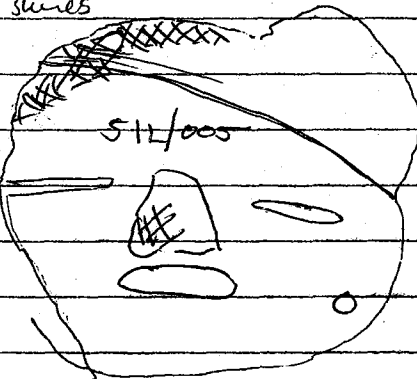

15 MAY 2000

cont

loads more & more like rain.

WS

Sg L-1

40-50 cont

SIL/009

sheds, i. thics

50-60 cm bags

SIL/011

60-70

SIL/014 sheds

E1E

Sg M-X

40-50 cm bags

SIM/003

50-60 cm bags

SIM/004 009

60-70

SIM/005

sheds, chrt

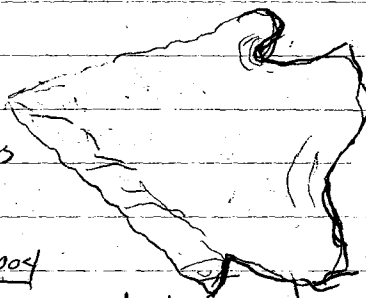

cream
2.5 x 5/4
small inclusions

Sg L-2

X 40-50 cont

SIL/007

sheds, chert, obs, brja

X 50-60

SIL/010

sheds

60-70

SIL/012

sheds, chrt

70-80

SIL/013

sheds

Sg J-4

40-60 - bags

SIL/019

sheds

60-70 - bags

SIL/020

S



SIL/020 incised sherd
broken but can
be refit at 2 cm x
11 cm

Sg K-4

30-40 - bags

SIL/021 S

SIL/025

→ BAGS

Sg L-3

20-30

SIL/011

JH

Sg F-4

10 m N of Sg F-3

6-20 - bags

20-30

