

2006

PVC-019-L. Schwartz-Field Notes-2006

Lauren Schwartz

Follow this and additional works at: <https://digital.kenyon.edu/honduras>

 Part of the Archaeological Anthropology Commons

Recommended Citation

Schwartz, Lauren, "PVC-019-L. Schwartz-Field Notes-2006" (2006). *Four Valleys Archive*. Paper 28243.
<https://digital.kenyon.edu/honduras/28243>

This Field Notes is brought to you for free and open access by the Anthropology at Digital Kenyon: Research, Scholarship, and Creative Exchange. It has been accepted for inclusion in Four Valleys Archive by an authorized administrator of Digital Kenyon: Research, Scholarship, and Creative Exchange. For more information, please contact noltj@kenyon.edu.

PVN 647*

Tuesday, 11 July 2006

[Combination of PVN 642-646 (+ others) from 2005]

↑pm on
on. 10 July '06

Beginning test pits in the morning.

① Structure 3

(summit)

647A/001 will be on northern facing of str. 1

@ an $\angle = 285^\circ$

② structure 17

647B/001 will be on southern facing of str. 17

@ an $\angle = 351^\circ$

③ structure 6

647B/001 will be on SW facing of str. 6

@ an $\angle = 21^\circ$

The goal of these test pits will be to understand the degree of architectural preservation AND to establish chronology of the site (or exposed areas) from artifacts recovered.

A deeper probe into str. 1 will (hopefully) reveal any earlier evidence of occupation by means of layers of architecture.

Test pits around/on other structures will reveal the preservation of architecture and associated artifacts. As a whole, these preliminary excavations will provide a foundation for future excavations.

L.E. Schwartz

2006-19-2

PVN 647

Tuesday, 11 July 2006

Starting to set up test pits ...

Structure #6 orientation

$\angle = 21^\circ$ N/S

E/W wall is 114°

Subop # B

unit 1 levels

NE - ~~54~~ ~~54~~ 54

SE - ~~61~~ 61

NW 59.5

SW - 63

C 61

datum

B

Structure # 3

$\angle = 285^\circ$ N

Subop C

unit 1 levels below datum C

NE = 70

SE = 57

NW = 66

SW = 56

C = 65

Structure #17

$\angle = 351^\circ$ N

Subop D

unit 1

levels below datum D

NE = ~~71~~ ~~65~~ 65 cm

SE = 68 cm

NW = ~~68~~ 64 cm

SW = 71 cm

C = 70 cm

Manuel y
Narciso

10:12am

FINALLY, everybody is set up.

There was a lot of rain last night + everything is very wet. But the sun is out now + it's getting a little hot.

Jorge helped me set up 1x2 m units on str's 6 + 17 + what I think is the NW facing of str. 5.

But I think Ed meant for me to put it in the middle of str. 1, 5 + 3... but from his sketch map, I honestly can't see the difference.

PVN 647

Tues., 11 July 2006

Subop B = str. 6

647B/001 is 0-10 bgs. ^{+ is 1x1m} the starting levels are in unit ~~1~~

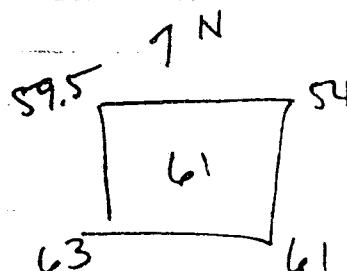
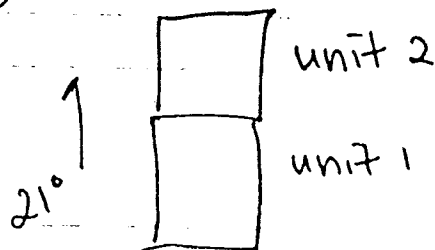
Subop C = str. ~~2~~ 3

647C/001 is in unit 1 + is 0-10 bgs beginning elevations

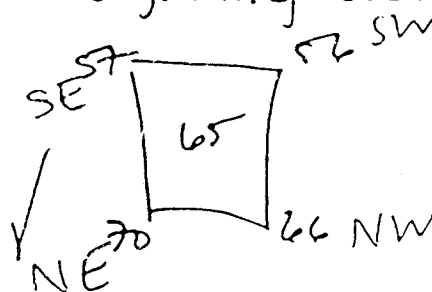
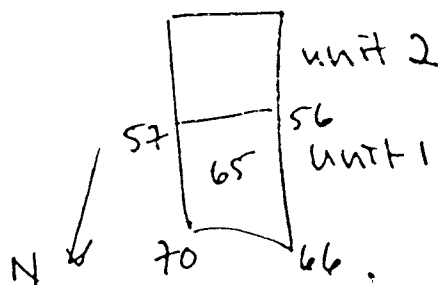

Subop D = str. 17

647D/001 is in unit 1 + is 0-10 bgs beginning elevations

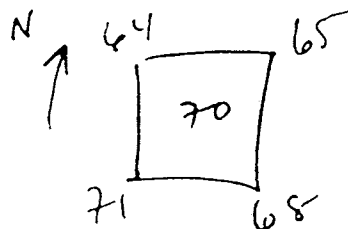
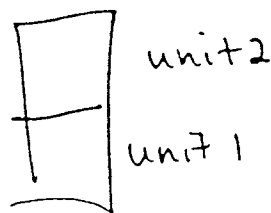

PVN 647

Tues., 11 July 2006

Subop C is done str. 3

1x1m ^{triestos}
 647C/001 = 0-10cm bgs has ceramics + lithics
 And a few river cobbles as tumble. But they're
 staying in there. Soil is thick + dark + there
 is a lot more to go in this 1x1m.

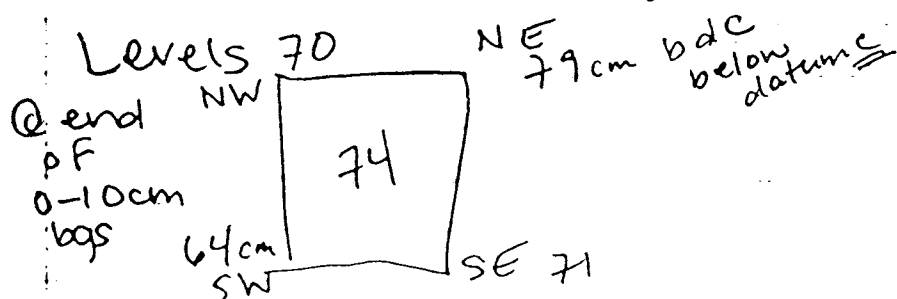

10:37am 647C/002 in unit 1 10-20cm has begun

Subop B is done

647B/001 @ Str. 6 to the SE group.

10:50am

only sherds = 35 ceramics + one appears to be
 a possible rim of a potstand (?)

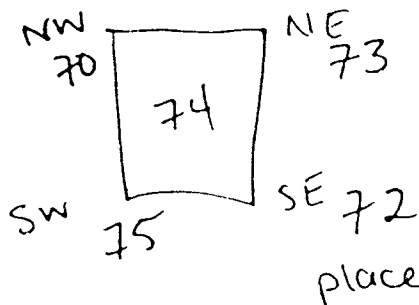

The soil, again, is thick, dark, +
 moist... then again it's been raining.
 There are a medium amount of rocks...
 Some we took out + others left in
 place.

647B/002 in unit 1 is 10-20 bgs has begun
 by cleaning up around the tumble cobbles.

PVN 647

Tues., 11 July 2006

11:04 am

Subop D is done

647D/001 0-10cm has 81 sherds

- 5 lithics (obsidian)

Levels below datum D

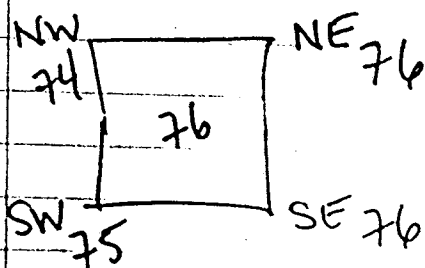

There are a variety of cobbles present after /001. We removed some of the smaller ones, but left the bgs ones in to clean more around them. Nothing is very well defined yet.

647D/002 10-20cm bgs has begun; mainly around the S + SE portions of the unit.

Subop C

Str. 3 ✓

647C/002 is done

Levels

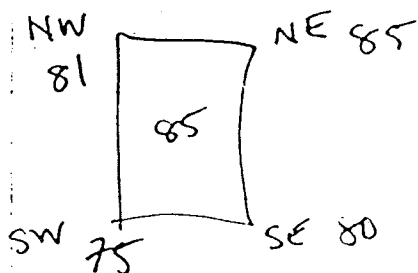

There are 3 large rocks in the middle of the unit, but for the time being, I'm keeping them there. There were the same # of ceramics. None that look too different from the other side of the river.

647C/003 in unit 20-30cm bgs has begun around the large cobbles. The soil appears to be getting harder, but there are still a lot of artifacts coming out.

PVN 647

Tues., 11 July 2006

:46am

Subop B

647B/002 10-20cm in unit 1 is moving along quite well. Jorge y _____ left the rocks in place + it's easy to see now. Hard to tell if it's all tumble or part of some kind of line... but we'll see.

A lot of sherds have come from this lot. Some a little painted. 1 or 2 are from a censer... + in general they are large pieces. Jorge y _____ seem to work well together. I like their pace. Salvador y Marvin work very fast... too fast that I don't know what to do w/ them.

11:54am

647B/002 - almost done - 2 large roots in the unit... Jorge
 sherds = 201 they are from a ceiba tree
 lithic = 3 about 80-100m near the quebrada.
 bajareque = 2 They're about 12 cm thick... don't think we're moving them.

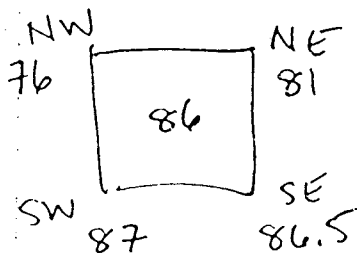

@ end of 002 from datum B

The NW + N areas have a lot of tumble + they can't go down very deep b/c of the fallen cobbles.

2:07pm

We took levels + will remove some cobbles after lunch. They will begin
 647B/003 - 20-30cm bgs in unit 1

subop C → Salvador y Marvin are working w/in 647C/003 20-30cm around the 3 large cobbles.

Salvador just found 2 sherds that have been incised; 1 only has a line + the other has some sort of pattern

1pm

Subop C

647C/003 is done

- sherds and a good amount of chert flakes.

RVN647 Peña Island

Tues., 11 July 2006

:06pm

647C/003 ending levels

subop C

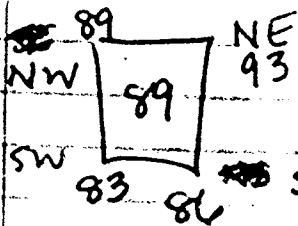

We took levels + then removed the 3 large cobbles. Now, they're cleaning up the soil from around the cobbles b/c it's apart of the same lot. When the soil is removed then it will be a new lot.

subop D

647D/002 - ~~20-30cm~~ 10-20cm

:23pm

They (Manuel y Don Narciso) cleaned very well around the smaller rocks... they were all floating around 7-8cm bgs. They're removing them + keeping it all part of the same level (lot) 002 10-20cm.

:31pm

subop C

647C/003 is complete → sherds (1/2 bag of 6x10) + lithics (obsidian + chert)

647C/004 30-40cm is beginning. Since the 3 large cobbles were removed, there is absolutely nothing in the unit... as far as cobbles

But beginning 004, Salvador has found some bone. It's a little weird, but I'm pretty sure it's bone. He's being careful so he doesn't break anymore of it. But I think he hates dealing w/ bones of any sort just like I do.

Bone is in SW corner area of unit... some was burnt but not all of it.

2:12pm

subop B

647B/003 - 20-30cm in unit 1 is still continuing... a lot of slumping cobbles from off of the structures. We removed a lot of them + continuing to excavate around the tumble. Jorge found a lot of circular perlite pieces.

PVN 647

Tues., 11 July 2006

B

647B/003 - 20-30cm bgs

- a lot of sherds 2 bags of 7x14 + lithics tumble

- levels will be taken tomorrow AM

C

647C/004 - 30-40 cm bgs

- sherds, lithics a lot of obsidian, + bone

- levels will be taken tomorrow AM

D

647D/002 - 10-20cm bgs

- 3 bags of sherds (7x14) y lithics tumble

- all small to medium sized cobbles were removed. They ~~are~~ were all at the same level and appear as if they could have been a surface if it was level + the soil underneath wasn't as soft or had more sherds, etc both below + in b/w the cobbles.

- levels will be taken tomorrow AM.

PVN 647

Wed., 12 July 2006

Tues. 11 Jul.

8:45pm

Tomorrow morning Ed is coming out to the site to visit + look at what went on today. I think he is not going to like the excavations on str. 5 + the orientation of str. 6 excavations. They are aligned according to a summit line (or a potential one) but Ed may say the Δ is off.

But tomorrow the levels of each excavation needs to happen before more excavations can happen.

8:13am

subop C 647C/004 30-40 cm done

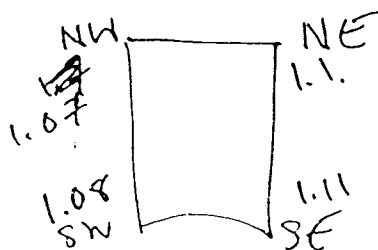

unit 1
lot 004

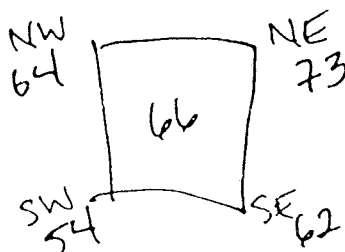

unit 2
lot 005 - 0-10cm

647C/005 in unit 2 is 0-10cm

Ed said to begin moving in on the architecture.

Subop D

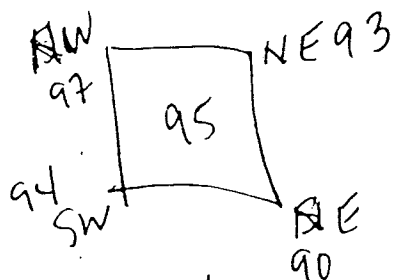

unit 1

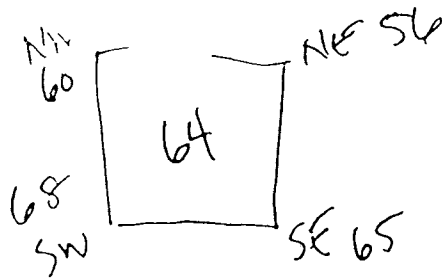

unit 2

PVN 647

Wed., 12 July 2006

Subop B

647B/003 in unit 1 20-30cm is done
beginning 004 0-10cm in unit 2.

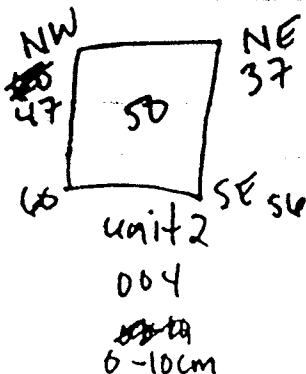
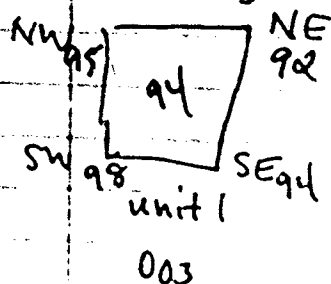

Subop C

647C/005 0-10cm is done! I just walked back + they're
done! levels after 005 0-10cm bgs

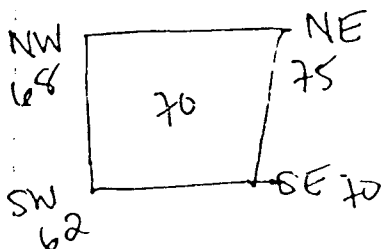

647C/006 in unit 2 is beginning + it's 10-30cm a 20cm lot!

8:48am

Okay! A lot of excavations have already happened!

Subop C has already completed 647C/005 0-10cm bgs in unit 2. There were NO cobbles or rocks, but sherds + lithics... both chert + obsidian.

Since Salvador y Melvin move so fast!! They are beginning lot 006 which is 10-30cm (a 20cm lot). There doesn't appear that there will be that much.

Perhaps tumble in about 8cm into the lot. But we're still about another meter away from a potential wall.

Ed came out w/ me this morning + said this is actually the W side of Str. 3!! So, all previous references need to be changed.

PVN 647

Wed., 12 July 2006

8:56am

subop

C

005 =
T.D.

So continuing... Ed said that the excavations of str. 3 need to locate a wall + then move up top to the middle of str's, 1, 2, + 3 to see if the mound is natural or constructed for all 5 of these structures to be up here.

subop D

647D/002 10-20cm was measured this morning + 003 0-10cm in unit 2 was begun.

We just cleaned out more tumble of cobbles + they're continuing down to a more substantial 10 cm bgs.

subop B

647B/003 ~~20~~ 20-30cm in unit 1 was completed yesterday + levels were taken this morning.

Lot 004 in unit 2 was begun to move closer to the wall. A lot of tumble is present, so we know we're getting closer. So far, mainly sherds have been found.

But Jorge also just found a very large + dense piece of bajareque.

subop C

647C/004 10-30cm is done levels in unit 2 after 006

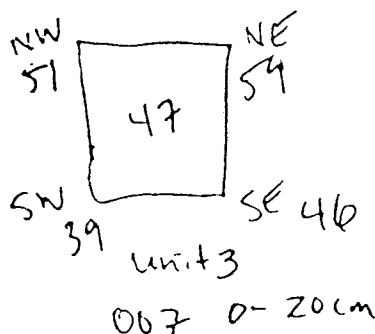
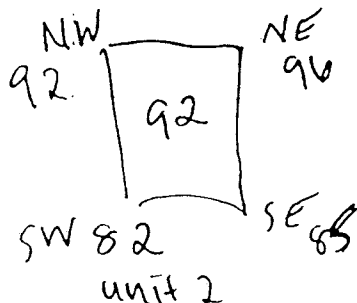

Wed., 12 July 2006

Found potstand frag!

subop D 647D/003 in unit 2 0-10cm

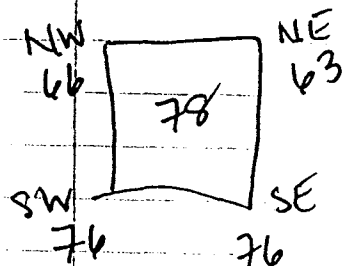

A lot of tumble of smaller sized cobbles everywhere.

Began 004 10-20cm, but probably not quite 20cm, which will take us to the bottom of all the tumble... just above the level of the tumble.

subop B 647B/004 levels @ bottom of

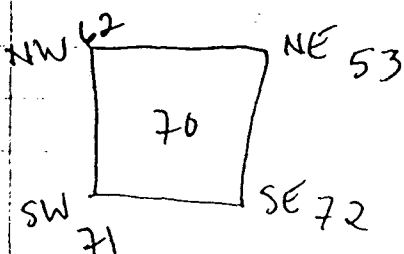

Keeping it all one lot to keep it separate from what's below.

647B/004 is complete. Shards + a large piece of bj.

647B/005 10-20cm in unit 2

has begun by clearing away all of the tumble.

The dogs keep laying in the excavations + sometimes pawing @ the soil. Tigre + ~~the~~ especially the brown one is always inside a unit. Jorge + Reynaldo just work around them.

10:37am

Well, everybody took a little bit longer of a break, except for Jorge y Reynaldo. Jorge seems to just want to work + get things over w/.

subop D

647D/004 10 → 15-20cm has just started + @ first they were throwing all of the shards into the same pile! They almost ruined the lot that has the potstand! But it's worked out + they're removing the loose cobbles + only excavating down to the level just under the tumble cobbles. Deeper below that, the soil is thicker, darker + brown. More clay-like.

PVN647

Wed., 12 July 2006

subop B

647B/005

10-20 cm levels

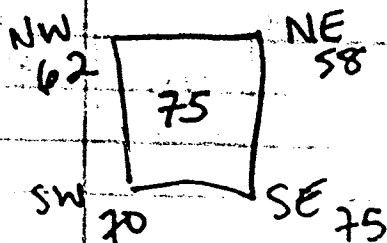

on top of
rocks -> possible wall!!

005 = sherds, 3 lithics.

In the southern half there are a lot of cobbles on both sides. (E + W). But a wall is possibly sticking out in the Northern half of the unit... it is pretty perpendicular to the walls of the excavations. If it is a wall, then we'll be done w/ these excavations.

647B/006 20-30 cm in unit 2 has started to go down in front of possible wall to clarify better.

subop C

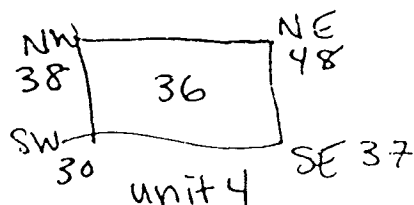

647C/007 0-20 cm is done + on the 'southern' side there appear to be 3 rocks semi-aligned + it's possible that it's a wall. But it sucks b/c it's right along the division b/w unit 3 + unit 4.

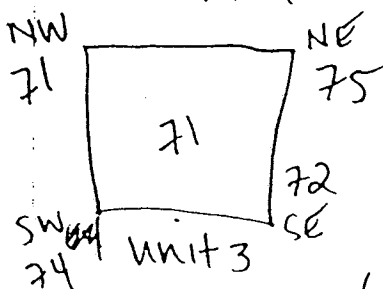

Unit 4 is only 100 x 50 cm b/c I believe it is on top of the wall.

647C/008 in Unit 4 is 0-10 cm bgs on top of the cobbles that may be a part of the sliding wall.

2006-19-14

Wed., 12 July 2006

PVN 647

647C/008

- 0-10cm in unit 4 (100 cm x 50 cm)

subop C

NW

43

1:10pm

39

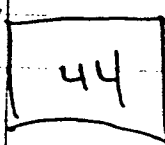

NE 43

SE

43

end levels in unit 4
after 008

Now, 009 has started 10-20cm in NE corner.

Subop D

1:21pm

647D/004 is now 10-30cm b/c it's all tumble +
can be grouped together.

1:26pm

subop B

NW

32

NE

86

31

93

86

SW

95

unit 2

SE

94

006 20-30cm

647B/006 20-30cm is complete.

← These are the levels @ the end
of 006.

Now, 647B/007 30-50cm in the
area of unit 2 in front of the wall.
We found it! We now need to see how
deep it goes.

Ed also mentioned to set up a 100 x 50cm unit
N of unit 2 on top of the wall to see if we can
pick up the other line that appears to be
on the surface.

647C/010 is 20-30cm in unit 3 in front wall.

The soil is getting very hard + dense again in lot 010
as it was in the previous lots of 003 + 006.

Sherds, lithics + bajareque

1:49pm

subop C

subop D

647D/004 10-30cm is going well. They have made it level
down to the other unit... even though the other unit is
only to 20cm. But b/c of differences in surface
elevations, unit 2 had more to excavate down to, b/c
the surface level is more on a slope leading up to the
structure.

PVN 647

Wed., 12 July 2006

Subop D 647D/004 10-30cm in unit 2 is complete

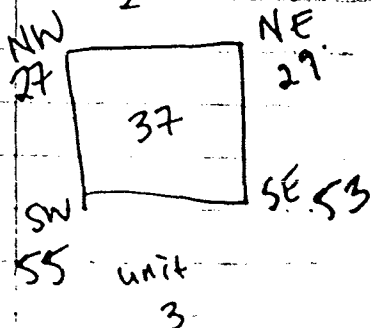
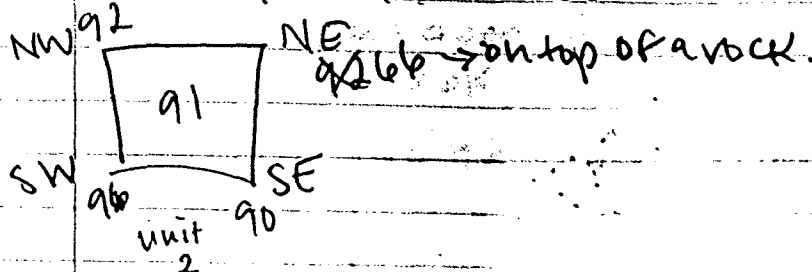
Unit 3 level @ ground surface.
Start excavating tomorrowSubop B 647B/007 → a burnt earth floor in the Eastern Corner.
Wall goes no deeper

NEED LEVELS TOMORROW

Lithics need a tag

Subop C 647C/010 is done
NEED LEVELS TOMORROW
→ sherds y lithics

8:18pm Subop D - Manuel y Don N. can begin in unit 3 0-10cm around the cobbles. Unit 3 is N of unit 2 + is 1x1m.

Hopefully, the wall is w/in this unit.

Subop C - Tomorrow need to draw / record the cobble + the remove it from the floating soil to see if wall is behind it.

Subop B - measure out unit 3 → a 1m x 50 cm unit N of unit 2 to view other wall. Record more of earthen floor.

PVN 647

~~Wed~~, Thurs., 13 July 2006

The clouds appear to be clearing + my back hurts.
 Subop B looks good from yesterday.

Subop B

Levels @ end of

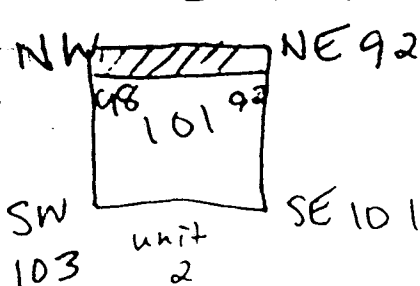
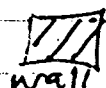

on top of preserved surface. wall is in the corner + didn't measure from on top of the wall but a little in from the wall.

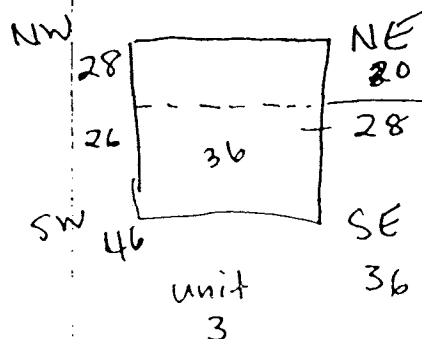

→ another line near summit

We just set up unit 3 + it's 1m N of unit 2. Ed wanted us to define a different line on top of the wall that we already have.

647B/008 0-10cm in unit 3. has begun.

Subop D

Since we measured yesterday, Manuel y D. N. started 647D/005 0-10 in unit 3, which is 1 unit N of unit 2. It's a 1x1m.

A cow crapped in the SW corner of unit 1 ... I think as it was leaping over.

Subop C

I photographed + noted the 3rd cobble in a line that appears level in front of the possible wall. Then we removed it + are slowly creeping in to find the wall. It's a little complicated + I want to rip it all out, but Ed said to leave it in.

8:42am

We just removed another another large cobble to look for the wall. 647C/011 10-30 clearing under tumble in middle of unit.

2006-19-17

PVN 647

Thurs., 13 July 2006

Subop D

647D/005

0-10 is complete & the wall occupies to top 12 cm of the unit to the N. We removed some tumble & are trying to define it further.

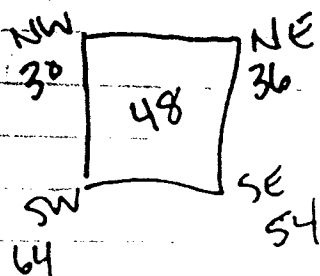

only lithics

647D/006 10-30 cm is beginning & all in tumble.

Subop B

9:12am

647B/008 in unit 3 turned into 0-20cm, but it is all right. In the Western half of the str. they have clearly defined. They are working on the Eastern side, but I told them to be careful b/c there might be something ~~else~~ else. Ed thought that the Western half may have caught the edge of a doorway & on the East there is more construction. The Eastern side of the excavations in front of the basal wall is where the burnt earth surface is.

★ The theme that I'm going to use is colors... very unoriginal... I used it in 2002. Anyway, Ed would like me to name my walls so that it's easier to locate them again in the future. (hopefully next year)

→ The wall is only ~ 2 courses high & does contain some medium-sized chinking stones.

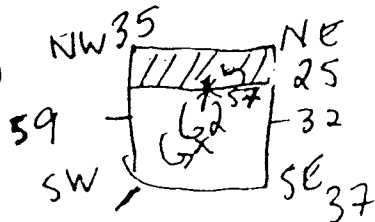

62 on top of wall

ending levels for 647B/008 10-30 ish cm
it varies b/c in the middle of wall & lines

L.E. Schwartz

2006-19-18

PVN647

Thurs., 13 July 2006

9:45am

647C/Ø11 10-30 is complete + there is NOTHING!

Subop C

This is getting a little frustrating + Salvador is getting pissy too! I hate that.

10:48am

Levels @ end of Ø11 10-30cm

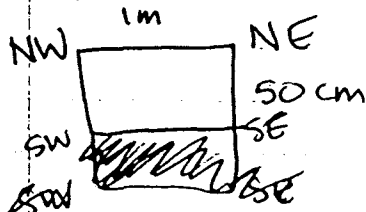

Levels @ beginning of Ø12 0-10cm in unit 5. Unit 5 is 1m x 50cm E of unit 4. HOPEFULLY, this will catch the wall. I'm going to be so mad if we need to do more. Especially b/c Salvador is being an ass about the whole thing!

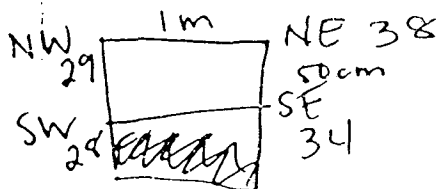

Subop C

After

647C/Ø12 0-10cm finished → a lot of large pieces of ceramics w/ vixins. → from large vessels/vases.

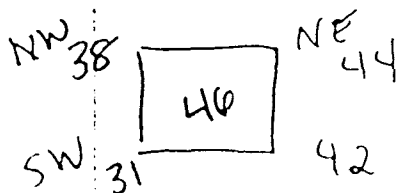

647C/Ø13 10-30cm in front of hopefully a wall is what's going on now.

PVN 647

~~Thurs.~~ Thurs., 13 July 2006

subop E

A new subop is being opened up Subop E.
It is located on the same axis as subop C
But it's beginning 3 meters to the East... in
the middle of Str. 3, 2, + 1.

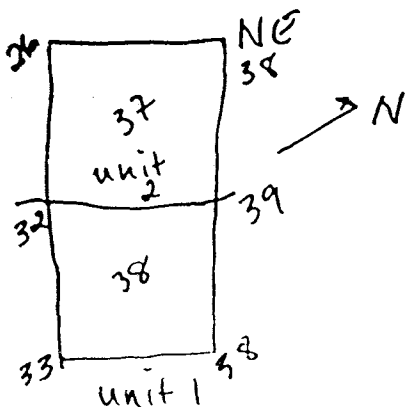

647E/001 is 0-10 cm in unit 1 → these excavations
will reveal more info about this rise where Str. 1, 2, + 3
are located.

subop D

647D/006 10-30 cm

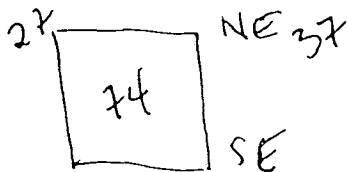

They exposed more of the wall +
there is still a lot of tumble in
front of it.

007 30-50 cm is about to begin
to reveal more of the wall. Hopefully we'll
find the base soon. There is a lot of tumble
w/ a lot of cobbles of various sizes.

subop C

647C/013 10-30 in unit 5 is complete! There's
nothing!! And of course the most frustrating subop
has to have Salvador.

A new unit unit has been opened.

647C/014 0-10 cm in unit 6 is beginning.

PVN647

Thurs., 13 July 2006

12:22pm

It's lunch + all the guys are eating close to Manuel y Don. N + Subop. D.

I need to ~~be~~ take photos of subop B + the wall. I need to name it + the wall in subop D.

subop C → Is driving me nuts! I think I should just listen to myself + not worry too much what Ed says. He said ~~we~~ yesterday to leave some of the excavations + cobbles in place. But now the cobbles are floating + don't make sense. I'm only leaving it b/c he said to yesterday, but if he hadn't, it would have been gone a long time ago.

1:07pm

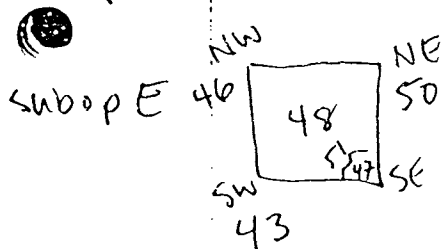

647E/001 0-10cm in unit 1
is complete. Only -10 sherds +
7 lithics

647E/002 10-30cm has begun.
Only a few cobbles + they could be
tumble from anywhere.

subop D 647D/007 ~~30-50cm~~ 30-50cm

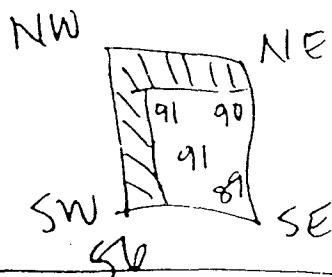

subop C The flat cobbles in C are 38cm b datum C.
+ E The flat cobbles in E unit 1 are 48cm b- datum C.
They may be a part of the level floor surface.
There are no rocks under either ones.

subop C

647C/014 in unit 6 0-10cm has a very nice pot smash w/ a lot of obsidian flakes. It appears to possibly have been an olla. It is only 36cm below datum C. Need to take a picture. And probably should draw it. It's near the NW ~~edge~~ edge of the structure. There really isn't any kind of a wall ... only something that's only 1 level of rocks.

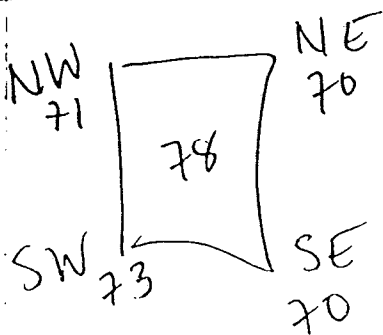
subop
E

after 647E/002
10-30cm

L.E. Schwartz

2006-19-22

PVN647

Subop E

647E/003 30-50cm

Fri., 14 Julio 2006
in unit 1

Subop C

647E/015 30-40cm in unit 2

Subop D

647D/008 50-60cm ending levels

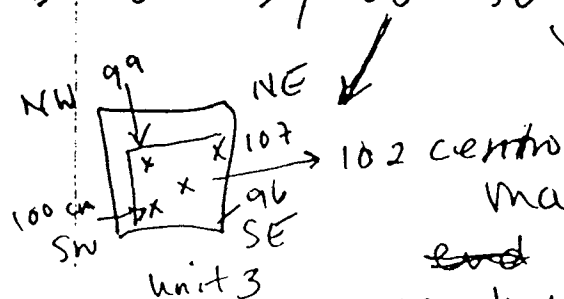

from the end of yesterday.

Manual says they have the bottom end of the wall that is ~~parallel~~ to the excavations, but it's not very clear. The wall is very well established as ending. There is a layer of soil under the last line of cobbles that's about 4cm thick -> fill of some sort.

8:13am

647D/009 - 60-70cm in unit 3 in front of wall. The soil is very hard + dense + dark. These last 10 cm should help ~~me~~ achieve a more sterile level + verify just how deep the wall is, but also how deep the artifacts go.

8:22am

Subop C

647E/015 30-40cm is being excavated @ Ed's request b/c he wanted the large orange-reddish rock that appear @ the bottom of unit 2. Salvador has since removed it + it's quite large + heavy. They are just excavating the rest of the unit down to an equal level.

Subop E

Jorge + Reynaldo are going down another 20cm to get down to more of the soil. + collect more artifacts

PVN647

Fri, 14 Julio 2006

→ Things that need to get done.

- ① Draw subop B profile
- ② Draw subop D profile
- ③ Draw subop C + E profile when they meet.
- ④ Draw facing of wall subop B
- ⑤ Draw wall facing of subop D
- ⑥ Draw walls (?) of subop C

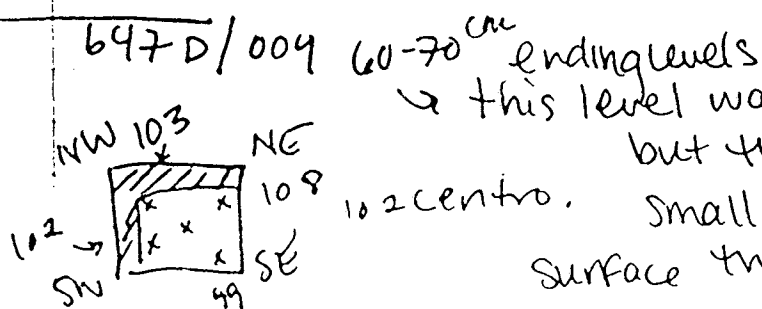
subop
D

→ this level was planned to be 10cm, but they came down upon a small cobble (baseball-sized) surface that is below the wall.

The order of the construction for here is that this small cobbled floor/surface was 1st + perhaps is other places in this plaza area. Then the wall (_____) was built on top of the cobble surface. Then (3rd) a thin layer of some kind of surface ... 3-4cm thick runs under the wall parallel to the excavation on the W side. Possible a floor ... but a prepared surface. Then lastly, the wall (_____) that abuts the basal wall (_____) was possibly constructed last.

9:31am

subop C +
E

647E/015 in unit 2 is still going down to make the ~~level~~ bottom of the unit level w/ the bottom of unit 1. They are find some bone fragments, some burned; some not.

647E/003 is find some burnt bone fragments too. They are also pulling out some material that appears to be older → Preclassic or something earlier than Late Classic or Classic.

PVN647

Fri., 14 Julio 2006

Subop C+E

The distance b/w where there are established units is w/in C + E is 3 meters.

For both subops combined, it's 10 meters long.

6 UNITS for subop C (b/c 2 are only 1m x 50cm) and 5 UNITS for subop E b/c they're all 1x1m units.

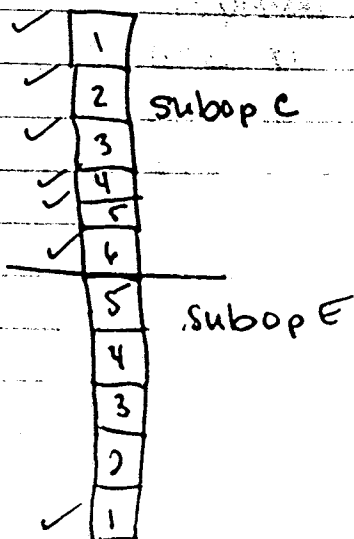

subop C 64C / 015 in unit 2

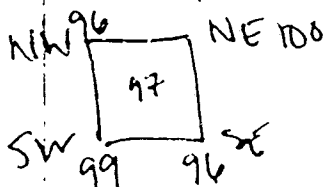

No cobbles @ all in this unit.

10:33am

Subop E

beginning levels from top of ground surface.

More units have been set up

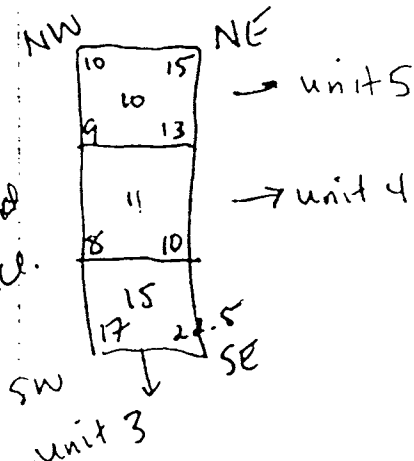

Cobbles hanging out of excavations

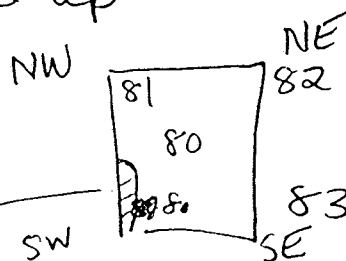

end levels of unit 1
647E / 003
30-50

PVN 647

Fri., 14 Julio 2006

10:47am

Oh God! What have I done?!?

Subop D is pretty much finished. The corner of the wall parallel to the excavations is a little unclear. I would pull some of it out... but Ed said he was coming in the afternoon, so I'll wait + have him look @ it.

So that means EVERYBODY is up on the platform. Jorge y Reynaldo finished

647E/003 30-50cm in unit 1 + have now started 647E/004 ~ 0-10cm in unit 2.

Not a complete 10cm, but on top of the cobbles (present) from unit 1.
visible

647E/005 0-10cm in unit 5 has started w/ Salvador y. merbin. They are going down to the same level as 647C/014 unit 6.

647E/006 0-10cm in unit 4 has started w/ Mammel y Don. N. We're trying to establish what's going on over this whole structure. Hopefully, we won't go very deep...

11:27am Subop E

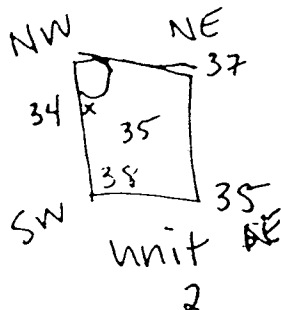
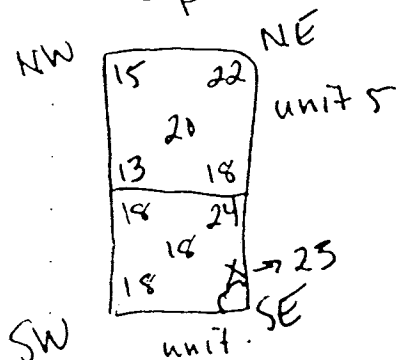

0-10cm

647E/007 0-10cm in unit 3 - 2 sherds 2 lithics

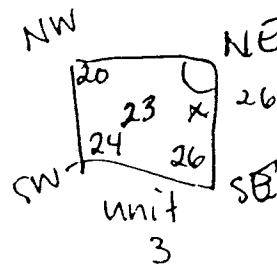

0-10cm

PVN647

Fri., 14 Julio 2006

11:57pm

It is a little early, but I had to cut it early for lunch. Moving all the guys to the same place wasn't the best idea, but their spirits ^{seem} a little up. Jorge has been great w/ me + w/ all the guys of constantly working. Salvador is the laziest son of a bitch. I'm not hiring him in the future.

But about the archaeology... So, the axial trench of subops C + E have met + it's crazy the # of lines! They're all running very nicely ~~para~~ parallel + perpendicular to each other. I had the guys clear the grass away from everywhere so you can see the other visible lines from the surface. It's crazy b/c it's hard to tell how deep the lines/walls go below cleaning them off. There's been no identifiable architectural pattern. One line of rocks composing a wall is very strange to me... but if that's the way it is, then so be it.

1:23pm

I started some drawings in subop B → the profile of the Eastern wall of the excavations.
Now a 2 new lots have begun.

647E/008 10-20cm bgs in unit 3. There is a wall/line along the Northern wall. They are cleaning down on the SE side of Str. 3. It should be the front that faces Str. 1 + 2.

647E/009 10-30 cm bgs in unit 2... but only along the Eastern wall. There are cobbles all along the Western side that are being preserved.

PVN647

Fri., 14 July 2006

1:31pm

Salvador y Melbin are cleaning up the rest of the trench by sweeping + removing plants. Then I'll be able to take nice photos w/ clean ^{excavation} floors. And I need to take photos of subop D.

2:22pm

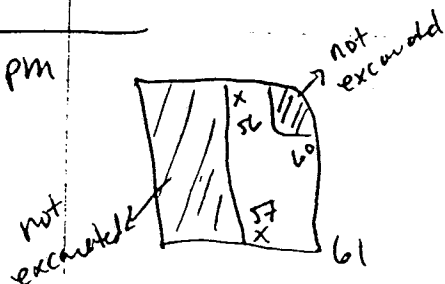

647E/009 10-30cm

NW

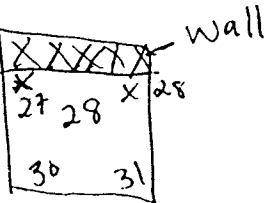
647E/008
unit 3 10-20cm

SW

647E/010 is 20-30cm in unit 3.

2:30pm

subop E

Ed just came by + said to excavate a little further down in front of the wall facing the rest of the plaza. That's what 647E/010 20-30cm in unit 3 is for. It's only in the NW corner along the southern side of the wall.

He also mentioned for the excavations to go a little deeper in unit 1 (beyond 50cm) to see how deep it goes.

Subop D

Lastly, he said to clean up the tumble in subop D along the N-S wall that runs parallel to the excavations.

L.B. Schwartz

2006-19-28

PVN 647

Fri., 14 July 2006

2:30pm

Ed also said that a lot of the cobbles in unit 2 were just tumble from the neighboring structure.

subop

E

647E/Ø1Ø 20-30cm - sherd, 2 lithics

PIN 647

Monday, 17 July 2006

8:32am There was a little sprinkle of rain this morning just as we got out here, but there are only white clouds now.

subop D $\phi 1 \phi$ 10-20cm w/in all the tumble along the parallel wall. (sherds + 1 lithic). This lot was only the tumble + only a few artifacts were recovered. This definitely helped clarify the wall a little better.

Manuel

y Don. Narciso removed all of the soil that was between the tumble + the white surface that's beneath it. The white surface is visible under the parallel wall + this lot attempted to only come down on top of the white layer. What was revealed is that only a thin layer of the white surface appears to around where the tumble was. Then again, right now the soil is still damp + moist + needs to dry out a little.

647D/ $\phi 11$ 20-30cm = sherds + 1 lithic.

subop E

647E/ $\phi 1 \phi$ 50-60cm bgs in unit 1 is attempting to find out more about the chronology of that platform. There are still artifacts coming out. And we'll probably keep going deeper until there are no more.

8:48am Manuel y Don Narciso have finished in subop D + are going to help Jorge + Reynaldo.

L.E. Schwartz

2006-19-30

PVN 647

Monday, 17 July 2006

Things that I need to do today are

- ① Finish excavations in subop D
- ② " " " " " E
- ③ Clean profile from subop B
- ④ Final Notes " "
- ⑤ Final photos of features subop B
- ⑥ Clean profile from subop C+E
- ⑦ Final Notes " "
- ⑧ Final photos^{features} " "
- ⑨ DRAW profile subop D
- ⑩ Final Notes " "
- ⑪ Final photos " "
- ⑫ Label all drawn + shot in points on rocks.

9:08am
subop E

647E/010 is now going to be a 20cm lot
50 → 70cm

large just completed 10cm + there ^{are} still artifacts, sherds, obsidian, chert, + 1 jute. Since artifacts are still coming out, the lot is being extended to a 20cm lot.

647E/010 sherds, lithics, jute

64E/011 70-80cm only 10 more

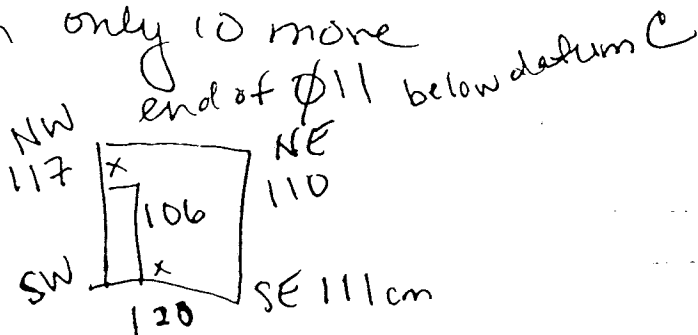
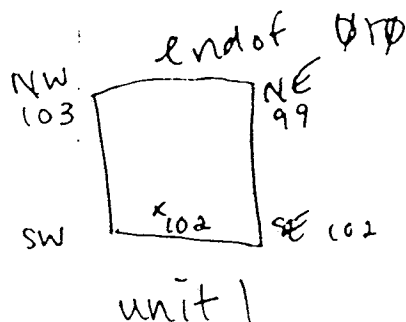

PN647 FINAL Notes (1) Monday, 17 July 2006

Intro.

7:35am

Intro
#

The following subops were excavated during Tuesday 11 July to Monday 17 July, 2006. The purpose of these excavations was to establish the chronology for PN647⁺ to ~~access~~ access the degree of architectural preservation. To do this, a sample of 3 areas ~~was~~ was taken. Subop B located on Str. 6 in the NE group; subop C located on the NW side of Str. 3; subop D located on the SE side (plaza side) of Str. 17; + subop E located w/in the middle of the platform w/ Str. 1, 2, + 3 + joins together w/ subop C to create a complete axial trench measures 10 meters in total oriented @ a 285° N angle.

Subop A is reserved for surface collection findings.

Subop B This ^{sub-}operation began by aligning 2 (1x1m) units @ an 21° N angle, which is ⊥ to the presumed lines on the summit of Str. 6 w/in the SE group.

The first 1x1m (unit 1) revealed only tumble + T.D. + only reached a base excavation depth of ~30cm bgs surface.

BLUE → Unit 2 revealed 2 named features. BLUE is ~30cm high the exterior basal wall to the south of Str. 6, which is also the plaza side. BLUE is ~2 courses high made up of medium-large cobbles w/ smaller chinking stones in b/w. The cobbles are unmodified river cobbles.

Yellow → The 2nd feature w/in unit 2 is Yellow. Yellow has been identified as being a burnt earthen surface.

PVNG47 FINAL NOTES ②

Monday, 17 July 2006

Subop B
YELLOW

YELLOW measures to be ~ 30 x 18 cm long along the eastern wall of the excavations. It does not go all the way up to BLUE, yet we preserved the surface @ that level w/ the excavations. But YELLOW does appear to be @ the base of ~~RED~~ BLUE but hard to tell if it goes under BLUE.

1:15 pm

On top of BLUE + \perp to it is ~~Red~~ PURPLE. PURPLE is only 1 course high. There are smaller cobbles under it + it is oriented w/ the excavation units. It is only 2 cobbles long + probably extends to the E. + forms some type of step out from RED.

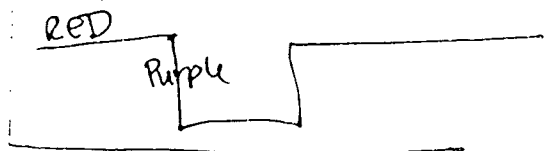

BLUE

RED is the final feature + it is a wall that is probably the outer wall facing of the summit room. Only 40-45 cm of RED were exposed. It is 1 course high w/ some smaller rocks at the base where BLUE is up against it. BLUE might be abutting RED w/ PURPLE on top of BLUE.

- Red ✓
- Blue ✓
- Purple ✓
- Yellow ✓
- Orange ✓
- Green ✓
- Black ✓
- Brown ✓

Subop
etc

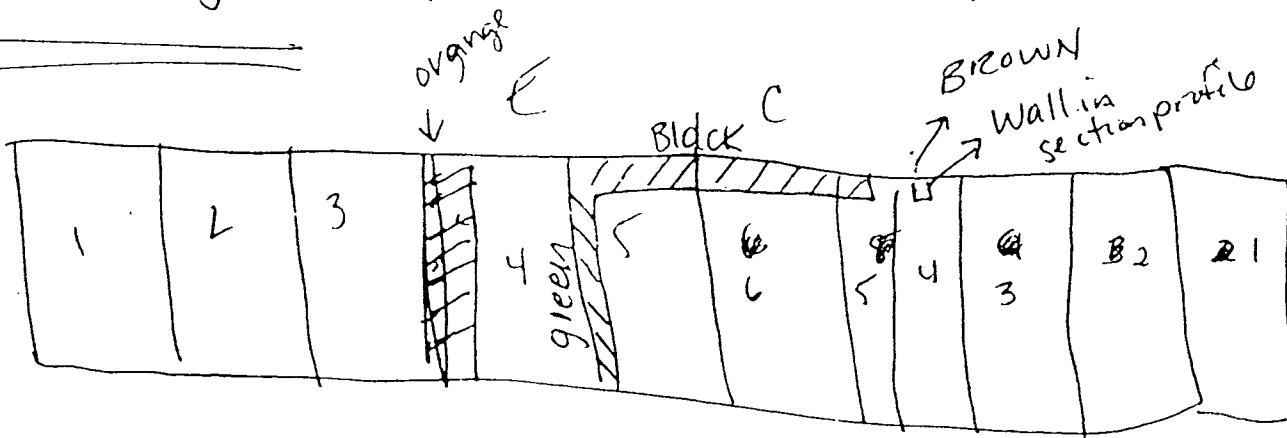

PNG47 FINAL NOTES (3)

Monday, 17 July 2006

2:12pm

Subop C

This subop was opened the way it was b/c I was confused. This subop originates to the NW of Str. 3 (back side from "plaza" / "patio" area w/ Str's 1 + 2. 3 meters were excavated before coming upon BROWN. BROWN is a low lying (~ 7-8cm bgs) single cobble feature. Actually, all "wall" features in subops C+E are only one line thick. There were other cobbles associated w/ BROWN, but they were pulled out b/c I wasn't convinced they were a line.

BROWN

Subop E
BLACK

BROWN (only a rock in profile is ~ 10cm high x 15cm long. Moving further up to the summit... BLACK appears in the W edge of the EU. BLACK is along the entire Wedge of EU 5 + 6 + Subop E EU 5. It is a low lying (surface to 5-7cm bgs) line of both cobbles + flat faced rocks (not shaped). BLACK is ~ 15cm wide x 2.3m long.

GREEN. BLACK joins w/ ~~orange~~ in the Southern edge of EU 5 ~~from~~ from Subop E. + Northern edge of EU 4. It consists of 2 cobbles in the EU's but extends on the surface of ~~an~~ unexcavated areas for ~ 3 meters.

GREEN

ORANGE

About 35cm S of the Southern facing of GREEN is the Northern facing of ORANGE. ORANGE is also low lying on the surface + is 2 cobbles wide. All of these walls are only 1 course high. From excavating @ the base of ORANGE we know there is only soil under it.

PVN647 FINAL NOTES (4) Mon., 17 July 2006

2:24pm

Subop E

ORANGE is ~ 60cm wide + extends the length of the EU (1m) + extends along the ground surface parallel to GREEN for ~ 3m. as well.

ORANGE

cont'd

EU's 1, 2 + maybe part of 3 each have low lying flat cobbles on the SW side of them. Ed says in EU 1 + 2 they appear to be tumble slipping off of neighboring str. 2. b/c it's only 1.5-2 m away.

Subop E has potentially shown that this rise is not natural but is human constructed.

Deep excavations revealed early ceramics + jade; indicating perhaps Early Middle Classic.

In all both of these subops reveal a lot.

Good preservation of artifacts + architectures (even though it is very shallow) but also a potential chronology for this E rise / platform b/c it's probably not natural.

Tuesday,
18 July 2006

PVN 647 FINAL NOTES (5)

Subop D

This subop was opened to get a sample of the artifact types from w/in this plaza group of structures. Str. 17 has 3 1x1m of a trench entering from the S (SW) side (or the plaza side) of the structure. Also this subop was opened on str. 17 to gain an understanding of the construction style, architecture + chronology for this area of the site. What was uncovered is ~~an~~ an exterior basal wall + another wall that is parallel to the excavations.

Basal wall of str. 17 is GRAY
+ to GRAY is PINK

GRAY

GRAY is the exterior basal wall on the south side (plaza side) of str. 17. It is 3 course high w/ med-small sized chinking stones. It is 1m long in Eu 3, but extends along the ground surface in unexcavated areas ~5 m. It has a height of 65cm from base to top + an estimated thickness of 20 cm oriented °N.

PINK

PINK is a N-S oriented wall of 35° N. PINK abutts GRAY in the NW corner of Eu 3. It only appears for 125 cm w/in Eu 2 + 3. It is 2 courses high = height of 33cm. (chinking stones?) It is 1.25m long. It is a combination of different types of rocks + v. cobbles. In Eu 2 it has... one large rock near the top w/ several medium-sized cobbles underneath. In Eu 3 there are 2 distinct courses of larger v.c's w/ small chinking stone in b/w.

w/ med-small
chinking
stones

(time)
10:41 am
Subop D

TEAL

PVN 647 FINAL NOTES (6) Tuesday, 18 July 2006
TEAL is a ^{small} cobble surface layer @ the base of GRAY. It extends the ~~complete~~ bottom of excavations w/in EU3. It was the first constructed feature b/c it is below everything. Cobbles = ~ 3x4 cm. ~~This~~ TEAL may extend under GRAY, but it is hard to tell for sure. It is about ~ 3-4 cm high. ~ 80 cm x 60 cm wide.

3-4 cm
thick

AQUA

AQUA is the thin layer of white material that is above TEAL, but below PINK + abutts w/ GRAY near to its base. It's hard to tell if it was a plaza surface b/c it is not preserved everywhere + shows up best in the Western side profile... it is not present to the East. It extends under PINK from GRAY to the South ~ 45-50 cm. It is definitely the 3rd feature to have been constructed in this area. B/c after ~ 4 cm of soil is the base of PINK. But AQUA definitely extends under PINK but not GRAY.

PINK clearly abutts GRAY + ~~it~~ is not interdigitated. to connect the 2 walls.

This subop of D has reveal about about this plaza area + order of construction.

conclusions

PVN 647

Tuesday, 18 July 2006

11:21am

We just changed the wooden datum stakes for the permanent metal ~~stake~~ stakes.

Datum 1 is fine + Jorge put a lot of cobbles around it.

The North Stake was also replaced.

We were measuring from the North Stake when it was 12cm bgs. We usually had the stake @ ~~4.2m~~ 4.2m. So, the machine knew that the stake was 12cm by calculating the height @ the North Stake.

So, next time to get the height to be the same w/ measurements from this year → 12cm needs to be taken into consideration.